



32D05NW0156 32 GARRISON

010

DIAMOND DRILLING

TOWNSHIP: GARRISON

REPORT NO: 32

WORK PERFORMED FOR: H.L. Mineral Holdings Ltd., Lanny Anderson

RECORDED HOLDER: Same as Above [xx]
: Other []

<u>Claim No.</u>	<u>Hole No.</u>	<u>Footage</u>	<u>Date</u>	<u>Note</u>
L 1029092	MRG-87-1	'987'	Dec/87	(1)
	MRG-87-2	1201.5'	Dec/87	(1)
		<u>2188.5</u>		

Notes: (1) #W8808.053, filed in July/88

DURHAM GEOLOGICAL SERVICES INC.
Box 734
TIMMINS, ONTARIO
P4N 7G2

DIAMOND DRILL HOLE LOG

PROJECT: Meridor Resources

HOLE NUMBER: MRG-87-1

AREA: Garrison Township

LOCATION: S.E. Claim of Claim Block

CLAIM NUMBER: 1029092

AZIMUTH: 335°

CORE SIZE: BQ

DIP: -45°

DRILLED BY: Norex Drilling

DATE: Dec 1987

LOGGED BY: R. D. Maass

CASING: 60.0'

CORE STORED AT Durham Geological Warehouse
Timmins, Ontario

LENGTH: 987'

OBJECTIVE: Geological Cross Section
Test Airborne Magnetic Low

ACID TEST	<u>Depth</u>	<u>Dip</u>
	0'	45°
	300	45°
	600'	47°
	987'	43°

DIAMOND DRILL HOLE LOG

Elevation		ROCK TYPE AND DESCRIPTION	Core Angle to Axis	% Sulphides	SAMPLE			Analytical Result	
From	To				Number	From	To	Length	
		472' 1' wide Fault Gouge Zone							
		471-472 Fault Breccia Zone		<1%	9168				
		472-476 Breccia Zone			9169				
		-tan siliceous angular fragments in dark green chloritic matrix			9170				
		476-483.1-chloritic mafic volcanics		<1%	9171				
		-with thin stringers of tan sericite-minor pyrite stringers			9172				
		493.5-495.0-epidote and hematite altered mafic volcanics with stringers of quartz-carbonate, hematite and fine pyrite		1%	9173				
		550-554-mafic volcanics with thin bands of tan sericite		1%	9174				
		-minor carbonate and pyrite							
		561-563-mafic volcanics with stringers of calcite and pyrite.		1%	9175				
563.0	570.9	Feldspar Porphyry		1%	9176				
		-dark grey groundmass with white euhedral feldspar phenocrysts-numerous white quartz-carbonate, light green epidote and orange hematite stringers			9177				

Footage		ROCK TYPE AND DESCRIPTION	Core Angle to Axis	% Sulphides	SAMPLE			Analytical Result	
From	To				Number	From	To	Length	
786.0	862.0	Sediments (Greywacke + Argillite)		70°	1%				
		-well banded-fine grain							
		-light grey color							
		-soft and easily scratched							
		809.5-812.5 sections-contain numerous quartz-				9192			
		828.4-831.7 carbonate veins, sericite and fine py.				9193			
		832.5-835.5				9194			
862	863	Fault Gouge							
863	876.3	Silicified Sediments		75°	1-2%	9195			
		-dark grey siliceous sediments				9196			
		-hard and not easily scratched				9197			
		-well foliated-minor quartz-carbonate veining-							
		stringers of finely disseminated pyrite							
876.3	903.1	Silicified Sediments with Sericite Bands				9198			
		-marked increase in quartz veining				9199			
		-sericite, fine pyrite and calcite also associated				9200			
		with veins				0301			
		-dark grey color-well foliated							

Footage		ROCK TYPE AND DESCRIPTION	Core Angle to Axis	% Sulphides	SAMPLE			Analytical Result	
From	To				Number	From	To	Length	
						0302			
						0303			
						0304			
						0305			
903.1	962.0	Sediments		<1%		0306			
		-light grey green color with several quartz,				0307			
		carbonate and sericite veins							
		-soft and easily scratched							
		-well banded							
962.0	967.8	Feldspar Porphyry		1-2%		0308			
						0309			
967.8	972.0	Siliceous Sediments		1-2%		0310			
972.0	977.1	Greywacke and Argillite		1-2%		0311			
977.1	978.6	Feldspar Porphyry		2-3%		0312			
978.6	987.0	Siliceous Sediments		1-2%		0313			
						0314			
		E.O.H. = 987 Feet							
		<i>Logged by Randy D Moass</i>							

DURHAM GEOLOGICAL SERVICES INC.
Box 734
TIMMINS, ONTARIO
P4N 7G2

DIAMOND DRILL HOLE LOG

PROJECT: Meridor Resources Limited

AREA: Garrison Township

CLAIM NUMBER: 1029092

CORE SIZE: BQ

DRILLED BY: Norex Drilling

LOGGED BY: Randy D. Maass

CORE STORED AT Durham Geological
Warehouse, Timmins

OBJECTIVE: Airborne Mag. Low

HOLE NUMBER: MRG-87-2

LOCATION: SE Corner of Property

AZIMUTH: 335°

DIP: -45°

DATE: December 1987

CASING: 22.0'

LENGTH: 1201.5'

ACID TEST	Depth	Dip
	0.0	45°
	400.0	44°
	1201.5	41°

DIAMOND DRILL HOLE LOG

Footage		ROCK TYPE AND DESCRIPTION	Core Angle to Axis	% Sulphides	SAMPLE			Analytical Result	
From	To				Number	From	To	Length	
396.7	402.0	Altered Mafic Volcanics							
		-pink-orange color composed of dark green chloritic and quartz							
		-numerous quartz and quartz-carbonate veinlets-							
		-minor fine pyrite							
		401-402 Fault Breccia Zone							
		-dark green chloritic matrix with orange angular siliceous fragments							
402.0	668.0	Massive Mafic Volcanics			0371				
		-dark green color with veins of light green epidote red hematite and white quartz-carbonate-fine pyrite associated with veining			0372				
		-fine to medium grain size			0373				
		-non-foliated-hard, siliceous and not easily scratched			0374				
		-fine-medium grain size			0375				
		466.8-466.9 Fault Breccia Zone			0376				
					0377				
					0378				
					0379				
					0380				
					0381				

DIAMOND DRILL HOLE LOG

Footage		ROCK TYPE AND DESCRIPTION	Core Angle to Axis	% Sulphides	SAMPLE			Analytical Result	
From	To				Number	From	To	Length	
668.0	1068.0	Greywacke/Argillite	70°	1-2%					
		-light to dark grey in color with the occasional							
		veinlet of quartz or quartz-carbonate							
		-fine grain with medium grain sections							
		-narrow yellow-green sericite altered							
		sections-soft and easily scratched							
		-well banded with alternating medium and fine							
		grain sediments							
		691.3 -692.6 sediments							
		-with numerous carbonate stringers giving the							
		rock a pseudo-brecciated texture							
		719.5-723.7 Silicified Sericite-Altered Sediments			0382				
		-quartz veinlets containing 1% fine pyrite							
		750.0-753.0 Graphitic Sediments			0383				
		783.6-796.0 Sediments			0384				
		-with several sericite-altered sections			0385				
		and quartz veining 1-2% fine pyrite			0386				
		931.0-952.0 Silicified Sediments			0387				
		-quartz-carbonate veins and sericite-altered							
		sections							

DIAMOND DRILL HOLE LOG

Footage		ROCK TYPE AND DESCRIPTION	Core Angle to Axis	% Sulphides	Number	SAMPLE		Analytical Result
From	To					From	To	
1164.2	1186.9	Epidote-Altered Mafic Volcanics			041			
		-volcanics have been altered						
		by light green epidote, pink feldspar						
		and transparent quartz						
1186.9	1194.0	Porphyritic Mafic Volcanics						
1194.0	1201.5	Mafic Volcanics			042			
		-with quartz-carbonate, chlorite, feldspar,			043			
		epidote veinlets and stringers-several broken			044			
		and brecciated sections						
		1197.5-1201.5 Silicified Mafic Volcanics	1-2%					
		1-2% fine pyrite						
	1201.5	End of Hole						
		<i>Logged by Randy D. Moore</i>						



DOCUMENT NO. W8808-053/88 Mining



32D05NW0156 32 GARRISON

900

AMENDED

Name and Postal Address of Recorded Holder

L. Mineral Holdings Ltd., Lanny ANGELSON

1-40431 4-42000

Suite 1900, 999 West Hastings Street, Vancouver, B.C. V6C 2W2

660 Suzanne Street, Timmins, Ontario

Garrison Twp.

Summary of Work Performance and Distribution of Credits

Total Work Days Cr. claimed 2040.	Mining Claim		Work Days Cr.	Mining Claim		Work Days Cr.	Mining Claim		Work Days Cr.
	Prefix	Number		Prefix	Number		Prefix	Number	
for Performance of the following work. (Check one only) <input type="checkbox"/> Manual Work <input type="checkbox"/> Shaft Sinking Drifting or other Lateral Work. <input type="checkbox"/> Compressed Air, other Power driven or mechanical equip. <input type="checkbox"/> Power Stripping <input checked="" type="checkbox"/> Diamond or other Core drilling <input type="checkbox"/> Land Survey									

Please see the attached list

All the work was performed on Mining Claim(s):

L 1029092

Required information eg: type of equipment, Names, Addresses, etc. (See Table Below)

Drilling Company	Drill Hole #	Footage
Norex Drilling, Porcupine, Ontario	MRG-87-1	987.0'
Size of Drill Core		
BQ	MRG-87-2	1201.5'
Dates of Diamond Drilling	Total Footage 2188.5'	
December 8-31, 1987		

RECORDED

FEB 26 1988

Receipt # _____

ONTARIO GEOLOGICAL SURVEY ASSESSMENT FILES OFFICE

MAR - 3 1988

RECEIVED

LARDER LAKE MINING DIV.

RECORDED

FEB 26 1988

7 18 | 9 | 10 | 11 | 12 | 13 | 14 | 15

Date of Report: Feb. 24/88

Recorded Holder or Agent (Signature): *Bruce Durham*

Certification Verifying Report of Work

I hereby certify that I have a personal and intimate knowledge of the facts set forth in the Report of Work annexed hereto, having performed the work or witnessed same during and/or after its completion and the annexed report is true.

Name and Postal Address of Person Certifying

Bruce Durham, P.O. Box 734, Timmins, Ontario P4N 7G2

Date Certified: Feb. 24/88

Certified by (Signature): *Bruce Durham*

Table of Information/Attachments Required by the Mining Recorder

Type of Work	Specific information per type	Other information (Common to 2 or more types)	Attachments
Manual Work	Nil	Names and addresses of men who performed manual work/operated equipment, together with dates and hours of employment.	Work Sketch: these are required to show the location and extent of work in relation to the nearest claim post.
Shaft Sinking, Drifting or other Lateral Work			
Compressed air, other power driven or mechanical equip.	Type of equipment	Names and addresses of owner or operator together with dates when drilling/stripping done.	
Power Stripping	Type of equipment and amount expended. Note: Proof of actual cost must be submitted within 30 days of recording.		
Diamond or other core drilling	Signed core log showing; footage, diameter of core, number and angles of holes.	Nil	Work Sketch (as above) in duplicate
Land Survey	Name and address of Ontario land surveyer.		Nil

MERIDOR RESOURCES LTD.

GARRISON TOWNSHIP

CLAIM LIST

MINING CLAIM

<u>PREFIX</u>	<u>NUMBER</u>	<u>WORK DAYS CREDIT</u>
L	741694	80
L	741695	80
L	741696	80
L	741697	80
L	789812	80
L	789870	80
L	792671	80
L	792672	80
L	792673	80
L	792674	80
L	792675	80
L	792676	80
L	792680	80
L	792681	80
L	792682	80
L	792683	80
L	792684	80
L	792687	80
L	792688	80
L	792689	80
L	792690	80
L	792691	80
L	792692	80
L	792693	80
L	792694	80
L	1029092	20
L	1029093	20

TOTAL NUMBER OF CLAIMS = 27

TOTAL DAYS CREDIT
FOR DIAMOND DRILLING

NUMBER OF DAYS
CREDIT CLAIMED

EXCESS DAYS TO
BE APPLIED AT
FUTURE DATE

2188.5

-

2040

=

148.5

February 19, 1988

To Whom It May Concern:

I, Lanny Anderson did stake two (2) mining claims numbered L1029092 and L1029093, in Garrison Township, Larder Lake Mining Division, on November 25, 1987. The claims were staked on a contract basis on behalf of HL Mineral Holdings Ltd., Lic # T4645.

The necessary forms have been signed transferring 100% interest to HL Mineral Holdings Ltd.

Yours truly,



Lanny Anderson

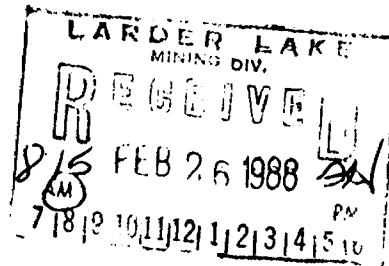

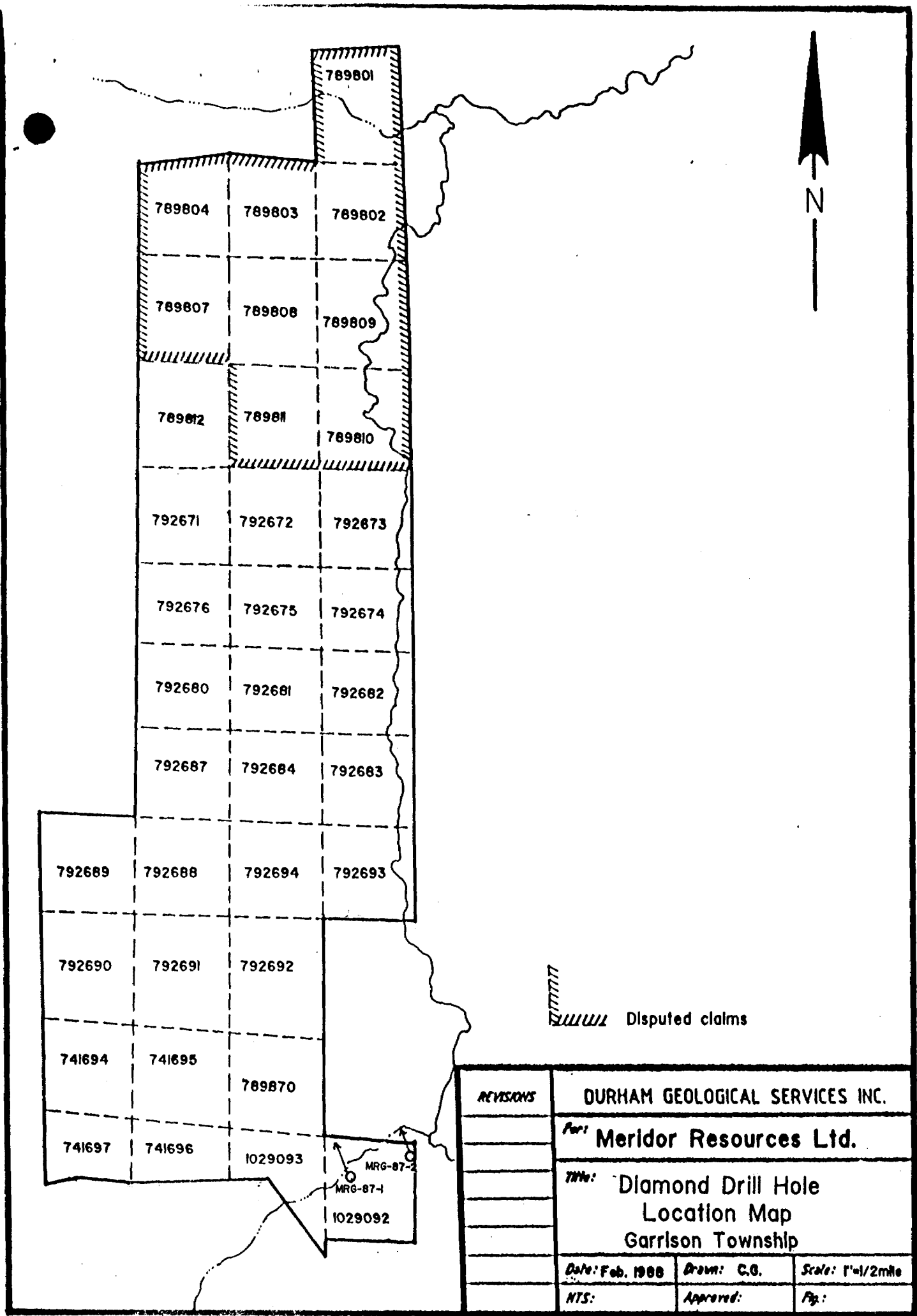

 Disputed claims

REVISIONS	DURHAM GEOLOGICAL SERVICES INC.		
	For:	Meridor Resources Ltd.	
	Title:	Diamond Drill Hole Location Map Garrison Township	
	Date: Feb. 1988	Drawn: C.G.	Scale: 1"=1/2mile
	NTS:	Approved:	Fig:

G-3038

PWT 10/21/83

G-3038

AREAS WITHDRAWN FROM DEPOSIT

- M.R.O. - MINING RIGHTS ONLY
- S.R.O. - SURFACE RIGHTS ONLY
- M+S. - MINING AND SURFACE RIGHTS

Description	Order No.	Date	Disposition	File
Sec. 34/130/70	N.F.W. 42/83	2/7/83	S.R. & M.R.	

Apply under Public Lands Act - proposed higher line

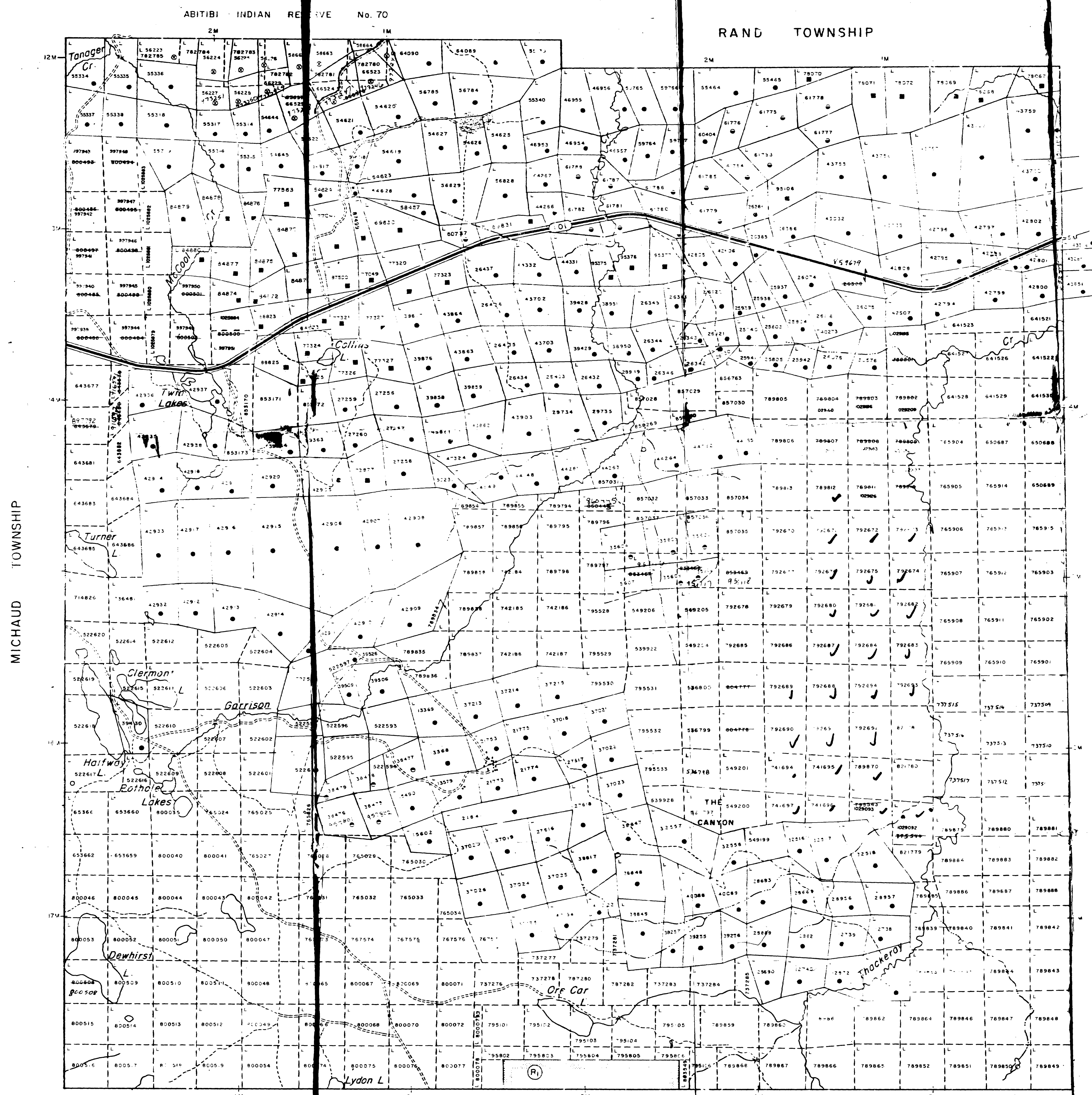

LEGEND

- HIGHWAY AND ROUTE
- OTHER ROADS
- TRAILS
- SURVEYED LINES
- TOWNSHIP, BASE LINES, ETC.
- LOTS, MINING CLAIMS, PARCELS, ETC.
- UNSURVEYED LINES
- EXT. LINES
- PANEL BOUNDARY
- MINING CLAIMS ETC.
- RAILWAY AND RIGHT OF WAY
- UTILITY LINES
- NAT. PERENNIAL STREAM
- FLOODING OR FLOODING RIGHTS
- SUBDIVISION OR COMPOSITE PLAN
- RESERVATIONS
- ORIGINAL SHORELINE
- MONUMENT MARKED
- MONUMENT

DISPOSITION OF COCHANE LINES

- TYPE OF DOCUMENT
- PATENT SURFACE & MINING RIGHTS
 - SURFACE RIGHTS ONLY
 - MINING RIGHTS ONLY
 - LEASE SURFACE & MINING RIGHTS
 - SURFACE RIGHTS ONLY
 - MINING RIGHTS ONLY
 - LICENCE OF OCCUPATION
 - ORDER IN COUNCIL
 - RESERVATION
 - CANCELLED
 - SAND & GRAVEL
- NOTE: MINING RIGHTS IN PARCELS PATENTED PRIOR TO MAY 8, 1913, VESTED IN ORIGINAL PATENTEE BY THE PUBLIC LANDS ACT, R.S.C. 1906, CHAP. 54, SEC. 68, SUBSEC. 1.

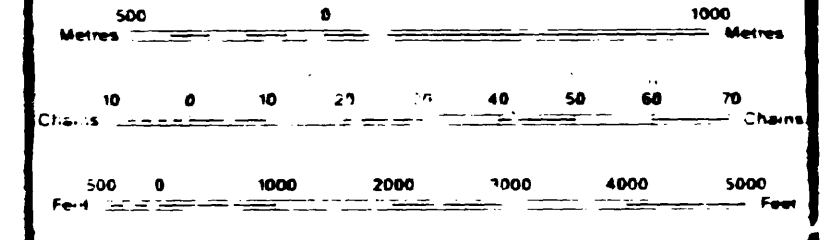

SCALE 1:20 000

Application for 5 Rights under public lands Act.

DATE OF ISSUE
FEB 16 1988
 LARDER LAKE
 MINING RECORDERS OFFICE

TOWNSHIP GARRISON

M.N.R. ADMINISTRATIVE DISTRICT
 KIRKLAND LAKE
 MINING DIVISION
 LARDER LAKE
 LAND TITLES / REGISTRY DIVISION
 COCHRANE

Ministry of Natural Resources Ontario
 Ministry of Northern Development and Mines

Date: SEPTEMBER 1986
 G-3038

8238

PWT 10/21/83

G-3038