



32D05NW0173 20 GARRISON

010

Diamond Drilling

Township Garrison

Report NO 20

Work performed by: Golden Croesus Mines Ltd.

Claim NO	Hole NO	Footage	Date	Note
L 71424	1	452	Nov/62	(1)

Notes: (1) Rec'd from cancelled claims; July/84

# DIAMOND DRILL RECORD

PROPERTY GOLDEN CRESCUS MINES LTD.

HOLE NO. No 18

SHEET NUMBER 1

SECTION FROM \_\_\_\_\_ TO \_\_\_\_\_

STARTED Nov-16 '62

LOCATION  
LATITUDE '707' ON CLAIM LINE S.W.  
FROM POST 2 CLAIM L71424

DATUM \_\_\_\_\_

COMPLETED \_\_\_\_\_

DEPARTURE \_\_\_\_\_

BEARING N 10° W

ULTIMATE DEPTH \_\_\_\_\_

ELEVATION \_\_\_\_\_

DIP - 50°

PROPOSED DEPTH 1000'

DEPTH FEET	FORMATION	SAMPLE NO.	WIDTH OF SAMPLE	GOLD \$	SLUDGE GOLD \$
0.0 - 8.0	CASING.				
8.0 - 400.0	UNIFORM LAYA, GREY FINE GRAINED SCATTERED QTZ STRS.				
30.6 - 33.9	BRECCIATED ZONE - EPIDOTE, GARNET, QTZ. ALTERATION MEDIUM MINERALIZATION				
37.2 - 1/2"	EPIDOTE STR.				
46.0 - 46.4	GARNET, EPIDOTE, ALTERATION - PORCELINIC SHARDS,				
47.3 - 47.6	EPIDOTE STRS. PORCELINIC SHARDS,				
50.0 - 75.0	MANY VERY FINE EPIDOTE STRS.				
73.8 - 1"	QTZ, CALCITE STRS.				
75.0 - 77.1	MOSTLY EPIDOTE LIGHT MINERALIZATION.				
96.2 - 98.5	" " " "				
109.5 - 110.8	QTZ. STRS. WELL MINERALIZED - HEMATITE AT CONTACTS.				
113.0 - 113.9	EPIDOTE STR.				
114.0 - 114.5	QTZ. STRS. WELL MINERALIZED				
125.0 - 150.0	MUCH EPIDOTE ALT.				
150.0 - 225.0	SCATTERED NARROW EPIDOTE STRS.				
198.5 - 200.0	NARROW CALCITE STRS.				
205.5 - 206.0	EPIDOTE WITH 1/2" CALCITE - HEMATITE STR. IN CENTER				
208.3 - 208.6	" STR.				
226.0 - 292.0	MANY CALCITE STRS - SOME WITH HEMATITE ON CONTACTS				

N.M.P., TORONTO - STOCK FORM NO. 501 REV. 12/51

292.0 - 375.0 HEAVY EPIDOTE ALT. SCATTERED LIGHTLY MIN. SECTIONS

DRILLED BY \_\_\_\_\_

SIGNED \_\_\_\_\_

*[Handwritten Signature]*

# DIAMOND DRILL RECORD

PROPERTY GOLDEN CRESCUS MINES LTD.

HOLE NO. 18

SHEET NUMBER 1  
 LATITUDE 27 2 20 W  
 DEPARTURE 20 2 45 S  
 ELEVATION \_\_\_\_\_

SECTION FROM \_\_\_\_\_ TO \_\_\_\_\_  
 DATUM \_\_\_\_\_  
 BEARING N 10° W  
 DIP - 50°

STARTED NOV. 16th, 1962  
 COMPLETED Dec. 16th, 1962  
 ULTIMATE DEPTH 752  
 PROPOSED DEPTH 1,000

DEPTH FEET	FORMATION	SAMPLE NO.	WIDTH OF SAMPLE	GOLD g	SLUDGE GOLD g
0.0 - 8.0	Casing				
8.0 - 525.6	Uniform lava - grey, fine grained scattered narrow qtz str.				
30.6 - 33.9	Brecciated Zone - epidote, garnet - qtz - alteration medium mineralization				
37.2 - 1/2 in	Epidote str.				
46.0 - 46.4	Garnet, epidote alteration porcelanitic shards				
47.3 - 47.6	Epidote str.				
50.0 - 75.0	Many hairline stringers - epidote - pers. shards.				
73.8 - 1"	Quartz str.				
75.0 - 77.1	Mostly epidote - light mineralization.				
96.2 - 98.5	" " " "				
109.5 - 110.8	Qtz str. Well mineralized - hematite at contacts				
113.0 - 113.9	Epidote str.				
114.0 - 114.5	Qtz. str. well mineralized				
125.0 - 150.0	Much epidote alt.				
150.0 - 225.0	Scattered narrow epidote str.				
198.5 - 200.0	Narrow calcite str.				
205.5 - 206.0	Epidote with 1/2 calcite - hematite str.				
208.3 - 208.6	Epidote str.				
226.0 - 292.0	Many calcite str. Some with hematite on contacts.				
292.0 - 375.0	Heavy epidote alt. Scattered light mineralized sections.				





32D05NW0173 20 GARRISON

900

**IMPORTANT**

Attach sketch showing location of work in relation to corner posts, and nature and extent thereof.

Form 12 A  
25M-59-360

**THE MINING ACT**



**REPORT OF WORK**

To the Recorder of Larder Lake Mining Division:

I, Golden Croesus Mines Ltd.  
(Name of Applicant)  
Suite 301, 69 Yonge Street, Toronto  
(Post Office Address)

the recorded holder of mining claim No. L. 71424 hereby report the performance of 90-2/5 days' work not before reported, to be applied to this claim.

\*This mining claim is one of a group of contiguous claims numbered L. 71417, L. 71420, L. 71423, L. 71424, L. 71425

of which I am the recorded holder under Mining License No. A. 35575 and the work was performed on mining claim(s) L. 71424 and is to be applied

in respect of mining claim(s) as above (\*Complete above section only if applicable)

The work is as follows:

Stripping or opening up mines, sinking shafts or other actual mining operations

The names and addresses of the men who performed the work and the dates upon which each man worked in its performances are: (If more space is required, attach list)

.....  
.....  
.....

Diamond or other Core Drilling Total No. of days .....

Footage drilled 452 No. of holes drilled 1 Angle -50°  
Diameter of core 1-1/8 Names and addresses of owner and operator of  
drill J.L. Pilon Ltd., North Bay

Dates upon which drilling was done Nov. 19 to Dec. 16, 1962 (Note: This is balance of 752' of drilling of which 300' was reported Nov. 26/62)

Total No. of days 452

Work by Compressed Air or other Power Driven Rock Drill or Mechanical Equipment.

Type of drill .....  
Names and addresses of men engaged in operating drill.

Dates upon which each man worked .....  
Total No. of days .....

RECORDED FEB 6 1963  
R.C. No. ....

The penalty for making a false statement in this certificate is \$500. or six months imprisonment or both.

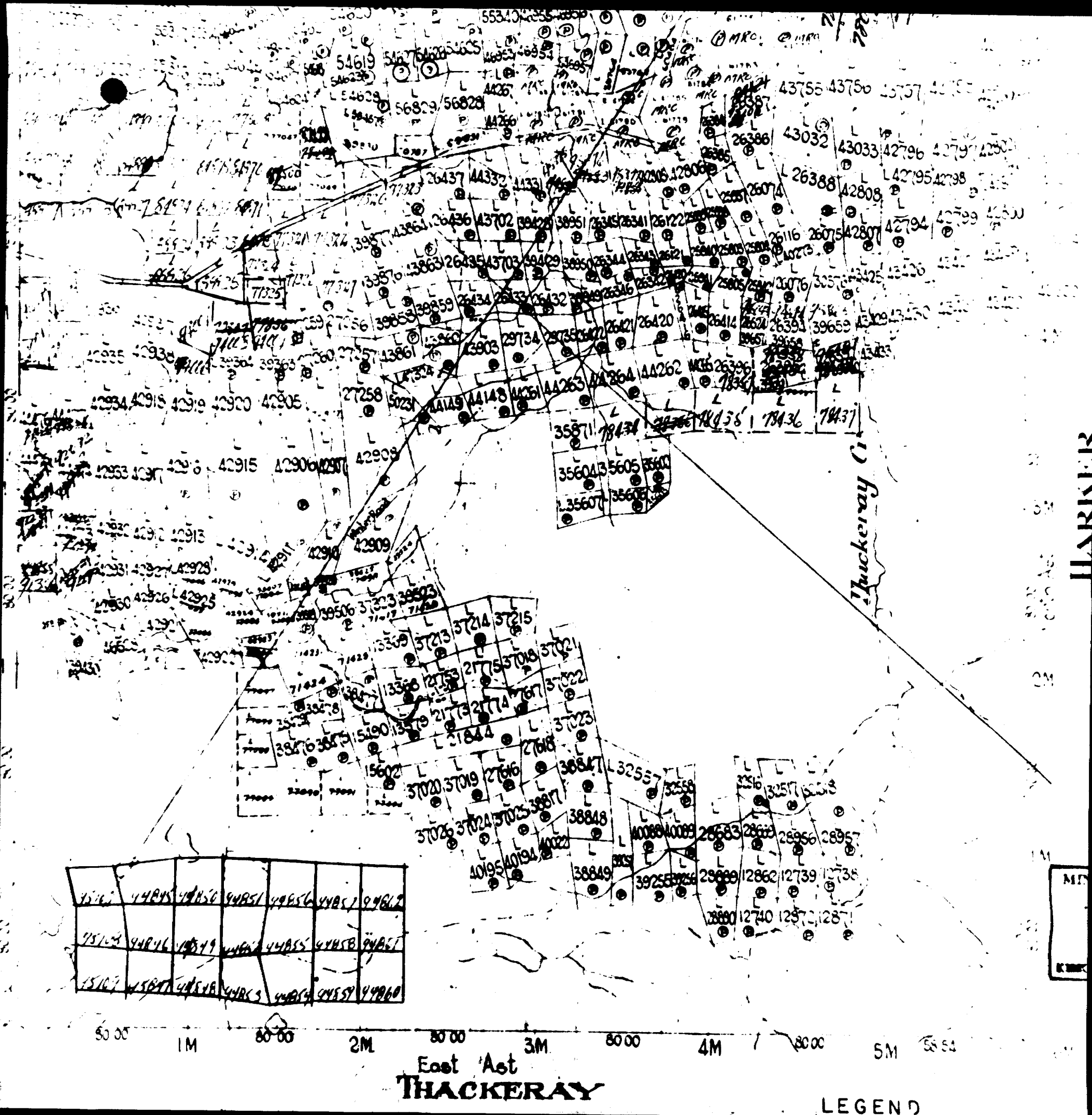

44812	44815	44816	44817	44818	44819	44820
44821	44824	44825	44826	44827	44828	44829
44830	44833	44834	44835	44836	44837	44838

East Ast  
**THACKERAY**

LEGEND

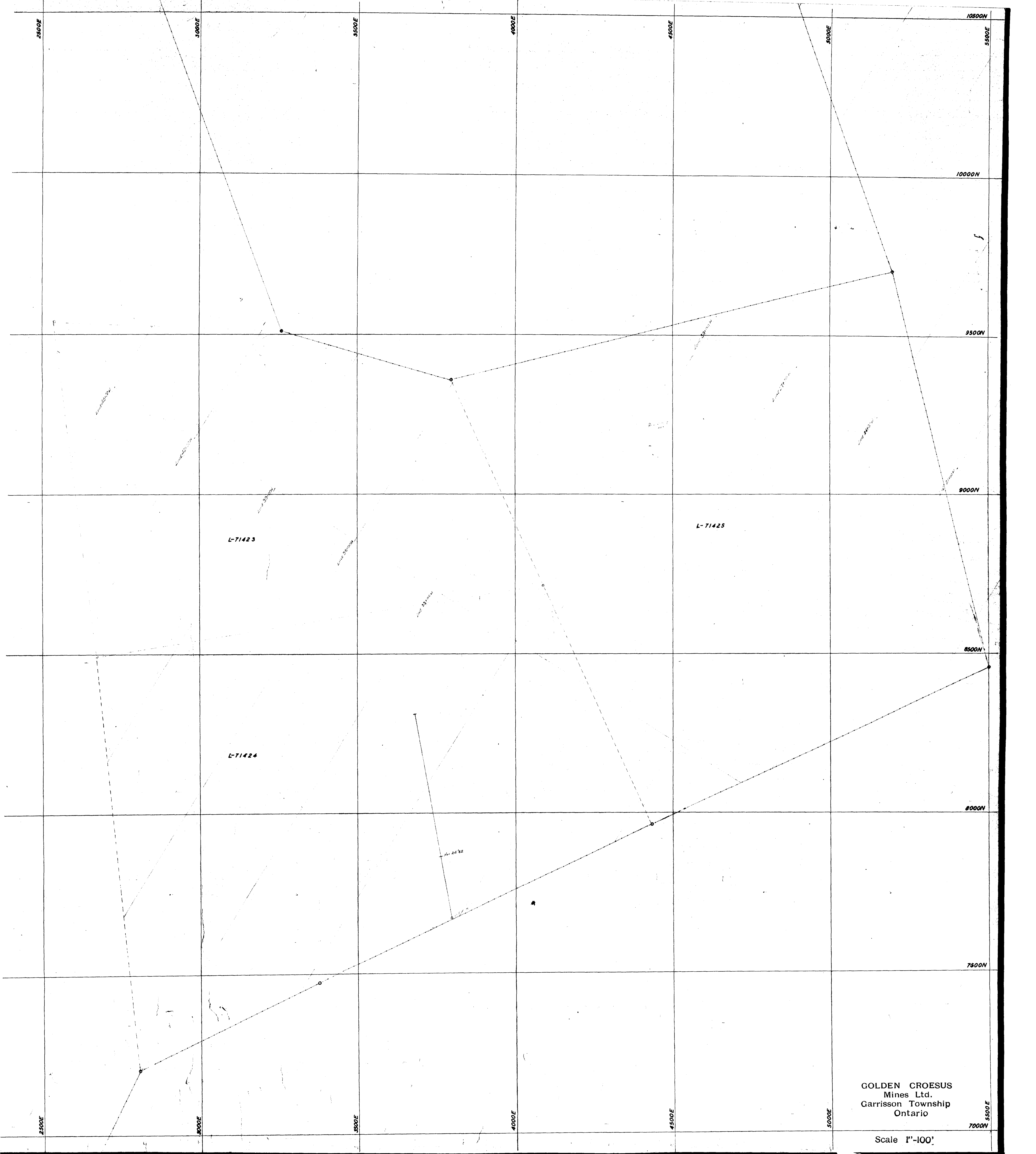

L-71423

L-71425

L-71424

GOLDEN CROESUS  
Mines Ltd.  
Garrison Township  
Ontario

Scale 1"=100'

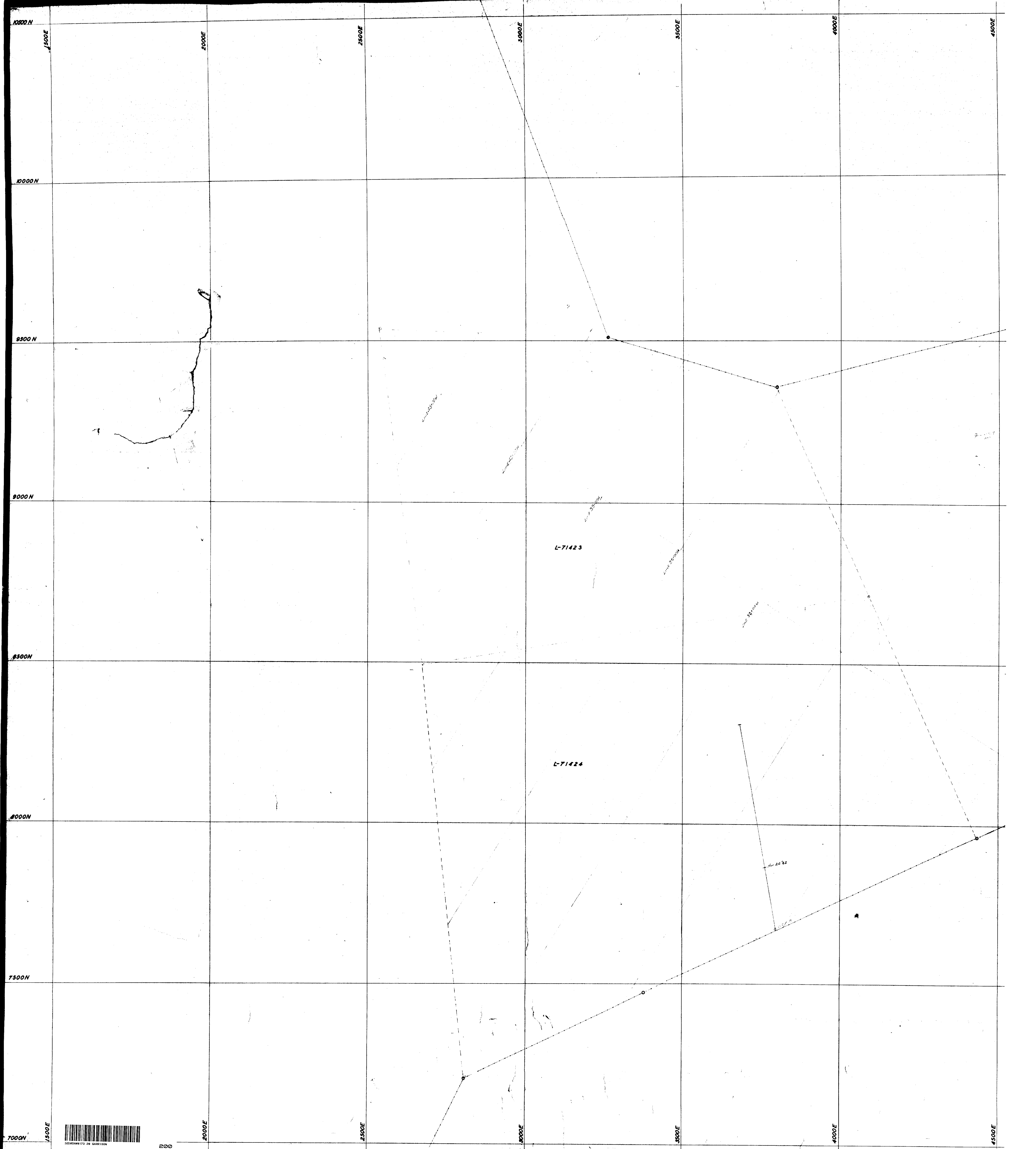

10500 N  
10000 N  
9500 N  
9000 N  
8500 N  
8000 N  
7500 N  
7000 N

1500E  
2000E  
2500E  
3000E  
3500E  
4000E  
4500E

L-71423

L-71424

