



32D05NW0378 56 HARKER

010

DIAMOND DRILLING

TOWNSHIP: HARKER TWP.

REPORT NO:56

WORK PERFORMED FOR: American Barrick Resources

RECORDED HOLDER: Same as Above [xx]  
: Other [ ]

<u>Claim No.</u>	<u>Hole No.</u>	<u>Footage</u>	<u>Date</u>	<u>Note</u>
<sup>38</sup> 783088	MC-87-370	263.96m	Dec/87	(1)

NOTES: (1) #505/87, filed in June/88

# DIAMOND DRILL RECORD

Cone size BQ measurement - Metric.  
Section 22+00E

NAME OF PROPERTY Foster - Harley  
 HOLE NO. Mc 87-370 LENGTH 263.96m (866 feet)  
 LOCATION 22° E, ~~22° S~~ 17 50 S  
 LATITUDE na DEPARTURE na  
 ELEVATION Surface AZIMUTH 360° DIP -60°  
 STARTED December 16, 1987 FINISHED December 23, 1987

FOOTAGE	DIP	AZIMUTH	FOOTAGE	DIP	AZIMUTH
45.72	60.5°		228.60	60.5°	
91.44	59.5°				
137.16	59.5°				
182.88	62.5°				

HOLE NO. 87-370 SHEET NO. 1 of  
 REMARKS Casing left in ground  
Metric

LOGGED BY Gary Baschuk.

FOOTAGE		DESCRIPTION	SAMPLE				ASSAYS				
FROM	TO		NO.	% SULPHIDES	FOOTAGE			%	%	OZ/TON	OZ/TON
					FROM	TO	TOTAL				
0	41.45	Casing.									
41.45	44.07	mafic syenite									
44.07	50.90	Foliated Basalt									
50.90	90.66	Magnetic Basalt									
90.66	101.85	Basalt									
101.85	232.80	Magnetic Basalt									
232.80	263.96	Basalt									
	263.96	End of Hole (866 feet)									

# DIAMOND DRILL RECORD

NAME OF PROPERTY Foster Harley  
 HOLE NO. Mc. 87-370 SHEET NO. 2 of 8

FOOTAGE		DESCRIPTION	SAMPLE			ASSAYS				
FROM	TO		NO.	% SULPH IDES	FOOTAGE		%	%	OZ/TON	OZ/TON
					FROM	TO				
0	41.45	Casing								
41.45	44.07	Mafic syenite Fine grained, red to gm, weakly foliated intrusive. Minor brecciation. The start of the unit is at 40.75m. The section is altered with chlorite along foliation planes. locally magnetic, moderately <sup>pervasively</sup> carbonated with calcite throughout. The lower contact is indistinct and gradational to the underlying basalt. Foliation at 41.5 m at 23 degrees to core axis. Basaltic fragments are incorporated into the lower 1 m of the intrusive. Lower contact is in rubble, highly fractured section with clay-grit seam.								
44.07	50.90	Foliated Basalt Fine grained, strongly foliated unit with grey to purple silicified fragments comprising 5 to 10% of the section. The silicification is most intense in the upper 2m, decreasing gradually down section. The rocks are strongly pervasively carbonated. Non-magnetic throughout. Pyrite occurs as fine disseminations and stringers along foliation planes comprising 1% of the unit. The foliation is @ 25 degrees at 44.65m, 17 degrees @ 46.80 m. The lower contact is gradational and taken where foliation has decreased to very weak and chlorite fracture fillings have terminated.								

# DIAMOND DRILL RECORD

NAME OF PROPERTY Foster-Harley  
 HOLE NO. Mc. 87-370 SHEET NO. 3 of 8

FOOTAGE		DESCRIPTION	SAMPLE			ASSAYS					
FROM	TO		NO.	% SULPHIDES	FOOTAGE			%	%	OZ./TON	OZ./TON
					FROM	TO	TOTAL				
50.90	90.66	<p>Basalt: Magnetic</p> <p>Fine grained, green massive flow. The upper 3m is moderately to strongly pervasively carbonatized with intensity decreasing down section. Carbonate stringers 1 to 5mm in width comprise 3 to 5% of the section decreasing amount down section below 59m. Magnetics become noticeable below 54m, where carbonatization terminates. Fine grained, dark green to green, magnetic intrusive is noted from 54.5 to 54.71m. Contacts at 62 and 83 degrees to core axis, non-chilled and sharp. traces of py &amp; po noted throughout section as fine disseminations and splashes. Weak specular hematite &amp; carb filled shear noted at 59.2m at 56 degrees to core axis. No shearing in adjacent basalts. Fine magnetite grains are noted throughout the unit comprising 2% of the rock. Grain size increases down section, gradually, to medium-grained by 62m. Quartz veining at 20 degrees to core axis noted from 66.7 to 67.15m. 3;5% py within veins.</p> <p>By 69.7m, the flow becomes granular with a mottled texture and increased qtz and or cb stringers to 5%.</p> <p>73.45 to 74.45 m : grey to locy greenish-pink intensely silicified zone with 2 to 4% finely diss. py. non-carbonatized, non-magnetic</p> <p>Below this section, the magnetics become more sporadic in the mottled textured sections. Mafic intrusive (trap) noted from 74.67 to 75.30m. This is fine grained, pale green to green with contacts</p>									

# DIAMOND DRILL RECORD

NAME OF PROPERTY Foster-Harley  
 HOLE NO. Mc. 87-370 SHEET NO. 4 of 8

FOOTAGE		DESCRIPTION	SAMPLE			ASSAYS					
FROM	TO		NO.	% SULPH IDES	FOOTAGE			%	%	OZ./TON	OZ./TON
					FROM	TO	TOTAL				
		<p>sharp and non-chilled at 57 and 59 degrees to core axis. Localized sections, eg. 76.7 to 77.5m is chloritic and fine grained with magnetite speckling. An increase in carbonate fracture fillings is noted within this section along with moderate to strong pervasive carbonatization. Qtz-carbonate stringers with 2 to 3% finely disseminated py noted at 87.6m within a chlorite-rich section as described from 76.7 to 77.5m. The lowest 1m is ofg to aph.</p>									
90.66	101.85	<p>Basalt                      The section grades from a weakly foliated flow top breccia into a zone of carbonate filled amygdaloid into a fine grained green to dark green massive basalt. Within the flow top, the fragments often have wispy contacts and traces of py in the matrix with minor qtz pods and grey silicified fragments. The flow top extends to 94.64m. The amygdaloidal portion extends to 96.3m where the flow grades into a more chloritic section with a mottled texture and traces to 1% finely disseminated py. This continues to 99.15m where a fine to medium grained massive flow dominates. This flow has a "fish-net" texture and fines to 101.85m where a second flow top is noted.</p>									

# DIAMOND DRILL RECORD

NAME OF PROPERTY Foster-Harley  
 HOLE NO. Mc. 87-370 SHEET NO. 5 of 8

FOOTAGE		DESCRIPTION	SAMPLE			ASSAYS					
FROM	TO		NO.	% SULPH IDES	FOOTAGE			%	%	OZ./TON	OZ./TON
					FROM	TO	TOTAL				
101.85	232.80	<p><i>Basalt - Magnetic</i></p> <p>101.85 - 119.88 Flow top breccia grading into amygdoidal flow from 105.05 to 106.45m, then into a massive, mottled flow. The top is aphanitic to very fine grained with purple grey siliceous fragments within a chloritic matrix. 10% carbonate fracture fillings. The amyg. flow is fg, dk green to green with 5% white carbonate filled amygdules. This grades into a fg dk green, magnetic massive flow. Section at 113.75 to 113.90m is highly magnetic with quartz veining and 1% Py.</p> <p>119.88 130.35 ft with chl and py filled amygdules grading into to, dk gn mass flow. tr py noted throughout the section. Magnetic, carbonate, qtz and epidote stringers comprise 2-3% of the rock.</p> <p>130.35 139.86 continuation of the above mass flow, but the rock are highly magnetic with a purplish coloration, 2-3% qtz-carb stringers with tr - 1% Py. Dominant orientation is at 40-45 degrees, and an older set at 75 degrees to core axis.</p> <p>139.86 152.30 continuation of the mass, magnetic flow from 119.88 to 130.35 m. The rocks are fine to med. grained, mag and dk gn to gn. Locally fish-net text. noted.</p>									

# DIAMOND DRILL RECORD

NAME OF PROPERTY Foster-Harley  
 HOLE NO. Mc. 87-370 SHEET NO. 6 of 8

FOOTAGE		DESCRIPTION	SAMPLE			ASSAYS				
FROM	TO		NO.	% SULPH IDES	FOOTAGE		%	%	OZ/TON	OZ/TON
					FROM	TO				
101.85	232.80	U7m continued;								
	152.30	188.29								
		weakly brecciated, aphanitic, dk gn to black flow top, rapidly grading into a massive flow. tr py noted within top * Rare glomerophyritic Feldspar phenocrysts are noted in clumps up to 5 mm across. These are concentrated at 154.40 to 163.8 m comprising 1% of the rock. The mass portion is fg, dk gn, locally chloritic with tr py and 1% chlorite fracture filling at variable angles to core axis.								
	188.29	206.40								
		Altered magnetic basalt. Aphanitic to very fine grained, locally silicified, locally foliated basalt cut by 10 to 20% qtz veins with 3-5% py crystals. Locally the rocks are strongly foliated w/ chloritic and purple hematized bands at 30 deg to core axis from 194.70 to 198.1 m. Highly weathered section at 194.20 to 194.60 m withankerite and calcite plus tr-1% Py. The section is locally carbonatized.								

# DIAMOND DRILL RECORD

NAME OF PROPERTY Foster-Harley  
 HOLE NO. Mc. 87-370 SHEET NO. 7 of 8

FOOTAGE		DESCRIPTION	SAMPLE			ASSAYS				
FROM	TO		NO.	% SULPH IDES	FOOTAGE		%	%	OZ/TON	OZ/TON
					FROM	TO				
101.85	232.80	U7m cont;								
		206.40 232.80 massive flow. Fine grained, dk gn to black flow. The magnetics are sporadic. This section is a continuation of the above altered section, but qtz veining is minor and less than 1% of the section, ti: 1%. Finely diss. py is noted throughout the unit. 1% wt feldspar grains are noted scattered throughout averaging 1-2mm in length.								
232.80	263.96	V7								
		232.80 250.05 Fine grained massive flow with variolitic, weakly brecciated flow top with 10cm of chert at the upper ct at 20 degrees to core axis. 5% qtz. veins are noted within the top containing 1-2% pyrite. The grain size increases down section to med. grained with a sub-optic texture below 243.5m. By 249.3, the grain size is decreasing to very fg. and becomes aphanitic by the lower contact. These mg and contact zone rocks are grey green and mag. The lower ct is at a selvage.								



# DIAMOND DRILL RECORD

NAME OF PROPERTY Foster-Harley  
 HOLE NO. Mc. 87-370 SHEET NO. 8 of 8

FOOTAGE		DESCRIPTION	SAMPLE			ASSAYS					
FROM	TO		NO.	% SULPH IDES	FOOTAGE			%	%	OZ/TON	OZ/TON
					FROM	TO	TOTAL				
		V7 continued; 250.05 263.96 pillowed flow: Very fine grained, green to pale green pillows with chloritic selvages, locally with up to 30% massive pyrite. Selvages are generally well developed with good chills averaging 2-5cm in width. Locally qtz and cb are noted in selvages. Minor qtz veining is noted at 262.5 m with traces of py - not within selvege.									
263.96		end of hole. (866') Drill hole to be continued									

*Gary Bascauk*  
 GARY BASCAUK

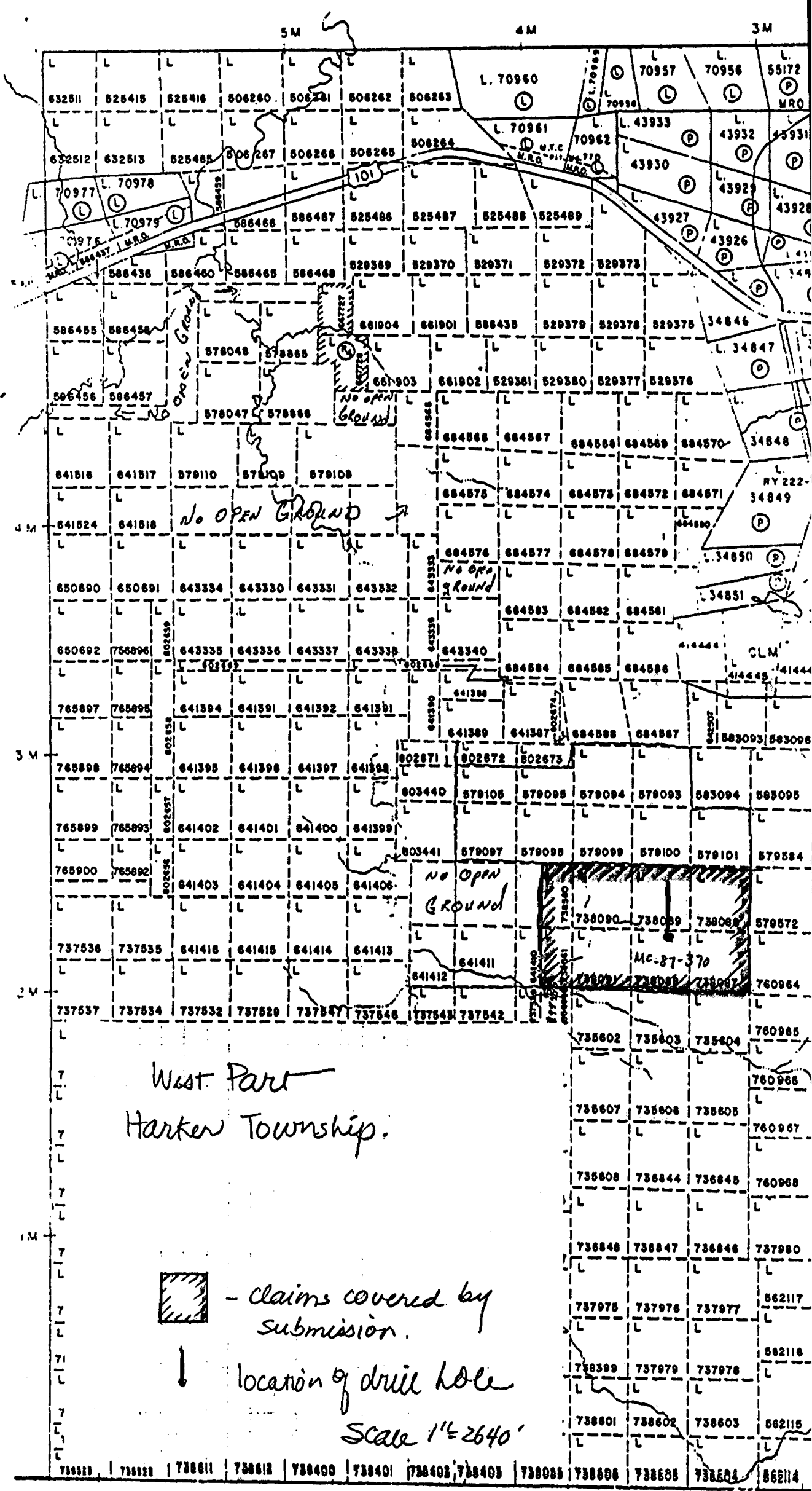

- claims covered by submission.

↓ location of drill hole

Scale 1" = 2640'

West Part  
Harker Township.

13E 14E 15E 16E 17E 18E 19E 20E 21E 22E 23E 24E 25E 26E 27E 28E

B.L. 13+75S

738089

738086

738088

738087

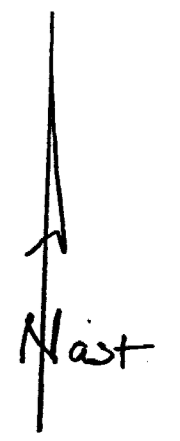
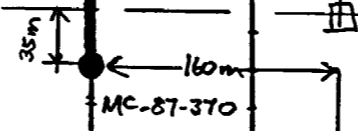

DDH MC-87-370  
Line 22E @ 17+50m S

Scale 1:5000.

L-738088

L-738089

MC-87-370

L 22+00E @ 17+50S

Az. 0°

0vb = 36m

mafic oysterite

Foliated Basalt

Magnetic Basalt

Basalt

magnetic Basalt

ion

201

Basalt

26396m.

SECTION DDH MC-87-370.

L 22E @ 17+50mS.

1:1000



#505/



Mining A

32D05NW0378 56 HARKER

900

Name: *Harker Corp*  
 Postal Address of Recorder/Holder: *American Barrick Resources Corporation | 1-854*  
*Box 1203, 953 Government Road West, Kirkland Lake, On. P2N 3M7*

Summary of Work Performance and Distribution of Credits

Total Work Days Cr. claimed <i>866</i>	Mining Claim			Mining Claim			Mining Claim		
	Prefix	Number	Work Days Cr.	Prefix	Number	Work Days Cr.	Prefix	Number	Work Days Cr.
for Performance of the following work. (Check one only) <input type="checkbox"/> Manual Work <input type="checkbox"/> Shaft Sinking Drifting or other Lateral Work. <input type="checkbox"/> Compressed Air, other Power driven or mechanical equip. <input type="checkbox"/> Power Stripping <input checked="" type="checkbox"/> Diamond or other Core drilling <input type="checkbox"/> Land Survey	L	738086	120						
		738087	120						
		738088	120						
		738089	120						
		738090	120						
		738091	120						
		738560	100						
	738561	46							

All the work was performed on Mining Claim(s): *L 738088 and 738089 (com on 738088)*

Required Information eg: type of equipment, Names, Addresses, etc. (See Table Below)

*Diamond Drilling, BQ Core, December 16-23, 1987*

*Work performed by:*  
*Philippon Diamond Drilling Inc*  
*CP. 788,*  
*829 Boulevard Quebec*  
*Rouyn Quebec J9X 5C7*

ONTARIO GEOLOGICAL SURVEY  
 JAN 5 1988  
 RECEIVED

RECORDED  
 DEC 29 1987  
 Receipt # \_\_\_\_\_

Date of Report: *December 23/87* | Recorded Holder or Agent (Signature): *Dale R Alexander*

Certification Verifying Report of Work

I hereby certify that I have a personal and intimate knowledge of the facts set forth in the Report of Work annexed hereto, having performed the work or witnessed same during and/or after its completion and the annexed report is true.

Name and Postal Address of Person Certifying:  
*DALE R ALEXANDER, AMERICAN BARRICK RESOURCES, KIRKLAND LAKE*  
*P2N 3M7*

Date Certified: *Dec 29/87* | Certified by (Signature): *Dale R Alexander*

Table of Information/Attachments Required by the Mining Recorder

Type of Work	Specific information per type	Other Information (Common to 2 or more types)	Attachments
Manual Work	Nil	Names and addresses of men who performed manual work/operated equipment, together with dates and hours of employment.	Work Sketch: these are required to show the location and extent of work in relation to the nearest claim post.
Shaft Sinking, Drifting or other Lateral Work			
Compressed air, other power driven or mechanical equip.	Type of equipment	Names and addresses of owner or operator together with dates when drilling/stripping done.	
Power Stripping	Type of equipment and amount expended. Note: Proof of actual cost must be submitted within 30 days of recording.		
Diamond or other core drilling	Signed core log showing; footage, diameter of core, number and angles of holes.		Work Sketch (as above) in duplicate
Land Survey	Name and address of Ontario land surveyor.	Nil	Nil