



32D05NW2074 2.20459 HARKER

010

GEOPHYSICAL SURVEY REPORT

ON

THE IRIS PROPERTY

MAGNETOMETER & ELECTROMAGNETIC SURVEYS

HARKER & ELLIOTT TOWNSHIPS

LARDER LAKE MINING DIVISION

DISTRICT OF COCHRANE, ONTARIO

FOR

ALEXANDER H. PERRON

JULY 24, 2000

WENDY K. WELLER
GEOTECH

2. 20459



TABLE OF CONTENTS

32D05NW2074 2.20459 HARKER

010C

SUMMARY. i)

INTRODUCTION 1

LOCATION AND ACCESS. 1, 2

REGIONAL GEOLOGY 2

PROPERTY HISTORY 2

PREVIOUS WORK 2, 3

INSTRUMENTATION. 4

PRESENTATION AND DISCUSSION OF RESULTS 4, 5, 6

OBSERVATIONS AND RECOMMENDATIONS 6

ASSESSMENT DATA FORM 7

TECHNICAL DATA 8

BIBLIOGRAPHY 9

CERTIFICATE. 10

FIGURES, TABLES AND MAPS

CLAIMS WORK PERFORMED ON (FIGURE 1) 2 a)

CLAIM LOCATION MAP (FIGURE 1a) 2 b)

LOCATION MAP (FIGURE 1b) 2 c)

KINOJEVIS GROUP - LEGEND - (FIGURE 2). 2 d)

IRIS GOLD PROPERTY MAP - FIGURE 3) 3 a)

GROUND VLF-EM SURVEY MAP NO. I/2000/vlf. IN BACK POCKET

GROUND MAGNETOMETER SURVEY MAP NO. I/2000/mag. IN BACK POCKET

SUMMARY

i)

This report is a geophysical survey as required by The Ministry of Northern Development and Mines for assessment work purposes, following the recommendation set for in the Mining Act Regulations 1991.

The report includes an introduction to the property, general geology, field results and conclusions based on the field study.

Technical Data is provided on the Assessment Data form found at the back of this report.

Field Data is compiled on the accompanying plan maps found at the back of this report, Maps No. IR/2000/mag and IR/2000/vlf.

In 1999, Mr. Ben Berger from O.G.S. re-mapped and sampled the Iris Property. In his findings, from the sampling, a percentage of the ground showed certain minerals that have never been looked for. (e.g. Platium and Poladium SP).

On June 5, 2000, Gwen Resources started to cut a new North/South grid over the entire Iris Property, including Iris-10 (unpatented mining claims).

GEOPHYSICAL SURVEY REPORT
ON
THE IRIS PROPERTY
MAGNETOMETER & ELECTROMAGNETIC SURVEYS
HARKER & ELLIOTT TOWNSHIPS
LARDER LAKE MINING DIVISION
DISTRICT OF COCHRANE, ONTARIO

INTRODUCTION

On June 5, 2000, a new North/South grid was started on the West Section of the Iris Property.

The baseline was turned off thirty five feet west of the #3 post and pin of patent claim 9739 along the south (East/West) township line of Harker Township and Elliott Township, and twenty feet south of the township line in Elliott Township.

The west baseline was cut and two men chained for a distance of 44 + 17 feet to the west North/South survey line of claim CLM399. All picket lines were turned off at 325° north off the baseline (53° East).

This section of the new grid encompasses the following leased CLM399 and L-738902 and L-667848 unpatented mining claims.

All grid control points were two man chained by Gwen Resources Ltd.

All linecutting, chaining was performed by M. Fecteau and crew.

The magnetometer survey and electromagnetic surveys were done by Miss Wendy K. Weller and Mrs. J. R. Hennessey.

All drafting was done by Mrs. J. R. Hennessey. Report writing and contouring was done by Miss Wendy K. Weller.

Ownership of the aforementioned leased and unpatented mining claims has been attested to by The Alberta Gold Exploration Corporation and Alexander H. Perron, and was not independently ascertained by the writer.

LOCATION AND ACCESS

The Iris Group is comprised of 16 patented claims, 2 leases and 12 unpatented mining claims, located in the South East corner of

Harker Township and the north/east corner of Elliott Township, Larder Lake Mining Division, Ontario. (Figure 1 - List of Claims).

The property is situated approximately 75 miles east of Timmins, Ontario, and approximately 25 miles north/northeast of Kirkland Lake, Ontario.

Access to the property is provided by Highway 672 that runs approximately 400 meters west of the West side of the Iris Property north/south survey line of CLM399. Throughout the property there are existing four wheeler trails to access the new grid. (See Figures 1a) and 1b).

REGIONAL GEOLOGY

The Iris Gold claim group is located in the Abitibi Greenstone Belt of the Canadian Shield. This belt is composed of a sequence of metavolcanic and metasedimentary Archean age rocks that cover an area stretching about 220 miles from Timmins, Ontario, on the west to Val D'Or, Quebec, on the east.

The claims are situated within a sequence of iron rich and magnesium rich tholeiitic basalt flows known as the Kinojevis group (Figure 2). Stratigraphically, this group is about 30,000 feet thick and it occupies the core of a large east plunging synclinorium.

The Iris claim group is underlain by a sequence of tholeiitic basalt flows belonging to the Kinojevis Group. This group is composed of a sequence of iron rich and magnesium rich tholeiitic basalt flows forming a stratigraphic package about 30,000 feet thick. These rocks are overlain by younger, Blake River group calc-alkalic volcanics. Both have been folded into a large, east plunging synclinorium, the northern and southern limbs of which, have been cut by the major Porcupine Destor and Kirkland Lake-Larder Lake fault zones respectively. The Iris Property is situated about 5 miles south of the Destor Porcupine Fault zone near the Kinojevis-Blake River group contact.

PROPERTY HISTORY

The Iris property comprises 31 patented and/or unpatented mineral claims, (Figure 2) in Harker and Elliott Townships, Ontario, all registered in the name of John E. Perron, a principal of the The Alberta Gold Exploration Corporation.

PREVIOUS WORK

The Harker-Holloway area was the centre of mining activity during the 1920's when Harker Gold Mines Ltd. carried out a program

FIGURE 1

HARKER & ELLIOTT TOWNSHIPS

CLAIMS WORK PERFORMED ON

CLM399 (10)

L-667848

L-738902

12 CLAIMS

LOCATION MAP

FIGURE 1b)

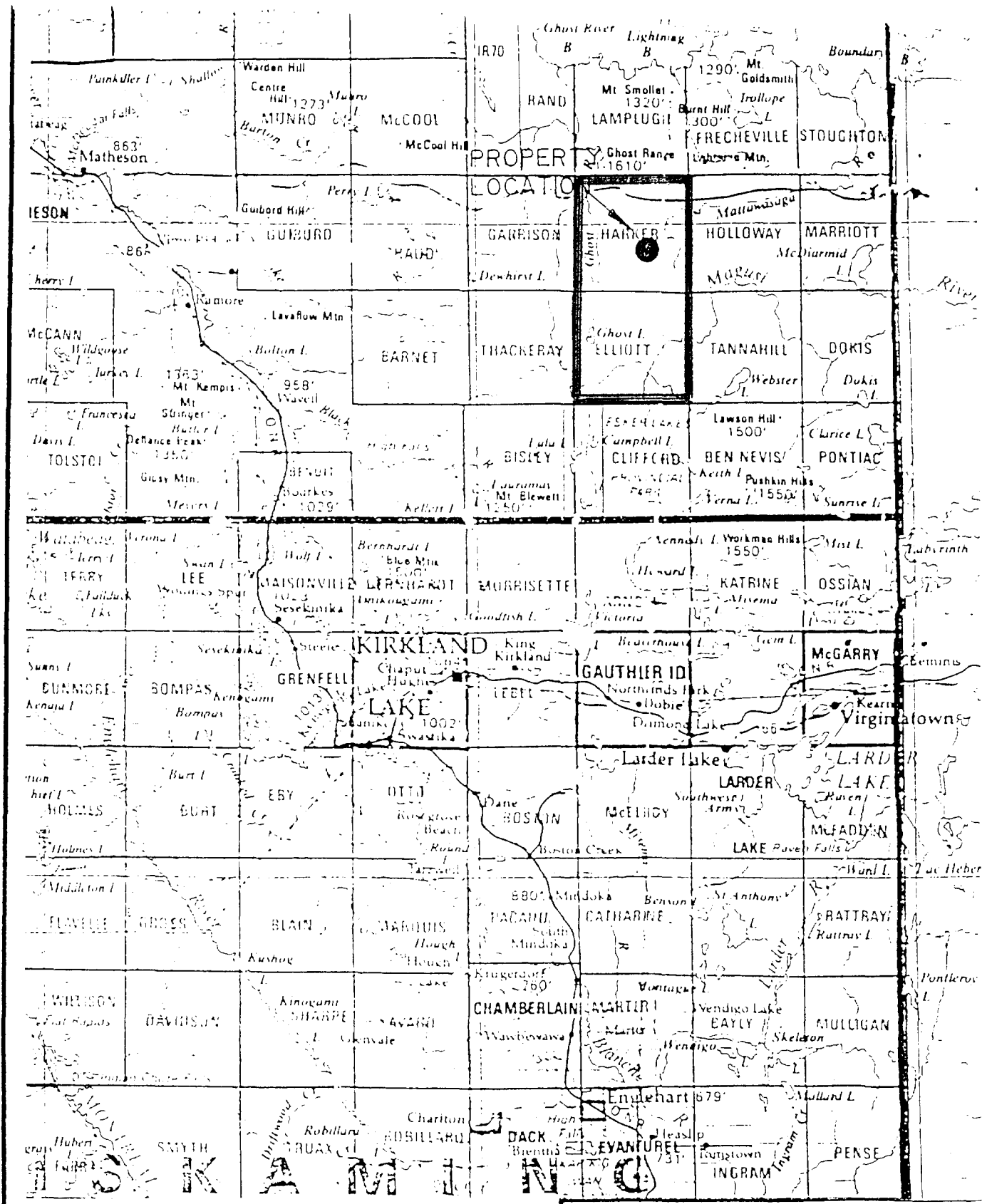

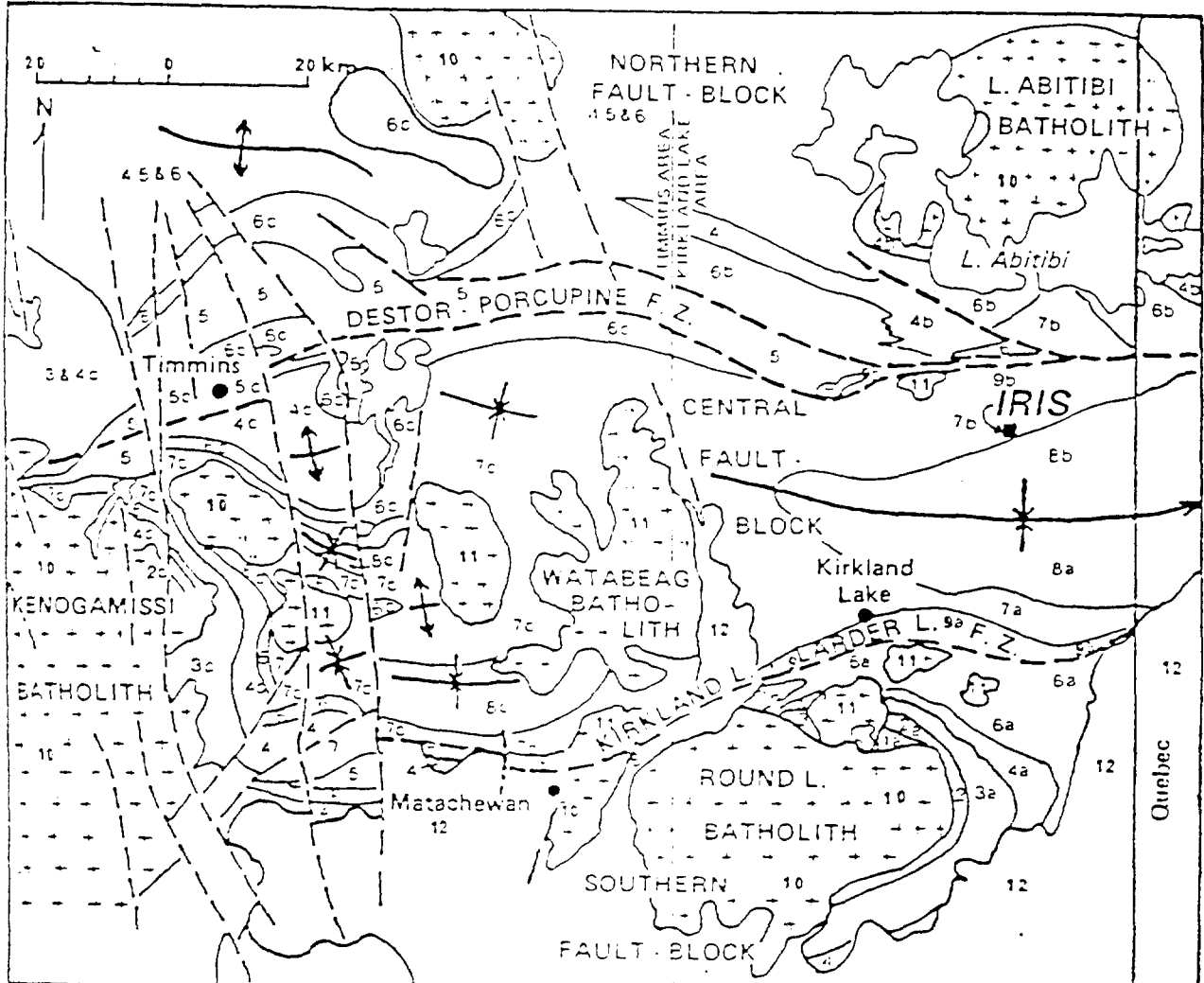

LEGEND

- | | | | |
|---|--|-------------------|---|
| Proterozoic | | 7 | 7a, 7b, Kinojevis Group, 7c Kinojevis Group, (Middle Fm., Tisdale Group) |
| Keeweenawan diabase (not shown) | | 6 | 6a Larder Lake Group, 6b Stoughton-Rouembour Group, 6c Lower Fm., Tisdale Group |
| 12 Cobalt Group | | 5 | 5c Porcupine Group |
| Archean | | Lower Supergroups | |
| Matachewan diabase (not shown) | | 4 | 4a Skead Group, 4b Hunter Mine Group, 4c Upper Fm., Deloro Group |
| Granitic rocks | | 3 | 3a Catherine Group, 3c Middle Fm., Deloro Group |
| 11 Granodiorite, monzonite, quartz monzonite, syenite | | 2 | 2a Wabewawa Group, 2c Lower Fm., Deloro Group |
| 10 Massive to enebic quartz diorite, tonalite, trondhjemite | | 1 | 1a facies tufts **** |
| Upper Supergroup | | | |
| 9 9a* Timiskaming Group, 9b** Destor - Porcupine Complex | | | |
| 8 8a, 8b, Blake River Group, 8c*** Blake River (Upper Fm., Tisdale Group) | | | |

AFTER JENSEN AND LANGFORD (1985)

FIGURE 2

of extensive underground development on their Golden Harker property, situated immediately to the north of the Iris claim group. The Golden Harker Mine was closed in 1929.

In 1947, R. Storen examined the Iris property and reported the occurrence of gold mineralization in three separate localities, associated with «rhyolite» interflow horizons (Figure 3).

Vein 1 was exposed in two pits 900 feet apart and it consisted of sheared basalt/rhyolite mineralized with quartz-pyrite-chalcopyrite and galena. The vein was 1.9 feet wide and returned values of 0.29 ozs. per ton AU over 1.7 feet and 0.08 ozs. per ton AU over 1.9 feet.

Vein 2 is similar to vein 1 and returned values of 0.03 and 0.04 ozs. per ton AU over 8 inches and 7.5 inches respectively.

Vein 3 is located about 2,000 feet west of Vein 1 on the same «rhyolite» interflow horizon. It was exposed in two pits and it consisted of a N 70° E near vertical quartz vein containing pyrite, chalcopyrite, galena and visible gold. Assay samples taken from the east and west pits returned values of 0.11 ozs. per ton AU over 14 inches and 0.06 per ton AU over 8 inches respectively.

Storen (1947) also reported the occurrence of a wide zone of quartz mineralization in rhyolite on claim L-545251. The quartz contained disseminated pyrite with minor amounts of chalcopyrite and galena. A chip sample from this locality returned a value of 0.01 per ton AU over 5 feet.

In 1985 American Barrick Resources Ltd. announced the discovery of the Holt-McDermott deposit containing reserves of 2.8 million tons averaging 0.197 ozs. per ton AU. This announcement coupled with encouraging news from companies exploring other properties in the area helped intensify exploration efforts in the whole region. Recently, Canamax Resources Ltd. completed an underground exploration and development program on their East Zone property with a view to achieving production during 1988. Lenora Explorations Ltd., one of the Kasner Group of companies is in the midst of a substantial underground exploration program on their Gold Harker property which adjoins the Iris claim group immediately to the north. They have increased the reserves on the property and discovered new mineralized zones which are undergoing intensive evaluation.

During the period 1982 to 1987 detailed ground geophysical, geological and geochemical work plus airborne electromagnetic and magnetic surveys were completed on the Iris claim group. A number of geophysical and geochemical anomalies were defined by this work. In late 1986 and early 1987, a 5,924 foot drill program was carried out on the property by Perrex Resources Ltd. The drilling was focussed on geological targets and succeeded in defining areas of wide spread, low grade, gold mineralization within a syenite plug and narrow zones of higher grade mineralization within shear/breccia zones in basalts.

INSTRUMENTATION

Magnetometer Survey:

This system uses a backward motion of spinning protons of a hydrogen atom within fluid of hydrogen and carbon. These spinning magnetic protons are caused to have two opposite poles by applying a magnetic field using a current within a coil of wire. This frequency of precision is proportional to the earth's total magnetic field.

This instrument is read directly in gammas which is the absolute value of the earth's total field for that station.

The diurnal variation was monitored by closing each loop at any secondary check station, at a grid line, baseline intersection. Diurnal corrections were applied by linear distribution of any observed variation over the time between base stations.

Electromagnetic Survey:

The VLF-EM method uses as a source, several of the main submarine communications transmitters in the 15 to 25 kHz band found throughout the world.

The submarine communication radio waves travel in a single mode parallel to the surfaces of the earth along the earth-air interface.

VLF instruments are capable of picking up any structures that change the direction of the waves by measuring the tilt angle being zero on flat ground, but when a conductor is present, the tilt angle will acquire a finite value. The direction of tilt indicates the direction of the conductor.

Calculations of such parameters as depth, depth extent, dip and width of the conductors is very minimal.

The VLF easily illustrates the location of the upper limit of dipping structures which can be seen or plotted as VLF profiles as areas of greatest change in tilt angle per unit of distance.

The instrument used for this survey was a Geonics EM-16 Unit. The sensitivity of this unit is 1% for the inphase and 1% for the quadrature. The operating frequency for the EM-16 from 15-25 kHz and the station is made by plug-in units.

Further information on the VLF and the magnetometer can be found in the back of this report on the Technical Data and Assessment forms.

PRESENTATION AND DISCUSSION OF RESULTS

i) Magnetometer Survey 2000:

The field data is presented on Map No. IR/2000/mag at

a scale of 1" = 200' found at the back of this report.

The magnetic data is illustrated as isomagnetic contours, contour intervals 100 gammas, on a Map of corrected magnetic values at each station.

The magnetic relief ranges from 57,003 gammas to 59,525 gammas (difference of 2522 gammas). The magnetic trend is in a east to northeast direction.

Over three quarters of the new grid is covered by large low magnetic bands crossing the property. The two large high magnetic bands crossing the property at N70-80°/75°-85°S are part of the Kinojevis sequence, that forms the main structure. (These structures are found north and south of the baseline and in the southwest corner of the property).

In the south-east section of the new grid (P-1200W to P-200W) an interruption in the large low magnetic band occurs by a large high magnetic structure. It has been noted by previous work across the property that there has been a number of north to northwesterly trending faults some of which indicate offsets while others don't.

ii) Electromagnetic Survey:

The field data is presented on Map I/2000/vlf at a scale of 1 inch = Two hundred feet found at the back of this report.

In this 1st Phas of the Iris/2000/Project there are six distinctive anomalies found.

- C1 - Crosses PL12+00W 9+60N to PL20+00W 13+20N.
This contact is found in a wet pine bog. The magnetic survey shows the contact crossing the magnetic low band at 76° northeast. The quadrature is positive.
- C2 - Crosses PL24+00W 1410N to PL32+00W 1400N.
This contact is found in a very wet alder, pine bog. The contact crosses the large magnetic low band at a 55° northeast. The quadrature is positive.
- C3 - Crosses PL32+00W 7+60N to PL34+00W 10+70N.
This contact is found in a flat to a small north rise in thick alder and pine bog. This contact crosses the south edge of a small magnetic high anomalie and crosses a magnetic low band at 90° east. The quadrature is positive.
- C4 - Crosses PL18+00W 14+70S to PL32+00W 15+80S.
The south-west corner of the contact starts in a thick, wet alder seamp and goes northeast (50°) crossing the south edge of a large egg shaped outcrop at PL1800W 14+70S. This VLF contact is found along and crosses the known Interbedded sediments (rhyolite) horizons. (See Figure 3).

- C5 - Crosses PL200W 7+90N to PL8+00W 11+20N.
This contact is found along and crossing previous trenching.
(Interbedded sediments). The quadrature is positive.
- C6 - Crosses PL2+00W 21+45S to PL10+00W 21+60S.
The area is flat, wet pine, alder bog. The contact is in the
same direction as the magnetic trend @ 57° north east.

At the present time the VLF-EM Survey is being run through the
Fraser Filter Computer Program to help eliminate background
noise.

OBSERVATIONS AND RECOMMENDATIONS

The Iris Gold Group and the Iris 10 Group of Alberta Gold Exploration Corporation and Mr. Alexander H. Perron is located in the Archean Abitibi Greenstone Belt south of the Porcupine Destor Fault Zone in east north-east trending Kinojevis Group rocks.

The claim groups cover various flow and fragmental units of mafic volcanic nature with two rhyolite interflow horizons that cross the group for a length of about 3.22 kilometers. It was recommended by Mr. A. D. Drummond, Ph.D., P. Eng., Geological Engineer, «in order to test the two distinct targets of this property, that the old pre-existing grid be re-established for survey control. That the rhyolite horizons and the syenite stock be defined magnetically and an electromagnetic survey be run to help define the foot and hanging walls of both rhyolite horizons and to check the brecciated aureole and the syenite stock». The original grid was cut in 1985, due to timbering in the west end of the grid (CLM399) and the length of time the grid had not been worked on only the original baseline was discernible. The new grid was tied into the survey posts and pins of CLM399 and old existing roads.

Phase II (central section) of the grid is presently being cut. In the near future a gradiometer survey and Induced Polarization Survey will be run as well as down the hole I.P. in old diamond drill holes.

Respectfully submitted,



July 24, 2000

Miss Wendy K. Weller
Geotech

Assessment Data Form

Type of Work:

Prospecting: _____ Geological: _____

Physical: LINE CUTTING AND CHAINING

Geophysical: ELECTROMAGNETIC (1 STATION) AND MAGNETOMETER SURVEY

Geochemical: _____ Drilling: _____

Assays/Analyses: _____ Other work: _____

Cost of Work: \$14,509.00

Dollars Applied: \$14,400.00

Recorded Holder:

ALEX PERRON/
Name: THE ALBERTA GOLD EXPLORATION CORP.

Address: 103 GOVERNMENT ROAD EAST,
KIRKLAND LAKE, ONTARIO P2N 1A9

Survey Company:

Name: GWEN RESOURCES LTD.

Address: 103 GOVERNMENT ROAD EAST,
KIRKLAND LAKE, ONTARIO P2N 1A9

Survey/Report Information:

Start of work: JUNE 5, 2000 End of work: JULY 23, 2000

Draughting time: JUNE 14, JULY 22, 23, 2000 Report time: JULY 23, 24, 2000

Completion of report: JULY 24, 2000 Author: MISS WENDY K. WELLER

Work performed on claim(s) CLM-399, L-667848, L-738902

Work applied to claim(s) L-1046998, L-1046999, L-1047000, L-1047001, L-1047002,
L-1047003, L-1047004, L-1047005, L-1047006, L-1047507, L-1047508, L-1047509,
L-1047510, L-1047749, L-1047750, L-1047751, L-1047752, L-1047753, L-1047754,
L-1047755, L-1047756, L-1047757, L-1047758, L-1047759, L-1047760, L-1047761,
L-1047762, L-1047763, L-1047764, L-1047765, L-1047766, L-1047767, L-1047768,
L-1047930, L-1047931, L-1047932.

Persons who performed work (supervisor first):

GWEN RESOURCES LTD.

WENDY K. WELLER

J. HENNESSEY

PAUL SIFORD AND CREW

MICHEL FECTEAU

Technical Data:

Line (mi/km): 28.61 KM
 No. of samples/stations: 939
ELECTROMAGNETIC SURVEY:
 Instrument: GEONICS EM-16
 Coil configuration: VERTICAL AND HORIZONTAL
 Method: FIXED TRANSMITTER
 Vertical scale: 1 INCH = \pm 40%
 Frequency: 24.8 kHz
 Operational technique:

Line traversed:
 Line/picket spacing: 200 FT./100 FT.
 Operator: MRS. JAN HENNESSEY
 Accuracy: \pm 1%
 Coil separation: INFINITY
 Parameters: INPHASE & QUADRATURE
 Horizontal scale: 1:50000
 Station: CUTLER, MAINE

MAGNETIC SURVEY:

Instrument: MCPHAR GP-8 PROTON
 Base station: BLO+00
 Base station time: 30 MINUTES
 Contour interval: 100 GAMMAS
 Contoured by: MISS WENDY K. WELLER
 Operational technique: SPENCER POLE MOUNT

Operator: MISS WENDY K. WELLER
 Accuracy: \pm GAMMA
 Diurnal method:
 Location/value: BLO+00
 Datum subtracted: 57,000 GAMMAS
 Horizontal scale: 1:50000

INDUCED POLARIZATION SURVEY

Transmitter used:
 Method:
 On time:
 Off time:
 Power source:
 Electrode array:
 Readings taken:
 Operational technique:

Receiver used:
 Frequency:
 Range:
 Delay time:
 Output:
 Electrode spacing:
 Other data:

BIBLIOGRAPHY

- Storen, R. 1947 - Preliminary Report of Iris Gold Mines Ltd., Harker Township, Larder Lake Mining Division, Province of Ontario, private engineers report.
- Satterly, J. 1952 - Geology of Harker Township; 60th Annual Report of the Ontario Department of Mines, Vol. LX, Part VIII, 1951.
- Drummond, A.D. 1987 - Report on The Winter 1986-1987 Drill Program, 31 Claim Iris Gold Group: a private report for The Alberta Gold Exploration Corporation.
- Jensen, L.S. 1986 - Mineralization and Volcanic Stratigraphy in The Western Part of the Abitibi Subprovince: Ontario Geological Survey, Misc. Paper 129.
- D. R. Hawke, 1988 - Report on the 1988 Exploration Program Iris Joint Venture Project NTS 32D/5.
- Workman, Al. 1988 - Evaluation Report.

C E R T I F I C A T E

I, Wendy K. Weller, of Kirkland Lake, Ontario, do hereby certify:

- 1) That I am a Geotech in Training and reside at:
71 Second Street, Apartment #2, Kirkland Lake, Ontario P2N IR6.
- 2) That I graduated from the Haileybury School of Mines as a certified Diamond Driller in 1982. I have had a staking licence for the past (10) ten years.
- 3) That I was employed as a Diamond Driller for Heath & Sherwood for 1 year.
- 4) That I have been practising as a Geotech Trainee for a period of (10) ten years and I am qualified to write this report.
- 5) That I supervised and participated in this survey.

July 24/2000
Date

Wendy K. Weller
Geotech



32D05NW2074 2.20459 HARKER 900

Ity of subsections 65(2) and 66(3) of the Mining Act. Under section 8 of the 1 to review the assessment work and correspond with the mining land holder. Ing Recorder, Ministry of Northern Development and Mines, 6th Floor.

Instructions: - For work performed on Crown Lands before recording a claim, use form 0240.
 - Please type or print in ink.

2. 20459
1. Recorded holder(s) (Attach a list if necessary)

| | |
|--|--|
| Name THE ALBERTA GOLD EXPLORATION CORP/ALEX PERRON | Client Number #200833 - #181257 |
| Address 103 GOVERNMENT ROAD EAST, KIRKLAND LAKE, ONTARIO P2N 1A9 | Telephone Number (705) 567-3001 Fax Number (705) 567-2158 |
| Name ALEX H. PERRON | Client Number #181257 |
| Address 103 GOVERNMENT ROAD EAST, KIRKLAND LAKE, ONTARIO P2N 1A9 | Telephone Number (705) 567-3001 Fax Number (705) 567-2158 |

2. Type of work performed: Check (✓) and report on only ONE of the following groups for this declaration.

 Geotechnical: prospecting, surveys, assays and work under section 18 (regs)
 Physical: drilling, stripping, trenching and associated assays
 Rehabilitation

| | |
|--|--|
| Work Type LINE CUTTING AND CHAINING MAGNETOMETER AND ELECTROMAGNETIC SURVEYS | Office Use Commodity Total \$ Value of Work Claimed 14,509 NTS Reference Mining Division Larder Lake Resident Geologist District Kirkland Lake |
| Dates Work Performed From 05 06 00 To 23 07 00 Day Month Year Day Month Year | |
| Global Positioning System Data (if available) Township/Area THACKERAY/HARKER/ELLIOTT M or G-Plan Number | |

 Please remember to:

- obtain a work permit from the Ministry of Natural Resources as required;
- provide proper notice to surface rights holders before starting work;
- complete and attach a Statement of Costs, form 0212;
- provide a map showing contiguous mining lands that are linked for assigning work;
- include two copies of your technical report.

3. Person or companies who prepared the technical report (Attach a list if necessary)

| | |
|---|------------------------------------|
| Name MISS WENDY K. WELLER | Telephone Number (705) 567-3001 |
| Address 103 GOVERNMENT RD.E., KIRKLAND LAKE, ONTARIO P2N 1A9 | Fax Number (705) 567-2158 |
| Name RECEIVED LARDER LAKE MINING DIVISION | Telephone Number |
| Address | Fax Number |
| Name JUL 24 2000 | Telephone Number |
| Address 2. 554 | Fax Number |

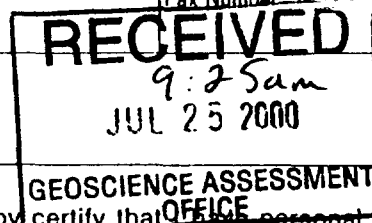
4. Certification by Recorded Holder or Agent

 I, WENDY K. WELLER (Print Name), do hereby certify that ~~it is~~ personal knowledge of the facts set forth in this Declaration of Assessment Work having caused the work to be performed or witnessed the same during or after its completion and, to the best of my knowledge, the annexed report is true.

| | |
|---|--|
| Signature of Recorded Holder or Agent | Date JULY 24, 2000 |
| Agent's Address 103 GOVERNMENT RD.E., KIRKLAND LAKE, ONT.P2N 1A9 | Telephone Number (705) 567-3001 Fax Number (705) 567-2158 |

5. Work to be recorded and distributed. Work can only be assigned to claims that are contiguous (adjoining) to the mining land where work was performed, at the time work was performed. A map showing the contiguous link must accompany this form.

W0080.00297

| Mining Claim Number. Or if work was done on other eligible mining land, show in this column the location number indicated on the claim map. | Number of Claim Units. For other mining land, list hectares. | Value of work performed on this claim or other mining land. | Value of work applied to this claim. | Value of work assigned to other mining claims. | Bank. Value of work to be distributed at a future date. |
|---|--|---|--------------------------------------|--|---|
| eg TB 7827 | 16 ha | \$26,825 | N/A | \$24,000 | \$2,825 |
| eg 1234567 | 12 | 0 | \$24,000 | 0 | 0 |
| eg 1234568 | 2 | \$ 8,892 | \$ 4,000 | 0 | \$4,892 |
| G.8000437 CLM-399 | 10 | \$ 13,238.00 | | \$ 13,238.00 | |
| 2 L-667848 | 1 | \$ 27.00 | | \$ 27.00 | |
| 3 L-738902 | 1 | \$ 1,244.00 | | \$ 1,135.00 | \$ 109.00 |
| 4 L-1046998 | 1 | | \$ 400.00 | | |
| 5 L-1046999 | 1 | | \$ 400.00 | | |
| 6 L-1047000 | 1 | | \$ 400.00 | | |
| 7 L-1047001 | 1 | | \$ 400.00 | | |
| 8 L-1047002 | 1 | | \$ 400.00 | | |
| 9 L-1047003 | 1 | | \$ 400.00 | | |
| 10 L-1047004 | 1 | | \$ 400.00 | | |
| 11 L-1047005 | 1 | | \$ 400.00 | | |
| 12 L-1047006 | 1 | | \$ 400.00 | | |
| 13 L-1047507 | 1 | | \$ 400.00 | | |
| 14 L-1047508 | 1 | | \$ 400.00 | | |
| 15 L-1047509 | 1 | | \$ 400.00 | | |
| Column Totals | | \$ 14,509.00 | \$4,800.00 | \$ 14,400.00 | \$ 109.00 |

I, WENDY K. WELLER, do hereby certify that the above work credits are eligible under subsection 7 (1) of the Assessment Work Regulation 6/96 for assignment to contiguous claims or for application to the claim where the work was done.

Signature of Recorded Holder or Agent Authorized in Writing

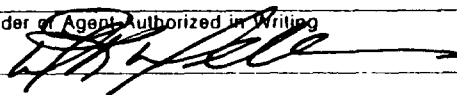

Date

JULY 24, 2000

6. Instructions for cutting back credits that are not approved.

Some of the credits claimed in this declaration may be cut back. Please check (✓) in the boxes below to show how you wish to prioritize the deletion of credits:

- 1. Credits are to be cut back from the Bank first, followed by option 2 or 3 or 4 as indicated.
- 2. Credits are to be cut back starting with the claims listed last, working backwards; or
- 3. Credits are to be cut back equally over all claims listed in this declaration; or
- 4. Credits are to be cut back as prioritized on the attached appendix or as follows (describe):

2

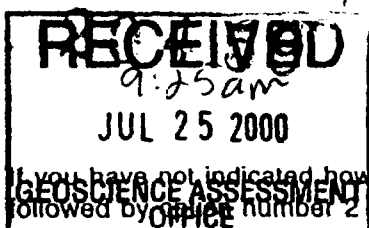

Note: If you have not indicated how your credits are to be deleted, credits will be cut back from the Bank first, followed by office number 2 if necessary.

For Office Use Only

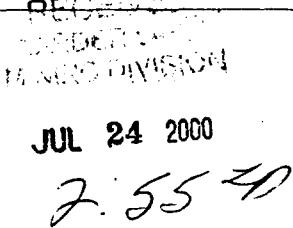
| | | |
|---|----------------------|--------------------------------|
| Received Stamp  | Deemed Approved Date | Date Notification Sent |
| | Date Approved | Total Value of Credit Approved |
| Approved for Recording by Mining Recorder (Signature) | | |



THE ALBERTA GOLD EXPLORATION CORP. CLIENT NO. 200833
ALEXANDER H. PERRON CLIENT NO. 181257

WAP

| Mining Claim Number. Or if work was done on other eligible mining land, show in this column the location number indicated on the claim map. | | Number of Claim Units. For other mining land, list hectares. | Value of work performed on this claim or other mining land | Value of work applied to this claim | Value of work assigned to other mining claims | Bank. Value of work to be distributed at a future date |
|---|-----------|--|--|-------------------------------------|---|--|
| 16 | L-1047510 | 1 | | \$ 400.00 | | |
| 17 | L-1047749 | 1 | | \$ 400.00 | | |
| 18 | L-1047750 | 1 | | \$ 400.00 | | |
| 19 | L-1047751 | 1 | | \$ 400.00 | | |
| 20 | L-1047752 | 1 | | \$ 400.00 | | |
| 21 | L-1047753 | 1 | | \$ 400.00 | | |
| 22 | L-1047754 | 1 | | \$ 400.00 | | |
| 23 | L-1047755 | 1 | | \$ 400.00 | | |
| 24 | L-1047756 | 1 | | \$ 400.00 | | |
| 25 | L-1047757 | 1 | | \$ 400.00 | | |
| 26 | L-1047758 | 1 | | \$ 400.00 | | |
| 27 | L-1047759 | 1 | | \$ 400.00 | | |
| 28 | L-1047760 | 1 | | \$ 400.00 | | |
| 29 | L-1047761 | 1 | | \$ 400.00 | | |
| 30 | L-1047762 | 1 | | \$ 400.00 | | |
| 31 | L-1047763 | 1 | | \$ 400.00 | | |
| 32 | L-1047764 | 1 | | \$ 400.00 | | |
| 33 | L-1047765 | 1 | | \$ 400.00 | | |
| 34 | L-1047766 | 1 | | \$ 400.00 | | |
| 35 | L-1047767 | 1 | | \$ 400.00 | | |
| 36 | L-1047768 | 1 | | \$ 400.00 | | |
| 37 | L-1047930 | 1 | | \$ 400.00 | | |
| 38 | L-1047931 | 1 | | \$ 400.00 | | |
| 39 | L-1047932 | 1 | | \$ 400.00 | | |
| 40 | | | | | | |
| 41 | | | | | | |
| 42 | | | | | | |
| 43 | | | | | | |
| 44 | | | | | | |
| 45 | | | | | | |
| 46 | | | | | | |
| 47 | | | | | | |
| 48 | | | | | | |
| 49 | | | | | | |
| 50 | | | | | | |
| Column Totals | | | \$ 14,509.00 | \$14,400.00 | \$14,400.00 | \$ 109.00 |

RECEIVED
LARDER LAKE
MINING DIVISION

JUL 24 2000

2 55 40

RECEIVED
9:25 am
JUL 25 2000
GEOSCIENCE ASSESSMENT
OFFICE



Personal information collected on this form is obtained under the authority of subsection 6(1) of the Assessment Work Regulation 6/96. Under section 8 of the Mining Act, the information is a public record. This information will be used to review the assessment work and correspond with the mining land holder. Questions about this collection should be directed to the Chief Mining Recorder, Ministry of Northern Development and Mines, 6th Floor, 933 Ramsey Lake Road, Sudbury, Ontario, P3E 6B5.

| Work Type | Units of Work <small>Depending on the type of work, list the number of hours/days worked, metres of drilling, kilometres of grid line, number of samples, etc.</small> | Cost Per Unit of work | Total Cost |
|--|---|-----------------------|--------------------------------|
| LINE CUTTING & CHAINING | 28.61 KM X \$275.00 KM | | \$ 7,868.00 |
| MAGNETOMETER SURVEY | 28.61 KM X \$105.00 KM | | \$ 3,004.00 |
| ELECTROMAGNETIC SURVEY | 28.61 KM X \$110.00 KM | | \$ 3,147.00 |
| Associated Costs (e.g. supplies, mobilization and demobilization). | | | |
| Transportation Costs | | | |
| 1 TRUCK | 8 DAYS X 41 KM X .30¢/KM | | \$ 98.00 |
| 1 FOUR WHEELER | X 8 DAYS X \$35.00/DAY | | \$ 280.00 |
| Food and Lodging Costs | | | |
| 2 PEOPLE | X 8 DAYS X \$7.00/PERSON (LUNCH) | | \$ 112.00 |
| RECEIVED LAFDER LAKE MINING DIVISION | | | Total Value of Assessment Work |
| | | | \$14,509.00 |

JUL 24 2000

Calculations of Filing Discounts:

2.55 4

1. Work filed within two years of performance is claimed at 100% of the above Total Value of Assessment Work.
2. If work is filed after two years and up to five years after performance, it can only be claimed at 50% of the Total Value of Assessment Work. If this situation applies to your claims, use the calculation below:

TOTAL VALUE OF ASSESSMENT WORK \times 0.50 = Total \$ value of worked claimed

Note:

- Work older than 5 years is not eligible for credit.
- A recorded holder may be required to verify expenditures claimed in this statement of costs within 45 days of a request for verification and/or correction/clarification. If verification and/or correction/clarification is not made, the Minister may reject all or part of the assessment work submitted.

Certification verifying costs:

I, WENDY K. WELLER, do hereby certify, that the amounts shown are as accurate as may reasonably be determined and the costs were incurred while conducting assessment work on the lands indicated on

the accompanying Declaration of Work form as AGENT I am authorized to make this submission.

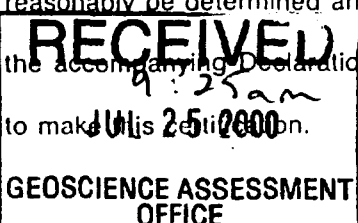

Signature Wendy K. Weller Date JULY 24, 2000

August 24, 2000

Wendy K. Weller
THE ALBERTA GOLD EXPLORATION CORPORATION
103 GOVERNMENT ROAD EAST
KIRKLAND LAKE, Ontario
P2N-1A9

Geoscience Assessment Office
933 Ramsey Lake Road
6th Floor
Sudbury, Ontario
P3E 6B5

Telephone: (888) 415-9845
Fax: (877) 670-1555

Dear Sir or Madam:

Submission Number: 2.20459

Status

Subject: Transaction Number(s): W0080.00297 Approval

We have reviewed your Assessment Work submission with the above noted Transaction Number(s). The attached summary page(s) indicate the results of the review. **WE RECOMMEND YOU READ THIS SUMMARY FOR THE DETAILS PERTAINING TO YOUR ASSESSMENT WORK.**

If the status for a transaction is a 45 Day Notice, the summary will outline the reasons for the notice, and any steps you can take to remedy deficiencies. The 90-day deemed approval provision, subsection 6(7) of the Assessment Work Regulation, will no longer be in effect for assessment work which has received a 45 Day Notice. Allowable changes to your credit distribution can be made by contacting the Geoscience Assessment Office within this 45 Day period, otherwise assessment credit will be cut back and distributed as outlined in Section #6 of the Declaration of Assessment work form.

Please note any revisions must be submitted in DUPLICATE to the Geoscience Assessment Office, by the response date on the summary.

If you have any questions regarding this correspondence, please contact BRUCE GATES by e-mail at bruce.gates@ndm.gov.on.ca or by telephone at (705) 670-5856.

Yours sincerely,



ORIGINAL SIGNED BY
Steve B. Beneteau
Acting Supervisor, Geoscience Assessment Office
Mining Lands Section

Work Report Assessment Results

Submission Number: 2.20459

Date Correspondence Sent: August 24, 2000

Assessor: BRUCE GATES

| Transaction Number | First Claim Number | Township(s) / Area(s) | Status | Approval Date |
|---------------------------|---------------------------|------------------------------|---------------|----------------------|
| W0080.00297 | 667848 | THACKERAY, HARKER, ELLIOTT | Approval | August 23, 2000 |

Section:

14 Geophysical MAG

14 Geophysical VLF

Correspondence to:

Resident Geologist
Kirkland Lake, ON

Assessment Files Library
Sudbury, ON

Recorded Holder(s) and/or Agent(s):

Wendy K. Weller
THE ALBERTA GOLD EXPLORATION CORPORATION
KIRKLAND LAKE, Ontario

ALEXANDER H. PERRON
KIRKLAND LAKE, Ontario

LAMPLUGH TWP M-358

NOTICE OF FORESTRY ACTIVITY
THIS TOWNSHIP AREA FALLS WITHIN THE
ARBITRAL MANAGEMENT UNIT
AND MAY BE SUBJECT TO FORESTRY OPERATIONS.
THE M.N.R. UNIT FORESTER FOR THIS AREA CAN BE
CONTACTED AT: P.O. BOX 129 SWASTIKA ONT. POK-10
705-642-3222

THE TOWNSHIP OF HARKER

DISTRICT OF
COCHRANE

LARDER LAKE
MINING DIVISION

SCALE: 1-INCH 40 CHAINS

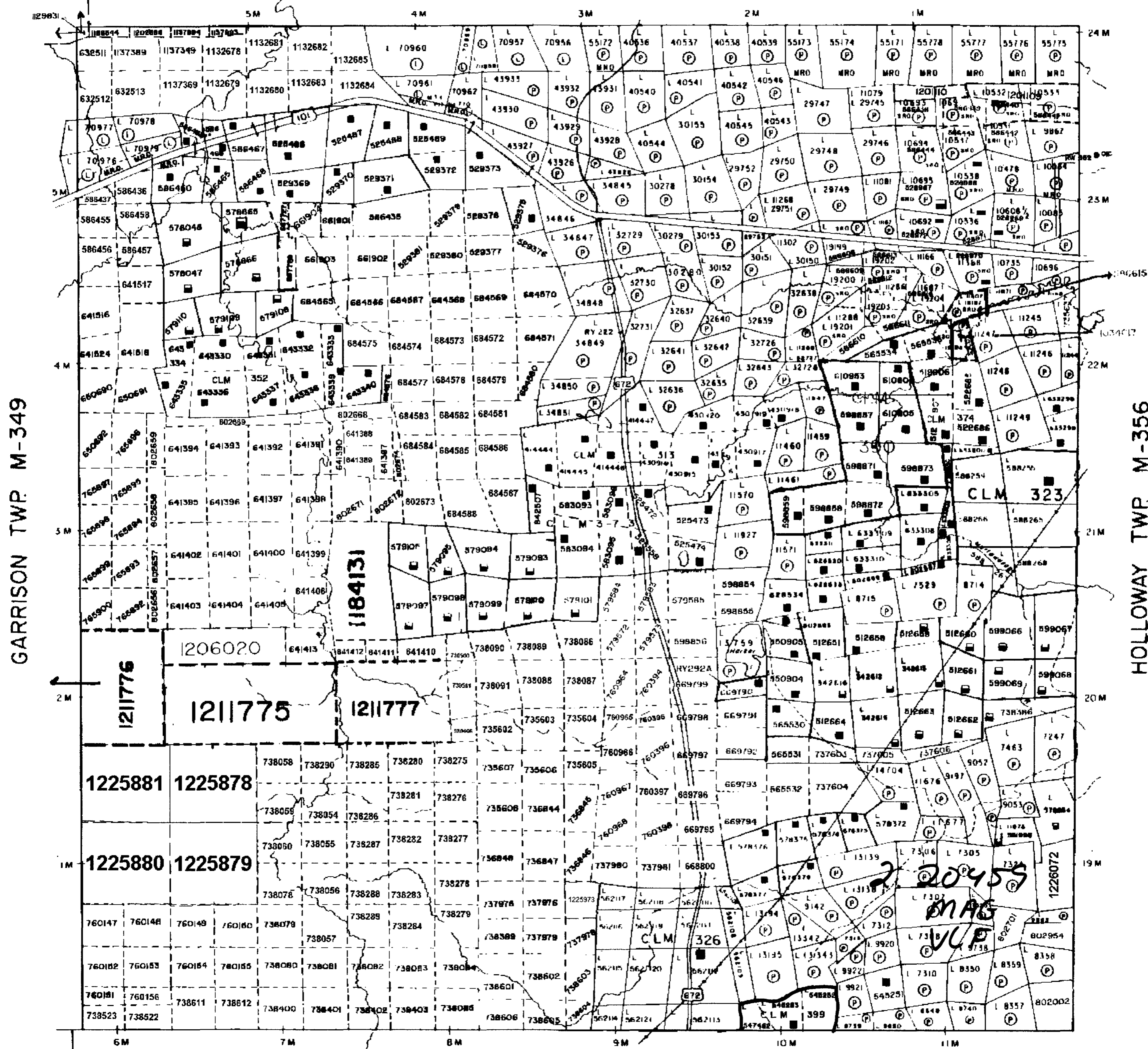

LEGEND

- PATENTED LAND
- CROWN LAND SALE
- LEASES
- LOCATED LAND
- LICENSE OF OCCUPATION
- MINING RIGHTS ONLY
- SURFACE RIGHTS ONLY
- ROADS
- IMPROVED ROADS
- KING'S HIGHWAYS
- RAILWAYS
- POWER LINES
- MARSH OR MUSKEG
- MINES
- CANCELLED
- PATENTED S.R.O.
- LEASE - MINING RIGHTS ONLY
- ORDER - IN - COUNCIL

NOTES

400' Surface Rights reservation along the shores of all lakes and rivers.

AREAS WITHDRAWN FROM DISPOSITION

- M.R.O. - MINING RIGHTS ONLY
- S.R.O. - SURFACE RIGHTS ONLY
- M. + S. MINING AND SURFACE RIGHTS

| Description | Order No. | Date | Disposition | File |
|-------------|-----------|------|---|------|
| L.U.P. | | | LAND USE PERMIT NO. 117130/PENDING APPLICATION UNDER PUBLIC LANDS ACT | |

THE INFORMATION THAT APPEARS ON THIS MAP HAS BEEN COMPILED FROM VARIOUS SOURCES, AND ACCURACY IS NOT GUARANTEED. THOSE WISHING TO START MINING CLAIMS SHOULD CONSULT WITH THE MINING RECORDER, MINISTRY OF NORTHERN DEVELOPMENT AND MINES, FOR ADDITIONAL INFORMATION ON THE STATUS OF THE LANDS SHOWN HEREON



ELLIOTT TWP M-347



Ministry of
Natural
Resources

Ministry of
Northern Development
and Mines

Date: _____
Name: **G-3643**

REFERENCES

AREAS WITHDRAWN FROM DISPOSITION

- M.R.O. - MINING RIGHTS ONLY
- S.R.O. - SURFACE RIGHTS ONLY
- M.F.S. - MINING AND SURFACE RIGHTS

Description Order No. Date Disposition File

(M) MNR GRAVEL PIT 36-34

THE INFORMATION THAT APPEARS ON THIS MAP HAS BEEN COMPILED FROM VARIOUS SOURCES AND ACCURACY IS NOT GUARANTEED. THOSE WISHING TO STAKE MINING CLAIMS SHOULD CONSULT WITH THE MINING RECORDER, MINISTRY OF NORTHERN DEVELOPMENT AND MINES, FOR ADDITIONAL INFORMATION ON THE STATUS OF THE LANDS SHOWN HEREON.

NOTICE FORESTRY ACTIVITY.
THIS TOWNSHIP FALLS WITHIN THE ARDUBI MANAGEMENT UNIT AND MAY BE SUBJECT FOR FORESTRY OPERATIONS. THE MNR FORESTER FOR THIS AREA CAN BE CONTACTED AT:
P.O. BOX 129
SWASTIKA, ONTARIO
POB 110
705-642-3222

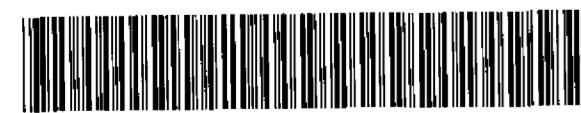

32055N2074 2.20459 HARKER 210

HARKER TOWNSHIP

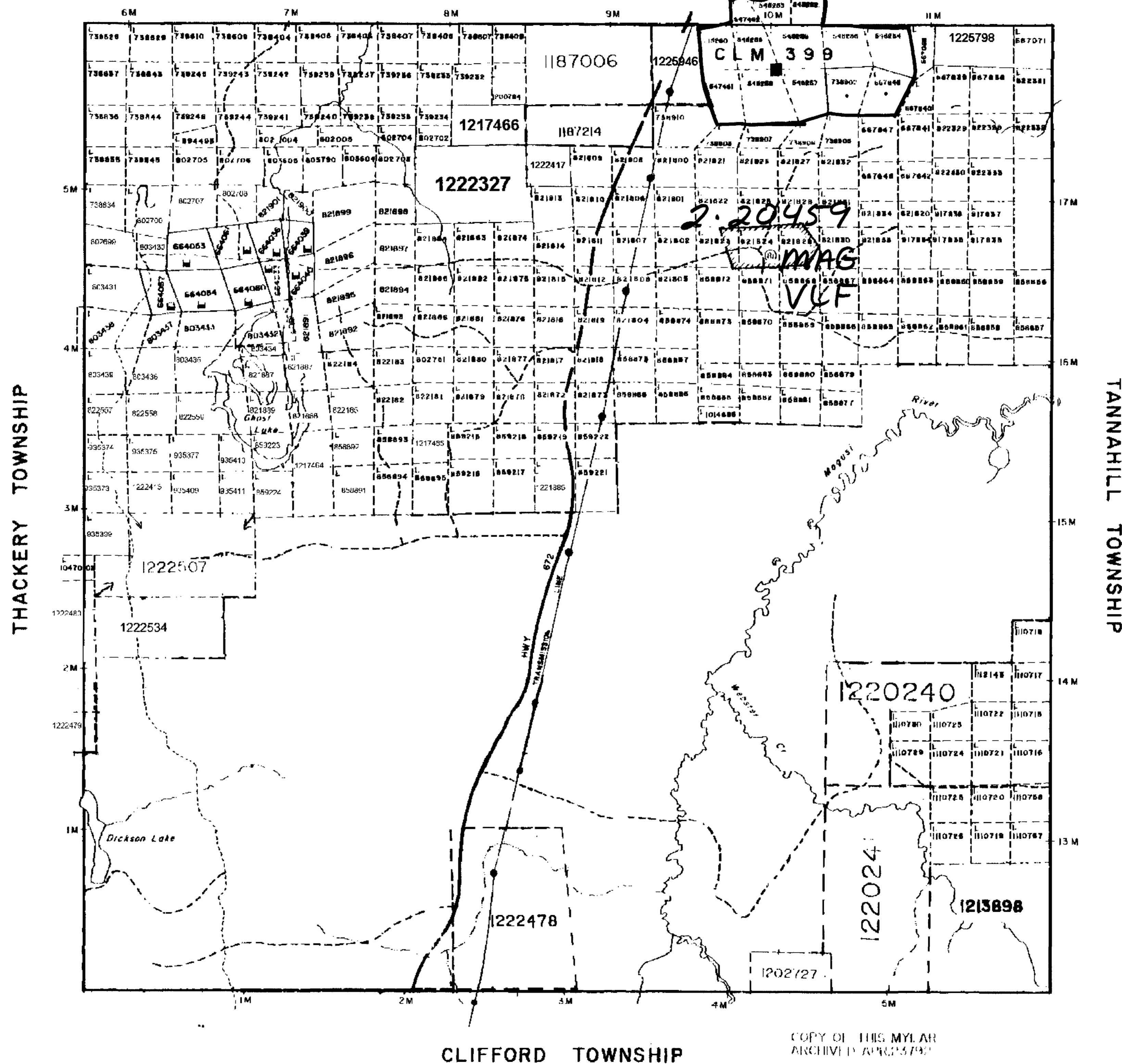

COPY OF THIS MYLAR
ARCHIVED 4/10/97
ARCHIVED MAY 02, 1984
ARCHIVED APRIL 05, 1997
FILED IN 10/97

LEGEND

- HIGHWAY AND ROUTE NO.
- OTHER ROADS
- RAILS
- SURVEYED LINES
- TOWNSHIP, BASE LINES, ETC.
- LOTS, MINING CLAIMS, PARCELS, ETC.
- UNSURVEYED LINES
- LOT LINES
- PARCEL BOUNDARY
- MINING CLAIMS ETC.
- RAILWAY AND RIGHT OF WAY
- UTILITY LINES
- NON PERENNIAL STREAM
- FLOODING OR FLOODING RIGHTS
- SUBDIVISION OR COMPOSITE PLAN
- RESERVATIONS
- ORIGINAL SHORELINE
- MARSH OR MUSKEG
- MINES
- TRAVERSE MONUMENT

DISPOSITION OF CROWN LANDS

| TYPE OF DOCUMENT | SYMBOL |
|---------------------------------|--------|
| PATENT, SURFACE & MINING RIGHTS | |
| " SURFACE RIGHTS ONLY | |
| " MINING RIGHTS ONLY | |
| LEASE, SURFACE & MINING RIGHTS | |
| " SURFACE RIGHTS ONLY | |
| " MINING RIGHTS ONLY | |
| LICENCE OF OCCUPATION | |
| ORDER IN COUNCIL | |
| RESERVATION | |
| CANCELLED | |
| SAND & GRAVEL | |

SCALE: 1 INCH = 40 CHAINS

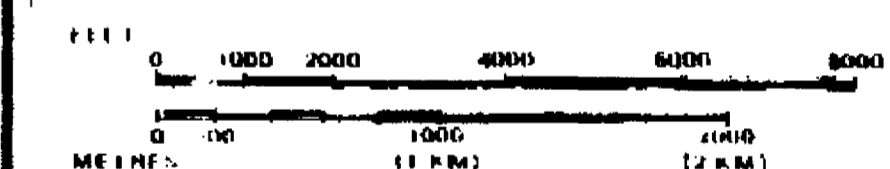

TOWNSHIP
ELLIOTT
M.N.R. ADMINISTRATIVE DISTRICT
KIRKLAND LAKE
MINING DIVISION
LARDER LAKE
LAND TITLES / REGISTRY DIVISION
COCHRANE



Ministry of Natural Resources
Ministry of Northern Development and Mines

Date: MAY 1997

Number:

G-3633

PREPARED BY: MNR 20/1997

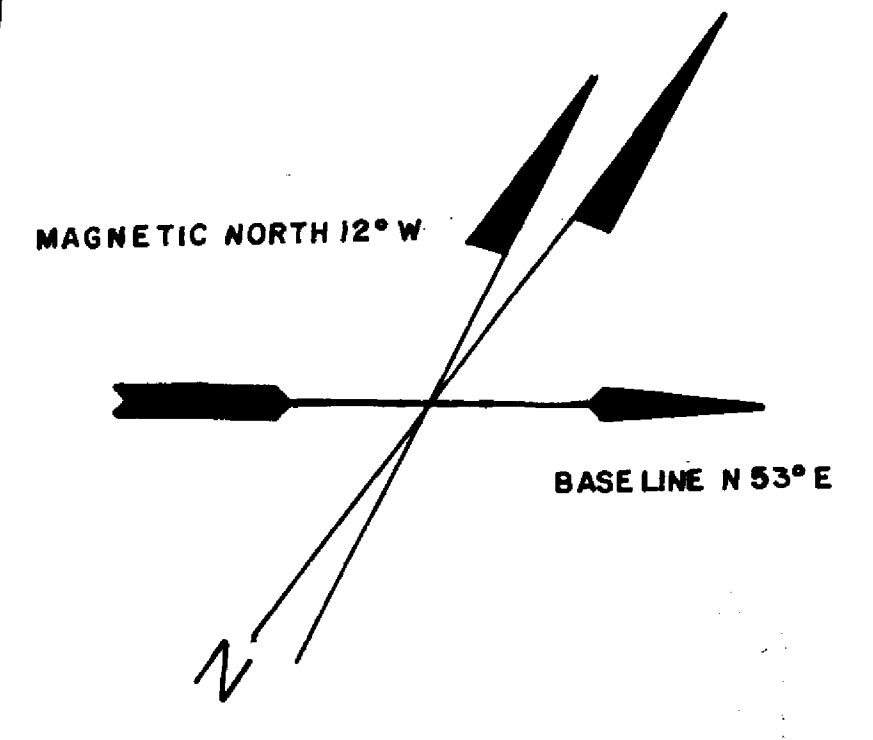
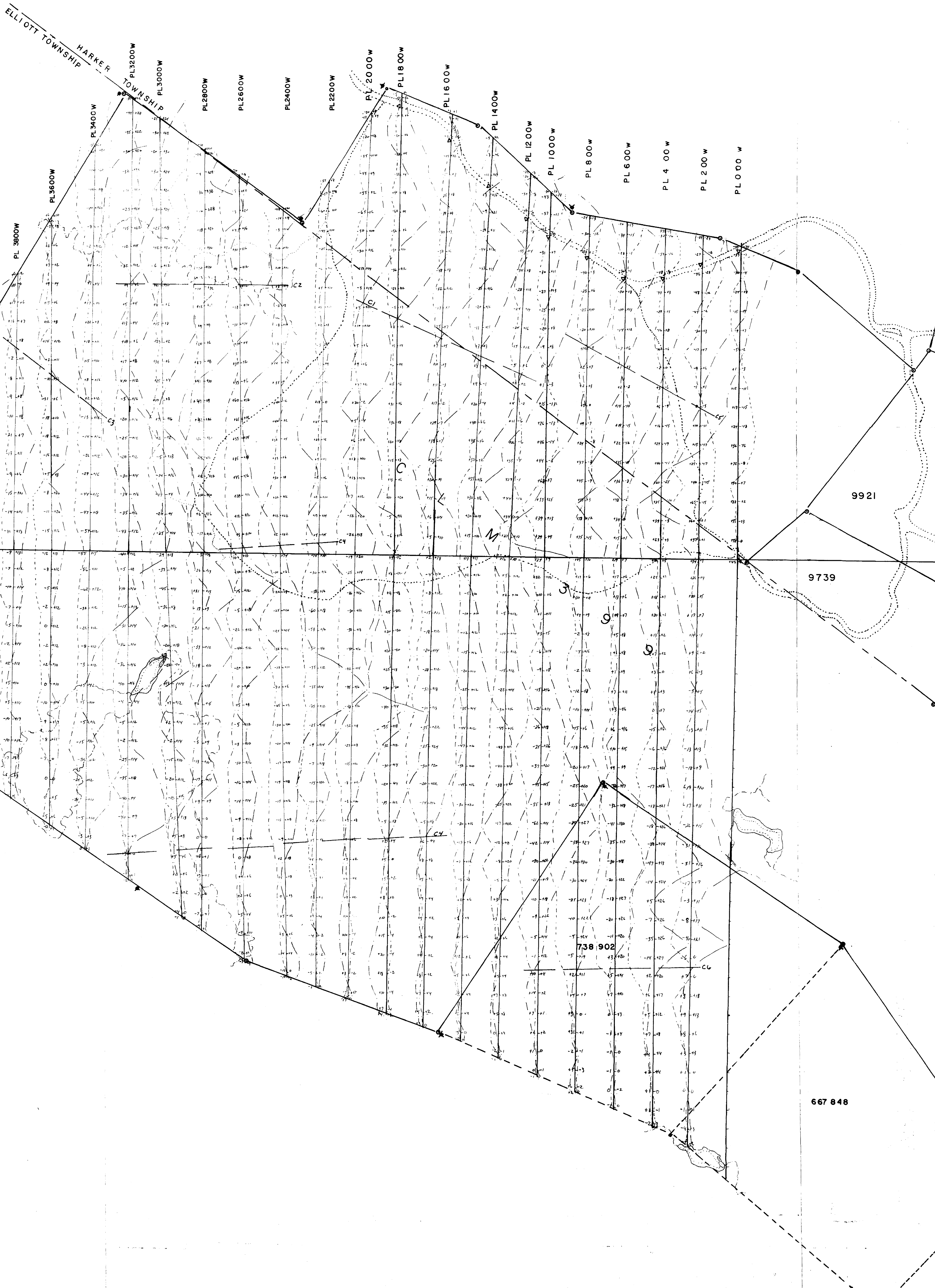

SYMBOLS

- SURVEY PIN LOCATED
- ASSUMED PIN
- SURVEY LINE CUT
- TWP LINE
- CLAIM POST TIE-ON
- CLAIM LINE
- GRID CONTROL POINTS
- ROAD TRAIL

2. 20 4 59

INSTRUMENTATION

INSTRUMENT USED GEONICS EM 16
 STATION USED CUTLER, MAINE, USA
 VERTICAL SCALE ± 40 %

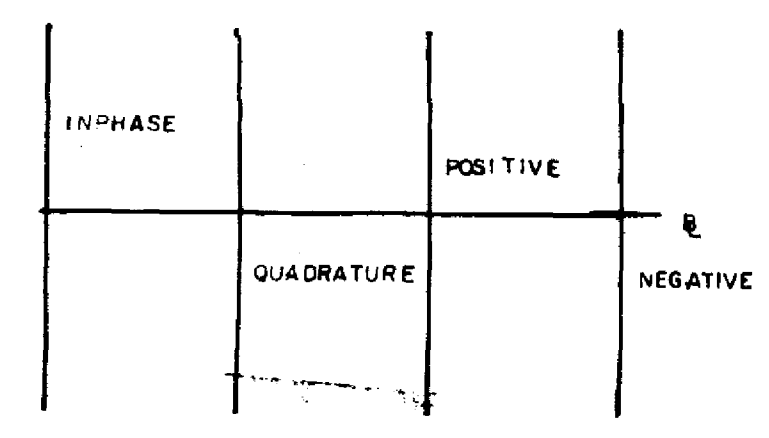

REPORT BY W.K.WELLER

CONTOURED BY W.K.WELLER

KEY MAP

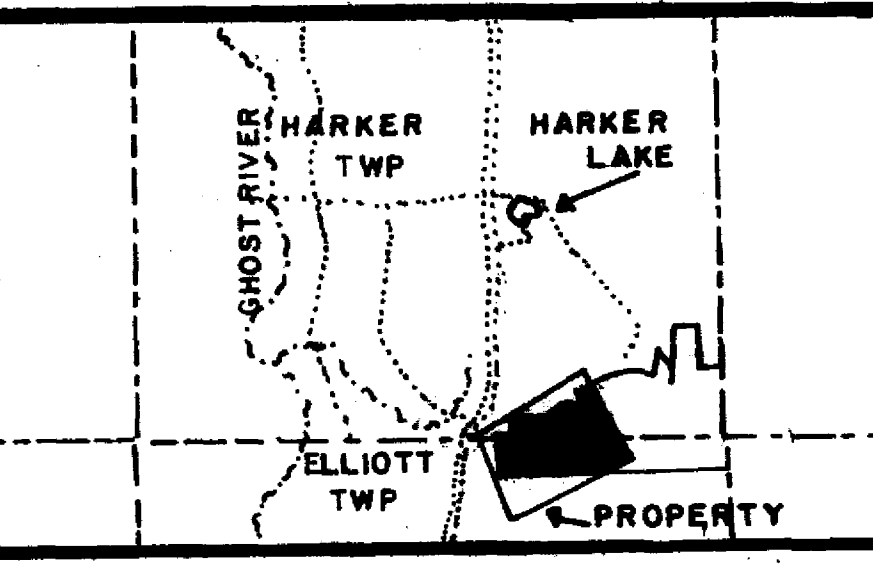

GWEN RES
 IRIS 2000 PROJECT
 NEW NORTH - SOUTH GRID
 WEST SHEET

GROUND VLF-EM SURVEY

HARKER-ELLIOTT TOWNSHIP
 LARDER LAKE MINING DIVISION
 DISTRICT OF COCHRANE, ONTARIO
 SCALE= 1" TO 200'



MAP NO. 118 / 2000 / VLF DATE: JUNE 2000
 DRAFTED BY JR.HAMILTON-HENNESSEY

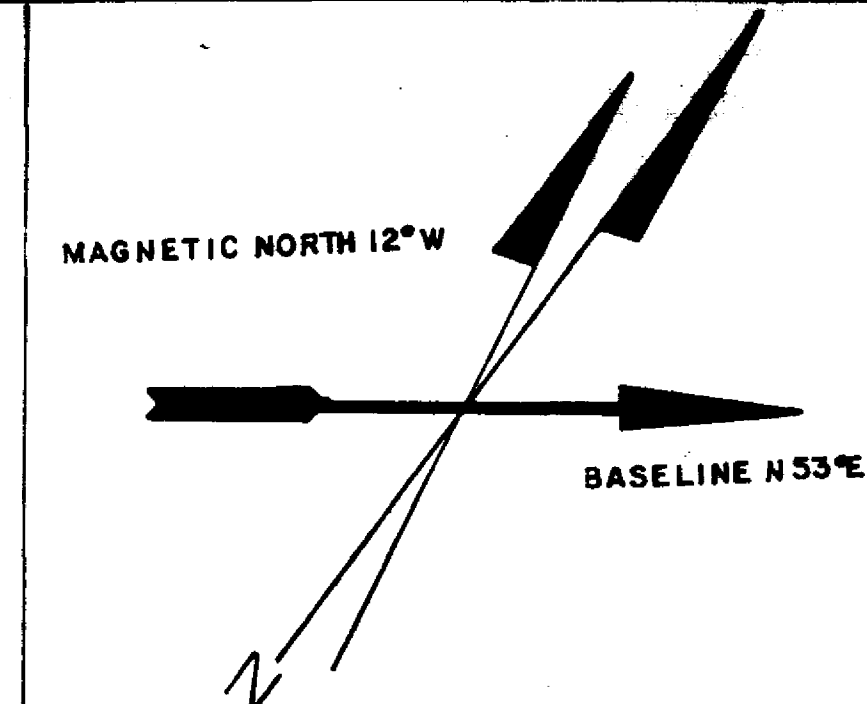

SYMBOLS

- SURVEY PIN LOCATED ○
- ASSUMED PIN ○
- SURVEY LINE CUT ———
- TWP LINE ———
- CLAIM POST ■ TIE-ON ▴
- CLAIM LINE - - - - -
- GRID CONTROL POINTS ▲
- ROAD - - - - - TRAIL - - - - -

2. 20459

INSTRUMENTATION

INSTRUMENT USED McPHAR GP 8
 DATUM N SUBTRACTED 57000 M
 CONTOURS INTERVALS 100 M

| | |
|------------|----------|
| INPHASE | POSITIVE |
| QUADRATURE | NEGATIVE |

VLF CONTACT ——— C I

REPORT BY W.K.WELLER
W.K. Weller
 CONTOURED BY W.K.WELLER

KEY MAP

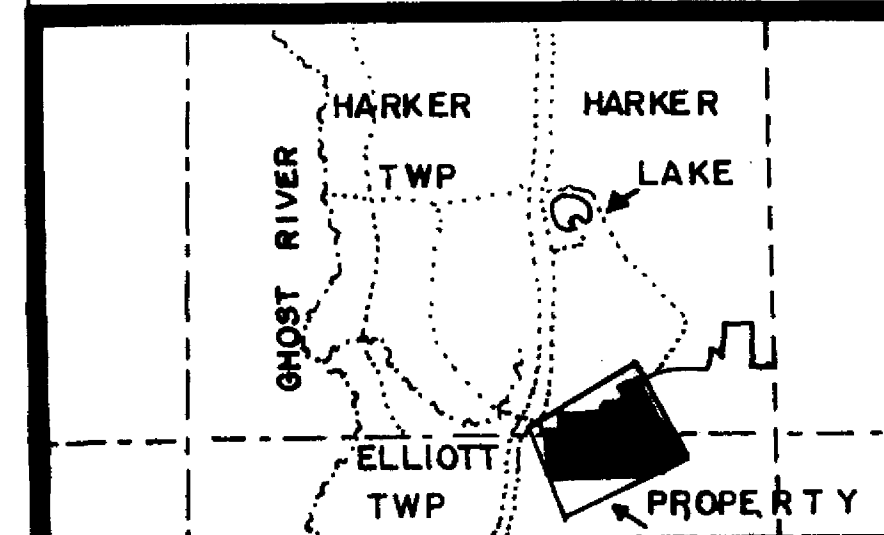

GWEN RES
 IRIS 2000 PROJECT
 NEW NORTH-SOUTH GRID
 WEST SHEET

GROUND MAGNETOMETER SURVEY

HARKER - ELLIOTT TOWNSHIPS
 LARDER LAKE MINING DIVISION
 DISTRICT OF COCHRANE, ONTARIO

SCALE = 1" TO 200'



MAP NO (1R/2000 MAG) DATE JUNE, 00
 DRAFTED BY J.R. HAMILTON-HENNESSEY

