



32D05NW2076 2.20595 HARKER

010

GEOPHYSICAL SURVEY REPORT  
ON THE  
IRIS PROPERTY - PHASE II

MAGNETOMETER & ELECTROMAGNETIC SURVEYS

HARKER & ELLIOTT TOWNSHIPS

LARDER LAKE MINING DIVISION

DISTRICT OF COCHRANE, ONTARIO

**2.20595**

FOR

ALEXANDER H. PERRON

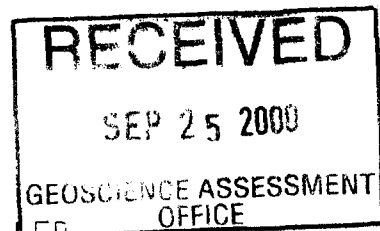
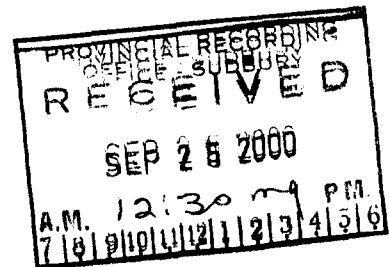

SEPTEMBER 22, 2000

WENDY K. WELLER  
GEOTECH



TABLE OF CONTENTS

SUMMARY . . . . . i)

INTRODUCTION . . . . . 1

LOCATION AND ACCESS. . . . . 1, 2

REGIONAL GEOLOGY . . . . . 2

PROPERTY HISTORY . . . . . 2

PREVIOUS WORK . . . . . 2, 3

INSTRUMENTATION. . . . . 4

PRESENTATION AND DISCUSSION OF RESULTS . . . . . 4, 5

OBSERVATIONS AND RECOMMENDATIONS . . . . . 5

ASSESSMENT DATA FORM . . . . . 6

TECHNICAL DATA . . . . . 7

BIBLIOGRAPHY . . . . . 8

CERTIFICATE. . . . . 9

FIGURES, TABLES AND MAPS

CLAIMS WORK PERFORMED ON (FIGURE 1) . . . . . 2 a)

CLAIM LOCATION MAP ( FIGURE 1a) . . . . . 2 b)

LOCATION MAP (FIGURE 1b) . . . . . 2 c)

KINOJEVIS GROUP - LEGEND - (FIGURE 2). . . . . 2 d)

IRIS GOLD PROPERTY MAP - FIGURE 3) . . . . . 3 a)

GROUND VLF-EM SURVEY MAP NO. I/2000/vlf2 . . . . . IN BACK POCKET

GROUND MAGNETOMETER SURVEY MAP NO. I/2000/mag2 . . . . . IN BACK POCKET

SUMMARY

i)

This report is a geophysical survey as required by The Ministry of Northern Development and Mines for assessment work purposes, following the recommendation set for in the Mining Act Regulations 1991.

The report includes an introduction to the property, general geology, field results and conclusions based on the field study.

Technical Data is provided on the Assessment Data form found at the back of this report.

Field Data is compiled on the accompanying plan maps found at the back of this report, Maps No. I/2000/mag2 and No. I/2000/vlf2.

In 1999, Mr. Ben Berger from O.G.S. re-mapped and sampled the Iris Property. In his findings, from the sampling, a percentage of the ground showed certain minerals that have never been looked for. (e.g. Platium and Poladium SP).

On June 5, 2000, Gwen Resources started to cut a new North/South grid over the entire Iris Property, including Iris-10 (unpatented mining claims).

GEOPHYSICAL SURVEY REPORT  
ON THE

IRIS PROPERTY - PHASE II

MAGNETOMETER & ELECTROMAGNETIC SURVEYS  
HARKER & ELLIOTT TOWNSHIPS  
LARDER LAKE MINING DIVISION  
DISTRICT OF COCHRANE, ONTARIO

INTRODUCTION

On June 5, 2000, a new North/South grid was started on the West Section of the Iris Property.

The baseline was turned off thirty five feet west of the #3 post and pin of patent claim 9739 along the south (East/West) township line of Harker Township and Elliott Township, and twenty feet south of the township line in Elliott Township.

The **east** baseline was cut and two men chained for a distance of 37+00E feet. All picket lines were turned off at 325° north off the baseline (53° East).

Due to many large areas of flooded beaver ponds and creeks, three tie lines were established for grid control points. (TL8+00N, TL4+00S and TL16+00S).

All grid control points were two man chained by Gwen Resources Ltd.

All linecutting, chaining was performed by M. Fecteau and crew.

The magnetometer survey and electromagnetic surveys were done by Miss Wendy K. Weller and Mrs. Jan Hennessey.

All drafting was done by Mrs. J. R. Hennessey. Report writing and contouring was done by Miss Wendy K. Weller.

Ownership of the aforementioned leased and unpatented mining claims has been attested to by The Alberta Gold Exploration Corporation and Alexander H. Perron, and was not independently ascertained by the writer.

LOCATION AND ACCESS

The Iris Group is comprised of 16 patented claims, 2 leases and 12 unpatented mining claims, located in the South East corner of

Harker Township and the north/east corner of Elliott Township, Larder Lake Mining Division, Ontario. (Figure 1 - List of Claims).

The property is situated approximately 75 miles east of Timmins, Ontario, and approximately 25 miles north/northeast of Kirkland Lake, Ontario.

Access to the property is provided by Highway 672 that runs approximately 400 meters west of the West side of the Iris Property north/south survey line of CLM399. Throughout the property there are existing four wheeler trails to access the new grid. (See Figures 1a) and 1b).

### REGIONAL GEOLOGY

The Iris Gold claim group is located in the Abitibi Greenstone Belt of the Canadian Shield. This belt is composed of a sequence of metavolcanic and metasedimentary Archean age rocks that cover an area stretching about 220 miles from Timmins, Ontario, on the west to Val D'Or, Quebec, on the east.

The claims are situated within a sequence of iron rich and magnesium rich tholeiitic basalt flows known as the Kinojevis group (Figure 2). Stratigraphically, this group is about 30,000 feet thick and it occupies the core of a large east plunging synclinorium.

The Iris claim group is underlain by a sequence of tholeiitic basalt flows belonging to the Kinojevis Group. This group is composed of a sequence of iron rich and magnesium rich tholeiitic basalt flows forming a stratigraphic package about 30,000 feet thick. These rocks are overlain by younger, Blake River group calc-alkalic volcanics. Both have been folded into a large, east plunging synclinorium, the northern and southern limbs of which, have been cut by the major Porcupine Destor and Kirkland Lake-Larder Lake fault zones respectively. The Iris Property is situated about 5 miles south of the Destor Porcupine Fault zone near the Kinojevis-Blake River group contact.

### PROPERTY HISTORY

The Iris property comprises 31 patented and/or unpatented mineral claims, (Figure 2) in Harker and Elliott Townships, Ontario, all registered in the name of John E. Perron, a principal of the The Alberta Gold Exploration Corporation.

### PREVIOUS WORK

The Harker-Holloway area was the centre of mining activity during the 1920's when Harker Gold Mines Ltd. carried out a program

FIGURE 1

HARKER & ELLIOTT TOWNSHIPS

CLAIMS WORK PERFORMED ON

CLM-399

P-8650

P-9921

P-9922

P-9739

L-545251

L-667068

L-667848

CLAIM LOCATION MAP

FIGURE 1a)

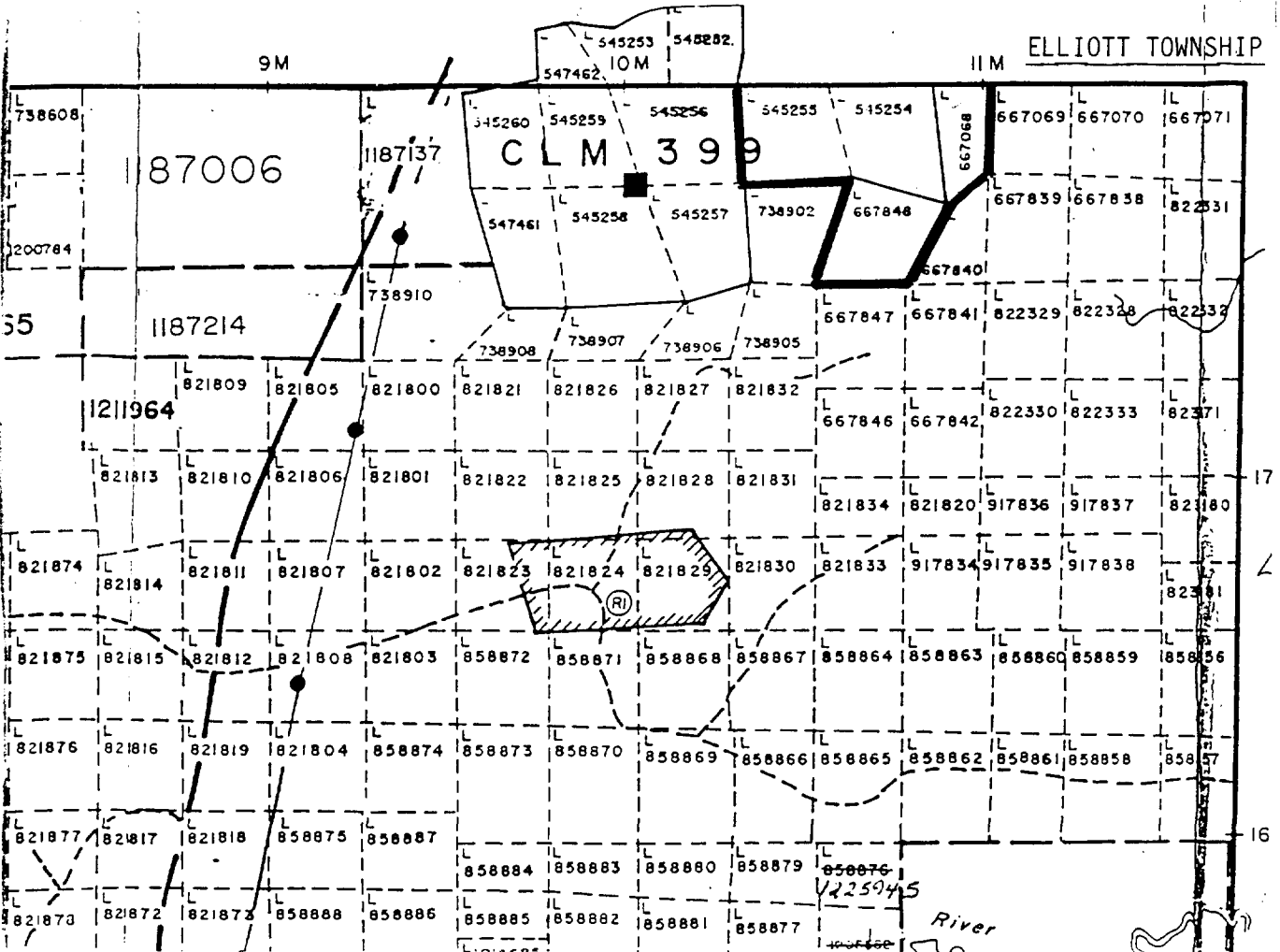
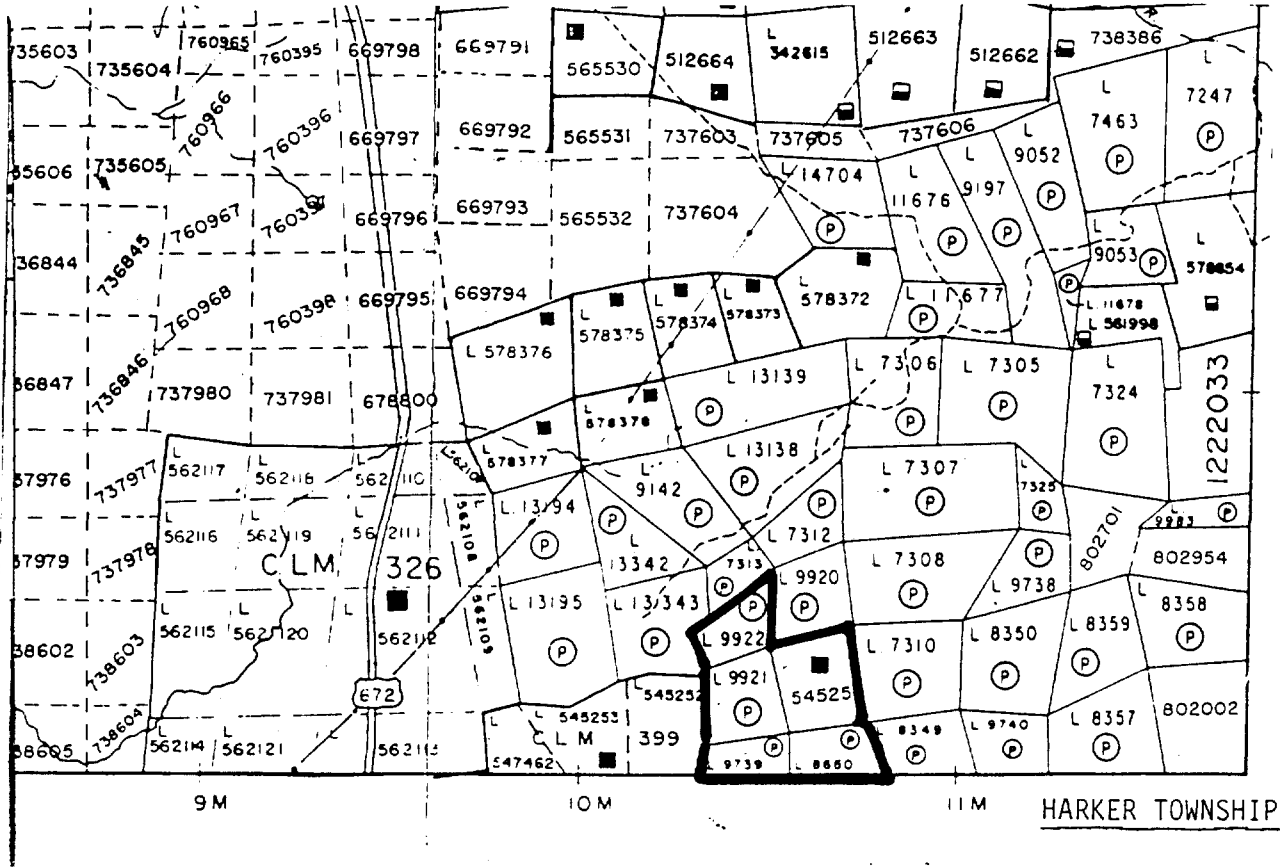





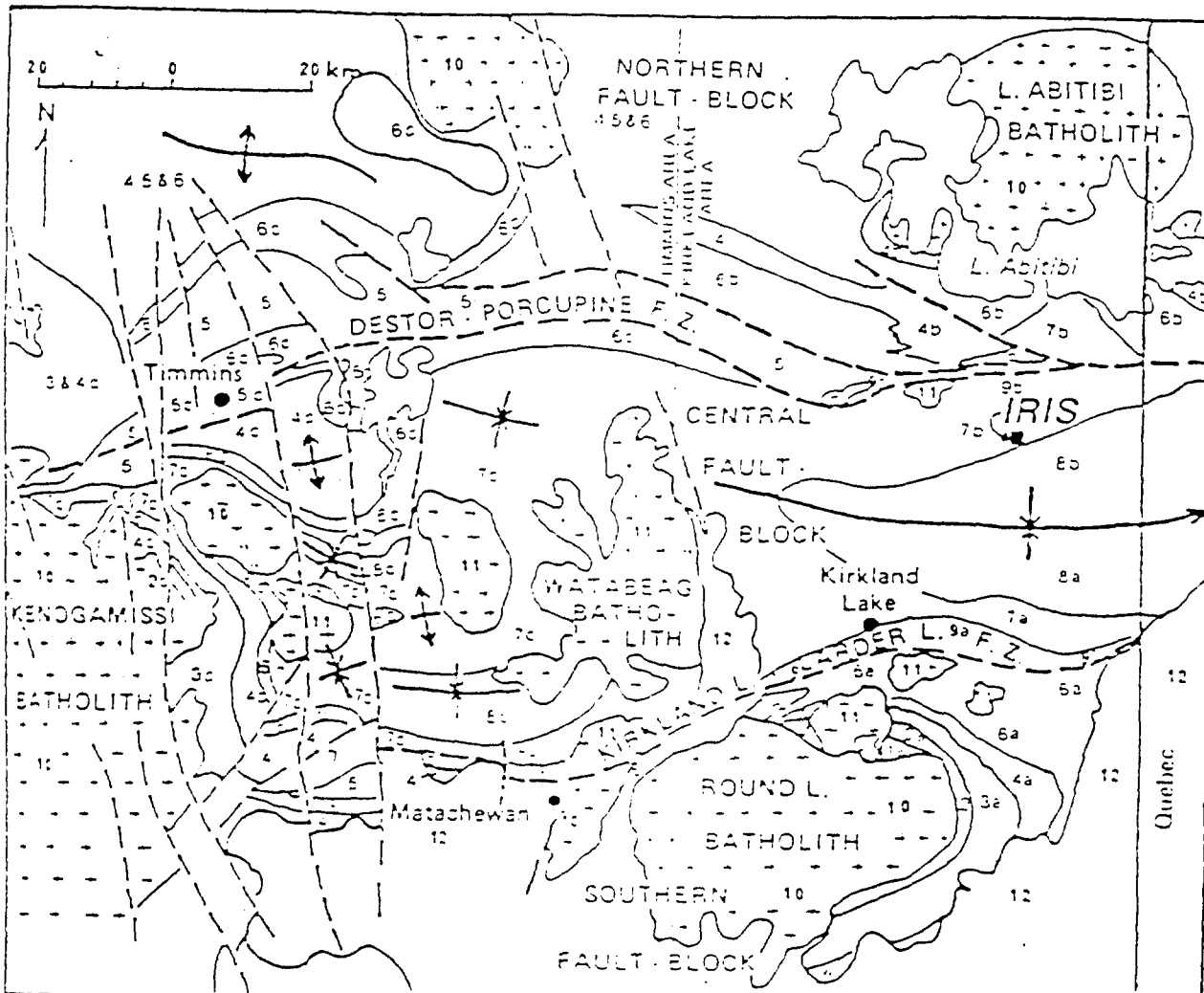

LEGEND

- |                  |   |  |
|------------------|---|--|
| Proterozoic      | 12 Cobalt Group   | 7a, 7b, Kirklevig Group, 7c Kirklevig Group, Middle Fm., Tisdale Group           |
| Archean          | Matatchewan diabase (not shown)   | 6a Larder Lake Group, 6b Stoughton-Roquemaure Group, 6c Lower Fm., Tisdale Group |
| Granitic rocks   | 11 Granodiorite, monzonite, quartz monzonite, syenite                     | 5c Porcupine Group   |
|                  | 10 Massive to gneissic quartz diorite, tonalite, trondhjemite             | Lower Supergroups  |
| Upper Supergroup | 9 9a, 9b, Timiskaming Group, 9b** Destor-Porcupine Complex                | 4 4a Slead Group, 4b Hunter Mine Group, 4c Upper Fm., Deloro Group               |
|                  | 8 8a, 8b, Brake River Group, 8a*** Brake River (Upper Fm., Tisdale Group) | 3 3a Catherine Group, 3c Middle Fm., Deloro Group                                |
|                  |   | 2 2a Wapewawa Group, 2c Lower Fm., Deloro Group                                  |
|                  |   | 1 1a Passadultzis ****   |

AFTER JENSEN AND LANGFORD (1985)

FIGURE 2

of extensive underground development on their Golden Harker property, situated immediately to the north of the Iris claim group. The Golden Harker Mine was closed in 1929.

In 1947, R. Storen examined the Iris property and reported the occurrence of gold mineralization in three separate localities, associated with «rhyolite» interflow horizons (Figure 3).

Vein 1 was exposed in two pits 900 feet apart and it consisted of sheared basalt/rhyolite mineralized with quartz-pyrite-chalcopyrite and galena. The vein was 1.9 feet wide and returned values of 0.29 ozs. per ton AU over 1.7 feet and 0.08 ozs. per ton AU over 1.9 feet.

Vein 2 is similar to vein 1 and returned values of 0.03 and 0.04 ozs. per ton AU over 8 inches and 7.5 inches respectively.

Vein 3 is located about 2,000 feet west of Vein 1 on the same «rhyolite» interflow horizon. It was exposed in two pits and it consisted of a N 70° E near vertical quartz vein containing pyrite, chalcopyrite, galena and visible gold. Assay samples taken from the east and west pits returned values of 0.11 ozs. per ton AU over 14 inches and 0.06 per ton AU over 8 inches respectively.

Storen (1947) also reported the occurrence of a wide zone of quartz mineralization in rhyolite on claim L-545251. The quartz contained disseminated pyrite with minor amounts of chalcopyrite and galena. A chip sample from this locality returned a value of 0.01 per ton AU over 5 feet.

In 1985 American Barrick Resources Ltd. announced the discovery of the Holt-McDermott deposit containing reserves of 2.8 million tons averaging 0.197 ozs. per ton AU. This announcement coupled with encouraging news from companies exploring other properties in the area helped intensify exploration efforts in the whole region. Recently, Canamax Resources Ltd. completed an underground exploration and development program on their East Zone property with a view to achieving production during 1988. Lenora Explorations Ltd., one of the Kasner Group of companies is in the midst of a substantial underground exploration program on their Gold Harker property which adjoins the Iris claim group immediately to the north. They have increased the reserves on the property and discovered new mineralized zones which are undergoing intensive evaluation.

During the period 1982 to 1987 detailed ground geophysical, geological and geochemical work plus airborne electromagnetic and magnetic surveys were completed on the Iris claim group. A number of geophysical and geochemical anomalies were defined by this work. In late 1986 and early 1987, a 5,924 foot drill program was carried out on the property by Perrex Resources Ltd. The drilling was focussed on geological targets and succeeded in defining areas of wide spread, low grade, gold mineralization within a syenite plug and narrow zones of higher grade mineralization within shear/breccia zones in basalts.

HARKER TOWNSHIP

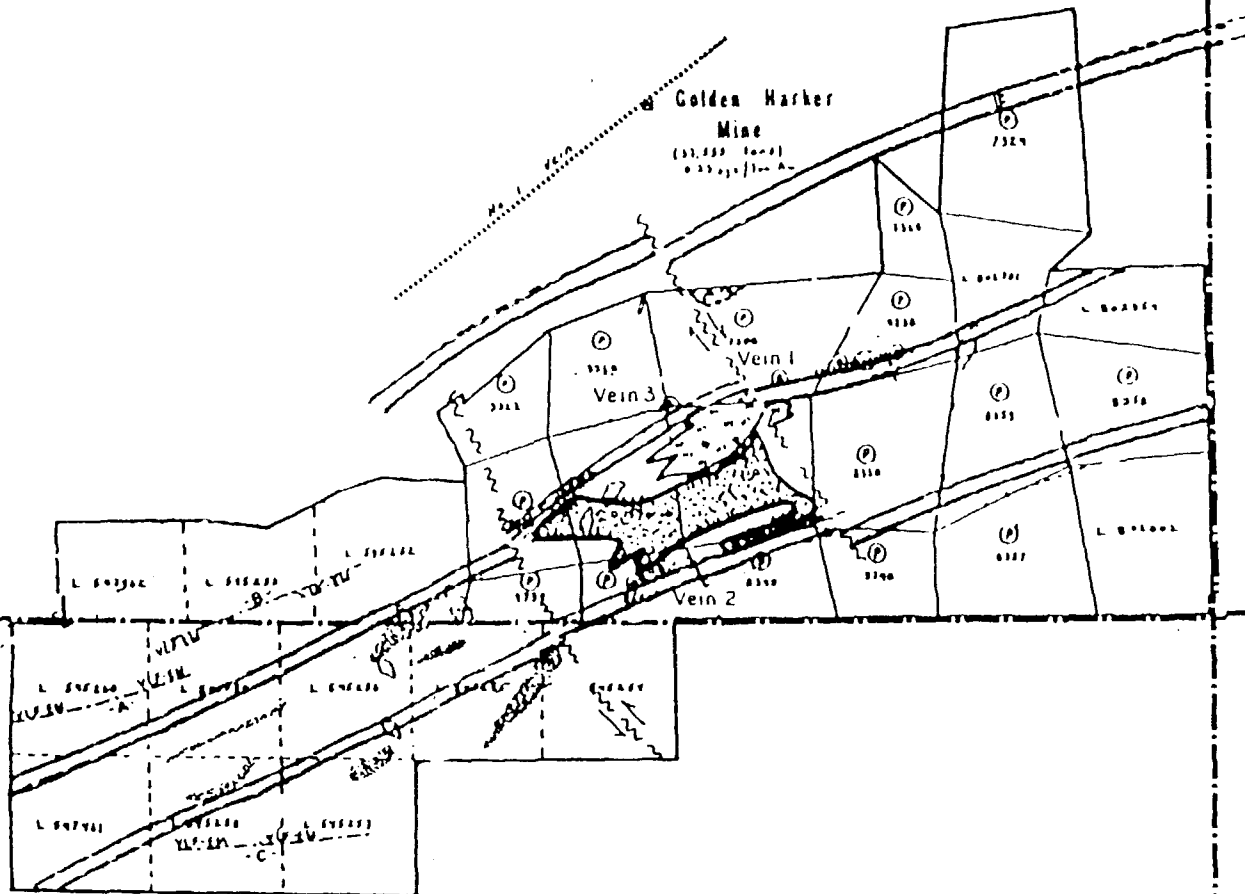

ELLIOTT TOWNSHIP

FIGURE 3

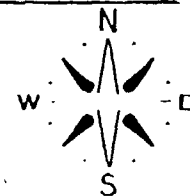

**LEGEND**

- Quartz vein (with associated gold)
- Siliceous Zone
- Byssite
- Fault
- Electromagnetic anomaly
- Geochemical anomaly
- Now stripping
- Old trenches
- Old pit workings on showings
- Pyroxenite

**KEY MAP**

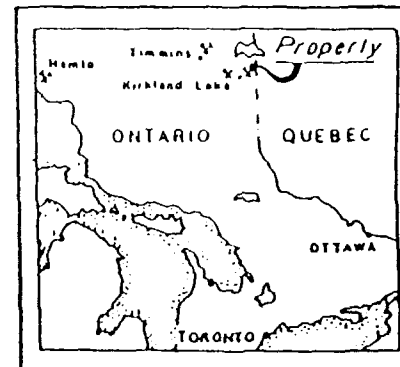

FIGURE 4

The Alberta Gold Exploration Corporation  
**IRIS GOLD PROPERTY MAP**

HARKER GOLD AREA  
 LARDER LAKE MINING DIVISION  
 DISTRICT OF COCHRANE, ONTARIO

1000 0 1000 2000

Scale: 1 inch to 1000 feet

**PERRONS'**

*Kirkland Lake, Canada*

Map No. 1 | Registered by: Geological Survey | Drawn by: Mary Green | Date: June 1985

-3 a)-

## INSTRUMENTATION

### Magnetometer Survey:

This system uses a backward motion of spinning protons of a hydrogen atom within fluid of hydrogen and carbon. These spinning magnetic protons are caused to have two opposite poles by applying a magnetic field using a current within a coil of wire. This frequency of precision is proportional to the earth's total magnetic field.

This instrument is read directly in gammas which is the absolute value of the earth's total field for that station.

The diurnal variation was monitored by closing each loop at any secondary check station, at a grid line, baseline intersection. Diurnal corrections were applied by linear distribution of any observed variation over the time between base stations.

### Electromagnetic Survey:

The VLF-EM method uses as a source, several of the main submarine communications transmitters in the 15 to 25 kHz band found throughout the world.

The submarine communication radio waves travel in a single mode parallel to the surfaces of the earth along the earth-air interface.

VLF instruments are capable of picking up any structures that change the direction of the waves by measuring the tilt angle being zero on flat ground, but when a conductor is present, the tilt angle will acquire a finite value. The direction of tilt indicates the direction of the conductor.

Calculations of such parameters as depth, depth extent, dip and width of the conductors is very minimal.

The VLF easily illustrates the location of the upper limit of dipping structures which can be seen or plotted as VLF profiles as areas of greatest change in tilt angle per unit of distance.

The instrument used for this survey was a Geonics EM-16 Unit. The sensitivity of this unit is 1% for the inphase and 1% for the quadrature. The operating frequency for the EM-16 from 15-25 kHz and the station is made by plug-in units.

Further information on the VLF and the magnetometer can be found in the back of this report on the Technical Data and Assessment forms.

## PRESENTATION AND DISCUSSION OF RESULTS

### i) Magnetometer Survey 2000:

The field data is presented on Map No. I/2000/mag2 at

a scale of 1" = 200' found at the back of this report.

The magnetic data is illustrated as isomagnetic contours, contour intervals 100 gammas, on a Map of corrected magnetic values at each station.

The magnetic relief ranges from 57,080 gammas to 61,585 gammas (difference of 4505 gammas). In claim L-545254 (Figure 3) shows a north/south fault running through the west side of the claim. There is an interruption in the magnetic trend in this area of the grid.

ii) Electromagnetic Survey:

The field data is presented on Map No. I/2000/vlf2, at a scale of one inch to two hundred feet, found at the back of this report.

There are two distinctive anomalies found in this small section of the east side of the new grid.

C9 - Crosses PL14+00E 21+50S to PL18+00E 21+30S.

The topography of the area is a large overburdened outcrop sloping south covered in birch, poplar and balsam. The magnetometer shows a north contact between a large high anomaly to a very low linear magnetic anomaly. This contact may be the contact between the rhyolite zones that trend parallel to the volcanic rocks.

C10- Crosses PL14+00E 10+50N to PL18+00E 11+30N.

This contact may possibly be the contact between the rhyolite #3 one and the volcanic rocks. The topography of the area is flat, very wet and thick alder, cedar swamp.

OBSERVATIONS AND RECOMMENDATIONS

At present time the continuation of the new grid is being completed.

The claim group covers various flow and fragmental units of mafic volcanic nature with two rhyolite interflow horizons. The information that has been tallied by the new grid is helping to prove up new diamond drill targets. In the most southern claims in Elliott Township a Tieline is being established due to excessive amount of creeks and beaver ponds.

At the completion of these two surveys, new drill targets will be discussed as well as down the hole I.P. in the existing diamond drill holes.

Respectfully submitted,



Miss Wendy K. Weller  
Geotech

September 22, 2000

# Assessment Data Form

## Type of Work:

Prospecting: ..... Geological: .....

Physical: LINE CUTTING AND CHAINING

Geophysical: ELECTROMAGNETIC (1 STATION) AND MAGNETOMETER SURVEY

Geochemical: ..... Drilling: .....

Assays/Analyses: ..... Other work: .....

Cost of Work: \$3,275.00 Dollars Applied: \$ 3,275.00

Recorded Holder: ALEX PERRON/ Survey Company:

Name: THE ALBERTA GOLD EXPLORATION CORP. Name: GWEN RESOURCES LTD.

Address: 103 GOVERNMENT ROAD EAST, Address: 103 GOVERNMENT ROAD EAST,  
KIRKLAND LAKE, ONTARIO P2N 1A9 KIRKLAND LAKE, ONTARIO P2N 1A9

## Survey/Report Information:

Start of work: AUGUST 29, 2000 End of work: SEPTEMBER 21, 2000

Draughting time: SEPT. 21, 2000 Report time: SEPT. 21,22, 2000

Completion of report: SEPT. 22, 2000 Author: MISS WENDY K. WELLER

Work performed on claim(s) .....

CLM-399, P-8650, P-9921, P-9922, P-9739, L-545251, L-667068, L-667848.

Work applied to claim(s) .....

L-735602, L-735603, L-735604, L-917836, L-917837, L-917838.

Persons who performed work (supervisor first): .....

GWEN RESOURCES LTD.

WENDY K. WELLER

J. HENNESSEY JAMIE HENNESSEY

PAUL SIFORD AND CREW

MICHEL FECTEAU

Technical Data:

Line (mi/km): 6.45 KM  
 No. of samples/stations: 212  
**ELECTROMAGNETIC SURVEY:**  
 Instrument: GEONICS EM-16  
 Coil configuration: VERTICAL AND HORIZONTAL  
 Method: FIXED TRANSMITTER  
 Vertical scale: 1 INCH =  $\pm$  40%  
 Frequency: 24.8 kHz  
 Operational technique:

Line traversed:  
 Line/picket spacing: 200 FT./100 FT.  
 Operator: JAN HENNESSEY  
 Accuracy:  $\pm$  1%  
 Coil separation: INFINITY  
 Parameters: INPHASE & QUADRATURE  
 Horizontal scale: 1:50000  
 Station: CUTLER, MAINE

MAGNETIC SURVEY:

Instrument: MCPHAR GP-8 PROTON  
 Base station: BL10+00E  
 Base station time: 30 MINUTES  
 Contour interval: 100 GAMMAS  
 Contoured by: MISS WENDY K. WELLER  
 Operational technique: SPENCER POLE MOUNT

Operator: MISS WENDY K. WELLER  
 Accuracy:  $\pm$  GAMMA  
 Diurnal method: CLOSED LOOP  
 Location/value: BL 10+00E  
 Datum subtracted: 57,000 GAMMAS  
 Horizontal scale: 1:50000

INDUCED POLARIZATION SURVEY

Transmitter used:  
 Method:  
 On time:  
 Off time:  
 Power source:  
 Electrode array:  
 Readings taken:  
 Operational technique:

Receiver used:  
 Frequency:  
 Range:  
 Delay time:  
 Output:  
 Electrode spacing:  
 Other data:

BIBLIOGRAPHY

- Storen, R. 1947 - Preliminary Report of Iris Gold Mines Ltd., Harker Township, Larder Lake Mining Division, Province of Ontario, private engineers report.
- Satterly, J. 1952 - Geology of Harker Township; 60th Annual Report of the Ontario Department of Mines, Vol. LX, Part VIII, 1951.
- Drummond, A.D. 1987 - Report on The Winter 1986-1987 Drill Program, 31 Claim Iris Gold Group: a private report for The Alberta Gold Exploration Corporation.
- Jensen, L.S. 1986 - Mineralization and Volcanic Stratigraphy in The Western Part of the Abitibi Subprovince: Ontario Geological Survey, Misc. Paper 129.
- D. R. Hawke, 1988 - Report on the 1988 Exploration Program Iris Joint Venture Project NTS 32D/5.
- Workman, Al. 1988 - Evaluation Report.
- Weller, Miss Wendy K. 2000 - Geophysical Survey Report on The Iris Property, Magnetometer & Electro-magnetic surveys, Harker & Elliott Townships, Larder Lake Mining Division, District of Cochrane, Ontario. July 24, 2000
- Weller, Miss Wendy K. August 28, 2000 - Geophysical Survey Report on the Iris Property - Phase II Harker & Elliott Townships Larder Lake Mining Division District of Cochrane, Ontario August 28, 2000



C E R T I F I C A T E

I, Wendy K. Weller, of Kirkland Lake, Ontario, do hereby certify:

- 1) That I am a Geotech in Training and reside at:  
71 Second Street, Apartment #2, Kirkland Lake, Ontario P2N 1R6.
- 2) That I graduated from the Haileybury School of Mines as a certified Diamond Driller in 1982. I have had a staking licence for the past (10) ten years.
- 3) That I was employed as a Diamond Driller for Heath & Sherwood for 1 year.
- 4) That I have been practising as a Geotech Trainee for a period of (10) ten years and I am qualified to write this report.
- 5) That I supervised and participated in this survey.

09/22/00

Date



Wendy K. Weller  
Geotech

Personal information collected on this form is obtained under the authority of subsections 65(2) and 66(3) of the Mining Act. Under section 8 of the Act, the view the assessment work and correspond with the mining land holder, recorder, Ministry of Northern Development and Mines, 6th Floor.



32D05NW2076 2.20595 HARKER 900  
 - please type or print in ink.

Recording a claim, use form 0240.

2.20595

1. Recorded holder(s) (Attach a list if necessary)

Name THE ALBERTA GOLD EXPLORATION CORP./ALEX H. PERRON	Client Number #200833 - #181257
Address 103 GOVERNMENT ROAD EAST, KIRKLAND LAKE, ONTARIO P2N 1A9	Telephone Number (705) 567-3001 Fax Number (705) 567-2158
Name JOHN PERRON/PERREX RESOURCES INC.	Client Number #181279 - #181187
Address 103 GOVERNMENT ROAD EAST, KIRKLAND LAKE, ONTARIO P2N 1A9	Telephone Number (705) 567-3001 Fax Number (705) 567-2158

2. Type of work performed: Check (✓) and report on only ONE of the following groups for this declaration.

Geotechnical: prospecting, surveys, assays and work under section 18 (regs)       Physical: drilling, stripping, trenching and associated assays       Rehabilitation

Work Type LINE CUTTING AND CHAINING MAGNETOMETER AND ELECTROMAGNETIC SURVEYS	Office Use Commodity Total \$ Value of Work Claimed 3275 NTS Reference Mining Division Larder Lake Resident Geologist District Kirkland Lake
Dates Work Performed From 29 08 00 To 21 09 2000 Day Month Year Day Month Year	
Global Positioning System Data (if available)	Township/Area M or G-Plan Number HARKER/ELLIOTT

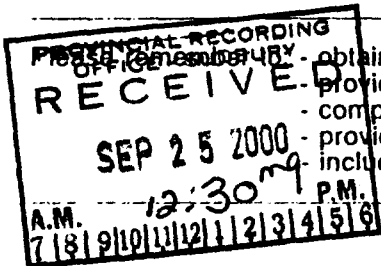

- obtain a work permit from the Ministry of Natural Resources as required;
- provide proper notice to surface rights holders before starting work;
- complete and attach a Statement of Costs, form 0212;
- provide a map showing contiguous mining lands that are linked for assigning work;
- include two copies of your technical report.

3. Person or companies who prepared the technical report (Attach a list if necessary)

Name MISS WENDY K. WELLER	Telephone Number (705) 567-3001
Address 103 GOVERNMENT RD.E., KIRKLAND LAKE, ONTARIO P2N 1A9	Fax Number (705) 567-2158
Name RECEIVED LARDER LAKE MINING DIVISION	Telephone Number
Name SEP 22 2000	Telephone Number
Address 1:07	Fax Number

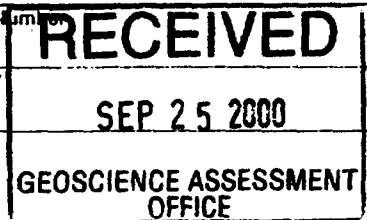

4. Certification by Recorded Holder or Agent

I, WENDY K. WELLER, do hereby certify that I have personal knowledge of the facts set forth in this Declaration of Assessment Work having caused the work to be performed or witnessed the same during or after its completion and, to the best of my knowledge, the annexed report is true.

Signature of Recorded Holder or Agent <i>Wendy K. Weller</i>	Date SEPTEMBER 22, 2000
Agent's Address 103 GOVERNMENT RD.E., KIRKLAND LAKE, ONT. P2N 1A9	Telephone Number (705) 567-3001 Fax Number (705) 567-2158

5. Work to be recorded and distributed. Work can only be assigned to claims that are contiguous (adjoining) to the mining land where work was performed, at the time work was performed. A map showing the contiguous link must accompany this form.

W.0080-00352

Mining Claim Number. Or if work was done on other eligible mining land, show in this column the location number indicated on the claim map.		Number of Claim Units. For other mining land, list hectares.	Value of work performed on this claim or other mining land.	Value of work applied to this claim.	Value of work assigned to other mining claims.	Bank. Value of work to be distributed at a future date.
eg	TB 7827	16 ha	\$26,825	N/A	\$24,000	\$2,825
eg	1234567	12	0	\$24,000	0	0
eg	1234568	2	\$8,892	\$4,000	0	\$4,892
G.937 1	CLM 399	10 ✓	\$1,275.00		\$1,275.00	
G.272 2	P-8650	1 ✓	\$460.00		\$460.00	
G.281 3	P-9921	1 ✓	\$604.00		\$604.00	
G.282 4	P-9922	1 ✓	\$430.00		\$430.00	
G.278 5	P-9739	1 ✓	\$102.00		\$102.00	
G.939 6	L-545251	1 ✓	\$325.00		\$325.00	
7	L-667068	1 ✓	\$47.00		\$47.00	
8	L-667848	1 ✓	\$32.00		\$32.00	
9	L-735602	1		\$400.00		
10	L-735603	1		\$400.00		
11	L-735604	1		\$216.00		
12	L-917836	1		\$663.00		
13	L-917837	1		\$798.00		
14	L-917838	1		\$798.00		
15						
<b>Column Totals</b>			\$3,275.00	\$3,275.00	\$3,275.00	

I, WENDY K. WELLER, do hereby certify that the above work credits are eligible under subsection 7 (1) of the Assessment Work Regulation 6/96 for assignment to contiguous claims or for application to the claim where the work was done.

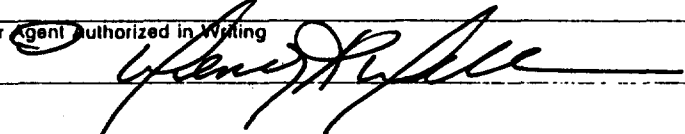
Signature of Recorded Holder or Agent authorized in Writing:  Date: SEPTEMBER 22, 2000

6. Instructions for cutting back credits that are not approved.
- Some of the credits claimed in this declaration may be cut back. Please check ( ✓ ) in the boxes below to show how you wish to prioritize the deletion of credits:
- 1. Credits are to be cut back from the Bank first, followed by option 2 or 3 or 4 as indicated.
  - 2. Credits are to be cut back starting with the claims listed last, working backwards; or
  - 3. Credits are to be cut back equally over all claims listed in this declaration; or
  - 4. Credits are to be cut back as prioritized on the attached appendix or as follows (describe):

Note: If you have not indicated how your credits are to be deleted, credits will be cut back from the Bank first, followed by option number 2 if necessary.

<b>For Office Use Only</b> RECEIVED LARDER LAKE MINING DIVISION SEP 22 2000 1:07 PM	Deemed Approved Date	Date Notification Sent
	Date Approved	Total Value of Credit Approved
	Approved for Recording by Mining Recorder (Signature)	



Personal information collected on this form is obtained under the authority of subsection 6(1) of the Assessment Work Regulation 6/96. Under section 8 of the Mining Act, the information is a public record. This information will be used to review the assessment work and correspond with the mining land holder. Questions about this collection should be directed to the Chief Mining Recorder, Ministry of Northern Development and Mines, 6th Floor, 933 Ramsey Lake Road, Sudbury, Ontario, P3E 6B5.

202505

Table with 4 columns: Work Type, Units of Work, Cost Per Unit of work, Total Cost. Rows include LINE CUTTING & CHAINING, MAGNETOMETER SURVEY, ELECTROMAGNETIC SURVEY, Associated Costs, Transportation Costs, and Food and Lodging Costs.

RECEIVED LABDER LAKE MINING DIVISION

RECEIVED SEP 25 2000 GEOSCIENCE ASSESSMENT OFFICE

Total Value of Assessment Work \$ 3,275.00

Calculations of Filing Discounts:

1.074

- 1. Work filed within two years of performance is claimed at 100% of the above Total Value of Assessment Work. 2. If work is filed after two years and up to five years after performance, it can only be claimed at 50% of the Total Value of Assessment Work.

TOTAL VALUE OF ASSESSMENT WORK x 0.50 = Total \$ value of worked claimed.

Note: - Work older than 5 years is not eligible for credit. - A recorded holder may be required to verify expenditures claimed in this statement of costs within 45 days of a request for verification and/or correction/clarification.

Certification verifying costs:

I, WENDY K. WELLER, do hereby certify, that the amounts shown are as accurate as may reasonably be determined and the costs were incurred while conducting assessment work on the lands indicated on the accompanying Declaration of Work form as I am authorized to make this certification.

Signature: Wendy K. Weller Date: SEPTEMBER 22, 2000

Geoscience Assessment Office  
933 Ramsey Lake Road  
6th Floor  
Sudbury, Ontario  
P3E 6B5

Telephone: (888) 415-9845  
Fax: (877) 670-1555

October 20, 2000

Wendy K. Weller  
THE ALBERTA GOLD EXPLORATION CORPORATION  
103 GOVERNMENT ROAD EAST  
KIRKLAND LAKE, Ontario  
P2N-1A9

Visit our website at:  
[www.gov.on.ca/MNDM/MINES/LANDS/mlsmnpge.htm](http://www.gov.on.ca/MNDM/MINES/LANDS/mlsmnpge.htm)

Dear Sir or Madam:

**Submission Number:** 2.20595

**Status**

**Subject: Transaction Number(s):** W0080.00352 Approval

---

We have reviewed your Assessment Work submission with the above noted Transaction Number(s). The attached summary page(s) indicate the results of the review. **WE RECOMMEND YOU READ THIS SUMMARY FOR THE DETAILS PERTAINING TO YOUR ASSESSMENT WORK.**

If the status for a transaction is a 45 Day Notice, the summary will outline the reasons for the notice, and any steps you can take to remedy deficiencies. The 90-day deemed approval provision, subsection 6(7) of the Assessment Work Regulation, will no longer be in effect for assessment work which has received a 45 Day Notice. Allowable changes to your credit distribution can be made by contacting the Geoscience Assessment Office within this 45 Day period, otherwise assessment credit will be cut back and distributed as outlined in Section #6 of the Declaration of Assessment work form.

Please note any revisions must be submitted in DUPLICATE to the Geoscience Assessment Office, by the response date on the summary.

If you have any questions regarding this correspondence, please contact LUCILLE JEROME by e-mail at [lucille.jerome@ndm.gov.on.ca](mailto:lucille.jerome@ndm.gov.on.ca) or by telephone at (705) 670-5858.

Yours sincerely,

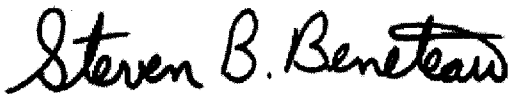

ORIGINAL SIGNED BY  
Steve B. Beneteau  
Acting Supervisor, Geoscience Assessment Office  
Mining Lands Section

# Work Report Assessment Results

**Submission Number:** 2.20595

**Date Correspondence Sent:** October 20, 2000

**Assessor:** LUCILLE JEROME

<b>Transaction Number</b>	<b>First Claim Number</b>	<b>Township(s) / Area(s)</b>	<b>Status</b>	<b>Approval Date</b>
W0080.00352	667068	HARKER, ELLIOTT	Approval	October 16, 2000

**Section:**

14 Geophysical VLF  
14 Geophysical MAG

At the discretion of the Ministry, the assessment work performed on the mining lands noted in this work report may be subject to inspection and/or investigation at any time.

**Correspondence to:**

Resident Geologist  
Kirkland Lake, ON

Assessment Files Library  
Sudbury, ON

**Recorded Holder(s) and/or Agent(s):**

Wendy K. Weller  
THE ALBERTA GOLD EXPLORATION CORPORATION  
KIRKLAND LAKE, Ontario

ALEXANDER H. PERRON  
KIRKLAND LAKE, Ontario

JOHN EDWARD PERRON  
KELOWNA, B.C.

PERREX RESOURCES INC.  
KIRKLAND LAKE, Ontario

LAMPLUGH TWP M-358

NOTICE OF FORESTRY ACTIVITY  
 THIS TOWNSHIP/AREA FALLS WITHIN THE  
 ARBITRI MANAGEMENT UNIT  
 AND MAY BE SUBJECT TO FORESTRY OPERATIONS.  
 THE M.N.R. UNIT FORESTER FOR THIS AREA CAN BE  
 CONTACTED AT: P.O. BOX 129 SWASTIKA ONT. POK-1T0  
 705-642-3222

THE TOWNSHIP  
 OF

HARKER

DISTRICT OF  
 COCHRANE

LARDER LAKE  
 MINING DIVISION







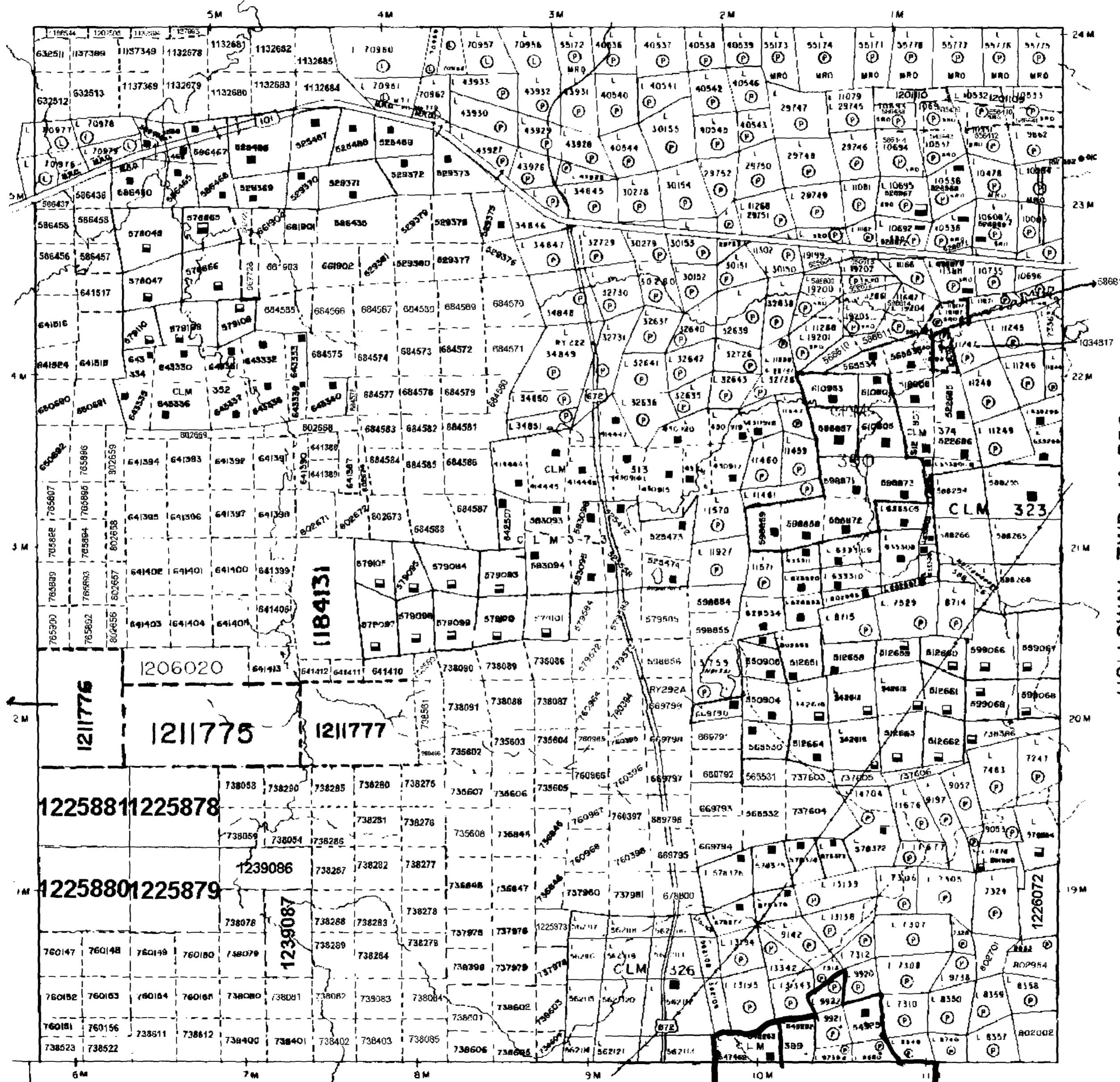







SCALE: 1-INCH 40 CHAINS

GARRISON TWP M-349

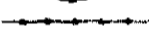
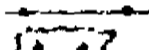
HOLLOWAY TWP M-356

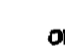
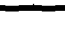

LEGEND

- PATENTED LAND  P
- CROWN LAND SALE  C.S.
- LEASES  L
- LOCATED LAND  L.C.
- LICENSE OF OCCUPATION  L.O.
- MINING RIGHTS ONLY  M.R.O.
- SURFACE RIGHTS ONLY  S.R.O.
- ROADS  ROAD
- IMPROVED ROADS  IMPROVED ROAD
- KING'S HIGHWAYS  KING'S HIGHWAY
- RAILWAYS  RAILWAY
- POWER LINES  POWER LINE
- MARSH OR MUSKEG  MARSH OR MUSKEG
- MINES  MINE
- CANCELLED PATENTED S.R.O.  C
- LEASE - MINING RIGHTS ONLY  M
- ORDER - IN - COUNCIL  O.C.

NOTES

400' Surface Rights reservation along the shores of all lakes and rivers

AREAS WITHDRAWN FROM DISPOSITION

- M.R.O. MINING RIGHTS ONLY
- S.R.O. SURFACE RIGHTS ONLY
- M.I.S. MINING AND SURFACE RIGHTS

Description Order No. Date Disposition File

L.U.P. LAND USE PERMIT NO. 117130, PENDING APPLICATION UNDER PUBLIC LANDS ACT

THE INFORMATION THAT APPEARS ON THIS MAP HAS BEEN COMPILED FROM VARIOUS SOURCES, AND ACCURACY IS NOT GUARANTEED. THOSE WISHING TO START MINING CLAIMS SHOULD CONSULT WITH THE MINING RECORDER, MINISTRY OF NORTHERN DEVELOPMENT AND MINES, FOR ADDITIONAL INFORMATION ON THE STATUS OF THE LANDS SHOWN HEREON



ELLIOTT TWP M-347

ARCHIVED APRIL 3, 1995



Ministry of  
 Natural  
 Resources

Ministry of  
 Northern Development  
 and Mines

Date

Sheet

G-3643

CIRCULATED FEB. 26, 1990

**REFERENCES**

**AREAS WITHDRAWN FROM DISPOSITION**

- M.R.O. - MINING RIGHTS ONLY
- S.R.O. - SURFACE RIGHTS ONLY
- M + S. - MINING AND SURFACE RIGHTS

Description    Order No    Date    Disposition    File

(10) MNR GRAVEL PIT No. 34



32D05NW2076 2.20595 HARKER 210

THE INFORMATION THAT APPEARS ON THIS MAP HAS BEEN COMPILED FROM VARIOUS SOURCES, AND ACCURACY IS NOT GUARANTEED. THOSE WISHING TO STAKE MINING CLAIMS SHOULD CONSULT WITH THE MINING RECORDER, MINISTRY OF NORTHERN DEVELOPMENT AND MINES, FOR ADDITIONAL INFORMATION ON THE STATUS OF THE LANDS SHOWN HEREON.

NOTICE FORESTRY ACTIVITY  
THIS TOWNSHIP FALLS WITHIN THE ADIRUDI MANAGEMENT UNIT AND MAY BE SUBJECT FOR FORESTRY OPERATIONS. THE MNR FOR THIS AREA CAN BE CONTACTED AT:  
P.O. BOX 129  
SANDY BEACH, ONTARIO  
P0B 1T0  
707 642-3222

**HARKER TOWNSHIP**

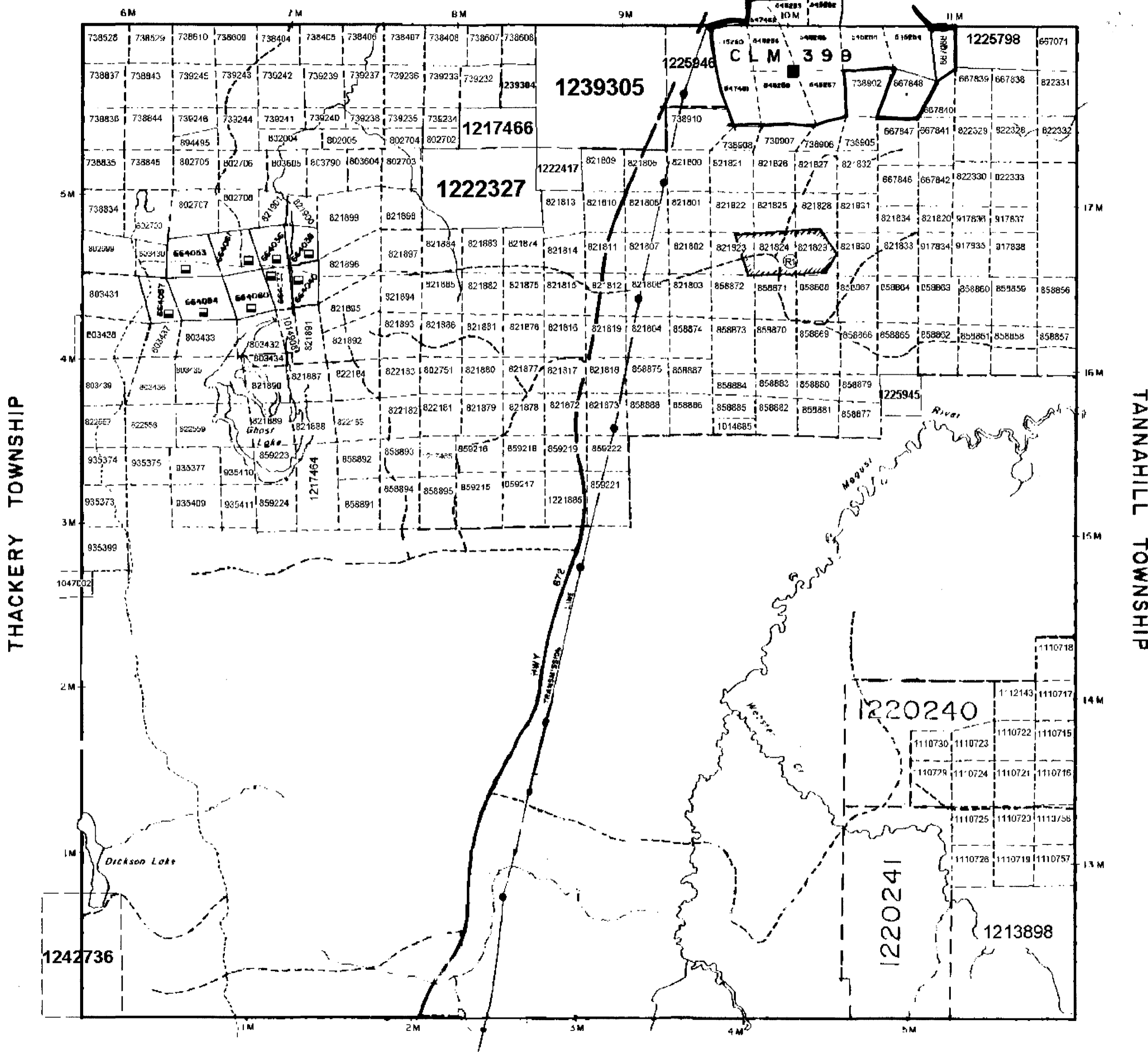

**LEGEND**

- HIGHWAY AND ROUTE No.
- OTHER ROADS
- TRAILS
- SURVEYED LINES
- TOWNSHIPS, BASE LINES, ETC.
- LOTS, MINING CLAIMS, PARCELS, ETC.
- UNSURVEYED LINES
- LOT LINES
- PARCEL BOUNDARY
- MINING CLAIMS ETC.
- RAILWAY AND RIGHT OF WAY
- UTILITY LINES
- NON-PERENNIAL STREAM
- FLOODING OR FLOODING RIGHTS
- SUBDIVISION OR COMPOSITE PLAN
- RESERVATIONS
- ORIGINAL SHORELINE
- MARSH OR MUSKEG
- MINES
- TRAVERSE MONUMENT

**DISPOSITION OF CROWN LANDS**

TYPE OF DOCUMENT	SYMBOL
PATENT, SURFACE & MINING RIGHTS	●
SURFACE RIGHTS ONLY	○
MINING RIGHTS ONLY	◐
LEASE, SURFACE & MINING RIGHTS	■
SURFACE RIGHTS ONLY	□
MINING RIGHTS ONLY	◑
LICENCE OF OCCUPATION	▽
ORDER IN COUNCIL	◇
RESERVATION	⊙
CANCELLED	⊘
SAND & GRAVEL	⊚

SCALE: 1 INCH = 40 CHAINS

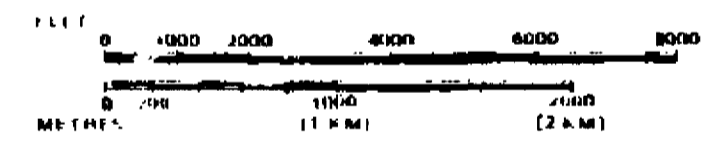

TOWNSHIP 21 N  
**ELLIOTT**  
 M.N.R. ADMINISTRATIVE DISTRICT  
 KIRKLAND LAKE  
 MINING DIVISION  
 LARDER LAKE  
 LAND TITLES / REGISTRY DIVISION  
 COCHRANE

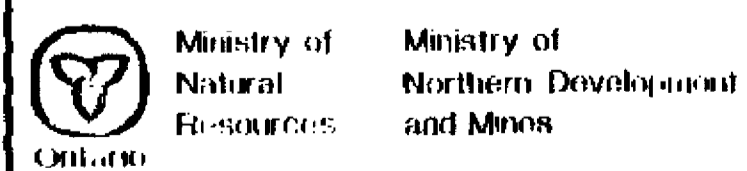

Date: MAY 1994  
 Number: G-3633

**CLIFFORD TOWNSHIP**

COPY OF THIS MYLAR ARCHIVED IN APRIL 1994  
 ARCHIVED MAY 02, 1994  
 ARCHIVED APRIL 05, 1994



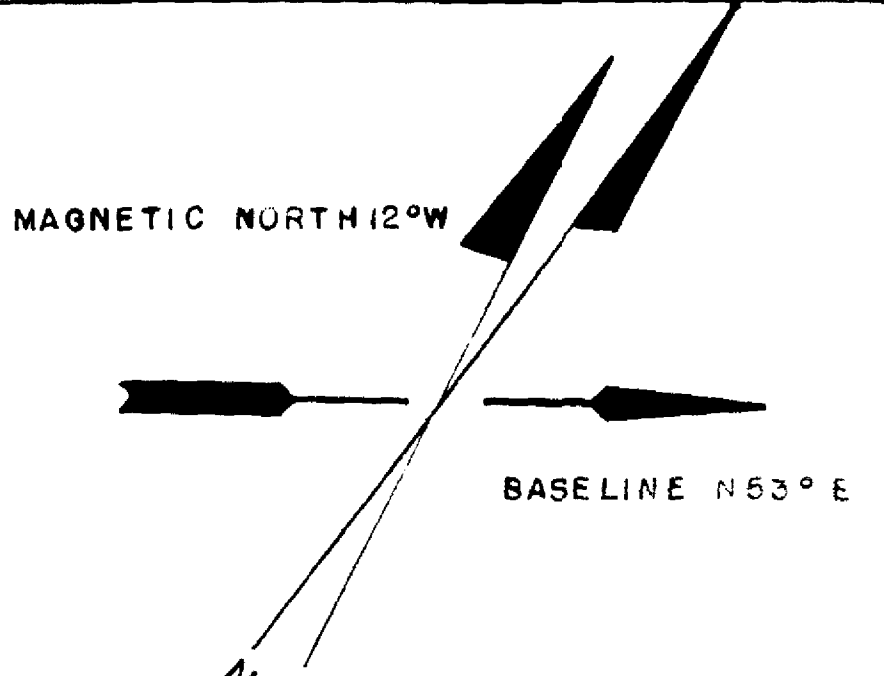
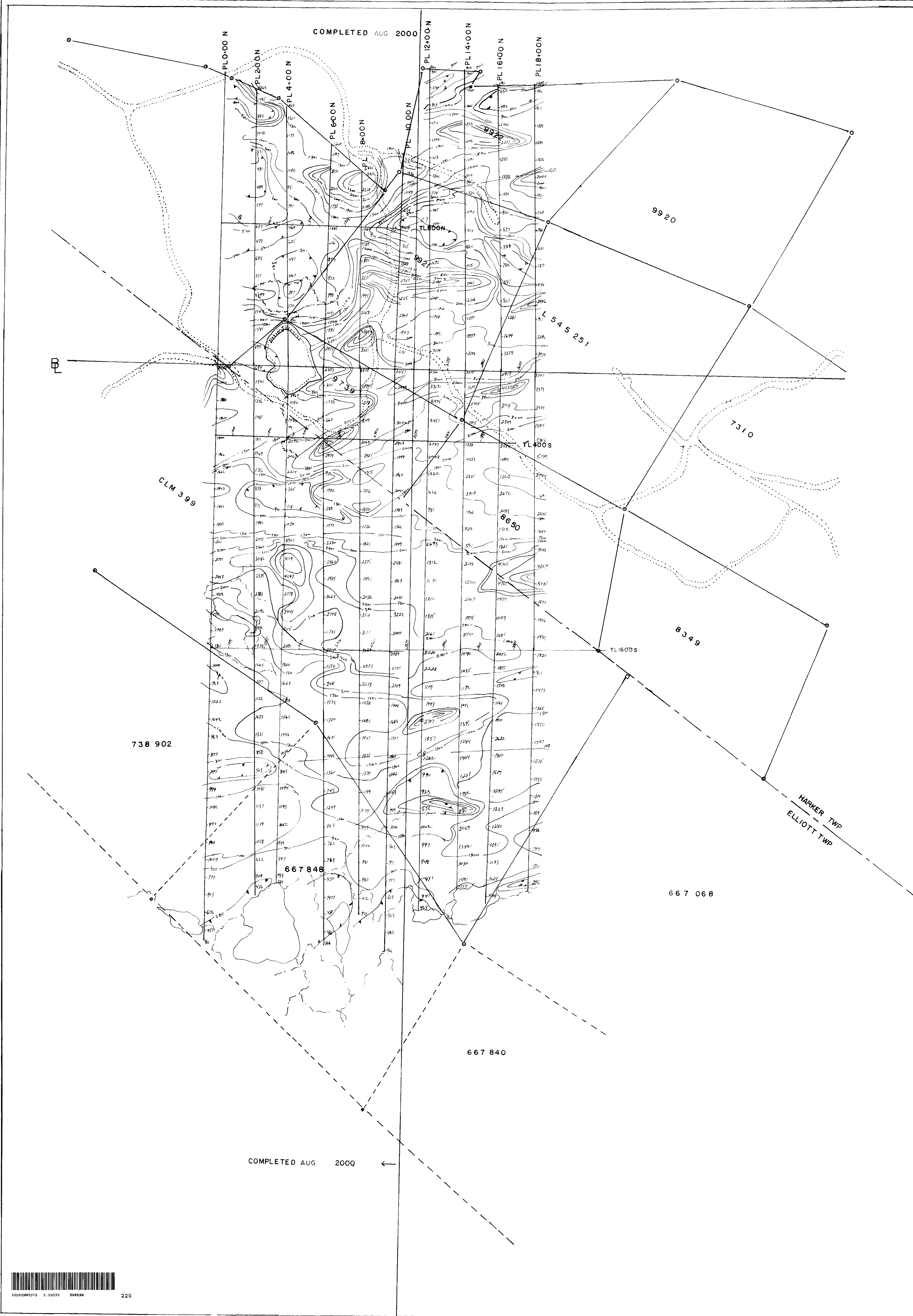

**SYMBOLS**

- SURVEY PIN LOCATED ○
- ASSUMED PIN ○
- SURVEY LINE CUT ———
- TWP LINE ———
- CLAIM LINE - - - - -
- CLAIM POST • TIE-ON \*
- GRID CONTROL POINTS A
- ROAD ——— TRAIL ———
- POND ——— CREEK ———
- COMPLETED ———

**INSTRUMENTATION**

INSTRUMENT USED McPHAR GP 8  
 DATUM SUBTRACTED 57 000  
 CONTACT VLF ——— CI  
 CONTOURS INTERVALS 100

INPHASE	POSITIVE
QUADRATURE	NEGATIVE

**GROUND MAGNETOMETER SURVEY**

REPORT BY W K WELER  
 CONTOURED BY W K WELER

**KEY MAP**

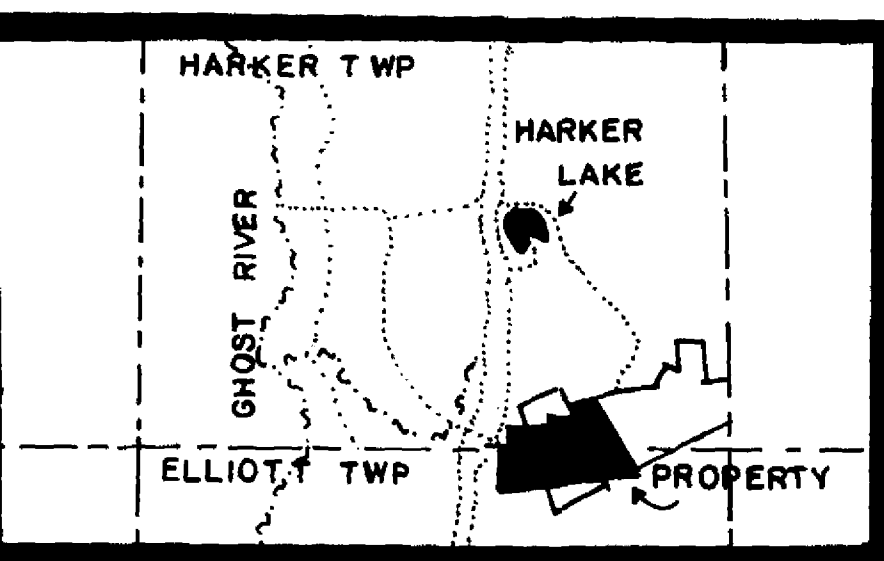

**GWEN RES**  
 IRIS 2000 PROJECT  
 NEW NORTH - SOUTH GRID  
 CENTRAL SHEET

HARKER - ELLIOTT TOWNSHIPS  
 LARDER LAKE MINING DIVISION  
 DISTRICT OF COCHRANE ONT.  
 SCALE = 1" TO 200'



MAP NO I/2000/MP 6 2  
 DATE SEPT. 2000  
 DRAFTED BY JR HAMILTON HENNESSEY

COMPLETED AUG. 2000

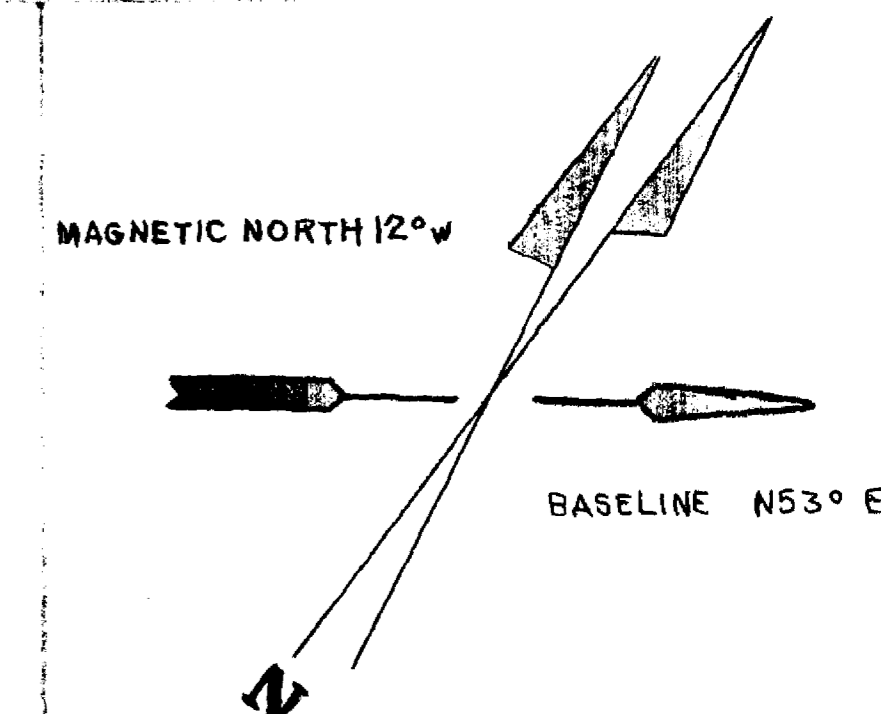

### SYMBOLS

- SURVEY PIN LOCATED  $\odot$
- ASSUMED PIN  $\circ$
- SURVEY LINE CUT  $\text{---}$
- TWP LINE  $\text{---}$
- CLAIM LINE  $\text{---}$
- CLAIM POST  $\blacksquare$  TIE-ON  $\blacktriangle$
- GRID CONTROL POINTS  $\triangle$
- ROAD  $\text{---}$  TRAIL  $\text{---}$
- POND  $\text{---}$  CREEK  $\text{---}$
- COMPLETED  $\text{---}$

### INSTRUMENTATION

INSTRUMENT USED GEONICS EM 16  
STATION USED CUTLER, MAINE, USA  
VERTICAL SCALE 40%

CONTOURS INTERVALS 100 ft

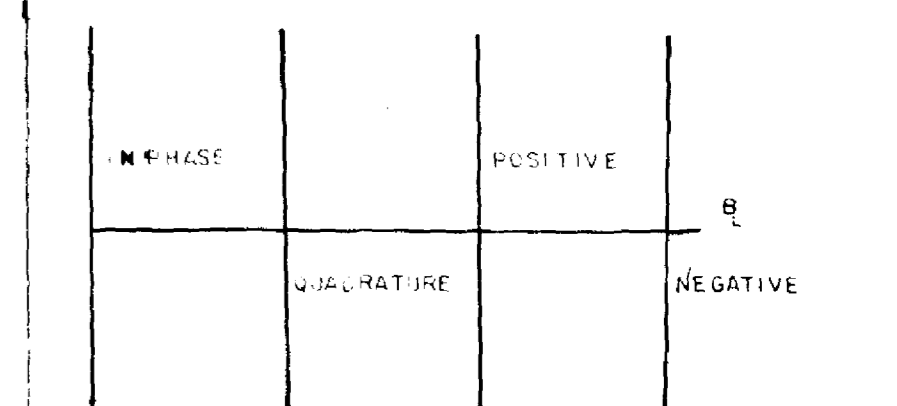

GROUND VLF - EM SURVEY

REPORT BY W K WELER

CONTOURED BY W K WELER

### KEY MAP

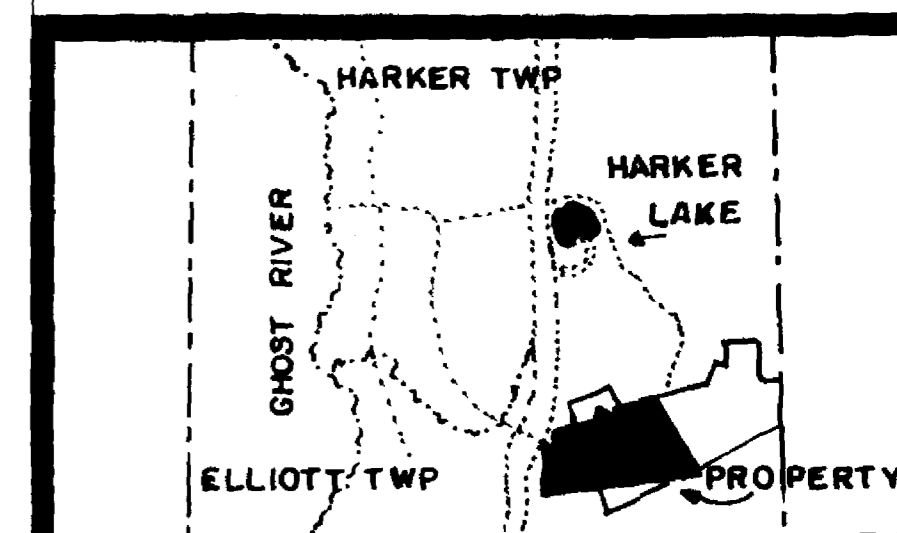

### GWEN RES

IRIS 2000 PROJECT

NEW NORTH - SOUTH GRID  
CENTRAL SHEET

HARKER-ELLIOTT TOWNSHIPS  
LARDER LAKE MINING DIVISION  
DISTRICT OF COCHRANE ONT.

SCALE = 1" TO 200'



MAP NO I/2000-1-1  
DATED SEPT. 2000  
DRAFTED BY RHAMILTON-HENNESSEY

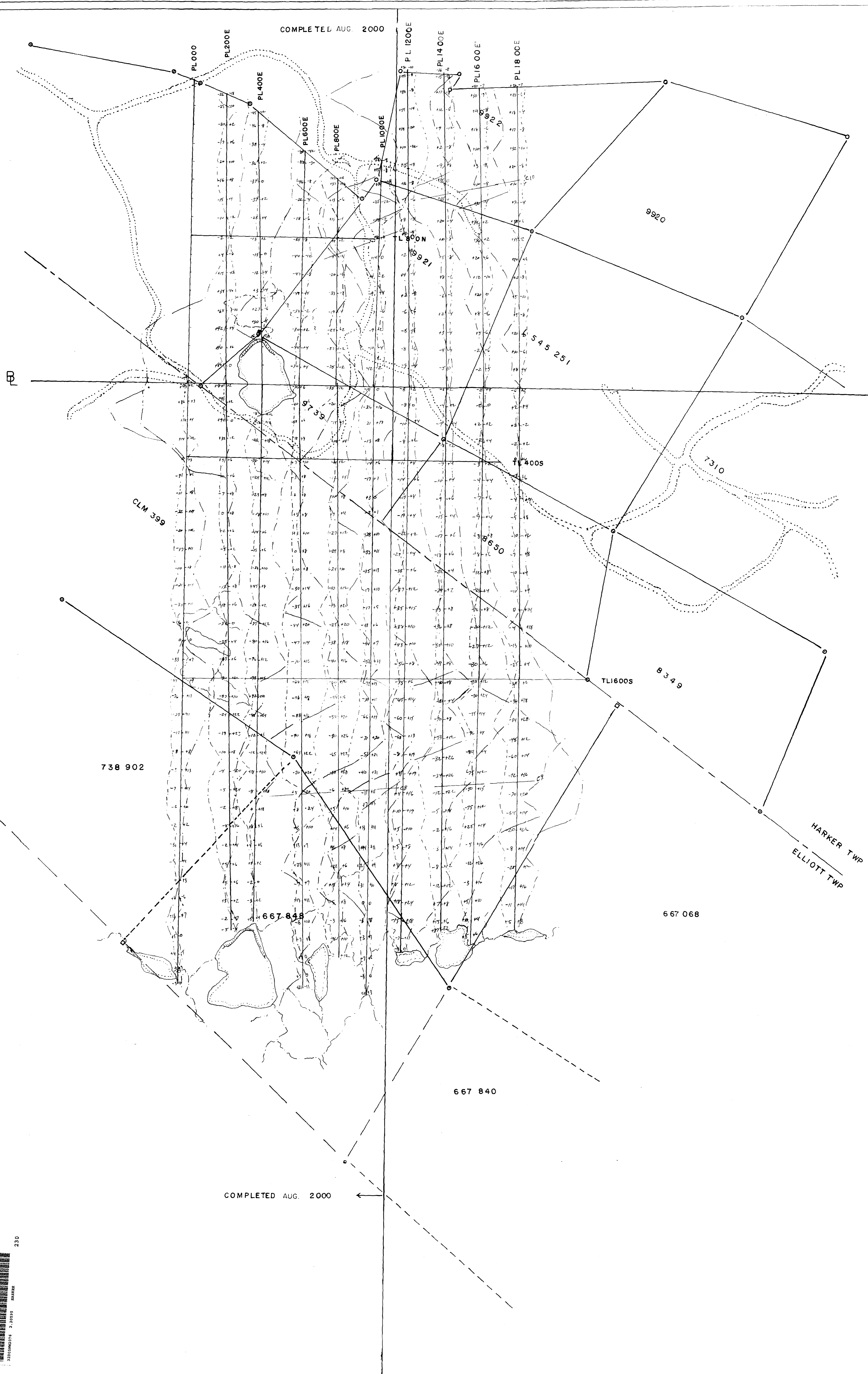

COMPLETED AUG. 2000

