

32D05NW2093 2.20544 HARKER

010

GEOPHYSICAL SURVEY REPORT
ON THE
IRIS PROPERTY - PHASE II

MAGNETOMETER & ELECTROMAGNETIC SURVEYS

HARKER & ELLIOTT TOWNSHIPS

LARDER LAKE MINING DIVISION

DISTRICT OF COCHRANE, ONTARIO

FOR

2.20544

ALEXANDER H. PERRON

AUGUST 28, 2000

WENDY K. WELLER
GEOTECH

TABLE OF CONTENTS

SUMMARY i)
INTRODUCTION 1
LOCATION AND ACCESS. 1, 2
REGIONAL GEOLOGY 2
PROPERTY HISTORY 2
PREVIOUS WORK 2, 3
INSTRUMENTATION. 4
PRESENTATION AND DISCUSSION OF RESULTS 4, 5
OBSERVATIONS AND RECOMMENDATIONS 5, 6
ASSESSMENT DATA FORM 7
TECHNICAL DATA 8
BIBLIOGRAPHY 9
CERTIFICATE. 10

FIGURES, TABLES AND MAPS

CLAIMS WORK PERFORMED ON (FIGURE 1) 2 a)
CLAIM LOCATION MAP (FIGURE 1a) 2 b)
LOCATION MAP (FIGURE 1b) 2 c)
KINOJEVIS GROUP - LEGEND - (FIGURE 2). 2 d)
IRIS GOLD PROPERTY MAP - FIGURE 3) 3 a)
GROUND VLF-EM SURVEY MAP NO. I/2000/v1f2 IN BACK POCKET
GROUND MAGNETOMETER SURVEY MAP NO. I/2000/mag2 IN BACK POCKET

32D05NW2093

2-20544

HARKER

010C



SUMMARY

i)

This report is a geophysical survey as required by The Ministry of Northern Development and Mines for assessment work purposes, following the recommendation set for in the Mining Act Regulations 1991.

The report includes an introduction to the property, general geology, field results and conclusions based on the field study.

Technical Data is provided on the Assessment Data form found at the back of this report.

Field Data is compiled on the accompanying plan maps found at the back of this report, Maps No. I/2000/mag2 and No. I/2000/vlf2.

In 1999, Mr. Ben Berger from O.G.S. re-mapped and sampled the Iris Property. In his findings, from the sampling, a percentage of the ground showed certain minerals that have never been looked for. (e.g. Platium and Poladium SP).

On June 5, 2000, Gwen Resources started to cut a new North/South grid over the entire Iris Property, including Iris-10 (unpatented mining claims).

GEOPHYSICAL SURVEY REPORT
ON THE
IRIS PROPERTY - PHASE II
MAGNETOMETER & ELECTROMAGNETIC SURVEYS
HARKER & ELLIOTT TOWNSHIPS
LARDER LAKE MINING DIVISION
DISTRICT OF COCHRANE, ONTARIO

INTRODUCTION

On June 5, 2000, a new North/South grid was started on the West Section of the Iris Property.

The baseline was turned off thirty five feet west of the #3 post and pin of patent claim 9739 along the south (East/West) township line of Harker Township and Elliott Township, and twenty feet south of the township line in Elliott Township.

The **east** baseline was cut and two men chained for a distance of 37+00E feet. All picket lines were turned off at 325° north off the baseline (53° East).

Due to many large areas of flooded beaver ponds and creeks, three tie lines were established for grid control points. (TL8+00N, TL4+00S and TL16+00S).

All grid control points were two man chained by Gwen Resources Ltd.

All linecutting, chaining was performed by M. Fecteau and crew.

The magnetometer survey and electromagnetic surveys were done by Miss Jamie Hennessey and Mrs. Jan Hennessey.

All drafting was done by Mrs. J. R. Hennessey. Report writing and contouring was done by Miss Wendy K. Weller.

Ownership of the aforementioned leased and unpatented mining claims has been attested to by The Alberta Gold Exploration Corporation and Alexander H. Perron, and was not independently ascertained by the writer.

LOCATION AND ACCESS

The Iris Group is comprised of 16 patented claims, 2 leases and 12 unpatented mining claims, located in the South East corner of

Harker Township and the north/east corner of Elliott Township, Larder Lake Mining Division, Ontario. (Figure 1 - List of Claims).

The property is situated approximately 75 miles east of Timmins, Ontario, and approximately 25 miles north/northeast of Kirkland Lake, Ontario.

Access to the property is provided by Highway 672 that runs approximately 400 meters west of the West side of the Iris Property north/south survey line of CLM399. Throughout the property there are existing four wheeler trails to access the new grid. (See Figures 1a) and 1b).

REGIONAL GEOLOGY

The Iris Gold claim group is located in the Abitibi Greenstone Belt of the Canadian Shield. This belt is composed of a sequence of metavolcanic and metasedimentary Archean age rocks that cover an area stretching about 220 miles from Timmins, Ontario, on the west to Val D'Or, Quebec, on the east.

The claims are situated within a sequence of iron rich and magnesium rich tholeiitic basalt flows known as the Kinojevis group (Figure 2). Stratigraphically, this group is about 30,000 feet thick and it occupies the core of a large east plunging synclorium.

The Iris claim group is underlain by a sequence of tholeiitic basalt flows belonging to the Kinojevis Group. This group is composed of a sequence of iron rich and magnesium rich tholeiitic basalt flows forming a stratigraphic package about 30,000 feet thick. These rocks are overlain by younger, Blake River group calc-alkalic volcanics. Both have been folded into a large, east plunging synclorium, the northern and southern limbs of which, have been cut by the major Porcupine Destor and Kirkland Lake-Larder Lake fault zones respectively. The Iris Property is situated about 5 miles south of the Destor Porcupine Fault zone near the Kinojevis-Blake River group contact.

PROPERTY HISTORY

The Iris property comprises 31 patented and/or unpatented mineral claims, (Figure 2) in Harker and Elliott Townships, Ontario, all registered in the name of John E. Perron, a principal of the The Alberta Gold Exploration Corporation.

PREVIOUS WORK

The Harker-Holloway area was the centre of mining activity during the 1920's when Harker Gold Mines Ltd. carried out a program

FIGURE 1

HARKER - ELLIOTT TOWNSHIPS

CLAIMS WORK PERFORMED ON

CLM-399

P-9739

P-9921

P-9922

L-667848

L-738902

CLAIM LOCATION MAP

FIGURE 1a)

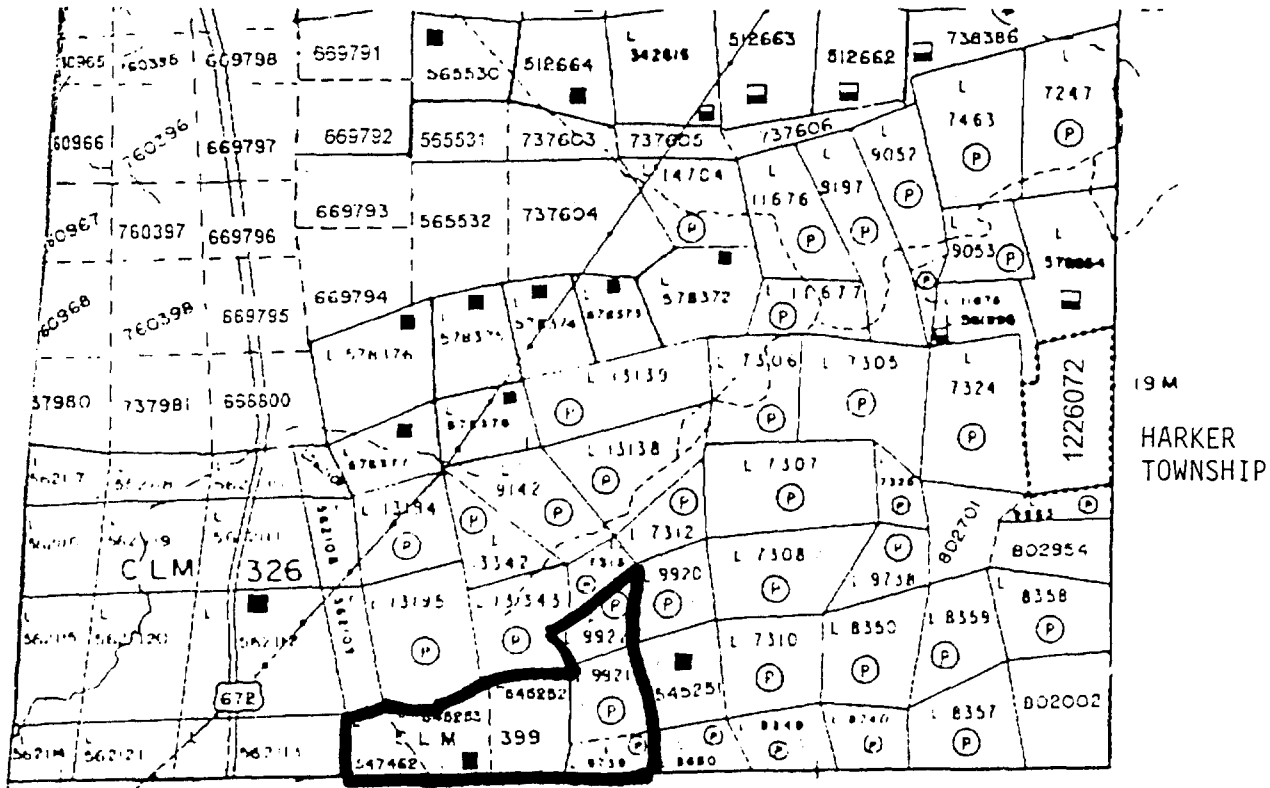

ELLIOTT TOWNSHIP

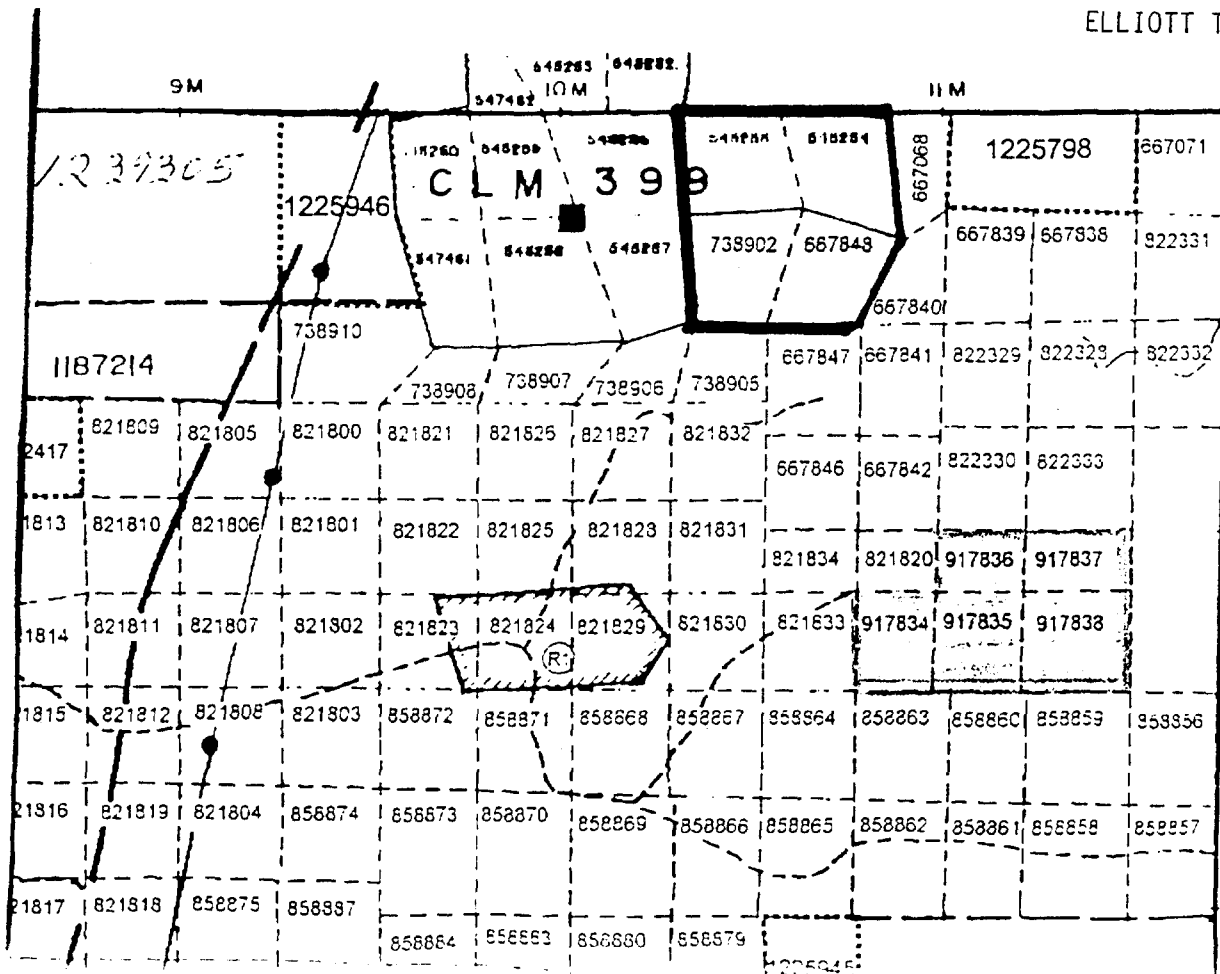

LOCATION MAP

FIGURE 1b)

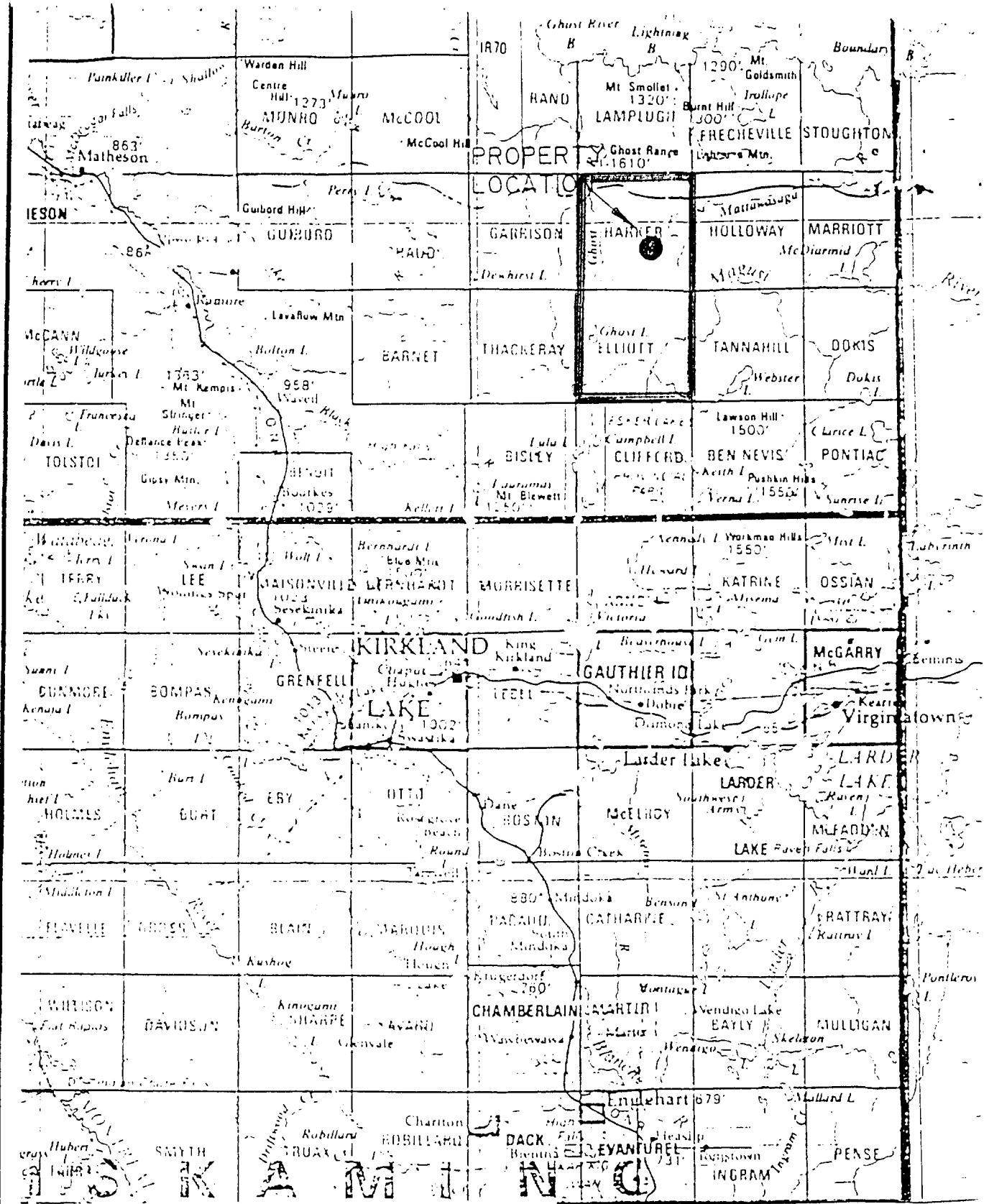

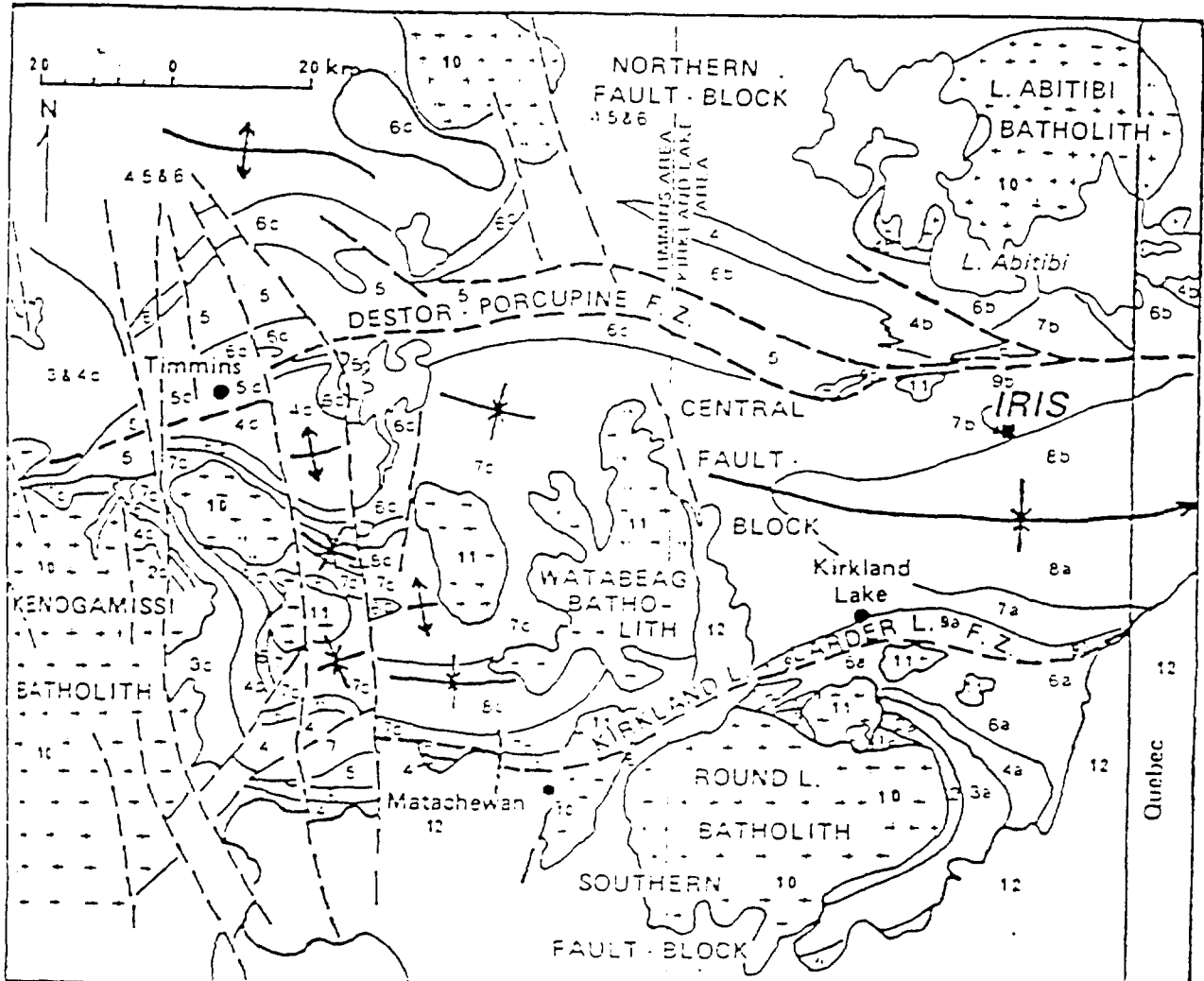

LEGEND

- Proterozoic
 - Keeweenawan diabase (not shown)
 - 12 Cobalt Group
- Archean
 - Matachewan diabase (not shown)
- Granitic rocks
 - 11 Granodiorite, monzonite, quartz monzonite, syenite
 - 10 Massive to gneissic quartz diorite, tonalite, trondhjemite
- Upper Supergroup
 - 9 9a* Timiskaming Group, 9b** Destor-Porcupine Complex
 - 8 8a, 8b, Blake River Group, 8c*** Blake River (Upper Fm., Tisdale Group)
- Lower Supergroups
 - 4 4a Skead Group, 4b Hunter Mine Group, 4c Upper Fm., Deloro Group
 - 3 3a Catherine Group, 3c Middle Fm., Deloro Group
 - 2 2a Wabewawa Group, 2c Lower Fm., Deloro Group
 - 1 1a Pacaud tuffs, ****
- 7 7a, 7b, Kinjojevis Group, 7c Kinjojevis Group, (Middle Fm., Tisdale Group)
- 6 6a Larder Lake Group, 6b Sloughton-Roduemaure Group, 6c Lower Fm., Tisdale Group
- 5 5c Porcupine Group

AFTER JENSEN AND LANGFORD (1985)

FIGURE 2

of extensive underground development on their Golden Harker property, situated immediately to the north of the Iris claim group. The Golden Harker Mine was closed in 1929.

In 1947, R. Storen examined the Iris property and reported the occurrence of gold mineralization in three separate localities, associated with «rhyolite» interflow horizons (Figure 3).

Vein 1 was exposed in two pits 900 feet apart and it consisted of sheared basalt/rhyolite mineralized with quartz-pyrite-chalcopyrite and galena. The vein was 1.9 feet wide and returned values of 0.29 ozs. per ton AU over 1.7 feet and 0.08 ozs. per ton AU over 1.9 feet.

Vein 2 is similar to vein 1 and returned values of 0.03 and 0.04 ozs. per ton AU over 8 inches and 7.5 inches respectively.

Vein 3 is located about 2,000 feet west of Vein 1 on the same «rhyolite» interflow horizon. It was exposed in two pits and it consisted of a N 70° E near vertical quartz vein containing pyrite, chalcopyrite, galena and visible gold. Assay samples taken from the east and west pits returned values of 0.11 ozs. per ton AU over 14 inches and 0.06 per ton AU over 8 inches respectively.

Storen (1947) also reported the occurrence of a wide zone of quartz mineralization in rhyolite on claim L-545251. The quartz contained disseminated pyrite with minor amounts of chalcopyrite and galena. A chip sample from this locality returned a value of 0.01 per ton AU over 5 feet.

In 1985 American Barrick Resources Ltd. announced the discovery of the Holt-McDermott deposit containing reserves of 2.8 million tons averaging 0.197 ozs. per ton AU. This announcement coupled with encouraging news from companies exploring other properties in the area helped intensify exploration efforts in the whole region. Recently, Canamax Resources Ltd. completed an underground exploration and development program on their East Zone property with a view to achieving production during 1988. Lenora Explorations Ltd., one of the Kasner Group of companies is in the midst of a substantial underground exploration program on their Gold Harker property which adjoins the Iris claim group immediately to the north. They have increased the reserves on the property and discovered new mineralized zones which are undergoing intensive evaluation.

During the period 1982 to 1987 detailed ground geophysical, geological and geochemical work plus airborne electromagnetic and magnetic surveys were completed on the Iris claim group. A number of geophysical and geochemical anomalies were defined by this work. In late 1986 and early 1987, a 5,924 foot drill program was carried out on the property by Perrex Resources Ltd. The drilling was focussed on geological targets and succeeded in defining areas of wide spread, low grade, gold mineralization within a syenite plug and narrow zones of higher grade mineralization within shear/breccia zones in basalts.

HARKER TOWNSHIP

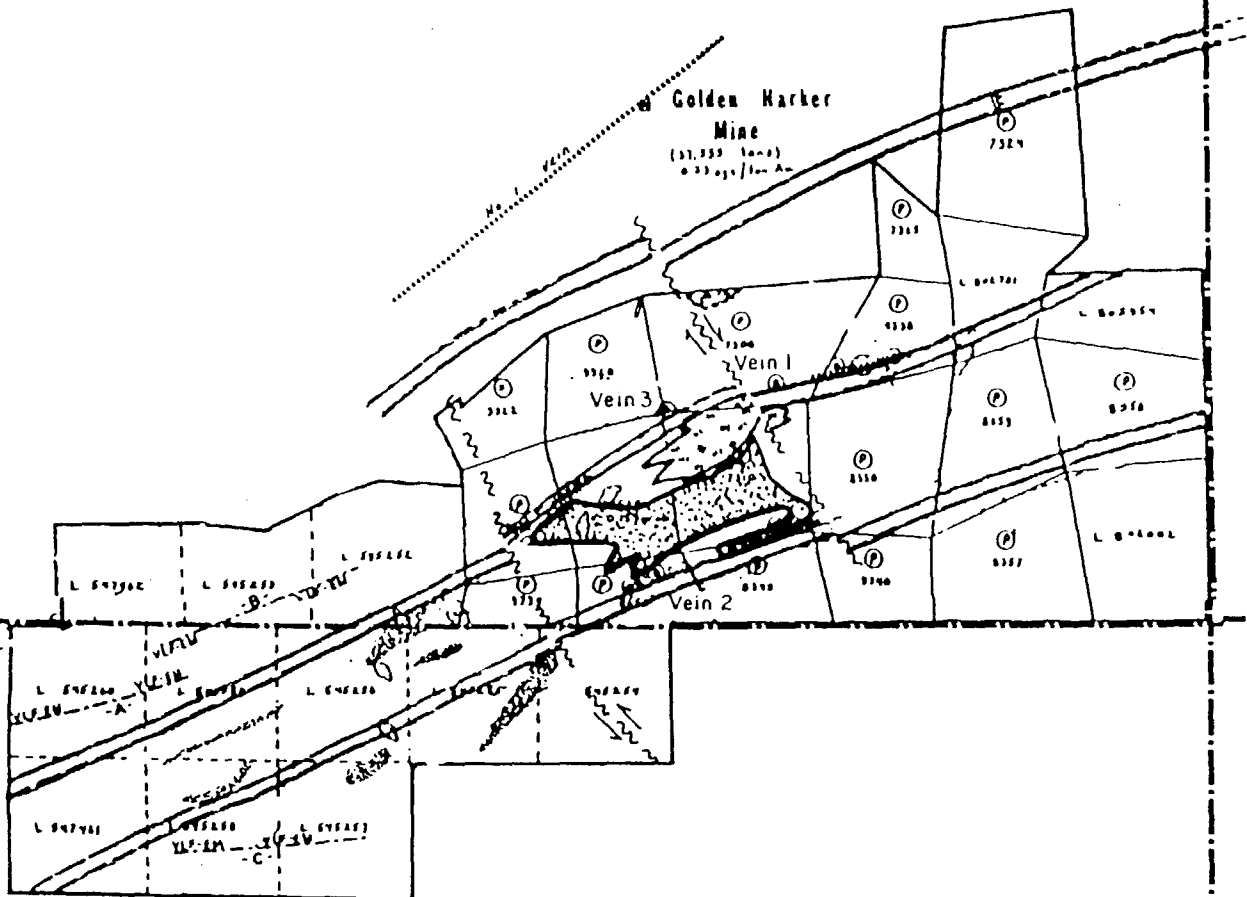

ELLIOTT TOWNSHIP

FIGURE 3

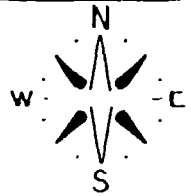

LEGEND

- Quartz vein (with associated gold) [Symbol]
- Siliceous Zone [Symbol]
- Gyanta [Symbol]
- Fault [Symbol]
- Electromagnetic anomaly [Symbol]
- Geochemical anomaly [Symbol]
- New stripping [Symbol]
- Old trenches [Symbol]
- Old pit workings on showings [Symbol]
- Pyroxenite [Symbol]

KEY MAP

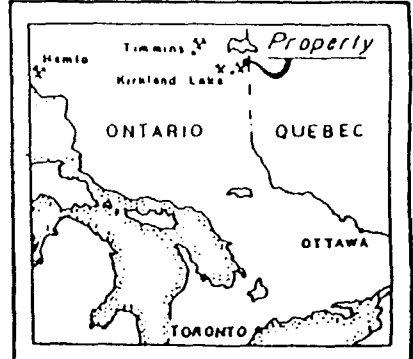

FIGURE 4

The Alberta Gold Exploration Corporation
IRIS GOLD PROPERTY MAP

HARKER GOLD AREA
LARDER LAKE MINING DIVISION
DISTRICT OF COCHRANE, ONTARIO



Scale: 1 inch to 1000 feet

PERRONS'

Kirkland Lake, Canada

Approved by: Alexander Perron

Map No. 1 | Drawn by: Mary Goss | Date: June 1985

INSTRUMENTATION

Magnetometer Survey:

This system uses a backward motion of spinning protons of a hydrogen atom within fluid of hydrogen and carbon. These spinning magnetic protons are caused to have two opposite poles by applying a magnetic fluid using a current within a coil of wire. This frequency of precision is proportional to the earth's total magnetic field.

This instrument is read directly in gammas which is the absolute value of the earth's total field for that station.

The diurnal variation was monitored by closing each loop at any secondary check station, at a grid line, baseline intersection. Diurnal corrections were applied by linear distribution of any observed variation over the time between base stations.

Electromagnetic Survey:

The VLF-EM method uses as a source, several of the main submarine communications transmitters in the 15 to 25 kHz band found throughout the world.

The submarine communication radio waves travel in a single mode parallel to the surfaces of the earth along the earth-air interface.

VLF instruments are capable of picking up any structures that change the direction of the waves by measuring the tilt angle being zero on flat ground, but when a conductor is present, the tilt angle will acquire a finite value. The direction of tilt indicates the direction of the conductor.

Calculations of such parameters as depth, depth extent, dip and width of the conductors is very minimal.

The VLF easily illustrates the location of the upper limit of dipping structures which can be seen or plotted as VLF profiles as areas of greatest change in tilt angle per unit of distance.

The instrument used for this survey was a Geonics EM-16 Unit. The sensitivity of this unit is 1% for the inphase and 1% for the quadrature. The operating frequency for the EM-16 from 15-25 kHz and the station is made by plug-in units.

Further information on the VLF and the magnetometer can be found in the back of this report on the Technical Data and Assessment forms.

PRESENTATION AND DISCUSSION OF RESULTS

i) Magnetometer Survey 2000:

The field data is presented on Map No. IR/2000/mag at

a scale of 1" = 200' found at the back of this report.

The magnetic data is illustrated as isomagnetic contours, contour intervals 100 gammas, on a Map of corrected magnetic values at each station.

The magnetic relief ranges from 61,373 gammas to 57,366 gammas (difference of 4,007 gammas). The magnetic trend is in a north east direction.

Over this small section of the east side of the property, D.D.H. Geomanagement Ltd., November 27, 1986, noted, «there are three rhyolitic horizons trending parallel to the enclosing volcanic rocks that cross the subject area». Geophysically, the felsic units are of low magnetic susceptibility when compared to the enclosing basalts. The rhyolite horizons have been mapped over the property. They vary in width from 10 feet to 300 feet. In this small section over the east side of the property, a large low magnetic band is interrupted (in the north section) by a large high magnetic anomalie. This may possibly be some structural readjustement between the flows and the interflow rhyolite horizons. D.D.H. Geomanagement states «On either side of the rhyolite, faults or shear zones have formed which from limited exposure available appear to vary in width and intensity along strike».

ii) Electromagnetic Survey:

The field data is presented on Map I/2000/vlf2. The map is drawn to scale of one inch to two hundred feet, found at the back of this report.

In this section of the east half of the grid there were two distinctive anomalies found.

C7 - Crosses PL8+00E 7+00N to PL10+00E 795N.

The area is flat, thick second growth of poplar and alder.

This contact is in the area of a large north/south fault. (See Figure 3).

C8 - Crosses PL6+00E 22+25S to PL10+00E 22+00S.

The area is very wet, drainage creeks flowing to and from the massive beaver pond system found in L-667848.

OBSERVATIONS AND CONCLUSIONS

Due to the amount of activity of ponds and creeks on the east side of the grid three tie lines were established as grid control points.

At the completion of the center east section of the new grid,

the electromagnetic survey will be Fraser Filtered to help reduce background noise.

At that time all data will be looked at to help set up what grid lines will be used for a detail Induced Polarization Survey.

Respectfully submitted,

A handwritten signature in black ink, appearing to read "Wendy K. Weller". The signature is fluid and cursive, with a long horizontal stroke at the end.

August 28, 2000

Miss Wendy K. Weller
Geotech

Assessment Data Form

Type of Work:

Prospecting: Geological:

Physical: LINE CUTTING AND CHAINING

Geophysical: ELECTROMAGNETIC (1 STATION) AND MAGNETOMETER SURVEY

Geochemical: Drilling:

Assays/Analyses: Other work:

Cost of Work: \$4,531.00

Dollars Applied: \$4,531.00

Recorded Holder:

Name: THE ALBERTA GOLD EXPLORATION CORP. ALEX PERRON/

Address: 103 GOVERNMENT ROAD EAST,
KIRKLAND LAKE, ONTARIO P2N 1A9

Survey Company:

Name: GWEN RESOURCES LTD.

Address: 103 GOVERNMENT ROAD EAST,
KIRKLAND LAKE, ONTARIO P2N 1A9

Survey/Report Information:

Start of work: JULY 26, 2000

End of work: AUGUST 25, 2000

Draughting time: AUGUST 21, 25, 2000

Report time: AUGUST 27, 28, 2000

Completion of report: AUGUST 28, 2000

Author: MISS WENDY K. WELLER

Work performed on claim(s)

CLM-399, P-9739, P-9921, P-9922, L-667848, L-738902.

Work applied to claim(s)

L-802002, L-802701, L-802954, L-803546, L-803547, L-803548, L-803549, L-917834,

L-917835, L-917836.

Persons who performed work (supervisor first):

GWEN RESOURCES LTD.

WENDY K. WELLER

J. HENNESSEY

JAMIE HENNESSEY

PAUL SIFORD AND CREW

MICHEL FECTEAU

Technical Data:

Line (mi/km): 8.78 KM
No. of samples/stations: 289

ELECTROMAGNETIC SURVEY:

Instrument: GEONICS EM-16
Coil configuration: VERTICAL AND HORIZONTAL
Method: FIXED TRANSMITTER
Vertical scale: 1 INCH = \pm 40%
Frequency: 24.8 kHz
Operational technique:

Line traversed:
Line/picket spacing: 200 FT./100 FT.
Operator: JAN HENNESSEY
Accuracy: \pm 1%
Coil separation: INFINITY
Parameters: INPHASE & QUADRATURE
Horizontal scale: 1:50000
Station: CUTLER, MAINE

MAGNETIC SURVEY:

Instrument: MCPHAR GP-8 PROTON
Base station: BLO+00
Base station time: 30 MINUTES
Contour interval: 100 GAMMAS
Contoured by: MISS WENDY K. WELLER
Operational technique: SPENCER POLE MOUNT

Operator: MISS WENDY K. WELLER
Accuracy: - GAMMA
Diurnal method: CLOSED LOOP
Location/value: BLO+00
Datum subtracted: 57,000 GAMMAS
Horizontal scale: 1:50000

INDUCED POLARIZATION SURVEY

Transmitter used:
Method:
On time:
Off time:
Power source:
Electrode array:
Readings taken:
Operational technique:

Receiver used:
Frequency:
Range:
Delay time:
Output:
Electrode spacing:
Other data:

BIBLIOGRAPHY

- Storen, R. 1947 - Preliminary Report of Iris Gold Mines Ltd., Harker Township, Larder Lake Mining Division, Province of Ontario, private engineers report.
- Satterly, J. 1952 - Geology of Harker Township; 60th Annual Report of the Ontario Department of Mines, Vol. LX, Part VIII, 1951.
- Drummond, A.D. 1987 - Report on The Winter 1986-1987 Drill Program, 31 Claim Iris Gold Group: a private report for The Alberta Gold Exploration Corporation.
- Jensen, L.S. 1986 - Mineralization and Volcanic Stratigraphy in The Western Part of the Abitibi Subprovince: Ontario Geological Survey, Misc. Paper 129.
- D. R. Hawke, 1988 - Report on the 1988 Exploration Program Iris Joint Venture Project NTS 32D/5.
- Workman, Al. 1988 - Evaluation Report.
- Weller, Miss Wendy K. 2000 - Geophysical Survey Report on The Iris Property, Magnetometer & Electro-magnetic surveys, Harker & Elliott Townships, Larder Lake Mining Division, District of Cochrane, Ontario. July 24, 2000

C E R T I F I C A T E

I, Wendy K. Weller, of Kirkland Lake, Ontario, do hereby certify:

- 1) That I am a Geotech in Training and reside at:
71 Second Street, Apartment #2, Kirkland Lake, Ontario P2N IR6.
- 2) That I graduated from the Haileybury School of Mines as a certified Diamond Driller in 1982. I have had a staking licence for the past (10) ten years.
- 3) That I was employed as a Diamond Driller for Heath & Sherwood for 1 year.
- 4) That I have been practising as a Geotech Trainee for a period of (10) ten years and I am qualified to write this report.
- 5) That I supervised and participated in this survey.

Aug 28/2000
Date

Wendy K. Weller
Geotech



32D05NW2093 2.20544 HARKER

900

Authority of subsections 65(2) and 66(3) of the Mining Act. Under section 8 of the Act, this Declaration of Assessment Work may be used to review the assessment work and correspond with the mining land holder or the Mining Recorder, Ministry of Northern Development and Mines, 6th Floor

Instructions: - For work performed on Crown Lands before recording a claim, use form 0240.
- Please type or print in ink.

2.20544

1. Recorded holder(s) (Attach a list if necessary)

Name ALBERTA GOLD EXPLORATION CORP./ALES PERRON	Client Number #200833 - #181257
Address 103 GOVERNMENT ROAD EAST, KIRKLAND LAKE, ONTARIO P2N 1A9	Telephone Number (705) 567-3001 Fax Number (705) 567-2158
Name ALBERTA GOLD EXPL.CORP./GWEN RESOURCES LTD./JOHN PERRON	Client Number #200833 - 140281 - #181279
Address 103 GOVERNMENT ROAD EAST, KIRKLAND LAKE, ONTARIO P2N 1A9	Telephone Number (705) 567-3001 Fax Number (705) 567-2158

2. Type of work performed: Check (✓) and report on only ONE of the following groups for this declaration.

Geotechnical: prospecting, surveys, assays and work under section 18 (regs) Physical: drilling, stripping, trenching and associated assays Rehabilitation

Work Type LINE CUTTING AND CHAINING MAGNETOMETER AND ELECTROMAGNETIC SURVEYS	Office Use Commodity Total \$ Value of Work Claimed 4531 NTS Reference
Dates Work Performed From 26 07 00 To 25 08 00 Day Month Year Day Month Year	Mining Division <i>harder lake</i> Resident Geologist District <i>Kirkland Lake</i>
Global Positioning System Data (if available) Township/Area HARKER/ELLIOTT/THACKERAY M or G-Plan Number	

Please remember to: - obtain a work permit from the Ministry of Natural Resources as required;
- provide proper notice to surface rights holders before starting work;
- complete and attach a Statement of Costs, form 0212;
- provide a map showing contiguous mining lands that are linked for assigning work;
- include two copies of your technical report.

3. Person or companies who prepared the technical report (Attach a list if necessary)

Name MISS WENDY K. WELLER	Telephone Number (705) 567-3001
Address 103 GOVERNMENT RD.E., KIRKLAND LAKE, ONTARIO P2N 1A9	Fax Number (705) 567-2158
Name	Telephone Number
Address	Fax Number
Name	Telephone Number
Address	Fax Number

RECEIVED
LARDER LAKE
MINING DIVISION

AUG 28 2000
11:00

RECEIVED
AUG 29 2000
GEOSCIENCE ASSESSMENT OFFICE

4. Certification by Recorded Holder or Agent

I, WENDY K. WELLER (Print Name), do hereby certify that I have personal knowledge of the facts set forth in this Declaration of Assessment Work having caused the work to be performed or witnessed the same during or after its completion and, to the best of my knowledge, the annexed report is true.

Signature of Recorded Holder or Agent <i>Wendy K. Weller</i>	Date AUGUST 28, 2000
Agent's Address 103 GOVERNMENT RD.E., KIRKLAND LAKE, ONT. P2N 1A9	Telephone Number (705) 567-3001 Fax Number (705) 567-2158

5. Work to be recorded and distributed. Work can only be assigned to claims that are contiguous (adjoining) to the mining land where work was performed, at the time work was performed. A map showing the contiguous link must accompany this form.

Mining Claim Number. Or if work was done on other eligible mining land, show in this column the location number indicated on the claim map.	Number of Claim Units. For other mining land, list hectares.	Value of work performed on this claim or other mining land.	Value of work applied to this claim.	Value of work assigned to other mining claims.	Bank. Value of work to be distributed at a future date.
eg TB 7827	16 ha	\$26,825	N/A	\$24,000	\$2,825
eg 1234567	12	0	\$24,000	0	0
eg 1234568	2	\$8,892	\$4,000	0	\$4,892
1 CLM399 G.937	10	\$2,608.00		\$2,608.00	
2 P-9739 G.278	1	\$489.00		\$489.00	
3 P-9921 G.281	1	\$413.00		\$413.00	
4 P-9922 G.282	1	\$16.00		\$16.00	
5 L-667848	1	\$693.00		\$693.00	
6 L-738902	1	\$312.00		\$312.00	
7 L-802002	1		\$400.00		
8 L-802701	1		\$400.00		
9 L-802954	1		\$400.00		
10 L-803546	1		\$400.00		
11 L-803547	1		\$400.00		
12 L-803548	1		\$400.00		
13 L-803549	1		\$400.00		
14 L-917834	1		\$798.00		
15 L-917835	1		\$798.00		
L-917836	1		\$135.00		
Column Totals		\$4,531.00	\$4,531.00	\$4,531.00	

I, WENDY K. WELLER, do hereby certify that the above work credits are eligible under subsection 7 (1) of the Assessment Work Regulation 6/96 for assignment to contiguous claims or for application to the claim where the work was done.

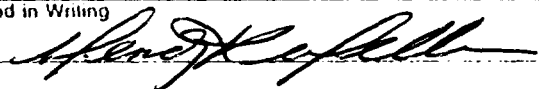
Signature of Recorded Holder or Agent Authorized in Writing  Date AUGUST 28, 2000

6. Instructions for cutting back credits that are not approved.

Some of the credits claimed in this declaration may be cut back. Please check (✓) in the boxes below to show how you wish to prioritize the deletion of credits:

- 1. Credits are to be cut back from the Bank first, followed by option 2 or 3 or 4 as indicated.
- 2. Credits are to be cut back starting with the claims listed last, working backwards; or
- 3. Credits are to be cut back equally over all claims listed in this declaration; or
- 4. Credits are to be cut back as prioritized on the attached appendix or as follows (describe):

RECEIVED
 AUG 29 2000
 ASSESSMENT OFFICE

2.20544

Note: If you have not indicated how your credits are to be deleted, credits will be cut back from the Bank first, followed by option number 2 if necessary.

For Office Use Only Received Stamp <div style="border: 1px solid black; padding: 5px; text-align: center;"> RECEIVED LARDER LAKE MINING DIVISION AUG 28 2000 <i>11:00</i> </div>	Deemed Approved Date	Date Notification Sent
	Date Approved	Total Value of Credit Approved
	Approved for Recording by Mining Recorder (Signature)	



Statement of Costs for Assessment Credit

Transaction Number (office use) 100080.0032E

Personal information collected on this form is obtained under the authority of subsection 6(1) of the Assessment Work Regulation 6/96. Under section 8 of the Mining Act, the information is a public record. This information will be used to review the assessment work and correspond with the mining land holder. Questions about this collection should be directed to the Chief Mining Recorder, Ministry of Northern Development and Mines, 6th Floor, 933 Ramsey Lake Road, Sudbury, Ontario, P3E 6B5.

2.20544

Table with 4 columns: Work Type, Units of Work, Cost Per Unit of work, Total Cost. Rows include LINE CUTTING & CHAINING, MAGNETOMETER SURVEY, ELECTROMAGNETIC SURVEY, Associated Costs, Transportation Costs, and Food and Lodging Costs. Total Value of Assessment Work: \$ 4,531.00

RECEIVED LATERALINE MINING DIVISION

Calculations of Filing Discounts:

AUG 28 2000

11:00

- 1. Work filed within two years of performance is claimed at 100% of the above Total Value of Assessment Work.
2. If work is filed after two years and up to five years after performance, it can only be claimed at 50% of the Total Value of Assessment Work.

TOTAL VALUE OF ASSESSMENT WORK x 0.50 = Total \$ value of worked claimed

Note:

- Work older than 5 years is not eligible for credit.
- A recorded holder may be required to verify expenditures claimed in this statement of costs within 45 days of a request for verification and/or correction/clarification.

RECEIVED AUG 29 2000 GEOSCIENCE ASSESSMENT OFFICE

Certification verifying costs:

WENDY K. WELLER

I, WENDY K. WELLER, do hereby certify, that the amounts shown are as accurate as may reasonably be determined and the costs were incurred while conducting assessment work on the lands indicated on the accompanying Declaration of Work form as ABEST I am authorized to make this certification.

Signature [Handwritten Signature]

Date AUGUST 28, 2000

Geoscience Assessment Office
933 Ramsey Lake Road
6th Floor
Sudbury, Ontario
P3E 6B5

Telephone: (888) 415-9845
Fax: (877) 670-1555

October 2, 2000

Wendy K. Weller
THE ALBERTA GOLD EXPLORATION CORPORATION
103 GOVERNMENT ROAD EAST
KIRKLAND LAKE, Ontario
P2N-1A9

Visit our website at:
www.gov.on.ca/MNDM/MINES/LANDS/mlsmnpge.htm

Dear Sir or Madam:

Submission Number: 2.20544

Status

Subject: Transaction Number(s): W0080.00325 Approval

We have reviewed your Assessment Work submission with the above noted Transaction Number(s). The attached summary page(s) indicate the results of the review. WE RECOMMEND YOU READ THIS SUMMARY FOR THE DETAILS PERTAINING TO YOUR ASSESSMENT WORK.

If the status for a transaction is a 45 Day Notice, the summary will outline the reasons for the notice, and any steps you can take to remedy deficiencies. The 90-day deemed approval provision, subsection 6(7) of the Assessment Work Regulation, will no longer be in effect for assessment work which has received a 45 Day Notice. Allowable changes to your credit distribution can be made by contacting the Geoscience Assessment Office within this 45 Day period, otherwise assessment credit will be cut back and distributed as outlined in Section #6 of the Declaration of Assessment work form.

Please note any revisions must be submitted in DUPLICATE to the Geoscience Assessment Office, by the response date on the summary.

If you have any questions regarding this correspondence, please contact LUCILLE JEROME by e-mail at lucille.jerome@ndm.gov.on.ca or by telephone at (705) 670-5858.

Yours sincerely,

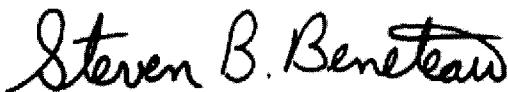

ORIGINAL SIGNED BY
Steve B. Beneteau
Acting Supervisor, Geoscience Assessment Office
Mining Lands Section

Work Report Assessment Results

Submission Number: 2.20544

Date Correspondence Sent: October 02, 2000

Assessor: LUCILLE JEROME

Transaction Number	First Claim Number	Township(s) / Area(s)	Status	Approval Date
W0080.00325	8000937	HARKER, ELLIOTT	Approval	October 02, 2000

Section:

14 Geophysical MAG

14 Geophysical VLF

Correspondence to:

Resident Geologist
Kirkland Lake, ON

Assessment Files Library
Sudbury, ON

Recorded Holder(s) and/or Agent(s):

Wendy K. Weller
THE ALBERTA GOLD EXPLORATION CORPORATION
KIRKLAND LAKE, Ontario

GWEN RESOURCES LTD.
KIRKLAND LAKE, Ontario

JOHN EDWARD PERRON
KELOWNA, B.C.

LAMPLUGH TWP M-358

NOTICE OF FORESTRY ACTIVITY
 THIS TOWNSHIP/AREA FALLS WITHIN THE
 ABILITY MANAGEMENT UNIT
 AND MAY BE SUBJECT TO FORESTRY OPERATIONS.
 THE M.N.R. UNIT FORESTER FOR THIS AREA CAN BE
 CONTACTED AT: P.O. BOX 129 SWASTIKA ONT. POK-1T0
 705-642-3222

THE TOWNSHIP
 OF
HARKER
 DISTRICT OF
 COCHRANE
 LARDER LAKE
 MINING DIVISION

SCALE: 1-INCH 40 CHAINS

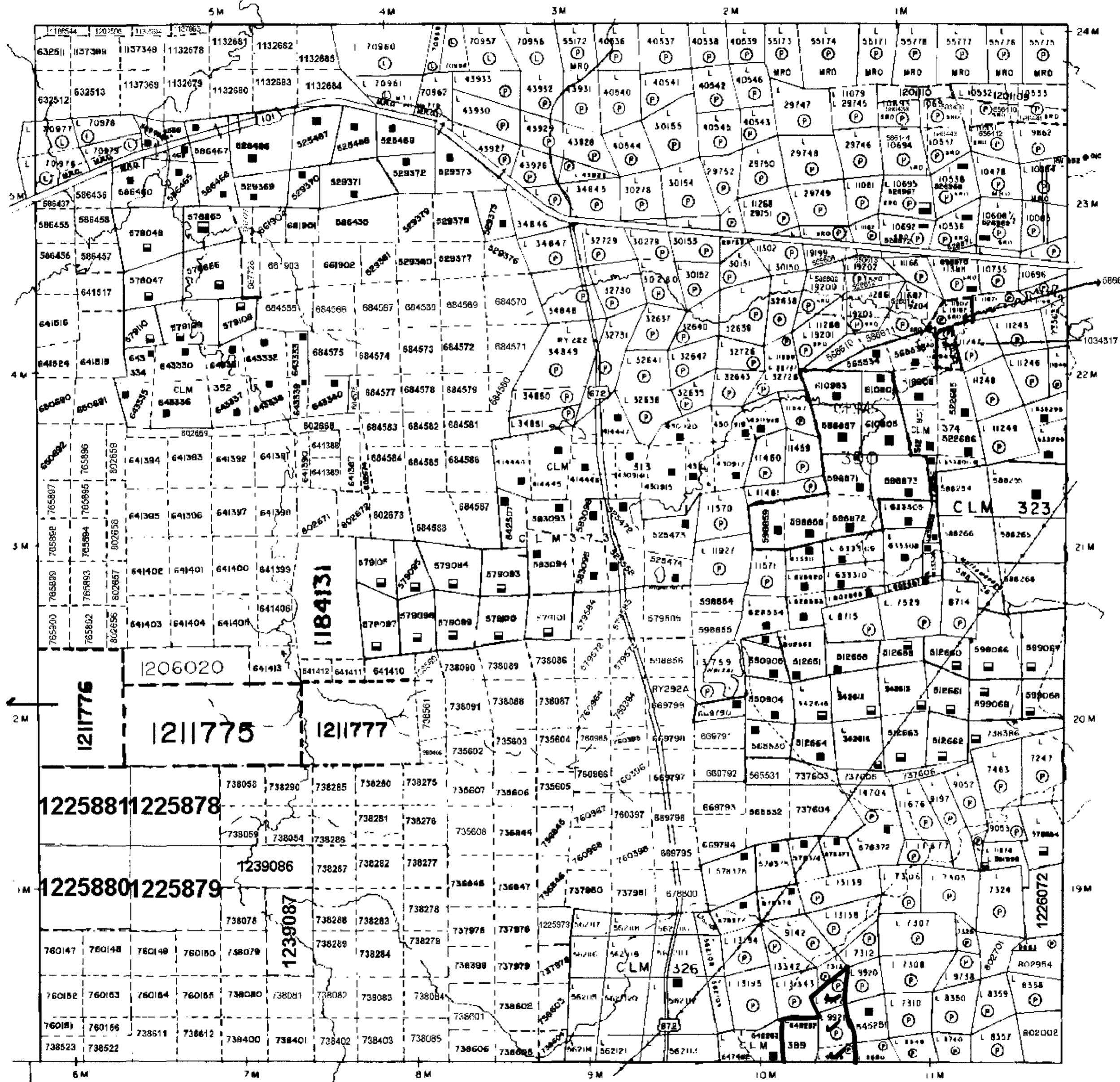

LEGEND

- PATENTED LAND
- CROWN LAND SALE
- LEASES
- LOCATED LAND
- LICENSE OF OCCUPATION
- MINING RIGHTS ONLY
- SURFACE RIGHTS ONLY
- ROADS
- IMPROVED ROADS
- KING'S HIGHWAYS
- RAILWAYS
- POWER LINES
- MARSH OR MUSKEG
- MINES
- CANCELLED
- PATENTED S.R.O.
- LEASE - MINING RIGHTS ONLY
- ORDER - IN - COUNCIL

NOTES

400' Surface Rights reservation along the shores of all lakes and rivers

AREAS WITHDRAWN FROM DISPOSITION

- M.R.O. - MINING RIGHTS ONLY
- S.R.O. - SURFACE RIGHTS ONLY
- M.S. - MINING AND SURFACE RIGHTS

Description	Order No.	Date	Disposition	File
L.U.P.			LAND USE PERMIT NO. 11730, PENDING APPLICATION UNDER PUBLIC LANDS ACT	



Ministry of Natural Resources
 Ministry of Northern Development and Mines

Date: _____
 Name: _____
G-3643

ELLIOTT TWP M-347

ARCHIVED APRIL 3, 1995



32D05NW2093 2.20544 HARKER

REFERENCES

AREAS WITHDRAWN FROM DISPOSITION

- M.R.O. - MINING RIGHTS ONLY
- S.R.O. - SURFACE RIGHTS ONLY
- M.+S. - MINING AND SURFACE RIGHTS

Occupation Order No. Date Disposition File

(1) MNR GRANT, DT. No. 34

HARKER TOWNSHIP

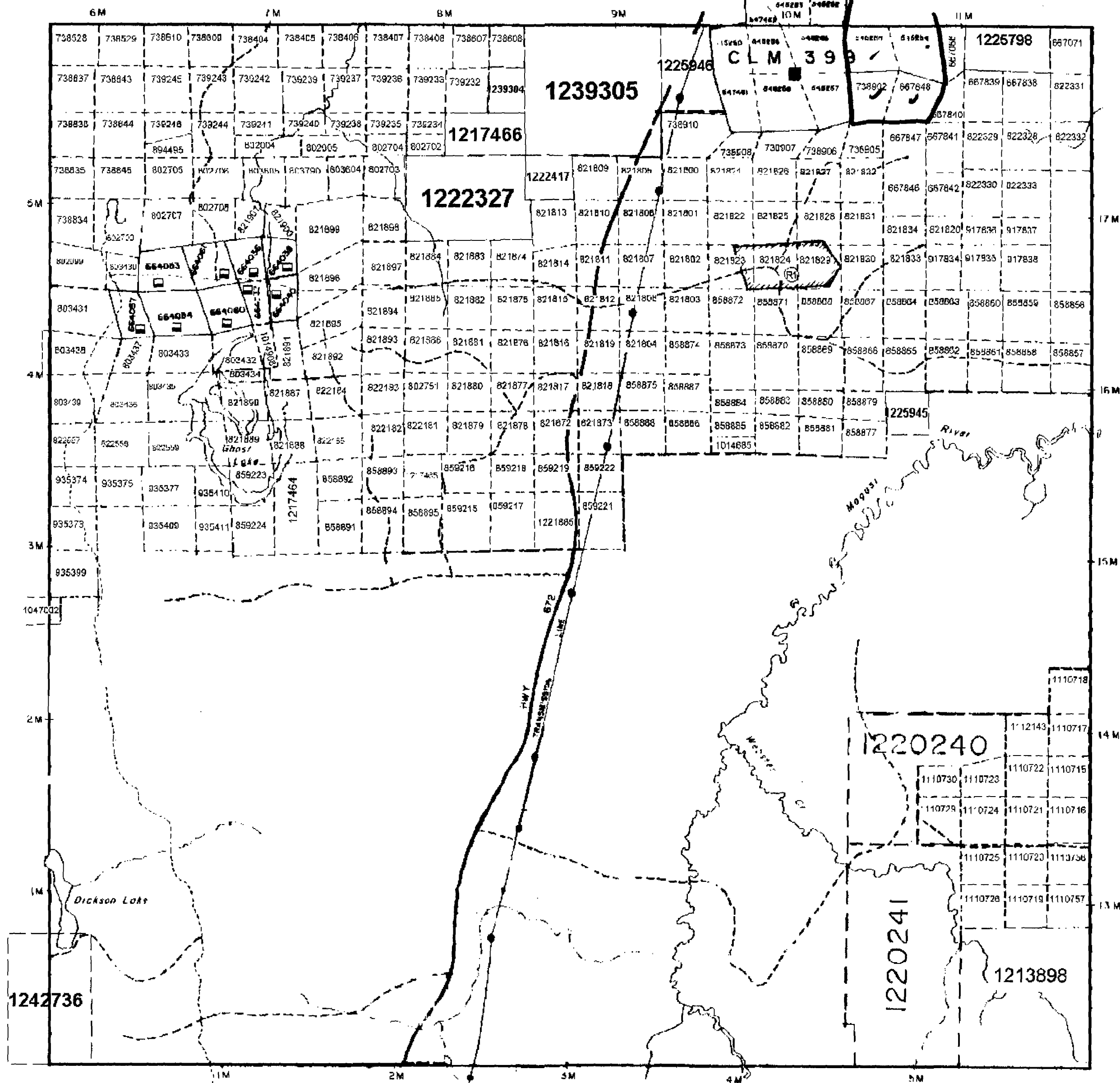

LEGEND

- HIGHWAY AND ROUTE No.
- OTHER ROADS
- TRAILS
- SURVEYED LINES
- TOWNSHIPS, BASE LINES, ETC.
- LOTS, MINING CLAIMS, PARCELS, ETC.
- UNSURVEYED LINES
- LOT LINES
- PARCEL BOUNDARY
- MINING CLAIMS ETC.
- RAILWAY AND RIGHT OF WAY
- UTILITY LINES
- NON-PERENNIAL STREAM
- FLOODING OR FLOODING RIGHTS
- SUBDIVISION OR COMPOSITE PLAN RESERVATIONS
- ORIGINAL SHORELINE
- MARSH OR MUSKEG
- MINES
- TRAVERSE MONUMENT

DISPOSITION OF CROWN LANDS

TYPE OF DOCUMENT	SYMBOL
PATENT SURFACE & MINING RIGHTS	
" SURFACE RIGHTS ONLY	
" MINING RIGHTS ONLY	
LEASE SURFACE & MINING RIGHTS	
" SURFACE RIGHTS ONLY	
" MINING RIGHTS ONLY	
LICENCE OF OCCUPATION	
DROPPED IN COUNCIL	
RESERVATION	
CANCELLED	
SAND & GRAVEL	

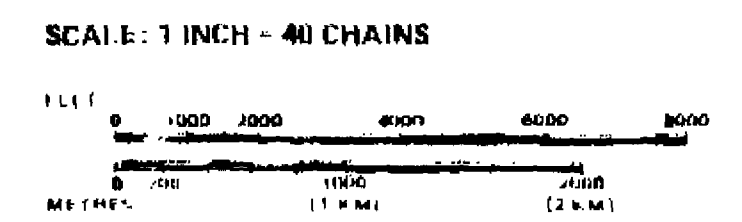

TOWNSHIP
ELLIOTT
M.N.R. ADMINISTRATIVE DISTRICT
KIRKLAND LAKE
MINING DIVISION
LARDER LAKE
LAND TITLES / REGISTRY DIVISION
COCHRANE

Ministry of Natural Resources
Ministry of Northern Development and Mines

Date: MAY 1984
Number: **G-3633**

THE INFORMATION THAT APPEARS ON THIS MAP HAS BEEN COMPILED FROM VARIOUS SOURCES, AND ACCURACY IS NOT GUARANTEED. THOSE WISHING TO STAKE MINING CLAIMS SHOULD CONSULT WITH THE MINING RECORDS, MINISTRY OF NORTHERN DEVELOPMENT AND MINES, FOR ADDITIONAL INFORMATION ON THE STATUS OF THE LANDS SHOWN HEREON.

NOTICE FORESTRY ACTIVITY
THIS TOWNSHIP FALLS WITHIN THE APPLIED MANAGEMENT UNIT AND MAY BE SUBJECT TO FORESTRY OPERATIONS. THE INFORMATION FOR THIS AREA CAN BE CONTACTED AT:
P.O. BOX 129
SWASTIKA, ONTARIO
POB 110
707 642-3222

CLIFFORD TOWNSHIP

COPY OF THIS MYLAR ARCHIVED APRIL 23, 1997
ARCHIVED MAY 02, 1994
ARCHIVED APRIL 05, 1997



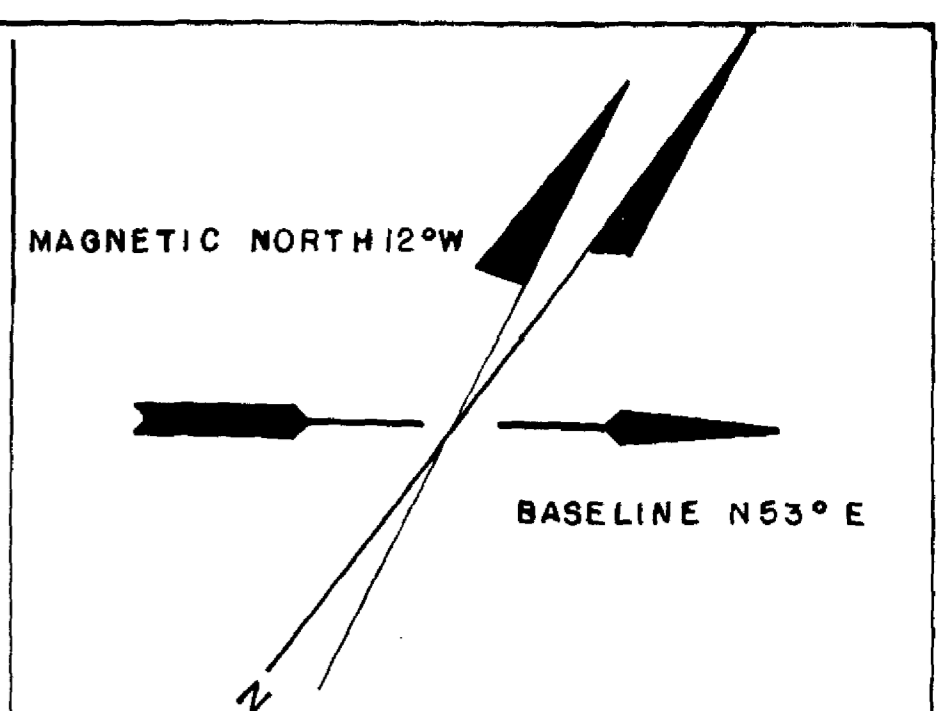
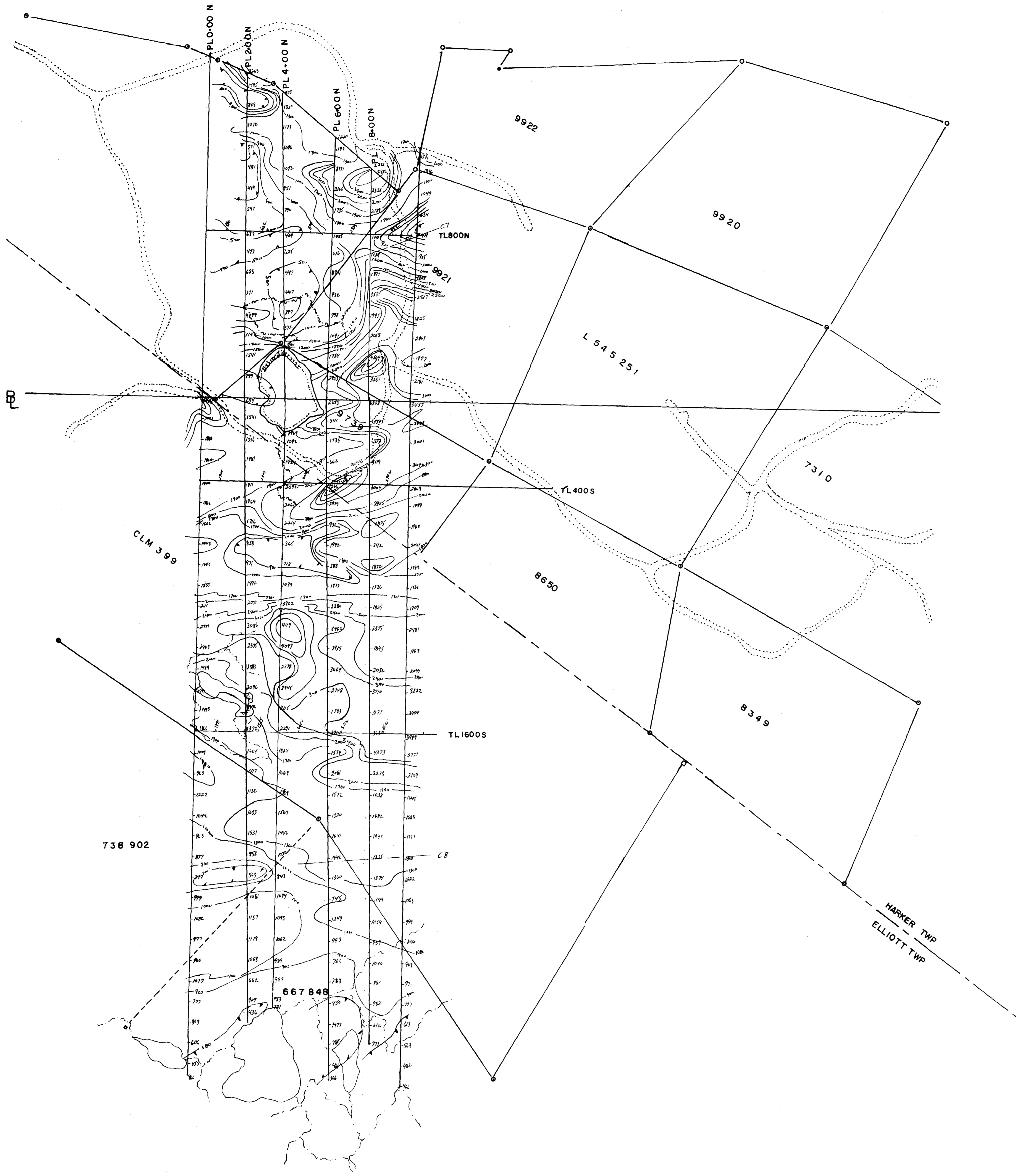

SYMBOLS

- SURVEY PIN LOCATED ◊
- ASSUMED PIN ○
- SURVEY LINE CUT ———
- TWP LINE - - - - -
- CLAIM LINE - - - - -
- CLAIM POST • TIE-ON †
- GRID CONTROL POINTS ▲
- ROAD ———
- TRAIL - - - - -
- POND ◊
- CREEK ~~~~~

INSTRUMENTATION

INSTRUMENT USED McPHAR GP 8
 DATUM SUBTRACTED 57000 #
 CONTACT V L F _____ CI
 CONTOURS INTERVALS 100 #

INPHASE	POSITIVE	
	QUADRATURE	
		NEGATIVE

GROUND MAGNETOMETER SURVEY

REPORT BY W K WELLER
 CONTOURED BY W K WELLER

KEY MAP

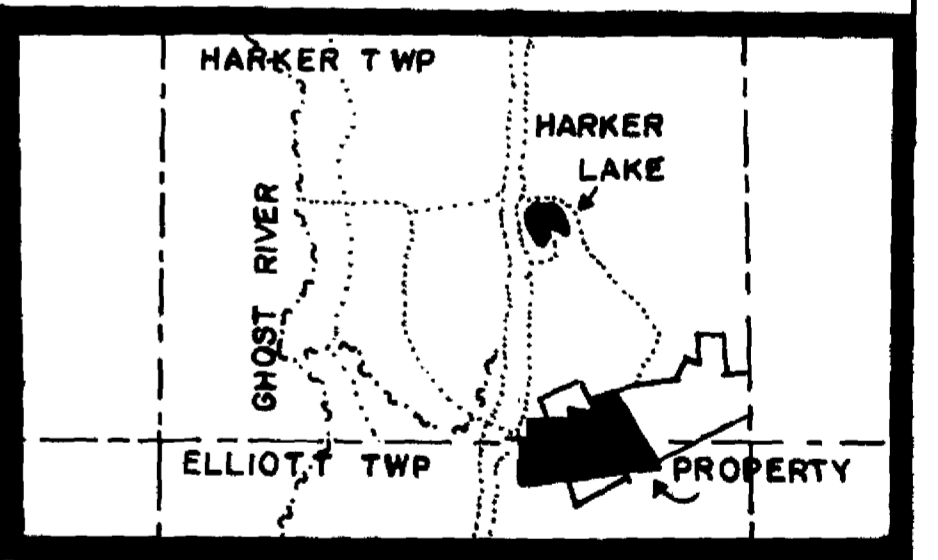

GWEN RES
 IRIS 2000 PROJECT
 NEW NORTH - SOUTH GRID

 CENTRAL SHEET

 HARKER - ELLIOTT TOWNSHIPS
 LARDER LAKE MINING DIVISION
 DISTRICT OF COCHRANE ONT.
 SCALE = 1" TO 200'

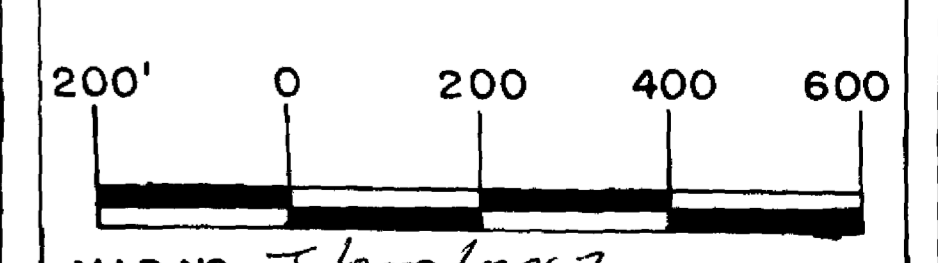

MAP NO J/2000/1006-2
 DATE Aug 28/2000
 DRAFTED BY JR HAMILTON HENNESSEY

[Signature]

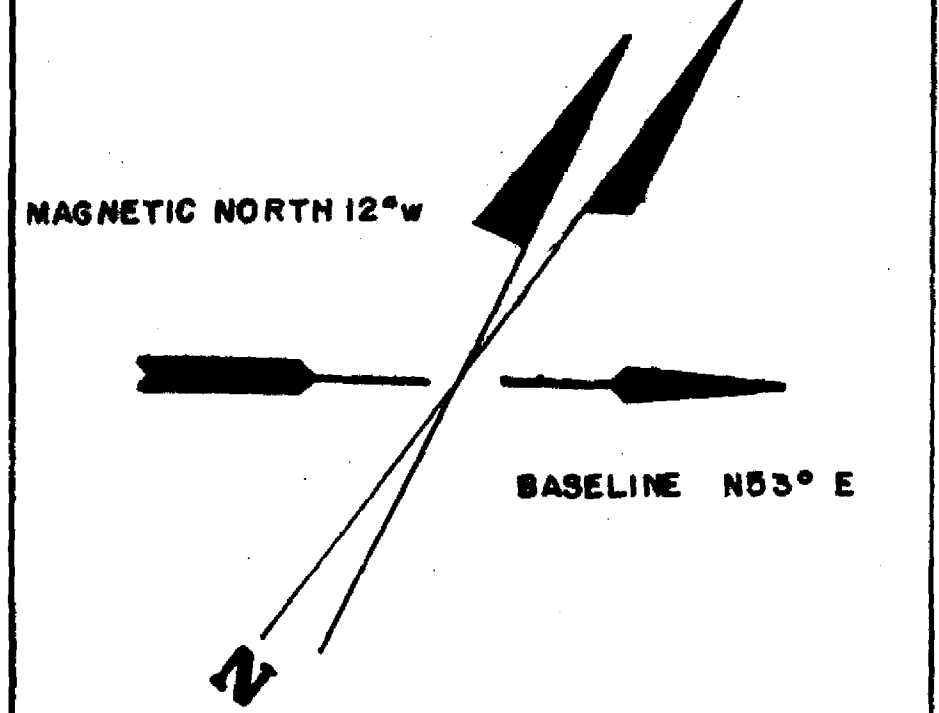
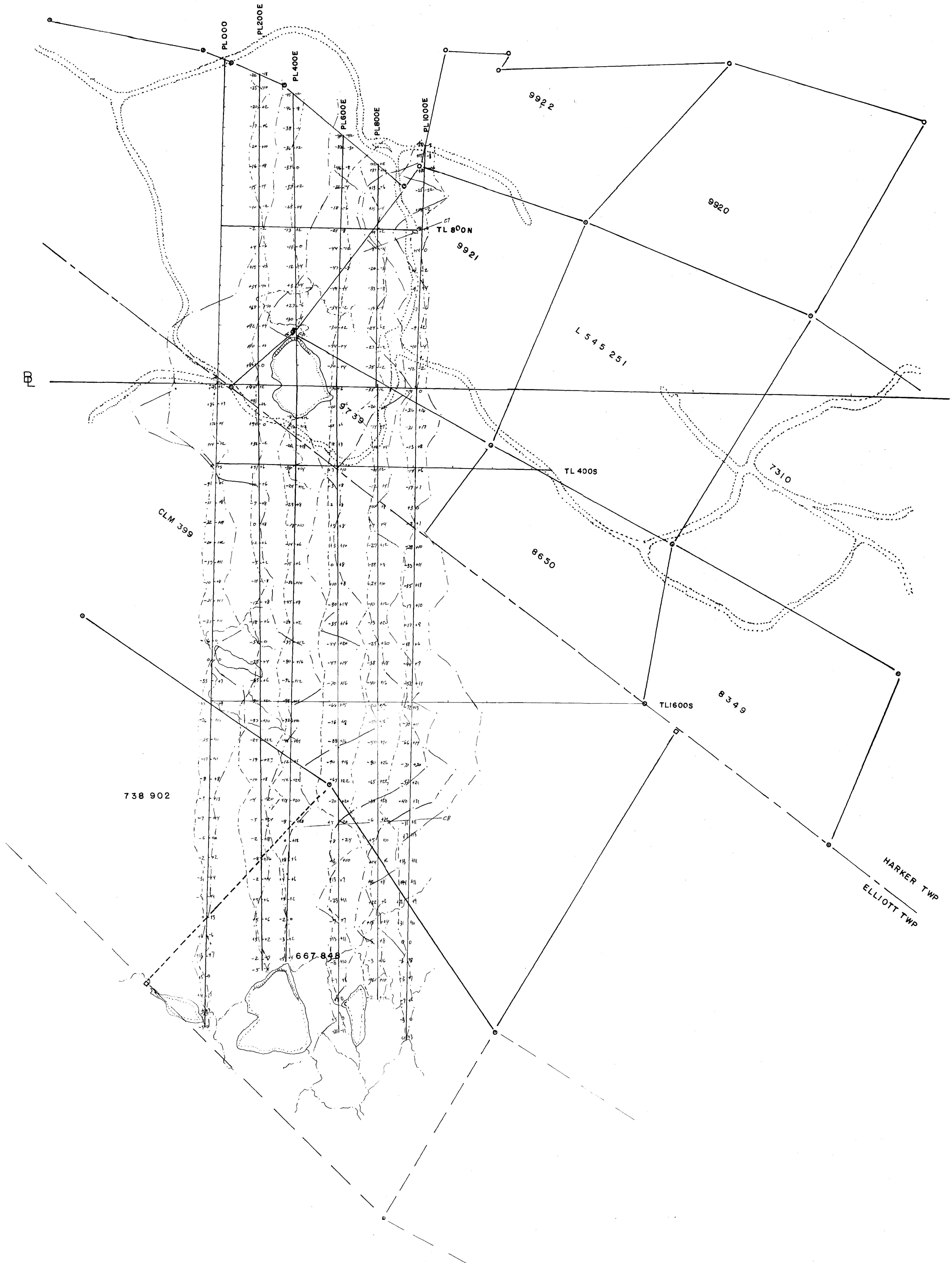

- SYMBOLS**
- SURVEY PIN LOCATED ◊
 - ASSUMED PIN ○
 - SURVEY LINE CUT ———
 - TWP LINE - - - - -
 - CLAIM LINE - · - · - ·
 - CLAIM POST ■ TIE-ON ▣
 - GRID CONTROL POINTS △
 - ROAD ——— TRAIL - · - · - ·
 - POND ○ CREEK ———

INSTRUMENTATION

INSTRUMENT USED GEONICS EM 16
 STATION USED CUTLER, MAINE, USA
 VERTICAL SCALE 40%
 CONTOURS INTERVALS 100 ft

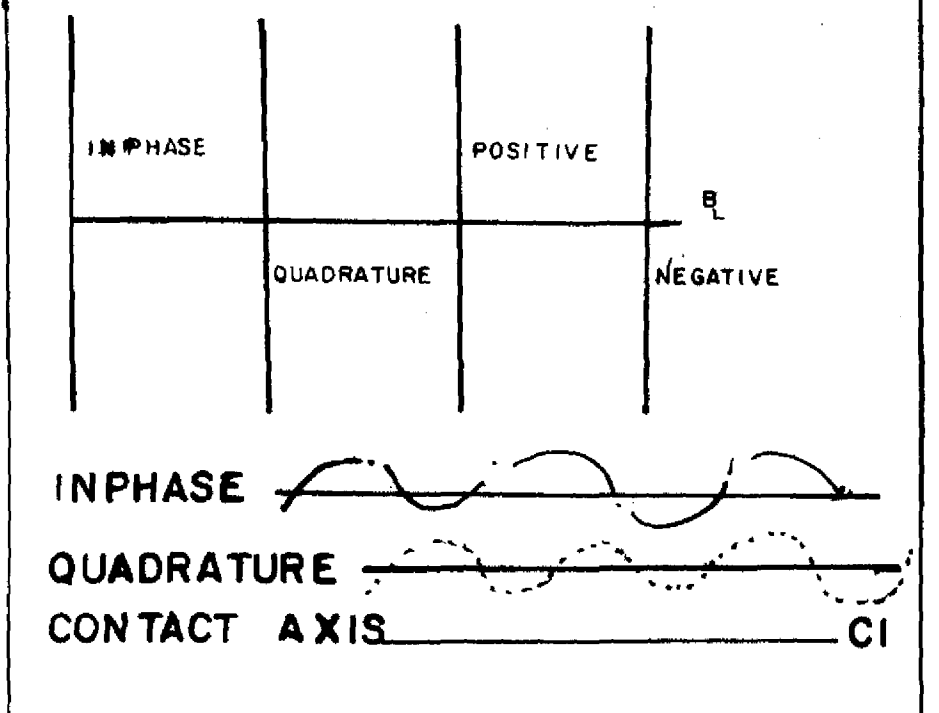

GROUND VLF - EM SURVEY

REPORT BY W K WELLER
 CONTOURED BY W K WELLER

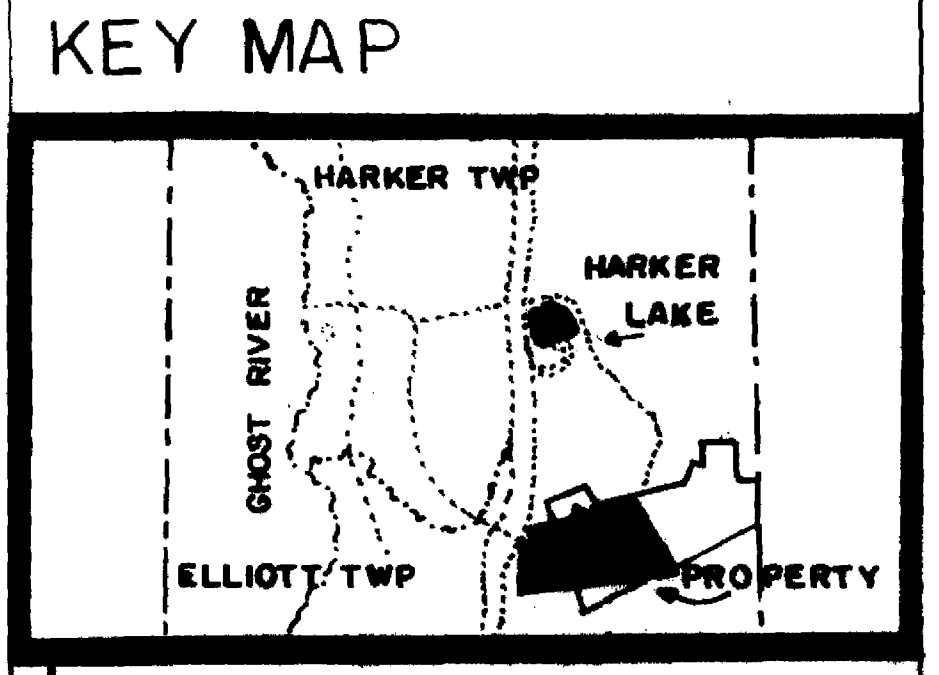

GWEN RES
 IRIS 2000 PROJECT
 NEW NORTH - SOUTH GRID
 CENTRAL SHEET

HARKER-ELLIOTT TOWNSHIPS
 LARDER LAKE MINING DIVISION
 DISTRICT OF COCHRANE ONT.

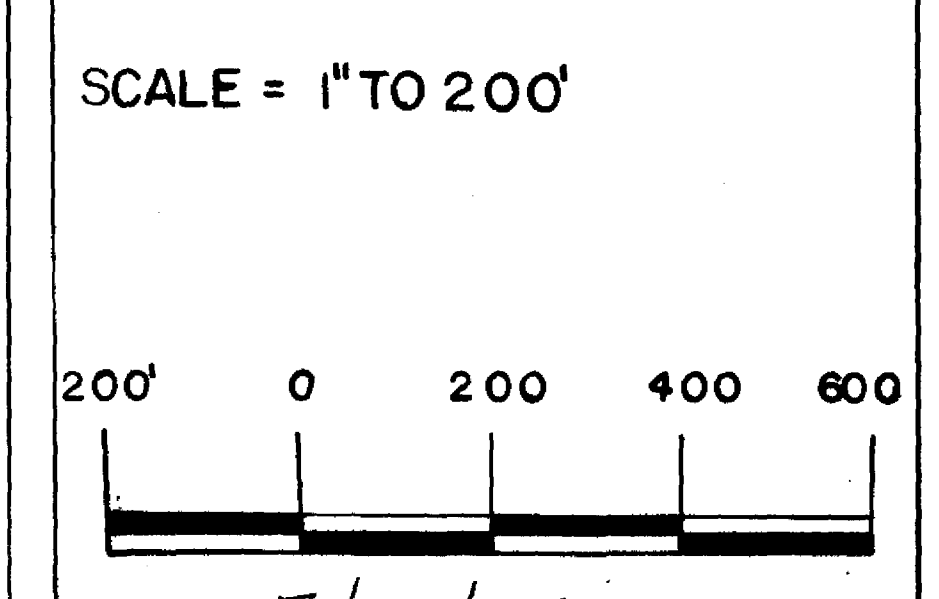

MAP NO I/2000/VLF2
 DATED Aug 28/2000
 DRAFTED BY JR HAMILTON-HENNESSEY

[Signature]
 2.20544