



32D05NW2094 2.20624

HARKER

010

GEOPHYSICAL SURVEY REPORT
ON THE
IRIS PROPERTY - PHASE II

MAGNETOMETER & ELECTROMAGNETIC SURVEYS

HARKER & ELLIOTT TOWNSHIPS
LARDER LAKE MINING DIVISION
DISTRICT OF COCHRANE, ONTARIO

FOR

2.20624

ALEXANDER H. PERRON

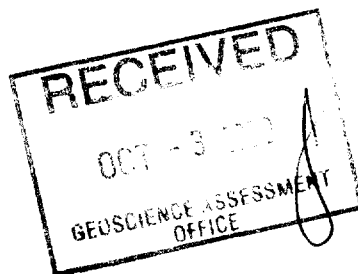

SEPTEMBER 30, 2000

WENDY K. WELLER
GEOTECH



TABLE OF CONTENTS

SUMMARY i)

INTRODUCTION 1

LOCATION AND ACCESS. 1, 2

REGIONAL GEOLOGY 2

PROPERTY HISTORY 2

PREVIOUS WORK 2, 3

INSTRUMENTATION. 4

PRESENTATION AND DISCUSSION OF RESULTS 4, 5, 6

OBSERVATIONS AND RECOMMENDATIONS 6

ASSESSMENT DATA FORM 7

TECHNICAL DATA 8

BIBLIOGRAPHY 9

CERTIFICATE. 10

FIGURES, TABLES AND MAPS

CLAIMS WORK PERFORMED ON (FIGURE 1) 2 a)

CLAIM LOCATION MAP (FIGURE 1a) 2 b)

LOCATION MAP (FIGURE 1b) 2 c)

KINOJEVIS GROUP - LEGEND - (FIGURE 2). 2 d)

IRIS GOLD PROPERTY MAP - FIGURE 3) 3 a)

GROUND VLF-EM SURVEY MAP NO. I/2000/vlf3 IN BACK POCKET

GROUND MAGNETOMETER SURVEY MAP NO. I/2000/mag3 IN BACK POCKET

SUMMARY

i)

This report is a geophysical survey as required by The Ministry of Northern Development and Mines for assessment work purposes, following the recommendation set for in the Mining Act Regulations 1991.

The report includes an introduction to the property, general geology, field results and conclusions based on the field study.

Technical Data is provided on the Assessment Data form found at the back of this report.

Field Data is compiled on the accompanying plan maps found at the back of this report, Maps No. I/2000/mag3 and No. I/2000/vlf3.

In 1999, Mr. Ben Berger from O.G.S. re-mapped and sampled the Iris Property. In his findings, from the sampling, a percentage of the ground showed certain minerals that have never been looked for. (e.g. Platinum and Poladium SP).

On June 5, 2000, Gwen Resources started to cut a new North/South grid over the entire Iris Property, including Iris-10 (unpatented mining claims).

GEOPHYSICAL SURVEY REPORT
ON THE

IRIS PROPERTY - PHASE II

MAGNETOMETER & ELECTROMAGNETIC SURVEYS
HARKER & ELLIOTT TOWNSHIPS
LARDER LAKE MINING DIVISION
DISTRICT OF COCHRANE, ONTARIO

INTRODUCTION

On June 5, 2000, a new North/South grid was started on the West Section of the Iris Property.

The baseline was turned off thirty five feet west of the #3 post and pin of patent claim 9739 along the south (East/West) township line of Harker Township and Elliott Township, and twenty feet south of the township line in Elliott Township.

The east baseline was cut and two men chained for a distance of 37+00E feet. All picket lines were turned off at 325° north off the baseline (53° East).

Due to many large areas of flooded beaver ponds and creeks, three tie lines were established for grid control points. (TL8+00N, TL4+00S and TL16+00S).

All grid control points were two man chained by Gwen Resources Ltd.

All linecutting, chaining was performed by M. Fecteau and crew.

The magnetometer survey and electromagnetic surveys were done by Miss Wendy K. Weller and Mrs. Jan Hennessey.

All drafting was done by Mrs. J. R. Hennessey. Report writing and contouring was done by Miss Wendy K. Weller.

Ownership of the aforementioned leased and unpatented mining claims has been attested to by The Alberta Gold Exploration Corporation and Alexander H. Perron, and was not independently ascertained by the writer.

LOCATION AND ACCESS

The Iris Group is comprised of 16 patented claims, 2 leases and 12 unpatented mining claims, located in the South East corner of

Harker Township and the north/east corner of Elliott Township, Larder Lake Mining Division, Ontario. (Figure 1 - List of Claims).

The property is situated approximately 75 miles east of Timmins, Ontario, and approximately 25 miles north/northeast of Kirkland Lake, Ontario.

Access to the property is provided by Highway 672 that runs approximately 400 meters west of the West side of the Iris Property north/south survey line of CLM399. Throughout the property there are existing four wheeler trails to access the new grid. (See Figures 1a) and 1b).

REGIONAL GEOLOGY

The Iris Gold claim group is located in the Abitibi Greenstone Belt of the Canadian Shield. This belt is composed of a sequence of metavolcanic and metasedimentary Archean age rocks that cover an area stretching about 220 miles from Timmins, Ontario, on the west to Val D'Or, Quebec, on the east.

The claims are situated within a sequence of iron rich and magnesium rich tholeiitic basalt flows known as the Kinojevis group (Figure 2). Stratigraphically, this group is about 30,000 feet thick and it occupies the core of a large east plunging synclinorium.

The Iris claim group is underlain by a sequence of tholeiitic basalt flows belonging to the Kinojevis Group. This group is composed of a sequence of iron rich and magnesium rich tholeiitic basalt flows forming a stratigraphic package about 30,000 feet thick. These rocks are overlain by younger, Blake River group calc-alkalic volcanics. Both have been folded into a large, east plunging synclinorium, the northern and southern limbs of which, have been cut by the major Porcupine Destor and Kirkland Lake-Larder Lake fault zones respectively. The Iris Property is situated about 5 miles south of the Destor Porcupine Fault zone near the Kinojevis-Blake River group contact.

PROPERTY HISTORY

The Iris property comprises 31 patented and/or unpatented mineral claims, (Figure 2) in Harker and Elliott Townships, Ontario, all registered in the name of John E. Perron, a principal of the The Alberta Gold Exploration Corporation.

PREVIOUS WORK

The Harker-Holloway area was the centre of mining activity during the 1920's when Harker Gold Mines Ltd. carried out a program

FIGURE 1

HARKER AND ELLIOTT TOWNSHIPS

CLAIMS WORK PERFORMED ON

CLM 399

P-7310

P-8349

P-8650

P-9920

P-9922

L-545251

L-667068

L-667839

L-667840

L-667848

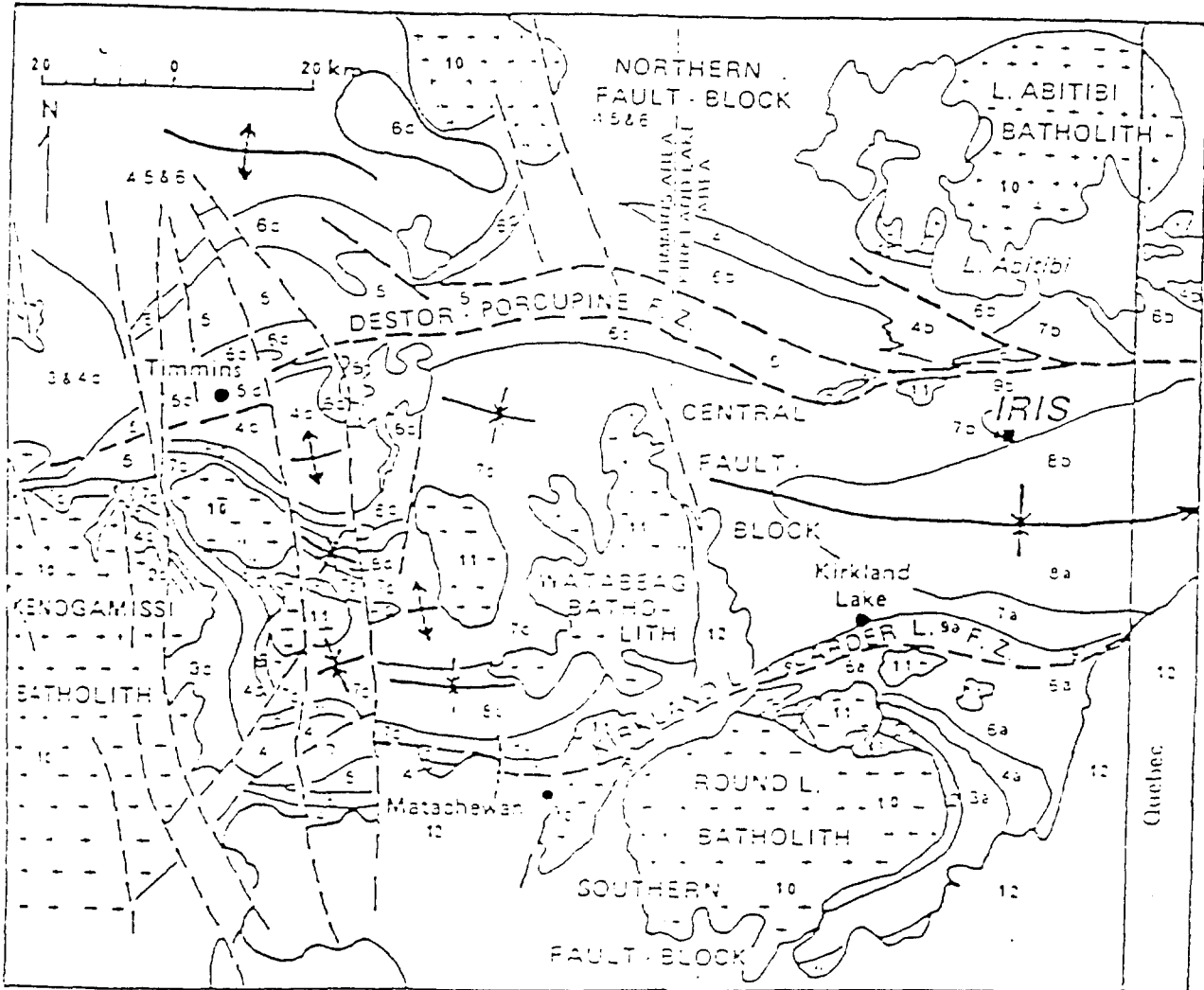

LEGEND

- | | |
|---|---|
| <p>Proterozoic</p> <p>12 Matatchewan diabase (not shown)</p> <p>12 Cobalt Group</p> <p>Archean</p> <p>Matatchewan diabase (not shown)</p> <p>Granitic rocks</p> <p>11 Granodiorite, monzonite, quartz monzonite, syenite</p> <p>10 Massive to gneissic quartz diorite, tonalite, trondhjemite</p> <p>Upper Supergroup</p> <p>9 9a Timiskaming Group, 9b** Destor - Porcupine Complex</p> <p>8 8a, 8b, Blake River Group, 8c*** Blake River (Upper Fm., Tisdale Group)</p> | <p>7 7a, 7b Kirkland Group, 7c Kirkland Group (Middle Fm., Tisdale Group)</p> <p>6 6a Larder Lake Group, 6b Sloughton, Piquemaure Group, 6c Lower Fm., Tisdale Group</p> <p>5 5a Porcupine Group</p> <p>Lower Supergroups</p> <p>4 4a Sleds Group, 4b Hunter Mine Group, 4c Upper Fm., Delora Group</p> <p>3 3a Catherine Group, 3c Middle Fm., Delora Group</p> <p>2 2a Wabewawa Group, 2b Lower Fm., Delora Group</p> <p>1 1a Pasqua tuff, ****</p> |
|---|---|

AFTER JENSEN AND LANGFORD (1985)

FIGURE 2

of extensive underground development on their Golden Harker property, situated immediately to the north of the Iris claim group. The Golden Harker Mine was closed in 1929.

In 1947, R. Storen examined the Iris property and reported the occurrence of gold mineralization in three separate localities, associated with «rhyolite» interflow horizons (Figure 3).

Vein 1 was exposed in two pits 900 feet apart and it consisted of sheared basalt/rhyolite mineralized with quartz-pyrite-chalcopyrite and galena. The vein was 1.9 feet wide and returned values of 0.29 ozs. per ton AU over 1.7 feet and 0.08 ozs. per ton AU over 1.9 feet.

Vein 2 is similar to vein 1 and returned values of 0.03 and 0.04 ozs. per ton AU over 8 inches and 7.5 inches respectively.

Vein 3 is located about 2,000 feet west of Vein 1 on the same «rhyolite» interflow horizon. It was exposed in two pits and it consisted of a N 70° E near vertical quartz vein containing pyrite, chalcopyrite, galena and visible gold. Assay samples taken from the east and west pits returned values of 0.11 ozs. per ton AU over 14 inches and 0.06 per ton AU over 8 inches respectively.

Storen (1947) also reported the occurrence of a wide zone of quartz mineralization in rhyolite on claim L-545251. The quartz contained disseminated pyrite with minor amounts of chalcopyrite and galena. A chip sample from this locality returned a value of 0.01 per ton AU over 5 feet.

In 1985 American Barrick Resources Ltd. announced the discovery of the Holt-McDermott deposit containing reserves of 2.8 million tons averaging 0.197 ozs. per ton AU. This announcement coupled with encouraging news from companies exploring other properties in the area helped intensify exploration efforts in the whole region. Recently, Canamax Resources Ltd. completed an underground exploration and development program on their East Zone property with a view to achieving production during 1983. Lenora Explorations Ltd., one of the Kasner Group of companies is in the midst of a substantial underground exploration program on their Gold Harker property which adjoins the Iris claim group immediately to the north. They have increased their reserves on the property and discovered new mineralized zones which are undergoing intensive evaluation.

During the period 1982 to 1987 detailed ground geophysical, geological and geochemical work plus airborne electromagnetic and magnetic surveys were completed on the Iris claim group. A number of geophysical and geochemical anomalies were defined by this work. In late 1986 and early 1987, a 5,924 foot drill program was carried out on the property by Perrex Resources Ltd. The drilling was focussed on geological targets and succeeded in defining areas of wide spread, low grade, gold mineralization within a syenite plug and narrow zones of higher grade mineralization within shear/breccia zones in basalts.

HARKER TOWNSHIP

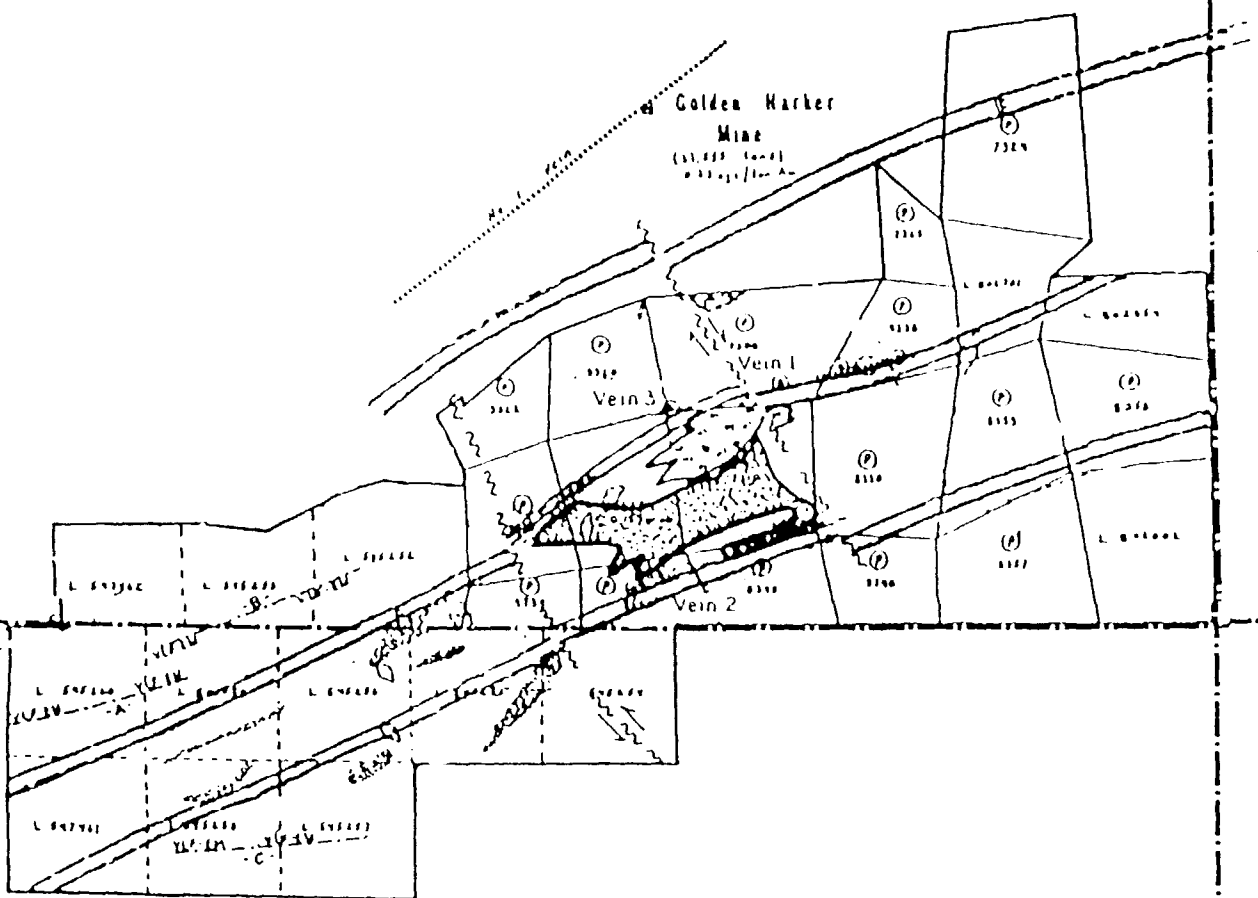

ELLIOTT TOWNSHIP

FIGURE 3

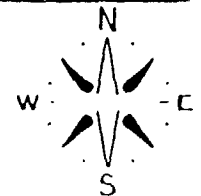

LEGEND

- Quartz vein (with associated gold)
- Siliceous Zone
- Byalite
- Fault
- Electromagnetic anomaly
- Geochemical anomaly
- Now stripping
- Old trenches
- Old pit workings or showings
- Pyroxenite

KEY MAP

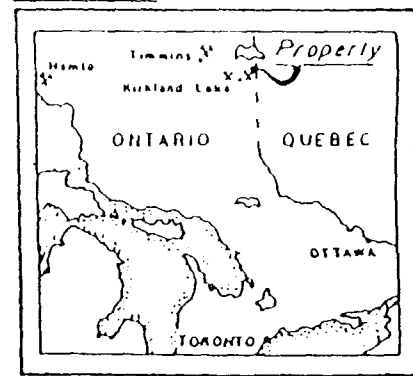

FIGURE 4

The Alberta Gold Exploration Corporation
IRIS GOLD PROPERTY MAP

HARKER GOLD AREA
LARDER LAKE MINING DIVISION
DISTRICT OF COCHRANE, ONTARIO

1000 0 1000 2000

Scale: 1 inch to 1000 feet

PERRONS'

Kirkland Lake, Canada

Approved by: Alexander Perron

Map No. 1 Drawn by: Mary Green Date: June 1988

-3a)-

INSTRUMENTATION

Magnetometer Survey:

This system uses a backward motion of spinning protons of a hydrogen atom within fluid of hydrogen and carbon. These spinning magnetic protons are caused to have two opposite poles by applying a magnetic field using a current within a coil of wire. This frequency of precision is proportional to the earth's total magnetic field.

This instrument is read directly in gammas which is the absolute value of the earth's total field for that station.

The diurnal variation was monitored by closing each loop at any secondary check station, at a grid line, baseline intersection. Diurnal corrections were applied by linear distribution of any observed variation over the time between base stations.

Electromagnetic Survey:

The VLF-EM method uses as a source, several of the main submarine communications transmitters in the 15 to 25 kHz band found throughout the world.

The submarine communication radio waves travel in a single mode parallel to the surfaces of the earth along the earth-air interface.

VLF instruments are capable of picking up any structures that change the direction of the waves by measuring the tilt angle being zero on flat ground, but when a conductor is present, the tilt angle will acquire a finite value. The direction of tilt indicates the direction of the conductor.

Calculations of such parameters as depth, depth extent, dip and width of the conductors is very minimal.

The VLF easily illustrates the location of the upper limit of dipping structures which can be seen or plotted as VLF profiles as areas of greatest change in tilt angle per unit of distance.

The instrument used for this survey was a Geonics EM-15 Unit. The sensitivity of this unit is 1% for the inphase and 1% for the quadrature. The operating frequency for the EM-16 from 15-25 kHz and the station is made by plug-in units.

Further information on the VLF and the magnetometer can be found in the back of this report on the Technical Data and Assessment forms.

PRESENTATION AND DISCUSSION OF RESULTS

i) Magnetometer Survey 2000:

The field data is presented on Map No. I/2000/mag3 at

a scale of 1" = 200' found at the back of this report.

The magnetic data is illustrated as isomagnetic contours, contour intervals 100 gammas, on a Map of corrected magnetic values at each station.

The magnetic relief ranges from 57,058 gammas to 62,765 gammas (difference of 5707 gammas). The magnetic trend is in a north to north east direction.

Over this small section of the east side of the property, D.D.H. Geomanagement Ltd., November 27, 1986, noted, «there are three rhyolitic horizons trending parallel to the enclosing volcanic rocks that cross the subject area». Geophysically, the felsic units are of low magnetic susceptibility when compared to the enclosing basalts. The rhyolite horizons have been mapped over the property. They vary in width from 10 feet to 300 feet. In this small section over the east side of the property, a large low magnetic band is interrupted (in the north section) by a large high magnetic anomalie. This may possibly be some structural readjustment between the flows and the interflow rhyolite horizons. D.D.H. Geomanagement states «On either side of the rhyolite, faults or shear zones have formed which from limited exposure available appear to vary in width and intensity along strikes.»

To be able to cut and read the south west section of the grid tie line 4,000 south was turned off PL 20+00E. In this section of the grid a very large low magnetic trend was noted. The small higher magnetic trend in claim L-667840 crossed a small overburdened outcrop. In 1985 M. Greer noted in her geological survey that the outcrop was Iron rich tholeiitic pillow lava.

ii) Electromagnetic Survey:

The field data is presented on Map No. I/2000/vlf3. The map is drawn to the scale of one inch to two hundred feet, found at the back of this report.

In this section of the central section of the I-2000 Project, there are five (5) distinctive anomalies found.

C1 - Crosses PL20+00E 13+80N to PL24+00E. 15+30N.

The contact crosses through a thick cedar swamp to the west side of a very large overburdened outcrop. In 1988, D. Hawke noted a large north/south fault crossing the top of the outcrop. This contact may possibly be a small south/west fault branching off the north/south fault.

C2 - Crosses PL20+00E 8+80S to PL24+00E 7+00S.

This contact is in the same area where Zone I (Figure 3) crosses the new grid. The contact is most likely the contact between the rhyolite (Interbedded Sediments) and the enclosing volcanic rocks (basalts).

- C3 - Crosses PL20+00E 17+90S to PL24+00E 1700S.
This contact is most likely the south edge of the No. 1 Zone (Figure 3) of the rholite and the volcanic rocks (basalts).
- C4 - Crosses PL16+00E 44+50S to PL24+00E 42+80S.
This area is the north side of a large overburdened outcrop. In 1985, M. Greer reported a large contact 85-B to be a lower response running in the same direction as a small creek system.
- C5 - Crosses PL22+00E 34+80S to PL24+00E 34+50S.
This contact is in a low lying wet tag alder, poplar swamp.

OBSERVATIONS AND RECOMMENDATIONS

Due to the amount of activity of ponds and creeks, TL 40+00S was cut to help in the bottom south west claims.

The continuation of the center section of the grid is on going. All information is being assessed for a detail I.P. Program on surface and down the hole.

Respectfully submitted,



September 30, 2000

Miss Wendy K. Weller
Geotech

Assessment Data Form

Type of Work:

Prospecting: _____ Geological: _____

Physical: LINE CUTTING AND CHAINING _____

Geophysical: ELECTROMAGNETIC (1 STATION) AND MAGNETOMETER SURVEY _____

Geochemical: _____ Drilling: _____

Assays/Analyses: _____ Other work: _____

Cost of Work: \$4,369.00 _____ Dollars Applied: \$4,369.00 _____

Recorded Holder:

Name: ALEX PERRON/
THE ALBERTA GOLD EXPLORATION CORP.

Address: 103 GOVERNMENT ROAD EAST,
KIRKLAND LAKE, ONTARIO P2N 1A9

Survey Company:

Name: GWEN RESOURCES LTD.

Address: 103 GOVERNMENT ROAD EAST,
KIRKLAND LAKE, ONTARIO P2N 1A9

Survey/Report Information:

Start of work: SEPTEMBER 21, 2000 _____ End of work: SEPTEMBER 29, 2000 _____

Draughting time: SEPT. 28, 29, 2000 _____ Report time: SEPT. 29, 30, 2000 _____

Completion of report: SEPT. 30, 2000 _____ Author: MISS WENDY K. WELLER _____

Work performed on claim(s) _____

CLM-399, P-7310, P-8349, P-8650, P-9920, P-9922, L-545251, L-667068, L-667839,
L-667840, L-667848.

Work applied to claim(s) _____

L-735604, L-735605, L-735606, L-735607, L-735608, L-736844, L-736845, L-736846,
L-736847, L-736848, L-815428, L-815431.

Persons who performed work (supervisor first):

GWEN RESOURCES LTD.

WENDY K. WELLER

J. HENNESSEY

JAMIE HENNESSEY

PAUL SIFORD AND CREW

MICHEL FECTEAU

Technical Data:

Line (mi/km): 8.6 KM
 No. of samples/stations: 283
ELECTROMAGNETIC SURVEY:
 Instrument: GEONICS EM-16
 Coil configuration: VERTICAL AND HORIZONTAL
 Method: FIXED TRANSMITTER
 Vertical scale: 1 INCH = \pm 40%
 Frequency: 24.8 kHz
 Operational technique:

Line traversed:
 Line/picket spacing: 200 FT./100 FT.
 Operator: WENDY K. WELLER
 Accuracy: \pm 1%
 Coil separation: INFINITY
 Parameters: INPHASE & QUADRATURE
 Horizontal scale: 1" = 200 FT.
 Station: CUTLER, MAINE

MAGNETIC SURVEY:

Instrument: MCPHAR GP-8 PROTON
 Base station: BL 18+00E
 Base station time: 30 MINUTES
 Contour interval: 100 GAMMAS
 Contoured by: MISS WENDY K. WELLER
 Operational technique: SPENCER POLE MOUNT

Operator: MISS WENDY K. WELLER
 Accuracy: \pm GAMMA
 Diurnal method: CLOSED LOOP
 Location/value: BL 18+00E
 Datum subtracted: 57,000 GAMMAS
 Horizontal scale: 1" = 200 FT.

INDUCED POLARIZATION SURVEY

Transmitter used: Receiver used:
 Method: Frequency:
 On time: Range:
 Off time: Delay time:
 Power source: Output:
 Electrode array: Electrode spacing:
 Readings taken: Other data:
 Operational technique:

BIBLIOGRAPHY

- Storen, R. 1947 - Preliminary Report of Iris Gold Mines Ltd., Harker Township, Larder Lake Mining Division, Province of Ontario, private engineers report.
- Satterly, J. 1952 - Geology of Harker Township; 60th Annual Report of the Ontario Department of Mines, Vol. LX, Part VIII, 1951.
- Drummond, A.D. 1987 - Report on The Winter 1986-1987 Drill Program, 31 Claim Iris Gold Group: a private report for The Alberta Gold Exploration Corporation.
- Jensen, L.S. 1986 - Mineralization and Volcanic Stratigraphy in The Western Part of the Abitibi Subprovince: Ontario Geological Survey, Misc. Paper 129.
- D. R. Hawke, 1988 - Report on the 1988 Exploration Program Iris Joint Venture Project NTS 32D/5.
- Workman, Al. 1988 - Evaluation Report.
- Weller, Miss Wendy K. 2000 - Geophysical Survey Report on The Iris Property, Magnetometer & Electro-magnetic surveys, Harker & Elliott Townships, Larder Lake Mining Division, District of Cochrane, Ontario. July 24, 2000
- Weller, Miss Wendy K. August 28, 2000 - Geophysical Survey Report on the Iris Property - Phase II Harker & Elliott Townships Larder Lake Mining Division District of Cochrane, Ontario August 28, 2000
- Weller, Miss Wendy K. September 22, 2000 - Geophysical Survey Report on the Iris Property - Phase II Harker & Elliott Townships Larder Lake Mining Division District of Cochrane, Ontario Sept. 22, 2000

C E R T I F I C A T E

I, Wendy K. Weller, of Kirkland Lake, Ontario, do hereby certify:

- 1) That I am a Geotech in Training and reside at:
71 Second Street, Apartment #2, Kirkland Lake, Ontario P2N 1R6.
- 2) That I graduated from the Haileybury School of Mines as a certified Diamond Driller in 1982. I have had a staking licence for the past (10) ten years.
- 3) That I was employed as a Diamond Driller for Heath & Sherwood for 1 year.
- 4) That I have been practising as a Geotech Trainee for a period of (10) ten years and I am qualified to write this report.
- 5) That I supervised and participated in this survey.

Sept 30/00
Date



Wendy K. Weller
Geotech



32D05NW2094 2.20624 HARKER

900

authority of subsections 65(2) and 66(3) of the Mining Act. Under section 8 of the Act, you are required to use this form to review the assessment work and correspond with the mining land holder or the Mining Recorder, Ministry of Northern Development and Mines, 6th Floor

Instructions: - For work performed on Crown Lands before recording a claim, use form 0240.
 - Please type or print in ink.

1. Recorded holder(s) (Attach a list if necessary)

2.20624

Name THE ALBERTA GOLD EXPLORATION CORP./ALEX H. PERRON	Client Number #200833 - #181257
Address 103 GOVERNMENT ROAD EAST, KIRKLAND LAKE, ONTARIO P2N 1A9	Telephone Number (705) 567-3001 Fax Number (705) 567-2158
Name PERREX RESOURCES INC.	Client Number #181187
Address 103 GOVERNMENT ROAD EAST, KIRKLAND LAKE, ONTARIO P2N 1A9	Telephone Number (705) 567-3001 Fax Number (705) 567-2158

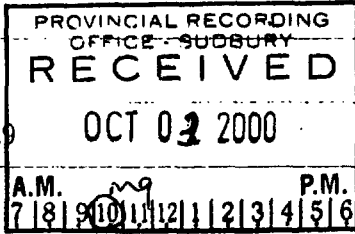

2. Type of work performed: Check (✓) and report on only ONE of the following groups for this declaration.

- Geotechnical: prospecting, surveys, assays and work under section 18 (regs) Physical: drilling, stripping, trenching and associated assays Rehabilitation

Work Type LINE CUTTING AND CHAINING MAGNETOMETER & ELECTROMAGNETIC SURVEYS	Office Use Commodity Total \$ Value of Work Claimed <u>4369</u> NTS Reference Mining Division <u>harder lake</u> Resident Geologist District <u>Kirkland lake</u>
Dates Work Performed From 21 09 00 To 30 09 00 Day Month Year Day Month Year	
Global Positioning System Data (if available)	Township/Area HARKER/ELLIOTT/HOLLOWAY M or G Plan Number

Please remember to: - obtain a work permit from the Ministry of Natural Resources as required;
 - provide proper notice to surface rights holders before starting work;
 - complete and attach a Statement of Work Form 0212;
 - provide a map showing contiguous mining lands that are linked for assigning work;
 - include two copies of your geotechnical report.

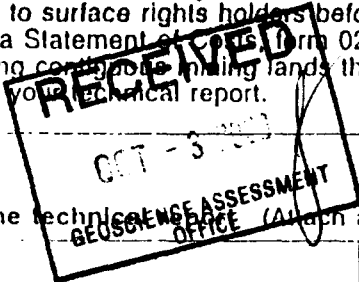

3. Person or companies who prepared the technical report (Attach a list if necessary)

Name MISS WENDY K. WELLER	Telephone Number (705) 567-3001
Address 103 GOVERNMENT RD.E., KIRKLAND LAKE, ONTARIO P2N 1A9	Fax Number (705) 567-2158
Name RECEIVED LARDER LAKE MINING DIVISION	Telephone Number
Address	Fax Number
Name <u>JCT 2 2000</u>	Telephone Number
Address <u>8:35 4</u>	Fax Number

4. Certification by Recorded Holder or Agent

I, WENDY K. WELLER (Print Name), do hereby certify that I have personal knowledge of the facts set forth in this Declaration of Assessment Work having caused the work to be performed or witnessed the same during or after its completion and, to the best of my knowledge, the annexed report is true.

Signature of Recorded Holder or Agent 	Date SEPTEMBER 30, 2000
Agent's Address 103 GOVERNMENT RD.E., KIRKLAND LAKE, ONT. P2N 1A9	Telephone Number (705) 567-3001 Fax Number (705) 567-2158

5. Work to be recorded and distributed: Work can only be assigned to claims that are contiguous (adjoining) to the mining land where work was performed, at the time work was performed. A map showing the contiguous link must accompany this form.

Mining Claim Number. Or if work was done on other eligible mining land, show in this column the location number indicated on the claim map.		Number of Claim Units. For other mining land, list hectares.	Value of work performed on this claim or other mining land.	Value of work applied to this claim.	Value of work assigned to other mining claims.	Bank. Value of work to be distributed at a future date.
eg	TB 7827	16 ha	\$26,825	N/A	\$24,000	\$2,825
eg	1234567	12	0	\$24,000	0	0
eg	1234568	2	\$ 0,892	\$ 4,000	0	\$4,892
1.937	1 CLM-399	10	\$ 260.00		\$ 260.00	
2.260	2 P-7310	1	\$ 28.00		\$ 28.00	
3.266	3 P-8349	1	\$ 185.00		\$ 185.00	
G.2724	4 P-8650	1	\$ 253.00		\$ 253.00	
3.280	5 P-9920	1	\$ 223.00		\$ 223.00	
G.282	6 P-9922	1	\$ 208.00		\$ 208.00	
G.939	7 L-545251	1	\$ 730.00		\$ 730.00	
8	L-667068	1	\$ 820.00		\$ 820.00	
9	L-667839	1	\$ 489.00		\$ 489.00	
10	L-667840	1	\$1,035.00		\$1,035.00	
11	L-667848	1	\$ 138.00		\$ 138.00	
12	L-735604	1		\$ 184.00		
13	L-735605	1		\$ 400.00		
14	L-735606	1		\$ 400.00		
15	L-735607	1		\$ 400.00		
Column Totals			\$4,369.00	\$1,384.00	\$4,369.00	

I, WENDY K. WELLER, do hereby certify that the above work credits are eligible under subsection 7 (1) of the Assessment Work Regulation 6/96 for assignment to contiguous claims or for application to the claim where the work was done.

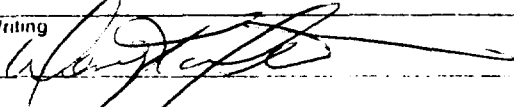
Signature of Recorded Holder or Agent Authorized in Writing  Date SEPTEMBER 30, 2000

6. Instructions for cutting back credits that are not approved.

Some of the credits claimed in this declaration may be cut back. Please check (✓) in the boxes below to show how you wish to prioritize the deletion of credits:

- 1. Credits are to be cut back from the Bank first, followed by option 2 or 3 or 4 as indicated.
- 2. Credits are to be cut back starting with the claims listed last, working backwards; or
- 3. Credits are to be cut back equally over all claims listed in this declaration; or
- 4. Credits are to be cut back as prioritized on the attached appendix or as follows (describe):

Note: If you have not indicated how your credits are to be deleted, credits will be cut back from the Bank first, followed by option number 2 if necessary.

For Office Use Only Received Stamp <div style="text-align: center;"> RECEIVED LARDER LAKE MINING DIVISION OCT 2 2000 8:35 </div>	Deemed Approved Date	Date Notification Sent
	Date Approved	Total Value of Credit Approved
	Approved for Recording by Mining Recorder (Signature)	



Schedule for Declaration or Assessment Work on Mining Land

Transaction Number (office use)

L00680.00366

THE ALBERTA GOLD EXPLORATION CORP.
ALEX H. PERRON
PERREX RESOURCES INC.

CLIENT NO. 200833
CLIENT NO. 181257
CLIENT NO. 181187

Mining Claim Number. Or if work was done on other eligible mining land, show in this column the location number indicated on the claim map.	Number of Claim Units. For other mining land, list hectares.	Value of work performed on this claim or other mining land	Value of work applied to this claim	Value of work assigned to other mining claims	Bank. Value of work to be distributed at a future date
16	L-735608	1	\$ 400.00		
17	L-736844	1	\$ 400.00		
18	L-736845	1	\$ 400.00		
19	L-736846	1	\$ 400.00		
20	L-736847	1	\$ 400.00		
21	L-736848	1	\$ 400.00		
22 ^v	L-815428	1	\$ 400.00		
23 ^v	L-815431	1	\$ 185.00		
24					
25					
26					
27					
28					
29					
30					
31					
32					
33					
34					
35					
36					
37					
38					
39	RECEIVED				
40	LARDER LAKE				
41	MINING DIVISION				
42	OCT 2 2000				
43	8.35 #				
44					
45					
46					
47					
48					
49					
50					
Column Totals		\$ 4,369.00	\$4,369.00	\$ 4,369.00	

RECEIVED
OCT - 3 2000
GEOSCIENCE ASSESSMENT



Personal information collected on this form is obtained under the authority of subsection 6(1) of the Assessment Work Regulation 6/96. Under section 8 of the Mining Act, the information is a public record. This information will be used to review the assessment work and correspond with the mining land holder. Questions about this collection should be directed to the Chief Mining Recorder, Ministry of Northern Development and Mines, 6th Floor, 933 Ramsey Lake Road, Sudbury, Ontario, P3E 6B5.

2.20024

Work Type	Units of Work <small>Depending on the type of work, list the number of hours/days worked, metres of drilling, kilometres of grid line, number of samples, etc.</small>	Cost Per Unit of work	Total Cost
LINE CUTTING & CHAINING	8.6 KM X \$275.00 KM		\$ 2,365.00
MAGNETOMETER SURVEY	8.6 KM X \$105.00 KM		\$ 903.00
ELECTROMAGNETIC SURVEY	8.6 KM X \$110.00 KM		\$ 946.00
Associated Costs (e.g. supplies, mobilization and demobilization).			
RECEIVED LARDER LAKE MINING DIVISION OCT 2 2000 8.35			
Transportation Costs			
1 TRUCK X 80 KM X 5 DAYS X .30¢			\$ 120.00
Food and Lodging Costs			
1 PERSON X 5 DAYS X \$7.00/DAY/ (LUNCH)			\$ 35.00
Total Value of Assessment Work			\$ 4,369.00

RECEIVED
OCT - 3 2000

Calculations of Filing Discounts:

1. Work filed within two years of performance is claimed at 100% of the above Total Value of Assessment Work.
2. If work is filed after two years and up to five years after performance, it can only be claimed at 50% of the Total Value of Assessment Work. If this situation applies to your claims, use the calculation below:

TOTAL VALUE OF ASSESSMENT WORK x 0.50 = Total \$ value of worked claimed.

Note:

- Work older than 5 years is not eligible for credit.
- A recorded holder may be required to verify expenditures claimed in this statement of costs within 45 days of a request for verification and/or correction/clarification. If verification and/or correction/clarification is not made, the Minister may reject all or part of the assessment work submitted.

Certification verifying costs:

I, WENDY K. WELLER (please print full name), do hereby certify, that the amounts shown are as accurate as may reasonably be determined and the costs were incurred while conducting assessment work on the lands indicated on the accompanying Declaration of Work form as Albert I am authorized (recorded holder, agent, or state company person with signing authority) to make this certification.

Signature: [Signature] Date: SEPTEMBER 30, 2000

Geoscience Assessment Office
933 Ramsey Lake Road
6th Floor
Sudbury, Ontario
P3E 6B5

October 17, 2000

THE ALBERTA GOLD EXPLORATION CORPORATION
103 GOVERNMENT ROAD EAST
KIRKLAND LAKE, Ontario
P2N-1A9

Telephone: (888) 415-9845
Fax: (877) 670-1555

Visit our website at:
www.gov.on.ca/MNDM/MINES/LANDS/mlsmnpge.htm

Dear Sir or Madam:

Submission Number: 2.20624

Status

Subject: Transaction Number(s): W0080.00366 Approval

We have reviewed your Assessment Work submission with the above noted Transaction Number(s). The attached summary page(s) indicate the results of the review. **WE RECOMMEND YOU READ THIS SUMMARY FOR THE DETAILS PERTAINING TO YOUR ASSESSMENT WORK.**

If the status for a transaction is a 45 Day Notice, the summary will outline the reasons for the notice, and any steps you can take to remedy deficiencies. The 90-day deemed approval provision, subsection 6(7) of the Assessment Work Regulation, will no longer be in effect for assessment work which has received a 45 Day Notice. Allowable changes to your credit distribution can be made by contacting the Geoscience Assessment Office within this 45 Day period, otherwise assessment credit will be cut back and distributed as outlined in Section #6 of the Declaration of Assessment work form.

Please note any revisions must be submitted in DUPLICATE to the Geoscience Assessment Office, by the response date on the summary.

If you have any questions regarding this correspondence, please contact BRUCE GATES by e-mail at bruce.gates@ndm.gov.on.ca or by telephone at (705) 670-5856.

Yours sincerely,



ORIGINAL SIGNED BY
Steve B. Beneteau
Acting Supervisor, Geoscience Assessment Office
Mining Lands Section

Work Report Assessment Results

Submission Number: 2.20624

Date Correspondence Sent: October 17, 2000

Assessor: BRUCE GATES

Transaction Number	First Claim Number	Township(s) / Area(s)	Status	Approval Date
W0080.00366	667068	HARKER, ELLIOTT, HOLLOWAY	Approval	October 16, 2000

Section:

14 Geophysical MAG

14 Geophysical VLF

At the discretion of the Ministry, the assessment work performed on the mining lands noted in this work report may be subject to inspection and/or investigation at any time.

Correspondence to:

Resident Geologist
Kirkland Lake, ON

Assessment Files Library
Sudbury, ON

Recorded Holder(s) and/or Agent(s):

Wendy K. Weller
KIRKLAND LAKE, ONTARIO, CANADA

THE ALBERTA GOLD EXPLORATION CORPORATION
KIRKLAND LAKE, Ontario

ALEXANDER H. PERRON
KIRKLAND LAKE, Ontario

PERREX RESOURCES INC.
KIRKLAND LAKE, Ontario

LAMPLUGH TWP M-358

NOTICE OF FORESTRY ACTIVITY... THIS TOWNSHIP AREA FALLS WITHIN THE ABITIBI MANAGEMENT UNIT AND MAY BE SUBJECT TO FORESTRY OPERATIONS. THE M.N.R. UNIT FORESTER FOR THIS AREA CAN BE CONTACTED AT: P.O. BOX 129 SWASTIKA ONT. POK 1T0 705-642-3222

THE TOWNSHIP OF HARKER

DISTRICT OF COCHRANE
LARDER LAKE MINING DIVISION

SCALE: 1-INCH 40 CHAINS

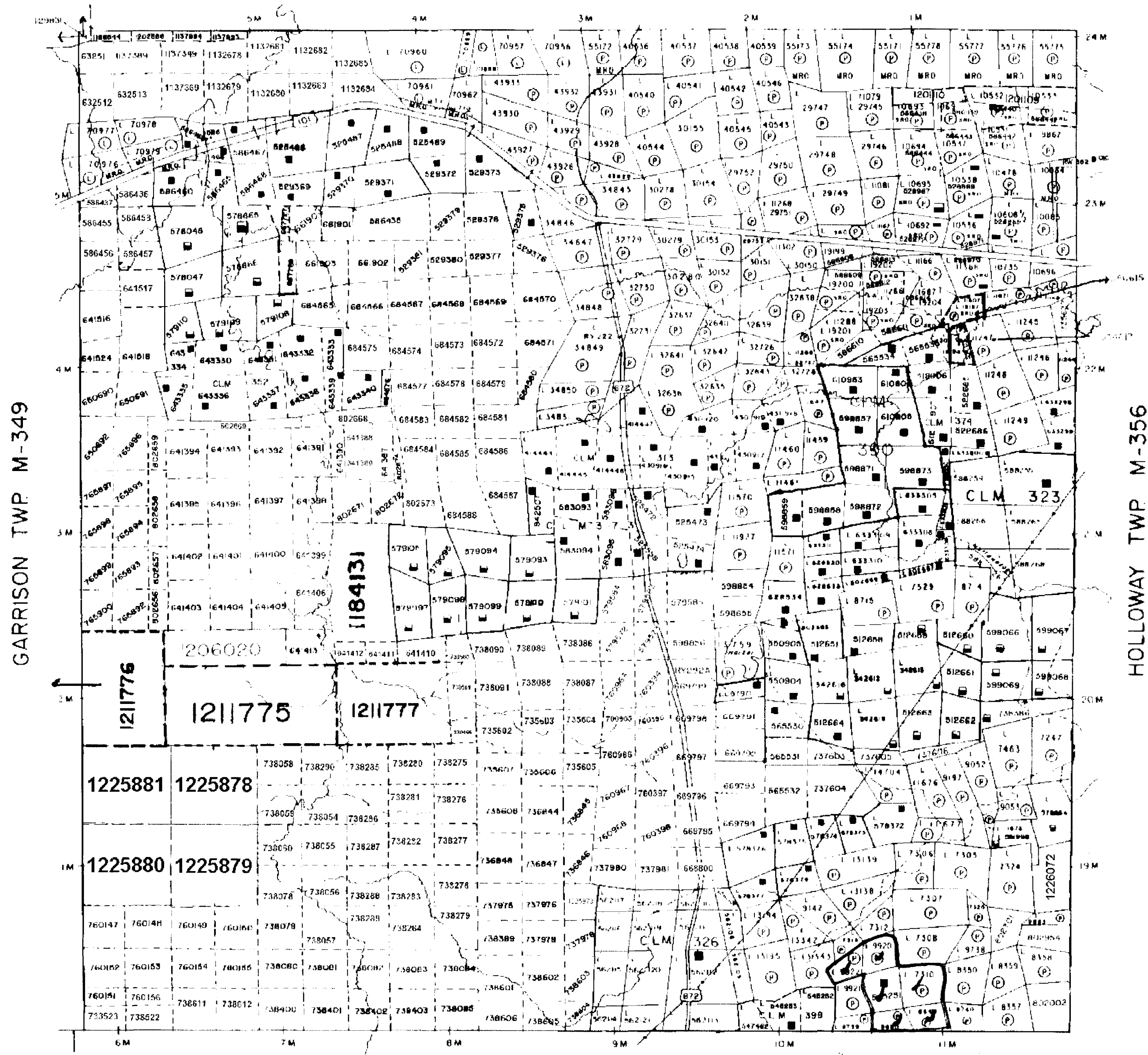

GARRISON TWP M-349

HOLLOWAY TWP M-356

LEGEND

- PATENTED LAND ● or ⊙
- CROWN LAND SALE C.S.
- LEASES □ or ⊕
- LOCATED LAND Loc
- LICENSE OF OCCUPATION L.O.
- MINING RIGHTS ONLY M.R.O.
- SURFACE RIGHTS ONLY S.R.O.
- ROADS ———
- IMPROVED ROADS ———
- KING'S HIGHWAYS ———
- RAILWAYS ———
- POWER LINES ———
- MARSH OR MUSKEG ———
- MINES ———
- CANCELLED PATENTED S.R.O. ———
- LEASE - MINING RIGHTS ONLY ———
- ORDER - N - COUNCIL ———

NOTES

400' Surface Rights reservation along the shores of all lakes and rivers.

AREAS WITHDRAWN FROM DISPOSITION

- M.R.O. - MINING RIGHTS ONLY
- S.R.O. - SURFACE RIGHTS ONLY
- M + S. MINING AND SURFACE RIGHTS

Description	Order No	Date	Disposition	File

L.U.P. LAND USE PERMIT NO. 117130/PENDING APPLICATION UNDER PUBLIC LANDS ACT

THE INFORMATION THAT APPEARS ON THIS MAP HAS BEEN COMPILED FROM VARIOUS SOURCES, AND ACCURACY IS NOT GUARANTEED THOSE WISHING TO START MINING CLAIMS SHOULD CONSULT WITH THE MINING RECORDER, MINISTRY OF NORTHERN DEVELOPMENT AND MINES, FOR ADDITIONAL INFORMATION ON THE STATUS OF THE LANDS SHOWN HEREON

ELLIOTT TWP M-347

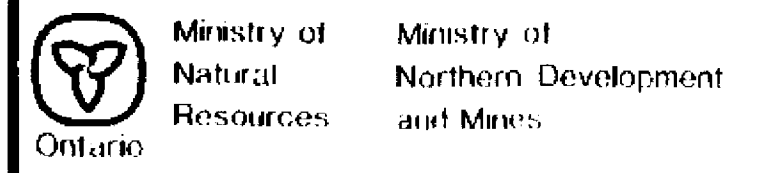

REFERENCES

AREAS WITHDRAWN FROM DISPOSITION

- M.R.O. - MINING RIGHTS ONLY
- S.R.O. - SURFACE RIGHTS ONLY
- M+S. - MINING AND SURFACE RIGHTS

Description	Order No.	Date	Disposition	File
(R) MIN. GRAVEL, ET AL.				

(R) MIN. GRAVEL, ET AL.

THE INFORMATION THAT APPEARS ON THIS MAP HAS BEEN COMPILED FROM VARIOUS SOURCES, AND ACCURACY IS NOT GUARANTEED. THOSE WISHING TO STAKE MINING CLAIMS SHOULD CONSULT WITH THE MINING RECORDER, MINISTRY OF NORTHERN DEVELOPMENT AND MINES, FOR ADDITIONAL INFORMATION ON THE STATUS OF THE LANDS SHOWN HEREON.

NOTICE FORESTRY ACTIVITY
THIS TOWNSHIP FALLS WITHIN THE APPLIED MANAGEMENT UNIT AND MAY BE SUBJECT TO FORESTRY OPERATIONS. THE MAPPING UNIT FOR THIS AREA CAN BE CONTACTED AT:
P.O. BOX 129
SWASTIKA, ONTARIO
POB 110
705 642-3222

HARKER TOWNSHIP

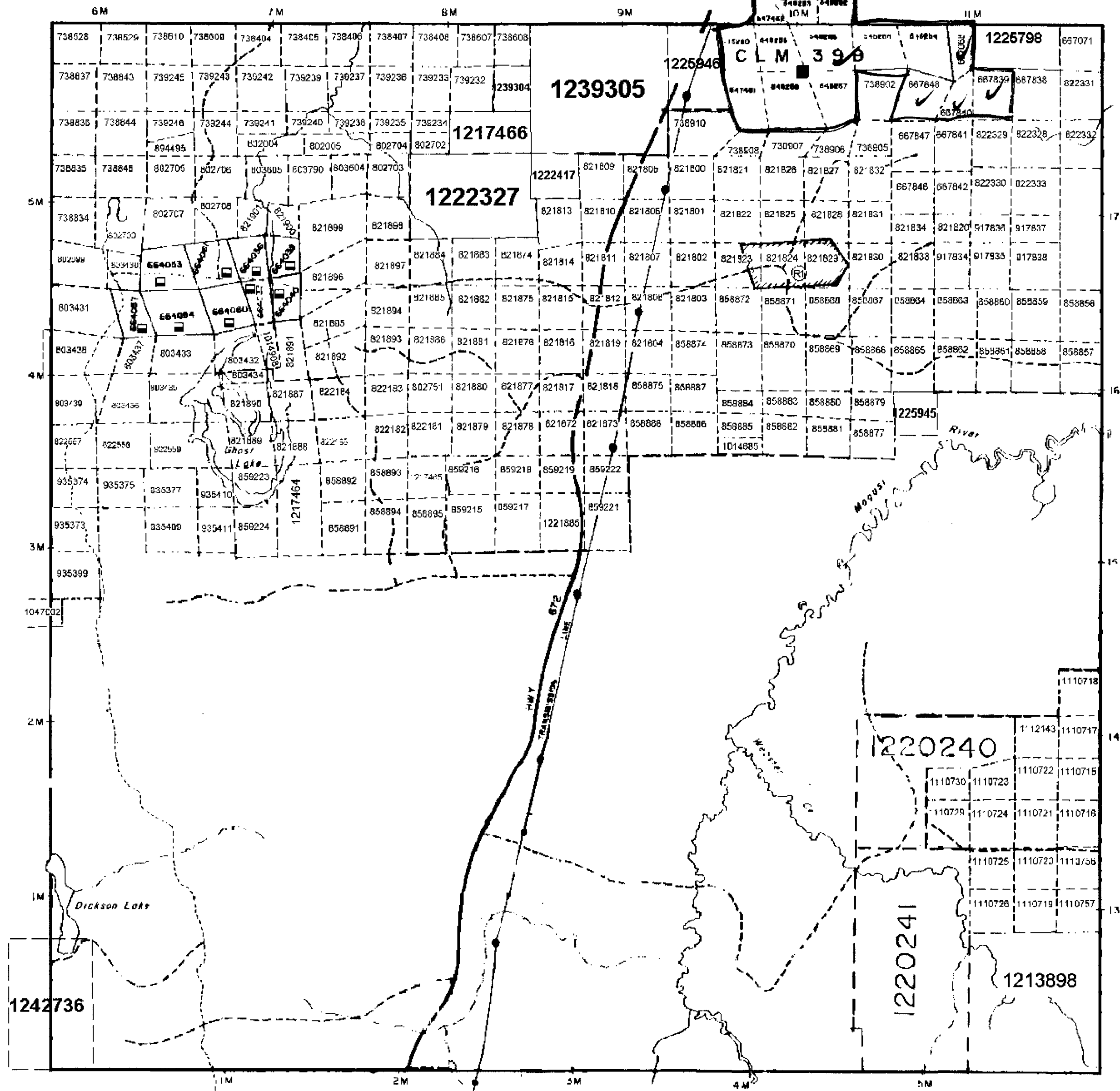

CLIFFORD TOWNSHIP

LEGEND

- HIGHWAY AND ROUTE No.
- OTHER ROADS
- TRAILS
- SURVEYED LINES
- TOWNSHIPS, BASE LINES, ETC.
- LOTS, MINING CLAIMS, PARCELS, ETC.
- UNSURVEYED LINES
- LOT LINES
- PARCEL BOUNDARY
- MINING CLAIMS ETC.
- RAILWAY AND RIGHT OF WAY
- UTILITY LINES
- NON-PERENNIAL STREAM
- FLOODING OR FLOODING RIGHTS
- SUBDIVISION OR COMPOSITE PLAN
- RESERVATIONS
- ORIGINAL SHORELINE
- MARSH OR MUSKEG
- MINES
- TRAVERSE MONUMENT

DISPOSITION OF CROWN LANDS

- | TYPE OF DOCUMENT | SYMBOL |
|---------------------------------|--------|
| PATENT, SURFACE & MINING RIGHTS | |
| " SURFACE RIGHTS ONLY | |
| " MINING RIGHTS ONLY | |
| LEASE, SURFACE & MINING RIGHTS | |
| " SURFACE RIGHTS ONLY | |
| " MINING RIGHTS ONLY | |
| LICENCE OF OCCUPATION | |
| ORDER IN COUNCIL | |
| RESERVATION | |
| CANCELLED | |
| SAND & GRAVEL | |

SCALE: 1 INCH = 40 CHAINS

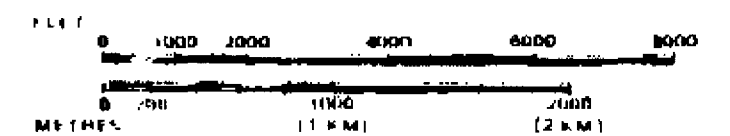

TOWNSHIP
ELLIOTT
M.N.R. ADMINISTRATIVE DISTRICT
KIRKLAND LAKE
MINING DIVISION
LARDER LAKE
LAND TITLES / REGISTRY DIVISION
COCHRANE

Ministry of Natural Resources
Ministry of Northern Development and Mines

Date: MAY 1994
Map No: G-3633

COPY OF THIS MYLAR ARCHIVED BY APR 23 1997
ARCHIVED MAY 02 1994
ARCHIVED APRIL 05 1997



32D05NM2094 2.20624 HARKER

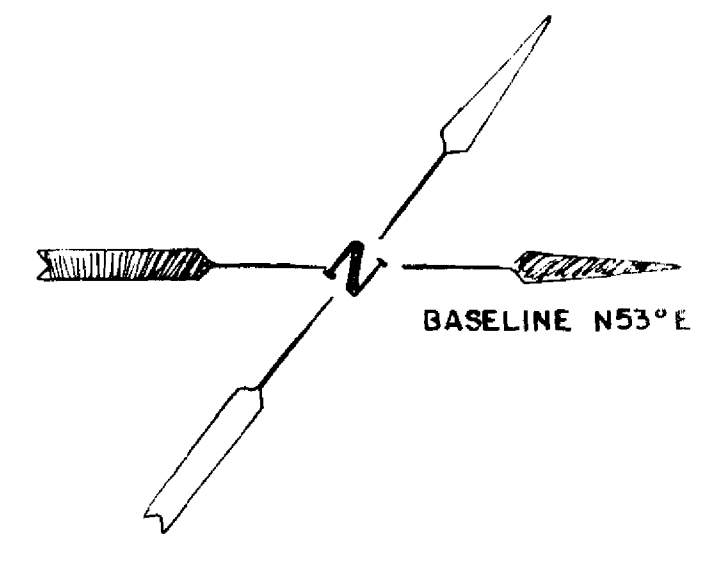
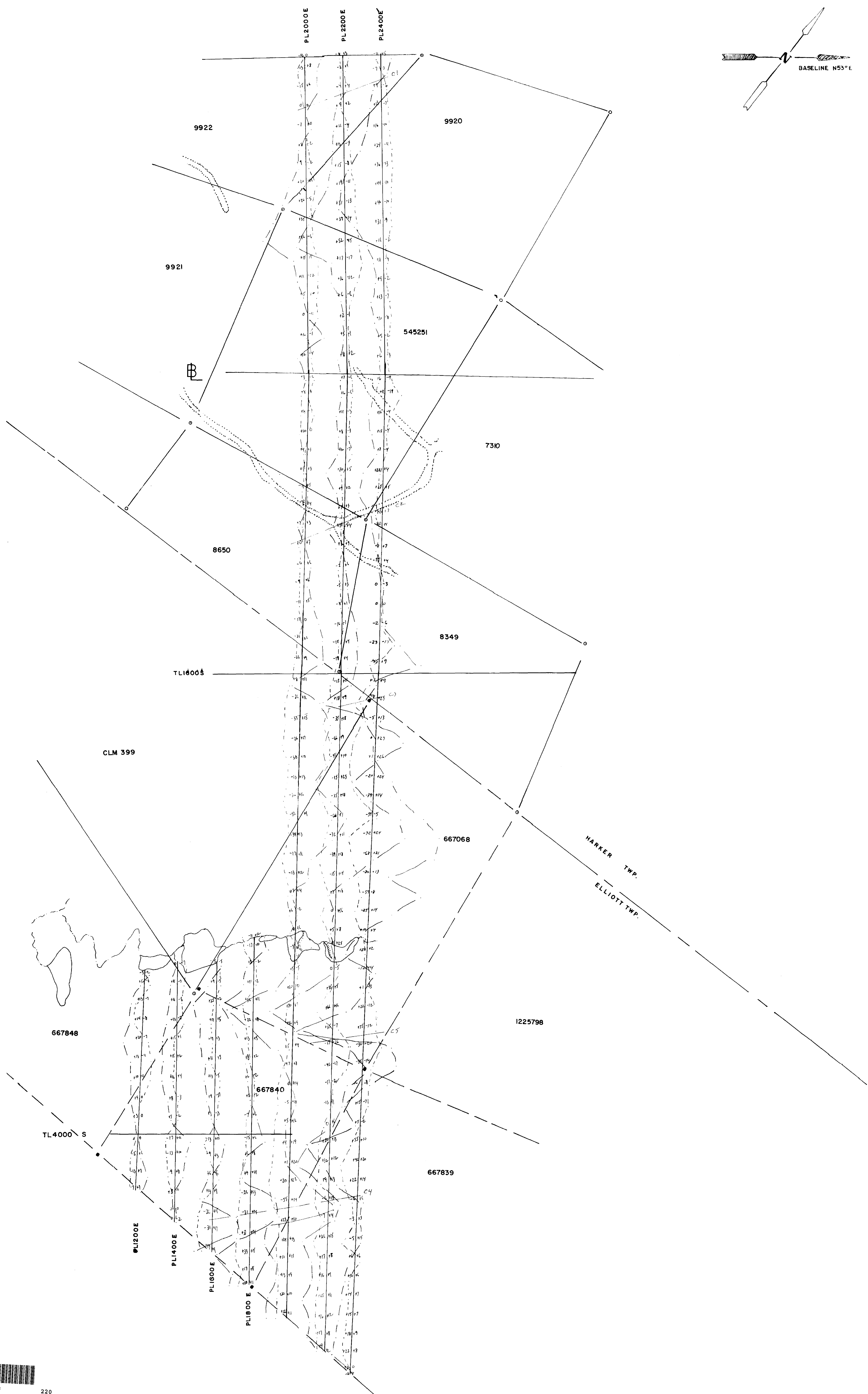

SYMBOLS

Claim post ■	Claim line ————
Survey Post ○	Survey line ————
Township line ————	
Creek ————	Pond ————
Access road ————	Trail ————
Inphase ————	
Quadrature ————	
VLF Contact ————	C1

INSTRUMENTATION
 Instrument used GEONICS EM 16
 Station Cutler, Maine
 Vertical scale 40%

GWEN RES.
IRIS 2000
CENTER SHEET
 GROUND VLF-EM SURVEY
 HARKER and ELLIOTT Townships

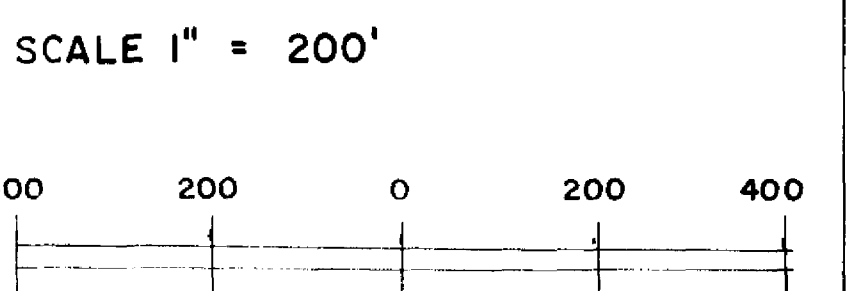

Report by WK Waller
 Drafted by WKW
 Date Sept. 2000
 Map no. I/2000/VLF3

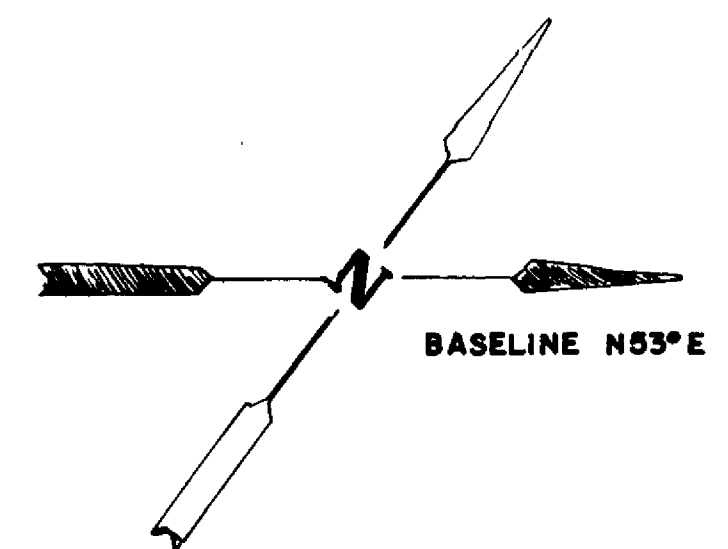
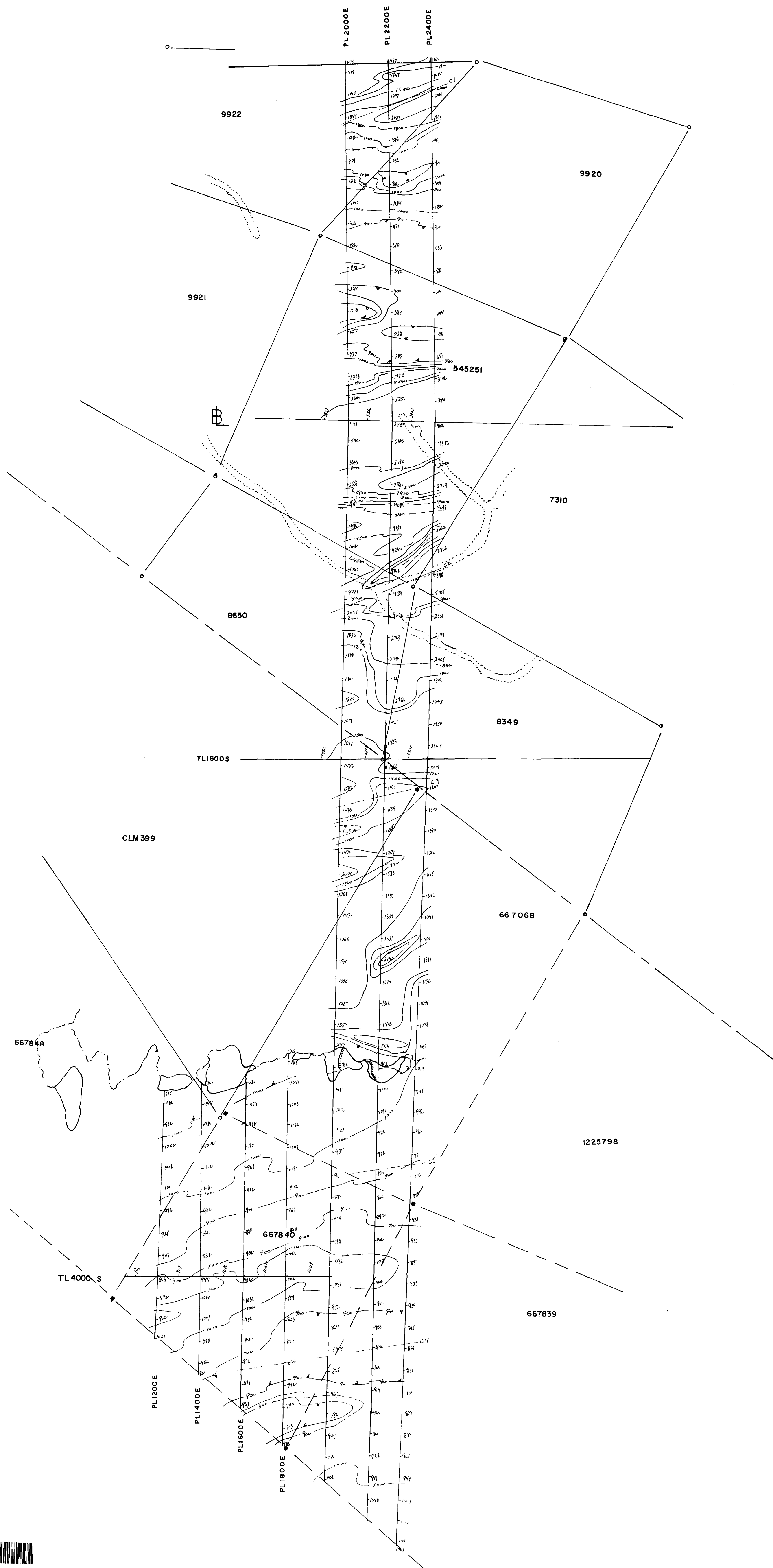

SYMBOLS

- Survey Post ○
- Township line - - - - -
- Access road - - - - -
- Pond
- Base station ○
- Isomagnetic contours
- VLF Contact - - - - - C1
- Claim post ■
- Claim line - - - - -
- Trail - - - - -
- Creek

INSTRUMENTATION

Instrument used McPhar GP 8
 Contour interval 100 ft
 Datum subtracted 57000 ft

Report by WKWeller

GWEN RES.
 IRIS 2000
 CENTER SHEET
 GROUND MAGNETOMETER SURVEY
 HARKER and ELLIOTT
 TOWNSHIPS

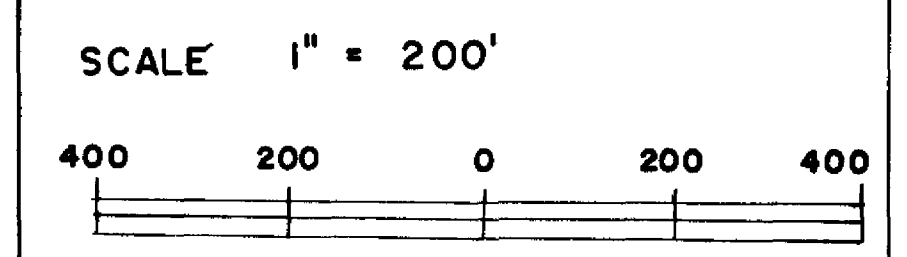

Contoured by WKW
 Drafted by WKW
 Date Sept. 2000
 Map no. I 12000/1746