

GEOLOGY SURVEY REPORT  
ON  
IRIS-31 GROUP  
EAST HALF  
HARKER TOWNSHIP  
LARDER LAKE MINING DIVISION  
DISTRICT OF COCHRANE, ONTARIO

FOR

ALEXANDER H. PERRON

DECEMBER 14, 2001

MISS WENDY K. WELLER  
GEOTECH

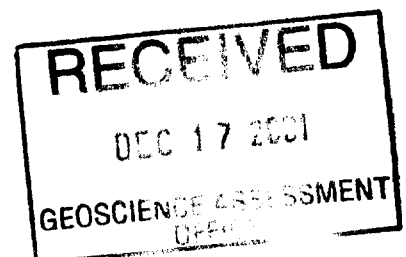

32D05NW2107 2.22578 HARKER

TABLE OF CONTENTS

SUMMARY. . . . . i)

INTRODUCTION . . . . . 1)

LOCATION AND ACCESS. . . . . 1)

REGIONAL GEOLOGY.. . . . 2)

PROPERTY HISTORY . . . . . 2)

PREVIOUS WORK. . . . . 2, 3

PRESENTATION AND DISCUSSION OF RESULTS . . . . . 3

TOPOGRAPHY . . . . . 3

GEOLOGICAL MAPPING . . . . . 3, 4

CONCLUSIONS AND RECOMMENDATIONS. . . . . 4

ASSESSMENT DATA FORM . . . . . 5

BIBLIOGRAPHY . . . . . 6

CERTIFICATE. . . . . 7

FIGURES, TABLES AND MAPS

CLAIMS WORK PERFORMED ON - (FIGURE 1). . . . . 1 a)

CLAIM LOCATION MAP - (FIGURE 1a) . . . . . 1 b)

LOCATION MAP - (FIGURE 1b) . . . . . 1 c)

KINOJEVIS GROUP LEGEND - (FIGURE 2). . . . . 2 a)

IRIS GOLD PROPERTY MAP - (FIGURE 3). . . . . 2 b)

GEOLOGICAL SURVEY MAP NO. IR31/2001/GEO. . . . . IN BACK POCKET

## SUMMARY

i)

This report is a geological survey as required by The Ministry of Northern Development and Mines for assessment work purposes, following the recommendation set forth in the Mining Act Regulations 1991.

The report includes an introduction to the property, general geology, field results and conclusions based on the field study.

Technical Data is provided on the Assessment Data form found at the back of this report.

Field Data is compiled on the accompanying plan maps found at the back of this report, Maps No. IR31/2001/GEO.

In 1999, Mr. Ben Berger from O.G.S. re-mapped and sampled the Iris Property. In his findings, from the sampling a percentage of the group showed certain minerals that have never been looked for. (e.g. Platinum and Poladium SP).

GEOLOGY SURVEY REPORT  
ON  
IRIS-31 GROUP  
EAST HALF  
HARKER TOWNSHIP  
LARDER LAKE MINING DIVISION  
DISTRICT OF COCHRANE, ONTARIO

INTRODUCTION

Sunday, December 9, 2001, a small detail geological survey was started on claim L-802002 and P-8357 on the Iris-31 Claim Group.

In March of 2001, three quarters of the Iris-10 Group was timbered, the new bush road and trails uncovered small outcrop showings that were missed in the 1985 report.

All geological features were located and chained into the 2000 new north/south grid.

All work was performed by Miss Wendy K. Weller, as well as drafting and report writing.

Ownership of the aforementioned leased and unpatented mining claims has been attested to by The Alberta Gold Exploration Corporation and Alexander H. Perron, and was not independently ascertained by the writer.

LOCATION AND ACCESS

The Iris Group is comprised of 16 patented claims, 2 leased and 12 unpatented mining claims, located in the South East corner of Harker Township and the north/east corner of Elliott Township, Larder Lake Mining Division, Ontario. (Figure 1 - List of Claims).

The property is situated approximately 75 miles east of Timmins, Ontario, and approximately 25 miles north/northeast of Kirkland Lake, Ontario.

Access to the property is provided by Highway 672 that runs approximately 400 meters west of the west side of the Iris Property north/south survey line of CLM399. Throughout the property there are existing four wheeler trails to access the new grid. (See Figures 1a) and 1b).

CLAIMS WORK PERFORMED ON

FIGURE 1

HARKER TOWNSHIP

P-8357

L-802002

CLAIM LOCATION MAP

FIGURE 1a)

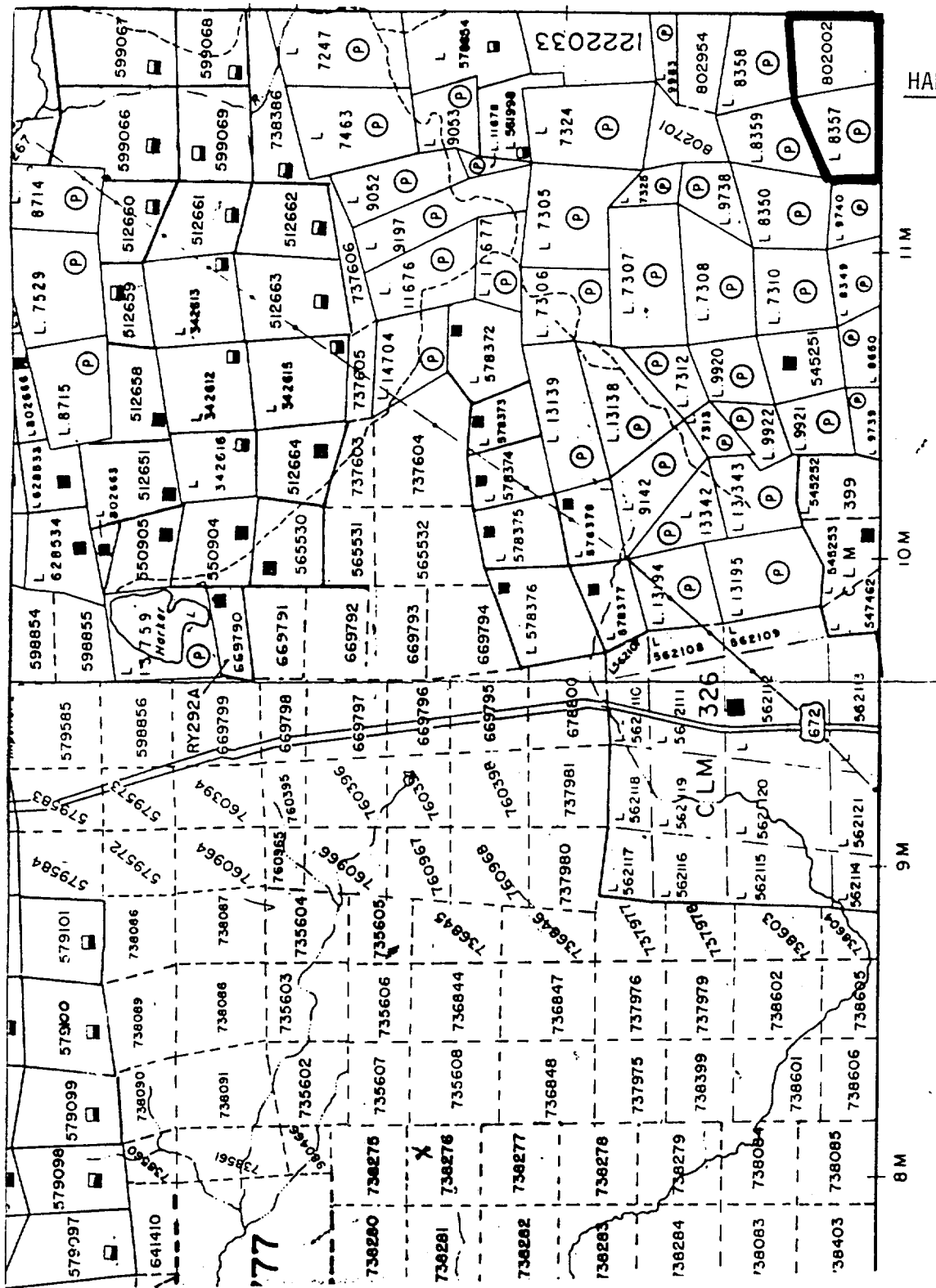

HARKER TOWNSHIP

11M

10M

9M

8M



## REGIONAL GEOLOGY

The Iris Gold claim group is located in the Abitibi Greenstone Belt of the Canadian Shield. This belt is composed of a sequence of meta-volcanic and metasedimentary Archean age rocks that cover an area stretching about 220 miles from Timmins, Ontario, on the west to Val D'Or, Quebec, on the east.

The claims are situated within a sequence of iron rich and magnesium rich tholeiitic basalt flows known as the Kinojevis group (Figure 2). Stratigraphically, this group is about 30,000 feet thick and it occupies the core of a large east plunging synclinorium.

The Iris claim group is underlain by a sequence of tholeiitic basalt flows belonging to the Kinojevis Group. This group is composed of a sequence of iron rich and magnesium rich tholeiitic basalt flows forming a stratigraphic package about 30,000 feet thick. These rocks are overlain by younger, Blake River group calc-alkalic volcanics. Both have been folded into a large, east plunging synclinorium, the northern and southern limbs of which, have been cut by the major Porcupine Destor and Kirkland Lake-Larder Lake fault zones respectively. The Iris Property is situated about 5 miles south of the Destor Porcupine Fault zone near the Kinojevis-Blake River group contact.

## PROPERTY HISTORY

The Iris property comprises 31 patented and/or unpatented mining claims, (Figure 2) in Harker and Elliott Townships, Ontario, all registered in the name of John E. Perron, a principal of the Alberta Gold Exploration Corporation.

## PREVIOUS WORK

The Harker-Holloway area was the centre of mining activity during the 1920's when Harker Gold Mines Ltd. carried out a program of extensive underground development on their Golden Harker property, situated immediately to the north of the Iris claim group. The Golden Harker Mine was closed in 1929.

In 1947, R. Storen examined the Iris property and reported the occurrence of gold mineralization in three separate localities, associated with «rhyolites» interflow horizons (Figure 3).

Vein 1 was exposed in two pits 900 feet apart and it consisted of sheared basalt/rhyolite mineralized with quartz-pyrite-chalcopyrite and galena. The vein was 1.9 feet wide and returned values of 0.29 ozs. per ton AU over 1.7 feet and 0.08 ozs. per ton AU over 1.9 feet.

Vein 2 is similar to vein 1 and returned values of 0.03 and 0.04 ozs. per ton AU over 8 inches and 7.5 inches respectively.

Vein 3 is located about 2,000 feet west of Vein 1 on the same «rhyolite» interflow horizon. It was exposed in two pits and it consisted of a N 70° E near vertical quartz vein containing pyrite, chalcopyrite, galena and visible gold. Assay samples taken from the east and west pits returned values of 0.11 ozs. per ton AU over 14 inches and 0.06 per ton AU over 8 inches respectively.



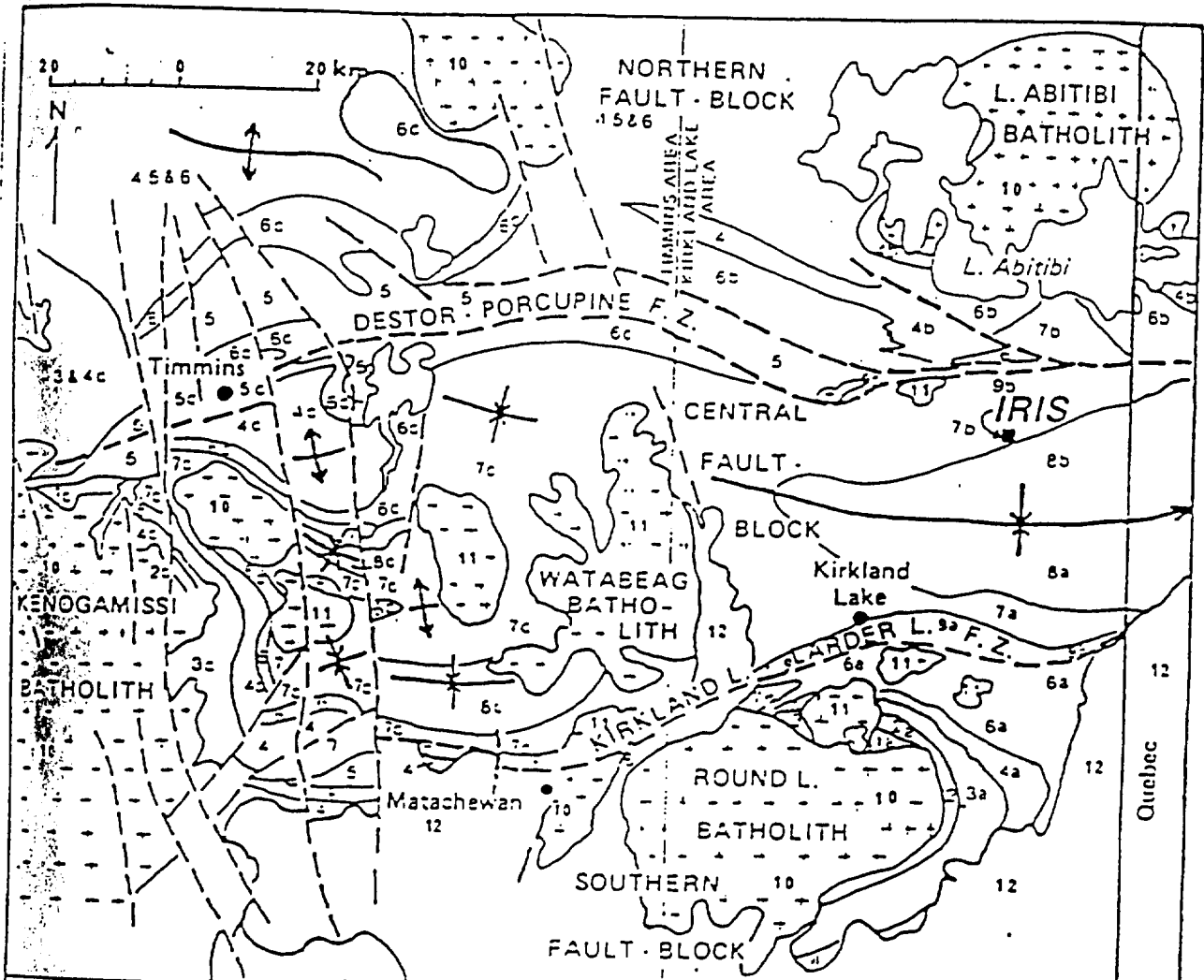

LEGEND

- Proterozoic**
- 12 Keeweenaw diabase (not shown)
  - 12 Cobalt Group
- Archean**
- 12 Matatchewan diabase (not shown)
- Granitic rocks**
- 11 Granodiorite, monzonite, quartz monzonite, syenite
  - 10 Massive to gneissic quartz diorite, tonalite, trondhjemite
- Upper Supergroup**
- 9 9a\* Timiskaming Group, 9b\*\* Destor - Porcupine Complex
  - 6 6a, 6b, Blake River Group, 6c\*\*\* Blake River (Upper Fm., Tisdale Group)
- Lower Supergroups**
- 7 7a, 7b, Kinohew Group, 7c Kinohew Group, (Middle Fm., Tisdale Group)
  - 6 6a Larder Lake Group, 6b Stoughton-Roquemaure Group, 6c Lower Fm., Tisdale Group
  - 5 5c Porcupine Group
- Lower Supergroups**
- 4 4a Skead Group, 4b Hunter Mine Group, 4c Upper Fm., Deloro Group
  - 3 3a Catherine Group, 3c Middle Fm., Deloro Group
  - 2 2a Wabewawa Group, 2c Lower Fm., Deloro Group
  - 1 1a Pascaud tuffs \*\*\*\*

AFTER JENSEN AND LANGFORD (1985)

FIGURE 2

HARKER TOWNSHIP

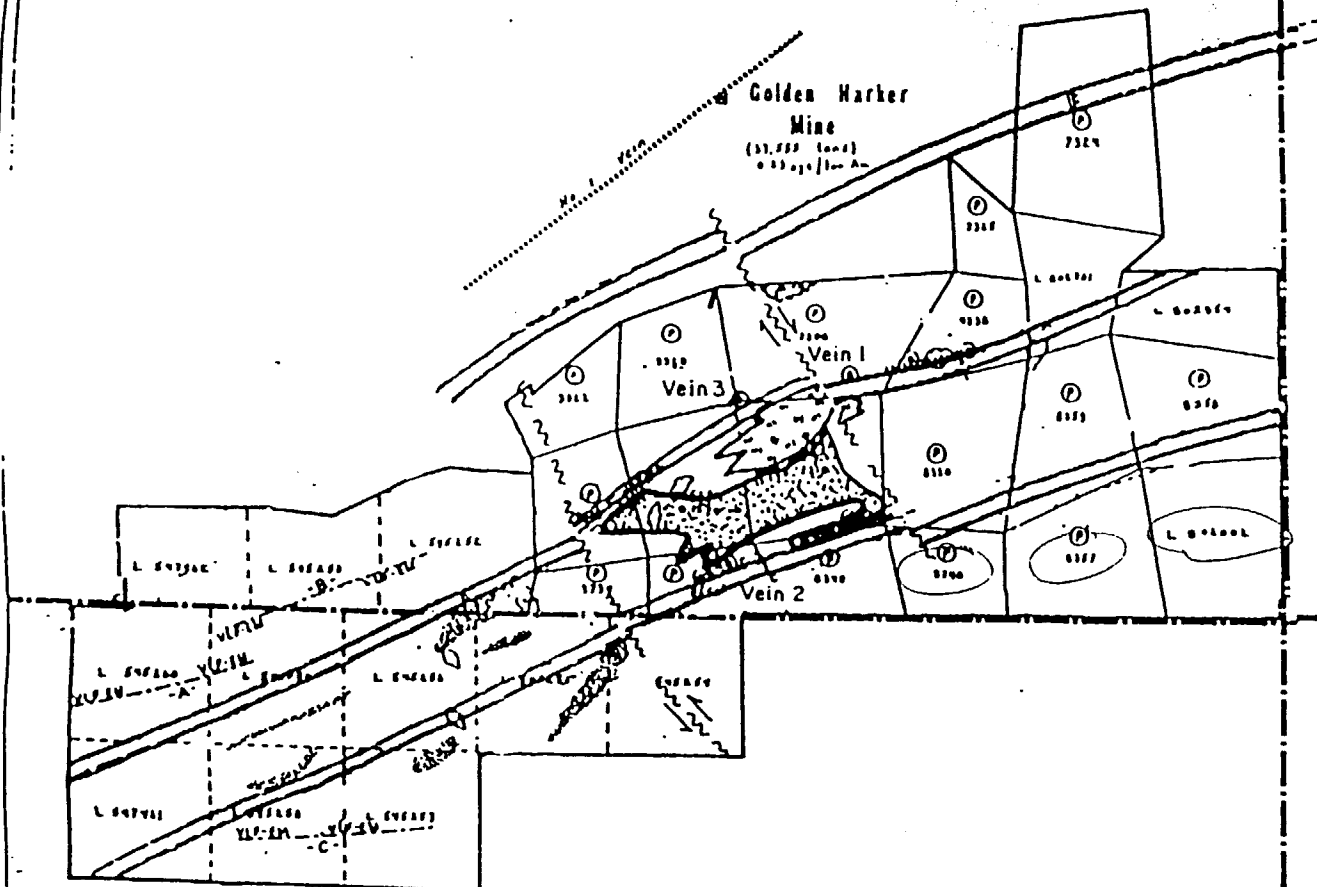

ELLIOTT TOWNSHIP

FIGURE 3



**LEGEND**

- Quartz vein (with associated gold)
- Siliceous Zone
- Granite
- Fault
- Electromagnetic anomaly
- Geochemical anomaly
- Now stripping
- Old trenches
- Old pit workings on showings
- Pyroxenite

**KEY MAP**

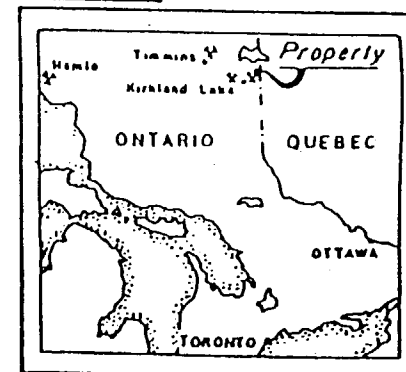

FIGURE 4

The Alberta Gold Exploration Corporation

IRIS GOLD PROPERTY MAP

HARKER GOLD AREA  
LARDER LAKE MINING DIVISION  
DISTRICT OF COCHRANE, ONTARIO

1000 0 1000 2000

Scale: 1 inch to 1000 feet

PERRONS'

Kirkland Lake Canada

Approved by: Alexander Perron

Map No. | Drawn by: Mary Green | Date: June 1985

- 2 b) -

Storen (1947) also reported the occurrence of a wide zone of quartz mineralization in rhyolite on claim L-545251. The quartz contained disseminated pyrite with minor amounts of chalcopyrite and galena. A chip sample from this locality returned a value of 0.01 per ton AU over 5 feet.

In 1985 American Barrick Resources Ltd. announced the discovery of the Holt-McDermott deposit containing reserves of 2.8 million tons averaging 0.197 ozs. per ton AU. This announcement coupled with encouraging news from companies exploring other properties in the area helped intensify exploration efforts in the whole region. Recently, Canamax Resources Ltd. completed an underground exploration and development program on their East Zone property with a view to achieving production during 1988. Lenora Explorations Ltd., one of the Kasner Group of companies is in the midst of a substantial underground exploration program on their golden Harker property which adjoins the Iris claim group immediately to the north. They have increased the reserves on the property and discovered new mineralized zones which are undergoing intensive evaluation.

#### PRESENTATION AND DISCUSSION OF RESULTS:

The field data is presented on Map No. IR31/2001/GEO at a scale of one inch to two hundred feet, found at the back of this report. An Assessment Data form has been completed and is also at the back of this report.

In the summer and fall of 2000 a new north/south grid was established, at that time 1 VLF station and a magnetometer survey were carried out. It was noticed (in the above survey) a number of outcrop showings not noted in the 1985 report on the Elliott North Group in Elliott Township. The month of March 2001, a timbering operation occurred over the properties. Due to the timbering operations and new bush trails into the properties, it was decided on to look closer at the outcrop showings in Claim L-802002 and Claim P-8357.

#### TOPOGRAPHY

Over half of the ground in low lying alder swamps or thick second growth of poplar, spruce and red pine.

In Claim L-802002 a large drainage creek flows south into a large beaver pond system.

Over three quarters of the area was timbered in March of 2000.

#### GEOLOGICAL MAPPING

In this survey the outcrops studies were of two distinct volcanic lithology, 1 - Magnesium rich tholeiites  
2 - Iron rich tholeiites  
classified as the early Precambrian (Archean) volcanic rocks.

Fe-rich tholeiites dominated the outcrop showings. They were generally massive dark green to black (in colour), fine grained flows, that are magnetic.

The pillowing is more developed than the Mg-rich tholeiites with a general strike of N70°-80°/75°-80°S and steep south dip.

Mg-rich tholeiites are generally fine grained aphanitic with minor porphyritic phases. Pillows development is poor and strike orientation could not be derived with any certainty from these flows.

P-8357 is located south of the #2 Rhyolite Zone. On either side of the rhyolite, faults or shear zones have formed which from the limited exposure available to vary in width and intensity along strike.

It is at these locations that either quartz veins or quartz filled breccia occurs.

In claim L-802002 in the southeast section of this survey sampling (grab samples) were taken in the area of quartz veins or quartz filled breccia.

#### CONCLUSIONS AND RECOMMENDATIONS

The grab samples have been sent to be assayed, and the new East/West grid over the Iris-31 is being completed.

Respectfully submitted,



December 14, 2001

Miss Wendy K. Weller  
Geotech

# Assessment Data Form

## Type of Work:

Prospecting: ..... Geological: DETAILED GEOLOGY.....  
 Physical: .....  
 Geophysical: .....  
 Geochemical: ..... Drilling: .....  
 Assays/Analyses: ..... Other work: .....

Cost of Work: \$1,276.00.....

Dollars Applied: \$1,276.00.....

Recorded Holder: GWEN  
 Name: THE ALBERTA GOLD EXPLORATION CORP. RESOURCES LTD.

Survey Company:  
 Name: GWEN RESOURCES LTD.

Address: 103 GOVERNMENT ROAD EAST,  
 KIRKLAND LAKE, ONTARIO P2N 1A9

Address: 103 GOVERNMENT ROAD EAST,  
 KIRKLAND LAKE, ONTARIO P2N 1A9

## Survey/Report Information:

Start of work: DECEMBER 9, 2001..... End of work: DECEMBER 12, 2001.....  
 Draughting time: DECEMBER 12, 2001..... Report time: DEC. 13, 14, 2001.....  
 Completion of report: DEC. 14, 2001..... Author: MISS WENDY K. WELLER.....

Work performed on claim(s).....

P-8357, L-802002.....

Work applied to claim(s).....

L-737276, L-737277, L-737278, L-737279, L-737283.....

Persons who performed work (supervisor first):.....

GWEN RESOURCES LTD......

WENDY K. WELLER.....

BIBLIOGRAPHY

- Storen, R. 1947
- Satterly, J. 1952
- Drummond, A.D. 1987
- Jensen, L.S. 1986
- D. R. Hawke, 1988
- Workman, Al. 1988
- Weller, Miss Wendy K.  
July 24, 2000
- Weller, Miss Wendy K.  
August 24, 2001
- Preliminary Report of Iris Gold Mines Ltd., Harker Township, Larder Lake Mining Division, Province of Ontario, private engineers report.
  - Geology of Harker Township; 60th Annual Report of the Ontario Department of Mines, Vol. LX, Part VIII, 1951.
  - Report on The Winter 1986-1987 Drill Program, 31 Claim Iris Gold Group: a private report for The Alberta Gold Exploration Corporation.
  - Mineralization and Volcanic Stratigraphy in The Western Part of the Abitibi Subprovince: Ontario Geological Survey, Misc. Paper 129.
  - Report on the 1988 Exploration Program Iris Joint Venture Project NTS 32D/5.
  - Evaluation Report.
  - Geophysical Survey Report on The Iris Property Magnetometer & Electromagnetic Surveys Harker & Elliott Townships, Larder Lake Mining Division, District of Cochrane, Ontario
  - Geology Survey Report on The Iris 10 & Patents, East Half, Harker & Elliott Townships, Larder Lake Mining Division District of Cochrane, Ontario

C E R T I F I C A T E

I, Wendy K. Weller, of Kirkland Lake, Ontario, do hereby certify:

- 1) That I am a Geotech in Training and reside at:  
71 Second Street, Apartment #2, Kirkland Lake, Ontario.  
P2N 1R6.
- 2) That I graduated from the Haileybury School of Mines as a certified Diamond Driller in 1982. I have had a staking licence for the past 11 years.
- 3) That I was employed as a Diamond Driller for Heath & Sherwood for 1 year.
- 4) That I have been practising as a Geotech Trainee for a period of eleven (11) years and I am qualified to write this report.
- 5) That I supervised and participated in this survey.

Dec 14/01  
Date

Wendy K. Weller  
Wendy K. Weller  
Geotech





Date: 2002-JAN-14

GEOSCIENCE ASSESSMENT OFFICE  
933 RAMSEY LAKE ROAD, 6th FLOOR  
SUDBURY, ONTARIO  
P3E 6B5

WENDY KATHLEEN WELLER  
THE ALBERTA GOLD EXPLORATION CORPORATIC  
103 GOVERNMENT ROAD EAST  
KIRKLAND LAKE, ONTARIO  
P2N 1A9 CANADA

Tel: (888) 415-9845  
Fax:(877) 670-1555

**Submission Number:** 2.22578  
**Transaction Number(s):** W0180.31248

Dear Sir or Madam

**Subject: Approval of Assessment Work**

We have approved your Assessment Work Submission with the above noted Transaction Number(s). The attached Work Report Summary indicates the results of the approval.

At the discretion of the Ministry, the assessment work performed on the mining lands noted in this work report may be subject to inspection and/or investigation at any time.

If you have any question regarding this correspondence, please contact STEVEN BENETEAU by email at [steve.beneteau@ndm.gov.on.ca](mailto:steve.beneteau@ndm.gov.on.ca) or by phone at (705) 670-5855.

Yours Sincerely,



Ron Gashinski  
Senior Manager, Mining Lands Section

**Cc:** Resident Geologist

Gwen Resources Ltd.  
(Claim Holder)

Starmin Mining Inc.  
(Claim Holder)

The Alberta Gold Exploration Corporation  
(Assessment Office)

Assessment File Library

John Edward Perron  
(Claim Holder)

The Alberta Gold Exploration Corporation  
(Claim Holder)



MINISTRY OF  
NORTHERN DEVELOPMENT  
AND MINES  
PROVINCIAL MINING  
RECORDERS OFFICE

**MINING LAND TENURE  
MAP**

Date / Time of Issue Dec 11 2001 10:00h Eastern

TOWNSHIP / AREA PLAN  
HARKER G-3643

**ADMINISTRATIVE DISTRICTS / DIVISIONS**

Mining Division Larder Lake  
Land Titles/Registry Division COCHRANE  
Ministry of Natural Resources District KIRKLAND LAKE

**TOPOGRAPHIC**

- ▲ Administrative Boundary
- Township
- Concession Lot
- Private Road
- Easement
- Fences
- Fences - Approx. Location / Direction
- Spot
- Mine
- Pipeline
- Road
- Trail
- National Grid Feature
- Hydro Line
- Communication Line
- Wooded Area
- Mine - (Not a Concession / Not a Mine Claim)

**LAND TENURE**

- Freehold Status
  - Surface And Mining Rights
  - Surface Rights Only
  - Mining Rights Only
- Leasedhold Status
  - Surface And Mining Rights
  - Surface Rights Only
  - Mining Rights Only
- Licenses of Occupation
  - Leasehold Surface
  - Surface And Mining Rights
  - Surface Rights Only
  - Mining Rights Only
- Other
  - LRD Mine Lease
  - Crown Lease
  - Water Power Lease Agreement

**LAND TENURE WITHDRAWALS**

- Area Withdrawal from Disposition Mining Act (Withdrawal Type)
  - Surface And Mining Rights
  - Surface Rights Only
  - Mining Rights Only
  - Other (In Certain Withdrawal Types)
  - Surface And Mining Rights
  - Surface Rights Only
  - Mining Rights Only
- No IMPORTANT NOTICES

**LAND TENURE WITHDRAWAL DESCRIPTIONS**

Ministry	Type	Date	Description
3384	Wm	Jan 1 2001	60017 SURFACE RIGHTS RESERVATION ALONG THE SHORES OF ALL LAKES & RIVERS
3387	Wm	Jan 1 2001	LAND USE PERMIT NO. 111138 PENDING APPLICATION UNDER PUBLIC LANDS ACT
3485	Wm	Jan 1 2001	NO OVER GROUND
3341	Wm	Jul 26 2001	SEC. 43.73 367771 S.A.O. 14650

**IMPORTANT NOTICES**

Areas under which special regulations, restrictions or conditions exist that affect normal prospecting, staking and mineral development activities.

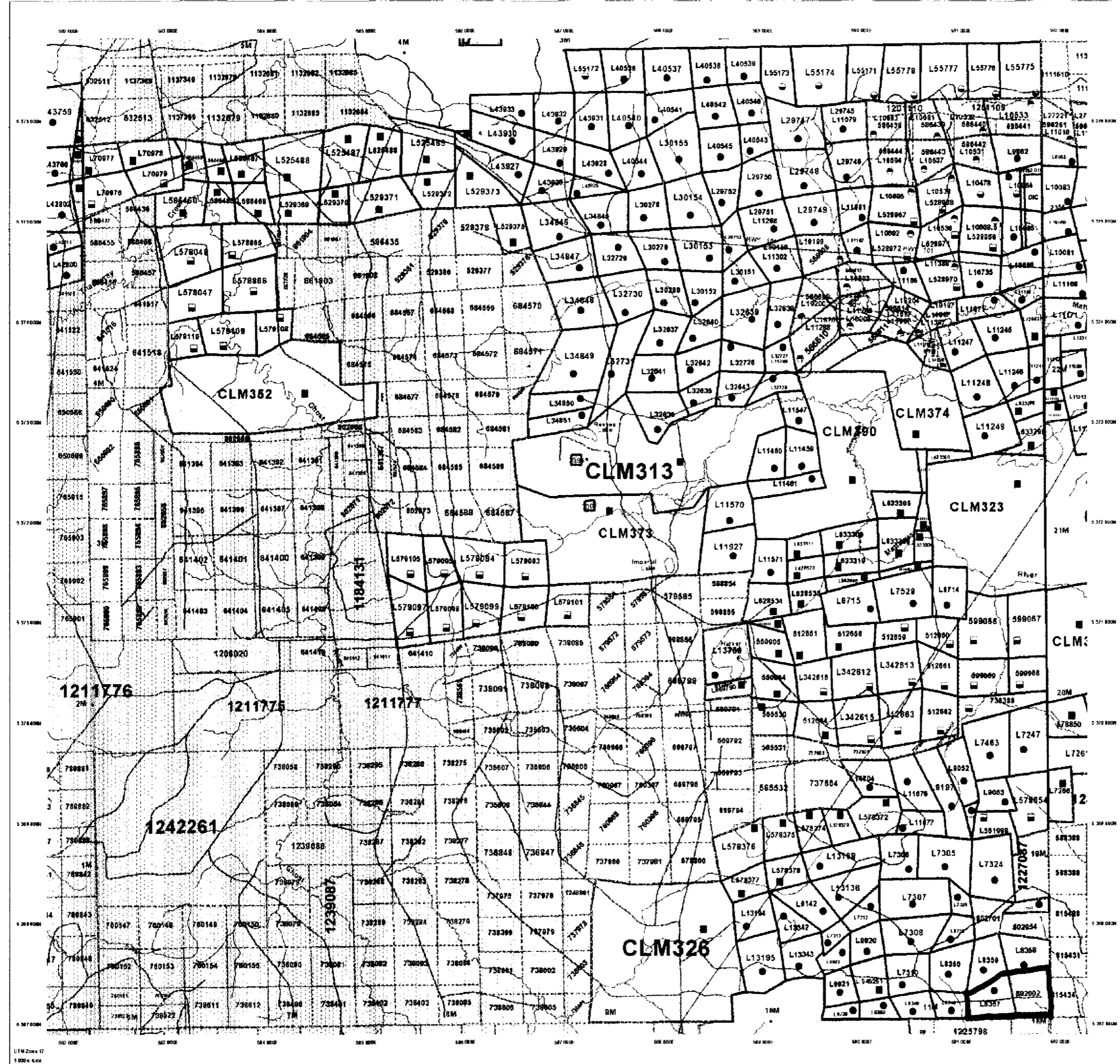

32D05NW2107 HARKER 2.22576

Those wishing to stake mining claims should consult with the Provincial Mining Records Office of the Ministry of Northern Development and Mines for additional information on the status of the lands shown herein. This map is not intended for navigation, survey or land title determination purposes as the information shown on this map is compiled from various sources. Crown-owns and accuracy is not guaranteed. A detailed description may be obtained through the local title office or the Ministry of Natural Resources.

The information shown is derived from digital data available to the Provincial Mining Records Office of the Ministry of Northern Development and Mines.

**General Information and Limitations**

Copyright © 2001, Ministry of Northern Development and Mines, Ontario  
 Provincial Mining Records Office, 100 King Street West, Toronto, Ontario M5X 1C6  
 905-947-3800 (toll-free) Fax: 905-947-3800  
 905-947-3800 (local) Fax: 905-947-3800  
 905-947-3800 (toll-free) Fax: 905-947-3800

This map may not show all additional land tenure and interests in land including certain joint tenancy, leases, easements, right of way, the right to the surface, or other forms of encumbrance of rights and interests from the Crown. Users should consult the relevant records or provide to the Ministry of Northern Development and Mines for a more detailed map.

**SYMBOLS**

Claim post	Claim line
Township line	Hydro line
Access road	Trail
Outcrop	Vegetation boundary

**LEGEND**

**CENOZOIC**

**PLEISTOCENE**  
Sand, Gravel, Clay, Peat

**MAFIC VOLCANICS**

**KINOJEVIS GROUP**

MO THOLEIITE	a undivided
FE THOLEIITE	b fine grained
	c pillowed
	d flow top breccia
	e ash tuff
	f tuff breccia
	g diabasic
	h rhyolite

**IRIS GROUP**  
**GEOLOGICAL SURVEY**  
HARKER TWP.

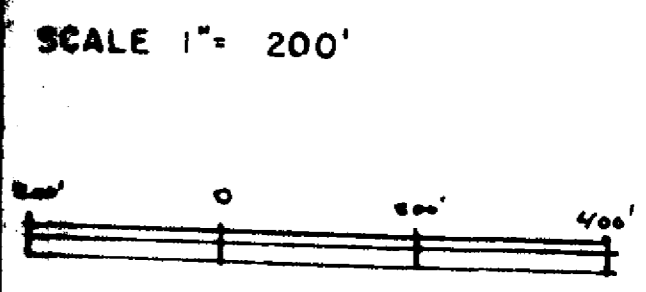

Report by **WK Weller**

MAP NO. *W.K. Weller*

DATE

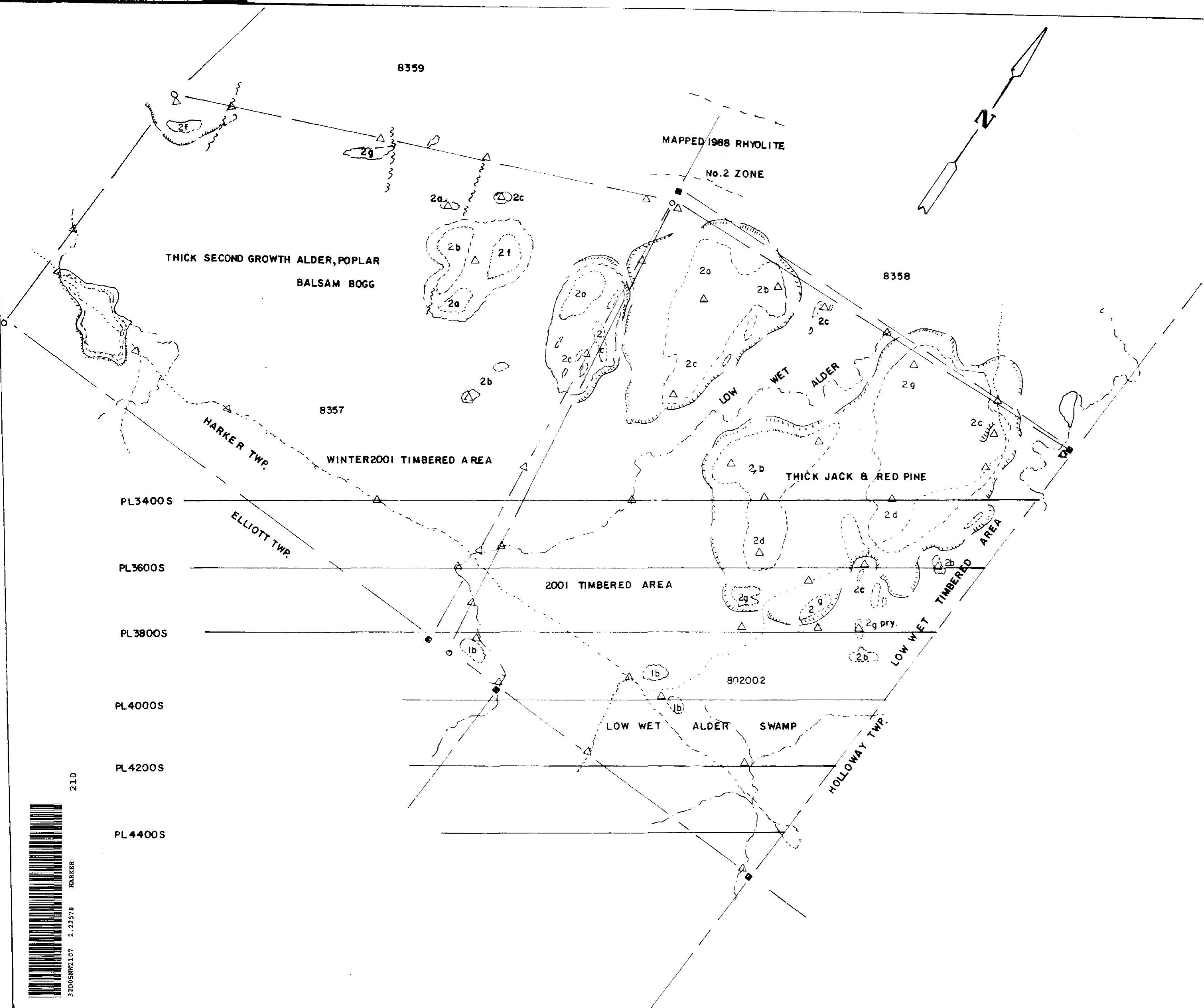

210

32D05NW2107 2.22578 HARKER