

DIAMOND DRILLING



010

TOWNSHIP: Ben Nevis

REPORT No.: 17

WORK PERFORMED BY: Goldmac Explorations <sup>Inc</sup> Ltd.

<u>CLAIM No.</u>	<u>HOLE No.</u>	<u>FOOTAGE</u>	<u>DATE</u>	<u>NOTE</u>
L 544467	BN82-1	237.0	July/82	(1)
L 544468	BN82-2	211.0	July/82	(1)
	BN82-3	104.0	July/82	(1)
	BN82-4	312.0	July/82	(1)
	BN82-5	405.0	July/82	(1)
		<u>1269.0</u>		

NOTES: (1) #287-82

Ben Nevis

29100

DRAWING: N30W

DIP: -15

DATE: July 19/82

COM. TIME: 1.5 hrs

SHEET: 1 of 2

H.D.

H.D.

DRILL BY: Merksby Diamond Drilling Co Ltd

DEPTH: 200

LOG: Core L 544467 - 160' N of #2 Post

LOG: 11:16

DEPTH	LITHOLOGY	SAMPLE INTERVALS	SAMPLE No.	WIDTH Ft.	ASSAY DATA	
					Gr. A.	Gr. B.
0-11	Casing					
20.5	Rhyolite Agglomerate - many dark streaks fair py	11 - 20.5	2066	9.5	NIL	NIL
23.5	Dacite					
52	Rhy Aggl - py mostly around large (6") frags	23.5 - 32	2067	9.5	NIL	NIL
		32 - 42	2068	10.0	NIL	NIL
		42 - 52	2069	10.0	NIL	NIL
55	Dacite - no mineral					
78	Rhy Aggl	55 - 62	2070	7.0	NIL	NIL
		62 - 72	2071	10.0	NIL	NIL
		72 - 78	2072	6.0	NIL	Tr
109.7	Diabase					
162	Rhy Aggl	109.7 - 117	2073	7.3	NIL	NIL
		117 - 122	2074	5.0	NIL	NIL
		122 - 127	2075	5.0	NIL	NIL
		127 - 132	2076	5.0	NIL	NIL
		132 - 137	2077	5.0	.001	Tr
		137 - 142	2078	5.0	.001	Tr
		142 - 147	2079	5.0	NIL	0.33
		147 - 152	2080	5.0	.003	0.61
		152 - 157	2081	5.0	.019	2.96
		157 - 162	2082	5.0	.015	1.96
174.5	Dacite - clay alt. - F. gr. tuffaceous, fair mineral	162 - 167	2083	5.0	.001	0.26
		167 - 174.5	2084	7.5	.002	0.4
187	Dacite Breccia - pinkish color, hard, siliceous	174.5 - 187	2085	12.5	.005	0.10
		187 - 197	2086	10.0	.012	Tr

187.0  
15.0

Ben Nevis Twp. PROPERTY: Goldmac Explorations Inc.

LATITUDE :	BEARING:	DIP:	STARTED:	COMPLETED:	HOLE NO. B1 02-1
DEPARTURE:	V.D.	H.D.	DRILLED BY:		Sheet 2 of 2.
ELEVATION:	LOCATION:				DEPTH:
					LOGGED BY:

FOOTAGE	SAMPLE FOOTAGES	SAMPLE No.	WIDTH FT.	ASSAY DATA					
				Gr Au	Gr Ag				
	197 - 207	2087	10.0	.006	TR				
	207 - 217	2088	10.0	.003	NIL				
	217 - 227	2089	10.0	.005	NIL				
	227 - 237	2090	10.0	.003	NIL				
END OF HOLE									

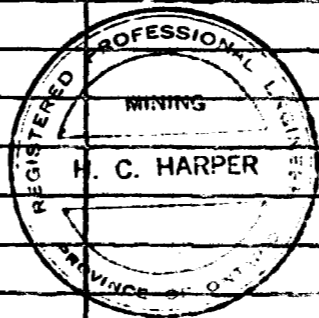

*H. C. Harper*

Ben Nevis Township      PROPERTY: Goldmac Explorations Inc.      HOLE NO. BNCB-2

LATITUDE: L 0+50 N      BEARING: N 30 W      DIP: -45      STARTED: July 13/82      COMPLETED: July 14/82

DEPARTURE: 1+00 E      V.D.      H.D.      DRILLED BY: Markstay Diamond Drillers      DEPTH: 211

ELEVATION:      LOCATION: Claim L 544 468 - 30'E & 190'N of #3 Post.      B.Q.      LOGGED BY: Harper

FOOTAGE	DESCRIPTION	SAMPLE FOOTAGES	SAMPLE No.	WIDTH FT.	ASSAY DATA										
					Ox Au	Ox Ag									
0-2	Casing														
19.5	Rhyolite Agglomerate - very coarse qtz frags surrounded by white mica & py	1-12	2050	11.0	NIL	NIL									
		12-19.5	2051	7.5	NIL	Tr									
42	Dacite - pale green - some py														
54	Rhyolite Agglomerate - abundant py & white mica	42-54	2052	12.0	.011	.47									
73	" " - less siliceous - dacite interbeds														
	less mineral	62-72	2053	10.0	.019	.37									
117	Diabase														
211	Agglomerate - partly carbonated - scatt py around frags & to a lesser degree in spars from 162' - Zone of increasing carb & less py	132-142	2054	10.0	.005	.09									
		162-172	2055	10.0	NIL	NIL									
	very low mineral strong carb	182-192	2056	10.0	NIL	NIL									
END OF HOLE															

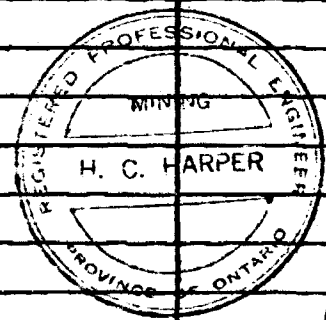

H. C. Harper

Bed Nevie Township      PROPERTY: Goldmac Explorations Inc      HOLE NO. BN 82-3  
 LATITUDE: L100N      BEARING: N30W      DIP: -45      STARTED: July 11/82      COMPLETED: July 12/82  
 DEPARTURE: 1+00E      V.D.      H.D.      DRILLED BY: Markstay Diamond Drillers      DEPTH: 104'  
 ELEVATION:      LOCATION: 1/2 in L 544468 - 70'E + 220' N of #3 Post.      B.Q.      LOGGED BY: Harper

FOOTAGE	DESCRIPTION	SAMPLE FOOTAGES	SAMPLE No.	WIDTH FT.	ASSAY DATA		DATA	
					GRAV	AG		
0-19	Casing							
85	Dacite - heavily carbonated. Fractured at CA 30 Scott py in seams. PHS.	19-25	2045	6.0	.039	.21		
		25-29	2046	4.0	.086	.22		
		29-35	2047	6.0	.009	TF		
		35-45	2048	10.0	.002	TF		
		45-55	2049	10.0	TF	NIL		
104	Diabase dike - fractured. LOST HOLE							
	END OF HOLE							

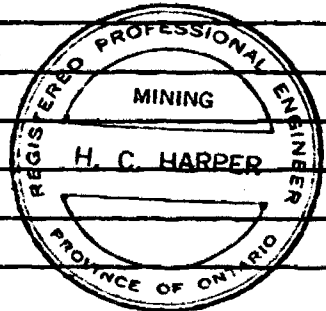

H. C. Harper



PROPERTY: *Goldmac Explorations Inc.*

HOLE NO. *BN 82 1*  
 Sheet 2 of 2  
 DEPTH:  
 LOGGED BY:

LATITUDE : BEARING: DIP: STARTED: COMPLETED:  
 DEPARTURE: V.D. H.D. DRILLED BY:  
 ELEVATION: LOCATION:

FOOTAGE		SAMPLE FOOTAGES	SAMPLE No.	WIDTH FT.	ASSAY DATA					
					Gr. Au	Gr. Ag				
<i>187-206</i>	<i>Agglomerate - py around &amp; thru' frags thyo litic</i>	<i>187-192</i>	<i>2035</i>	<i>5.0</i>	<i>.005</i>	<i>Tr</i>				
		<i>192-197</i>	<i>2036</i>	<i>5.0</i>	<i>.004</i>	<i>Tr</i>				
	<i>extremely siliceous</i>	<i>197-202</i>	<i>2037</i>	<i>5.0</i>	<i>Tr</i>	<i>0.22</i>				
		<i>202-206</i>	<i>2038</i>	<i>4.0</i>	<i>Tr</i>	<i>NIL</i>				
<i>242</i>	<i>Diabase</i>									
<i>312</i>	<i>Agglomerate</i>									
	<i>sections heavily carbonated.</i>	<i>247-252</i>	<i>2039</i>	<i>5.0</i>	<i>.002</i>	<i>NIL</i>				
	<i>py in fractures &amp; around frags</i>	<i>252-257</i>	<i>2040</i>	<i>5.0</i>	<i>Tr</i>	<i>NIL</i>				
		<i>257-262</i>	<i>2041</i>	<i>5.0</i>	<i>NIL</i>	<i>NIL</i>				
		<i>262-272</i>	<i>2042</i>	<i>10.0</i>	<i>NIL</i>	<i>NIL</i>				
		<i>272-282</i>	<i>2043</i>	<i>10.0</i>	<i>NIL</i>	<i>NIL</i>				
		<i>282-292</i>	<i>2044</i>	<i>10.0</i>	<i>NIL</i>	<i>NIL</i>				
<i>END OF HOLE</i>										

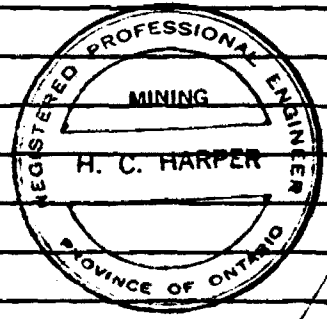

*H. C. Harper*

Ben Nevis Twp. PROPERTY: Goldmac Explorations Inc. HOLE NO. BN 82-5  
 LATITUDE: L 3700 N BEARING: N30 W DIP: -45 STARTED: July 21/82 COMPLETED: July 23/82 Sheet 1 of 2  
 DEPARTURE: 2+50 E V.D. H.D. DRILLED BY: Markstay Diamond Drillers Co Ltd DEPTH: 405.  
 ELEVATION: LOCATION: Claim L 544+168 -220' N & 320' E of #3 Post B.O. LOGGED BY: Harper.

FOOTAGE		SAMPLE FOOTAGES	SAMPLE No.	WIDTH FT.	ASSAY DATA					
					As Ar	As A				
0-10	Casing									
29	Rhyolite Agglomerate									
33	Dacite - grey, f. gr. chl. blebs									
117	Rhyolite Aggl + interbedded tufts - minor sulphides									
	55-110 Zone of leached Fault Seam									
128	Dacite - 25 above.									
	125' Fault Zone leached.									
156	Rhyolite - 25 above									
	147' - Fault Zone leached	149.5-152.4	2057	2.9	.004	NIL				
	156 - Fault Zone									
160	Dacite									
237.5	Aggl + Tuff interbeds, talcy, carbonated, dacite & rhy.	179-185	2058	6.0	.004	NIL				
	fractures increasing with py 25 f.f. dark streaks	185-195	2059	10.0	NIL	0.10				
	increasing	195-205	2060	10.0	.002	NIL				
		205-215	2061	10.0	NIL	0.10				
		215-225	2062	10.0	.004	Tr				
		225-230	2063	5.0	.001	Tr				
		230-235	2064	5.0	NIL	Tr				
		235-237.5	2065	2.5	NIL	Tr				
275	Diabase									
300	Mineralized Zone - very siliceous, abundant py.	275-280	2091	5.0	.006	2.05	} 1.81 As 2.00'			
	some clay or sericite alt <sup>n</sup>	280-285	2092	5.0	.004	3.63				
		285-290	2093	5.0	.002	0.99				
		290-295	2094	5.0	.001	0.57				
		295-300	2095	5.0	Tr	NIL				



Ben Nevis Twp.

PROPERTY: Goldmac Explorations Inc.

HOLE NO. P.N 82-5

LATITUDE :

BEARING :

DIP :

STARTED :

COMPLETED :

Sheet 2 of 2

DEPARTURE :

V.D.

H.D.

DRILLED BY :

DEPTH :

ELEVATION :

LOCATION :

LOGGED BY :

FOOTAGE	SAMPLE FOOTAGES	SAMPLE No.	WIDTH FT.	ASSAY DATA					
				Disc Au	Disc Ag				
300 - 310	Rhyolite Agglomerate - neg sulphides, very silic. large frags								
	335 to 350 25 above but with sparse sulphides								
		315 - 320	2096	5.0	NIL	NIL			
		335 - 340	2097	5.0	NIL	NIL			
		340 - 345	2098	5.0	NIL	NIL			
		345 - 350	2099	5.0	NIL	NIL			
	350 - to end - rhy aggl - very sparse sulphides								
		375 - 380	2100	5.0	NIL	NIL			
	END OF HOLE								

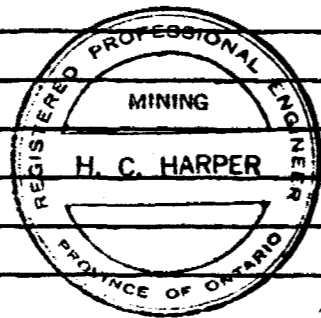

*H. C. Harper*

1911

4 M



32005SE0046 17 BEN NEVIS

900

#287-82

Ben Nevis twp

M325

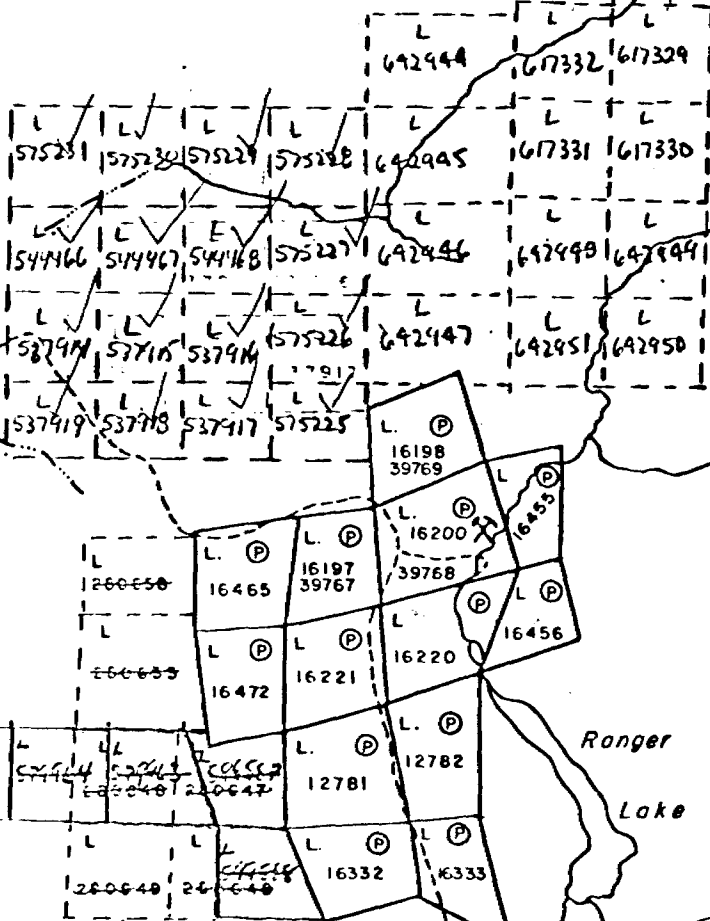

Duralia L.

JOHN E. JACKSON 1911

5M

4M

3M

2M

1M

Stuart Lake

Ranger Lake

Lake

Shubat L.

Pushkin Lake

Lake

Captain Lake

GRAVEL  
FL. 150420  
62

Little Misema R.

Pontiac Twp. (M.382)

PATE  
CRO  
LEAS  
LOC  
LICE  
MIN  
SUR  
ROA  
IMPE  
KING  
RAIL  
POW  
MAR  
MIN  
CAN  
TRA

400  
shc

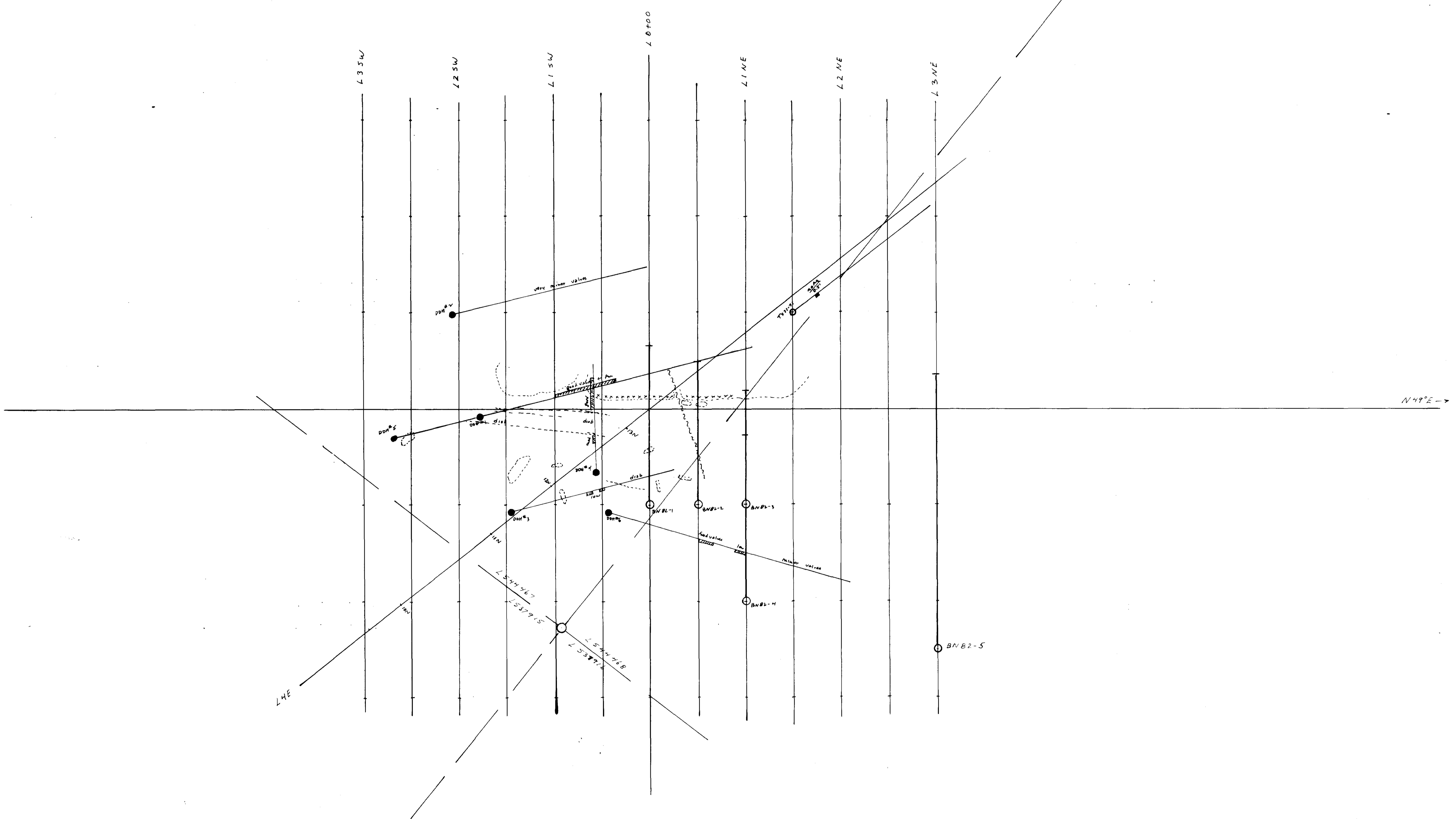
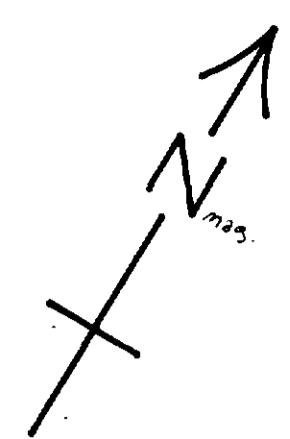

DDM#1  
1984 drill program

DDM#1  
1982 drill holes

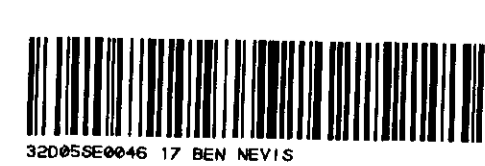

200



GOLDMAC EXPLORATIONS INC.  
BEN NEVIS TOWNSHIP  
DIAMOND DRILL PLAN



SEP 15 1982

H. G. Harper