

DIAMOND DRILLING



32D05SE0070 15 BEN NEVIS

010

TOWNSHIP: Ben Nevis

REPORT No.: 15

WORK PERFORMED BY: P. J. Roche

<u>CLAIM No.</u>	<u>HOLE No.</u>	<u>FOOTAGE</u>	<u>DATE</u>	<u>NOTE</u>
L.76642	1	350'	Jan-Feb/64	
	2	300'	Feb/64	
	3	253'	Feb/64	
	4	174'	Feb/64	
	5	542'	Feb/64	
	6	352'	Feb/64	

NOTES:

DIAMOND DRILL RECORD

Sheet No. 1

PROPERTY: Prober - Pete Roche Option

LOCATION: Ben Nevis Twp., Ont.

HOLE No.: Prober F-64-1

LENGTH: F-64-1 38

LATITUDE: 1-00' S

STARTED: 2003 Dec/1964

BEARING:

DEPARTURE: 0-0'

FINISHED: Feb. 2nd/1964

DIP: COLLAR: 45 degs

ELEVATION:

PURPOSE: To test min. zone west of trench

150' 40 degs
300' 38 degs

LOGGED BY: G.E.M.

FOOTAGE	DESCRIPTION	NO.	WIDTH IN FT.	GOLD OZS.	ASSAYER	REC. No.
0.0-34.0'	Casing					
34.0-41.2	Cherty fragmental-white massive-closely packed					
41.2-48.7	Feldspar Porphyry-dark grey groundmass-irreg. contacts massive-cut by a few Qtz. carb. strgs.					
48.7-122.0	Cherty Fragmental-massive, fairly closely packed-numerous hairline fractures-some with carb. soft yellowish green or dark (ash) filling around frags.-sl. scattered fine py. 101.5-112.7-more fractured around 50° to core incident sericite or slips developed 121.0-122.0-several fine strgs. of py with low pbs.					
122.0-129.5	Mineralized Zone-more alteration, some carb, often as large strgs.-less closely spaced frags.-filling more altered-greyish with odd greenish or pinkish alteration-mineralized with fine and coarser (1/8") py-coarser often associated with Qtz. in filling around frags.-sheared and in places schistose though fairly massive-slips around 50-55 degs. to core. 122.0-124.6-F.W.M. py in filling and in strgs 124.6-129.5-1st 1.4' low min-rest W.M.py-little pbs-surrounding frags & in strgs.	12 13	2.6 4.9	0.01	2.32	0.24 0.53
129.5-131.6	Diorite(?) much altered, carb.-light green-fine grained					
131.6-212.8	Mineralized Zone- more more tuff-more schistose -55° 131.6-134.8-fair py. with pbs-around frags and on many fine x-fractures 134.8-137.8-fair py on many fine x-fractures 137.8-142.8- " " with pbs-patchy & finely disseminated 142.8-147.4- as above	14 15 16 17	2.7 5.3 5.0 4.8	0.04	2.50 1.68 4.26 4.16	0.64 0.75 0.25 0.05
						1.81

RECORDED
REC. No.

FOOTAGE	DESCRIPTION	NO.	WIDTH IN FT.	GOLD OZS.	AG		C	
					0.25 COPPER	pb	zn	g
	147.4-152.4-fair to good min-more finely fract.coarse & fine py with pbs	18	5.0		1.68	0.04		0.04
	152.4-155.4-fair min-mainly in strgs-some greenish alter.-	24	3.2		0.72	0.01		
	155.4-158.5 fair min,mainly in strgs with qtz.	25	3.1		0.70	0.01		
	158.5-163.3-more fract- good min-patchy coarser py often with qtz filling & strgs-fine py in strgs.-some green & pink alteration of tuff filling-some fine dark specks in altered rock	19	5.0	Tr.	0.22	0.01		0.78
	165.3-167.3-lesser more scattered min							
	167.3-169.3- good py coarse & disseminated	20	2.6		0.70	0.03		
	169.3-173.3- good py-mainly patchy-50 sect. altered pinkish with fine hairline min. fractures	21	3.3		0.04	0.02		
	173.3-175.0- low scattered min							
	175.0-182.4- fair py-patchy & in strgs.some pbs	22	3.4	Tr.	0.04	0.02		
	182.4-216.0-low scattered min-less coarser more fine py-shears around 60 degs.							
	216.0-218.3-w.m. patchy py-odd speck opy. some fine dks. py-some pink alteration	23	2.3	0.02	0.24	0.04		1.41
218.3-273.0-	Cherty Fragmental-becoming more altered& greenish (epi- dote-more massive-though sheared- slips at 55 degs.-many fine qtz. carb. strgs-low scattered min.							
273.0-274.0	Mineralized Zone-2 nd section w.m. py & good pbs-rest fair py-some bluish min (?)	26	0.6		0.32			
274.0-350.0	Cherty Fragmental--fairly massive-less greenish-low scattered min.							

E N D

RECORDED JUN 18 1954
REC. NO.

DIAMOND DRILL RECORD

Sheet No. 1

PROPERTY: Epoch-Pete Soche Option LOCATION: Ben Nevis Twp., Ont.

HOLE No: F-64-2 LENGTH: 300 feet LATITUDE: 1-05' south

STARTED: Feb. 3rd, 1964 BEARING: N 20° E DEPARTURE: 1-00 W

FINISHED: " 6th, 1964 DIP: COLLAR: 45 degs ELEVATION: _____

PURPOSE: To test for extension to the west of mineralized zone 150 44" 300 40" LOGGED BY: G.E. Moody

FOOTAGE	DESCRIPTION	NO.	WIDTH IN FT.	GOLD OZS.	% COPPER
0.0-7.0 7.0-205.0	Casing Cherty Fragmental-fairly massive though schistose slips at 50 to 60 degs.-greyish with greenish alteration-odd rusty slip-neg. min.-lacks fine x fract.as in No.1 0-18.0- many oxidized slips-neg. py 116.0-124.0-much altered-neg. min. 126.5-talcose slip at 15 degs. 152.0-163.0-carner-finer and fewer frags. so groundmass shows up more 191.4-196.3-low patchy py.				
205.0-220.2	Mineralized Zone- shears & schistosity 50-60 degs. sections of mineralization. -no pbs or zns noticed. 205.0-207.5-low py on slips 207.3-208.3- 0.7' heavy py in qtz. carb. filling filling low angle slip comprising 1/3 of core-neg, min in rest.	27	1.0	0.20	4g/ozs
226.2-300.0	Cherty Fragmental- as before except less altered and more massive from 252' 298.0-300.0-low py-mainly fine in strgs. & filling around frags.	28	2.0		0.12
E N D					

RECORDED JUN 16 1964
 REC'D

DIAMOND DRILL RECORD

Sheet No. 1

PROPERTY: FROBEN-Roche Option

LOCATION: Ben Nevis Twp., Ontario

HOLE No: F-64-2

LENGTH: 253

LATITUDE: 1-00S

STARTED: Feb. 7th, 1964

BEARING: N 20 E

DEPARTURE: 1-00 E

FINISHED: " 10th "

DIP: COLLAR: -45 degs
250' -38½ "

ELEVATION: _____

PURPOSE: To investigate Min. Zone
100' to east of Hole No.1

LOGGED BY: G.D. Moody

FOOTAGE	DESCRIPTION	NO.	WIDTH IN FT.	GOLD OZS.	% COPPER
0.0-8.0	Casing				
8.0-134.0	Cherty Fragmental-more altered than Holes 1 & 2- more ash-dark filling with grey sections with greenish alteration-fair fracturing & schistosity around 55 degs.-also fair x fract.-neg. py				
134.0-170.0	Mineralized zone-cherty frags. with soft dark filling low patchy min.-			OZS AG	% Zn
	139.0-140.5-very fine py.with later coarser py.associated with qtz. carb.-med min.	29	1.3	0.03	nil
	142.4-143.4-med. min.-coarser py with little fine min.	30	1.2	0.44	
	145.6-149.0-med. min.-patchy coarser py.	31	4.3	0.28	
	157.2-159.5- fair min. fine & coarser py	32	2.3	0.04	
170.0-253.0	Diabase- fine to med. grained-chilled contact-fine fractures around 55-60 degs. also x-fract. some talcose slips mainly at low angles 196.0- 2" irreg. qtz. vein 226.0-231.0- epidotized sets. & strgs.				

RECORDED JUN 18 1964

DIAMOND DRILL RECORD

Sheet No. 1

PROPERTY: PROBEX- Roche Option

LOCATION: Ben Nevis Twp., Ontario

HOLE No: F-54-4

LENGTH: 174

LATITUDE: 1-10 E

STARTED: Feb. 11th, 1964

BEARING: N 59 degs. W

DEPARTURE: 0-15' S

FINISHED: " 12th "

DIP: COLLAR: 45 degs

ELEVATION: _____

PURPOSE: To test for Cross Structure

170' 40 "

LOGGED BY: G.E. Moody

FOOTAGE	DESCRIPTION	NO.	WIDTH IN FT.	GOLD OZS.	% COPPER
0.0- 8.0	Casing				
8.0-56.5	Cherty Fragmental-some fine x-fract.-low min. ^{low fine py} 45 & low	33	1.8	0.25 AG 0.82	%Zn nil
56.5-89.0	Diabase-fine to med. grained-fair fract. 45 & low angle to core				
89.0-121.8	Cherty Frag-highly altered finely fract. x-fract. frags. closely packed-scattered fine & coarser py				
121.8-167.0	114.6-118.3- highly altered-much carb.-light gre rich grey-tuff (?) Mineralized zone-much altered-less frags.-finely x-fract.-schistose-at 55 degs. to core				
	121.8-124.6-fine frags.-more filling w.m.	34			
	122.6-126.1- low scattered min				
	126.1-129.5-fair coarser py mainly patchy around frags. associated with qtz. & carb	35	3.4	OZS. AG 1.3	%ZN %PB
	129.5-132.9-heavy coarser py. as above	35	3.4	2.66	
	132.9-137.9-patchy sects. of coarser py- scaly pbs or argentite on flat slip	36	5.0	2.18	0.15
	137.9-142.9- fair coarser py around frags. zns & pbs noted on some flat slips	37	5.0	9.52	0.70
	142.9-147.9- as above	38	5.0	9.72	
	147.9-153.0- low	39	5.1	2.14	
	153.0-158.0-w.k. coarser py as fillings & on strgs.-high x-fract.-some pinkish altered zns. noted	40.	5.0	0.94	
	158.0-163.0- as above but less min.	41	5.0	0.40	
	163.0-168.0- last 21' very highly altered-fine frags.-fair min. mainly on fine fract.	42	5.0	0.44	
167.0-174.0	Cherty Fragmental-highly altered-low min-fine frags.				

1964 01 11
 PROBEX
 174
 F-54-4

DIAMOND DRILL RECORD

Sheet No. 1

PROPERTY: FREEMAN- Roche Option

LOCATION: Ben Nevis Twp., Ont.

HOLE No.: F-64-5

LENGTH: 448'

LATITUDE: 2-93' S

STARTED: Feb. 13th, 1964

BEARING: N 20 degs. E

DEPARTURE: 0-0

FINISHED: " 17th "

DIP: COLLAR: -50 degs.

ELEVATION: _____

PURPOSE: To intersect Min. Zone
around 250 feet Vert.

200' 40 "
440 38 "

LOGGED BY: G. B. Moody

FOOTAGE	DESCRIPTION	NO.	WIDTH IN FT.	GOLD OZS.	% COPPER
	Note:- This hole is being extended at least another 100' starting Feb. 24th.				
0.0-12.0	Casing				
12.0-39.0	Cherty Fragmental-highly altered-pale green threads & areas (epidote)-carb.-schistose-fairly coarse frags.-fine strgs of qtz & carb with fine py cut by later qtz.				
	15.0-17.0- highly altered-fine x-fract. w.m. fine py on strgs. with qtz. carb.	43	2.0	OZS AG 0.18	
39.0-57.7	Fragmental-fine tuffaceous-highly altered-schistose dark colored & soft-epidote in bx sect.-schistosity & fract. at around 55 degs.				
	41.0- 4" leached & rusty				
	45.7-57.7-med. grained with some bx-flecked with chlorite-low scattered min.				
57.7-70.7	Dyke (?)- silic-fine grained light grey-qtz eyes-schistose at 55 degs.-odd cubic py 1/8"				
70.7-145.0	Fragmental- as before-frags squeezed-schistosity & frag alignment at 55 degs.				
145.0-149.2	Frag-highly x-fract. and blocky-some core ground				
	145.7-148.0-last foot cherty & cut by qtz. strg				
149.2-203.0	Diabase- fine to med. grained-chilled contact at 35° to core-fairly well fract.-45 & 70 degs. & low angle-occas. wisp of epidote				
	149.2-152.0-blocky				
	152.3-irreg. feldsite strg. cut by talcose slip				
	153.5- qtz. strg. on talcose slip at 65 degs.				
203.0-215.0	Cherty Fragmental-med. size-altered-finely x-fract.				
215.0-242.0	Frag.-med-very highly altered-possibly some bx-schistose-greenish grey				
242.0-448.0	Tuffaceous- silic-alternating sect. of frag. with				

JUN 18 1964

FOOTAGE	DESCRIPTION	NO.	WIDTH IN FT.	GOLD OZE.	% COPPER
438.0-448.0	<p>Fine tufaceous material-threads and areas with epidote-odd cluster of chloritic spots & threads-schistose at 45-50 degs.-some fract at 135 degs. measuring from top of hole to bottom. 288.0-385.0- quite heavy epidote alteration- not as siliceous 348.0-348.7- barren irreg. qtz. vein 435.0-438.0- larger cherty frags. Min. Zone (?)- on whole low min-coarser py as filling around cherty frags.-few short sects of pinkish alteration 443.9-444.9-W.M. py in fillings & on strgs.</p> <p><i>See description card</i></p>	44	1.0	OZS AG	

RECORDED
JUN 18 1954

FOOTAGE	DESCRIPTION	NO.	WIDTH IN FT.	GOLD OZS.	% COPPER
	Deepened:- Resumed Feb. 27th. Finished-" 29th				
448.0-458.5	Mineralized Zone- as before				
458.5-509.0	Cherty Fragmental-fairly closely packed-fine x fract. scattered sects. of fair py in filling around frags.-schistosity & main fracturing at 65 legs. to core				
509.0-518.0	Tuff or fine flow-much carb. -schistose-knife edge contact-little dissem. py.				
518.0-527.0	Cherty Fragmental-with some tuff				
527.0-536.0-	Tuff- as before-quartz in amygdules toward end.				
536.0-545.0-	Cherty Fragmental as before				

JUN 18 1964

DIAMOND DRILL RECORD

Sheet No. 1

PROPERTY: Fraser- Roche Option

LOCATION: Ben Nevis Exp., Ont.

HOLE No: F-64-6

LENGTH: 352 feet

LATITUDE: 0-20' S

STARTED: Feb. 18th, 1964

BEARING: N 50° E

DEPARTURE: 1-45' E

FINISHED: " 21st "

DIP: COLLAR: 50 degs,
350'35 "

ELEVATION: _____

PURPOSE: To investigate fragmentals
east of diabase dyke.

LOGGED BY: G. E. Moody

FOOTAGE	DESCRIPTION	NO.	WIDTH IN FT.	GOLD OZS.	% COPPER	
0.0-13.0	Casing					
13.0-134.5	Cherty Fragmental- fairly large and closely packed- schistose but fairly massive @ 51° to core- scattered py. as filling and in strgs.					
134.5-159.5	Mineralized Zone- Cherty fragmental-less closely packed- highly altered-epidote and considerable pinkish alteration-on whole W.M.-coarse py in filling around frags, & in strgs. with Qtz. & schistosity around 50 degs. to core			OZS	%	Pt.
	134.7-139.7- W.M. coarse py.	45	3.0	1.93	0.05	0.05
	139.7-145.7- Heavy py. min.	46	0.0	1.10	0.45	0.15
	145.7-149.5- W.M. py.	47	4.0	0.40		
	146.7-159.5-more tuffaceous-less min-finely x-fract.-with short sects. of bx					
	149.5-154.5- low to fair scattered py	48	5.0	0.46		
	154.5-159.9- fair py. around frags.	49	4.4	0.20		
159.9-206.0	Mineralized Zone- fine grained tuffaceous, altered finely fract-with py on fract. schistose-around 50 degs. to core					
	159.9-164.9- fair py on strgs.	50	5.0	0.08		
	164.9-169.9- as above	51	5.0	0.20		
	160'- 1" ground					
	180.5-180.9-several rusty slips-blocky					
	188.7-191.7- w.m. -coarser py around frags. py. cut by Qtz.-sli. grinding at 190'-few rusty slips	52.	5.0	1.74		
	191.7-206.0- less min.-number of rusty x-fract.	53	3.4	0.52		
206.0-275.5	Tuffs-fine grained & altered-many fine irreg.fracts. some pink and dark grey alteration-some leaching -low min.					

RECORDED JUN 18 1964

FOOTAGE	DESCRIPTION	NO.	WIDTH IN FT.	GOLD OZS.	% COPPER
275.5-352.0	<p>208.0-218.0- sects of leaching 235.0- 240.0-more pinkish alteration-more finely x-fract.-taken as sample of this type of alteration-fine py on slips-with few strgs. with coarser py</p> <p>Tuffs- as before but less fractured-mineralized & altered-softener--schistose at around 50 degs. to core 337.5-338.5-bedding (?) -schistosity 347.0-352.0- more x fract.-little py.</p>	54		ozs/ft. 0.12	

RECORDED JUN 18 1954
No.

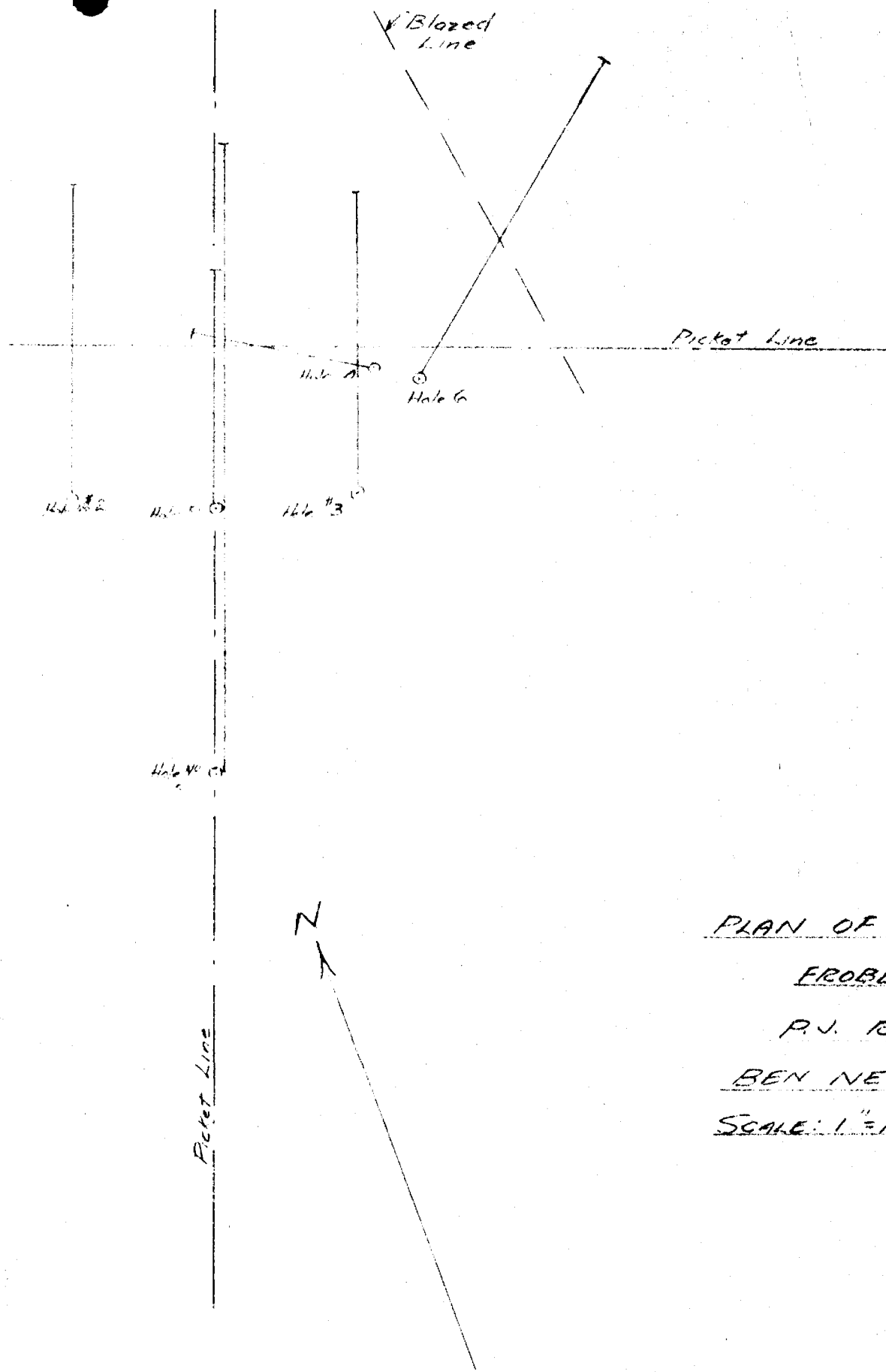

PLAN OF DIAMOND DRILLING
 EROBEX OPTION
 P.J. ROCHE CLAIMS
 BEN NEVIS TWP., ONT.
 SCALE: 1" = 100' March 18/64.

N91 Post L-76637
 NE2 " L-76642*
 NR3 " L-76641
 NR4 " L-76638

RECORDED JUN 18 1964
 REC. No.



32D055E0070 15 BEN NEVIS

900

extent thereof.

Form 12 A

THE MINING ACT



ONTARIO

REPORT OF WORK

To the Recorder of Larder Lake Mining Division:

I, Peter J. Roche
(Name of Applicant)
71 Chatsworth Drive, Toronto 12, Ontario
(Post Office Address)

the recorded holder of mining claim No. L76642 hereby report the performance of 120 days' work not before reported, to be applied to this claim.

*This mining claim is one of a group of contiguous claims numbered L76636 to L76645 incl.
L78037 to L78042 incl. ~~L78270~~, L78295 L78296

of which I am the recorded holder under Mining License No. 3058 J and the work was performed on mining claim(s) L76642 and is to be applied

in respect of mining claim(s) L76636 to L76645 incl. L78037 to L78042 incl. ~~L78270~~, L78295, L78296
(*Complete above section only if applicable)

The work is as follows:

Stripping or opening up mines, sinking shafts or other actual mining operations

The names and addresses of the men who performed the work and the dates upon which each man worked in its performance are: (If more space is required, attach list).

Total No. of days

Diamond or other Core Drilling

Footage drilled 1971 No. of holes drilled 6 Angle 45 deg. and 50 deg.
Diameter of core 1 and 9/32 inches Names and addresses of owner and operator of drill Continental Diamond Drilling Co. Rouyn, Quebec

Dates upon which drilling was done Jan. 30, 1964 to Feb. 29, 1964
(Core log and Sketch in duplicate by core examiner accompanies this Report.)

Total No. of days 1971

Work by Compressed Air or other Power Driven Rock Drill or Mechanical Equipment.

Type of drill
Names and addresses of men engaged in operating drill.

Dates upon which each man worked

Total No. of days

The penalty for making a false statement in this certificate is \$500. or six months imprisonment or both.

RECORDED JUN 18 1964
REC. No.

Power Stripping

Type of equipment used

Names and addresses of owner and operators

.....

.....

.....

.....

.....

Amount expended \$

Dates on which work was done

Total No. of days

Date June 17, 1964

P. J. Roeb
Signature of Recorded Holder or Agent

The Mining Act
CERTIFICATE VERIFYING REPORT OF WORK

I, F. A. Innes

254 Glenrose Ave.
(post-office address)

Toronto 7, Ont.
(City, town, village or township)

hereby certify:

1. That I have a personal and intimate knowledge of the facts set forth in the report of work annexed hereto.
2. That the grounds of my knowledge are Study of reports, maps, invoices etc.
3. That the annexed report is true.

F. A. Innes
(Signature)

Dated June 1964 Toronto, Ontario
(post-office address)

The penalty for making a false statement in this certificate is \$500, or six months imprisonment or both.