

3205SW0004 22 CLIFFORD

010

DIAMOND DRILLING

TOWNSHIP: CLIFFORD

REPORT NO: 22

WORK PERFORMED FOR: Lac Minerals Ltd.

RECORDED HOLDER: SAME AS ABOVE (xx)

: OTHER ( )

<u>CLAIM NO.</u>	<u>HOLE NO.</u>	<u>FOOTAGE</u>	<u>DATE</u>	<u>NOTE</u>
L803336	C14J	263.65m	Jan-Feb/88	(1)
	C14I	234.7m	Jan/88	(1)

NOTES: (1) # W8908.337, filed Nov/89

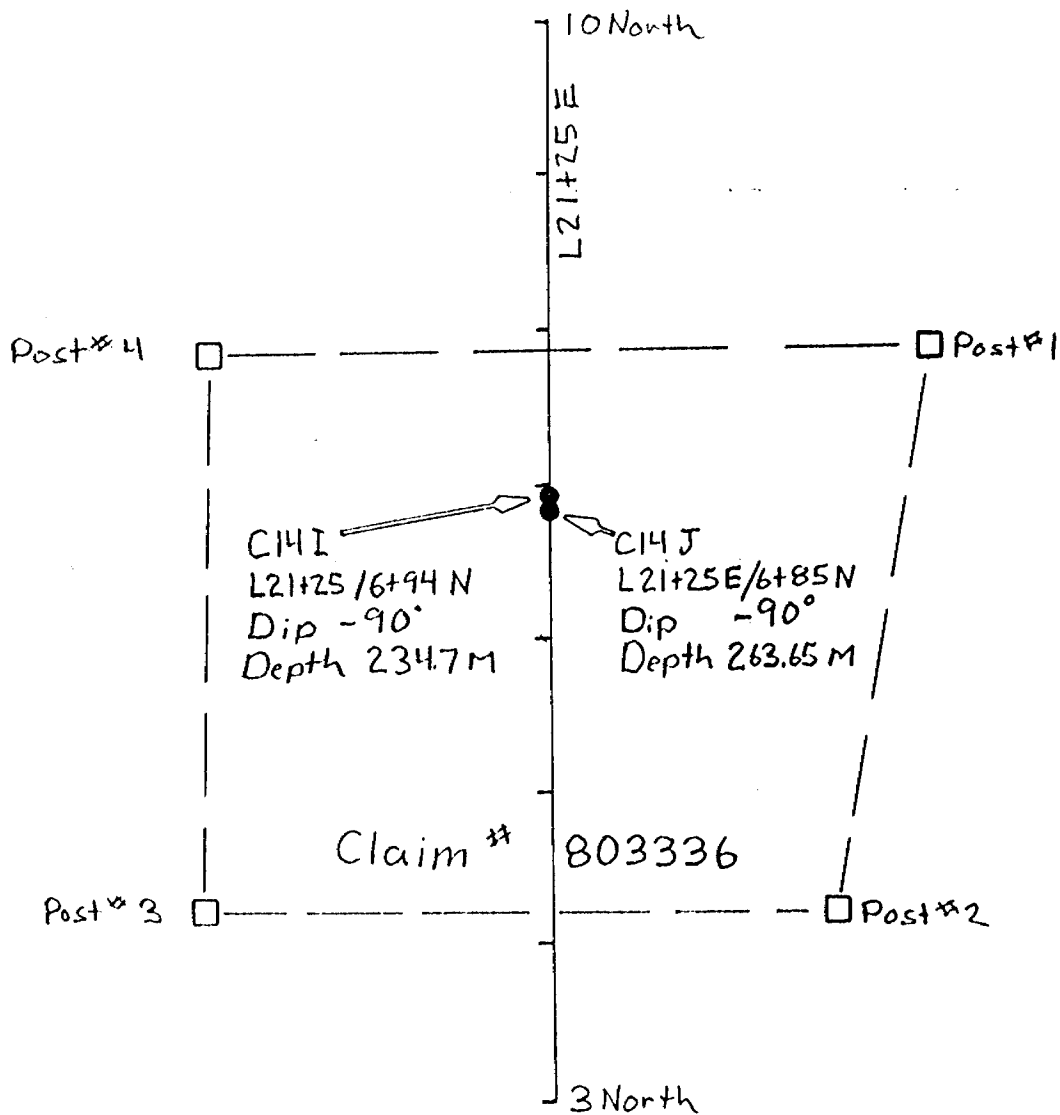

Drill Hole Location Plan  
 Grid C14  
 Clifford Twp. Ont.  
 Scale 1:5000

AR

Lac Minerals Exploration - Drill Hole Summary

Project :	Location :
Property : GRID C-14	Line : L21+25E
Hole No. : C14J	Station : 6+85n
Logged By : John Kovalala	Length : 263.65
Date : February 1988	Units : metres
Hole Type : DDH	Dip : -90°
Start Date : January 22nd, 1988	Azimuth : 0°
End Date : February 9th, 1988	Elevation :
Core Size : SHR	Collar :
Recovery : 98%	Bottom :
Target :	
Assay Cert No	

Hole : C14J - Survey Data

Distance	Azi	Dip	Type	Remarks
No Survey Data				

AN

Lac Minerals Ltd	Drill Hole : C14J	Project :	Target :
Geological and Assay Data		Property: GRID C-14	

IX	From	To	Remarks	Sample Number	From	To	metres	Au Assay (Core)				Sludge		Au ppb
								1st Pulp ppb	2nd Pulp ppb	Oz/ Ton	From	To		

0.00 47.70 OVERBURDEN

0 - 15.24 Muskeg, Lower Down  
- some sand and gravel

15.24 - 33.53 Large Boulders and Coarse Gravel

33.53 - 42.98 Basal Till? Gravel and Clay

42.98 - 45.72 Solid Compact Basal Till

Drillers indicate bedrock intersected at 45.72. Drill to 47.7 before core is recovered.

Casing left in the hole

47.70 263.65 ULTRAMAFIC BRECCIA  
Very similar to Hole C14J

This rock consists of a heterogeneous mixture of 17 to 31% fragments in a dark grey green serpentized matrix. Fragments range in size from 0.4cm to 1.2meters but the larger blocks are rare. Most are 0.4 to 10cm in diameter, very few are > 10cm. Fragment colour varies from light green and white to black. They range from fine grained to medium grained and are occasionally intensely serpentized and soft.

The matrix is fine grained and intensely serpentized. Carbonate is abundant throughout. Olivine is abundant throughout the matrix as phenocrysts upto 0.8cm in diameter but is most common in the 1 to 2mm range. Most have been serpentized black and only pseudomorphs remain or they have been leached away.

Carbonate occurs occasionally as stringers and veins throughout the section.

158.50 - 158.80 Fault Zone  
Ground Core Clay

Lac Minerals Ltd	Drill Hole : C14J	Project :	Target :
Geological and Assay Data		Property: GRID C-14	

IX	From	To	Remarks	Sample Number	From	To	metres	Au Assay (Core)				Sludge		Au ppb
								1st Pulp ppb	2nd Pulp ppb	Oz/ Ton	ppb	From	To	

160.32 - 160.93 Broken Core

161.69 - 161.84 Broken Core

176.78 - 177.69 Fault Zone and Ground Core at 0 to 10° to Core Axis

203.91 - 204.51 Broken Core

208.36 Irregular altered zone 1 to 4cm wide. Breccia fragments 0.4 to 1cm in diameter are altered to a dirty brownish green. The matrix is altered white. Minor Carbonate.

216.10 - 216.40 Broken Core

217.32 - 217.47 Broken Core

220.06 - 220.31 Broken Core

237.40 - 244.29 Ground Core  
along sheared zone @ 15° to Core Axis

237.44 - 246.73 Very soft altered core sheared at 10 to 20° to Core Axis

263.65 263.65 End of Hole

X

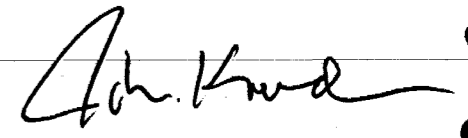

=====

Lac Minerals Exploration - Drill Hole Summary

-----

Project :	Location	
Property : GRID C-14	Line : L21+25E	
Hole No. : C14I	Station : 6+94N	
-----		
Logged By : John Kovala	Length : 234.7	
Date : January 1988	Units : metres	
-----		
Hole Type : DDH	Dip : -90°	
Start Date : January 7th, 1988	Azimuth : 0°	
End Date : January 21st, 1988		
-----		
Core Size : SHR	Elevation	
Recovery : 98%	Collar :	
	Bottom :	
-----		
Target :		
Assay Cert No		

=====

Hole : C14I - Survey Data

-----

Distance	Azi	Dip	Type	Remarks
No Survey Data				

*AK*

Lac Minerals Ltd	Drill Hole : C141	Project :	Target :
Geological and Assay Data		Property: GRID C-14	

IX	From	To	Remarks	Sample Number	From	To	metres	Au Assay (Core)				Sludge		Au ppb
								1st Pulp ppb	2nd Pulp ppb	Oz/Ton		From	To	

0.00 44.50 OVERBURDEN

0 - 19.81 Muskeg - clay

19.81 - 32.95 Boulders and coarse gravel. Large boulders encountered throughout

32.95 - 44.50 Basal Till  
- hard and compact containing numerous fragments in a clay matrix

Casing left in hole.

44.50 44.80 ULTRAMAFIC BRECCIA  
- same as 45.41 to 234.70

44.80 45.41 SAND AND GRAVEL

45.41 234.70 ULTRAMAFIC BRECCIA  
This rock contains 22 to 32% fragments ranging in size from 0.4 to 9cm. Fragments > than 9cm in diameter are rare. Most range from 0.4 to 2cm. Fragment colours vary from light green and white to black. They are fine to medium grained and are occasionally intensely serpentinized and soft.

The ground mass has been moderate to intensely serpentinized and is medium to dark grey green containing abundant olivine phenocrysts 1 to 2mm in diameter. Most olivines have been serpentinized and are black, only pseudomorphs remain or they have been completely leached away.

Minor carbonate veins and stringers <0.5%.  
No sulphides.

147.82 - 148.59 Ground Sheared Core  
- Sheared at 20° to Core Axis  
- @ 147.82 carbonate vein at 20° to Core Axis

AN

Lac Minerals Ltd Geological and Assay Data		Drill Hole : C141		Project : Property: GRID C-14		Target :					
IX	From	To	Remarks	Sample Number	Au Assay (Core)				Sludge		Au ppb
					From	To	metres	1st Pulp ppb	2nd Pulp ppb	Oz/ Ton	
			149.19 2cm wide shear @ 20° to Core Axis								
			151.19 - 152.10 Broken Core - sheared and fractured parallel to Core Axis and at 20° to Core Axis								
			157.58 - 159.10 Carbonate Veins - @ 30° and parallel to Core Axis. Rock is extremely soft.								
			160.32 - 162.15 Ice Carbonate Vein - parallel to Core Axis								
			160.93 - 161.59 Ground Core								
			161.60 - 162.15 Sheared @ 35° to Core Axis								
			170.07 - 174.34 Sheared and fractured - Carbonate veins and masses throughout. Most veins are parallel to Core Axis or at a high angle to the Core Axis								
			174.09 - 174.34 Carbonate Vein - parallel to Core Axis								
	234.70	234.70	End of Hole								

X

*John K...*



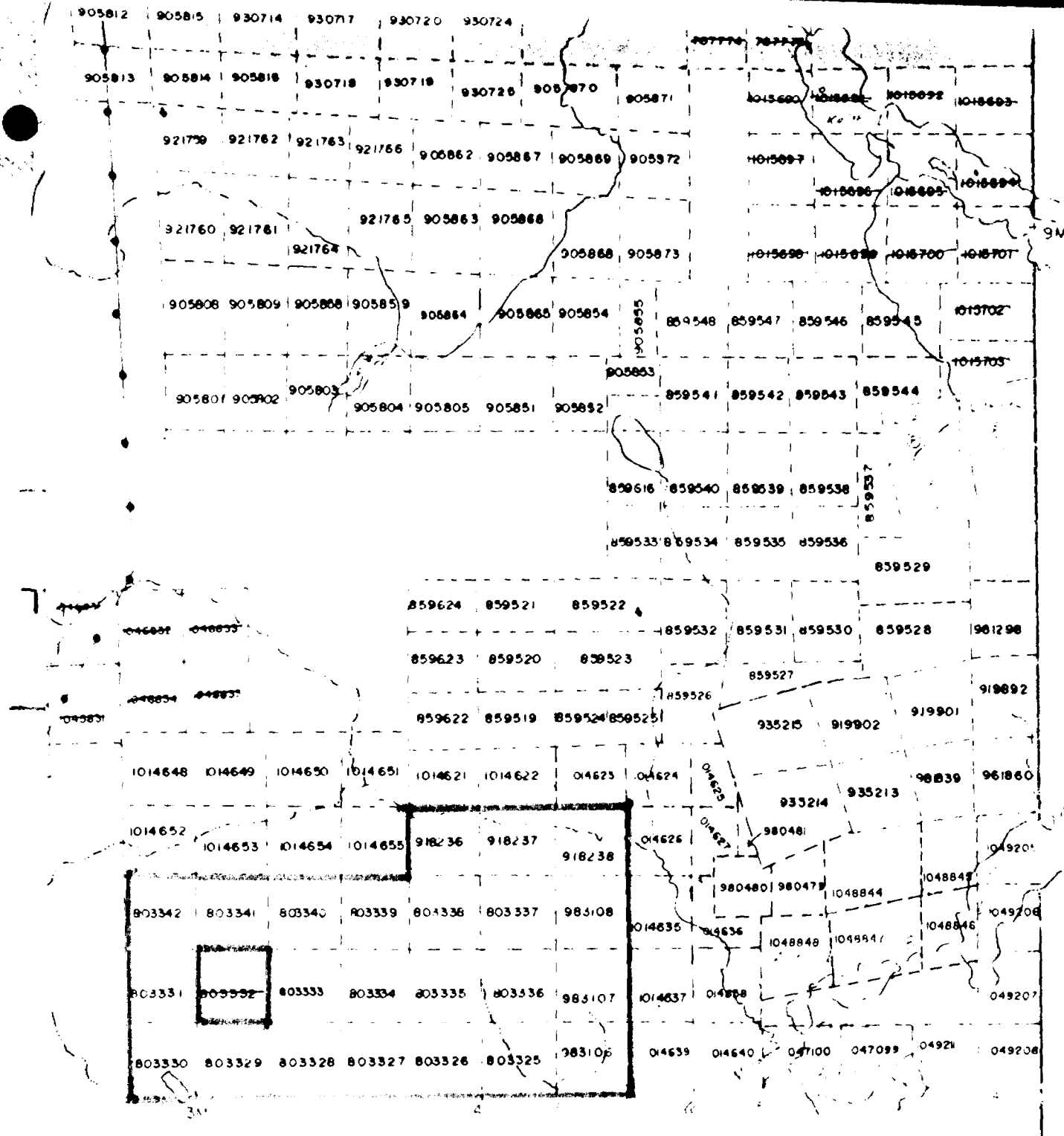

LINE  
ION

NOLD TWP. M-34

*Clifford-Twp*

DATE RECEIVED MARCH 2 1989

**DOCUMENT No.**  
**W8908-337**



**Mining Act Report of Work**

Name and Address of Recorded Holder <b>LAC Minerals Ltd.</b>	Prospector's Licence No. <b>T-664</b>
<b>6 Al Wende Avenue, P.O. Box 670, KIRKLAND LAKE, Ont. P2N</b>	Telephone No. <b>3K1 (705)-567-5656</b>

**Summary of Distribution of Credits and Work Performance**

Mining Division <b>Larder Lake</b>	Mining Claim		Work Days Cr.	Mining Claim		Work Days Cr.	Mining Claim		Work Days Cr.
	Prefix	Number		Prefix	Number		Prefix	Number	
Township or Area <b>Clifford</b>	L	803325	40	L	803336	40	L	983106	140
Total Assessment Credits Claimed <b>1332</b>		803326	40		803337	40		983107	140
		803327	40		803338	40		983108	140
Type of Work Performed (Check one only)		803328	40		803339	40			
<input type="checkbox"/> Manual Work		803329	40		803340	40			
<input type="checkbox"/> Shaft Sinking Drifting or other Lateral Work		803330	32		803341	40			
<input type="checkbox"/> Mechanical equipment		803331	40		803342	40			
<input type="checkbox"/> Power Stripping other than Manual (maximum credit allowed - 100 days per claim)		803333	40		918236	80			
<input checked="" type="checkbox"/> Diamond or other Core drilling		803334	40		918237	80			
<input type="checkbox"/> Core Specimens		803335	40		918238	80			

Dates when work was performed From: <b>January 7/88</b> To: <b>February 9/88</b>	Total No. of Days Performed <b>1635</b>	Total No. of Days Claimed <b>1332</b>	Total No. of Days to be Claimed at a Future Date <b>303</b>
---	--	--	--

All the work was performed on Mining Claim(s): Indicate no. of days performed on each claim. * (See note No. 1 on reverse side)		Mining Claim <b>L 803336</b>	No. of Days <b>1635</b>	Mining Claim	No. of Days	Mining Claim	No. of Days	Mining Claim	No. of Days
Mining Claim	No. of Days	Mining Claim	No. of Days	Mining Claim	No. of Days	Mining Claim	No. of Days	Mining Claim	No. of Days

Required information eg. type of equipment, Names, Addresses, etc. (See Table on reverse side)  
If space below is insufficient, attach schedules with required information and location sketches

Duplicate logs and location sketches submitted with Report of Work.

Drilling Company: **Tonto Drilling Services**  
2701 West 900 South  
SAULT LAKE CITY, U.S.A.  
United States, 84104

Hole Location: **C14I L21+25E/6+94N**  
Dip: **-90°**  
Depth: **770' = 770 days**

Hole Location: **C14J L21+25E/6+85N**  
Dip: **-90°**  
Depth: **865' = 865 days**

**C14I (770') + C14J (865') = 1635 days - 1332 days applied = 303 days banked**

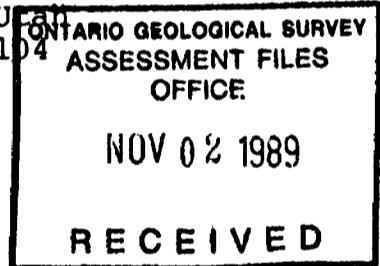

**Certification of Beneficial Interest \* (See Note No. 2 on reverse side)**

I hereby certify that, at the time the work was performed, the claims covered in this report of work were recorded in the current recorded holder's name or held under a beneficial interest by the current recorded holder.	Date <b>October 5, 1989</b>	Recorded Holder or Agent (Signature) <i>[Signature]</i>
--	--------------------------------	--

**Certification Verifying Report of Work**

I hereby certify that I have a personal and intimate knowledge of the facts set forth in the Report of Work annexed hereto, having performed the work or witnessed same during and/or after its completion and the annexed report is true.

Name and Address of Person Certifying  
**John Kovala, P.O. Box 334, KIRKLAND LAKE, Ontario P2N 3J1**

Telephone No. <b>(705)-567-5495</b>	Date <b>October 5, 1989</b>	Certified By (Signature) <i>[Signature]</i>
--	--------------------------------	--

**For Office Use Only**

Work Assignments Claim # <b>2-803336</b> R.H. <b>LAC Minerals Ltd.</b> Days Recorded <b>1292</b> Balance <b>2006</b>	Received Stamp <b>RECEIVED</b> LARDER LAKE MINING DIV. OCT 13 1989
---	---