



32D05SW0046 2.1041 CLIFFORD

CANADEx MINING
COVERING
A MAGNETOMETER SURVEY
CLIFFORD TOWNSHIP
LARDER LAKE AREA
ONTARIO

PROPERTY, LOCATION & ACCESS

The claims numbered ~~266295 - 266309~~ inclusive and 266312 - 266315 inclusive form a contiguous block of 19 claims in the southeast corner of the township. Located 15 miles northeast of the Town of Kirkland Lake, the claims are readily accessible from the Esker Park road which runs north from Highway 66 at a point 8 miles east of Kirkland Lake. Ten miles north of Highway 66, logging roads run easterly from the Esker Park road and cross the west boundary of the property.

PREVIOUS WORK & HISTORY

The claims have been prospected many years ago and numerous trenches and pits are in evidence. A few drill casings were found indicating the presence of a drill program at some unknown date.

Best source of geological information is the recently published O.D.M. Map P.692 of Clifford Township.

GEOLOGY OF THE PROPERTY

The Canadex property is underlain by easterly trending, steeply dipping, Keewatin type volcanic rocks and ejecta, weakly metamorphized, intruded by a few narrow felsic dikes of granodiorite and feldspar porphyry (none exposed but revealed in drilling by Mining Corporation) and several large stocks of gabbro.

LINE CUTTING

From the southwest corner of the property a base line was cut striking N 30° E. From this, lines were cut at right angles every 300 feet to the property boundaries. This work was done by Murray Macquarrie, 88 Taylor Avenue, Kirkland Lake, Ontario during September, 1970. A total of 18.5 miles of lines were cut.

MAGNETOMETER SURVEY

Using a McPhar M700 instrument the survey was completed by the writer. The base station was 0 + 00 on the base line and was set at 0 gammas. Diurnal corrections were applied to the readings.

*1 hr - 52 hr interval
13 stations every 400' along base line
looping procedure followed*

FORM NO. 11-58-1 P. REPORT PAPER GRANVILLE TOY LIMITED

RESULTS

South of the base line the property shows little magnetic contrast with the maximum variation being from a minus 140 gammas reading to a plus 270 gamma reading. This magnetic high was in an area of overburden and was drilled years ago by Mining Corporation of Canada Limited but results are not known. Geological maps suggest the area is underlain by felsic volcanic rocks with low magnetic properties.

Two pits showing pyrite mineralization were on the lines and both gave low negative readings of -5 to -15 gammas,

North of the base line are a number of "highs" within greater areas of normal background of 0 gammas to 100 gammas. The highs which range from 400 gammas to 1,000 gammas with one exceptional value of 2,500 gammas are considered to be due to mafic intrusives, mainly diorite or gabbro.

In the northwest claim, no. 266315, the maximum low of minus 1900 gammas was recorded.

Rusty outcrops were noted near station 21 W on line L 28 W.

RECOMMENDATIONS

It is recommended that sufficient geological investigation be done to identify the rock types in the vicinity of the anomalous "high" and particularly in the area of the gossans valued at 21 W on line 28 W.

Signed,

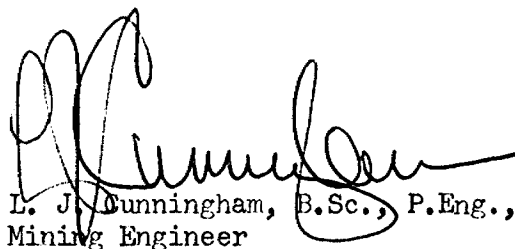

E. J. Cunningham, B.Sc., P.Eng.,
Mining Engineer

Dated at Kirkland Lake, Ontario
10th October, 1972



GEOPHYSICAL - GEOLOGICAL
TECHNICAL DATA STATEMENT

32D05SW0046 2.1041 CLIFFORD

900

OCT 16 1972

PROJECTS SECTION

TO BE ATTACHED AS AN APPENDIX TO TECHNICAL REPORT
FACTS SHOWN HERE NEED NOT BE REPEATED IN REPORT
TECHNICAL REPORT MUST CONTAIN INTERPRETATION, CONCLUSIONS ETC.

Type of Survey Magnetometer
Township or Area Clifford
Claim holder(s) Murray Macquarrie
Author of Report L. J. Cunningham
Address 1 McPhee Ave., Kirkland Lake, Ontario
Covering Dates of Survey 10 - 17 August, 1972
(linecutting to office)
Total Miles of Line cut 18.5

MINING CLAIMS TRAVERSED
List numerically

L. (prefix)	266295	(number)
	266296	
	266297	
	266298	
	266299	
	266300	
	266301	
	266302	
	266303	
	266304	
	266305	
	266306	
	266307	
	266308	
	266309	
	266312	
	266313	
	266314	
	266315	

SPECIAL PROVISIONS
CREDITS REQUESTED

DAYS
per claim

ENTER 40 days (includes
line cutting) for first
survey.
ENTER 20 days for each
additional survey using
same grid.

Geophysical
-Electromagnetic
-Magnetometer
-Radiometric
-Other
Geological
Geochemical

20

AIRBORNE CREDITS (Special provision credits do not apply to airborne surveys)

Magnetometer _____ Electromagnetic _____ Radiometric _____
(enter days per claim)

DATE: 17th August, 1972 SIGNATURE: [Signature]
Author of Report or Agent

PROJECTS SECTION

Res. Geol. _____ Qualifications 63.1603

Previous Surveys 2.545 (E.N.) same lines Only 30 day

Checked by _____ date _____
Credits were given on 266303 + 13 as they were not completely traversed

GEOLOGICAL BRANCH _____

Approved by _____ date _____

GEOLOGICAL BRANCH _____

Approved by _____ date _____

TOTAL CLAIMS 19

OFFICE USE ONLY

If space insufficient, attach list

Show instrument technical data in each space for type of survey submitted or indicate "not applicable"

GEOPHYSICAL TECHNICAL DATA

GROUND SURVEYS

Number of Stations 968 Number of Readings 968
Station interval 100 feet
Line spacing 400 feet
Profile scale or Contour intervals 100 gammas
(specify for each type of survey)

MAGNETIC

Instrument McPhar M 700
Accuracy - Scale constant ± 5 gammas
Diurnal correction method _____
Base station location No. 2 Post 266298

ELECTROMAGNETIC

Instrument _____
Coil configuration _____
Coil separation _____
Accuracy _____
Method: Fixed transmitter Shoot back In line Parallel line
Frequency _____
(specify V.L.F. station)

Parameters measured _____

GRAVITY

Instrument _____
Scale constant _____
Corrections made _____
Base station value and location _____

Elevation accuracy _____

INDUCED POLARIZATION - RESISTIVITY

Instrument _____
Time domain _____ Frequency domain _____
Frequency _____ Range _____
Power _____
Electrode array _____
Electrode spacing _____
Type of electrode _____

ELLIOTT TWP. M-347

NOTES

400' surface rights reservation along the shores of all lakes and rivers.

DATE OF ISSUE
OCT 18 1972
ONT. DEPT. OF MINES
AND NORTHERN AFFAIRS

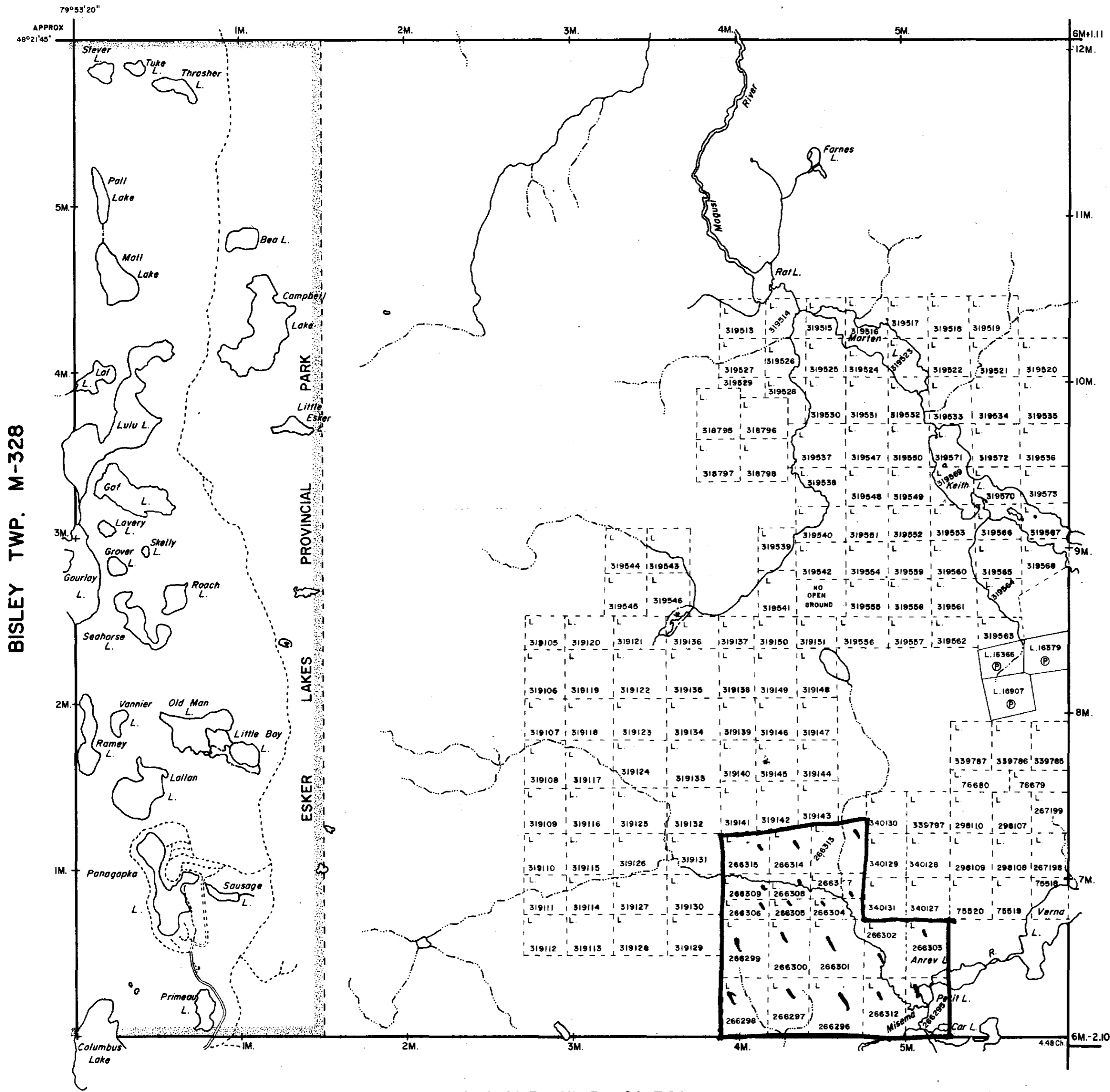

BEN NEVIS TWP. M-325

LEGEND

- PATENTED LAND P or *
 - PATENTED FOR SURFACE RIGHTS ONLY L
 - LEASE L.O.
 - LICENSE OF OCCUPATION C.S.
 - CROWN LAND SALES Loc.
 - LOCATED LAND C.
 - CANCELLED M.R.O.
 - MINING RIGHTS ONLY S.R.O.
 - SURFACE RIGHTS ONLY (H)
 - HIGHWAY & ROUTE NO. (H)
 - ROADS (H)
 - TRAILS (H)
 - RAILWAYS (H)
 - POWER LINES (H)
 - MARSH OR MUSKEG (H)
 - MINES (H)
- *used only with summer resort locations or when space is limited

TOWNSHIP OF
CLIFFORD
2.1041
DISTRICT OF
TIMISKAMING

LARDER LAKE
MINING DIVISION
SCALE : 1 INCH = 40 CHAINS (1/2 MILE)

DR. R.W. NOBLE
DATE DEC. 9, 71. PLAN NO. **M-338**

ONTARIO
DEPARTMENT OF MINES
AND NORTHERN AFFAIRS



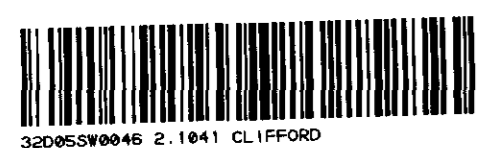

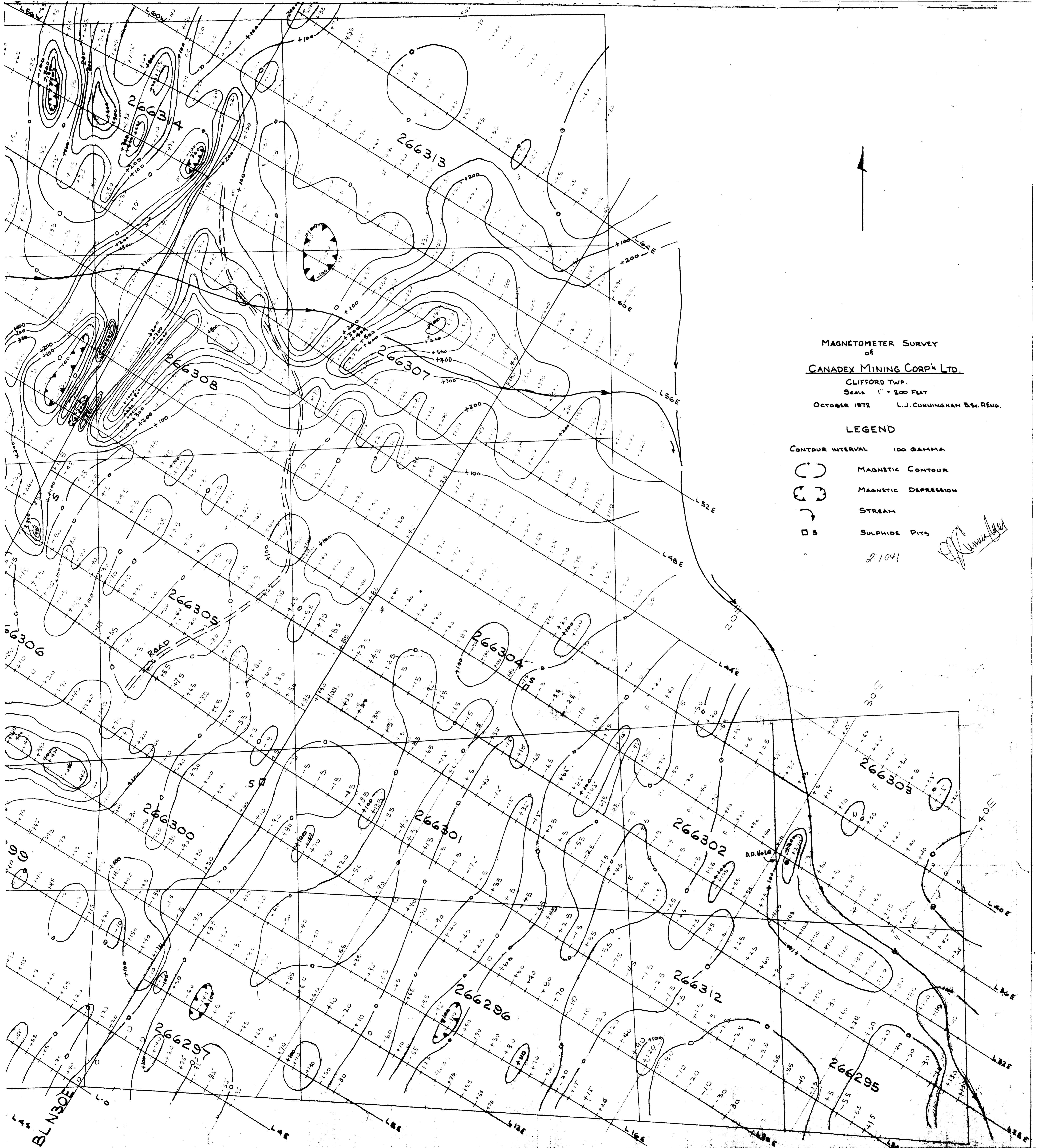
ARNOLD TWP. M-321





MAGNETOMETER SURVEY
 of
CANADIX MINING CORP. LTD.
 CLIFFORD TWP.
 SCALE 1" = 200 FEET
 OCTOBER 1972 L.J. CUNNINGHAM B.Sc. RÉMO.

LEGEND

- CONTOUR INTERVAL 100 GAMMA
-  MAGNETIC CONTOUR
-  MAGNETIC DEPRESSION
-  STREAM
-  SULPHIDE PITS

2.1041

L.J. Cunningham