

32055W0116 16 BISLEY

010

DIAMOND DRILLING

TOWNSHIP: BISLEY

REPORT NO: 16

WORK PERFORMED FOR: Lac Minerals Ltd.

RECORDED HOLDER: SAME AS ABOVE (xx)

: OTHER ()

<u>CLAIM NO.</u>	<u>HOLE NO.</u>	<u>FOOTAGE</u>	<u>DATE</u>	<u>NOTE</u>
L858271	B20A	274.3m	Nov/87	(1)

NOTES: (1) # W8908.348, filed Nov/89

Grid B30
Drill Hole
Location Plan

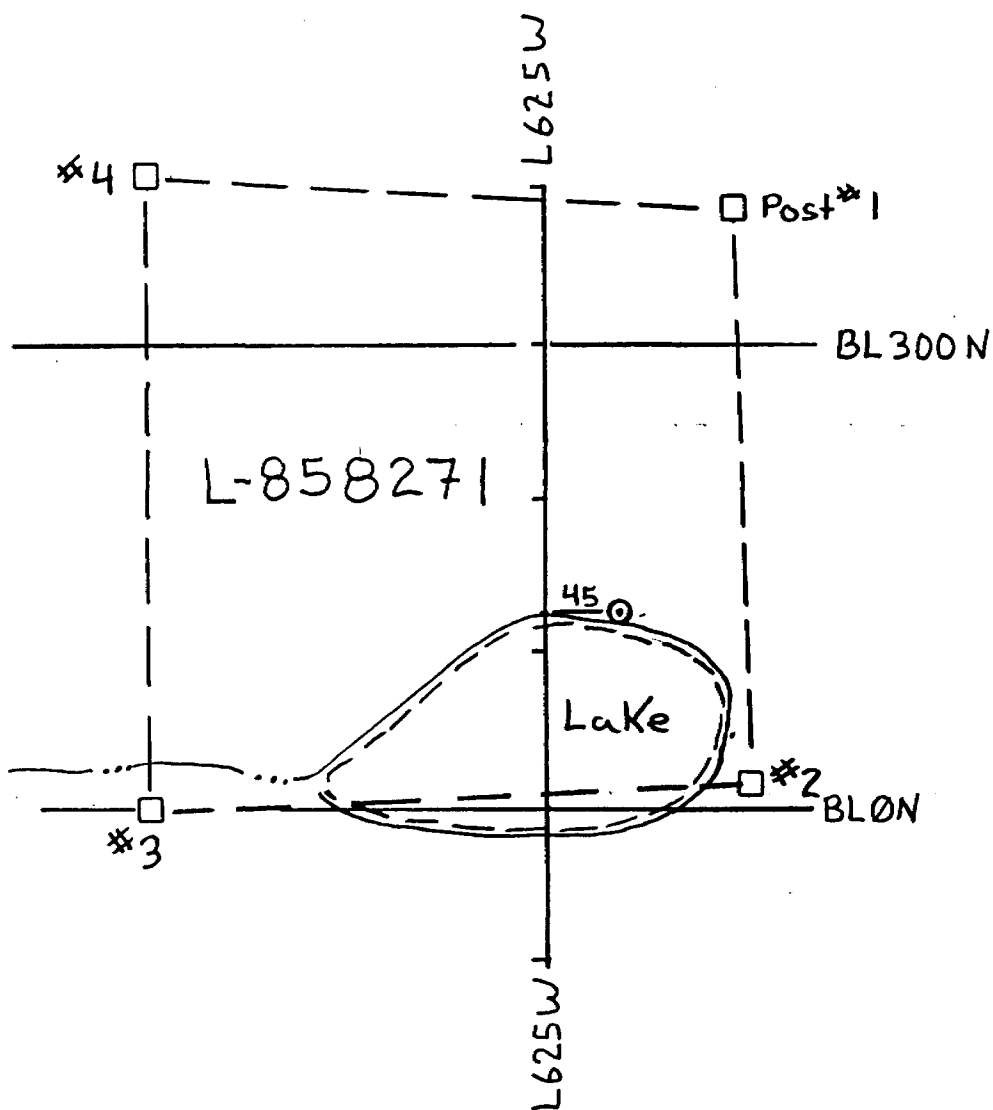

Hole : B30A
Claim : L858271
Loc : L5+80W / 1+25N
Dip : -90°
Metric Grid. Scale 1:5000

Lac Minerals Exploration - Drill Hole Summary

Project	: D.K.	Location	
Property	: B30	Line	: 15-00W
Hole No.	: B30A	Station	: 1105N
Logged By	: John Kovala	Length	: 274.3
Date	: November 23, 1987	Units	: metric
Hole Type	: DDH	Dip	: 90°
Start Date	: November 6th, 1987	Azimuth	: 0
End Date	: November 10th, 1987	Elevation	
Core Size	: 3HR	Collar	:
Recovery	: 99%	Bottom	:

Target : Test Magnetic Anomaly

Assay Cert No

Hole : B30A - Survey Data

Distance	Azi	Dip	Type	Remarks
----------	-----	-----	------	---------

** No Survey Data

JK

=====
 | Lac Minerals Ltd | Drill Hole : B30A | Project : B.K. | Target : Test Magnetic Anomaly |
 | Geological and Assay Data | | Property: B30 | |
 =====

IX	From	To	Remarks	Sample Number	From	To	metric	Au Assay (Core)				Sludge		Au ppb
								1st Pulp ppb	2nd Pulp ppb	Oz/ Ton	From	To		

0.00 54.86 OVERBURDEN
 Dominantly sand and gravel.
 Boulder layers encountered @ 3.96m and 36.58m

54.86 274.32 ULTRAMAFIC BRECCIA
 This rock consists of 15 to 25% fragments set in a light to medium greenish grey ground mass. The ground mass has been moderately to intensely serpentinized. Lighter areas tend to be richer in chlorite and calcite. Phenocrysts of olivine are present in the matrix, most have been serpentinized and are black, only pseudomorphs remain or they have been completely leached away. Fragments make up 15 to 25% of the rock ranging in size from 1 to 15cm. The mean is 5cm range. Colours vary from light green and white to black. They range from fg to mg and are occasionally intensely serpentinized and soft.

The total hole remained consistent throughout except for occasional minor fragment choked intervals. These sections also often contained larger fragments.

58.37 to 59.89 Broken core, poor recovery

62.18 to 63.40 Fragment alignment @ 70° to 90° to Core Axis

182.57 to 170.53 Broken/Ground Core

231.65 Broken/Ground Core

274.32 End of Hole

x

John Kovel

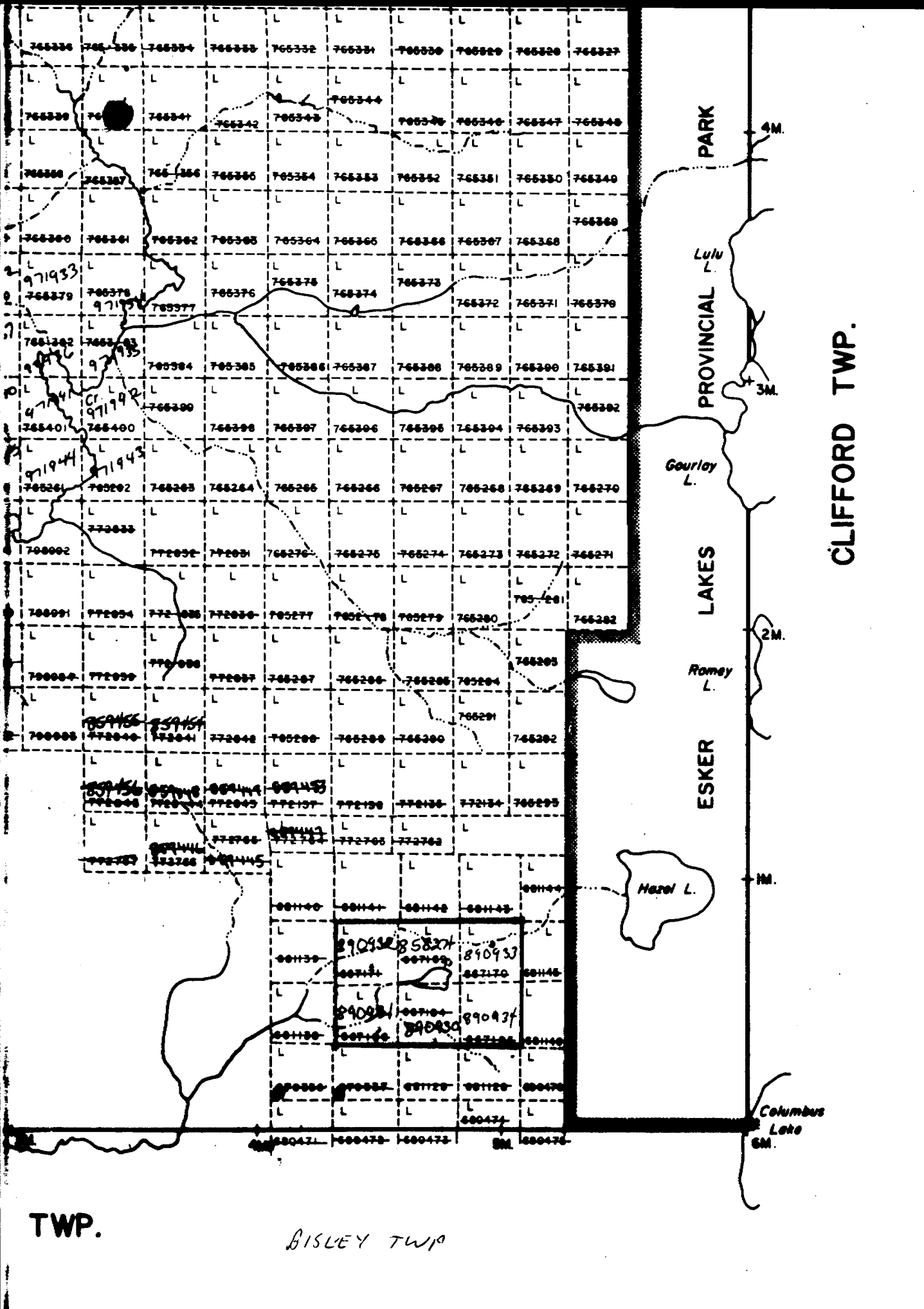

DISPO

TYPE OF
 PATENT, S
 " SU
 " M
 LEASE, SU
 " SUP
 " MIN
 LICENCE O
 ORDER-IN-
 RESERVAT
 CANCELLE
 SAND & GR
 NOTE: MINIM
 1913,
 LAND

SCALE: 1
 FEET
 0 1
 METRES
 0 200

TOWNSH
BIS
 M.N.R. A
KIRKL
MINING
LARDE
LAND TIT
COCH



Sale JAN

TWP.

BISLEY TWP

CLIFFORD TWP.

PARK
 Lulu L.
 PROVINCIAL
 LAKES
 Gourlay L.
 Romey L.
 ESKER



Columbus Lake
 5M.

DOCUMENT No
W8908



32D055W0116 16 BISLEY

900

(Geological, Geophysical, Geochemical) and form no. 878 for Expenditures.
Refer to Sections 76 and 77, the Mining Act for assessment work requirements and the reverse side of this form for table of information.

Mining Act Report of Work

Bisley Twp

Name and Address of Recorded Holder LAC Minerals Ltd	Prospector's Licence No. T-664
6 Al Wende Avenue, P.O. Box 670, Kirkland Lake, Ont.	Telephone No. (705)-567-5656

Summary of Distribution of Credits and Work Performance

Mining Division Larder Lake	Mining Claim			Mining Claim			Mining Claim		
	Prefix	Number	Work Days Cr.	Prefix	Number	Work Days Cr.	Prefix	Number	Work Days Cr.
Township or Area Bisley	L	858271	120						
Total Assessment Credits Claimed 900		890930	120						
Type of Work Performed (Check one only)		890931	120						
	<input type="checkbox"/> Manual Work								
	<input type="checkbox"/> Shaft Sinking Drifting or other Lateral Work								
	<input type="checkbox"/> Mechanical equipment								
	<input type="checkbox"/> Power Stripping other than Manual (maximum credit allowed - 100 days per claim)								
<input checked="" type="checkbox"/> Diamond or other Core drilling									
<input type="checkbox"/> Core Specimens									

Dates when work was performed From November 6, /87 To: November 16/87	Total No. of Days Performed 900	Total No. of Days Claimed 720	Total No. of Days to be Claimed at a Future Date 180
--	---	---	--

All the work was performed on Mining Claim(s): Indicate no. of days performed on each claim. * (See note No. 1 on reverse side)	Mining Claim	No. of Days	Mining Claim	No. of Days	Mining Claim	No. of Days	Mining Claim	No. of Days
	858271	900						

Required Information eg. type of equipment, Names, Addresses, etc. (See Table on reverse side)
If space below is insufficient, attach schedules with required information and location sketches

Duplicate Log and Location Sketches submitted with Report of Work.

Drilling Company: **Tonto Drilling Services**
2701 West 900 South
SAULT LAKE CITY, Utah
United States
84104

Hole Location: **B30A L5+80W/1+25N**

Dip: **-90°**

Depth: **900 = 900 days credit**

ONTARIO GEOLOGICAL SURVEY
ASSESSMENT FILES
OFFICE
NOV 16 1989
RECEIVED

900 days credit - 720 days applied = 180 days banked

Certification of Beneficial Interest * (See Note No. 2 on reverse side)

I hereby certify that, at the time the work was performed, the claims covered in this report of work were recorded in the current recorded holder's name or held under a beneficial interest by the current recorded holder.	Date September 26, 1989	Recorded Holder or Agent (Signature) <i>John Koval</i>
--	-----------------------------------	---

Certification Verifying Report of Work

I hereby certify that I have a personal and intimate knowledge of the facts set forth in the Report of Work annexed hereto, having performed the work or witnessed same during and/or after its completion and the annexed report is true.

Name and Address of Person Certifying John Kovala 7 Teck Hughes Property, KIRKLAND LAKE, Ontario P2N 3J1	Telephone No. (705)-567-5495	Date September 26, 1989	Certified By (Signature) <i>John Koval</i>
--	--	-----------------------------------	---

For Office Use Only

Work Assignments	Received Stamp
claim # R.H. L 858271 LAC Minerals Ltd. Days Recorded 720 Balance 3280	<div style="border: 1px solid black; padding: 5px;"> <p>RECEIVED OCT 2 1989 9:58am</p> </div>

Postmarked Sept 29/89