



32D12SW0135 38 GARRISON

010

DIAMOND DRILLING

TOWNSHIP: GARRISON TWP.

REPORT NO: 38

WORK PERFORMED FOR: Meridor Resources Ltd.

RECORDED HOLDER: Same as Above []
: Other [xx] H.L. Mineral Holdings Ltd.

<u>Claim No.</u>	<u>Hole No.</u>	<u>Footage</u>	<u>Date</u>	<u>Note</u>
1. 789801	MRG-88-3	986'	Jul/88	(1)
	MRG-88-4	252'	Jul/88	(1)
	6-88-5	1238'		

Notes: (1) #W8808.351, filed in Dec/88

DURHAM GEOLOGICAL SERVICES INC.

Box 734
Timmins Ontario
P4N 7G2

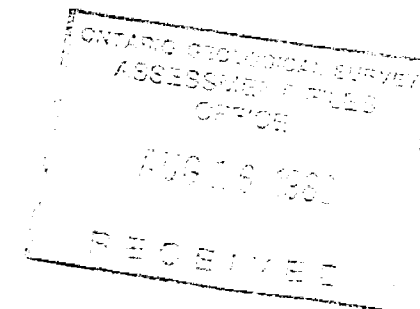

DIAMOND DRILL HOLE LOG

PROJECT: Meridor Resources Limited

HOLE NUMBER: MRG-88-4

AREA: Garrison Township

LOCATION: 600 Feet North of ③ L 789801

CLAIM NUMBER: L 789801

AZIMUTH: 030°

CORE SIZE: BQ

DIP: 50°

DRILLED BY: Norex Drilling

DATE: July 12-14/88

LOGGED BY: Randy D. Maass

CASING: 244.0'

CORE STORED AT: Aunor Minesite

LENGTH: 252.0'

OBJECTIVE: Geological Cross Section South of Destor
Porcupine Fault

ACID TEST: No Test Taken

DURHAM GEOLOGICAL SERVICES INC.

Box 734
Timmins Ontario
P4N 7G2

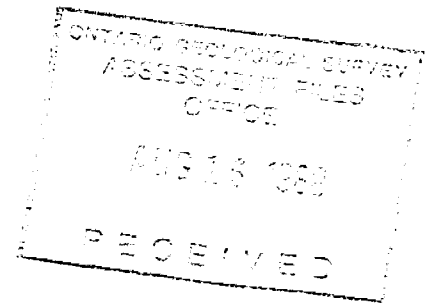

DIAMOND DRILL HOLE LOG

PROJECT: Meridor Resources Limited

HOLE NUMBER: MRG-88-5

AREA: Garrison Township

LOCATION: 500' North of ③ L 789801

CLAIM NUMBER: L 789801

AZIMUTH: 360°

CORE SIZE: BQ

DIP: 60°

DRILLED BY: Norex Drilling

DATE: July 14-19/88

LOGGED BY: Randy D. Maass

CASING: 40.0

CORE STORED AT: Aunor Minesite

LENGTH: 834.0

OBJECTIVE: Geological Crosssection
south of Destor Porcupine Fault

ACID TEST:	Depth	Dip
	0	60°
	250	60°
	500	61°
	800	60°

DURHAM
GEOLOGICAL
SERVICES INC.

DIAMOND DRILL HOLE LOG

FOOTAGE		ROCK TYPE AND DESCRIPTION	Core Angle to Axis	% Sul- phides	SAMPLE			ANALYTICAL RESULT					
From	To				Number	From	To	Length (ft)	Au ppb	As ppm	Pb ppm	Zn ppm	Cu ppm
		-hard and not easily scratched											
516	646	MAFIC VOLCANICS											
		-dark green to dark grey colour with											
		fractures infilled with chlorite and											
		epidote											
		-strongly magnetic											
		fine grained and not foliated											
		-fine disseminated pyrite											
		-hard and not easily scratched											
646	834	DIABASE DYKE											
		-medium to coarse grained intrusive											
		with a very irregular contact											
		-fine grain chill margin at contact											
		with volcanics											
		-dark grey colour											
		-black pyroxene crystals											
		-very massive with no veining and											
		very minor pyrite											
		-weakly magnetic											
		EOH = 834 feet											

Logged by Randy D. Mason

DURHAM GEOLOGICAL SERVICES INC.

Box 734
Timmins Ontario
P4N 7G2

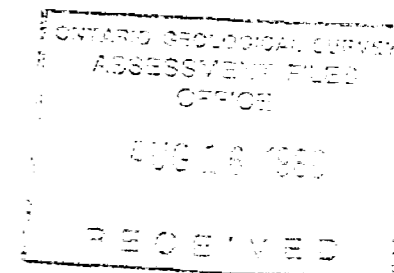

DIAMOND DRILL HOLE LOG

PROJECT: Meridor Resources Limited

HOLE NUMBER: MRG-88-3

AREA: Garrison Township

LOCATION: 300' north of ③ L 789801

CLAIM NUMBER: L 789801

AZIMUTH: 030°

CORE SIZE: BQ

DIP: 50°

DRILLED BY: Norex Drilling

DATE: July 4-12/88

LOGGED BY: Randy D. Maass

CASING: 16.0'

CORE STORED AT: Aunor Minesite

LENGTH: 986.0'

OBJECTIVE: Geological Crosssection
south of Destor Porcupine Fault

ACID TEST:	Depth	Dip
	0	50°
	200'	50°
	500'	44°
	880'	45°

DURHAM
GEOLOGICAL
SERVICES INC.

DIAMOND DRILL HOLE LOG

FOOTAGE		ROCK TYPE AND DESCRIPTION	Core Angle to Axis	% Sul- phides	SAMPLE			ANALYTICAL RESULT						
From	To				Number	From	To	Length (ft)	Au ppb	As ppm	Pb ppm	Zn ppm	Cu ppm	Ag ppm
		-hard and not easily scratched with a knife												
116.6	148.5	MAFIC VOLCANICS												
		-dark green, chloritic mafic volcanics												
		-fine grained, massive and not foliated												
		-very minor veining and minor fine pyrite												
		-soft and easily scratched with a knife												
		-non magnetic												
148.5	194.5	MAFIC DYKE		<1%	10301	162	166	4.0						
		-medium to coarse grained mafic			10302	166	171	5.0						
		intrusive crosscut by numerous pink feldspar porphyry dykes			10303	173.8	175.7	1.9						
		-intrusive is dark green with coarse black amphibole crystals - several			10304	181	184	3.0						
		biotite rich sections - thin veinlets			10305	184	187	3.0						
		of quartz with 2-3% associated moly. and py.			10306	187	189	2.0						
		-porphyry dykes are pink with white subhedral feldspar phenocrysts			10307	189	193	4.0						
					10308	193	194.5	1.5						

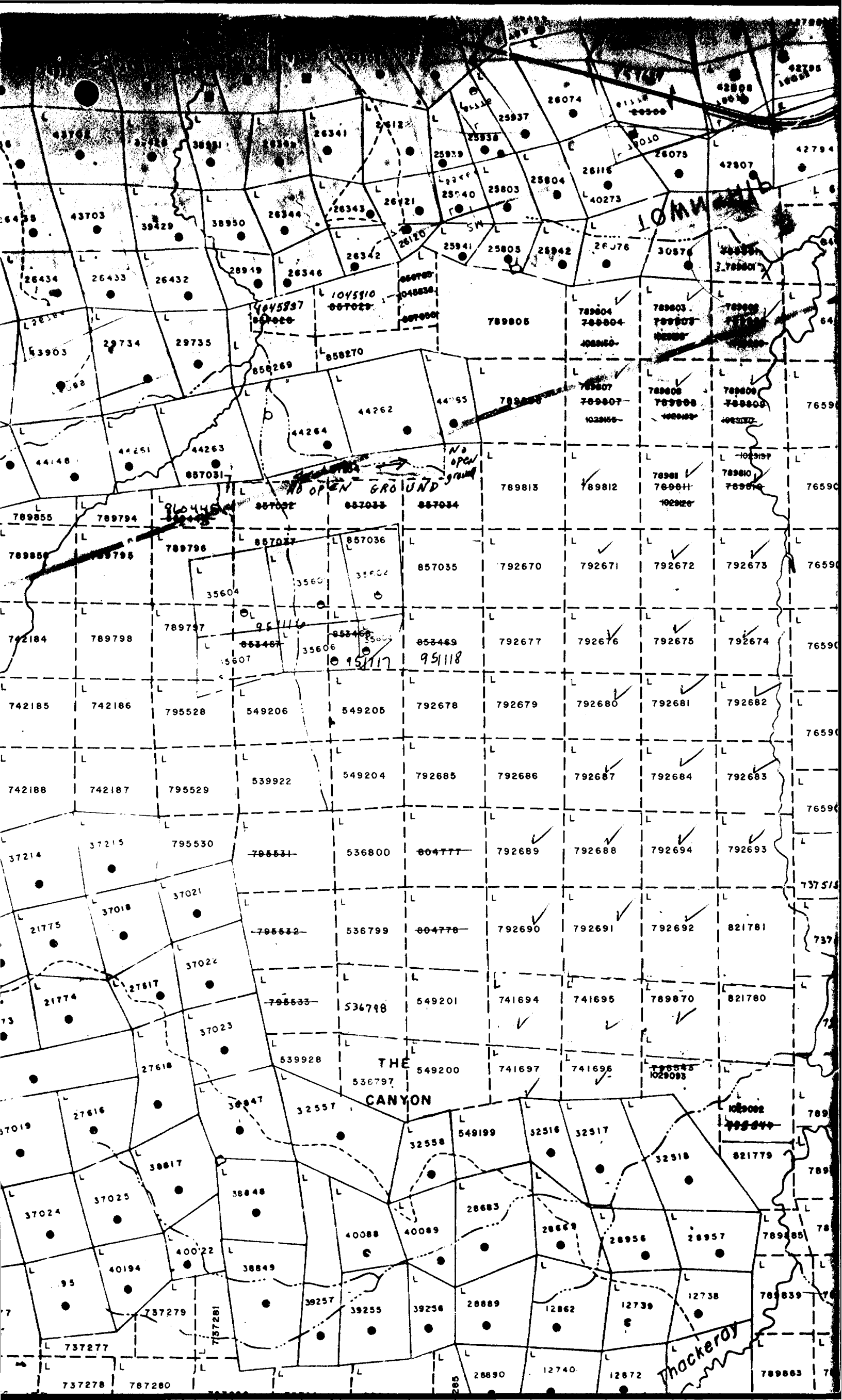

104587
104588
104589
104590

NO OPEN GROUND
grind

THE CANYON

Thackeray

MRG-88-3 (300' North of 3 L78980)

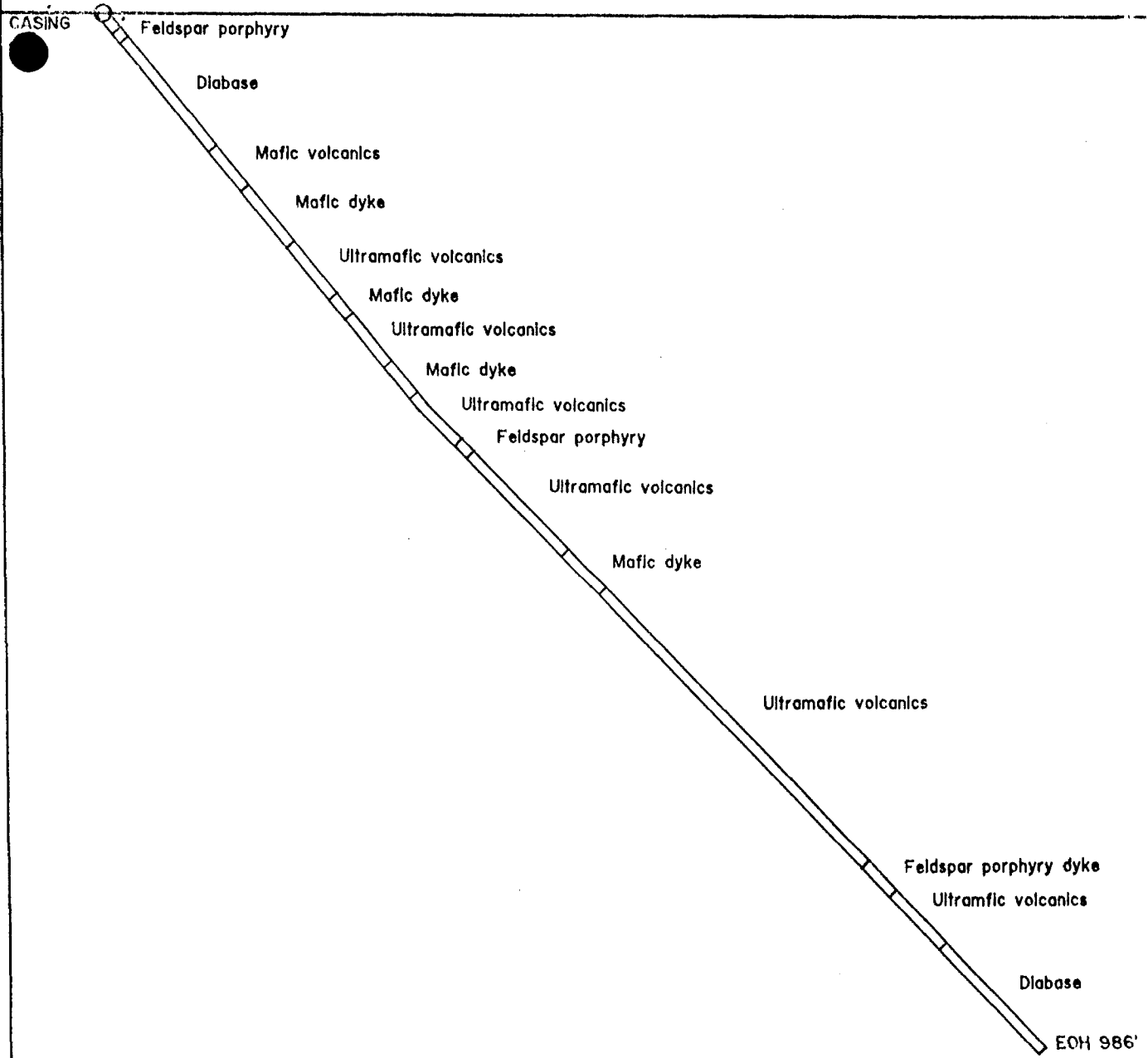

Dip -50°
Az 030°
Depth 986'

GARRISON GEOLOGICAL SURVEY
ASSESSMENT FILES
OFFICE

AUG 16 1988

RECEIVED

REVISIONS	DURHAM GEOLOGICAL SERVICES INC.		
	For:	Meridor Resources Ltd.	
	TMA:	Garrison Township	
		DDH SECTION	
		MRG-88-3	
	Date: July 1988	Drawn: C.G.	Scale: 1"=100'
	NTS:	Approved:	Fig.:

MRG-88-5 (500' North of ③ L78980)

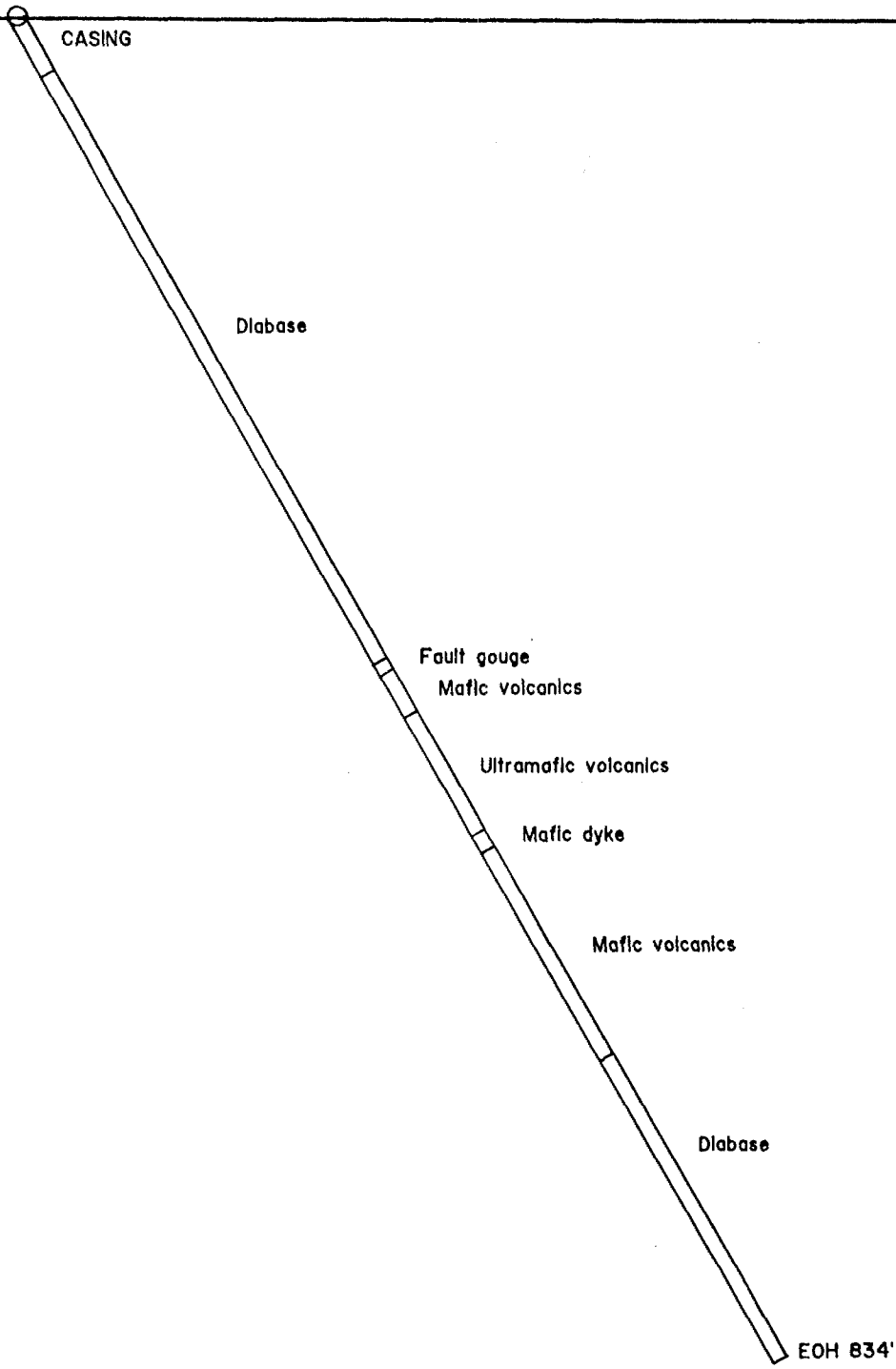

Dip -60°
Az 360°
Depth 834'

ONTARIO GEOLOGICAL SURVEY
ASSESSMENT FILES
OFFICE

AUG 16 1988

RECEIVED

REVISIONS	DURHAM GEOLOGICAL SERVICES INC.		
	For: Meridor Resources Ltd.		
	Title: Garrison Township DDH SECTION MRG-88-5		
	Date: July 1988	Drawn: C.G.	Scale: 1"=100'
	NTS:	Approved:	Fig:

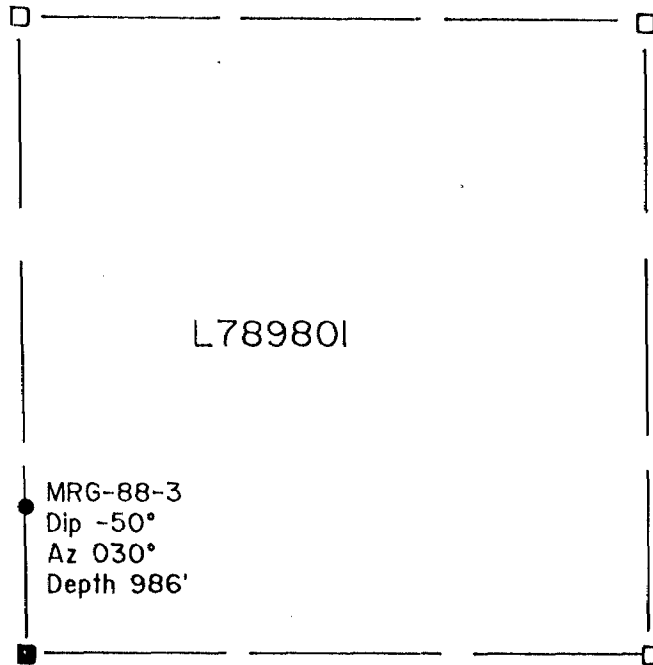

L789801

MRG-88-3
 Dip -50°
 Az 030°
 Depth 986'

ONTARIO GEOLOGICAL SURVEY
 ASSESSMENT FILES
 OFFICE

 AUG 16 1988

 RECEIVED

REVISIONS	DURHAM GEOLOGICAL SERVICES INC.		
	<i>For:</i> Meridor Resources Ltd.		
	<i>Title:</i> Garrison Township		
	DDH LOCATION MAP		
	MRG-88-3		
	<i>Date:</i> July 1988	<i>Drawn:</i> C.G.	<i>Scale:</i> 1"=400'
	<i>NTS:</i>	<i>Approved:</i>	<i>Fig:</i>

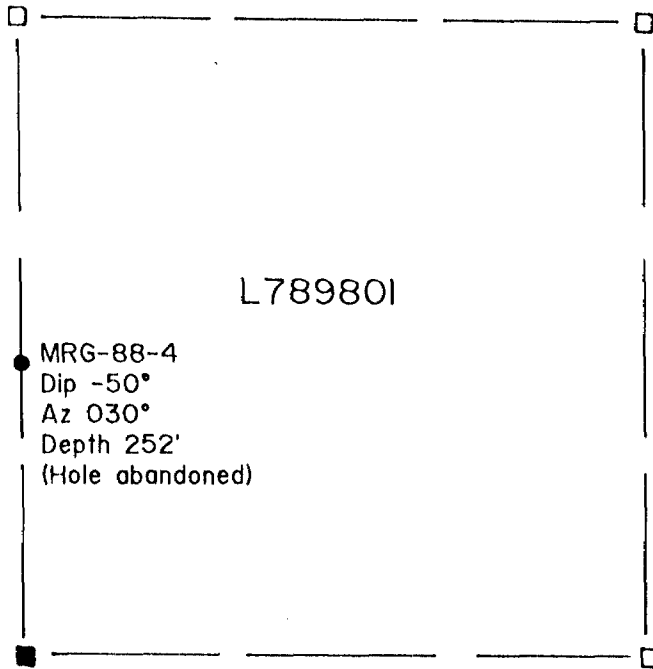

ONTARIO GEOLOGICAL SURVEY
 ASSESSMENT FILES
 OFFICE
 AUG 16 1988
 RECEIVED

<i>REVISIONS</i>	DURHAM GEOLOGICAL SERVICES INC.		
	<i>For:</i> Meridor Resources Ltd.		
	<i>Title:</i> Garrison Township DDH LOCATION MAP MRG-88-4		
	<i>Date:</i> July 1988	<i>Drawn:</i> C.G.	<i>Scale:</i> 1"=400'
	<i>NTS:</i>	<i>Approved:</i>	<i>Flp:</i>

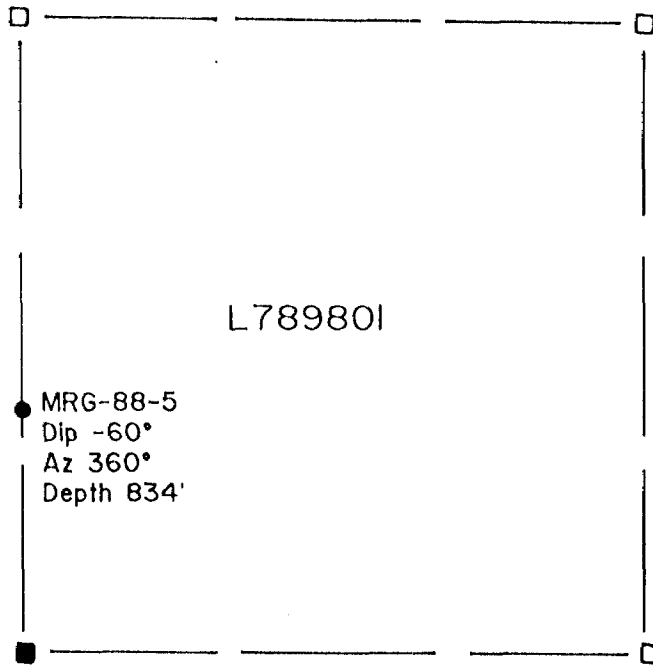

ONTARIO GEOLOGICAL SURVEY
ASSESSMENT FILES
OFFICE

AUG 16 1988

RECEIVED

<i>REVISIONS</i>	DURHAM GEOLOGICAL SERVICES INC.		
	<i>For:</i> Meridor Resources Ltd.		
	<i>Title:</i> Garrison Township		
	DDH LOCATION MAP MRG-88-5		
	<i>Date:</i> July 1988	<i>Drawn:</i> C.G.	<i>Scale:</i> 1"=400'
<i>NTS:</i>	<i>Approved:</i>	<i>Fig:</i>	

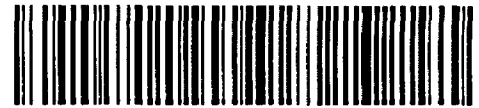

900

Name and Postal Address of Recorded Holder
L. Mineral Holdings Limited
1900-999 West Hastings Street, Vancouver, B.C. V6C 2W2
T-4645

Summary of Work Performance and Distribution of Credits

Total Work Days Cr. claimed 2072	Mining Claim		Work Days Cr.	Mining Claim		Work Days Cr.	Mining Claim		Work Days Cr.
	Prefix	Number		Prefix	Number		Prefix	Number	
for Performance of the following work. (Check one only) <input type="checkbox"/> Manual Work <input type="checkbox"/> Shaft Sinking Drifting or other Lateral Work. <input type="checkbox"/> Compressed Air, other Power driven or mechanical equip. <input type="checkbox"/> Power Stripping <input checked="" type="checkbox"/> Diamond or other Core drilling <input type="checkbox"/> Land Survey									
	Please see attached list			ONTARIO GEOLOGICAL SURVEY ASSESSMENT FILES OFFICE					
				AUG 16 1988					
				RECEIVED					

All the work was performed on Mining Claim(s): **L 789801**

Required Information eg: type of equipment, Names, Addresses, etc. (See Table Below)

Drilling Company	Drill Hole #	Footage
Norex Drilling	MRG-88-3	986.0
Box 88	MRG-88-4	252.0
Porcupine, Ontario	MRG-88-5	834.0
Total Footage		2072.0'

Size of Core	BQ
Dates of Drilling	July 4-19/88

RECEIVED
AUG 8 1988
10:15am

RECORDED
AUG 8 1988
Receipt # _____

Date of Report	Recorded Holder or Agent (Signature)
July 28/88	Randy Maass

Certification Verifying Report of Work

I hereby certify that I have a personal and intimate knowledge of the facts set forth in the Report of Work annexed hereto, having performed the work or witnessed same during and/or after its completion and the annexed report is true.

Name and Postal Address of Person Certifying
Randy D. Maass c/o Durham Geological Services Inc.
Box 1330, Timmins, Ontario P4N 7J8

Date Certified: **July 28/88**
 Certified by (Signature): **Randy Maass**

Table of Information/Attachments Required by the Mining Recorder

Type of Work	Specific information per type	Other information (Common to 2 or more types)	Attachments
Manual Work	Nil	Names and addresses of men who performed manual work/operated equipment, together with dates and hours of employment.	Work Sketch: these are required to show the location and extent of work in relation to the nearest claim post.
Shaft Sinking, Drifting or other Lateral Work			
Compressed air, other power driven or mechanical equip.	Type of equipment	Names and addresses of owner or operator together with dates when drilling/stripping done.	Work Sketch (as above) in duplicate
Power Stripping	Type of equipment and amount expended. Note: Proof of actual cost must be submitted within 30 days of recording.		
Diamond or other core drilling	Signed core log showing; footage, diameter of core, number and angles of holes.	Nil	Nil
Land Survey	Name and address of Ontario land surveyer.		

H. L. Mineral Holdings Ltd.

Garrison Township

<u>Mining Claim</u>	<u>Work Days Credit</u>
L-741694	60
L-741695	60
L-741696	60
L-741697	60
L-789801	60
L-789802	60
L-789803	60 60 Rm
L-789804	80
L-789807	80
L-789808	80
L-789809	60 80 Rm
L-789810	60
L-789811	60
L-789812	60
L-792671	60
L-792672	60
L-792673	60
L-792674	60
L-792675	60
L-792676	60
L-792680	60
L-792682	60
L-792683	60
L-792684	60
L-789870	60

cont'd

<u>Mining Claim</u>	<u>Work Days Credit</u>
L-792687	60
L-792688	60
L-792689	60
L-792690	60
L-792691	60
L-792692	60
L-792693	60
L-792694	60
L-792681	12
Total Days Credit-2072	