



32D12SW0145 27 GARRISON

010

DIAMOND DRILLING

Township: Garrison

Report No: 27

WORK PERFORMED FOR: Salo, R./Dolan, R./Salo, L/Therriault, J.

RECORDED HOLDER: SAME AS ABOVE [x]

: OTHER []

<u>CLAIM No.</u>	<u>HOLE No.</u>	<u>FOOTAGE</u>	<u>DATE</u>	<u>NOTE</u>
L 789805	86-1	392'	Feb/86	(1)
	86-4	286'		
L 789806	86-2	301'		
L 789813	CS-86-4	400'		(2)
	<i>11</i>	<i>1379'</i>		

NOTES: (1) #59-87 (filed in July/87)

#127-87 (filed in Aug/87)

(2) Similar diamond drilling logs; summary and location map added Sept/89 from OMEP #OM86-6-C-275.

CREAM SILVER MINES LTD.

GARRISON TOWNSHIP

DRILL PROGRAM SUMMARY

Cream Silver Mines Ltd. completed a 4,000' drill program on its Garrison Township property east of Matheson, Ontario, between November 28, 1986 and January 19, 1987.

The property consists of 44 contiguous unpatented mining claims in the Larder Lake Mining Division of Northeastern Ontario. The bedrock geology on the property consists of granitic rocks in the southern portion of the property and mafic to ultramafic volcanics and porphyritic intrusive rocks in the northern section of the property.

The drill program was undertaken to test geophysical anomalies on the property and to test an area of favorable geology south of the Destor Porcupine Fault near the north boundary of the property.

Hole CS-86-4, the first diamond drill hole of the program, was drilled to test an E-W trending VLF conductor ^{and it} which intersected 350' of granite. The next two holes, CS-86-5 and CS-86-6, were drilled to test mineralization in the granites which is visible in outcrop occurring in a series of pits and trenches on surface. Both drill holes intersected several

silicified sections within the granites containing 2-3% finely disseminated pyrite. Within the granites there were also several mineralized quartz veins. The remaining four drill holes, CS-86-7A, CS-87-8, CS-87-9 and CS-87-10, were drilled to test favorable geology south of the Destor Porcupine Fault in the northern portion of the property. These holes intersected a series of mafic to ultramafic volcanics and porphyries typical of the geology found associated with the Destor Porcupine Fault zone in the Porcupine gold camp. The porphyries contain 2-3% molybdenite mineralization and 3-5% finely disseminated pyrite.

Approximately 250 samples of the drill core were analysed for Au, As, and Mo. The presence of molybdenite mineralization in the drill core was confirmed by the assay results. The background value for molybdenite was found to be less than 5 ppm with five samples assaying between 800 and 820 ppm molybdenite, and three very anomalous samples with 2100, 2700 and 4300 ppm molybdenite.

~~Sold~~^{Gold} values indicate a background of less than 10 ppb in the drill core with 20 samples returning anomalous values between 100 and 765 ppb gold. Arsenic values were quite low with a background of less than 5 ppm, with the most anomalous sample returning an assay of 72 ppm As.

Sincerely,
Randy D. Mooss
PROJECT GEOLOGIST

DURHAM GEOLOGICAL SERVICES INC.

DIAMOND DRILL HOLE LOG

PROJECT: Cream Silver Mines Ltd.

HOLE NUMBER: CS-86-4

AREA: Garrison Township

LOCATION: L16W, 12 + 50N

CLAIM NUMBER: 789813

AZIMUTH: Grid N

CORE SIZE: BQ

DIP: -45° at collar
-52° at 400'

DRILLED BY: Norex Drilling

DATE: January 1987

LOGGED BY: Randy D. Maass

CASING: 48.0'

CORE STORED AT: Durham Geological Warehouse
Timmins, Ontario

LENGTH: 400.0'

OBJECTIVE: Drill Test
Mineralized Trench

ACID TEST:	Depth	Dip
	0.0	-45°
	400.0	-52°

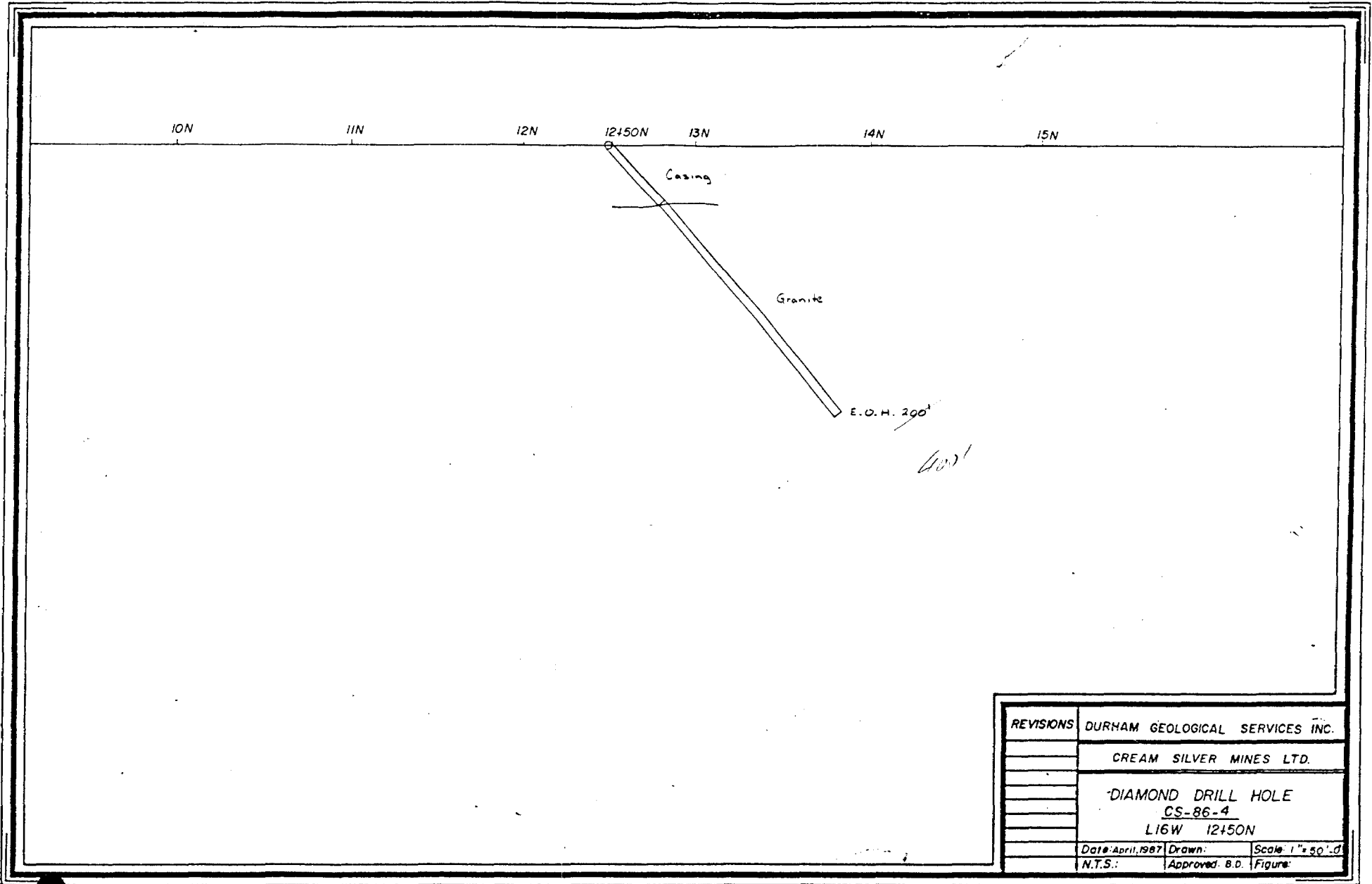

REVISIONS	DURHAM GEOLOGICAL SERVICES INC.	
	CREAM SILVER MINES LTD.	
	DIAMOND DRILL HOLE	
	CS-86-4	
	L16W 12+50N	
	Date: April, 1987	Scale: 1" = 50' d
	N.T.S.:	Approved: B.D. Figure:

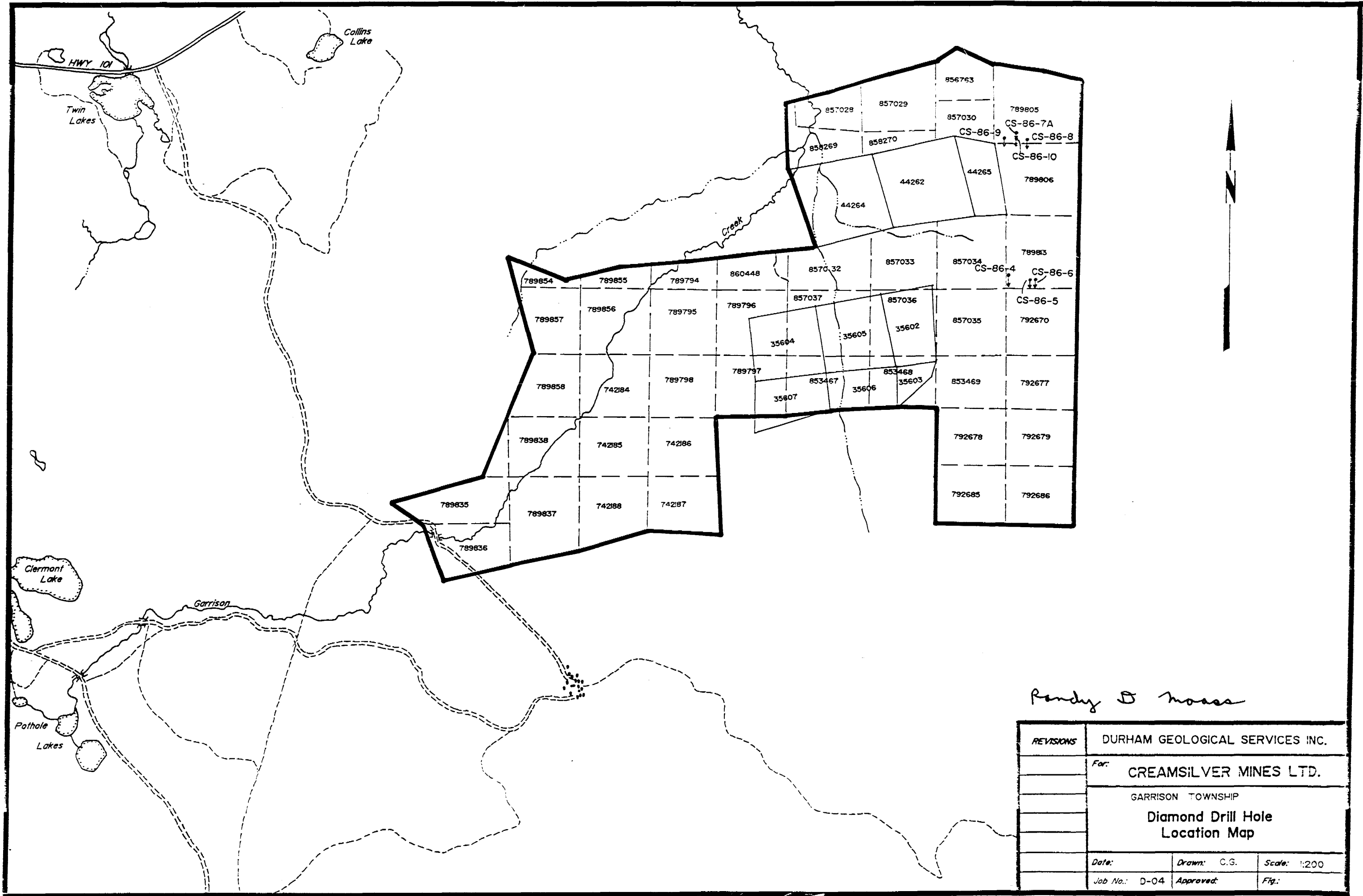

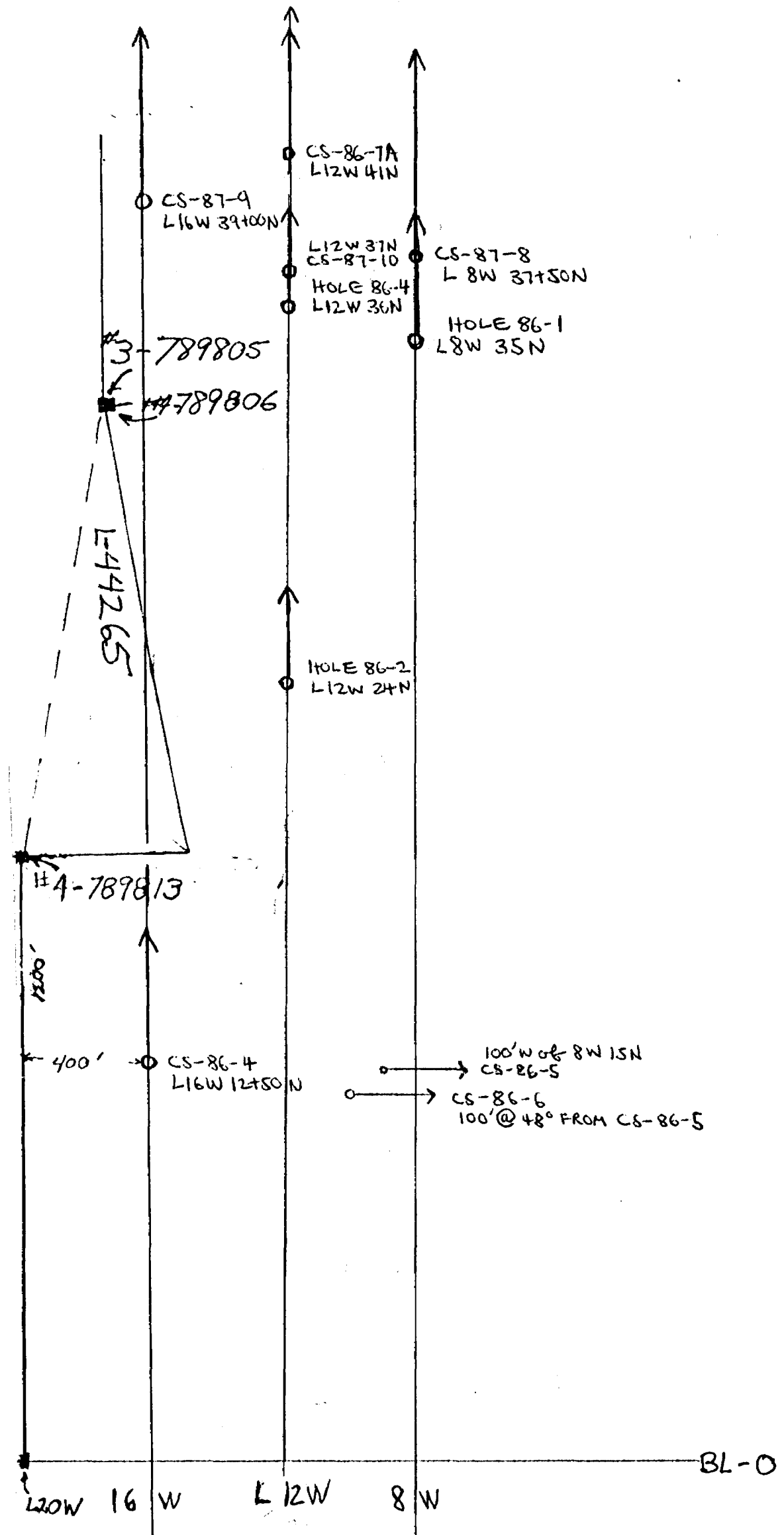

DRILL HOLE LOCATIONS
 SCALE 1" = 400'
 CREAM SILVER MINES LTD
 GARRISON TOWNSHIP

DOMINION OF CANADA
Province of Ontario

IN THE MATTER OF

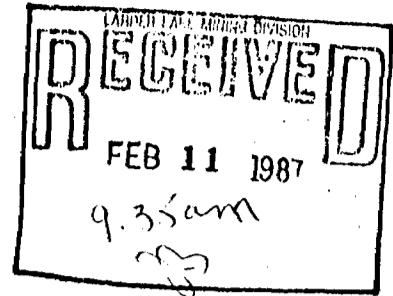

To Wit:

I, *Robert Bruce Durham*
of the *City* of *Timmins*
DISTRICT of *COCHRANE*
DO SOLEMNLY DECLARE, that

in the

*I have personal knowledge that Ron
McKinnon is the beneficial owner of the following
contiguous unpatented mining claims in the
Larder Lake Mining Division: 1 742184 742185,
742186 742187 742188, 789794, 789795, 789796, 789797
789798, 789805, 789806, 789813 789834, 789835
789836, 789837, 789838 789854, 789855, 789856
789857, 792670, 792678, 792679, 860448, 792685, 7926
789858, 792677, 792690 795528, 795529
951116, 951117, 951118
795530 856763 860445. I also declare that*

*I have personal knowledge that Cream Silver
Mines Ltd. hold the property under option
from Mr McKinnon and have had the
property under option for the full duration
of the drilling that is being filed for
assessment credit.*

AND I make this solemn Declaration conscientiously believing it to be true, and know
ing that it is of the same force and effect as if made under oath and by virtue of the
Canada Evidence Act.

Declared before me at the *City*
of *Timmins*
in the *District*
of *Cochrane*
this *6th* day of *February*.
A. D., 19 *87* *2:43 P.M.*

Bruce Durham

Colin J. ...
A COMMISSIONER APPOINTED



Drilling Company HERBERT FUNK DIAMOND DRILLING		Collar Elevation —	Bearing of hole from true North 0°	Total Footage 392	Dip of Hole at Collar 45°	Location of hole in relation to a fixed point on the claim.	Map Reference No.	Claim No.
Date Hole Started FEB 5/	Date Completed FEB 12 /	Date Logged MAR. 24/86	Logged by FENTON SCOTT		Ft.		Location (Twp., Lot, Con. or Lat. and Long.) GARRISON TOWNSHIP	Property Name GARRISON
Exploration Co., Owner or Optionee CREAM SILVER MINES		Date Submitted MAY 20/86	Submitted by (Signature) <i>Fenton Scott</i>		Ft.			

Footage		Rock Type	Description Colour, grain size, texture, minerals, alteration, etc.	Planar Feature Angle*	Core Specimen Footage*	Your Sample No.	Sample Footage		Sample Length	Assays †	
From	To						From	To		Au	
0	31	CASING	IN OVERBURDEN								
31	53	AMPHIBOLITE	DARK GREY-GREEN, MEDIUM GRAINED, HYBRID CONTACT ROCK, RECRYSTALLIZED VOLCANICS, CUT BY FREQUENT GRANITE LAYERS, LENSES 1" to 12", CONFORMABLE WITH FOLIATION	35° 40° 45° 50°	25° 35° 45° 60°	CG-1 CG-2 CG-3	34 43 48	38 48 53	4.0 5.0 5.0	.002 NIL .002	
			34-38 - DISSEM PYRITE // BEDDING	55°	75°						
			43-48 " " // "								
			48-53 " " // "								
53	54.5	GABBRO	DARK GREEN, MEDIUM-GRAINED, CHLORITIZED.								
54.5	62	BASIC TUFF	DARK GREY-GREEN, FINE TO MEDIUM GRAINED, STRONGLY FOLIATED. 5% QUARTZ, 5% AYLITE IN LENSES AND IRREGULAR LAYERS	60°	60°						
			54.5-60 < 1% DISSEM PYRITE, AYLITE CONTACTS			CG-4	54.5	60	5.5	.002	
			60-62 < 1% " " "			CG-5	60	62	2.0	NIL	
62	62.7	GABBRO	AS AT 53-54.5								
62.7	80	BASIC TUFF	DARK GREEN, RECRYSTALLIZED	65° 70° 75° 80°	35° 60° 45° 35°	CG-6 CG-7	62.7 70	70 74	7.3 4.0	.002 NIL	
80	108	BASIC TUFF	GREEN, GREY FINE GRANULIC, FOLIATED, LESS ALTERED THAN 62.7-80 SECTION	85°	35°						
			84-89 1% STREAKS DISSEM. PYRITE	90°	40°	CG-8	84	89	5.0	.002	
			89-94 1% " " "	95°	45°	CG-9	89	94	5.0	.002	
			94-98.2 1% " " "	100° 105° 110°	55° 45° 40°	CG-10	94	98.2	4.2	.002	



Fill in on
every page

Hole No.
86-1

Page No.
3

Drilling Company		Collar Elevation	Bearing of hole from true North	Total Footage	Dip of Hole at Collar	Location of hole in relation to a fixed point on the claim.	Map Reference No.	Claim No.
Date Hole Started	Date Completed	Date Logged	Logged by		Ft.		Location (Twp., Lot, Con. or Lat. and Long.)	
Exploration Co., Owner or Optionee		Date Submitted	Submitted by (Signature)		Ft.			
					Ft.			Property Name

Footage		Rock Type	Description Colour, grain size, texture, minerals, alteration, etc.	Planar Feature Angle *	Core Specimen Footage †	Your Sample No.	Sample Footage		Sample Length	Assays †	
From	To						From	To			
329	343	DIORITE	DARK GREY GREEN, MEDIUM GRAINED								
343	367	DIORITE	GREEN, FINE GRAINED, CHLORITIZED	45°							
367	374	TALC SCHIST.	MEDIUM GREEN, SERPENTINIZED,								
374	382.5	DIORITE	CHLORITIZED, GREEN, SERPENTINIZED, MAY BE AMPHIBOLITE.								
382.5	392	SERPENTINIZED PHEKLOPHANE	DARK GREEN, SCHISTOSE,								



Drilling Company HERBERT FUNK DIAMOND DRILLING		Collar Elevation	Bearing of hole from true North	Total Footage 301	Dip of Hole at 45 Collar 45°	Location of hole in relation to a fixed point on the claim.	Map Reference No.	Claim No.
Date Hole Started FEB 13/86	Date Completed FEB 18/86	Date Logged FEB 22/86	Logged by F. F. W.		Fl.		Location (Twp., Lot, Con. or Lat. and Long.) GARRISON TWP	Property Name GARRISON
Exploration Co., Owner or Optionee CREAM SILVER MINES		Date Submitted	Submitted by (Signature)		Fl.			
					Fl.			

Footage		Rock Type	Description Colour, grain size, texture, minerals, alteration, etc.	Planar Feature Angle *	Core Specimen Footage †	Your Sample No.	Sample Footage		Sample Length	Assays †	
From	To						From	To		Aw	
0	56		CASING IN OVERBURDEN								
56	301	GRANITE	PINK, COARSE GRAINED, RAKE FRACTURES 110 - 112.5, BRICK RED ALTERATION WITH FRACTURE 150.2 - 150.9 - RED ALTERATION, 2% FINE DISSEMINATED PYRITE ASSOCIATED WITH FRACTURE 217.5 - 218.5 - RED ALTERATION 2% FINE DISSEMINATED PYRITE	35°							
						GG-16	150.2	150.9	0.7	.03	
						RC-17	217.5	218.5	1.0	.01	



Ontario

Ministry of
Natural
Resources

Diamond
Drilling
Log

Fill in on
every page

Hole No. **86-4** Page No. **1**

Drilling Company HERBERT FUNK DIAMOND DRILLING		Collar Elevation	Bearing of hole from true North	Total Footage	Dip of Hole at Collar 45°	Location of hole in relation to a fixed point on the claim.	Map Reference No.	Claim No.
Date Hole Started FEB 28/86	Date Completed FEB 28/86	Date Logged	Logged by F SCOTT		Ft.		Location (Twp., Lot, Con. or Lat. and Long.) GARRISON TOWNSHIP.	Property Name GARRISON
Exploration Co., Owner or Optionee CREAM SILVER MINES		Date Submitted	Submitted by (Signature) <i>F. Scott</i>		Ft.			
					Ft.			

Footage		Rock Type	Description Colour, grain size, texture, minerals, alteration, etc.	Planar Feature Angle*	Core Specimen Footage †	Your Sample No.	Sample Footage		Sample Length	Assays †
From	To						From	To		
0	50		CASING IN OVERBURDEN.							
50	118	AMPHIBOLITE	DARK GREY - FINE TO MEDIUM GRAINED, BIOTITE, ORIGINALLY BASIC VOLCANICS 50-57 - 20% 1" GRANITE LAYERED HYBRID ROCK. 105-107 - 1/4" VEINLETS OF QUARTZ AND PYRITE AT 45°-60° CORE AXIS.	55°		CG-31	105	107	2.0	
118	123	GRANITE	GREY, MEDIUM - GRAINED							
123	134.5	AMPHIBOLITE	AS AT 50-118, INCREASED LAMINATION	45° TO 60°						
134.5	148.8	GRANITE	PINK, MEDIUM GRAINED - 15% AMPHIBOLITE INCLUSIONS							
148.8	152	BRECCIA	GRANITE/AMPHIBOLITE							
152	167	HORNfels	DARK GREY, CHLORITIZED, HEAVY BIOTITE, TRACE PYRITE.	45°						
167			GREY, FINE GRAINED							
177	179.6	AMPHIBOLITE	BIOTITE-RICH INCLUSION, LAMINATED	40°						
179.6	190	GRANITE PORPHYRY	GREY, MEDIUM GRAINED 182-185 - INCLUSION							
190	225	SERPENTINIZED PREGIOTITE	GREY GREEN, SHEARED, SERPENTINIZED, SOAPSTONE FAULT ZONE 184.5-196 PINK ALTERED PORPHYRY, SILICIFIED INCLUSION OR VEIN 1/2% PYRITE 1% GREY SULFIDE	45° TO 60°		CG-32	184.5	196	1.5	

* For features such as foliation, bedding, schistosity, measured from the long axis of the core.

† Additional credit available. See Assessment Work Regulations.



Ontario

Ministry of
Natural
Resources

**Diamond
Drilling
Log**

Fill in on
every page

Hole No.
86-4

Page No.
2

Drilling Company HERBERT FUNK DIAMOND DRILLING		Collar Elevation	Bearing of hole from true North	Total Footage 286'	Dip of Hole at Collar	Location of hole in relation to a fixed point on the claim.	Map Reference No.	Claim No.
Date Hole Started	Date Completed	Date Logged	Logged by F. SCOTT		Ft.		Location (Twp., Lot, Con. or Lat. and Long.)	
Exploration Co., Owner or Optionee		Date Submitted	Submitted by (Signature) 		Ft.			
					Ft.			Property Name GARRISO

Footage From	Footage To	Rock Type	Description Colour, grain size, texture, minerals, alteration, etc.	Planar Feature Angle *	Core Specimen Footage †	Your Sample		Sample Footage		Sample Length	Assays †	
						Sample No.	From	To	Length		Gr.	
			212 - 214.5 - PINK QUARTZ-CALCINATE IN SHEAL - 2% PYLITE			CG-33	212	214.5	2.5'			
			214.5 - 217			CG-34	214.5	217	2.5'			
225'	255.3	ANDOSITE (2.)	GREY, FINE GRAINED, ALTERED, INCIPIENT BRECCIATION SHEARING	60°								
255.3	263	PORPHYRY	PINK, FINE GRAINED 1% FINE PYLITE THROUGHOUT			CG-35	255.3	260	4.7			
			263 - 264.5 - CARBONATED			CG-36	260	263	3.0			
						CG-37	263	265	2.0			
265	286	CALCINATED PERIDOTITE	MEDIUM GREY, FINE GRAINED, TRACES DISSEMINATED MAGNETITE (LISTWANITE)									

* For features such as foliation, bedding, schistosity, measured from the long axis of the core.

† Additional credit available. See Assessment Work Regulations.

HOLE NO.
 DRILL HOLE LOG CS-86-4

TOTAL FOOTAGE 400'
 DIP AT COLLAR 45°
 DIAMETER OF CORE BQ

Footage		ROCK TYPE AND DESCRIPTION	Core Angle to Axis	% Sulphides	SAMPLE			Analytical Result		
From	To				Number	From	To	Length (feet)	Au ppb	Ag ppm
0.0	48.0	CASING								
48.0	400.0	GRANITE		< 1%						
		- massive - pink - color granite								
		- non-foliated - coarse grained								
		- mineralogy consists of mainly quartz, feldspar and orthoclase								
		- crystals of these minerals are subhedral to euhedral form								
		- minor mafic volcanic xenoliths								
		- dark green chlorite is present along fracture planes								
		- minor fracturing infilled by quartz, calcite and chlorite								
		- very minor py. in quartz veinlets								
		E.O.H. = 400'								
		Logged by Randy D Moass								

ONTARIO GEOLOGICAL SURVEY
 RESEARCH OFFICE
 APR 13 1987
 RECEIVED

Name and Postal Address of Recorded Holder: Randal Salo, M21107, Robert Dolan M21281, Larry Salo M20010, et al
 Janet Mericault M21589. All General Delivem/Connaught except R Dolan
 Prospector's Licence No. whose address is RR#3 Sandy Falls Ed Timmins

Total Work Days Cr. claimed: 1379.1281

for Performance of the following work. (Check one only)	Mining Claim			Mining Claim			Mining Claim		
	Prefix	Number	Work Days Cr.	Prefix	Number	Work Days Cr.	Prefix	Number	Work Days Cr.
<input type="checkbox"/> Manual Work <input type="checkbox"/> Shaft Sinking Drifting or other Lateral Work. <input type="checkbox"/> Compressed Air, other Power driven or mechanical equip. <input type="checkbox"/> Power Stripping <input checked="" type="checkbox"/> Diamond or other Core drilling <input type="checkbox"/> Land Survey	L	789805	140	L	792686	140			
		789806	140		856763	140			
		789813	140						
		792670	140						
		792677	140						
		792679	140						
	792678	140							
	792685	140							



32D12SW0145 27 GARRISON

900

RECEIVED

All the work was performed on Mining Claim(s): L789805, L789806, L789813

Required Information eg: type of equipment, Names, Addresses, etc. (See Table Below)

Herbert Funk Diamond Drilling: Timmins Ont.
 Dates of Drilling Footage
 CS86-1 Feb 5-12/86 392
 86-2 Feb 13-18/86 301
 86-4 Feb 24-28/86 286
 979 feet.
 Norex Drilling - Porcupine Ont.
 Hole CS86-4 Nov 30/86 - Dec 1/86
 Total Footage 400 feet.

1379
 1281
 98 for future use

RECORDED

FEB 27 1987

Receipt # _____

Date of Report: Feb 27/87
 Recorded Holder or Agent (Signature): R. Bruce Durham

Certification Verifying Report of Work

I hereby certify that I have a personal and intimate knowledge of the facts set forth in the Report of Work annexed hereto, having performed the work or witnessed same during and/or after its completion and the annexed report is true.

Name and Postal Address of Person Certifying: R. Bruce Durham

Box 734 Timmins Ont P4N 7G2
 Date Certified: Feb 27/87
 Certifying Agent (Signature): R. Bruce Durham

Table of Information/Attachments Required by the Mining Recorder

Type of Work	Specific information per type	Other information (Common to 2 or more types)	Attachments
Manual Work	Nil	Names and addresses of men who performed manual work/operated equipment, together with dates and hours of employment.	Work Sketch: these are required to show the location and extent of work in relation to the nearest claim post.
Shaft Sinking, Drifting or other Lateral Work			
Compressed air, other power driven or mechanical equip.	Type of equipment	Names and addresses of owner or operator together with dates when drilling/stripping done.	
Power Stripping	Type of equipment and amount expended. Note: Proof of actual cost must be submitted within 30 days of recording.		
Diamond or other core drilling.	Signed core log showing; footage, diameter of core, number and angles of holes.	Nil	Work Sketch (as above) in duplicate
Land Survey	Name and address of Ontario land surveyer.		Nil



120/87

Name and Postal Address of Recorded Holder ML Mineral Holdings Ltd. 1300 - 999 West Hastings St., VANCOUVER, B.C. V6C 2W2	Prospector's Licence No. T-4645
--	------------------------------------

Summary of Work Performance and Distribution of Credits

Total Work Days Cr. claimed	Mining Claim			Work Days Cr.	Mining Claim			Work Days Cr.	Mining Claim			Work Days Cr.
	Prefix	Number	Days Cr.		Prefix	Number	Days Cr.		Prefix	Number	Days Cr.	
for Performance of the following work. (Check one only)	L	792686	19									
<input type="checkbox"/> Manual Work												
<input type="checkbox"/> Shaft Sinking Drifting or other Lateral Work.												
<input type="checkbox"/> Compressed Air, other Power driven or mechanical equip.												
<input type="checkbox"/> Power Stripping												
<input type="checkbox"/> Diamond or other Core drilling												
<input type="checkbox"/> Land Survey												

All the work was performed on Mining Claim(s):

Required Information eg: type of equipment, Names, Addresses, etc. (See Table Below)

As per report filed Feb. 27/87, a copy of which is attached.
 Unused credits Feb. 27/87 report 98 days
 Credit being applied 19 days
 Remaining Credit 79 days

ONTARIO GEOLOGICAL SURVEY
RECEIVED
MAY 12 1987

LAKESHORE LAKE MINING DIVISION
RECEIVED
MAR 28 1987

RECORDED

MAR 28 1987

Receipt # _____

Date of Report Mar. 27/87	Recorded Holder or Agent (Signature) <i>Bruce Durham</i>
------------------------------	---

Certification Verifying Report of Work

I hereby certify that I have a personal and intimate knowledge of the facts set forth in the Report of Work annexed hereto, having performed the work or witnessed same during and/or after its completion and the annexed report is true.

Name and Postal Address of Person Certifying Bruce Durham, Box 734, Timmins, Ontario P4N 7G2	Date Certified Mar. 27/87	Certified by (Signature) <i>Bruce Durham</i>
---	------------------------------	---

Table of Information/Attachments Required by the Mining Recorder

Type of Work	Specific information per type	Other information (Common to 2 or more types)	Attachments
Manual Work	Nil	Names and addresses of men who performed manual work/operated equipment, together with dates and hours of employment.	Work Sketch: these are required to show the location and extent of work in relation to the nearest claim post.
Shaft Sinking, Drifting or other Lateral Work			
Compressed air, other power driven or mechanical equip.	Type of equipment	Names and addresses of owner or operator together with dates when drilling/stripping done.	Work Sketch (as above) in duplicate
Power Stripping	Type of equipment and amount expended. Note: Proof of actual cost must be submitted within 30 days of recording.		
Diamond or other core drilling	Signed core log showing; footage, diameter of core, number and angles of holes.		
Land Survey	Name and address of Ontario land surveyer.	Nil	Nil

Beneficial Interest to Don McKinnon, Mining Act

Prospector's Licence No. [Blank]
 and Postal Address of Recorded Holder: Robert Dolan M21281, Larry Salo M20010, net Theriault M21589. All General Delivem/Connaught except R. Dolan whose address is RR #2 Sandy Falls Rd Timmins

Work Days Claimed	Mining Claim			Mining Claim			Mining Claim		
	Prefix	Number	Work Days Cr.	Prefix	Number	Work Days Cr.	Prefix	Number	Work Days Cr.
1379 (1281)	L	789805	140	L	792686	140			
		789806	140		856763	140			
		789813	140						
		792670	140						
		792677	140						
		792679	140						
		792678	140						
		792685	140						

The work was performed on Mining Claim(s): L789805, L789806, L789813

Required Information eg: type of equipment, Names, Addresses, etc. (See Table Below)

Herbert Funk Diamond Drilling: Timmins Ont.
 Dates of Drilling Footage
 CS86-1 Feb 5-12/86 392 - L789805
 86-2 Feb 13-18/86 301 L789806
 86-3 Feb 24-28/86 286 L789805
 979 feet.
 Jones Drilling - Porcupine Ont.
 Hole CS86-4 Nov 30/86 - Dec 1/86
 Total Footage 400 feet. - L789813
 979
 400
 1379
 1379
 1st Rec'd Feb 6/87
RECORDED
 FEB 27 1987
 Receipt # _____
 98 a for future use
 Date of Report: Feb 27/87
 Recorded Holder or Agent (Signature): R. Bruce Durham

Verification Verifying Report of Work

I hereby certify that I have a personal and intimate knowledge of the facts set forth in the Report of Work annexed hereto, having performed the work and witnessed same during and/or after its completion and the annexed report is true.

Name and Postal Address of Person Certifying: R. Bruce Durham

Date Certified: Feb 27/87
 Certified by (Signature): R. Bruce Durham

Additional Information/Attachments Required by the Mining Recorder

Type of Work	Specific information per type	Other information (Common to 2 or more types)	Attachments
Manual Work	Nil	Names and addresses of men who performed manual work/operated equipment, together with dates and hours of employment.	Work Sketch: these are required to show the location and extent of work in relation to the nearest claim post.
Shaft Sinking, Drifting or other Lateral Work			
Compressed air, other power driven or mechanical equip.	Type of equipment Type of equipment and amount expended.		

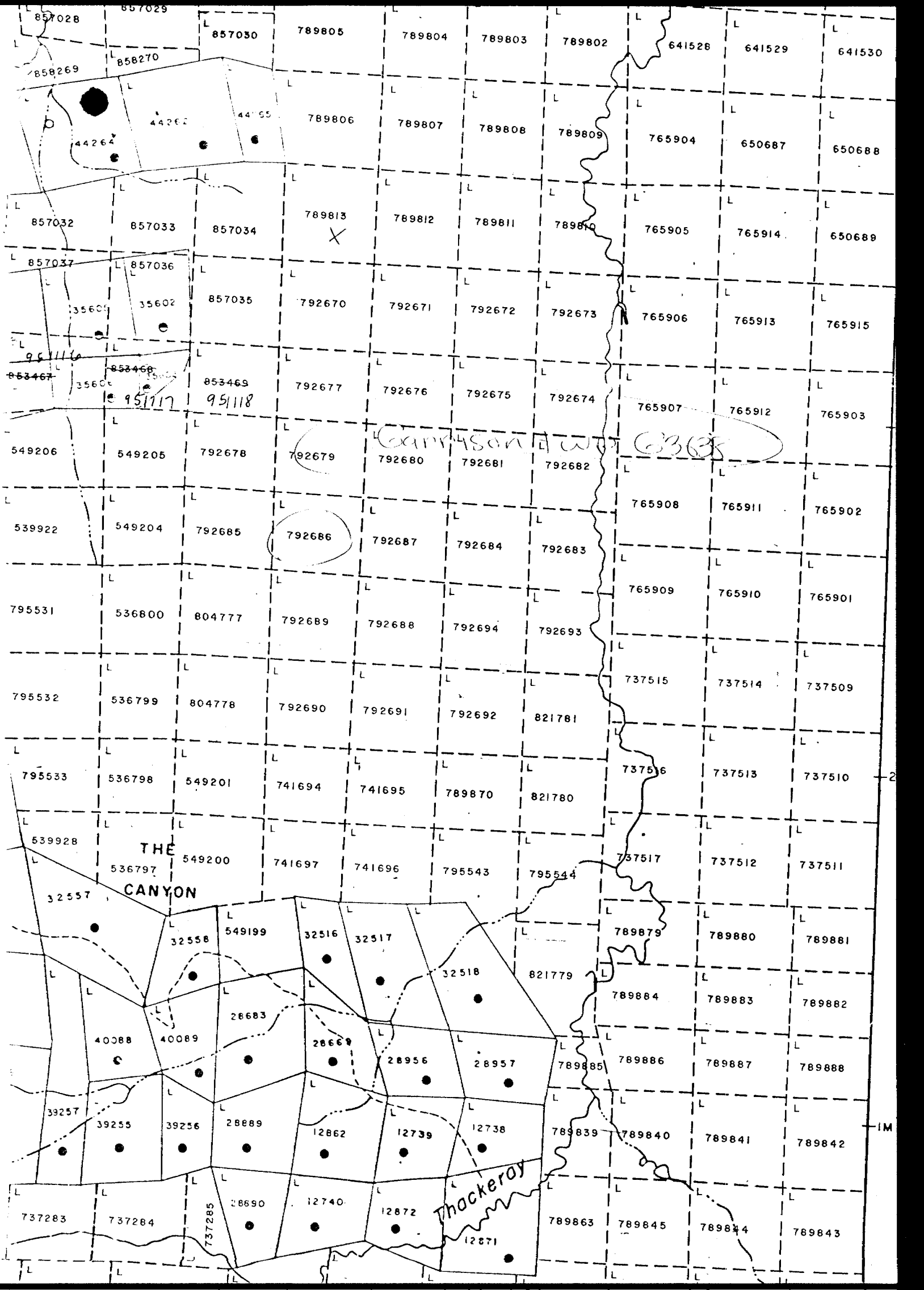

RAND TOWNSHIP

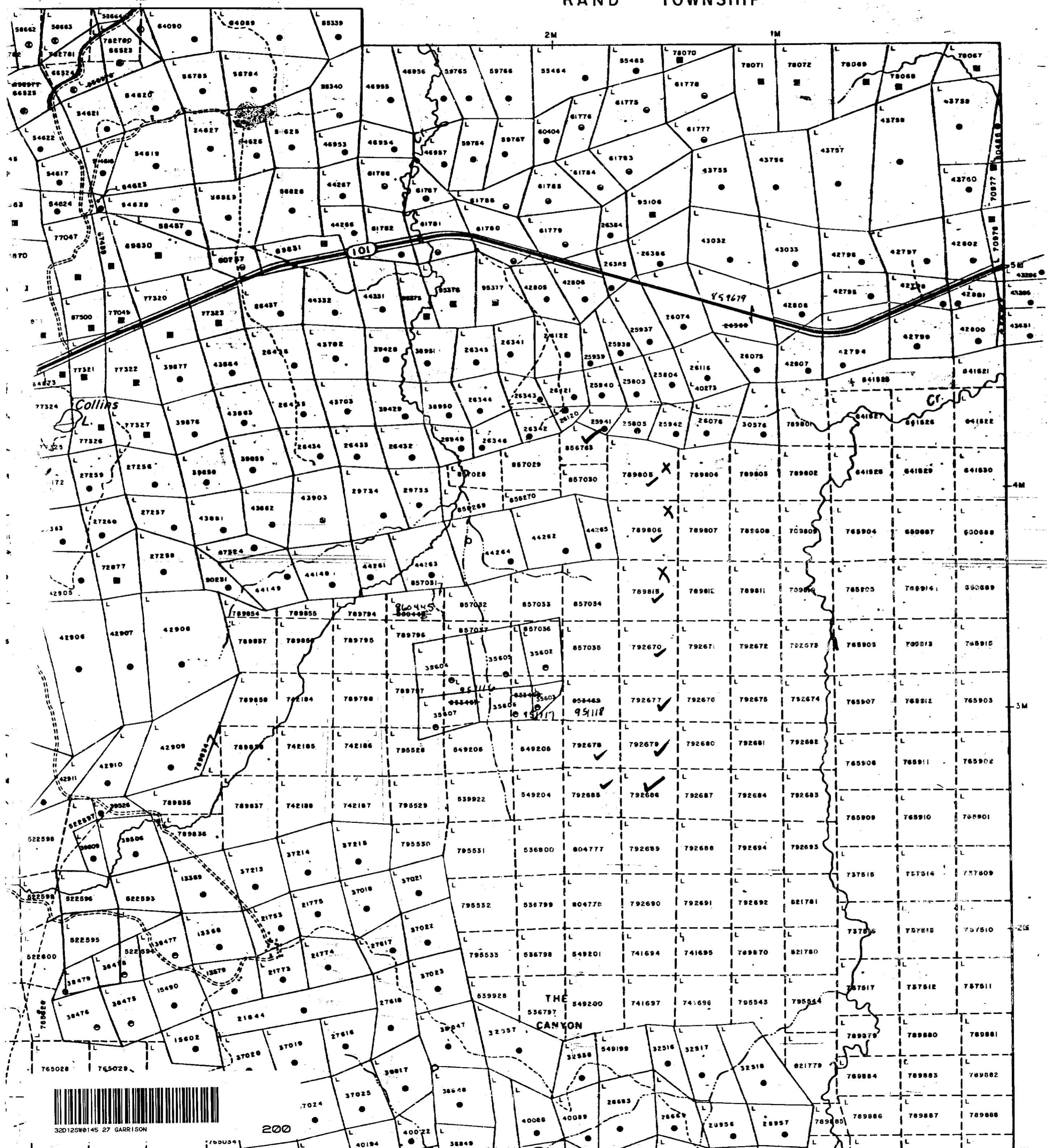

LEGEND

- HIGHWAY AND ROUTE No.
- OTHER ROADS
- TRAILS
- SURVEYED LINES:
 - TOWNSHIPS, BASE LINES, ETC.
 - LOTS, MINING CLAIMS, PARCELS, ETC.
- UNSURVEYED LINES:
 - LOT LINES
 - PARCEL BOUNDARY
 - MINING CLAIMS ETC.
- RAILWAY AND RIGHT OF WAY
- UTILITY LINES
- NON-PERENNIAL STREAM
- FLOODING OR FLOODING RIGHTS
- SUBDIVISION OR COMPOSITE PLAN
- RESERVATIONS
- ORIGINAL SHORELINE
- MARSH OR MUSKEG
- MINES
- TRAVERSE MONUMENT

DISPOSITION OF CROWN LANDS

TYPE OF DOCUMENT	SYMBOL
PATENT, SURFACE & MINING RIGHTS	●
SURFACE RIGHTS ONLY	○
MINING RIGHTS ONLY	◐
LEASE, SURFACE & MINING RIGHTS	■
SURFACE RIGHTS ONLY	◼
MINING RIGHTS ONLY	◻
LICENCE OF OCCUPATION	▼
ORDER-IN-COUNCIL	OC
RESERVATION	⊙
CANCELLED	⊖
SAND & GRAVEL	⊕

NOTE: MINING RIGHTS IN PARCELS PATENTED PRIOR TO MAY 6, 1913, VESTED IN ORIGINAL PATENTEE BY THE PUBLIC LANDS ACT, R.S.O. 1970, CHAP. 360, SEC. 63, SUBSEC. 1.

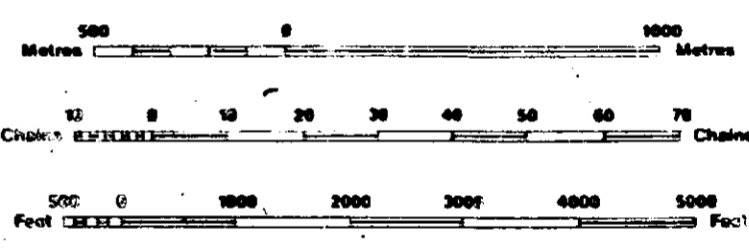

SCALE 1:20 000

Application for S. Rights under public Lands Act.

Garrison twp
G 3638

Rec'd Oct 21, 1986

TOWNSHIP

