

32D12SW0307 2.6826 HOLLOWAY

010

CAMFLO MINES LIMITED
GEOPHYSICAL REPORT
ON THE
'EAST BLOCK' PROPERTY
HARKER AND HOLLOWAY TOWNSHIPS
LARDER LAKE MINING DIVISION
NORTHEASTERN ONTARIO

RECEIVED
JUL 11 1984
MINING LANDS SECTION

June 1984

Gilles Tousignant, ing. geol.



32D12SW0307 2.6826 HOLLOWAY

010C

TABLE OF CONTENTS

	<u>Page</u>
I. Introduction	1
II. Regional Geology	1
III. Geology of the Property	2
IV. Work Done by Camflo	2
V. Conclusion	3

I. Introduction

The 'East block' of the Camflo property is located in Holloway and Harker Townships, Northeastern Ontario, Larder Lake Mining Division.

It includes the following 16 claims:

1 - In Holloway Township:

L-633296, L-633297

2 - In Harker Township:

L-633298, L-633299, L-633300, L-633301, L-633303, L-633305, L-633306, L-633308, L-633309, L-633310, L-633311, L-628520, L-628533, L-628534.

These claims were staked for Camflo Mines Limited in 1982; they are east-west and cover the western extension of the Ghostmount Fault. No work has been reported on these claims.

The general area is 35 miles east of Matheson, via highway 101 going to the Quebec border, and the claims are two miles south of the main road. A timber road gives easy access by truck or car to the west part of the claims.

II. Regional Geology

Most of the area is underlain by Keewatin sediments and volcanics, cut by pre-Algonian basic and ultra basic intrusives.

The volcanic rocks are basic to intermediate in composition, and are found as fine to coarse grained flows, as pillow lavas, or as flow and pillow breccias, with thin bands of associated pyroclastics. Sediments, ranging from argillites to greywackes, and chert beds are sometimes intercalated between the different flows.

The strike of the different formations is N85°E, with a steep south dip and they are facing to the south.

North of the township, a major sedimentary unit is in contact with the volcanics, along the inferred Porcupine - Destor fault zone. These sediments are greywacke, slate, conglomerate and iron formation. The volcanic-sediments contact is not exposed, and, as seen in the drill core, it seems to be marked by a strong fault. There are very few outcrops of this unit.

The intrusives are usually diabasic and are often found as sills; sometimes, however, the coarse grained center of flows can be mistaken for diabasic or dioritic sills, both the lavas and the dikes being very close in composition. Some north-south quartz - diabase dikes were reported in Harker Township, and minor syenitic dikes are also present, but are of limited width and length.

North of the township and of the sediments lies a rhyolitic horizon, and the Ghostmount ultramafic complex, which is thought to be a possible source for the gold found south of the Porcupine-Destor break.

The main structural feature of the area is the east-west trending Porcupine-Destor fault zone, which is presumed to cross the north part of the township, along the sediments-volcanics contact. The exact location of the break is not known, due to the lack of exposure, but it has probably been intersected in some diamond drill holes. Many subsidiary strike faults, trending N75°E are reported, and are probably related to the main break. The McDermott fault, along which numerous gold showings were found, and the Ghostmount fault, which crosses the property now under study, are in this last category.

III. Geology of the Property

Very little is known about the geology of the property, because it is almost completely drift covered. However, extrapolating from the geology of the adjoining properties, it is assumed to be underlain by basaltic flows, with the associated breccias and pyroclastics. The most interesting factor is the possible presence of the Ghostmount fault.

IV. Work Done by Camflo

During the summer of 1983, Camflo Mines Limited completed the following work:

1 - Line Cutting

30 km. of lines were cut at an interval of 50 meters, and with stations spaced 25 meters along the lines.

2 - VLF Survey

A VLF survey was conducted along these lines, using a Geonics EM-16 instrument; the transmitter was the Cutler Station, (NAA) with a 17.8 KHz frequency. All the readings were taken facing north-east, with the positive reading indicating the instrument was pointing northeast, and a negative reading when it was pointing to the south-west. The readings were taken as percentage (i.e. slopes) and used as such to plot the profiles, but were converted to degrees to calculate the Fraser filter values.

The results of the survey show a series of short but often very strong anomalies, oriented NE - SW, parallel to the magnetic axis. The shape of these anomalies, which are very wide, and frequent quadrature cross-over which are parallel to the in phase, strongly suggest the presence of conductive overburden.

This interpretation is also confirmed by the fact that the anomalies are stronger around the few outcrops on the property, where they are caused by the bedrock-overburden contacts.

Furthermore, the areas where there are no outcrops show very flat quadrature and in phase profiles, which could be due to poor penetration caused by conductive clays.

In conclusion, we can say that while the VLF survey is an indirect indicator of the geology, showing the topographic features that can be caused by different geological units, it did not show any bedrock conductor.

3 - Magnetic Survey

A magnetometer survey was conducted along the same grid, with readings taken every 25 meters along the lines, and at 12,5 meter intervals where anomalous values were encountered.

The instrument used was a MP-2 proton magnetometer from Scintrex, and the diurnal corrections were made with a compatible base station. The total field was measured, and the values, minus 58,000 were plotted on the accompanying map. Total instrument and operator's error is less than 10 gammas.

The mag axes are trending south-west, and the high magnetic trend is the continuation of the one found south of the McDermott property. It is interpreted as being due to a more magnetic basaltic flow. This magnetic high follows closely the location of the inferred Ghostmount fault as shown on Satterly's map.

The continuity of the magnetic axis is generally very good, even if minor cross faults, with small displacement, are possible.

The low magnetic area, north of the magnetic basalt flows, are possible due to interflow sediments, or to less magnetic basalts or andesites.

V. Conclusion

The information that can be drawn from the EM-16 survey is limited, due to the conductive overburden. The magnetometer survey is more useful, and should be preferred for diamond drill hole location, along with the available geological information.

The presence of the Ghostmount fault was not shown clearly by this survey, especially if we interpret the high magnetic axis as being due to magnetic basalts.

Respectfully submitted,

Gilles Tousignant

Gilles Tousignant, ing. geol.

June 12, 1984

CERTIFICATE OF QUALIFICATION

I, Gilles Tousignant, of the city of Val d'Or, province of Quebec, do hereby certify that:

- I graduated from l'Ecole Polytechnique de Montréal, in 1973, with a B.A.Sc in geology.
- I am a member of the Quebec Order of Engineers.
- Since 1973, I have been involved in mineral exploration, development and production with various companies.
- I am employed by Camflo Mines Limited as Project Manager.
- I supervised and I had personal knowledge of the various surveys conducted in 1983 on the company's property in Harker Township, North-eastern Ontario.

Gilles Tousignant

Gilles Tousignant, ing. geol.

June 11, 1984

Lands Man B.

#181



Ministry of Natural Resources

Report of Work (Geophysical, Geological, Geochemical and Expenditures)



320125W0307 2.6826 HOLLOWAY

900

claims traversed form, attach a list. calculated in the "n may be entered vs Cr." columns. s below.

File # 633296

Type of Survey(s): **GEOPHYSICAL** Township or Area: **HARKER & HOLLOWAY TWPS.**

Claim Holder(s): **CAMFLO MINES LIMITED** Prospector's Licence No.: **T 834**

Address: **SUITE 3001, ROYAL BANK PLAZA, SOUTH TOWER, P.O. BOX 45, TORONTO, ONTARIO M5J 2J1**

Survey Company: **--** Date of Survey (from & to): **01 07 83 | 30 09 83** Total Miles of line Cut: **19 miles**

Name and Address of Author (of Geo-Technical report): **Gilles Tousignant, 615 Central Avenue, Val D'Or, Quebec, J9P 1P9**

Credits Requested per Each Claim in Columns at right

Special Provisions	Geophysical	Days per Claim
For first survey: Enter 40 days. (This includes line cutting)	- Electromagnetic	40
	- Magnetometer	20
For each additional survey: using the same grid: Enter 20 days (for each)	- Radiometric	
	- Other	
Man Days	Geological	
	Geochemical	
	Geophysical	
Complete reverse side and enter total(s) here	- Electromagnetic	
	- Magnetometer	
	- Radiometric	
	- Other	
Airborne Credits	Geological	
	Geochemical	
	Electromagnetic	
Note: Special provisions credits do not apply to Airborne Surveys.	Magnetometer	
	Radiometric	
	Other	

Mining Claims Traversed (List in numerical sequence)

Mining Claim		Expend. Days Cr.	Mining Claim		Expend. Days Cr.
Prefix	Number		Prefix	Number	
L	633296				
	633297				
	633298				
	633299				
	633300				
	633301				
	633303				
	633305				
	633306				
	633308				
	633309				
	633310				
	633311				
	628520				
	628533				
	628534				

RECEIVED

LARDER LAKE MINING DIV.
RECEIVED
MAY 17 1984
AM 7 18 19 10 11 12 1 2 3 14 15 16 PM

See Reversed Statement

Expenditures (excludes power stripping)

Type of Work Performed: **JUN 01 1984**

Performed on Claim(s): **MINING LANDS SECTION**

Calculation of Expenditure Days Credits

Total Expenditures: \$ + 15 =

Total Days Credits:

Instructions: Total Days Credits may be apportioned at the claim holder's choice. Enter number of days credits per claim selected in columns at right.

Total number of mining claims covered by this report of work. **16**

For Office Use Only

Total Days Cr. Recorded: **960** Date Recorded: **MAY 17 1984** Mining Recorder: *[Signature]*

Date Approved as Recorded: *[Signature]* Branch Director: *[Signature]*

Date: **May 15, 1984** Recorded Holder or Agent (Signature): *[Signature]*

Certification Verifying Report of Work

I hereby certify that I have a personal and intimate knowledge of the facts set forth in the Report of Work annexed hereto, having performed the work or witnessed same during and/or after its completion and the annexed report is true.

Name and Postal Address of Person Certifying: **M.E. Holt, Camflo Mines Limited, Suite 3001, Royal Bank Plaza, South Tower, P.O. Box 45, Toronto, Ontario M5J 2J1**

Date Certified: **May 15, 1984** Certified by (Signature): *[Signature]*



**GEOPHYSICAL – GEOLOGICAL – GEOCHEMICAL
TECHNICAL DATA STATEMENT**

TO BE ATTACHED AS AN APPENDIX TO TECHNICAL REPORT
FACTS SHOWN HERE NEED NOT BE REPEATED IN REPORT
TECHNICAL REPORT MUST CONTAIN INTERPRETATION, CONCLUSIONS ETC.

Type of Survey(s) MAGNETOMETER & EM. 16 V.L.F
 Township or Area HOLLANDAY & HARKER TOWNSHIPS
 Claim Holder(s) CAMPLO MINES LIMITED
SUITE 3001 - SOUTH TOWER - ROYAL BANK PLAZA, TORONTO
 Survey Company AS ABOVE
 Author of Report GILLES TOSIGNANT
 Address of Author 245 LA CANADIENNE VAL D'OR QUEBEC
 Covering Dates of Survey AUG. 22 to SEPT 7/83 JAN 30 to FEB 6/84
 (linecutting to office)
 Total Miles of Line Cut 19.0

MINING CLAIMS TRAVERSED
List numerically

L	633296
(prefix)	(number)
L	633297
L	633298
L	633299
L	633300
L	633301
L	633303
L	633305
L	633306
L	633308
L	633309
L	633310
L	633311
L	628520
L	628533
L	628534
RECEIVED	
JUL 11 1984	
MINING CLAIMS SECTION	
TOTAL CLAIMS	<u>16</u>

If space insufficient, attach list

<u>SPECIAL PROVISIONS CREDITS REQUESTED</u>	Geophysical	DAYS per claim
ENTER 40 days (includes line cutting) for first survey.	-Electromagnetic	<u>40</u>
ENTER 20 days for each additional survey using same grid.	-Magnetometer	<u>20</u>
	-Radiometric	_____
	-Other	_____
	Geological	_____
	Geochemical	_____

AIRBORNE CREDITS (Special provision credits do not apply to airborne surveys)

Magnetometer _____ Electromagnetic _____ Radiometric _____
 (enter days per claim)

DATE: June 26/84 SIGNATURE: [Signature]
 Author of Report or Agent

Res. Geol. _____ Qualifications 2.6368

Previous Surveys

File No.	Type	Date	Claim Holder

OFFICE USE ONLY

GEOPHYSICAL TECHNICAL DATA

GROUND SURVEYS -- If more than one survey, specify data for each type of survey

Number of Stations 1200 MAG. + EM Number of Readings EM. 1200 MAG. 1016
Station interval 28m. & 12.5m Line spacing 50 & 100 m. MAG. & EM.
Profile scale 1:1250 EM
Contour interval 250 gammas. MAG.

MAGNETIC

Instrument SCINTREX MP-2 PROTON MAGNETOMER
Accuracy - Scale constant +/- 10 gammas
Diurnal correction method COMPATIBLE BASE STATION
Base Station check-in interval (hours) 5 hrs approx.
Base Station location and value

ELECTROMAGNETIC

Instrument GEONICS EM-16
Coil configuration
Coil separation
Accuracy +/- 1%
Method: [x] Fixed transmitter [] Shoot back [] In line [] Parallel line
Frequency 17.8 kHz CUTLER, MAINE (specify V.L.F. station)
Parameters measured The vertical in-phase component & the vertical out-of-phase component (quadrature)

GRAVITY

Instrument
Scale constant
Corrections made
Base station value and location
Elevation accuracy

INDUCED POLARIZATION RESISTIVITY

Instrument
Method [] Time Domain [] Frequency Domain
Parameters - On time Frequency
- Off time Range
- Delay time
- Integration time
Power
Electrode array
Electrode spacing
Type of electrode

SELF POTENTIAL

Instrument _____ Range _____

Survey Method _____

Corrections made _____

RADIOMETRIC

Instrument _____

Values measured _____

Energy windows (levels) _____

Height of instrument _____ Background Count _____

Size of detector _____

Overburden _____

(type, depth -- include outcrop map)

OTHERS (SEISMIC, DRILL WELL LOGGING ETC.)

Type of survey _____

Instrument _____

Accuracy _____

Parameters measured _____

Additional information (for understanding results) _____

AIRBORNE SURVEYS

Type of survey(s) _____

Instrument(s) _____
(specify for each type of survey)

Accuracy _____
(specify for each type of survey)

Aircraft used _____

Sensor altitude _____

Navigation and flight path recovery method _____

Aircraft altitude _____ Line Spacing _____

Miles flown over total area _____ Over claims only _____

GEOCHEMICAL SURVEY – PROCEDURE RECORD

Numbers of claims from which samples taken _____

Total Number of Samples _____

Type of Sample _____
(Nature of Material)

Average Sample Weight _____

Method of Collection _____

Soil Horizon Sampled _____

Horizon Development _____

Sample Depth _____

Terrain _____

Drainage Development _____

Estimated Range of Overburden Thickness _____

SAMPLE PREPARATION

(Includes drying, screening, crushing, ashing)

Mesh size of fraction used for analysis _____

General _____

ANALYTICAL METHODS

Values expressed in: per cent
p. p. m.
p. p. b.

Cu, Pb, Zn, Ni, Co, Ag, Mo, As, (circle)

Others _____

Field Analysis (_____ tests)

Extraction Method _____

Analytical Method _____

Reagents Used _____

Field Laboratory Analysis

No. (_____ tests)

Extraction Method _____

Analytical Method _____

Reagents Used _____

Commercial Laboratory (_____ tests)

Name of Laboratory _____

Extraction Method _____

Analytical Method _____

Reagents Used _____

General _____



Ontario

Ministry of Natural Resources

Technical Assessment Work Credits

File 2.6826

Date 1984 07 26 Mining Recorder's Report of Work No. 181

Recorded Holder CAMFLO MINES LIMITED
Township or Area HARKER & HOLLOWAY TOWNSHIPS

Table with 2 columns: Type of survey and number of Assessment days credit per claim, Mining Claims Assessed. Includes rows for Geophysical, Geological, and Geochemical surveys, and checkboxes for special provisions.

Special credits under section 77 (16) for the following mining claims

No credits have been allowed for the following mining claims
not sufficiently covered by the survey
Insufficient technical data filed

The Mining Recorder may reduce the above credits if necessary in order that the total number of approved assessment days recorded on each claim does not exceed the maximum allowed as follows: Geophysical — 80; Geological — 40; Geochemical — 40; Section 77 (19)—60:



Ontario

Ministry of Natural Resources

Technical Assessment Work Credits

File 2.6826

Date 1984 07 26

Mining Recorder's Report of Work No. 181

Recorded Holder	CAMFLO MINES LIMITED
Township or Area	HARKER & HOLLOWAY TOWNSHIPS

Type of survey and number of Assessment days credit per claim	Mining Claims Assessed
Geophysical Electromagnetic _____ days Magnetometer _____ <u>16</u> days Radiometric _____ days Induced polarization _____ days Other _____ days Section 77 (19) See "Mining Claims Assessed" column Geological _____ days Geochemical _____ days Man days <input type="checkbox"/> Airborne <input type="checkbox"/> Special provision <input checked="" type="checkbox"/> Ground <input checked="" type="checkbox"/> <input checked="" type="checkbox"/> Credits have been reduced because of partial coverage of claims. <input type="checkbox"/> Credits have been reduced because of corrections to work dates and figures of applicant.	L 633296 to 301 inclusive 633303-05-06 633308 to 311 inclusive 628520-33

Special credits under section 77 (16) for the following mining claims

No credits have been allowed for the following mining claims

not sufficiently covered by the survey Insufficient technical data filed

L 628534

Mining Lands Section

File No 2.6826

Control Sheet

TYPE OF SURVEY



GEOPHYSICAL



GEOLOGICAL



GEOCHEMICAL



EXPENDITURE

MINING LANDS COMMENTS:

no further report (duplicate)

exp. LD.

S. Hurst

Signature of Assessor

July 23/84

Date

1984 08 15

Your File: 181
Our File: 2.6826

Mr. George J. Koleszar
Mining Recorder
Ministry of Natural Resources
4 Government Road East
Kirkland Lake, Ontario
P2N 1A2

Dear Sir:

RE: Notice of Intent dated July 26, 1984
Geophysical (Electromagnetic and Magnetometer)
Survey on Mining Claims L 633296 et al in the
Townships of Harker and Holloway

The assessment work credits, as listed with the above-mentioned Notice of Intent, have been approved as of the above date.

Please inform the recorded holder of these mining claims and so indicate on your records.

Yours sincerely,

S.E. Yundt
Director
Land Management Branch

Whitney Block, Room 6643
Queen's Park
Toronto, Ontario
M7A 1W3
Phone: (416)965-4888

S. Hurst:mc

cc: Camflo Mines Limited
Suite 3001
Royal Bank Plaza
South Tower
P.O. Box 45
Toronto, Ontario M5J 2J1

cc: Mr. G.H. Ferguson
Mining & Lands Commissioner
Toronto, Ontario

cc: Resident Geologist
Kirkland Lake, Ontario

Encl.



Aug 10/84

1984 07 26

Your File: 181
Our File: 2.6826

Mr. George J. Koleszar
Mining Recorder
Ministry of Natural Resources
4 Government Road East
Kirkland Lake, Ontario
P2N 1A2

Dear Sir:

Enclosed are two copies of a Notice of Intent with statements listing a reduced rate of assessment work credits to be allowed for a technical survey. Please forward one copy to the recorded holder of the claims and retain the other. In approximately fifteen days from the above date, a final letter of approval of these credits will be sent to you. On receipt of the approval letter, you may then change the work entries on the claim record sheets.

For further information, if required, please contact Mr. R.J. Pichette at 416/965-4888.

Yours sincerely,

S.E. Yundt
Director
Land Management Branch

Whitney Block, Room 6643
Queen's Park
Toronto, Ontario
M7A 1W3

Rph S. Hurst:mc

Encls.

cc: Camflo Mines Limited
Suite 3001
Royal Bank Plaza
South Tower
P.O. Box 45
Toronto, Ontario M5J 2J1

cc: Mr. G.H. Ferguson
Mining & Lands Commissioner
Toronto, Ontario



Ministry of
Natural
Resources

Ontario

Notice of Intent
for Technical Reports

1984 07 26

2.6826/181

An examination of your survey report indicates that the requirements of The Ontario Mining Act have not been fully met to warrant maximum assessment work credits. This notice is merely a warning that you will not be allowed the number of assessment work days credits that you expected and also that in approximately 15 days from the above date, the mining recorder will be authorized to change the entries on his record sheets to agree with the enclosed statement. Please note that until such time as the recorder actually changes the entry on the record sheet, the status of the claim remains unchanged.

If you are of the opinion that these changes by the mining recorder will jeopardize your claims, you may during the next fifteen days apply to the Mining and Lands Commissioner for an extension of time. Abstracts should be sent with your application.

If the reduced rate of credits does not jeopardize the status of the claims then you need not seek relief from the Mining and Lands Commissioner and this Notice of Intent may be disregarded.

If your survey was submitted and assessed under the "Special Provision-Performance and Coverage" method and you are of the opinion that a re-appraisal under the "Man-days" method would result in the approval of a greater number of days credit per claim, you may, within the said fifteen day period, submit assessment work breakdowns listing the employees names, addresses and the dates and hours they worked. The new work breakdowns should be submitted direct to the Land Management Branch, Toronto. The report will be re-assessed and a new statement of credits based on actual days worked will be issued.

1984 06 13

Your File: 181
Our File: 2.6826

Mr. George J. Koleszar
Mining Recorder
Ministry of Natural Resources
4 Government Road East
P.O. Box 984
Kirkland Lake, Ontario
P2N 1A2

Dear Sir:

We have received maps only for a Geophysical
(Electromagnetic and Magnetometer) Survey
submitted under Special Provisions (credit for
Performance and Coverage) on Mining Claims
L 633296 et al in the Townships of Harker and
Holloway.

This material will be examined and assessed and
a statement of assessment work credits will be
issued.

Yours sincerely,

S.E. Yundt
Director
Land Management Branch

Whitney Block, Room 6643
Queen's Park
Toronto, Ontario
M7A 1W3
Phone: (416) 965 1380

A. Barr:sc

cc: Camflo Mines Limited
Suite 3001
Royal Bank Plaza, South Tower
P.O. Box 45
Toronto, ontario
M5J 2J1

cc: Gilles Tousignant
615 Central Avenue
Val D'Or, Que
J0P 1P9



CAMFLO MINES LIMITED

Executive Offices:
Suite 3001, South Tower
P.O. Box 45, Royal Bank Plaza
Toronto, Ontario, Canada M5J 2J1
(416) 865-0005

June 28, 1984

Mr. George Koleszar
Mining Recorder
Ministry of Natural Resources
4 Government Road East
Kirkland Lake, Ontario
P2N 1A2

Re: Camflo East Block #162; Your File #2.6826

As per our submission of May 15 I am herewith sending you a full report of work along with a technical report.

Trusting everything is to your satisfaction.

Yours very truly
CAMFLO MINES LIMITED

C. Mathews

Ms. C.A. Mathews
Exploration

Enc.

RECEIVED

JUL 11 1984

MINING LANDS SECTION

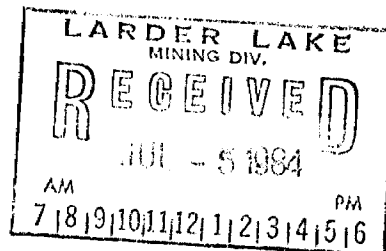



Recording Office
4 Gov't. Rd. E.
Kirkland Lake, Ont.
P2N 1A2

July 5, 1984

Camflo Mines Ltd.
Suite 3001, South Tower
P.O. Box 45, Royal Bank Plaza
Toronto, Ontario M5J 2J1

Att: Ms. C.A. Mathews

Re: Technical reports and maps, Camflo West & Camflo East Blocks.

I have received the data you sent me on the above claim groups. The data consists of technical data statements for both groups, 1 copy of technical report for both groups and 2 copies of a map showing VLF EM-16 profiles on the West Block.

As there are two groups of claims and two surveys on each group and as the data should be submitted in duplicate not enough data has been sent. Would you please provide the following:

- East Block -Technical report - 1 copy
- Map, VLF EM-16 profiles - 2 copies
- Map, Contoured magnetometer - 2 copies
- West Block -Technical report - 1 copy
- Map, Contoured magnetometer - 2 copies

Would you also please ensure that all maps and reports are signed. Send the above data to the following address:

Land Management Branch
Ministry of Natural Resources
Whitney Block, Room 6610
99 Wellesley St. West
Toronto, Ontario M7A 1W3

I have forwarded the data you sent me to Land Management Branch.

Yours truly

George Koleszar
Mining Recorder
Telephone (705) 567-9241

GK/ps

cc. Land Management Branch

Encl.

RECEIVED

JUL 15 1984

MINING LANDS SECTION

RECEIVED	
Management Branch	<input type="checkbox"/>
RECORDS	<input type="checkbox"/>
BY	
JUL 15 1984	
C. R. NUNNET	
J. R. HORTON	
J. C. GIBB	
W. L. GOOD	
RETURN TO R. 6643	

#181

Instructions: - Please type or print.
- If number of mining claims traversed exceeds space on this form, attach a list.
Note: - Only days credits calculated in the "Expenditures" section may be entered in the "Expend. Days Cr." columns.
- Do not use shaded areas below.

Ministry of Natural Resources
Report of Work
(Geophysical, Geological, Geochemical and Expenditures)

The Mining Act

Township or Area
HARKER & HOLLOWAY TWPS.

Prospector's Licence No.
T 834

File # 633296

Number of Survey(s)
GEOPHYSICAL

Claim Holder(s)
CAMFLO MINES LIMITED

Address
SUITE 3001, ROYAL BANK PLAZA, SOUTH TOWER, P.O. BOX 45, TORONTO, ONTARIO M5J 2J1

Date of Survey (from & to)
01 07 83 30 09 83
Day Mo. Yr. Day Mo. Yr.

Total Miles of line Cut
19 miles

Survey Company

Name and Address of Author (of Geo-Technical report)
Gilles Tousignant, 615 Central Avenue, Val D'Or, Quebec, J9P 1P9

Credits Requested per Each Claim in Columns at right

Special Provisions	Geophysical	Days per Claim
For first survey: Enter 40 days. (This includes line cutting)	- Electromagnetic	40
For each additional survey: using the same grid: Enter 20 days (for each)	- Magnetometer	20
	- Radiometric	
	- Other	

Man Days	Geophysical	Days per Claim
Complete reverse side and enter total(s) here	- Electromagnetic	
	- Magnetometer	
	- Radiometric	
	- Other	
	Geological	
	Geochemical	

Airborne Credits	Geophysical	Days per Claim
Note: Special provisions credits do not apply to Airborne Surveys.	- Electromagnetic	
	- Magnetometer	
	- Radiometric	
	Geological	
	Geochemical	

Mining Claims Traversed (List in numerical sequence)

Prefix	Mining Claim Number	Expend. Days Cr.		Prefix	Mining Claim Number	Expend. Days Cr.
		Days	Cr.			
L	633296	✓	✓			
	633297	1/4	1/4			
	633298	✓	✓			
	633299	1/2	1/2			
	633300	1/2	1/2			
	633301	✓	✓			
	633303	✓	✓			
	633305	✓	✓			
	633306	3/4	3/4			
	633308	1/4	1/4			
	633309	✓	✓			
	633310	✓	✓			
	633311	✓	✓			
	628520	✓	✓			
	628533	3/4	3/4			
	628534	3/4	0			

Expenditures (excludes power stripping)
Type of Work Performed
JUL 01 1984

Performed on Claim(s)
MINING LANDS SECTION

Calculation of Expenditure Days Credits
Total Expenditures \$ ÷ 15 = Total Days Credits

Instructions
Total Days Credits may be apportioned at the claim holder's choice. Enter number of days credits per claim selected in columns at right.

Date
May 15, 1984
Recorded Holder or Agent (Signature)
[Signature]

3/15
LARDER LAKE MINING DIV.
RECEIVED
MAY 17 1984
AM 7 18 9 10 11 12 1 2 3 4 5 6 PM

For Office Use Only
Total Days Cr. Recorded
Date Recorded
MAY 17 1984
Date Approved as Recorded
Mining Recorder
Branch Director
960

Total number of mining claims covered by this report of work.

Verification of Report of Work
I hereby certify that the personal and intimate knowledge of the facts set forth in the Report of Work annexed hereto, having performed the same, is true and correct.
Bank Plaza, South Tower,
[Signature]

EM

$$16 \times 40 = 640$$

$$640 \div 19.75 = 32$$

m

$$15 \times 20 = 300$$

$$300 \div 18.75 = 16$$



HARKER TOWNSHIP
HOLLOWAY TOWNSHIP

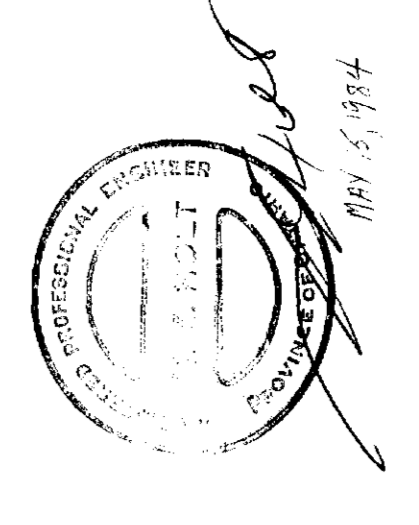

MAP AREA NO. 3
CAMELO MINES LTD.
 McDERMOTT PROJECT
 HARKER & HOLLOWAY TMS (MT)
MAGNETOMETER SURVEY
 DATE: OCT. 03 | DRAWN BY: J.H. | PROJECT NO. 205
 Scale 1:2500
 METERS

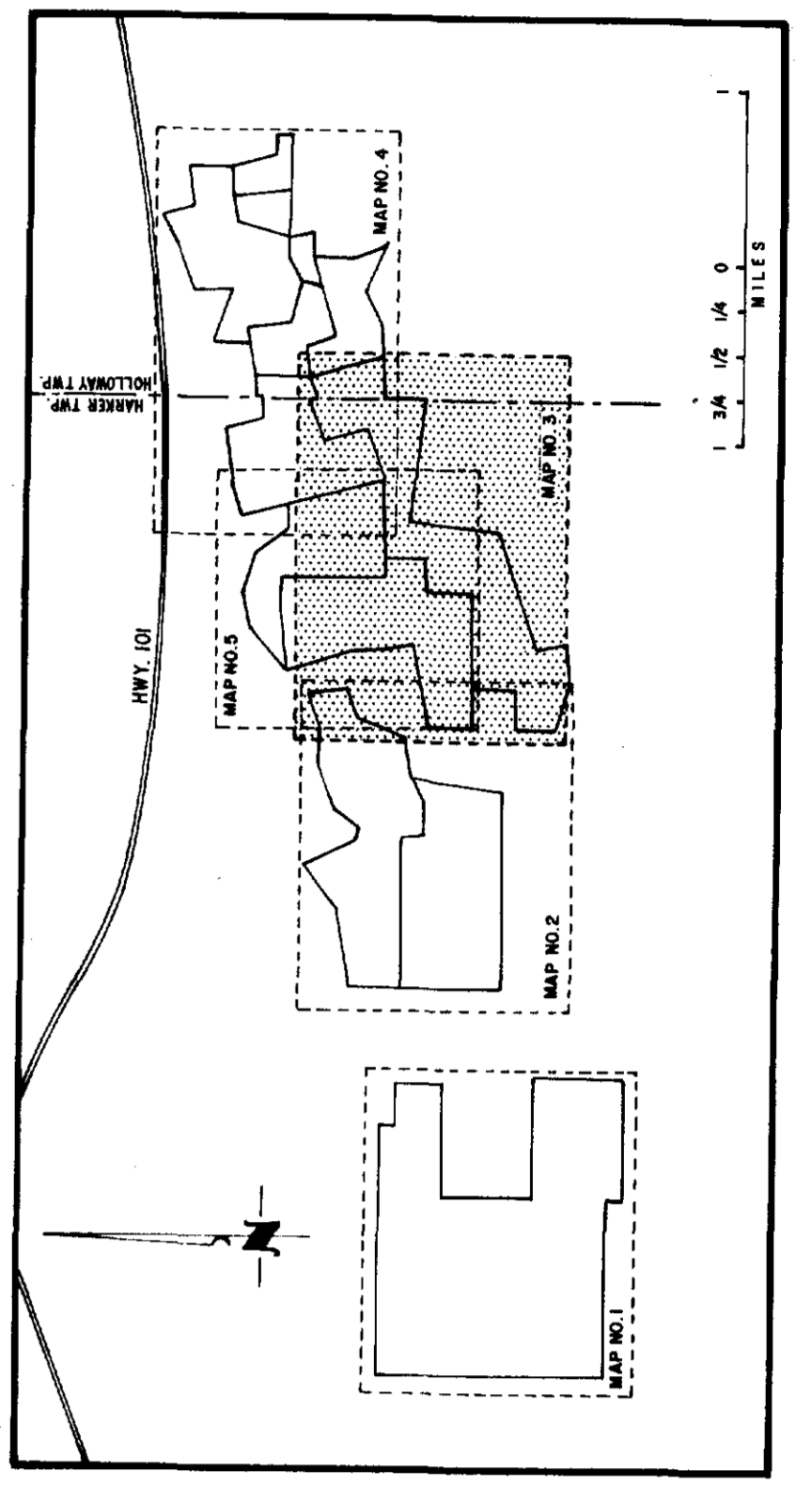

Magnetometer readings in gamma values plotted are
 total field less 50,000 gammas.

628534



2000



HARKER TOWNSHIP
HOLLOWAY TOWNSHIP

MAP AREA NO. 3
CAMPLO MINES LTD.
 McDERMOTT PROJECT - 26506
 HARKER & HOLLOWAY TOWNSHIPS
V.L.F. E.M. 16
RAW DATA PROFILES
 Scale 1:2500
 DATE: OCT. 95 DRAWN BY: B.J.H. INTS. NO. 33/0/2 PROJ. NO. P. 05

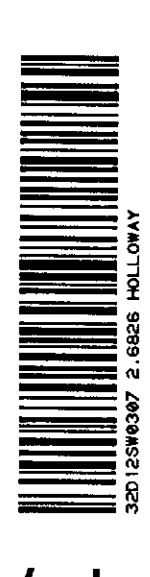
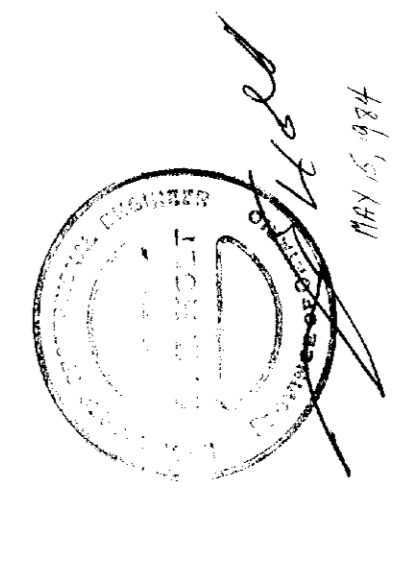



HARKER TOWNSHIP
HOLLOWAY TOWNSHIP

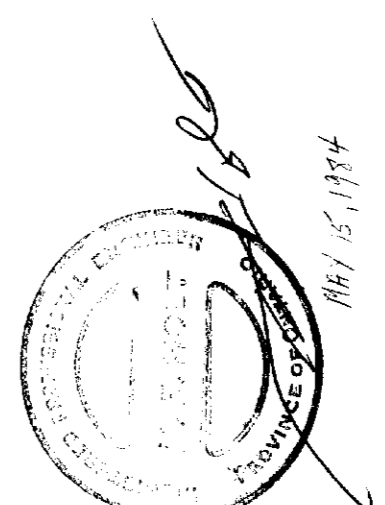

MAP SHEET NO. 3

CAMFLO MINES LTD.

McDERMOTT PROJECT

HARKER & HOLLOWAY TOWNSHIP

VLF E.M. 16

FRASER FILTER DATA

DATE: OCT. 85 DRAWN BY: R.J.H. PLOT NO: 2572/2 PROJECT NO: 2435

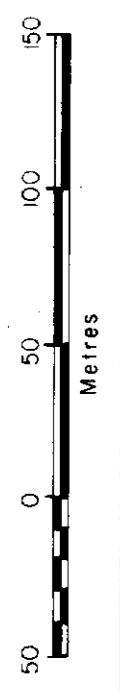

250

HARKER TOWNSHIP
HOLLOWAY TOWNSHIP


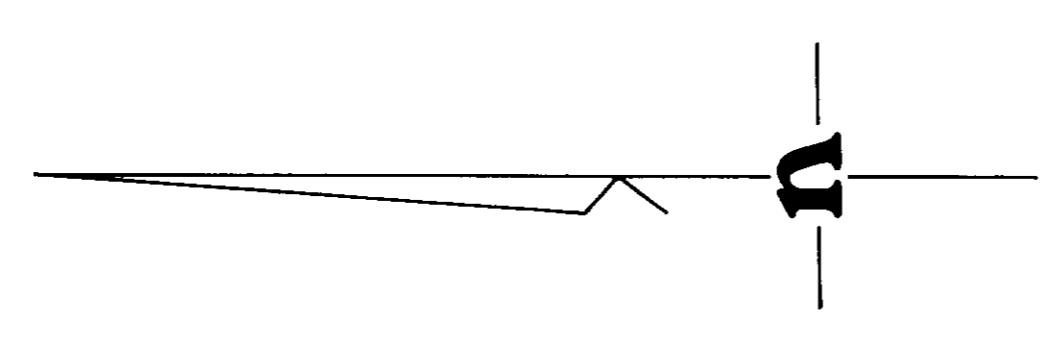

HARKER TOWNSHIP
HOLLOWAY TOWNSHIP

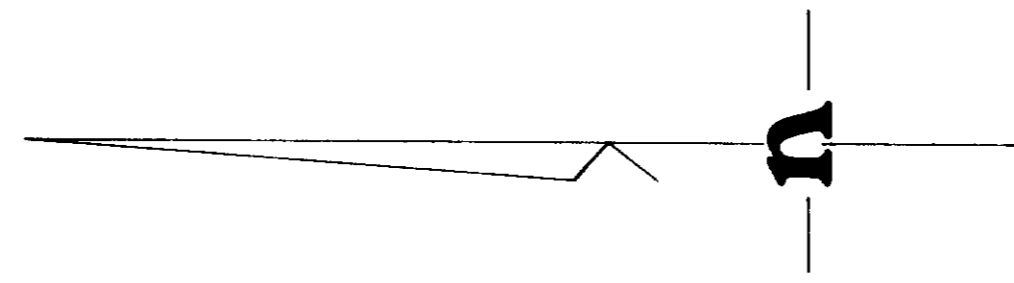

633297

633299

633300

633301

633303

633306

633305

633308

633309

633311



HARKER TOWNSHIP
HOLLOWAY TOWNSHIP

