

W7208.219

# 219



THE MINING

To the Recorder of Larder Lake

010

I, Leonard Darby name of Recorded Holder

M/ 18852 Miner's Licence

203 Maple Street N.

Timmins, Ontario

Post Office Address

do hereby report the performance of 120 days of Trenching Gas Plugger type of work

not before reported to be applied on the following contiguous claims

Claim No.	Days	Claim No.	Days	Claim No.	Days
L. 299568	.30.	Steele Township			
L. 299569	.30.	Central Part of N. 1/2			
L. 299570	.30.				
L. 300983	30				

All the work was performed on Mining Claim (s) L-299568, L-299569, L-299570, L-300983 (In the case of geological and/or geophysical survey (s) where more than 18 claims are involved attach a schedule)

READ CAREFULLY: THE FOLLOWING INFORMATION IS REQUIRED BY THE MINING RECORDER.

- For Manual Work, Stripping or Opening up of Mines, Sinking Shafts or Other Actual Mining Operations - Names and addresses of the men who performed the work and the dates and hours of their employment.
- For Diamond and other Core Drilling - Footage, No. and angle of holes and diameter of core. Name and address of owner or operator of drill. Dates when drilling was done. Signed core log and sketch in duplicate.
- For Compressed Air or Other Power Driven or Mechanical Equipment
  - Type of drill or equipment. Names and addresses of men engaged in operating equipment and the dates and hours of their employment.
  - For Power Stripping - Type of equipment. Name and address of owner or operator. Amount expended. Dates on which work was done. Proof of actual cost must be submitted within 30 days of recording.
- With each of the above types of work sketches are required to show the location and extent of the work in relation to the nearest claim post. In the case of diamond or other core drilling the sketch must be submitted in duplicate.
- For Geological and Geophysical Survey - The names and addresses of men employed as well as dates. Type of instrument used in the case of geophysical survey. Reports and maps in duplicate must be filed with the Minister within 60 days of recording.
- For Land Survey - the name and address of Ontario Land surveyor.

The Required Information is as Follows: (Attach a list if this space is insufficient)

See Attached

Date July 25, 1972

Signature of Recorded Holder or Agent

The Mining Act Certificate Verifying Report of Work

I, Leonard Darby M-18852 203 Maple St. North - Timmins Ont (Post Office Address)

hereby certify:

- That I have a personal and intimate knowledge of the facts set forth in the report of work annexed here-to, having performed the work or witnessed same during and/or after its completion.
- That the annexed report is true.

Dated July 25 19 72

Signature

Stamp: 718191011

File L 299569

RECORDED JUL 27 1972 REC. No.

THE PENALTY FOR MAKING A FALSE STATEMENT IN THIS REPORT AND/OR CERTIFICATE IS \$500. OR SIX MONTHS IMPRISONMENT OR BOTH

<u>NAME</u>	<u>ADDRESS</u>	<u>DATE</u>	<u>HRS. WORKED</u>	<u>Trenching</u>	<u>Mining Days</u>
E. Colbert	167 Lakeshore	June 22/72	12	Gas Plugger	4
Len Darby	203 Maple N.	June 22/72	12	" "	4
E. Colbert	167 Lakeshore	June 22/72	12	" "	4
Len Darby	203 Maple N.	June 22,		- -	.
E. Colbert	Timmins	July 2,			
Len Darby	"	July 2,			
E. Colbert	"	July 3,			
Len Darby	"	July 3,			
J. Twain	83 Alg. Blvd. E.	" 7,			
Len Darby	Timmins	July 7/72	12	" "	4
J. Twain	"	July 8/72	12	" "	4
Len Darby	"	July 8/72	12	" "	4
J. Twain	"	July 9/72	12	" "	4
Len Darby	"	July 9/72	12	" "	4
J. Twain	"	July 10/72	12	" "	4
Len Darby	"	July 10/72	12	" "	4
J. Twain	"	July 11/72	12	" "	4
Len Darby	"	July 11/72	12	" "	4
J. Twain	"	July 12/72	12	" "	4
Len Darby	"	July 12/72	12	" "	4
J. Twain	"	July 15/72	12	" "	4
Len Darby	"	July 15/72	12	" "	4
J. Twain	"	July 16/72	12	" "	4
Len Darby	"	July 16/72	12	" "	4
John Darby	203 Maple N.	July 18/72	12	" "	4
Len Darby	Timmins	July 18/72	12	" "	4
John Darby	"	July 19/72	12	" "	4
Len Darby	"	July 19/72	12	" "	4
John Darby	"	July 20/72	12	" "	4
Len Darby	"	July 20/72	12	" "	4



900

Total 120

Labour details for the work performed on claims

# 1- 299568 - 299569 - 299570 - 300983

Steele Township.

July 25, 1972

L. Darby  
M- 18852 *[Signature]*

L-300983 L-299570

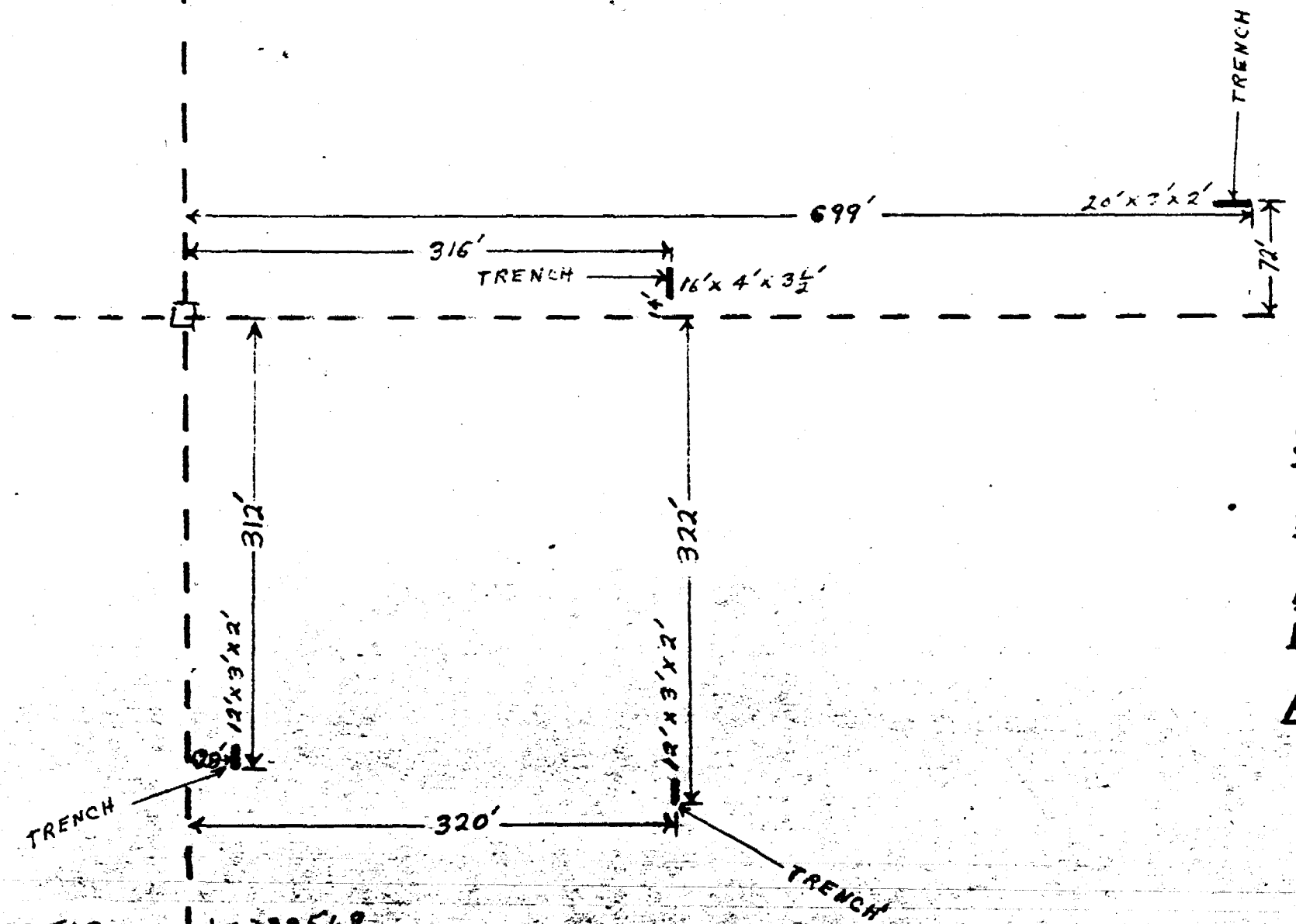

STEELE TWP.

SCALE 1 INCH = 100  
FT.

LEN DARBY  
MINING CLAIMS

ASSESSMENT WORK

LIC# 18852

L-299548 L-299569