

#207

W7308.207



ON THE MINING ACT

010

To the Recorder of... LARDER LAKE
I, LEONARD DARBY M-18852
name of Recorded Holder Miner's Licence
P.O. BOX 186 TIMMINS-ONT.
Post Office Address

do hereby report the performance of 112 days of TRENCHING (MANUAL) LABOUR
not before reported to be applied on the following contiguous claims

Claim No.	Days	Claim No.	Days	Claim No.	Days
354485	12	363061	10	Steele trap	
354486	12	363062	10	NEW Part of NE 1/4	
354487	12	363067	10		
354490	12	363068	10		
363059	12				
363060	12				

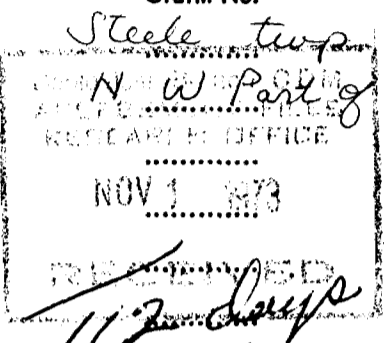

All the work was performed on Mining Claim (s): 299568-69-70 and 300983
(In the case of geological and/or geophysical survey (s) where more than 18 claims are involved attach a schedule)
(see sketches)

READ CAREFULLY: THE FOLLOWING INFORMATION IS REQUIRED BY THE MINING RECORDER.

- For Manual Work, Stripping or Opening up of Mines, Sinking Shafts or Other Actual Mining Operations - Names and addresses of the men who performed the work and the dates and hours of their employment.
- For Diamond and other Core Drilling - Footage, No. and angle of holes and diameter of core. Name and address of owner or operator of drill. Dates when drilling was done. Signed core log and sketch in duplicate.
- For Compressed Air or Other Power Driven or Mechanical Equipment
- Type of drill or equipment. Names and addresses of men engaged in operating equipment and the dates and hours of their employment.
- For Power Stripping - Type of equipment. Name and address of owner or operator. Amount expended. Dates on which work was done. Proof of actual cost must be submitted within 30 days of recording.
- With each of the above types of work sketches are required to show the location and extent of the work in relation to the nearest claim post. In the case of diamond or other core drilling the sketch must be submitted in duplicate.
- For Geophysical, Geological, Geochemical Surveys and Expenditure Credits - the name of author of report. Covering dates of survey (linecutting & office). Type of instrument used. Total amount of expenditure. Technical reports, maps, expenditure breakdown, receipts must be filed in duplicate with the Minister within 60 days of recording.
- For Land Survey - the name and address of Ontario Land surveyor.

The Required Information is as Follows: (Attach a list if this space is insufficient)

see attached plans and lists of men and dates.

Date Oct 29, 1973
Signature of Recorded Holder or Agent

The Mining Act Certificate Verifying Report of Work

I, L. DARBY
P.O. Box 186 Timmins Ont.
(Post Office Address)

- hereby certify:
- That I have a personal and intimate knowledge of the facts set forth in the report of work annexed here-to, having performed the work or witnessed same during and/or after its completion.
 - That the annexed report is true.

Dated Oct 29 1973
Signature

File L299568 Recorded OCT 30 1973

THE PENALTY FOR MAKING A FALSE STATEMENT IN THIS REPORT AND/OR CERTIFICATE IS \$500. OR SIX MONTHS IMPRISONMENT OR BOTH

900



N

		22 DAYS	21 DAYS	21 DAYS	21 DAYS
300983	299570	354490	363059	363062	363067
		22 DAYS	21 DAYS	21 DAYS	21 DAYS
299568	299569	354485	363060	363061	363068
		21 DAYS	21 DAYS		
		354487	354486		

GROUP PLAN

**STEELE TWP
DARBY CLAIMS
ASSESSMENT WORK**

SCALE - 1" = 1220'

CLAIM 388583

CLAIM 299570

DARBY CLAIMS
STEELE TWP.
ASSESSMENT
WORK
MANUAL WORK
TRENCHING

SCALE - 200' = 1"



CLAIM

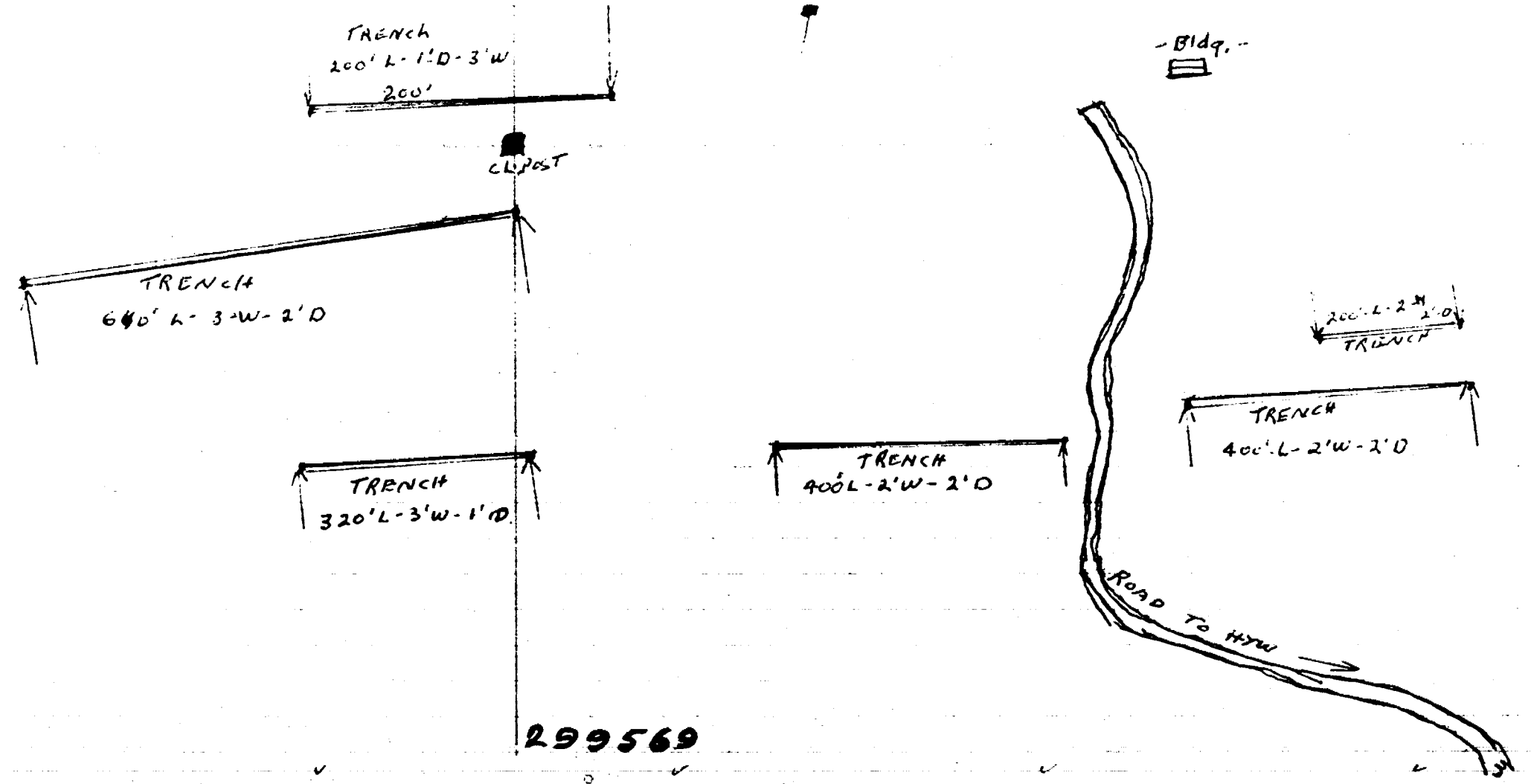

NAME	ADDRESS	DATE	HRS. WORKED	TRENCHING MANUAL LABOUR	DAYS CR.
Douglas Browne	295 Hemlock	Timmins, Ont.			
"	"	July 9, '73	12	"	2
"	"	" 10, "	12	"	2
"	"	" 11, "	12	"	2
"	"	" 12, "	12	"	2
"	"	" 13, "	12	"	2
"	"	" 17, "	12	"	2
"	"	" 18, "	12	"	2
"	"	" 19, "	12	"	2
"	"	" 20, "	12	"	2
"	"	" 21, "	12	"	<u>2</u>

Total 20 Days

L. Darby Mining Claims

Assessment Works

Steele Township

Oct. 29, 1973

NAME	ADDRESS	DATE	HRS. WORKED	TRENCHING MANUAL LABOUR	DAYS CR.
Dan Rochon	316 Golden St. Timmins, Ont	July 9, '73	12	"	2
"	"	" 10, "	12	"	2
"	"	" 11, "	12	"	2
"	"	" 12, "	12	"	2
"	"	" 13, "	12	"	2
"	"	" 14, "	12	"	2
Total					12 Days

L. Darby Mining Claims

Assessment work

Steele Township

Oct. 29, 1973

NAME	ADDRESS	DATE	HRS. WORKED	TRENCHING MANUAL LABOUR	DAYS CR.
------	---------	------	-------------	----------------------------	----------

Sean Mahoney	76 Spruce No.	Timmins Ont.			
"	"	June 27, 1973	12	"	2
"	"	" 28,	12	"	2
"	"	" 29,	12	"	2
"	"	" 30,	12	"	2
"	"	July 1,	12	"	2
"	"	" 4,	12	"	2
"	"	" 5,	12	"	2
"	"	" 7,	12	"	2
"	"	" 8,	12	"	2
"	"	" 9,	12	"	2
"	"	Aug 6,	12	"	2
"	"	" 7,	12	"	2
"	"	" 8,	12	"	2
"	"	" 9,	12	"	2
"	"	" 10,	12	"	2
"	"	" 11,	12	"	2

Total ~~12 Days~~
32 Days

L. Darby Mining Claims
 Assessment Work
 Steele Township
 Oct. 29, 1973

NAME	ADDRESS	DATE	HRS. WORKED	TRENCHING MANUAL LABOUR	DAYS CR.
Marcel Potvin	214 main St Timmins Ont.				
		June 8, 1973	12	"	2
		" 9, "	12	"	2
		" 14, "	12	"	2
		" 15, "	12	"	2
		" 16, "	12	"	2
		" 17, "	12	"	2
				Total	<u>12 Days</u>

L. Darby Mining Claims
 Assessment work
 Steele Township
 Oct. 29, 1973

NAME	ADDRESS	DATE	HRS. WORKED	TRENCHING MANUAL LABOUR	DAYS CR.
John Darby	203 maple St. No. Timmins.				
"	"	June 29, '73	12	"	2
"	"	" 30, "	12	"	2
"	"	July 1, "	12	"	2
"	"	" 2, "	12	"	2
"	"	" 3, "	12	"	2
"	"	" 4, "	12	"	2
"	"	" 5, "	12	"	2
"	"	" 6, "	12	"	<u>2</u>
				Total	16 Days

L. Darby Mining Claims
 Assessment Work
 Steele Township
 Oct. 29, 1973

NAME	ADDRESS	DATE	HRS. WORKED	TRENCHING MANUAL LABOUR	DAYS CR.
H. Mousseau.	262 Wende St. Timmins, Ont.				
"	"	July 17, 1973	12	"	2
"	"	" 18,	" 12	"	2
"	"	" 19,	" 12	"	2
"	"	" 20,	" 12	"	2
"	"	" 21,	" 12	"	2
"	"	July 25,	" 12	"	2
"	"	" 26,	" 12	"	2
"	"	" 27,	" 12	"	2
"	"	" 28,	" 12	"	2
"	"	" 29,	" 12	"	2

Total 20 Days

L. Darby Mining Claims
 Assessment Work
 Steele Township
 Oct. 29, 1973