



Ministry of Natural Resources

Steelcorp

#165

w7608.165 Steel Corp #165-76 A separate form is

THE MINING ACT



32013NW5015 W7808-00185 STEELE

To the Recorder of LARDER LAKE

I, DEX LTD.

name of Recorded Holder P.O. Box 186

Timmins Ont.

Inspector's Licence T-633

Post Office Address

010

do hereby report the performance of 234 days of Power Stripping type of work

not before reported to be applied on the following contiguous claims

Claim No.	Days	Claim No.	Days	Claim No.	Days
354485	27	363061	23		
354486	23	363062	23		
354487	23	363067	23		
354490	23	363068	23		
363059	23				
363060	23				

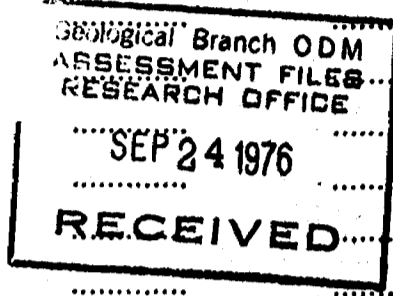

299569

All the work was performed on Mining Claim (s) (In the case of geological and/or geophysical survey (s) where more than 18 claims are involved attach a schedule)

READ CAREFULLY: THE FOLLOWING INFORMATION IS REQUIRED BY THE MINING RECORDER.

- For Manual Work, Stripping or Opening up of Mines, Sinking Shafts or Other Actual Mining Operations - Names and addresses of the men who performed the work and the dates and hours of their employment.
- For Diamond and other Core Drilling - Footage, No. and angle of holes and diameter of core. Name and address of owner or operator of drill. Dates when drilling was done. Signed core log and sketch in duplicate.
- For Compressed Air or Other Power Driven or Mechanical Equipment - Type of drill or equipment. Names and addresses of men engaged in operating equipment and the dates and hours of their employment.
- For Power Stripping - Type of equipment. Name and address of owner or operator. Amount expended. Dates on which work was done. Proof of actual cost must be submitted within 30 days of recording.
- With each of the above types of work sketches are required to show the location and extent of the work in relation to the nearest claim post. In the case of diamond or other core drilling the sketch must be submitted in duplicate.
- For Geophysical, Geological, Geochemical Surveys and Expenditure Credits - the name of author of report. Covering dates of survey (linecutting & office). Type of instrument used. Total amount of expenditure. Technical reports, maps, expenditure breakdown, receipts must be filed in duplicate with the Minister within 60 days of recording.
- For Land Survey - the name and address of Ontario Land surveyor.

The Required Information is as Follows: (Attach a list if this space is insufficient)

See Attach

Date Sept. 8, 1976

Signature of Recorded Holder or Agent

The Mining Act Certificate Verifying Report of Work

L.H. Darby

I, P.O. Box 186 Timmins (Post Office Address)

hereby certify:

1. That I have a personal and intimate knowledge of the facts set forth in the report of work annexed hereto, having performed the work or witnessed same during and/or after its completion.

2. That the attached report is true.

Dated Sept 9 1976 RECEIVED SEP 9 1976 AM 7 18 10 11 12 1 2 3 4 5 6 PM

Signature

RECEIVED SEP 9 1976 REC. NO.

(file 2353485)

THE PENALTY FOR MAKING A FALSE STATEMENT IN THIS REPORT AND/OR CERTIFICATE IS \$500. OR SIX MONTHS IMPRISONMENT OR BOTH

STEELE T.W.P.

GROUP PLAN

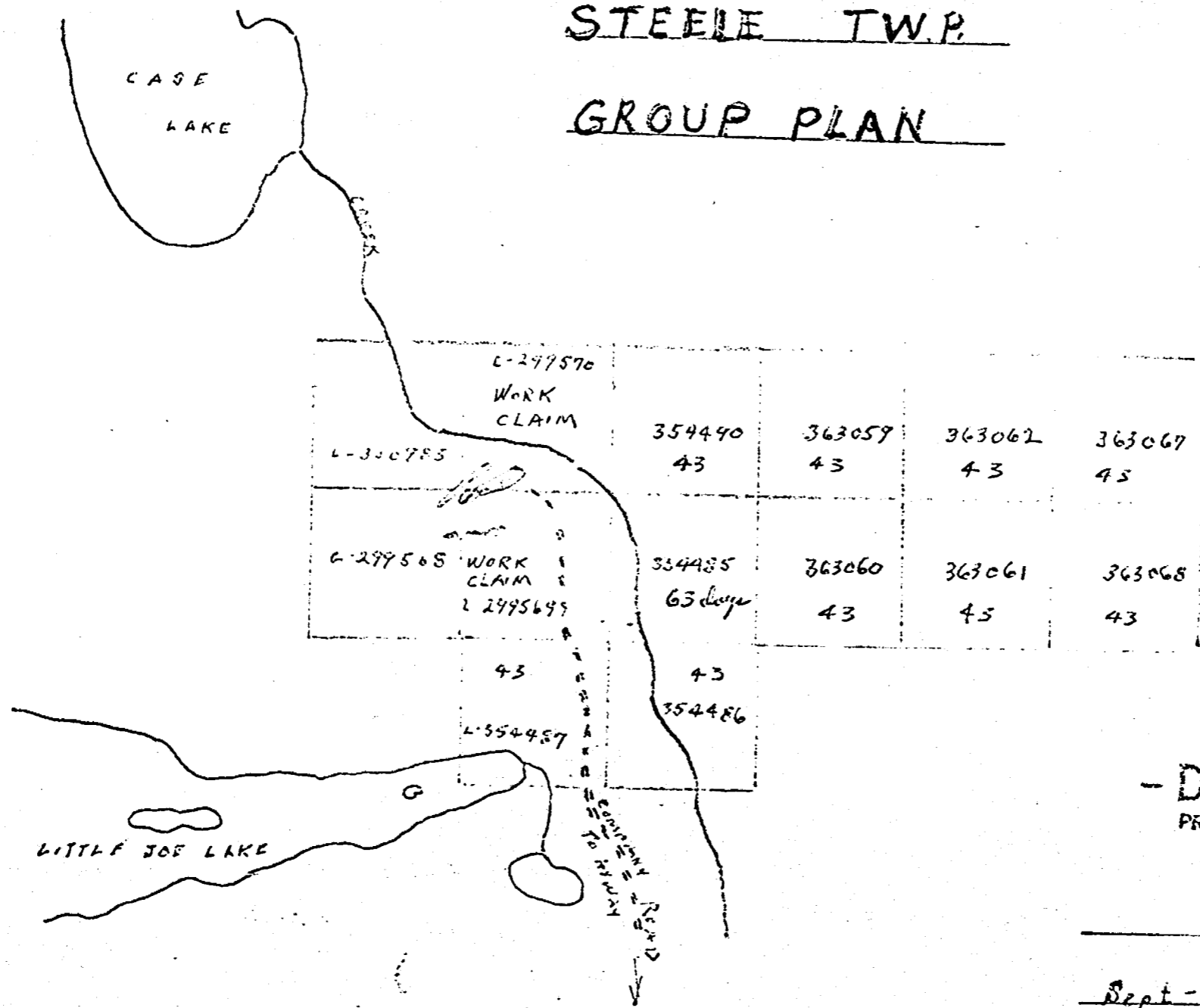

- DEX LTD. -
PRIVATE COMPANY

LIC - T. 683

Sept - 1976



900

ASSESSMENT WORK DETAIL

STEELE TWP

Power Stripping Bulldozer Company Owned @ \$ 20.00 per Hr
Operator Len Darby 203 Maple St. N. Timmins. Ont.

<u>Date</u>	<u>Hrs. Worked</u>	<u>Days Cr.</u>
Oct. 9/75	11	22
" 10/75	10	20
" 11/75	8	16
" 12/75	8	16
" 13/75	10	20
" 16/75	8	16
" 17/75	10	20
" 18/75	5	10
" 21/75	8	16
" 22/75	5	10
" 23/75	8	16
" 24/75	8	16
" 25/75	10	20
" 26/75	8	16
<hr/>		<hr/>
Total	117 Hrs.	234 Days

Sept/ 76

- DEX LTD. -
PRIVATE COMPANY



300983 299572
299568 6-299569

STEELE TWP.
POWER STRIPPING
Sept - 1976

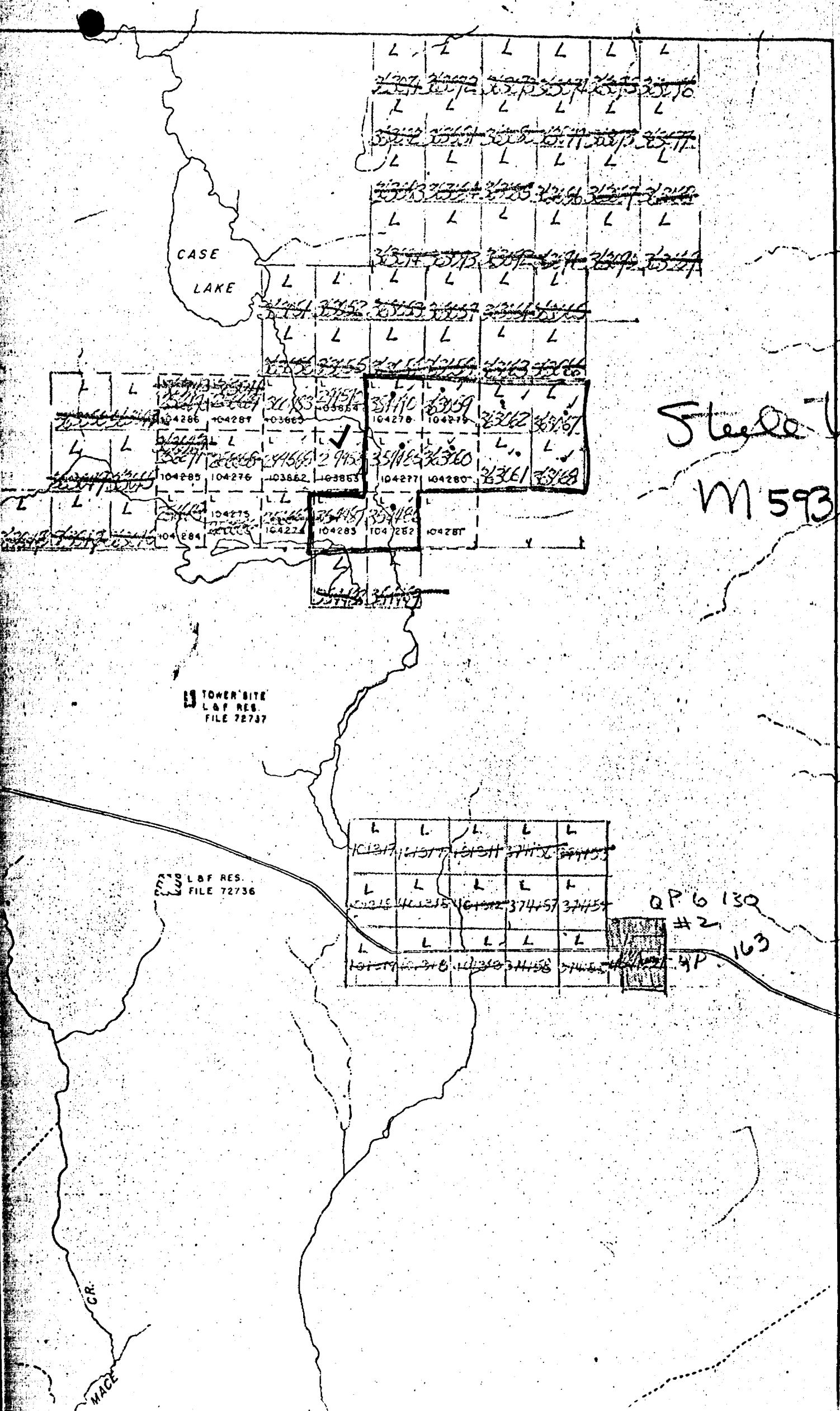

Steel trap
M 593

TOWER SITE
L & P RES.
FILE 72737

L & P RES.
FILE 72736

QP 6 130
#2
4P 163