



Ministry of Natural Resources

Ontario

Steele top

W76 08-246

#246

THE MINING ACT

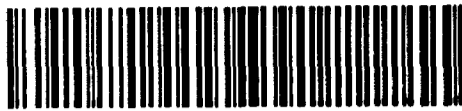

32D13NW5017 W7608-00246 STEELE

010

To the Recorder of LARDER LAKE

DEX LTD.

P.O. Box 186

TIMMINS

Ont.

do hereby report the performance of 610 days of POWERSTRIPPING type of work

not before reported to be applied on the following contiguous claims

Claim No.	Days	Claim No.	Days	Claim No.	Days
XXXXXX		363060	60		
354485	65	363061	60		
354486	65	363062	60		
354487	60	363067	60		
354490	60	363068	60		
363059	60				

Geological Branch ODM
ASSESSMENT FILES
RESEARCH OFFICE
NOV 2 1976
RECEIVED

All the work was performed on Mining Claim (s) 299569 - 354485 - 354486 - 354487
(In the case of geological and/or geophysical survey (s) where more than 18 claims are involved attach a schedule)

READ CAREFULLY: THE FOLLOWING INFORMATION IS REQUIRED BY THE MINING RECORDER.

- For Manual Work, Stripping or Opening up of Mines, Sinking Shafts or Other Actual Mining Operations - Names and addresses of the men who performed the work and the dates and hours of their employment.
- For Diamond and other Core Drilling - Footage, No. and angle of holes and diameter of core. Name and address of owner or operator of drill. Dates when drilling was done. Signed core log and sketch in duplicate.
- For Compressed Air or Other Power Driven or Mechanical Equipment
Type of drill or equipment. Names and addresses of men engaged in operating equipment and the dates and hours of their employment.
- For Power Stripping - Type of equipment. Name and address of owner or operator. Amount expended. Dates on which work was done. Proof of actual cost must be submitted within 30 days of recording.
- With each of the above types of work sketches are required to show the location and extent of the work in relation to the nearest claim post. In the case of diamond or other core drilling the sketch must be submitted in duplicate.
- For Geophysical, Geological, Geochemical Surveys and Expenditure Credits - the name of author of report. Covering dates of survey (linecutting & office). Type of instrument used. Total amount of expenditure. Technical reports, maps, expenditure breakdown, receipts must be filed in duplicate with the Minister within 60 days of recording.
- For Land Survey - the name and address of Ontario Land surveyor.

The Required Information is as Follows: (Attach a list if this space is insufficient)

see attached

Date October 25, 1976

[Signature] DEX LTD.
PRIVATE COMPANY
Signature of Recorded Holder or Agent

The Mining Act Certificate Verifying Report of Work

Len Darby

P.O. Box 186

Timmins Ont.

(Post Office Address)

hereby certify:

- That I have a personal and intimate knowledge of the facts set forth in the report of work annexed hereto, having performed the work or witnessed same during and/or after its completion.
- That the annexed report is true.

Dated Oct. 25 1976

[Signature]
Signature

OCT 27 1976
7 18 19 10 11 12 13 14 15 16

354485

OCT 27 1976
RECEIVED

THE PENALTY FOR MAKING A FALSE STATEMENT IN THIS REPORT AND/OR CERTIFICATE IS \$500. OR SIX MONTHS IMPRISONMENT OR BOTH

ASSESSMENT WORK



DEX LTD. T - 633

32D13NW5017 W7608-00246 STEELE

900

Power Stripping TD-15 Bulldozer. Operator L. Darby 203 Maple St. N
 Company owned rate @ \$ 20.00 per hr...ea. \$ 10.00 cr. 1 day's work

<u>XXXX</u>	<u>Date</u>	<u>Hrs Worked</u>	<u>Days Cr.</u>
April	16/76	9	18
"	17/76	10	20
"	18/76	8	16
"	19/76	5	10
"	20/76	7	14
"	21/76	9	18
"	22/76	8	16
June	26/76	10	20
"	27/76	8	16
"	28/76	8	16
"	29/76	10	20
"	30/76	10	20
July	2/76	10	20
"	3/76	10	20
"	4/76	4	8
"	5/76	12	24
"	6/76	5	10
July	12/76	6	12
"	13/76	5	10
"	14/76	10	20
"	15/76	10	20
July	20/76	11	22
"	21/76	10 X	20
"	22/76	11	22
"	23/76	8	16
"	24/76	9	18
"	25/76	10	20
Aug.	8/76	8	16
"	9/76	10	20
"	10/76	10	20
"	11/76	8	16
Aug.	17/76	8	16
"	18/76	10	20
"	19/76	8	16
"	20/76	10	20
Total		305 Hrs.	610 days

DEX LTD.
PRIVATE COMPANY

N

		60 CR	60 CR	60 CR	60 CR
300983	299570	354490	363059	363062	363067
		60 CR	60 CR	60 CR	60 CR
299568	299569	354485	363060	363061	363068
		60 CR	60 CR	60 CR	60 CR
		-60 DAY			
		354487	354486		

GROUP PLAN

STEELE TWP
DEX CLAIMS
ASSESSMENT WORK

OCT-25-1976

SCALE - 1" = 1320'

STEELE TWP.
Power Stripping
Scale - 1" = 10 chains
11/25/76

PIT
AREA

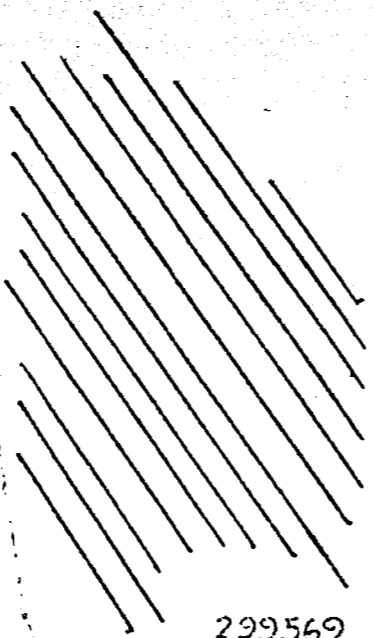

299569

354485

354487

354486

CREEK

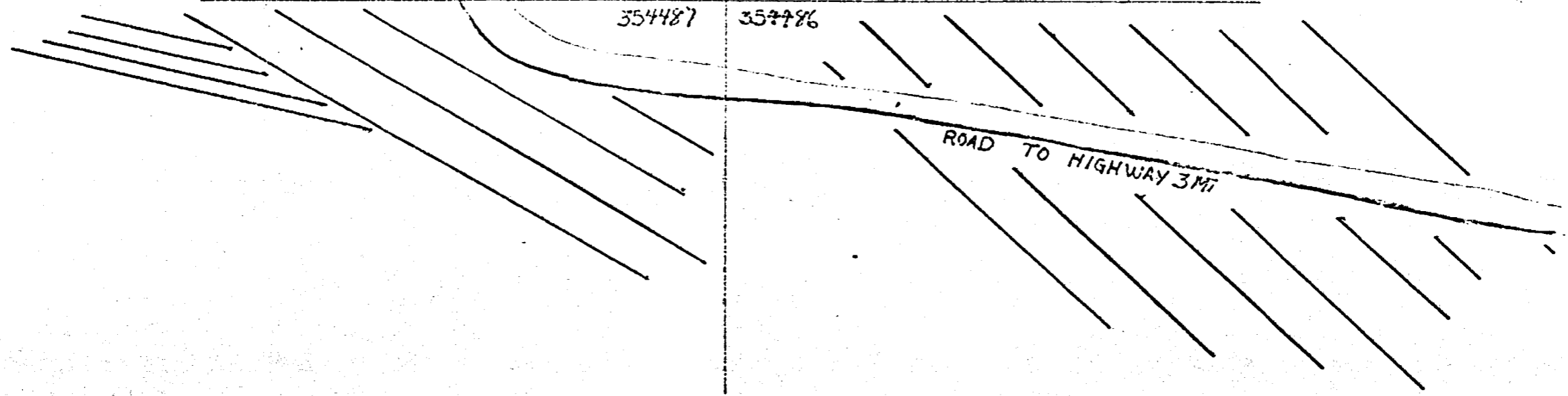

ROAD TO HIGHWAY 3 MI

TWP. M. 442

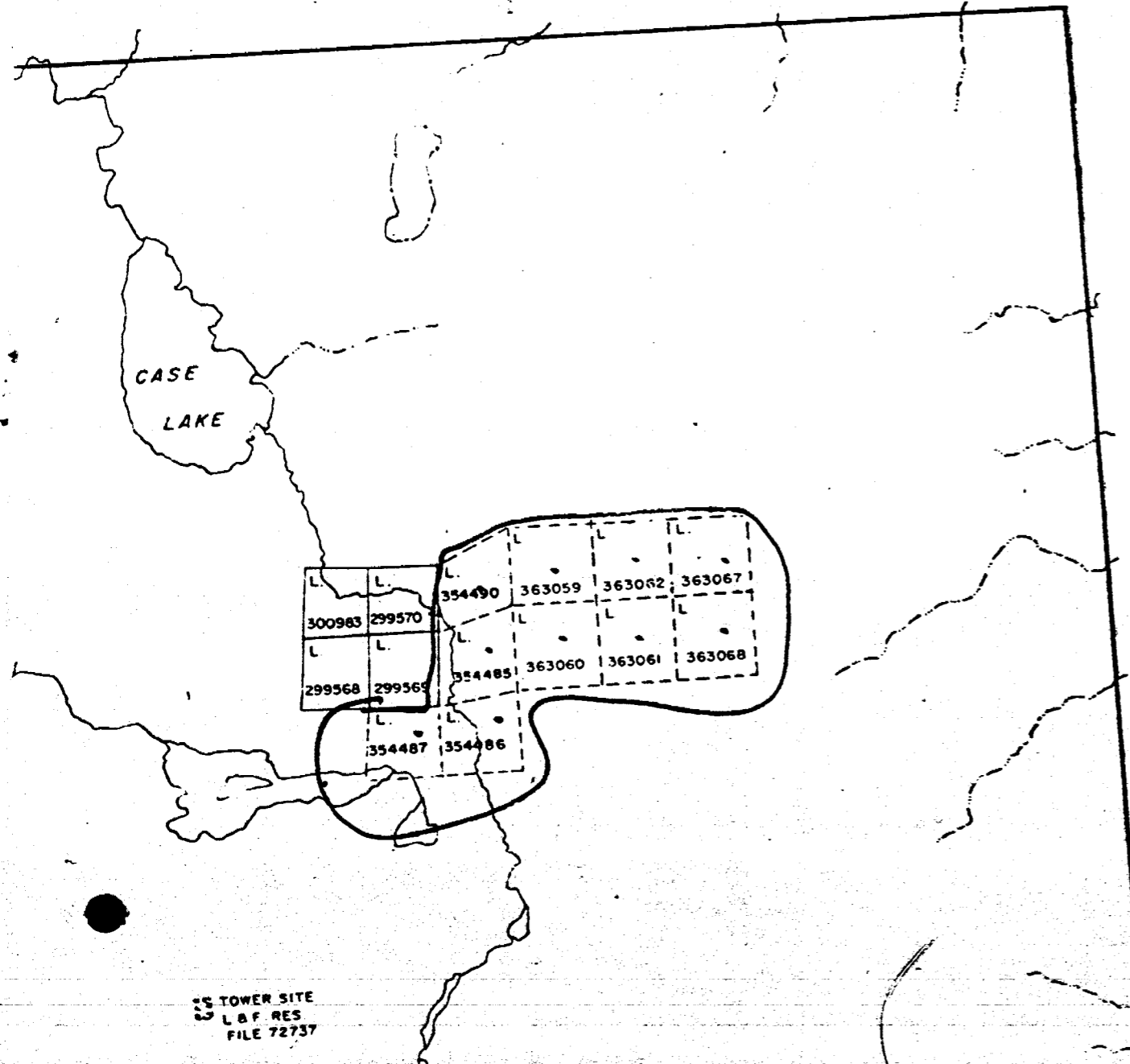

TOWER SITE
L & F RES
FILE 72737

APA TWP M. 585

STEELE

DISTRICT OF
COCHRANE
LARDER LAKE
MINING DIVISION

SCALE: 1-INCH = 40 CHAINS

LEGEND

- PATENTED LAND (P)
- CROWN LAND SALE C.S.
- LEASES (L)
- LOCATED LAND Loc.
- LICENSE OF OCCUPATION L.O.
- MINING RIGHTS ONLY M.R.O.
- SURFACE RIGHTS ONLY S.R.O.
- ROADS
- TRAILS
- HIGHWAY & ROUTE No
- RAILWAYS
- POWER LINES
- MARSH OR MUSKEG
- MINES X
- CANCELLED C.

NOTES

along the