



32E04SE0009 2.10320 ADAIR

010

**BASAL TILL SURVEY**  
**GOLD HILL RESOURCES INC.**  
**ABBOTSFORD and ADAIR TWPS.**  
**ONTARIO**

**by**

**C. W. Archibald, B. A. Sc.**

**10 August, 1987**

**RECEIVED**  
SEP - 1 1987  
**MINING LANDS SECTION**



32E04SE0009 2.10320 ADAIR

INDEX

010C

	<u>Page</u>
INTRODUCTION	1
PROPERTY	3
LOCATION & ACCESS	3
FIGURE 1	4
TOPOGRAPHY	5
BASAL TILL SURVEY	5
RESULTS OBTAINED	6
CONCLUSIONS AND RECOMMENDATIONS	7

MAPS

PLAN OF PROPERTY WITH DRILL HOLE LOCATION	PLATE 1
---	---------

APPENDICES

SECTION LINE 1E
SECTION LINE 0
SECTION LINE 0 + 50W
LOGS OF HOLES THE DRILLED

BASAL TILL SURVEY  
GOLD HILL RESOURCES INC.  
ABBOTSFORD AND ADAIR TWPS.  
ONTARIO

INTRODUCTION

In much of Northern Ontario, there is a varying depth of glacial till consisting of unconsolidated clay, sand, gravel, boulders, or a mixture of these, overlying bedrock. The layer immediately above the bedrock, or the basal till, generally consists of a coarse sand or gravel and, at times, portions of weathered or decomposed bedrock.

Where the basal till contains pieces of the weathered bedrock, a sample of this material will give an indication of the mineral content at this exact point and, when recovered, assists in correlating the geology.

Assays of basal till samples cannot all be taken as representative of the immediate bedrock as this till layer can be contaminated by the flow of ground water. The ground water can and does percolate through the basal till layer and absorbs some of the chemical content of both the bedrock it flows past and that of the basal till through which it flows. Where this condition exists, a grid of holes is necessary to trace the location of mineral content by following the stronger indications to the source.

In this survey, attempts were made to obtain a sample of basal till adjacent to the bedrock and a piece of the bedrock as an aid in the geological survey. At times, a clay layer was present all the way to the bedrock, giving no till layer, no oxidation zone and making it difficult to retrieve a bedrock sample.

At other times, there was a cemented sand and/or basal till layer adjacent to the bedrock. In both the above cases, there was no ground water percolation.

The 'cobbles' mentioned in the drill logs are angular or subangular pieces of rock generally found in the basal till layer.

Assays were obtained in parts per billion (p.p.b.) with 1740 p.p.b. approximately equalling 0.05 ounces of gold per ton.

The highest gold value obtained in this survey was 1,746 parts per billion and the ratings in p.p.b.'s were as shown below:

- Over 500 p.p.b.'s - anomalous
- From 150 - 500 p.p.b.'s - significant
- From 25 - 150 p.p.b.'s - needs further investigation
- Up to 25 p.p.b.'s - background

PROPERTY

The property consists of twenty-three contiguous, unpatented mining claims straddling the north-south boundary between Abbotsford and Adair Townships, Larder Lake Mining Division, District of Cochrane, Ontario (see Figure 1, page 4). Gold Hill Resources Inc. owns a one hundred percent interest in the property.

Of the twenty-three claims, eight of the claims are in Abbotsford Township while the remaining fifteen are in Adair Township to the east (see Figure 1). They are numbered as follows:

755061 and 755062	(Abbotsford Township)
737343 to 737348, inclusive	(Abbotsford Township)
755063	(Adair Township)
737350 to 737363, inclusive	(Adair Township)

LOCATION AND ACCESS

The claim group is located approximately forty miles east-northwest of the town of Cochrane, Ontario, and is just over 20 miles northwest of La Sarre, Quebec. The property may be reached by road from either location, via logging roads that cross the area. During the winter it is possible to get within five miles of the property, after which a snowmobile would be required.

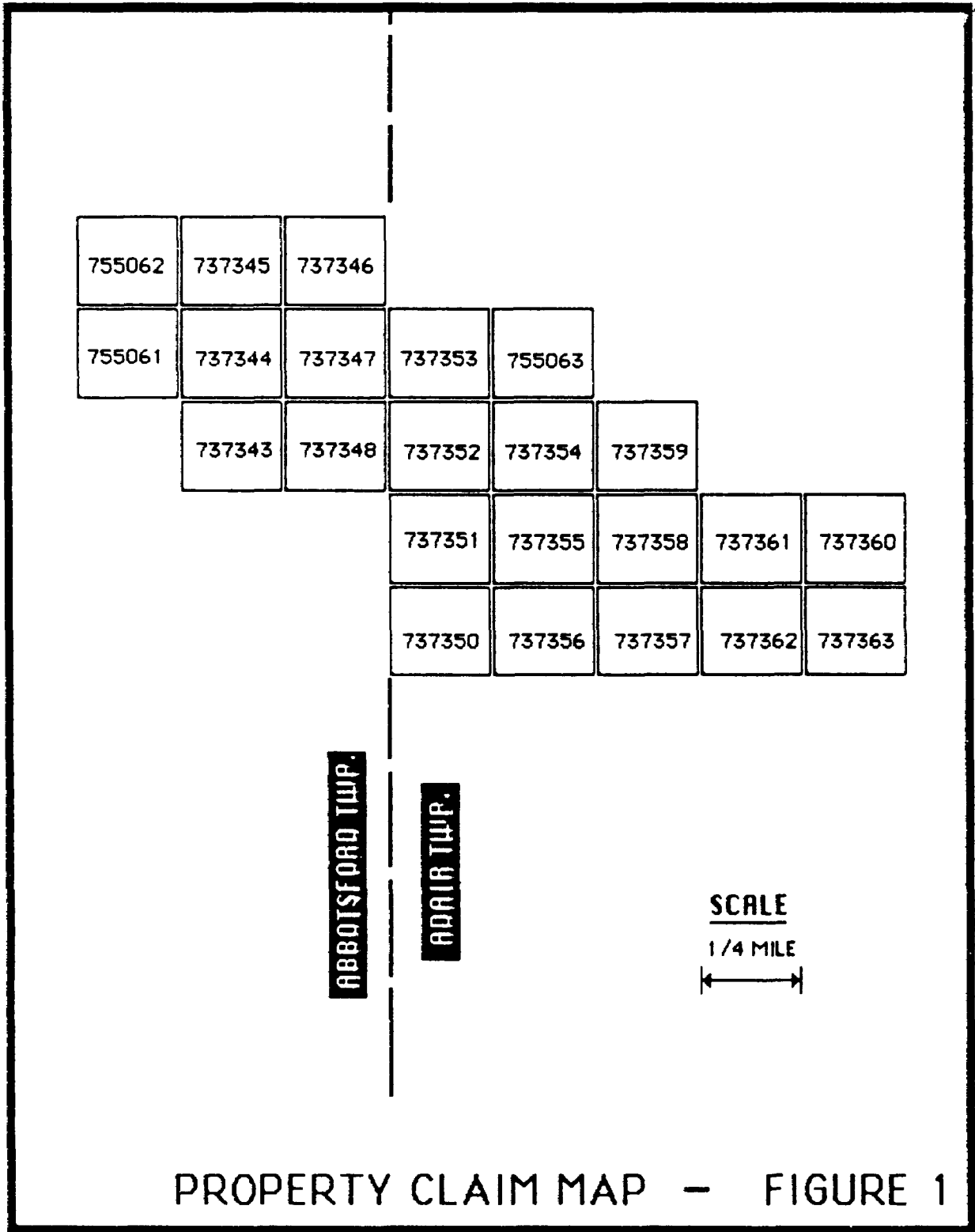

### TOPOGRAPHY

The topography of the area is typical Canadian Shield terrain, a low-lying, irregular, poorly-drained landscape, the pattern disrupted by occasional north-south trending eskers. Overburden is comparatively shallow, as noted by the holes drilled during this survey. Outcrop is estimated at approximately five percent. Maximum elevation in Abbotsford Township is in the 400 metre range above sea level. Forest cover is fairly dense, consisting mainly of jack pine and spruce.

### BASAL TILL SURVEY

This program was conducted in June of this year, using a Wink Vibra Corer Drill which produces an uncontaminated and undisturbed sample of overburden in the form of core which may be visually examined and sampled.

A total of 1952.5 feet were drilled in 58 holes during the survey.

The drill will not penetrate bedrock, most boulder beds or certain types of varved clay, but sand, gravel, most clays or silt with a moisture content are easily cored.

Three lines of holes were made on the property, as shown on the attached property plan (Plate 1). Holes were spaced 40 metres or approximately 120 feet apart on lines cut normal to the general strike of the geology. Lines 1 East and line 0 are 100 metres or approximately 300 feet apart.

Logs of the holes, and sections by line, are attached to this report. The three sections have the horizontal scale different from the vertical scale in order to accentuate the differences in the bedrock levels.

## RESULTS OBTAINED

Section line 1E had 24 holes drilled on it, 16 of which reached bedrock.

One hole only, number 37 at 80N (240 feet north of the baseline), showed values worth investigating. All other holes showed minimal values.

Hole 37 assayed 131 parts per billion, which warrants further investigation, though this measure was actually a low value.

Since this hole is at the lower portion of the bedrock (see section), it could be an accumulation of gold values from up-slope to the south. However, hole 36, which is up-slope, has a higher than normal assay value of 43 p.p.b.'s, so the area should be investigated.

Section line 0, parallel to and west of line 1E, is a more interesting line of 25 holes, of which 14 definitely reached bedrock.

On this line of holes, one was very highly anomalous and two others should be investigated.

The one anomalous hole, number 3, 40 feet south of the baseline, with an assay of 1746 p.p.b.'s (or 0.05 ounces of gold per ton) was exceptionally high for this type of survey and warrants a diamond drill hole to test it. As it is only 8.0 feet to bedrock, stripping by bulldozer could be contemplated.

The only other notable holes on this line were numbers 12 and 13, located at 400 and 440 feet, respectively, south of the baseline. Because of the dip of the bedrock in this area, it is my opinion that the gold values come from just north of hole 12 but have been more concentrated at the site of hole 13.



Section line O+50 W is a short line of 9 holes close by the road leading north (see Plate I).

Three of the 9 holes (numbers 52, 56 and 58) should be further investigated, but none of the holes show anomalous values.

#### CONCLUSIONS AND RECOMMENDATIONS

Only one anomalous hole, with 1746 parts per billion of gold (0.05 ounces of gold per ton) was located in this survey in hole 3 on line O. This hole could be investigated by trenching as there is only 8 feet of overburden over bedrock. A bulldozer could be brought in from La Sarre, or, if this is not available, a short diamond drill hole could test the area.

In all three lines of holes, there were only 6 additional holes which warranted further investigation. The holes in this category on all lines would have to be investigated by diamond drilling due to the depth of the overburden.

This overburden drilling program has shown itself to be useful by indicating several zones of possible gold mineralization and by giving the depths of overburden which could be useful when locating future diamond drill holes or stripping sites.

Respectfully submitted,

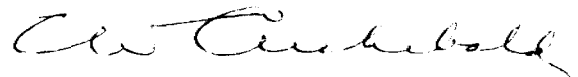

Toronto, Ontario  
10 August, 1987

C. W. Archibald, B.A.Sc.  
P. Eng. of Ontario

C. W. ARCHIBALD LIMITED  
Consulting Mining Engineers

702 - 100 Adelaide Street W.  
Toronto, Ontario (M5H 1S3)  
TEL. 363-5054

August 10, 1987

CERTIFICATE

I am submitting herewith a report covering a basal till survey of the Gold Hill Resources property in Abbotsford and Adair Townships, Ontario.

In connection with this report, I hereby certify:

1. That I am a graduate of the University of Toronto in Mining Engineering and reside at 418 Glencairn Avenue, Toronto, Ontario.
2. That I have been practising my profession for more than thirty years.
3. That I have no interest directly or indirectly in the Company or property nor do I expect to receive any interest.
4. That the accompanying report is based on a personal knowledge of the property and the basal till survey as it was carried out.

Toronto, Ontario  
August 10, 1987

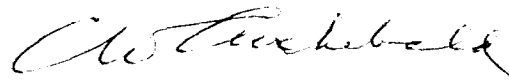

C. W. Archibald, B. A. Sc.  
P. Eng. of Ontario

North

520N 560N 600N 640N 680N 720N 760N 800N DATUM LINE

**LEGEND**

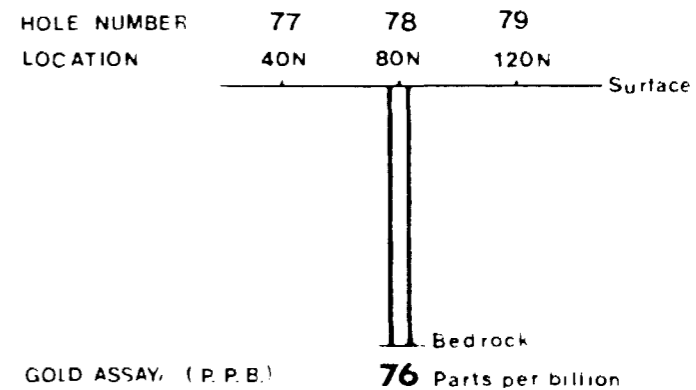

BACKGROUND	0 - 50	P.P.B.'s
INVESTIGATE	50 - 150	P.P.B.'s
SIGNIFICANT	150 - 500	P.P.B.'s
ANOMALOUS	> 500	P.P.B.'s

*2.10320*

**BASAL TILL SURVEY  
GOLD HILL RESOURCES INC.**

ABBOTSFORD & ADAIR TWPS., ONT.

**SECTION**

**L 1E**

*at the end*

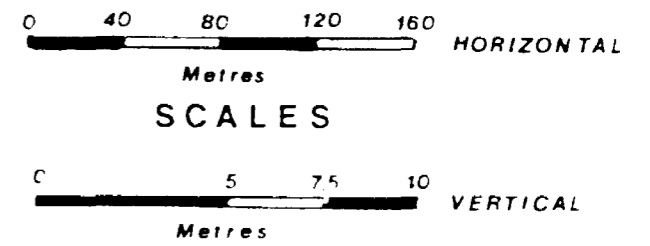
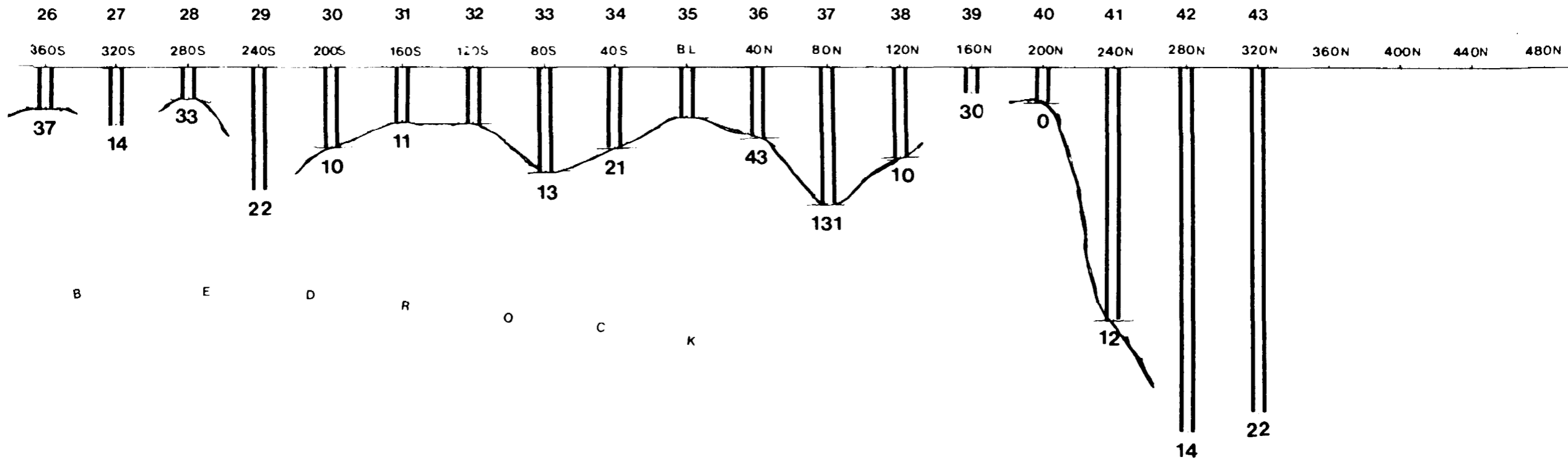

South

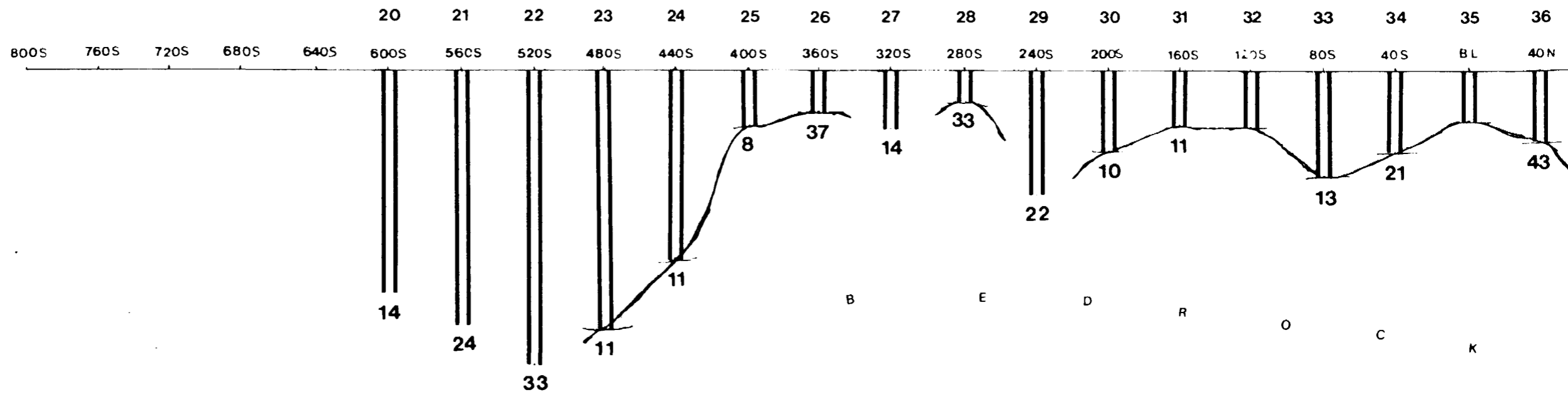

North

ON 520N 560N 600N 640N 680N 720N 760N 800N  
↓ DATUM LINE

**LEGEND**

HOLE NUMBER	77	78	79
LOCATION	40N	80N	120N

Surface

Bedrock

GOLD ASSAY ( P.P.B. ) **76** Parts per billion

BACKGROUND	0 - 50	P.P.B.'s
INVESTIGATE	50 - 150	P.P.B.'s
SIGNIFICANT	150 - 500	P.P.B.'s
ANOMALOUS	> 500	P.P.B.'s

*210320*

**BASAL TILL SURVEY  
GOLD HILL RESOURCES INC.**

ABBOTSFORD & ADAIR TWPS., ONT.

**SECTION**

**L O**

*W. C. ...*

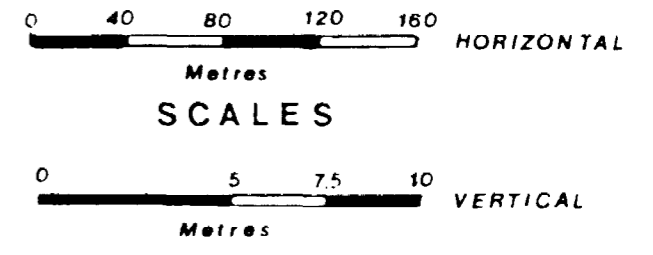
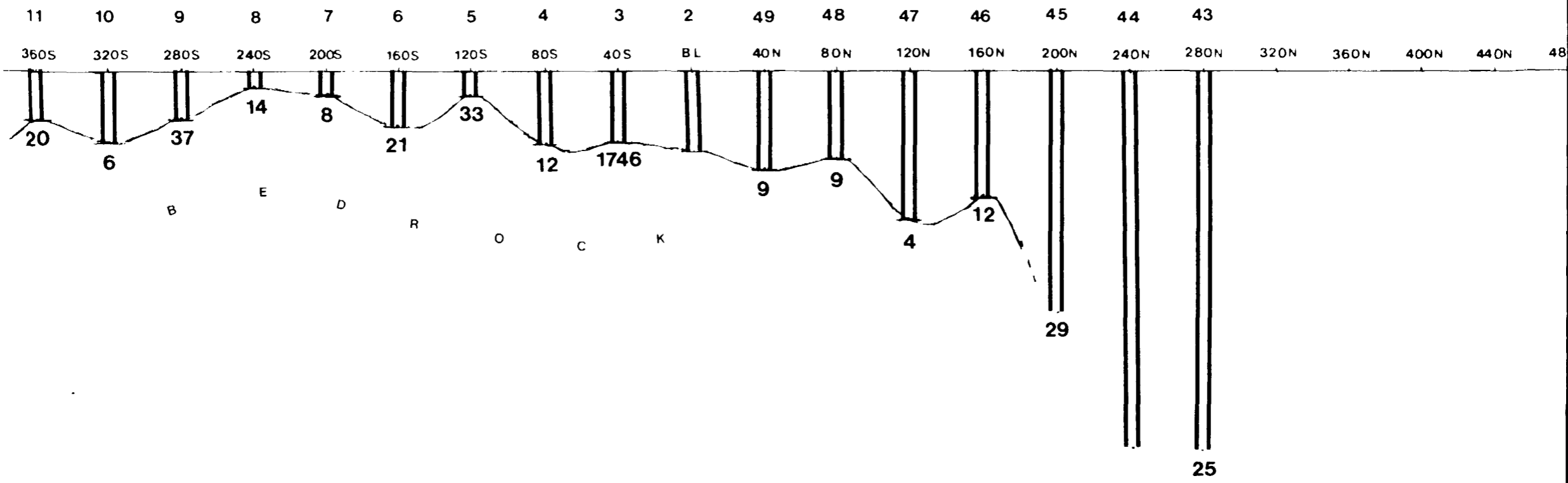

South

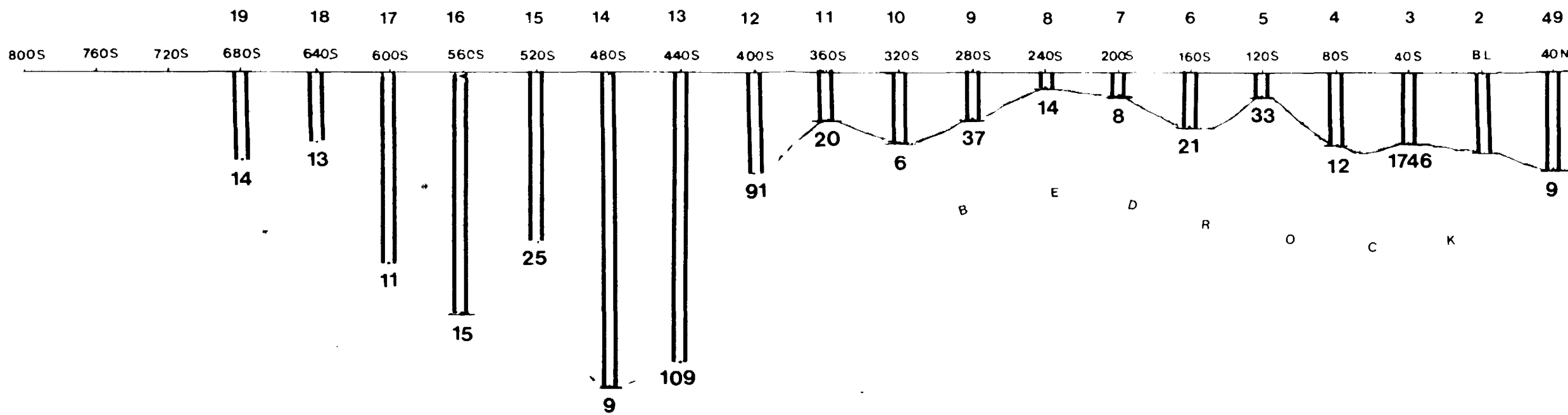



North

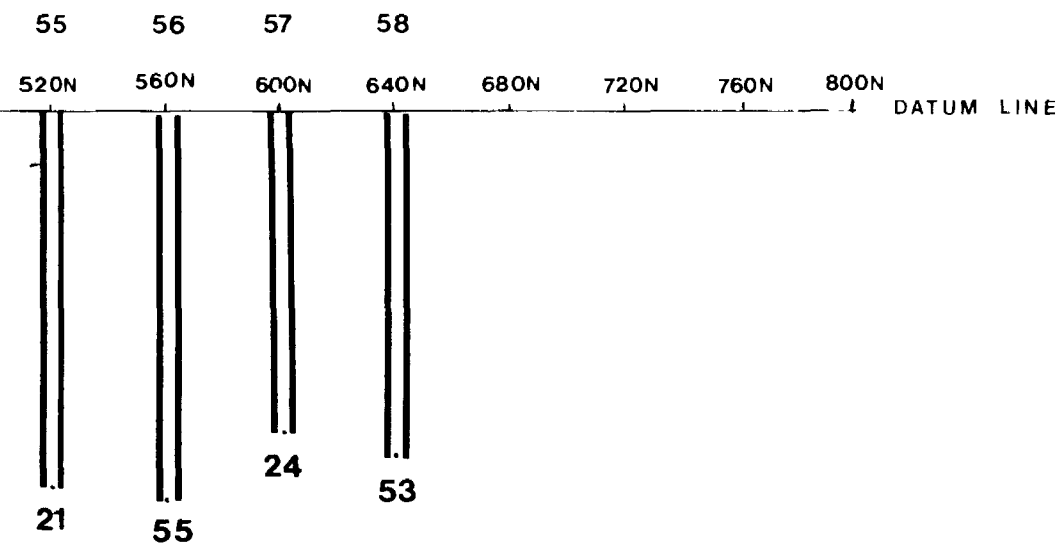

**LEGEND**

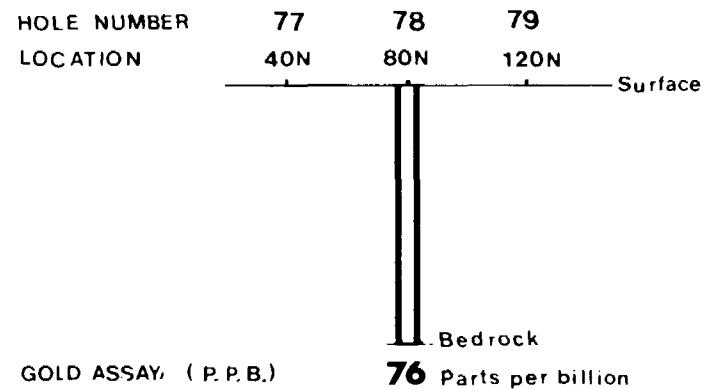

<b>BACKGROUND</b>	0 - 50	P.P.B.'s
<b>INVESTIGATE</b>	50 - 150	P.P.B.'s
<b>SIGNIFICANT</b>	150 - 500	P.P.B.'s
<b>ANOMALOUS</b>	> 500	P.P.B.'s

210320

**BASAL TILL SURVEY  
GOLD HILL RESOURCES INC.**

ABBOTSFORD & ADAIR TWPS., ONT.

**SECTION**

**L 0+50W**

*Handwritten signature*

360S 320S 280S 240S 200S 160S 120S 80S 40S BL 40N 80N 120N 160N 200N 240N 280N 320N 360N 400N 440N 480N 50 51 52 53 54

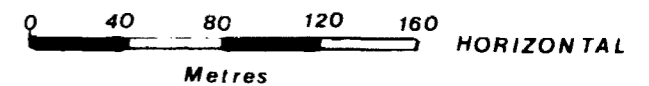
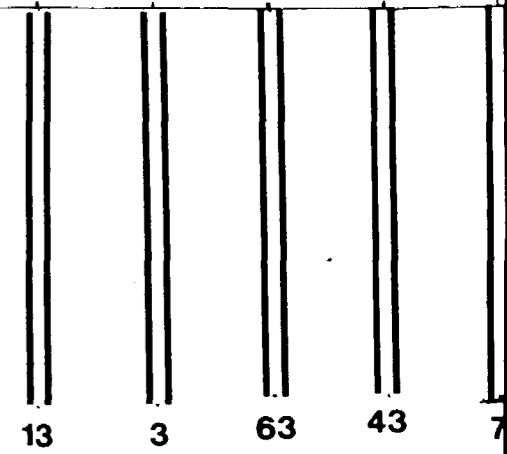

**SCALES**

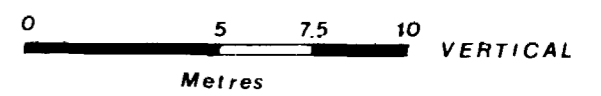

South

800S 760S 720S 680S 640S 600S 560S 520S 480S 440S 400S 360S 320S 280S 240S 200S 160S 120S 80S 40S BL 40N

# GOLD HILL RESOURCES INC.

## SONIC OVERBURDEN DRILLING

DATE DRILLED: June 13, 1987

HOLE NO: BS 87-3

LOCATION: L00-0+40South

<u>FOOTAGE</u>	<u>DETAILS</u>	<u>SAMPLE NO</u>	<u>LOCATION</u>	<u>AU</u> <u>ASSAY</u> <u>p.p.b.</u> <u>oz.</u>
0-7.0	Clay (brown), compact			
7.0-7.5	Clay-Silt-Sand			
7.5-8.0	Sand with Gravel			
8.0	Bedrock	24251	7.0-8.0	1746

# GOLD HILL RESOURCES INC.

## SONIC OVERBURDEN DRILLING

DATE DRILLED:

June 14, 1987

HOLE NO: BS 87-4

LOCATION: L00- 0+80South

<u>FOOTAGE</u>	<u>DETAILS</u>	<u>SAMPLE NO</u>	<u>LOCATION</u>	<u>AU ASSAY</u> <small>p.p.b. oz.</small>
0-1.0	Humus-Organics- sandy-wet			
1.0-5.0	Clay- brown, compact			
5.0-6.0	Clay-Sand			
6.0-7.5	Sand-Gravel (brown)			
7.5-8.0	Sand-Gravel layers- cobbles to 5 cm. diameter			
8.0	Bedrock	24252	7.0-8.0'	12

**GOLD HILL RESOURCES INC.**

**SONIC OVERBURDEN DRILLING**

DATE DRILLED: June 14, 1987

HOLE NO: BS 87- 5

LOCATION: L00-1+20South

<u>FOOTAGE</u>	<u>DETAILS</u>	<u>SAMPLE NO</u>	<u>LOCATION</u>	<u>AU ASSAY</u> <small>p.p.b. oz.</small>
0-1.0	humus-Organics			
1.0-2.0	Clay-Gravel			
2.0-3.0	Sand-Gravel- compacted, attempted two holes (same depth both times)	24253	2.2-3.0'	33
3.0	Bedrock			

# GOLD HILL RESOURCES INC.

## SONIC OVERBURDEN DRILLING

DATE DRILLED: June 14, 1987

HOLE NO: BS 87-6

LOCATION: L00- 1+60South

<u>FOOTAGE</u>	<u>DETAILS</u>	<u>SAMPLE NO</u>	<u>LOCATION</u>	<u>AU ASSAY</u> <small>p.p.b. oz.</small>
0-1.5	Humus-Organics			
1.5-4.5	Clay- compact, brown			
4.5-7.0	Sand-Gravel with large cobbles			
7.0	Bedrock	24254	6.0-7.0'	21

# GOLD HILL RESOURCES INC.

## SONIC OVERBURDEN DRILLING

DATE DRILLED: June 14, 1987

HOLE NO: BS 87-7

LOCATION: L00-2+00South

<u>FOOTAGE</u>	<u>DETAILS</u>	<u>SAMPLE NO</u>	<u>LOCATION</u>	<u>AU</u> <u>ASSAY</u> <small>p.p.b. oz.</small>
0-1.0	Humus-Organics			
1.0-2.0	Clay- brown colour			
2.0-2.5	Sand-Fine Gravel- tried twice with			
2.5	Bedrock			
	same depth both	24255	2.0-2.5'	8
	times			



# GOLD HILL RESOURCES INC.

## SONIC OVERBURDEN DRILLING

DATE DRILLED: June 14, 1987

HOLE NO: BS 87- 8

LOCATION: L00-2+40South

<u>FOOTAGE</u>	<u>DETAILS</u>	<u>SAMPLE NO</u>	<u>LOCATION</u>	<u>AU</u> <u>ASSAY</u> <small>p.p.b. oz.</small>
0-0.5	Humus-Organics- red loam			
0.5-2.0	Sand with gravel at bottom			
2.0	Bedrock	24256	1.0-2.0'	14

# GOLD HILL RESOURCES INC.

## SONIC OVERBURDEN DRILLING

DATE DRILLED: June 14, 1987

HOLE NO: BS 87- 9

LOCATION: L00-2+80South

<u>FOOTAGE</u>	<u>DETAILS</u>	<u>SAMPLE NO</u>	<u>LOCATION</u>	<u>AU ASSAY</u> <small>p.p.b. oz.</small>
0-0.3	Humus-Organics			
0.3-4.5	Clay- brown colour, compact			
4.5-5.5	Sand- fine, grey colour			
5.5-6.0	Sand(Coarse)-Gravel			
6.0	Bedrock	24257	5.0-6.0'	37

# GOLD HILL RESOURCES INC.

## SONIC OVERBURDEN DRILLING

DATE DRILLED: June 14, 1987

HOLE NO: BS 87- 10

LOCATION: L00-3+20South

<u>FOOTAGE</u>	<u>DETAILS</u>	<u>SAMPLE NO</u>	<u>LOCATION</u>	<u>AU ASSAY</u> <small>p.p.b. oz.</small>
0-0.4	Humus-Organics			
0.4-5.0	Clay- brown, compact @ 4.0-5.0- grey sand with clay			
5.0-6.0	Sand- fine, grey colour			
6.0-8.3	Sand-gravel layers			
8.3-9.0	Sandy Gravel till with a few rounded cobbles to 4 cm. diameter	24258	8.0-9.0	6
9.0	Bedrock			

# GOLD HILL RESOURCES INC.

## SONIC OVERBURDEN DRILLING

DATE DRILLED: June 14, 1987

HOLE NO: BS 87- 11

LOCATION: L00-3+60South

<u>FOOTAGE</u>	<u>DETAILS</u>	<u>SAMPLE NO</u>	<u>LOCATION</u>	<u>AU</u> <u>ASSAY</u> <u>p.p.b.</u> <u>oz.</u>
0-0.4	Humus-Organics			
0.4-5.0	Clay- brown, 10-15% moisture cont.			
5.0-5.6	Sand- wet, grey			
5.6-6.3	Sand-Gravel till with some larger cobbles			
6.3	Bedrock	24259	5.0-6.3	20

# GOLD HILL RESOURCES INC.

## SONIC OVERBURDEN DRILLING

DATE DRILLED: June 14, 1987

HOLE NO: BS 87- 12

LOCATION: L00-4+00South

<u>FOOTAGE</u>	<u>DETAILS</u>	<u>SAMPLE NO</u>	<u>LOCATION</u>	<u>AU ASSAY</u> <small>p.p.b. oz.</small>
0-3.0	Humus-Organics			
3.0-12.9	Clay- compact, brown colour			
12.9-13.0	Clay-Sand with odd large cobble - tried several attempts to penetrate- no further - sample mainly sand/clay - brown colour	24260	12.0-13.0	91

**GOLD HILL RESOURCES INC.**

**SONIC OVERBURDEN DRILLING**

DATE DRILLED: June 15-17, 1987

HOLE NO: BS 87-13

LOCATION: L00-4+40South

<u>FOOTAGE</u>	<u>DETAILS</u>	<u>SAMPLE NO</u>	<u>LOCATION</u>	<u>AU</u> <u>ASSAY</u> <small>p.p.b. oz.</small>
0-6.0'	Humus-Organics (swamp cover)			
6.0-29.0	Clay- +20% moisture content			
29.0-37.3	Sand-Gravel layers			
37.3-38.0	Sandy Gravel- grey colour, cobbles to 4 cm. diameter			
38.0	End of Hole- compact	24261	37.0-38.0	109

# GOLD HILL RESOURCES INC.

## SONIC OVERBURDEN DRILLING

DATE DRILLED: June 17, 1987

HOLE NO: BS 87- 14

LOCATION: L00-4+80South

<u>FOOTAGE</u>	<u>DETAILS</u>	<u>SAMPLE NO</u>	<u>LOCATION</u>	<u>AU ASSAY</u> <small>p.p.b. oz.</small>
0-6.0'	Humus-Organics-(swamp cover)			
6.0-27.0	Clay- penetrates 1' in 5 sec. +20% moisture content			
27.0-39.3	Gravel with sand layers			
39.3-39.6	Sandy Gravel with cobbles to 4 cm. diameter			
39.6-40.0	Sand with some till gravel, grey colour with high moisture content			
40.0	Bedrock	24262	39.0-40.0	9

**GOLD HILL RESOURCES INC.**

**SONIC OVERBURDEN DRILLING**

DATE DRILLED: June 17, 1987

HOLE NO: BS 87-15

LOCATION: L00- 5+20South

<u>FOOTAGE</u>	<u>DETAILS</u>	<u>SAMPLE NO</u>	<u>LOCATION</u>	<u>AU ASSAY</u> <small>p.p.b. oz.</small>
0-3.0'	Humus-Organics			
3.0-13.0	Clay- brown-grey colour			
13.0-21.3	Gravel			
21.3-22.0	Sand with some gravel, cobbles to 5 cm. diameter			
22.0	End of Hole- cobble stuck in end	24263	21.0-22.0	25



# GOLD HILL RESOURCES INC.

## SONIC OVERBURDEN DRILLING

DATE DRILLED: June 18, 1987

HOLE NO: BS 87-16

LOCATION: L00- 5+60South

<u>FOOTAGE</u>	<u>DETAILS</u>	<u>SAMPLE NO</u>	<u>LOCATION</u>	<u>AU</u> <u>ASSAY</u> <u>p.p.b.</u> <u>oz.</u>
0-2.0	Humus-Organics			
2.0-6.5	Clay			
6.5-29.8	Gravel with boulder layers			
29.8-30.5	Sand with cobbles & fragments			
30.5	Bedrock	24264	29.8-30.5	15

**GOLD HILL RESOURCES INC.**

**SONIC OVERBURDEN DRILLING**

DATE DRILLED: June 18, 1987      HOLE NO: BS 87- 17      LOCATION: L00 6+00South

<u>FOOTAGE</u>	<u>DETAILS</u>	<u>SAMPLE NO</u>	<u>LOCATION</u>	<u>AU</u> <u>ASSAY</u> <small>p.p.b. oz.</small>
0-1.0	Humus-Organics			
1.0-6.0	Clay- 1' penetration in 5 seconds +20% moisture content			
6.0-23.3	Gravel with large cobbles and boulder layers			
23.3-24.0	Fine grey Sand with gravel layers - dry and compacting			
24.0	End of Hole- compacted	24265	23.3-24.0	11

# GOLD HILL RESOURCES INC.

## SONIC OVERBURDEN DRILLING

DATE DRILLED: June 18, 1987

HOLE NO: BS 87-18

LOCATION: L00- 6+40South

<u>FOOTAGE</u>	<u>DETAILS</u>	<u>SAMPLE NO</u>	<u>LOCATION</u>	<u>AU</u> <u>ASSAY</u> <u>p.p.b.</u> <u>oz.</u>
0-1.0	Humus-Organics			
1.0-5.0'	Clay- compact, brown colour			
5.0-8.3	Sand with gravel layers at depth			
8.3-9.0	Gravel with grey sand matrix	24266	8.3-9.0'	13
9.0	End of Hole- slow penetration			

**GOLD HILL RESOURCES INC.**

**SONIC OVERBURDEN DRILLING**

DATE DRILLED: June 19, 1987

HOLE NO: BS 87-19

LOCATION: L00- 6+80South

<u>FOOTAGE</u>	<u>DETAILS</u>	<u>SAMPLE NO</u>	<u>LOCATION</u>	<u>AU ASSAY</u> <small>p.p.b. oz.</small>
0-1.0	Humus-Organics			
1.0-4.5	Clay- 1 foot penetration in 15 seconds.			
4.5-9.0	Sand- fine, compact, grey colour			
9.0-10.3	Gravel- with sand matrix (grey)			
m10.3-11.0	Gravel with angular fragments and cobbles (to 5 cm diameter)			
11.0	End of hole	24267	10.3-11.0	14

# GOLD HILL RESOURCES INC.

## SONIC OVERBURDEN DRILLING

DATE DRILLED:

June 25, 1987

HOLE NO: BS 87-49

LOCATION: L0-0+40North

<u>FOOTAGE</u>	<u>DETAILS</u>	<u>SAMPLE NO</u>	<u>LOCATION</u>	<u>AU</u> <u>ASSAY</u> <small>p.p.b. oz.</small>
0-1.5	road bed			
1.5-8.0	Clay- brown			
8.0-12.4	Gravel- sand layers -coarse sand-cobbles to 2cm.			
12.4	Bedrock brown colour granitic comp.	24297	11.8-12.4	9

# GOLD HILL RESOURCES INC.

## SONIC OVERBURDEN DRILLING

DATE DRILLED: June 25, 1987

HOLE NO: BS 87-48

LOCATION: L0-0+80North

<u>FOOTAGE</u>	<u>DETAILS</u>	<u>SAMPLE NO</u>	<u>LOCATION</u>	<u>AU ASSAY</u> <small>p.p.b. oz.</small>
0-1.0	Humus-Organics			
1.0-6.0	Clay- brown to grey with depth			
6.0-11.5	Gravel with sand layers -coarse sand, granitic composition			
11.5	Bedrock	24296	10.8-11.5	9

# GOLD HILL RESOURCES INC.

## SONIC OVERBURDEN DRILLING

DATE DRILLED: June 25, 1987

HOLE NO: BS 87- 47

LOCATION: L0-1+20North

<u>FOOTAGE</u>	<u>DETAILS</u>	<u>SAMPLE NO</u>	<u>LOCATION</u>	<u>AU</u> <u>ASSAY</u> <u>p.p.b.</u> <u>oz.</u>
0-1.0	Humus-Organics			
1.0-12.0	Clay- brown to grey with depth			
12.0-18.8	Gravel with sand layers -coarse sand, brown colour			
18.8	Bedrock granitic comp.	24295	18.3-18.8	4

# GOLD HILL RESOURCES INC.

## SONIC OVERBURDEN DRILLING

DATE DRILLED: June 25, 1987

HOLE NO: BS 87-46

LOCATION: L0-1+60North

<u>FOOTAGE</u>	<u>DETAILS</u>	<u>SAMPLE NO</u>	<u>LOCATION</u>	<u>AU</u> <u>ASSAY</u> <small>p.p.b. oz.</small>
0-2.5	Humus/Organics			
2.5-13.0	Clay- grey colour			
13.0-16.0	Gravel - brown colour, granodiorite cobbles to 3 cm. diameter			
16.0	Bedrock	24294	15.3-16.0	12



**GOLD HILL RESOURCES INC.**

**SONIC OVERBURDEN DRILLING**

DATE DRILLED: June 25, 1987      HOLE NO: BS 87- 45      LOCATION: L0-2+00North

<u>FOOTAGE</u>	<u>DETAILS</u>	<u>SAMPLE NO</u>	<u>LOCATION</u>	<u>AU ASSAY</u> <small>p.p.b. oz.</small>
0-4.5	Humus-Organics			
4.5-30.3	Clay- brown, sticky			
30.3-31.0	Gravel/Silt/Clay/Sand			
31.0	End of Hole- cannot penetrate - sample-clay/silt	24293	30.0-31.0	29

# GOLD HILL RESOURCES INC.

## SONIC OVERBURDEN DRILLING

DATE DRILLED: June 24, 1987

HOLE NO: BS 87- 44

LOCATION: L0-2+40North

<u>FOOTAGE</u>	<u>DETAILS</u>	<u>SAMPLE NO</u>	<u>LOCATION</u>	<u>AU ASSAY</u> <small>p.p.b. oz.</small>
0-3.0	Humus-Organics			
3.0-13.0	Clay- brown/compact/sticky			
13.0-44.0	Clay to sand with depth			
44.0-47.0	Gravel-Sand layers			
47.0	End of Hole- lost sample	-----		

**GOLD HILL RESOURCES INC.**  
**SONIC OVERBURDEN DRILLING**

DATE DRILLED: 24 June, 1987

HOLE NO: BS 87-43

LOCATION: L0, 2+80 N

<u>FOOTAGE</u>	<u>DETAILS</u>	<u>SAMPLE NO</u>	<u>LOCATION</u>	<u>AU ASSAY</u> <small>p.p.b. oz.</small>
0.0- 4.0	HUMUS ( swamp at 3+10N)			
4.0 -38.0	CLAY, grey			
38.0 -47.3	GRAVEL			
47.3 -48.0	SAND, grey, wet	24291	47.3-48.0	25
	Large cobble in bit - could penetrate no further			

**GOLD HILL RESOURCES INC.**  
**SONIC OVERBURDEN DRILLING**

DATE DRILLED: June 19, 1987

HOLE NO: BS 87-20

LOCATION: L1E- 6+00South

<u>FOOTAGE</u>	<u>DETAILS</u>	<u>SAMPLE NO</u>	<u>LOCATION</u>	<u>AU ASSAY</u> <small>p.p.b. oz.</small>
0-1.5	Humus-Organics			
1.5-6.0	Clay- compact, dark brown colour			
6.0-29.8	Sand- grey colour, compact			
29.8-30.5	Gravel- angular till fragments			
30.5	End of Hole	24268	29.8-30.5	14

**GOLD HILL RESOURCES INC.**  
**SONIC OVERBURDEN DRILLING**

DATE DRILLED: June 19, 1987      HOLE NO: BS 87- 21      LOCATION: L1E- 5+60South

<u>FOOTAGE</u>	<u>DETAILS</u>	<u>SAMPLE NO</u>	<u>LOCATION</u>	<u>AU</u> <u>ASSAY</u> <small>p.p.p. oz.</small>
0-2.0	Humus-Organics			
2.0-5.0	Clay + Humus			
5.0-34.3	Clay to Sand with depth			
34.3-35.0'	Sand-Gravel			
35.0	End of Hole	24269	34.3-35.0	24

**GOLD HILL RESOURCES INC.**  
**SONIC OVERBURDEN DRILLING**

DATE DRILLED: June 19, 1987

HOLE NO: BS 87-22

LOCATION: L1E- 5+20South

<u>FOOTAGE</u>	<u>DETAILS</u>	<u>SAMPLE NO</u>	<u>LOCATION</u>	<u>AU ASSAY</u> <small>p.p.b. oz.</small>
0-2.0	Humus-Organics			
2.0-6.0	Organics-Clay			
6.0-39.8	Clay to sand with dpth.			
39.8-40.5	Sand- grey, coarse, with some large cobbles			
40.5	End of Hole	24270	39.5-40.5	33

**GOLD HILL RESOURCES INC.**  
**SONIC OVERBURDEN DRILLING**

DATE DRILLED: June 20, 1987

HOLE NO: BS 87- 23

LOCATION: L1E- 4+80South

<u>FOOTAGE</u>	<u>DETAILS</u>	<u>SAMPLE NO</u>	<u>LOCATION</u>	<u>AU ASSAY</u> <small>p.p.b. oz.</small>
0-6.0	Humus-Organics			
6.0-34.8	Clay to sand with depth			
34.8-35.5	Gravel- till, angular fragments with rusty appearance (shear zone)			
35.5	Bedrock	24271	34.5-35.5	11

**GOLD HILL RESOURCES INC.**  
**SONIC OVERBURDEN DRILLING**

DATE DRILLED: June 20, 1987

HOLE NO: BS 87- 24

LOCATION: L1E-4+40South

<u>FOOTAGE</u>	<u>DETAILS</u>	<u>SAMPLE NO</u>	<u>LOCATION</u>	<u>AU ASSAY</u> <small>p.p.b. oz.</small>
0-3.5'	road bed at edge of swamp			
3.5-7.0	Clay- compact, dark grey colour			
7.0-25.2	Clay to sand with depth			
25.3-26.0	Gravel- till with angular frag. cobble stuck in end of shoe			
26.0	Bedrock	24272	25.0-26.0	11



**GOLD HILL RESOURCES INC.**

**SONIC OVERBURDEN DRILLING**

DATE DRILLED: June 20, 1987

HOLE NO: BS 87-25

LOCATION: L1E-4+00South

<u>FOOTAGE</u>	<u>DETAILS</u>	<u>SAMPLE NO</u>	<u>LOCATION</u>	<u>AU ASSAY</u> <small>p.p.b. oz.</small>
0-2.0	Road bed			
2.0-4.5	Clay- brown colour, compact			
4.5-7.0	Clay- fine, compacted, with sand atbdepth			
7.0-7.5	Sand- fine, grey colour, Gravel layers at depth			
7.5	Bedrock	24273	7.0-7.5'	8

**GOLD HILL RESOURCES INC.**  
**SONIC OVERBURDEN DRILLING**

DATE DRILLED: June 20, 1987

HOLE NO: BS 87- 26

LOCATION: L1E-3+60South

<u>FOOTAGE</u>	<u>DETAILS</u>	<u>SAMPLE NO</u>	<u>LOCATION</u>	<u>AU ASSAY</u> <small>p.p.b. oz.</small>
0-2.0	Road bed			
2.0-4.0	Clay- brown colour, compacted			
4.0-4.8	Sand- grey colour			
4.8-5.5	Gravel with angular fragments, some rusty cobbles			
5.5	Bedrock	24274	4.8-5.5'	37

# GOLD HILL RESOURCES INC.

## SONIC OVERBURDEN DRILLING

DATE DRILLED: June 20, 1987

HOLE NO: BS 87-27

LOCATION: L1E-3+20South

<u>FOOTAGE</u>	<u>DETAILS</u>	<u>SAMPLE NO</u>	<u>LOCATION</u>	<u>AU ASSAY</u> <small>p.p.b. oz.</small>
0-2.0	Humus-Sand			
2.0-7.3	Sand-Gravel layers			
7.3-8.0	Sand and Gravel with large cobble			
8.0	End of Hole- slow penetration	24275	7.3-8.0'	14

**GOLD HILL RESOURCES INC.**  
**SONIC OVERBURDEN DRILLING**

DATE DRILLED: June 20, 1987

HOLE NO: BS 87- 28

LOCATION: L1E-2+80South

<u>FOOTAGE</u>	<u>DETAILS</u>	<u>SAMPLE NO</u>	<u>LOCATION</u>	<u>AU ASSAY</u> <small>p.p.b. oz.</small>
0-0.5	Humus-Organics			
0.5-4.5	Sand-Gravel- with angular fragments			
4.5	Bedrock (outcrop 20' to west)	24276	3.5-4.5'	33

**GOLD HILL RESOURCES INC.**

**SONIC OVERBURDEN DRILLING**

DATE DRILLED: June 20, 1987      HOLE NO: BS 87-29      LOCATION: L1E-2+40South

<u>FOOTAGE</u>	<u>DETAILS</u>	<u>SAMPLE NO</u>	<u>LOCATION</u>	<u>AU ASSAY</u> <small>p.p.b. oz.</small>
0-2.0'	Humus-Organics			
2.0-6.0	Clay- grey/brown colour			
6.0-16.3	Sand- grey, fine grained			
16.3-17.0	Sand with Gravel layers - grey/brown colour - large cobble stuck in drive shoe			
17.0	End of Hole- slow penetration	24277	16.3-17.0	22

**GOLD HILL RESOURCES INC.**  
**SONIC OVERBURDEN DRILLING**

DATE DRILLED: June 21, 1987

HOLE NO: BS 87-30

LOCATION: L1E-2+00South

<u>FOOTAGE</u>	<u>DETAILS</u>	<u>SAMPLE NO</u>	<u>LOCATION</u>	<u>AU</u> <u>ASSAY</u> <small>p.p.b. oz.</small>
0-1.5	Humus- sandy			
1.5-6.0	Clay- brown/grey, moisture content increasing with depth			
6.0-11.0	Silty clay to sand with depth some gravel layers at bottom			
11.0	Bedrock	24278	10.3-11.0	10

# GOLD HILL RESOURCES INC.

## SONIC OVERBURDEN DRILLING

DATE DRILLED: June 21, 1987      HOLE NO: BS 87- 31      LOCATION: L1E-1+60South

<u>FOOTAGE</u>	<u>DETAILS</u>	<u>SAMPLE NO</u>	<u>LOCATION</u>	<u>AU</u> <u>ASSAY</u> <u>p.p.b.</u> <u>oz.</u>
0-1.5	Humus-Organics			
1.5-6.5	Brown Clay to silt at depth			
6.5-7.5	Sand-Gravel			
7.5	Bedrock	24279	6.5-7.5'	11

# GOLD HILL RESOURCES INC.

## SONIC OVERBURDEN DRILLING

DATE DRILLED: June 21, 1987

HOLE NO: BS 87-32

LOCATION: L1E-1+20South

<u>FOOTAGE</u>	<u>DETAILS</u>	<u>SAMPLE NO</u>	<u>LOCATION</u>	<u>AU ASSAY</u> <small>p.p.b. oz.</small>
0-1.5	Humus-Organics			
1.5-6.5	Brown Clay to Grey Clay with depth			
6.5-8.0	Clay-Sand (fine)-penetrated twice- no recovery	-----		
8.0	Bedrock			



**GOLD HILL RESOURCES INC.**  
**SONIC OVERBURDEN DRILLING**

DATE DRILLED: June 21, 1987

HOLE NO: BS 87-33

LOCATION: L1E-0+80South

<u>FOOTAGE</u>	<u>DETAILS</u>	<u>SAMPLE NO</u>	<u>LOCATION</u>	<u>AU ASSAY</u> <small>p.p.b. oz.</small>
0-1.0	Humus-Organics			
1.0-5.5	Brown Clay to Grey Clay with depth			
5.5-13.8	Clay to sand with depth			
13.8-14.5	Coarse Sand-Gravel			
14.5	Bedrock	24281	13.8-14.3	13

**GOLD HILL RESOURCES INC.**  
**SONIC OVERBURDEN DRILLING**

DATE DRILLED: June 21, 1987

HOLE NO: BS 87- 34

LOCATION: L1E-0+40South

<u>FOOTAGE</u>	<u>DETAILS</u>	<u>SAMPLE NO</u>	<u>LOCATION</u>	<u>AU ASSAY</u> <small>p.p.b. oz.</small>
0-0.5	Humus-Organics			
0.5-7.0	Brown Clay to Grey Clay with depth			
7.0-10.3	Sand			
10.3-11.0	Sandy Gravel with coarse cobbles - cobble stuck in end of shoe			
11.0	Bedrock	24282	10.3-11.0	21

**GOLD HILL RESOURCES INC.**  
**SONIC OVERBURDEN DRILLING**

DATE DRILLED: June 21, 1987

HOLE NO: BS 87- 35

LOCATION: L1E- base line

<u>FOOTAGE</u>	<u>DETAILS</u>	<u>SAMPLE NO</u>	<u>LOCATION</u>	<u>AU ASSAY</u> <small>p.p.b. oz.</small>
0-1.0	Humus-Organics			
1.0-7.0	Clay (brown) to silt with depth			
7.0	Bedrock- lost sample (tried twice to retrieve)	-----		

**GOLD HILL RESOURCES INC.**  
**SONIC OVERBURDEN DRILLING**

DATE DRILLED: June 22, 1987

HOLE NO: BS 87- 36

LOCATION: L1E-0+40North

<u>FOOTAGE</u>	<u>DETAILS</u>	<u>SAMPLE NO</u>	<u>LOCATION</u>	<u>AU ASSAY</u> <small>p.p.b. oz.</small>
0-1.0	Organics-Humus			
1.0-9.8	Clay- brown, -10% moisture content			
9.8-10.0	Sand with angular rock fragment -mafic volcanic fragment to 2 cm. diameter			
10.0	Bedrock	24284	9.0-10.0	43

**GOLD HILL RESOURCES INC.**  
**SONIC OVERBURDEN DRILLING**

DATE DRILLED: June 22, 1987

HOLE NO: BS 87- 37

LOCATION: L1E-0+80North

<u>FOOTAGE</u>	<u>DETAILS</u>	<u>SAMPLE NO</u>	<u>LOCATION</u>	<u>AU ASSAY</u> <small>p.p.b. oz.</small>
0-1.0	Humus-Organics			
1.0-18.0	Clay- brown to grey with depth			
18.0-19.0	silt to Gravel - brown colour,			
19.0	Bedrock? angular frag. (mafic volc) to 2 cm.diameter	24285	18.0-19.0	131

**GOLD HILL RESOURCES INC.**  
**SONIC OVERBURDEN DRILLING**

DATE DRILLED: June 23, 1987

HOLE NO: BS 87- 38

LOCATION: L1E-1+20North

<u>FOOTAGE</u>	<u>DETAILS</u>	<u>SAMPLE NO</u>	<u>LOCATION</u>	<u>AU ASSAY</u> <small>p.p.b. oz.</small>
0-0.5	Humus-Organics			
0.5-12.5	Sand-Gravel (gravel layers at depth)			
	11.8-12.5- till, +30% moisture			
	- brown colour,			
12.5	Bedrock granitic cobbles	24286	11.8-12.5	10

**GOLD HILL RESOURCES INC.**

**SONIC OVERBURDEN DRILLING**

DATE DRILLED: June 23, 1987

HOLE NO: BS 87- 39

LOCATION: L1E-1+60North

FOOTAGE	DETAILS	SAMPLE NO	LOCATION	AU ASSAY p.p.b. oz.
0-1.0	Humus-Organics			
1.0-3.5	Sand to Gravel with depth - gravel with angular fragments @ 3.5- boulder layer - End of Hole - brown colour, granitic cobbles to 2 cm. diam. & mafic volcanic fragments	24287	2.5-3.5'	30

# GOLD HILL RESOURCES INC.

## SONIC OVERBURDEN DRILLING

DATE DRILLED: June 23, 1987

HOLE NO: BS 87-40

LOCATION: L1E-2+00N

<u>FOOTAGE</u>	<u>DETAILS</u>	<u>SAMPLE NO</u>	<u>LOCATION</u>	<u>AU ASSAY</u> <small>p.p.b. oz.</small>
0-1.0	Humus-Organics			
1.0-4.5	Clay- brown to grey with depth			
4.5-5.0	Sand-Gravel with till and angular (mafic volc.) fragments			
5.0	Bedrock -frag. to 3 cm. - carbonate rich	24288	4.0-5.0'	0



**GOLD HILL RESOURCES INC.**  
**SONIC OVERBURDEN DRILLING**

DATE DRILLED: June 23, 1987

HOLE NO: BS 87- 41

LOCATION: L1E-2+40North

<u>FOOTAGE</u>	<u>DETAILS</u>	<u>SAMPLE NO</u>	<u>LOCATION</u>	<u>AU ASSAY</u> <small>p.p.b. oz.</small>
0-4.0	Humus-Organics			
4.0-23.0	Clay- brown to grey with depth			
23.0-34.3	Sand to gravel with depth			
34.2-35.0	Gravel-till- grey colour, siliceous rich			
35.0	Bedrock	24289	34.0-35.0	12

**GOLD HILL RESOURCES INC.**  
**SONIC OVERBURDEN DRILLING**

DATE DRILLED: June 23, 1987

HOLE NO: BS 87- 42

LOCATION: L1E-2+80North

<u>FOOTAGE</u>	<u>DETAILS</u>	<u>SAMPLE NO</u>	<u>LOCATION</u>	<u>AU</u> <u>ASSAY</u> <small>p.p.b. oz.</small>
0-4.0	Humus-Organics			
4.0-29.0	Clay to sand with depth			
29.0-49.8	Gravel-Sand layers			
49.8-50.5	Gravel-till- grey/green colour felsic cobbles (carb) to 2cm	24290	49.8-50.5	14
50.5	Gravel boulders or Bedrock?			

**GOLD HILL RESOURCES INC.**  
**SONIC OVERBURDEN DRILLING**

DATE DRILLED: June 24, 1987

HOLE NO: BS 87-43

LOCATION: L0-3+20North

<u>FOOTAGE</u>	<u>DETAILS</u>	<u>SAMPLE NO</u>	<u>LOCATION</u>	<u>AU ASSAY</u> <small>P.P.B. OZ.</small>
0-4.0	Humus-Organics			
4.0-38.0	Clay			
38.0-47.3	Gravel-Sand layers			
47.3-48.0	Sand-Gravel with cobble stuck in end of drive shoe			
48.0	End of Hole -grey/green colour -mafic volc.cobble to 4 cm. diam.	24291	47.0-48.0	22

**GOLD HILL RESOURCES INC.**  
**SONIC OVERBURDEN DRILLING**

DATE DRILLED: June 25, 1987      HOLE NO: BS 87-50      LOCATION: L0+50West-3+20North

<u>FOOTAGE</u>	<u>DETAILS</u>	<u>SAMPLE NO</u>	<u>LOCATION</u>	<u>AU ASSAY</u> <small>p.p.b. oz.</small>
0-2.0	Humus-Organics			
2.0-32.0	Clay			
32.0-42.0	Gravel-Sand layers			
	41.3-42.0- cobble layer			
	- cobbles/fragments			
	to 3 cm., granitic			
42.0	to granodioritic	24298	41.3-42.0	13
	End of Hole - grey colour			

**GOLD HILL RESOURCES INC.**  
**SONIC OVERBURDEN DRILLING**

DATE DRILLED: June 26, 1987

HOLE NO: BS 87- 51

LOCATION: L0+50West-road  
3+60North

<u>FOOTAGE</u>	<u>DETAILS</u>	<u>SAMPLE NO</u>	<u>LOCATION</u>	<u>AU ASSAY</u> <small>p.p.b. oz.</small>
0-3.0	Humus-Organics			
3.0-22.0	Clay- grey colour			
22.0-36.5	Gravel with coarse Sand matrix			
36.5-	End of Hole - coarse sand- brown colour, granitic composition	24299	35.4-36.5	3

**GOLD HILL RESOURCES INC.**  
**SONIC OVERBURDEN DRILLING**

DATE DRILLED: June 26, 1987

HOLE NO: BS 87- 52

LOCATION: Road-4+00North

<u>FOOTAGE</u>	<u>DETAILS</u>	<u>SAMPLE NO</u>	<u>LOCATION</u>	<u>AU ASSAY</u> <small>p.p.b. oz.</small>
0-4.0	Road bed			
4.0-13.0	Clay-grey colour			
13.0-34.0	Gravel-sand layers with large cobble - granitic/mafic volc. cobbles			
34.0	End of Hole to 5 cm. diam. - brown colour	24300	33.3-34.0	63

**GOLD HILL RESOURCES INC.**  
**SONIC OVERBURDEN DRILLING**

DATE DRILLED: June 26, 1987

HOLE NO: BS 87- 53

LOCATION: road-4+40North

<u>FOOTAGE</u>	<u>DETAILS</u>	<u>SAMPLE NO</u>	<u>LOCATION</u>	<u>AU ASSAY</u> <small>p.p.b. oz.</small>
0-4.5	Road Bed			
4.5-19.0	Clay			
19.0-34.5	Gravel-Sand layers- compact till fine gravel_ fine grey sand (cemented)			
34.5	End of Hole	24201	33.8-34.5	43

**GOLD HILL RESOURCES INC.**

**SONIC OVERBURDEN DRILLING**

DATE DRILLED: June 26, 1987

HOLE NO: BS 87-54

LOCATION: Road-4+80North

<u>FOOTAGE</u>	<u>DETAILS</u>	<u>SAMPLE NO</u>	<u>LOCATION</u>	<u>AU</u> <u>ASSAY</u> <u>p.p.b.</u> <u>oz.</u>
0-4.0	Humus-Organics			
4.0-19.0	Clay- +25% moisture content			
19.0-34.0	Gravel - Sand layers till with grey sand matrix - mafic volc./granodiorite			
34.0	Bedrock cobbles to 4 cm., cemented layers	24202	33.3-34.0	7



**GOLD HILL RESOURCES INC.**  
**SONIC OVERBURDEN DRILLING**

**DATE DRILLED:** June 26, 1987      **HOLE NO:** BS 87-55      **LOCATION:** Road-5+20North

FOOTAGE	DETAILS	SAMPLE NO	LOCATION	AU ASSAY <small>p.p.b. oz.</small>
0-6.0	Humus-Organics			
6.0-21.0	Clay			
21.0-29.0	Gravel-Sand layers finer and more compact at depth			
29.0	End of Hole  sample- coarse brown sand, with interlayers of fine grey sand/silt (cemented)	24203	28.3-29.0	21

**GOLD HILL RESOURCES INC.**  
**SONIC OVERBURDEN DRILLING**

DATE DRILLED: June 26, 1987

HOLE NO: BS 87- 56

LOCATION: Road-5+60North

<u>FOOTAGE</u>	<u>DETAILS</u>	<u>SAMPLE NO</u>	<u>LOCATION</u>	<u>AU ASSAY</u> <small>p.p.b. oz.</small>
0-6.0	Humus-Organics			
6.0-22.0	Clay- grey colour			
22.0-33.0	Gravel with sand layers			
	compact sand-silt layer at bottom - grey colour with syenite cobbles to 3 cm. diam.			
33.0	End of Hole	24204	32.6-33.0	55

**GOLD HILL RESOURCES INC.**  
**SONIC OVERBURDEN DRILLING**

DATE DRILLED:

June 26, 1987

HOLE NO: BS 87- 57

LOCATION: Road- 6+00North

<u>FOOTAGE</u>	<u>DETAILS</u>	<u>SAMPLE NO</u>	<u>LOCATION</u>	<u>AU ASSAY</u> <small>p.p.b. oz.</small>
0-4.0	Humus-Organics			
4.0-25.0	Clay			
25.0-25.5	Gravel-sand - fine sand -silt layers with mafic volcanic frag.			
25.5	Bedrock-Boulder? (to 1 cm. diam.)	24205	25.0-25.5	24

**GOLD HILL RESOURCES INC.**  
**SONIC OVERBURDEN DRILLING**

DATE DRILLED: June 26, 1987

HOLE NO: BS 87- 58

LOCATION: Road-6+40North

<u>FOOTAGE</u>	<u>DETAILS</u>	<u>SAMPLE NO</u>	<u>LOCATION</u>	<u>AU ASSAY</u> <small>p.p.b. oz.</small>
0-4.0	Humus-Organics			
4.0-23.0	Clay			
23.0-26.5	Silt-Clay with fine sand			
26.5	Boulder-Bedrock? - brown colour	24206	26.0-26.5	53



487 00 353 Min

Type of Survey(s) <b>BASAL TILL SURVEY</b>	Township or Area <b>Abbotsford &amp; Adair Twp.</b>
Claim Holder(s) <b>GOLD HILL RESOURCES INC.</b>	Prospector's Licence No. <b>T 1792</b>
Address <b>402-27 Queen Street East, Toronto, Ontario M5C 2M6</b>	
Survey Company <b>SONIC SOIL SAMPLING INC.</b>	Date of Survey (from & to) <b>10 06 87 26 06 87</b> Day Mo. Yr. Day Mo. Yr.
Name and Address of Author (of Geo-Technical report) <b>C. W. Archibald, 702-100 Adelaide St. West, Toronto, Ont. M5H 1S3</b>	

Credits Requested per Each Claim in Columns at right

Special Provisions	Geophysical	Days per Claim
For first survey: Enter 40 days. (This includes line cutting)	- Electromagnetic	
	- Magnetometer	
For each additional survey: using the same grid: Enter 20 days (for each)	- Radiometric	
	- Other	
	Geological	
	Geochemical	

Man Days	Geophysical	Days per Claim
Complete reverse side and enter total(s) here	- Electromagnetic	
	- Magnetometer	
	- Radiometric	
	Geological	
	Geochemical	

*Stamp: SEP 2 1987 9:40am*

Airborne Credits	Geophysical	Days per Claim
Note: Special provisions credits do not apply to Airborne Surveys.	Electromagnetic	
	Magnetometer	
	Radiometric	

Mining Claims Traversed (List in numerical sequence)

Mining Claim		Expend. Days Cr.	Mining Claim		Expend. Days Cr.
Prefix	Number		Prefix	Number	
	755061	10.5			
	755062	10.5			
	755063	9.3			
	737343	30.5			
	737344	49.1			
	737345	49.1			
	737346	49.1			
	737347	49.1			
	737348	50.5			
	737350	28.1			
	737351	49.1			
	737352	49.1			
	737353	49.1			
	737354	49.1			
	737355	49.1			
	737356	49.1			
	737357	49.1			
	737358	49.1			
	737359	49.1			
	737360	9.1			
	737361	29.1			
	737362	28.1			
	737363	10.5			

**RECEIVED**  
SEP 21 1987  
MINING LANDS SECTION

Expenditures (excludes power stripping)

Type of Work Performed  
**BASAL TILL SURVEY**

Performed on Claim(s)  
**755063, 737354, 737355, 737351, 737350**

Calculation of Expenditure Days Credits

Total Expenditures **\$ 12,818.58** ÷ Total Days Credits **15** = **854.5**

Instructions  
Total Days Credits may be apportioned at the claim holder's choice. Enter number of days credits per claim selected in columns at right.

Date **18 Aug '87** Recorded Holder or Agent (Signature) *C. W. Archibald*

Expenditure Days Credits

Total Days Credits Requested **854.5** Date Performed **Sept 2 1987** Mining Recorder *[Signature]*

**1987-09-30** *[Signature]*

Certification Verifying Report of Work

I hereby certify that I have a personal and intimate knowledge of the facts set forth in this Report of Work and have performed the same or witnessed same during and/or after its completion and the annexed report is true.

Name and Postal Address of Person Certifying  
**C. W. Archibald, 702-100 Adelaide St. West, Toronto, Ontario. M5H 1S3**

Date Certified **25 Aug '87** Certified by (Signature) *[Signature]*

23

Clive Twp. - M.450

THE TOWNSHIP OF

2.10320

ADAIR

DISTRICT OF COCHRANE

SEP 26 1988

LARDER LAKE MINING DIVISION

SCALE: 1-INCH = 40 CHAINS

LEGEND

- PATENTED LAND Ⓟ
- CROWN LAND SALE C.S.
- LEASES Ⓛ
- LOCATED LAND Loc.
- LICENSE OF OCCUPATION L.O.
- MINING RIGHTS ONLY M.R.O.
- SURFACE RIGHTS ONLY S.R.O.
- ROADS —
- IMPROVED ROADS —
- KING'S HIGHWAYS —
- RAILWAYS —
- POWER LINES —
- MARSH OR MUSKEG —
- MINES X
- CANCELLED C.

NOTES

400' Surface Rights Reservation around all lakes and rivers.

Areas withdrawn from staking under Section 43 of the Mining Act (R.S.O. 1970).

Order No. File Date Disposition

NR-4579	1982	271775	9-R.O.
Rescinded	R.O. 78164	March 9, 1984	9-R.O.

Abbotsford Twp. - M.400

QUEBEC OF PROVINCE

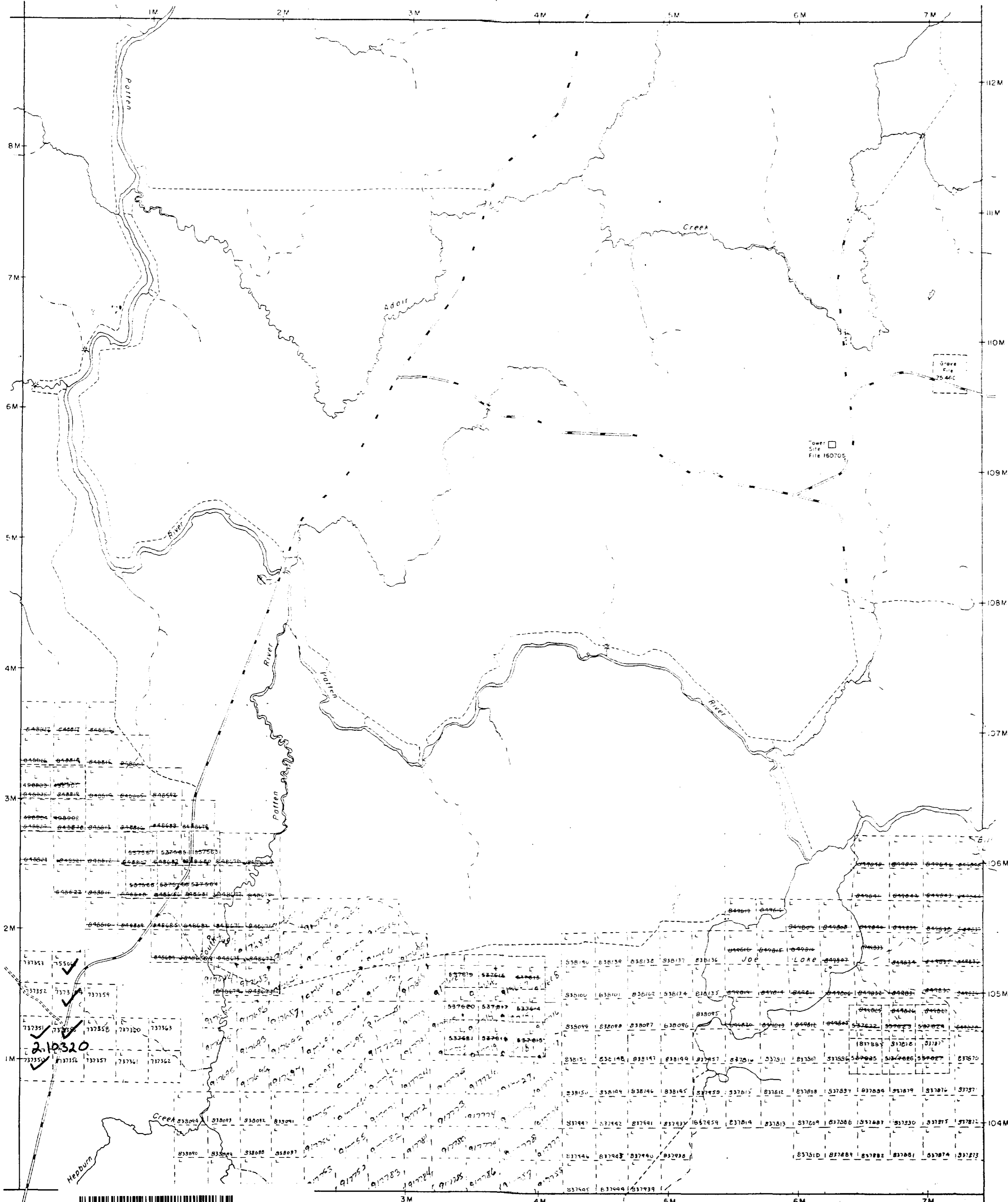

Hepburn Twp. - M.500

PLAN NO.- M.401

ONTARIO #2  
 MINISTRY OF NATURAL RESOURCES  
 SURVEYS AND MAPPING BRANCH



**LEGEND**

- Diamond drill hole
- Basal till hole
- 1 Mafic volcanics
- 2 Felsic volcanics
- 3 Diabase

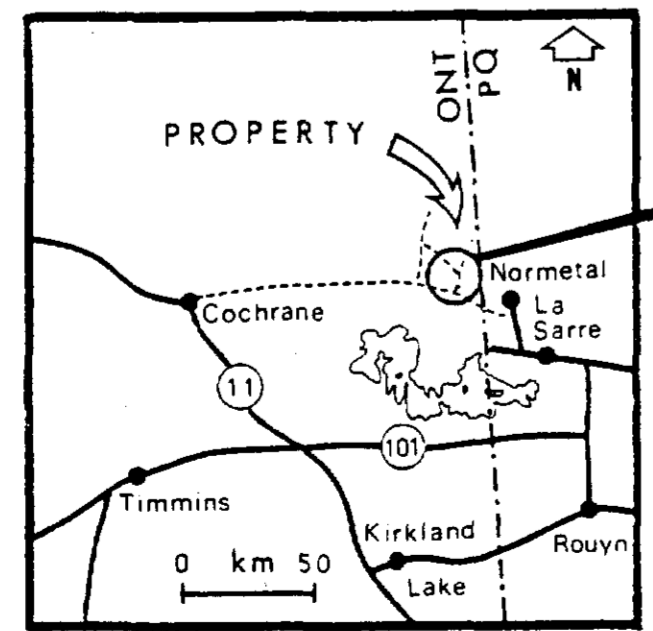
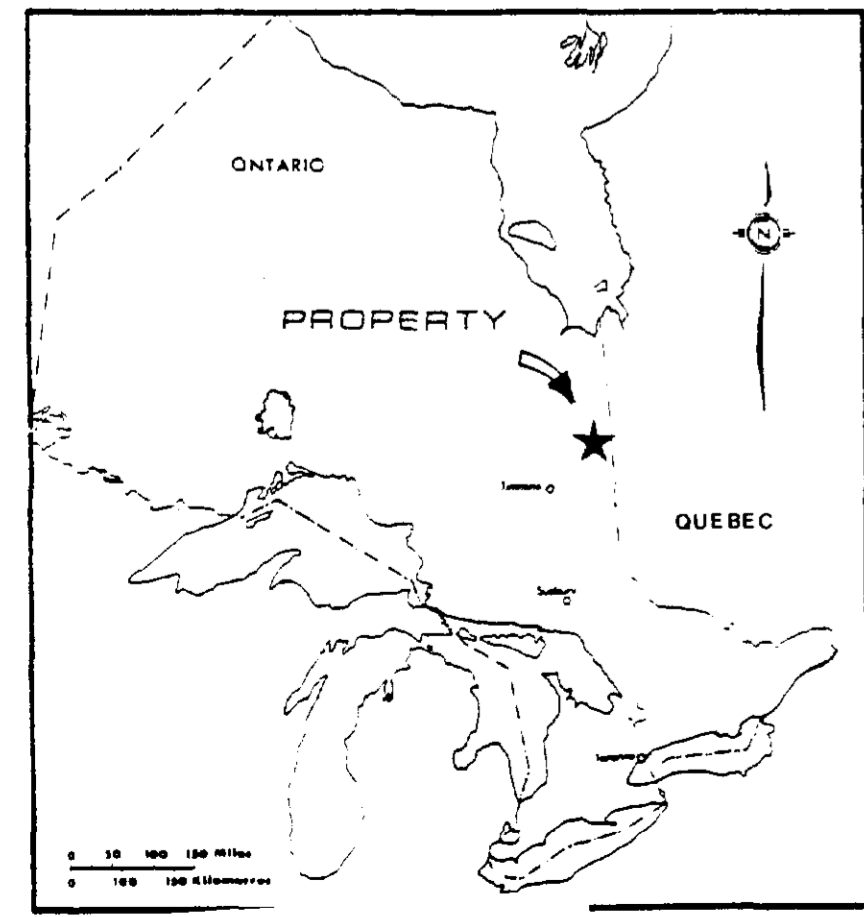
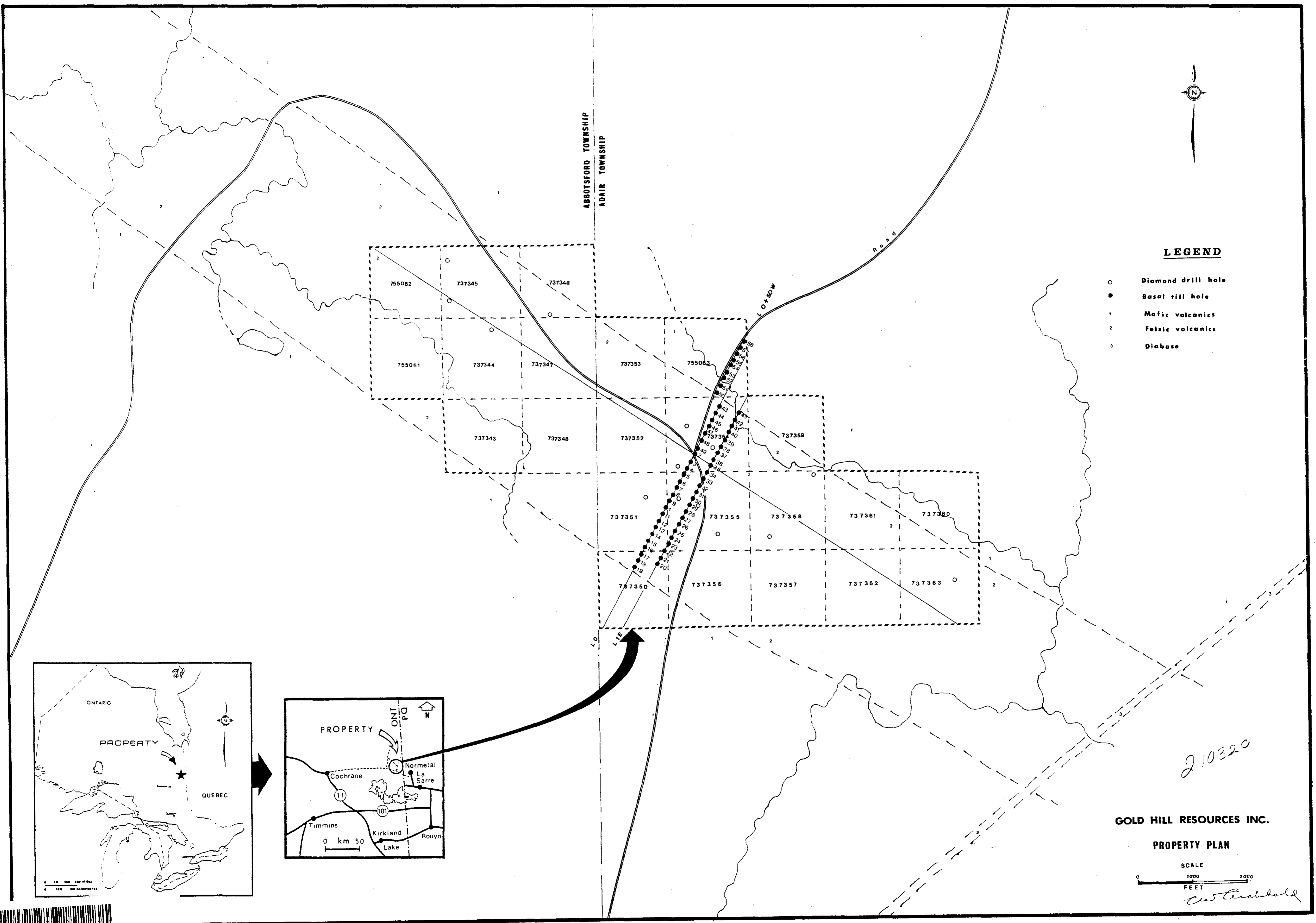

210320

**GOLD HILL RESOURCES INC.**

**PROPERTY PLAN**



*C. W. Caraballo*

