



32E04SE0019 10 ADAIR

010

# Diamond Drilling

Township of ADAIR

Report No: 10

Work performed by: ~~ADDAIR~~ CANADIAN JAVELIN LTD.

Claim No	Hole No	Footage	Date	Note
L 91745	# 1	294'	Aug/65	
L 92304	# 2	305'	Aug/65	
	# 4	277.5'	Aug/65	
L 91746	# 3	445'	Aug/65	
	# 7	650'	Aug-Sept/65	
	# 5	297'	Aug/65	
L 92305	# 6	303'	Aug/65	
L 91664	# 8	250'	Aug/65	(1)
	# 14	182'	Aug/65	(1)
L 92301	# 9	299'	Aug/65	(1)
L 91724	# 10	248'	Sept/65	
L 91723	# 11	185'	Sept/65	
L 91686	# 12	193'	Sept/65	
L 92300	# 13A	105'	Sept/65	(1)
	# 13B	205'	Sept/65	(1)

1500h.

4238.5'

Notes: (1) Located in Abbotsford Township.

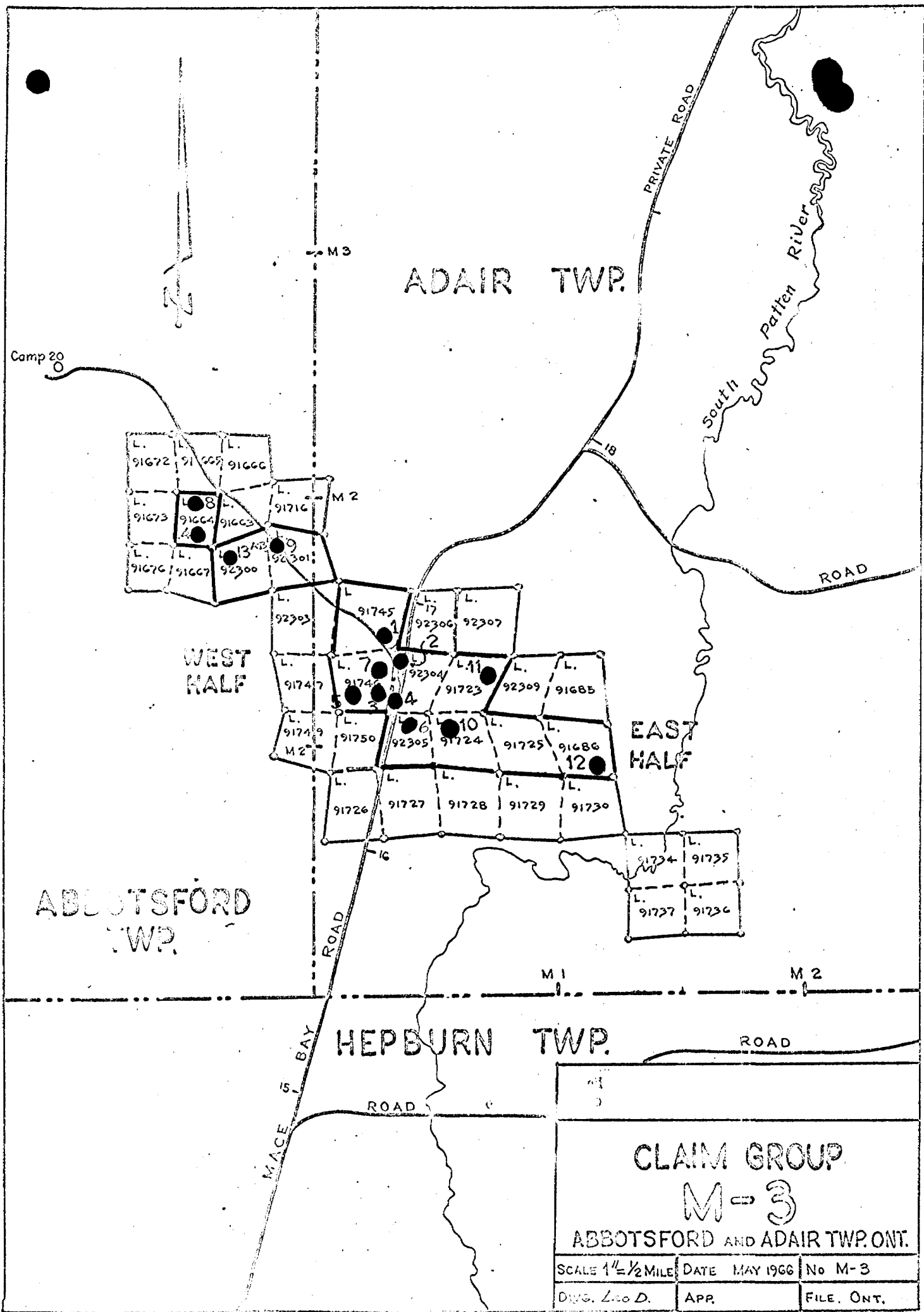

<b>CLAIM GROUP</b> <b>M-3</b> <b>ABBOTSFORD AND ADAIR TWP. ONT.</b>		
SCALE 1 1/2 MILE	DATE MAY 1966	NO M-3
DWG. L. & D.	APP.	FILE. ONT.

# D R I L L R E C O R D

Company: Jubilee-NALCO Mine Location: Adair Township, Ontario	Hole No: 1 Sheet No: 1				
Hole Location: Drilled By: Logged By:	Az. 220	Inclination 455 45S	Coords. 5+00W	Elevation 0+57N	<i>R. B. Brubaker</i>
Continental Diamond Drilling W.B., D.K.				Date: Aug 4-5, 1965 Date: Aug 8-27	

Size	Footage		Recovery		DESCRIPTION
	From	To	Feet	%	
BX	0	10			Overburden
AX	10	49		100	Poikiloblastic andesite, some biotite, feldspar porphyry 28-31, 47-49, epidote 31-35 and elsewhere in cracks. <sup>are</sup> Raw pyrite. Foliation 45°.
	49	85		100	Amphibolite, disseminated pyrite, quartz veinlets, some carbonate, locally fine-grained and chloritic, also locally quartzose.
	85	95		100	Poikiloblastic andesite, gneissic
	95	98.5		100	Amphibolite, fine grained
	98.5	109		100	Tuffs, porphyritic feldspar to 101, very fine grained 106-109, carbonate in cracks.
	109	129		100	Garnet amphibolite, locally fine grained, locally pyrrhotiferous & graphitic.
	129	130		100	Massive, fine grained pyrrhotite and chert.
	130	132.5		100	Chert, some quartz and epidote.
	132.5	142.5		100	Tuff, rare pyrite
	142.5	148		100	Pyrrhotite, some pyrite in tuff which looks like cement, sulfides in bands, contorted.



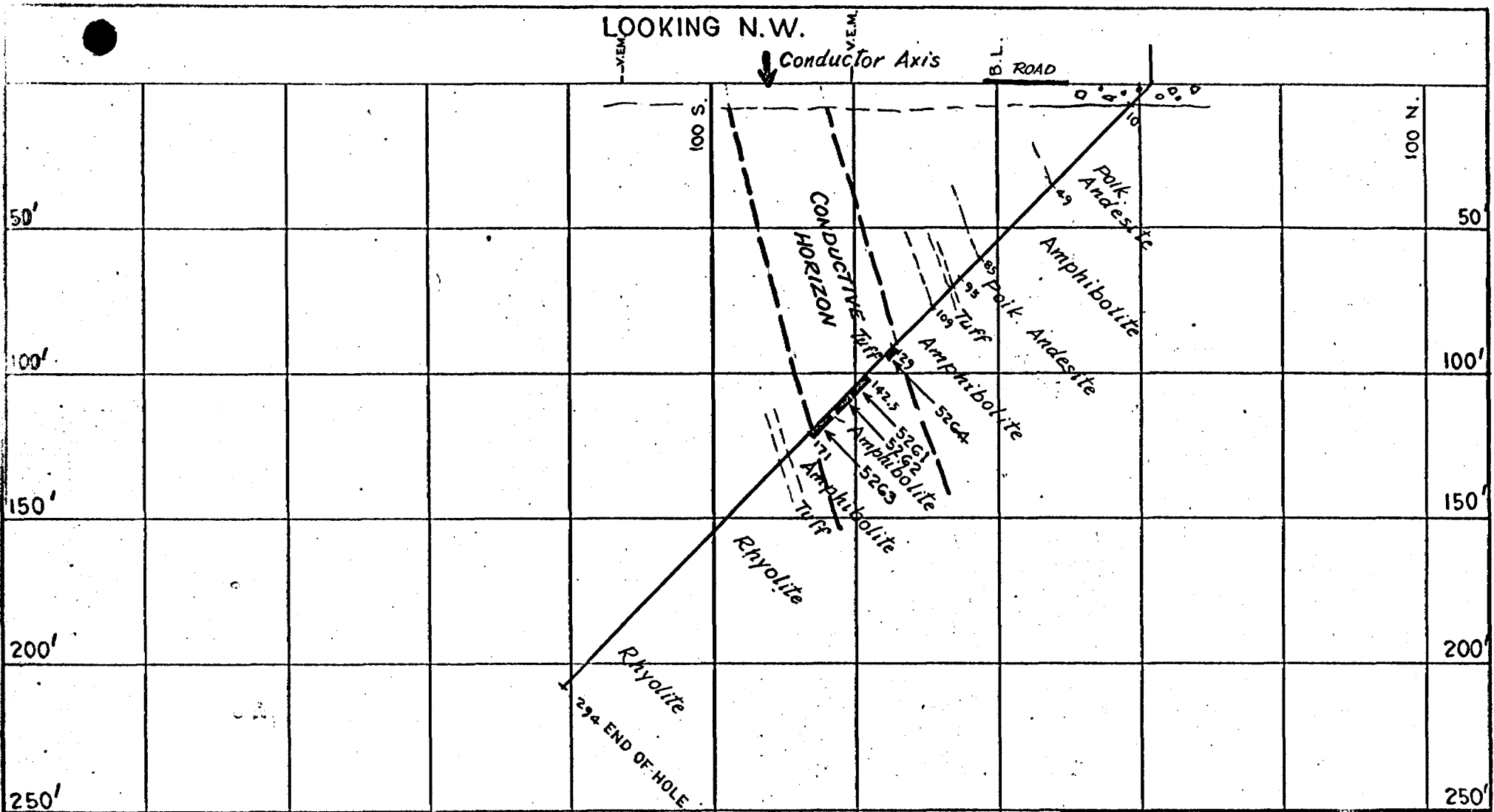

Depth	Samples	Au.	Ag.	Cu.	Zn.	Ni.	Pb.
143-152	5261	Nil	Trace	.02	None	None	-
152-158.5	5262	-	Nil	None	"	"	-
163-171	5263	-	"	"	"	"	-
128.5-131	5264	-	"	"	"	"	-

**JAVELIN - JUBILEE**

**JOE LAKE AREA**

**ZONE 3 D.D.H # 1**

5+00 N.W.    0+55 N.E    DIP 45° SW.

SCALE 1" = 50'	DATE: MAY 1966	NO.
DWG. L.E.D.	APP. <i>Bunker</i>	FILE



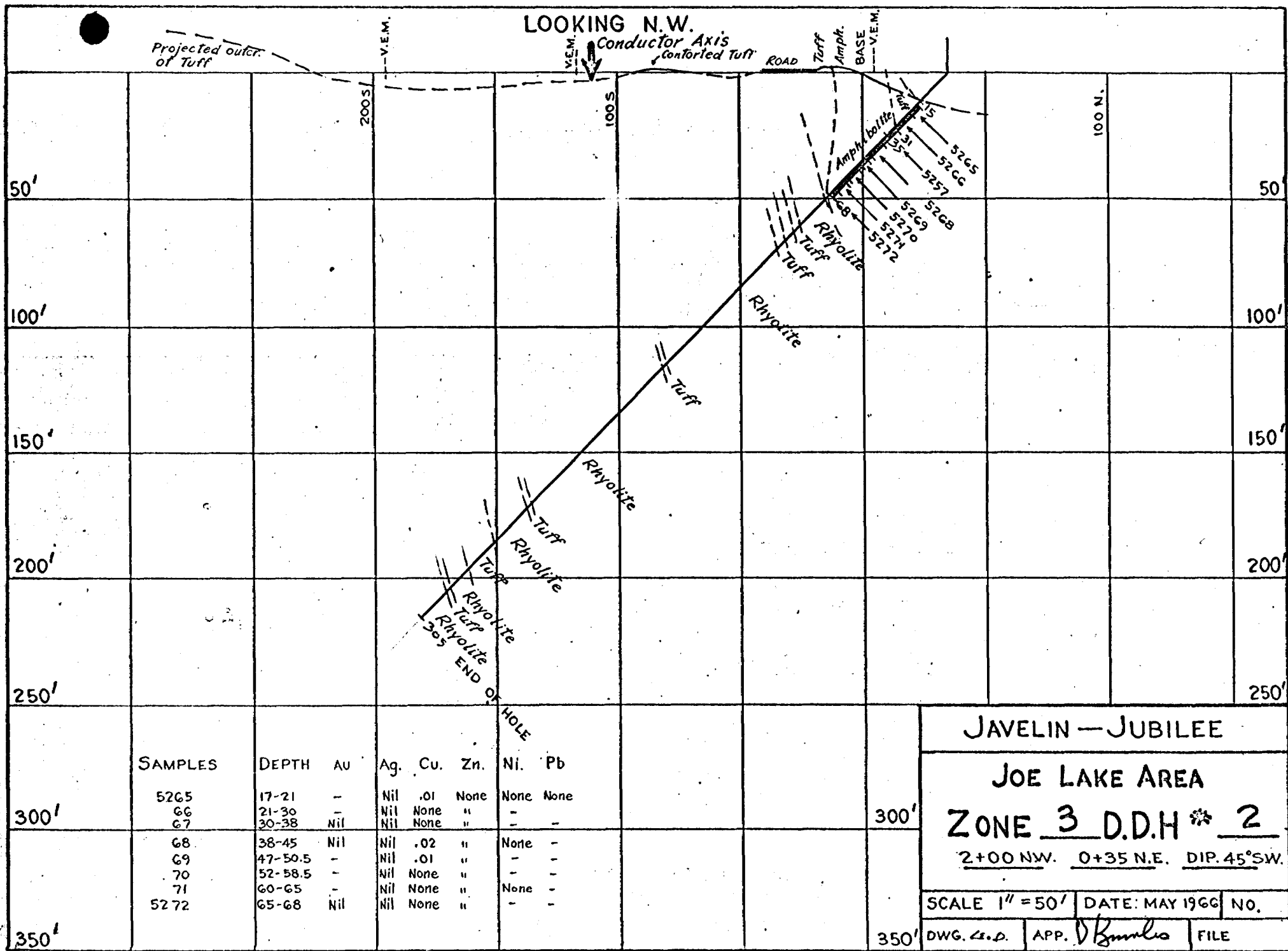

D R I L L   R E C O R D

Company:	Jubilee-NALCO	Hole No: 3
Mine		Sheet No: 1
Mine Location:	Adair Township, Ontario.	

Hole Location:	Az.	Inclination	Coords.	Elevation	<i>D. Blakeman</i>
Drilled By:	040	45° N	2+00W	9+45S	
Logged By:	Continental			Date: Aug 6-13/65	
	Wm. Blakeman			Date: Aug 14-	

Size	Footage		Recovery		DESCRIPTION
	From	To	Feet	%	
BX	0	8			Overburden
AX	8	121.5		100	Tuff, thin banded, thickest 6", contorted, numerous quartz veins, chloritized shears locally - possible rhyolite bed 56-58.5, and 80-82.5. Locally with garnet and visible hornblend.
	121.5	131.5		"	Pyrrhotized mud and tuff bands, contorted, nearly aphanitic, graphitic, chloritic & pyritic shear 125-128, brecciated & biotitic 128.5-131.5, also chert bands. Sampled 121.5-124.5, 125.5-131.5.
	131.5	249		"	Tuff, variably banded with hornblend horizons, occasional garnets, altered shears rare. Included thick banded horizons may be rhyolite.
	249	290		"	Garnetiferous rhyolite, some tuff interbeds, also amphibolite horizons.
	290	298		"	Banded, pyrrhotite-pyrite seams in amphibolite. Sampled 290-295.
	298	310		"	As above, with with garnets, sampled 289-310
	310	313.5		"	Tuff & chert beds, chert brecciated, sampled 311-313.5
	313.5	321.5		"	Banded amphibolitic tuff, well mineralized with pyrrhotiferous mud bands



D R I L L   R E C O R D

Company: Jubilee-NALCO  
 Mine Location: Adair Township, Ontario.

Hole No: 3  
 Sheet No: 2

Hole Location:	Az.	Inclination	Coords.	Elevation
Drilled By:				Date:
Logged By:				Date:

Size	Footage		Recovery		DESCRIPTION
	From	To	Feet	%	
					sampled 314-321.5
	321.5	331		100	Brecciated chert, pyrite-pyrrhotite in cracks, sampled.
	331	343.5		"	Amphibolitic tuff, mineralized, chert and brecciated below 332. Sampled.
	343.5	353		"	Banded amphibolitic tuff, some garnets, moderate sulfide mineralization, sampled.
	353	357		"	Very siliceous banded & amphibolitic tuff, contorted and mineralized with pyrrhotite. Sampled.
	357	376		"	Mineralized amphibolite, garnets, sheared & contorted, core angle variable 0-20°. Some graphite. Sampled.
	376	385		" ;	Banded siliceous tuff and usual mud-like pyrrhotite bands. Sampled.
	385	392.5		"	Rhyolite, some garnets
	392.5	405.5		"	Tuff - garnets & amphibolite. Banded pyrrhotite contorted. Sampled.
	405.5	430		"	Garnetiferous amphibolite, mineralization weak to absent, some tuff interbeds.
	430	445		"	Rhyolite, dark & fine grained, massive.
		EOH			Acid tests and lists 300, 42° - 430, 42°

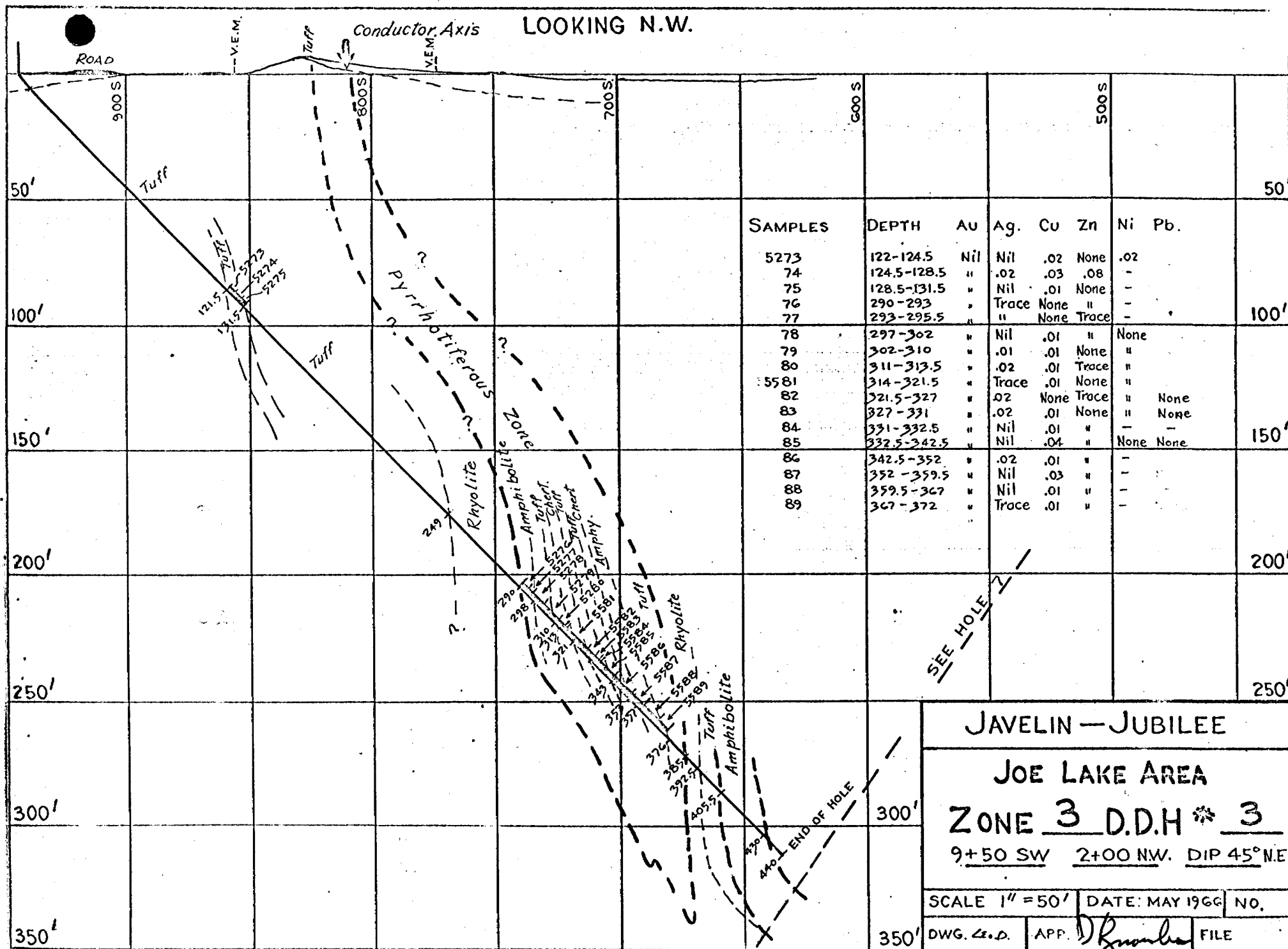

SEE HOLE 7

JAVELIN - JUBILEE

JOE LAKE AREA

ZONE 3 D.D.H \* 3

9+50 SW 2+00 NW. DIP 45° NE.

SCALE 1" = 50' DATE: MAY 1966 NO.

DWG. C.E.D. APP. *D. Brumbaugh* FILE

D R I L L   R E C O R D

Company: Jubilee-NALCO  
 Mine Location: Adair Township, Ontario.

Hole No: 4  
 Sheet No: 1

Hole Location:	Az. 220	Inclination 45°S	Coords. 2+00E	Elevation 7+30S
Drilled By:	Continental D. D.			Date: Aug 11-13/65
Logged By:	WBB and D. K.			Date: Aug 14-26

*D. Knowles*

Size	Footage		Recovery		DESCRIPTION
	From	To	Feet	%	
BX	0	22			Overburden
AX	22	78		100	Rhyolite, weakly foliated, banded, visible hornblende locally, rare feldspar, phenocryst, also rare garnets.
	78	97		"	Mineralized tuffs, bands of pyrrhotized silt, gradually becoming coarser grained, bands of chert and amphibolite bands, locally contorted.
					Sampled 78 to <del>89.5</del> <sup>49.5</sup> . Local graphite.
	97	120		"	Amphibolite with contorted chert & pyrrhotiferous mud bands a few inches thick at 102, 107-109, 113, 117.
	120	170		"	Garnetiferous amphibolite, garnets stop at 135. Amphibole content decreases.
	170	277.5		"	Rhyolite, amphibolitic, massive, local amphibolite layers, garnet rare, poikiloblastic below 230.
		EOH			

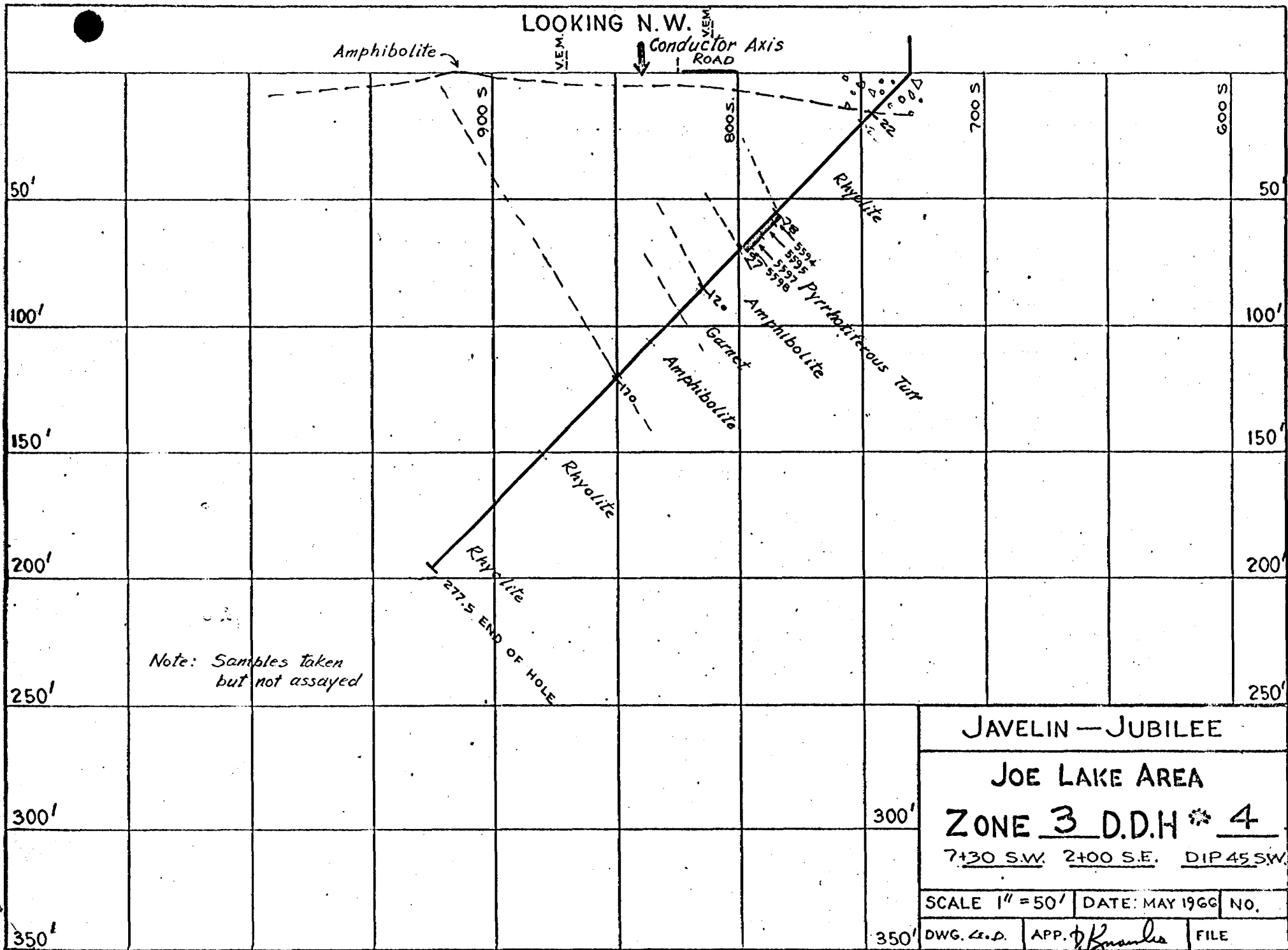

JAVELIN — JUBILEE

JOE LAKE AREA

ZONE 3 D.D.H \* 4

7+30 S.W. 2+00 S.E. DIP 45 SW.

SCALE 1" = 50' | DATE: MAY 1966 | NO.

DWG. G.D. | APP. *[Signature]* | FILE

D R I L L   R E C O R D

Company: Jubilee-NALCO  
 Mine:  
 Mine location: Adair Township, Ontario.

Hole No: 5  
 Sheet No: 1

Hole Location:	Az.	Inclination	Coords.	Elevation
Drilled By:	040	45°	5+00W	10+25S
Logged By:	Continental T.F. and D. K.			Date: Aug. 11-16/65 Date: Aug 18-19, 26

*D. Knowles*

Size	Footage		Recovery		DESCRIPTION
	From	To 1	Feet	%	
BX	0	21			Overburden
AX	21	117		100	Rhyolite, foliation 45°, greenish color, some hornblend phenocrysts and quartzose layers.
	117	144		"	Hornblend gneiss, gradational from above by increase of grain size. Pyrrhotite seam at 137.
	144	152		"	Amphibolite and pyrrhotiferous mudstone layers. Some garnet.
	152	155		"	Mudstone, weakly banded, aphanitic, some pyrrhotite bearing seams but no massive sulfides as in other holes. Sampled.
	155	169		"	Acid volcanics, aphanitic, hard, conchoidal fractures. Some hornblend.
	169	214		"	Tuff, thickly (6"-2') banded, rare feldspar phenocrysts, some garnet, rare pyrrhotite.
	214	280		"	Massive rhyolite, weakly foliated, rare garnet, C. A. 45° - occasional zones show feldspar phenocrysts. Hornblend erratically distributed.
	280	297 EOH		"	As above, but got several cherty layers

LOOKING N.W.

ROAD CONDUCTOR AXIS

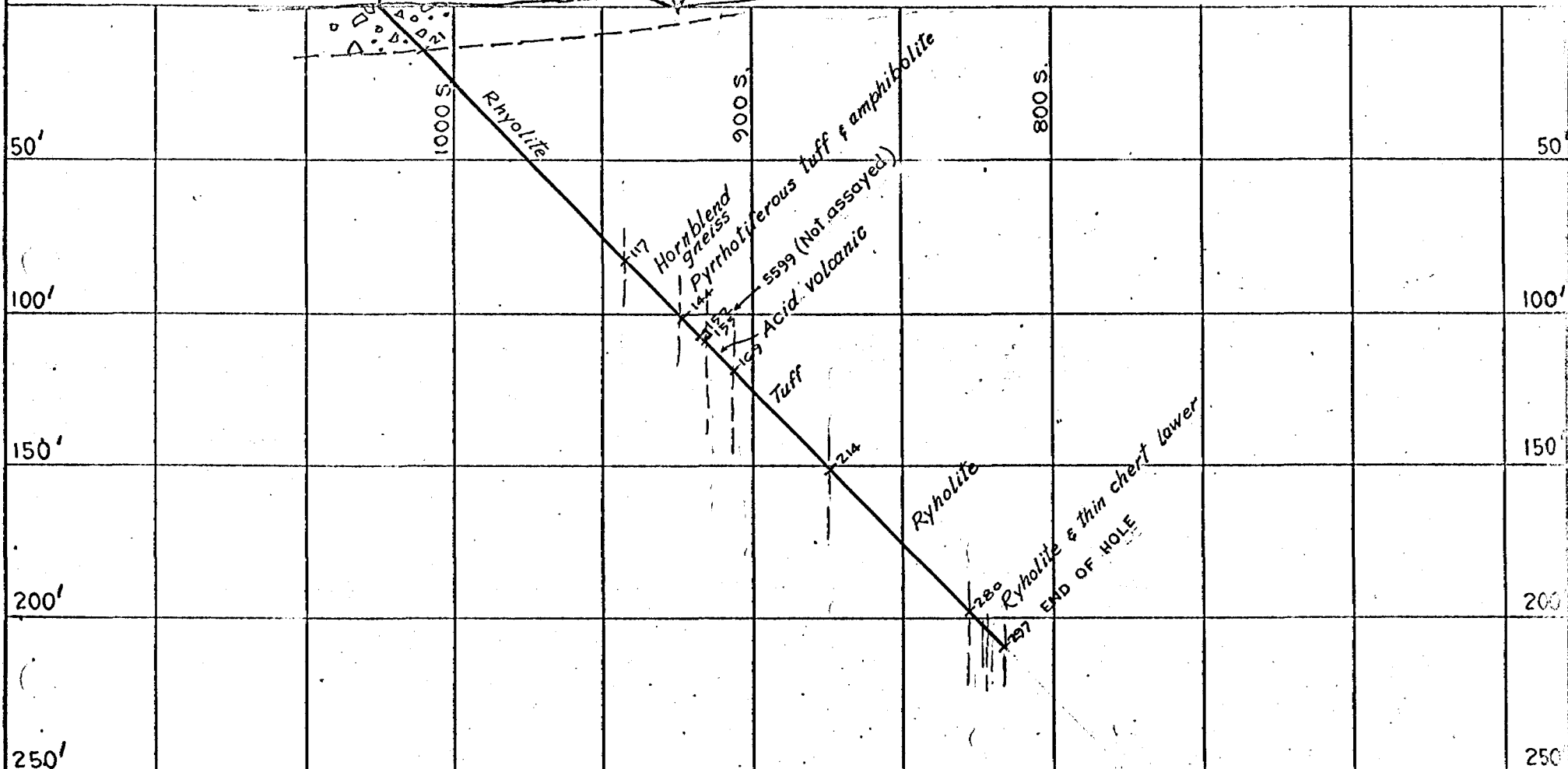

JAVELIN — JUBILEE

JOE LAKE AREA

ZONE 3 D.D.H # 5

G+00 E. G.65 S. DIP 45 N.E.

SCALE 1" = 50' DATE: MAY 1966 NO.

DWG. G.S.D. APP. D. Knowles FILE

## D R I L L   R E C O R D

Company: Jubilee-NALCO	Hole No: 6
Mine Location: Adair Township, Ontario	Sheet No: 1

Hole Location:	Az.	Inclination	Coords.	Elevation	<i>D. Knowles</i>
	220	45° S	600E	6+65S	
	Drilled By:	Continental		Date: Aug 11-16/65	
Logged By:	T. F. and D. K.		Date: Aug 18-19, 26		

Size	Footage		Recovery		DESCRIPTION
	From	To	Feet	%	
BX	0	22			Overburden
AX	22	129		100	Rhyolite, massive, weakly foliated @ 45°, rare garnet, some hornblend phenocrysts, rare cherty layers
	129	132		"	Chert, with weak pyrrhotite mineralization
	132	151		"	Rhyolite, siliceous locally, garnets
	151	158		"	Contorted, banded, fine grained, pyrrhotiferous mud and chert bands, fractures filled with coarse grained pyrrhotite. Same as other holes.
	158	173		"	Rhyolite, some garnet, rare pyrrhotite
	173	303		"	Hornblende gneiss, some garnet, a few sections 2-4 ft thick of amphibolite.
		EOH			CA 40-50° Pyrrhotite in breccia zone 255-260.





D R I L L   R E C O R D

Company:	Jubilee-NALCO	Hole No:	7
Mine Location:	Adair Township, Ontario	Sheet No:	1
Hole Location: Drilled By: Logged By:	Az.	Inclination	Coords.
	220	<del>45°S</del> 55°S	2+00W
	Elevation	4+00S	
	Continental Knowles		Date: Aug 19-27/65 Date: Sept. 26

D. Knowles

Size	Footage		Recovery		DESCRIPTION
	From	To 1	Feet	%	
BX	0	24			Overburden
AX	24	73		100	Rhyolite, massive, some garnet, locally with hornblend phenocrysts. CA 20° above 49, changes to 0° around 70 - grades into below
	73	90		"	Hornblende gneiss, garnets, foliated 30°
	90	118		"	Rhyolite, very massive, aphanitic. Feldspar porphyry 101-106, 111-118 Amphibole appears 106-111.
	118	190		"	Rhyolite, scattered feldspar & hornblend phenocrysts, some garnet below 130.
	190	214		"	Hornblend gneiss, local amphibolite horizons, rare garnet
	214	216		"	Flaw surface, irregular textures
	216	266		"	Rhyolite, massive, occasional banding, some garnets. Flaw surface 255-260.
	266	287		"	Rhyolite, but banded dark & light colored, some garnetiferous amphibolite seams.
	287	362		"	Rhyolite, feldspar phenocrysts, no garnets or hornblende phenocrysts, very massive.
	362	386		"	Intermixed rhyolite and amphibolite, some weak pyrrhotite in amphibolite



LOOKING N.W.

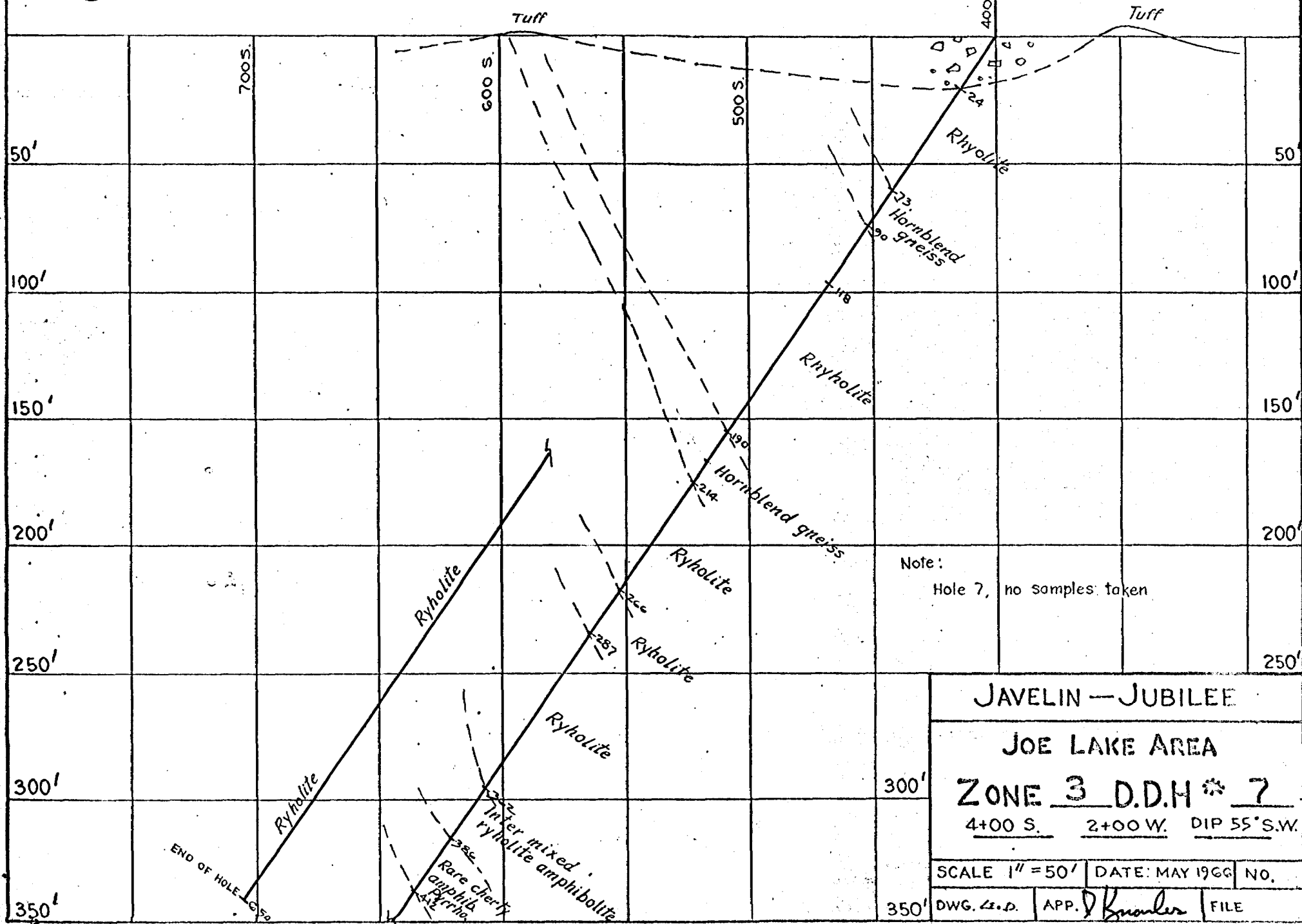

JAVELIN — JUBILEE

JOE LAKE AREA

ZONE 3 D.D.H. # 7

4+00 S. 2+00 W. DIP 55° S.W.

SCALE 1" = 50' | DATE: MAY 1966 | NO.

DWG. G.D. | APP. *J. Knauer* | FILE



LOOKING N.W.

HEM. CONDUCTOR AXIS VEM.

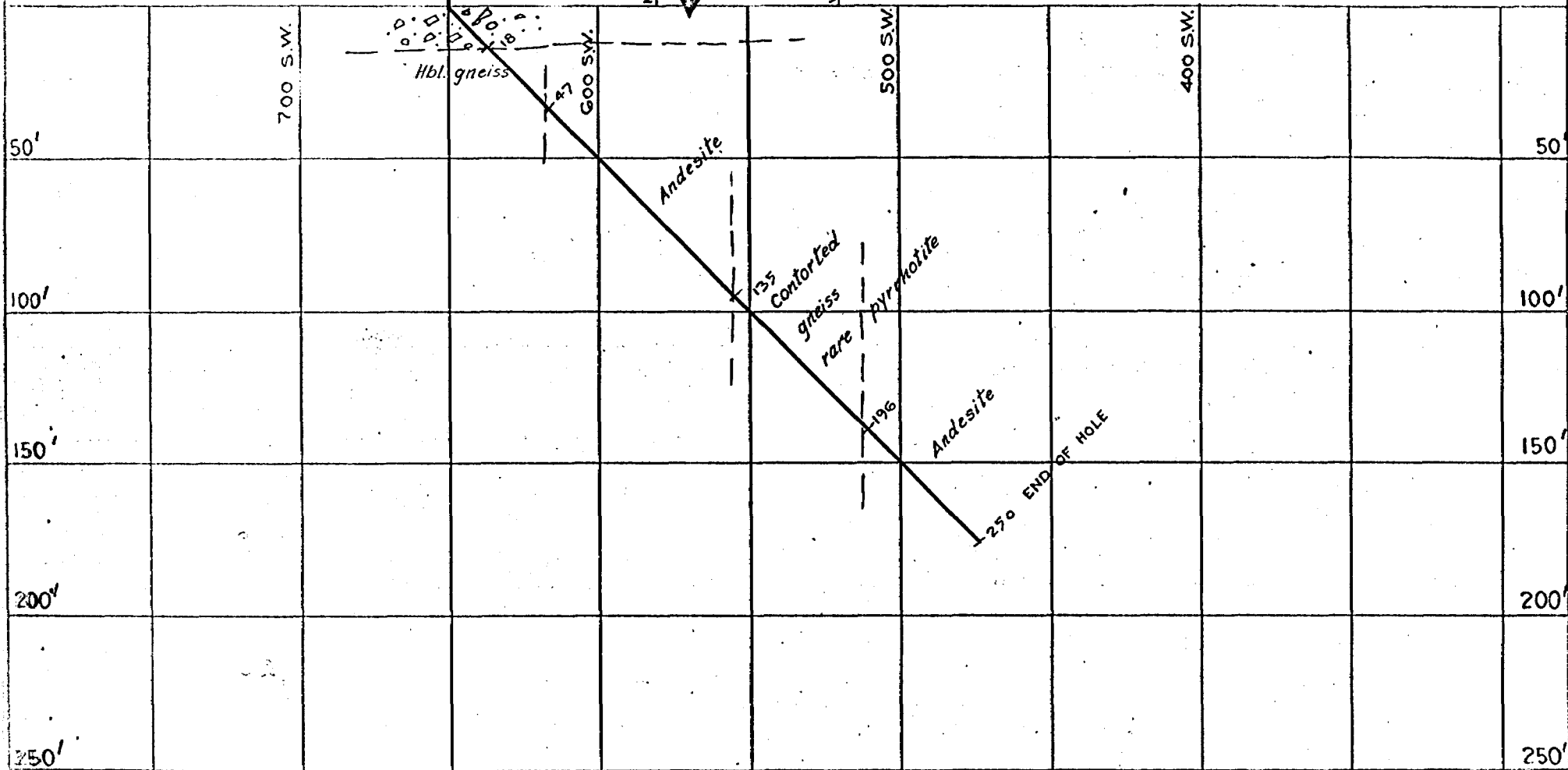

JAVELIN - JUBILEE

JOE LAKE AREA

ZONE 1 D.D.H \* 8

16+00 NW. G+50 S.W. DIP 45° N.E.

SCALE 1" = 50' | DATE: MAY 1966 | NO.

350' DWG. G.E.D. | APP. D. K. [Signature] | FILE



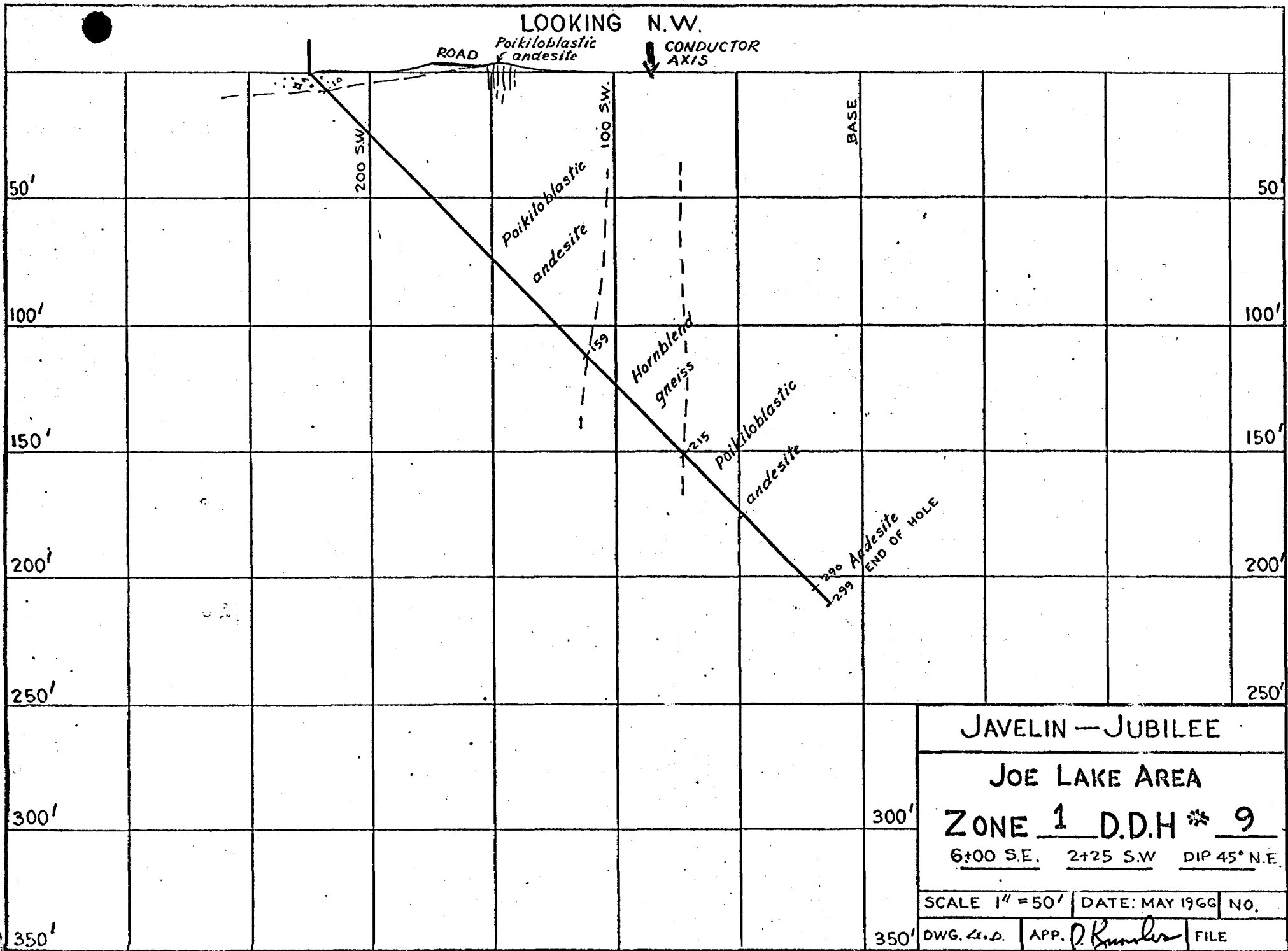

JAVELIN — JUBILEE

JOE LAKE AREA

ZONE 1 D.D.H \* 9

6+00 S.E.    2+25 S.W    DIP 45° N.E.

SCALE 1" = 50'    DATE: MAY 1966    NO.

350' DWG. *Lee D.*    APP. *D. Bunker*    FILE

D R I L L   R E C O R D

Company: Jubilee-NALCO	Hole No: 10				
Mine Location: Adair Township, Ontario	Sheet No: 1				
Hole Location:	Az. 230	Inclination 45 SW	Coords. 18+00 SE	Elevation 5+20SW	<i>D. Knowles</i>
Drilled By:	Continental			Date: Sept. 1-3/65	
Logged By:	D. Knowles			Date: Sept 26/65	

Size	Footage		Recovery		DESCRIPTION
	From	To	Feet	%	
BX	0	27			Overburden
	27	39		100	Amphibolitic rhyolite, foliated, 45°
	39	43		"	Garnet, biotite hornblende gneiss
	43	127		"	Rhyolite, amphibolitic sections, garnets present below 95, pyrrhotite present
					126-127
	127	160		"	Amphibolitic rhyolite, garnets with amphibole sections 129-134, 142-147,
					158-160. Massive pyrrhotite in 1-2" seams 158-160.
	160	176.5		"	Rhyolite, some garnets and amphibole porphyry, foliation 45°
	176.5	182		"	Cherty mudstone, contorted, a little disseminated pyrrhotite, plus a 1" seam
					of solid pyrrhotite at 176.5.
	182	200		"	Massive hornblend gneiss, foliation 45° gradational from above section.
	200	224		"	Hornblend gneiss, but hornblend content and grain size gradually decreases to:
	224	248		"	Amphibolitic rhyolite - 6 inch quartz seam at 226.
		EOH			



LOOKING N.W.

CONDUCTOR AXIS ↓

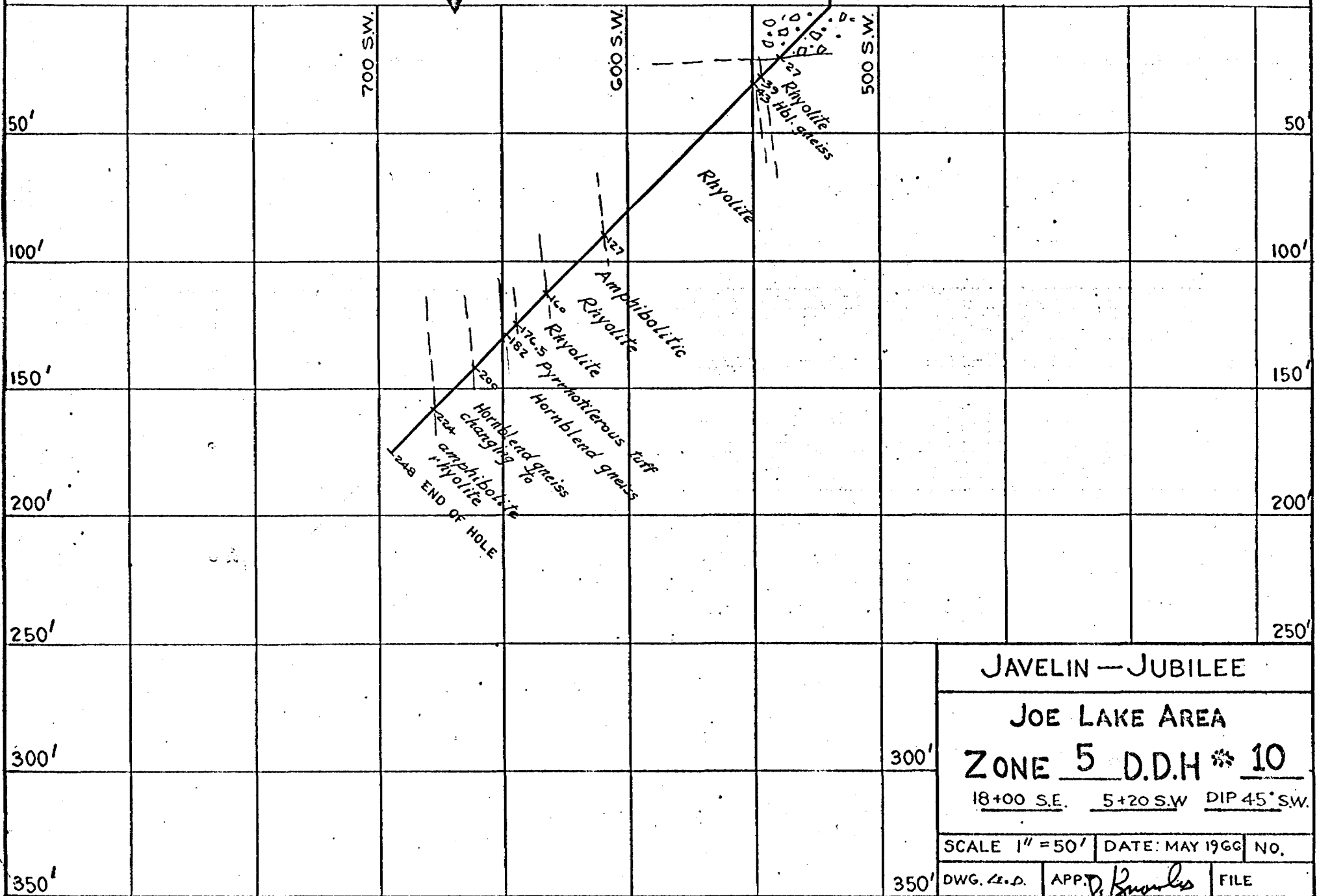

JAVELIN — JUBILEE

JOE LAKE AREA

ZONE 5 D.D.H # 10

18+00 S.E. 5+20 S.W DIP 45° SW.

SCALE 1" = 50' | DATE: MAY 1966 | NO.

DWG. *L.S.D.* | APP. *D. Knowles* | FILE

D R I L L   R E C O R D

Company:	Jubilee-NALCO	Hole No:	11
Mine		Sheet No:	1
Mine Location:	Adair Township, Ontario.		
Hole Location:	Az.	Inclination	Coords.
Drilled By:	230	45 SW	18+00 SE
Logged By:	Continental D. Knowles		Elevation 7+50NE
		Date: Sept 7-9/65	<i>D/K Knowles</i>
		Date: Sep 27/65	

Size	Footage		Recovery		DESCRIPTION
	From	To	Feet	%	
BX	0	37			Overburden
AX	37	63		100	Rhyolite, amphibolitic, weak foliation 45°, rare garnet; graphitic, chloritic shear 56-58.
	63	84		"	Amphibolite, garnetiferous, foliation 45°
	84	101		"	Rhyolite, some hornblende & garnets below 90
	101	148		"	Amphibolite, coarse & with garnet below 105. Pyrrhotiferous 101-105, occasional pyrrhotite stringers rest of section. Grades into next section.
	148	160		"	Andesite, some visible hornblende, foliation 45°
	160	182		"	Andesite, brecciated, graphitic & chloritic with a little pyrite and pyrrhotite. Chlorite-graphite decrease & pyrrhotite increases below 170 to about 40% sulfides.
	182	185		"	Andesite, massive.
		EOH			

LOOKING N.W.

CONDUCTOR AXIS

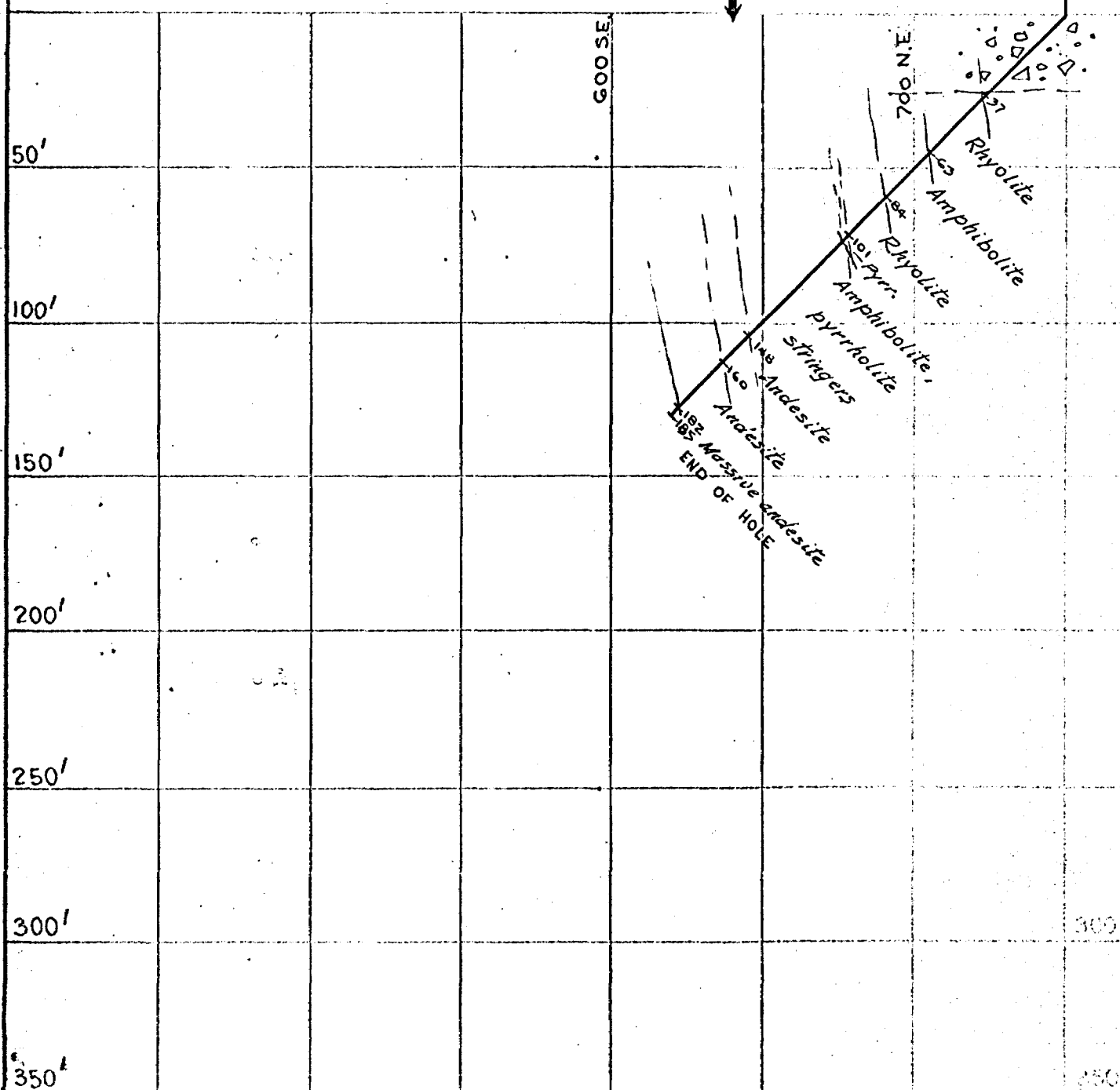

SECTION 4, T11N, R18E, S4E  
18+00 S.E. 7+50 N.E. DIP 45° SW.

D. K. ...



LOOKING N.W.

CONDUCTOR AXIS  
↓

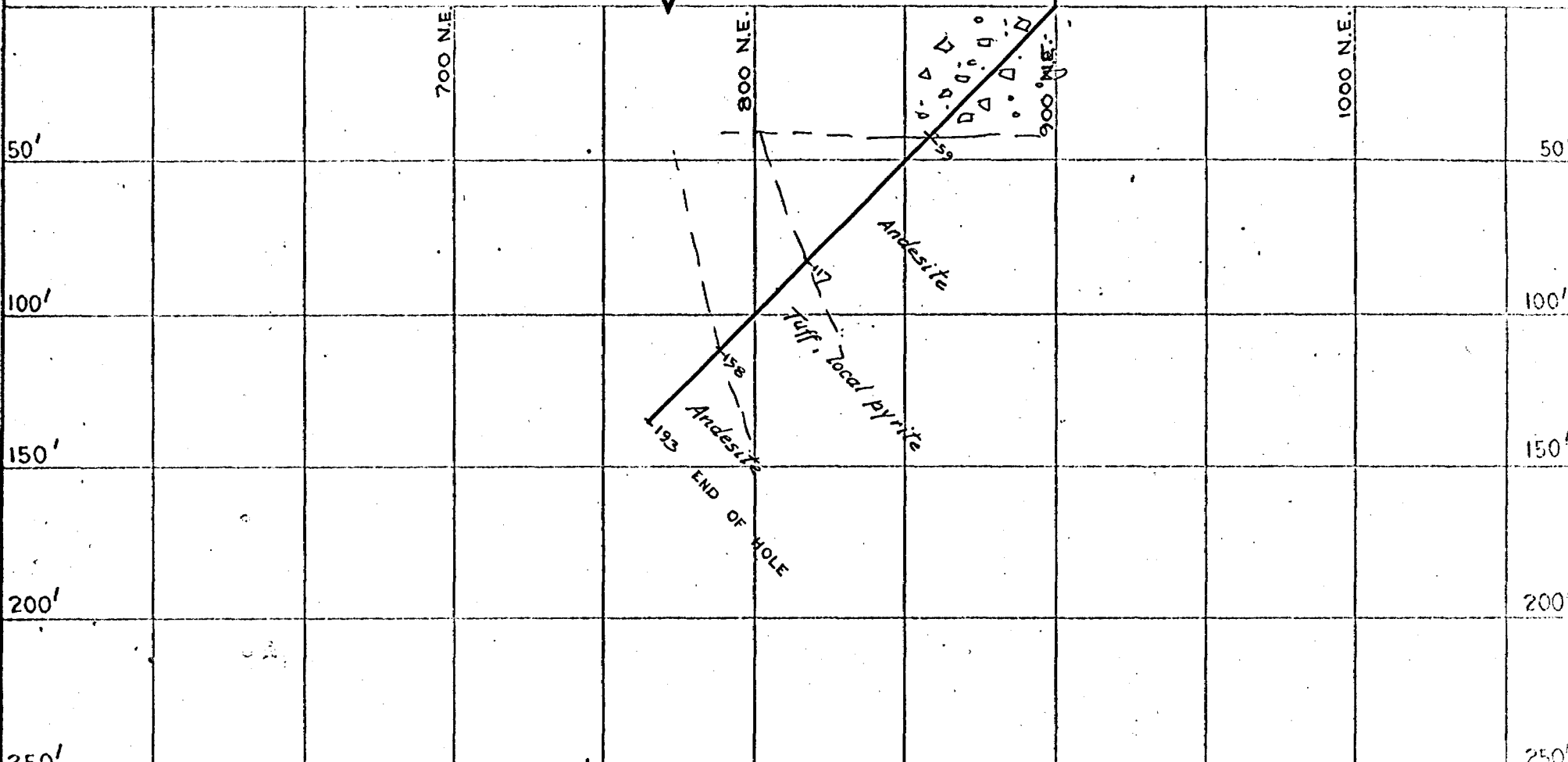

JAVELIN --- JUBILEE

JOE LAKE AREA

ZONE 6 D.D.H. # 12

46+00 S.E. 9+00 N.E. DIP 45° S.W.

SCALE 1" = 50' DATE: MAY 1966 NO.

DWG. G.D. APP. *D. Knauer* FILE





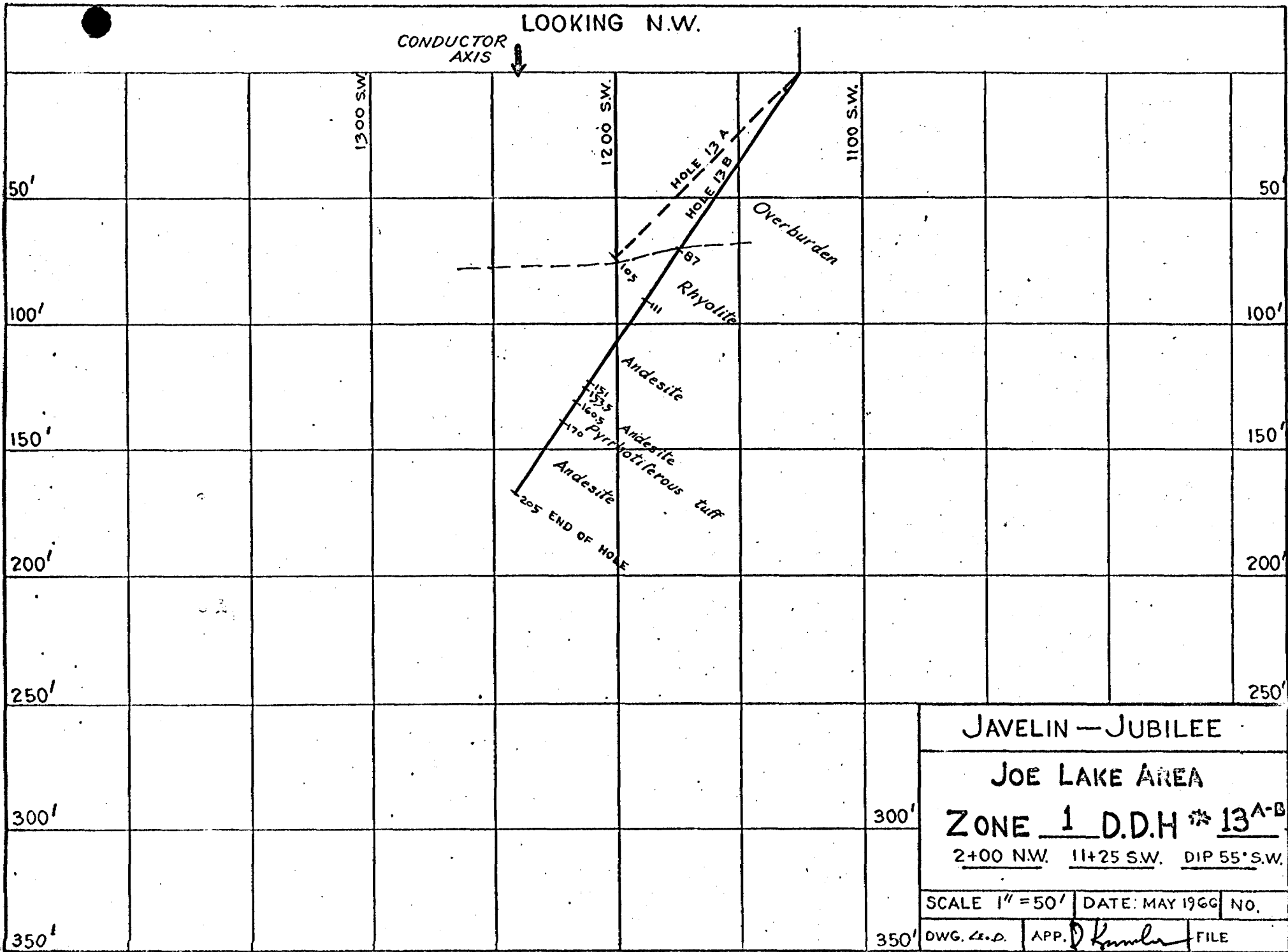



# D R I L L   R E C O R D

Company: Jubilee-NALCO  
 Mine Location: Abbotsford Township, Ontario.

Hole No: 14  
 Sheet No:

Hole Location:	Az. 230	Inclination 55SW	Coords. 9 + 30NW	Elevation 11 + 25 SW
Drilled By:	Continental D. D.			Date: Sep 28-30/65
Logged By:	Peter LaRush			Date: Oct 12/65

Size	Footage		Recovery		DESCRIPTION
	From	To	Feet	%	
NX	0	22			Overburden
AX	22	41 <del>41</del>		100	Andesite, light & darker color bands, chloritized fractures in a few places.
					Quartz porphyry 37-41. Occasional garnets.
	41	84		"	Andesite, uniform except for occasional garnet zones.
	84	116		"	Andesite, occasional light colored siliceous sections, rare garnet
	116	124½		"	Andesite, with quartz phenocrysts 119½-124½
	124½	145		"	<i>Rhyolite</i> <del>Darker andesite</del> , some garnets
	145	152		"	<i>Tuff</i> <del>Andesite</del> , with heavy pyrrhotite replacement
	152	155		"	Andesite, disseminated pyrrhotite, garnet
	155	182		"	Andesite, quartz porphyritic at 173-178
		EOH			

LOOKING N.W.

CONDUCTOR  
AXIS

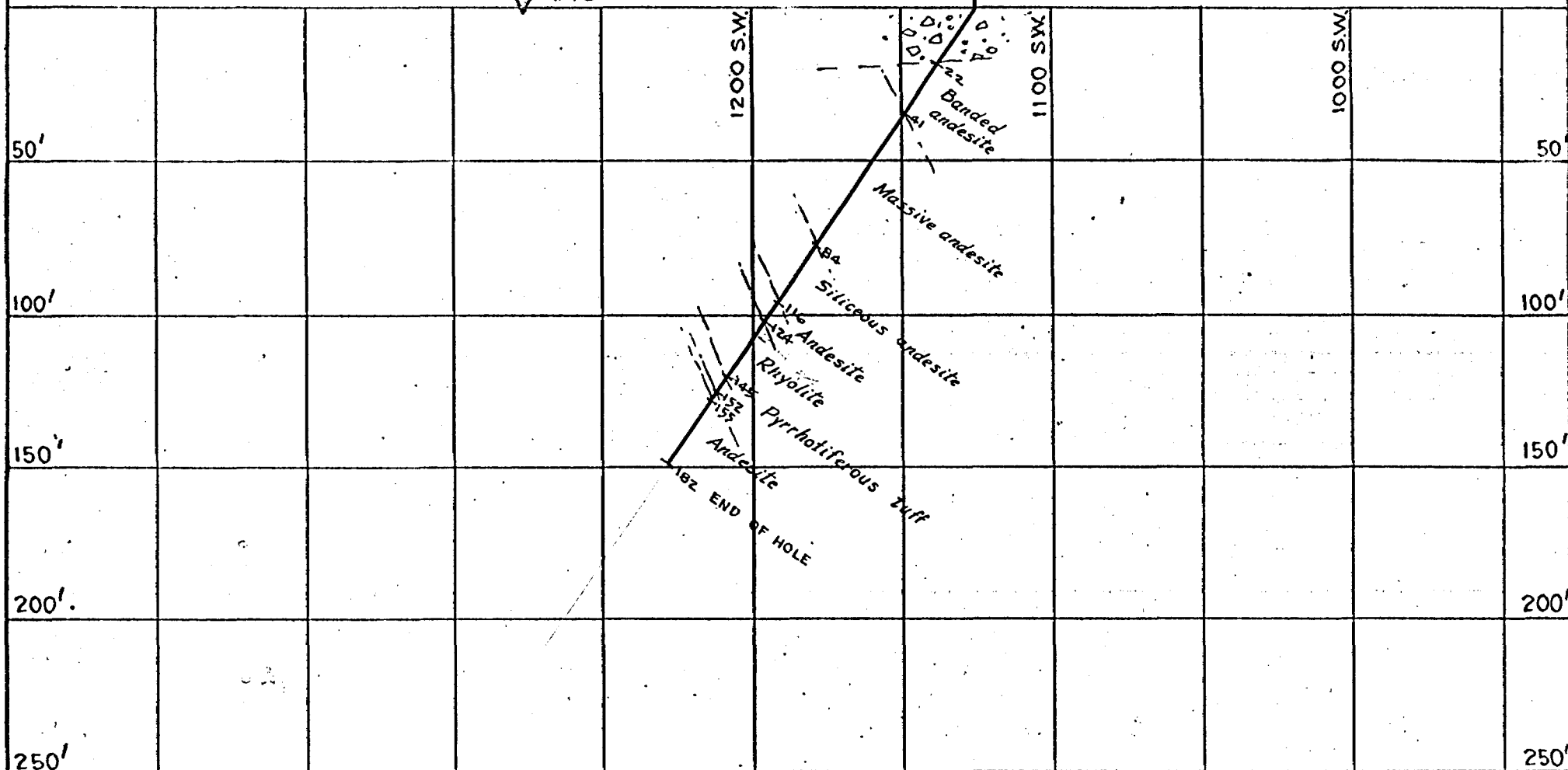

JAVELIN — JUBILEE

JOE LAKE AREA

ZONE 1 D.D.H # 14

10+00 N.W. 11+25 S.W. DIP 55° S.W.

SCALE 1" = 50' DATE: MAY 1966 NO.

DWG. G.E.D. APP. *D. Knowles* FILE



32E045E0019 10 ADAIR

900

required for each type of work to be recorded.

ONTARIO

THE MINING ACT REPORT OF WORK

To the Recorder of LARDER LAKE Mining Division

CANADIAN JAVELIN LTD.

A-37225

name of Recorded Holder 100 BRONSON AVE OTTAWA ONT SUITE 1201

Miner's Licence

Post Office Address

do hereby report the performance of 2722 days of Diamond Drilling type of work

not before reported to be applied on the following contiguous claims

Table with 6 columns: Claim No., Days, Claim No., Days, Claim No., Days. Contains claim numbers L-91663 to L-91672 and L-91750 to L-91666 with handwritten checkmarks and '151' in the days column.

All the work was performed on Mining Claim (s) L-91664, L-91750, L-91745, L-91746, L-92300, L-92301 (In the case of geological and/or geophysical survey (s) where more than 18 claims are involved attach a schedule)

READ CAREFULLY: THE FOLLOWING INFORMATION IS REQUIRED BY THE MINING RECORDER.

- For Manual Work, Stripping or Opening up of Mines, Sinking Shafts or Other Actual Mining Operations - Names and addresses of the men who performed the work and the dates and hours of their employment.
For Diamond and other Core Drilling - Footage, No. and angle of holes and diameter of core. Name and address of owner or operator of drill. Dates when drilling was done. Signed core log and sketch in duplicate.
For Compressed Air or Other Power Driven or Mechanical Equipment
Type of drill or equipment. Names and addresses of men engaged in operating equipment and the dates and hours of their employment.
For Power Stripping - Type of equipment. Name and address of owner or operator. Amount expended. Dates on which work was done. Proof of actual cost must be submitted within 30 days of recording.
With each of the above types of work sketches are required to show the location and extent of the work in relation to the nearest claim post. In the case of diamond or other core drilling the sketch must be submitted in duplicate.
For Geological and Geophysical Survey - The names and addresses of men employed as well as dates. Type of instrument used in the case of geophysical survey. Reports and maps in duplicate must be filed with the Minister within 60 days of recording.
For Land Survey - the name and address of Ontario Land surveyor.

The Required Information is as Follows: (Attach a list if this space is insufficient)

Table with 2 columns: DDH # and Footage. Lists DDH #1 to #14 with footages from 294' to 182'. Includes handwritten notes: 'All drilling is AX core', 'Contractor - Continental Diamond Drilling Co., Ltd. Rouyn P.Q.', and 'For remainder of the required information see drill logs and sketch'.

Date June 10 1966. Signature of David M. Knowles, Agent for Canadian Javelin Ltd.

The Mining Act Certificate Verifying Report of Work

I, David M. Knowles, R.R. #2, Manotick, Ont. (Post Office Address)

hereby certify:

- 1. That I have a personal and intimate knowledge of the facts set forth in the report of work annexed hereto, having performed the work or witnessed same during and/or after its completion.
2. That the annexed report is true.

Dated June 10 1966. Signature of David M. Knowles.

RECORDED JUN 19 1966 REC. No.

THE PENALTY FOR MAKING A FALSE STATEMENT IN THIS REPORT AND/OR CERTIFICATE IS \$500. OR SIX MONTHS IMPRISONMENT OR BOTH



ONTARIO

THE MINING ACT REPORT OF WORK

A separate form is required for each type of work to be recorded.

To the Recorder of LARDER LAKE Mining Division
CANADIAN JAVELIN LTD. name of Recorded Holder A-37225 Miner's Licence

1000 BURNHAM AVE. Oshawa Ont. Post Office Address

do hereby report the performance of 15 1/2 days of Diamond Drilling type of work

not before reported to be applied on the following contiguous claims

Table with 6 columns: Claim No., Days, Claim No., Days, Claim No., Days. Lists claims L-91685 to L-91726 and L-92304 to L-92309 with days and checkmarks.

All the work was performed on Mining Claim (s) L-91686, L-91723, L-91724, L-92304 (In the case of geological and/or geophysical survey (s) where more than 18 claims are involved attach a schedule)

READ CAREFULLY: THE FOLLOWING INFORMATION IS REQUIRED BY THE MINING RECORDER.

- For Manual Work, Stripping or Opening up of Mines, Sinking Shafts or Other Actual Mining Operations - Names and addresses of the men who performed the work and the dates and hours of their employment.
For Diamond and other Core Drilling - Footage, No. and angle of holes and diameter of core. Name and address of owner or operator of drill. Dates when drilling was done. Signed core log and sketch in duplicate.
For Compressed Air or Other Power Driven or Mechanical Equipment
Type of drill or equipment. Names and addresses of men engaged in operating equipment and the dates and hours of their employment.
For Power Stripping - Type of equipment. Name and address of owner or operator. Amount expended. Dates on which work was done. Proof of actual cost must be submitted within 30 days of recording.
With each of the above types of work sketches are required to show the location and extent of the work in relation to the nearest claim post. In the case of diamond or other core drilling the sketch must be submitted in duplicate.
For Geological and Geophysical Survey - The names and addresses of men employed as well as dates. Type of instrument used in the case of geophysical survey. Reports and maps in duplicate must be filed with the Minister within 60 days of recording.
For Land Survey - the name and address of Ontario Land surveyor.

The Required Information is as Follows: (Attach a list if this space is insufficient)

DDH # 2 305' All drilling is AX core.
#4 278' Contractor - Continental Diamond Drilling Co.
#6 303' Ltd., Rouyn P.Q.
#10 248
#11 185 For additional information see logs
#12 193 and sketches. David M Knowles
1512'

Date June 18 1966 Signature of Recorded Holder or Agent David M Knowles FOR CANADIAN JAVELIN LTD

The Mining Act Certificate Verifying Report of Work

I, David M Knowles
P.O. # 2 MANOTICK Ont. (Post Office Address)

- hereby certify:
1. That I have a personal and intimate knowledge of the facts set forth in the report of work annexed hereto, having performed the work or witnessed same during and/or after its completion.
2. That the annexed report is true.

Dated June 18 1966 Signature David M Knowles

RECORDED JUN 29 1966 REC. No.

THE PENALTY FOR MAKING A FALSE STATEMENT IN THIS REPORT AND/OR CERTIFICATE IS \$500. OR SIX MONTHS IMPRISONMENT OR BOTH

Assessment Work Breakdown

- 1. Type of Survey Diamond Drilling
- 2. Township or Area ADAIR TWP. ABITIBI EAST
- 3. Mining claim numbers L-91685, L-91686, L-91723, L-91724, L-91725, L-91726, L-91727, L-91728, L-91729, L-91730, L-91735, L-91736, L-91737, L-92304, L-92305, L-92307, L-92309.
- 4. Number of miles of line cut
- \* 5. Type of instrument used CANADIAN LONGEAR AX SIDE DRILL
- \* 6. Scale constant or sensitivity
- \* 7. Number of <sup>holes</sup> stations established 6 holes for a total of 1512'
- 8. Summary of days worked ( details on reverse side )
  - Total technical (include consultants, draughting etc.)
  - Total line-cutting
  - Total man-days ( technical plus line-cutting ) 1512' x Monday/foot = 1512 md
  - Assessment days credit per claim  $\frac{1512}{18} = 84$  mandays/claim

9: Dated June 10/66 Signed David M Knowles  
David M Knowles

\* Complete only if applicable

Complete list of names, addresses and dates on reverse side

Use for one type of survey only

Assessment Work Breakdown

1. Technical

<u>Type of Work</u>	<u>Name &amp; Address</u>	<u>Dates Worked</u>	<u>Hours</u>	<u>Days</u>
<b>Totals</b>				

Consultants

<u>Name &amp; Address</u>	<u>Dates Worked (specify in field or office)</u>	<u>Hours</u>	<u>Days</u>
Continental Diamond Drilling Co. Ltd. Rayon P.Q.	1512' AX (1" ) x 1 md/foot = 1512 mandays		
<b>Totals</b>			1512'

Draughtsman, Typing, others (specify)

<u>Name &amp; Address</u>	<u>Type of Work</u>	<u>Dates Worked</u>	<u>Hours</u>	<u>Days</u>
L. DESROCHERS 109 Urenmount Dr. Ottawa	Draughtsman			
M. NELSON 238 Summerset Ottawa	Typing			
<b>Totals</b>				

2. Line-Cutting

<u>Name</u>	<u>Address</u>	<u>Dates Worked</u>	<u>Hours</u>	<u>Days</u>
<b>Totals</b>				

D