



32E13NE0050 2.6255 LOWER DETOUR LAKE

010

Westmin Resources Limited
Horizontal Loop Electromagnetic Survey
Nash Creek Claims
Lower Detour Lake Area (M2603)
Porcupine Mining District

N.T.S. 32 E13

Latitude 49°54'N

Longitude 79°31'W

by

C. J. Rockingham, B.Sc., M.Sc.
Project Geologist

January 5, 1984.

RECEIVED

JAN 10 1984

MINING LANDS SECTION

2.6255 010

Introduction:

The following report pertains to Max-Min II (H.L.E.M.) survey data collected by Phantom Geophysics on behalf of Westmin Resources. The claims are located in the Porcupine Mining District, Lower Detour Lake area (M2603). The survey was carried out on a previously established picket line grid in late February and early March of 1982.

Property, Location and Access:

The Nash Creek claim block is located in the Detour Lake area of the Abitibi greenstone belt on the Ontario-Quebec boundary at latitude $49^{\circ}54'$. This is approximately 135 km NNE of Cochrane and a similar distance NNW of La Sarre. Access is available all year round by fixed wing or helicopter from either town. In the winter the property is also accessible via diamond drill roads from the winter road to the Detour Lake gold mine a distance of approximately 20 km.

Property Status:

Equity: Westmin Resources Limited 100%
Location: Lower Detour Lake M2603
Latitude: 49°54'N
Longitude: 79°31'W
NTS 32 E13

Ontario (27 claims)

Claims	Due Date
P.575669-575671 (3)	July 21, 1986
P.553627-553635 (9)	Jan. 4, 1985
P.553642-553651 (10)	Jan. 4, 1985
P.553658-553662 (5)	Jan. 4, 1985

Grid Details, Instrument and Survey Specifications:

In order to facilitate the geophysical surveys a picket line grid was established with an east-west baseline and north-south grid lines every 120 m and pickets at 25 m intervals along the grid lines. The total length of grid lines surveyed was 23.2 km.

An Apex Parametrics Max-Min II survey (Horizontal Loop Electromagnetic Survey) was carried out to measure the in-phase and out-of-phase components of the vertical magnetic field as a percentage of the horizontal primary field. The resolution of these components was $\pm 1/2\%$. All readings were taken with a 150 m coil separation and stations at 25 m intervals using three frequencies namely 222 Hz, 888 Hz and 3555 Hz. For clarity only one frequency is presented on the plan map although the interpretation of the data is based on all three frequencies.

Results and Interpretation:

Two distinct conductors are indicated by the survey data. The more northerly one is the weaker and occurs on three survey lines, 3+60W, 5+25N to 6+00W, 5+75N. The conductivity thickness product is only three mhos, the dip is near vertical and the depth estimate is less than 70 metres. The strongest conductor has a poor expression at 9+60W, 5+30S and a much stronger expression at 10+80W, 5+00S. The EM response to this conductor gradually decreases towards the west with the last clearly recognizable response on line 14+40W at 3+75S. The conductivity thickness product is 75 - 100 mhos, the dip is 50-60°S and the depth to

the top of the conductor approximately 25 meters on line 10+80W. Other weaker responses on the property require more detailed work in order to be properly evaluated as to the nature of the conductive response.

Summary of Expenditures:

Rechaining grid	23.225 km @ \$75/km	=	\$ 1,741.88
Max-Min Survey	23.225 km @ \$150/km	=	\$ 3,483.75
Data Interpretation, J. Betz - 1 day @ \$440/day		=	\$ 440.00
Report writing, administration, drafting, filing of assessment		=	\$ 1,000.00
			<u>\$ 6,665.63</u>

Certification

I, Christopher J. Rockingham, of 261 Booth Avenue, Toronto, Ontario, certify the following facts:

- 1) I am a Fellow of the Geological Association of Canada.
- 2) I hold a B.Sc. in Chemistry and Biology obtained from the University of Toronto in 1972 and a M.Sc. in Geology obtained from the University of Western Ontario in 1979.
- 3) I have practised my profession for 9 years, working in Canada, Australia and Southern Africa.
- 4) I have supervised the work and interpreted the results mentioned in the foregoing report.
- 5) I have no financial interest in this property.

January 6, 1984.

Christopher J. Rockingham



32E13NE0050 2.6255 LOWER DETOUR LAKE

900

Ministry of Natural Resources

Notification of recording of assessment work credits

Lands Administration Branch Mining Lands Section Ministry of Natural Resources Room 1617, Whitney Block Queen's Park, Toronto M7A 1W3

RECEIVED

JAN 30 1984

MINING LANDS DIVISION

Date of recording of work: Dec 1, 1983

Recorded holder: Westman Resources Limited

Address: 25 Adelaide St East, Suite 1400 Toronto, Ont M5C 1Y2

Township or Area: Lower Detour Area

Table with 2 columns: Type of survey and number of Assessment days credit per claim, Mining claims. Includes rows for Geophysical (Electromagnetic, Magnetometer, Radiometric, Induced polarization, Section 7719), Geological, and Geochemical. Includes checkboxes for Man days, Airborne, Special provision, and Ground.

Notice to recorded holder:

- Survey reports and maps in duplicate be submitted to the Lands Administration Branch, Toronto within 60 days from the date of recording of this work.
Reports and maps are being forwarded to the Lands Administration Branch with this letter.

Handwritten signature and stamp: Mining recorder Mining Recorder c.c. Westman Resources Limited



Ministry of Natural Resources Ontario

395/83

Lower Detour Area

A separate form is required for each type of work to be recorded.

THE MINING ACT REPORT OF WORK

To the Recorder of Porcupine Mining Division Westmin Resources Limited T-778

name of Recorded Holder 25 Adelaide St. East, Suite 1400, Toronto, Ontario

Prospector's Licence M5C 1Y2 do hereby report the performance of 445 days of Geophysical (EM) Electromagnetic (ground) type of work

not before reported to be applied on the following contiguous claims

Table with 6 columns: Claim No., Days, Claim No., Days, Claim No., Days. Lists claims P.553627, P.553628-630(3), P.553632-635(4), P.553642-645(4), P.553648-651(4), P.553658-661(4) and P.575669, P.575670, P.575671. Includes note: FOR DETAILS SEE ATTACHED SCHEDULE "A"

All the work was performed on Mining Claim (s) All claims listed in Schedule "A" (In the case of geological and/or geophysical survey (s) where more than 18 claims are involved attach a schedule)

READ CAREFULLY: THE FOLLOWING INFORMATION IS REQUIRED BY THE MINING RECORDER.

- For Manual Work, Stripping or Opening up of Mines, Sinking Shafts or Other Actual Mining Operations - Names and addresses of the men who performed the work and the dates and hours of their employment.
For Diamond and other Core Drilling - Footage, No. and angle of holes and diameter of core. Name and address of owner or operator of drill. Dates when drilling was done. Signed core log and sketch in duplicate.
For Compressed Air or Other Power Driven or Mechanical Equipment
Type of drill or equipment. Names and addresses of men engaged in operating equipment and the dates and hours of their employment.
For Power Stripping - Type of equipment. Name and address of owner or operator. Amount expended. Dates on which work was done. Proof of actual cost must be submitted within 30 days of recording.
With each of the above types of work sketches are required to show the location and extent of the work in relation to the nearest claim post. In the case of diamond or other core drilling the sketch must be submitted in duplicate.
For Geophysical, Geological, Geochemical Surveys and Expenditure Credits - the name of author of report. Covering dates of survey (linecutting & office). Type of instrument used. Total amount of expenditure. Technical reports, maps, expenditure breakdown, receipts must be filed in duplicate with the Minister within 60 days of recording.
For Land Survey - the name and address of Ontario Land surveyor.

The Required Information is as Follows: (Attach a list if this space is insufficient)

Author of the report: C.J. Rockingham
Dates of Survey: February and March 1982
Instrument used: Max-Min II
Expenditure: FORCUPINE MINING DIVISION, 483.75

RECORDED DEC 1 1983

RECEIVED DEC - 1 1983

Date: November 29 1983

Signature of Recorded Holder or Agent

The Mining Act Certificate Verifying Report of Work

C. J. Rockingham 25 Adelaide Street East, Suite 1400, Toronto, Ontario M5C 1Y2 (Post Office Address)

hereby certify:

- 1. That I have a personal and intimate knowledge of the facts set forth in the report of work annexed hereto, having performed the work or witnessed same during and/or after its completion.
2. That the annexed report is true.

Dated November 29 19 83 Signature C.J. Rockingham

THE PENALTY FOR MAKING A FALSE STATEMENT IN THIS REPORT AND/OR CERTIFICATE IS \$500. OR SIX MONTHS IMPRISONMENT OR BOTH

2.6255

1984 05 16

Your File: 395/83
Our File: 2.6255

Mr. Bruce Hanley
Mining Recorder
Ministry of Natural Resources
60 Wilson Avenue
Timmins, Ontario
P4N 2S7

Dear Sir:

RE: Notice of Intent dated April 27, 1984.
Geophysical (Electromagnetic) Survey on
Mining Claims P 553627 et al in the Area
of Lower Detour Lake

The assessment work credits as listed with the
above mentioned Notice of Intent, have been approved
as of the above date.

Please inform the recorded holder of these mining
claims and so indicate on your records.

Yours sincerely,

S.E. Yundt
Director
Land Management Branch

Whitney Block, Room 6643
Queen's Park
Toronto, Ontario
M7A 1W3
Phone: (416) 965-6918

S. Hurst:sc

cc: Westmin Resources Limited
Suite 1400
25 Adelaide Street East
Toronto, Ontario
M5C 1Y2
Attention: C.J. Rockingham

cc: Mr. G.H. Ferguson
Mining & Lands Commissioner
Toronto, Ontario

cc: Resident Geologist
Timmins, Ontario

Recorded Holder **WESTMIN RESOURCES LIMITED**

Township or Area **LOWER DETOUR LAKE AREA**

Type of survey and number of Assessment days credit per claim	Mining Claims Assessed
Geophysical Electromagnetic _____ <u>17</u> days Magnetometer _____ days Radiometric _____ days Induced polarization _____ days Other _____ days Section 77 (19) See "Mining Claims Assessed" column Geological _____ days Geochemical _____ days Man days <input type="checkbox"/> Airborne <input type="checkbox"/> Special provision <input checked="" type="checkbox"/> Ground <input checked="" type="checkbox"/> <input checked="" type="checkbox"/> Credits have been reduced because of partial coverage of claims. <input type="checkbox"/> Credits have been reduced because of corrections to work dates and figures of applicant.	P 553627 553628 to 630 inclusive 553632 to 635 inclusive 553642 to 645 inclusive 553648 to 651 inclusive 553658 to 661 inclusive 575669 to 671 inclusive

Special credits under section 77 (16) for the following mining claims

No credits have been allowed for the following mining claims

not sufficiently covered by the survey Insufficient technical data filed

The Mining Recorder may reduce the above credits if necessary in order that the total number of approved assessment days recorded on each claim does not exceed the maximum allowed as follows: Geophysical — 80; Geological — 40; Geochemical — 40; Section 77(19)—60.



May 14/84

Your file: 395/83

1984 04 27

Our file: 2.6255

Mr. Bruce W. Hanley
Mining Recorder
Ministry of Natural Resources
60 Wilson Avenue
Timmins, Ontario
P4N 2S7

Dear Sir:

Enclosed are two copies of a Notice of Intent with statements listing a reduced rate of assessment work credits to be allowed for a technical survey. Please forward one copy to the recorded holder of the claims and retain the other. In approximately fifteen days from the above date, a final letter of approval of these credits will be sent to you. On receipt of the approval letter, you may then change the work entries on the claim record sheets.

For further information, if required, please contact Mr. F.W. Matthews at 416/965-6918.

Yours very truly,

S.E. Yundt
Director
Land Management Branch

Whitney Block, Room 6643
Queen's Park
Toronto, Ontario
M7A 1W3
Phone: 416/965-1316

S. Hurst:mc

Encls.

cc: Westmin Resources Ltd
Suite 1400
25 Adelaide Street East
Toronto, Ontario
M5C 1Y2
Attention: C.J. Rockingham

cc: Mr. G.H. Ferguson
Mining & Lands Commissioner
Toronto, Ontario



Ministry of
Natural
Resources

Notice of Intent
for Technical Reports

1984 04 27
2.6255/395/83

An examination of your survey report indicates that the requirements of The Ontario Mining Act have not been fully met to warrant maximum assessment work credits. This notice is merely a warning that you will not be allowed the number of assessment work days credits that you expected and also that in approximately 15 days from the above date, the mining recorder will be authorized to change the entries on his record sheets to agree with the enclosed statement. Please note that until such time as the recorder actually changes the entry on the record sheet, the status of the claim remains unchanged.

If you are of the opinion that these changes by the mining recorder will jeopardize your claims, you may during the next fifteen days apply to the Mining and Lands Commissioner for an extension of time. Abstracts should be sent with your application.

If the reduced rate of credits does not jeopardize the status of the claims then you need not seek relief from the Mining and Lands Commissioner and this Notice of Intent may be disregarded.

If your survey was submitted and assessed under the "Special Provision-Performance and Coverage" method and you are of the opinion that a re-appraisal under the "Man-days" method would result in the approval of a greater number of days credit per claim, you may, within the said fifteen day period, submit assessment work breakdowns listing the employees names, addresses and the dates and hours they worked. The new work breakdowns should be submitted direct to the Lands Management Branch, Toronto. The report will be re-assessed and a new statement of credits based on actual days worked will be issued.



May 1, 1984.

This would be more convenient for us because we have just completed the same survey on some of the claims not previously covered and we shall apply for this credit shortly, as soon as the results would be put together.

Thank you.

Yours truly,

WESTMIN RESOURCES LIMITED

A handwritten signature in cursive script, appearing to read "S. Kuprejanov".

(Mrs.) S. Kuprejanov,
Administrative Geologist.

SK/hmc

Copy to: Mining Recorder, Timmins
C. J. Rockingham, Westmin
R. H. McMillan, Westmin
Mr. G. H. Ferguson, Mining & Land Commissioner

Initial Sheet

D.K.

Assessed

Approved Reports of Work
sent out

Notice of Intent filed

Approval after Notice of Intent
sent out

Duplicate sent to Resident
Geologist

Duplicate sent to A.F.R.O.

1984 01 13

Our File: 2.6255

Mr. Bruce Hanley
Mining Recorder
Ministry of Natural Resources
60 Wilson Avenue
Timmins, Ontario
P4N 2S7

Dear Sir:

We have received reports and maps for a Geophysical (Electromagnetic) Survey submitted under Special Provisions (credit for Performance and Coverage) on Mining Claims P 553627 et al in the Area of Lower Detour Lake.

This material will be examined and assessed and a statement of assessment work credits will be issued.

We do not have a copy of the report of work which is normally filed with you prior to the submission of this technical data. Please forward a copy as soon as possible.

Yours very truly,

J.R. Morton
Acting Director
Land Management Branch

Whitney Block, Room 6643
Queen's Park
Toronto, Ontario
M7A 1W3
Phone:(416)965-1380

M.E. Anderson:mc

cc: Westmin Resources Ltd
Suite 1400
25 Adelaide Street East
Toronto, Ontario
M5C 1Y2
Attention: C.J. Rockingham

GEOCHEMICAL SURVEY - PROCEDURE RECORD



Ministry of Natural Resources
GEOCHEMICAL - GEOLOGICAL - GEOCHEMICAL
TECHNICAL DATA STATEMENT

File _____

Numbers of claims from which samples taken _____

Total Number of Samples _____
Type of Sample (Nature of Material) _____
Average Sample Weight _____
Method of Collection _____

Soil Horizon Sampled _____
Horizon Development _____
Sample Depth _____
Terrain _____

Drainage Development _____
Estimated Range of Overburden Thickness _____

Reagents Used _____
Field Laboratory Analysis _____
No. (_____ tests)
Extraction Method _____
Analytical Method _____
Reagents Used _____

Commercial Laboratory (_____ tests)
Name of Laboratory _____
Extraction Method _____
Analytical Method _____
Reagents Used _____

General _____

ANALYTICAL METHODS

Values expressed in: per cent
 p. p. m.
 p. p. b.

Cu, Pb, Zn, Ni, Co, Ag, Mo, As, (circle)

Others _____

Field Analysis (_____ tests)

Extraction Method _____
Analytical Method _____

Reagents Used _____

Field Laboratory Analysis _____

No. (_____ tests)

Extraction Method _____

Analytical Method _____

Reagents Used _____

Commercial Laboratory (_____ tests)

Name of Laboratory _____

Extraction Method _____

Analytical Method _____

Reagents Used _____

General _____

TO BE ATTACHED AS AN APPENDIX TO TECHNICAL REPORT
FACTS SHOWN HERE NEED NOT BE REPEATED IN REPORT
TECHNICAL REPORT MUST CONTAIN INTERPRETATION, CONCLUSIONS ETC.

Type of Survey(s) Geophysical (Electromagnetic)
Township or Area Lower Detour Lake Area
Claim Holder(s) Westmin Resources Limited
25 Adelaide St., E., #1400, Toronto, Ont. M5C 1Y2
Survey Company Phanton Exploration
Author of Report C. J. Rockingham
25 Adelaide Street East, Suite 1400,
Address of Author Toronto, Ontario M5C 1Y2
Covering Dates of Survey February - March 1982
(linecutting to office)
Total Miles of Line Cut 23.20

**SPECIAL PROVISIONS
CREDITS REQUESTED**

ENTER 40 days (includes line cutting) for first survey.
ENTER 20 days for each additional survey using same grid.

Geophysical
-Electromagnetic 20
-Magnetometer _____
-Radiometric _____
-Other _____
Geological _____
Geochemical _____

AIRBORNE CREDITS (Special provision credits do not apply to airborne surveys)
Magnetometer _____ Electromagnetic _____ Radiometric _____
(enter days per claim)

DATE: Jan. 9, 1984 SIGNATURE: [Signature]
Author of Report or Agent

Res. Geol. _____ Qualifications _____

Previous Surveys File No.	Type	Date	Claim Holder
_____	_____	_____	_____
_____	_____	_____	_____
_____	_____	_____	_____
_____	_____	_____	_____

MINING CLAIMS TRAVERSED
List numerically

P. 553627 (prefix)	(number)
P. 553628	
P. 553629	
P. 553630	
P. 553632	
P. 553633	
P. 553634	
P. 553635	
P. 553642	
P. 553643	
P. 553644	
P. 553645	
P. 553648	
P. 553649	
P. 553650	
P. 553651	
P. 553658	
P. 553659	
P. 553660	
P. 553661	
P. 575669	
P. 575670 and P. 575671	
TOTAL CLAIMS	23

OFFICE USE ONLY

GEOPHYSICAL TECHNICAL DATA

GROUND SURVEYS - If more than one survey, specify data for each type of survey

Number of Stations 930 Number of Readings 1860
Station interval 25 m Line spacing 120 m
Profile scale 1 cm = 5%
Contour interval N/A

MAGNETIC

Instrument _____
Accuracy - Scale constant _____
Diurnal correction method _____
Base Station check-in interval (hours) _____
Base Station location and value _____

ELECTROMAGNETIC

Instrument Appex Parametric Max-Min II.
Coil configuration Horizontal loop
Coil separation 150 m
Accuracy +1/2%
Method: Fixed transmitter Shoot back In line Parallel line
Frequency 888 Hz (specify V.L.F. station)
Parameters measured In phase, out of phase

GRAVITY

Instrument _____
Scale constant _____
Corrections made _____
Base station value and location _____
Elevation accuracy _____

RESISTIVITY

Instrument _____
Method Time Domain Frequency Domain
Parameters - On time _____ Frequency _____
- Off time _____ Range _____
- Delay time _____
- Integration time _____
Power _____
Electrode array _____
Electrode spacing _____
Type of electrode _____

SELF POTENTIAL

Instrument _____ Range _____
Survey Method _____

Corrections made _____

RADIOMETRIC

Instrument _____
Values measured _____
Energy windows (levels) _____
Height of instrument _____ Background Count _____
Size of detector _____
Overburden _____ (type, depth - include outcrop map)

OTHERS (SEISMIC, DRILL WELL LOGGING ETC.)

Type of survey _____
Instrument _____
Accuracy _____
Parameters measured _____
Additional information (for understanding results) _____

AIRBORNE SURVEYS

Type of survey(s) _____
Instrument(s) _____ (specify for each type of survey)
Accuracy _____ (specify for each type of survey)
Aircraft used _____
Sensor altitude _____
Navigation and flight path recovery method _____
Aircraft altitude _____ Line Spacing _____
Miles flown over total area _____ Over claims only _____

PHANION EXPLORATION

R.R. #14, ALICE AVE., THUNDER BAY, ONT.

RES: 807-623-8916 BUS: 807-767-4671

DETOUR PROJECT

WESTMIN RESOURCES LTD
 SUITE 1414
 390 Bay St.
 TORONTO, ONT.

DATE OF INVOICE FEB 11/82

INVOICE NO. 012

SURVEY	DESCRIPTION		RATE	AMOUNT
	DETOUR GRID.			
MAINING		62.5 km	\$75/km	\$4,687.50 ✓
K-MIN		66.8 km	\$150/km	\$10,020.00 ✓
MIN	MANDAY RATE	2 MANDAY	\$150/day	\$300.00 ✓
	<u>NASH CREEK GRID.</u>			
		23.225 km	\$75/km	\$1,741.88 ✓
MAINING		23.225 km	\$150/km	\$3,483.75 ✓
KX-MIN	SUNDAY LAKE GRID.			
		30.875 km	\$75/km	\$2,315.63 ✓
MIN		28.675 km	\$150/km	\$4,301.25 ✓
MIN CUTTING				\$100.00
	TORONTO TRIP REFERENCE TO JACK BETZ			\$290.00
			TOTAL	27,240.01 ✓



A separate form is required for each type of work to be recorded.

THE MINING ACT REPORT OF WORK

To the Recorder of Porcupine Mining Division
Westmin Resources Limited T-778
name of Recorded Holder Prospector's Licence
25 Adelaide St. East, Suite 1400, Toronto, Ontario M5C 1Y2
do hereby report the performance of 445 days of Electromagnetic (ground) type of work
not before reported to be applied on the following contiguous claims

Table with 6 columns: Claim No., Days, Claim No., Days, Claim No., Days. Includes entries like P.553627 (5 days), P.553628-630 (3) (20/each), P.553632-635 (4) (20/each), P.553642-645 (4) (20/each), P.553648-651 (4) (20/each), P.553658-661 (4) (20/each). Includes a large 'COPY' watermark and the text 'FOR DETAILS SEE ATTACHED SCHEDULE "A"'

All the work was performed on Mining Claim (s) All claims listed in Schedule "A"
(In the case of geological and/or geophysical survey (s) where more than 18 claims are involved attach a schedule)

READ CAREFULLY: THE FOLLOWING INFORMATION IS REQUIRED BY THE MINING RECORDER.

- For Manual Work, Stripping or Opening up of Mines, Sinking Shafts or Other Actual Mining Operations - Names and addresses of the men who performed the work and the dates and hours of their employment.
For Diamond and other Core Drilling - Footage, No. and angle of holes and diameter of core. Name and address of owner or operator of drill. Dates when drilling was done. Signed core log and sketch in duplicate.
For Compressed Air or Other Power Driven or Mechanical Equipment
Type of drill or equipment. Names and addresses of men engaged in operating equipment and the dates and hours of their employment.
For Power Stripping - Type of equipment. Name and address of owner or operator. Amount expended. Dates on which work was done. Proof of actual cost must be submitted within 30 days of recording.
With each of the above types of work sketches are required to show the location and extent of the work in relation to the nearest claim post. In the case of diamond or other core drilling the sketch must be submitted in duplicate.
For Geophysical, Geological, Geochemical Surveys and Expenditure Credits - the name of author of report. Covering dates of survey (linecutting & office). Type of instrument used. Total amount of expenditure. Technical reports, maps, expenditure breakdown, receipts must be filed in duplicate with the Minister within 60 days of recording.
For Land Survey - the name and address of Ontario Land surveyor.

The Required Information is as Follows: (Attach a list if this space is insufficient)

Author of the report: C.J. Rockingham
Dates of Survey: February and March 1982
Instrument used: Max-Min II
Expenditure: \$3,483.75

Date November 29, 1983

Signature of Recorded Holder or Agent

The Mining Act Certificate Verifying Report of Work

C. J. Rockingham

25 Adelaide Street East, Suite 1400, Toronto, Ontario M5C 1Y2
(Post Office Address)

hereby certify:

- 1. That I have a personal and intimate knowledge of the facts set forth in the report of work annexed hereto, having performed the work or witnessed same during and/or after its completion.
2. That the annexed report is true.

Dated November 29 1983

Signature

THE PENALTY FOR MAKING A FALSE STATEMENT IN THIS REPORT AND/OR CERTIFICATE IS \$500. OR SIX MONTHS IMPRISONMENT OR BOTH

S C H E D U L E "A"

ELECTROMAGNETIC SURVEY (Ground)

Work to be applied on the following contiguous claims:

<u>Claim No.</u>	<u>Days</u>
P.553627	5
P.553628	20
P.553629	20
P.553630	20
P.553632	20
P.553633	20
P.553634	20
P.553635	20
P.553642	20
P.553643	20
P.553644	20
P.553645	20
P.553648	20
P.553649	20
P.553650	20
P.553651	20
P.553658	20
P.553659	20
P.553660	20
P.553661	20
P.575669	20
P.575670	20
P.575671	20

Total: 445 days

2.6255'

553627

$\frac{1}{2}$

28 ✓

29 ✓

30 ✓

32 $\frac{1}{2}$ ✓

33 ✓

34 ✓

35 $\frac{1}{4}$

42 $\frac{1}{4}$

43 ✓

44 ✓

45 $\frac{1}{2}$

48 $\frac{1}{2}$ ✓

49 ✓

50 ✓

51 $\frac{1}{4}$

58 $\frac{1}{4}$

59 ✓

60 ✓

61 $\frac{1}{2}$ ✓

69 ✓

70 ✓

71 ✓

~~$\frac{1}{2}$~~ ~~3x~~
~~44~~ ~~4~~

$23 \times 20 = 460$

$\frac{460}{26.5} = 17.35'$

≈ 17

See.

$\frac{1}{4} \times 22 \times 20 = 18$
 $\frac{25}{25}$

2'

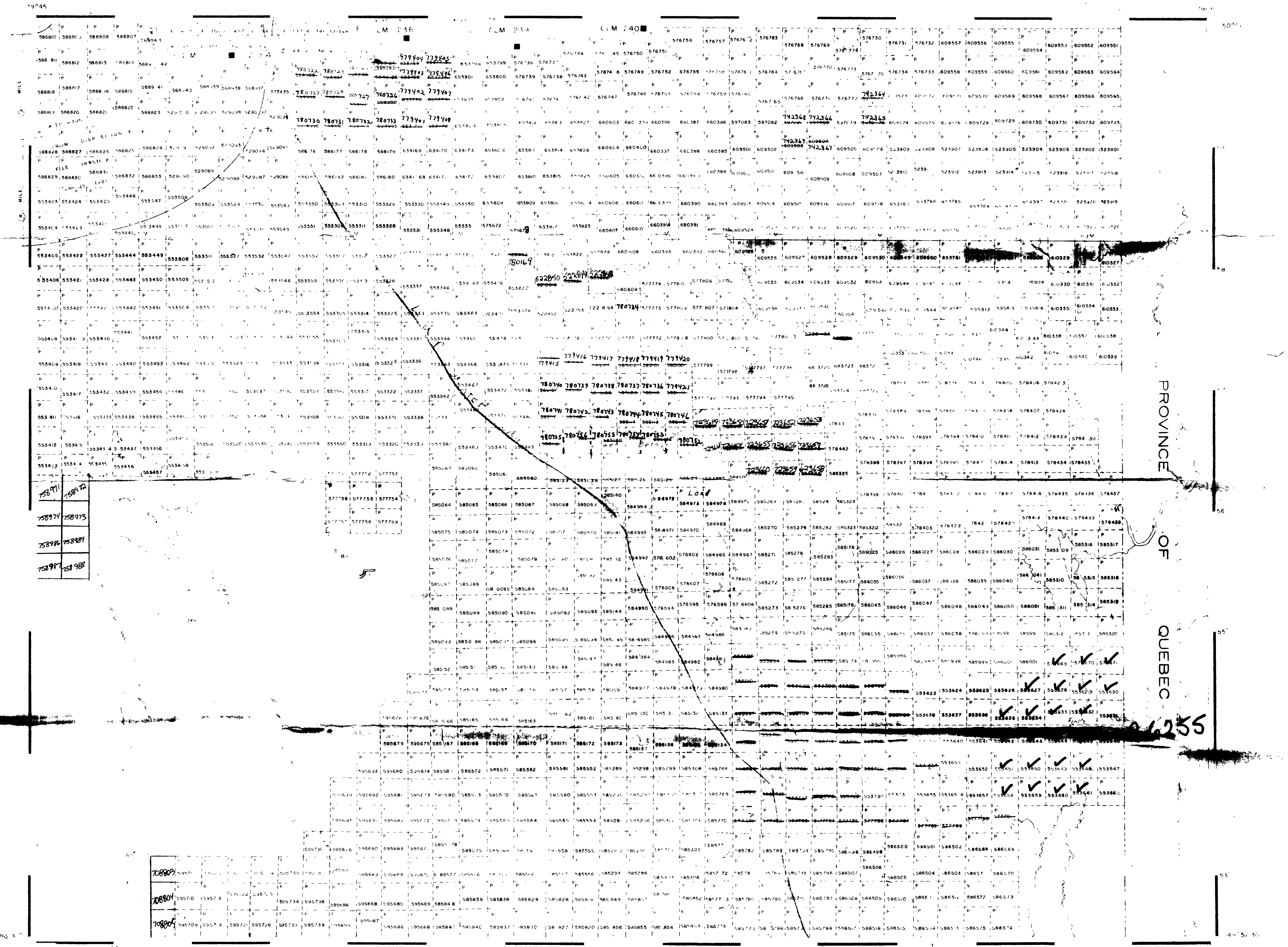

M R O MINING RIGHTS ONLY
 S R O SURFACE RIGHTS ONLY
 M + S MINING AND SURFACE RIGHTS

Description Order No Date Disposition File
 NR W 1/81 15/7/81 S R O 1881

Received Aug 4/83

LEGEND

- HIGHWAY AND ROUTE No. ————
- OTHER ROADS ————
- TRAILS ————
- SURVEYED LINES
 TOWNSHIPS BASE LINES ETC. ————
- LOTS MINING CLAIMS PARCELS ETC. ————
- UNSURVEYED LINES
 LOT LINE ————
- PARCEL BOUNDARY ————
- MINING CLAIMS ETC. ————
- RAILWAY AND HIGHWAY A.A. ————
- UTILITY LINE ————
- NON PERENNIAL STREAM ————
- FLOODING OR FLOODING RIGHTS ————
- SUBDIVISION OR COMPOSITE PLAN ————
- RESERVATIONS ————
- ORIGINAL SHORELINE ————
- MARSH OR MISCELL. ————
- MINES ————
- TRAVERSE MONUMENT ————

DISPOSITION OF CROWN LANDS

TYPE OF DOCUMENT	SYMBOL
PATENT SURFACE & MINING RIGHTS	●
SURFACE RIGHTS ONLY	○
MINING RIGHTS ONLY	◐
LEASE SURFACE & MINING RIGHTS	■
SURFACE RIGHTS ONLY	◼
MINING RIGHTS ONLY	◻
LICENCE OF OCCUPATION	◔
ORDER IN COUNCIL	○
RESERVATION	⊙
CANCELLED	⊘
SAND & GRAVEL	⊙

NOTE MINING RIGHTS IN PARCELS PATENTED PRIOR TO MAY 6 1913 VESTED IN ORIGINAL PATENTEE BY THE PUBLIC LANDS ACT R.S.O. 1910 CHAP. 380 SEC. 63 SUB-SEC. 1

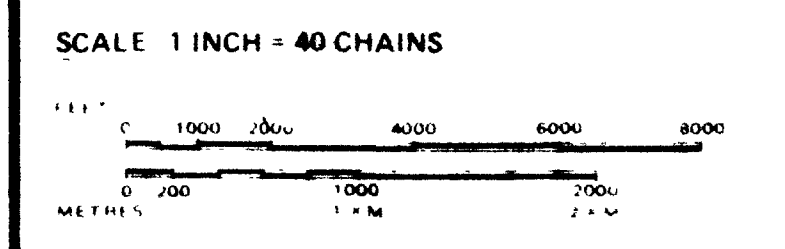

AREA
LOWER DETOUR LAKE
 M N R ADMINISTRATIVE DISTRICT
COCHRANE
 MINING DIVISION
PORCUPINE
 LAND TITLES / REGISTRY DIVISION
COCHRANE

Ontario Ministry of Natural Resources Land Management Branch

Date DECEMBER 1982 Number **G-1647**

HOPPER LAKE G-1636

PROVINCE OF QUEBEC



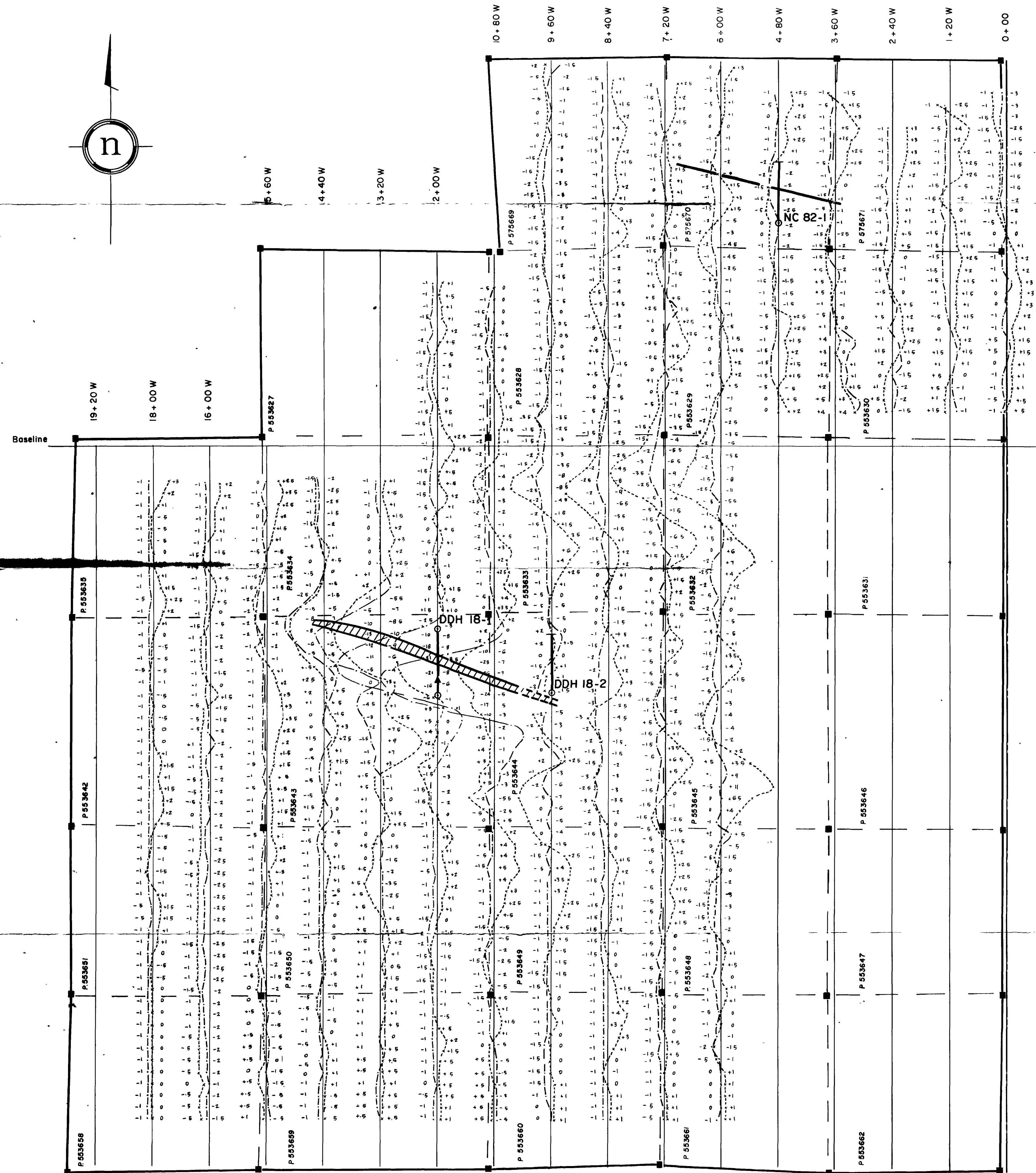
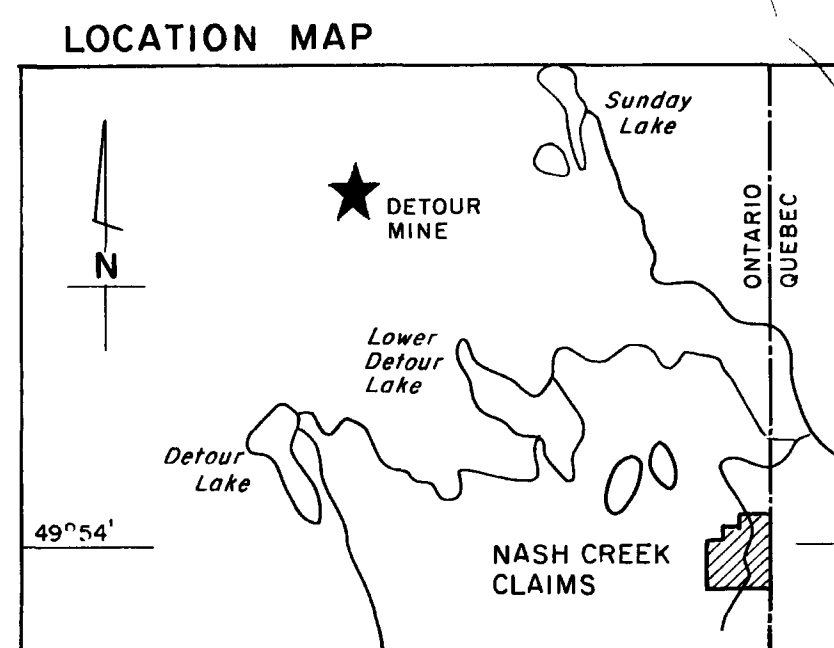
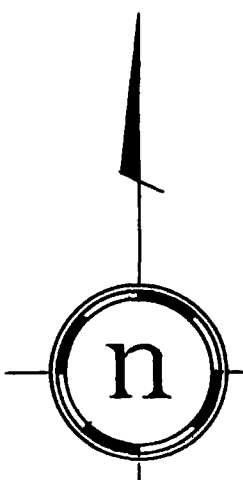

LEGEND

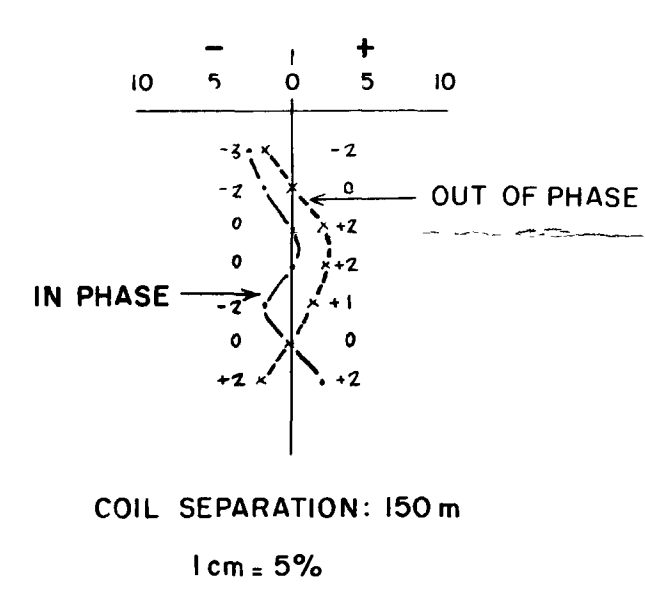

C. Roddingham

REVISIONS	
DATE	BY

Westmin Resources Limited
 EASTERN CANADA MINING DIVISION

DETOUR PROJECT - NASH CREEK CLAIMS

MAX-MIN II SURVEY
 888 Hz

Work by C.R., J.B.	Scale 1:5000
Date Dec. 1983	NTS 32E/13

