



32E13NE9306 2.4481 ATKINSON LAKE

010

REPORT  
ON  
ELECTROMAGNETIC & MAGNETIC SURVEYS  
BY  
ABITIBI-PRICE INC.  
MINERAL RESOURCES DIVISION  
ATKINSON LAKE AREA &  
LOWER DETOUR LAKE AREA, ONTARIO

**RECEIVED**  
JAN 12 1982  
MINING LANDS SECTION

D.A. McCombe  
Abitibi-Price Inc.  
Mineral Resources Division

December, 1981



32E13NE9306 2.4481 ATKINSON LAKE

010C

TABLE OF CONTENTS

INTRODUCTION

LOCATION AND ACCESS

PROPERTY

PREVIOUS WORK

GEOLOGY

SURVEY PROCEDURE AND INSTRUMENTATION

STATISTICS

INTERPRETATION

CONCLUSIONS AND RECOMMENDATIONS

MAPS: Magnetics

Radem

## INTRODUCTION

### PURPOSE OF SURVEY

A systematic Radem and Magnetic Survey were performed over staked claims held by Abitibi-Price Inc. for the purpose of exploring for base and precious metal sulphide deposits. The area covered by this report occurs on the Atkinson Lake Sheet (M2622) and the Lower Detour Lake Sheet (M2603), Ontario.

### LOCATION AND ACCESS

The staked area is located in the south western portion of the Lower Detour Lake area, approximately 120 miles northeast of Timmins, Ontario. Open spruce forest and spruce bog cover most of the area with sections of open bog along the southern edge of the claim group.

Access by helicopter is necessary.

### PROPERTY

The eighty-five unpatented claims covered by the survey are held by Abitibi-Price Inc. These include:

P595660-699

P595700-744

### PREVIOUS WORK

In 1959, the Kesagami Syndicate drilled four holes east of the presently staked claim group to test several ground EM conductors. Narrow bands of iron formation with trace chalcopyrite and sphalerite were intersected in one hole. The other conductors were explained by the presence of narrow bands of disseminated sulphides - pyrite and pyrrhotite.

During 1959-1960, Conwest Exploration performed ground magnetic and EM (HEM) surveys. Nine holes were drilled. Narrow sulphide zones (up to 75% po, minor py) in quartz-chlorite, sericite and occasionally graphitic schists explained the conductors.

AMOCO Petroleum Canada drilled three (3) holes during 1974-1975 to test ground HEM conductors located in this vicinity. Mafic to intermediate volcanics with disseminated pyrrhotite and pyrite were encountered.

In 1975 Hudson Bay Exploration and Development Co. Ltd. performed a ground HEM survey as a follow-up to an airborne electromagnetic survey. Seven EM conductors were delineated. The two holes drilled intersected pyrite, pyrrhotite, magnetite and graphite. Assay values were not encouraging.

#### GEOLOGY

A belt of felsic to intermediate volcanics with intercalated metasediments, striking in an east-west direction encompasses most of this claim group. The sequence is interrupted by a diorite-granodiorite intrusive which borders the northern edge of the claim group. M. Bell, deLorme Consulting Ltd. performed the geological mapping in August-September 1981.

#### SURVEY PROCEDURE

The VLF-EM survey was carried out using a Radem unit manufactured by Crone Geophysics. Readings were obtained at 100 ft. stations. Profiles of the data are plotted at 1" = 20% on maps at the back of this report.

The EM and magnetic surveys were completed during July and August 1981.

The magnetic survey was done using a Geometrics total field magnetometer. A contoured map at 500 gamma intervals is included at the back of this report.

Base lines and tie lines were read by looping back to a base station. The main base station for the grid was located at 88+00W and the base line (0+00W - 1000 gammas).

The Radem and magnetic surveys were performed by Abitibi-Price temporary personnel - Victor Bergeron and Charles Jaba.

## STATISTICS

Approximately 70 miles of grid line was cut on the eighty-five contiguous claims covered by these surveys.

Radem readings were observed at 6254 stations and magnetometer readings were observed at 12,614 stations.

## INTERPRETATION

### RADEM

Seven EM conductors were outlined on this survey. A long conductor (A,C,D) extends from Line 104W, 20S to Line 22W and the base line. This parallels the major magnetic anomaly in this area. Conductor A and Conductor B (Line 108W, 3S to Line 100W, 1+00N) were drilled by AMOCO in 1974-1975. Disseminated pyrrhotite (10%) and pyrite (5%) with trace chalcopyrite were discovered within intermediate to mafic volcanics.

Conwest drilled Conductor D, (Line 52W, 4S to Line 22W and baseline) in 1959-60 and intersected 20 feet of massive pyrite and pyrrhotite. Hudson Bay Exploration and Development encountered disseminated pyrite, pyrrhotite magnetite and some graphite when Conductors F and G were drilled. No anomalous assays were obtained.

Conductor "C" (68+00W, 6+50S to 58+00W, 4+50S) has an associated magnetic response and may possibly be due to the presence of pyrrhotite.

Graphite and pyritic sulphides may explain Conductor "H" (60W, 24+00N to 56W, 22+00N) which lacks an associated magnetic expression.

Conductor "E" in the southeastern portion of the claim group may be due to conductive overburden.

MAGNETICS

Maximum magnetic relief on this property is approximately 6900 gammas. A 400 foot wide anomalous magnetic high trends east-west from Line 120+00W, 19+00S to 44+00W and the base line. It then continues along the base line to 22+00W where it curves to the northeast and extends east of the property boundary at 21+00N. This conductor is probably due to pyrrhotite bearing sulphides.

CONCLUSIONS AND RECOMMENDATIONS

Most of the EM anomalies in this area have previously been drilled however, Conductors "C" and "H" may require further attention.

Conductor "C" may be a continuation of anomalies A and D and is probably caused by massive sections of pyrite and pyrrhotite in volcanics.

Further detailed geophysics should be performed over Anomaly H and if warranted, a drill hole completed.

*D.A. McCombe*

D.A. McCombe

DAM/nw



32E13NE9306 2.4481 ATKINSON LAKE

900

1983 03 11

2.4481

Mining Recorder  
Ministry of Natural Resources  
60 Wilson Avenue  
Timmins, Ontario  
P4N 2S7

Dear Sir:

RE: Geophysical (Electromagnetic & Magnetometer) Survey  
submitted on Mining Claims P 595660 et al in the  
Areas of Lower Detour Lake and Atkinson Lake.

---

The Geophysical (Electromagnetic & Magnetometer) Survey  
assessment work credits as listed with my Notice of Intent dated  
January 17, 1983 have been approved as of the above date.

Please inform the recorded holder of these mining claims and so  
indicate on your records.

Yours very truly,

E.F. Anderson  
Director  
Land Management Branch

Whitney Block, Room 6450  
Queen's Park  
Toronto, Ontario  
M7A 1W3

A. Barr:sc

cc: Petromet Resources Ltd  
Calgary, Alberta. Attn: L. Smith.

cc: Terra Nova Exploration  
Toronto, Ontario

cc: Abitibi Price Inc  
Toronto, Ontario. Attn: D.A. McCombe.

cc: Resident Geologist  
Timmins, Ontario



Ministry of  
Natural  
Resources

Ontario

FEB <sup>11</sup> 1983

Your file:

1983 01 17

Our file: 2.4481

**Mining Recorder  
Ministry of Natural Resources  
60 Wilson Avenue  
Timmins, Ontario**

**Dear Sir:**

Enclosed are two copies of a Notice of Intent with statements listing a reduced rate of assessment work credits to be allowed for a technical survey. Please forward one copy to the recorded holder of the claims and retain the other. In approximately fifteen days from the above date, a final letter of approval of these credits will be sent to you. On receipt of the approval letter, you may then change the work entries on the claim record sheets.

Yours very truly,

**For further information, if  
required, please contact  
Mr. F.W. Matthews at  
416/965-1380.**

E.F. Anderson  
Director  
Lands Administration Branch  
Whitney Block, Room 6450  
Queen's Park  
Toronto, Ontario  
M7A 1W3  
Phone: 416/965-1316

**A. Barr:sc**

**cc: Terra Nova Exploration  
Toronto, Ontario**

**cc: Abitibi Price Inc  
Toronto, Ontario  
Attn: D.A. McCombe.**

**cc: Mr. G.H. Ferguson  
Mining & Lands Commissioner  
Toronto, Ontario**





Ministry of  
Natural  
Resources

Notice of Intent  
for Technical Reports

1983 01 17

2.4481

An examination of your survey report indicates that the requirements of The Ontario Mining Act have not been fully met to warrant maximum assessment work credits. This notice is merely a warning that you will not be allowed the number of assessment work days credits that you expected and also that in approximately 15 days from the above date, the mining recorder will be authorized to change the entries on his record sheets to agree with the enclosed statement. Please note that until such time as the recorder actually changes the entry on the record sheet, the status of the claim remains unchanged.

If you are of the opinion that these changes by the mining recorder will jeopardize your claims, you may during the next fifteen days apply to the Mining and Lands Commissioner for an extension of time. Abstracts should be sent with your application.

If the reduced rate of credits does not jeopardize the status of the claims then you need not seek relief from the Mining and Lands Commissioner and this Notice of Intent may be disregarded.

If your survey was submitted and assessed under the "Special Provision-Performance and Coverage" method and you are of the opinion that a re-appraisal under the "Man-days" method would result in the approval of a greater number of days credit per claim, you may, within the said fifteen day period, submit assessment work breakdowns listing the employees names, addresses and the dates and hours they worked. The new work breakdowns should be submitted direct to the Lands Management Branch, Toronto. The report will be re-assessed and a new statement of credits based on actual days worked will be issued.

Recorded Holder  
**TERRA NOVA EXPLORATION**

Township or Area  
**LOWER DETOUR LAKE, ATKINSON LAKE AREA**

Type of survey and number of Assessment days credit per claim	Mining Claims Assessed
<b>Geophysical</b> Electromagnetic <u>40</u> days Magnetometer _____ days Radiometric _____ days Induced polarization _____ days Section 86 (18) _____ days <b>Geological</b> _____ days <b>Geochemical</b> _____ days  Man days <input type="checkbox"/> Airborne <input type="checkbox"/> Special provision <input checked="" type="checkbox"/> Ground <input checked="" type="checkbox"/>  <input type="checkbox"/> Credits have been reduced because of partial coverage of claims. <input type="checkbox"/> Credits have been reduced because of corrections to work dates and figures of applicant.	<b>P 595660 to 66 incl.</b> <b>595668 to 99 incl.</b> <b>595703 to 06 incl.</b> <b>595709 to 44 incl.</b>

**Special credits under section 86 (15a) for the following mining claims**

10 days	20 days	30 days
P 595701-02	P 595700 595708	P 595707

**No credits have been allowed for the following mining claims**

not sufficiently covered by the survey                       Insufficient technical data filed

**P 595667**

The Mining Recorder may reduce the above credits if necessary in order that the total number of approved assessment days recorded on each claim does not exceed the maximum allowed as follows: Geophysical — 80; Geological — 40; Geochemical — 40; Section 86(18)-60:

<b>Recorded Holder</b>	<b>TERRA NOVA EXPLORATION</b>
<b>Township or Area</b>	<b>LOWER DETOUR LAKE ATKINSON LAKE AREAS</b>

Type of survey and number of Assessment days credit per claim	Mining Claims Assessed
<b>Geophysical</b> Electromagnetic _____ days Magnetometer <b>20</b> _____ days Radiometric _____ days Induced polarization _____ days Section 86 (18) _____ days <b>Geological</b> _____ days <b>Geochemical</b> _____ days  Man days <input type="checkbox"/> Airborne <input type="checkbox"/> Special provision <input checked="" type="checkbox"/> Ground <input checked="" type="checkbox"/>  <input type="checkbox"/> Credits have been reduced because of partial coverage of claims. <input type="checkbox"/> Credits have been reduced because of corrections to work dates and figures of applicant.	<b>P 595660 to 66 incl.</b> <b>595668 to 99 incl.</b> <b>595703 to 06 incl.</b> <b>595709 to 44 incl.</b>

**Special credits under section 86 (15a) for the following mining claims**

<b>5 days</b>	<b>10 days</b>	<b>15 days</b>
<b>P 595701-02</b>	<b>P 595700 595708</b>	<b>P 595707</b>

**No credits have been allowed for the following mining claims**

<input checked="" type="checkbox"/> not sufficiently covered by the survey	<input type="checkbox"/> Insufficient technical data filed
<b>P 595667</b>	

The Mining Recorder may reduce the above credits if necessary in order that the total number of approved assessment days recorded on each claim does not exceed the maximum allowed as follows: Geophysical — 80; Geological — 40; Geochemical — 40; Section 86(18)-60:

**Report of Work**  
(Geophysical, Geological, Geochemical and Expenditures)

Instructions: - Please type or print.  
- If number of mining claims traversed exceeds space on this form, attach a list.  
Note: - Only days credits calculated in the "Expenditures" section may be entered in the "Expend. Days Cr." columns.  
- Do not use shaded areas below.

# 22  
2,4481  
3,4480  
Atkinson Lake Area M-26 22  
Lower Detour Lake Area M-26 03  
The Mining Act

Type of Survey(s) <b>Electromagnetic, Magnetic, Geology</b>		Township or Area <b>Atkinson Lake Area Lower Detour Lake</b>	
Claim Holder(s) <b>Terra Nova Exploration</b>		Prospector's Licence No. <b>T858</b>	
Address <b>P.O. Box 21 Toronto Dominion Centre Toronto, Ontario M5K 1B3</b>			
Survey Company <b>Abitibi-Price Inc.</b>		Date of Survey (from & to) 01 Day   07 Mo.   81 Yr.   15 Day   12 Mo.   81 Yr.	
Total Miles of line Cut <b>70</b>			
Name and Address of Author (of Geo-Technical report) <b>D.A. McCombe Abitibi-Price Inc. P.O. Box 21 T-D Centre Toronto, Ontario M5K 1B3</b>			

Credits Requested per Each Claim in Columns at right

Mining Claims Traversed (List in numerical sequence)

Special Provisions	Geophysical	Days per Claim
For first survey: Enter 40 days. (This includes line cutting)	- Electromagnetic	40 <sup>2,4481</sup>
	- Magnetometer	20 <sup>3,4480</sup>
For each additional survey: using the same grid: Enter 20 days (for each)	- Radiometric	
	- Other	
	Geological	20 <sup>2,4480</sup>
	Geochemical	

Man Days	Geophysical	Days per Claim
Complete reverse side and enter total here	- Electromagnetic	
	- Magnetometer	
	- Radiometric	
	- Other	
	Geological	
	Geochemical	

Mining Claim		Expend. Days Cr.	Mining Claim		Expend. Days Cr.
Prefix	Number		Prefix	Number	
<b>RECEIVED</b>					
<b>FEB 8 1982</b>					
<b>MINING LANDS SECTION</b>					
<b>RECEIVED</b>					
<b>JAN 12 1982</b>					
<b>MINING LANDS SECTION</b>					

Expenditures (excludes power stripping)

Type of Work Performed <b>PORCUPINE MINING DIVISION</b>
Performed on Claim(s) <b>RECEIVED</b>
<b>JAN 27 1982</b>
Calculation of Expenditure Days Credits Total Expenditures: <b>789101121123456</b> + <b>15</b> = <b>789101121123456</b>
Instructions Total Days Credits may be apportioned at the claim holder's choice. Enter number of days credits per claim selected in columns at right.

Total number of mining claims covered by this report of work. **85**

Date <b>Dec. 22, 1981</b>	Recorded Holder or Agent (Signature) <i>Deborah A. McCombe</i>
------------------------------	---

For Office Use Only		Regional Mining Recorder <i>[Signature]</i>
Total Days Cr. Recorded <b>6,500</b>	Date Recorded <b>1/15/82</b>	
Date Approved as Recorded		Branch Director

**Certification Verifying Report of Work**

I hereby certify that I have a personal and intimate knowledge of the facts set forth in the Report of Work annexed hereto, having performed the work or witnessed same during and/or after its completion and the annexed report is true.

Name and Postal Address of Person Certifying <b>Deborah A. McCombe Abitibi-Price Inc. P.O. Box 21 Toronto Dominion Centre</b>		Date Certified <b>Dec. 22, 1981</b>	Certified by (Signature) <i>[Signature]</i>
<b>Toronto, Ontario M5K 1B3</b>			

ABITIBI-PRICE INC.

LOWER DETOUR LAKE-ATKINSON LAKE

CONTIGUOUS CLAIMS - GEOLOGY SURVEY

Claims		Days
P595660		20
P595661		20
P595662		20
P595663		20
P595664		20
P595665		20
P595666		20
P595667		20
P595668		20
P595669		20
P595670		20
P595671		20
P595672		20
P595673		20
P595674		20
P595675		20
P595676		20
P595677		20
P595678		20
P595679		20
P595680		20
P595681		20
P595682		20
P595683		20
P595684		20
P595685		20
P595686		20
P595687		20
P595688		20
P595689		20
P595690		20
P595691		20
P595692		20
P595693		20
P595694		20
P595695		20
P595696		20
P595697		20
P595698		20
P595699		20
P595700		20

Claims		Days
P595701		20
P595702		20
P595703		20
P595704		20
P595705		20
P595706		20
P595707		20
P595708		20
P595709		20
P595710		20
P595711		20
P595712		20
P595713		20
P595714		20
P595715		20
P595716		20
P595717		20
P595718		20
P595719		20
P595720		20
P595721		20
P595722		20
P595723		20
P595724		20
P595725		20
P595726		20
P595727		20
P595728		20
P595729		20
P595730		20
P595731		20
P595732		20
P595733		20
P595734		20
P595735		20
P595736		20
P595737		20
P595738		20
P595739		20
P595740		20
P595741		20
P595742		20
P595743		20
P595744		20

ABITIBI-PRICE INC.

LOWER DETOUR LAKE-ATKINSON LAKE

CONTIGUOUS CLAIMS - MAGNETIC SURVEY

Claims	P595660	Days	20	Claims	P595701	Days	20
	P595661		20		P595702		20
	P595662		20		P595703		20
	P595663		20		P595704		20
	P595664		20		P595705		20
	P595665		20		P595706		20
	P595666		20		P595707		20
	P595667		20		P595708		20
	P595668		20		P595709		20
	P595669		20		P595710		20
	P595670		20		P595711		20
	P595671		20		P595712		20
	P595672		20		P595713		20
	P595673		20		P595714		20
	P595674		20		P595715		20
	P595675		20		P595716		20
	P595676		20		P595717		20
	P595677		20		P595718		20
	P595678		20		P595719		20
	P595679		20		P595720		20
	P595680		20		P595721		20
	P595681		20		P595722		20
	P595682		20		P595723		20
	P595683		20		P595724		20
	P595684		20		P595725		20
	P595685		20		P595726		20
	P595686		20		P595727		20
	P595687		20		P595728		20
	P595688		20		P595729		20
	P595689		20		P595730		20
	P595690		20		P595731		20
	P595691		20		P595732		20
	P595692		20		P595733		20
	P595693		20		P595734		20
	P595694		20		P595735		20
	P595695		20		P595736		20
	P595696		20		P595737		20
	P595697		20		P595738		20
	P595698		20		P595739		20
	P595699		20		P595740		20
	P595700		20		P595741		20
					P595742		20
					P595743		20
					P595744		20

ABITIBI-PRICE INC.

LOWER DETOUR LAKE-ATKINSON LAKE

CONTIGUOUS CLAIMS - ELECTROMAGNETIC

Claims	P595660	Days	40	Claims	P595701	Days	40
	P595661		40		P595702		40
	P595662		40		P595703		40
	P595663		40		P595704		40
	P595664		40		P595705		40
	P595665		40		P595706		40
	P595666		40		P595707		40
	P595667		40		P595708		40
	P595668		40		P595709		40
	P595669		40		P595710		40
	P595670		40		P595711		40
	P595671		40		P595712		40
	P595672		40		P595713		40
	P595673		40		P595714		40
	P595674		40		P595715		40
	P595675		40		P595716		40
	P595676		40		P595717		40
	P595677		40		P595718		40
	P595678		40		P595719		40
	P595679		40		P595720		40
	P595680		40		P595721		40
	P595681		40		P595722		40
	P595682		40		P595723		40
	P595683		40		P595724		40
	P595684		40		P595725		40
	P595685		40		P595726		40
	P595686		40		P595727		40
	P595687		40		P595728		40
	P595688		40		P595729		40
	P595689		40		P595730		40
	P595690		40		P595731		40
	P595691		40		P595732		40
	P595692		40		P595733		40
	P595693		40		P595734		40
	P595694		40		P595735		40
	P595695		40		P595736		40
	P595696		40		P595737		40
	P595697		40		P595738		40
	P595698		40		P595739		40
	P595699		40		P595740		40
	P595700		40		P595741		40
					P595742		40
					P595743		40
					P595744		40

2.4481

# ABITIBI-PRICE

ABITIBI-PRICE MINERAL RESOURCES, Toronto-Dominion Centre, Toronto, Canada M5K 1B3 (416) 866-4610

January 11, 1982

Mr. E.F. Anderson  
Ministry of Natural Resources  
Land Management Branch  
Whitney Block, Room 6450  
Queen's Park  
Toronto, Ontario  
M7A 1W3

Dear Sir:

Re: Your file No. 2.4481. Geophysical Survey Submitted on Mining  
Claims P 595660 et al in the Areas of Lower Detour Lake and  
Atkinson Lake

---

Please find enclosed our Magnetometer map, in duplicate, for the above  
survey. The readings have been plotted at each station point.

Yours truly,

ABITIBI-PRICE MINERAL RESOURCES

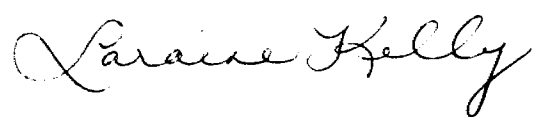

Laraine Kelly  
Drafting Assistant

/lak  
Encl.

**RECEIVED**

**JAN 12 1983**

**MINING LANDS SECTION**





Mining Lands Comments

- Mag maps need readings

To: Geophysics Mr. Barlow.

Comments

-

Approved     Wish to see again with corrections    Date Oct 29/82    Signature Ryan P. [unclear]

To: Geology - Expenditures

Comments

Approved     Wish to see again with corrections    Date    Signature

To: Geochemistry

Comments

LD

Approved     Wish to see again with corrections    Date    Signature

To: Mining Lands Section, Room 6462, Whitney Block. (Tel: 5-1380)

1982 12 16

2.4481

Abitibi Price Incorporated  
P.O. Box 21  
Toronto Dominion Centre  
Toronto, Ontario  
M5K 1B3

Dear Sir:

RE: Geophysical (Electromagnetic and Magnetometer) Survey  
submitted on Mining Claims P 595660 et al in the Areas  
of Lower Detour Lake and Atkinson Lake

---

Enclosed is the Magnetometer map in duplicate for the above  
mentioned survey. Please plot the readings at each station  
point and return the maps to this office.

For further information, please contact Mr. F.W. Matthews at  
965-1380.

Yours very truly,

E.F. Anderson  
Director  
Land Management Branch

Whitney Block, Room 6450  
Queen's Park  
Toronto, Ontario  
M7A 1W3  
Phone: 416/965-1380

A. Barr:sc

Encls:

cc: Mining Recorder  
Timmins, Ontario

January 26, 1982

2.4481

Office of the Mining Recorder  
Ministry of Natural Resources  
60 Wilson Avenue  
Timmins, Ontario  
P4N 2S7

Dear Sir:

We have received reports and maps for a Geophysical (Electromagnetic and Magnetometer) Survey submitted under Special Provisions (credit for Performance and Coverage) on Mining Claims P.595660 et al, in the Areas of Lower Detour Lake and Atkinson Lake.

This material will be examined and assessed and a statement of assessment work credits will be issued.

Also, please find enclosed a "Report of Work" form which was sent to us by mistake.

Yours very truly,

E.F. Anderson  
Director  
Land Management Branch

Whitney Block, Room 6450  
Queen's Park  
Toronto, Ontario  
M7A 1W3  
Phone: 416/965-1380

J. Skura/bk

Encl.

cc: Abitibi-Price Inc.  
Toronto, Ontario  
Attention: Deborah A. McCombe

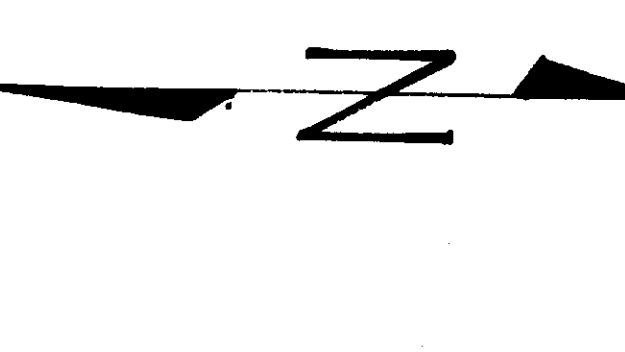

**LEGEND**

- CLAIM POSTS
- 595676, etc. CLAIM NUMBERS
- △ BASE STATION

CENTRE INTERVAL: 1000'  
 3000' +  
 500' INTERVAL

ABITIBI - PRICE INC.  
 TERRA NOVA EXPLORATIONS

DETOUR LAKE AREA

MAGNETICS

DATE: OCT. 22/81  
 SCALE: 1" = 400'  
 PROJECT BY: C. JARVA  
 DRAWN BY: L. KELLY  
 MR. DL-100

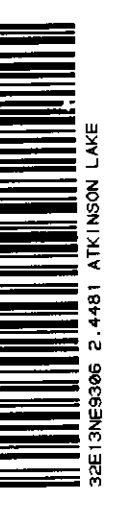
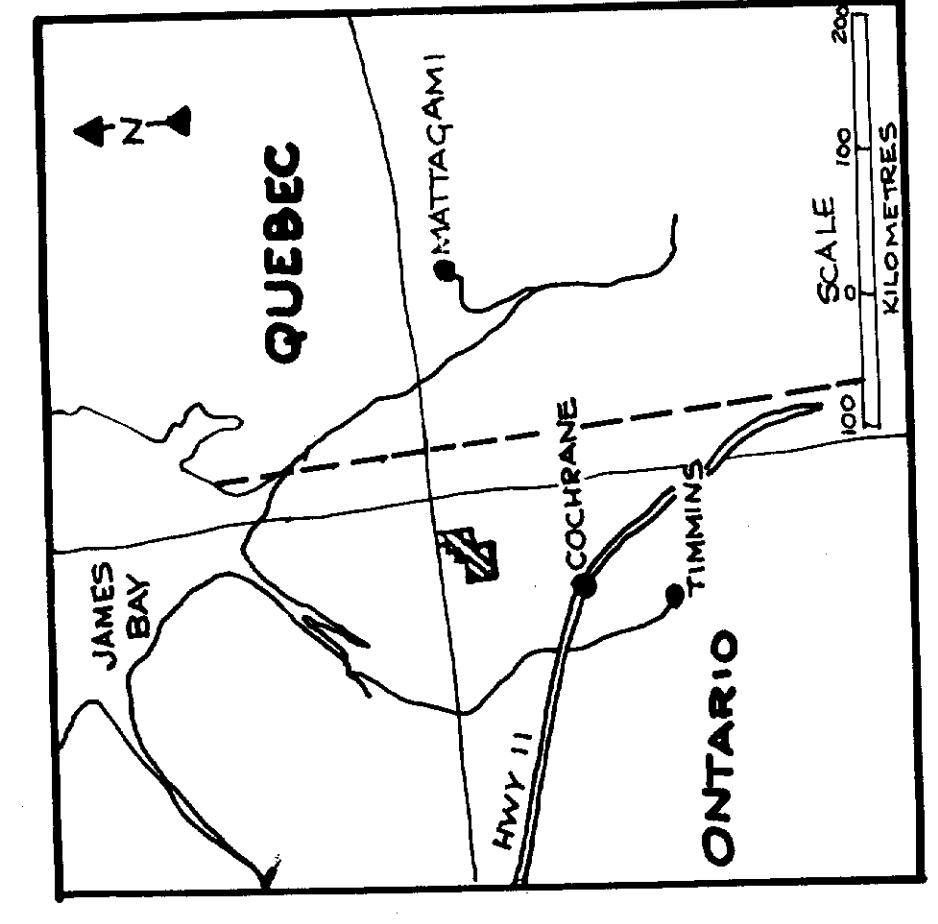
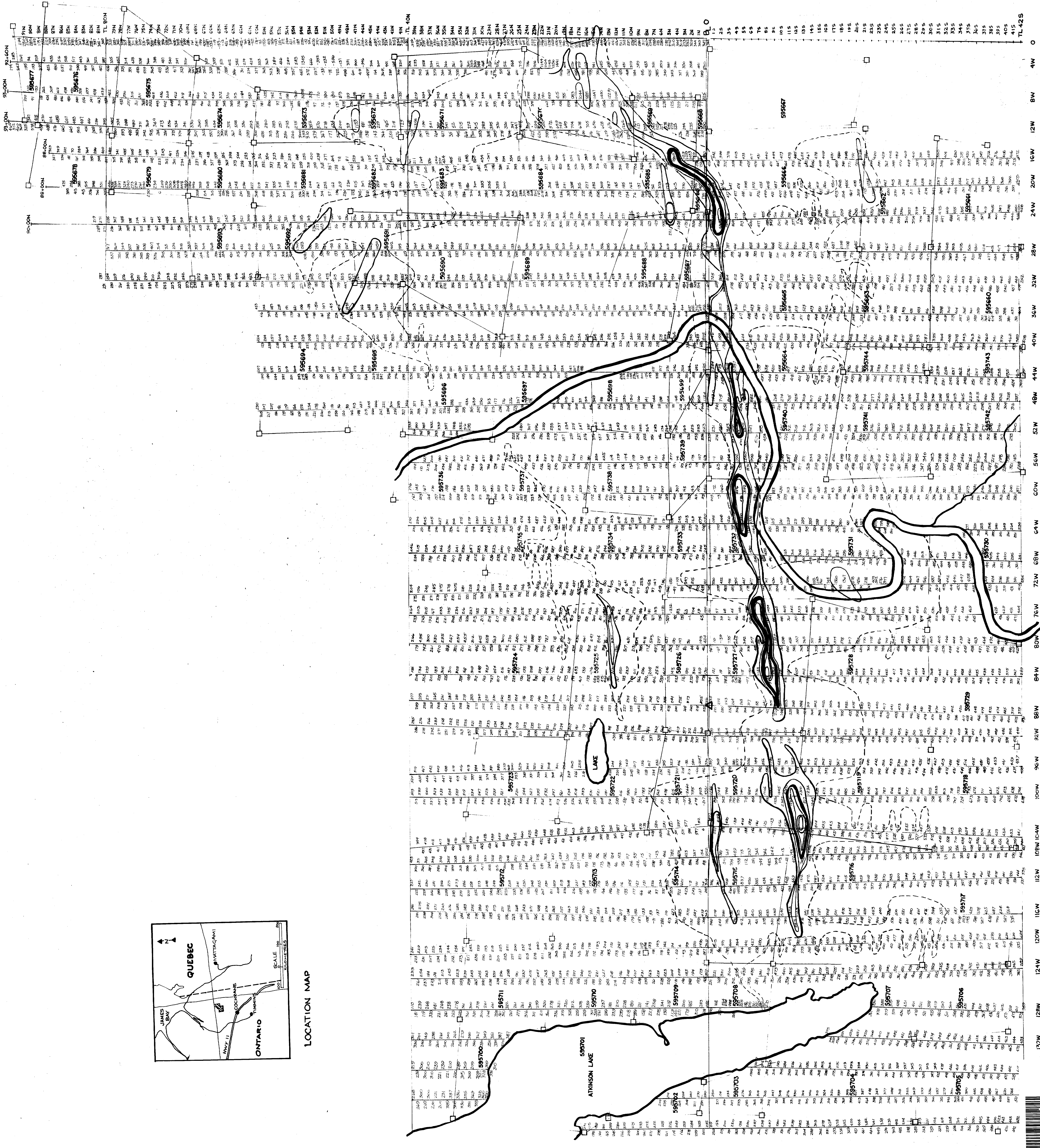

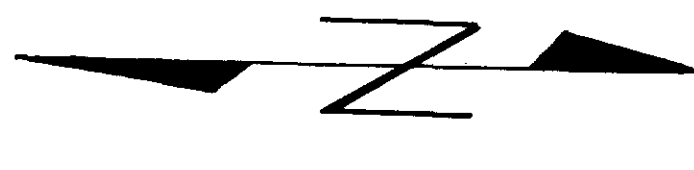

**LEGEND**

- CLAIM POSTS
- 3/4" H.C. CONDUCTORS
- 200 FIELD STRENGTH
- X-X-X DIP ANGLES
- CONTOUR INTERVAL - 20'

VLF (name): CUTLER NAME 17.8 Hz.

ARTIBI - PRICE INC.  
TERRA INNOVATIONS LTD.

DETOUR LAKE AREA  
RADEM SURVEY

DATE: OCT. 26/81  
SCALE: 1" = 400'  
BY: L. KELLY  
CHECKED BY: M. KELLY  
DRAWN BY: M. KELLY  
MR-DL-102

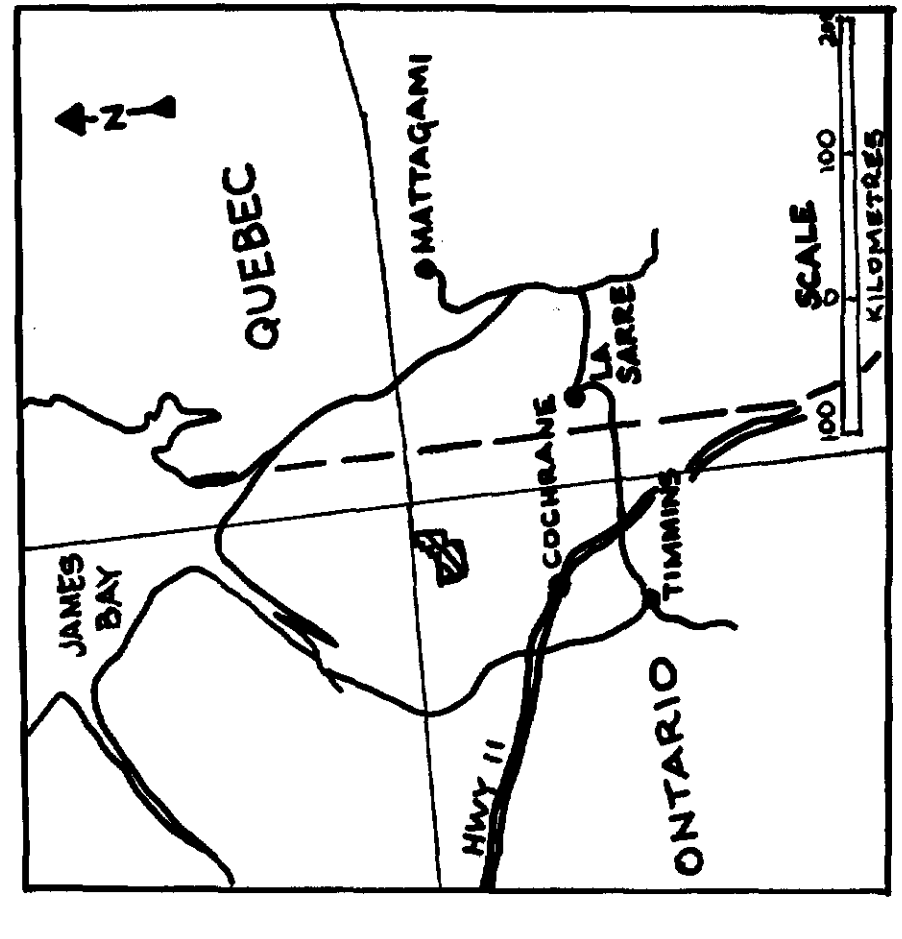
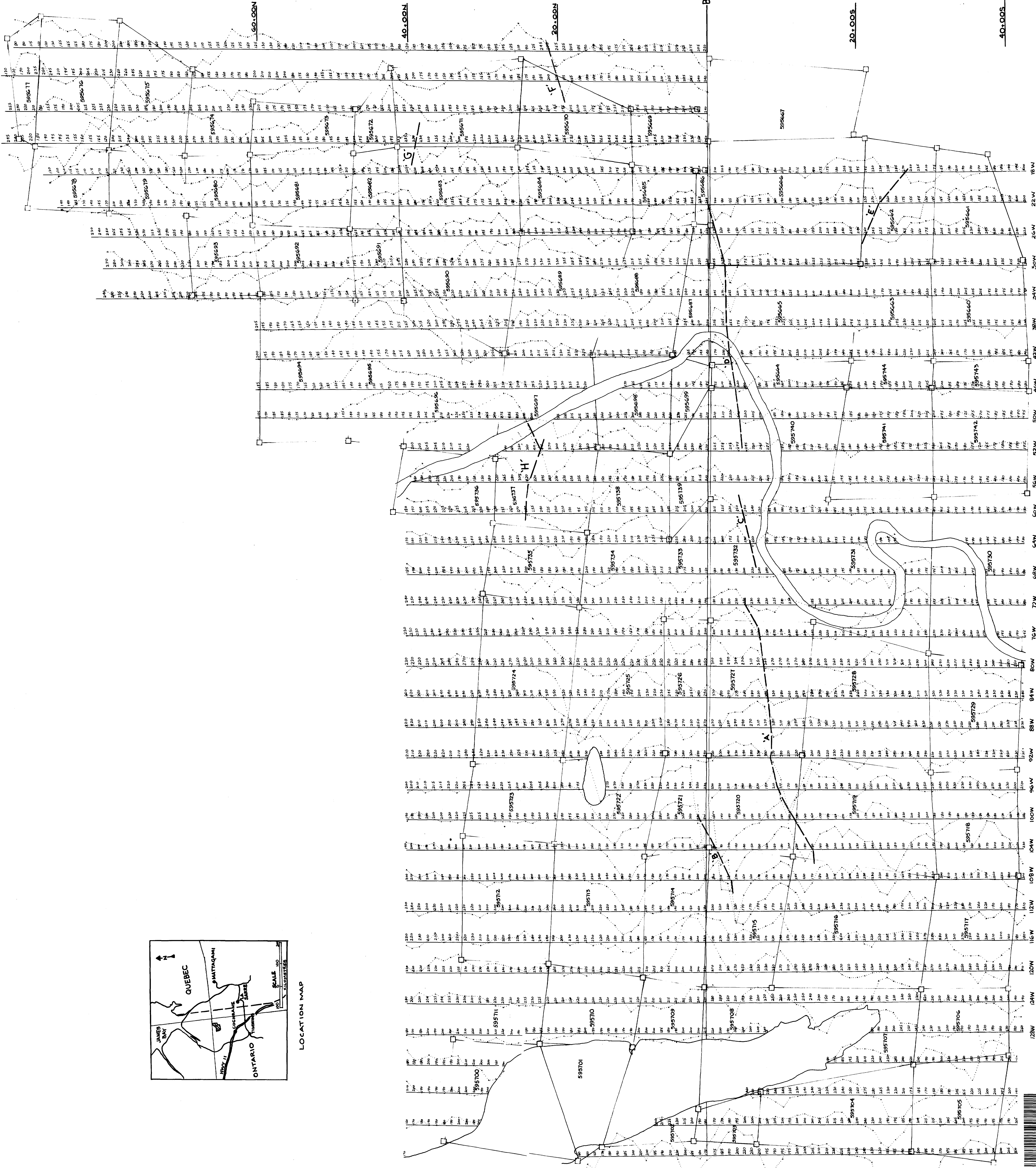

LOCATION MAP