



32E13SE0011 37 ATKINSON LAKE

010

Diamond Drilling

Area Atkinson Lake

Report N<sup>o</sup> 37

Work performed by: Getty Canadian Metals Ltd.

Claim N <sup>o</sup>	Hole N <sup>o</sup>	Footage	Date	Note
P 586528	DL-83-36	647	Nov/83	(1)

Notes: (1) #448-84

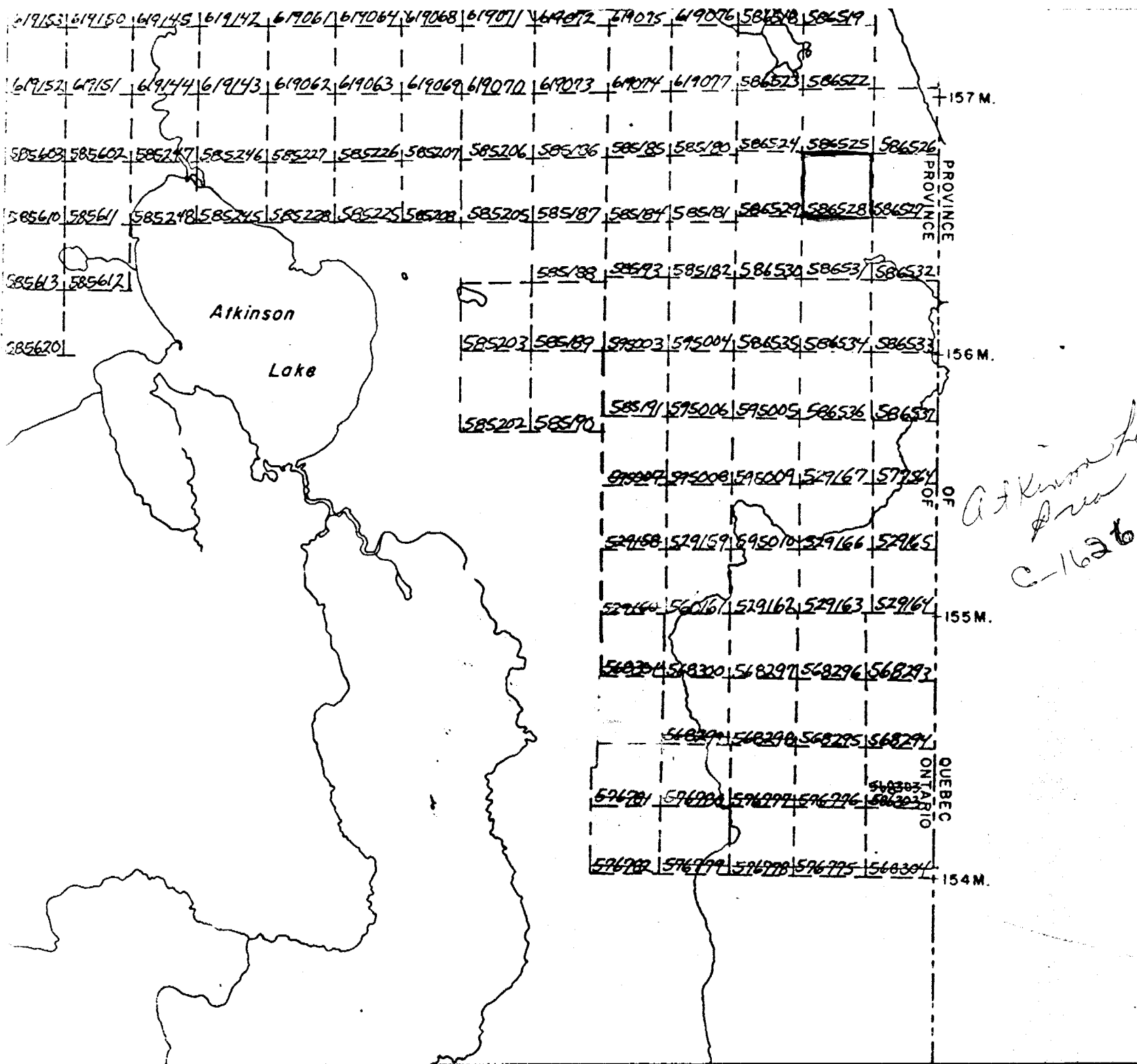

- TRAILS
- SURVEY
- TOWNS
- LOTS, M
- UNSURVEY
- LOT LIM
- PARCEL
- MINING
- RAILWAY
- UTILITY L
- NON-PERE
- FLOODING
- SUBDIVIS
- RESERVAT
- ORIGINAL
- MARSH OR
- MINES
- TRAVERSE

**DISPO**

- TYPE OF
- PATENT, S
- " SU
- " MI
- LEASE, SUR
- " SUR
- " MIN
- LICENCE OF
- ORDER-IN-C
- RESERVAT
- CANCELLED
- SAND & GR

NOTE: MININ  
1913,  
LANDS

SCALE: 1  
FEET

*Atkinson Lake*  
*C-1626*

50'  
49'  
48'  
47'

PROVINCE

OF

QUEBEC  
ONTARIO

157 M.

156 M.

155 M.

154 M.

619153 619150 619145 619142 619061 619064 619068 619071 619072 619075 619076 586518 586519

619152 619151 619144 619143 619062 619063 619069 619070 619073 619074 619077 586523 586522

585603 585602 585247 585246 585227 585226 585207 585206 585196 585185 585180 586524 586525 586526

585610 585611 585248 585245 585228 585225 585208 585205 585187 585184 585181 586529 586528 586527

585613 585612

585188 585193 585182 586530 586531 586532

585620

585203 585189 585003 585004 586539 586534 586533

585202 585190 585191 585006 585005 586536 586537

585009 585008 585009 585167 585164

585158 585159 585010 585166 585165

585164 585167 585162 585163 585161

585284 585280 585297 585296 585293

585291 585290 585275 585271

585281 585280 585279 585276 585273

585272 585279 585278 585275 585274

## GETTY MINES, LIMITED

Hole Number

DL-83-36

## DRILL HOLE LOG

Property.....DEFOUR LAKE.....  
 Location...144 KM. NE. of. Cochrane, Ont.  
 Grid....EAST '0'  
 Latitude...10+25N  
 Departure...141.98 E

Core Size....8.0  
 Elev. Collar.....  
 Bearing.....020°  
 Dip.....-45°  
 Length...197.5  
 Horiz. Trace...155.0m  
 Vert. Trace...125.0m

Starting Date..NOVEMBER 17, 1983  
 Completion Date..NOVEMBER 19, 1983

Date Logged..NOVEMBER 17, 19, 1983  
 Logged by...D. Ruppelham:...

K. Sutterland

## Dip Tests

Depth	Angle	
	Read	Actual
Collar		-45°
30.5	54°	-45°
106.7	-45°	-36°
182.9	-45°	-36°

FROM	TO	DESCRIPTION	SAMPLE NUMBER	METRES		CORE LGTH.	ASSAY			
				FROM	TO		AU (ppm)	CU (ppm)	Zn (ppm)	Ag (ppm)
0	28.2	OVERBURDEN								
28.2	59.2	MAFIC - INTERMEDIATE Volcanic Rock. - the rock is green to grey-green, hard, non-magnetic, and medium-grained - massive - 60% amphibole, 40% plagioclase - 1% disseminated py/po throughout. Locally 1mm-5mm blebs associated with quartz veins. - 2-3% quartz and quartz carbonate veins generally 2mm-8mm wide and oriented 30°-50° to CA. They are regularly spaced at 1-2cm. Concen- tration of quartz-carbonate veins increases at 48m. - minor brecciated zones up to 10cm wide with 1-2% py/po and minor carbonate and chlorite. - randomly oriented fractures generally at a shallow angle to CA.	D00813	30.93	31.43	0.5	42	220	60	1.0
			D00814	42.19	42.69	0.5	42	82	25	0.5
			D00815	49.37	49.87	0.5	42	50	75	1.0
			D00816	49.87	50.37	0.5	42	76	76	1.0
			D00817	50.99	51.49	0.5	42	41	69	0.5



## GETTY MINES, LIMITED

Hole Number

DL-83-36

## DRILL HOLE LOG

FROM	TO	DESCRIPTION	SAMPLE NUMBER	METRES		CORE LGTH	ASSAY			
				FROM	TO		Au (PPM)	Cu (PPM)	Zn (PPM)	Ag (PPM)
		68.10 - 68.5 : weak to moderate conductive zone in felsic tuff, strongly cash-oxidized in places, well-bedded ( $50^{\circ}$ to CA), up to 20% po + py (disseminated), stringers, and semi-massive)								
73.9	75.9	CONDUCTIVE ZONE	D00835	74.07	74.77	0.5	47	110	830	1.5
		- sulfide-bearing metasedimentary rock, light to dark grey, hard, fine-grained, locally magnetic	36	74.77	75.07	0.5	49	140	1300	1.0
		- 30% - 40% graphite throughout.	37	75.07	75.77	0.5	39	100	120	1.0
		- 25% - 30% pyrite, disseminated, veined, and semi-massive. Not more than 5% po present.								
		- carbonate alteration in places, especially along fracture surfaces. Some quartz-carbonate veins present, as at 75.7, not exceeding 2 cm in width. These are sulfide bearing as well.								
		- entire section bedded, $30^{\circ}$ - $40^{\circ}$ to CA.								
		- some non-marginalized bands of black argillite present, as at 75.1 (2-3 cm wide).								
		74.7 - 74.9 : possibly a tuffaceous layer (?) with disseminated sulfides, bedding at $30^{\circ}$ to CA.								
75.9	85.5	BANDED ARGILLITE	D00838	75.77	76.27	0.5	42	120	120	20.5
		- dark grey to black, magnetic, hard, and very fine-grained	39	76.27	76.77	0.5	4	190	350	0.5
		- bedding $50^{\circ}$ to CA.	40	76.77	77.27	0.5	42	120	130	1.0
		- some quartz-carbonate stringers present, concordant with bedding, and not	41	77.27	77.77	0.5	2	190	900	0.5
			42	77.77	78.27	0.5	42	120	200	1.0
			43	78.27	78.77	0.5	42	80	200	1.0
			44	78.77	79.27	0.5	42	220	130	1.0

## GETTY MINES, LIMITED

Hole Number

DL-83-36

## DRILL HOLE LOG

FROM	TO	DESCRIPTION	SAMPLE NUMBER	METRES		CORE LGTH	ASSAY			
				FROM	TO		NO (gms)	CO (gms)	CU (gms)	PPG (gms)
		more than 5mm wide. Some irregular	DCC845	79.77	79.77	0.5	42	75	550	2.5
		veining in turbid areas, as at 77.0.	46	79.77	80.27	0.5	42	89	340	1.0
		- 5-7% po+py, occurring in stringers	47	81.36	81.86	0.5	5	97	810	1.0
		concordant with bedding, and in blebs	48	83.18	83.68	0.5	42	110	610	1.0
		up to 1cm in diameter, and disseminated	49	83.68	84.18	0.5	42	57	220	0.5
		throughout	50	84.18	84.18	0.5	42	58	200	0.5
		78.50 - 79.3: intermediate to felsic	51	84.18	85.18	0.5	2	120	810	0.5
		volcanic rock, very coarse-grained	52	85.18	85.68	0.5	17	320	1300	1.0
		(almost porphyritic), weakly magnetic,								
		light grey, fairly soft, with some								
		carbonate and possibly chlorite								
		alteration. 1-2% disseminated py+po.								
85.5	85.6	TURBID GRAVATIONAL CONTACT								
		- between overlying volcanic rocks and								
		underlying sediments. Shows soft								
		sediment deformation suggesting that								
		the volcanics were deposited on								
		unlithified sediment, implying that								
		tops are downhole.								
85.6	93.3	Intermediate Volcanic Rock	DCC853	85.68	86.18	0.5	4	110	920	1.0
		- light grey to grey-green, fine-grained,	54	88.47	88.97	0.5	3	120	72	0.5
		magnetic, medium hardness.	55	89.46	90.46	0.5	42	110	99	0.5
		- quartz-carbonate veining, 40° to 60°	56	90.89	91.39	0.5	42	120	74	1.0
		in most cases, but can be randomly	57	92.08	92.58	0.5	42	85	70	0.5
		oriented, as at 89.2. Veins are up to								
		5mm wide.								
		- chlorite alteration								
		- 2-3% disseminated po+py.								
		- some areas are blebbed, as at 80.0								
93.3	96.3	Mafic Volcanic Rock	DCC858	94.06	94.56	0.5	42	87	55	1.0
		- dark grey to black, medium hardness,	59	95.83	96.33	0.5	42	190	230	1.0

## GETTY MINES, LIMITED

Hole Number

DL-83-36

## DRILL HOLE LOG

FROM	TO	DESCRIPTION	SAMPLE NUMBER	METRES		CORE LGTH	ASSAY			
				FROM	TO		As (PPS)	Cu (PPM)	Zn (PPM)	Pg (PPM)
		medium-grained, non-magnetic to heavily magnetic - faintly sharp contact with overlying unit - quartz-carbonate veining throughout, with most veins 3mm to 5mm wide, oriented 40° to 60°. Two fracture sets noted at this orientation. There are some randomly oriented fractures as well. - around 95.5 the unit becomes silicified and shows an increased concentration of sulphides; 4-5% disseminated po and 1-2% disseminated py. The rest of the section contains 1-2% disseminated po + py - calcareous alteration increases down the unit, becoming highly carbonatized near the contact with the mines conductive zone.								
96.3	96.7	Minor Conductive Zone - graphitic metamictary rock, magnetic fine-grained, hard, black - sharp upper and lower contacts - up to 40-50% graphite - some bedding noted, however unit is quite tumbled and beds do not have a regular orientation. - 2-3% angular clasts present, with bedding, curving around clasts. - 8-10% po, 8-10% py, disseminated, stringers, and semi-massive.	000860	96.33	96.83	0.5	7	310	2300	1.0
96.7	97.5	Intermediate Tuff - lapilli size, hard, magnetic, light	000861 62	96.83 97.33	97.33 97.83	0.5 0.5	3 2	34 64	6.2 7.50	1.0 1.0

## GETTY MINES, LIMITED

Hole Number

DL-83-36

## DRILL HOLE LOG

FROM	TO	DESCRIPTION	SAMPLE NUMBER	METRES		CORE LGTH	ASSAY			
				FROM	TO		Au (Pb)	Cu (Ppm)	Zn (Ppm)	Ag (Ppm)
		to dark grey. - carbonated throughout - 1-2% py + pc, disseminated throughout - 1mm quartz-carbonate stringers, 20°-30° to CA. - irregular layering, 80-90° to CA.								
97.5	99.0	Miner Connective Zone - as at 96.3-96.7	DC863 64	97.83 98.33	98.33 98.83	0.5 0.5	22 4	69 170	730 130	0.5 1.0
99.0	105.4	Mafic Volcanic Rock - dark grey-green, hard, medium-grained, heavily magnetic. - partially silicified for upper 50 cm, some small areas of silicification occur outward from narrow fractures, as at 99.8. - minor quartz-carbonate stringers through- out, some randomly oriented, but most at 40° to CA. - 1-2% disseminated pc, < 1% disseminated py - bleached blebs of pc (< 1cm wide) occur, as at 101.6. - some chlorite alteration noted, although this is not pervasive. - some carbonate alteration along fracture surfaces.	DC865 66 67 68 69 70	98.83 99.33 99.83 101.43 101.93 105.07	99.33 99.83 100.33 101.43 102.43 105.57	0.5 0.5 0.5 0.5 0.5 0.5	14 22 22 2 4 22	150 120 150 130 130 110	190 160 55 27 18 12	1.5 1.0 0.5 10.5 16.5 0.5
105.4	117.1	Amphibolitized Mafic Volcanic Rock - light to dark grey, moderate hardness, medium-grained, non-magnetic. - contains up to 30-35% amphibole. - gradational upper contact. - some thin (10cm) bands of bleached	DC871 72 73 74 75 76 77	106.30 106.80 110.63 116.72 122.08 131.05 136.90	106.80 107.30 111.13 117.72 122.58 124.55 127.10	0.5 0.5 0.5 0.5 0.5 0.5 0.5	2 22 22 22 14 22 27	150 94 180 58 90 80 100	20 10 16 43 26 34 47	10.5 10.5 10.5 0.5 10.5 0.5 0.5







## GETTY MINES, LIMITED

Hole Number

DL-83-36

## DRILL HOLE LOG

FROM	TO	DESCRIPTION	SAMPLE NUMBER	METRES		CORE LGTH	ASSAY			
				FROM	TO		HU (PPM)	CU (PPM)	Zn (PPM)	Pb (PPM)
		sharp contacts with siltstone - some minor quartz-carbonate stringers concordant with bedding.								
174.7	177.6	INTERMEDIATE Tuff and Epiclastic Sedimentary Rock - light to dark grey tuffaceous units (up to 50 cm wide) interbedded with epiclastic sedimentary material. - tuff is hard (partially silicified?), medium-grained (lapilli size), magnetic, layered (60° to CA). - epiclastic sedimentary rock is light grey with some alternating bands of chloritic / bristly material, medium hardness, magnetic, medium-grained. - upper and lower contacts gradational. 176.7 - 176.9 : minor conductive zone on either side of a 6 cm wide quartz- carbonate vein. Vein is chloritized. the zone on either side of vein is turbid. Vein is oriented 40° to CA.	DC0904	174.99	175.49	0.5	42	68	110	1.0
			05	175.49	175.99	0.5	42	84	240	1.0
			06	175.99	176.49	0.5	42	78	39	1.0
			07	176.49	176.99	0.5	10	61	360	1.0
			08	176.99	177.49	0.5	42	61	210	1.0
177.6	190.7	CONDUCTIVE ZONE - hosted in a combination of interbedded argillaceous meta-sedimentary rock, epiclastic sedimentary rock, and interbedded lapilli tuff. - the entire zone is magnetic. - banding 50° to CA. - carbonate alteration throughout, particularly along fracture surfaces. - these are disseminated, veined and semi-massive sulfides throughout. 10-15% pc, 5-7% pb. Sulfide veins - thin and irregular - to limits in the 180°	DC0909	177.49	177.99	0.5	3	150	760	1.0
			10	177.99	178.49	0.5	2.1	240	1100	1.5
			11	178.49	178.99	0.5	21	330	1700	1.0
			12	178.99	179.49	0.5	33	300	2500	1.0
			13	179.49	179.99	0.5	21	260	1100	1.0
			14	179.99	180.49	0.5	13	220	970	1.0
			15	(ECT)	180.99	0.5	5	98	670	1.0
			16	180.99	181.49	0.5	7	49	980	0.5
			17	181.49	181.99	0.5	8	94	830	0.5
			18	181.99	182.49	0.5	10	140	1000	1.0
			19	182.49	182.99	0.5	27	390	1700	1.5
			20	182.99	183.49	0.5	18	270	3600	1.0
			21	183.49	183.99	0.5	17	200	2600	1.0

## GETTY MINES, LIMITED

Hole Number

DL-83-36

## DRILL HOLE LOG

FROM	TO	DESCRIPTION	SAMPLE NUMBER	METRES		CORE LGTH	ASSAY			
				FROM	TO		H <sub>2</sub> O (cc/g)	CO (cc/g)	Zn (cc/g)	P <sub>2</sub> O <sub>5</sub> (cc/g)
		are oriented 40-50° to CA.	000922	183.99	184.49	0.5	20	390	1600	1.0
		- chlorite alteration noted, particularly	23	184.49	184.99	0.5	22	99	200	1.0
		in epiclastic material.	24	184.99	185.49	0.5	4	340	410	1.0
		- upper and lower contacts gradational	25	185.49	185.99	0.5	4	520	420	1.0
			26	185.99	186.49	0.5	7	350	1800	1.0
190.7	197.5	Intermediate Tuff and Epiclastic Sandstone Back	27	186.49	186.99	0.5	8	480	1500	1.0
		- as in 174.7 - 177.6.	28	186.99	187.49	0.5	8	350	2200	1.5
			29	187.49	187.99	0.5	3	150	420	0.5
197.5		END OF HOLE	30	187.99	188.49	0.5	18	280	1200	1.0
			31	188.49	188.99	0.5	21	460	390	1.5
			32	188.99	189.49	0.5	10	160	250	1.0
			33	189.49	189.99	0.5	7	230	770	1.5
			34	189.99	190.49	0.5	11	220	240	1.0
			35	190.49	190.99	0.5	22	94	48	1.0
			000936	190.99	191.49	0.5	4	45	55	1.0
			37	191.49	191.99	0.5	12	120	71	1.5
			38	191.99	192.49	0.5	22	38	66	1.0
			39	192.49	192.99	0.5	22	140	36	0.5
			40	192.99	193.49	0.5	22	90	47	0.5

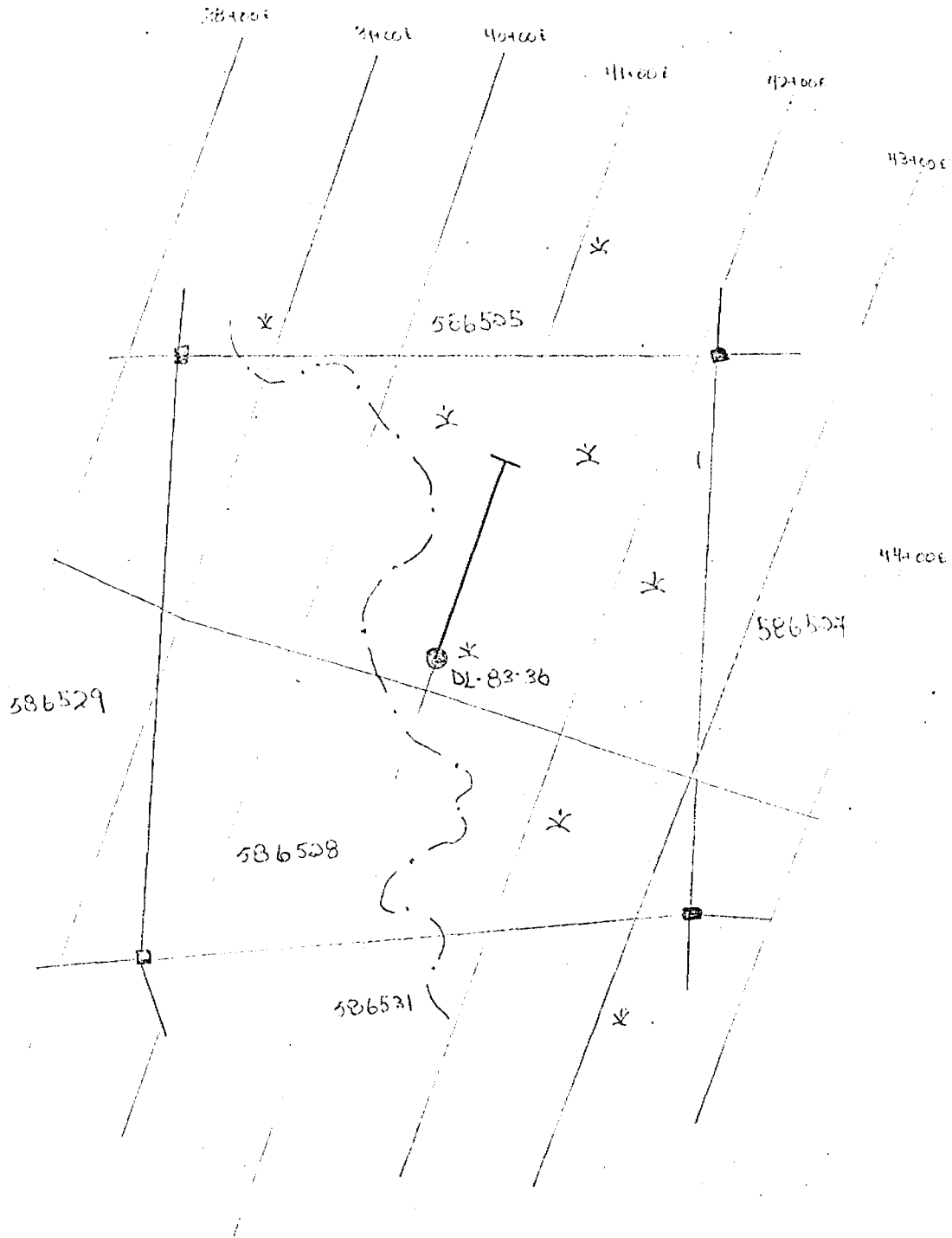

LEGEND

- { SWAMP BOUNDARY
- \* SURVEY P
- CLAIM POST
- ⊕ DPH

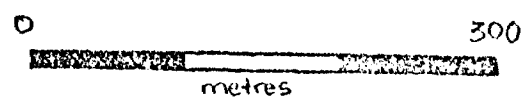

	DRAWN BY: DCR	DATE: OCT 184
	CHECKED BY:	DRAWING NO:
	NIS 396713	SCALE: 1:5000
<b>Getty Canadian Metals, Ltd.</b>		



32E13SE0011 37 ATKINSON LAKE

900

Name and Postal Address of Recorded Holder  
**GETTY CANADIAN METALS LIMITED** *Lower Ottawa Lake Area* | T-890  
 SUITE 1200 - 150 YORK ST., TORONTO, ONTARIO M5H 3S5

Summary of Work Performance and Distribution of Credits

Total Work Days Cr. claimed	Mining Claim			Work Days Cr.	Mining Claim			Work Days Cr.	Mining Claim			Work Days Cr.
	Prefix	Number	Work Days Cr.		Prefix	Number	Work Days Cr.		Prefix	Number	Work Days Cr.	
647												
for Performance of the following work. (Check one only) <ul style="list-style-type: none"> <li><input type="checkbox"/> Manual Work</li> <li><input type="checkbox"/> Shaft Sinking, Drifting or other Lateral Work.</li> <li><input type="checkbox"/> Compressed Air, other Power driven or mechanical equip.</li> <li><input type="checkbox"/> Power Stripping</li> <li><input checked="" type="checkbox"/> Diamond or other Core drilling</li> <li><input type="checkbox"/> Land Survey</li> </ul>												
		See attached (B)										

All the work was performed on Mining Claim(s): **P585564**

Required Information eg: type of equipment, Names, Addresses, etc. (See Table Below)

Bradley Bros.  
98 - 14th Street  
P.O. Box 2367  
Noranda, Quebec  
J9X 5A9

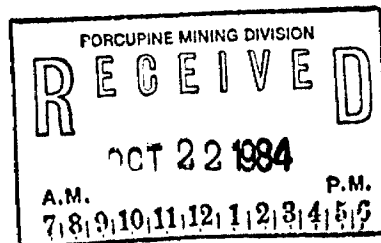
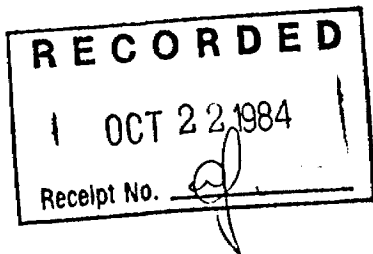
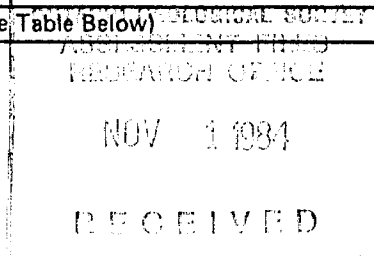

Date of Report: October 18, 1984  
 Recorded Holder Agent (Signature): *K. Sutherland*

Certification Verifying Report of Work

I hereby certify that I have a personal and intimate knowledge of the facts set forth in the Report of Work annexed hereto, having performed the work or witnessed same during and/or after its completion and the annexed report is true.

Name and Postal Address of Person Certifying  
**K.S. Sutherland** c/o Getty Canadian Metals, Limited  
 Toronto, Ont.  
 Suite 1200 - 150 York St. M5H 3S5  
 Date Certified: October 18, 1984  
 Certified by (Signature): *K. Sutherland*

Table of Information/Attachments Required by the Mining Recorder

Type of Work	Specific information per type	Other information (Common to 2 or more types)	Attachments
Manual Work	Nil	Names and addresses of men who performed manual work /operated equipment, together with dates and hours of employment.	Work Sketch: these are required to show the location and extent of work in relation to the nearest claim post.
Shaft Sinking, Drifting or other Lateral Work			
Compressed air, other power driven or mechanical equip.	Type of equipment	Names and addresses of owner or operator together with dates when drilling/stripping done.	
Power Stripping	Type of equipment and amount expended. Note: Proof of actual cost must be submitted within 30 days of recording.		
Diamond or other core drilling	Signed core log showing: footage, diameter of core, number and angles of holes.	Nil	Work Sketch (as above) in duplicate
Land Survey	Name and address of Ontario land surveyer.		Nil

ATTACHMENTS REQUIRED BY MINING RECORDER

FOR  
DIAMOND DRILLING

Submitted By

Getty Canadian Metals, Limited

Drill log and drill hole location map is submitted for drill hole DL-83-36.

Total metreage for the hole is 197.5 m (647 ft) for a total work days credit of 647 days.

A list of claims to which the drill credits are to be applied is attached.

K. S. Sutherland  
Geologist

October 1984  
Toronto, Ontario

(A)

DETOUR LAKE

DRILL HOLE LOCATION TABLE

ATTACHMENT FOR REPORT OF WORK

CLAIM NO.

DRILL HOLE NO.

METREAGE

586528

DL-83-36

197.5



(B)

1 of 2 pages

DETOUR LAKE

20 DAYS DIAMOND DRILLING ASSESSMENT

P 585566  
585565

32 DAYS DIAMOND DRILLING ASSESSMENT

P 585564

DETOUR LAKE

40 DAYS DIAMOND DRILLING ASSESSMENT

P 585557  
585558  
585559  
585579  
585826  
585827  
585828

585574  
585569  
585568  
585567

60 DAYS DIAMOND DRILLING ASSESSMENT

P 585570  
585563

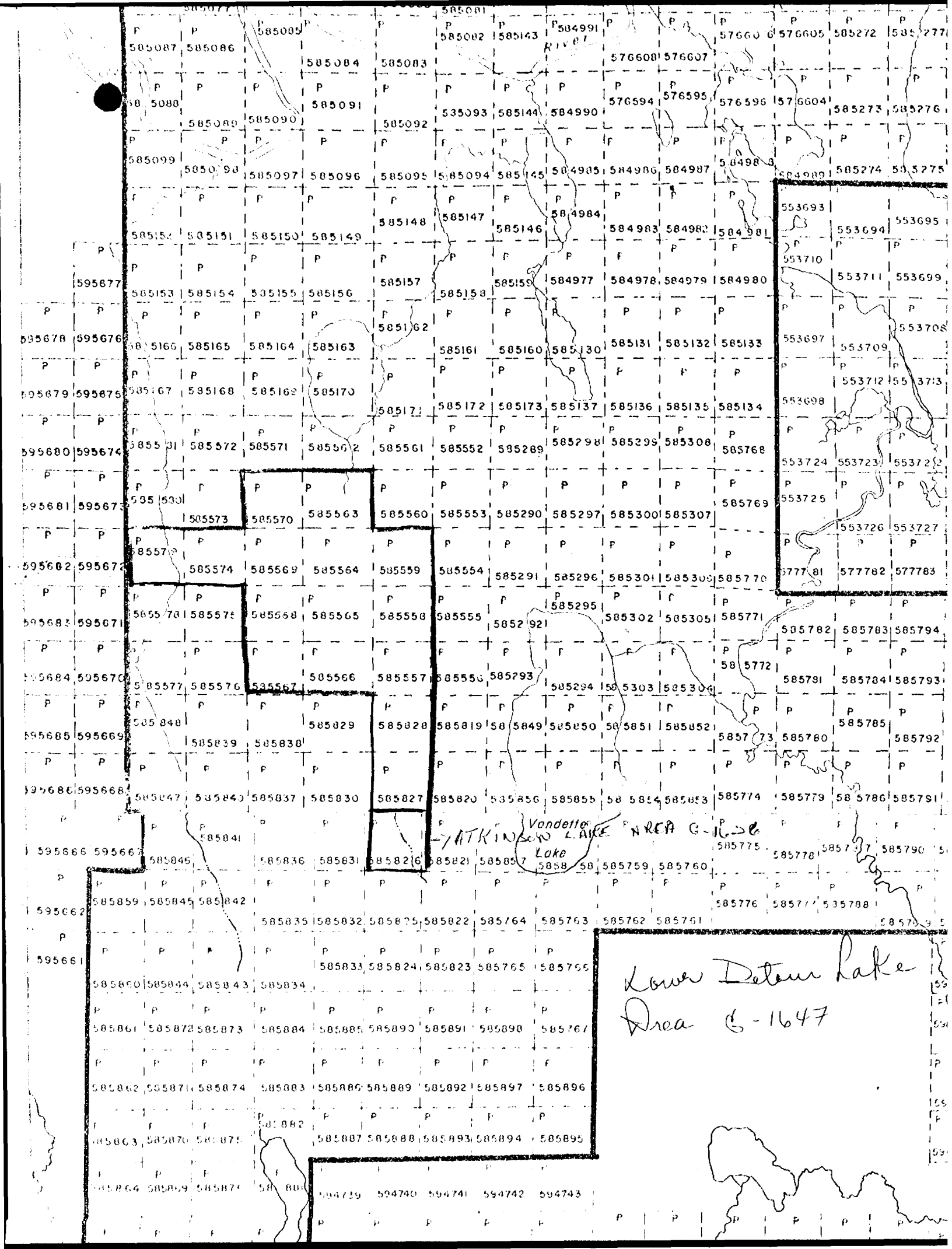

River

Vandette Lake Area  
 Lower Detour Lake Area G-1647

Lower Detour Lake  
 Area G-1647