



32E13SE0013 2.5578 ATKINSON LAKE

010

REPORT ON  
GEOLOGICAL SURVEY  
FOR CLAIMS P 529158 ET AL  
ATKINSON LAKE AREA  
DISTRICT OF COCHRANE  
NORTHEASTERN, ONTARIO  
FOR  
GETTY CANADIAN METALS, LIMITED

**RECEIVED**  
MAY 26 1983  
MINING LANDS SECTION

K.S. Sutherland  
Geologist

Toronto, Ontario  
March, 1983



32E13SE0013 2.5578 ATKINSON LAKE

010C

TABLE OF CONTENTS

<u>DESCRIPTION</u>	<u>PAGE</u>
INTRODUCTION	1
LOCATION AND ACCESS	1
HOLDERS OF PROPERTY	1
EXPLORATION HISTORY AND PREVIOUS WORK	2
GENERAL GEOLOGY	2
TOPOGRAPHY	2
PROPERTY GEOLOGY	2
REFERENCES	4
LIST OF APPENDICES	
APPENDIX A	i
APPENDIX B	ii
APPENDIX C	iii

LIST OF APPENDICES

- APPENDIX A            List of claims covered by  
                         Survey
- APPENDIX B            Field Geology Map of Survey    (In Pocket)  
                         Area, Scale 1:5,000
- APPENDIX C            Qualifications of Author

INTRODUCTION

Getty Canadian Metals, Limited is currently carrying out a gold and base metal exploration programme on its property in the Atkinson Lake area, northeastern Ontario.

This report discusses the results of a detailed geological mapping survey over 207 unpatented mining claims completed by Getty during the 1982 summer field season.

LOCATION AND ACCESS

The survey area consists of 207 unpatented Mining claims in the Porcupine Mining District located 144 km northeast of Cochrane, Ontario (Figure 1). Access to the property is via floatplane from Cochrane. A winter road from La Sarre, Quebec traverses the eastern portion of the survey area.

HOLDERS OF THE PROPERTY

Getty Canadian Metals, Limited,  
150 York Street, Suite 1200,  
Toronto, Ontario.  
M5H 3S5

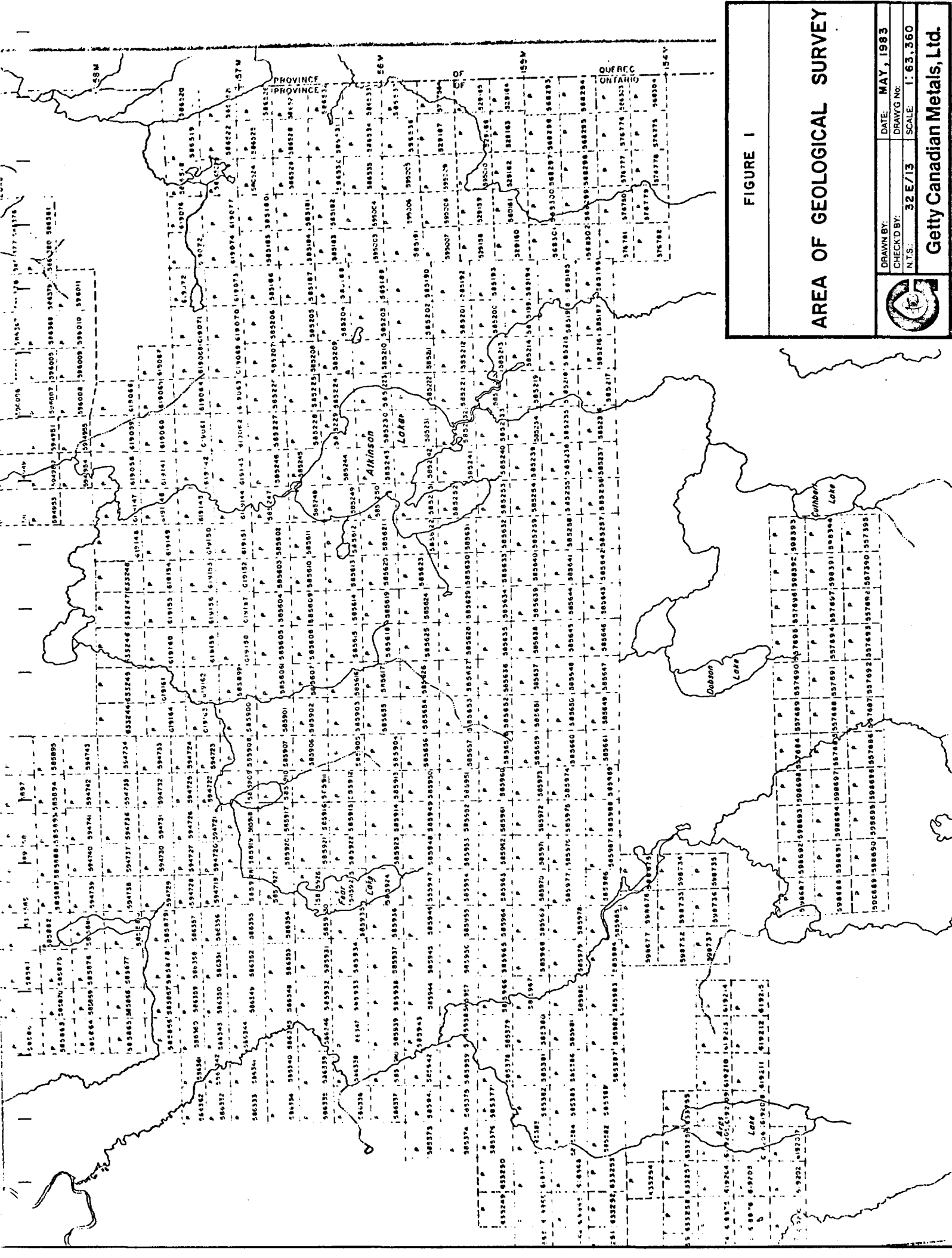

FIGURE I

AREA OF GEOLOGICAL SURVEY



DRAWN BY: DATE: MAY, 1983  
 CHECKED BY: DRAWING NO:  
 N.T.S.: 32 E/13 SCALE: 1" = 63,360

Getty Canadian Metals, Ltd.

## EXPLORATION HISTORY AND PREVIOUS WORK

Mineral exploration activity has been recorded in the Detour area since 1912 when gold was discovered on the Patten River. Discovery of the copper-zinc Normetal mine in Quebec sparked further exploration activity and many companies were actively exploring for base metals during the late 50's, early 60's and early 70's. Discovery of the Dome-Amoco Detour Lake gold deposit (60 MM tons grading 0.11 oz Au/ton) in 1974 initiated a staking rush into the Detour Lake area during the late 70's and many companies are currently exploring for gold, as well as base metals, in this area.

At least 16 diamond drill holes (8,000 ft) are located within the Getty survey area drilled during previous base metal exploration programmes during the early 60's and 70's but many of the drill holes are lacking in sufficient assay data.

## GENERAL GEOLOGY

The Detour Lake project area is underlain by an E-W trending sequence of metavolcanic and metasedimentary rocks which have been intruded by granitic batholiths to the north, south and west. The rocks are Archean in age and form part of the north central portion of the Abitibi Greenstone Belt of the Superior province. The rocks have undergone upper greenschist to amphibolite facies metamorphism. Outcrop exposure is <10% and the area is covered by Pleistocene deposits (sandy till, outwash gravels and glacial fluvial eskers) averaging 15-30 m thick.

## TOPOGRAPHY

The survey area is flat lying, drainage is poor and much of area is covered by muskeg swamps of the Hudson Bay Lowlands (Johns).

## PROPERTY GEOLOGY

Detailed geological mapping, at a scale of 1:5,000, was carried out over the gridded survey area during the 1982 field season; June to August (Appendix B). The survey area consists of 435 line km of two overlapping grids: Grid 'A' (west) and Grid 'B' (east) with cross lines oriented 340° and 020° respectively.

Outcrop exposure is less than 5% and most of the area is covered by Pleistocene deposits (glacial till, eskers), swamps and small lakes. Vegetation consists of spruce and tamarack.

A camp was established at the north end of Atkinson Lake and the 435 kms of grid lines were accessible on foot except the eastern and western extensions of the grid which were accessed by helicopter.

The geology of the property consists of amphibolitized mafic volcanic rocks with minor exposures of granodiorite that appear to intrude the mafic volcanic rocks to the south. No zones of mineralization are exposed on surface in the survey area.

#### Mafic Metavolcanic Rocks

The mafic metavolcanic rocks are fine to coarse grained, green black on the fresh surface and grey brown on the weathered surface, medium hard and locally magnetic. Rock mineralogy consists of 50-60% black subhedral crystals of amphibole, 30-40% white anhedral feldspar/plagioclase crystals, 5% biotite and 1% pyrite. Magnetite is present up to 10% in some rock exposures. The rocks are well foliated in an east-west direction and show strong alignment of amphibole crystals. The mafic volcanic rocks are coarser grained and appear to be of a higher grade of metamorphism in proximity to the granodiorite intrusion. Minor quartz rich veins, which are 1 cm - 10 cm wide and show no dominant orientation, are present in some exposures but carry no accessory mineralization.

Whole rock analyses were completed on 7 rock samples. The results were plotted using the Jensen cation plot and indicate the rocks are iron-rich tholeiites.

#### Felsic Intrusive Rocks

The felsic intrusive rocks (granodiorite/quartz monzonite in composition) are medium to coarse grained, pink/white, hard and non-magnetic. Mineralogy consists predominantly of feldspar and quartz with minor amphibole, biotite and chlorite. The rocks are exposed west of Atkinson Lake in the southern area of the grid and have intruded the mafic metavolcanic rocks.

*Karen Sutherland*

**RECEIVED**

AUG 3 1983

MINING LANDS SECTION

REFERENCES

Brereton, W.E., 1981; Report on an Airborne Magnetic Survey  
Detour Lake Area Porcupine Mining Division  
Ontario for Getty Canadian Metals, Limited  
(Assessment Files OGS).

Johns, G.W., 1979; Geology of the Detour Burntbush Area,  
District of Cochrane OFR 5279.



APPENDIX A

List of claims covered by Survey



**GEOPHYSICAL - GEOLOGICAL - GEOCHEMICAL  
TECHNICAL DATA STATEMENT**

**TO BE ATTACHED AS AN APPENDIX TO TECHNICAL REPORT  
FACTS SHOWN HERE NEED NOT BE REPEATED IN REPORT  
TECHNICAL REPORT MUST CONTAIN INTERPRETATION, CONCLUSIONS ETC.**

Type of Survey(s) Geological

Township or Area Atkinson Lake Area

Claim Holder(s) Getty Canadian Metals, Ltd.  
1200 - 150 York St. Toronto

Survey Company N/A

Author of Report K.S. Sutherland

Address of Author as above

Covering Dates of Survey June to August 1982  
(linecutting to office)

Total Miles of Line Cut 435 line kms

**MINING CLAIMS TRAVERSED**  
List numerically

(prefix) (number)

see attached list

**SPECIAL PROVISIONS  
CREDITS REQUESTED**

ENTER 40 days (includes  
line cutting) for first  
survey.

ENTER 20 days for each  
additional survey using  
same grid.

**DAYS  
per claim**

Geophysical

-Electromagnetic \_\_\_\_\_

-Magnetometer \_\_\_\_\_

-Radiometric \_\_\_\_\_

-Other \_\_\_\_\_

Geological 40

Geochemical \_\_\_\_\_

**AIRBORNE CREDITS** (Special provision credits do not apply to airborne surveys)

Magnetometer \_\_\_\_\_ Electromagnetic \_\_\_\_\_ Radiometric \_\_\_\_\_  
(enter days per claim)

DATE: May 17, 1983 SIGNATURE: K. Sutherland  
Author of Report or Agent

Res. Geol. \_\_\_\_\_ Qualifications \_\_\_\_\_

**Previous Surveys**

File No.	Type	Date	Claim Holder

**TOTAL CLAIMS** 222

If space insufficient, attach list

OFFICE USE ONLY



Ministry of Natural Resources

Report of Work (Geophysical, Geological, Geochemical and Expenditures)

Instructions: - Please type or print. - If number of mining claims traversed exceeds space on this form, attach a list. Note: - Only days credits calculated in the "Expenditures" section may be entered in the "Expend. Days Cr." columns. - Do not use shaded areas below.

The Mining Act

Form header section containing: Type of Survey(s) Geological, Township or Area Atkinson Lake Area, Claim Holder(s) Getty Canadian Metals Ltd., Prospector's Licence No. T-890, Address 1200 - 150 York St., Toronto, Ontario M5H 3S5, Survey Company Getty Canadian Metals, Ltd., Date of Survey (from & to) 06 82 to 08 82, Total miles of line cut 270 miles, Name and Address of Author (of Geo-Technical report) Karen Sutherland 1200 - 150 York St., Toronto

Credits Requested per Each Claim in Columns at right

Table with 3 columns: Special Provisions, Geophysical/Geological/Geochemical, Days per Claim. Includes rows for first survey (40 days), additional surveys (20 days), Man Days, and Airborne Credits.

Mining Claims Traversed (List in numerical sequence)

Large table for listing mining claims with columns: Mining Claim Prefix, Mining Claim Number, Expend. Days Cr., Mining Claim Prefix, Mining Claim Number, Expend. Days Cr.

Expenditures (excludes power stripping)

Form section for expenditures including: Type of Work Performed, Performed on Claim(s), Calculation of Expenditure Days Credits (Total Expenditures / 15 = Total Days Credits), and Instructions.

Total number of mining claims covered by this report of work. 222

For Office Use Only section with fields: Total Days Cr. Recorded, Date Recorded, Mining Recorder, Date Approved as Recorded, Branch Director.

Date April 15, 1983, Recorder's Name/Signature Karen Sutherland

Certification Verifying Report of Work

I hereby certify that I have a personal and intimate knowledge of the facts set forth in the Report of Work annexed hereto, having performed the work or witnessed same during and/or after its completion and the annexed report is true.

Name and Postal Address of Person Certifying: Karen Sutherland, c/o Getty Canadian Metals Ltd., 1200 - 150 York St. Toronto, Ontario M5H 3S5. Date Certified April 15, 1983, Certified by Signature K. Sutherland

40 days Geological assessment (Special Provisions): 222 claims (cont)

P619141  
P619142  
P619143  
P619144  
P619145  
P619146  
P619147  
P619148  
P619149  
P619150  
P619151  
P619152  
P619153  
P619154  
P619155  
P619156  
P619157  
P619158  
P619159  
P619160  
P619161  
P619162  
P619163  
P619164

P633244  
P633245  
P633246  
P633247  
P633248

APPENDIX B

Field Geology Map  
Scale 1:5,000

(5 map sheets)

APPENDIX C

Qualifications of Author

VITAE

Name: Karen Sutherland

Date of Birth: June 18, 1957  
Toronto, Ontario

Education: BSc (Honours) 1980  
Queen's University 1976-1980

Membership: Canadian Institute of Mining and  
Metallurgy (Toronto Branch)

Prospectors and Developers Association

Work Experience: 1980-1981 Mayman Exploration Services  
(on contract to Getty Mines Ltd.)  
Northwestern Ontario,  
Northeastern Ontario.

1981-1983 Getty Mines Limited  
Northwestern Ontario,  
Northeastern Ontario.

40 days Geological assessment (Special Provisions): 222 claims

P529158	P585244	P585916	P586354
P529159	P585245	P585917	P586355
P529160	P585246	P585918	
P529161	P585247	P585919	P586518
P529162	P585248	P585920	P586519
P529163	P585249	P585921	P586520
P529164		P585922	P586521
P529165	P585602	P585923	P586522
P529166	P585603	P585924	P586523
P529167	P585604	P585925	P586524
	P585605	P585926	P586525
P568293	P585606	P585927	P586526
P568294	P585607	P585928	P586527
P568295	P585608		P586528
P568296	P585609	P585930	P586529
P568297	P585610	P585931	P586530
P568298	P585611	P585932	P586531
P568299	P585612	P585933	P586532
P568300	P585613	P585934	P586533
P568301	P585614	P585935	P586534
P568302	P585615	P585936	P586535
	P585616	P585937	P586536
P577564	P585617	P585938	P586537
	P585618	P585939	
P585180	P585619		P595003
P585181	P585620	P585943	P595004
P585182		P585944	P595005
P585183		P585945	P595006
P585184	P585626	P585946	P595007
P585185		P585947	P595008
P585186	P585653	P585948	P595009
P585187	P585654	P585949	P595010
P585188	P585655	P585950	
P585189	P585656	P585951	P619058
P585190	P585657	P585952	P619059
P585191		P585953	P619060
P585192	P585899	P585954	P619061
	P585900	P585955	P619062
P585202	P585901	P585956	P619063
P585203	P585902	P585957	P619064
P585204	P585903		P619065
P585205	P585904	P585961	P619066
P585206	P585905	P585962	P619067
P585207	P585906	P585963	P619068
P585208	P585907	P585964	P619069
P585209	P585908	P585965	P619070
	P585909	P585966	P619071
P585224	P585910		P619072
P585225	P585911	P585968	P619073
P585226	P585912		P619074
P585227	P585913		P619075
P585228	P585914	P586352	P619076
P585229	P585915	P586353	P619077





40 days Geological assessment (Special Provisions): 222 claims

P529158	P585244	P585916	P586354
P529159	P585245	P585917	P586355
P529160	P585246	P585918	
P529161	P585247	P585919	P586518
P529162	P585248	P585920	P586519
P529163	P585249	P585921	P586520
P529164		P585922	P586521
P529165	P585602	P585923	P586522
P529166	P585603	P585924	P586523
P529167	P585604	P585925	P586524
	P585605	P585926	P586525
P568293	P585606	P585927	P586526
P568294	P585607	P585928	P586527
P568295	P585608		P586528
P568296	P585609	P585930	P586529
P568297	P585610	P585931	P586530
P568298	P585611	P585932	P586531
P568299	P585612	P585933	P586532
P568300	P585613	P585934	P586533
P568301	P585614	P585935	P586534
P568302	P585615	P585936	P586535
	P585616	P585937	P586536
P577564	P585617	P585938	P586537
	P585618	P585939	
P585180	P585619		P595003
P585181	P585620	P585943	P595004
P585182		P585944	P595005
P585183		P585945	P595006
P585184	P585626	P585946	P595007
P585185		P585947	P595008
P585186	P585653	P585948	P595009
P585187	P585654	P585949	P595010
P585188	P585655	P585950	
P585189	P585656	P585951	P619058
P585190	P585657	P585952	P619059
P585191		P585953	P619060
P585192	P585899	P585954	P619061
	P585900	P585955	P619062
P585202	P585901	P585956	P619063
P585203	P585902	P585957	P619064
P585204	P585903		P619065
P585205	P585904	P585961	P619066
P585206	P585905	P585962	P619067
P585207	P585906	P585963	P619068
P585208	P585907	P585964	P619069
P585209	P585908	P585965	P619070
	P585909	P585966	P619071
P585224	P585910		P619072
P585225	P585911	P585968	P619073
P585226	P585912		P619074
P585227	P585913		P619075
P585228	P585914	P586352	P619076
P585229	P585915	P586353	P619077

40 days Geological assessment (Special Provisions): 222 claims (cont'd)

P619141  
P619142  
P619143  
P619144  
P619145  
P619146  
P619147  
P619148  
P619149  
P619150  
P619151  
P619152  
P619153  
P619154  
P619155  
P619156  
P619157  
P619158  
P619159  
P619160  
P619161  
P619162  
P619163  
P619164

P633244  
P633245  
P633246  
P633247  
P633248

Recorded Holder **GETTY CANADIAN METALS LIMITED**

Township or Area **ATKINSON LAKE**

Type of survey and number of Assessment days credit per claim	Mining Claims Assessed	
<b>Geophysical</b>		
Electromagnetic _____ days	P 529158 to 67 incl.	
	568293 to 301 incl	
Magnetometer _____ days	577564	
	585180 to 92 incl	
Radiometric _____ days	585202 to 09 incl	
	585224 to 29 incl	
Induced polarization _____ days	585245 to 48 incl.	
	585602 to 20 incl	
Other _____ days	585626	
	585653 to 57 incl	586352 to 55 incl
Section 77 (19) See "Mining Claims Assessed" column	585899 to 909 incl	586518-19
	585911 to 23 incl	586522 to 37 incl
Geological _____ 40 _____ days	585926 to 28 incl	595003 to 10 incl
	585930 to 39 incl	619058 to 77 incl
Geochemical _____ days	585943 to 57 incl	619141 to 64 incl
	585961 to 66 incl	633244 to 48 incl
	585968	
Man days <input type="checkbox"/> Airborne <input type="checkbox"/>		
Special provision <input checked="" type="checkbox"/> Ground <input checked="" type="checkbox"/>		
<input checked="" type="checkbox"/> Credits have been reduced because of partial coverage of claims.		
<input type="checkbox"/> Credits have been reduced because of corrections to work dates and figures of applicant.		

**Special credits under section 77 (16) for the following mining claims**

20 days Geological

P 568302                      586520-21  
 585249  
 585910  
 585924-25

**No credits have been allowed for the following mining claims**

not sufficiently covered by the survey       Insufficient technical data filed

P 585244



June 28/83.

Mining Lands Comments

- show map area with those offices  
present? ↑  
cover is shown rather sketchy  
& more could be shown.  
Approved.

To: Geophysics

Comments

Approved     Wish to see again with corrections    Date    Signature

To: Geology - Expenditures *Mr. Kustra.*

Comments

Approved     Wish to see again with corrections    Date *July 21/83*    Signature *C. Kustra*

To: Geochemistry

Comments

*L.D.*

Approved     Wish to see again with corrections    Date    Signature

To: Mining Lands Section, Room 6462, Whitney Block. (Tel: 5-1380)

July 29, 1983

2.5578

Getty Canadian Metals Ltd.  
1200 - 150 York Street  
Toronto, Ontario  
M5H 3S5

Attention: K. Sutherland

Dear Sirs:

RE: Geological Survey Submitted on Mining Claims P 529158 et al  
in the Area of Atkinson Lake

---

Enclosed is the final page of the report, in duplicate, for the above-mentioned survey. Please have K. Sutherland, the author of the report, sign each page and return them to this office.

For further information, please contact Mr. F.W. Matthews at 416/965-1380.

Yours very truly,

E.F. Anderson  
Director  
Land Management Branch

Whitney Block, Room 6450  
Queen's Park  
Toronto, Ontario  
M7A 1W3  
Phone: 416/965-1380

R. Pichette:nfc

Encl.

cc: Mining Recorder  
Timmins, Ontario

#118 P529158

2.5578

1983 05 30

Mr. William L. Good  
Mining Recorder  
Ministry of Natural Resources  
60 Wilson Avenue  
Timmins, Ontario  
P4N 2S7

Dear Sir:

We have received reports and maps for Geological survey submitted under Special Provisions (credit for Performance and Coverage) on Mining Claims P529158 et al in the Area of Atkinson Lake.

This material will be examined and assessed and a statement of assessment work credits will be issued.

Yours very truly,

E.F. Anderson  
Director  
Land Management Branch

Whitney Block, Room 6450  
Queen's Park  
Toronto, Ontario  
M7A 1W3  
Phone: 416/965-1380

A. Barr: mc

cc: Getty Canadian Metals Ltd.  
1200-150 York Street  
Toronto, Ontario  
M5H 3S5  
Attention: Karen Sutherland



Getty Canadian Metals, Limited | Suite 1200, 150 York Street, Toronto, Ontario M5H 3S5 • (416) 863-0487

---

May 19, 1983

**RECEIVED**

**MAY 26 1983**

**MINING LANDS SECTION**

Mr. F. Matthews, Supervisor  
Projects Section  
Ministry of Natural Resources  
Whitney Block, Room 1617  
Toronto, Ontario  
M7A 1X1

Dear Mr. Matthews:

Enclosed please find two (2) copies of the Technical Report submitted for assessment credit for claims P529158 et al in the Atkinson Lake Area, northeastern Ontario.

I trust you will find the enclosed to be in order.

Would you please acknowledge receipt of these reports.

Yours sincerely,

GETTY CANADIAN METALS, LIMITED

Karen Sutherland  
Geologist

KS:es

Encls.





Getty Canadian Metals, Limited | Suite 1200, 150 York Street, Toronto, Ontario M5H 3S5 • (416) 863-0487

---

August 02, 1983.

Your file: 2.5578.

Mr. E.F. Anderson  
Director  
Land Management Branch  
Whitney Block, Room 6450  
Queen's Park,  
Toronto, Ontario  
M7A 1W3

Dear Sir,

Re: Geological Survey Submitted on Mining Claims P 529158 et al  
in the Area of Atkinson Lake

With reference to your letter dated July 29, 1983, we enclose herewith the final page of the report, in duplicate, duly signed by the author, as requested.

Yours truly,

Karen Sutherland  
Geologist

/nb  
Encl: (2)

**RECEIVED**

AUG 3 1983

**MINING LANDS SECTION**

2.5578

2.5578

1983 09 21

Mr. William L. Good  
Mining Recorder  
Ministry of Natural Resources  
60 Wilson Avenue  
Timmins, Ontario  
P4N 2S7

Dear Sir:

RE: Geological Survey on Mining Claims P 529158 et al  
in the Area of Atkinson Lake

---

The Geological Survey assessment work credits as listed with my Notice of Intent dated August 22, 1983, have been approved as of the above date.

Please inform the recorded holder of these mining claims and so indicate on your records.

Yours very truly,

E.F. Anderson'  
Director  
Land Management Branch

Whitney Block, Room 6450  
Queen's Park  
Toronto, Ontario  
M7A 1W3  
Phone: (416)965-1380

D. Kinvig:mcc

cc: Getty Canadian Metals Ltd  
Suite 1200  
150 York Street  
Toronto, Ontario  
M5H 3S5

~~cc: Resident Geologist  
Timmins, Ontario~~



Sept 15, 1983

Your file:

.1983 08 22

Our file: 2.5578

Mining Recorder  
Ministry of Natural Resources  
60 Wilson Avenue  
Timmins, Ontario  
P4N 2S7

Dear Sir:

Enclosed are two copies of a Notice of Intent with statements listing a reduced rate of assessment work credits to be allowed for a technical survey. Please forward one copy to the recorded holder of the claims and retain the other. In approximately fifteen days from the above date, a final letter of approval of these credits will be sent to you. On receipt of the approval letter, you may then change the work entries on the claim record sheets.

For further information, if required, please contact Mr. F.W. Matthews at 416/965-1380.

Yours very truly,

E.F. Anderson  
Director  
Land Management Branch

Whitney Block, Room 6450  
Queen's Park  
Toronto, Ontario  
M7A 1W3  
Phone: 416/965-1316

*JK*  
D. Kinvig:sc

Encls:

cc: Getty Canadian Metals Ltd  
Toronto, Ontario  
Attn: K. Sutherland.

cc: Mr. G.H. Ferguson  
Mining & Lands Commissioner  
Toronto, Ontario

✓ FILE



Ministry of  
Natural  
Resources

## Notice of Intent for Technical Reports

An examination of your survey report indicates that the requirements of The Ontario Mining Act have not been fully met to warrant maximum assessment work credits. This notice is merely a warning that you will not be allowed the number of assessment work days credits that you expected and also that in approximately 15 days from the above date, the mining recorder will be authorized to change the entries on his record sheets to agree with the enclosed statement. Please note that until such time as the recorder actually changes the entry on the record sheet, the status of the claim remains unchanged.

If you are of the opinion that these changes by the mining recorder will jeopardize your claims, you may during the next fifteen days apply to the Mining and Lands Commissioner for an extension of time. Abstracts should be sent with your application.

If the reduced rate of credits does not jeopardize the status of the claims then you need not seek relief from the Mining and Lands Commissioner and this Notice of Intent may be disregarded.

If your survey was submitted and assessed under the "Special Provision-Performance and Coverage" method and you are of the opinion that a re-appraisal under the "Man-days" method would result in the approval of a greater number of days credit per claim, you may, within the said fifteen day period, submit assessment work breakdowns listing the employees names, addresses and the dates and hours they worked. The new work breakdowns should be submitted direct to the Lands Management Branch, Toronto. The report will be re-assessed and a new statement of credits based on actual days worked will be issued.

LOWER DETOUR LAKE G-1647

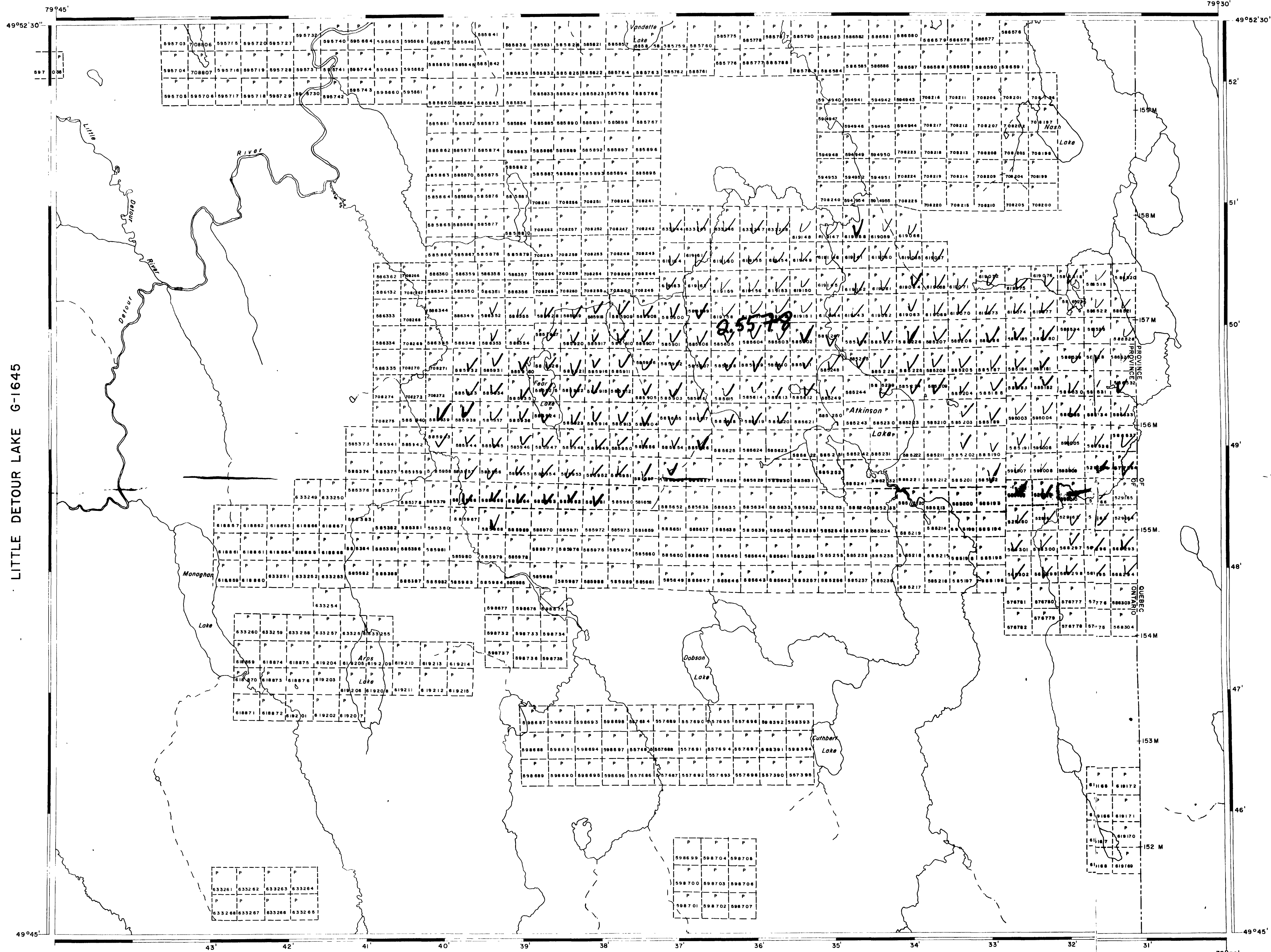

REFERENCES

- AREAS WITHDRAWN FROM DISPOSITION  
 M.R.O. - MINING RIGHTS ONLY  
 S.R.O. - SURFACE RIGHTS ONLY  
 M.+S. - MINING AND SURFACE RIGHTS
- | Description | Order No. | Date | Disposition | File |
|-------------|-----------|------|-------------|------|
|             |           |      |             |      |

DATE OF ISSUE  
 AUG - 5 1983  
 Ministry of Natural Resources  
 TORONTO

LEGEND

- HIGHWAY AND ROUTE No.
- OTHER ROADS
- TRAILS
- SURVEYED LINES:  
 TOWNSHIPS, BASE LINES, ETC.
- LOTS, MINING CLAIMS, PARCELS, ETC.
- UNSURVEYED LINES:  
 LOT LINES
- PARCEL BOUNDARY
- MINING CLAIMS ETC.
- RAILWAY AND RIGHT OF WAY
- UTILITY LINES
- NON-PERENNIAL STREAM
- FLOODING OR FLOODING RIGHTS
- SUBDIVISION OR COMPOSITE PLAN
- RESERVATIONS
- ORIGINAL SHORELINE
- MARSH OR MUSKEG
- MINES
- TRAVERSE MONUMENT

DISPOSITION OF CROWN LANDS

TYPE OF DOCUMENT	SYMBOL
PATENT, SURFACE & MINING RIGHTS	
" SURFACE RIGHTS ONLY	
" MINING RIGHTS ONLY	
LEASE, SURFACE & MINING RIGHTS	
" SURFACE RIGHTS ONLY	
" MINING RIGHTS ONLY	
LICENCE OF OCCUPATION	
ORDER-IN-COUNCIL	
RESERVATION	
CANCELLED	
SAND & GRAVEL	

NOTE: MINING RIGHTS IN PARCELS PATENTED PRIOR TO MAY 6, 1913, VESTED IN ORIGINAL PATENTEE BY THE PUBLIC LANDS ACT, R.S.O. 1970, CHAP. 380, SEC. 63, SUBSEC. 1

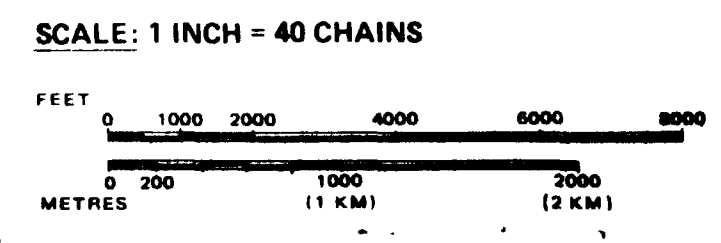

AREA  
**ATKINSON LAKE**  
 M.N.R. ADMINISTRATIVE DISTRICT  
 COCHRANE  
 MINING DIVISION  
 PORCUPINE  
 LAND TITLES / REGISTRY DIVISION  
 COCHRANE



Date: DECEMBER 1982  
 Number: **G-1626**

KINGROY LAKE G-1643

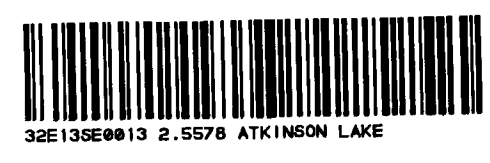

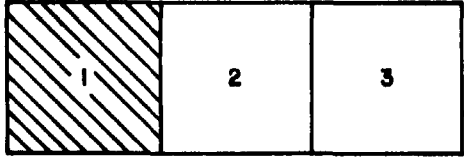
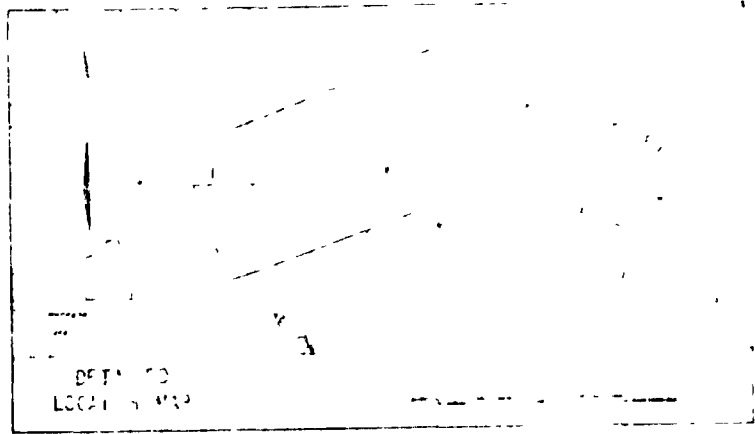
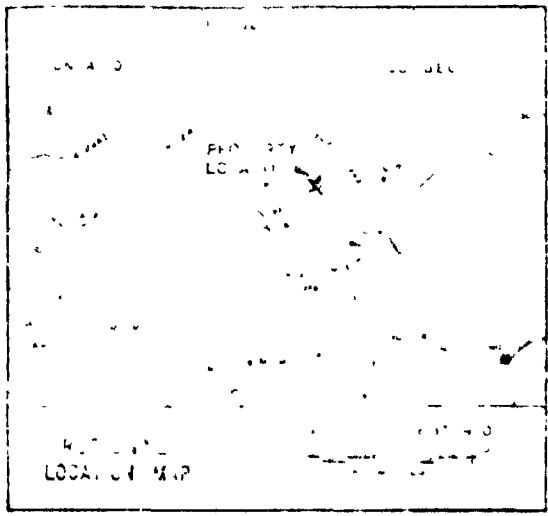

WEST GRID INDEX

**SYMBOLS**

- FOLIATION (Inclined, undetermined dip)
- AREA OF OUTCROP
- STRIKE OF VEIN
- QUARTZ VEIN
- CLAIM POST - observed
- CLAIM POST - assumed
- SWAMP BOUNDARY
- SWAMP
- STREAM
- WINTER ROAD
- TRAIL
- ESKER

**LEGEND**

- FELSIC INTRUSIVE ROCKS  
unsubdivided  
a Granodiorite
- MAFIC TO INTERMEDIATE METAVOLCANIC ROCKS  
f Dioritic / gabbroic  
g Amphibolitic

9+00N -

8+00S -

7+00N -

6+00N -

5+00N -

4+00N -

3+00N -

2+00N -

1+00N -

BASE LINE -

1+00S -

2+00S -

3+00S -

4+00S -

5+00S -

0 100 200 300  
METERS

*Sutherland*

DETOUR LAKE PROPERTY

FIELD GEOLOGY MAP

WEST (A) GRID

DRAWN BY S.G.  
CHECKED BY N.T.S.

DATE OCT., 1982  
DRAWING No. 1  
SCALE 1:5000



Getty Canadian Metals, Ltd.



32E13SE0013 2.5578 ATKINSON LAKE

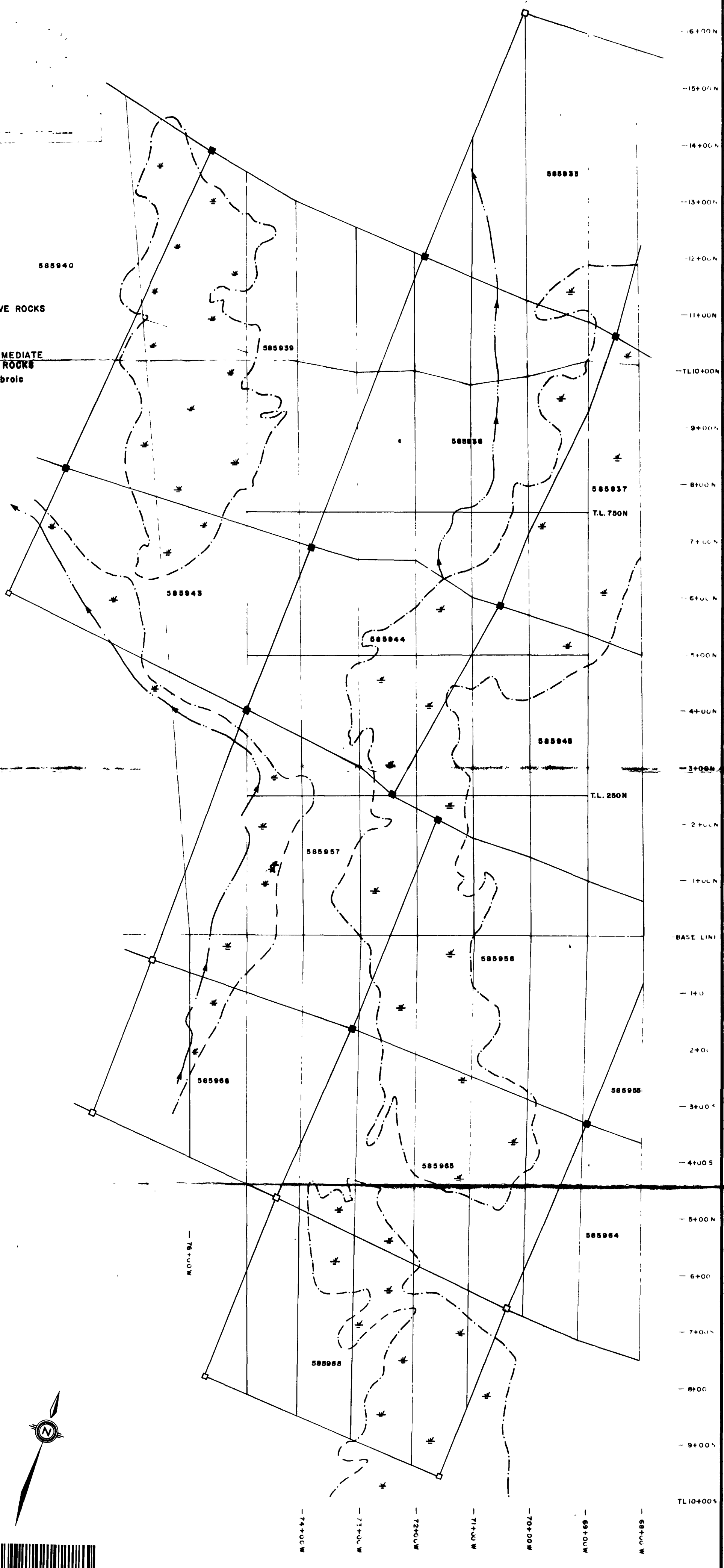

16+00N  
15+00N  
14+00N  
13+00N  
12+00N  
11+00N  
10+00N  
9+00N  
8+00N  
7+00N  
6+00N  
5+00N  
4+00N  
3+00N  
2+00N  
1+00N  
BASE LINE  
1+00S  
2+00S  
3+00S  
4+00S  
5+00S  
6+00S  
7+00S  
8+00S  
9+00S  
10+00S

78+00W  
77+00W  
76+00W  
75+00W  
74+00W  
73+00W  
72+00W  
71+00W  
70+00W  
69+00W  
68+00W



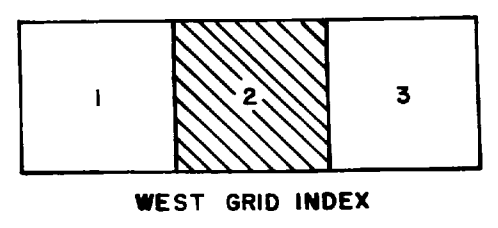
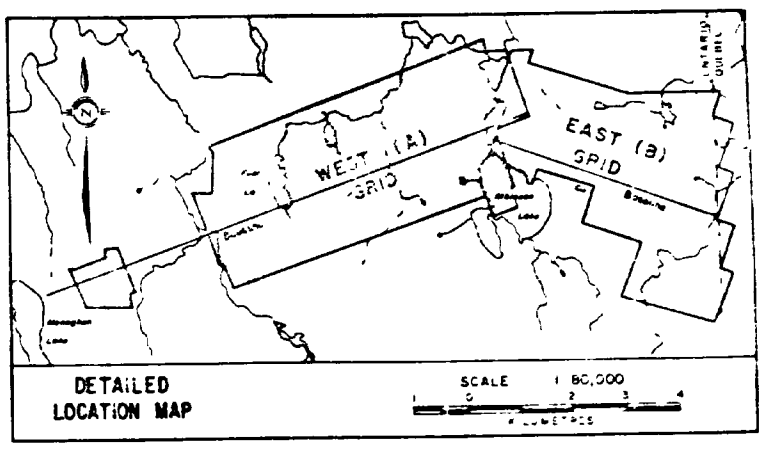
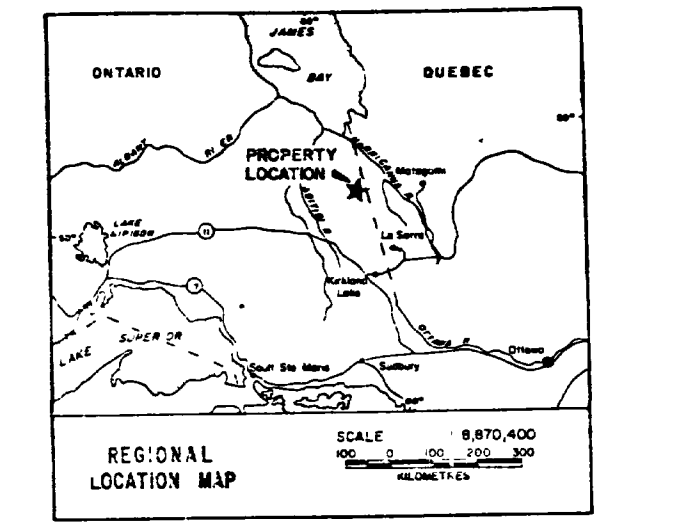

- LEGEND**
- FELSIC INTRUSIVE ROCKS
  - MAFIC TO INTERMEDIATE METAVOLCANIC ROCKS
  - DIORITIC/GABBROIC
  - AMPHIBOLITE
- SYMBOLS**
- FOLIATION (inclined, undetermined dip)
  - AREA OF OUTCROP
  - STRIKE OF VEIN
  - QUARTZ VEIN
  - CLAIM POST - observed
  - CLAIM POST - assumed
  - SWAMP BOUNDARY
  - SWAMP
  - STREAM
  - WINTER ROAD
  - TRAIL
  - ESKER

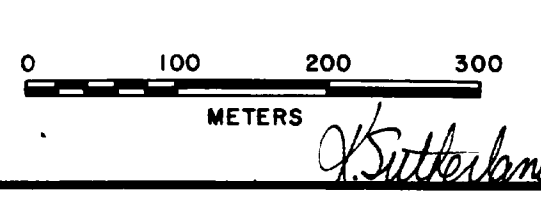
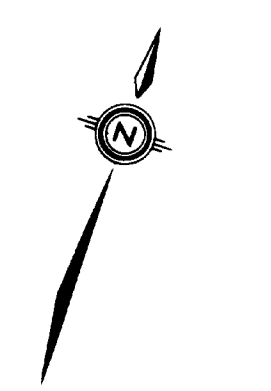

DETOUR LAKE PROPERTY  
**FIELD GEOLOGY MAP**  
 WEST (A) GRID

DRAWN BY: S.G. DATE: OCT. 1982  
 CHECKED BY: [Signature] DRAWN BY: E.  
 N.T.S. SCALE: 1:5000  
 Getty Canadian Metals, Ltd.

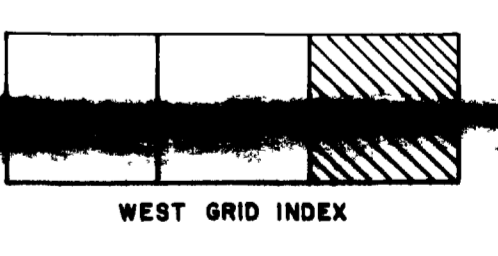
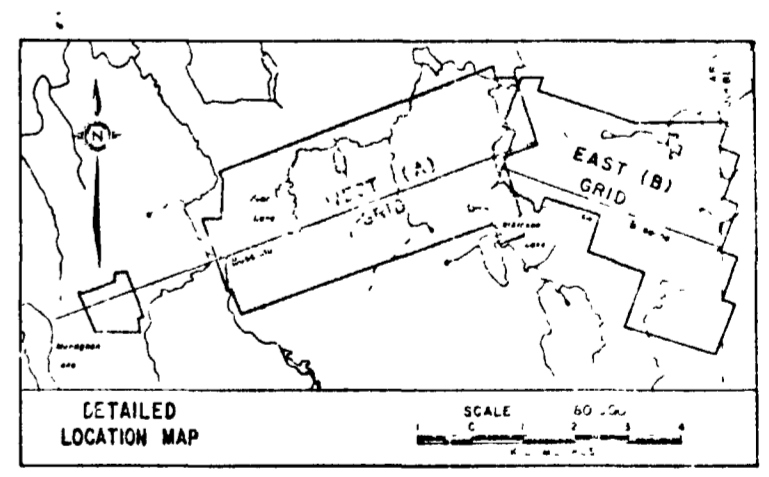
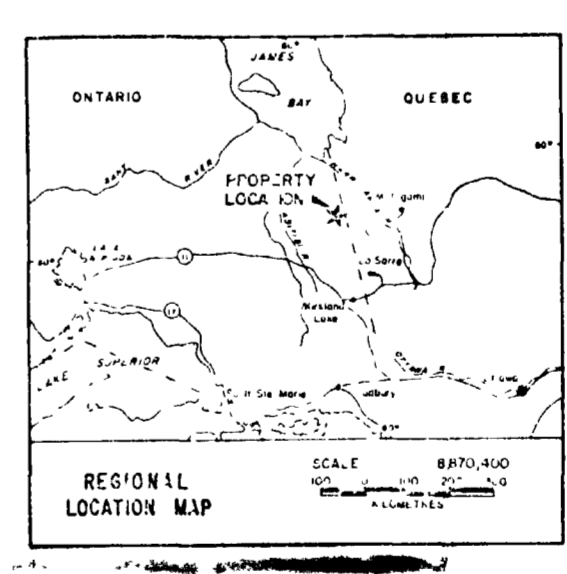
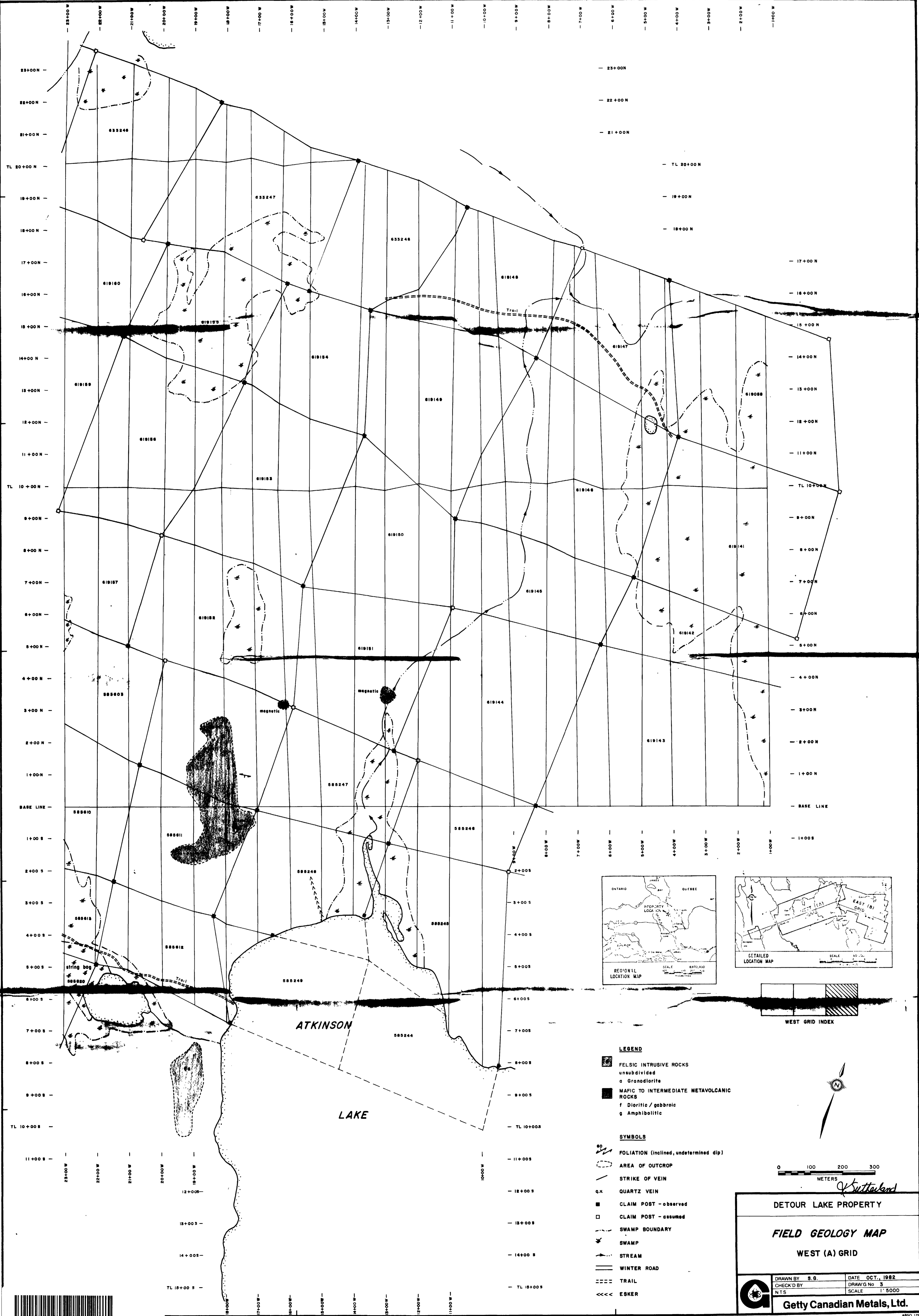

- LEGEND**
- FELSIC INTRUSIVE ROCKS
    - unsubdivided
    - a Granodiorite
  - MAFIC TO INTERMEDIATE METAVOLCANIC ROCKS
    - f Dioritic / gabbroic
    - g Amphibolitic
- SYMBOLS**
- FOLIATION (inclined, undetermined dip)
  - AREA OF OUTCROP
  - STRIKE OF VEIN
  - Q.V. QUARTZ VEIN
  - CLAIM POST - observed
  - CLAIM POST - assumed
  - SWAMP BOUNDARY
  - SWAMP
  - STREAM
  - WINTER ROAD
  - TRAIL
  - ESKER

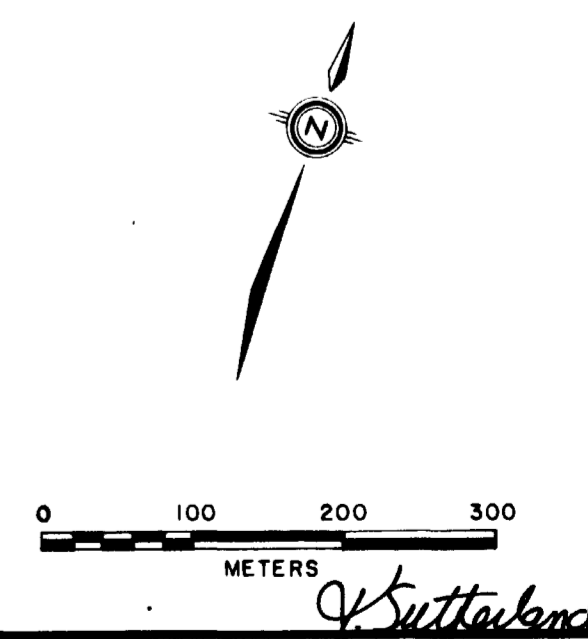

*S. G. Sutherland*

**DETOUR LAKE PROPERTY**

**FIELD GEOLOGY MAP**

**WEST (A) GRID**

DRAWN BY S.G.	DATE OCT., 1982
CHECK'D BY	DRAW'G No 3
NTS	SCALE 1:5000

**Getty Canadian Metals, Ltd.**





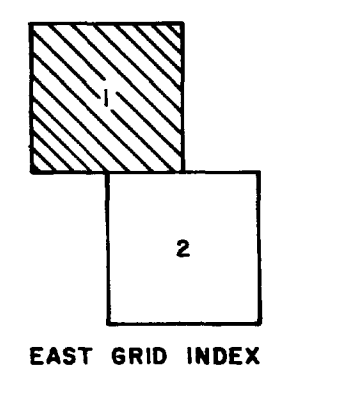
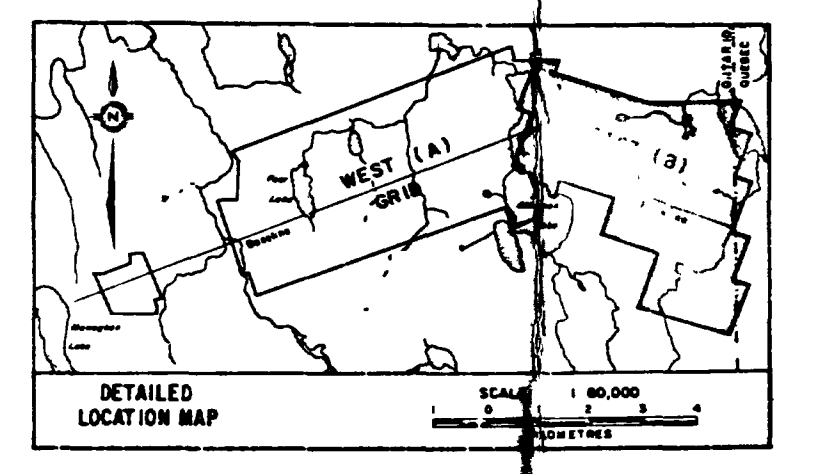
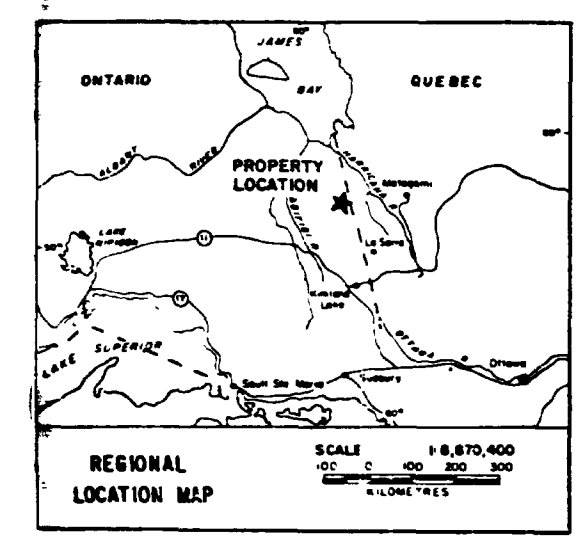

- LEGEND**
- FELSIC INTRUSIVE ROCKS
    - ◻ unclassified
    - ◻ Granodiorite
  - MAFIC TO INTERMEDIATE METAVOLCANIC ROCKS
    - f Dioritic / gabbroic
    - g Amphibolite
- SYMBOLS**
- FOLIATION (inclined, undetermined dip)
  - STRIKE OF VEIN
  - QUARTZ VEIN
  - CLAIM POST - observed
  - CLAIM POST - assumed
  - SWAMP BOUNDARY
  - SWAMP
  - STREAM
  - WINTER ROAD
  - TRAIL
  - ESKER

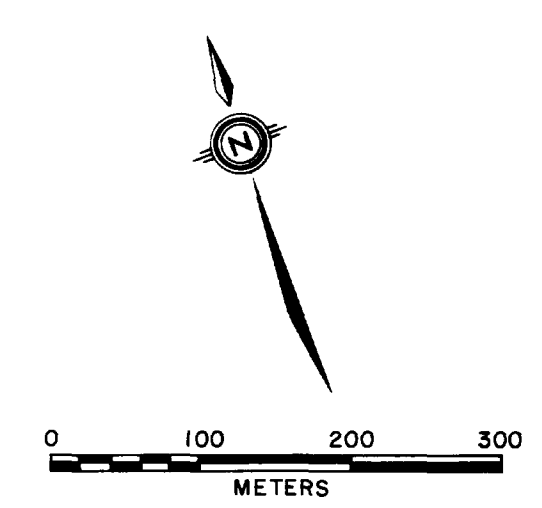

*Battell*

DETOUR LAKE PROPERTY

**FIELD GEOLOGY MAP**

EAST (B) GRID

DRAWN BY S.G.	DATE OCT, 1982
CHECKED BY	DRAWING No. 1
PTS.	SCALE 1:5000

Getty Canadian Metals, Ltd.



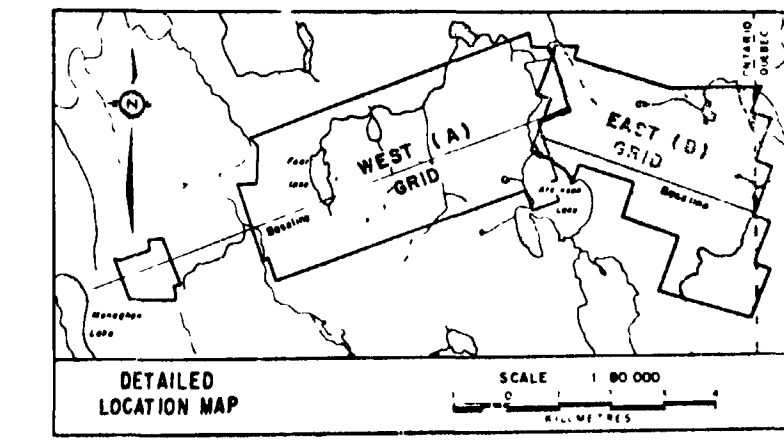
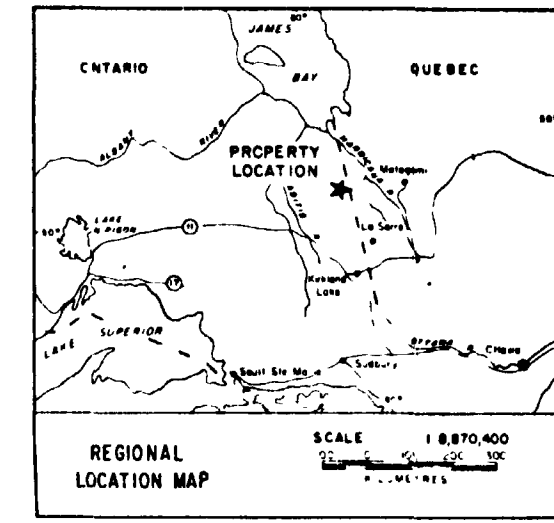
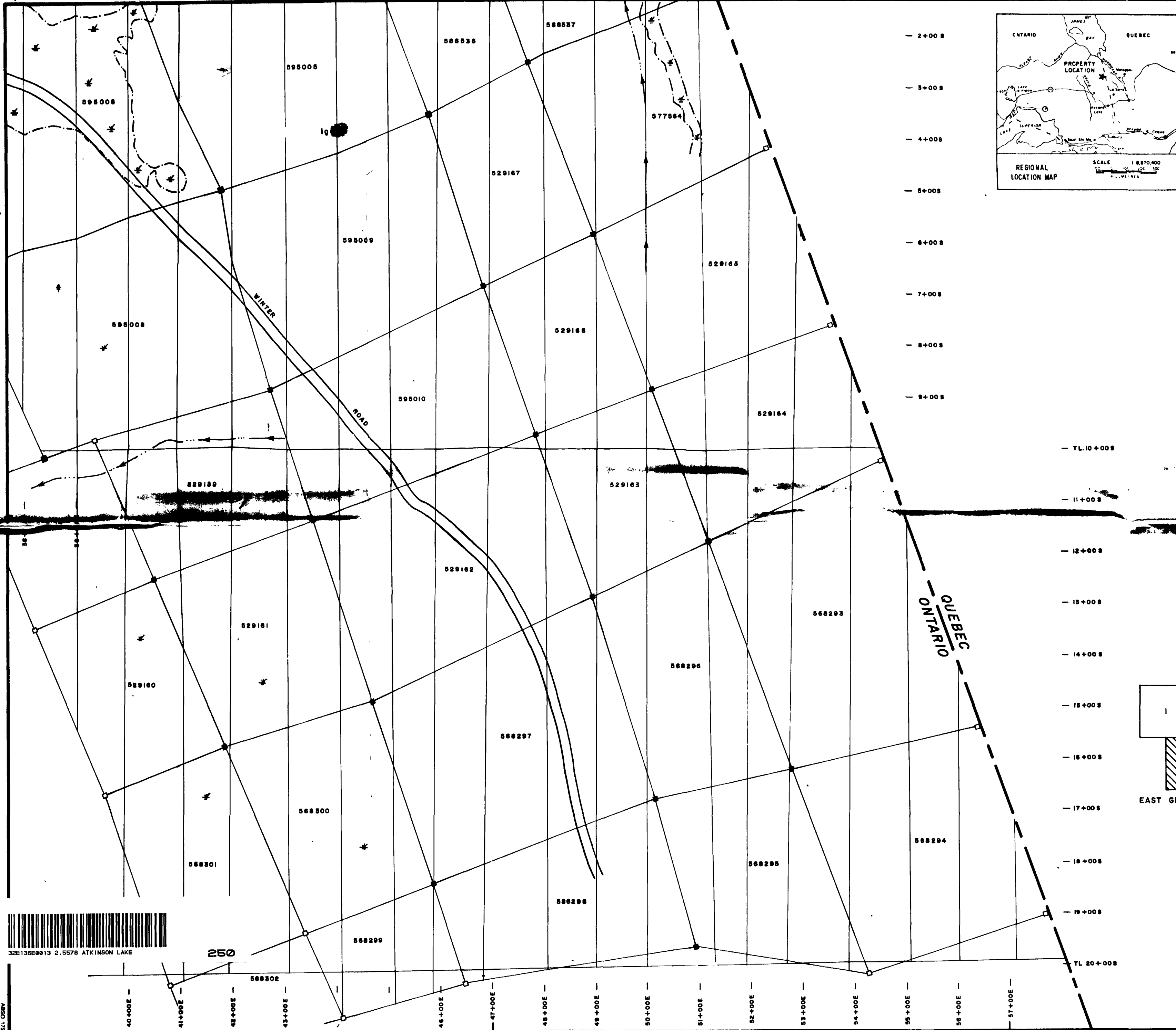

**LEGEND**

- FELSIC INTRUSIVE ROCKS**  
unsubdivided  
a Granodiorite
- MAFIC TO INTERMEDIATE METAVOLCANIC ROCKS**  
f Dioritic / gabbroic  
g Amphibolitic

**SYMBOLS**

- FOLIATION (inclined, undetermined dip)
- AREA OF OUTCROP
- STRIKE OF VEIN
- q.v. QUARTZ VEIN
- CLAIM POST - assumed
- SWAMP BOUNDARY
- STREAM
- WINTER ROAD
- TRAIL
- ESKER

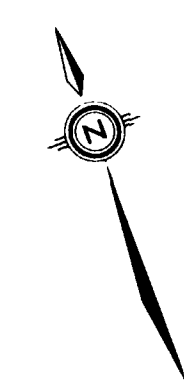
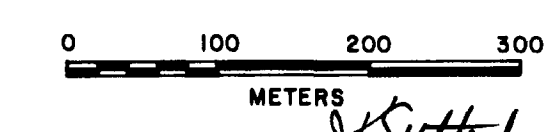
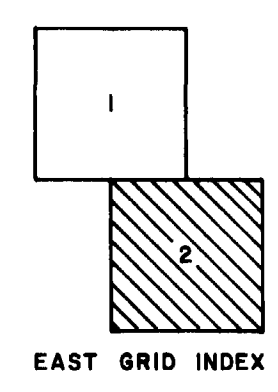

<b>DETOUR LAKE PROPERTY</b>	
<b>FIELD GEOLOGY MAP</b>	
<b>EAST (B) GRID</b>	
DRAWN BY S.G.	DATE OCT., 1982
CHECKED BY N.T.S.	DRAW'G No 2
SCALE 1:5000	
<b>Getty Canadian Metals, Ltd.</b>	

25578