

\*\*\* DETOUR LAKE MINEX \*\*\*  
PLACER DOME CANADA LIMITED

Drill Hole: 464-103

Northing : 20900.00  
Easting : 15400.00  
Elevation : 6250.00  
Hole Depth : 965.66mt

Project ID : 464  
Core Size : NQ  
Date Logged : 25APR96  
Logged By : RKM  
Assisted by :

010

MINING CLAIM NUMBER: CLM 229  
DRILLING STARTED: APRIL 20, 1996  
DRILLING COMPLETED: MAY 15, 1996  
DRILLING CONTRACTOR: BRADLEY BROTHERS LIMITED  
DRILL CORE STORAGE LOCATION: DETOUR LAKE MINE  
LOGGING STARTED: APRIL 25, 1996  
LOGGING COMPLETED: MAY 20, 1996  
LOGGED BY: RYAN MCEACHERN



Drill Hole Survey Data

Depth	Azimuth	Dip
Collar	180.00	-81.00
32.00mt	183.00	-81.00
50.00mt	185.00	-80.50
98.00mt	183.00	-80.00
152.00mt	181.00	-79.25
200.00mt	184.00	-78.50
250.00mt	184.00	-77.50
302.00mt	182.00	-76.75
350.00mt	184.00	-76.00
400.00mt	178.00	-75.75
452.00mt	178.00	-75.00
500.00mt	181.00	-74.50
554.00mt	180.00	-74.00
602.00mt	182.00	-73.75
650.00mt	185.00	-73.00
701.00mt	185.00	-72.75
752.00mt	185.00	-72.25
800.00mt	182.00	-72.00
848.00mt	182.00	-71.75
902.00mt	182.00	-71.25
950.00mt	186.00	-70.75



From	To	Geology
0.00	20.00	OVERBURDEN
20.00	188.00	PILLOWED FLOW, Amygdaloidal, pillowed, trace specks AU, trace specks CP, trace blebs MR, trace blebs PO, trace specks PY, trace microveins QV 37.35 39.20 INTERMEDIATE DYKE(PURPLISH/BROWN), almandine garnet, foliated 60.40 61.57 INTERMEDIATE DYKE(PURPLISH/BROWN), almandine garnet 61.57 63.85 MASSIVE MAFIC FLOW(<1%bt) 110.85 112.10 INTERMED DYKE WITH CHLORITIC PHENOCRYSTS, chlorite, albite, foliated, Porphyritic, trace microveins QV 115.45 115.92 FELSIC DYKE(PURPLISH/WHITE), Fractured, foliated, trace blebs CP, 00.3-0.5% specks PY, 00.3-0.5% microveins QV 146.50 146.75 FELSIC DYKE(PURPLISH/WHITE) 159.10 159.40 SERICITICALLY ALTERED(+10%)+/- PLAG PHENOS, sericite, foliated 159.40 161.50 INTERMEDIATE DYKE(PURPLISH/BROWN), almandine garnet, foliated 161.60 162.55 FELSIC DYKE(PURPLISH/WHITE), foliated 166.15 166.85 ULTRAMAFIC INTRUSIVE, actinolite, biotite, foliated 166.85 168.10 MASSIVE MAFIC FLOW(<1%bt), foliated 170.27 170.90 POTASSICALLY ALTERED PILLOWED FLOW(+5%pervasive K), biotite, chlorite, Banded, foliated 173.45 173.85 GABBROIC DYKE;DISTINCT MED-CRSE GRAINED INTRUSIVE, hornblende, biotite 174.80 175.05 FELSIC DYKE(PURPLISH/WHITE), sericite, foliated 175.05 175.55 POTASSICALLY ALTERED PILLOWED FLOW(+5%pervasive K), biotite, QZ, trace blebs PO, 20% veins QV 175.55 176.45 INTERMEDIATE DYKE(PURPLISH/BROWN), almandine garnet, foliated 177.20 178.80 FELSIC DYKE(PURPLISH/WHITE), sericite, Fractured, foliated 180.00 180.85 FELSIC DYKE(PURPLISH/WHITE), Fractured, foliated 184.55 185.25 ULTRAMAFIC INTRUSIVE, actinolite, foliated

From	To	Geology
188.00	195.74	PILLOWED FLOW, Fine Grained, 45 FO very lightly fractured, 00.3-0.5% selvages BI, trace stringers CB, trace PO, trace vein associated/in vein PY, trace QV
195.74	202.00	MASSIVE MAFIC FLOW(<1%bt), Massive, Medium Grained, very lightly fractured, trace stringers CB, trace stringers PY, trace microveins QV
	199.65 200.48	INTERMEDIATE DYKE(PURPLISH/BROWN), almandine garnet, Fine Grained, trace stringers PY
202.00	234.07	PILLOWED FLOW, Fine Grained, 45 FO lightly fractured, 00.3-0.5% selvages BI, trace stringers CB, trace bands and layering EP, trace PO, trace vein associated/in vein PY, trace QV
	204.58 206.05	FELSIC DYKE(PURPLISH/WHITE), Medium Grained, 45 FO
	206.40 207.00	FELSIC DYKE(PURPLISH/WHITE), Fine Grained
	207.56 207.83	FELSIC DYKE(PURPLISH/WHITE), Fine Grained, 40 FO
	208.24 208.95	MAFIC DYKE(GREENISH), Massive, Fine Grained
	210.21 210.73	ULTRAMAFIC INTRUSIVE, Massive, Medium Grained
	211.64 212.35	INTERMEDIATE DYKE(PURPLISH/BROWN), Fine Grained, 60 FO
	214.57 214.95	ULTRAMAFIC INTRUSIVE, Massive, Medium Grained
	229.83 230.28	FELSIC DYKE(PURPLISH/WHITE), Fine Grained
234.07	237.57	MAFIC DYKE(GREENISH), Massive, Medium Grained, slightly fractured, trace vein associated/in vein PY, trace stringers QV
	235.34 236.19	FELSIC DYKE(PURPLISH/WHITE), Fine Grained, 40 FO 00.5-2% veins EP, trace vein associated/in vein PO
237.57	267.92	PILLOWED FLOW, Fine Grained, 50 FO slightly fractured, trace stringers AB, trace selvages BI, trace selvages CB, trace selvages CL, trace vein associated/in vein CP, 00.3-0.5% selvages EP, trace vein associated/in vein MR, 00.3-0.5% PO, trace vein associated/in vein PY, trace QV
	245.26 247.12	MAFIC DYKE(GREENISH), Massive, Medium Grained
	247.23 249.77	INTERMEDIATE DYKE(PURPLISH/BROWN), Massive, Fine Grained
	253.89 254.36	FELSIC DYKE(PURPLISH/WHITE), almandine garnet, Fine Grained, 50 FO
	262.82 263.51	INTERMEDIATE DYKE(PURPLISH/BROWN), Massive, Fine Grained
267.92	275.00	GABBROIC DYKE;DISTINCT MED-CRSE GRAINED INTRUSIVE, Coarse Grained, slightly fractured, trace stringers CB, trace vein associated/in vein PO, trace stringers QV
275.00	303.18	PILLOWED FLOW, Fine Grained, 50 FO fairly lightly fractured, trace stringers AB, trace selvages BI, trace selvages CB, trace selvages CL, trace CP, 00.5-2% selvages EP, 00.3-0.5% PO, trace PY, trace QV
	276.95 277.38	INTERMEDIATE DYKE(PURPLISH/BROWN), Massive, Fine Grained
	280.70 281.28	GABBROIC DYKE;DISTINCT MED-CRSE GRAINED INTRUSIVE, Massive, Coarse Grained
	288.93 289.23	MAFIC DYKE(GREENISH), Porphyritic
	299.40 300.62	INTERMEDIATE DYKE(PURPLISH/BROWN), Massive, Fine Grained
303.18	309.30	HEALED FAULT ZONE + Qz/Ab/Cb Vns+/- Kf,Ep, Fine Grained, slightly fractured, trace blebs CP, trace blebs PO, trace stringers QV
309.30	407.00	PILLOWED FLOW, Fine Grained, slightly fractured, trace stringers AB, trace selvages BI, trace stringers CB, trace selvages CL, trace vein associated/in vein CP, trace selvages EP, trace vein associated/in vein MR, 00.3-0.5% PO, trace vein associated/in vein PY, 00.3-0.5% QV
	310.00 310.43	FELSIC DYKE(PURPLISH/WHITE), Fine Grained, fairly lightly fractured
	312.30 312.76	MAFIC DYKE(GREENISH), Porphyritic
	313.12 314.50	PLAG PORPH FELSIC DYKE(+Kf+/- hem matrix), Porphyritic, 60 FO
	318.71 319.35	MAFIC DYKE(GREENISH), Fine Grained
	322.99 323.48	MAFIC DYKE(GREENISH), Porphyritic
	335.00 336.10	PLAG PORPH FELSIC DYKE(+Kf+/- hem matrix), Fractured, Porphyritic, trace specks PY
	339.20 340.60	PLAG PORPH FELSIC DYKE(+Kf+/- hem matrix), trace fracture filling PY
	345.90 346.20	INTERMED DYKE WITH CHLORITIC PHENOCRYSTS, foliated, Porphyritic
	349.60 349.95	INTERMED DYKE WITH CHLORITIC PHENOCRYSTS, foliated, Porphyritic
	349.95 351.10	INTERMEDIATE DYKE(PURPLISH/BROWN), foliated
	354.73 356.15	INTERMEDIATE DYKE(PURPLISH/BROWN), foliated
	356.15 357.30	INTERMEDIATE DYKE(PURPLISH/BROWN), foliated
	360.00 360.45	INTERMEDIATE DYKE(PURPLISH/BROWN), almandine garnet, foliated
	360.45 361.85	INTERMED DYKE WITH CHLORITIC PHENOCRYSTS, chlorite, plagioclase, foliated
	361.85 366.50	INTERMEDIATE DYKE(PURPLISH/BROWN), almandine garnet, foliated
	366.50 366.89	FELSIC DYKE(PURPLISH/WHITE), plagioclase, foliated, Porphyritic
	374.30 375.40	INTERMEDIATE DYKE(PURPLISH/BROWN), foliated
	376.70 378.15	INTERMEDIATE DYKE(PURPLISH/BROWN)
	378.20 381.60	INTERMEDIATE DYKE(PURPLISH/BROWN), almandine garnet, foliated
	381.60 382.20	PLAG PORPH FELSIC DYKE(+Kf+/- hem matrix), foliated, Porphyritic

From	To	Geology
		382.20 383.00 INTERMEDIATE DYKE(PURPLISH/BROWN), almandine garnet, foliated
		387.00 387.56 INTERMEDIATE DYKE(PURPLISH/BROWN), foliated
		390.93 391.30 SERICITICALLY ALTERED(+10%)+/- PLAG PHENOS, sericite, Fractured, foliated
		391.50 391.95 PLAG PORPH FELSIC DYKE(+Kf+/- hem matrix), plagioclase, foliated, Porphyritic
		395.78 396.25 INTERMEDIATE DYKE(PURPLISH/BROWN), Fractured, foliated
		397.25 398.70 HYPABYSSAL GABBRO, chlorite, foliated, trace vein associated/in vein PY, trace microveins QV
		400.40 400.98 FELSIC DYKE(PURPLISH/WHITE), sericite, albite, foliated, Fractured
		400.98 401.48 MAFIC DYKE(GREENISH), biotite, foliated
407.00	497.13	PILLOWED FLOW, VARIOLITIC, Amygdaloidal, trace specks AU, trace blebs CP, trace blebs MR, trace blebs PO, trace specks PY, 00.5-2% microveins QV
		417.00 418.00 INTERMEDIATE DYKE(PURPLISH/BROWN), foliated
		426.05 426.85 INTERMEDIATE DYKE(PURPLISH/BROWN), almandine garnet, foliated, 00.3-0.5% microveins QV
		429.50 430.12 INTERMEDIATE DYKE(PURPLISH/BROWN), almandine garnet, foliated
		430.55 431.02 INTERMEDIATE DYKE(PURPLISH/BROWN), Fine Grained
		434.00 435.05 INTERMEDIATE DYKE(PURPLISH/BROWN), almandine garnet, foliated
		437.10 437.97 INTERMEDIATE DYKE(PURPLISH/BROWN), almandine garnet, foliated
		446.50 447.00 MAFIC DYKE(GREENISH), biotite, foliated
		447.00 447.50 INTERMEDIATE DYKE(PURPLISH/BROWN), foliated
		447.75 448.52 MAFIC DYKE(GREENISH), biotite, foliated
		454.25 454.82 FELSIC DYKE(PURPLISH/WHITE), plagioclase, foliated, Porphyritic
		454.82 457.26 INTERMEDIATE DYKE(PURPLISH/BROWN), almandine garnet, foliated, 00.3-0.5% veins QV
		457.26 457.67 FELSIC DYKE(PURPLISH/WHITE), plagioclase, foliated, Porphyritic
		457.67 458.69 INTERMEDIATE DYKE(PURPLISH/BROWN), almandine garnet, foliated
		460.10 462.95 INTERMEDIATE DYKE(PURPLISH/BROWN), almandine garnet, foliated, 00.3-0.5% veins QV
		464.24 464.61 MAFIC DYKE(GREENISH), biotite, foliated
		464.61 465.29 INTERMEDIATE DYKE(PURPLISH/BROWN), almandine garnet, foliated, 00.3-0.5% veins QV
		472.45 473.48 INTERMEDIATE DYKE(PURPLISH/BROWN), almandine garnet, foliated
		476.04 477.73 INTERMEDIATE DYKE(PURPLISH/BROWN), almandine garnet, foliated
		479.52 480.30 INTERMEDIATE DYKE(PURPLISH/BROWN), almandine garnet, foliated
		480.30 481.83 MAFIC DYKE(GREENISH), biotite, foliated
		481.83 482.81 INTERMEDIATE DYKE(PURPLISH/BROWN), foliated
		489.48 491.43 PLAG PORPH MAFIC DYKE, plagioclase, foliated, Porphyritic
		491.64 492.51 FELSIC DYKE(PURPLISH/WHITE), Fractured, foliated
		492.84 494.16 PLAG PORPH MAFIC DYKE, plagioclase, foliated, Porphyritic
		494.22 494.53 PLAG PORPH MAFIC DYKE, foliated, Porphyritic
		494.66 495.67 INTERMEDIATE DYKE(PURPLISH/BROWN), almandine garnet, foliated
		495.75 497.13 INTERMEDIATE DYKE(PURPLISH/BROWN), almandine garnet, foliated
497.13	534.61	MASSIVE MAFIC FLOW(<1%bt), foliated, trace blebs PO, trace microveins QV
		500.30 501.55 INTERMEDIATE DYKE(PURPLISH/BROWN), almandine garnet, foliated
		505.35 507.88 MAFIC DYKE WITH CHLORITIC PHENOS, plagioclase, chlorite, foliated, Porphyritic
		508.60 509.55 INTERMEDIATE DYKE(PURPLISH/BROWN), foliated
		510.95 511.75 INTERMEDIATE DYKE(PURPLISH/BROWN), almandine garnet, foliated
		521.66 522.26 INTERMED DYKE WITH CHLORITIC PHENOCRYSTS, chlorite, plagioclase, foliated, Porphyritic
		522.26 523.04 HYPABYSSAL GABBRO, foliated
		532.21 532.53 INTERMEDIATE DYKE(PURPLISH/BROWN), foliated
		534.06 534.61 INTERMEDIATE DYKE(PURPLISH/BROWN), foliated
534.61	633.65	PILLOWED FLOW, VARIOLITIC, foliated, pillowed, trace specks AU, 00.3-0.5% bands and layering BI, trace wisp CP, trace blebs MR, trace blebs PO, trace specks PY, trace microveins QV
		536.29 536.65 INTERMEDIATE DYKE(PURPLISH/BROWN), foliated
		545.01 546.59 INTERMED DYKE WITH CHLORITIC PHENOCRYSTS, chlorite, foliated
		549.20 549.85 INTERMEDIATE DYKE(PURPLISH/BROWN), foliated
		554.10 556.78 INTERMED DYKE WITH CHLORITIC PHENOCRYSTS, chlorite, plagioclase, foliated
		556.78 558.40 HEALED FAULT ZONE + Qz/Ab/Cb Vns+/- Kf,Ep, chlorite, Fractured
		558.40 562.50 FELSIC DYKE(PURPLISH/WHITE), hematite, Fractured
		562.50 566.00 INTERMEDIATE DYKE(PURPLISH/BROWN), Fractured, foliated
		566.05 567.80 INTERMEDIATE DYKE(PURPLISH/BROWN), almandine garnet, foliated, trace microveins QV
		571.45 573.50 INTERMEDIATE DYKE(PURPLISH/BROWN), almandine garnet, foliated, trace microveins QV
		573.50 574.15 FELSIC DYKE(PURPLISH/WHITE), Fractured
		590.40 591.80 INTERMEDIATE DYKE(PURPLISH/BROWN), foliated
		597.15 598.70 INTERMEDIATE DYKE(PURPLISH/BROWN), almandine garnet, foliated
		602.02 604.60 INTERMED DYKE WITH CHLORITIC PHENOCRYSTS, chlorite, foliated, Porphyritic
		609.38 611.50 INTERMED DYKE WITH CHLORITIC PHENOCRYSTS, chlorite, foliated, Porphyritic
		611.50 611.85 INTERMEDIATE DYKE(PURPLISH/BROWN), foliated

From	To	Geology
		624.50 625.20 INTERMEDIATE DYKE(PURPLISH/BROWN), foliated 627.70 628.15 INTERMEDIATE DYKE(PURPLISH/BROWN), foliated 628.15 628.57 INTERMEDIATE DYKE(PURPLISH/BROWN), foliated 628.75 631.80 INTERMEDIATE DYKE(PURPLISH/BROWN), almandine garnet, foliated 632.45 633.65 INTERMEDIATE DYKE(PURPLISH/BROWN), foliated
633.65	760.10	WEAK POTASSIC PILLOW FLOW(1-5%K), foliated, pillowed, trace fracture filling AB, 2-4% bands and layering BI, trace wisp CP, trace specks MR, 00.5-2% blebs PO, trace specks PY, 00.3-0.5% microveins QV 634.30 636.40 INTERMEDIATE DYKE(PURPLISH/BROWN), almandine garnet, foliated 649.00 649.53 INTERMEDIATE DYKE(PURPLISH/BROWN), foliated 653.95 655.20 INTERMED DYKE WITH CHLORITIC PHENOCRYSTS, foliated, Porphyritic 656.20 656.85 INTERMED DYKE WITH CHLORITIC PHENOCRYSTS, foliated, Porphyritic 657.25 657.77 SERICITICALLY ALTERED(+10%)+/- PLAG PHENOS, sericite, foliated 661.95 662.75 INTERMEDIATE DYKE(PURPLISH/BROWN), foliated 662.75 663.10 FELSIC DYKE(PURPLISH/WHITE), foliated 666.70 667.40 INTERMEDIATE DYKE(PURPLISH/BROWN), foliated 672.60 673.40 SERICITICALLY ALTERED(+10%)+/- PLAG PHENOS, sericite, foliated 688.04 688.95 INTERMEDIATE DYKE(PURPLISH/BROWN), foliated 688.95 689.00 FAULT ZONE;+/- CHLORITIC GOUGE, chlorite, hornblende, foliated 689.00 689.30 INTERMEDIATE DYKE(PURPLISH/BROWN), foliated 689.30 689.86 FELSIC DYKE(PURPLISH/WHITE), sericite, foliated 689.86 690.60 INTERMEDIATE DYKE(PURPLISH/BROWN), foliated 689.40 690.00 INTERMED DYKE WITH CHLORITIC PHENOCRYSTS, chlorite, foliated, Porphyritic 696.85 697.20 INTERMEDIATE DYKE(PURPLISH/BROWN), foliated 697.40 699.16 FELSIC DYKE(PURPLISH/WHITE), Fractured, foliated 699.90 702.10 FELSIC DYKE(PURPLISH/WHITE), foliated, Fractured 708.00 709.15 INTERMEDIATE DYKE(PURPLISH/BROWN), foliated 712.05 713.00 SERICITICALLY ALTERED(+10%)+/- PLAG PHENOS, sericite, Banded, foliated 713.00 713.45 INTERMEDIATE DYKE(PURPLISH/BROWN), foliated 713.45 714.52 SERICITICALLY ALTERED(+10%)+/- PLAG PHENOS, sericite, Banded, foliated 714.52 715.24 INTERMEDIATE DYKE(PURPLISH/BROWN), foliated 737.75 738.50 INTERMEDIATE DYKE(PURPLISH/BROWN), foliated 742.75 743.40 INTERMEDIATE DYKE(PURPLISH/BROWN), foliated 743.67 744.34 MAFIC DYKE(GREENISH) 744.47 745.30 INTERMEDIATE DYKE(PURPLISH/BROWN), foliated 747.50 748.25 ULTRAMAFIC INTRUSIVE, actinolite, foliated 754.15 754.38 ULTRAMAFIC INTRUSIVE, foliated 754.38 754.75 INTERMEDIATE DYKE(PURPLISH/BROWN), foliated 754.75 755.10 FELSIC DYKE(PURPLISH/WHITE), foliated 755.10 756.95 INTERMEDIATE DYKE(PURPLISH/BROWN), foliated 756.95 757.70 SERICITICALLY ALTERED(+10%)+/- PLAG PHENOS, Banded, foliated 757.70 758.10 INTERMEDIATE DYKE(PURPLISH/BROWN), foliated 758.10 760.10 SERICITICALLY ALTERED(+10%)+/- PLAG PHENOS, Banded, foliated
760.10	811.40	CHLORITIC GREENSTONE;+50% CHLORITE ALTERATION;MINOR TALC, chlorite, biotite, Banded, foliated, trace specks AU, 10% bands and layering BI, trace specks CP, trace blebs PO, trace specks PY, trace crystals and/or phenocrysts TE 761.90 764.80 SERICITICALLY ALTERED(+10%)+/- PLAG PHENOS, sericite, Banded, foliated 765.60 766.10 FELSIC DYKE(PURPLISH/WHITE) 766.20 766.70 MAFIC DYKE(GREENISH) 767.55 768.20 INTERMEDIATE DYKE(PURPLISH/BROWN), foliated 768.20 769.50 MAFIC DYKE(GREENISH) 770.70 771.50 SERICITICALLY ALTERED(+10%)+/- PLAG PHENOS, sericite, Banded, foliated 772.43 773.40 INTERMEDIATE DYKE(PURPLISH/BROWN), foliated 774.20 775.05 FELSIC DYKE(PURPLISH/WHITE), foliated 777.10 777.63 FELSIC DYKE(PURPLISH/WHITE), foliated 777.93 778.36 FELSIC DYKE(PURPLISH/WHITE), foliated 780.40 780.75 HEALED FAULT ZONE + Qz/Ab/Cb Vns+/- Kf,Ep, brecciated, Fractured 782.80 783.90 INTERMEDIATE DYKE(PURPLISH/BROWN), foliated 784.95 785.50 FELSIC DYKE(PURPLISH/WHITE), foliated 787.00 788.50 FELSIC DYKE(PURPLISH/WHITE), foliated 792.17 792.42 FELSIC DYKE(PURPLISH/WHITE), foliated 795.85 796.05 INTERMEDIATE DYKE(PURPLISH/BROWN), almandine garnet, foliated 796.35 797.28 INTERMEDIATE DYKE(PURPLISH/BROWN), biotite, foliated 798.25 799.50 FELSIC DYKE(PURPLISH/WHITE), foliated 800.55 801.15 FELSIC DYKE(PURPLISH/WHITE), foliated 804.20 805.10 INTERMEDIATE DYKE(PURPLISH/BROWN), foliated 806.72 808.10 INTERMEDIATE DYKE(PURPLISH/BROWN), foliated

From	To	Geology
811.40	821.10	INTERMEDIATE DYKE(PURPLISH/BROWN), biotite, foliated, 00.5-2% pervasive BI, trace blebs QV
821.10	965.66	PILLOWED FLOW, chlorite, biotite, pillowed, foliated, trace specks CP, trace blebs PO, trace microveins QV
		827.55 828.70 INTERMEDIATE DYKE(PURPLISH/BROWN), foliated
		831.80 832.15 FELSIC DYKE(PURPLISH/WHITE), Fractured, foliated
		833.60 834.25 FELSIC DYKE(PURPLISH/WHITE), foliated
		841.85 842.40 INTERMEDIATE DYKE(PURPLISH/BROWN), foliated
		849.92 850.13 FELSIC DYKE(PURPLISH/WHITE), Fractured, foliated
		851.80 852.15 FELSIC DYKE(PURPLISH/WHITE), foliated
		853.60 854.35 FELSIC DYKE(PURPLISH/WHITE), Porphyritic, foliated
		858.25 858.62 INTERMEDIATE DYKE(PURPLISH/BROWN), foliated
		860.60 861.60 INTERMEDIATE DYKE(PURPLISH/BROWN), foliated
		865.50 867.85 FELSIC DYKE(PURPLISH/WHITE), foliated
		872.90 873.75 INTERMEDIATE DYKE(PURPLISH/BROWN), foliated
		873.75 874.85 GABBROIC DYKE;DISTINCT MED-CRSE GRAINED INTRUSIVE, foliated
		876.25 876.65 INTERMEDIATE DYKE(PURPLISH/BROWN), foliated
		878.38 879.66 MAFIC DYKE(GREENISH), foliated
		880.99 882.10 INTERMEDIATE DYKE(PURPLISH/BROWN), foliated
		894.90 895.41 INTERMEDIATE DYKE(PURPLISH/BROWN), foliated
		896.10 896.75 MAFIC DYKE(GREENISH), foliated
		897.30 899.21 INTERMEDIATE DYKE(PURPLISH/BROWN), foliated
		914.16 915.05 MAFIC DYKE(GREENISH), biotite, foliated
		915.05 915.40 INTERMEDIATE DYKE(PURPLISH/BROWN), foliated
		916.27 917.60 INTERMEDIATE DYKE(PURPLISH/BROWN), foliated
		924.35 924.63 MAFIC DYKE(GREENISH), biotite, foliated
		926.47 928.81 GABBROIC DYKE;DISTINCT MED-CRSE GRAINED INTRUSIVE, foliated
		930.80 931.20 INTERMEDIATE DYKE(PURPLISH/BROWN), foliated
		935.83 936.60 INTERMEDIATE DYKE(PURPLISH/BROWN), foliated
		938.76 938.97 MAFIC DYKE(GREENISH), foliated
		940.60 941.20 INTERMED DYKE WITH CHLORITIC PHENOCRYSTS, chlorite, biotite, foliated
		941.20 941.66 MAFIC DYKE(GREENISH), foliated
		941.66 942.16 INTERMED DYKE WITH CHLORITIC PHENOCRYSTS, foliated
		944.20 945.80 INTERMED DYKE WITH CHLORITIC PHENOCRYSTS, foliated
		950.33 950.80 MAFIC DYKE(GREENISH), foliated
		956.50 956.85 INTERMEDIATE DYKE(PURPLISH/BROWN), foliated
		963.14 964.05 FELSIC DYKE(PURPLISH/WHITE), foliated
965.66		** END OF HOLE **

## LEGEND

CP	CHALCOPYRITE
MR	MARCASITE
PO	PYRRHOTITE
PY	PYRITE
BI(bt)	BIOTITE
CB	CARBONATE
EP	EPIDOTE
AB	ALBITE
CL	CHLORITE
QZ	QUARTZ
HEM	HEMATITE
Kf	POTASSIUM FELDSPAR
K	POTASSIC ALTERATION
QV	QUARTZ VEIN
FO	FOLIATION

\*\*\* DETOUR LAKE MINEX \*\*\*  
PLACER DOME CANADA LIMITED

Drill Hole: 464-108

Northing : 20977.00  
Easting : 15400.00  
Elevation : 6280.00  
Hole Depth : 1205.00mt

Project ID : 464  
Core Size : NQ  
Date Logged : 04JUN96  
Logged By : RKM  
Assisted by :

MINING CLAIM NUMBER: CLM 229  
DRILLING STARTED: JUNE 3, 1996  
DRILLING COMPLETED: JUNE 22, 1996  
DRILLING CONTRACTOR: BRADELY BROTHERS LIMITED  
DRILL CORE STORAGE LOCATION: DETOUR LAKE MINE  
LOGGING STARTED: JUNE 4, 1996  
LOGGING COMPLETED: JUNE 23, 1996  
LOGGED BY: RYAN MCEACHERN



Drill Hole Survey Data

Depth	Azimuth	Dip
Collar	193.00	-82.00
29.00mt	193.00	-82.25
47.00mt	193.00	-82.00
101.00mt	189.00	-81.00
150.00mt	185.00	-80.50
200.00mt	181.00	-79.50
251.00mt	180.00	-78.75
302.00mt	178.00	-78.00
353.00mt	178.00	-77.00
401.00mt	178.00	-76.00
449.00mt	178.00	-74.25
500.00mt	175.00	-73.75
551.00mt	177.00	-73.00
599.00mt	175.00	-71.75
650.00mt	175.00	-71.25
707.00mt	174.00	-70.75
755.00mt	174.00	-70.25
803.00mt	175.00	-69.25
857.00mt	178.00	-69.00
908.00mt	175.00	-68.25
953.00mt	180.00	-67.75
1001.00mt	178.00	-67.00
1049.00mt	183.00	-66.25
1103.00mt	180.00	-65.50
1154.00mt	183.00	-65.00
1205.00mt	182.00	-64.00

From	To	Geology
0.00	25.10	OVERBURDEN
25.10	31.00	MASSIVE MAFIC FLOW(<1%bt), Fractured, foliated, 70 FO extremely well fractured, trace microveins QV 27.75 29.83 FELSIC DYKE(PURPLISH/WHITE), foliated
31.00	43.10	PILLOWED FLOW, foliated, pillowed, trace blebs PO, trace microveins QV 39.25 39.75 FELSIC DYKE(PURPLISH/WHITE), almandine garnet, foliated
43.10	69.10	MASSIVE MAFIC FLOW(<1%bt), foliated, trace microveins QV 44.60 46.25 FELSIC DYKE(PURPLISH/WHITE), almandine garnet, foliated 48.00 49.00 WEAKLY POTASSIC MAFIC FLOW(1-5%K), foliated 56.25 56.50 INTERMEDIATE DYKE(PURPLISH/BROWN), foliated 59.10 59.60 MAFIC DYKE(GREENISH), foliated 59.60 61.00 WEAKLY POTASSIC MAFIC FLOW(1-5%K), foliated
69.10	96.75	CHLORITIC GREENSTONE;+50% CHLORITE ALTERATION;MINOR TALC, actinolite, biotite, foliated, 00.5-2% bands and layering BI, 00.3-0.5% fracture filling CB, trace vein associated/in vein KF, trace blebs PO, trace specks PY, 00.5-2% veins QV 87.90 89.30 INTERMEDIATE DYKE(PURPLISH/BROWN), foliated 89.50 89.98 MAFIC DYKE(GREENISH), foliated 91.20 92.50 INTERMEDIATE DYKE(PURPLISH/BROWN), foliated 94.45 95.00 INTERMED DYKE WITH CHLORITIC PHENOCRYSTS, chlorite, plagioclase, foliated, Porphyritic

From	To	Geology
96.75	156.15	PILLOWED FLOW, foliated, pillowed, VARIOLITIC, 00.5-2% bands and layering BI, trace vein associated/in vein CB, trace blebs PO, 00.3-0.5% microveins QV 122.77 123.40 INTERMEDIATE DYKE(PURPLISH/BROWN), foliated, 00.3-0.5% microveins QV 137.08 137.90 FELSIC DYKE(PURPLISH/WHITE), almandine garnet, foliated 138.72 140.80 MASSIVE MAFIC FLOW(<1%bt), biotite, foliated 140.80 141.08 INTERMEDIATE DYKE(PURPLISH/BROWN), foliated 141.70 142.79 INTERMEDIATE DYKE(PURPLISH/BROWN), foliated 143.10 143.45 INTERMEDIATE DYKE(PURPLISH/BROWN), foliated 145.38 146.05 INTERMEDIATE DYKE(PURPLISH/BROWN), magnetite, foliated 152.80 154.30 SERICITICALLY ALTERED(+10%)+/- PLAG PHENOS, almandine garnet, sericite, foliated
156.15	161.35	SERICITICALLY ALTERED(+10%)+/- PLAG PHENOS, sericite, almandine garnet, Porphyritic, foliated, 10% pervasive KF
161.35	240.75	PILLOWED FLOW, foliated, pillowed, trace specks AU, trace blebs CP, trace blebs MR, 00.3-0.5% blebs PO, trace specks PY, 00.5-2% veins QV 176.00 176.60 MAFIC DYKE(GREENISH), biotite, foliated 178.25 178.65 ULTRAMAFIC INTRUSIVE, foliated 189.58 191.60 INTERMEDIATE DYKE(PURPLISH/BROWN), magnetite, foliated 203.36 204.45 SERICITICALLY ALTERED(+10%)+/- PLAG PHENOS, sericite, almandine garnet, Porphyritic, foliated 206.80 208.04 SERICITICALLY ALTERED(+10%)+/- PLAG PHENOS, sericite, almandine garnet, Porphyritic, foliated 215.05 215.60 INTERMED DYKE WITH CHLORITIC PHENOCRYSTS, chlorite, plagioclase, foliated 227.95 228.40 ULTRAMAFIC INTRUSIVE, actinolite 234.68 236.72 ULTRAMAFIC INTRUSIVE, actinolite 236.72 237.40 FELSIC DYKE(PURPLISH/WHITE), Fractured, 00.3-0.5% disseminations & scattered crystals CP, 00.5-2% disseminations & scattered crystals PY 240.00 240.75 ULTRAMAFIC INTRUSIVE, actinolite
240.75	244.40	HEALED FAULT ZONE + Qz/Ab/Cb Vns+/- Kf,Ep, albite, hematite, Fractured, 5-7% vein associated/in vein AB, trace blebs CP, trace crystals and/or phenocrysts PY 242.20 243.30 INTERMEDIATE DYKE(PURPLISH/BROWN), foliated
244.40	289.35	PILLOWED FLOW, albite, pillowed, foliated, trace crystals and/or phenocrysts AB, trace blebs CP, trace blebs MR, 00.3-0.5% specks PY, 00.3-0.5% microveins QV 248.35 248.70 ULTRAMAFIC INTRUSIVE, actinolite, foliated 269.60 270.00 INTERMED DYKE WITH CHLORITIC PHENOCRYSTS, albite, chlorite, Porphyritic, foliated 289.00 289.35 INTERMEDIATE DYKE(PURPLISH/BROWN), foliated
289.35	294.00	MASSIVE MAFIC FLOW(<1%bt), foliated, 2-4% bands and layering BI, trace blebs CP, trace blebs PY, trace microveins QV
294.00	330.25	PILLOWED FLOW, foliated, VARIOLITIC, pillowed, trace bands and layering BI, trace blebs CP, trace blebs MR, trace blebs PO, trace crystals and/or phenocrysts PY, trace microveins QV 297.70 298.10 MAFIC DYKE(GREENISH), foliated 298.45 299.85 SERICITICALLY ALTERED(+10%)+/- PLAG PHENOS, Fractured, foliated 300.60 301.95 SERICITICALLY ALTERED(+10%)+/- PLAG PHENOS, Fractured, foliated 310.10 310.90 MASSIVE MAFIC FLOW(<1%bt), foliated 324.85 325.08 PLAG PORPH FELSIC DYKE(+Kf+/- hem matrix), plagioclase, foliated, Porphyritic 326.30 327.10 FELSIC DYKE(PURPLISH/WHITE), almandine garnet, foliated 327.10 327.70 INTERMEDIATE DYKE(PURPLISH/BROWN), foliated 329.85 330.10 FELSIC DYKE(PURPLISH/WHITE), foliated
330.25	333.85	MASSIVE MAFIC FLOW(<1%bt), foliated, trace blebs PO, trace stringers QV 332.95 333.45 INTERMED DYKE WITH CHLORITIC PHENOCRYSTS, chlorite, Porphyritic, foliated
333.85	459.65	PILLOWED FLOW, VARIOLITIC, foliated, pillowed, trace specks AU, 00.5-2% bands and layering BI, 00.3-0.5% blebs CP, trace blebs MR, 00.5-2% blebs PO, trace crystals and/or phenocrysts PY, 00.5-2% microveins QV 335.60 335.85 PLAG PORPH FELSIC DYKE(+Kf+/- hem matrix), plagioclase, foliated, Porphyritic 338.60 338.92 SERICITICALLY ALTERED(+10%)+/- PLAG PHENOS, sericite, foliated 342.62 343.50 MAFIC DYKE(GREENISH), albite, foliated 344.40 344.95 MAFIC DYKE(GREENISH), albite, foliated 346.25 346.68 FELSIC DYKE(PURPLISH/WHITE), foliated 365.30 366.32 INTERMEDIATE DYKE(PURPLISH/BROWN), almandine garnet, foliated 366.60 367.15 INTERMEDIATE DYKE(PURPLISH/BROWN), foliated 367.58 369.20 INTERMEDIATE DYKE(PURPLISH/BROWN), almandine garnet, foliated 369.79 370.55 INTERMEDIATE DYKE(PURPLISH/BROWN), foliated



From	To	Geology
		375.35 376.90 INTERMEDIATE DYKE(PURPLISH/BROWN), almandine garnet, foliated 376.90 377.21 PLAG PORPH FELSIC DYKE(+Kf+/- hem matrix), plagioclase, foliated, Porphyritic 377.21 379.70 INTERMEDIATE DYKE(PURPLISH/BROWN), foliated 383.80 386.00 MAFIC DYKE(GREENISH), foliated 386.00 386.95 INTERMEDIATE DYKE(PURPLISH/BROWN), foliated 392.10 392.75 INTERMEDIATE DYKE(PURPLISH/BROWN), foliated 393.85 394.75 INTERMED DYKE WITH CHLORITIC PHENOCRYSTS, chlorite, foliated, Porphyritic 396.70 398.35 MASSIVE MAFIC FLOW(<1%bt), foliated 404.35 404.85 FELSIC DYKE(PURPLISH/WHITE), foliated 404.85 405.20 MAFIC DYKE(GREENISH), foliated 405.45 406.10 FELSIC DYKE(PURPLISH/WHITE), foliated 406.20 408.80 PLAG PORPH FELSIC DYKE(+Kf+/- hem matrix), plagioclase, almandine garnet, foliated, Porphyritic 411.25 412.35 MAFIC DYKE(GREENISH), foliated 420.33 421.12 MAFIC DYKE(GREENISH), foliated 422.90 423.36 FELSIC DYKE(PURPLISH/WHITE), almandine garnet, foliated 423.45 423.77 INTERMEDIATE DYKE(PURPLISH/BROWN), foliated 424.80 425.25 MAFIC DYKE(GREENISH), foliated 425.49 425.80 INTERMEDIATE DYKE(PURPLISH/BROWN), foliated 437.43 437.85 INTERMEDIATE DYKE(PURPLISH/BROWN), foliated 440.40 441.05 MAFIC DYKE(GREENISH), albite, foliated, Porphyritic 441.80 442.43 PLAG PORPH FELSIC DYKE(+Kf+/- hem matrix), plagioclase, foliated, Porphyritic 443.10 444.95 FELSIC DYKE(PURPLISH/WHITE), foliated 447.20 449.05 FELSIC DYKE(PURPLISH/WHITE), foliated 456.85 457.70 MAFIC DYKE(GREENISH), foliated
459.65	465.10	INTERMEDIATE DYKE(PURPLISH/BROWN), almandine garnet, magnetite, foliated 461.78 462.10 MAFIC DYKE(GREENISH), foliated
465.10	467.05	PILLOWED FLOW, foliated, pillowed, 00.5-2% bands and layering BI, trace microveins CB, trace blebs CP, trace blebs MR, 00.3-0.5% blebs PO, trace crystals and/or phenocrysts PY, 00.5-2% microveins QV 465.55 465.80 MAFIC DYKE(GREENISH) 466.97 467.05 INTERMEDIATE DYKE(PURPLISH/BROWN), foliated
467.05	481.90	MASSIVE MAFIC FLOW(<1%bt), foliated, 30% pervasive BI, trace blebs PO, trace microveins QV 469.65 471.05 INTERMEDIATE DYKE(PURPLISH/BROWN), almandine garnet, foliated 471.05 471.65 MAFIC DYKE(GREENISH), foliated 480.40 481.90 MAFIC DYKE(GREENISH), foliated
481.90	560.93	GABBROIC DYKE;DISTINCT MED-CRSE GRAINED INTRUSIVE, chlorite, biotite, foliated, trace vein associated/in vein MR, trace disseminations & scattered crystals PO, trace blebs PY 483.60 484.85 FELSIC DYKE(PURPLISH/WHITE), almandine garnet, foliated 488.72 488.82 SERICITICALLY ALTERED(+10%)+/- PLAG PHENOS, sericite, foliated 491.20 492.10 SERICITICALLY ALTERED(+10%)+/- PLAG PHENOS, sericite, foliated 493.26 493.85 MASSIVE MAFIC FLOW(<1%bt), biotite, foliated 495.40 496.21 MASSIVE MAFIC FLOW(<1%bt), biotite, chlorite, foliated 497.65 498.20 INTERMEDIATE DYKE(PURPLISH/BROWN), almandine garnet, foliated 500.30 500.55 SERICITICALLY ALTERED(+10%)+/- PLAG PHENOS, sericite, foliated 500.72 502.18 SERICITICALLY ALTERED(+10%)+/- PLAG PHENOS, sericite, foliated 505.80 506.30 SERICITICALLY ALTERED(+10%)+/- PLAG PHENOS, sericite, foliated 520.60 522.50 INTERMEDIATE DYKE(PURPLISH/BROWN), foliated 524.60 525.30 MASSIVE MAFIC FLOW(<1%bt), foliated 533.80 534.25 MAFIC DYKE(GREENISH), foliated 541.15 542.50 INTERMEDIATE DYKE(PURPLISH/BROWN), almandine garnet, foliated 543.05 544.75 INTERMEDIATE DYKE(PURPLISH/BROWN), foliated 548.40 550.35 INTERMEDIATE DYKE(PURPLISH/BROWN), almandine garnet, foliated 554.00 556.50 FELSIC DYKE(PURPLISH/WHITE), foliated 557.30 558.30 INTERMEDIATE DYKE(PURPLISH/BROWN), foliated 558.30 558.90 MASSIVE MAFIC FLOW(<1%bt), foliated, Amygdaloidal 558.90 560.93 MAFIC DYKE(GREENISH), foliated
560.93	578.00	GABBROIC DYKE;DISTINCT MED-CRSE GRAINED INTRUSIVE, foliated, trace blebs CP, trace blebs MR, 00.5-2% disseminations & scattered crystals PO 563.00 565.00 FELSIC DYKE(PURPLISH/WHITE), almandine garnet, foliated 574.95 575.70 INTERMEDIATE DYKE(PURPLISH/BROWN), almandine garnet, foliated
578.00	582.60	INTERMEDIATE DYKE(PURPLISH/BROWN), almandine garnet, foliated

From	To	Geology
582.60	602.20	GABBROIC DYKE;DISTINCT MED-CRSE GRAINED INTRUSIVE, foliated, trace blebs CP, trace blebs MR, 00.5-2% disseminations & scattered crystals PO, trace blebs PY 588.70 589.70 FELSIC DYKE(PURPLISH/WHITE), hematite, foliated 601.85 602.20 INTERMEDIATE DYKE(PURPLISH/BROWN), foliated
602.20	604.50	MASSIVE MAFIC FLOW(<1%bt), foliated 602.90 604.38 INTERMEDIATE DYKE(PURPLISH/BROWN), foliated
604.50	608.75	INTERMEDIATE DYKE(PURPLISH/BROWN), foliated, trace fracture filling AB, trace blebs PO, trace microveins QV
608.75	609.25	MASSIVE MAFIC FLOW(<1%bt), foliated 609.45 609.95 SERICITICALLY ALTERED(+10%)+/- PLAG PHENOS, sericite, foliated
609.25	623.05	PILLOWED FLOW, pillowed, foliated 620.40 620.74 FELSIC DYKE(PURPLISH/WHITE), foliated 620.90 621.15 FELSIC DYKE(PURPLISH/WHITE), foliated 621.25 623.05 FELSIC DYKE(PURPLISH/WHITE), Porphyritic, foliated
623.05	627.90	INTERMEDIATE DYKE(PURPLISH/BROWN), foliated, trace vein associated/in vein AB, 00.5-2% pervasive BI
627.90	638.74	FELSIC DYKE(PURPLISH/WHITE), Porphyritic, Fractured, foliated, fairly fractured, 00.3-0.5% vein associated/in vein AB, trace vein associated/in vein CB, trace pervasive KF, trace blebs PO, 00.3-0.5% microveins QV 627.90 628.55 MASSIVE MAFIC FLOW(<1%bt), foliated 632.85 633.40 INTERMED DYKE WITH CHLORITIC PHENOCRYSTS, chlorite, Porphyritic, foliated 633.55 635.50 INTERMED DYKE WITH CHLORITIC PHENOCRYSTS, chlorite, Porphyritic, foliated 638.25 638.74 INTERMEDIATE DYKE(PURPLISH/BROWN), foliated
638.74	652.35	MASSIVE MAFIC FLOW(<1%bt), Fractured, foliated, extremely well fractured, trace vein associated/in vein CB, trace blebs PO, trace specks PY, trace microveins QV 639.10 639.45 FELSIC DYKE(PURPLISH/WHITE), foliated 640.32 640.90 FELSIC DYKE(PURPLISH/WHITE), almandine garnet, foliated 642.05 643.85 FELSIC DYKE(PURPLISH/WHITE), almandine garnet, foliated 646.65 647.55 FELSIC DYKE(PURPLISH/WHITE), Fractured, foliated 647.55 649.20 PLAG PORPH INTERMEDIATE DYKE, plagioclase, hematite, foliated, Porphyritic 651.00 652.35 PLAG PORPH INTERMEDIATE DYKE, plagioclase, hematite, foliated, Porphyritic
652.35	664.75	FAULT ZONE;+/- CHLORITIC GOUGE, Fractured 651.75 652.20 FELSIC DYKE(PURPLISH/WHITE), Fractured 652.35 655.00 MASSIVE MAFIC FLOW(<1%bt), Fractured, foliated 655.00 656.75 FELSIC DYKE(PURPLISH/WHITE), hematite, Fractured 656.75 657.30 MASSIVE MAFIC FLOW(<1%bt) 657.30 658.50 FELSIC DYKE(PURPLISH/WHITE), hematite, Fractured 658.80 659.12 FELSIC DYKE(PURPLISH/WHITE), hematite, Fractured 659.12 662.70 MASSIVE MAFIC FLOW(<1%bt), Fractured, foliated 662.70 663.68 INTERMEDIATE DYKE(PURPLISH/BROWN), foliated, 00.5-2% disseminations & scattered crystals PO 663.68 664.75 GABBROIC DYKE;DISTINCT MED-CRSE GRAINED INTRUSIVE, chlorite, foliated
664.75	681.65	MASSIVE MAFIC FLOW(<1%bt), foliated 664.75 667.45 INTERMEDIATE DYKE(PURPLISH/BROWN), foliated, 00.3-0.5% blebs PY 667.45 669.67 FELSIC DYKE(PURPLISH/WHITE), Fractured, foliated 672.68 673.82 FELSIC DYKE(PURPLISH/WHITE), foliated 674.38 676.22 FELSIC DYKE(PURPLISH/WHITE), foliated 677.52 678.75 INTERMEDIATE DYKE(PURPLISH/BROWN), foliated 680.75 681.65 SERICITICALLY ALTERED(+10%)+/- PLAG PHENOS, sericite, almandine garnet, foliated
681.65	756.70	PILLOWED FLOW, pillowed, foliated, trace vein associated/in vein CB, trace blebs MR, trace blebs PO, trace microveins QV 688.40 689.87 INTERMEDIATE DYKE(PURPLISH/BROWN), almandine garnet, foliated 689.87 690.45 MAFIC DYKE(GREENISH), foliated 692.39 693.05 WEAK POTASSIC PILLOW FLOW(1-5%K), foliated, pillowed 693.05 693.41 INTERMEDIATE DYKE(PURPLISH/BROWN), foliated 693.90 695.53 SERICITICALLY ALTERED(+10%)+/- PLAG PHENOS, sericite, foliated 697.10 697.56 INTERMEDIATE DYKE(PURPLISH/BROWN), almandine garnet, foliated 697.95 698.32 SERICITICALLY ALTERED(+10%)+/- PLAG PHENOS, sericite, foliated 698.32 700.15 INTERMEDIATE DYKE(PURPLISH/BROWN), almandine garnet, foliated 700.36 701.40 INTERMEDIATE DYKE(PURPLISH/BROWN), foliated

From	To	Geology
		701.90 702.55 FELSIC DYKE(PURPLISH/WHITE), foliated 705.00 705.30 ULTRAMAFIC INTRUSIVE, foliated 705.75 706.05 ULTRAMAFIC INTRUSIVE, actinolite, foliated 706.35 707.10 INTERMEDIATE DYKE(PURPLISH/BROWN), almandine garnet, foliated 707.60 710.90 ULTRAMAFIC INTRUSIVE, actinolite, foliated 712.55 714.27 INTERMEDIATE DYKE(PURPLISH/BROWN), almandine garnet, foliated 716.25 717.18 FELSIC DYKE(PURPLISH/WHITE), almandine garnet, sericite, foliated 717.18 717.56 ULTRAMAFIC INTRUSIVE, actinolite, foliated 717.56 720.10 FELSIC DYKE(PURPLISH/WHITE), almandine garnet, sericite, foliated 720.10 721.65 INTERMEDIATE DYKE(PURPLISH/BROWN), foliated 722.85 723.85 INTERMEDIATE DYKE(PURPLISH/BROWN), foliated 725.89 726.45 INTERMEDIATE DYKE(PURPLISH/BROWN), foliated 729.65 730.46 FELSIC DYKE(PURPLISH/WHITE), almandine garnet, foliated 731.87 732.25 ULTRAMAFIC INTRUSIVE, actinolite, foliated 732.90 733.50 INTERMED DYKE WITH CHLORITIC PHENOCRYSTS, chlorite, plagioclase, Porphyritic, foliated 733.84 735.80 FELSIC DYKE(PURPLISH/WHITE), almandine garnet, foliated 735.99 736.18 FELSIC DYKE(PURPLISH/WHITE), almandine garnet, foliated 737.60 738.58 ULTRAMAFIC INTRUSIVE, actinolite, foliated 751.03 752.35 FELSIC DYKE(PURPLISH/WHITE), foliated
756.70	760.55	INTERMEDIATE DYKE(PURPLISH/BROWN), foliated, 00.5-2% disseminations & scattered crystals PY
760.55	827.00	PILLOWED FLOW, pillowed, foliated, 00.3-0.5% bands and layering BI, 00.3-0.5% vein associated/in vein CB, trace blebs MR, trace blebs PO, trace blebs PY 760.80 762.90 GABBROIC DYKE;DISTINCT MED-CRSE GRAINED INTRUSIVE, albite, Porphyritic, foliated 772.45 773.21 PLAG PORPH MAFIC DYKE, albite, Porphyritic, foliated 773.21 773.60 ULTRAMAFIC INTRUSIVE, actinolite, foliated 774.62 775.75 MAFIC DYKE WITH CHLORITIC PHENOS, chlorite, Porphyritic, foliated 776.20 777.18 SERICITICALLY ALTERED(+10%)+/- PLAG PHENOS, sericite, foliated 781.57 782.15 INTERMEDIATE DYKE(PURPLISH/BROWN), foliated 787.33 789.65 INTERMEDIATE DYKE(PURPLISH/BROWN), biotite, foliated 803.95 804.80 FELSIC DYKE(PURPLISH/WHITE), hematite, Fractured 809.75 810.55 SERICITICALLY ALTERED(+10%)+/- PLAG PHENOS, sericite, foliated 810.55 811.25 INTERMEDIATE DYKE(PURPLISH/BROWN) 812.93 813.62 ULTRAMAFIC INTRUSIVE 813.62 814.90 INTERMEDIATE DYKE(PURPLISH/BROWN) 816.55 816.95 INTERMEDIATE DYKE(PURPLISH/BROWN) 818.95 819.80 INTERMEDIATE DYKE(PURPLISH/BROWN) 820.35 821.35 INTERMEDIATE DYKE(PURPLISH/BROWN), foliated 825.25 827.00 INTERMEDIATE DYKE(PURPLISH/BROWN)
827.00	863.80	PILLOWED FLOW, VARIOLITIC, foliated, pillowed, 00.3-0.5% vein associated/in vein CB, trace blebs CP, trace blebs PO, trace specks PY 835.10 838.45 MASSIVE MAFIC FLOW(<1%bt), foliated 845.94 846.12 FELSIC DYKE(PURPLISH/WHITE), foliated 846.20 846.90 INTERMEDIATE DYKE(PURPLISH/BROWN), foliated 846.90 847.35 FELSIC DYKE(PURPLISH/WHITE), foliated 851.95 852.95 INTERMEDIATE DYKE(PURPLISH/BROWN), foliated 857.90 858.42 INTERMEDIATE DYKE(PURPLISH/BROWN), foliated 861.60 863.37 GABBROIC DYKE;DISTINCT MED-CRSE GRAINED INTRUSIVE, foliated, 00.3-0.5% microveins QV 863.37 863.80 INTERMEDIATE DYKE(PURPLISH/BROWN), foliated
863.80	867.20	CHLORITIC GREENSTONE;+50% CHLORITE ALTERATION;MINOR TALC, chlorite, biotite, foliated, Banded, 00.5-2% vein associated/in vein AB, 20% bands and layering BI, 60% pervasive CL, trace blebs PO, trace crystals and/or phenocrysts PY, 00.5-2% microveins QV 865.40 865.78 FELSIC DYKE(PURPLISH/WHITE), albite, foliated
867.20	904.38	SERICITICALLY ALTERED(+10%)+/- PLAG PHENOS, sericite, foliated, 00.3-0.5% fracture filling AB, trace microveins QV 870.15 870.40 CHLORITIC GREENSTONE;+50% CHLORITE ALTERATION;MINOR TALC, chlorite, biotite, foliated 873.52 874.02 CHLORITIC GREENSTONE;+50% CHLORITE ALTERATION;MINOR TALC, foliated 874.02 875.75 FELSIC DYKE(PURPLISH/WHITE), hematite, foliated 876.06 876.73 FELSIC DYKE(PURPLISH/WHITE), foliated 876.73 877.35 INTERMEDIATE DYKE(PURPLISH/BROWN), biotite, foliated 879.85 880.03 CHLORITIC GREENSTONE;+50% CHLORITE ALTERATION;MINOR TALC, biotite, chlorite,

From	To	Geology
		<p>foliated</p> <p>881.90 883.25 CHLORITIC GREENSTONE;+50% CHLORITE ALTERATION;MINOR TALC, biotite, chlorite, foliated, 00.3-0.5% blebs PO</p> <p>883.25 883.72 FELSIC DYKE(PURPLISH/WHITE), Fractured, foliated</p> <p>883.92 884.24 ULTRAMAFIC INTRUSIVE, actinolite, foliated</p> <p>884.24 885.00 INTERMEDIATE DYKE(PURPLISH/BROWN), foliated</p> <p>885.00 885.35 FELSIC DYKE(PURPLISH/WHITE), Fractured, foliated</p> <p>885.35 886.88 INTERMEDIATE DYKE(PURPLISH/BROWN), foliated</p> <p>888.00 889.60 FELSIC DYKE(PURPLISH/WHITE), sericite, foliated</p> <p>889.60 891.89 CHLORITIC GREENSTONE;+50% CHLORITE ALTERATION;MINOR TALC, chlorite, foliated</p> <p>891.89 892.24 INTERMEDIATE DYKE(PURPLISH/BROWN), foliated</p> <p>892.24 893.00 FELSIC DYKE(PURPLISH/WHITE), sericite, foliated</p> <p>893.00 893.95 CHLORITIC GREENSTONE;+50% CHLORITE ALTERATION;MINOR TALC, chlorite, foliated</p> <p>893.95 894.30 FELSIC DYKE(PURPLISH/WHITE), foliated</p> <p>894.30 894.80 CHLORITIC GREENSTONE;+50% CHLORITE ALTERATION;MINOR TALC, chlorite, foliated</p> <p>894.80 895.50 FELSIC DYKE(PURPLISH/WHITE), foliated</p> <p>895.50 896.90 CHLORITIC GREENSTONE;+50% CHLORITE ALTERATION;MINOR TALC, chlorite, foliated, 00.3-0.5% veins QV</p> <p>901.80 903.00 CHLORITIC GREENSTONE;+50% CHLORITE ALTERATION;MINOR TALC, chlorite, foliated</p> <p>903.00 904.38 INTERMEDIATE DYKE(PURPLISH/BROWN), foliated</p>
904.38	917.85	<p>ULTRAMAFIC INTRUSIVE, actinolite, foliated</p> <p>908.54 908.80 FELSIC DYKE(PURPLISH/WHITE), foliated</p> <p>914.30 915.20 FELSIC DYKE(PURPLISH/WHITE), foliated</p> <p>915.35 915.68 FELSIC DYKE(PURPLISH/WHITE), foliated</p> <p>917.30 917.85 FELSIC DYKE(PURPLISH/WHITE), foliated</p>
917.85	928.12	<p>CHLORITIC GREENSTONE;+50% CHLORITE ALTERATION;MINOR TALC, chlorite, biotite, foliated</p> <p>918.00 918.42 FELSIC DYKE(PURPLISH/WHITE), foliated</p> <p>918.68 919.12 FELSIC DYKE(PURPLISH/WHITE), foliated</p> <p>919.65 921.35 INTERMEDIATE DYKE(PURPLISH/BROWN), foliated</p> <p>921.54 922.68 INTERMEDIATE DYKE(PURPLISH/BROWN), foliated</p> <p>922.68 923.45 FELSIC DYKE(PURPLISH/WHITE), foliated</p> <p>923.45 923.95 INTERMEDIATE DYKE(PURPLISH/BROWN), foliated</p> <p>923.95 924.58 FELSIC DYKE(PURPLISH/WHITE), foliated</p> <p>925.80 927.55 INTERMEDIATE DYKE(PURPLISH/BROWN), foliated</p> <p>927.65 928.12 FELSIC DYKE(PURPLISH/WHITE), foliated</p>
928.12	964.55	<p>PILLOWED FLOW, pillowed, foliated, 00.3-0.5% bands and layering BI, trace vein associated/in vein CB, trace blebs CP, trace blebs PO, trace microveins QV</p> <p>932.25 933.52 INTERMEDIATE DYKE(PURPLISH/BROWN), foliated</p> <p>934.62 935.05 INTERMEDIATE DYKE(PURPLISH/BROWN), foliated</p> <p>936.11 938.50 INTERMEDIATE DYKE(PURPLISH/BROWN), foliated</p> <p>938.70 939.74 INTERMEDIATE DYKE(PURPLISH/BROWN), foliated</p> <p>939.74 940.14 GABBROIC DYKE;DISTINCT MED-CRSE GRAINED INTRUSIVE, foliated</p> <p>946.25 947.20 ULTRAMAFIC INTRUSIVE, actinolite, foliated</p> <p>949.15 949.40 INTERMEDIATE DYKE(PURPLISH/BROWN), foliated</p> <p>949.40 951.35 ULTRAMAFIC INTRUSIVE, actinolite, foliated</p> <p>955.32 956.30 ULTRAMAFIC INTRUSIVE, actinolite, foliated</p> <p>956.47 958.30 ULTRAMAFIC INTRUSIVE, actinolite, foliated</p> <p>958.30 958.61 INTERMEDIATE DYKE(PURPLISH/BROWN), foliated</p> <p>958.61 960.95 ULTRAMAFIC INTRUSIVE, actinolite, foliated</p> <p>964.20 964.55 ULTRAMAFIC INTRUSIVE, actinolite, foliated</p>
964.55	974.95	<p>MASSIVE MAFIC FLOW(&lt;1%bt), foliated, 20% pervasive CL, trace blebs PY, trace microveins QV</p> <p>972.33 972.98 GABBROIC DYKE;DISTINCT MED-CRSE GRAINED INTRUSIVE, foliated</p>
974.95	991.00	<p>PILLOWED FLOW, foliated, pillowed, trace vein associated/in vein AB, trace vein associated/in vein CB, trace blebs PO, trace stringers QV</p> <p>974.95 976.15 FELSIC DYKE(PURPLISH/WHITE), foliated</p>
991.00	1003.60	<p>MASSIVE MAFIC FLOW(&lt;1%bt), foliated, 00.5-2% vein associated/in vein CB, 20% pervasive CL, trace blebs PO, trace stringers QV</p> <p>991.00 992.30 INTERMEDIATE DYKE(PURPLISH/BROWN), foliated</p> <p>994.68 995.51 INTERMEDIATE DYKE(PURPLISH/BROWN), foliated</p> <p>995.51 996.87 ULTRAMAFIC INTRUSIVE, foliated</p> <p>1002.22 1003.60 INTERMEDIATE DYKE(PURPLISH/BROWN), foliated</p>

From	To	Geology
1003.60	1053.61	PILLOWED FLOW, pillowed, foliated, 00.5-2% vein associated/in vein CB, 20% pervasive CL, trace blebs PO, 00.5-2% microveins QV 1004.47 1005.20 INTERMEDIATE DYKE(PURPLISH/BROWN), foliated 1006.80 1008.30 INTERMED DYKE WITH CHLORITIC PHENOCRYSTS, chlorite, plagioclase, foliated, Porphyritic 1009.85 1010.74 INTERMEDIATE DYKE(PURPLISH/BROWN), foliated 1016.38 1017.80 INTERMEDIATE DYKE(PURPLISH/BROWN), foliated 1017.90 1020.30 INTERMEDIATE DYKE(PURPLISH/BROWN), foliated 1028.28 1029.40 INTERMEDIATE DYKE(PURPLISH/BROWN), foliated 1035.90 1037.03 FELSIC DYKE(PURPLISH/WHITE), almandine garnet, foliated 1037.50 1038.90 FELSIC DYKE(PURPLISH/WHITE), foliated 1039.15 1041.10 FELSIC DYKE(PURPLISH/WHITE), foliated 1044.03 1044.31 PLAG PORPH FELSIC DYKE(+Kf+/- hem matrix), plagioclase, almandine garnet, Porphyritic, foliated
1053.61	1057.50	FELSIC DYKE(PURPLISH/WHITE), sericite, almandine garnet, foliated
1057.50	1071.82	PILLOWED FLOW, pillowed, foliated, trace blebs PO, trace specks PY, trace microveins QV 1057.50 1057.87 MAFIC DYKE(GREENISH), biotite, foliated 1058.15 1058.56 INTERMEDIATE DYKE(PURPLISH/BROWN), foliated 1059.05 1060.27 FELSIC DYKE(PURPLISH/WHITE), almandine garnet, foliated 1064.85 1065.50 FELSIC DYKE(PURPLISH/WHITE), foliated 1071.45 1071.82 FELSIC DYKE(PURPLISH/WHITE), foliated
1071.82	1095.87	MASSIVE MAFIC FLOW(<1%bt), foliated, 10% pervasive BI, trace vein associated/in vein CB 1079.97 1080.53 MAFIC DYKE(GREENISH), biotite, foliated 1084.18 1085.20 FELSIC DYKE(PURPLISH/WHITE), almandine garnet, foliated 1093.20 1094.35 FELSIC DYKE(PURPLISH/WHITE), almandine garnet, foliated 1094.35 1095.62 GABBROIC DYKE;DISTINCT MED-CRSE GRAINED INTRUSIVE, biotite, foliated
1095.87	1111.00	PILLOWED FLOW, pillowed, foliated, 00.3-0.5% bands and layering BI, trace vein associated/in vein CB, trace blebs PO, trace blebs PY, trace microveins QV 1097.28 1098.20 INTERMEDIATE DYKE(PURPLISH/BROWN), biotite, foliated 1100.15 1100.70 INTERMEDIATE DYKE(PURPLISH/BROWN), foliated 1103.60 1103.97 MAFIC DYKE(GREENISH), foliated 1106.20 1106.81 INTERMEDIATE DYKE(PURPLISH/BROWN), foliated, trace specks PY, 00.3-0.5% microveins QV 1110.65 1111.00 GABBROIC DYKE;DISTINCT MED-CRSE GRAINED INTRUSIVE, biotite, foliated
1111.00	1123.00	MASSIVE MAFIC FLOW(<1%bt), foliated, trace bands and layering BI, trace blebs PO, trace crystals and/or phenocrysts PY, trace microveins QV
1123.00	1152.45	GABBROIC DYKE;DISTINCT MED-CRSE GRAINED INTRUSIVE, hornblende, biotite, foliated, 2-4% interstitial BI, trace blebs PO, trace veins QV 1137.50 1138.70 WEAK POTASSIC PILLOW FLOW(1-5%K), biotite, foliated, pillowed, trace blebs PO, trace microveins QV 1142.87 1145.98 WEAK POTASSIC PILLOW FLOW(1-5%K), biotite, foliated, pillowed, trace blebs PO, trace specks PY, 00.5-2% veins QV 1151.10 1152.45 PLAG PORPH MAFIC DYKE, foliated, Porphyritic
1152.45	1157.60	WEAK POTASSIC PILLOW FLOW(1-5%K), pillowed, foliated, trace blebs PO, trace crystals and/or phenocrysts PY, trace microveins QV
1157.60	1205.00	GABBROIC DYKE;DISTINCT MED-CRSE GRAINED INTRUSIVE, hornblende, Coarse Grained, trace specks PY, trace veins QV 1159.20 1160.60 WEAK POTASSIC PILLOW FLOW(1-5%K), pillowed, foliated, trace blebs PO, trace microveins QV 1163.00 1164.85 WEAK POTASSIC PILLOW FLOW(1-5%K), pillowed, foliated, trace stringers QV
1205.00		** END OF HOLE **

## LEGEND

CP	CHALCOPYRITE
MR	MARCASITE
PO	PYRRHOTITE
PY	PYRITE
BI\bt)	BIOTITE
CB	CARBONATE
EP	EPIDOTE
AB	ALBITE
CL	CHLORITE
QZ	QUARTZ
HEM	HEMATITE
Kf	POTASSIUM FELDSPAR
K	POTASSIC ALTERATION
QV	QUARTZ VEIN
FO	FOLIATION

\*\*\* DETOUR LAKE MINEX \*\*\*  
PLACER DOME CANADA LIMITED

Drill Hole: 464-110

Northing : 21070.00  
Easting : 15400.00  
Elevation : 6280.00  
Hole Depth : 356.40mt

Project ID : 464  
Core Size : NQ  
Date Logged : 23JUN96  
Logged By : RKM  
Assisted by :

MINING CLAIM NUMBER: CLM 229  
DRILLING STARTED: JUNE 18, 1996  
DRILLING COMPLETED: JUNE 22, 1996  
DRILLING CONTRACTOR: BRADLEY DIAMOND DRILLING  
DRILL CORE STORAGE LOCATION: DETOUR LAKE MINE  
LOGGING STARTED: JUNE 23, 1996  
LOGGING COMPLETED: JUNE 26, 1996  
LOGGED BY: RYAN MCEACHERN



Drill Hole Survey Data

Depth	Azimuth	Dip
Collar	180.00	-82.00
29.00mt	184.00	-81.50
80.00mt	178.00	-81.00
131.00mt	169.00	-80.50
182.00mt	172.00	-80.00
253.00mt	163.00	-79.00
284.00mt	162.00	-77.00
335.00mt	163.00	-73.00

From	To	Geology
0.00	19.00	OVERBURDEN
19.00	69.58	PILLOWED FLOW 50.70 52.67 PLAG PORPH MAFIC DYKE, foliated, Porphyritic, 60 FO , trace disseminations & scattered crystals PY, trace microveins QV 53.55 54.17 MAFIC DYKE(GREENISH), foliated, Fine Grained, 28 FO , trace microveins QV 54.54 54.84 FELSIC DYKE(PURPLISH/WHITE), foliated, 55 FO , trace disseminations & scattered crystals PY, trace microveins QV 55.52 55.87 INTERMEDIATE DYKE(PURPLISH/BROWN), foliated, Fine Grained, 55 FO , trace disseminations & scattered crystals PY, trace microveins QV 55.87 56.48 GABBROIC DYKE;DISTINCT MED-CRSE GRAINED INTRUSIVE, foliated, Medium Grained, 40 FO , trace disseminations & scattered crystals PY, trace microveins QV 56.48 56.82 INTERMEDIATE DYKE(PURPLISH/BROWN), foliated, Fine Grained, 40 FO , trace disseminations & scattered crystals PY, trace microveins QV 59.88 60.97 PLAG PORPH MAFIC DYKE, foliated, Porphyritic, 55 FO , trace wisp PY 60.97 61.32 GABBROIC DYKE;DISTINCT MED-CRSE GRAINED INTRUSIVE, foliated, Medium Grained, 35 FO , trace disseminations & scattered crystals PY 65.44 65.86 FELSIC DYKE(PURPLISH/WHITE), foliated, 50 FO , trace vein associated/in vein PY, trace microveins QV 65.86 67.97 FELSIC DYKE(PURPLISH/WHITE), foliated, 75 FO , trace microveins QV
69.58	78.08	MASSIVE MAFIC FLOW(<1%bt), foliated, Medium Grained, slightly fractured 46 FO , trace patches, as in quilts CL, trace QV 74.16 74.46 MAFIC DYKE(GREENISH), foliated, Medium Grained, 55 FO , trace blebs QV 77.00 78.08 GABBROIC DYKE;DISTINCT MED-CRSE GRAINED INTRUSIVE, foliated, Medium Grained, 40 FO , trace vein associated/in vein PY, trace blebs QV
78.08	82.20	PILLOWED FLOW, foliated, pillowed, slightly fractured 55 FO , trace bands and layering BI, trace selvages PY, trace microveins QV
82.20	85.60	PILLOWED FLOW, foliated, pillowed, very lightly fractured 60 FO , trace selvages CL, trace selvages KF, trace selvages PY, trace microveins QV
85.60	101.02	MASSIVE MAFIC FLOW(<1%bt), foliated, Medium Grained, very lightly fractured 50 FO , trace vein associated/in vein CP, trace vein associated/in vein PO, trace vein associated/in vein PY, trace blebs QV 89.27 89.65 PLAG PORPH MAFIC DYKE, Porphyritic, foliated, 62 FO , trace patches, as in quilts PO, trace patches, as in quilts PY, trace microveins QV
101.02	115.37	ULTRAMAFIC INTRUSIVE, Porphyritic, Medium Grained, lightly fractured 45 FO , 5-7% disseminations & scattered crystals MG, trace vein associated/in vein PO, trace blebs QV 109.73 113.00 SERICITICALLY ALTERED(+10%)+/- PLAG PHENOS, foliated, 35 FO , trace wisp PO,

From	To	Geology
		trace wisp PY, trace microveins QV
115.37	118.55	FELSIC DYKE(PURPLISH/WHITE), foliated, 50 FO very lightly fractured, trace disseminations & scattered crystals PY
118.55	168.20	ULTRAMAFIC INTRUSIVE, Medium Grained, foliated, 55 FO lightly fractured, 10% disseminations & scattered crystals MG, trace fracture filling QV 118.55 119.46 INTERMEDIATE DYKE(PURPLISH/BROWN), foliated, 50 FO 129.00 132.43 ULTRAMAFIC INTRUSIVE, Medium Grained, foliated, 35 FO 132.43 135.45 FELSIC DYKE(PURPLISH/WHITE), foliated, 60 FO 144.23 144.68 CHLORITIC GREENSTONE;+50% CHLORITE ALTERATION;MINOR TALC, foliated, 23 FO 144.68 145.40 FELSIC DYKE(PURPLISH/WHITE), foliated, 25 FO 5-7% microveins QV 145.40 145.83 MAFIC DYKE(GREENISH), Fine Grained, foliated, 55 FO 145.83 146.17 FELSIC DYKE(PURPLISH/WHITE), foliated, 65 FO 156.16 156.70 MAFIC DYKE(GREENISH), Fine Grained, foliated, 55 FO 156.90 157.35 MAFIC DYKE(GREENISH), Fine Grained, foliated, 55 FO trace vein associated/in vein PO, trace blebs QV 157.35 158.00 ULTRAMAFIC INTRUSIVE, foliated, 30 FO 160.58 160.95 ULTRAMAFIC INTRUSIVE, foliated, 45 FO 164.40 165.04 ULTRAMAFIC INTRUSIVE, foliated, 43 FO
168.20	181.00	MASSIVE MAFIC FLOW(<1%bt), Medium Grained, foliated, 40 FO very lightly fractured, trace vein associated/in vein PY, trace microveins QV 178.13 179.39 INTERMED DYKE WITH CHLORITIC PHENOCRYSTS
181.00	247.50	MASSIVE MAFIC FLOW(<1%bt), foliated, 60 FO lightly fractured, trace microveins AB, trace vein associated/in vein PO, trace vein associated/in vein PY, 00.5-2% QV 194.12 196.00 INTERMEDIATE DYKE(PURPLISH/BROWN), foliated, 67 FO 00.5-2% disseminations & scattered crystals PY, 00.5-2% QV 196.33 196.80 INTERMEDIATE DYKE(PURPLISH/BROWN), foliated, 60 FO 00.3-0.5% disseminations & scattered crystals PY, trace veins QV 199.23 199.73 ULTRAMAFIC INTRUSIVE, Medium Grained, foliated, 53 FO 207.80 208.30 FAULT ZONE;+/- CHLORITIC GOUGE 208.51 209.00 MAFIC DYKE(GREENISH), Fine Grained, foliated, 61 FO trace microveins QV 220.61 221.11 INTERMEDIATE DYKE(PURPLISH/BROWN), Fine Grained, foliated, 68 FO 221.67 222.03 INTERMEDIATE DYKE(PURPLISH/BROWN), Fine Grained, foliated, 62 FO 234.86 235.19 GABBROIC DYKE;DISTINCT MED-CRSE GRAINED INTRUSIVE, Medium Grained, foliated, 57 FO trace vein associated/in vein PY, trace veins QV 236.34 237.20 INTERMED DYKE WITH CHLORITIC PHENOCRYSTS, Porphyritic, foliated, 64 FO trace microveins QV 239.00 240.76 GABBROIC DYKE;DISTINCT MED-CRSE GRAINED INTRUSIVE, Medium Grained, foliated, 51 FO trace vein associated/in vein PO, trace vein associated/in vein PY, 00.5-2% microveins QV 240.76 242.28 CHLORITIC GREENSTONE;+50% CHLORITE ALTERATION;MINOR TALC, foliated, 00.5-2% disseminations & scattered crystals PO, 00.5-2% disseminations & scattered crystals PY, 10% blebs QV 241.28 241.64 INTERMEDIATE DYKE(PURPLISH/BROWN), Fine Grained, foliated, 65 FO trace microveins QV 241.64 242.10 CHLORITIC GREENSTONE;+50% CHLORITE ALTERATION;MINOR TALC, foliated, 00.5-2% disseminations & scattered crystals PO, 00.5-2% disseminations & scattered crystals PY, 10% blebs QV
247.50	299.84	MASSIVE MAFIC FLOW(<1%bt), Fine Grained, foliated, 55 FO very lightly fractured, trace vein associated/in vein PO, trace vein associated/in vein PY, 00.5-2% QV 249.92 250.46 FELSIC DYKE(PURPLISH/WHITE), foliated, 35 FO trace disseminations & scattered crystals PY, trace microveins QV 254.00 254.54 FAULT ZONE;+/- CHLORITIC GOUGE, Fragmental, 60 FO 257.28 257.70 FELSIC DYKE(PURPLISH/WHITE), foliated, 50 FO trace disseminations & scattered crystals PY, trace microveins QV 259.13 260.68 ULTRAMAFIC INTRUSIVE, Medium Grained, foliated, 60 FO 263.81 264.60 FELSIC DYKE(PURPLISH/WHITE), foliated, 50 FO trace disseminations & scattered crystals PY, trace microveins QV 274.66 275.17 FELSIC DYKE(PURPLISH/WHITE), foliated, 52 FO trace wisp PY, trace microveins QV 280.40 280.80 FAULT ZONE;+/- CHLORITIC GOUGE 283.00 284.02 PLAG PORPH MAFIC DYKE, Porphyritic, foliated, 55 FO trace vein associated/in vein PY, trace microveins QV
299.84	313.40	PILLOWED FLOW, VARIOLITIC, pillowed, foliated, 45 FO very lightly fractured, trace selvages BI, trace vein associated/in vein PY, 00.3-0.5% veins QV 301.18 302.79 PLAG PORPH INTERMEDIATE DYKE, 35 FO



From	To	Geology
313.40	329.23	WEAK POTASSIC PILLOW FLOW(1-5%K), pillowed, foliated, 40 FO slightly fractured, 00.5-2% selvages BI, trace vein associated/in vein PO, trace vein associated/in vein PY, 00.5-2% QV 316.51 316.90 INTERMED DYKE WITH CHLORITIC PHENOCRYSTS, Porphyritic, foliated, 65 FO trace blebs QV 317.50 320.04 INTERMED DYKE WITH CHLORITIC PHENOCRYSTS, Porphyritic, foliated, 60 FO trace vein associated/in vein PY, trace microveins QV 320.04 320.95 INTERMEDIATE DYKE(PURPLISH/BROWN), Fine Grained, foliated, 60 FO trace vein associated/in vein PO, trace vein associated/in vein PY, trace QV
329.23	349.88	PILLOWED FLOW, pillowed, foliated, 42 FO slightly fractured, trace vein associated/in vein BI, trace vein associated/in vein PO, trace vein associated/in vein PY, trace QV 333.49 333.83 INTERMED DYKE WITH CHLORITIC PHENOCRYSTS, Porphyritic, foliated, 62 FO trace vein associated/in vein PY, trace microveins QV 333.83 338.20 GABBROIC DYKE;DISTINCT MED-CRSE GRAINED INTRUSIVE, Medium Grained, foliated, 49 FO trace vein associated/in vein PY, 00.5-2% QV 349.41 349.88 INTERMEDIATE DYKE(PURPLISH/BROWN), Porphyritic, foliated, 48 FO
349.88	356.40	MASSIVE MAFIC FLOW(<1%bl), VARIOLITIC, foliated, 55 FO not fractured, trace vein associated/in vein PY, 00.5-2% QV 351.90 352.50 PLAG PORPH INTERMEDIATE DYKE, Porphyritic, foliated, 65 FO trace vein associated/in vein PY, trace blebs QV
356.40		** END OF HOLE **

\*\*\* DETOUR LAKE MINEX \*\*\*  
PLACER DOME CANADA LIMITED

Drill Hole: 464-110A

Northing : 21070.00  
Easting : 15400.00  
Elevation : 6280.00  
Hole Depth : 705.55mt

Project ID : 464  
Core Size : NQ  
Date Logged : 26JUN96  
Logged By : YEB  
Assisted by :

MINING CLAIM NUMBER: CLM 229  
DRILLING STARTED: JUNE 23, 1996  
DRILLING COMPLETED: JULY 7, 1996  
DRILLING CONTRACTOR: BRADLEY BROTHERS LIMITED  
DRILL CORE STORAGE LOCATION: DETOUR LAKE MINE  
LOGGING STARTED: JUNE 26, 1996  
LOGGING COMPLETED: JULY 12, 1996  
LOGGED BY: RYAN MCEACHERN



Drill Hole Survey Data

Depth	Azimuth	Dip
Collar	180.00	-82.00
29.00mt	184.00	-81.50
80.00mt	178.00	-81.00
131.00mt	169.00	-80.50
182.00mt	172.00	-80.00
253.00mt	163.00	-79.00
284.00mt	162.00	-77.00
335.00mt	163.00	-73.00
296.00mt	164.00	-78.25
320.00mt	162.00	-77.00
359.00mt	163.00	-75.00
410.00mt	156.00	-74.75
461.00mt	162.00	-74.50
512.00mt	164.00	-73.50
563.00mt	164.00	-71.75
614.00mt	167.00	-70.50
668.00mt	166.00	-69.75
705.00mt	166.00	-69.25

From	To	Geology
286.40	300.12	MASSIVE MAFIC FLOW(<1%bt), Medium Grained, foliated, 48 FO very lightly fractured, trace vein associated/in vein PO, trace vein associated/in vein PY, 00.5-2% QV 293.96 294.16 INTERMEDIATE DYKE(PURPLISH/BROWN), Fine Grained, foliated, 40 FO trace clustered or grouped QV 294.75 294.90 FAULT ZONE;+/- CHLORITIC GOUGE, 30 FO 299.26 300.12 INTERMED DYKE WITH CHLORITIC PHENOCRYSTS, Porphyritic, foliated, 50 FO trace disseminations & scattered crystals PY, 00.3-0.5% microveins QV
300.12	310.50	PILLOWED FLOW, foliated, pillowed, 45 FO very lightly fractured, 00.3-0.5% selvages BI, trace patches, as in quilts PO, 00.5-2% QV
310.50	320.99	WEAK POTASSIC PILLOW FLOW(1-5%K), pillowed, foliated, 45 FO very lightly fractured, trace selvages BI, trace selvages PO, 00.3-0.5% QV 317.01 317.34 INTERMED DYKE WITH CHLORITIC PHENOCRYSTS, Porphyritic, foliated, 51 FO trace fracture filling PY, trace microveins QV
320.99	353.36	PILLOWED FLOW, foliated, pillowed, VARIOLITIC, 45 FO very lightly fractured, trace selvages BI, trace vein associated/in vein PO, trace vein associated/in vein PY, 00.5-2% QV 320.99 321.36 INTERMED DYKE WITH CHLORITIC PHENOCRYSTS, foliated, Porphyritic, 46 FO trace vein associated/in vein PY, 00.5-2% QV 325.70 326.24 INTERMED DYKE WITH CHLORITIC PHENOCRYSTS, foliated, Porphyritic, 48 FO 00.3-0.5% disseminations & scattered crystals PY, 00.3-0.5% microveins QV 338.73 339.11 INTERMEDIATE DYKE(PURPLISH/BROWN), foliated, Fine Grained, 50 FO trace disseminations & scattered crystals PY 341.80 342.29 INTERMEDIATE DYKE(PURPLISH/BROWN), foliated, Fine Grained, 60 FO trace patches, as in quilts PY, trace fracture filling QV
353.36	363.00	MASSIVE MAFIC FLOW(<1%bt), VARIOLITIC, foliated, Medium Grained, 55 FO slightly fractured, trace patches, as in quilts AB, trace vein associated/in vein PO, trace vein associated/in vein PY, 00.5-2% QV 353.36 353.60 INTERMEDIATE DYKE(PURPLISH/BROWN), foliated, Fine Grained, 60 FO 354.41 354.71 INTERMED DYKE WITH CHLORITIC PHENOCRYSTS, foliated, Porphyritic, 57 FO trace

From	To	Geology
		crystals and/or phenocrysts PY
363.00	387.70	PILLOWED FLOW, VARIOLITIC, foliated, pillowed, 50 FO trace vein associated/in vein PO, trace vein associated/in vein PY, 00.5-2% QV 366.87 367.16 INTERMEDIATE DYKE(PURPLISH/BROWN), foliated, Fine Grained, 60 FO trace vein associated/in vein PY, 10% microveins QV 370.80 371.38 INTERMEDIATE DYKE(PURPLISH/BROWN), foliated, Fine Grained, 50 FO trace vein associated/in vein PY, trace microveins QV 372.83 373.09 FELSIC DYKE(PURPLISH/WHITE), foliated, 47 FO trace fracture filling QV
387.70	398.33	PILLOWED FLOW, foliated, pillowed, 50 FO very lightly fractured, trace selvages BI, trace vein associated/in vein CP, trace vein associated/in vein PO, trace vein associated/in vein PY, 00.5-2% QV 389.53 390.90 INTERMEDIATE DYKE(PURPLISH/BROWN), foliated, Fine Grained, 35 FO trace blebs QV
398.33	404.90	MASSIVE MAFIC FLOW(<1%bt), foliated, Medium Grained, 50 FO not fractured, 00.3-0.5% bands and layering BI, 00.5-2% QV
404.90	420.30	PILLOWED FLOW, foliated, pillowed, 55 FO very lightly fractured, trace vein associated/in vein PO, trace vein associated/in vein PY, 00.3-0.5% QV 412.07 413.06 MASSIVE MAFIC FLOW(<1%bt), foliated, Medium Grained, 50 FO trace vein associated/in vein PO, trace blebs QV
420.30	432.50	PILLOWED FLOW, VARIOLITIC, foliated, pillowed, 45 FO slightly fractured, trace vein associated/in vein CP, 00.3-0.5% vein associated/in vein PO, 00.3-0.5% vein associated/in vein PY, 00.5-2% QV 421.05 421.70 FELSIC DYKE(PURPLISH/WHITE), foliated, 40 FO 2-4% microveins QV 428.32 428.72 FELSIC DYKE(PURPLISH/WHITE), foliated, 43 FO 00.5-2% microveins QV 431.71 432.16 FELSIC DYKE(PURPLISH/WHITE), foliated, 60 FO 00.5-2% QV 432.20 432.50 FELSIC DYKE(PURPLISH/WHITE), foliated, 68 FO trace disseminations & scattered crystals PY, 00.3-0.5% microveins QV
432.50	448.53	MASSIVE MAFIC FLOW(<1%bt), foliated, Medium Grained, 46 FO lightly fractured, trace vein associated/in vein PO, trace vein associated/in vein PY, 00.5-2% anastomosing QV 443.25 443.63 FELSIC DYKE(PURPLISH/WHITE), foliated, 62 FO 00.5-2% microveins QV 443.92 444.17 INTERMEDIATE DYKE(PURPLISH/BROWN), foliated, Fine Grained, 52 FO 00.5-2% disseminations & scattered crystals PY, 00.5-2% microveins QV 445.45 446.41 FELSIC DYKE(PURPLISH/WHITE), foliated, 50 FO trace disseminations & scattered crystals PY, 00.3-0.5% microveins QV 447.97 448.53 FELSIC DYKE(PURPLISH/WHITE), foliated, 48 FO trace disseminations & scattered crystals PY, 00.5-2% microveins QV
448.53	452.03	PILLOWED FLOW, VARIOLITIC, foliated, pillowed, 47 FO slightly fractured, 00.5-2% bands and layering BI, trace patches, as in quilts PO, trace patches, as in quilts PY, 00.3-0.5% QV
452.03	454.10	MASSIVE MAFIC FLOW(<1%bt), foliated, Fine Grained, 49 FO slightly fractured, 00.3-0.5% QV
454.10	486.00	PILLOWED FLOW, foliated, pillowed, 47 FO very lightly fractured, 00.3-0.5% selvages BI, trace selvages PO, trace selvages PY, 00.3-0.5% QV 454.76 455.04 FELSIC DYKE(PURPLISH/WHITE), foliated, Porphyritic, 50 FO 00.5-2% microveins QV 470.00 472.47 MAFIC DYKE(GREENISH), foliated, Medium Grained, 40 FO 00.5-2% veins QV
486.00	572.25	PILLOWED FLOW, foliated, pillowed, 55 FO very lightly fractured, trace bands and layering BI, 00.3-0.5% selvages PO, 00.3-0.5% selvages PY, 00.3-0.5% QV 486.05 488.00 FELSIC DYKE(PURPLISH/WHITE), foliated, Porphyritic, 50 FO trace clustered or grouped PO, trace microveins QV 490.34 490.71 INTERMEDIATE DYKE(PURPLISH/BROWN), foliated, 40 FO trace vein associated/in vein PY, 00.5-2% QV 490.76 491.11 FELSIC DYKE(PURPLISH/WHITE), foliated, Porphyritic, 47 FO trace microveins QV 516.61 517.43 FELSIC DYKE(PURPLISH/WHITE), foliated, 59 FO trace vein associated/in vein PY, 00.3-0.5% microveins QV 517.43 519.53 INTERMEDIATE DYKE(PURPLISH/BROWN), foliated, 40 FO trace vein associated/in vein PO, trace microveins QV 523.38 523.83 PLAG PORPH FELSIC DYKE(+Kf+/- hem matrix), foliated, Porphyritic, 39 FO 00.5-2% veins QV 532.15 533.35 INTERMEDIATE DYKE(PURPLISH/BROWN) 537.29 540.12 FELSIC DYKE(PURPLISH/WHITE), Porphyritic, foliated, 00.3-0.5% veins QV 542.52 543.75 FELSIC DYKE(PURPLISH/WHITE), Porphyritic, foliated 550.95 551.90 MAFIC DYKE(GREENISH) 554.90 556.65 SERICITICALLY ALTERED(+10%)+/- PLAG PHENOS, sericite, foliated

From	To	Geology
		562.10 564.10 PLAG PORPH MAFIC DYKE, foliated, Porphyritic 569.50 569.85 MASSIVE MAFIC FLOW(<1%bt), Coarse Grained 571.30 572.25 PLAG PORPH FELSIC DYKE(+Kf+/- hem matrix), Porphyritic
572.25	613.70	MASSIVE MAFIC FLOW(<1%bt), Coarse Grained, foliated, slightly fractured, 00.5-2% bands and layering BI, trace blebs PO, 00.3-0.5% microveins QV 582.45 582.90 INTERMEDIATE DYKE(PURPLISH/BROWN), foliated 585.20 585.88 INTERMED DYKE WITH CHLORITIC PHENOCRYSTS, chlorite, biotite, foliated 586.60 588.85 INTERMEDIATE DYKE(PURPLISH/BROWN), almandine garnet, foliated 589.25 590.40 INTERMEDIATE DYKE(PURPLISH/BROWN), almandine garnet, foliated 593.65 594.17 INTERMEDIATE DYKE(PURPLISH/BROWN), almandine garnet, foliated 596.20 596.70 MAFIC DYKE WITH CHLORITIC PHENOS, chlorite, Porphyritic, foliated 609.05 609.34 FELSIC DYKE(PURPLISH/WHITE), Fractured, foliated 609.34 610.45 ULTRAMAFIC INTRUSIVE 612.60 612.90 FELSIC DYKE(PURPLISH/WHITE), Fractured, foliated 613.10 613.70 ULTRAMAFIC INTRUSIVE
613.70	692.00	GABBROIC DYKE;DISTINCT MED-CRSE GRAINED INTRUSIVE, foliated, Coarse Grained 616.30 616.83 INTERMEDIATE DYKE(PURPLISH/BROWN) 617.90 618.10 INTERMEDIATE DYKE(PURPLISH/BROWN), almandine garnet, foliated 628.70 629.16 FELSIC DYKE(PURPLISH/WHITE), sericite, foliated 631.70 632.30 MAFIC DYKE(GREENISH), chlorite, foliated 635.30 635.45 MAFIC DYKE WITH CHLORITIC PHENOS, chlorite, Porphyritic, foliated 638.75 641.10 FELSIC DYKE(PURPLISH/WHITE), foliated 641.20 642.50 INTERMEDIATE DYKE(PURPLISH/BROWN), almandine garnet, foliated 645.10 646.65 PLAG PORPH INTERMEDIATE DYKE, Porphyritic, foliated 664.05 665.35 INTERMEDIATE DYKE(PURPLISH/BROWN), almandine garnet, foliated 677.78 679.67 INTERMEDIATE DYKE(PURPLISH/BROWN), foliated 681.22 681.95 INTERMEDIATE DYKE(PURPLISH/BROWN), foliated 682.20 683.30 MASSIVE MAFIC FLOW(<1%bt), foliated 686.60 686.92 MASSIVE MAFIC FLOW(<1%bt), foliated 688.00 689.88 MASSIVE MAFIC FLOW(<1%bt), foliated 689.88 690.12 INTERMEDIATE DYKE(PURPLISH/BROWN), foliated
692.00	705.55	ULTRAMAFIC INTRUSIVE, hornblende, Coarse Grained, trace blebs PO 701.84 702.82 WEAKLY POTASSIC MAFIC FLOW(1-5%K), foliated 702.82 703.65 INTERMEDIATE DYKE(PURPLISH/BROWN), foliated 703.82 704.50 INTERMEDIATE DYKE(PURPLISH/BROWN), almandine garnet, foliated
705.55		** END OF HOLE **

## LEGEND

CP	CHALCOPYRITE
MR	MARCASITE
PO	PYRRHOTITE
PY	PYRITE
BI\bt)	BIOTITE
CB	CARBONATE
EP	EPIDOTE
AB	ALBITE
CL	CHLORITE
QZ	QUARTZ
HEM	HEMATITE
Kf	POTASSIUM FELDSPAR
K	POTASSIC ALTERATION
QV	QUARTZ VEIN
FO	FOLIATION

\*\*\* DETOUR LAKE MINEX \*\*\*  
PLACER DOME CANADA LIMITED

Drill Hole: 464-111

Northing : 20800.00  
Easting : 15400.00  
Elevation : 6280.00  
Hole Depth : 408.20mt

Project ID : 464  
Core Size : NQ  
Date Logged : 13JUL96  
Logged By : RKM  
Assisted by :

MINING CLAIM NUMBER: CLM 229  
DRILLING STARTED: JUNE 23, 1996  
DRILLING COMPLETED: JULY 8, 1996  
DRILLING CONTRACTOR: BRADLEY BROTHERS LIMITED  
DRILL CORE STORAGE LOCATION: DETOUR LAKE MINE  
LOGGING STARTED: JULY 9, 1996  
LOGGING COMPLETED: JULY 14, 1996  
LOGGED BY: RYAN MCEACHERN

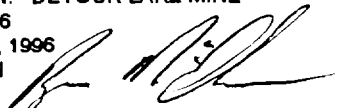

Drill Hole Survey Data

Depth	Azimuth	Dip
Collar	180.00	-80.00
38.00mt	192.00	-79.00
50.00mt	190.00	-79.00
98.00mt	189.00	-78.00
152.00mt	185.00	-76.50
203.00mt	185.00	-74.75
254.00mt	184.00	-74.00
305.00mt	183.00	-72.00
356.00mt	184.00	-72.50
395.00mt	191.00	-70.25

From	To	Geology
0.00	25.00	OVERBURDEN
25.00	44.00	PILLOWED FLOW, VARIOLITIC, sheared, foliated, pillowed, extremely well fractured, 00.5-2% bands and layering BI, trace blebs PO, 00.3-0.5% microveins QV
44.00	91.80	MASSIVE MAFIC FLOW(<1%bt), Coarse Grained, foliated, lightly fractured, trace specks AU, 00.5-2% bands and layering BI, trace blebs CP, trace blebs PO, trace specks PY, trace microveins QV
	50.60	51.50 FELSIC DYKE(PURPLISH/WHITE), Fractured
	51.50	53.50 WEAK POTASSIC PILLOW FLOW(1-5%K), Fractured, pillowed
	58.80	60.00 PILLOWED FLOW, foliated, pillowed
	61.15	61.40 FELSIC DYKE(PURPLISH/WHITE), foliated
	69.62	71.65 ULTRAMAFIC INTRUSIVE, actinolite, foliated
	72.40	72.95 ULTRAMAFIC INTRUSIVE, actinolite, foliated
	72.95	73.15 FELSIC DYKE(PURPLISH/WHITE), foliated
	73.15	73.50 ULTRAMAFIC INTRUSIVE, actinolite, foliated
	76.45	77.75 WEAK POTASSIC PILLOW FLOW(1-5%K), foliated, pillowed
	80.10	80.60 FELSIC DYKE(PURPLISH/WHITE), Porphyritic, foliated
	87.45	88.85 WEAK POTASSIC PILLOW FLOW(1-5%K), foliated, pillowed
	88.85	90.17 FELSIC DYKE(PURPLISH/WHITE), Porphyritic, foliated
91.80	162.57	PILLOWED FLOW, VARIOLITIC, foliated, pillowed, 00.5-2% bands and layering BI, trace vein associated/in vein CB, trace blebs CP, trace blebs PO, trace specks PY, 00.3-0.5% microveins QV
	97.70	98.20 FELSIC DYKE(PURPLISH/WHITE), Fractured
	106.80	107.15 PLAG PORPH FELSIC DYKE(+Kf+/- hem matrix), Porphyritic, foliated
	112.50	112.95 FELSIC DYKE(PURPLISH/WHITE)
	116.50	117.05 PLAG PORPH FELSIC DYKE(+Kf+/- hem matrix), Porphyritic, foliated
	117.05	118.05 MAFIC DYKE(GREENISH), foliated
	120.24	121.15 GABBROIC DYKE;DISTINCT MED-CRSE GRAINED INTRUSIVE, foliated, Coarse Grained
	126.65	127.18 MAFIC DYKE(GREENISH), foliated
	127.80	128.22 MAFIC DYKE(GREENISH), foliated
	137.13	137.60 MAFIC DYKE(GREENISH), foliated, Medium Grained
	140.83	141.85 GABBROIC DYKE;DISTINCT MED-CRSE GRAINED INTRUSIVE
	143.95	146.63 FELSIC DYKE(PURPLISH/WHITE), foliated
	150.00	150.65 INTERMEDIATE DYKE(PURPLISH/BROWN), almandine garnet, foliated
	152.00	152.74 MAFIC DYKE WITH CHLORITIC PHENOS, chlorite, Porphyritic, foliated
	156.00	157.00 GABBROIC DYKE;DISTINCT MED-CRSE GRAINED INTRUSIVE, Medium Grained
	157.75	160.53 FELSIC DYKE(PURPLISH/WHITE), plagioclase, Porphyritic, foliated
	160.53	161.10 WEAK POTASSIC PILLOW FLOW(1-5%K), pillowed, foliated
	161.10	162.18 INTERMEDIATE DYKE(PURPLISH/BROWN), almandine garnet, foliated

From	To	Geology
		162.18 162.57 FELSIC DYKE(PURPLISH/WHITE), foliated
162.57	165.75	INTERMEDIATE DYKE(PURPLISH/BROWN), almandine garnet, foliated
165.75	220.65	PILLOWED FLOW, brecciated, foliated, pillowed, trace specks AU, trace blebs CP, trace blebs MR, trace blebs PO, trace crystals and/or phenocrysts PY, trace microveins QV 166.50 167.25 INTERMEDIATE DYKE(PURPLISH/BROWN), foliated 173.08 174.31 ULTRAMAFIC INTRUSIVE, foliated 175.12 176.40 BRECCIATED PILLOWED FLOW, foliated, brecciated, trace wisp CP, trace vein associated/in vein MR, 00.5-2% interstitial PO, 00.3-0.5% interstitial PY, trace microveins QV 177.15 177.80 BRECCIATED PILLOWED FLOW, foliated, brecciated, trace blebs CP, 00.5-2% interstitial PO, 00.3-0.5% crystals and/or phenocrysts PY 178.13 178.75 BRECCIATED PILLOWED FLOW, foliated, brecciated, trace blebs CP, 00.5-2% interstitial PO, 00.3-0.5% crystals and/or phenocrysts PY, trace microveins QV 178.75 179.35 FELSIC DYKE(PURPLISH/WHITE), foliated 190.15 190.67 INTERMEDIATE DYKE(PURPLISH/BROWN), foliated, 00.3-0.5% microveins QV 191.67 192.11 PLAG PORPH MAFIC DYKE, plagioclase, foliated, Porphyritic 193.90 195.05 ULTRAMAFIC INTRUSIVE, foliated 196.98 197.55 PLAG PORPH FELSIC DYKE(+Kf+/- hem matr), plagioclase, foliated, Porphyritic 199.85 200.35 MAFIC DYKE(GREENISH), biotite, foliated 205.40 206.20 INTERMED DYKE WITH CHLORITIC PHENOCRYSTS, chlorite, Porphyritic, foliated 206.20 206.40 HEALED FAULT ZONE + Qz/Ab/Cb Vns+/- Kf,Ep 210.53 211.15 ULTRAMAFIC INTRUSIVE, actinolite, foliated 212.90 213.26 FELSIC DYKE(PURPLISH/WHITE), Fractured, foliated 214.00 214.05 HEALED FAULT ZONE + Qz/Ab/Cb Vns+/- Kf,Ep 214.05 215.00 INTERMEDIATE DYKE(PURPLISH/BROWN), foliated 215.40 216.20 FELSIC DYKE(PURPLISH/WHITE) 216.45 217.05 FELSIC DYKE(PURPLISH/WHITE), foliated, Fractured 217.05 218.50 INTERMEDIATE DYKE(PURPLISH/BROWN), almandine garnet, foliated 219.55 220.60 FELSIC DYKE(PURPLISH/WHITE), almandine garnet, foliated
220.65	225.10	PLAG PORPH FELSIC DYKE(+Kf+/- hem matr), plagioclase, sericite, Fractured, Porphyritic, foliated, fairly well fractured, 00.5-2% fracture filling AB
225.10	239.30	PILLOWED FLOW, pillowed, foliated, very lightly fractured, trace vein associated/in vein AB, 00.3-0.5% bands and layering BI, 00.5-2% vein associated/in vein CB, trace blebs CP, trace blebs MR, 00.3-0.5% blebs PO, trace crystals and/or phenocrysts PY, trace microveins QV 227.05 227.55 PLAG PORPH MAFIC DYKE, plagioclase, foliated, Porphyritic 230.15 233.20 FELSIC DYKE(PURPLISH/WHITE), Fractured, foliated 234.10 234.95 GABBROIC DYKE;DISTINCT MED-CRSE GRAINED INTRUSIVE, foliated, Coarse Grained 236.50 237.10 FELSIC DYKE(PURPLISH/WHITE), foliated 238.55 239.30 INTERMEDIATE DYKE(PURPLISH/BROWN), foliated
239.30	251.55	PILLOWED FLOW, foliated, pillowed, trace vein associated/in vein AB, trace specks AU, 00.3-0.5% bands and layering BI, 00.5-2% vein associated/in vein CB, 00.3-0.5% blebs CP, trace blebs MR, 00.5-2% blebs PO, trace crystals and/or phenocrysts PY, trace veins QV 243.05 243.58 MAFIC DYKE(GREENISH) 243.58 244.05 PLAG PORPH FELSIC DYKE(+Kf+/- hem matrix), plagioclase, Porphyritic, foliated 247.40 248.55 INTERMEDIATE DYKE(PURPLISH/BROWN), almandine garnet, foliated
251.55	259.10	INTERMEDIATE DYKE(PURPLISH/BROWN), almandine garnet, foliated
259.10	266.20	PILLOWED FLOW, VARIOLITIC, pillowed, foliated, 00.3-0.5% bands and layering BI, 00.3-0.5% vein associated/in vein CB, 00.3-0.5% wisp CP, trace blebs MR, 00.5-2% blebs PO, 00.3-0.5% specks PY, 00.5-2% veins QV
266.20	270.00	FELSIC DYKE(PURPLISH/WHITE), Fractured, foliated, very lightly fractured, 00.5-2% fracture filling AB, trace fracture filling CP, trace fracture filling PO
270.00	306.40	PILLOWED FLOW, VARIOLITIC, foliated, pillowed, very lightly fractured, trace bands and layering BI, trace blebs CP, trace blebs MR, 00.3-0.5% blebs PO, trace specks PY, 00.5-2% veins QV 272.60 273.25 INTERMEDIATE DYKE(PURPLISH/BROWN), foliated 274.70 276.78 MAFIC DYKE(GREENISH), foliated 276.86 277.05 MAFIC DYKE WITH CHLORITIC PHENOS, chlorite, feldspar, foliated, Porphyritic 277.95 278.60 PLAG PORPH FELSIC DYKE(+Kf+/- hem matrix), plagioclase, foliated, Porphyritic 283.90 284.95 INTERMEDIATE DYKE(PURPLISH/BROWN), foliated 287.25 288.75 INTERMEDIATE DYKE(PURPLISH/BROWN), foliated 290.35 291.45 INTERMEDIATE DYKE(PURPLISH/BROWN), almandine garnet, foliated

From	To	Geology
		304.85 305.35 FELSIC DYKE(PURPLISH/WHITE), Fractured, foliated
306.40	311.05	INTERMEDIATE DYKE(PURPLISH/BROWN), almandine garnet, foliated, not fractured
311.05	376.00	PILLOWED FLOW, VARIOLITIC, Amygdaloidal, foliated, pillowed, trace blebs CP, trace blebs MR, trace blebs PO, trace specks PY, 00.3-0.5% microveins QV 312.72 312.90 FELSIC DYKE(PURPLISH/WHITE), foliated 315.47 315.93 INTERMEDIATE DYKE(PURPLISH/BROWN), foliated 317.86 318.75 FELSIC DYKE(PURPLISH/WHITE), foliated 320.78 321.60 PLAG PORPH FELSIC DYKE(+Kf+/- hem matrix), plagioclase, foliated, Porphyritic 321.60 321.95 INTERMEDIATE DYKE(PURPLISH/BROWN), almandine garnet, foliated 325.85 327.15 INTERMEDIATE DYKE(PURPLISH/BROWN), almandine garnet, foliated 331.25 331.75 FELSIC DYKE(PURPLISH/WHITE), foliated, Fractured 332.75 333.75 MASSIVE MAFIC FLOW(<1%bt), foliated, Medium Grained 334.05 336.60 MASSIVE MAFIC FLOW(<1%bt), foliated 342.33 344.12 FELSIC DYKE(PURPLISH/WHITE), almandine garnet, foliated 345.00 347.55 PLAG PORPH MAFIC DYKE, Porphyritic 347.55 348.00 FELSIC DYKE(PURPLISH/WHITE), Fractured 348.80 349.10 FELSIC DYKE(PURPLISH/WHITE) 349.90 350.40 INTERMEDIATE DYKE(PURPLISH/BROWN) 361.05 361.50 INTERMEDIATE DYKE(PURPLISH/BROWN) 364.15 364.90 FELSIC DYKE(PURPLISH/WHITE), 00.5-2% blebs PY 366.00 367.05 MAFIC DYKE(GREENISH) 367.05 368.10 MAFIC DYKE WITH CHLORITIC PHENOS, chlorite, Porphyritic
376.00	381.80	FELSIC DYKE(PURPLISH/WHITE), foliated, Fractured 379.10 379.60 PILLOWED FLOW, foliated, pillowed, 00.3-0.5% blebs MR, 00.3-0.5% blebs PO
381.80	408.20	PILLOWED FLOW, Amygdaloidal, foliated, pillowed, trace blebs MR, trace blebs PO, trace microveins QV 388.45 389.70 INTERMEDIATE DYKE(PURPLISH/BROWN), almandine garnet, foliated 390.40 391.88 INTERMEDIATE DYKE(PURPLISH/BROWN), foliated 394.78 396.00 INTERMEDIATE DYKE(PURPLISH/BROWN), almandine garnet, foliated 397.50 397.98 INTERMEDIATE DYKE(PURPLISH/BROWN) 401.30 402.30 INTERMEDIATE DYKE(PURPLISH/BROWN), almandine garnet, foliated 404.25 404.60 FELSIC DYKE(PURPLISH/WHITE) 406.75 408.20 FELSIC DYKE(PURPLISH/WHITE)
408.20		** END OF HOLE **



\*\*\* DETOUR LAKE MINEX \*\*\*  
PLACER DOME CANADA LIMITED

Drill Hole: 464-111A

Date: 31st Oct, 1992  
Northing : 20825.00  
Easting : 15400.00  
Elevation : 6280.00  
Hole Depth : 742.87mt

Project ID : 464  
Core Size : NQ  
Date Logged : 15JUL96  
Logged By : RKM  
Assisted by :

MINING CLAIM NUMBER: CLM 229  
DRILLING STARTED: JULY 9, 1996  
DRILLING COMPLETED: JULY 16, 1996  
DRILLING CONTRACTOR: BRADLEY BROTHERS LIMITED  
DRILL CORE STORAGE LOCATION: DETOUR LAKE MINE  
LOGGING STARTED: JULY 15, 1996  
LOGGING COMPLETED: JULY 19, 1996  
LOGGED BY: RYAN MCEACHERN



Drill Hole Survey Data

Depth	Azimuth	Dip
Collar	180.00	-80.00
38.00mt	192.00	-79.00
50.00mt	190.00	-79.00
98.00mt	189.00	-78.00
152.00mt	185.00	-76.50
203.00mt	185.00	-74.75
254.00mt	184.00	-74.00
305.00mt	183.00	-72.00
356.00mt	184.00	-72.50
395.00mt	191.00	-70.25
446.00mt	186.00	-68.50
497.00mt	186.00	-68.00
551.00mt	186.00	-67.50
599.00mt	188.00	-67.00
650.00mt	190.00	-65.50
701.00mt	190.00	-65.00
742.80mt	192.00	-65.00

From	To	Geology
384.65	451.40	PILLOWED FLOW, GREEN, VARIOLITIC, Amygdaloidal, foliated, pillowed, trace vein associated/in vein AB, 00.3-0.5% bands and layering BI, trace vein associated/in vein CB, trace vein associated/in vein CL, trace blebs CP, trace blebs MR, trace blebs PO, trace specks PY, 00.3-0.5% veins QV 388.40 389.70 INTERMEDIATE DYKE(PURPLISH/BROWN), almandine garnet, foliated 390.45 391.09 INTERMEDIATE DYKE(PURPLISH/BROWN), almandine garnet, foliated 394.60 395.70 INTERMEDIATE DYKE(PURPLISH/BROWN), almandine garnet, foliated 397.00 397.70 INTERMEDIATE DYKE(PURPLISH/BROWN), almandine garnet, foliated 401.30 403.55 INTERMEDIATE DYKE(PURPLISH/BROWN), almandine garnet, foliated 404.90 406.37 MASSIVE MAFIC FLOW(<1%bt), biotite 406.37 406.70 INTERMED DYKE WITH CHLORITIC PHENOCRYSTS, chlorite, Porphyritic, foliated 406.70 408.90 FELSIC DYKE(PURPLISH/WHITE), foliated, Fractured, trace microveins QV 410.40 411.20 INTERMEDIATE DYKE(PURPLISH/BROWN), almandine garnet, foliated 412.60 413.75 INTERMEDIATE DYKE(PURPLISH/BROWN), almandine garnet, foliated 415.90 417.05 FELSIC DYKE(PURPLISH/WHITE), foliated 417.75 418.20 FELSIC DYKE(PURPLISH/WHITE), foliated 423.40 424.00 FELSIC DYKE(PURPLISH/WHITE), foliated 424.80 425.14 INTERMEDIATE DYKE(PURPLISH/BROWN), foliated 426.65 427.62 INTERMEDIATE DYKE(PURPLISH/BROWN), foliated 430.30 430.85 INTERMEDIATE DYKE(PURPLISH/BROWN), foliated 449.10 449.75 FAULT ZONE; +/- CHLORITIC GOUGE 449.75 451.20 FELSIC DYKE(PURPLISH/WHITE), Fractured 451.20 451.40 FAULT ZONE; +/- CHLORITIC GOUGE
451.40	457.00	FELSIC DYKE(PURPLISH/WHITE), brecciated, foliated, Fractured, well fractured, 00.5-2% vein associated/in vein AB, trace vein associated/in vein CB, trace blebs PO, 00.3-0.5% specks PY, trace veins QV
457.00	460.32	PLAG PORPH INTERMEDIATE DYKE, foliated, Porphyritic, trace vein associated/in vein AB, trace fracture filling CB
460.32	464.30	INTERMEDIATE DYKE(PURPLISH/BROWN), foliated, Fractured, trace crystals and/or phenocrysts PY, trace stringers QV

From	To	Geology
742.87		** END OF HOLE **

## LEGEND

CP	CHALCOPYRITE
MR	MARCASITE
PO	PYRRHOTITE
PY	PYRITE
BI(bt)	BIOTITE
CB	CARBONATE
EP	EPIDOTE
AB	ALBITE
CL	CHLORITE
QZ	QUARTZ
HEM	HEMATITE
Kf	POTASSIUM FELDSPAR
K	POTASSIC ALTERATION
QV	QUARTZ VEIN
FO	FOLIATION

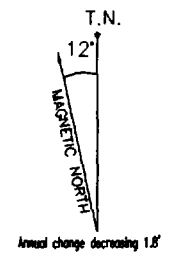
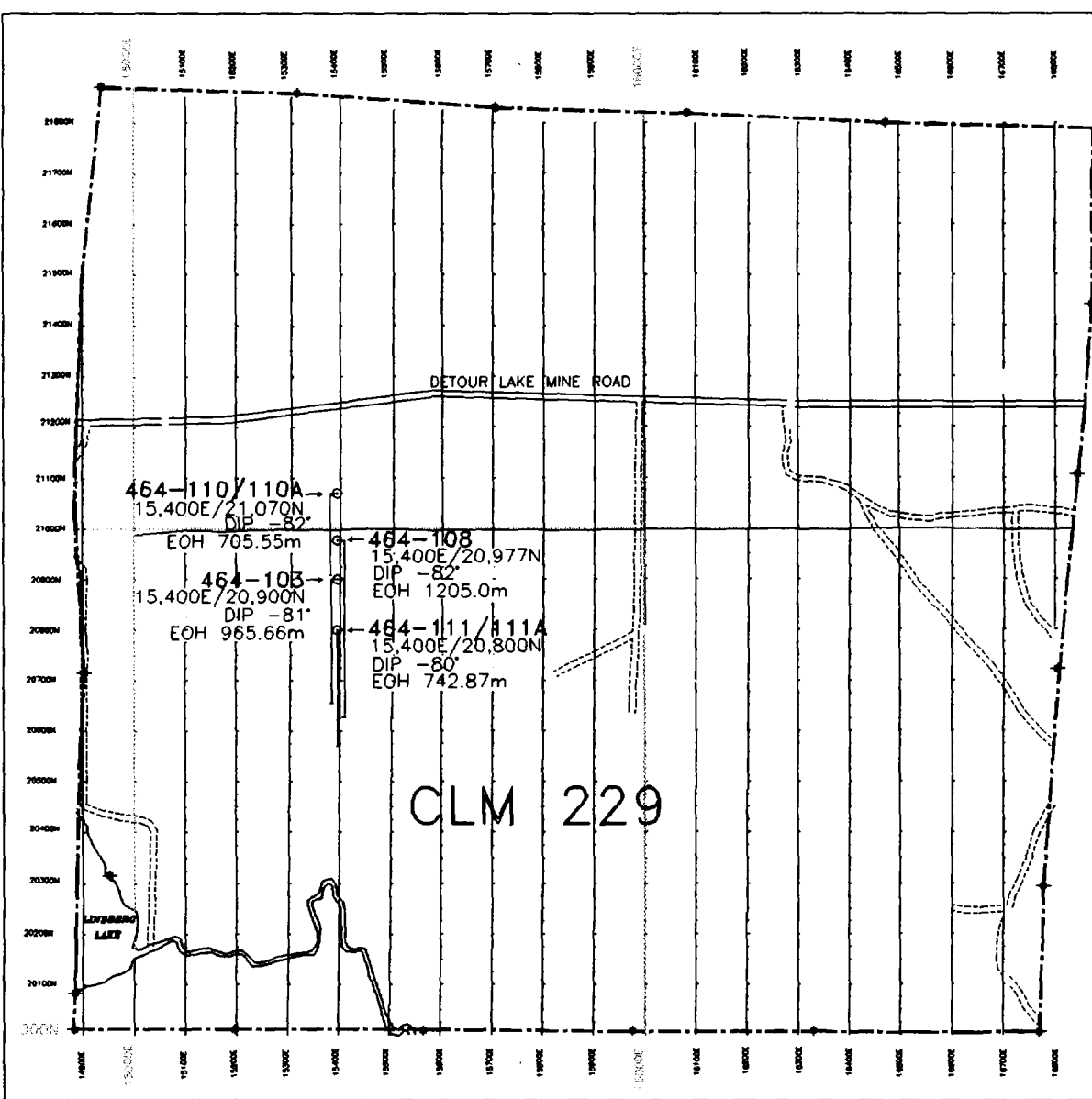

**LEGEND**

- PROPERTY BOUNDARY ———
- DDH ○
- GRID ———
- DRAINAGE ———
- ROADS ———
- CLAIM POSTS ◆



<b>P</b> PLACER DOME CANADA LIMITED.		
PROJECT NO. 464		
DIAMOND DRILL HOLES DETOUR LAKE MINE SUNDAY LAKE AREA		
DATE: 08/96	DRG BY: L.WARDER DRAWN BY: MC	DRG. NO.
SCALE: AS SHOWN	NTS REF. 32L/4	



# Report of Work Conducted After Recording Claim

## Mining Act

Transaction Number

W9660.00485

Personal information collected on this form is obtained under the authority of the Mining Act. This information will be used for correspondence. Questions about this collection should be directed to the Provincial Manager, Mining Lands, Ministry of Northern Development and Mines, Fourth Floor, 159 Cedar Street, Sudbury, Ontario, P3E 6A5, telephone (705) 670-7264.

- Instructions:**
- Please type or print and submit in duplicate.
  - Refer to the Mining Act and Regulations for Recorder.
  - A separate copy of this form must be completed.
  - Technical reports and maps must accompany this form in duplicate.
  - A sketch, showing the claims the work is assigned to, must accompany this form.

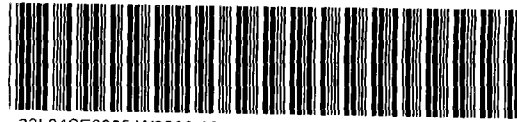

32L04SE0005 W9660-00485 SUNDAY LAKE

900

Recorded Holder(s) PLACER DOME CANADA LIMITED		Client No. 300210
Address P.O. BOX 960 TIMMINS, ONTARIO P4N 7H1		Telephone No. (705) 267-5400
Mining Division PORCUPINE	Township/Area WEST OF SUNDAY LAKE	M or G Plan No. G-1680
Dates Work Performed From: APRIL 20, 1996		To: JULY 15, 1996

**Work Performed (Check One Work Group Only)**

Work Group	Type
<input type="checkbox"/> Geotechnical Survey	
<input checked="" type="checkbox"/> Physical Work, Including Drilling	3712.63 metres in four diamond drillholes (+ 2 wedged holes)
<input type="checkbox"/> Rehabilitation	holes 464-103; 464-108; 464-110+110A; 464-111+111A
<input type="checkbox"/> Other Authorized Work	
<input type="checkbox"/> Assays	
<input type="checkbox"/> Assignment from Reserve	

Total Assessment Work Claimed on the Attached Statement of Costs \$ 239,000

**Note:** The Minister may reject for assessment work credit all or part of the assessment work submitted if the recorded holder cannot verify expenditures claimed in the statement of costs within 30 days of a request for verification.

**Persons and Survey Company Who Performed the Work (Give Name and Address of Author of Report)**

Name	Address
Bradley Bros. Ltd.	PO Box 485, Timmins ON P4N 7E7
Ryan McEachern, Placer Dome	PO Box 960, Timmins ON P4N 7H1

(attach a schedule if necessary)

**Certification of Beneficial Interest \* See Note No. 1 on reverse side**

I certify that at the time the work was performed, the claims covered in this work report were recorded in the current holder's name or held under a beneficial interest by the current recorded holder.	Date Aug 16/96	Recorded Holder or Agent (Signature) Robin Price
--	-------------------	---

Assistant Land Manager

**Certification of Work Report**

I certify that I have a personal knowledge of the facts set forth in this Work report, having performed the work or witnessed same during and/or after its completion and annexed report is true.		
Name and Address of Person Certifying Paul Burchell, Placer Dome Canada Limited; PO Box 960, Timmins ON P4N 7H1		
Telephone No. (705) 267-5400	Date August 16, 1996	Certified By (Signature) P. Burchell

**For Office Use Only**

Total Value Cr. Recorded 239,000	Date Recorded	Mining Recorder	
	Deemed Approval Date Nov 14/96	Date Approved Nov. 14, 1996	
	Date Notice for Amendments Sent		



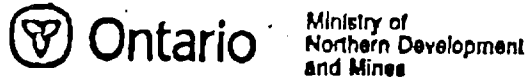

**Statement of Costs  
for Assessment Credit**

Transaction Number (office use)  
W9660.00485

Personal information collected on this form is obtained under the authority of subsection 6(1) of the Assessment Work Regulation 6/96. Under section 6 of the Mining Act, the information is a public record. This information will be used to review the assessment work and correspond with the mining land holder. Questions about this collection should be directed to the Chief Mining Recorder, Ministry of Northern Development and Mines, 6th Floor, 933 Ramsey Lake Road, Sudbury, Ontario, P3E 6B5.

Work Type	Units of Work <small>Depending on the type of work, list the number of hours/days worked, metres of drilling, kilometres of grid line, number of samples, etc.</small>	Cost Per Unit	Total Cost
overburden drilling	89.10m	varies	\$4,542.59
diamond drilling	3712.63m	varies	\$208,195.34
logging core	62 days	\$250/day	\$15,500.00
<b>Associated Costs (e.g. supplies, mobilization and demobilization).</b>			
wedging costs for 2 drillholes			\$5,600.00
Sperry Sun surveys			\$2,730.00
* see detailed cost statement attached for cost breakdown per hole			
<b>Transportation Costs</b>			
<b>Food and Lodging Costs</b>			
62 days		\$40/day	\$2480.00

**Total Value of Assessment Work** \$239,047.93

\$239,000 being claimed

**RECEIVED**  
AUG 16 1996  
MRO PORCUPINE DIV

**Calculations of Filing Discounts:**

1. Work filed within two years of performance is claimed at 100% of the above Total Value of Assessment Work.
2. If work is filed after two years and up to five years after performance, it can only be claimed at 50% of the Total Value of Assessment Work. If this situation applies to your claims, use the calculation below:

TOTAL VALUE OF ASSESSMENT WORK                      x 0.50 =                      Total \$ value of worked claimed.

**Note:**

- Work older than 5 years is not eligible for credit.
- A recorded holder may be required to verify expenditures claimed in this statement of costs within 45 days of a request for verification and/or correction/clarification. If verification and/or correction/clarification is not made, the Minister may reject all or part of the assessment work submitted.

**Certification verifying costs:**

I, Paul Burchell (please print full name), do hereby certify, that the amounts shown are as accurate as may reasonably be determined and the costs were incurred while conducting assessment work on the lands indicated on the accompanying Declaration of Work form as SENIOR GEOLOGIST (recorded holder, agent, or state company position with signing authority) I am authorized to make this certification.

*Paul Burchell* August 15/1996

10716700925  
 DDH - Detour Lake Minesite to Destor claims

Work Report #	Claim #	# Units	\$ Assessment Done	\$ Value Applied	\$ Value Assigned	\$ Reserve Work
	CLM 229	0	239000	0	239000	0
	1133200	1	0	2400		
	1133201	1	0	2400		
	1133202	1	0	2400		
	1133203	1	0	2400		
	1133204	1	0	2400		
	1133205	1	0	2400		
	1133206	1	0	2400		
	1133207	1	0	2400		
	1133208	1	0	2400		
	1133209	1	0	2400		
	1158819	1	0	2400		
	1158820	1	0	2400		
	1160141	1	0	<del>1200</del> 1600		
	1160142	4	0	<del>4800</del> 6400		
	1160143	4	0	<del>4800</del> 6400		
	1160144	2	0	<del>2400</del> 3200		
	1160145	3	0	3600 4800		
	1160146	1	0	1000 1400		
	1160147	2	0	2400 3200		
	1160148	4	0	4800 6400		
	1160149	4	0	<del>4800</del> 6400		
	1160150	4	0	<del>4800</del> 5042		
	1160151	4	0	4800 stay at 4800		
	578384	1	0	2400 2200		
	578385	1	0	2400 2200		
	578386	1	0	2400 2200		
	578387	1	0	<del>2400</del> 2200		
	578388	1	0	2400 2200		
	578389	1	0	2400 2200		
	578390	1	0	2400 2200		
	578391	1	0	2400 2200		
	578392	1	0	2400 2200		
	578393	1	0	<del>2400</del> 2200		
	578394	1	0	2400 2200		
	578395	1	0	2400 2200		
	578396	1	0	2400 2200		

R Price  
 18 Nov/96

R Price  
 18 Nov/96

page 1 of 3  
 R Price  
 16 Aug 1996



DDH - Detour Lake Minesite to Destor claims

Work Report #	Claim #	# Units	\$ Assessment Done	\$ Value Applied	\$ Value Assigned	\$ Reserve Work
	578397	1	0	2400	2200	
	578398	1	0	2400	2200	
	578399	1	0	2400	2200	
	578400	1	0	2400	2200	
	578401	1	0	2400	2200	
	578402	1	0	2400	2200	
	578403	1	0	2400	2200	
	578404	1	0	2400	2200	
	578405	1	0	2400	2200	
	578406	1	0	2400	2200	
	578407	1	0	2400	2200	
	578408	1	0	2400	2200	
	578409	1	0	2400	2200	
	578410	1	0	2400	2200	
	578411	1	0	2400	2200	
	578412	1	0	2400	2200	
	578413	1	0	2400	2200	
	578414	1	0	2400	2200	
	578415	1	0	2400	2200	
	578416	1	0	2400	2200	
	578417	1	0	2400	2200	
	578418	1	0	2400	2200	
	578419	1	0	2400	2200	
	578420	1	0	2400	2200	
	578421	1	0	2400	2200	
	578422	1	0	2400	2200	
	578423	1	0	2400	2200	
	578428	1	0	2400	2200	
	578429	1	0	2400	2200	
	578430	1	0	2400	2200	
	578433	1	0	2400	2200	
	578434	1	0	2400	2200	
	578435	1	0	2400	2200	
	578436	1	0	2400	2200	
	578437	1	0	2400	2200	
	578438	1	0	2400	2200	
	578439	1	0	2400	2200	
	578440	1	0	2400	2358	
	578441	1	0	2400	stay	
	578442	1	0	2400	2200	

*R Price*  
18 Nov 1996

page 2 of 3  
*R Price*  
16 Aug 1999

DDH - Detour Lake Minesite to Destor claims

Work Report #	Claim #	# Units	\$ Assessment Done	\$ Value Applied	\$ Value Assigned	\$ Reserve Work
	836966	1	0	2000		
	836967	1	0	2000		
	836971	1	0	2000		
	836972	1	0	2000		
	836973	1	0	2000		
	836974	1	0	2000		
	836976	1	0	2000		
	836977	1	0	2000		
	836978	1	0	2000		
	836979	1	0	2000		
	1190901	6	0	14400		
	1190902	2	0	4800		
	1190903	1	0	2400		
	1160200	1	0	2000		
		118	239000	239000	239000	0

*R Price*  
18 Nov 1996

page 3 of 3  
R Price  
16 Aug 1999

KATTAWAGAMI RIVER G-1639

THE INFORMATION THAT APPEARS ON THIS MAP HAS BEEN COMPILED FROM VARIOUS SOURCES, AND ACCURACY IS NOT GUARANTEED. THOSE WISHING TO STAKE MINING CLAIMS SHOULD CONSULT WITH THE MINING RECORDER, MINISTRY OF NORTHERN DEVELOPMENT AND MINES, FOR ADDITIONAL INFORMATION ON THE STATUS OF THE LANDS SHOWN HEREON.

NEWHAM CREEK G-1658

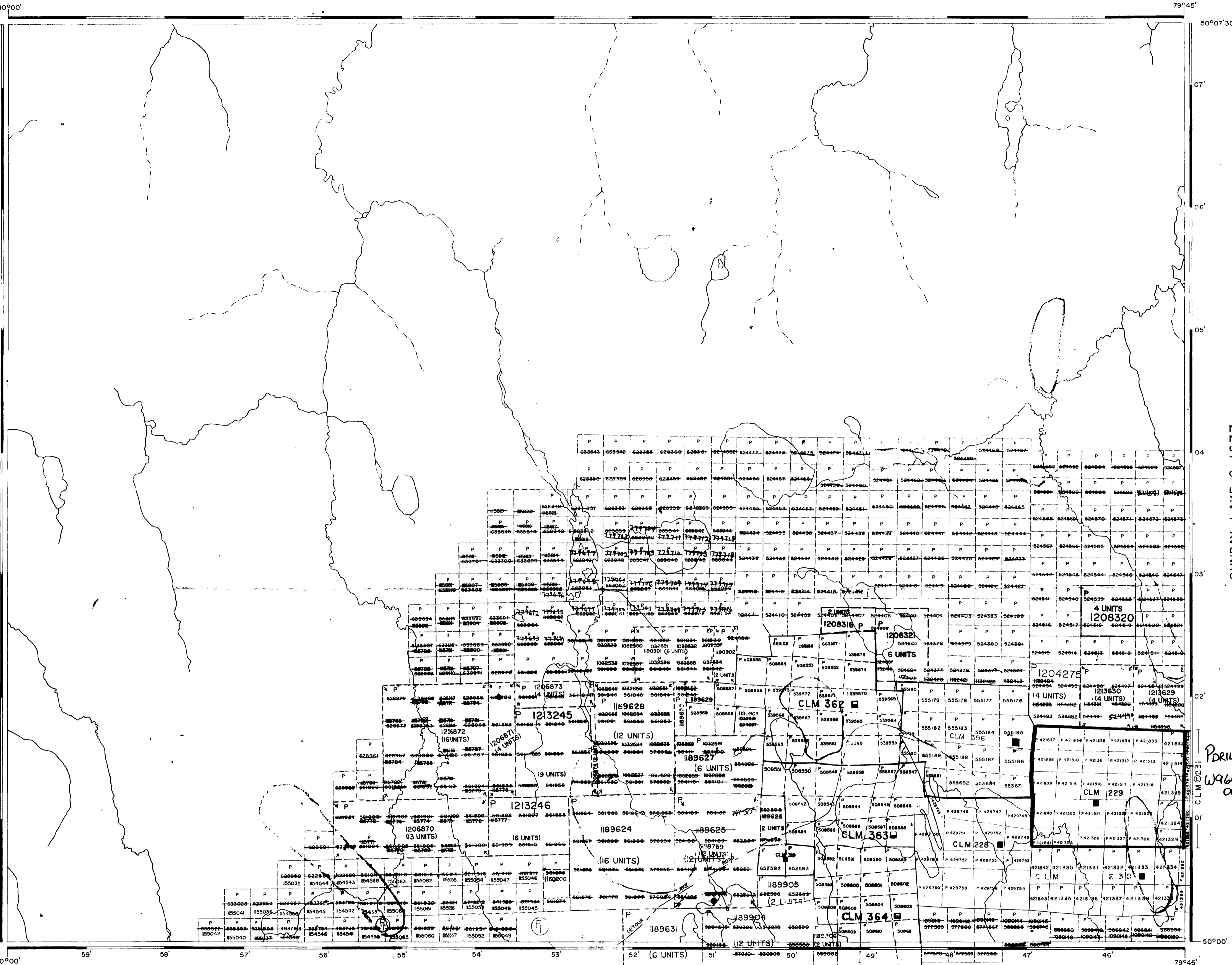

HOPPER LAKE G-1636

REFERENCES

AREAS WITHDRAWN FROM DISPOSITION

M.R.O. - MINING RIGHTS ONLY  
 S.R.O. - SURFACE RIGHTS ONLY  
 M + S. - MINING AND SURFACE RIGHTS

Description	Order No.	Date	Disposition	File
AREA REOPENED BY ORDER # NRO 27/85		JULY 22, 1985	S.R.O.	

THIS TWP. IS SUBJECT TO FORESTRY ACTIVITIES IN 1994/95 FURTHER INFORMATION AVAILABLE ON FILE.  
 THIS TOWNSHIP IS SUBJECT TO FORESTRY OPERATIONS IN 1996/97 FURTHER INFORMATION ON FILE.

Received Aug 18/83

LEGEND

- HIGHWAY AND ROUTE No.
- OTHER ROADS
- TRAILS
- SURVEYED LINES
- TOWNSHIPS, BASE LINES, ETC.
- LOTS, MINING CLAIMS, PARCELS, ETC.
- UNSURVEYED LINES
- LOT LINES
- PARCEL BOUNDARY
- MINING CLAIMS ETC.
- RAILWAY AND RIGHT OF WAY
- UTILITY LINES
- NON-PERENNIAL STREAM
- FLOODING OR FLOODING RIGHTS
- SUBDIVISION OR COMPOSITE PLAN
- RESERVATIONS
- ORIGINAL SHORELINE
- MARSH OR MUSKEG
- MINES
- TRAVERSE MONUMENT

DISPOSITION OF CROWN LANDS

TYPE OF DOCUMENT	SYMBOL
PATENT, SURFACE & MINING RIGHTS	●
" SURFACE RIGHTS ONLY	○
" MINING RIGHTS ONLY	◐
LEASE, SURFACE & MINING RIGHTS	■
" SURFACE RIGHTS ONLY	□
" MINING RIGHTS ONLY	◑
LICENCE OF OCCUPATION	▽
ORDER-IN COUNCIL	OC
RESERVATION	⊙
CANCELLED	⊖
SAND & GRAVEL	⊕

NOTE MINING RIGHTS IN PARCELS PATENTED PRIOR TO MAY 8, 1913, VESTED IN ORIGINAL PATENTEE BY THE PUBLIC LANDS ACT, R.S.O. 1970, CHAP. 300, SEC. 63, SUBSEC. 1.

REMOTE TOURIST CAMP

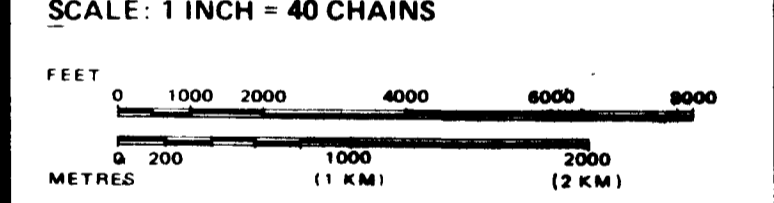

AREA  
**WEST OF SUNDAY LAKE**  
 M.N.R. ADMINISTRATIVE DISTRICT  
**COCHRANE**  
 MINING DIVISION  
**PORCUPINE**  
 LAND TITLES / REGISTRY DIVISION  
**COCHRANE**

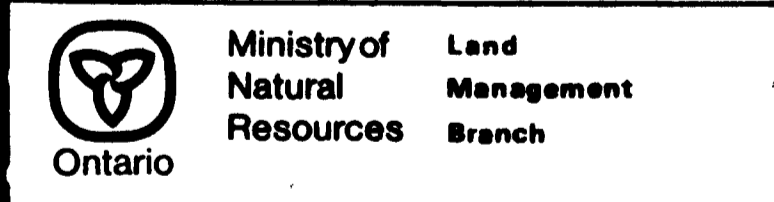

Date  
 DECEMBER 19 82

Number  
**G-1680**

501794



CLM 229

464-111A  
742.80m  
[27.57]  
AZ 180°  
DIP 80°

464-110A  
705.50m  
[-41.58]  
AZ 180°  
DIP 82°

464-103  
965.66m  
[10.71]  
AZ 180°  
DIP 81°

464-108  
1205.00m  
[-7.42]  
AZ 193°  
DIP 82°

**LEGEND**

**VOLCANIC ROCKS**

- MF MASSIVE MAFIC FLOW
- PF PILLOWED FLOW
- KMF POTASSIC MAFIC FLOW
- WKMF WEAKLY POTASSIC MAFIC FLOW
- KPF POTASSICALLY ALTERED PILLOWED FLOW
- WKPF WEAK POTASSIC PILLOW FLOW
- BPFF BRECCIATED PILLOW FLOW
- FZ FAULT ZONE
- BFZ HEALED FAULT ZONE
- CG CHLORITIC GREENSTONE

**INTRUSIVE ROCKS**

- FI FELSIC DYKE
- II INTERMEDIATE
- MI MAFIC DYKE
- GB GABBROIC DYKE
- UI ULTRAMAFIC INTRUSIVE
- SRFI SERICITICALLY ALTERED
- PPFI PLAG PORPH FELSIC DYKE
- PPII PLAG PORPH INTERMEDIATE DYKE
- PPMI PLAG PORPH MAFIC DYKE
- CLI INTERMED DYKE WITH CHLORITIC PHENOCRYSTS
- CLMI MAFIC DYKE WITH CHLORITIC PHENOS

OVBD OVERBURDEN

0 50 100m  
SCALE BAR

**PLACER DOME CANADA LIMITED.**

PROJECT NO.  
DETOUR LAKE MINEX  
SECTION 15400  
LOOKING WEST

DATE: 08/16	ORIG. BY: P.TURNBULL	DWG. NO.
SCALE: 1:1000	DRAWN BY: WC	NTS. REF.

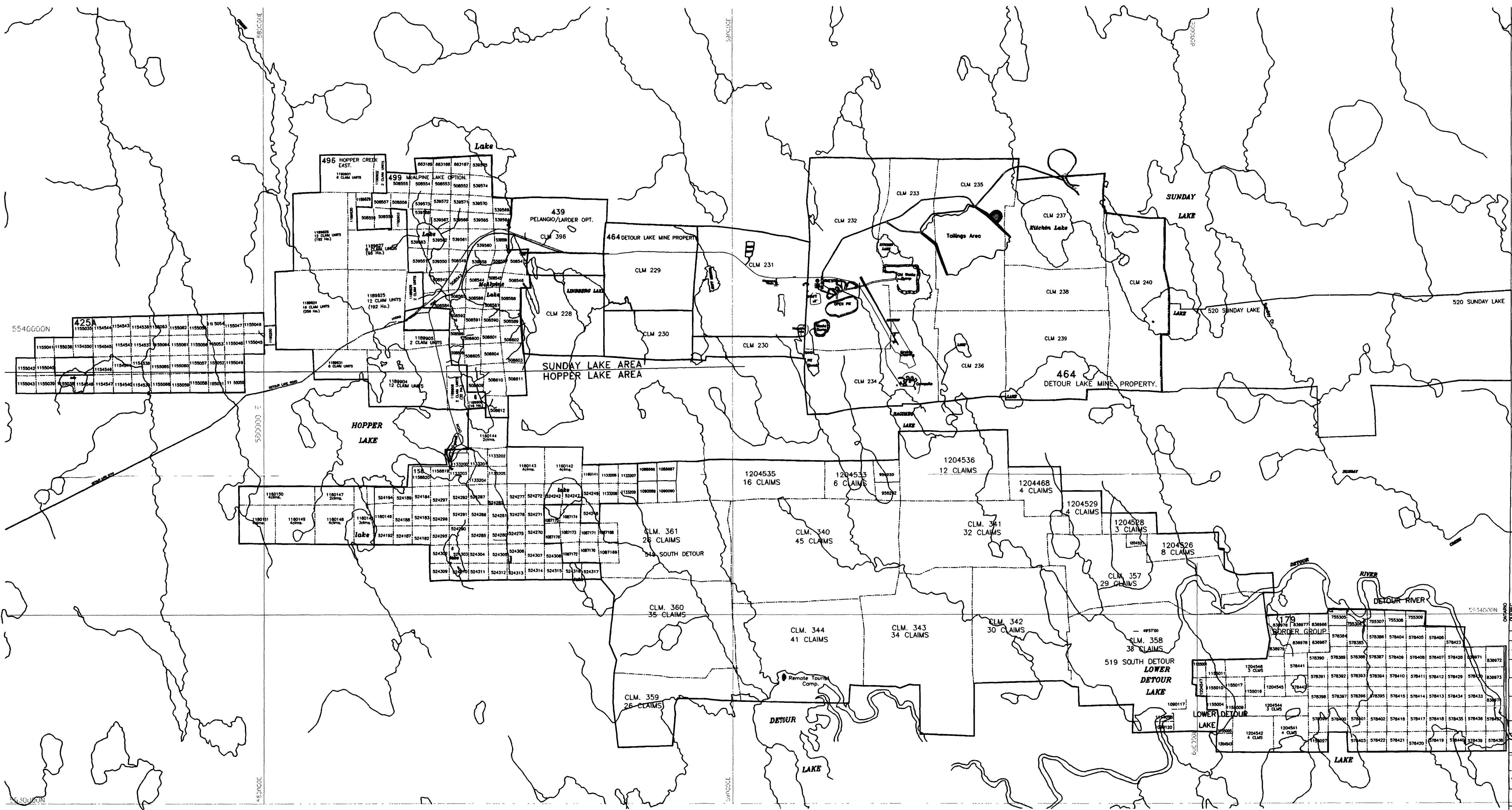

**LEGEND**

PROPERTY BOUNDARY

DRAINAGE

CLAIM BOUNDARY

ROADS

0 1000 2000 3000 meters  
SCALE BAR

- Claim where drilling was done
- Claim where drilling applied

**D PLACER DOME CANADA LIMITED.**

PROJECT NO. 464

**CLAIM LOCATION MAP  
DETOUR LAKE AREA**

DATE: 08/96	ORIG BY: CG	DWG. NO.
SCALE: 1:50000	DRAWN BY: WC	
	NTS REF. 32A	

