

DIAMOND DRILL:

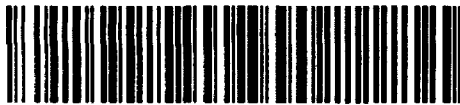

32L04SW9385 14 WEST OF SUNDAY LAKE

010

AREA: WEST OF SUNDAY LAKE

REPORT No.: 14

WORK PERFORMED BY: R. J. BRADSHAW

<u>CLAIM No.</u>	<u>HOLE No.</u>	<u>FOOTAGE</u>	<u>DATE</u>	<u>NOTE</u>
P 539565	80 - 1	351.0	NOV/80	(1)
P 508553	80 - 2	301.0	JAN/80	(1)
	81 - 3	300.0	FEB/81	(1)
P 508556	81 - 4	302.0	APR/81	(1)
P 508559	81 - 5	303.0	MAR/81	(1)
P 508588	81 - 6	392.0	MAR/81	(1)
P 508542	81 - 7	320.0	APR/81	(1)
P 508593	81 - 8	323.0	MAY/81	(1)
P 508597	81 - 9	300.0	MAY/81	(1)
P 508592	81 - 10	300.0	MAY/81	(1)
P 508600	81 - 11	322.0	JUNE/81	(1)
	81 - 12	321.0	JUNE/81	(1)

NOTES:

(1) #246 - 81

DIAMOND DRILL RECORD

P 539565

PROPERTY GOLD SHIELD - DMAB HOLE NO. 80-1

TOWNSHIP West of Sunday Lake PAGE NO. 1

LOCATION Line 28 West
Station 17+50S

CORE LOCATION Fault Lake camp.

STARTED November, 1980

DATUM _____

COMPLETED January 19, 1981

BEARING Grid north

DEPTH 351'

DIP 45°

ELEVATION _____

DEPTH FEET	FORMATION	SAMPLE NO.	WIDTH OF SAMPLE			
0 - 13	Overburden (casing).					
13 - 21.5	Amphibolite: grey-green, v. c. grained, c. grains of pyroxene in white feldspathic matrix.					
21.5 - 60.5	Mafic Volcanic: green, v. f. gr., fairly hard and massive.					
23	4" qtz-epidote str. @ 45°					
23.5-24	pyroxenite					
26	4" pyroxenite					
34	6" pyroxenite @ 45° to c.a.					
36-40	pyroxenite @ 30° to c.a.					
42.5	6" pyroxenite @ 20°					
44-60.5	poor banding @ 70° suggesting tuff with small up to 2" partially digested granitic inclusions					
50-55	some rusted material, 1% pyrite	1-1	5.0			
60.5 - 72.5	Amphibolite: as above but more dark minerals.					
72.5 - 145.6	Mafic Volcanic: dark green, as above, poor banding @ 50-70°, occ. amphibolite sections up to 6".					

Drilled By Northway

Signed  SHIELD GEOPHYSICS LIMITED

DIAMOND DRILL RECORD

PROPERTY _____ HOLE NO. 80-1

TOWNSHIP _____ PAGE NO. 2

LOCATION _____ CORE LOCATION _____ STARTED _____
 _____ DATUM _____ COMPLETED _____
 _____ BEARING _____ DEPTH _____
 ELEVATION _____ DIP _____

DEPTH FEET	FORMATION	SAMPLE NO.	WIDTH OF SAMPLE			
	103 10" qtz-feldspathic section @ 45°					
	124-125 amphibolite					
	140 amphibolite str. //ing c.a. for 1'					
145.6 - 159.6	Amphibolite: as above.					
159.6 - 307	Mafic Volcanic: v. f. gr. dark green, massive, with occ. 2-3" altered section, (epidote-feldspar) perhaps representing flow contact, few grains of py-po, odd str. of amphibolite.					
	167-168 3" of alteration with po-py seams	1-2	1.0			
	227.5-231.2 1% pyrrhotite	1-3	3.7			
	240-241.1 2% pyrrhotite, 2" qtz str.	1-4	1.1			
	254.5-259.5 2% diss. pyrrhotite	1-5	5.0			
	259.5-274 minor po					
	274-279 1% diss. po	1-6	5.0			
	279-284 2% diss. po-py	1-7	5.0			
	278.5-291 2% diss. po-py	1-8	2.5			
	291-307 minor po					
307 - 351	Amphibolite: dark grey, med. to c. gr., massive, crystalline, with obvious feldspar lathes.					

Drilled By _____

Signed  _____

SHIELD GEOPHYSICS LIMITED

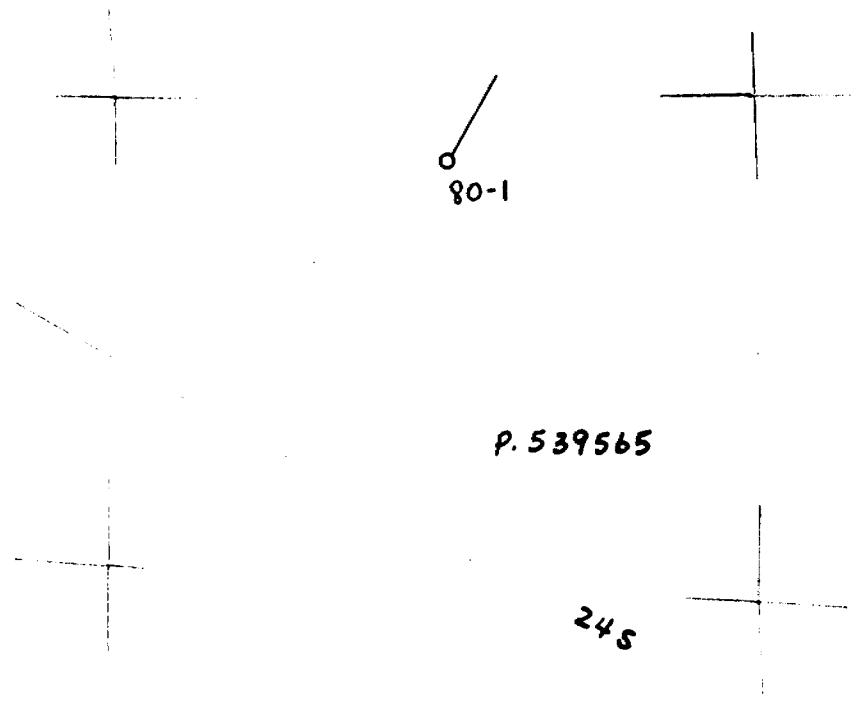
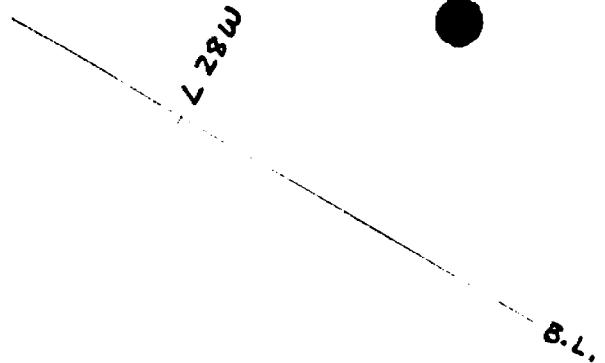

LOCATION OF HOLE 80-1
AREA WEST OF SUNDAY LAKE, ONT.
1" = 400'

DIAMOND DRILL RECORD

P 508553

PROPERTY GOLD SHIELD - DMAB HOLE NO. 80-2
 TOWNSHIP West of Sunday Lake PAGE NO. 1

LOCATION Line 8+00E CORE LOCATION camp site STARTED January 22, 1981
Station 10+00N DATUM _____ COMPLETED February 12, 1981
 BEARING Grid North DEPTH 301'
 ELEVATION _____ DIP 45°

DEPTH FEET	FORMATION	SAMPLE NO.	WIDTH OF SAMPLE				
0 - 30	Casing (overburden).						
30 - 301	Mafic Volcanic with Granitoid Injections:						
	volcanic is black & fine to medium grained with						
	lit-par-lit injection of grey to pink medium to						
	coarse grained granite at 50° to core axis;						
	banding @ 50° indicates tuff, some garnet.						
	46.0-47.0 core ground						
	63.0-67.0 core ground						
	75.7 3" diss. pyrite						
	82.0-83.0 4% diss. pyrite with granite	2-1	1.0				
	109.5-116.5 grey medium gr. diorite						
	120.0-124.0 3% py-po as seams	2-2	4.0				
	127.0-128.2 15% py-po as seams, some secondary	2-3	1.2				
	quartz						
	140.0-145.3 3% py-po as seams	2-4	5.3				
	145.3-156.0 diorite						
	160.0-162.3 2% po, 10% qtz banding	2-5	2.3				
	166.7-168.7 6% diss. po	2-6	2.0				
	176-187 c. gr. diorite						

Drilled By Northway

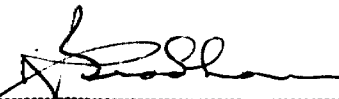
Signed  _____

SHIELD GEOPHYSICS LIMITED

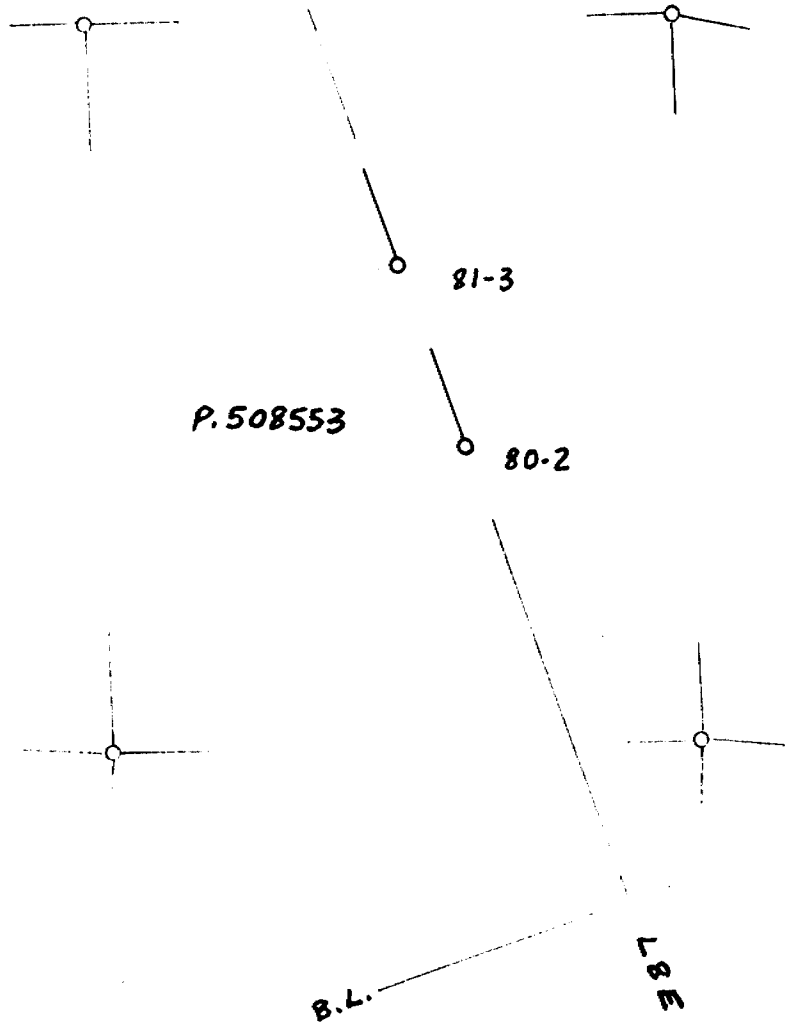

LOCATION OF HOLES 80-2 + 81-3
AREA WEST OF SUNDAY LAKE, ONT.

1" = 400'

DIAMOND DRILL RECORD

P508553

PROPERTY GOLD SHIELD - DMAB

HOLE NO. 81-3

TOWNSHIP Area West of Sunday Lake

PAGE NO. 1

LOCATION Line 8+00 East

CORE LOCATION camp site

STARTED February 15, 1981

Station 14+00N

DATUM _____

COMPLETED March 1, 1981

geophysical grid

BEARING grid North

DEPTH 300'

ELEVATION _____

DIP 45°

DEPTH FEET	FORMATION	SAMPLE NO.	WIDTH OF SAMPLE	Au/oz			
0 - 12	Casing (overburden).						
12 - 300	Mafic Volcanic Tuff with lit-par-lit Granodiorite: tuff is grey to black with banding @ 45° to c.a., fine grained, sil. sulphides generally as con- formable bands; granodiorite is medium to coarse grained, grey to black, totalling about 15%, some biotite; some garnet & epidote in tuff.						
	23.0-24.5 granodiorite						
	26.0-29.0 granodiorite						
	108.5-109.6 barren grey quartz						
	147.3-149.3 10% fine pyrite-pyrrhotite in tuff	3-1	2.0				
	132-300 very little granodiorite						
	163-164.5 15% pyrrhotite-pyrite as seams	3-2	1.5				
	210. 5" granodiorite						
	218.5 3" granodiorite						
	277-280 banded granodiorite						
	287 6" granodiorite						
300	END.						

Drilled By Northway

Signed [Signature]
SHIELD GEOPHYSICS LIMITED

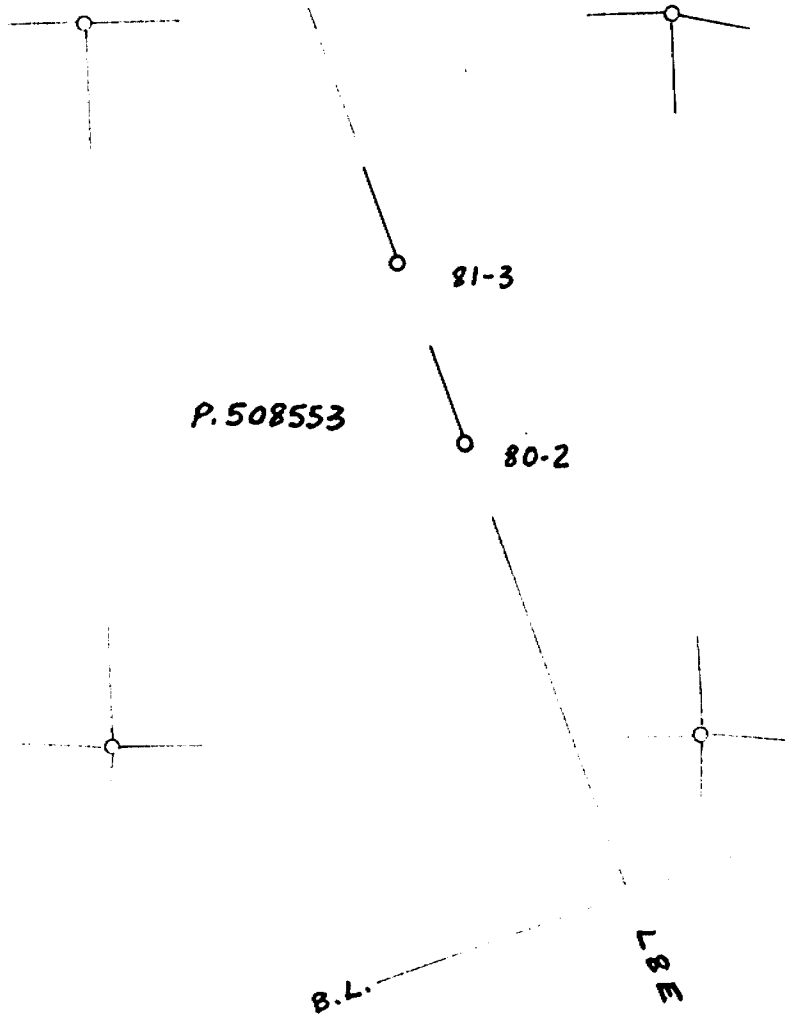

LOCATION OF HOLES 80-2 + 81-3
AREA WEST OF SUNDAY LAKE, ONT.

1" = 400'

DIAMOND DRILL RECORD

P508556

PROPERTY GOLD SHIELD - OMAB HOLE NO. 81-4

TOWNSHIP Area West of Sunday Lake PAGE NO. 1

LOCATION Line 16 West
Station 14+50 North

CORE LOCATION camp site

STARTED April 10, 1981

DATUM _____

COMPLETED April 14, 1981

BEARING grid North

DEPTH 302'

ELEVATION _____

DIP 45°

DEPTH FEET	FORMATION	SAMPLE NO.	WIDTH OF SAMPLE			
0 - 19	Casing (overburden).					
19 - 201	Intermediate to felsic Tuff: with lit-par-lit granodiorite; dark grey green with well defined bedding at 45° to c.a., local concentrations of garnet &/or epidote; granodiorite has 50% black mineral in light grey matrix.					
	70 1" qtz str. @ 45°					
	75.0-76.3 3% py-po, 1" qtz str. @ 45°	4-1	1.3			
	98 5" epidote, qtz, sli garnet					
	105.3 3" epidote					
	183-186 sli. py-po					
201 - 302	Intermediate to mafic Tuff?: dark green, softer massive, fine gr. dark green, without structure initially then occ. banding @ 45°, in part chloritic, few granodiorite str., shiny black mineral perhaps amphibole.					
	267-302 becoming more like unit above					
	289 fracture at 25° to c.a.					
302	END.					

Drilled By Manderstrom

Signed *[Signature]*
SHIELD GEOPHYSICS LIMITED



P. 508556

81-4



L 16 W

LOCATION OF HOLE 81-4
AREA WEST OF SUNDAY LAKE, ONT.
1" = 400'

DIAMOND DRILL RECORD

P 508559

PROPERTY GOLD SHIELD - OMAB HOLE NO. 81-5

TOWNSHIP Area West of Sunday Lake PAGE NO. 1

LOCATION Line 48 West
Station 6+75 North

CORE LOCATION camp site

STARTED March 30, 1981

DATUM _____

COMPLETED April 8, 1981

BEARING grid North

DEPTH 303'

ELEVATION _____

DIP 45°

DEPTH FEET	FORMATION	SAMPLE NO.	WIDTH OF SAMPLE				
0 - 15	Casing (overburden).						
15 - 303	Intermediate to felsic Tuff: with lit-par-lit granodiorite; dark grey green, f. grained banded at 60° to c.a., hard (6), granodiorite composed of approx. 50% grey white mineral, 50% black mineral, medium to c. gr. crystalline, no chilled contacts, up to 2' widths, occasional 1-3" epidote-garnet seams.						
69.6-72.0	3% diss. po. py. cpv	5-1	2.4				
89.8-90.4	3% seamed & diss. po. py. cpv	5-2	1.6				
96	3" epidote						
105	fracture with white mud						
133	4" epidote, garnet, qtz						
137.7-139.5	grey granitoid rock, 20% dark minerals foliated at 45°						
140.2-144	dark grey granitoid rock, 50% dark minerals						
145.3-150	salmon coloured granitoid rock, 10% dark minerals						

Drilled By Manderstrom

Signed *[Signature]*
SHIELD GEOPHYSICS LIMITED

DIAMOND DRILL RECORD

PROPERTY..... HOLE NO. 81-5
 TOWNSHIP..... PAGE NO. 2

LOCATION..... CORE LOCATION..... STARTED.....
 DATUM..... COMPLETED.....
 BEARING..... DEPTH.....
 ELEVATION..... DIP.....

DEPTH FEET	FORMATION	SAMPLE NO.	WIDTH OF SAMPLE				
	150.0-159.0 dark grey granitoid rock						
	160.5-162.5 70% grey granitoid str. @ 30-45°						
	162.5-233 odd narrow (up to 6") grey granodiorite str. generally conformable to tuff bedding						
	228-233.3 less than 1% seams of py in fractures						
	233.3-235.3 1' of grey qtz & granitoid rock @ 70°, 1% py-po	5-3	2.0				
	235.3-238.3 3-1" qtz str., 1" & 3" massive py 10% py-po	5-4	3.0				
	238.3-243.3 pyrite & po in fractures & bedding planes of contorted tuff, 5% py-po	5-5	5.0				
	243.3-248.3 5% py-po	5-6	5.0				
	248.3-250.3 2% py-po, some garnet	5-7	2.0				
	250.3-257 tuff is contorted with sli. py-po						
	257 dark grey tuff @ approx. 45°						
	269.8-272.8 2% py-po & 3-½" qtz str. @ 65°	5-8	3.0				
	300-302 1% pyrite						
303	END.						

Drilled By.....

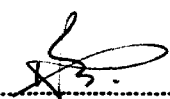
Signed .....
 SHIELD GEOPHYSICS LIMITED

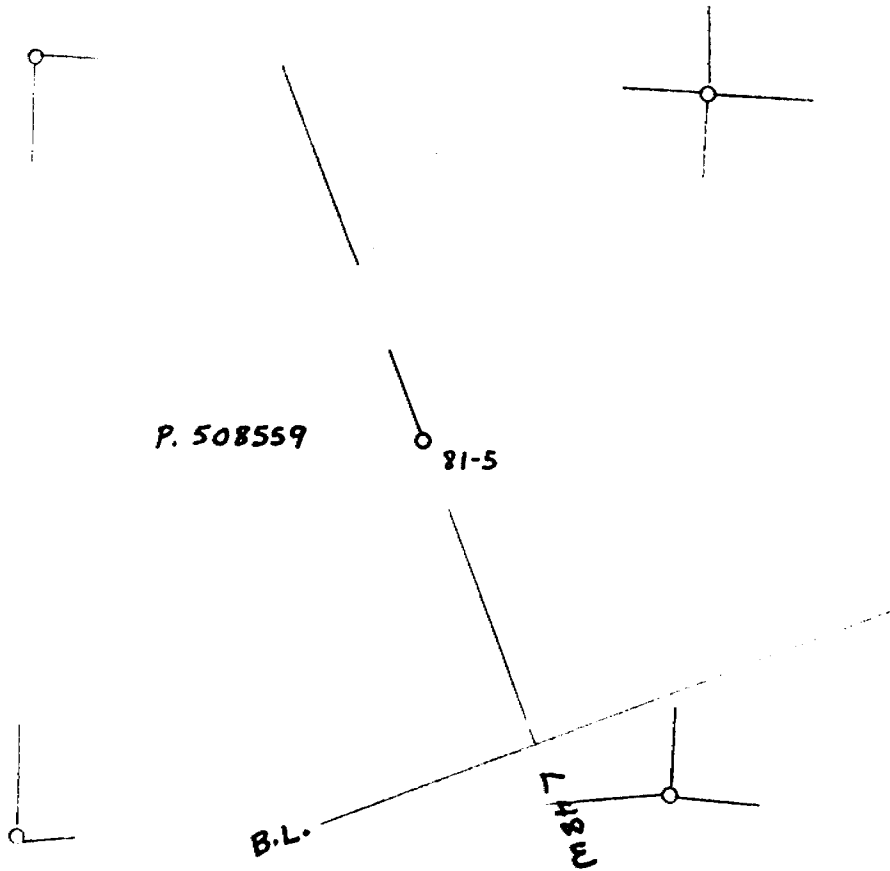

LOCATION OF HOLE 81-5
AREA WEST OF SUNDAY LAKE, ONT.
1" = 400'

DIAMOND DRILL RECORD

P508588

PROPERTY GOLD SHIELD - OMAB HOLE NO. 81-6

TOWNSHIP Area West of Sunday Lake PAGE NO. 1

LOCATION Fault Lake - 400' west &
50' south of peninsula
point on east side

CORE LOCATION camp site

STARTED March 21, 1981

DATUM _____

COMPLETED March 27, 1981

BEARING North (ast.)

DEPTH 392'

ELEVATION _____

DIP 50°

DEPTH FEET	FORMATION	SAMPLE NO.	WIDTH OF SAMPLE	Au/oz		
0 - 80	Casing - water & overburden (boulders).					
80 - 295	Intermediate to felsic Volcanic Tuff: dark green, v. f. gr., massive with faint banding @ approx. 40° to c.a. generally contorted; medium to very hard deeper, no other apparent volcanic structures, sli. py & po, diss. garnets locally.					
	117.8-126.8 brownish cast after garnet & diss. po, contorted banding & cherty silicification					
	118-123 1% py-po	6-1	5.0			
	123-124.8 1% py-po, sli. cpy	6-2	1.8			
	124.8-126.8 1% py-po	6-3	2.0			
	132-134.5 garnetiferous, cherty bands @ 30-40° 1% po-py	6-4	2.5			
	172.8-180 cherty with banding @ 30°					
	187 10% irreg. secondary qtz, 1% po, py some sericite	6-5	5.0			
	202-249 very siliceous with grey cherty bands showing much contortion, odd narrow qtz str. with diss. po-py					

Drilled By Manderstrom

Signed SHIELD GEOPHYSICS LIMITED

DIAMOND DRILL RECORD

PROPERTY..... HOLE NO. 81-6.....

TOWNSHIP..... PAGE NO. 2.....

LOCATION..... CORE LOCATION..... STARTED.....

..... DATUM..... COMPLETED.....

..... BEARING..... DEPTH.....

ELEVATION..... DIP.....

DEPTH FEET	FORMATION	SAMPLE NO.	WIDTH OF SAMPLE	Au/oz			
244.7-249.0	5% irreg. qtz str., 1% ps-py	6-6	4.3				
255	fracture @ 30°						
259-295	numerous narrow qtz-carb filled fractures, no definite angle						
272-276	chert & garnatiferous bands up to 3" with some pyrite						
278-280	muddy fractures						
283.5-288	1% diss. brown sphalerite with grey intrusive ?	6-7	4.8				
288-292.5	3% sphalerite, 1% py-cpy, minor galena in fractures with carb & as grains primarily in mud grey, v. f. gr. siliceous rock, perhaps intrusive also in grey black felsic wrk	6-8	4.5				
292.5-298.5	1% sphalerite, sli. py	6-9	6.0				
295 - 372	Intermediate Volcanic Tuff: no definite contact but dark green v. f. gr. partially chloritic finely banded (almost schistose), rock becomes softer, occ. narrow carb filled fractures, sli.						

Drilled By.....

Signed .....

SHIELD GEOPHYSICS LIMITED

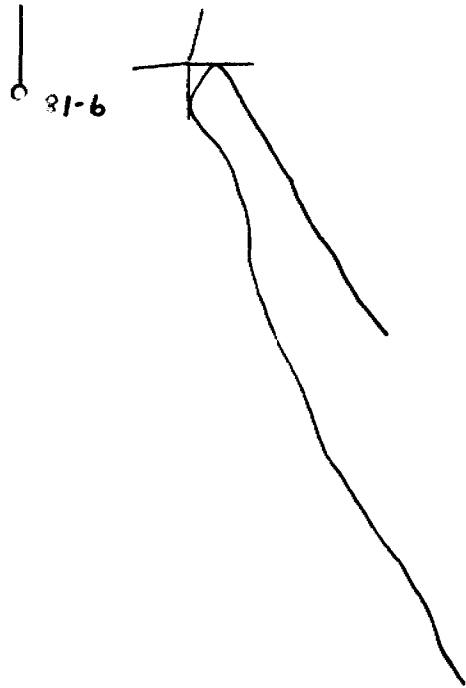

P.508598

Fault Lake

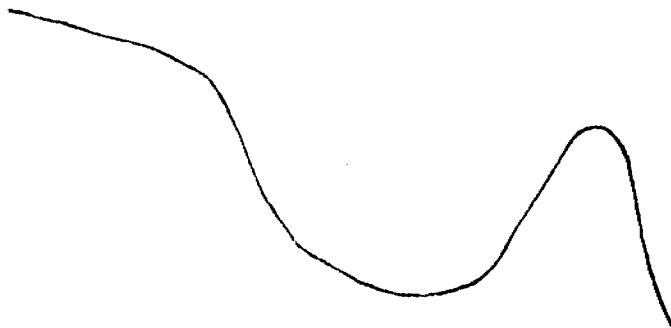

LOCATION OF HOLE 81-6
AREA WEST OF SUNDAY LAKE, ONT.

1" = 400'

DIAMOND DRILL RECORD

P508542

PROPERTY GOLD SHIELD - OMAB HOLE NO. 81-7
 TOWNSHIP Area West of Sunday Lake PAGE NO. 1

LOCATION Line 28 West CORE LOCATION camp site STARTED April 20, 1981
Station 23+50 North DATUM _____ COMPLETED April 29, 1981
 BEARING grid North DEPTH 320'
 ELEVATION _____ DIP 45°

DEPTH FEET	FORMATION	SAMPLE NO.	WIDTH OF SAMPLE				
0 - 126	Casing (overburden) - granite boulders last 20 ft.						
126 - 320	Intermediate to felsic Tuff: dark green to med. green, v. f. gr., contorted banding, slightly granitized, with seams and grains of pink feldspar totalling less than 5%.						
	141.0-142.0 core ground						
	150.0-151.0 core ground						
	154.0-177.6 rock is epidotized & broken with hematite fractures						
	174-177 core ground						
	177.6-207.2 epidotized with granitic patches up to 6"						
	193-196.5 less than 1% pyrite						
	205-206 coarse granite						
	206.2-207.2 coarse granite						
	216-217.7 grey to pink coarse grained granite @ 45°						
	218 banding @ 45°-30°						

Drilled By Manderstrom

Signed [Signature]
 SHIELD GEOPHYSICS LIMITED



P. 508542



81-7

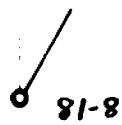
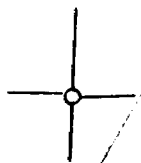

81-8

L 28 W

L 24 W

P. 508593

B.L.

LOCATION OF HOLES 81-7 + 81-8
AREA WEST OF SUNDAY LAKE, ONT

1" = 400'

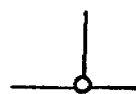
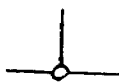

DIAMOND DRILL RECORD

P 508523

PROPERTY GOLD SHIELD - DMAB HOLE NO. 81-8
 TOWNSHIP Area West of Sunday Lake PAGE NO. 1

LOCATION Line 24 West CORE LOCATION camp site STARTED May 3, 1981
Station 3+50 North DATUM _____ COMPLETED May 6, 1981
 BEARING grid N DEPTH 323'
 ELEVATION _____ DIP 45°

DEPTH FEET	FORMATION	SAMPLE NO.	WIDTH OF SAMPLE			
0 - 114	Casing (overburden).					
114 - 323	Feldspar Porphyry (Quartz Monzonite)*: cream coloured phenocrysts up to 3/8" in grey black matrix, massive, uniform, hard.					
	176.0-185.0 more salmon coloured after orthoclase or iron stain					
	256.0-267.6 intermediate to felsic tuff (?) inclusion, green, v. f. gr., sheared at 30°, upper contact @ 10° to c.a., bottom contact @ 40° to c.a.					
	283.6-285.6 as above, slightly chloritic, massive					
	298.5-303.5 fractures filled with salmon coloured mineral, irregular, up to 10" sections of hematite stained silicic intrusive, sli. pyrite	8-1	5.0			
	313-323 some fracturing, slightly granitized					
323	END.					
	* Open File Report 5279					

Drilled By Manderstrom

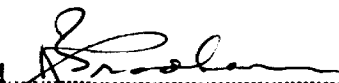
Signed 
 SHIELD GEOPHYSICS LIMITED



P. 508542

81-7

81-8

P. 508593

L 28 W

L 24 W

B.L.

LOCATION OF HOLES 81-7 + 81-8
AREA WEST OF SUNDAY LAKE, ONT

1" = 400'

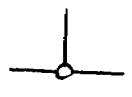
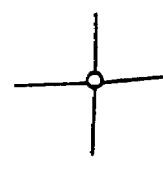
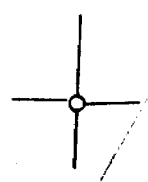
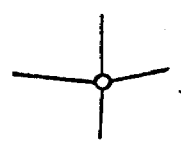

DIAMOND DRILL RECORD

P508597

PROPERTY GOLD SHIELD - DMAB HOLE NO. 81-9
 TOWNSHIP Area West of Sunday Lake PAGE NO. 1

LOCATION Line 32 West CORE LOCATION camp site STARTED May 8, 1981
 Station 15+50 South DATUM COMPLETED May 11, 1981
 BEARING grid N DEPTH 300'
 ELEVATION DIP 45°

DEPTH FEET	FORMATION	SAMPLE NO.	WIDTH OF SAMPLE				
0 - 9	Casing (overburden).						
9 - 300	Feldspar Porphyry (Quartz Monzonite)*: massive, with cream coloured, phenocrysts in grey black matrix, as hole 81-8, contains biotite & phloypite mica. 45.8-47.0 black fine grained inclusion 134 fracture @ 45° 207.5 ½" of clay mineral						
300	END.						
	*Open File Report 5279						

Drilled By Manderstrom

Signed 
 SHIELD GEOPHYSICS LIMITED

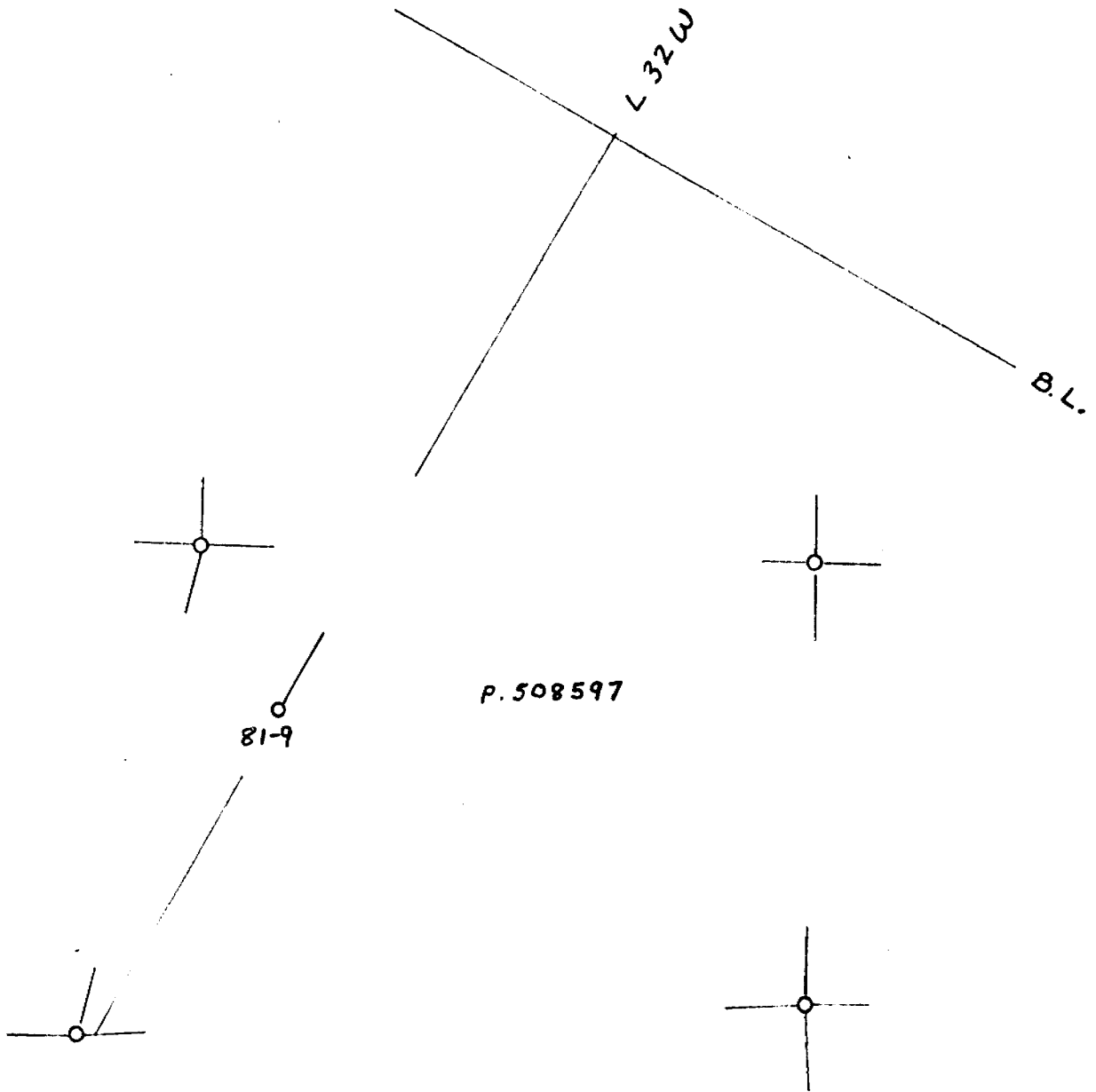

LOCATION OF HOLE 81-9
AREA WEST OF SUNDAY LAKE, ONT.
1" = 400'

DIAMOND DRILL RECORD

P508592

PROPERTY GOLD SHIELD - CMAB HOLE NO. 81-10
 TOWNSHIP Area West of Sunday Lake PAGE NO. 1

LOCATION Line 8 West CORE LOCATION camp site STARTED May 13, 1981
Station 4+75 North DATUM _____ COMPLETED May 15, 1981
 BEARING grid N DEPTH 300'
 ELEVATION _____ DIP 45°

DEPTH FEET	FORMATION	SAMPLE NO.	WIDTH OF SAMPLE				
0 - 128	Casing (overburden).						
128 - 300	Mafic Intrusive - Gabbro or Amphibolite: dark blue green, f. gr. to med. gr., locally diss. py moderately soft, little apparent plagioclase, chloritic & sericitic ?						
	138.0-143.5 intermediate to mafic tuff, faint banding, v. f. gr.; much epidote @ upper contact						
	156-157 fault seam //ing core - chlorite contacts over ¼"						
	226 3" pink to red granitized section @ 45°						
	228.7 2" pink granitic section						
	259.5 4" grey feldspar xtals						
	269-271 int. to felsic black tuff, upper & lower contact @ 40°-20° to c.a. and sharp						
	297-300 sutured or mylonitic texture @ about 60° to c.a.						

300 END.

Drilled By Manderstrom

Signed *[Signature]*
 SHIELD GEOPHYSICS LIMITED

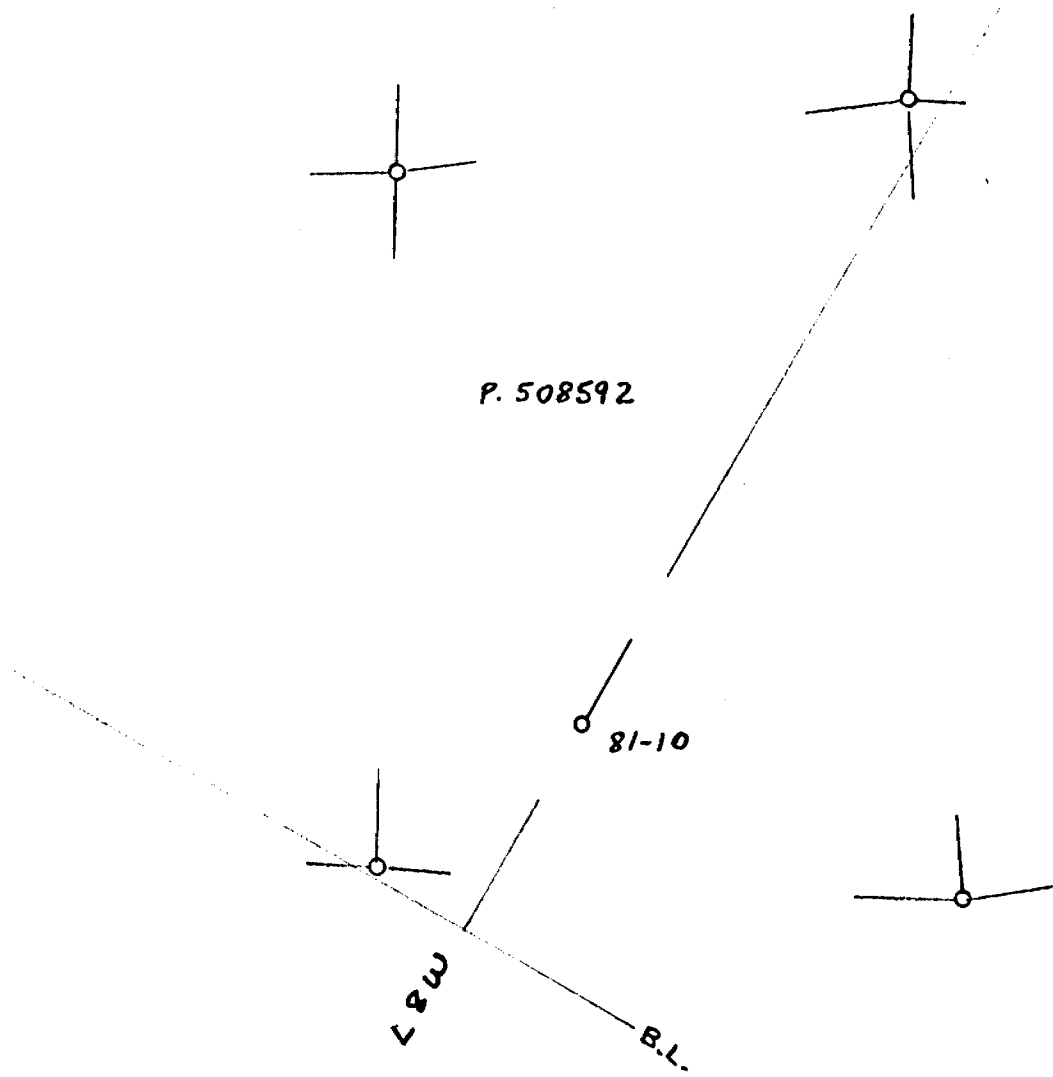

LOCATION OF HOLE 81-10
AREA WEST OF SUNDAY LAKE, ONT.
1" = 400'

DIAMOND DRILL RECORD

P 508600

PROPERTY GOLD SHIELD - CMAB HOLE NO. 81-11

TOWNSHIP Area West of Sunday Lake PAGE NO. 1

LOCATION Line 12 East

CORE LOCATION camp site

STARTED June 2, 1981

Station 5+50 North

DATUM _____

COMPLETED June 4, 1981

BEARING grid North

DEPTH 322'

ELEVATION _____

DIP 45°

DEPTH FEET	FORMATION	SAMPLE NO.	WIDTH OF SAMPLE	Au/oz			
0 - 49	Casing (overburden).						
49 - 54	Felsic Intrusive: grey, med. grained, crystalline, some pink feldspar, possible boulder.						
	52 4" grey qtz str. //ing c.a.						
54 - 102	Mafic Volcanic: grey black, fine grained, recrystallized to amphibolite, occ. epidote strs. odd narrow granite str.						
	95 1.5" grey granite str. @ 30° to c.a.						
102 - 107	Felsic Intrusive: grey black, med. grained.						
107 - 128	Felsic Volcanic Tuff: dark grey, v. f. gr., banded at 50° with grey siliceous sections & granitized sections with 1-2% py, epidote bands up to 2".						
	107.2-112.2 1% pyrite	11-1	5.0				
	115.3-118.0 pink, f. gr. granitization						
128 - 187	Mafic Volcanic Tuff: much softer, v. f. gr., chloritic, little banding, recrystallized.						
	134.5-135.1 faulted pink granite v. with 1/4" massive py with chlorite	11-1	0.6				

Drilled By Manderstrom

Signed  _____
SHIELD GEOPHYSICS LIMITED

DIAMOND DRILL RECORD

PROPERTY..... HOLE NO. 81-11
 TOWNSHIP..... PAGE NO. 2

LOCATION..... CORE LOCATION..... STARTED.....
 DATUM..... COMPLETED.....
 BEARING..... DEPTH.....
 ELEVATION..... DIP.....

DEPTH FEET	FORMATION	SAMPLE NO.	WIDTH OF SAMPLE				
	146.0-153.0 soft-chloritic						
	153 becoming harder						
	165-174.6 pink granite						
	170 4" chlorite @ 40°						
	174.6-182 epidotized greenstone						
	182-187 pink granite @ 40°						
187 - 309	Mafic to Intermediate Volcanic: dark grey, v. f. gr., recrystallized, amphibolitized, with epidote stringers.						
	207-208.2 pink granite @ 30°						
	230-248 becoming harder with siliceous banding @ 45°						
	248 colour changes to med. grey with faint crystalline texture--may be altered granodiorite intrusive						
	258 numerous fractures, some brecciation						
	267.4-268.4 pink granite						
	271-275.5 qtz-epidote-hematite breccia						
	275.5 2" gouge @ 45° to c.a.						

Drilled By.....

Signed .....
 SHIELD GEOPHYSICS LIMITED

DIAMOND DRILL RECORD

PROPERTY..... HOLE NO. 81-11

TOWNSHIP..... PAGE NO. 3

LOCATION..... CORE LOCATION..... STARTED.....

..... DATUM..... COMPLETED.....

..... BEARING..... DEPTH.....

ELEVATION..... DIP.....

DEPTH FEET	FORMATION	SAMPLE NO.	WIDTH OF SAMPLE				
	275.7-289.0 fractured & brecciated granite & greenstone						
	289-300.5 grey perhaps mylonite						
	300.5-309 grey & pink granite						
	305-306.2 barren white qtz @ 30°						
309 - 322	Intermediate Volcanic: black, med. grained, recrystallized.						
322	END.						

Drilled By.....

Signed .....
SHIELD GEOPHYSICS LIMITED

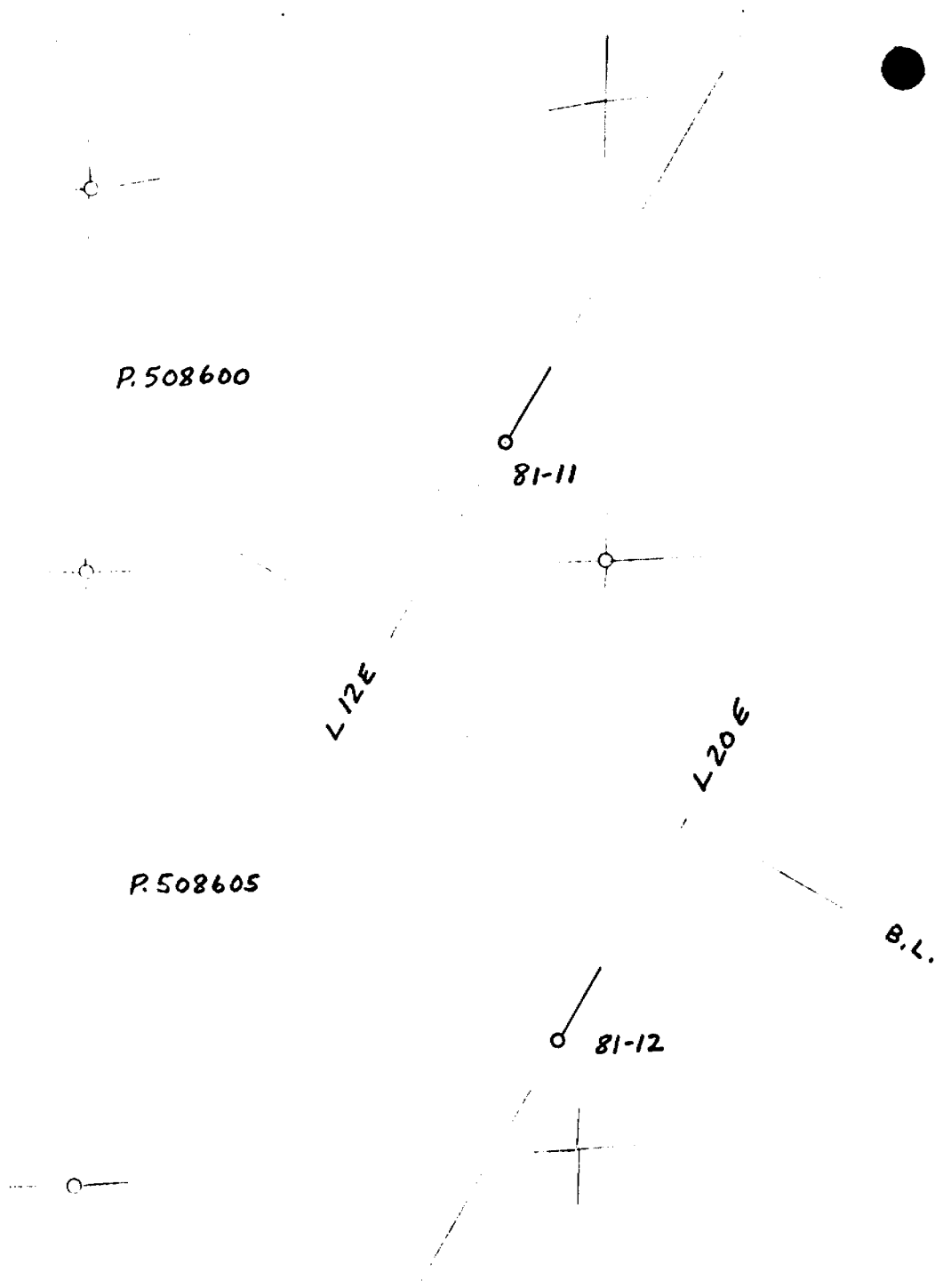

LOCATION OF HOLES 81-11 & 81-12
EA WEST OF SUNDAY LAKE, ONT.
1" = 400'

DIAMOND DRILL RECORD

P 508600

PROPERTY GOLD SHIELD - DMAB HOLE NO. 81-12

TOWNSHIP Area West of Sunday Lake PAGE NO. 1

LOCATION Line 20 East
Station 6+00 South

CORE LOCATION camp site

STARTED June 7, 1981

DATUM _____

COMPLETED June 8, 1981

BEARING grid North

DEPTH 321'

ELEVATION _____

DIP 45°

DEPTH FEET	FORMATION	SAMPLE NO.	WIDTH OF SAMPLE				
0 - 11	Casing (overburden).						
11 - 18.1	Intermediate to Felsic Tuff: dark grey to black, v. f. gr., faintly banded @ 45°.						
18.1 - 35	Felsic Intrusive: dark grey, med. grained, crystalline, much phlogopite mica particularly @ 33, bottom contact @ 45°.						
35 - 75	Felsic to Intermediate Volcanic: grey black, v. f. gr., recrystallized banding @ 40°.						
	46 4" pink granite @ 30°						
	71.2-72 80% qtz @ 40°						
75 - 121	Felsic Tuff: grey to black, banded at 40° with epidote, quartz str., garnet.						
	76.8-79.5 60% qtz str., epidote, some garnet less than 1% pyrite	12-1	2.7				
	84.3 2" heavy pyrrhotite diss.						
	97-100 1% diss. py	12-2	3.0				
121 - 132	Felsic Intrusive: dark grey, med. grained, crystalline.						
132 - 239.7	Felsic Tuff: as above banded at 45°.						

Drilled By Manderstrom

Signed *[Signature]*

SHIELD GEOPHYSICS LIMITED

DIAMOND DRILL RECORD

PROPERTY..... HOLE NO. 81-12
 TOWNSHIP..... PAGE NO. 2

LOCATION..... CORE LOCATION..... STARTED.....
 DATUM..... COMPLETED.....
 BEARING..... DEPTH.....
 ELEVATION..... DIP.....

DEPTH FEET	FORMATION	SAMPLE NO.	WIDTH OF SAMPLE				
	149.5-150.9 grey felsic intrusive						
	166.5-170.3 grey felsic intrusive						
	178-179.2 f. gr. pink granitoid rock						
	193-197.3 grey felsic intrusive						
	208.3-209 cherty, siliceous section @ 70°, sli. py at contacts						
	209.5-211.5 grey felsic intrusive						
	212.7-213.8 little py with calcite @ 70°						
	221.0-222.3 grey felsic intrusive						
	233-239.7 grey felsic intrusive						
239.7 - 321	Recrystallized Intermediate to Mafic Volcanic: dark grey, fine gr., poor banding @ 60°, epidote, white mineral, softer, chloritic, sli. py-po.						
	246.5-247.7 grey, f. gr. felsic intrusive						
	276 2" breccia at bottom contact of 10" grey felsic intrusive						
	298.7 2" barren white quartz						
321	END.						

Drilled By.....

Signed .....
 SHIELD GEOPHYSICS LIMITED

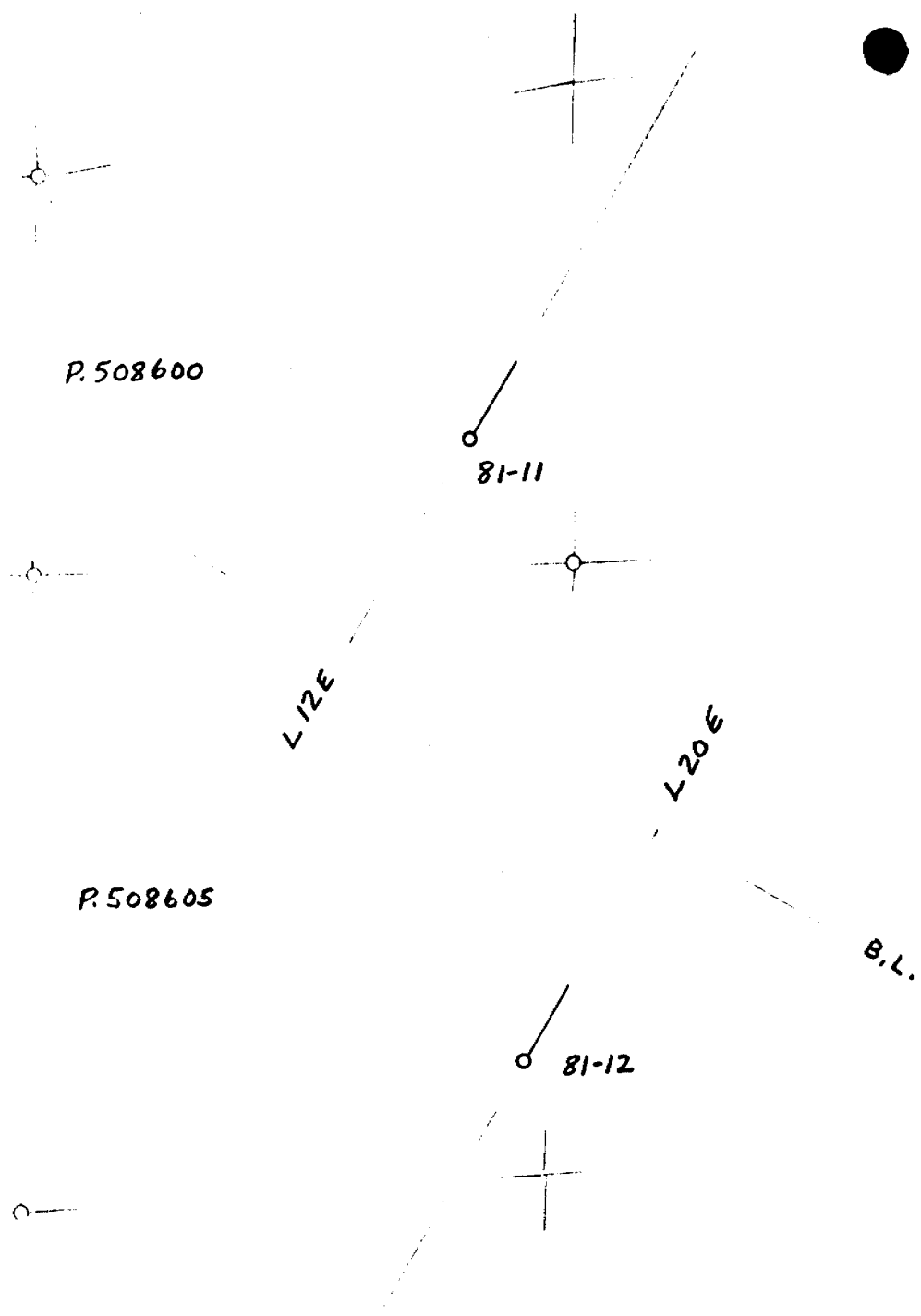

LOCATION OF HOLES 81-11 & 81-12
AREA WEST OF SUNDAY LAKE, ONT.
1" = 400'

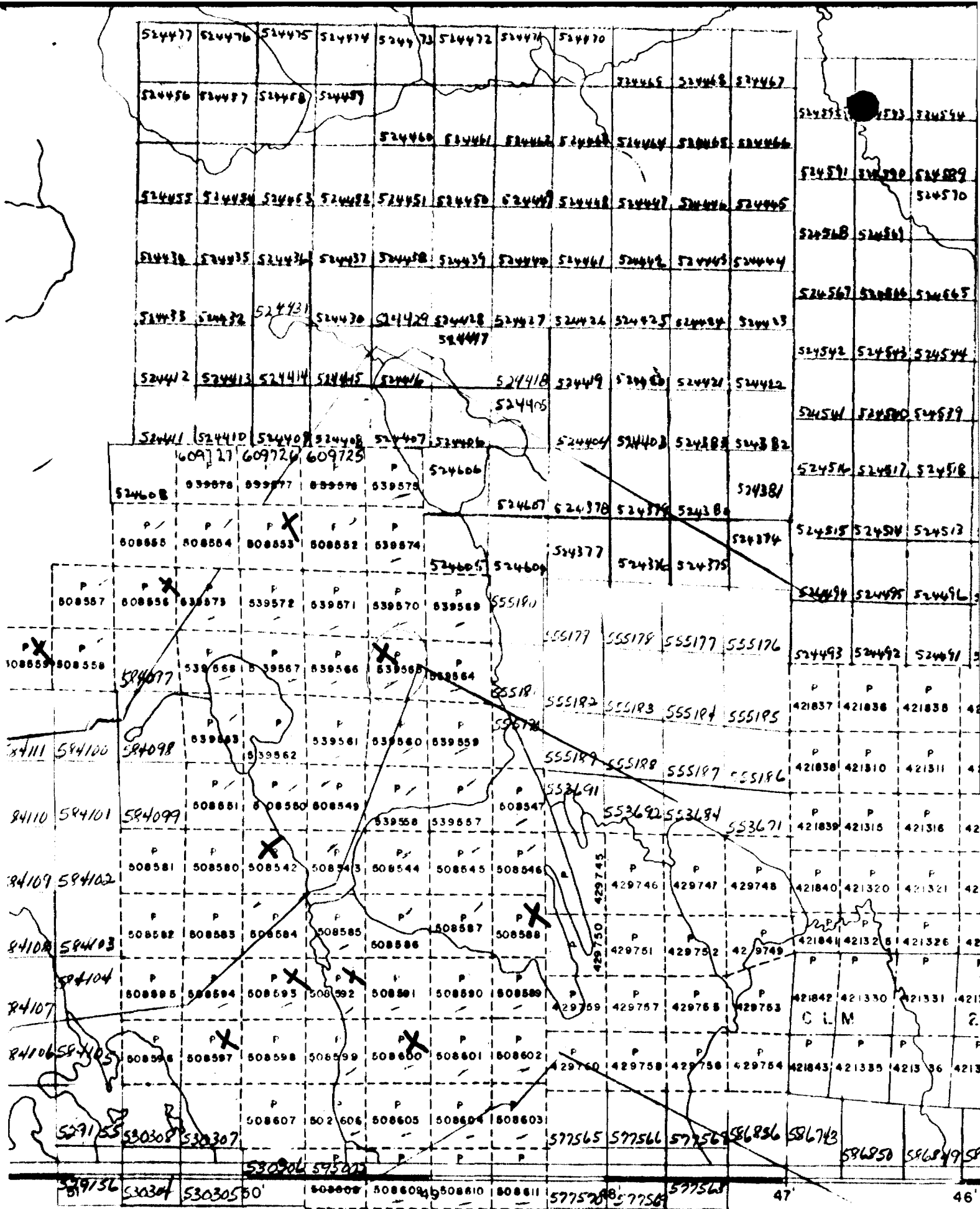

11

West of Sunday Lk # 246-81
 R. J. BRADSHAW