

DIAMOND DRILLING



41182SW0004 001001 BIGWOOD

010

TOWNSHIP: Bigwood

REPORT No.: 12

WORK PERFORMED BY: Steep Rock Iron Mines Ltd.

<u>CLAIM No.</u>	<u>HOLE No.</u>	<u>FOOTAGE</u>	<u>DATE</u>	<u>NOTE</u>
S 574878	FRN201	150.0	June/82	(1)
	FRN202	101.0	June/82	(1)
S 574880	FRN203	150.0	June/82	(1)
	FRN204	101.0	June/82	(1)
	FRN205	102.0	June/82	(1)
S 574881	FRN206	101.0	June/82	(1)

Total: 6 DH 705 Feet

NOTES: (1) #88-82

DIAMOND DRILLHOLE LOG

DRILLING COMPANY Eastern Ontario Diamond Drilling		COLLAR ELEV.	COMPANY Steep Rock Iron Mines Ltd.	PROPERTY NAME Alban North	HOLE NO. FRN 201	PAGE 1
DATE STARTED June 1982	DATE COMPLETED	DATE LOGGED Aug. 4/82	BEARING OF HOLE 240° T	LOCATION OF HOLE 665 feet on a bearing of 335° T from No. 3 post, claim S-574878	PROJECT NO. G2-8	
		DIP OF HOLE AT COLLAR 45°	TOTAL DEPTH 150 feet	LOGGED BY G.R. Guillet		

DEPTH		VISUAL QUALITY	DESCRIPTION	Sample Number	Sample Interval		Sample Length					
To	From				From	To						
0.0	3.0		Casing									
3.0	28.5	Poor	Nepheline syenite: Mixed, variable and locally altered, grey with some red fracture alteration. Biotite and hornblende common. Four sections of biotite schist up to 12 inches thick.	201-1	3.0	28.5	25.5					
28.5	41.0	Fair	Nepheline syenite: Mostly coarse grained pink and grey, with moderate hornblende content. Several zones of fracturing with red and green alteration.	201-2	28.5	41.0	12.5					
41.0	67.5	Waste	Biotite schist and heavily altered nepheline syenite: Grey black with much red alteration probably associated with faulting. 5 feet of lost core in scattered locations throughout the section.	201-3	41.0	67.5	26.5					
67.5	81.5	Fair	Nepheline syenite: Mostly coarse grained, pink and grey, with moderate content of biotite and hornblende. Locally higher concentrations of dark minerals and some red alteration.	201-4	67.5	81.5	14.0					
81.5	99.0	Good	Nepheline syenite: Uniform, coarse grained, pink and white, with a moderate content of biotite, hornblende and magnetite.	201-5	81.5	99.0	17.5					
99.0	120.0	Good	Nepheline syenite: Mostly coarse grained, pink and white, with moderate dark mineral content and minor alteration. Foliation is 70° to core axis.	201-6	99.0	120.0	21.0					
120.0	135.0	Waste	Nepheline syenite: Heavily altered and intruded by pink syenite and biotite schist. 3 feet of lost core.	201-7	120.0	135.0	15.0					
135.0	140.0	Good	Nepheline syenite pegmatite: Pink and grey, minor milky alteration; low content of dark minerals.	201-8	135.0	140.0	5.0					
140.0	150.0	Fair	Pink syenite: Mostly coarse grained, pink-grey, with a moderate content of dark minerals. Low nepheline content.	201-9	140.0	150.0	10.0					
150.0			End of hole.									

G.R. Guillet



DIAMOND DRILLHOLE LOG

DRILLING COMPANY Eastern Ontario Diamond Drilling		COLLAR ELEV.	COMPANY Steep Rock Iron Mines Ltd.	PROPERTY NAME Alban North	HOLE NO. FRN 202	PAGE 1
DATE STARTED June 1982	DATE COMPLETED	BEARING OF HOLE 240° T	TOTAL DEPTH 101 feet	LOCATION OF HOLE 200 feet on a bearing 350 ° T from No. 3 post, claim S-574878	PROJECT NO. G2-8	
		DATE LOGGED July 12/82	DIP OF HOLE AT COLLAR 45°	AT	LOGGED BY G.R. Guillet	

DEPTH		VISUAL QUALITY	DESCRIPTION	Sample Number	Sample Interval		Sample Length					
To	From				From	To						
0.0	5.0		Casing									
5.0	19.0	Poor	Nepheline syenite: Pink and grey, more or less altered, coarse grained; abundant hornblende and biotite. Reason for red alteration is not apparent - perhaps close to a fault or fractures.	202-1	5.0	19.0	14.0					
19.0	37.0	Good	Nepheline syenite: Mottled pink and white, coarse grained to pegmatitic, moderate content of hornblende and biotite, minor magnetite. 12-inch seam of biotite schist at 36'.	202-2	19.0	37.0	18.0					
37.0	50.5	Fair	Nepheline syenite: Grey, fine to medium grained, uniform; abundant hornblende, some biotite; low nepheline content.	202-3	37.0	50.5	13.5					
50.5	64.5	Waste	Biotite schist: Variable, fine to coarse grained, nepheline syenite and biotite schist in about equal portions. Coarse disseminated biotite in sections 51' to 52', 54' to 58'; massive biotite sections 61.5' to 62' and 63' to 64'.	202-4	50.5	64.5	14.0					
64.5	82.5	Good	Nepheline syenite: Mostly white, somewhat variable medium and coarse grained, moderate to common hornblende with biotite and magnetite.	202-5	64.5	82.5	18.0					
82.5	101.0	Fair	Nepheline syenite: Mottled pink, grey and white, mostly medium grained; several thin (1" to 4") schist seams; dark mineral content higher than average. Foliation is at 80° to core axis.	202-6	82.5	101.0	18.5					
101.0			End of hole.									

G.R. Guillet



DIAMOND DRILLHOLE LOG

DEPTH		VISUAL QUALITY	DESCRIPTION	Sample Number	Sample Interval		Sample Length		
To	From				From	To			
0.0	3.0		Casing.						
3.0	26.0	Good	Nepheline syenite: Uniform, grey-white, medium and coarse grained, with a moderate content of biotite and hornblende. Some pink and white pegmatite sections. Zircon locally common.	203-1	3.0	26.0	23.0		
26.0	36.5	Good	Nepheline syenite: Mixed section; mostly coarse grained, grey-white with low content of dark minerals. Several 1 or 2 inch sections of biotite schist at 26.5 and 32.0.	203-2	26.0	36.5	10.5		
36.5	50.7	Good	Nepheline syenite: Massive, coarse grained, pink and white, in places pegmatitic. Moderate content of hornblende and biotite.	203-3	36.5	50.7	14.2		
50.7	70.7	Good	Nepheline syenite: Mostly medium grained, occasionally coarse and pegmatitic; pink and white. Hornblende relatively common; some biotite and magnetite.	203-4	50.7	70.7	20.0		
70.7	81.2	Waste	Nepheline syenite: Extensively altered by fractures at 73.0, 74.5, 77.7, and 81.0. Green and red alteration. Some nepheline-poor syenite.	203-5	70.7	81.2	10.5		
81.2	99.0	Fair	Nepheline syenite: Mostly coarse grained grey with more than average content of hornblende and biotite. Nepheline content appears to be lower than normal.	203-6	81.2	99.0	17.8		
99.0	122.5	Poor-Waste	Nepheline syenite: Medium and coarse grained, with much red and green alteration; dark minerals common. Alteration particularly heavy 110-119 associated with a zone of fractures.	203-7	99.0	122.5	23.5		
122.5	138.0	Fair	Nepheline syenite: Mostly medium grained grey-white; dark minerals fairly common.	203-8	122.5	138.0	15.5		
138.0	150.0	Good	Nepheline syenite: Pink and white, medium and coarse grained; moderate dark mineral content.	203-9	138.0	150.0	12.0		
150.0			End of hole.						

G.R. Guillet



DIAMOND DRILLHOLE LOG

DRILLING COMPANY Eastern Ontario Diamond Drilling		COLLAR ELEV.	BEARING OF HOLE 240°T	TOTAL DEPTH 101 feet	PROPERTY NAME Alban North	HOLE NO. FRN 204	PAGE 1
DATE STARTED June 1982	DATE COMPLETED	DATE LOGGED July 13/82	DIP OF HOLE AT COLLAR 45°	AT	LOCATION OF HOLE 800 feet on a bearing of 154° from No. 1 post, claim S-574880	PROJECT NO. 62-8	LOGGED BY G.R. Guillet

DEPTH		VISUAL QUALITY	DESCRIPTION	Sample Number	Sample Interval		Sample Length							
To	From				From	To								
0.0	3.0		Casing											
3.0	11.5	Good	Nepheline syenite: Uniform, coarse grained, pink and white, with moderate amounts of hornblende and biotite.	204-1	3.0	11.5	8.5							
11.5	21.0	Good	Nepheline syenite: Grey-white, medium grained; slightly more than average hornblende and biotite; several small patches of pegmatitic nepheline.	204-2	11.5	21.0	9.5							
21.0	28.0	Good	Nepheline syenite: Mottled pink and white, coarse grained; moderate amounts of biotite and hornblende.	204-3	21.0	28.0	7.0							
28.0	38.6	Good	Nepheline syenite: Pink and white, medium grained; moderate amounts of biotite and hornblende.	204-4	28.0	38.6	10.6							
38.6	49.6	Fair	Nepheline syenite: Grey, medium grained; biotite and hornblende rather common; uniform.	204-5	38.6	49.5	11.0							
49.6	61.6	Good	Nepheline syenite: mostly coarse grained, pink and white, with several 8-inch pegmatite patches; moderate hornblende and biotite content. Brown zircon locally common.	204-6	49.6	61.6	12.0							
61.6	78.0	Fair	Nepheline syenite: Mixed section; mostly coarse grained pink and white. Heavy dark mineral content in first foot and at 66.5 (4 inches). Last 2 feet heavily altered green and red, associated with several fractures.	204-6	61.6	78.0	16.4							
78.0	101.0	Good	Nepheline syenite: Uniform, pink and white, coarse grained; in places pegmatitic. Low to moderate content of hornblende and biotite. Dark minerals locally abundant 83.8-84.5, 95.5-96.0, and 99.5 - 100.5.	204-7	78.0	101.0	23.0							
101.0			End of hole.											

G.R. Guillet



DIAMOND DRILLHOLE LOG

DRILLING COMPANY Eastern Ontario Diamond Drilling			COMPANY Steep Rock Iron Mines Ltd.		PROPERTY NAME Alban North			HOLE NO. FRN 705	PAGE 1	
DATE STARTED June 1982		DATE COMPLETED		COLLAR ELEV.	BEARING OF HOLE 240° T	TOTAL DEPTH 102 feet	LOCATION OF HOLE 1450 feet on a bearing of 150° T from No. 1 post, claim S-574880			
DATE LOGGED July 12/82		DATE LOGGED July 12/82		DIP OF HOLE AT COLLAR 45°	AT	PROJECT NO. G2-8			LOGGED BY G.R. Guillet	
DEPTH		VISUAL QUALITY	DESCRIPTION	Sample Number	Sample Interval		Sample Length			
To	From				From	To				
Feet	Feet				Feet	Feet	Feet			
0.0	3.0		Casing.							
3.0	20.5	Good	Nepheline syenite: Mostly white, coarse grained, with moderate amounts of hornblende and biotite, minor magnetite. Moderate amount of salmon-pink nepheline.	205-1	3.0	20.5	17.5			
20.5	25.0	Fair	Nepheline syenite: Mostly pink, medium grained, with rather abundant hornblende and biotite.	205-2	20.5	25.0	4.5			
25.0	40.5	Good	Nepheline syenite: Mostly white with several small pink pegmatitic nepheline patches. Slightly more than average hornblende and biotite. Foliation 70° to core axis.	205-3	25.0	40.5	15.5			
40.5	47.0	Fair	Nepheline syenite: Pink and grey, medium grained, with more than average hornblende and biotite, and a patch of pink pegmatitic nepheline at 43' to 44'.	205-4	40.5	47.0	6.5			
47.0	54.0	Good	Nepheline syenite: White, coarse grained, with low to moderate content of hornblende and biotite.	205-5	47.0	54.0	7.0			
54.0	57.5	Poor	Nepheline syenite: Grey, medium grained, with some alteration associated with a 10-inch seam of biotite schist at 57'.	205-6	54.0	57.5	3.5			
57.5	70.0	Fair	Nepheline syenite: Mottled grey and pink, medium grained; slightly more than average hornblende and biotite. Frequent narrow patches of pegmatitic pink and white nepheline and feldspar.	205-7	57.5	70.0	12.5			
70.0	88.5	Good	Nepheline syenite: Mottled pink and white, coarse grained, low to moderate amount of hornblende, minor biotite and magnetite.	205-8	70.0	88.5	18.5			
88.5	102.0	Fair	Nepheline syenite: Variable medium and coarse grained, grey-white-pink; some pegmatitic patches, more than average dark minerals, biotite predominating.	205-9	88.5	102.0	13.5			
102.0			End of hole.							

G.R. Guillet



DIAMOND DRILLHOLE LOG

DRILLING COMPANY Eastern Ontario Diamond Drilling		COLLAR ELEV.	BEARING OF HOLE 240° T	TOTAL DEPTH 101 feet	PROPERTY NAME Alban North	HOLE NO. FRN206	PAGE 1
DATE STARTED June 1982	DATE COMPLETED	DATE LOGGED July 19/82	DIP OF HOLE AT COLLAR 45°	AT	LOCATION OF HOLE 300 feet on a bearing of 200° from No. 2 post, claim S-574881	PROJECT NO. G2-8	LOGGED BY G.R. Guillet

DEPTH		VISUAL QUALITY	DESCRIPTION	Sample Number	Sample Interval		Sample Length					
To	From				From	To						
Feet 0.0	Feet 3.0		Casing		Feet	Feet	Feet					
3.0	33.0	Good	Nepheline syenite: mostly coarse grained, pink and white, uniform; biotite and hornblende in moderate amount. Brown zircon relatively common. Traces of pyrite and purple fluorite.	206-1	3.0	33.0	30.0					
33.0	58.0	Very good	Nepheline syenite: Coarse pegmatitic, pink and white, uniform. Relatively low content of biotite and hornblende; some magnetite. Relatively high nepheline content.	206-2	33.0	58.0	25.0					
58.0	84.5	Good	Nepheline syenite: Coarse grained pink and white; moderate content of biotite and hornblende; minor magnetite. Foliation is 70° to core axis.	206-3	58.0	84.5	26.5					
84.5	101.0	Poor	Nepheline syenite: Mostly grey, medium and coarse grained, with more than average dark mineral content. Rather low content of nepheline. Biotite schist, 7-inch section at 95.0 feet, 4-inch at 97.0 feet. Some muscovite; minor garnet.	206-4	84.5	101.0	16.5					
101.0			End of hole.									

G.R. Guillet

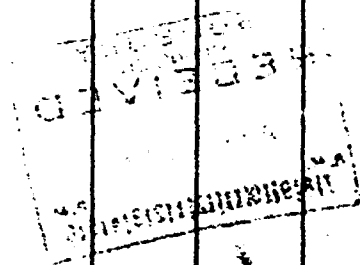

1982
G.R. GUILLET
206-4

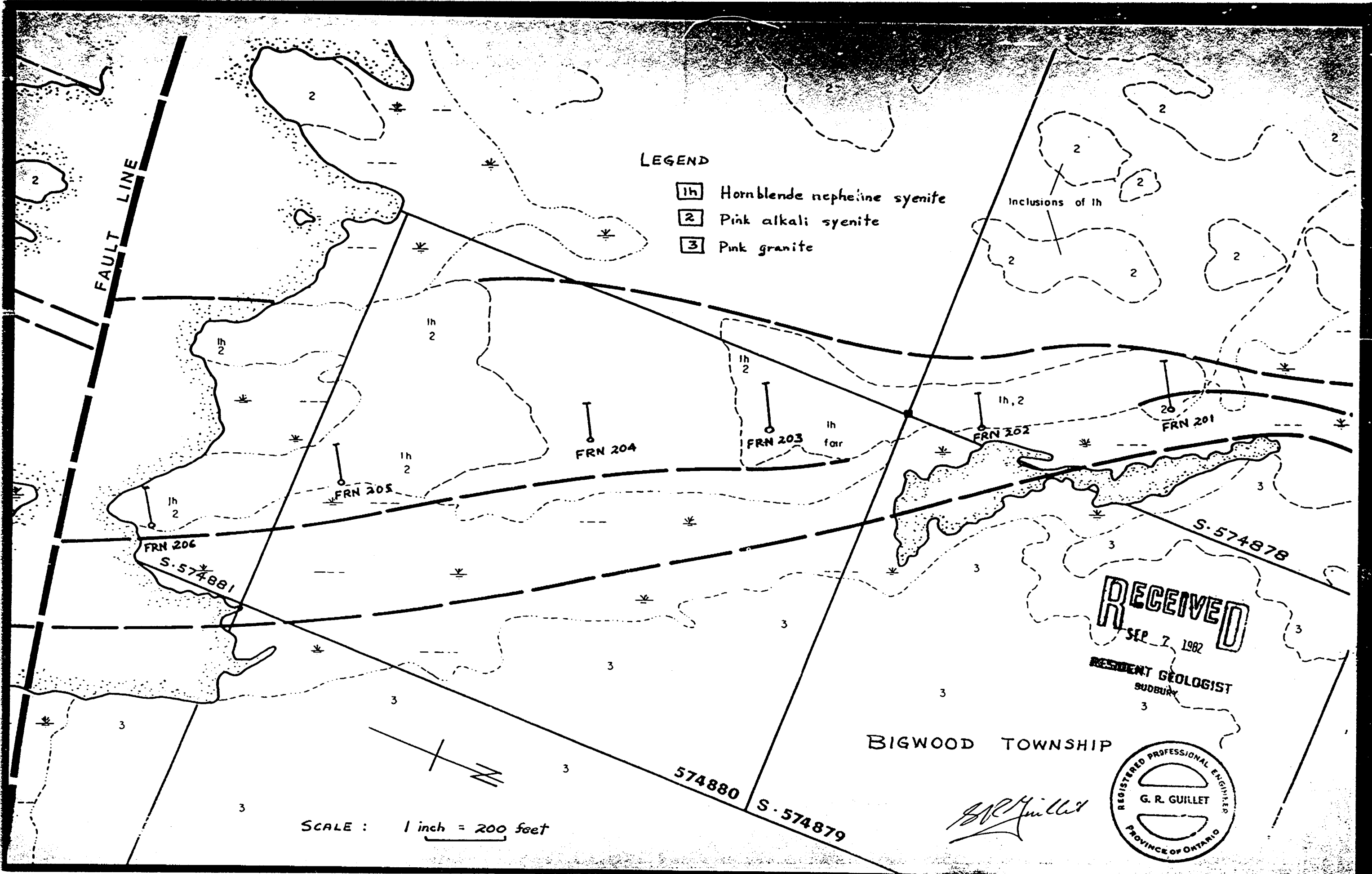

LEGEND

- 1h Hornblende nepheline syenite
- 2 Pink alkali syenite
- 3 Pink granite

Inclusions of 1h

FAULT LINE

FRN 206
S. 574881

FRN 205

FRN 204

FRN 203

FRN 202

FRN 201

RECEIVED
SEP 7 1982

RESIDENT GEOLOGIST
SUDBURY

BIGWOOD TOWNSHIP

G. R. Guillet

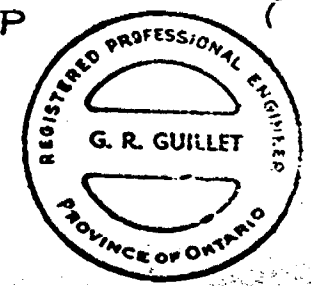

SCALE : 1 inch = 200 feet

574880

S. 574879

S. 574878



Ministry of
Natural
Resources

Report
of Work

Bigwood TWP.
(N. 666)
The Mining Act

Instructions - Supply required data on a separate form for each type of work to be recorded (see table below).
- For Geo-technical work use form no. 1362 "Report of Work (Geological, Geophysical, Geochemical and Expenditures)".

FILE S. 574878

Name and Postal Address of Recorded Holder Steep Rock Iron Mines Limited	Prospector's Licence No.
40 University Avenue, Suite 710, Toronto, Ontario, M5J 2G5	

Summary of Work Performance and Distribution of Credits

Total Work Days Cr. Claimed 705	Mining Claim			Mining Claim			Mining Claim		
	Prefix	Number	Work Days Cr.	Prefix	Number	Work Days Cr.	Prefix	Number	Work Days Cr.
for Performance of the following work. (Check one only) <input type="checkbox"/> Manual Work <input type="checkbox"/> Shaft Sinking Drifting or other Lateral Work. <input type="checkbox"/> Compressed Air, other Power driven or mechanical equip. <input type="checkbox"/> Power Stripping <input checked="" type="checkbox"/> Diamond or other Core drilling <input type="checkbox"/> Land Survey	S	574878	101						
		574879	101						
		574880	101						
		574881	101						
		574882	101						
		574883	100						
	574884	100							



41102SW0004 0010D1 BIGWOOD

900

Required Information eg: type of equipment, Names, Addresses, etc. (See Table below)

Claims on which work was performed (Diamond drilling as follows):

S-574878 - Hole FRN 201	150 feet
" FRN 202	101 "
S-574880 - " FRN 203	150 "
" FRN 204	101 "
" FRN 205	102 "
S-574881 - " FRN 206	101 "
	<hr/> 705 "

Note: All drillholes used AX equipment, returning a core of 1.185 inches diameter, drilled at angles of 45° on bearings of 240°T.

Date of Report August 9, 1982	Recorded Holder or Agent (Signature) <i>SR Guillet</i>
----------------------------------	---

Certification Verifying Report of Work

I hereby certify that I have a personal and intimate knowledge of the facts set forth in the Report of Work annexed hereto, having performed the work or witnessed same during and/or after its completion and the annexed report is true.

Name and Postal Address of Person Certifying G. Robert Guillet, M.A., P.Eng., Consulting Geologist	Date Certified August 9, 1982	Certified by (Signature) <i>SR Guillet</i>
Box 370 Mount Albert, Ontario, LOG 1M0		

Table of Information/Attachments Required by the Mining Recorder

Type of Work	Specific information per type	Other information (Common to 2 or more types)	Attachments
Manual Work	Nil	Names and addresses of men who performed manual work/operated equipment, together with dates and hours of employment.	Work Sketch: these are required to show the location and extent of work in relation to the nearest claim post.
Shaft Sinking, Drifting or other Lateral Work			
Compressed air, other power driven or mechanical equip.			
	Type of equipment and amount expended.		

July 19/82

Cox Twp. 6 00H (705') Bigwood Twp.

Delamere Twp

(M-735) Locations

#88-82

14 13 12 11 10 9

VI

V

400
Z

IV

III

Allen Twp. (M.625)

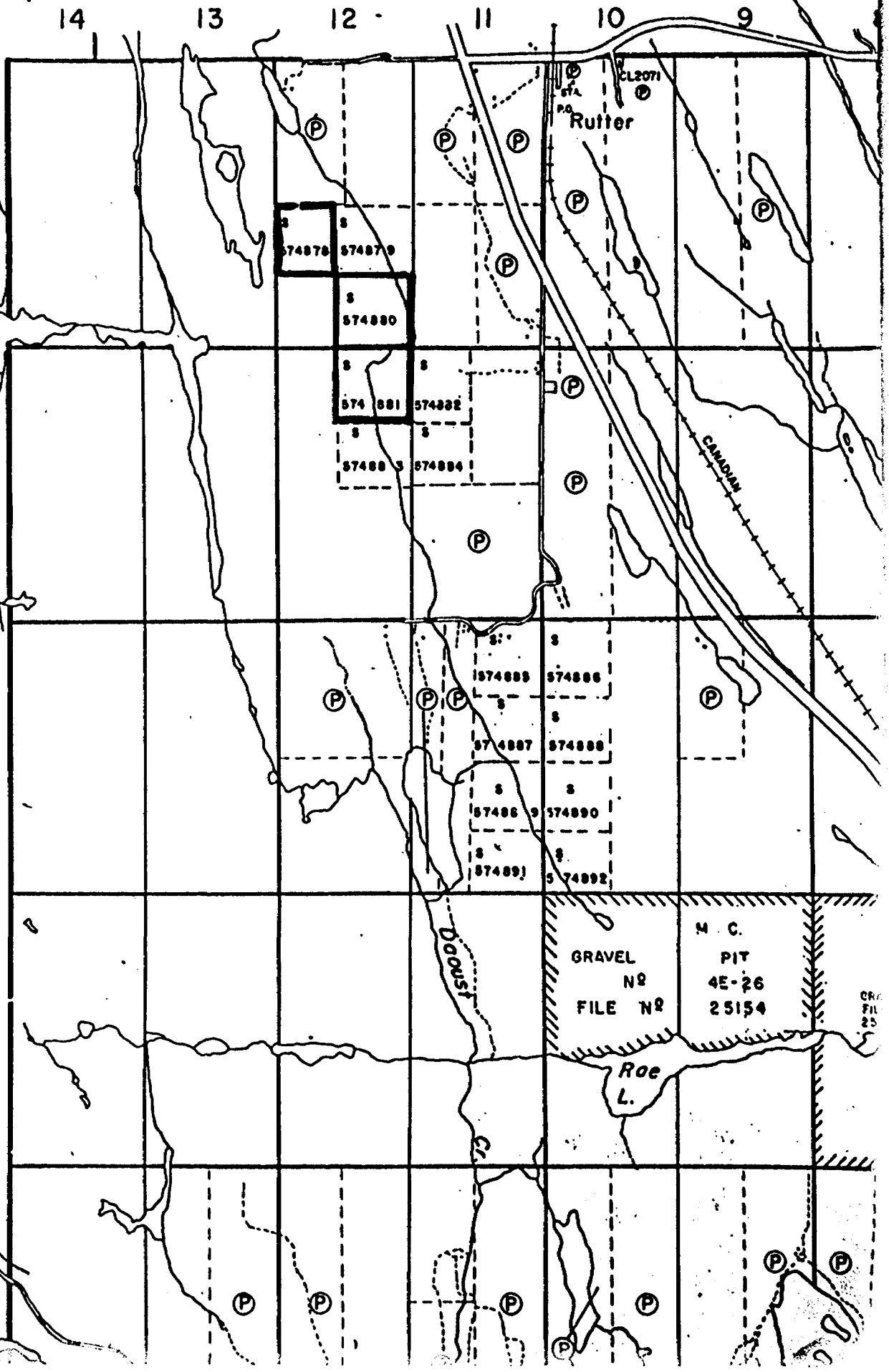

CR.
FILE
25