



41102SW0008 2.15827 STRUTHERS

010

# BLACK CRYSTAL Detail of Work Performed Mining Claims

Township of Struthers-District of Sudbury

RECEIVED  
JUN 22 1993  
TOWNSHIP OF STRUTHERS

## DETAIL OF WEEKLY WORK

### George Lahaie

June 7th/93 to June 11th/93	-	40 HRS at \$10.00 HR	=	\$400.00
June 14th/93 to June 18th/93	-	40 HRS at \$10.00 HR	=	\$400.00
June 21th/93 to June 25th/93	-	40 HRS at \$10.00 HR	=	\$400.00
July 5th/93 to July 9th/93	-	40 HRS at \$10.00 HR	=	\$400.00
July 12th/93 to July 16th/93	-	40 HRS at \$10.00 HR	=	\$400.00
July 19th/93 to July 22nd/93	-	32 HRS at \$10.00 HR	=	<u>\$320.00</u>
				\$2320.00

### Jacques Dionne

June 7th/93 to June 11th/93	-	40 HRS at \$10.00 HR	=	\$400.00
June 14th/93 to June 18th/93	-	40 HRS at \$10.00 HR	=	\$400.00
June 21th/93 to June 25th/93	-	40 HRS at \$10.00 HR	=	\$400.00
July 5th/93 to July 9th/93	-	40 HRS at \$10.00 HR	=	\$400.00
July 12th/93 to July 16th/93	-	40 HRS at \$10.00 HR	=	\$400.00
July 19th/93 to July 22nd/93	-	32 HRS at \$10.00 HR	=	<u>\$320.00</u>
				\$2320.00

## Detail of Equipement Used

### Komatzu Dozer

June 7th/93 to June 11th/93	-	15 HRS at \$40.00 HR	=	\$600.00
June 14th/93 to June 18th/93	-	25 HRS at \$40.00 HR	=	\$1000.00
June 21th/93 to June 25th/93	-	25 HRS at \$40.00 HR	=	\$1000.00
July 5th/93 to July 9th/93	-	25 HRS at \$40.00 HR	=	\$1000.00
July 12th/93 to July 15th/93	-	10 HRS at \$40.00 HR	=	<u>\$400.00</u>
				\$4000.00

### John Deere Skidder

June 7th/93 to June 11th/93	-	20 HRS at \$25.00 HR	=	\$500.00
June 14th/93 to June 18th/93	-	10 HRS at \$25.00 HR	=	\$250.00
June 21st/93 to June 25th/93	-	10 HRS at \$25.00 HR	=	<u>\$250.00</u>
				\$1000.00

### Komatzu Escavator

June 14th/93 to June 18th/93	-	20 HRS at \$60.00 HR	=	\$1200.00
June 21th/93 to June 25th/93	-	20 HRS at \$60.00 HR	=	\$1200.00
July 5th/93 to July 9th/93	-	15 HRS at \$60.00 HR	=	\$900.00
July 9th/93 to July 13th/93	-	15 HRS at \$60.00 HR	=	<u>\$900.00</u>
				\$4200.00

Black Crystal

Mine  
Box 37  
Alban, Ont.  
P.O. M 1A0

1993 Report

Re: Section 10 of Mining Act  
Regulations

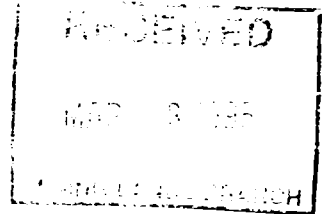

(i) the two sections indicated on map  
has an outcrop Elevation of approx 40 ft to 75 ft

(iv) find enclosed copy of dates equipment  
& hourly rates

(v) in 1993 we checked with Mr. Ray Dexamme  
who said that line recutting was not to take place  
for a minimum of 5 yrs from date of registered  
claims.

(b) find enclosed detailed map 1:5000

(i) in 1993 surface stripping was limited to the two  
areas shown on map

(ii) the two areas used for surface samples  
in 1993 consisted of stripping each area  
approx 50' x 50'

(iv) Graphic bar scale included top right corner  
of map

(3) line survey & mapping: by Mr. Doug Magee O.L.S.  
pany Sourd. PH. 746-2523

J. Polansky

Black Crystal  
Mine  
Box 37  
Aibon, Ont. P0M1A0

Brief report of Work-yr. 1993 only

After selecting these two areas we used equipment to clear access and strip surface of both areas approx 50'x50'

Drilling for dimensional stone samples lasted until we accumulated approximately 5 samples of approx 1 cubic meter

Which were processed by Kouri Granite  
Sudbury.

J. L. Lait

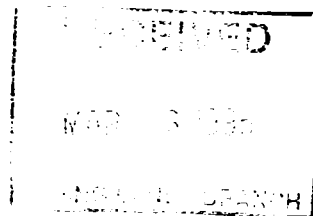

Mr. Steven B. Beneteau  
Kind enclosed copy of ASTM TEST  
dated Feb 6/95

Test results were well above ASTM Standards

Feb 23/95 I had a telephone conversation with  
Mr. Greg Hunt one of the engineers  
that performed ASTM test and he informed  
me that this type of rock would be  
ideal for trap rock and he was sure it  
would pass H-L-1. tests.

I checked with MTO Engineering Division,  
North-Bay + Toronto and they said there is  
a demand for this high quality rock.

by processing 100% of Material  
I'm sure it would make this  
venture (feasible) + (economical)

Thank You  
George

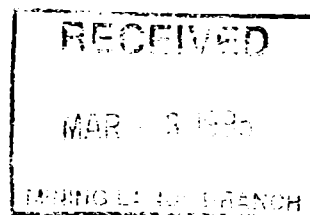



Sudbury Branch

Trow Consulting Engineers Ltd.  
1074 Webbwood Drive  
Sudbury, Ontario P3C 3B7  
Telephone: (705) 874-9681  
Facsimile: (705) 874-8271

SOO640R

February 6, 1995

Black Crystal Mine  
P.O. Box 37, R.R. #2  
Alban, Ontario  
POM 1A0

ATTENTION: Mr. George Lehaie

Dear Sirs:

### BUILDING STONE TEST

Below are the results for the test requested performed on the rock samples submitted to our office. These tests were undertaken according to ASTM standards as outlined in Volume 4.08.

The rock has been tentatively identified as a medium grained anorthosite. Anorthosite falls within the Granite Group according to the ASTM standard rock classification.

It should be noted that polished surfaces of the specimens indicate .25 to .50 percent sulphide mineralization. The mineralization occurs as anhedral to subhedral crystals less than 1 mm in size. This mineralization is of concern, as there may be a potential for oxidation of some or all of this mineralization. Additionally, found locally are discontinuous fractures with no apparent orientation. The fractures observed have a maximum length of 3 cm and an aperture of less than 1 mm. The fractures described have no apparent effect on the overall viability of the stone, as testing was well above ASTM minimum values. Test results are shown on the enclosed table.

Should there be any questions regarding these results, please do not hesitate to contact our office.

Yours truly,  
**TROW CONSULTING ENGINEERS LTD.**

  
Peter Karelse, AScT., C.E.T.  
Sr. Engineering Geologist

PK:gmv39  
Encl.

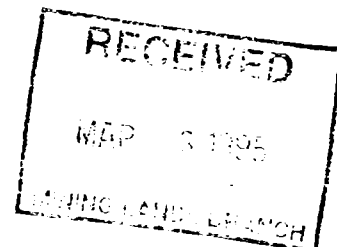



**Consulting  
Engineers**

**Trow Consulting Engineers Ltd.**  
1074 Webbwood Drive, Sudbury  
Ontario, Canada, P3C 3B7  
Telephone: (705) 674-9681  
Facsimile: (705) 674-8271

Black Crystal Mine  
P.O. Box 37, R.R. #2  
ALBAN, Ontario  
POM 1A0  
*PH. 1705-857-3211*

*Testing was well above ASTM minimum values*

S00640R TEST RESULTS		
Test Performed	Results	ASTM Standard
compressive strength	161.48 MPa	131 MPa
Absorption of Weight Maximum %	.09	.4
Density	3263	2560
Modulus of Rupture	17.66	10.34

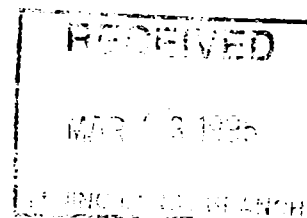

■ EXPLORATION SITES  
 ▲ STORAGE SHED  
 --- ACCESS ROAD

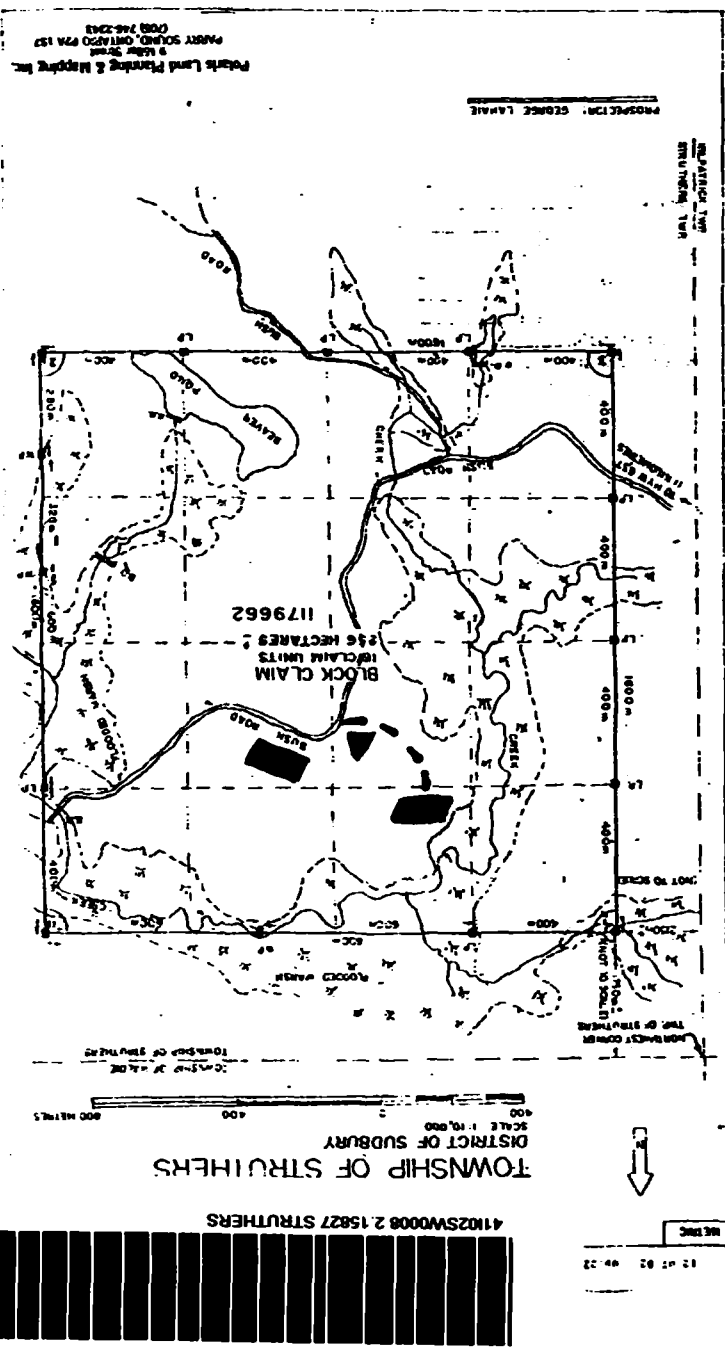

2.15822

RECEIVED  
 JAN 31 1995  
 MINING LANDS BRANCH

020



GEORGE LAHAIE ( BLACK CRYSTAL MINE )

DETAILS OF WORK PERFORMED & EXPENSES

DECEMBER 7TH, 1992 TO DECEMBER 31ST, 1993.

MAN HOURS

George Lahaié - 232 hours at \$ 10.00 \$ 2,320.00  
Jacques Dionne - 232 hours at \$ 10.00 2,320.00  
\$ 4,640.00

HEAVY EQUIPMENT ALLOCATION

One Komatsu Dozer - 100 hrs at \$ 40.00 \$ 4,000.00  
One J.D. Skidder - 40 hrs at \$ 25.00 1,000.00  
One Excavator - 70 hrs at \$ 60.00 4,200.00  
One Compressor - Rental 800.00  
\$10,000.00

CONSULTANT & CONTRACTOR FEES

Polaris Land Planning - Mapping - *cut here* \$ 2,000.00  
George Ittsopoulos - Consultant *occupy* 2,400.00  
\$ 4,400.00

SUPPLIES & RENTAL

Fuel, gas & Oil \$ 1,799.63  
Explosives 1,119.87  
Plunger & Bits - Rental 400.20  
\$ 3,319.70

\$23,359.70



SKETCH OF  
BLOCK MINING CLAIM  
TOWNSHIP OF STRUTHERS  
DISTRICT OF SUDBURY  
SCALE 1:5,000



Licence Endorsed X  
 Plotted on map dy  
 Reservations Done dy  
 Typed by DMJ  
 Sketches prepared DMJ  
 Verified to Topo No. DMJ  
 Claim Card Updated or Issued DMJ  
 Checked and Filed by \_\_\_\_\_  
 PLEASE INITIAL ALL STEPS...

WALLEN TWP  
STRUTHERS TWP  
MADAWASKAN  
STRUTHERS TWP

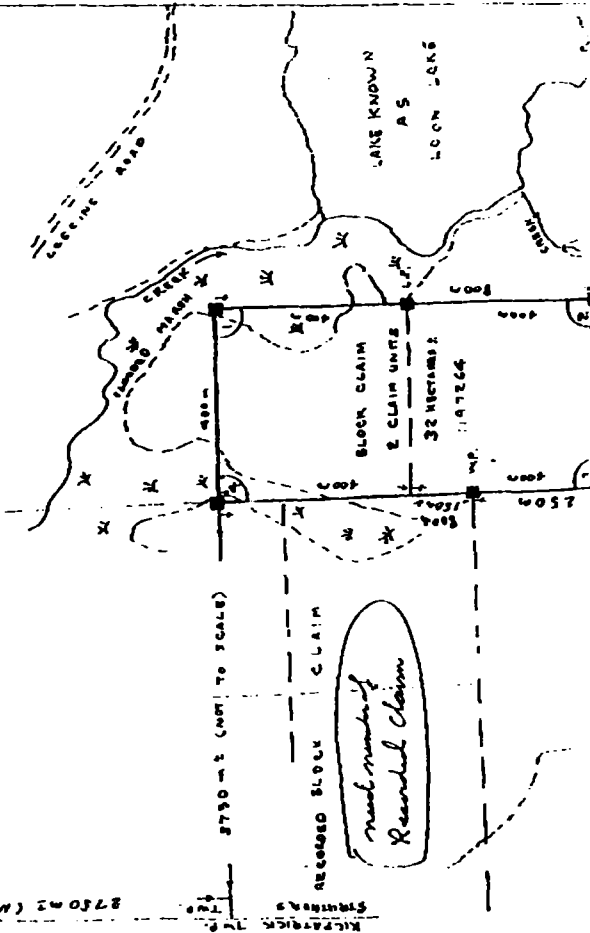

Northern Development  
and Mines

Application to Record  
Staked Mining Claim(s)  
Mining Act

Personal information collected on this form is obtained under the authority of the Mining Act. This information will be used to maintain a record and will be used for serving notices. Querrelants about this collector should be directed to the Provincial Manager, Mining Lands, Ministry of Northern Development and Mines, 1400 King Street West, Sudbury, Ontario, P3E 6A8, telephone (705) 670-7964.

Please Print Using Ink or Type

Name of Applicant

George F. Struthers  
Address: Street, City/Town/Village, Province, Postal Code

Box 37, RR 1, Alton ONT, P6A 1H0

Name and Address for Service in Ontario (Required if Applicant Resides Outside of Ontario)

Name of Recorded Holder

George F. Struthers

Address: Street, City/Town/Village, Province, Postal Code

215-867-2231

Telephone No.

215-867-2231

Claim No.

705-857-2071

Name and Address for Service in Ontario (Required if Recorded Holder Resides Outside of Ontario)

Mining Division

Sudbury

Township(s) or Area(s) (Show Plan No.)

Struthers Twp

Claim Number, 10 No. of Lots, Description of Staking in Subdivided Township (Lot No., Concession No., Section of Lot)

1/19/93 2 UNSUBDIVIDED

Staking Date

1 March 1993

Time

10:30

Office Use

Use

Completed

Completed

Completed

Completed

Completed

Completed

Completed

Completed

Completed

Completed

Completed

Completed

Completed

Completed

Completed

Completed

Completed

Completed

Completed

Completed

Completed

RECORDED  
MAR 15 1993  
Receipt 1537

Office Use Only:

1/27/1993

RECEIVED  
MAR 15 1993  
M.A. STRUTHERS  
1400 KING ST. W.  
SUDBURY ONT. P3E 6A8

Application No.

11371

Licence No.

C 37393

Telephone No.

705-857-2071

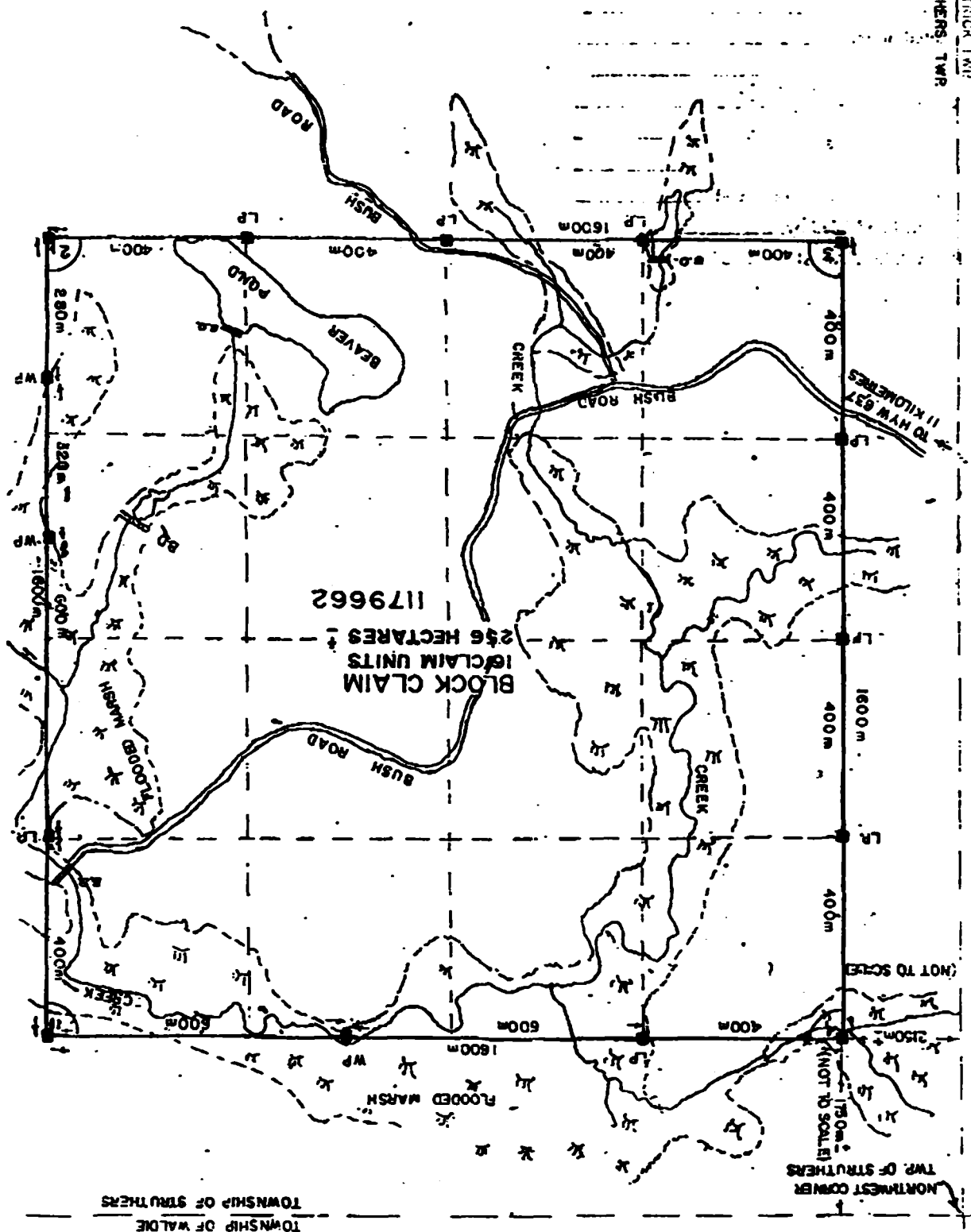

SKETCH OF  
 BLOCK MINING CLAIM  
 TOWNSHIP OF STRUTHERS  
 DISTRICT OF SUBURY  
 SCALE 1:10,000  
 400 0 400 800 METRES  
 TOWNSHIP OF WALDIE  
 TOWNSHIP OF STRUTHERS  
 NORTHWEST CORNER TWP. OF STRUTHERS  
 (NOT TO SCALE)  
 (NOT TO SCALE)

Report of Work Conducted After Recording Claim

W 9470-00226  
Transaction Number  
R9270-00402

Mining Act

Personal information collected on this form is obtained under the authority of the this collection should be directed to the Provincial Manager, Mining Lands, M1 Sudbury, Ontario, P3E 6A5, telephone (705) 670-7284.



900

- Instructions:
- Please type or print and submit in duplicate.
  - Refer to the Mining Act and Regulations for requirements of filing assessment work or consult the Mining Recorder.
  - A separate copy of this form must be completed for each Work Group.
  - Technical reports and maps must accompany this form in duplicate.
  - A sketch, showing the claims the work is assigned to, must accompany this form.

Recorded Holder(s) <b>GEORGE LAHAIE ( BLACK CRYSTAL MINE )</b>		Claim No. <b>CLN # 223799</b>
Address <b>R. R. # 2, Box 37, ALBAN, ONTARIO. P0M 1A0</b>		Telephone No. <b>705 - 857 - 3211</b>
Mining Division <b>DISTRICT OF SUDBURY</b>	Township/Area <b>STRUTHERS</b>	M or G Plan No. <b>6. 7107 1279662-1197204</b>
Dates Work Performed From: <b>DECEMBER 7TH, 1992</b>		To: <b>DECEMBER 31ST, 1993.</b>

Work Performed (Check One Work Group Only)

Work Group	Type
Geotechnical Survey	
Physical Work, including Drilling	<b>SURVEY LINES, CLEARING, EXCAVATING &amp; drilling</b>
Rehabilitation	
Other Authorized Work	<b>BLASTING</b>
Assays	
Assignment from Reserve	

RECEIVED  
JAN 31 1993  
MINING LANDS BRANCH

Total Assessment Work Claimed on the Attached Statement of Costs \$ ~~23,359.70~~ **23,360**

Note: The Minister may reject for assessment work credit all or part of the assessment work submitted if the recorded holder cannot verify expenditures claimed in the statement of costs within 30 days of a request for verification.

Persons and Survey Company Who Performed the Work (Give Name and Address of Author of Report)

Name	Address
<b>GEORGE LAHAIE</b>	<b>R. R. # 2, BOX 37, ALBAN, ONTARIO P0M 1A0</b>
<b>POLARIS LAND PLANNING</b>	<b>9 MILLER STREET, PARRY SOUND, ONTARIO.</b>
<b>JACQUES DIONNE</b>	<b>R. R. # 1, ALBAN, ONTARIO. P0M 1A0</b>
<b>LAHAIE LUMBER LTD</b>	<b>P.O. BOX 38, ALBAN, ONTARIO P0M 1A0</b>

(attach a schedule if necessary)

Certification of Beneficial Interest \* See Note No. 1 on reverse side

I certify that at the time the work was performed, the claims covered in this work report were recorded in the current holder's name or held under a beneficial interest by the current recorded holder.	Date <b>Dec. 4, 1994</b>	Recorded Holder or Agent (Signature) <i>George Lahaie</i>
--	-----------------------------	--

Certification of Work Report

I certify that I have a personal knowledge of the facts set forth in this Work report, having performed the work or witnessed same during and/or after its completion and annexed report is true.		
Name and Address of Person Certifying <b>GEORGE LAHAIE - R. R. # 2, ALBAN, ONTARIO. P0M 1A0</b>		
Telephone No. <b>705 - 857 - 3211</b>	Date <b>DECEMBER 4TH, 1994</b>	Certified by (Signature) <i>George Lahaie</i>

For Office Use Only

Total Value Cr. Recorded <b>\$ 23,360.00</b>	Date Recorded <b>Dec. 5/94</b>	Mining Recorder <i>K. Giroux</i>	<table border="1"> <tr> <td colspan="2">SUDBURY MINING DIV. <b>RECEIVED</b> <b>DEC 5 - 1994</b> A.M. 12:12:31 P.M. 12:51:16</td> </tr> </table>	SUDBURY MINING DIV. <b>RECEIVED</b> <b>DEC 5 - 1994</b> A.M. 12:12:31 P.M. 12:51:16	
	SUDBURY MINING DIV. <b>RECEIVED</b> <b>DEC 5 - 1994</b> A.M. 12:12:31 P.M. 12:51:16				
Deemed Approval Date <b>MARCH 28, 1995</b>	Date Approved				

# Report of Work Conducted After Recording Claim

Mining Act

Transaction Number  
**R9270-00402**  
~~R9370-00033~~

**2.15827**

Personal information collected on this form is obtained under the authority of the Mining Act. This information will be used for correspondence. Questions about this collection should be directed to the Provincial Manager, Mining Lands, Ministry of Northern Development and Mines, Fourth Floor, 150 Cedar Street, Sudbury, Ontario, P3E 6A5, telephone (705) 670-7284.

- Instructions:
- Please type or print and submit in duplicate.
  - Refer to the Mining Act and Regulations for requirements of filing assessment work or consult the Mining Recorder.
  - A separate copy of this form must be completed for each Work Group.
  - Technical reports and maps must accompany this form in duplicate.
  - A sketch, showing the claims the work is assigned to, must accompany this form.

Recorded Holder(s) <b>GEORGE LAHAIE ( BLACK CRYSTAL MINE )</b>		LIC # <b>C37393</b> Client No. CLN # <b>223799</b>
Address <b>R. R. # 2, Box 37, ALBAN, ONTARIO. POM 1A0</b>		Telephone No. <b>705 - 857 - 3211</b>
Mining Division <b>DISTRICT OF SUDBURY</b>	Township/Area <b>STRUTHERS</b>	M or B Plan No. <b>G. 7107</b> <del>1179662 - 1197264</del>
Date Work Performed From: <b>DECEMBER 7TH, 1992</b>		To: <b>DECEMBER 31ST, 1993.</b>

Work Performed (Check One Work Group Only)

Work Group	Type
Geotechnical Survey	
Physical Work, including Drilling	<b>SURVEY LINES, CLEARING, EXCAVATING &amp; drilling</b>
Rehabilitation	
Other Authorized Work	<b>BLASTING</b>
Assays	
Assignment from Reserve	

**RECEIVED**  
**JAN 31 1993**  
MINING DIVISION

Total Assessment Work Claimed on the Attached Statement of Costs \$ ~~22,359.70~~ **23,360**

Note: The Minister may reject for assessment work credit all or part of the assessment work submitted if the recorded holder cannot verify expenditures claimed in the statement of costs within 30 days of a request for verification.

Persons and Survey Company Who Performed the Work (Give Name and Address of Author of Report)

Name	Address
<b>GEORGE LAHAIE</b>	<b>R. R. # 2, BOX 37, ALBAN, ONTARIO POM 1A0</b>
<b>POLARIS LAND PLANNING</b>	<b>9 MILLER STREET, PARRY SOUND, ONTARIO.</b>
<b>JACQUES DIONNE</b>	<b>R. R. # 1, ALBAN, ONTARIO. POM 1A0</b>
<b>LAHAIE LUMBER LTD</b>	<b>P.O. BOX 38, ALBAN, ONTARIO POM 1A0</b>

(attach a schedule if necessary)

Certification of Beneficial Interest \* See Note No. 1 on reverse side

I certify that at the time the work was performed, the claims covered in this work report were recorded in the current holder's name or held under a beneficial interest by the current recorded holder.	Date <b>Dec. 4, 1994</b>	Recorded Holder or Agent (Signature) <b>X</b>
--	-----------------------------	--

Certification of Work Report

I certify that I have a personal knowledge of the facts set forth in this Work report, having performed the work or witnessed same during and/or after its completion and annexed report is true.		
Name and Address of Person Certifying <b>GEORGE LAHAIE - R. R. # 2, ALBAN, ONTARIO. POM 1A0</b>		
Telephone No. <b>705 - 857 - 3211</b>	Date <b>DECEMBER 4TH, 1994</b>	Certifying (Signature) <i>George Lahaie</i>

For Office Use Only

Total Value Cr. Recorded	Date Recorded	Mining Recorder	Received Stamp
	Deemed Approval Date <b>MARCH 5, 1995</b>	Date Approved	<b>SUDBURY. MINING DIV. RECEIVED. DEC 5 - 1994</b>
	Date Notice for Amendments Sent		A.M. 11:05 AM P.M.



**Statement of Costs for Assessment Credit**

**État des coûts aux fins du crédit d'évaluation**

**Mining Act/Loi sur les mines**

W. 9470-00226  
 Transaction No./N° de transaction  
 R9270-00402

~~R9370-00033~~

**2.15827**

Personal information collected on this form is obtained under the authority of the Mining Act. This information will be used to maintain a record and ongoing status of the mining claim(s). Questions about this collection should be directed to the Provincial Manager, Minings Lands, Ministry of Northern Development and Mines, 4th Floor, 150 Cedar Street, Sudbury, Ontario P3E 6A5, telephone (705) 670-7284.

Les renseignements personnels contenus dans la présente formule sont recueillis en vertu de la Loi sur les mines et serviront à tenir à jour un registre des concessions minières. Adressez toute question sur la collecte de ces renseignements au chef provincial des terrains miniers, ministère du Développement du Nord et des Mines, 150, rue Cedar, 4<sup>e</sup> étage, Sudbury (Ontario) P3E 6A5, téléphone (705) 670-7284.

**1. Direct Costs/Coûts directs**

Type	Description	Amount Montant	Totals Total global
Wages Salaires	Labour Main-d'oeuvre	4,640.	
	Field Supervision Supervision sur le terrain		4,640.
Contractor's and Consultant's Fees Droits de l'entrepreneur et de l'expert-conseil	Type MAPPING	2,000.	
	CONSULTANT	2,400.	
			4,400
Supplies Used Fournitures utilisées	Type Fuel, Gas	1,800.	
	EXPLOSIVES	1,120.	
	RENTAL	400.	
			3,320.
Equipment Rental Location de matériel	Type		
<b>Total Direct Costs Total des coûts directs</b>			<b>23,360</b>

**2. Indirect Costs/Coûts indirects**

\*\* Note: When claiming Rehabilitation work indirect costs are not allowable as assessment work. Pour le remboursement des travaux de réhabilitation, les coûts indirects ne sont pas admissibles en tant que travaux d'évaluation.

Type	Description	Amount Montant	Totals Total global
Transportation Transport	Type		
Food and Lodging Nourriture et hébergement			
Mobilization and Demobilization Mobilisation et démobiliation			
<b>Sub Total of Indirect Costs Total partiel des coûts indirects</b>			
Amount Allowable (not greater than 20% of Direct Costs) Montant admissible (n'excédant pas 20 % des coûts directs)			
Total Value of Assessment Credit (Total of Direct and Allowable Indirect costs) Valeur totale du crédit d'évaluation (Total des coûts directs et indirects admissibles)			

RECEIVED  
 JAN 3 1994  
 MINING DIVISION

Note: The recorded holder will be required to verify expenditures claimed in this statement of costs within 30 days of a request for verification. If verification is not made, the Minister may reject for assessment work all or part of the assessment work submitted.

Note : Le titulaire enregistré sera tenu de vérifier les dépenses demandées dans le présent état des coûts dans les 30 jours suivant une demande à cet effet. Si la vérification n'est pas effectuée, le ministre peut rejeter tout ou une partie des travaux d'évaluation présentés.

**Filing Discounts**

- Work filed within two years of completion is claimed at 100% of the above Total Value of Assessment Credit.
- Work filed three, four or five years after completion is claimed at 50% of the above Total Value of Assessment Credit. See calculations below:

Total Value of Assessment Credit	Total Assessment Claimed
x 0.50 =	

**Remises pour dépôt**

- Les travaux déposés dans les deux ans suivant leur achèvement sont remboursés à 100 % de la valeur totale susmentionnée du crédit d'évaluation.
- Les travaux déposés trois, quatre ou cinq ans après leur achèvement sont remboursés à 50 % de la valeur totale du crédit d'évaluation susmentionné. Voir les calculs ci-dessous.

Valeur totale du crédit d'évaluation	Evaluation totale demandée
x 0,50 =	

**Certification Verifying Statement of Costs**

I hereby certify that the amounts shown are as accurate as possible and these costs were incurred while conducting assessment work on the lands shown on the accompanying Report of Work form.

that as RECORDED HOLDER (Recorded Holder, Agent, Position in Company) I am authorized

to make this certification

**Attestation de l'état des coûts**

J'atteste par la présente que les montants indiqués sont le plus exact possible et que ces dépenses ont été engagées pour effectuer les travaux d'évaluation sur les terrains indiqués dans la formule de rapport de travail ci-joint.

Et qu'à titre de \_\_\_\_\_ je suis autorisé (titulaire enregistré, représentant, poste occupé dans la compagnie)

à faire cette attestation.

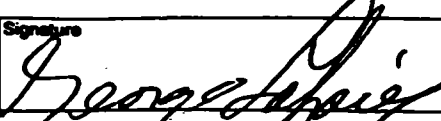
Signature 	Date DEC. 4TH, 1994
---	------------------------

Ministry of  
Northern Development  
and Mines

Ministère du  
Développement du Nord  
et des Mines

Geoscience Approvals Office  
933 Ramsey Lake Road  
6th Floor  
Sudbury, Ontario  
P3E 6B5

Telephone: (705) 670-5853  
Fax: (705) 670-5863

Our File: 2.15827  
Transaction #: W9470.00226

March 14, 1995

Mining Recorder  
Ministry of Northern Development & Mines  
933 Ramsey Lake Road, 6th floor  
Sudbury, Ontario  
P3E 6B5

Dear Mr. Denomme:

Subject: APPROVAL OF ASSESSMENT WORK CREDITS ON MINING CLAIM  
1179662 IN STRUTHERS TOWNSHIP

All deficiencies associated with this report of work have been correctd. Accordingly, assessment work credits have been approved as outlined on the attached report of work form. The credits have been approved under Section 10 (Physical) and Section 17 (Assays) of the Mining Act Regulations.

The approval date is March 14, 1995.

If you have any questions regarding this correspondence, please contact Steven Beneteau at (705) 670-5858.

ORIGINAL SIGNED BY:



Ron C. Gashinski  
Senior Manager, Mining Lands Section  
Mining and Land Management Branch  
Mines and Minerals Division

SBB  
SBB/jl  
Enclosure:

cc: Resident Geologist  
Sudbury, Ontario

✓ Assessment Files Library  
Sudbury, Ontario

**REPORT OF WORK FORM**

Please note, the assessment credits have been distributed to reflect the value of work performed on each claim.

**MARCH 14, 1995**  
**FILE 2.15827**  
**TRANSACTION No: W9470.00226**

<b>CLAIM</b>	<b>VALUE OF ASSESSMENT WORK DONE ON THIS CLAIM</b>
1179662	\$23,360.00
1197264	\$ 0.00
	-----
<b>TOTAL</b>	<b>\$23,360.00</b>



IN SERVICE FEBRUARY 27, 1980

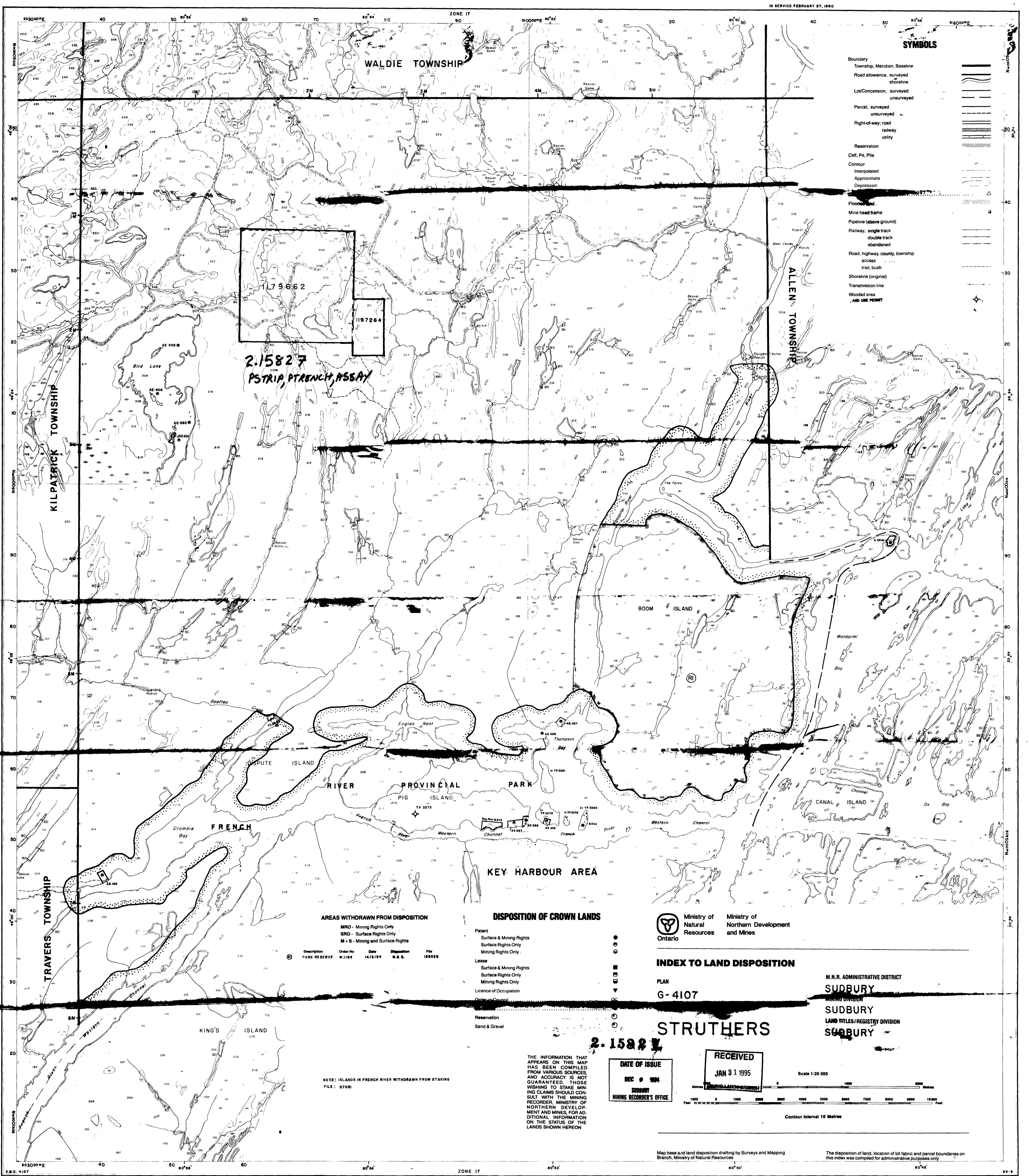

SYMBOLS

- Boundary Township, Meridian, Baseline
- Road allowance, surveyed
- shoreline
- Lot/Concession, surveyed
- unsurveyed
- Parcel, surveyed
- unsurveyed
- Right-of-way, road
- railway
- utility
- Reservation
- Cliff, Pt. Pile
- Contour
- Interpolated
- Approximate
- Depression
- Flooded land
- Mine head frame
- Pipeline (above ground)
- Railway, single track
- double track
- abandoned
- Road, highway county, township
- access
- trail, bush
- Shoreline (original)
- Transmission line
- Wooded area
- AND USE PERMIT

AREAS WITHDRAWN FROM DISPOSITION

- MRO - Mining Rights Only
- SRO - Surface Rights Only
- M + S - Mining and Surface Rights

Description	Order No.	Date	Disposition	File
PARK RESERVE	W.1184	14/3/84	M.R.S.	188038

DISPOSITION OF CROWN LANDS

- Patent
- Surface & Mining Rights
- Surface Rights Only
- Mining Rights Only
- Lease
- Surface & Mining Rights
- Surface Rights Only
- Mining Rights Only
- Licence of Occupation
- Order in Council
- Reservation
- Sand & Gravel

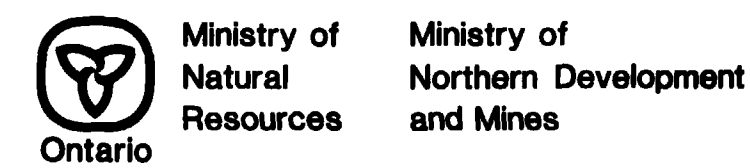

INDEX TO LAND DISPOSITION

PLAN G-4107

M.N.R. ADMINISTRATIVE DISTRICT  
**SUDBURY**  
 Mining Division  
**SUDBURY**  
 LAND TITLES/REGISTRY DIVISION  
**SUDBURY**

STRUTHERS

2.15827

DATE OF ISSUE  
 DEC 9 1984  
 SUDBURY  
 MINING RECORDER'S OFFICE

RECEIVED  
 JAN 31 1995

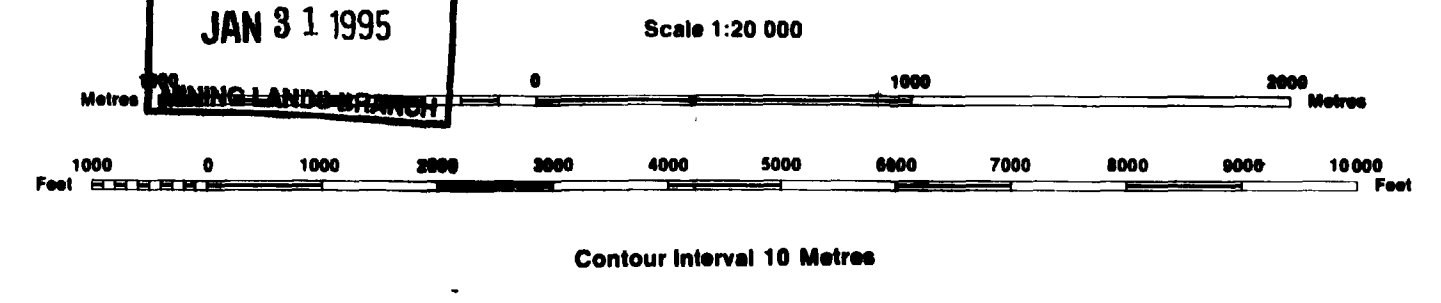

NOTE: ISLANDS IN FRENCH RIVER WITHDRAWN FROM STAKING  
 FILE: 67081

THE INFORMATION THAT APPEARS ON THIS MAP HAS BEEN COMPILED FROM VARIOUS SOURCES AND ACCURACY IS NOT GUARANTEED. THOSE WISHING TO STAKE MINING CLAIMS SHOULD CONSULT WITH THE MINING RECORDER, MINISTRY OF NORTHERN DEVELOPMENT AND MINES, FOR ADDITIONAL INFORMATION ON THE STATUS OF THE LANDS SHOWN HEREON

Map base and land disposition drafting by Surveys and Mapping Branch, Ministry of Natural Resources

The disposition of land, location of lot fabric and parcel boundaries on the index was compiled for administrative purposes only



METRIC

# SKETCH OF BLOCK MINING CLAIM TOWNSHIP OF STRUTHERS DISTRICT OF SUDBURY

MAGNETIC VARIATION USED 8°45' WEST

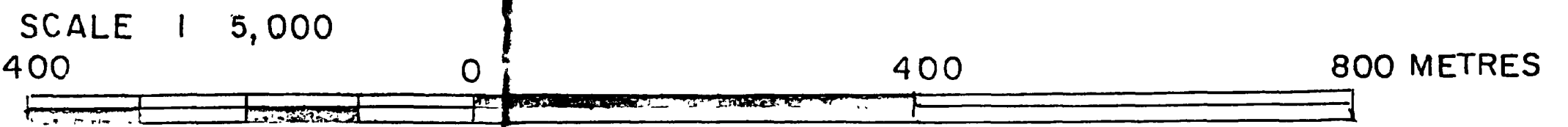

TOWNSHIP OF WALDIE  
TOWNSHIP OF STRUTHERS

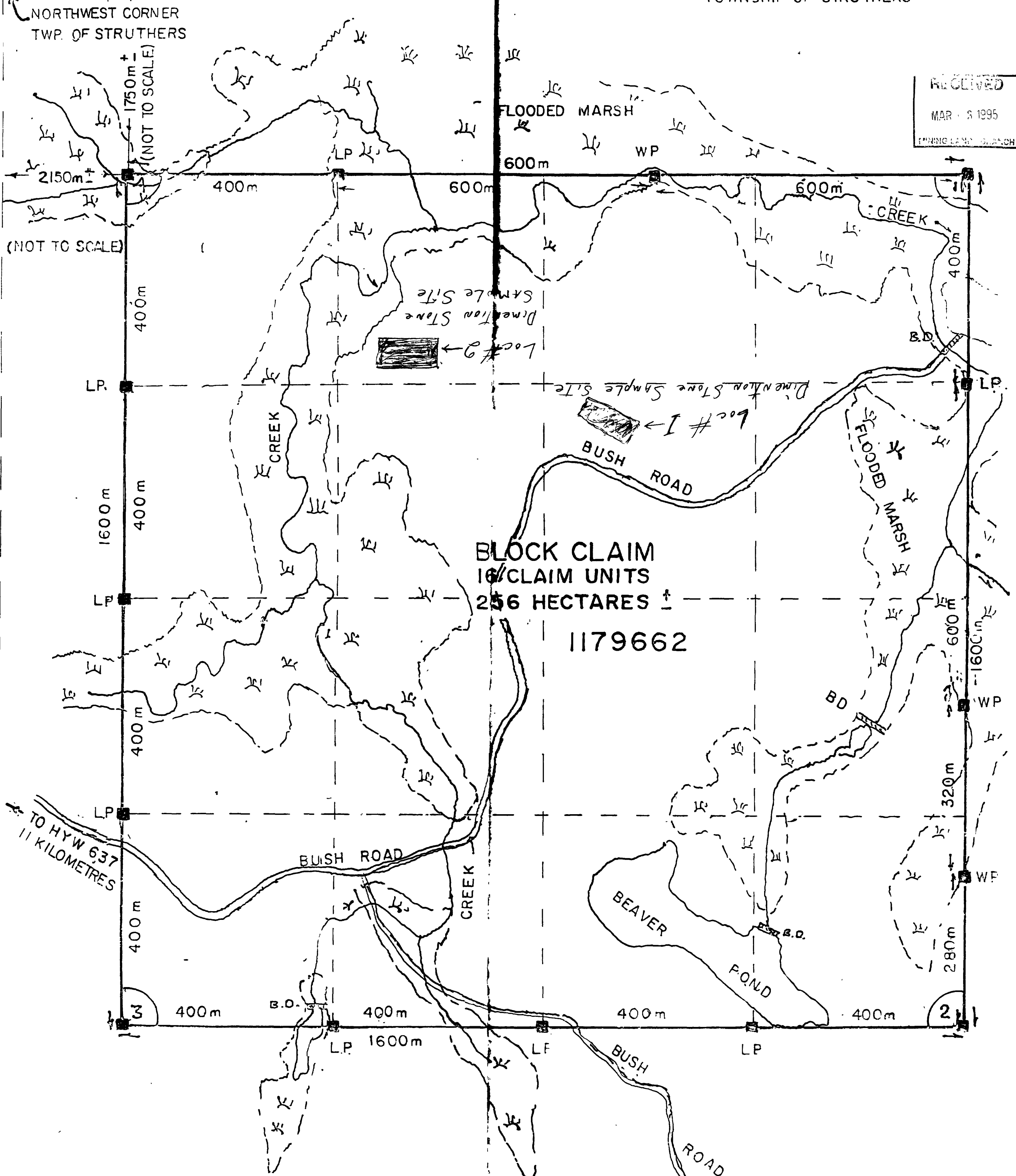

RECEIVED  
MAR 8 1995  
MINING LAND SURVEY

NORTHWEST CORNER  
TWP. OF STRUTHERS  
1750m ±  
(NOT TO SCALE)  
2150m ±  
(NOT TO SCALE)

TO HYW 637  
11 KILOMETRES

KILPATRICK TWP.  
STRUTHERS TWP.

PROSPECTOR: GEORGE LAHAIE

Polaris Land Planning & Mapping Inc.  
9 Miller Street  
PARRY SOUND, ONTARIO P2A 1S7  
(705) 746-2243

