



Handwritten: H.A. 1993

LOCATION

The Casson Lake claim group is located about 65 km west of the city of Sudbury, Ontario (Figure 1 and 2). The property was staked to cover a section of an easterly-trending Nipissing Diabase sill-like metagabbro body about 250 m wide which hosts or is associated with copper, nickel and platinum group elements mineralization within the sill itself or gold mineralization within the Huronian sediments near the dike contacts.

The claim group extends roughly 6 kilometers west from the eastern boundary of Curtin Township near the center of the township (Claim Map, back pocket). It lies in the Sudbury Mining Division, in the District of Sudbury. At least three small lakes, including Casson Lake in the eastern part, lie within the claim group. A few trails occur on the property, one of which leads to the past-producing Bousquet gold mine. The claims are shown on claim map sheet G-3005 (back pocket) and NTS map sheet 41 I/4. The center of the claim group is located at 81° 36' longitude West and 46° 9' latitude North.

ACCESS

The property can be reached from the town of Espanola by travelling 16 km south on Highway 6 to an all-season road (locally known as the Knights of Columbus Road) that runs due east. In the spring, a boat would be used to go from Charlton Lake, through Howry Creek then to a small unnamed lake just south of the claim group. From there, an all-terrain vehicle trail crosses the entire property. During the drier months, Howry Creek is not accessible and thus access would be obtained by boat to Miller Bay on Charlton Lake, then using all terrain vehicles on the trail across the property.

OWNERSHIP OF THE CLAIMS

The fifteen claims are numbered as follows: S895241 to S895243 inclusive, S984683 to SS984689 inclusive, S993985, S994573, S1136064, S1179657 (4 units) and S1179658 (14 units). These claims are jointly held by Dan Brunne and Roger Stringer, and an agreement between the author, Mr. Brunne and Mr. Stringer was made on March 21st, 1993 which enables the author to earn an ownership interest in all the claims described in this report.

PROSPECTING TARGETS

During this phase of work on the Casson Lake Property, platinum group elements occurring within the metagabbro sill (Nipissing Diabase) will be our main prospecting target. The previous work done by the present claim holders including power stripping and sampling gave several high platinum and palladium

assays and these areas will be mapped in detail and possibly extended and sampled further. The newly staked claims at the west end of the property were held by BP Resources from 1987 to early 1993. Although the work is not on file at the assessment files at the Resident Geologist's office in Sudbury because the claims were leased, one of the co-holders of the claims, Dan Brunne, has personal knowledge that BP did airborne and ground geophysical surveys, cut a grid on the property and drilled some diamond drill holes and obtained high platinum assays (Personal Communication, Dan Brunne). It is possible that the drill core was donated to the Sudbury Drill Core Library. If so, the author will re-log the core. The areas high in platinum will be located, mapped in detail and sampled extensively.

DEPOSIT TYPE AND GEOLOGY

The deposit type on the Casson Lake Property would be copper, nickel and platinum group elements associated with a Nipissing Diabase metagabbro sill. According to G.C. Wilson, 1988: " One prospect with PGE values is located in central Curtin Township ...A steeply dipping, sill-like body of Nipissing Diabase intrudes Gowganda Formation sediments, and PGE and Au values are reported to be associated with sulphides in an area of brecciated and sheared rocks. "(O.G.S. Open File Report 5681)

PREVIOUS WORK

At least three known gold showings occur on the property: the Bousquet Mine Occurrence; the Howry Creek Mine Occurrence and the Bridger Pond Occurrence. They occur in the Huronian sediments, locally close to the Nipissing sill contact.

In 1990 and 91, power stripping and sampling were done on the present claims, south of Casson Lake, by Dan Brunne and Roger Stringer. Assays were also included with the highest results as follows: 0.051 oz/ton Au; 3400 ppb Pt; 4507 ppb Pa; 8400 ppm Cu; and 3400 ppm Ni.

In 1988, linecutting, geology and sampling with assays, and mag and VLF-EM surveys were done by Roger Stringer on 11 of the present claims centered on Casson Lake.

In 1987, a combined helicopter-borne magnetic gradiometer and VLF-EM survey was done over an area centered just north of Casson Lake. The survey was done by Aerodat Limited for Stringer Explorations Ltd.

In 1987, BP Resources acquired 100% of a group of leased claims covering the west part of the present claim group. They did airborne and ground geophysics, linecutting and diamond drilling. Although the information was not filed with the Resident Geologist, the author has been told by Dan Brunne, who worked for BP during

this time and who is one of the other co-holders of the present claim group, that some high PGE values were obtained during the drilling. The claims were abandoned in early 1993 since BP Resources closed shop.

During the 1970's, platinum, palladium and gold in association with copper and nickel sulphide mineralization were found in the Curtin Township Nipissing Diabase gabbro sill by Dr. Fred Jowsey and prospectors Stan White and Charles Myles. The discovery was drilled and some sections containing low copper and nickel with some PGEs were located.

GEOLOGY:

(CARD 1978)

Tholeiitic gabbro bodies of early middle precambrian age, collectively referred to as "Nipissing Diabase", occur throughout the eastern part of the southern province where they intrude rocks of the Huronian Supergroup. The Nipissing Diabase intrusions are similar in chemistry and mineralogy to many other suites of magnetic mafic intrusions which occur throughout the world and the geological column (Hess 1960) their initial Sr^{87}/Sr^{86} ratio of 0.706 (Fairbairn et al 1969) is consistent with derivation from an upper heterogeneous part of the mantle or from the lower crust. The norite of the Sudbury nickel irruptive, which is similar to the

Nipissing Diabase in chemistry and petrology, though not age, also has a Sr^{87}/Sr^{86} ratio of 0.706 (Gibbons et al 1972) indicating a similar source for these intrusions. Deep penetrating faults probably formed channel ways for periodic upward movement of magma. Most intrusions of Nipissing Diabase in the Sudbury area have the surface form of transgressive sill-like bodies, dikes and incomplete rings. The Nipissing Diabase has, along with the Huronian rocks, been metamorphosed under conditions corresponding to the greenschist and lower amphibolite facies of regional metamorphism. Consequently, they were implaced after initiation of early major folding, but prior to later deformation and regional metamorphism. Nipissing Diabase intrusions are cut by Sudbury breccia bodies, and are consequently older than this brecciation which is probably closer related in time and genesis to the Whitewater Group and the Sudbury Nickel Irruptive.

Locally a belt of east trending Huronian metasediments of the Cobalt and Quirke Lake groups occupy the central part of Curtain Twp. A long Nipissing Diabase sill trends easterly across the property. Northwest trending right lateral faults of horizontal movement of several hundred feet are cut by east trending Charlton Lake fault, on which movement is in the order of several thousand feet. Sulphide mineralization is common throughout the Nipissing diabase sill; notable in silica rich phases of the intrusion. Disseminated pyrrhotite and chalcopyrite are the predominant sulphide minerals.

Work Done: (see summary of daily prospecting and maps enclosed in this report)

Results and Recommendations:

Prospecting for PGE's on the "BP Area" did not produce sufficient results to warrant further work at this time, however PGE's encountered on the "Casson Lake Area" were encouraging as another PGE showing was discovered adjacent to the "Malachite Pit". This showing adds continuity to previous workings by the co-holders of the property. (See "Malachite Pit" showing and map enclosed). The area was stripped utilizing a bulldozer and a backhoe then washed down with water supplied with a Mark II Wayjax pump. Channel samples consisting of 21x50 centimetre intervals were collected for assay. Co-holder Dan Brunne made a sketch of the showing. (See Malachite Pit map.) The area in general known as the "Casson Lake Area" has provided considerable encouragement to warrant further investigation and a program which includes gold as well as PGE's is being considered.

The area known as the "Rainbow Showings" discovered during the program is very encouraging as it clearly establishes that gold was deposited after the emplacement of the Nippissing Metagabbro which was previously thought to be the source of gold throughout this region. A large area of Brecciation a short distance west of the past producing "Bousquet Mine" and extends northwest and southeast for several kilometres offers excellent potential for a similar but larger structure related gold deposit to occur. A program incorporating additional staking, extending of grid lines, magnetic survey and conventional prospecting with geological mapping is recommended for 1994 field season. Follow-up work on the "Rainbow Showing" is anticipated which would include further stripping, channel sampling and detailed geological mapping. Should the results prove to be favourable diamond drilling would follow.

NOTE: With mining exploration at its present depressed state in our province only major mining companies have sufficient resources to carry out new resource projects, they appear to favour only those projects which have drill targets already established and are quite reluctant to invest in projects which do not have this criteria. Therefore the prospector must continue to advance his/her project to the drill stage plateau before a beneficial agreement can be made.

Dan Brunne
Prospector
Whitefish Falls, Ontario

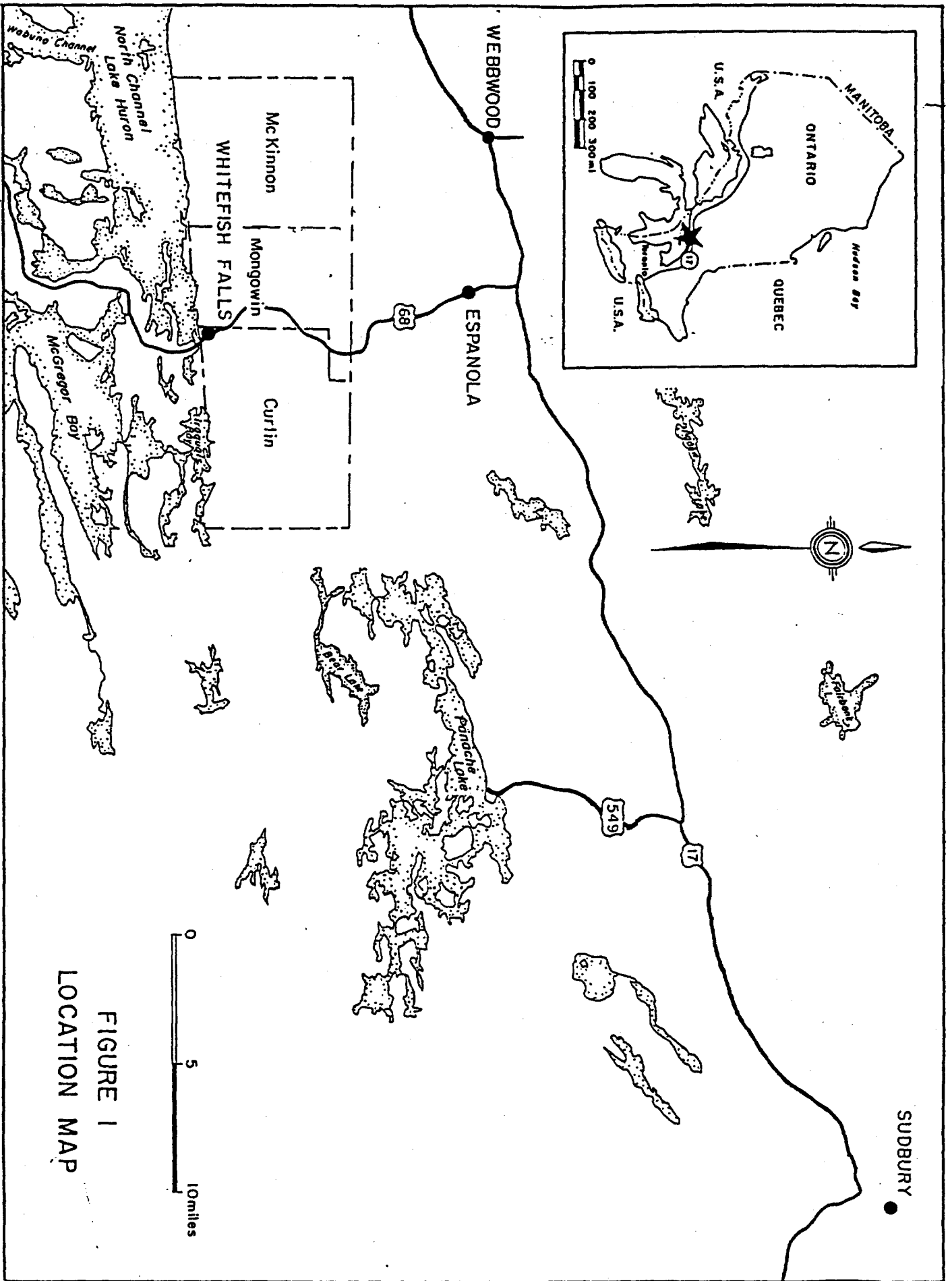
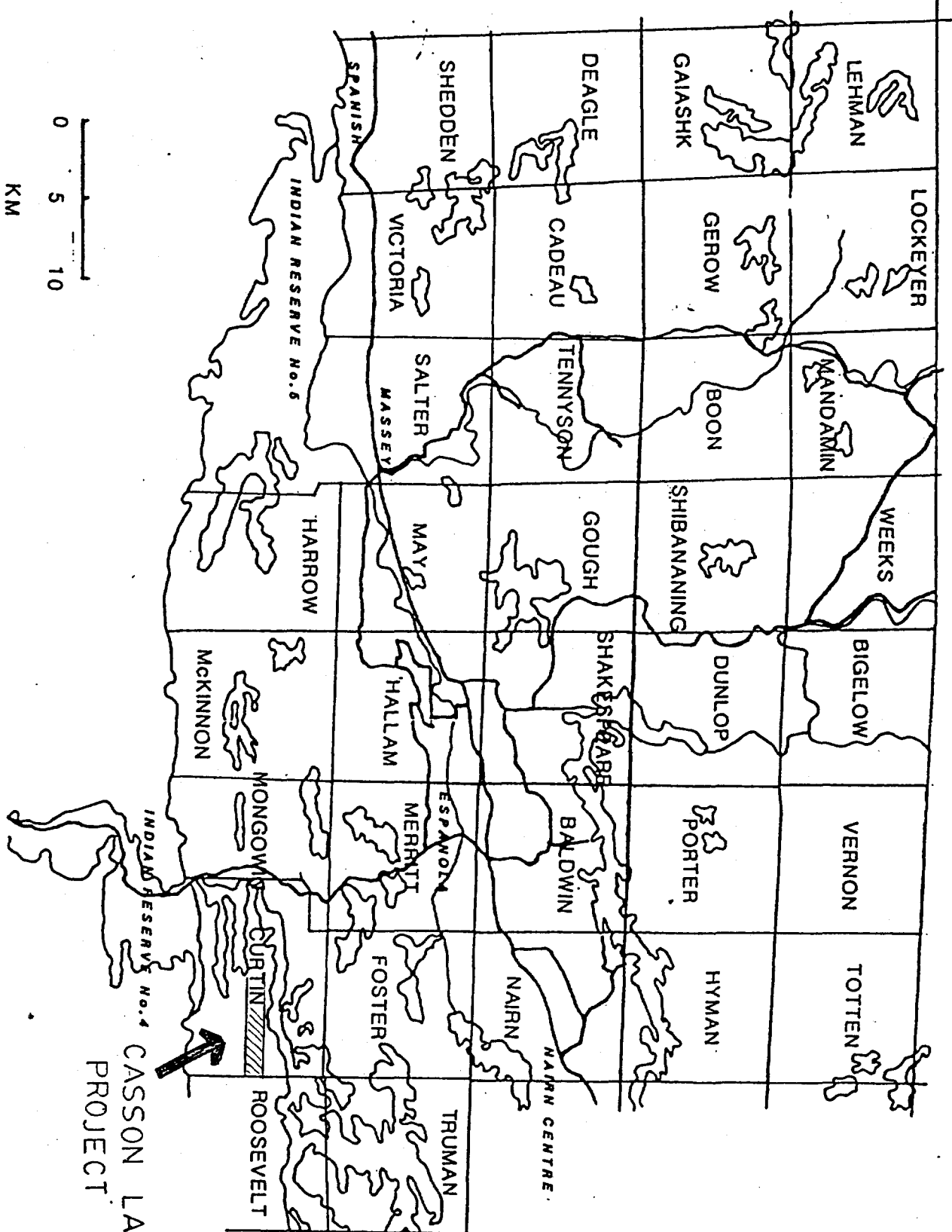
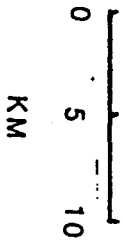

FIGURE 1
LOCATION MAP



CASSON LAKE PROJECT

CLAIM #

1179657-	ATV: 15 days @ 55.00/day	825.00
	Fuel: 150.00	
	Supplies: 100.00	
1179658-	Rock saw blade: 171.92	$\frac{1}{2}$ price of blade
	Rock saw: 4 days @ 45.00/day	180.00
	ATV: 25 days @ 55.00/day	1375.00
	Fuel: 448.79	
	Supplies: 534.95	
984687-	Rock saw blade: 171.93	$\frac{1}{2}$ price of blade
	Rock saw: 2 days @ 45.00/day	90.00
	ATV: 5 days @ 55.00/day	275.00
	Fuel: 100.00	
	Supplies: 100.00	

NOTE

Supplies:

See expense sheet under supplies for dates, amounts and companies names. I am including receipts from Canadian Forestry Ltd. as they are the major supplier. The cost of two cruiser vests @ 83.20 each for a total of 166.40 has been subtracted from the total cost for supplies.

ACCESS

RENTALS & SUPPLY LIMITED

REMIT TO: P.O. Box 2606, Station 'A'
Sudbury, Ontario P3A 5J2
Tel: (705) 560-5900

TERMS: 2% - 30 DAYS NET
2% PER MONTH INTEREST - NET 45 DAYS
CHARGED ON OVERDUE ACCOUNTS

RENTAL/SALES AGREEMENT MADE AT ABOVE LOCATION
BETWEEN ACCESS RENTALS & SUPPLY LIMITED HEREINAFTER
CALLED "LESSOR" / "VENDOR" AND THE CUSTOMER NAMED
BELOW HEREINAFTER CALLED "LESSEE" / "PURCHASER" / "CUSTOMER"

BRANCHES:

SUDBURY EAST: 2435 Lasalle Blvd.,
Tel: (705) 560-5900 Fax: (705) 560-3601
Toll Free 1-800-461-5929

SUDBURY WEST: 1085 Kelly Lake Rd.,
Tel: (705) 688-1000 Fax: (705) 688-0115

TIME USED		
DAY	WEEK	4 WEEKS

INVOICE

INVOICE #: 95899

DIVISION: 2 GST #: R100025683
CUSTOMER:

SALESMAN: INVOICE DATE: 09/20/93
PAGE: 1

BILL TO: CASH CUSTOMER
ONT

SHIP TO: CASH CUSTOMER
ONT

TEL:

(* = GST EXEMPT)

PRODUCT #	DESCRIPTION/COMMENTS	STATUS	QUANTITY	UNIT PRICE	AMOUNT	
DIA12R62	DIAM BLADE CONCRETE DRY 12x125	SOLD	1	299.00	299.00	
TOT RENTALS: .00					TOT SALES: 299.00	TOT SERVICES: .00
					GST: 20.93	
					PROVINCIAL: 23.92	
					TOTAL: 343.85	
					343.85	

~~YOU MAY DEPOSIT THIS INVOICE BY 10/20/93~~

BALANCE DUE: .00

Industrial & Construction Tools and Equipment
RENTAL • SALES • PARTS • SERVICE

DAVELO UNIFILL LINCOLN
 OUTBOARDS BY YAMAHA
 P.O. Box 103
 WHITEFISH FALLS, ONTARIO
 288-4353
 DATE Oct 27 19 93

NAME		TAX P.G.#	
ADDRESS		ACCT. FWD.	
SOLED BY	C.O.D.	CHANGE	ON ACCT.
1	RTV rental		
2	at 55.00 per day		2475.00
3	X 45 days.		
4			
5			
6			
7	TAX EX.		
8			
9	paid full.		
10	in full.		2475.00
SIGNATURE			24

53 GSINCR-2

DAVELO UNIFILL LINCOLN
 OUTBOARDS BY YAMAHA
 P.O. Box 103
 WHITEFISH FALLS, ONTARIO
 288-4353
 DATE Sept 11 19 93

NAME		TAX P.G.#	
ADDRESS		ACCT. FWD.	
SOLED BY	C.O.D.	CHANGE	ON ACCT.
1	Rock Awe		
2			
3	portable motor		
4	Rental at 45.00 per		
5	Day.		
6			
7	Total 6 days.		270.00
8			
9	Tax ex.		
10	paid in full.		
SIGNATURE			25

53 GSINCR-2



Report of Work Conducted After Recording Claim

Mining Act

Assessment - Ontario
Transaction Number
W947000028

Personal information collected on this form is obtained under the authority of the MI this collection should be directed to the Provincial Manager, Mining Lands, Mining Sudbury, Ontario, P3E 6A5, telephone (705) 670-7264.



41104NE0007 W9470.00027 CURTIN

900

- Instructions:**
- Please type or print and submit in duplicate.
 - Refer to the Mining Act and Regulations for requirements of filing assessment work or consult the Mining Recorder.
 - A separate copy of this form must be completed for each Work Group.
 - Technical reports and maps must accompany this form in duplicate.
 - A sketch, showing the claims the work is assigned to, must accompany this form.

Recorded Holder(s) Roger Stringer & Dan Brunne		Client No. 198402 112992
Address Box 2063, Espanola, Ont.		Telephone No. 705-869-4734
Mining Division Sudbury	Township/Area Curtin	M or G Plan No. 3005
Dates Work Performed From: may 17/93		To: Oct. 4/93

Work Performed (Check One Work Group Only)

Work Group	Type
Geotechnical Survey	
Physical Work, Including Drilling	Setting up pump and hose for washing power stripped sites
Rehabilitation	14 days @ \$150.00 per day \$2100.00
Other Authorized Work	SECTION 18 ONLY
Assays bulldozer	100 hours @ \$45.00 per hour \$4588.20
Assignment from Reserve	

Total Assessment Work Claimed on the Attached Statement of Costs \$ 6688.206688

Note: The Minister may reject for assessment work credit all or part of the assessment work submitted if the recorded holder cannot verify expenditures claimed in the statement of costs within 30 days of a request for verification.

Persons and Survey Company Who Performed the Work (Give Name and Address of Author of Report)

Name	Address
Howard Acton	Lang Lake Road, Whitefish Falls, Ont.

RECORDED
MAR 14 1994
Receipt *K/S*

(attach a schedule if necessary)

Certification of Beneficial Interest * See Note No. 1 on reverse side

I certify that at the time the work was performed, the claims covered in this work report were recorded in the current holder's name or held under a beneficial interest by the current recorded holder.	Date Mar. 14/94	Recorded Holder or Agent (Signature) <i>Roger Stringer</i>
--	--------------------	---

Certification of Work Report

I certify that I have a personal knowledge of the facts set forth in this Work report, having performed the work or witnessed same during and/or after its completion and annexed report is true.		
Name and Address of Person Certifying Same as Above		
Telephone No. 705-869-4734	Date Mar. 14/94	Certified By (Signature) <i>Roger Stringer</i>

For Office Use Only

Total Value Cr. Recorded	Date Recorded MARCH 14/94	Mining Recorder <i>[Signature]</i>	Received Stamp
	Deemed Approval Date	Date Approved May 31/94	14
	Date Notice for Amendments Sent		

Work Report Number for Applying Reserve	Claim Number (see Note 2)	Number of Claim Units
	1179657	4
	1179658	14
	984687	1
Total Number of Claims		3

Value of Assessment Work Done on this Claim	Value Applied to this Claim	
1680.00	0	
3988.20 3788	1900.00	
1020.00	00	
Total Value Work Done		6688.20
Total Value Work Applied		1900.00

Value Assigned from this Claim	Reserve: Work to be Claimed at a Future Date	
0	1680.00	
2088.20 0	4988.20 3108.20	
1020.00 0	1020.00	
Total Assigned From		4988.20
Total Reserve		4788.20

Credits you are claiming in this report may be cut back. In order to minimize the adverse effects of such deletions, please indicate from which claims you wish to prioritize the deletion of credits. Please mark (✓) one of the following:

- Credits are to be cut back starting with the claim listed last, working backwards.
- Credits are to be cut back equally over all claims contained in this report of work.
- Credits are to be cut back as prioritized on the attached appendix.

In the event that you have not specified your choice of priority, option one will be implemented.

Note 1: Examples of beneficial interest are unrecorded transfers, option agreements, memorandum of agreements, etc., with respect to the mining claims.

Note 2: If work has been performed on patented or leased land, please complete the following:

I certify that the recorded holder had a beneficial interest in the patented or leased land at the time the work was performed.	Signature	Date
---	-----------	------

Statement of Costs for Assessment Credit

État des coûts aux fins du crédit d'évaluation

Mining Act/Loi sur les mines

Transaction No./N° de transaction
W947000028

Personal information collected on this form is obtained under the authority of the Mining Act. This information will be used to maintain a record and ongoing status of the mining claim(s). Questions about this collection should be directed to the Provincial Manager, Minings Lands, Ministry of Northern Development and Mines, 4th Floor, 159 Cedar Street, Sudbury, Ontario P3E 6A5, telephone (705) 670-7264.

Les renseignements personnels contenus dans la présente formule sont recueillis en vertu de la Loi sur les mines et serviront à tenir à jour un registre des concessions minières. Adresser toute question sur la collecte de ces renseignements au chef provincial des terrains miniers, ministère du Développement du Nord et des Mines, 159, rue Cedar, 4^e étage, Sudbury (Ontario) P3E 6A5, téléphone (705) 670-7264.

1. Direct Costs/Coûts directs

Type	Description	Amount Montant	Totals Total global
Wages Salaires	Labour 14 days Main-d'oeuvre	2100.00	
	Field Supervision Supervision sur le terrain		2100.00
Contractor's and Consultant's Fees Droits de l'entrepreneur et de l'expert-conseil	Type		
Supplies Used Fournitures utilisées	Type		
Equipment Rental Location de matériel	Type Bulldozer	4588.20	
			4588.20
Total Direct Costs Total des coûts directs			6688.20

2. Indirect Costs/Coûts indirects

** Note: When claiming Rehabilitation work Indirect costs are not allowable as assessment work. Pour le remboursement des travaux de réhabilitation, les coûts indirects ne sont pas admissibles en tant que travaux d'évaluation.

Type	Description	Amount Montant	Totals Total global
Transportation Transport	Type		
Food and Lodging Nourriture et hébergement			
Mobilization and Demobilization Mobilisation et démoblisation			
Sub Total of Indirect Costs Total partiel des coûts indirects			
Amount Allowable (not greater than 20% of Direct Costs) Montant admissible (n'excédant pas 20 % des coûts directs)			
Total Value of Assessment Credit (Total of Direct and Allowable indirect costs)		Valeur totale du crédit d'évaluation (Total des coûts directs et indirects admissibles)	

Note: The recorded holder will be required to verify expenditures claimed in this statement of costs within 30 days of a request for verification. If verification is not made, the Minister may reject for assessment work all or part of the assessment work submitted.

Note : Le titulaire enregistré sera tenu de vérifier les dépenses demandées dans le présent état des coûts dans les 30 jours suivant une demande à cet effet. Si la vérification n'est pas effectuée, le ministre peut rejeter tout ou une partie des travaux d'évaluation présentés.

Filing Discounts

1. Work filed within two years of completion is claimed at 100% of the above Total Value of Assessment Credit.
2. Work filed three, four or five years after completion is claimed at 50% of the above Total Value of Assessment Credit. See calculations below:

Total Value of Assessment Credit	Total Assessment Claimed
	× 0.50 =

Remises pour dépôt

1. Les travaux déposés dans les deux ans suivant leur achèvement sont remboursés à 100 % de la valeur totale susmentionnée du crédit d'évaluation.
2. Les travaux déposés trois, quatre ou cinq ans après leur achèvement sont remboursés à 50 % de la valeur totale du crédit d'évaluation susmentionné. Voir les calculs ci-dessous.

Valeur totale du crédit d'évaluation	Évaluation totale demandée
	× 0,50 =

Certification Verifying Statement of Costs

I hereby certify: that the amounts shown are as accurate as possible and these costs were incurred while conducting assessment work on the lands shown on the accompanying Report of Work form.

that as Roger Sturges I am authorized (Recorded Holder, Agent, Position in Company)

to make this certification

Attestation de l'état des coûts

J'atteste par la présente : que les montants indiqués sont le plus exact possible et que ces dépenses ont été engagées pour effectuer les travaux d'évaluation sur les terrains indiqués dans la formule de rapport de travail ci-joint.

Et qu'à titre de _____ je suis autorisé (titulaire enregistré, représentant, poste occupé dans la compagnie)

à faire cette attestation.

Signature: Roger Sturges Date: March 14, 1978

CLAIM #

1179657-	Labour: 4 days @ 150.00/day	600.00
	Bulldozer: 24 hours @ 45.00/hr	1080.00
1179658-	Labour: 8 days @ 150.00/day	1200.00
	Bulldozer: 60 hours @ 45.00/hr	2788.20
984687-	Labour: 2 days @ 150.00/day	300.00
	Bulldozer: 16 hours @ 45.00/hr	720.00

HOWARD ACTON
LANG LAKE LODGE

DATE SEPT 18 1993

TAX REG NO. _____

NAME Roger Stricker

ADDRESS _____

	SOLD BY	C.O.D.	CHARGE	ON ACCT	ACCT PAID
1					
2			Bull Dora Rental		
3			To Sept 18/93		
4					
5			25 Hr. @ 45		
6					\$1175.00
7					
8					
9					
10					

30

GSNCR-2

HOWARD ACTON
LANG LAKE LODGE

DATE SEPT 8 1993

TAX REG NO. _____

NAME Roger Stricker

ADDRESS _____

	SOLD BY	C.O.D.	CHARGE	ON ACCT	ACCT PAID
1					
2			Bull Dora		
3			Rental To		
4					
5			Sept 6/93		
6					
7					
8			28 hrs @ 45/HR		
9					\$1,260.00
10			By Check		\$88.20
					\$1348.20

26

GSNCR-2

HOWARD ACTON
LANG LAKE LODGE

DATE Oct 6 1993

TAX REG NO. _____

NAME Roger Stricker

ADDRESS _____

	SOLD BY	C.O.D.	CHARGE	ON ACCT	ACCT PAID
1					
2			Bull Dora		
3			Rental To Sept 24/93		
4			Job Completed		
5					
6			18.5 Hr @ 45		
7					\$832.50
8					
9			Pho 2/HR		
10					

33

GSNCR-2

HOWARD ACTON
LANG LAKE LODGE

DATE SEPT 11 1993

TAX REG NO. _____

NAME Roger Stricker

ADDRESS _____

	SOLD BY	C.O.D.	CHARGE	ON ACCT	ACCT PAID
1					
2			Bull Dora Rental		
3			To SEPT 11/93		
4					
5			28.5 Hr. @ 45		
6					\$1282.50
7					
8					
9					
10					

28

GSNCR-2

Date 1993 Description Total Date Rental Supplies Dumps Repairs Surplus

Apr 30 Nelson's General Store 6000 6000

May 02 Boullier's Eggs 1350 1350
 08 Boullier's Eggs 5200 5200

17 Nelson's General Store 1800 1800
 17 Boullier's Eggs 1302 1302

23 Boullier's Eggs 2400 2400
 24 Ruyphard (Shipping) 1348 1348
 25 Canadian Forestry Equip. Ltd 39856 39856

28 Ontario National (Shipping) 1113 1113
 28 Boston's Office Supplies 1068 1068

30 Boullier's Eggs 1100 1100
 31 Canadian Forestry Equip. Ltd 8320 8320

64257 12552 49244 2461

May 02 Boullier's Eggs 1000 1000
 02 S.F. Request Form (Pulim, Map) 590 590

13 Nelson's General Store 1040 1040
 16 Robinson Drugs (Batteries) 918 918
 18 Canadian Tire (gas can) 746 746

18 Boullier's Eggs 751 751
 23 Canadian Tire 2069 2069
 28 Decaturway Sawmills 65153 65153

72267 2791 3405 65153 918

May 03 Boullier's Eggs 1341 1341
 11 Boullier's Eggs 1000 1000

22 Davis's Small Engine Repair 4000 4000
 25 Nelson's General Store 700 700

7041 3041 4000 7041

Aug 02 Boullier's Eggs 1000 1000
 04 Davis's Small Engine Repair 4000 4000

07 Boston's Office Supplies 492 492
 07 Canadian Tire 2294 2294

08 Boullier's Eggs 1100 1100
 10 Canadian Forestry Equip. Ltd 6335 6335
 28 Nelson's General Store 1200 1200

Date Description Total Gas Rental Supplies Overly's Repairs Amount

1993
 Aug 31 Nelson's, Leonard Store 2800 2800
 31 Dave's Small Engine 7820 7820
 @ 27041 6100 16941 4000

1994
 01 Nelson's General Store 2863 2863
 05 Boulton's Eels 1300 1300
 07 Dave's Small Engines 960 960
 08 Kang Lake Lodge (Buildings) 134820 134820
 08 Nelson's General Store 1328 1328
 08 Ontario Northland (Fuel) 3229 3229
 09 Boulton's Eels 2000 2000
 10 Boulton's Eels 4350 4350
 10 Canadian Tire (Tarp) 3161 3161
 11 Kang Lake Lodge (Buildings) 128250 128250
 11 Boulton's Eels 1700 1700

11 Dave's Small Engines (Part Saw) 27000 27000
 13 Boulton's Eels 1775 1775
 13 Boulton's Eels 2995 2995
 13 Kelly Kambur (Batteries Mag.) 3099 3099
 16 Boulton's Eels 4749 4749
 16 Kelly Kambur (Part for Axle) 1347 1347
 17 Occurrence Laboratories 27024 27024
 18 Boulton's Eels 3800 3800
 18 Boulton's Eels 849 849
 18 Kang Lake Lodge (Buildings) 112500 112500
 20 Occure Rental's Supply Ltd 34385 34385
 21 Canadian's Forestry Equip. 8887 8887
 24 Nelson's General Store 8286 8286

@ 582657 35995 436955 16494 89024 960 3229

1 Audbury Bay's Canvas 1915
 03 Boulton's Eels 1200 1200
 04 Olive Blue Print Ltd 1822 1822
 05 Kang Lake Lodge (Buildings) 83250 83250
 07 Nelson's Truck's Trailer Services 8331 8331
 16 Boulton's Eels 2000 2000
 20 Olive Blue Print Ltd 2209 2209
 27 Dave's Small Engines (ATV) 247504 247504

@ 348227 3200 330750 4031 10246

FINANCIAL STATEMENT
 CP93-031

Date	Description	Total	Bus Rental	Supplies	Repairs	Expenses
04	Draw salary 1/1/1933	42836				
12	Draw salary 1/1/1933	4622				
15	Draw Blue Print 1/1/1933	8683				
22	Draw 1 Office Supplies	1351				
		1351		8683		
		62898	10034	52864		

Summary

From April 1/1933 to Apr 30/1933	6800	6800				
From May 1/1933 to May 31/1933	64257	12554		49277		2461
From June 1/1933 to June 30/1933	70261	2791		3405		65153
From July 1/1933 to July 31/1933	7041	3371				4000
From Aug 1/1933 to Aug 31/1933	27041	6100		16271		4000
From Sept 1/1933 to Sept 30/1933	582657	35795	436955	16434	89024	960
From Oct 1/1933 to Oct 30/1933	348227	2200	330750	4031		10246

75754 @ 1107690 68879 767705 90115 154177 19206 6608

Report of Work Conducted After Recording Claim
Mining Act

Assessment - Toronto
 Transaction Number
 094700027

Personal information collected on this form is obtained under the authority of the Mining Act. This information will be used for correspondence. Questions about this collection should be directed to the Provincial Manager, Mining Lands, Ministry of Northern Development and Mines, Fourth Floor, 159 Cedar Street, Sudbury, Ontario, P3E 6A5, telephone (705) 670-7284.

- Instructions:**
- Please type or print and submit in duplicate.
 - Refer to the Mining Act and Regulations for requirements of filing assessment work or consult the Mining Recorder.
 - A separate copy of this form must be completed for each Work Group.
 - Technical reports and maps must accompany this form in duplicate.
 - A sketch, showing the claims the work is assigned to, must accompany this form.

Recorded Holder(s) Roger Stringer & Dan Brunne		Client No. 198402 / 112992
Address Box 2063, Espanola, Ont.		Telephone No. 705-869-4734
Mining Division Sudbury	Township/Area Curtin	M or G Plan No. 3005
Dates Work Performed	From: May 17/93	To: Oct. 4/93

Work Performed (Check One Work Group Only)

Work Group	
Geotechnical Survey	
<input checked="" type="checkbox"/> Physical Work, Including Drilling	TRENCHING
Rehabilitation	
Other Authorized Work	SECTION 18 ONLY
Assays	
Assignment from Reserve	

ONTARIO GEOLOGICAL SURVEY
 GIS - TYPE ASSESSMENT FILES
 JUN 02 1994
 RECEIVED MAR 14 1994
 Receipt x/5

Total Assessment Work Claimed on the Attached Statement of Costs \$ 4522.59 4523

Note: The Minister may reject for assessment work credit all or part of the assessment work submitted if the recorded holder cannot verify expenditures claimed in the statement of costs within 30 days of a request for verification.

Persons and Survey Company Who Performed the Work (Give Name and Address of Author of Report)

Name	Address
Dave's Small Engines	P.O. Box 103, Whitefish Falls, Ont.
Access Rentals	1085 Kelley Lake Rd.
Canadian Forestry Equip. Ltd.	Mississauga, Ont.

(attach a schedule if necessary)

Certification of Beneficial Interest * See Note No. 1 on reverse side

I certify that at the time the work was performed, the claims covered in this work report were recorded in the current holder's name or held under a beneficial interest by the current recorded holder.	Date Mar. 14/94	Recorded Holder or Agent (Signature) Roger Stringer
--	--------------------	--

Certification of Work Report

I certify that I have a personal knowledge of the facts set forth in this Work report, having performed the work or witnessed same during and/or after its completion and annexed report is true.

Name and Address of Person Certifying
SAME AS ABOVE

Telephone No. 705-869-4737	Date Mar. 14/94	Certified By (Signature) Roger Stringer
-------------------------------	--------------------	--

For Office Use Only

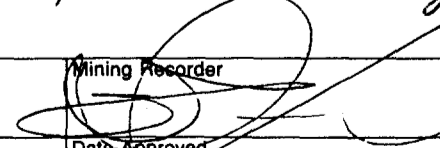
Total Value Cr. Recorded Reserved \$ 4,523.00	Date Recorded March 14/94	Mining Recorder 	Received Stamp RECEIVED 14/94
	Deemed Approval Date JUNE 12/94	Date Approved May 30/94	
	Date Notice for Amendments Sent		



Ministry of
Northern Development
and Mines

Ministère du
Développement du Nord
et des mines

**Statement of Costs
for Assessment Credit**

**État des coûts aux fins
du crédit d'évaluation**

Mining Act/Loi sur les mines

Transaction No./N° de transaction

U 94 70 000 27

Personal information collected on this form is obtained under the authority of the Mining Act. This information will be used to maintain a record and ongoing status of the mining claim(s). Questions about this collection should be directed to the Provincial Manager, Minings Lands, Ministry of Northern Development and Mines, 4th Floor, 159 Cedar Street, Sudbury, Ontario P3E 6A5, telephone (705) 670-7264.

Les renseignements personnels contenus dans la présente formule sont recueillis en vertu de la Loi sur les mines et serviront à tenir à jour un registre des concessions minières. Adresser toute question sur la collecte de ces renseignements au chef provincial des terrains miniers, ministère du Développement du Nord et des Mines, 159, rue Cedar, 4^e étage, Sudbury (Ontario) P3E 6A5, téléphone (705) 670-7264.

1. Direct Costs/Coûts directs

Type	Description	Amount Montant	Totals Total global
Wages Salaires	Labour Main-d'oeuvre		
	Field Supervision Supervision sur le terrain		
Contractor's and Consultant's Fees Droits de l'entrepreneur et de l'expert- conseil	Type		
Supplies Used Fournitures utilisées	Type		
	Diam. Blade	343.85	
	fuel	698.79	
	supplies	734.95	
			1777.59
Equipment Rental Location de matériel	Type		
	A.T.V.	2475.00	
	rock saw	270.00	
			2745.00
Total Direct Costs Total des coûts directs			4522.59

2. Indirect Costs/Coûts indirects

** Note: When claiming Rehabilitation work Indirect costs are not allowable as assessment work.
Pour le remboursement des travaux de réhabilitation, les coûts indirects ne sont pas admissibles en tant que travaux d'évaluation.

Type	Description	Amount Montant	Totals Total global
Transportation Transport	Type		
Food and Lodging Nourriture et hébergement			
Mobilization and Demobilization Mobilisation et démobilisation			
Sub Total of Indirect Costs Total partiel des coûts indirects			
Amount Allowable (not greater than 20% of Direct Costs) Montant admissible (n'excédant pas 20 % des coûts directs)			
Total Value of Assessment Credit (Total of Direct and Allowable indirect costs)		Valeur totale du crédit d'évaluation (Total des coûts directs et indirects admissibles)	

Note: The recorded holder will be required to verify expenditures claimed in this statement of costs within 30 days of a request for verification. If verification is not made, the Minister may reject for assessment work all or part of the assessment work submitted.

Note : Le titulaire enregistré sera tenu de vérifier les dépenses demandées dans le présent état des coûts dans les 30 jours suivant une demande à cet effet. Si la vérification n'est pas effectuée, le ministre peut rejeter tout ou une partie des travaux d'évaluation présentés.

Filing Discounts

1. Work filed within two years of completion is claimed at 100% of the above Total Value of Assessment Credit.
2. Work filed three, four or five years after completion is claimed at 50% of the above Total Value of Assessment Credit. See calculations below:

Total Value of Assessment Credit	Total Assessment Claimed
	x 0.50 =

Remises pour dépôt

1. Les travaux déposés dans les deux ans suivant leur achèvement sont remboursés à 100 % de la valeur totale susmentionnée du crédit d'évaluation.
2. Les travaux déposés trois, quatre ou cinq ans après leur achèvement sont remboursés à 50 % de la valeur totale du crédit d'évaluation susmentionné. Voir les calculs ci-dessous.

Valeur totale du crédit d'évaluation	Évaluation totale demandée
	x 0,50 =

Certification Verifying Statement of Costs

I hereby certify:
that the amounts shown are as accurate as possible and these costs were incurred while conducting assessment work on the lands shown on the accompanying Report of Work form.

that as Recorded Holder I am authorized
(Recorded Holder, Agent, Position in Company)

to make this certification

Attestation de l'état des coûts

J'atteste par la présente :
que les montants indiqués sont le plus exact possible et que ces dépenses ont été engagées pour effectuer les travaux d'évaluation sur les terrains indiqués dans la formule de rapport de travail ci-joint.

Et qu'à titre de _____ je suis autorisé
(titulaire enregistré, représentant, poste occupé dans la compagnie)

à faire cette attestation.

Signature: Roger Sturgeon Date: Mar. 14/94

LEGEND	
Mafic Intrusions	
6 (a)	Nipissing Diabase
(b)	Tf Gabbro
(c)	Amphibolite
Huronian Supergroup	
Gowanda Formation	
5 (a)	Quartzite Feldspathic
(b)	Quartzite Micaceous
(c)	Quartzite Orthoquartzite
4	Protoquartzite
3	Subwacke
2	Conglomerate
(a)	Pebble-Wacke, <10% clasts
(b)	Paraconglomerate >25% clasts
1	Pelitic
(a)	Mudstone
(b)	Siltstone

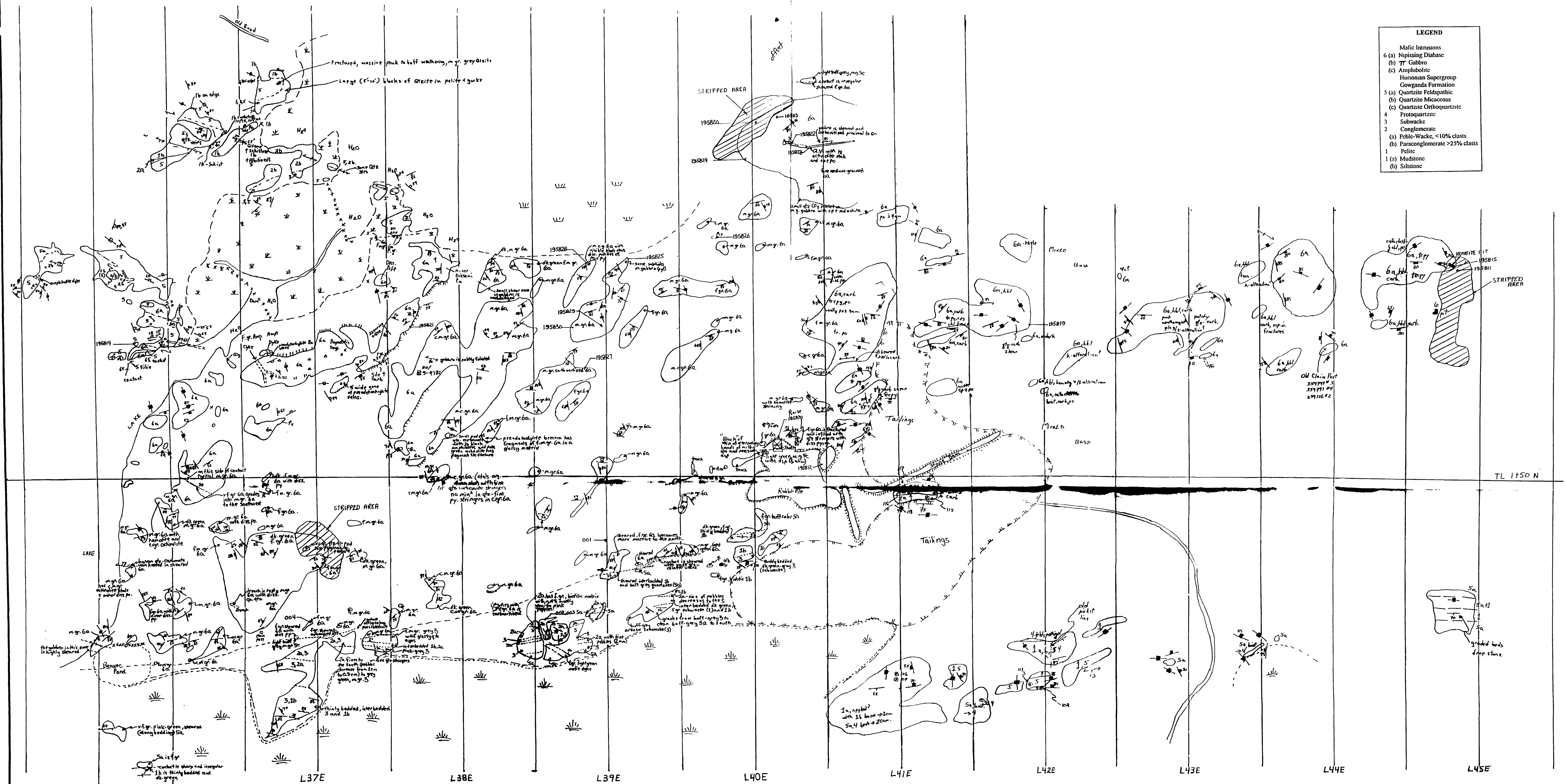

SEE "BOUSQUET SOUTH"

210
UNIVERSITY OF TORONTO LIBRARY

NO	REVISION	BY	DATE
CASSON LAKE PROJECT			
TITLE			
DETAIL GEOLOGY BOUSQUET MINE AREA			
DRW: J. DARBY	DATE: OCT/93	DRAWING NO: # 2	
CHECKED:	DATE:	BHT. NO: 2 OF 3	
APPRD:	SCALE: 1:12.5		

breccia does not appear to be highly sheared, frags range in size from 1/2" to 1 1/2"

breccia is highly sheared - frags elongated 5:1

pink granitic breccia is cut by 4-5m S20

breccia has frags which range from 1/2" to 1 1/2" in size - matrix is fine to med. and varies in color context and is sheared.

LEGEND	
Mafic Intrusions	
6 (a)	Nipissing Diabase
(b)	Gabbro
(c)	Amphibolite
Huronian Supergroup	
Gowanda Formation	
5 (a)	Quartzite Feldspathic
(b)	Quartzite Micaceous
(c)	Quartzite Orthoquartzite
4	Protoquartzite
3	Subwacke
2	Conglomerate
(a)	Pebble-Wacke, <10% clasts
(b)	Paraconglomerate >25% clasts
1	Pelite
1 (a)	Mudstone
(b)	Siltstone

CASSON LAKE B/L 0
13-07W

o12 ← o11
← o18, o19

195816
195817

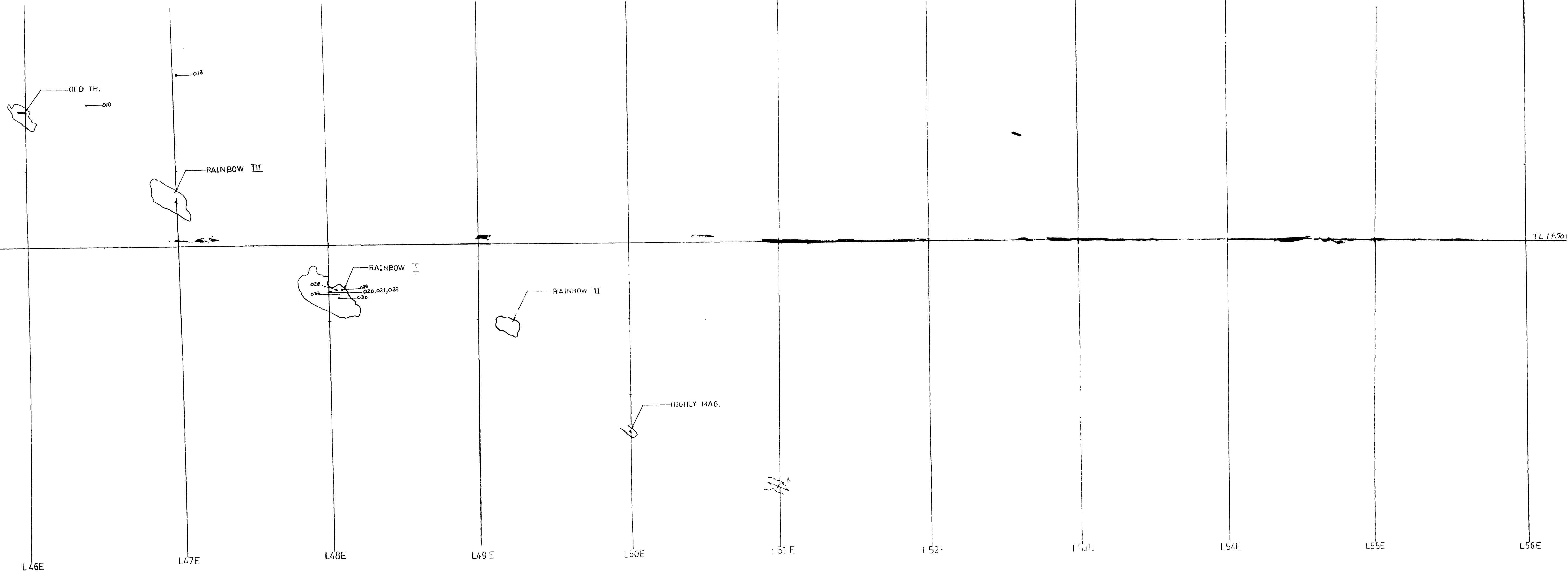

TL 14.501

NO	REVISION	BY	C
BOUSQUET EAST			
TITLE			
DRW.	DATE:	DRAWING NO. 43	
CHECK'D	DATE:		
APPR'D.	SCALE: 1:1204	SHT. NO. 3 OF 3	



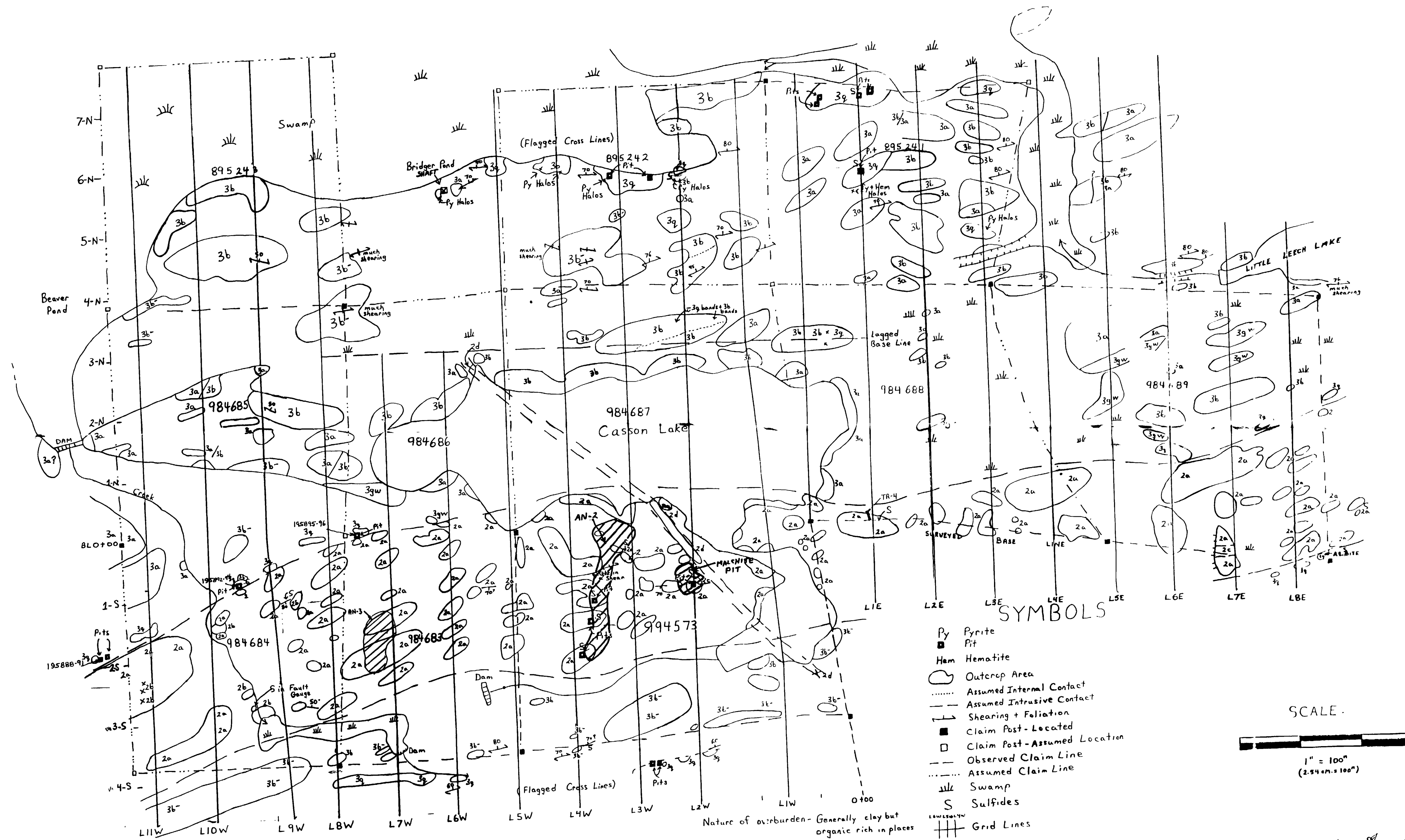

LEGEND

- 3j Quartzite
 - 3i Greywacke
 - 3b Tilloid Conglomerate (Polymictic Paraconglomerate with Laminated Argillite)
 - 3k Laminated or Massive Argillite
 - 3a Polymictic Paraconglomerate
- INTRUSIVE CONTACT**
- Nipissing Diabase
 - 2d Magnetic Pyroxenite
 - 2c Pegmatite Phase
 - 2b Mafic Rich (Gabbro in whole or in part)
 - 2a Diorite - Quartz Diorite

- SYMBOLS**
- Py Pyrite
 - Pit Pit
 - Hem Hematite
 - Outcrop Area
 - Assumed Internal Contact
 - - - - Assumed Intrusive Contact
 - Shearing + Foliation
 - Claim Post - Located
 - Claim Post - Assumed Location
 - Observed Claim Line
 - - - - Assumed Claim Line
 - Swamp
 - S Sulfides
 - Grid Lines

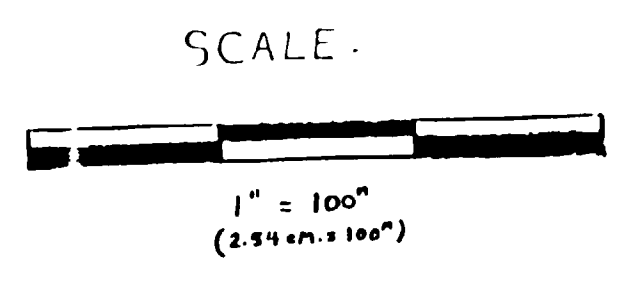

Geology + Report by: Frank Racicot
(Frank Racicot) June/88

NO	REVISION	BY	DATE
CASSON LAKE PROJECT			
GEOLOGY OF P.G.E. OCCURENCE			
DRW.	DATE: OCT/93	DRAWING NO.	
CHECK'D	DATE:		
APPR'D.	SCALE: 1:3937	SHT. NO.	

LEGEND	
Mafic Intrusions	
6 (a) Nipissing Diabase	
(b) TT Gabbro	
(c) Amphibolite	
Huronian Supergroup	
Govganda Formation	
5 (a) Quartzite Feldspathic	
(b) Quartzite Micaceous	
(c) Quartzite Orthoquartzite	
4 Protoquartzite	
3 Subwacke	
2 Conglomerate	
(a) Pebble-Wacke, <10% clasts	
(b) Paraconglomerate >25% clasts	
1 Pelite	
(a) Mudstone	
(b) Siltstone	

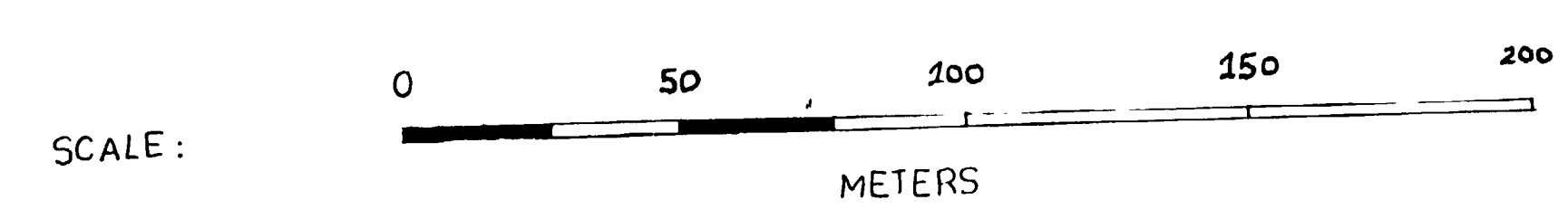
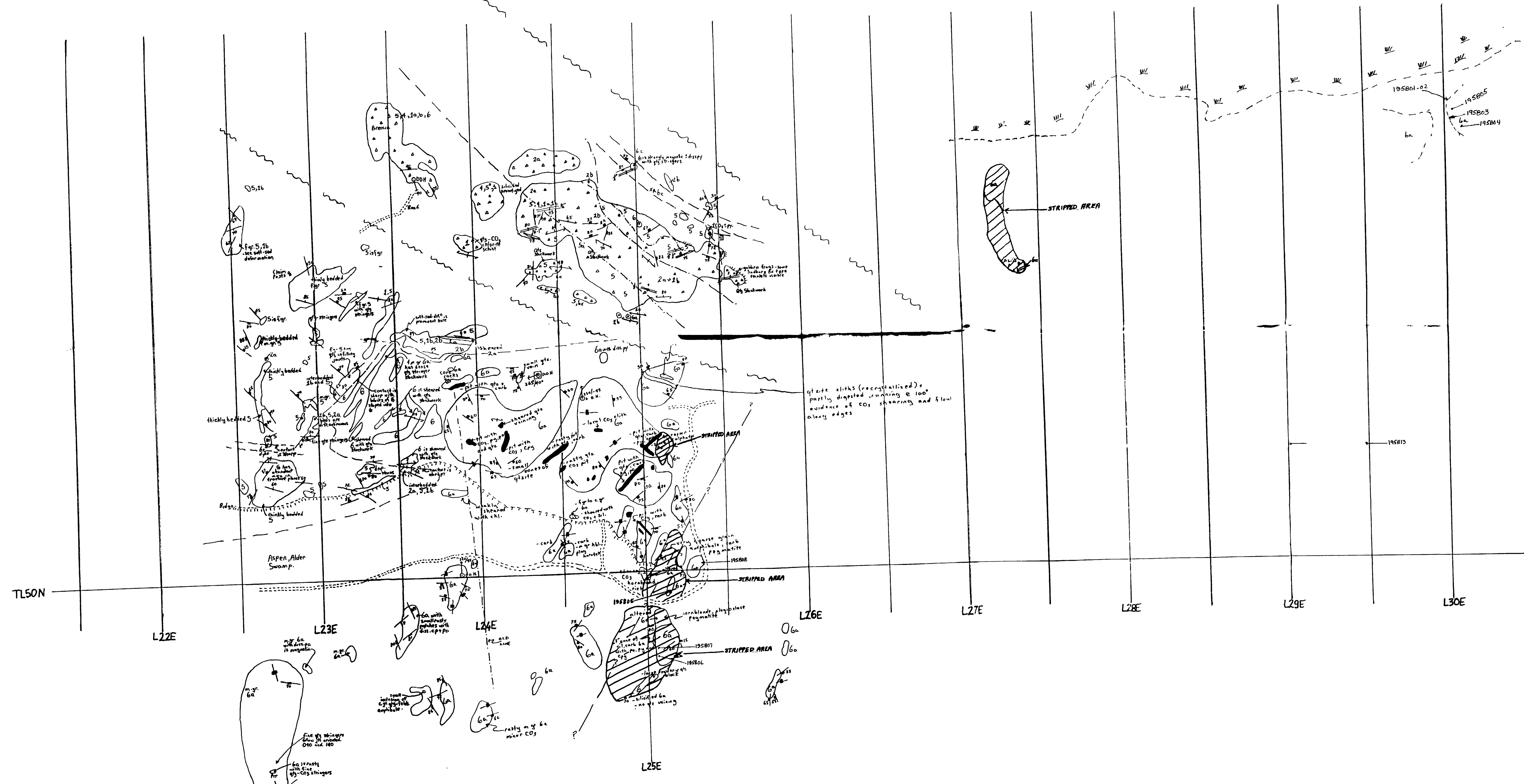

NO.	REVISION	BY	DATE
CASSON LAKE PROJECT			
TITLE PLATINUM OCCURRENCE BP #1			
DRW: T DARBY	DATE: OCT/93	DRAWING NO. # 1	
CHECK'D:	DATE:		
APPR'D:	SCALE: 1:1204	SHT. NO: 1 OF 3	

