

2.3440



41104NE0017 0015B1 FOSTER

010

RECEIVED

SEP - 1980

MINING LANDS SECTION

ASSESSMENT REPORT
ON
ANALYTICAL WORK (EXPENDITURE CREDITS)
FOSTUNG PROPERTY
FOSTER TOWNSHIP, DISTRICT OF SUDBURY

PROJECT #3115

ST. JOSEPH EXPLORATIONS LIMITED

Douglas Robinson

Douglas Robinson
Cobalt, Ontario

June 5, 1980

PROPERTY STANDING

The Fostung property consists of twenty-eight claims controlled by St. Joseph Explorations, 90 Eglinton Ave. West, Toronto, Ontario.

The aforementioned claims are numbers as follows:

S398131 - S398153 inclusive
S471202 - S471204 inclusive
S471438 - S471439 inclusive

All claims are in good standing through the date of this report.

LOCATION and ACCESS

The Fostung property of twenty-eight claims is located on lots 6, 7, 8 and 9 of Concessions III and IV of Foster Township.

* "Foster Township is located some 40 miles to the west of the city of Sudbury, Ontario.

The property is about 7 road miles (10km) east of the Town of Espanola over excellent gravel road. The claim group straddles this east-west road and is bounded by Elizabeth Lake on the north, and St. Leonard Lake on the south. A branch road to Hannah and Stratton Lakes departs the main gravel road near the west end of the property and proceeds south. It, too, is an excellent gravel road.

The potential of a mineral occurrence at this location is enhanced by the local infrastructure. The Town of Espanola is a source of competent labour and a supply centre. A hydro transmission line passes a mile and a half south of the property and the Canadian Pacific Railway branch line to Manitoulin Island passes within the 2 miles (3 km) of the claim group. The Great Lakes shipping port of Little Current is about 30 miles (45 km) south of Espanola on paved highway No. 68.

Numerous mining and milling facilities in the centres of Elliot Lake, Agnew Lake, and Sudbury are within trucking distance."

*M.L. Halladay's 1978 Assessment Work Report

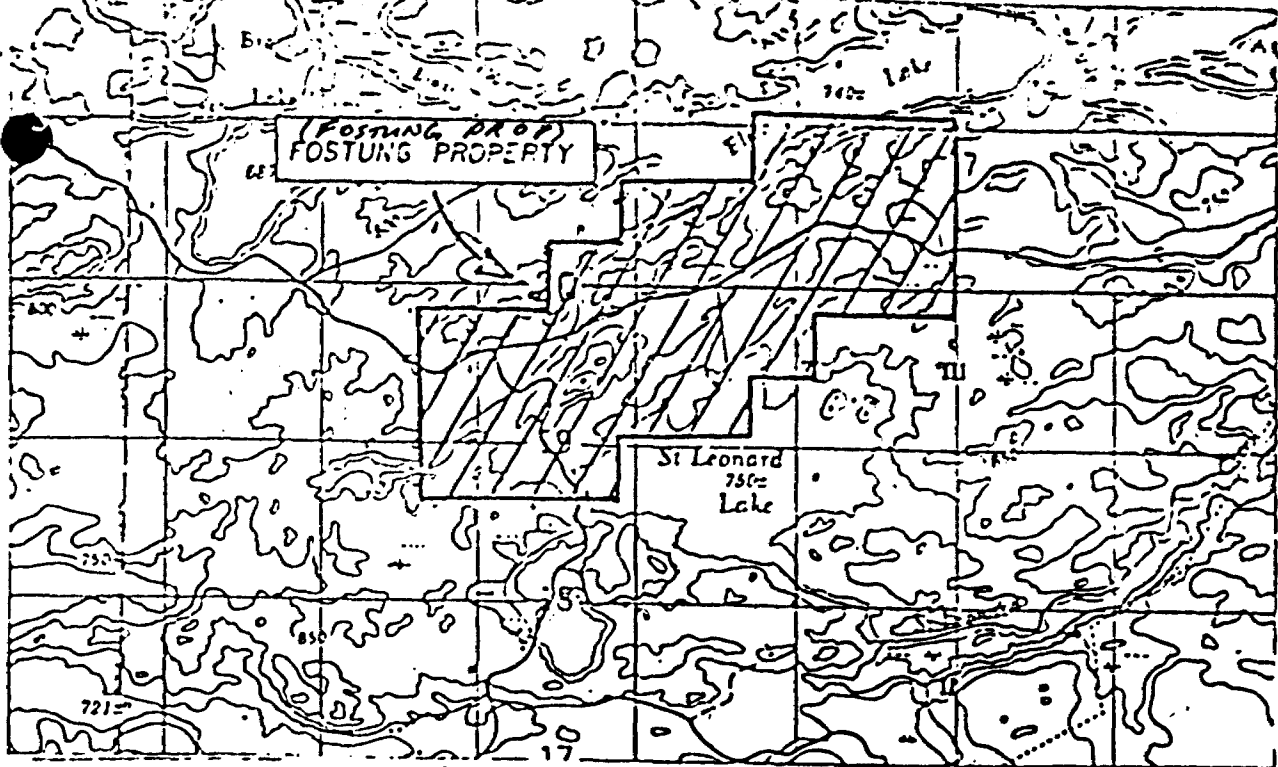

Scale 1:50,000 Échelle

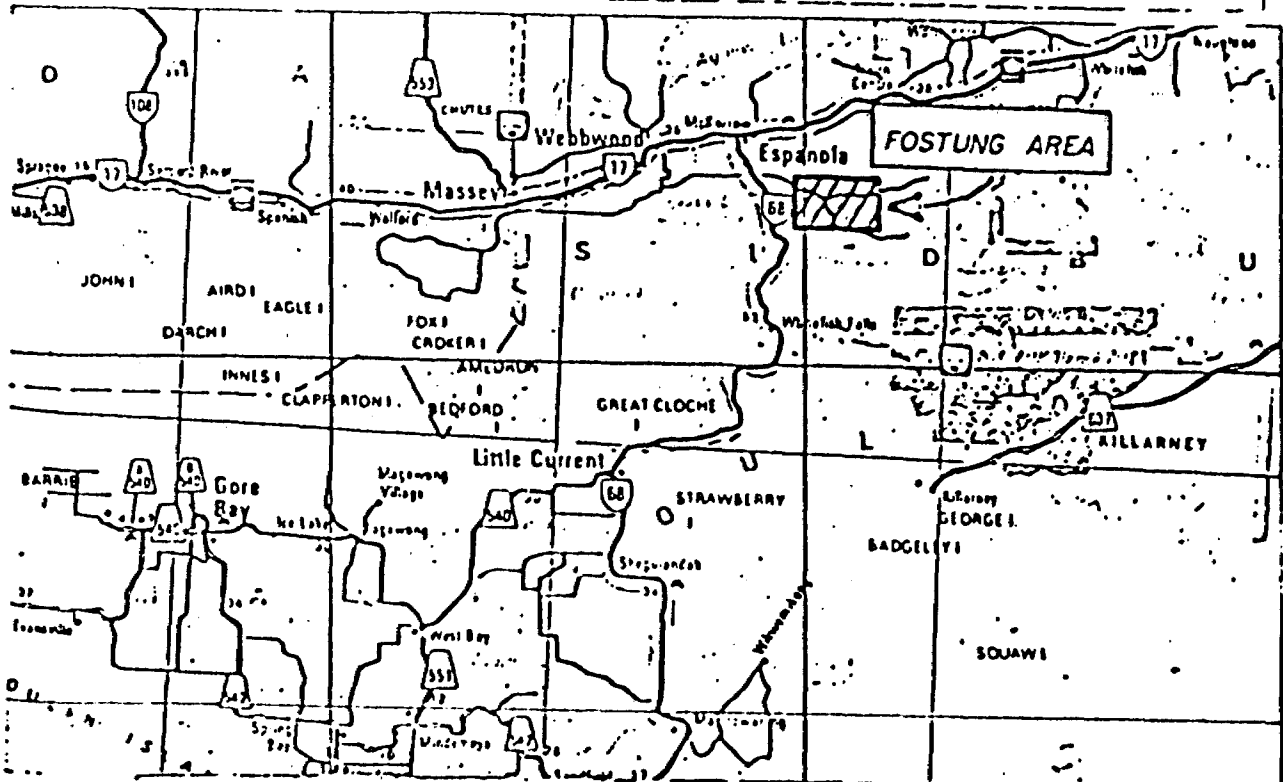
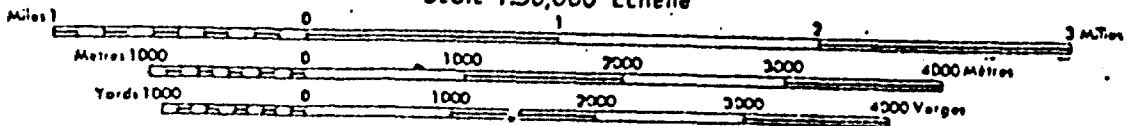

Scale 1:800,000

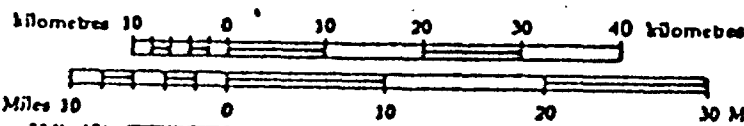

ST. JOSEPH EXPLORATIONS LIM. TORONTO, CANADA	
FOSTUNG LOCATION MAP	
APPROX. DATE OF LEASING BY COMPANY	PROJECT NO. 3118
APPROX. DATE OF ACQUISITION	PROJECT NO.

Nairn, Twp. - M. 883

Merrill Twp. - M. 883

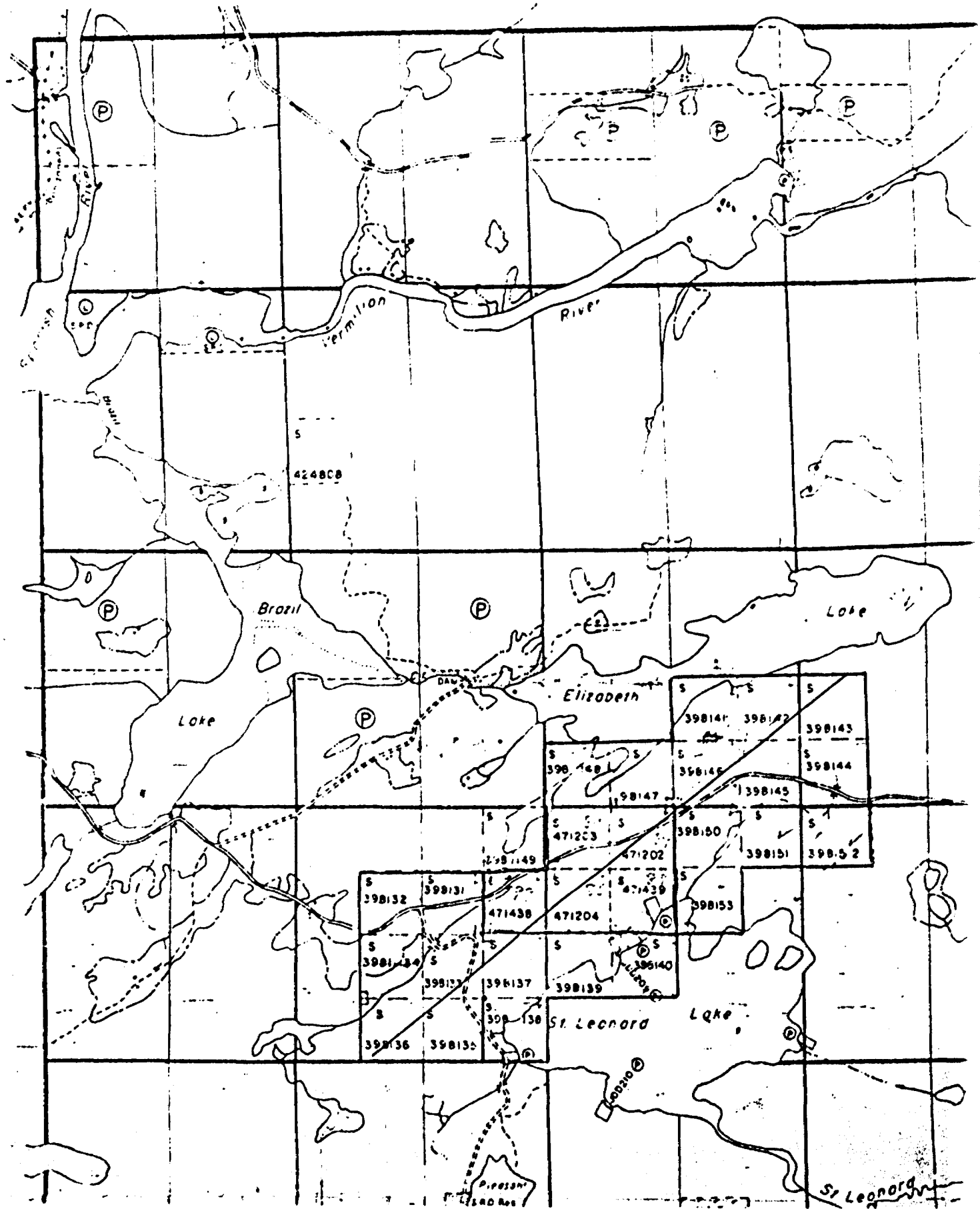

HISTORY

* "The existence of chalcopyrite - molybdenite with pyrite and pyrrhotite was known at this location for some years prior to 1966. At that time claims held by Messrs. Piispanen and Tamminen were optioned by Texas Gulf after R.M.Ginn examined the property, recognized the occurrence as skarn and discovered the presence of scheelite.

Texas Gulf then did a geological survey, partial magnetometer survey and 3073 feet of drilling in 6 holes. Results were encouraging but no ore intersections were obtained and the option was dropped.

In 1970 Cerro Corporation optioned the property and did trenching and surface sampling, together with further analyses on cores of the T.G.S. drilling. They dropped their option when Cerro suspended Canadian exploration.

In 1971 Vangulf, managed by R.M.Ginn, optioned the property and conducted surface surveys. Vangulf's option was taken over by St.Joseph Exploration and an additional 6 drill holes (4,629 feet) were completed without ore intersections.

In the summer of 1978 Union Carbide Exploration optioned 5 claims of the original property and staked a further 23 claims."

* M.L.Halladay's 1978 Assessment Work Report

Union Carbide then recut the original Texas Gulf grid on 400' centres and M.L.Halladay did considerable night lamping to determine the scheelite content of the showings. Union Carbide and St.Joseph Explorations formed a joint venture to explore for tungsten mineralization.

In 1979 St.Joseph Explorations extended the existing Union Carbide grid on 400' centres west of 0+00E, on 400' centres east of 79E and cut fill in lines between 0+00E and 79+00E on 200' centres. The base line azimuth is 53°.

During 1979 St.Joseph Explorations did a magnetometer survey on all twenty-eight (28) claims and a VLF survey on claims

S471202 - S471204 inclusive
S471438 - S471439 inclusive

This geophysics work report dated December 7, 1979, was filed with the Mining Recorder of the Sudbury District.

GEOLOGICAL WORK - 1979

Geological mapping on a scale of 1" = 200' was done by C. Harrison, 94 Davenport Road, Apt. #210, Toronto, Ontario, on the dates May 15 to 31 inclusive, 1979 and September 4 to 14 inclusive, 1979, and D.R. Robinson, Box 664, Cobalt, Ontario, POJ 1C0 on the dates September 4 to 14 inclusive, 1979; October 3 to 12 inclusive, 1979; and November 2 to 4 inclusive, 1979.

Representative rock samples were collected during mapping and lapped by short wave fluorescent light in the evenings to determine the scheelite content of the rock.

The following claims were mapped:

S398131 - S398133 inclusive
 S398137 - S398153 inclusive
 S471202 - S471204 inclusive
 S471438 - S471439 inclusive

A total of 525 days were claimed as work credits. This was 21 days for each of the claims listed above.

GENERAL GEOLOGY

* "Foster Township lies within the Precambrian Shield approximately half way between the Sudbury Basin and the Elliot Lake uranium camp. Foster Township is underlain by the sediments of the Huronian Super-group of Archean, (Proterozoic) age. The area has been mapped in some detail by the O.D.M. and is subject of a report (GR 131 Espanola-Whitefish Falls Area) by Dr. K.D. Card, and also Report 166 concerning the Sudbury-Manitoulin area, also by the same author. The rocks of the area are the Mississagi Formation of the Hough Lake Groups and the formations of the Quirke Lake Group (see Table of Formations). These are cut by diabasedyke intrusions. There are no known granitic intrusions in the immediate area.

The Grenville Front lies 20 miles to the southeast.

On the property, the sedimentary formations are the northern limb of a southwest plunging anticline. This structure is cut by two important faults.

The regional grade of metamorphism within Foster Township is green-schist with the exception of the present Union Carbide property which contains rocks altered to almandine amphibolite facies.

Previous official maps (O.D.M.) ascribed rocks south of the base line on the Union Carbide property to the Mississagi formation but recent studies (including some 30,000 feet of section measuring) have lead to the conclusion that the area is in fact part of the Serpent Formation -

indicating changes must be made to the previous interpretation of the structure."

* M.L. Halladay's 1978 Assessment Work Report.

GENERAL GEOLOGY OF CLAIM GROUP

Two major sediment formations, the Espanola and Serpent Formations and two ages of diabase dykes comprise most of the bedrock on the claim group.

The oldest formation is the Espanola limestones and siltstones which are metamorphosed and metasomatized to diopside and amphibole hornfels with local grossular skarn zones. It is the Espanola Formation which is the host of the scheelite ± base metal mineralization.

The Espanola is bounded on the south by the base line fault. South of the base line fault is Serpent Formation.

The north contact of the Espanola is a gradational contact with the Serpent. Both north and south of the base line fault the Serpent Formation is orthoquartzite and arkose with interbeds of silt and greywacke being common.

The Serpent Formation north of the base line fault is cut by a Nipissing diabase dyke which is subparallel to the bedding in the Serpent and both dip north.

A Nipissing diabase Dyke cuts the Sediments along the North edge of the Grid.

Keweenawan diabase dykes cut all the above rock types.

These Dykes tend to be narrow 1 - 50' wide.

Analytical Assessment Work

A total of \$2,630.09 were expended to analyse 133 rock samples. These samples were collected on claims.

S-398130
S-398133
S-398137
S-398142
S-398143
S-398145
S-398146
S-398147
S-398148
S-398150
S-398152
S-398153
S-471202
S-471203
S-471204
S-471438
S-471439

A total of 174 days of expenditure credits are claimed. 58 days are applied to each of claims.

S-398134
S-398135
S-398136

Sample Collection and Data Plotting

37 Samples were cut over the showings between 73+00E, 1+005 and 77+20E, 1+005. These were mapped in detail and all sample locations and grades were plotted on a 1" = 20' map (included in this report). Due to close spacing of samples, only higher grade samples or sample averages could be plotted on the 1" = 100' map included in this report.

Six samples were cut from the showings between 24+00E, 5+40N and 27+00E, 6+10N. These were all plotted on the 1" = 100' scale map only.

The cut samples listed above were taken to determine the grade of the better showings.

89 grab samples were collected randomly from the showings to help determine area with high concentrations of tungsten and to determine metal zoning. These samples were all plotted on the 1" = 100' map.

ELEMENT - ANALYSIS METHOD - DETECTION

LIMIT IN P.P.M.

	W	WO3	Mo	MoS2	Cu	Zn	Ag	F	Sn	Au
89 GRAB SAMPLES	S		AA 1		AA 1	AA 1	AA 0.1	F	XRF 1	
12 high W Samples AA From 89 Rerun										
6 Cut Samples Plus 1 Sludge	XRF			XRF	XRF	XRF	FA			FA
	100			100	100	100	6.9			0.3
37 CUT (7 samples) SAMPLES	XRF			XRF	XRF	XRF	FA			
	100			100	100	100	6.9			

AA - Atomic Absorption (HNO₃ - HCl digestion)
 FA - Fire Assay
 F - Fusion - Specific Ion Electrode
 S - Sinter - Colourmetric

Grades of Cut Samples from Showings

The grades of the showings were averaged and are tabulated below.

Coordinates	%WO ₃	%MoS ₂	% Cu	%Zn	oz/t Ag	oz/t Au	Width In Ft.	
24+00E 5+10N	0.33	0.00	0.22	0.07	0.17	tr	19.0	
25+70E 5+30N	0.15	0.02	0.26	0.11	0.23	tr	7.0	
27+90E 6+10N	0.38	0.04	0.05	0.07	tr	tr	8.3	
73+17E 0+855	0.38	0.01	0.05	0.05	tr		8.2	
74+00E 1+005	0.45	0.01	0.02	0.02	tr		12.3	
		includes 6.0' not sampled (averaged in at 0)						
74+24E 1+005	0.36	0.07	0.01	0.03	tr		6.4	
74+58E 1+005	3.67	0.07	0.16	0.04	tr		5.7	
74+92E 1+005	0.69	0.04	0.00	0.04	tr		13.0	
75+30E 1+005	0.04	0.03	Nil	0.05	Nil		14.5	
75+70E 1+005	0.14	tr	Nil	0.04	tr	tr	3.0 Sludge	
76+39E 1+055	0.03	0.01	0.01	0.03	Nil		6.8	
77+18E 1+105	0.05	0.01	0.02	0.15	tr		17.3	

Conclusions

The tungsten zone at 75+00E has a strike length of 190 ft. and is open to the west. East of line 75+00E the mineralization is weak and not of economic potential.

The showings with cut samples between 24+00E and 27+90E are of short strike length and should not be considered as a single continuous zone.

The grab samples indicate tungsten to molybdenum ratios south of the base line are 23 to 2000 and those north of the base line range from 1 to 100.

SCHEDULE OF ADDRESSES

UNION CARBIDE EXPLORATION CORPORATION
SUITE 930- 800WEST PENDER STREET, VANCOUVER, B.C.

ST. JOSEPH EXPLORATIONS LIMITED
90 EGLINTON AVENUE WEST, SUITE 505, TORONTO, ONTARIO

ALSO BOX 350 COBALT, ONTARIO, POJ 1CO

CHRISTOPHER HARRISON (GEOLOGIST)
94 DAVENPORT ROAD, APT.210, TORONTO, ONTARIO

DOUGLAS R. ROBINSON (GEOLOGIST)
~~Box 664, COBALT, ONTARIO, POJ 1CO~~
BOX 1125, HAILEYBURY, ONT. POJ1CO

C E R T I F I C A T E

I, DOUGLAS ROBINSON, OF HAILEYBURY, IN THE PROVINCE OF ONTARIO, IN THE DISTRICT OF TEMISKAMING, DO HEREBY CERTIFY AS FOLLOWS:

- 1 - THAT I AM A GEOLOGIST AND RESIDE AT 357 LAWLOR STREET, HAILEYBURY, ONTARIO.
- 2 - THAT I GRADUATED IN 1970 FROM HAILEYBURY SCHOOL OF MINES, HAILEYBURY, ONTARIO, WITH A TWO YEAR DIPLOMA IN MINING TECHNOLOGY.
- 3 - THAT I GRADUATED IN 1975 FROM QUEEN'S UNIVERSITY, KINGSTON, ONTARIO WITH AN HONOURS D.Sc. DEGREE IN GEOLOGICAL SCIENCES. (FACULTY OF APPLIED SCIENCE)
- 4 - THAT I AM A MEMBER OF THE ASSOCIATION OF PROFESSIONAL ENGINEERS OF ONTARIO.



Douglas R. Robinson
DOUGLAS R. ROBINSON



900

2.3440(A)
2.3440(A)



RECEIVED

SEP - 5 1980

Ministry of Natural Resources
Office of the Mining Recorder
Ontario Government Bldg.
199 Larch Street
Sudbury, Ontario, P3E 5P9
September 4, 1980
Supervisor, Projects Unit
Mining Lands Section
Ministry of Natural Resources
Room 1617, Whitney Block
Queen's Park, Toronto
M7A 1W3

Notification of recording **MINING LANDS SECTION**

of assessment work credits

Date of recording of work: September 4, 1980

Recorded holder: St. Joseph Exploration Ltd.
90 Eglinton Ave. W., Toronto, Ont., M4R 2E4
Address: Box 350, Cobalt, Ont., P0J 1C0

Township or Area: Foster Township

Type of survey and number of Assessment days credit per claim	Mining claims
Geophysical	S.398134-35-36
Electromagnetic _____ days	
Magnetometer _____ days	
Radiometric _____ days	
Induced polarization _____ days	
Section 86 (18) <u>58</u> days	
Geological _____ days	
Geochemical _____ days	
Man days <input checked="" type="checkbox"/> Airborne <input type="checkbox"/>	
Special provision <input type="checkbox"/> Ground <input checked="" type="checkbox"/>	

Notice to recorded holder:

- Survey reports and maps in duplicate must be submitted to the Projects Unit, Toronto within 60 days from the date of recording of this work.
- Reports and maps are being forwarded to the Projects Unit with this letter.

Ed 24/80
[Signature]
Mining recorder

c.c. St. Joseph Exploration Ltd. Toronto
c.c. St. Joseph Exploration Ltd. Cobalt

L.D



BOND/R-CLEGG & CO. COMPANY LTD.

764 BELFAST ROAD, OTTAWA, ONTARIO, K1G 0Z5 PHONE: 237-3110 TELEX: 053-3548

REC'D JAN 17 1980
INVOICE: C 10594

St-Joseph Explorations Limited,
90 Eglinton Avenue West,
Toronto, Ontario.
M4R 2E4

DATE: January 14, 1980

REPORT NO: 2458-79

PROJECT: Postung 3115

Rock Samples

89	Analyses of Copper	@ \$1.50	\$133.50
89	Analyses of Zinc	@ 0.65	57.85
89	Analyses of Molybdenum	@ 0.65	57.85
89	Analyses of Silver	@ 0.65	57.85
89	Analyses of Fluorine	@ 3.75	333.75
89	Analyses of Tungsten	@ 3.50	311.50
89	Sample Preparation	@ 1.75	155.75
			<u>\$1,108.05</u>
	Less 20% Contract Discount		<u>221.61</u>
			\$886.44
	Shipping Charges		<u>18.50</u>
			<u>\$904.94</u>

TOTAL

RECEIVED	
CHECKED	
CODE	315
APPROVED	<i>[Signature]</i>

2108-101
[Stamp]

Wm

BONDAR-CLEGG & COMPANY LTD.

LEFAST ROAD, OTTAWA, ONTARIO, K1G 0Z5 PHONE: 237-3110 TELEX: 053-3548

REC'D FEB - 1 1980

INVOICE: C 113313

DATE: January 30, 1980

REPORT NO: A-75-80

PROJECT:

St-Joseph Explorations Limited,
90 Eglinton Avenue West,
Toronto, Ontario.
M4R 2E4

12

Analyses of Tungsten

@ \$9.00

\$108.00

RECEIVED	
CHECKED	
CODE	
APPROVED	

14

THIS IS A PROFESSIONAL SERVICE
ACCOUNTS DUE WHEN RENDERED

X-RAY ASSAY LABORATORIES LIMITED

1885 LESLIE STREET, DON MILLS, ONTARIO M3B 3J4

INVOICE 6209 REF. FILE 2426-M6

05-DEC-79

TO: ST. JOSEPH EXPLORATIONS LTD.,
ATTN: D. ROBINSON,
90 EGLINTON AVE. W., SUITE 505,
TORONTO, ONTARIO.
M4R 2E4

6 ROCKS, 1 SLUDGE PROJECT: 3115 SUBMITTED ON 19-NOV-79
WERE ANALYSED.

Table with 4 columns: METHOD, UNIT COST, AMOUNT. Rows include AU OZ/TON, CU %, ZN %, MOS2 %, AG OZ/TON, W % with corresponding costs and amounts.

SHIPPING/DELIVERY CHARGES

\$ 241.50
4.00

INVOICE PLEASE PAY THIS AMOUNT.

\$ 245.50

RECEIVED CHECKED CODE 3115 APPROVED [Signature]

29190

TERMS NET 30 DAYS

764 BELFAST ROAD, CATAWA, ONTARIO, K1G 0Z5 PHONE: 237-3110 TELEX: 053-3548

REC'D JAN 21 1980

St-Joseph Explorations Limited
90 Eglinton Avenue West
Toronto, Ontario
M4R 2E4

INVOICE: C 10667

DATE: January 18, 1980

REPORT NO: 2458-79

PROJECT: 3115 Fostung

Rock Samples

89

Analyses of Tin	@ \$3.25	\$289.25
Less 20% Contract Discount		<u>57.85</u>

Total \$231.40

RECEIVED	
CHECKED	
CODE	3115
APPROVED	<i>[Signature]</i>

[Stamp]
2108

[Signature]

[Signature]

dr

THIS IS A PROFESSIONAL SERVICE
ACCOUNTS DUE WHEN RENDERED

X-RAY ASSAY LABORATORIES LIMITED REC'D DEC - 7 1979

1885 LESLIE STREET, DON MILLS, ONTARIO M3B 3J4

INVOICE 6212 REF. FILE 2430-M6

05-DEC-79

TO: ST. JOSEPH EXPLORATIONS LTD.,
ATTN: R. JACKSON,
90 EGLINTON AVE. W., SUITE 505,
TORONTO, ONTARIO.
M4R 2E4

37 ROCKS PROJECT: 3115 SUBMITTED ON 19-NOV-79
WERE ANALYSED.

	METHOD	UNIT COST	AMOUNT
37 CU %	XRF	4.50	166.50
37 ZN %	XRF	5.00	185.00
37 MOS2 %	XRF	7.00	259.00
37 AG OZ/TON	FA	5.00	185.00
37 W %	XRF	9.00	333.00

SHIPPING/DELIVERY CHARGES

\$ 1128.50
11.75

\$ 1140.25 *fa*

INVOICE PLEASE PAY THIS AMOUNT

RECEIVED	
CHECKED	
CODE	3115
APPROVED	<i>R. M. [Signature]</i>

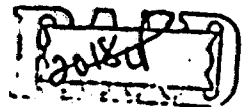

TERMS NET 30 DAYS

Foster Township
 St. Joseph Explorations Ltd.
 June 5, 1980. JUNE 5/80
 Assay Rept. ASSAY RPT

FOSTER TWP.
 ST JOSEPH EXPL. L.
 Nairn Twp. - M.883

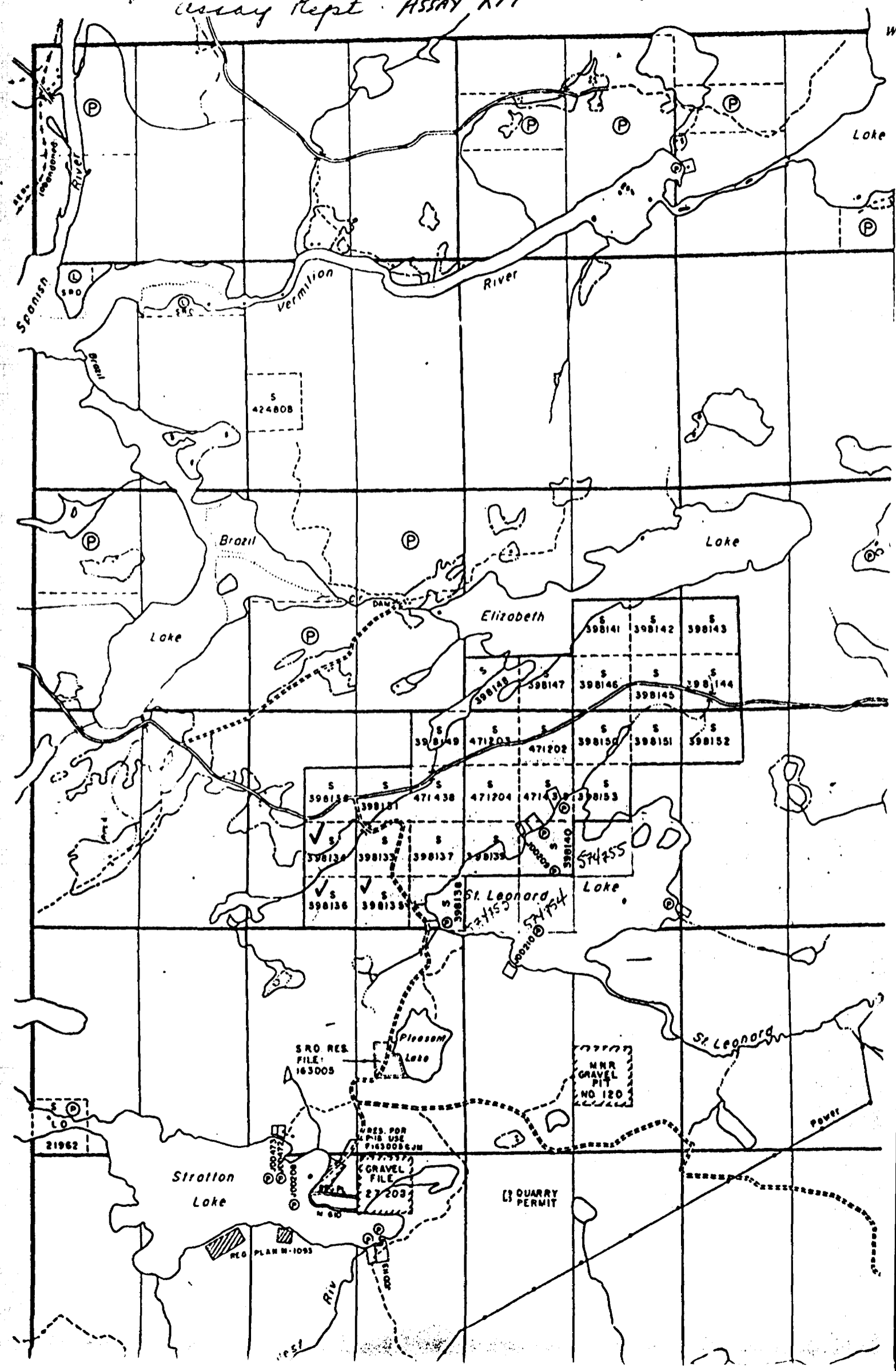

SEE ACCOMPANYING
MAP(S) IDENTIFIED AS

FOSTER-0015-B1, #1

LOCATED IN THE MAP
CHANNEL IN THE FOLLOWING
SEQUENCE (X)

