



010

Diamond Drilling

Township of Merritt

Report No: 10

Work performed by: Wilfred Lacelle

Claim No	Hole No	Footage	Date	Note
S 138180	22XC	41.0'	Oct/67	
	23XD	24.5'	Oct/67	
	24XC	13.5'	Oct/67	
S 134084	21XL	59.0'	July/67	
	25XC	40.0'	Oct/67	
S 138181		22.0'	Nov/67	
S 134085		35.0'	Dec/67	

7 DH 23 5.0 FT

Notes:

Nov. 25, 1967

Work performed on Claim No. S-138180 in MERRITT TWP
Lot 1 Conc. 6, Was drilled on Oct. 11-12, 1967 for
DDD # 23XD

DDH # 22XC was drilled on Oct. 5,6,7 & 8, 1967

DDH # 24XC was drilled on Oct. 17 & 18, 1967

All drilling done by myself -
Wilfred Lacelle (Lic. 29172)
of Massey, ONt (no helper)

**DUPLICATE COPY
POOR QUALITY ORIGINAL
TO FOLLOW**

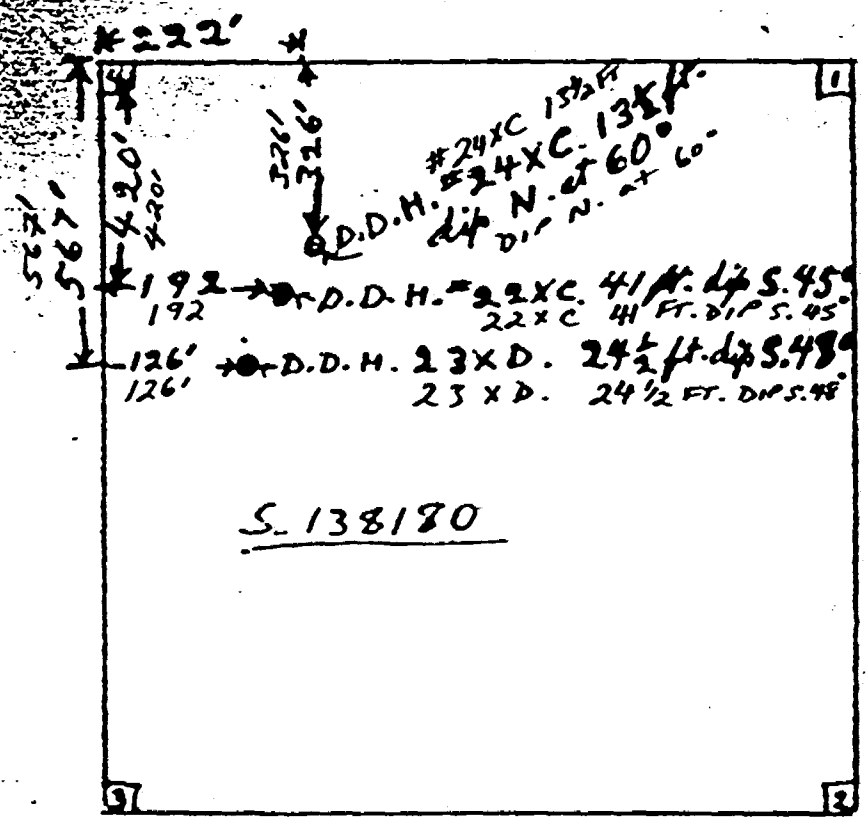

Nov. 25, 1967.

Work performed on Claim
No. S. 138180 in Merritt Twp. Lot,
Con. 6, Was drilled on Oct. 11th-12th
1967 for D.D.H. # 23XD.

D.D.H. #22XC. Was drilled on Oct. 5th, 6, 7th
and 8th 1967

D.D.H. #24XC. Was drilled on Oct. 17th and
18th, 1967.

All drilling done by myself -
Wilfred Lucelle (Lic. 29172) of
Morray, Ont.
(No helper)

Total drilled on this claim is 77 feet,
of 7/8 in. core.
Core left at each hole.

Total drilled on this claim is 77 feet
of 7/8 in core
Core left in each hole

Nov. 10, 1967

Work performed on Claim No. S-134084 in Lot 1 Con.5
Merritt Twp.

DDH # 21XL - 59 ft. dip south at 46° was drilled on
July 14,15,17 and 18, 1967

DDH # 25XC 40 ft. dep north at 49° was drilled on
Oct. 24,25 & 26, 1967

All drilling done by myself : Wilfred Lacelle
(Lic. No. 29172) of
Massey, Ont. with my own
drilling equipment.

I had one helper for five days only

Measurement done by stepping.

**DUPLICATE COPY
POOR QUALITY ORIGINAL
TO FOLLOW**



Nov 10 1967

Work performed on
Claim No. S-134084 in Lot 1. Co. 5,
Merrill Twp.

D.D.H. #21XL 59ft. dip South at 46°, was
drilled on July 14th, 15, 17, and 18th, 1967

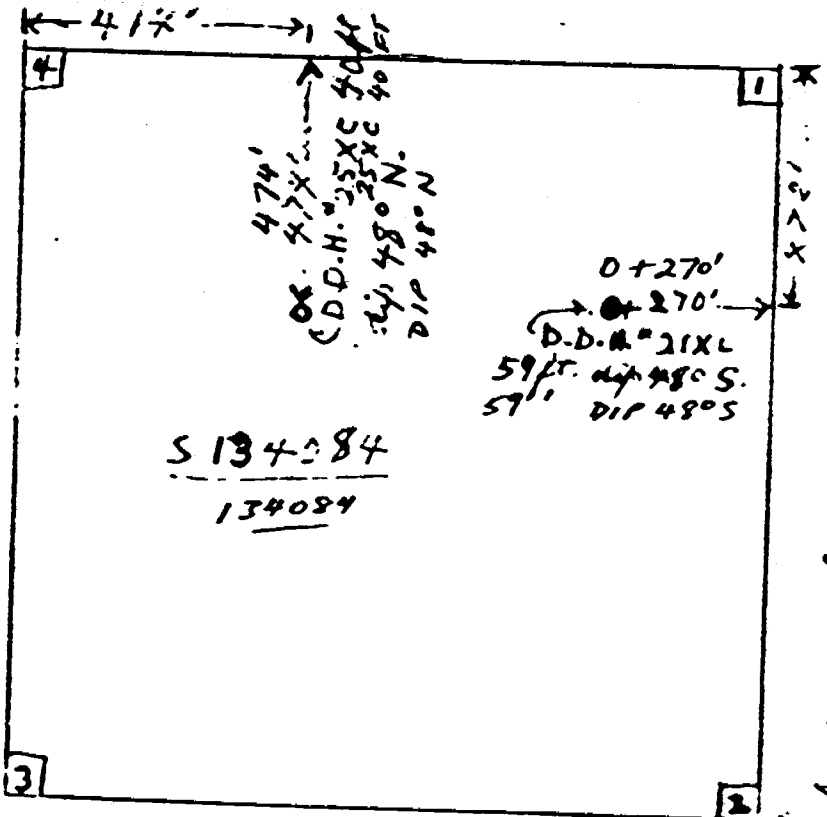

D.D.H. #25XC 40ft. dip North at 48°
Was drilled on October 24th, 25th and 26th
1967.

All drilling done by myself
Wilfred Lucille (Lic. No. 29172) of
Messy, Ont. With ~~my~~ own
drilling equipment.
I had one helper for five days conty.
■ surveyor.

TOTAL DRILLED ON THIS CLAIM
99 FT OF 7/8" CORE.
CORES LEFT AT EACH DRILL HOLE

Total drilled on this Claim
99 ft. of 7/8" Core.
Cores left at each drill hole

(MEASUREMENT DONE BY STEPPING)
5' measurement done by
stepping.

6

← 5 →

4

Nov. 25, 1967

Work performed on this claim (S-138181 was staked
by W. Lacelle and recorded Licence # 29172, Massey, Ont.
I performed the work, Drilling 2.2 feet hole and blasting
them, and cleaning the pit. No helper. Work done from
November 17-20th, 1967.

Measurement done by stepping.

**DUPLICATE COPY
POOR QUALITY ORIGINAL
TO FOLLOW**

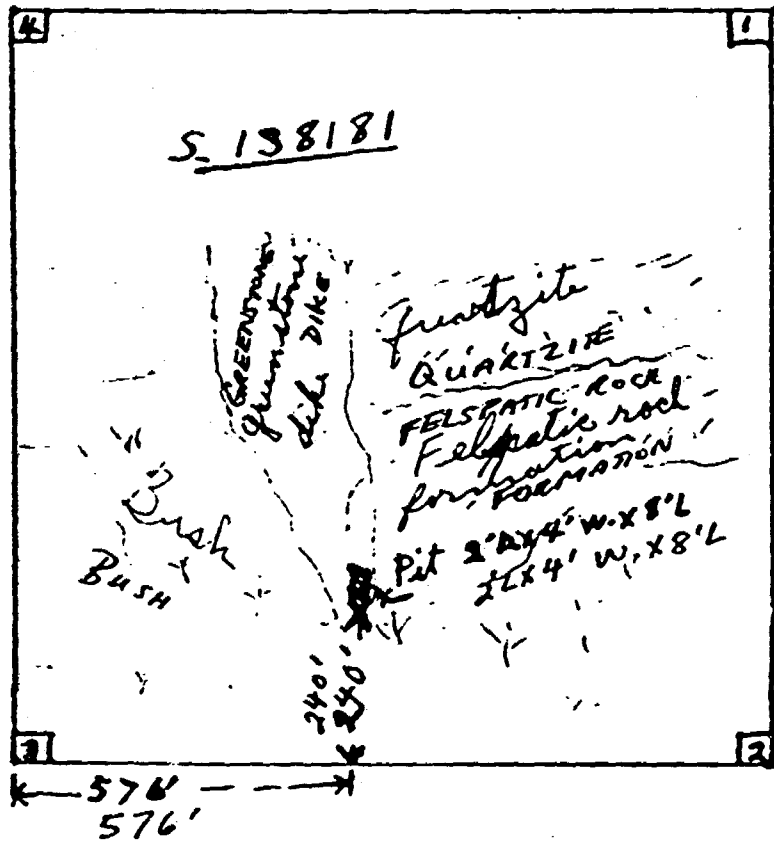

Nov. 25, 1967

Work performed on
 This Claim (S. 138181) - Surveyor's Post
 was staked by W. Lacle and recorded
 License # 29172, Manly, Ont. I performed the
 work: Drilling 2, 2 foot hole and blasting
 them, and cleaning the pit, no top.
 Work done from November 17 - 20
 1967.

in
 Merritt Twp.

(Measurement done by stepping.)

6

5

4

Jan. 3, 1968

Work performed on claim No. S-134085 in Merritt Twp
Lot 1, Conc. 5 by myself (Wilfred Lacelle, Lic.C-29172)
Massey, Ont.

One (1) DDH dipping south at 65° 35 feet deep in rock,
plus 40 in. casing below ground surface, making a total
of 38.4 feet.

Drilling was done from December 14-21st, 1967

The trench 5'W x 12'L x 3'D was dug out on Dec. 29-30,
1967 and Jan. 2nd & 3rd, 1968. Making a total of 4
days of 7 hours each.

**DUPLICATE COPY
POOR QUALITY ORIGINAL
TO FOLLOW**

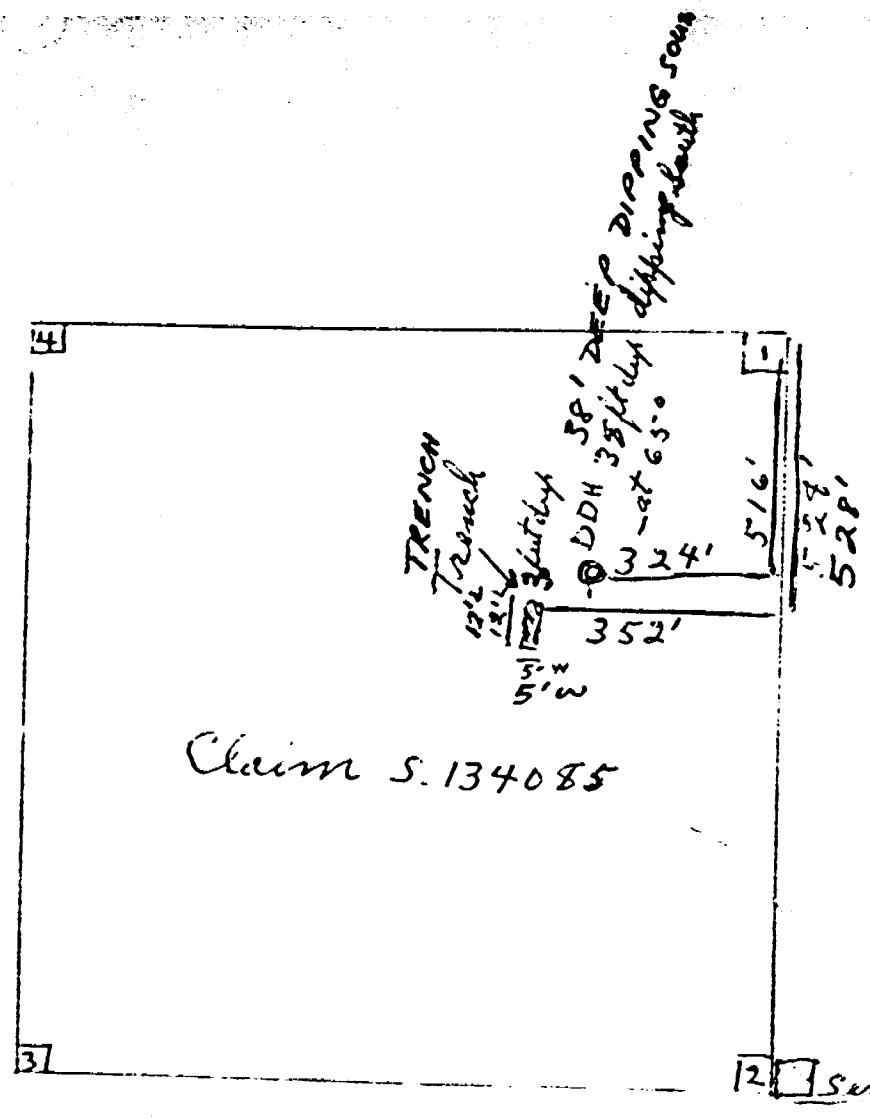

Jan. 8, 1968

Work performed on claim
no. S-134085 in Merritt Twp.
Lot 1 sec 5 by (myself)
Wilfred Lucelle Lic. C. 29172
Massey, Ont.

S - 134085
35' DEEP.

One (1) DDH dipping south at 65°
35 ft. deep ^{in rock} plus 40 in. casing below
ground surface, making a total
of 38.4 feet.

Drilling was done, from
December 14th to 21st 1967.

The trench 5' W x 12' L x 3' D was
dug out on Dec. 29 & 30th 1967 and
Jan. 2nd & 3rd 1968. - making a
total of 4 days of 7 hours each.

1936

Work performed on claim S - 138180
Merrit Township,

Sudbury Mining Division.

By:- W. Lacelle, Box 178 Massey, Ont

C. Lacelle Massey, Ont

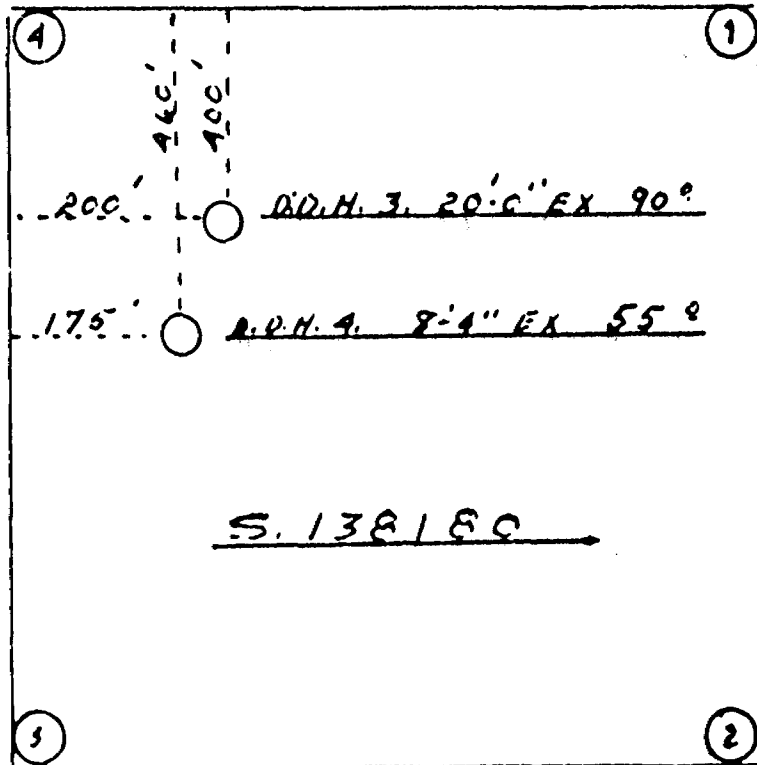

Diamond drilled 28'4" 15/16" dia.
core left on claim

MARCH 1ST 1962

W. Lacelle

1966

Group of 4 claims in Merrit Township,
Sudbury Mining Division
Recorded by; - Wilfrid Lacelle
Box 173 Massey, Ontario
License number, C-29172

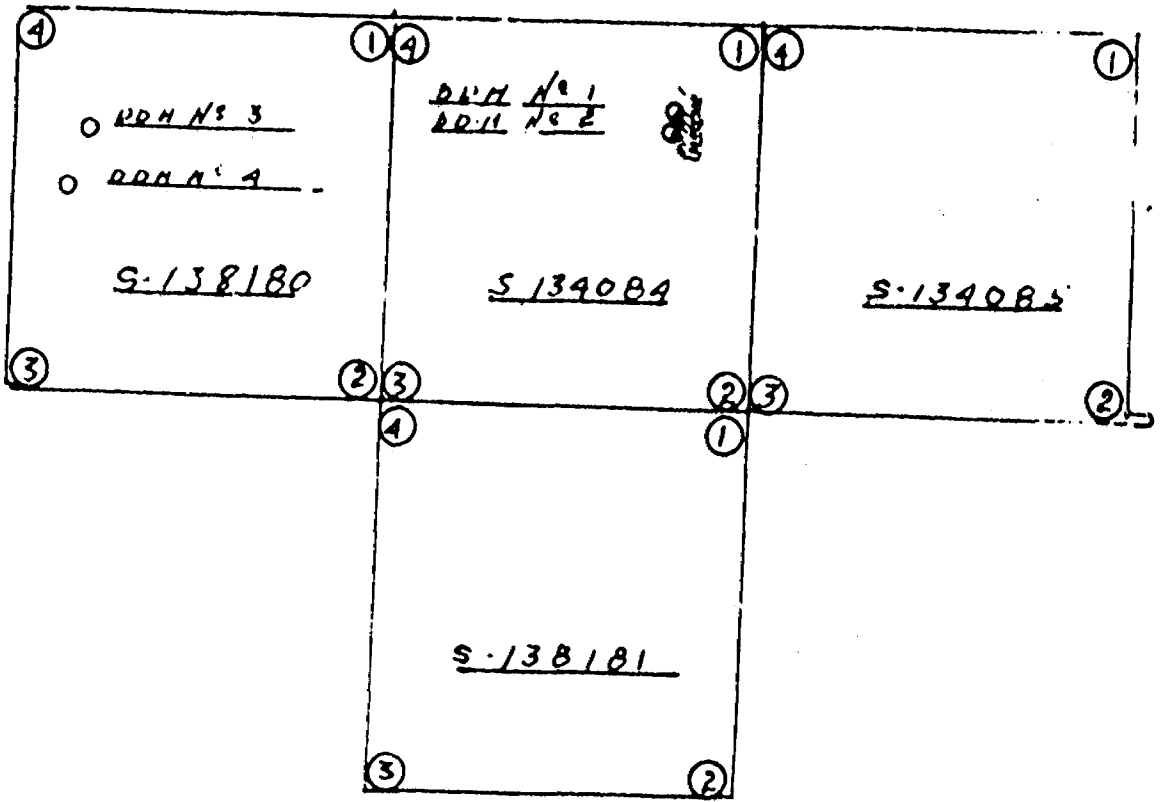

MARCH 1st 1967

W. Lacelle

SECTION
6

SECTION
5

SECTION
4



900

IMPORTANT

Attach sketch showing location of work in relation to corner posts, and nature and extent thereof.

THE MINING ACT



REPORT OF WORK

Merritt Sup C

To the Recorder ofSudbury..... Mining Division:

I,Wilfrid Lacelle.....
(Name of Applicant)
.....Box. 178 Massey, Ontario.....
(Post Office Address)

the recorded holder of mining claim No. ...S. 134084..... S. 138180..... hereby report the performance of ^{M.L.} 128 days' work not before reported, to be applied to this claim.

*This mining claim is one of a group of contiguous claims numbered ...S. 134034..... S. 138180.....

of which I am the recorded holder under Mining License No. C. 29172 and the work was performed on mining claim(s) S. 134084..... S. 138180 and is to be applied in respect of mining claim(s) S. 134084 (68 days)..... S. 138180 (60 days)
(*Complete above section only if applicable)

The work is as follows:
Stripping or opening up mines, sinking shafts or other actual mining operations

The names and addresses of the men who performed the work and the dates upon which each man worked in its performance are: (If more space is required, attach list).

.....Wilfrid Lacelle..... Massey, Ont.
.....C. Lacelle..... Massey, Ont.

List Attached

Total No. of days128.....

Diamond or other Core Drilling

Footage drilled32'6"..... No. of holes drilled4..... Angle90% and 55%.....
Diameter of core1 5/16"..... Names and addresses of owner and operator of drillW. Lacelle..... C. Lacelle.....

Dates upon which drilling was doneSeptember 6th to Sept 17/1966.....
(Core log and Sketch in duplicate by core examiner accompanies this Report.)

Total No. of days8days.....

Work by Compressed Air or other Power Driven Rock Drill or Mechanical Equipment.

Type of drillPack Sack.....
Names and addresses of men engaged in operating drill.

Dates upon which each man worked
Total No. of days128.....

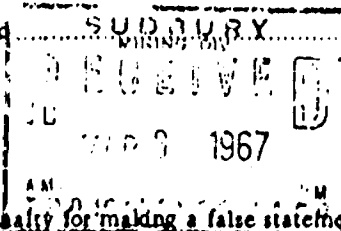

The penalty for making a false statement in this certificate is \$500. or six months imprisonment or both.

P-138180

1966

Work performed on claim S - 134084
Merritt Township,
Sudbury Mining Division.
By-; W. Lacelle, Box 178 Massey, Ont.
C. Lacelle, Massey, Ont.

N

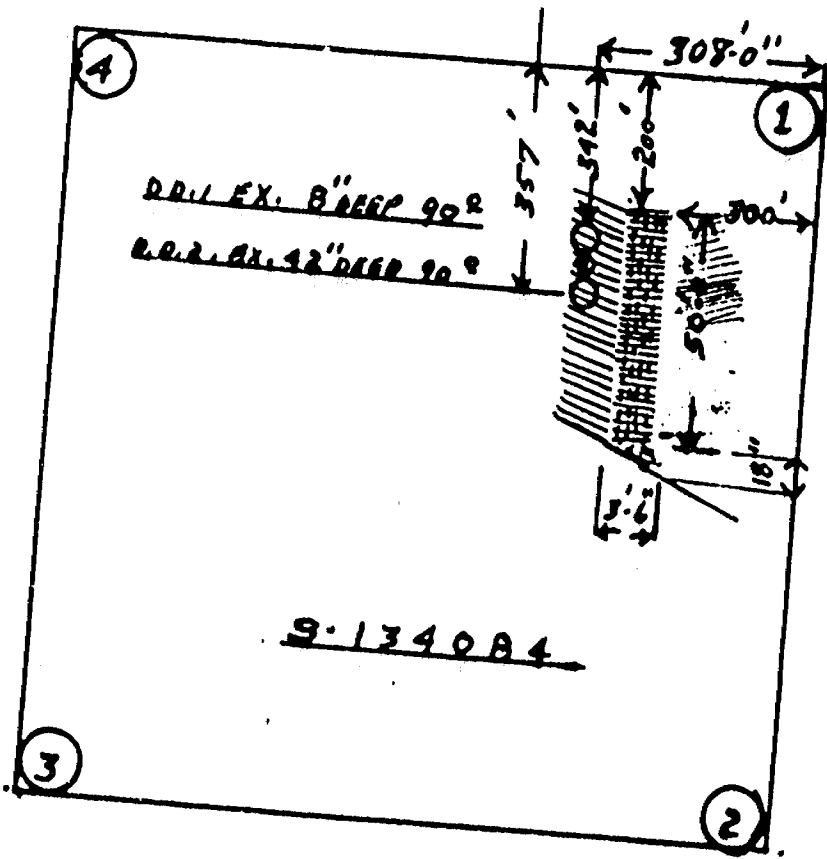

Stripping 50' X 3'-6" X 0" to 18" deep
Chipping strip above with hand chisel
to remove surface of bedrock.

50" of 15/16" core left on above claim

MARCH 1ST 1967

W. Lacelle



ONTARIO

THE MINING ACT REPORT OF WORK

A separate form is required for each type of work to be recorded.

To the Recorder of Sudbury Mining Division

I, Wilfred Lacelle name of Recorded Holder C-29172 Miner's Licence Box 178, Massey, Ont

do hereby report the performance of 68.25 Post Office Address days of Diamond drilling, Manual Labour type of work

not before reported to be applied on the following contiguous claims

Table with 6 columns: Claim No., Days, Claim No., Days, Claim No., Days. Rows include S-138180 (17 days), S-134084 (20.5 days), S-138181 (11 days), S-134085 (30 days).

DUPLICATE COPY POOR QUALITY ORIGINAL TO FOLLOW

All the work was performed on Mining Claim (s) 134084 (38.5 days) 138180 (29.75 days) (In the case of geological and/or geophysical survey (s) where more than 18 claims are involved attach a schedule)

READ CAREFULLY: THE FOLLOWING INFORMATION IS REQUIRED BY THE MINING RECORDER.

- For Manual Work, Stripping or Opening up of Mines, Sinking Shafts or Other Actual Mining Operations - Names and addresses of the men who performed the work and the dates and hours of their employment. For Diamond and other Core Drilling - Footage, No. and angle of holes and diameter of core. Name and address of owner or operator of drill. Dates when drilling was done. Signed core log and sketch in duplicate. For Compressed Air or Other Power Driven or Mechanical Equipment Type of drill or equipment. Names and addresses of men engaged in operating equipment and the dates and hours of their employment. For Power Stripping - Type of equipment. Name and address of owner or operator. Amount expended. Dates on which work was done. Proof of actual cost must be submitted within 30 days of recording. With each of the above types of work sketches are required to show the location and extent of the work in relation to the nearest claim post. In the case of diamond or other core drilling the sketch must be submitted in duplicate. For Geophysical, Geological, Geochemical Surveys and Expenditure Credits - the name of author of report. Covering dates of survey (linecutting & office). Type of instrument used. Total amount of expenditure. Technical reports, maps, expenditure breakdown, receipts must be filed in duplicate with the Minister within 60 days of recording. For Land Survey - the name and address of Ontario Land surveyor.

The Required Information is as Follows: (Attach a list if this space is insufficient)

Footage of diamond core drilling this year (1967) in my Merritt Twp claims done on Claim S-134084 and 138180

Labour for drilling 180 hours for core splitting and sampling 14 hrs. 194 hrs.

I use my own diamond drill. Had a helper for 7 days only.

Date Nov. 15, 1967 Signature of Recorded Holder or Agent

The Mining Act Certificate Verifying Report of Work

I, Wilfred Lacelle Box 178, Massey, Ont (Post Office Address)

hereby certify:

- 1. That I have a personal and intimate knowledge of the facts set forth in the report of work annexed hereto, having performed the work or witnessed same during and/or after its completion. 2. That the annexed report is true.

Dated Nov. 15, 1967 Signature

THE PENALTY FOR MAKING A FALSE STATEMENT IN THIS REPORT AND/OR CERTIFICATE IS \$500. OR SIX MONTHS IMPRISONMENT OR BOTH



ONTARIO

THE MINING ACT REPORT OF WORK

Merritt C

A separate form is required for each type of work to be recorded.

To the Recorder of *Sudbury* Mining Division

I, *Wilfred Lacelle* name of Recorded Holder C-29172 Miner's Licence

Box 178 Post Office Address

do hereby report the performance of *6.75* days of *D. Drilling, 1/2 in. hole* type of work

not before reported to be applied on the following contiguous claims

Claim No.	Days	Claim No.	Days	Claim No.	Days
<i>5-12790</i>	<i>12</i>				
<i>5-12791</i>	<i>20</i>				
<i>5-12792</i>	<i>11</i>				
<i>5-13405</i>	<i>20</i>				

5.5 day
29.75 day

Attach with this report Mining Claim (s) *13404 and 13406* and/or geophysical survey (s) where more than 18 claims are involved attach a schedule

THE FOLLOWING INFORMATION IS REQUIRED BY THE MINING RECORDER.

- For Work Done in the Opening up of Mines, Starting Up or Shutting Down Mining Operations - Names and addresses of the men who performed the work and the dates and hours of their employment.
- For Core and other Core Drilling - Footage, No. and angle of holes and diameter of core. Name and address of owner of motor of drill. Dates when drilling was done. Signed core log and sketch in duplicate.
- For Work Done by Motor Driven or Mechanical Equipment - Names and addresses of men engaged in operating equipment and the dates and hours of their work. Type of equipment. Name and address of owner or operator. Amount expended. Dates on which work was done. Reports and maps to be submitted within 30 days of recording.
- For Work Done by Hand Driven or Mechanical Equipment - Names and addresses of men engaged in operating equipment and the dates and hours of their work. Type of work. Sketches are required to show the location and actual depth work is done. In the case of diamond or other core drilling the sketch must be submitted in duplicate.
- For Geological and Geophysical Survey - The names and addresses of men employed as well as dates. Type of instrument used in the case of geophysical survey. Reports and maps in duplicate must be filed with the Minister within 60 days of recording.
- For Lead Survey - the name and address of Ontario Land surveyor.

The Required Information is as Follows: (Attach a list if this space is insufficient)

*Footage of diamond core drilling this year (1967) ^{in my} *Merritt**
Imp. claim ~~is not done~~, done on Claims 5-13404 & 138180
Labor for drilling 180 hours, for core splitting and sampling 14
hours
Total 194 hrs. Had a helper for 7 days
I use my own diamond drill. Only.
 Date *Mar 15, 1967* Signature of Recorded Holder or Agent *W. Lacelle*

The Mining Act Certificate Verifying Report of Work

I, *Wilfred Lacelle*
Box 178 (Post Office Address)

hereby certify:
1. That I have a personal and intimate knowledge of the facts set forth in the report of work annexed hereto, having performed the work or witnessed same during and/or after its completion.
2. That the annexed report is true.

Dated *Mar 15* 19*67*

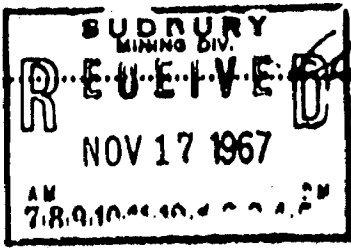

W. Lacelle Signature

13404

THE PENALTY FOR MAKING A FALSE STATEMENT IN THIS REPORT AND/OR CERTIFICATE IS \$500. OR SIX MONTHS IMPRISONMENT OR BOTH

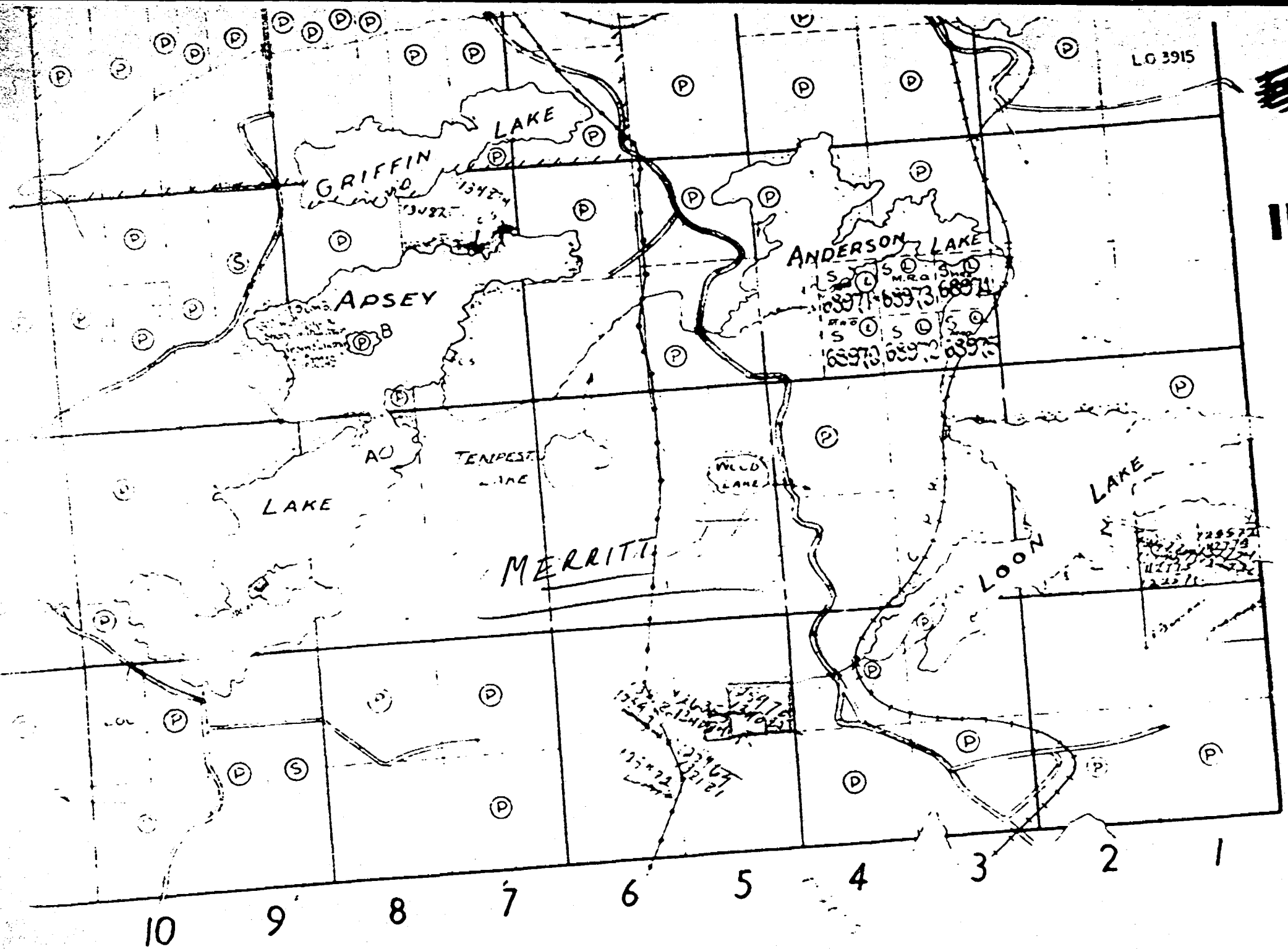

FOSTER

Grav
of H
TOWN