



41104NE0046 63.5907 ROOSEVELT

010

ASSESSMENT REPORT

J. White Claims

Roosevelt Township

Sudbury Mining Division

District of Sudbury

NTS 411/04

**Work Performed
Sept. - Oct. 1991**

**C. Butella
Shawonis Explorations Ent. Ltd.**

ASSESSMENT REPORT

WHITE CLAIMS

Location:

The J. White claim group consists of eleven (11) contiguous unpatented mining claims located in the Leech Lake area immediately south of Plunge Lake, in the western part of Roosevelt Township, Sudbury Mining Division, District of Sudbury. (NTS sheet 41I/04). The property is situated approximately 12 miles (19.4 km) southeast of Espanola and about 34 miles (54.7 km) southwest of Sudbury. It covers the area of approximately latitudes 46 degrees, 09' 22" to 46 degrees 10' 23" and longitudes 81 degrees 31' 15" to 81 degrees, 33' 15".

Access:

Access to the property was via Highway 6, from Espanola, 8 miles (12.9 km) south to the intersection of the Lang Lake Resort gravel road for the Allard crew, and approximately 22 miles (35.4 km) north from Little Current along Highway 6 to the Lang Lake road intersection for Shawonis personnel. From the intersection of Highway 6 and the Lang Lake Road, it is approximately 1.8 miles (3 km) southeast along gravel road to the government dock on Lang Lake, where access to the property is obtained by water taxi through Lang Lake to the southwest bay of Plunge Lake. At this point, a rented 12 foot aluminum boat was used to ferry the crew party through the shallows to the northern boundary of the claim group. A trail of 2,310' (704 m) to the north shore of Leech Lake

J. White Claim Group,
Roosevelt Township

Location and Geology Map

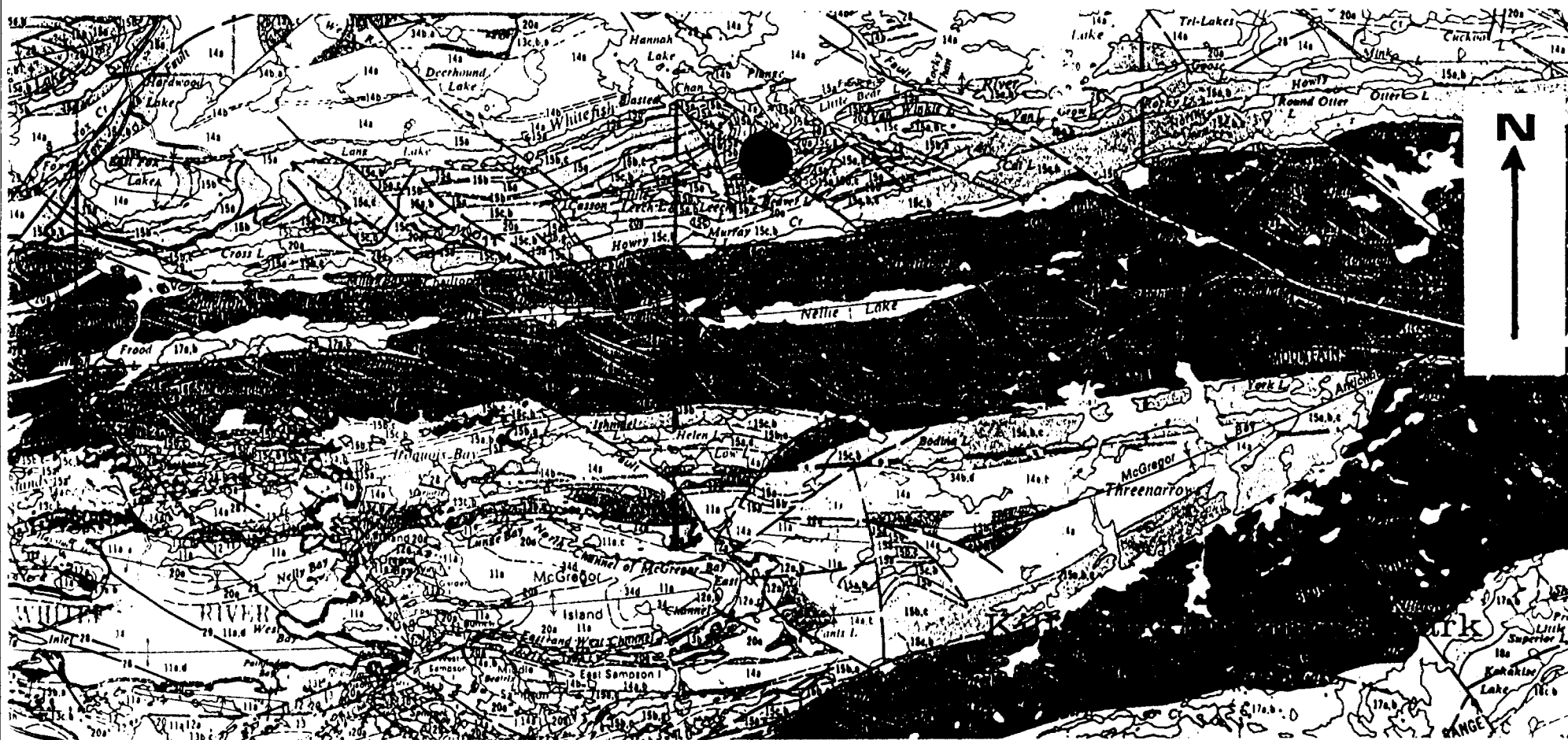

ken from: Ontario Geological Survey Map 2360
Sudbury-Manitoulin, Sudbury and
Manitoulin Districts

Scale: 1:126,720 or
1 inch to 2 miles.

Figure 1.



TABLEAU D'ARRONDISSEMENT DU SYSTÈME NATIONAL DE RÉFÉRENCE CARTOGRAPHIQUE

41 00	41 05	41 05
41 05	41 05	41 05
41 05	41 05	41 05

INDEX TO ADJOINING MAPS OF THE NATIONAL TOPOGRAPHIC SYSTEM

WHITEFISH FALLS
41-1/4
EDITION 3

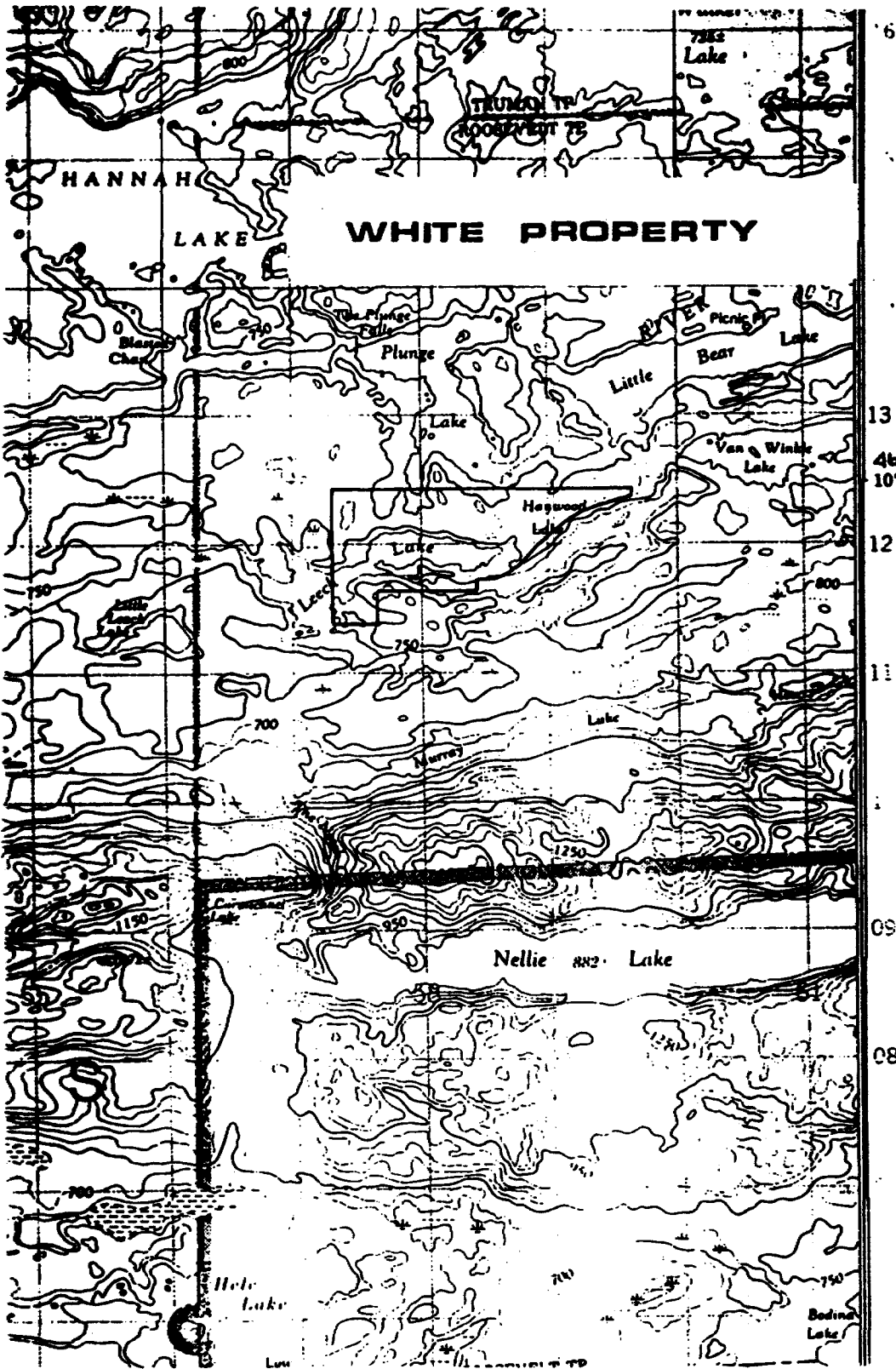
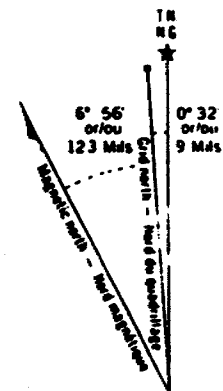

Use diagram only to obtain numerical values.
APPROXIMATE MEAN IN CLINATION (Mds)
FOR CENTRE IN MAP
Annual change decreasing 0.0

Utiliser le diagramme que pour obtenir les valeurs
DECLINAISON MOYENNE APPROXIMATIVE
AU CENTRE DE LA CARTE EN (Mds)
Variation annuelle décroissante 0.0

ONE THOUSAND METRE
UNIVERSAL TRANSVERSE MERCATOR GRID
ZONE 17
QUADRILLAGE DE MILLE MÈTRES
TRANSVERSE UNIVERSEL DE MERCATOR

provides access to the claims along both shores of Leech Lake via another 12 foot aluminum boat cached near the south end of the trail.

Claim Group:

The recorded holder of the claim group located in Roosevelt Township, as shown in Figure 2, Claims Location, is Mr. James William White of Box 71, Whitefish Falls, Ontario, POP 2H0. Mr. White currently holds Ontario Prospectors Licence No. C33855.

The claim numbers for the group of eleven contiguous unpatented mining claims are as follows:

S854861	Recorded May 26, 1986
S854862	Recorded May 26, 1986
S854863	Recorded May 26, 1986
S721041	Recorded November 18, 1983
S721042	Recorded November 18, 1983
S791264	Recorded May 15, 1984
S791266	Recorded May 15, 1984
S791269	Recorded July 24, 1984
S994574	Recorded May 13, 1988
S398278	Recorded October 17, 1980
S398279	Recorded October 17, 1980

Work recorded in this report is to be applied to claims S854861 to S854863 inclusive at a total expenditure equivalent to 59.74 man days per claim and to claim number S994574 for an

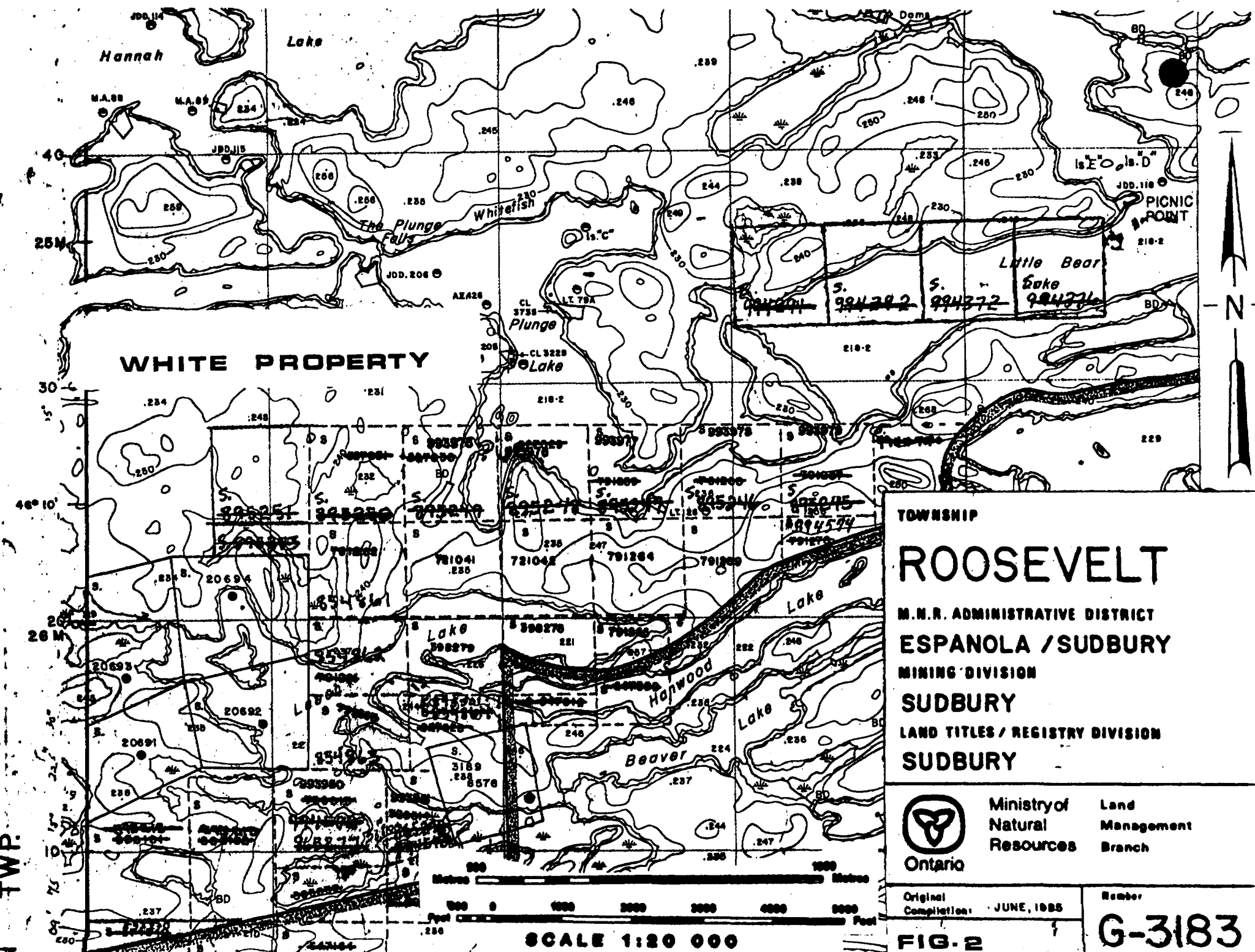

WHITE PROPERTY

TOWNSHIP
ROOSEVELT
 M.N.R. ADMINISTRATIVE DISTRICT
ESPANOLA / SUDBURY
 MINING DIVISION
SUDBURY
 LAND TITLES / REGISTRY DIVISION
SUDBURY



Ministry of
 Natural Resources
 Land Management
 Branch

Original Completion: JUNE, 1985

Number
G-3183

SCALE 1:20 000

FIG. 2

TWP.

expenditure equivalent of 35.50 man days. Any excess assessment expenditure work credits are requested at this time to be applied towards claim numbers S398278 and S398279 respectively.

WORK PERFORMED:

Prospecting:

Commencing September 27, 1991, a cursory property evaluation and a minor program consisting of limited prospecting, trenching and pitting was undertaken on the White claims. A list of personnel involved in this program has been included.

On September 28, 1991, John Allard accompanied by Del Doe, showed the writer several old workings and significant showings on the property. These areas were lightly prospected and thirteen samples were obtained for assay and future petrographic examination. Brief descriptions of these rock samples immediately follow. Sample locations are shown on Figure 3, Sample Location Map. All assay results are pending.

Rock Descriptions:

- W-91-01: *
- * extremely dense, highly altered (felsic?) siliceous rock
 - * intense fuschite ± olacherite
 - * very f.g. locally somewhat crystalline; massive
 - * minor extremely f.g. disseminated sulfides
 - * weathers tan - orangey brown and green

- W-91-02: * m.g. - c.g. porphyritic quartzitic rock
* contains ~2% blue qtz - eyes
* up to 25% fine disseminations and clusters of sulfide - py, cp ± asp
* contains to 5% sub angular (mm to 2 cm) fragments of very siliceous argillite and cherty rock
* locally bleached weather surface
- W-91-03: * extremely f.g. to f.g. brownish grey coloured quartzite
* o/c is massive
* 10% to 45% diss. vf.g. sulfide - py?
* local light grey coloured siltstone laminations
* weathers buff to lt gy to lt brown
- W-91-05: * moderately dense f.g. dark grey quartzite
* v.f.g. diss. sulfide py ± asp ± marc? to ~ 8%
* sulfide veinlets and fracture fill to 10% locally
* local leached areas
- W-91-06: * massive milky white opaque to slightly locally greyish coloured quartz vein
* 6.5 cm wide
* concoidal fracture; rusty pitted weather surface
* local py blebs to 1 cm dia + local py fract fill
- W-91-07: * blue grey massive to brecciated crystalline qtz vein

with massive sulfide stringers and veins to 6 cm wide

- * py, asp ± local cp. locally to 85-90%
- * local vuggy patches in qtz.
- * also minor diss. + blebs; cubic sulfide to 1 cm

W-91-08: *

- f.g. to m.g. dark greenish grey quartzite
- * contains up to 2 cm greyish quartz veinlets
- * veinlets locally 15%-20% asp
- * blebs and diss. of py 5-10%
- * sulfide content increases near quartz veinlets becomes more massive and appears in stringers to 80% (primarily brecciated py)

W-91-09: *

- similar to W-91-08
- * dark grey green m.g. crystalline, sucrosic textured quartzite
- * 10-15% diss + blebs py, asp. in quartzite
- * local parallel qtz veins to 3 cm-4 cm - massive greyish qtz
- * local limonite ± siderite fractures in quartz
- * py blebs and fracture fill tend to be associated with darker streaks in qtz veins
- * minor asp ± marc?

W-91-10: *

- dark grey to black sucrosic to vitreous quartzite
- * milky qtz veinlets white to grey coloured with blebs

& stringers sulfide generally associated with darker coloured streaks in qtz

- * 5%-25% sulfides as blebs and diss. py + asp
- * locally complete replacement of qtz veinlets by sulfide
- * qtz veinlets 0.5 cm to 2 cm wide

W-91-11: *

- grey to white opaque dull lustred quartz vein
- * limonite + siderite fractures ± hem stain?
- * aspy + py blebs, diss and vug fill

W-91-12: *

- dk grey fig crystalline quartzite with minor cross cutting qtz stringers
- * host to above (W-91-11)
- * massive sulfide replacement py minor asp. to 95%
- locally veins of sulfide to 6 cm wide
- * deep red stain prevalent
- * minor local cp diss & blebs

W-91-13: *

- as above but extremely siliceous
- * multiple qtz veins + silica flooding
- * qtz becomes dark grey to blue grey opaque to smokey looking
- * local blebs stringers & diss. asp. py to 35%
- * generally ≤ 25%

Geology:

The White claim group is underlain by roughly east-west trending metasediments of the Gowganda Formation of the Huronian Supergroup. The Gowganda Formation consists largely of a series of polymictic para and orthoconglomerates containing lenses of quartz feldspar sandstones, argillites, siltstones and greywackes.

In the vicinity of claim 721042 the Gowganda metasediments unconformably overly a quartz feldspar-calcareous sandstone sequence of the Serpent Formation (Quirke Lake Group). Roughly east-northeast trending Nipissing diabase dykes and sills intrude all rocks in the property area.

Trenching:

In an effort to trace the western extension of the sulfide dike located on claims 398278 and 398279, a 37 foot (11.3 m) long trench was excavated to an average width of 8 feet (2.4 m) and an average depth of 5 feet (1.5 m).

The trench exposed a siliceous dark grey to green coloured quartzite containing multiple parallel and cross cutting veins and veinlets of milky to smokey quartz (up to 6 cm wide). Minor argillaceous bands have also been exposed.

Mineralization appears to be in the form of disseminations of sulfide, primarily pyrite and arsenopyrite, with minor chalcopyrite.

The veinwork often contains sulfide blebs and small vugs infilled with massive pyrite ± arsenopynite and what may be marcasite mineralization. Limonite and what appears to be siderite staining are prevalent in some of the veins. Veins appear to be of several ages and associated sulfide mineralization seems to increase near vein contacts that parallel the 276 degree trend of "sulfide dike".

Unfortunately, due to heavy slumping of clay overburden and inclement weather conditions, an accurate map of the trench could not be made at this time. However, grab samples W-91-09 to W-91-13 inclusive were obtained from the trench. Assay results are pending.

Several hand shovelled pits were also dug in order to test the extension of this zone prior to trenching. Deep clay overburden greater than 5 feet prevented any relevant data from being obtained from these sites. The location of both the pits and the trench is shown on the sample Location Map at a scale of 1:5,000.

The trench was blasted using powder sticks and several bags of Amex II explosive. Overburden was removed using a Wajax trash pump and hand shovels.

CONCLUSIONS:

In the past, these claims were explored for gold

mineralization. Any new work would probably continue to target gold as well as the potential for sediment-hosted base metal deposition. Apparently platinum values have also been discovered in the Roosevelt - Curtin Township areas (Independent prospector assays). Results from multi-element analysis for the thirteen samples taken may indicate the direction for targeting minerals on the property, though gold will probably remain the focused commodity.

The best gold values to date have been associated with sulfide mineralization within the quartz rich "sulfide dike" zone (up to 4.65 oz per ton Au.). However, a brief perusal of past results suggests other areas of interest as well.

It is the writer's opinion however that due to insufficient detailed exploration, the economic potential of the property with respect to any commodity remains unknown.

Thus, a detailed program of Phase I exploration is recommended. This program would consist of establishing a cut line grid on the property for control. Geophysical and geochemical testing should be completed over the entire property and detailed geological mapping should tie existing workings into mappable units within property and regional contacts where possible.

**LIST OF PERSONNEL FOR WHITE CLAIMS
WORK REPORT**

NAME	ADDRESS	DAYS WORK	ONTARIO PROSPECTUS LICENCE
Cathy Butella Shawonis Explorations & Ent. Ltd.	R.R. #2, Brantford, Ontario N3T 5L5 (519) 752-3917	11 days	C37071
John Allard	447 St. Joseph Espanola, Ont. (705) 869-3647	8 days	C31481
Dave Bint	Lee Valley Road Espanola, Ont. (705) 869-1142	1 day	
Del Doe	Espanola, Ont. (contact through J. Allard)	4 days	
Russ Hunda	Espanola, Ontario (contact through J. Allard)	1 day	
Paul Sweeney	Espanola, Ontario (contact through J. Allard)	1 day	
Marcel Brunette	Espanola, Ontario (contact through J. Allard)		



62.2701

Personal information collected on this form is obtained under the authority of the Mining Act. This information will be used for correspondence. Questions about this collection should be directed to the Provincial Manager, Mining Lands, Ministry of Northern Development and Mines, Fourth Floor, 150 Cedar Street, Sudbury, Ontario, P3E 6A5, telephone (705) 670-7264.

- Instructions:**
- Please type or print and submit in duplicate.
 - Refer to the Mining Act and Regulations for requirements of filing assessment work or consult the Mining Recorder.
 - A separate copy of this form must be completed for each Work Group.
 - Technical reports and maps must accompany this form in duplicate.
 - A sketch, showing the claims the work is assigned to, must accompany this form.

Recorded Holder(s) James William White	Client No. 208286
Address Box 71 Whitefish Falls, Ont POP 2H0	Telephone No. (705) 285-4254
Mining Division Sudbury Division	Township/Area Roosevelt Township
	M or G Plan No. G 3183
Dates Work Performed From: September 27, 1991 To: October 10, 1991	

Work Performed (Check One Work Group Only)

Work Group	Type
Geotechnical Survey	
Physical Work, Including Drilling	Trenching, pitting and ^{Prospecting} Reports and Expenditures
Rehabilitation	
Other Authorized Work	
Assays	
Assignment from Reserve	

ONTARIO GEOLOGICAL SURVEY
GIS - ASSESSMENT FILES
JAN 22 1992
RECEIVED

Total Assessment Work Claimed on the Attached Statement of Costs \$ 7,110.36

Note: The Minister may reject for assessment work credit all or part of the assessment work submitted if the recorded holder cannot verify expenditures claimed in the statement of costs within 30 days of a request for verification.

Persons and Survey Company Who Performed the Work (Give Name and Address of Author of Report)

Name	Address
C. Butkila Shawonis Explorations & Ent Ltd	RR#2 Brantford Ont. N3T 5L5

Certified to be a true copy of the 2 page(s) of Document Report of Work Conducted After Recording Claim
Dated at Sudbury, Ontario, this 6th day of December 1991

(attach a schedule if necessary)

Certification of Beneficial Interest * See Note No. 1 on reverse side

I certify that at the time the work was performed, the claims covered in this work report were recorded in the current holder's name or held under a beneficial interest by the current recorded holder.

Recorded Holder or Agent (Signature)
James White
Date: **Nov 26/91**

Certification of Work Report

I certify that I have a personal knowledge of the facts set forth in this Work report, having performed the work or witnessed same during and/or after its completion and annexed report is true.

Name and Address of Person Certifying
Cathy Butkila RR#2 Brantford Ont. N3T 5L5

Telephone No. **(519) 752-3917** Date **Nov. 26/91** Certified By (Signature) **Catherine G. Butkila**

For Office Use Only

Total Value Cr. Recorded \$ 7,110.36	Date Recorded November 24, 1991	Mining Recorder K. Giroux	Received Stamp RECEIVED NOV 26 1991 P.M. 16 4:30
	Deemed Approval Date January 20, 1992	Date Approved	
	February 26, 1992		
	Date Notice for Amendments Sent December 6, 1991		

Report of Work Conducted After Recording Claim
Mining Act

Assm' /
Transaction Number
W 9170.50018

Personal information collected on this form is obtained under the authority of the Mining Act. This information will be used for correspondence. Questions about this collection should be directed to the Provincial Manager, Mining Lands, Ministry of Northern Development and Mines, Fourth Floor, 150 Cedar Street, Sudbury, Ontario, P3E 6A5, telephone (705) 670-7264.

- Instructions:**
- Please type or print and submit in duplicate.
 - Refer to the Mining Act and Regulations for requirements of filing assessment work or consult the Mining Recorder.
 - A separate copy of this form must be completed for each Work Group.
 - Technical reports and maps must accompany this form in duplicate.
 - A sketch, showing the claims the work is assigned to, must accompany this form.

Recorded Holder(s) James William White	Client No. 208286
Address Box 71 Whitefish Falls, Ont POP 2H0	Telephone No. (705) 285-4254
Mining Division Sudbury Division	Township/Area Roosevelt Township
	M or G Plan No. G 3183
Dates Work Performed From: September 27, 1991 To: October 10, 1991	

Work Performed (Check One Work Group Only)

Work Group	Type
Geotechnical Survey	
Physical Work, including Drilling	Trenching, pitting and roadwork
Rehabilitation	
Other Authorized Work	VOID
Assays	
Assignment from Reserve	

Total Assessment Work Claimed on the Attached Statement of Costs \$ _____

Note: The Minister may reject for assessment work credit all or part of the assessment work submitted if the recorded holder cannot verify expenditures claimed in the statement of costs within 30 days of a request for verification.

Persons and Survey Company Who Performed the Work (Give Name and Address of Author of Report)

Name	Address
C. Butela Shawonis Explorations & Ent. Ltd.	RR#2 Brantford Ont. N3T 5L5
see also schedule	

(attach a schedule if necessary)

Certification of Beneficial Interest * See Note No. 1 on reverse side

I certify that at the time the work was performed, the claims covered in this work report were recorded in the current holder's name or held under a beneficial interest by the current recorded holder.	Date Nov 26/91	Recorded Holder or Agent (Signature) James White
--	--------------------------	--

Certification of Work Report

I certify that I have a personal knowledge of the facts set forth in this Work report, having performed the work or witnessed same during and/or after its completion and annexed report is true.

Name and Address of Person Certifying Cathy Butela RR#2 Brantford Ont. N3T 5L5		
Telephone No. (519) 752-3917	Date Nov. 26/91	Certified By (Signature) Catherine G. Butela

For Office Use Only

Total Value Cr. Recorded	Date Recorded	Mining Recorder	RECEIVED Nov 2 1991 4:30
	Deemed Approval Date Jan 20/1992 MK February 26, 1992	Date Approved	
	Date Notice for Amendments Sent December 6, 1991		

1		3
Work Report Number for Applying Reserve	Claim Number (see Note 2)	Number of Claim Units
	S 721041	1
	S 398278	1
	S 398279	1
/	S 854861	1
/	S 854862	1
/	S 854863	1
/	S 994574	1

Total Number of Claims

4	5
Value of Assessment Work Done on this Claim	Value Applied to this Claim
1000	1000.00
3105.18	471.42
3105.18	471.42
Ø	1316.88
Ø	1316.88
Ø	1316.88
Ø	1316.88

7,210.36
Total Value Work Done

7,210.36
Total Value Work Applied

6	7
Value Assigned from this Claim	Reserve: Work to be Claimed at a Future Date
Ø	
2,633.76	
2,633.76	

5,210.36
Total Assigned From

Ø
Total Reserve

Credits you are claiming in this report may be cut back. In order to minimize the adverse effects of such deletions, please indicate from which claims you wish to prioritize the deletion of credits. Please mark (✓) one of the following:

- Credits are to be cut back starting with the claim listed last, working backwards.
 - Credits are to be cut back equally over all claims contained in this report of work.
 - Credits are to be cut back as prioritized on the attached appendix. In order from top to bottom as they appear on this sheet
- In the event that you have not specified your choice of priority, option one will be implemented.

Note 1: Examples of beneficial interest are unrecorded transfers, option agreements, memorandum of agreements, etc., with respect to the mining claims.

Note 2: If work has been performed on patented or leased land, please complete the following:

I certify that the recorded holder had a beneficial interest in the patented _____ Date _____
Signature _____

DIRECT EXPENSES

LABOUR, CONTRACTING AND CONSULTING FEES

Shawonis Explorations and Ent. Ltd. 11 days + expenses	3,053.24
John Allard - 1 days @ \$150/day	150.00
- 5 days @ \$175/day	875.00
Del Doe - 3 days @ \$100/day	300.00
Russ Hunda - 1 day @ \$100/day	100.00
Marcel Brunette - 1 day @ \$100/day	100.00
Water Taxi Charges - 6 days @ \$50/day + GST \$21.00	321.00

4,899.24 (B)

SUPPLIES AND EQUIPMENT RENTALS

Boat Rental:

12' aluminum cached on Plunge Lake - 8 days @ \$25/day	200.00
12' aluminum cached on Leech Lake - 8 days @ \$20/day	160.00
3 HP Johnson outboard motor - 8 days @ \$25/day + 100/wk	125.00
+ GST	33.95
+ PST	38.80

Gasoline - 5 gal (22.73 l) @ 57.3cents/l

13.02
510.77 (B)

Wajax Trash Pump:

pump - 8 days @ \$27/day; \$108/wk	135.00
nozzle - 8 days @ \$3/day	24.00
hose - 500' @ \$10/day/100' lengths = \$50/day; \$200/wk	250.00
+ GST	28.63
+ PST	32.72

Gasoline - 5 gal (22.73 l) @ 57.3 cents/l

13.02
483.87 (B)

Explosives:

Amex II - 5 bags @ \$34.90/1 kg. bag	174.50
B-line detonating cord - 150m spool	79.60
instant detonators - 40 @ \$4.20/3m length	168.00
+ GST	29.55
+ PST	33.77

485.42 (B)

TOTAL 6,538.80 (B)
6,438.80

Copies of this report of the _____ page(s)

of Document Direct Expenses

Dated at _____, Canada, this 6th day of

December 1991

ACTING K. Giroux
Subsidiary Marketing Division

Catherine Bitella
Dec. 27/91

INDIRECT EXPENSES

MOBILIZATION & DEMOBILIZATION

Labour

Del Doe	- 1 day @ \$100/day	100.00
Paul Sweeney	- 1 day @ \$100/day	100.00
John Allard	- 2 days @ \$175/day	300.00

Rental

16' aluminum boat & oars - Garnets		
+ 20 HP Evinrude outboard motor - 1 day		70.00
	+ GST	4.90
	+ PST	5.60

SHIPPING

Boyles Explosives - drop off fee		40.00
	+ GST	2.80

TRANSPORTATION OF PERSONS TO/FROM CLAIM

Mileage from Espanola to Lang Lake docks		
- use of personal vehicle		
31.8 km round trip/day		
8 days = 254 km @ .19/km		
(based on Tilden rental rates)		48.26

TOTAL 671.56

Copies made a true copy of the 1 page(s)
of Indirect Expenses
Dated 6th day of
December 1991

K. Grew
Mining Division

*Catherine
J. Butella
Dec 27/91*

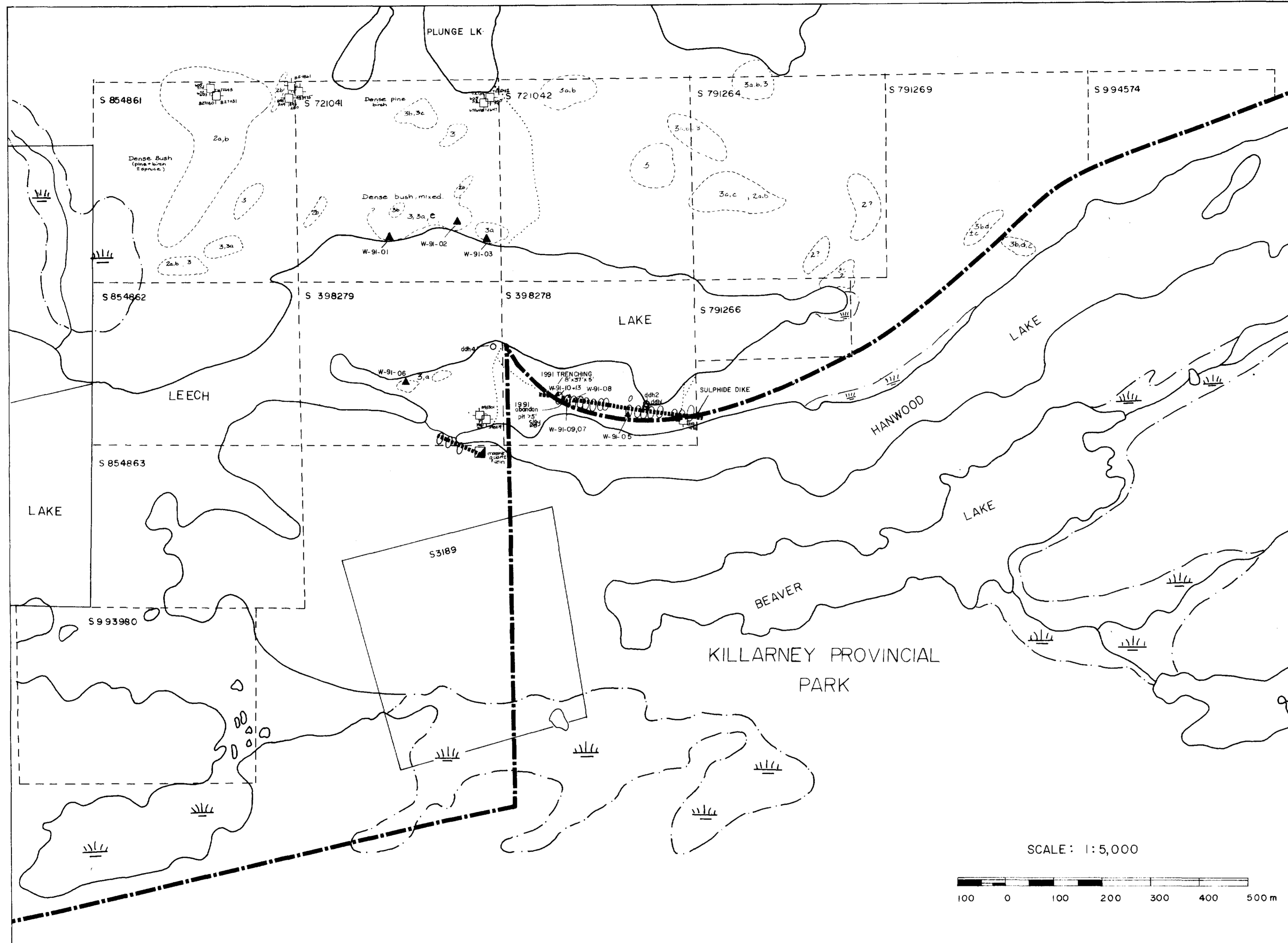

J. WHITE CLAIMS
ROOSEVELT TWP

LEGEND

ROCK TYPE

- 3 SEDIMENTS**
- 3a QUARTZITES, QUARTZ FELDSPAR SANDSTONES
 - 3b SILTSTONES
 - 3c WACKES
 - 3d ARGILLITES
 - 3e CONGLOMERATES
- 2 INTRUSIVES**
- 2a GABBRO
 - 2b DIABASE

SYMBOLS

- OUTCROP
- ▨ SWAMP
- TRAIL PORTAGE
- PROVINCIAL PARK BOUNDARY
- CLAIM BOUNDARY
- CLAIM POST
- ▲ SAMPLE LOCATION (grab)
- TRENCH
- SHAFT
- ▨ MINERALIZED ZONE

SCALE: 1:5,000

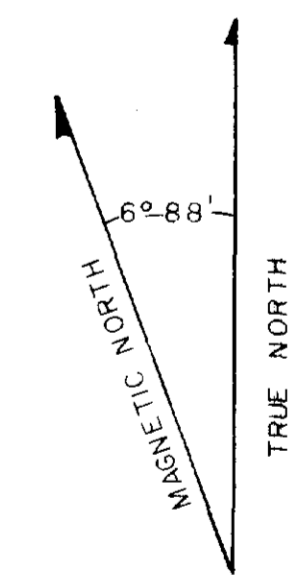
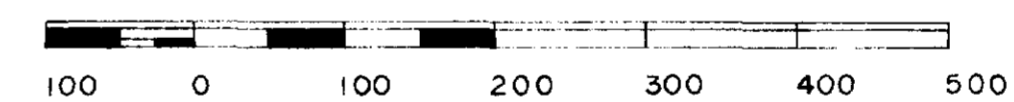

63.5907

SAMPLE LOCATION, PROSPECTING

J WHITE CLAIMS
ROOSEVELT TOWNSHIP
Sudbury Mining Division
District of Sudbury

NTS: 41/1/4 Date: October 1991
Scale: 1:5,000 MAP NO.: FIG 3

Work performed Sept 27 - Oct. 6, 1991
by John Allard and crew & C. Butella

J. ALLARD Lic. No.: C 31481
C. BUTELLA Lic. No.: C 37071

John Allard
Catherine Butella
Dec. 27/91

Rock Descriptions:

- W-91-01:** extremely dense, highly altered (felsitic) siliceous rock
- intense fuchsite ± chlorite
 - very f.g. locally somewhat crystalline, massive
 - minor extremely f.g. disseminated sulfides
 - weathers tan - orangey brown and green
- W-91-02:** m.g. - e.g. porphyritic quartzitic rock
- contains 2-3 blue qtz - eyes
 - up to 2% fine disseminations and clusters of sulfide - py, sp ± asp
 - contains to 5% sub angular (mm to 2 cm) fragments of very siliceous argillite and cherty rock
 - locally bleached weather surface
- W-91-03:** extremely f.g. to f.g. brownish grey coloured quartzite
- m/o is massive
 - 10% to 45% diam. v.f.g. sulfide - py?
 - local light grey coloured siliceous laminations
 - weathers buff to light brown

- W-91-04:** moderately dense f.g. dark grey quartzite
- v.f.g. diam. sulfide py ± asp ± hematite to 5%
 - sulfide veinlets and fracture fill to 10% locally
 - local leached areas
- W-91-05:** massive milky white opaque to slightly locally greyish coloured quartz vein
- 4-5 cm wide
 - conchoidal fracture; rusty pitted weather surface
 - local py blebs to 1 cm dia - local py fract fill
- W-91-07:** blue grey massive to brecciated crystalline qtz vein
- with massive sulfide stringers and veins to 6 cm wide
 - py, asp ± local op. locally to 5%-10%
 - local vuggy patches in qtz
 - also minor diam. ± blebs; cubic sulfide to 1 cm

- W-91-08:** f.g. to m.g. dark greenish grey quartzite
- contains up to 2 cm greyish quartz veinlets
 - veinlets locally 15%-20% asp
 - blebs and diam. of py 5-10%
 - sulfide contact laminae near quartz veinlets
 - becomes more massive and appears in stringers to 8% (primarily brecciated py)
- W-91-09:** similar to W-91-08
- dark grey green m.g. crystalline, muf-rod textured quartzite
 - 10-15% diam ± blebs py, asp. in quartzite
 - local parallel qtz veins to 3 cm ± - massive greyish qtz
 - local limonite ± siderite fractures in quartz
 - py blebs and fracture fill tend to be associated with darker streaks in qtz veins
 - minor asp ± hemat?
- W-91-10:** dark grey to black microcline to vitreous quartzite
- silty vit veinlets white to grey coloured with blebs

- W-91-11:** grey to white opaque dull lustrous quartz vein
- limonite - siderite fractures ± hemat
 - asp ± py blebs, diam and vug fill
- W-91-12:** dk grey f.g. crystalline quartzite with minor cross cutting qtz stringers
- host to above (W-91-11)
 - massive sulfide replacement by minor asp. to 5%
 - locally veins of sulfide to 6 cm wide
 - deep red stain prevalent
 - minor local op diam ± blebs
- W-91-13:** as above but extremely siliceous
- multiple qtz veins - silica flooding
 - qtz becomes dark grey to blue grey opaque to smoky looking
 - local blebs stringers ± diam. asp. py to 3%
 - generally ± 3%

