

RESIDENT GEOLOGIST REPORT

NO. S65-2

Pleasant Valley Mines Ltd.

Hallam Tp.

Location: South  $\frac{1}{2}$  lots 3, 4, 5, Con. 4

North  $\frac{1}{2}$  lots 9, 10, Con. 3

Lots 4, 5, 6, 8, Con. 3

S $\frac{1}{4}$  lot, 3, Con. 3

Lots 3, 4, 5, 6, 7, 8, Con. 2

The company also holds claims on Stratton Lake in Merritt and Foster townships.

General Geology:

Quirke's "Española area" map shows the geology of area in a very general way. The mineralization occurs in the Mississagi quartzite in an east-west trending breccia zone. Mapping in Merritt township shows a fault structure running across Merritt from Stratton Lake through Aprey, to the Hallam boundary. The Projection of this fault would pass through the property just north of exposed breccias.

Description of the Occurrences:

The company has opened one or more east-west trending breccia zones on claims 129016 and 129017. The breccias consist of angular fragments of quartzite in quartz and carbonate veins. The volume of fragments relative to matrix ranges from about 50:50 to 90:10. Chalcopyrite occurs rather sporadically as blebs in the matrix material. The main breccia is zoned, with a quartz-quartzite fragment core and carbonate-quartzite fragment walls. Most of the chalcopyrite is in the quartz core.

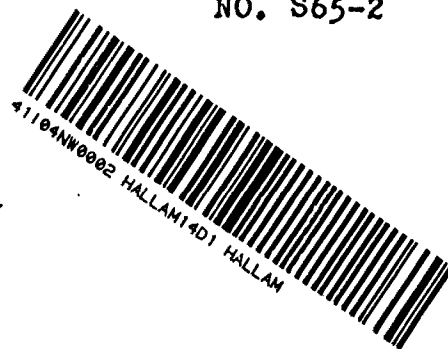

### Pit #9

An east-west trending, steeply dipping breccia zone is exposed over a width of about 10 feet. The breccia is zoned, with an inner quartz core ( 2 feet) and outer carbonate portions. The central quartz zone contains about 10% disseminated chalcopyrite. There is possibly some <sup>bornite</sup> ~~pyrite~~ with the chalcopyrite.

### Pit #1

A large pit, 30' x 150' x 20'. The breccia is much wider here and there are also several distinct shears exposed. These dip steeply. The breccia is again zoned, with an outer carbonate zone about 40 feet wide and inner quartz core exposed over about 10 feet. The chalcopyrite content of the quartz zone is about 10% to 15%.

Assays: Grab samples taken by the company give copper values ranging from about 1.00% to 9.7%.

### Geophysical Work:

The company has also made an EM survey of the main claims. The results of this were disappointing but this is expectatable.

### Conclusions:

The mineralized breccia zone is probably on one of the main east-west faults which occur in the area. The fault is apparently in the valley immediately north of the occurrence. Diamond drilling in the valley was advised to test the possibility of more mineralized breccia zones.

Note: The property was examined on Sept. 9 by Mr. A. Matheson of Newmont.

Report of Property Examination by Resident Geologist

Name of Property or Owner ....Pleasant.Valley.Mines.Ltd.....

Address of Owner ..Espanola.Ont,.....

Location of Property

Mining Division ...Sudbury.....

Township ..Hallam.....Concession<sup>See Over</sup>..Lot.....

or  
Area Map ..Espanola Area, Quirke.....or N.T.S. or Lat:Long.....

At time of visit was property being actively explored?<sup>Yes</sup>.....or dormant?...

Chief metal or mineral sought...<sup>copper</sup>.....

Has a report been prepared?....<sup>yes</sup>.....

Does report consist of information supplied by others for public use?<sup>yes</sup>.....

Has report been placed on open file (available for inspection and copying)?...

What original work did your examination involve? (check)

Geological Mapping: Surface..... Underground.....

Mineral Identification...<sup>X</sup>..... Core Examination.....Core Logging.....

Sampling.....Petrography.....Structural Interpretation...<sup>X</sup>.....

Other (list).....

Are notes or report on restricted file (available for discussion only)?<sup>yes</sup>.....

Date when property was examined.....

Comments...<sup>Interesting geology but low grade</sup>.....

Submitted by ...<sup>K. D. Card</sup>.....  
Resident Geologist

Office ..<sup>Sudbury</sup>.....

Date.....<sup>Sept. 10/65</sup>.....

Please complete one form for each property examined and forward to Director,  
Geological Branch.

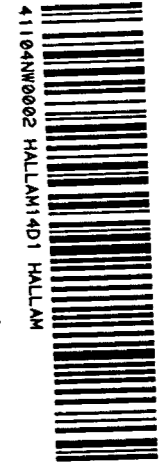
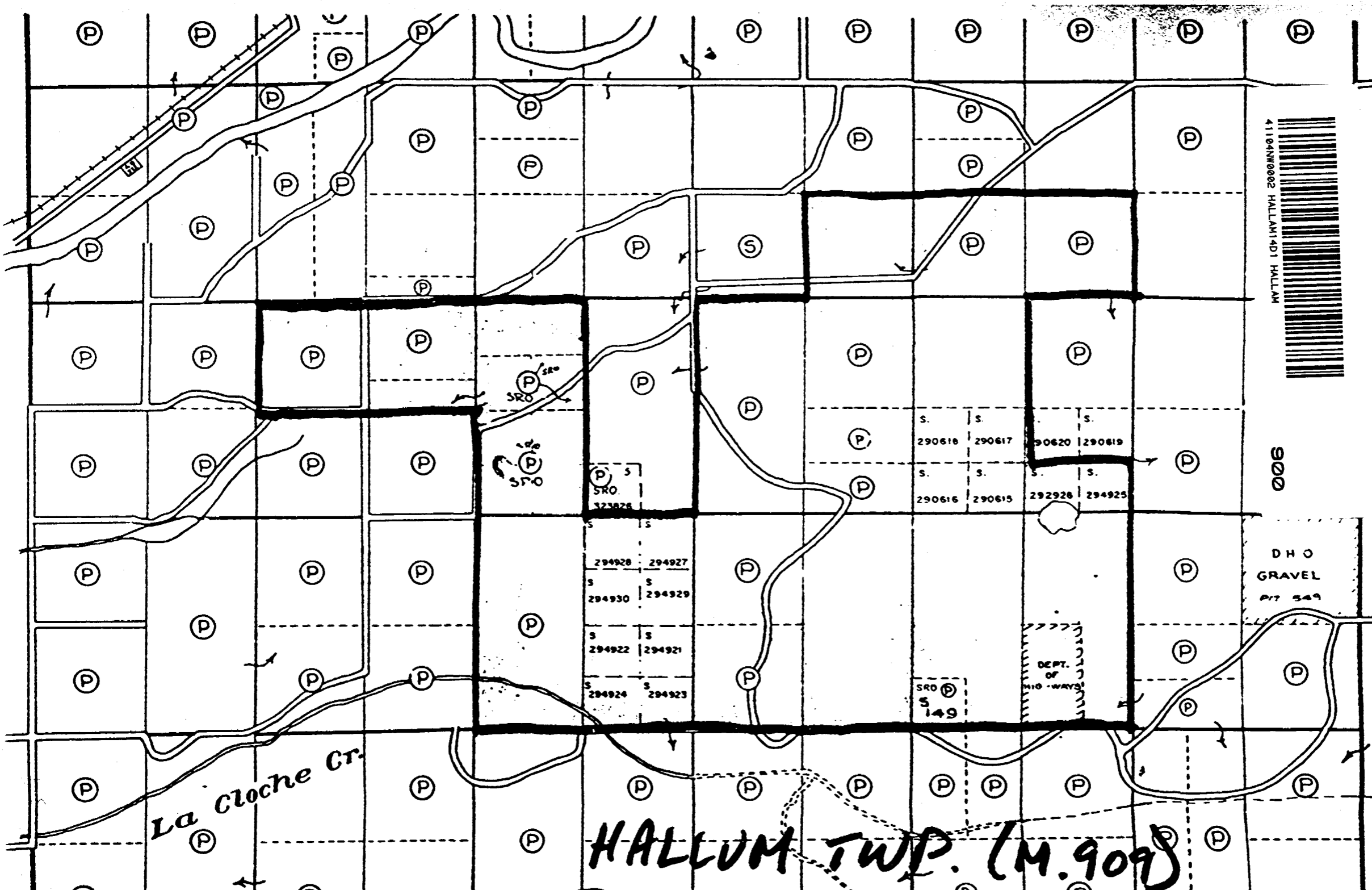

IV  
III  
MERRITT TWP.

000

DHO  
GRAVEL  
PIT 549

DEPT.  
OF  
HIGHWAYS

SR0  
S  
149

HALLUM TWP. (M. 909)

La Cloche Cr.

294928	294927
S	S
294930	294929
S	S
294922	294921
S	S
294924	294923

S.	S.	S.	S.
290618	290617	290620	290619
S.	S.	S.	S.
290616	290615	292928	294925

26  
77

2.1244

RECEIVED

JUN 7 1973

PROJECTS  
SECTION

MAGNETIC AND ELECTROMAGNETIC

SURVEY REPORTS

HANMER TOWNSHIP

SUDBURY MINING DIVISION

ONTARIO