



41104NW0035 0012A1 MONGOWIN

010

### Diamond Drilling

Township of MONGOWIN

Report NO 16

Work performed by: (John Allard) Denison Mines Limited

Claim NO	Hole NO	Footage	Date	Note
S 397936	AE-76-1	201.0'	July/76	(1)
	AE-76-2	174.0'	July/76	(1)
	AE-76-3	233.0'	July/76	(1)
	<u>Total: 301</u>	<u>608'</u>		

#### Notes:

(1) #20-77

ALLARD PROSPECT  
MONGOWIN TWP.

<u>Hole #</u>	<u>Sample #</u>	<u>Footage</u>	<u>Footage Ground</u>	<u>Sample Length</u>
AE-76-1	446	0-15'	8½'	6½'
	447	15'-30'	6'	9'
	448	30'-40'	1'	9'
	449	40'-50'	2'	8'
	450	50'-60'		10'
	451	60'-70'	2½'	7½'
	452	70'-80'	6'	4'
	453	80'-85'		5'
	454	85'-95'	1'	9'
	455	95'-105'		10'
	456	105'-115'	2'	8'
	457	115'-125'		10'
	458	125'-135'		10'
	459	135'-145'	2'	8'
	AE-76-2	460	0-10'	2'
461		10'-20'	2'	8'
462		20'-32'		12'
463		32'-40'		8'
464		40'-50'		10'
465		50'-60'	6"	9½'
466		60'-70'		10'
467		70'-75½'		5½'
468		75½'-85'		9½'
469		85'-95'	2'	8'
470		95'-105'	2'	8'
471		105'-115½'		10½'
472		115½'-119½'		4'
473	119½'-125'		5½'	
AE-76-3	474	18'-25'		7'
	475	25'-35'		10'
	476	35'-45'		10'
	477	45'-55'		10'
	478	55'-65'		10'
	479	65'-75'		10'
	480	75'-85'		10'
	481	85'-94'	4'	5'
	482	94'-105'	3'	8'
	483	105'-115'		10'
	484	115'-125'	1½'	8½'
	485	125'-140'	1'	14'
	486	140'-152'	1'	11'
	487	152'-165'	2'	11'
	488	165'-175'	1'	9'
489	175'-188'	2'	11'	

## DRILL HOLE LOG

PROPERTY	DENISON MINES LTD. (Allard Prospect)	HOLE NO.	AE-76-1
LAT.	334'S of post #1	DIP	45°
DEP.	341'W claim S397936	AZIMUTH	92°
ELEV.	770' a.s.l.	LOGGED BY	A. Chan
		LENGTH	201'
		SIZE	EX

FOOTAGE	DESCRIPTION	SAMPLE NO.	LENGTH			
	From      To					
0-30'	<p>Quartzite (Siltstone?): light yellowish brown, fine grained, massive; silicified; heavily fractured with quartz filling; in ¼"-12" sections. Quartz, whitish grey; stringers and bands, ¼"-8" thick; numerous chlorite stringers with trace of Py, B; rare Cp, occasionally up to 0.5%; up to 25% of unit. Ground core: 0-6'=4½; 9'-12'=3'; 12'-17'=1'; 17'-20'=2' and 20'-30'=3'.</p>					
30'-43'	<p>Quartzite: medium grey-grey, fine grained, massive, slight argillaceous; occasionally quartz fragments, 1/32"-1/4" in diameter. Few sections, 3"-6" thick, silicified with quartz stringers. Disseminated specks of PY, PO in unit; occasionally up to 0.5% with chlorite stringers. Ground core: 33'-35'=2½; 36'-40'=1' and 41'-43'=1'.</p>					
43'-110'	<p>Quartzite: fine grained, laminated light yellowish brown and medium grey, massive; heavily fractured with quartz filling. Alternating laminae ¼"-6" thick. Quartz, whitish grey, ¼"-6" thick, abundant chlorite stringers with trace of sulphides, occasionally up to 1% along fractures, fractures at 20°-45° to core; occasional specks of malachite; local hematite stains; up to 55% of unit. At 74', chlorite with 0.5% Py, PO, rare arsenopyrite(?) along fracture. At 83½'-84', two bands 1½" thick, massive PY, PO, CP and arsenopyrite(?), slight magnetic. Ground core: 46'-47'=6"; 51'-53'=6"; 59'-61'=1'; 73'-77'=1'; 89'-94'=2' and 108'-110'=1½'.</p>					
110'-146'	<p>Quartzite: same as from 43'-110'. Quartz 1/8"-1/4" thick, up to 30% of unit, occasional carbonate breccia. Last 2', slight argillaceous. Ground core: 110'-114'=1½'; 134'-138'=1½' and 143'-146'=1½'.</p>					
146'-201'	<p>Argillite: medium greyish green, local blackish green, fine grained, thinly bedded, bedding at 60° to core; occasional calcite and</p>					

**DRILL HOLE LOG**

PROPERTY .....

HOLE NO. AE-76-1

LAT. ....

DIP .....

HOLE STARTED .....

DEP. ....

AZIMUTH .....

HOLE FINISHED .....

ELEV. ....

LOGGED BY .....

LENGTH ..... SIZE .....

FOOTAGE	DESCRIPTION	SAMPLE NO.	LENGTH						
				From	To				
146'-201'	Argillite Continued: and quartz bands along bedding; moderately fractured along bedding; trace - 0.5% PY, PO. Ground core: 153'-156' = 1 1/2'; 178'-183' = 2' and 196'-197' = 6".								
201'	End of Hole.								

*Handwritten signature*

## DRILL HOLE LOG

PROPERTY DENISON MINES LTD. (Allard Prospect)

HOLE NO. AE-76-2

LAT. 565'S of post #1 DIP 45°

HOLE STARTED July 28, 76

DEP. 309'W claim S397936 AZIMUTH 82°

HOLE FINISHED July 30, 76

ELEV. 780 a.s.l. LOGGED BY A. Chan

LENGTH 174' SIZE EX

FOOTAGE	DESCRIPTION	SAMPLE NO.	LENGTH	From To	
0-32'	Quartzite: light brownish grey, local light brown, fine grained, massive, slight fractured with quartz and carbonate, occasionally chlorite filling; few gossan zones, 1" thick with honeycomb texture. Quartz whitish grey, hair thin-3" thick; abundant carbonate breccia, light whitish buff, 1/8"-1/4" in diameter; with chlorite around breccia; 0.5% Py, Po, occasional Cp; up to 10% of unit. Ground core: 1'-5'=6"; 12'-17'=1' and 18'-20'=6".				
32'-75½'	Siltstone (Quartzite?): light-medium brown, fine grained, massive; slicified; fractured with quartz and carbonate, occasionally chlorite filling; trace of Py, Po in unit. Quartz, whitish grey, ½"-4½" thick; abundant carbonate breccia, 1/8"-1/2" in diameter; occ. quartzite breccia, elongated at 40° to core; numerous chlorite stringers; occasional malachite grains, irregular, 1/32" in diameter; occasional hematite stain; 0.5%-1% Py, Po, Cp, occasional arsenopyrite along fractures; up to 50% of unit. Ground core: 50'-52'=6".				
75½'-113½'	Quartzite: light brownish grey, local light grey, fine grained, massive, slicified; fractured with quartz and carbonate occ. chlorite and 0.5% Py, Po filling. Quartz, whitish grey, ¼"-4" thick; some carbonate breccia, 1/8"-1/2" in diameter; occ. vuggy sections; numerous chlorite stringers; abundant sulphides bands, hair thin, 0.5-1.5% Py, Po, Cp, occ. blebs of arsenopyrite along fractures; few specks of malachite grains; up to 30% of unit. Ground core: 84'-87'=2'; 87'-92'=1'; 92'-96'=6"; 100'-102'=1½' and 102'-104'=6".				
113½'-119½'	Siltstone (Quartzite?): same as from 33'-75½'. Quartz, 1/16"-1½" thick; rare carbonate breccia; generally at 48° to core; trace of Py, Po, 1% malachite grains.				

# DRILL HOLE LOG

PROPERTY .....

HOLE NO. AE-76-2

LAT. ....

DIP .....

HOLE STARTED .....

DEP. ....

AZIMUTH .....

HOLE FINISHED .....

ELEV. ....

LOGGED BY .....

LENGTH ..... SIZE .....

FOOTAGE	DESCRIPTION	SAMPLE NO.	LENGTH			
				From	To	
119½'-125'	Quartzite: medium grey, fine grained, massive; argillaceous; trace of PY, PO. At 122½', 6" quartz zone, abundant carbonate breccia, 1/8" - 1/4" in diameter; trace of PY, PO along fracture with chlorite.					
125'-174'	Argillite: medium greyish green, fine grained, thinly bedded, bedding at 65° to core; occ. quartz and calcite stringers along bedding; moderately fractured along bedding, occasional narrow gossan zone; trace - 1/8 Py in unit. Ground core: 143'-147'=3', 151'-157'=1' and 157'-168'=2'.					
174'	End of Hole.					

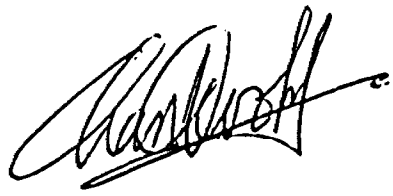

## DRILL HOLE LOG

PROPERTY DENISON MINES LTD. (Allard Prospect)

HOLE NO. AE-76-3

LAT. 750'S of post #1

DIP 45°

HOLE STARTED July 31, 76

DEP. 319'W claim S397936

AZIMUTH 102°

HOLE FINISHED August 8, 76

ELEV. 760'

LOGGED BY A. Chan

LENGTH 233' SIZE EX

FOOTAGE	DESCRIPTION	SAMPLE NO.	LENGTH				
				From	To		
0-18'	Overburden						
18'-94'	Quartzite (Siltstone?): light greyish brown, fine grained, massive; slicified, fractured with quartz and carbonate filling; trace of PY,PO in unit; occassional sulphides stringers up to 0.5% with chlorite along fractures. Quartz, whitish grey, hair thin - 8" thick; abundant carbonate breccia, light whitish buff, 1/8"-1/2" in diameter; numerous chlorite stringers with trace - 1% PY,PO, rare CP, arsenopyrite up to 50% of unit. Ground core: 88'-91'=3½' and 91'-94'=3'.						
94'-152'	Quartzite: Medium-dark brownish grey, fine grained massive, 0.5% of quartz fragments, 1/8"-1/2" in diameter; abundant chlorite stringers with up to 0.5% PY,PO along fractures, generally at 40° to core; trace of PY,PO in unit; local argillaceous sections, thinly bedded, bedding at 50° to core; few quartz sections, greyish white, 1"-8" thick, abundant chlorite stringers, trace of PY,PO, few talc sections, ¼"-1½" thick, light-medium green, fine grained, sheared; soapy and soft, at 140'-141½' and 148'-149½', upper and lower contact fairly clean at 37°, 18°, and 34°, 42° respectively. Ground core: 94'-96':1', 101'-105':1½', 121½'-123':1½', 134'-135':1' and 146'-147':1'.						
152'-188'	Quartzite (Siltstone?): same as from 18'-94'. Quartz, greyish white-white, 1'-9" thick, occ. carbonate breccia, 1/8"-2" in diameter; with chlorite stringers around breccia; nil-trace PY,PO. At 188', contact clean at 52° to core. Ground core: 158'-161':6", 163'-168':1', 168'-171':1½' and 176'-183':1½'.						
188'-233'	Argillite: medium greyish green, local blackish green, fine grained, thinly bedded, bedding at 50° to core; local folding; sparse quartz and calcite stringers along bedding; rare hematite stain; moderately fractured along bedding; trace - 0.5% PY,PO in unit. 188'-189' fairly silty.						

# DRILL HOLE LOG

PROPERTY .....

HOLE NO. AE-76-3

LAT. ....

DIP .....

HOLE STARTED .....

DEP. ....

AZIMUTH .....

HOLE FINISHED .....

ELEV. ....

LOGGED BY .....

LENGTH ..... SIZE .....

FOOTAGE	DESCRIPTION	SAMPLE NO.	LENGTH				
	From                  To						
188'-233'	Argillite Continued: Ground Core: 207'-209':2', 210½'-212':1½', 216'-217':1' and 232'-233':1'						
233'	End of Hole.						
							





- CHEMICAL RESEARCH AND ANALYSIS
- CONTRACT LABORATORIES

**TECHNICAL SERVICE LABORATORIES**  
 DIVISION OF BURGNER TECHNICAL ENTERPRISES LIMITED  
 1301 FEWSTER DRIVE, MISSISSAUGA, ONT. L4W 1A2  
 TELEPHONE: (416) 625-1544

**CERTIFICATE OF ANALYSIS**

SAMPLE(S) FROM Denison Mines Ltd.,  
 4 King St. West,  
 Toronto, Ontario.

REPORT No.  
 T - 02371

SAMPLE(S) OF Attn. Mr. A. T. Avison  
ROCK

Inv. #3184  
 Let. Aug. 16/76

Gold (Au) oz/ton    Nickel (Ni) %    Silver (Ag) oz/ton

AT-76-1

0-15'	446	<0.001	<0.01	-
15-30'	447	<0.001	<0.01	-
30-40'	448	<0.001	<0.01	-
40-50'	449	<0.001	<0.01	-
50-60'	450	<0.001	<0.01	-
60-70'	451	<0.001	<0.01	-
70-80'	452	<0.001	<0.01	-
80-85'	453	0.008	<0.01	0.01
85-95'	454	<0.001	<0.01	-
95-105'	455	<0.001	<0.01	-
105-115'	456	<0.001	<0.01	-
115-125'	457	-0.042	<0.01	-
125-135'	458	<0.001	<0.01	-
135-145'	459	<0.001	<0.01	-

AC-76-2

0-10	460	<0.001	<0.01	-
10-20	461	<0.001	<0.01	-
20-32	462	<0.001	<0.01	-
32-40	463	<0.001	<0.01	-
40-50	464	<0.001	<0.01	-
50-60	465	<0.001	<0.01	-

Samples, Pulps and Rejects discarded after two months

DATE August 25th, 1976.

SIGNED

*[Signature]*



- CHEMICAL RESEARCH AND ANALYSIS
- CONTRACT LABORATORIES

# TECHNICAL SERVICE LABORATORIES

DIVISION OF BURGNER TECHNICAL ENTERPRISES LIMITED

1301 FEWSTER DRIVE, MISSISSAUGA, ONT. L4W 1A2

TELEPHONE: (416) 625-1544

## CERTIFICATE OF ANALYSIS

SAMPLE(S) FROM Denison Mines Ltd.,  
4 King Street West,  
Toronto, Ontario.

REPORT No.

T - 02371

SAMPLE(S) OF M5H 1C2  
ROCK

Attn. Mr. A. T. Avlson

Inv. #3184

			<u>Gold (Au) oz/ton</u>	<u>Nickel (Ni) %</u>	<u>Silver (Ag) oz/ton</u>
AE-71-2	60-70'	466	-0.020	<0.01	-
	70-75 $\frac{1}{2}$	467	<0.001	<0.01	-
	75 $\frac{1}{2}$ -85'	468	0.003	<0.01	-
	85'-95'	469	<0.001	<0.01	-
	95'-105'	470	0.004	<0.01	-
	105'-115 $\frac{1}{2}$	471	<0.001	<0.01	<0.01
	115 $\frac{1}{2}$ -119 $\frac{1}{2}$	472	<0.001	<0.01	-
	119 $\frac{1}{2}$ -125'	473	<0.001	<0.01	-
AE-75-3	18-25'	474	<0.001	<0.01	-
	25'-35'	475	<0.001	<0.01	-
	35'-45'	476	<0.001	<0.01	-
	45'-55'	477	<0.001	<0.01	-
	55'-65'	478	<0.001	<0.01	-
	65'-75'	479	<0.001	<0.01	-
	75'-85'	480	<0.001	<0.01	-
	85'-94'	481	<0.001	<0.01	-
	94'-105'	482	<0.001	<0.01	-
	105'-115'	483	<0.001	<0.01	-
	115'-125'	484	<0.001	<0.01	-
	125'-140'	485	<0.001	<0.01	-
	140'-152'	486	<0.001	<0.01	-
	152'-165'	487	<0.001	<0.01	-
	165'-175'	488	<0.001	<0.01	-
	175'-188'	489	<0.001	<0.01	<0.01

Samples, Pulps and Rejects discarded after two months

DATE August 25th, 1976.

SIGNED

*Lata Hurd*



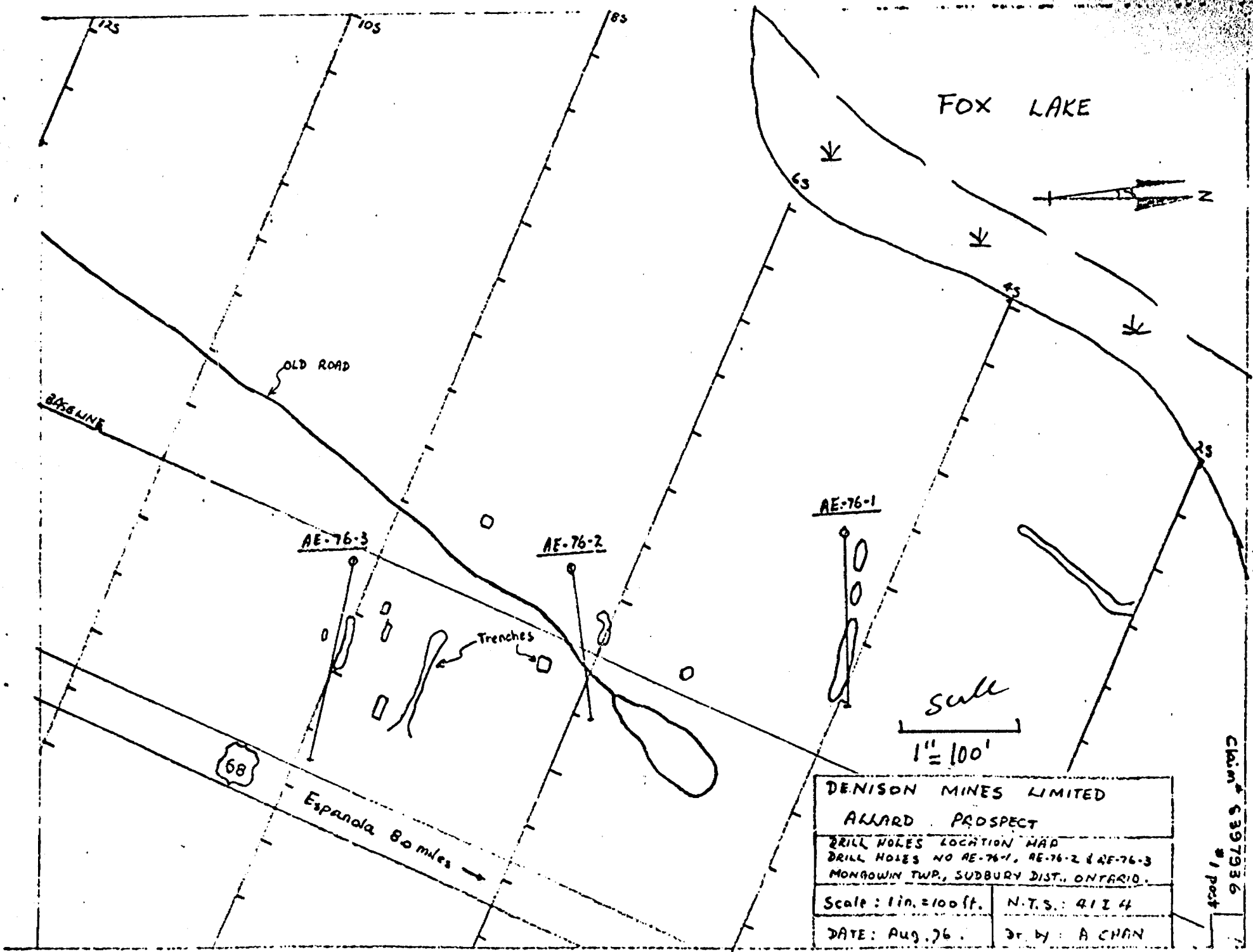

DENISON MINES LIMITED	
ALLARD PROSPECT	
DRILL HOLES LOCATION MAP	
DRILL HOLES NO AE-76-1, AE-76-2 & AE-76-3	
MONGOWIN TWP., SUDBURY DIST., ONTARIO.	
Scale: 1 in. = 100 ft.	N.T.S.: 4124
DATE: Aug. 76.	Dr. by: A CHAN

Claim # 6397936  
 #1 post



SEE ACCOMPANYING  
MAP(S) IDENTIFIED AS  
MONGOWIN - 0012-A1#1

---

---

LOCATED IN THE MAP  
CHANNEL IN THE FOLLOWING  
SEQUENCE (X)

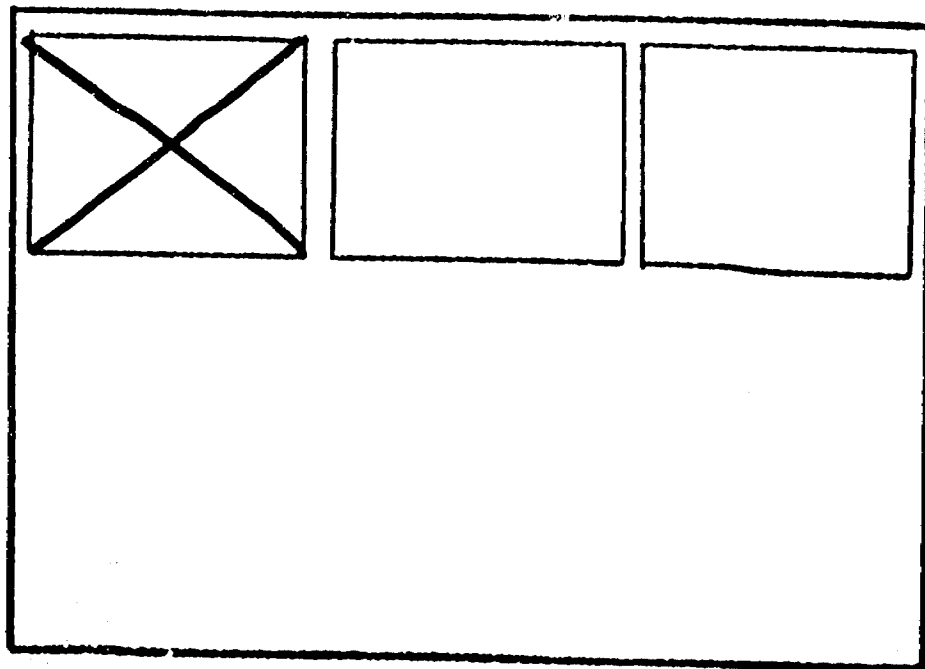

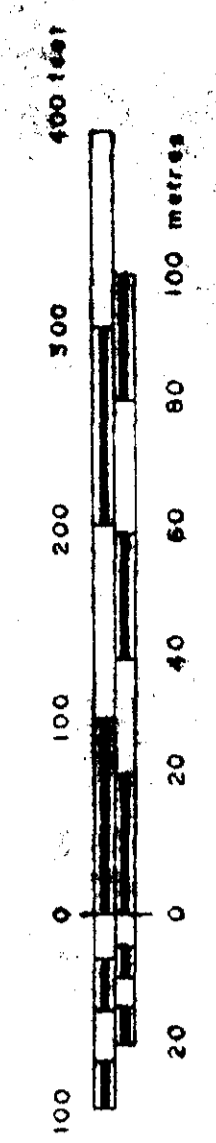
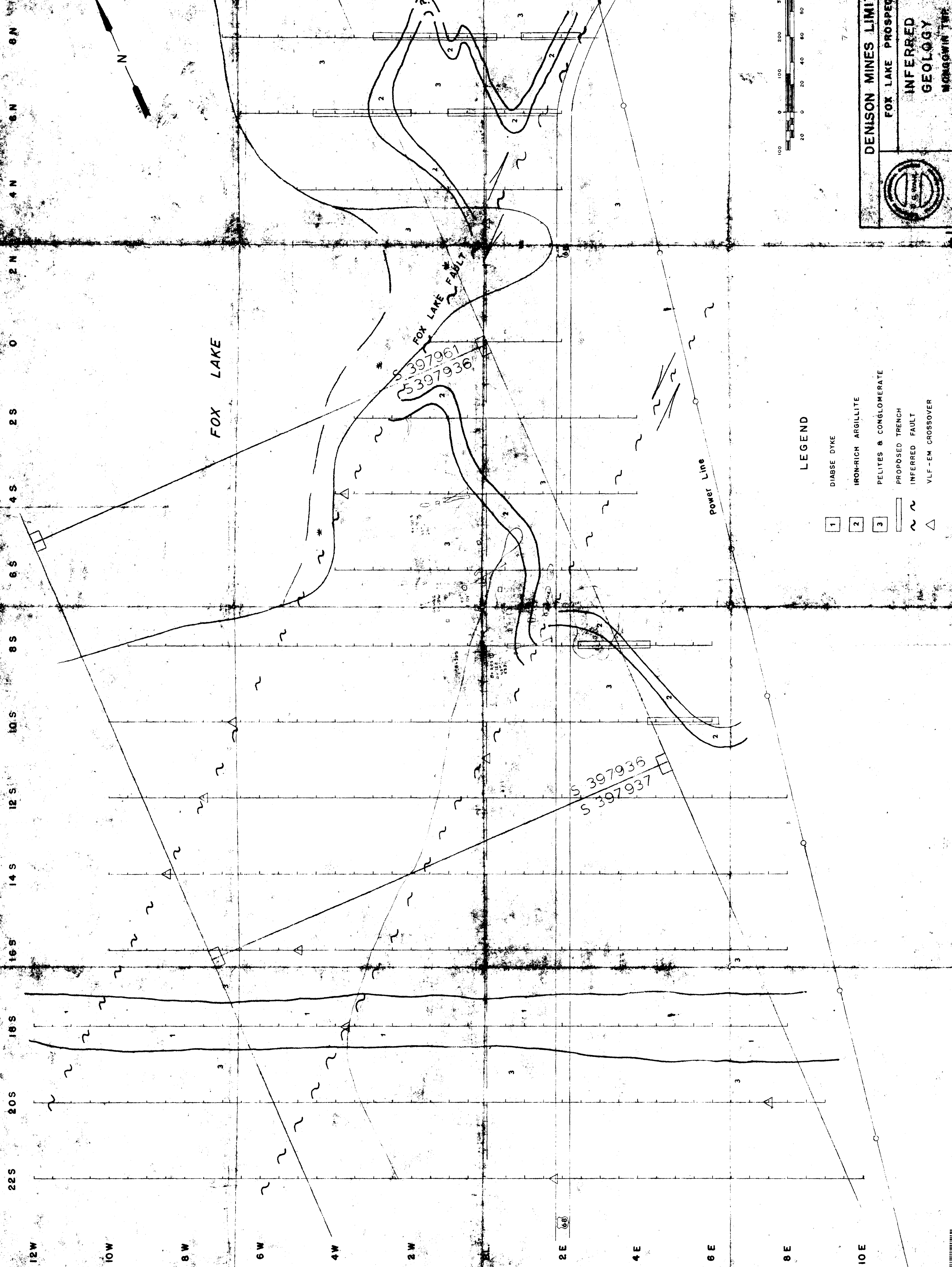

**LEGEND**

- 1 DIABSE DYKE
- 2 IRON-RICH ARGILLITE
- 3 PELITES & CONGLOMERATE
- PROPOSED TRENCH
- ~ INFERRED FAULT
- △ VLF-EM CROSSOVER

	<b>DENISON MINES LIMITED</b> FOX LAKE PROSPECT
	INFERRED GEOLOGY MONGWIN INC.
JUNE 1978 1:50,000 1 INCH TO 100 FEET	72-11-16-1

MONGWIN-0012-AL

