

Diamond Drilling



41104NW0040 0014 MONGOWIN

010

Township of MONGOWIN

Report NO: 11

Work performed by: Jo-Ami Gold Mines

Claim NO	Hole NO	Footage	Date	Note
S 107626	59-1	137'	Dec/59	
	59-2	142'	Dec/59	
	59-4	106'	Dec/59	
	59-5	255'	Dec/59	
	60-6	131'	Jan/60	
	60-7	204'	Jan/60	
	60-8	217'	Jan/60	
	60-17	200'	Mar/60	
S 107632	59-3	275'	Dec/59	
	60-9	275'	Jan/60	
	60-10	348'	Jan/60	
	60-11	204'	Feb/60	
	60-12	329'	Feb/60	
	60-13	337'	Feb/60	
	60-14	207'	Feb/60	
	Notes:	60-15	164'	Feb/60
	60-16	211'	Feb/60	

Total: 17 DH 3742'

DIAMOND DRILL RECORD

JO-AMI GOLD MINES LTD.
 PROPERTY MONGOWIN TWP. SUDBURY MINING DIVISION HOLE No. 59-1
 SHEET NUMBER 1 SECTION FROM TO STARTED Dec. 1/59
 Approx. 50' east of N.E corner
~~XXXXXXXXX~~ of Moyle lake, just DATUM Moyle (House) Lake COMPLETED Dec. 3/59
 south of N. boundary of claim S.107626
 DEPARTURE BEARING N 20 deg. min. W ULTIMATE DEPTH 137'
 ELEVATION approx. 5' above lake -45° PROPOSED DEPTH

DEPTH FEET	FORMATION	SAMPLE NO	FROM	TO	WIDTH	ASSAY VALUES		
						AU OZ/TON	SLUDGE FROM TO	AU
11.0	Recent & Pleistocene; Clay & Gravel (Casing)							
15.0	Sheared altered argillite with quartz stringers-some pyritic and hematitic mineralization in fractures.	2709	11	15	4	TR		
17.0	Quartz with some carbonate & inclusions of argillite (or greenstone) very little pyrite mineralization.	2710	15	17	2	NIL		
19.0	Quartz with inclusions argillite. mineralized with pyrite (& arsenopyrite) & hematite.	2711	17	19	2	TR	15	20 0.01
22.0	Altered brecciated argillite with some quartz, very little mineralization	2712	19	22	3	TR		
25.0	Quartz with argillite inclusion. Pyrite mineral from 23 to 25.	2713	22	25	3	NIL	20	25 0.01
27.5	Banded siliceous argillaceous greywacke-some pyrite min.	2714	25	27.5	2.5	TR		
30.0	Brecciated quartz 26-27.5	2715	27.5	30	2.5	TR	25	30 0.02
30.0	Quartz-carbonated, fractured & brecciated, Some pyritic min. & much red iron oxide.	2716	30	32.5	2.5	TR		
32.5	Quartz (carbonated) with some pyritic & hematitic mineralization.	2717	32.5	35	2.5	NIL	30	35 TR
35.0	Quartz (carb) with very little mineralization-some red oxide at 34'	2718	35	40	5	NIL	35	40 TR
40.0	Glassy white quartz. very little mineralization.							

DIAMOND DRILL RECORD

PROPERTY

HOLE No. 59-1

SHEET NUMBER 2 of 3

DUPLICATE COPY
POOR QUALITY ORIGINAL
TO FOLLOW

STARTED

LATITUDE

COMPLETED

DEPARTURE

BEARING

ULTIMATE DEPTH

ELEVATION

DIP

PROPOSED DEPTH

DEPTH FEET	FORMATION	SAMPLE NO.	FROM	TO	WIDTH	ASSAY VALUES			
						AU OZ/TON	SLUDGE	AU	
42.5	Quartz (some carb) with occasional inclusions of argillite & fairly well mineralized-pyritic	2719 S	40	42.5	2.5	TR			
45.0	Argillite mixed with quartz-well mineralized disseminated pyritic crystals.	2720 S	42.5	45	2.5	0.09	40	45	0.22
47.5	Quartz (carbonated) with good pyritic mineralization. Some inclusions of argillite.	2721 S	45	47.5	2.5	0.14			
50.0	Quartz with pyrite & red oxide (hematitic?) Argillite inclusion at 49-50	2722 S	47.5	50	2.5	TR	45	50	0.03
52.5	Argillite (50-51); Quartz (51-52.5) with pyritic & hematitic mineralization	2723 S	50	52.5	2.5	TR			
55.0	Quartz with hardly any pyritic mineralization but slightly coloured with red oxide.	2724 S	52.5	55	2.5	NIL	50	55	TR
57.5	Quartz with occasional specks of pyritic & hematitic mineralization	2725 S	55	57.5	2.5	NIL			
60.0	Argillite well mineralized with disseminated pyrite & hematized. Quartz at 58.5	2726 S	57.5	60	2.5	0.40	55	60	0.13
63.0	Quartz with some carbonates & slight disseminated pyritic mineralization	2727 S	60	63	3	NIL			
65.0	Mostly argillite with some quartz & much disseminated pyrite & hematitic oxide.	2728 S	63	65	2	TR	60	65	0.02
70.0	Buff coloured quartzitic material slightly fractured but mainly massive. Some fine fractures.	2729 S	65	70	5	TR	65	70	TR

DIAMOND DRILL RECORD

PROPERTY **HOLE No.** 59-1
SHEET NUMBER 3 of 3 **SECTION FROM** **TO** **STARTED**
LATITUDE **DATUM** **COMPLETED**
DEPARTURE **BEARING** **ULTIMATE DEPTH**
ELEVATION **DIP** **PROPOSED DEPTH**

DEPTH FEET	FORMATION	SAMPLE NO.	FROM	TO	WIDTH	ASSAY VALUES			
						AU OZ/TON	SLUDGE	AU	
75.0	Same as 2729S but with an inclusion of argillite or greenstone at 73.5 to 74.0	2730S	70	75	5	NIL	70	75	TR
80.0	Same as 2730S with occasional specks of pyrite scattered through massive quartzite	2731S	75	80	5	NIL	75	80	TR
85.0	Same as 2731S. Lost core 82.5 to 83.5. Appears like highly siliceous diorite but at 80 to 84 ft.	2732S	80	85	5	NIL	75	80	TR
90.0	Same as 2732S. Quartzite with inclusion of argillite or greenstone at 87.5	2733S	85	90	5	NIL	85	90	TR
95.0	Quartzite appears like quartz diorite in darker coloured section 92.5 to 93.5	2734S	90	95	5	TR	90	95	TR
100.0	Siliceous dioritic material (contact zone)?? Some disseminated pyrite. Lost core 97 to 98 feet.	2735S	95	100	5	TR	95	100	TR
137.0	Dark, fine grained basic rock-some laths of feldspar indicating diabase.						100	105	TR
							105	110	TR
							110	115	TR
							115	120	TR
							120	125	TR
							125	130	TR

DUPLICATE COPY
POOR QUALITY ORIGINAL
TO FOLLOW

CAMERON DRILLING CO. LTD.

DIAMOND DRILL RECORD

JO-AMI GOLD MINES LIMITED,
 PROPERTY MONGOWIN TOWNSHIP SUDBURY MINING DIVISION HOLE No. 59-1
 Whitefish Falls, Ontario

SHEET NUMBER 1 of 3 SECTION FROM 0 TO 40-feet STARTED December 1, 1959

Location: Approx 50 ft. east of N.E. corner of Moyle Lake, just south of N. boundary of Claim S.107626 DATUM Moyle (House) Lake COMPLETED December 3rd, 1959

DEPARTURE BEARING N. 20 deg. 40 min. W. ULTIMATE DEPTH 137 feet

ELEVATION Approx 5 ft. above lake DIP -45 degrees PROPOSED DEPTH

DEPTH FEET	FORMATION	SAMPLE NO.	FROM	TO	Core Length (feet)	ASSAY VALUES		
						AU oz./ton	SLUDGE	AU
11	Recent & Pleistocene Clay & Gravel (Casing)							
15	Sheared altered argillite with quartz stringers - some pyritic and hematitic mineralization in fractures	27095	11	15	4	tr.		
17	Quartz with some carbonate inclusions of argillite (or greenstone) very little pyritic mineralization	27105	15	17	2	nil		
19	Quartz with inclusions argillite mineralized with pyrite (& arsenopyrite) & hematite	27115	17	19	2	tr.	15	20
22	Altered brecciated argillite with some quartz, very little mineralization	27125	19	22	3	tr.		
25	Quartz with argillite inclusion, Pyritic mineral from 23 to 25	27135	22	25	3	nil	20	25
27.5	Banded siliceous argillaceous greywacke - some pyrite min. Brecciated quartz 26-27.5	27145	25	27.5	2.5	tr.		
30	Quartz-carbonated, fractured & brecciated Some pyritic min. & much red iron oxide	27155	27.5	30	2.5	tr.	25	30
32.5	Quartz (carb noted) with some pyritic & hematitic mineralization	27165	30	32.5	2.5	tr.		
35	Quartz (carb) with very little mineralization Some red oxide at 34 ft.	27175	32.5	35	2.5	nil	30	35
40	Glassy white quartz, very little mineralization	27185	35	40	5	nil	35	40

NORTHERN MINER FORM 505 REV. 194

DRILLED BY CAMERON DRILLING COMPANY LIMITED

P.O. Box 400, Malartic, P.Que.

SIGNED

A. S. Bayne, P. Eng.

DIAMOND DRILL RECORD

JO-AMI GOLD MINES LIMITED, MONGOWIN TWP.

PROPERTY SUBBURY MINING DIVISION, Whitefish Falls, Ont. HOLE No. 59-1

SHEET NUMBER 2 of 3 SECTION FROM ~~XX~~ 26540 TO 85 - feet STARTED Dec. 1, 1959

LATITUDE See sheet No. 1 DATUM COMPLETED Dec. 3, 1959

DEPARTURE BEARING N. 20 deg. 40 min. W. ULTIMATE DEPTH 137 feet

ELEVATION DIP -45 deg. PROPOSED DEPTH

DEPTH FEET	FORMATION	SAMPLE NO.	FROM	TO	Core WIDTH XX Length (feet)	ASSAY VALUES (oz. per ton)			
						SLUDGE	From	To	
42.5	Quartz (some carb.) with occasional inclusion of argillite & fairly well mineralized pyritic	2719 S	40	42.5	2.5	tr.	From	To	70
45	Argillite mixed with quartz - well mineralized disseminated pyritic crystals	2720 S	42.5	45	2.5	0.09	40	45	0.22 0.2
47.5	Quartz (carbonated) with good pyritic mineralization. Some inclusions of argillite.	2721 S	45	47.5	2.5	0.14			
50	Quartz with pyrite & red oxide (hematite?) Argillite inclusion at 49-50	2722 S	47.5	50	2.5	tr.	45	50	0.03 0.0
52.5	Argillite (50-51); Quartz (51-52.5) with pyrite & hematitic mineralization	2723 S	50	52.5	2.5	tr.			
55	Quartz with hardly any pyritic mineralization but slightly coloured with red oxide	2724 S	52.5	55	2.5	nil	50	55	Tr.
57.5	Quartz with occasional specs of pyritic & hematitic mineralization.	2725 S	55	57.5	2.5	nil			
60	Argillite well mineralized with disseminated pyrite & hematized. Quartz at 58.5	2726 S	57.5	60	2.5	0.40	55	60	0.1 0.13
63	Quartz with some carb notes & slight disseminated pyritic mineralization	2727 S	60	63	3	nil			
65	Mostly argillite with some quartz & much disseminated pyrite & hematitic oxide	2728 S	63	65	2	tr.	60	65	0.12 0.1
70	Buff coloured quartzitic material, slightly fractured but mainly massive. Some fine FeS	2729 S	65	70	5	tr.	65	70	tr 0.0
75	Same as 2729 S but with an inclusion of argillite or greenstone at 73.5 to 74	2730 S	70	75	5	nil	70	75	tr.
80	Same as 2730 S with occasional specs of pyrite scattered through massive quartzite.	2731 S	75	80	5	nil	75	80	tr.
85	Same as 2731 S. LOST CORE - 82.5 to 83.5 Appears like highly siliceous chlorite bed at 80 to 84 ft.	2732 S	80	85	5	nil	75	80	tr

NORTHERN MINER FORM 503 REV. 724

DRILLED BY CAMERON DRILLING COMPANY LTD.
P. O. Box 400, Malartic, P. C. U.S.

SIGNED

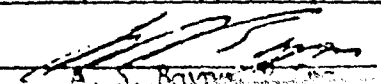

DIAMOND DRILL RECORD

JO-AMI GOLD MINES LIMITED, MONGOWIN TWP.
SUDBURY MINING DIVISION, Whitefish Falls, Ont.

PROPERTY
 SHEET NUMBER 3 of 3 SECTION FROM 80K 85 TO 137 -feet HOLE No. 59-1
 LATITUDE SEE SHEET NO. 1 DATUM STARTED Dec. 1, 1959
 DEPARTURE BEARING N. 20 deg. 40 min W. ULTIMATE DEPTH 137 feet
 ELEVATION DIP -45 deg. PROPOSED DEPTH

DEPTH FEET	FORMATION	SAMPLE NO.	FROM	TO	Core Length (feet)	ASSAY VALUES			
						Au (oz. per ton)		SLUDGE	
						From	To		Au
90	Same as 2732 S. Quartzite with inclusion of argillite or greenstone at 87.5	2733 S	85	90	5	nil	85	90	tr.
95	Quartzite. Appears like quartz diorite in darker coloured section 92.5 to 93.5	2734 S	90	95	5	trace	90	95	tr.
100	Siliceous dioritic material (contact zone) ?? Some disseminated pyrite	2735 S	95	100	5	tr.	95	100	tr.
	LOST CORE 97 to 98 feet						100	105	tr.
137	Dark, fine-grained basic rock—some laths of feldspar indicating diabase.						105	110	tr.
							110	115	tr.
							115	120	tr.
							120	125	tr.
							125	130	tr.

NORTHERN MINER FORM 505 REV. /64

CAMERON DRILLING COMPANY LIMITED

DRILLED BY P. O. Box 400, Malartic, P. C. C. U. S.

SIGNED

A. S. Payne
A. S. Payne, P. Eng.

DIAMOND DRILL RECORD

PROPERTY: JO-AMI GOLD MINES LTD. WHITEFISH FALLS, ONTARIO
MONGOWIN TWP. SUDBURY MINING DIVISION.

HOLE No. 59-2

SHEET NUMBER: 1 of 1

Location: 18" N.20 deg 40 min. to DDH# 59-1 to Moyle (House)

STARTED Dec. 4/59

approx. 50ft. east of N.E. corner of Moyle Lake

COMPLETED Dec. 6/59

Just south of N. Boundary of Claim S-107626

Approx. 5 ft. above lake BEARING N.20 deg. 40 min. W

ULTIMATE DEPTH 142 feet

ELEVATION: same as DDH# 59-1 DIP -60 degrees

PROPOSED DEPTH

DEPTH FLT	FORMATION	SAMPLE NO.	FROM	TO	WIDTH	ASSAY VALUES			
						AU OZ/TON	SLUDGE	AU	
13.0	Pleistocene & recent/clay & Gravel	2736	13	15	2	NIL	13	15	TR
	Casing	2737 S	15	20	5	TR	15	20	0.01
43.0	Argillite intruded by quartz veins	2738 S	20	25	5	TR	20	25	0.01
	25-25.5 - quartz vein	2739 S	25	30	5	0.02	25	30	0.06
	38-39 Lost core	2740 S	30	35	5	0.01	30	35	TR
	31-32.5 - quartz vein	2741 S	35	40	5	NIL	35	40	0.03
	41.5-42.5 Lost core	2742 S	40	45	5	TR	40	45	0.04
50.0	Quartz vein carbonated with some disseminated pyritic mineralization at 47.5 ft.	2743 S	45	47.5	2.5	NIL	45	50	0.10
67.0	White quartz vein, carbonated with occasional pyritic mineralization	2744 S	47.5	50	2.5	0.25	50	55	0.06
100.0	Buff coloured quartzite. Dioritic from 92-93 inclusion of either argillite or diabase.	2745 S	50	55	5	NIL	55	60	0.01
		2746 S	55	60	5	NIL	60	65	0.01
122.0	Quartzite with dark dioritic material at 92-93 feet.	2747 S	60	65	5	NIL	85	115	TR
		2748 S	65	70	5	NIL	115	125	TR
138.0	Mostly dioritic-either metamorphosed inclusions of argillite or inclusions of diabasic rock	2749 S	70	75	5	NIL			
		2301 S	75	80	5	TR			
142.0	Buff coloured quartzite.	2302 S	80	85	5	NIL			
		2303 S	85	90	5	NIL			
	END OF HOLE.	2304 S	90	95	5	NIL			
		2305 S	95	100	5	NIL			
		2306 S	100	105	5	NIL			
		2307 S	105	110	5	TR	125	135	TR
		2308 S	110	115	5	TR			
		2309 S	115	120	5	??			
		2310 S	120	125	5	TR	135	140	TR

**DUPLICATE COPY
POOR QUALITY ORIGINAL
TO FOLLOW**

DIAMOND DRILL RECORD

JO-AMI GOLD MINES LIMITED, Whitefish Falls, Ontario
 PROPERTY MONGOWIN TOWNSHIP, SUDBURY MINING DIVISION,

HOLE No. **59-2**

SHEET NUMBER **1 of 1** SECTION FROM **0** TO **142 - feet** STARTED **December 4th, 1959**

Location: **18 inches N. 20 deg. 40 min. to DDH 59-1** **Moyle (House Lake)** COMPLETED **December 6th, 1959**

approx. **50 ft. east of N.E. corner of Moyle Lake, just south of N. boundary of Claim S. 107626**
 approx **5 ft. above lake**
 DATUM: **N. 20 deg. 40 min W.** BEARING: **-60 degrees**
 ULTIMATE DEPTH: **142 feet**

ELEVATION: **Same as DDH 59-1** DIP: **-60 degrees** PROPOSED DEPTH:

DEPTH FEET	FORMATION	SAMPLE NO.	FROM	TO	Core length (feet)	ANALYSES			
						SLUDGE	Trace	Trace	
						From	To	As	
13	Pleistocene & Recent/ Clay & Gravel-Casing	2736 S	13	15	2	nil	13	15	0.01
43	Argillite intruded by quartz veins. 25-25.5 -- quartz vein 38 - 39 -- LOST CORE 31 - 32.5 -- quartz vein 41.5 - 42.5 -- LOST CORE	2737 S	15	20	5	trace	15	20	0.01
		2738 S	20	25	5	tr.	20	25	0.01
		2739 S	25	30	5	0.02	25	30	0.06
		2740 S	30	35	5	0.01	30	35	Trace
		2741 S	35	40	5	nil	35	40	0.03
50	Quartz vein, carbonated with some disseminated pyritic mineralization. Well mineralized at 47.5 ft.	2742 S	40	45	5	trace	40	45	0.04
		2743 S	45	47.5	2.5	na			
		2744 S	47.5	50	2.5	0.25	45	50	0.10
		2745 S	50	55	5	nil	50	55	0.06
		2746 S	55	60	5	nil	55	60	0.01
67	White quartz vein, carbonated with occasional pyritic mineralization.	2747 S	60	65	5	nil	60	65	0.01
		2748 S	65	70	5	nil	85	115	Trace
		2749 S	70	75	5	nil	115	125	Trace
100	Buff coloured quartzite. Dioritic from 92-93 inclusion of either argillite or diabase.	2301 S	75	80	5	trace			
		2302 S	80	85	5	nil			
		2303 S	85	90	5	nil			
		2304 S	90	95	5	nil			
122	Quartzite with dark dioritic material at 92-93 feet.	2305 S	95	100	5	nil			
		2306 S	100	105	5	nil			
		2307 S	105	110	5	Trace	125	135	Trace
		2308 S	110	115	5	Trace			
138	Mostly dioritic -either metamorphosed inclusions of argillite or inclusions of diabasic rock	2309 S	115	120	5	? ?			
		2310 S	120	125	5	Tr.	135	140	Trace
142	Buff coloured quartzite								
END OF HOLE									

NORTHERN MINER FORM 505 REV. 54

DRILLED BY **CAMERON DRILLING COMPANY LIMITED**

P.O. Box 400, Malartic, P. Que.

SIGNED

A. S. Doyle
A. S. Doyle, P. Eng.

DIAMOND DRILL RECORD

DUPLICATE COPY
FOR QUALITY ORIGINAL TO FOLLOW

PROPERTY JO-AMI GOLD MINES LTD. MONGOWIN TWP.

HOLE No. 59-4

SHEET NUMBER 1
 Location. Just south of N. Boundary of S 107626 TO
 Approx. 32 ft. east of Hole # 59-1 DAYOM Moyle (House) Lake

STARTED Dec. 14/59

COMPLETED Dec. 17/59

DEPARTURE BEARING N. 60 deg. 40 min. W

ULTIMATE DEPTH 106 feet

ELEVATION Approx. same as DDH_{UP} #59-1 -45 degrees

PROPOSED DEPTH

DEPTH FEET	FORMATION	SAMPLE NO.	FROM	TO	WIDTH	ASSAY VALUES		
						AU OZ/TON	SLUDGE	AU
8.0	Recent & Pleistocene Clay & Gravel Casing							
11.0	Argillite altered with red oxide (hematization)	4C1	8	11	3		8	15
15.0	Argillite, altered, more red oxide; vuggy; some quartz-carb stringers	4C2	11	15	4			
20.0	Argillite, altered with quartz-car stringers and much red oxide.	4C3	15	20	5			
22.0	Same as above with less red oxide but some pyritic mineralization	4C4	20	22	2		20	25
25.0	Mostly quartz-carb; some argillites slight red oxide; no pyritic mineral.	4C5	22	25	3			
27.5	Same as above. A little pyritic mineralization - no pyrite.	4C6	25	27.5	2.5		25	30
30.0	Quartz-carb. with more argillite, some oxide.	4C7	27.5	30	2.5			
33.5	Mixed quartz-carb & argillite? or greenstone? slight red oxide; some pyritic dissemination.	4C8	30	33.5	3.5			
37.5	Quartz-carb with inclusions of argillite? or greenstone? More red oxide and some pyrite.	4C9	33.5	37.5	4		30	35
40.0	Mostly argillite with quartz-carb. stringers. well mineralized with pyrite & red oxide.	4C10	37.5	40	2.5		35	40
42.5	Quartz-carb with some argillite? or greenstone? inclusions. Well mineralized with FeS & oxide.	4C11	40	42.5	2.5			
45.0	Same as above-not quite so well mineralized.	4C12	42.5	45	2.5		40	45
		4C13	45	47.5	2.5			

DIAMOND DRILL RECORD

PROPERTY

HOLE No. 59-4

SHEET NUMBER 2 of 3

SECTION FROM TO

STARTED

LATITUDE

DATUM

COMPLETED

DEPARTURE

BEARING

ULTIMATE

ELEVATION

DIP

PROPOSED DEPTH

**DUPLICATE COPY
POOR QUALITY ORIGINAL
TO FOLLOW**

DEPTH FEET	FORMATION	SAMPLE NO	FROM	TO	WIDTH	ASSAY VALUES		
						AU OZ/TON	SLUDGE	AU
47.5	Same as above-less mineralization.	4c14	47.5	50	2.5		45	50
50.0	Quartz-carb.with some argillite ? or greenstone? red oxide; well mineralized pyrite	4c15	50	52	2		50	55
52.0	Mostly argillite with some quartz and some red oxide and pyritic mineralization.	4c16	52	55	3			
55.0	Mostly quartz with inclusions of argillite? or greenstone. well mineralized-oxide & FeS	4c17	55	57.5	2.5		55	60
57.5	Same as above	4c18	57.5	60	2.5			
60.0	Mostly argillite with some quartz- carbonate. well mineralized with pyrite & red oxide.	4c19	60	62.5	2.5		60	65
62.5	Same as above, but poorly mineralized	4c20	62.5	65	2.5			
65.0	Mostly quartz with some argillite. Some scattered mineralization.	4c21	65.6	70	4.4			
65.6	Lost core							
70.0	Quartz-carbonate badly fractured with red oxide and FeS in fine fractures.	4c22	70	72.5	2.5			
72.5	Quartz-carbonate poorly mineralized	4c23	72.5	75	2.5			
75.0	- ditto -	4c24	75	78	3.0			
78.0	- ditto -							
81.5	Quartz-carbonate with inclusions of argillite? or greenstone? some scattered mineralization.	4c25	78	81.5	3.5			
85.0	Quartz-carbonate with some inclusions of argillite or greenstone? a little FeS	4c26	81.5	85	3.5			

NOTE

Sludge water failed to return from this point down. No sludge samples could therefore be taken.

DIAMOND DRILL RECORD

PROPERTY HOLE No. 59-4
 SHEET NUMBER 3 of 3 SECTION FROM TO STARTED
 LATITUDE DATUM COMPLETED
 DEPARTURE BEARING ULTIMATE DEPTH
 ELEVATION DIP PROPOSED DEPTH

DEPTH FEET	FORMATION	SAMPLE NO.	FROM	TO	WIDTH	ASSAY VALUES		
						AU OZ/TON	SLUDGE	AU
87.5	Same as section 81.5 to 85 feet	4c27	85	87.5	2.5			
91.5	Same as above but a little more red oxide	4c28	87.5	91.5	4			
93.0	Argillite well mineralized with pyritic sulphides	4c29	91.5	93	1.5			
95.0	Buff quartzite with some specs from 93 to 94.5 ft. Quartz-carbonate mineralization from 94.5 to 95	4c30	93	95	2			
97.5	Argillite with 12" quartz stringers in middle of section. Some red oxide and FeS.	4c31	95	97.5	2.5			
106.0	Buff quartzite	4c32	97.5	106				

END OF HOLE.

DUPLICATE COPY
POOR QUALITY ORIGINAL
TO FOLLOW

DIAMOND DRILL RECORD

JO-AMI GOLD MINES LIMITED, MONGOWIN TWP.

PROPERTY SUDBURY MINING DIVISION, Whitefish Falls, Ont. HOLE No. 59-4

SHEET NUMBER 1 of 3 SECTION FROM 0 TO 47.5 STARTED December 14, 1959

Location. Just south of N. boundary of S.107626
 Approx. 32 feet east of Moyle (House) Lake DATUM
 COMPLETED December 17, 1959

Hole No. 59-4 BEARING N. 60 deg. 40 min. W. ULTIMATE DEPTH 106 feet

ELEVATION Approx. same as DPH/59-1 -45 degrees PROPOSED DEPTH

DEPTH FEET	FORMATION	SAMPLE NO.	FROM	TO	Core Length (feet)	ASSAY VALUES			
						Au (oz. per ton)			
						SLUDGE		Au	
						From	To		
8	Recent and Pleistocene Clay and Gravel (Casing)								
11	Argillite altered with red oxide (hematization)	4C1	8	11	3				
15	Argillite, altered, more red oxide; vuggy; some quartz-carb. stringers	4C2	11	15	4	2	8	15	
20	Argillite, altered, with quartz-carb. stringers and much red oxide	4C3	15	20	5				
22	Same as above with less red oxide but some pyritic mineralization	4C4	20	22	2				
25	Mostly quartz-carb.; some argillite; slight red oxide; no pyritic mineralization	4C5	22	25	3		20	25	
27.5	Same as above. A little pyritic mineralization	4C6	25	27.5	2.5				
30	Quartz-carb. with more argillite; some pyrite no pyrite	4C7	27.5	30	2.5		25	30	
33.5	Mixed quartz-carb & argillite? or greenstone? slight red oxide; some pyritic dissemination	4C8	30	33.5	3.5				
37.5	Quartz-carb. with inclusions of argillite? or greenstone? More red oxide & some pyrite	4C9	33.5	37.5	4		30	35	
40	Mostly argillite with quartz-carb. stringers Well mineralized with pyrite & red oxide	4C10	37.5	40	2.5		35	40	
42.5	Quartz-carb with some argillite? or greenstone? inclusions. Well mineralized with FeS & oxide	4C11	40	42.5	2.5				
45	Same as above-not quite so well mineralized	4C12	42.5	45	2.5		40	45	
47.5	Same as above-less mineralization	4C13	45	47.5	2.5				

NORTHERN MINER FORM 503 REV./54

DRILLED BY CAMERON DRILLING LIMITED
P.O. Box 400, Malartic, P.Que.

SIGNED

A. S. Boyne., P. Eng.

DIAMOND DRILL RECORD

PROPERTY: **JO-AMI GOLD MINES LIMITED, Whitefish Falls, Ont.**
MONGOWIN TWP., SUDBURY MINING DIVISION

SHEET NUMBER: **2 of 3** SECTION FROM: **47.5** TO: **85-feet** HOLE No.: **59-4**
 STARTED: **Dec. 14, 1959**

Location: **SEE SHEET No. 1** DATUM: _____ COMPLETED: **Dec. 17, 1959**
 DEPARTURE: _____ BEARING: **N. 60 deg. 40 min. W.** ULTIMATE DEPTH: **106 feet**

ELEVATION: _____ DIP: **-45 degrees** PROPOSED DEPTH: _____

DEPTH FEET	FORMATION	SAMPLE NO.	FROM	TO	Core Length (feet)	ASSAY VALUES		
						Au (gr. per ton)		
						SLUDGE	Gr	Au
						From	To	Au
50	Quartz-carb. with some argillite? or greenstone? slight red oxide Well mineralized pyrite	4C14	47.5	50	2.5	45	50	
52	Mostly argillite with some quartz and some red oxide and pyritic mineralization.	4C15	50	52	2			
55	Mostly quartz with inclusions of argillite? or greenstone. Well mineralized-oxide & FeS	4C16	52	55	3	50	55	
57.5	Same as above	4C17	55	57.5	2.5			
60	Mostly argillite with some quartz-carbonate Well mineralized with pyrite & red oxide	4C18	57.5	60	2.5	55	60	
62.5	Same as above but poorly mineralized	4C19	60	62.5	2.5			
65	Mostly quartz with some argillite. Some scattered mineralization	4C20	62.5	65	2.5	60	65	
65.6	LOST CORE							
70	Quartz-carbonate body fractured with red oxide and FeS in fine fractures	4C21	65.6	70	4.4			
72.5	Quartz-carbonate poorly mineralized	4C22	70	72.5	2.5			
75	-ditto-	4C23	72.5	75	2.5			
78	-ditto-	4C24	75	78	3.0			
81.5	Quartz-carbonate with inclusions of argillite? or greenstone? Some scattered mineralization	4C25	78	81.5	3.5			
85	Quartz-carbonate with some inclusions of argillite? or greenstone? a little FeS	4C26	81.5	85	3.5			

NORTHERN MINER FORM 903 REV. 7/54

CAMERON DRILLING COMPANY LIMITED

DRILLED BY: **F. O. Box 400, MALARTIC, P. QUB.**

SIGNED _____

A. S. BAYNE, P. ENG.

DIAMOND DRILL RECORD

JO-AMI GOLD MINES LIMITED, Whitefish Falls, Ont.

PROPERTY.....SUDBURY MINING DIVISION, MONGOWIN TWP. HOLE No. **59-4**

SHEET NUMBER **3 of 3** SECTION FROM **85** TO **106 feet** STARTED **Dec. 14, 1959**

Location: See Sheet No. 1

LOCATION..... DATUM..... COMPLETED **Dec. 17, 1959**

DEPARTURE..... BEARING **N. 60 deg. 40 min. W.** ULTIMATE DEPTH **106 feet**

ELEVATION..... DIP **-45 degrees** PROPOSED DEPTH.....

DEPTH FEET	FORMATION	SAMPLE NO.	FROM	TO	Core Length (feet)	ASSAY VALUES		
						Au(oz. per ton)		
87.5	Same as section 81.5 to 85 feet	4C27	85	87.5	2.5			
91.5	Same as above but a little more red oxide	4C28	87.5	91.5	4			
93	Argillite well mineralized with pyritic and phloes	4C29	91.5	93	1.5			
95	Buff quartzite with some specs pyrite from 93 to 94.5 ft. Quartz-carbonate, no mineralization - 94.5	95						
		4C28						
		4C30	93	95	2			
97.5	Argillite with 12" quartz stringer in middle of section. Some red oxide and FeS	4C31	95	97.5	2.5			
106	Buff quartzite	4C32	97.5	106				
	END OF HOLE							

NORTHERN MINER FORM 809 REV. 54

DRILLED BY **CAMERON DRILLING LIMITED**
P.O. Box 400, MALARTIC, Que.

SIGNED _____

(Signature)
A. S. Brown, M. Eng.

DIAMOND DRILL RECORD

PROPERTY JO-AMI GOLD MINES LTD. WHITEFISH FALLS, ONT

HOLE No. 59-5

SHEET NUMBER 1 of 1

SECTION FROM TO

STARTED December 17, 1959

Location: Just south of N. Boundary of Claim S-107626

~~MINOR~~ Approx. 18 ft. S. DATUM Moyle (House) Lake

COMPLETED December 22, 1959

20 deg. 40 min. E of Hole No. 59-4

DEPARTURE BEARING N. 20 deg. 40 min. W

ULTIMATE DEPTH 255 feet

ELEVATION Approx. same as hole 59-4 -45 degrees

PROPOSED DEPTH

DEPTH FEET	FORMATION	SAMPLE NO.	FROM	TO	WIDTH	ASSAY VALUES			
12.0	Recent and Pleistocene Clay & Gravel (Casing)								
52.5	Argillite mixed with stringers of quartz-carbonate. Mineralized in some sections with red box. Iron oxide (hematization)? and pyritic sulphides.								
83.0	Quartz-carbonate vein with some inclusions of argillite. Mineralized in some sections as above.								
255.0	Basic fine-grained rock (diabase) ??? massive and altered near contact with quartz. Some fine (1/16 to 1/8 inch) stringers of quartz-carbonate. Some fine scattered crystals of pyrite in mass of rock.								

END OF HOLE.

**DUPLICATE COPY
POOR QUALITY ORIGINAL
TO FOLLOW**

DIAMOND DRILL RECORD

JO-AMI GOLD MINES LIMITED, Whitefish Falls, Ont.
 PROPERTY MONGOWIN TWP., SUDBURY MINING DIVISION HOLE No. 59-3

SHEET NUMBER 1 of 1 SECTION FROM 0 TO 255 feet STARTED December 17th, 1959

LOCATION: Just south of
 XXXXX N. boundary of Moyle (house) Lake DATUM Moyle (house) Lake COMPLETED December 22nd, 1959
 Claim S.107626, Approx. 18 feet S. 20 deg. 40 min. E.

DEPARTURE of Hole No. 59-4 BEARING N. 20 deg. 40 min W. ULTIMATE DEPTH 255 feet

ELEVATION Approx same as Hole 59-4 DIP -45 degrees PROPOSED DEPTH _____

DEPTH FEET	FORMATION	SAMPLE NO.	FROM	TO	Core width Length (feet)	ASSAY VALUES	
						Au (oz. per ton)	
12	Recent and Pleistocene Clay and Gravel (Casing)						
52.5	Argillite mixed with stringers of quartz-carbonate. Mineralized in some sections with red box Iron oxide (hematization?) and pyritic sulphides						
83	Quartz-carbonate vein with some inclusions of argillite. Mineralized in some sections as above.						
255	Basic fine-grained rock (diabase) ???, massive and altered near contact near with quartz. Some fine (1/16 to 1/8 inch) stringers of quartz-carbonate. Some fine scattered crystals of pyrite in mass of rock.						
	END OF HOLE						

NORTHERN MINER FORM 803 REV/54

DRILLED BY CAMERON DRILLING COMPANY LIMITED
P.O. Box 400 Malartic, P.Q.W.

SIGNED _____
A. S. Adams, P. Eng.

Location : 100 ft. S. 60°E from Hole No. 4
 Approx. 10' above lake level

DIAMOND DRILL RECORD

PROPERTY JO-AMI GOLD MINES LTD. MONGOWIN TWP. ONTARIO HOLE No. 60-6

SHEET NUMBER 1 SECTION FROM TO STARTED Jan. 5, 1960

LATITUDE DATUM Moyle (House) Lake COMPLETED Jan. 8, 1960

DEPARTURE BEARING N 60° W ULTIMATE DEPTH 131

ELEVATION Approx 10' above Lake level DIP -45° PROPOSED DEPTH

DEPTH (FEET)	FORMATION	SAMPLE NO.	FROM	TO	WIDTH	ASSAY VALUES		
						AU OZ/TON	SLUDGE SAMPLE #	AU
10.0	Casing							
86.5	Argillite with occasional quartz-carbonate stringers.	2284	86.5	87.5	1.5	TR	49 80-85	0.02
90.0	Quartz with some carbonate and occasional scattered pyrite.	2285	88	90	2.0	TR	50 85-90	TR
92.5	Argillite with some quartz stringers. Pyrite mineralization	2286	90	92.5	2.5	TR	51 90-95	0.01
102.5	Quartz with some carbonate & fine disseminated pyrite. Occasional bands of argillite.	2287	92.5	95.0	2.5	TR	52 85-100	0.07
125.0	White quartz with occasional specks of pyrite.	2288	95	97.5	2.5	0.02	53 100-105	0.03
127.0	Mixed quartz and quartzite with bands of argilleaceous greywacke.	2289	97.5	100	2.5	0.01	54 105-110	0.13
		2290	100	102.5	2.5	TR		
		2291	102.5	105	2.5	TR		
		2292	105	110	5.0	0.12		
		2293	110	112.5	2.5	0.04		
131.0	- do -	2294	112.5	115	2.5	TR	55 110-115	0.04
		2295	115	117.5	2.5	TR	56 115-120	0.03
		2296	117.5	120	2.5	TR		
		2297	120	122.5	2.5	NIL	57 120-125	0.05
		2298	122.5	125	2.5	0.04		
		2300	125	127	2	TR	58 125-131	0.04

DUPLICATE COPY
POOR QUALITY ORIGINAL
TO FOLLOW

DIAMOND DRILL RECORD

TO - AMI GOLD MINES LTD.
 PROPERTY: MONGSWIN TOWNSHIP DISTRICT HOLE No. 60-6
 SHEET NUMBER: 1 SECTION FROM 0' TO 112.5' STARTED Jan 5, 1960
 Location: 100 ft. DATUM: Mayle (House) L.M. COMPLETED Jan 8, 1960
 DIRECTION: S. 60° E from HOLE No. 4 BEARING: N. 60° W ULTIMATE DEPTH: 131'
 ELEVATION: Approx. 10' above lake level - 45' PROPOSED DEPTH: _____

DEPTH FEET	FORMATION	SAMPLE NO.	FROM	TO	Core Length	GOLD - ASSAY VALUES (OZ/TON)		
						GRAV	DRILL	FLUOR
0								
10	Casing	2284	86.5	87.5	1.5'	Trace	49	20-25 0.02
86.5	Argillite with occasional quartz	2285	88	90	2.0	"	50	20-25 Trace
	quartz carbonate stringers	2286	90	92.5	2.5	"	51	20-25 0.01
90	Quartz with some carbonate	2287	92.5	95.0	2.5	"		
	very small scattered	2288	95	97.5	2.5	0.02	52	25-100 0.07
	pyrite	2289	97.5	100	2.5	0.01		
97.5	Argillite with some quartz stringers	2290	100	102.5	2.5	Trace	53	100-125 0.02
	Pyrite and carbonate	2291	102.5	105	2.5	"		
	Trace	2292	105	110	5.0	0.12	54	100-140 0.13
102.5	Quartz with some carbonate & fine disseminated	2293	110	112.5	2.5	0.02		
	Trace of pyrite. Occasional bands of argillite.	2294	112.5	115	2.5	Trace	55	110-115 0.04

NORTHERN MINER FORM 505 REV 54

DRILLED BY: COMMERCE DRILLING CO LTD

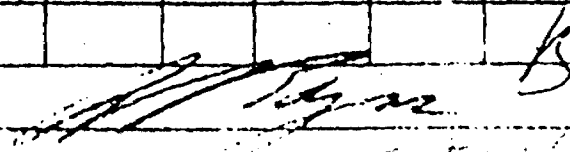
 J. J. [Signature] 1/12/60

DIAMOND DRILL RECORD

JO-AMI GOLD MINES LIMITED

PROPERTY

MONGOWIN TWP., ONTARIO

HOLE No.

60-6

SHEET NUMBER

2

SECTION FROM

112.5' TO 131'

STARTED

JAN. 5, 1960

LOCATION:

LATITUDE

100 ft.
S. 60° E. from

DATUM

Moyle (House) Lake

COMPLETED

JAN. 8, 1960

DEPARTURE

Hole No. 4

BEARING

N. 60° W.

ULTIMATE DEPTH

131'

ELEVATION

Approx. 10' above lake level

- 45'

PROPOSED DEPTH

DEPTH FEET	FORMATION	SAMPLE NO.	FROM	TO	Core Length (Feet)	GOLD		ASSAY VALUES (OZ/TON)			
						Core	Assay	Sample	Feather	Assay	
112.5											
118	White quartz with occasional specks of pyrite	2295	115	117.5	2.5	Trace	54	115-120		0.02	
		2296	117.5	120	2.5	"					
		2297	120	122.5	2.5	NIL	57	120-125		0.05	
122	Mixed quartz and quartzite with bands of light-colored gneiss	2298	122.5	125	2.5	0.04					
		2299	125	127	2.0	Trace	58	125-131		0.04	
131											
	- END OF HOLE -										

NORTHERN MINER FORM 602 4-1-54

DRILLED BY

P. W. W. DRILLING CO. LTD.

DATE

[Signature]

79

DIAMOND DRILL RECORD

PROPERTY JJ-AMI GOLD MINES LTD.

HOLE No. 60-7

SHEET NUMBER 1
 Location : Same set-up as Hole 60-6

STARTED Jan. 9/1960

LATITUDE DATUM Moyle (House) Lake

COMPLETED Jan. 13, 1960

DEPARTURE BEARING N20°40'W

ULTIMATE DEPTH. 204'

ELEVATION Approx. 19'
above lake

DIP -45°

PROPOSED DEPTH

DEPTH FEET	FORMATION	SAMPLE NO	FROM	TO	WIDTH	ASSAY VALUES			

9.0 CASING

AU

204.0 Dark coloured fine-grained massive
 diabasic rock throughout hole. 1810 53.0 53.5 0.5 0.02
 Occasional small specks of pyrite,
 well mineralized with pyrite from
 53.0-53.5'

END OF HOLE.

**DUPLICATE COPY
 POOR QUALITY ORIGINAL
 TO FOLLOW**

DIAMOND DRILL RECORD

J.O. AMI GOLD MINES LTD.

PROPERTY MONGOWIN TWP, ONTARIO

HOLE No. 60-7

SHEET NUMBER 1 SECTION FROM 0 TO 204

STARTED JAN. 9, 1960

Location: Same DATUM Moyle (House) Lake

COMPLETED JAN. 13, 1960

DESCRIPTION Set-up as Hole 60-6 BEARING N. 20° 40' W

ULTIMATE DEPTH 204'

ELEVATION: Approx. 19' Above Moyle Lake D.M. -43°

PROPOSED DEPTH

DEPTH FEET	FORMATION	SAMPLE NO.	FROM	TO	Core Width Length (feet)	GOLD CONT	ASSAY VALUES (OZ./TON)
0							
9'	Casing						
204	Dark colored fine-grained massive diatomite rock throughout hole. Occasional small spots of pyrite. Well mineralized with pyrite from 22.0' to 22.5'	1810	22.0	22.5	0.5	0.02	
	- END OF HOLE -						

[Handwritten signature]

Location : 100 ft. S 20° 40'E of Hole 59-1
 thence 100 ft. S.69° 20'W to Hole 60--8

DIAMOND DRILL RECORD

PROPERTY JO-AMI GOLD MINES LTD. MONGOWIN TWP. ONTARIO		HOLE No. 60-8
SHEET NUMBER 1	SECTION FROM TO	STARTED Jan. 13, 1960
LATITUDE	DATUM Moyle (House) Lake	COMPLETED Jan. 16, 1960
DEPARTURE	BEARING N 20° 40'W	ULTIMATE DEPTH 217'
ELEVATION Lake Level Drilled from ice	DIP -45°	PROPOSED DEPTH

DEPTH FEET	FORMATION	SAMPLE NO.	FROM	TO	WIDTH	ASSAY VALUES			
50.0	Casing								
217.0	Argillaceous greywacke throughout hole.								

END OF HOLE.

**DUPLICATE COPY
 POOR QUALITY ORIGINAL
 TO FOLLOW**

DIAMOND DRILL RECORD

JO. ANN GOLD MINES LTD.

PROPERTY *MONROVIA TWP, ONTARIO*

HOLE No. *60-8*

SHEET NUMBER *1* SECTION FROM *0* TO *217*

STARTED *JUN 13, 1960*

LATITUDE *100 ft. S. 20° 40' E*
of Hole 59-1 DATUM *Moyle (House) Lake*

COMPLETED *JUN 16, 1960*

DEPARTURE *70 ft. S. 69° 20' W*
to Hole 60-8 BEARING *N. 20° 40' W.*

ULTIMATE DEPTH *217'*

ELEVATION *Lake Level* TO *-45'*

PROPOSED DEPTH _____

Drilled from 150

DEPTH FEET	FORMATION	SAMPLE NO.	FROM	TO	WIDTH	ASSAY VALUES			
<i>0</i>									
<i>50'</i>	<i>Casing</i>								
<i>217</i>	<i>Argillaceous greywacke throughout hole</i>								
	<i>END OF HOLE</i>								

NORTHERN MINER FORM 505 REV 194

DRILLED BY *CAMPBELL DRILLING CO. LTD.* SIGNED *[Signature]* *15*
JO. ANN GOLD MINES LTD. *C. S. B...*

DIAMOND DRILL RECORD

PROPERTY JO-AMI GOLD MINES LTD. MONGOWIN TWP.

HOLE No. 60-17

SHEET NUMBER 1

SECTION FROM TO

STARTED March 2, 1960

LATITUDE 50°N 70°E of Hole
#60-6

DATUM Moyle (House) Lake

COMPLETED March 5, 1960

DEPARTURE

BEARING S 24° W

ULTIMATE DEPTH 200'

ELEVATION

DIP

PROPOSED DEPTH

DEPTH FEET	FORMATION	SAMPLE NO	FROM	TO	WIDTH	ASSAY VALUES			
15.0	Casing								
61.0	Pink & red quartzite								
62.0	1.0' Lost core								
62.5	Red quartzite.								
64.0	1.5' Lost core								
98.0	Pink and red quartzite								
99.0	1.5' Lost core								
114.0	Pink & red quartzite								
115.0	1.0' lost core								
116.0	Pink & red quartzite								
117.3	1.3' lost core								
126.0	Pink & red quartzite								
127.5	1.5' lost core								
167.0	Pink & red quartzite								
168.0	1.0' lost core								
173.0	Pink & red quartzite								
174.0	1.0' lost core								
176.0	Pink & red quartzite								
177.0	1.0' lost core								
183.0	Pink & red quartzite								
184.0	1.0' lost core								
187.5	Pink & red quartzite								
188.5	1.0' lost core								
194.0	Pink & red quartzite								
195.5	1.5' lost core								
200.0	Pink & red quartzite								

END OF HOLE

**DUPLICATE COPY
POOR QUALITY ORIGINAL
TO FOLLOW**

DIAMOND DRILL RECORD

PROPERTY *Adams*

HOLE No. *60-17*

SHEET NUMBER *1*

SECTION FROM *0'* TO *167'*

STARTED *March 1954*

LATITUDE *50° N 70° E of*

DATUM *May 10 (Huron) date*

COMPLETED *March 1954*

DEPARTURE *Hole No 60-6*

BEARING *S. 24° W.*

ULTIMATE DEPTH *200'*

ELEVATION *Approx 19 ft above lake level*

DIP *- 45°*

PROPOSED DEPTH

DEPTH FEET	FORMATION	SAMPLE NO.	FROM	TO	Core INDEX Length (feet)	GOLD ASSAY VALUES oz/ton			
0									
15	Casing								
61	Pink & red quartzite								
62	1.0' test core								
62.5	Red quartzite								
64	1.5' test core								
95	Pink & red quartzite								
99	1.5' test core								
110	Pink & red quartzite								
115	1.0' test core								
116	Pink & red quartzite								
117.3	1.3' test core								
126	Pink & red quartzite								
127.5	1.5' test core								
157	Pink & red quartzite								

B

DIAMOND DRILL RECORD

PROPERTY *225 US 101 W. 2100 S. 11th St. Butte, Mont.* HOLE No. **60-17**
 SHEET NUMBER **2** SECTION FROM **167'** TO **200'** STARTED *Mar 27, 1963*
 LATITUDE DATUM *Moyle (House) L.H.C.* COMPLETED *Mar 5th, 1963*
 DEPARTURE *See Sheet #1* BEARING **S. 24° W.** ULTIMATE DEPTH **200'**
 ELEVATION DIP **-45°** PROPOSED DEPTH

DEPTH FEET	FORMATION	SAMPLE NO.	FROM	TO	Core MADEN Length (ft)	GOLD ASSAY VALUES OZ/TON			
167									
168	1.0' lost core								
173	Pink & Red Quartzite								
174	1.0' lost core								
176	Pink & Red Quartzite								
177	1.0' lost core								
183	Pink & red quartzite								
184	1.0' lost core								
187.5	Pink & red quartzite								
188.5	1.0' lost core								
194	Pink & red quartzite								
195.5	1.5' lost core								
200	Pink & red quartzite								
- END OF HOLE -									

14

Location: approx. 115 ft. N. 20 deg. 40 min. W
of Hole No. 59-1; Just north of S. Boundary
of Claim S-107632

DIAMOND DRILL RECORD

PROPERTY JO-AMI GOLD MINES LTD. MONGOWIN TWP.

HOLE No. 59-3

SHEET NUMBER 1

SECTION FROM TO

STARTED Dec. 6, 1959

LATITUDE

DATUM Moyle Lake

COMPLETED Dec. 14, 1959

DEPARTURE

BEARING S.20 deg. 40 min. E

ULTIMATE DEPTH 275 feet

ELEVATION Approx. 43.5 feet above
Hole 59-1 (48.5 feet above
Moyle Lake) ^{DIP} -45 degrees.

PROPOSED DEPTH

DEPTH FEET	FORMATION	SAMPLE NO	FROM	TO	WIDTH	ASSAY VALUES	
						AU OZ/TON	
9.0	Recent & Pleistocene-Clay & Gravel Casing	2311 S	70	72.5	2.5	NIL	NOTE No sludge samples taken as water did not return after depth of 75 feet before reaching gold quartz vein.
75.0	Fine grained massive basic rock-diabasic-chloritic and sericitic alteration-finely disseminated sulphides throughout.	2312 S	77.5	81.5	4.0	TR	
		2313 S	81.5	82.5	1.0	NIL	
		2314 S	82.5	85.5	3.0	TR	
77.5	Diabase more altered. Quartz carb-stringers at 76-76.3	2315 S	85.5	87.0	1.5	0.05	
		2316 S	87.0	90.0	3.0	TR	
80.0	Massive hematized, vuggy diabase.	2317 S	90.0	95.0	5.0	TR	
81.5	Altered, fractured diabase, some pyritic mineralization. Lost core (3 in) @ 81.5 ft.	2318 S	95.0	100.0	5.0	NIL	
		2319 S	100.0	102.5	2.5	TR	
82.5	Quartz-carb-mineralized. Blocky Only 50% core recovered.	2320 S	102.5	105.0	2.5	0.09	
85.5	Diabase altered and hematized.	2321 S	105.0	107.5	2.5	0.03	
87.0	Quartz-carbonate; mineralized red oxide and pyritic in fractures.	2322 S	107.5	110.0	2.5	TR	
90.0	Quartz-carbonate. A little disseminated pyritic mineralization.	2323 S	110.0	112.5	2.5	TR	
102.5	Quartz-carb. a little red-oxide hematization.	2324 S	112.5	117.5	5.0	TR	
		2325 S	117.5	122.5	5.0	TR	
105.0	Quartz-carb. well fractured with good pyritic and hematitic mineralization.	2326 S	122.5	125.0	2.5	TR	
		2327 S	125.5	130.0	4.5	TR	
125.0	Ditto per above. Not quite as much mineralization. Core ground at Diabase or argillite or greenstone inclusion at 122.5 to 123.5	2328 S	130.0	135.0	5.0	NIL	
		2329 S	135.0	141.0	5.0	NIL	

DIAMOND DRILL RECORD

PROPERTY

HOLE No. 59-3

SHEET NUMBER 2

**DUPLICATE COPY
POOR QUALITY ORIGINAL
TO FOLLOW**

STARTED

LATITUDE

COMPLETED

DEPARTURE

ULTIMATE DEPTH

ELEVATION

DIP

PROPOSED DEPTH

DEPTH FEET	FORMATION	SAMPLE NO	FROM	TO	W.D.T.	ASSAY VALUES	
						AU OZ	TON
148.0	Quartz-carbonate vein, not much mineralization. LOST CORE from 129-130 ft.	2331S	140	145	5.0	TR	
		2332S	145	147.5	2.5	NIL	
150.0	Quartz mixed with argillite. A little disseminated pyrite mineralization.	2333S	147.5	150.0	2.5	0.13	
		2334S	150	152.5	2.5	NIL	
		2335S	152.5	155	2.5	NIL	
175	Mixed argillite & quartz-carbonate with some pyritic & hematitic mineralization.	2336S	155	157.5	2.5	NIL	
		2337S	157.5	160.0	2.5	NIL	
177	Quartz-carbonate. Not much mineral.	2338S	160.0	162.5	2.5	NIL	
200	Massive argillite with occasional 1/8 inch quartz-carbonate stringers	2339S	162.5	165.0	2.5	NIL	
250	Massive banded argillite (altered) Banding about 30 deg. to long axis of core	2340S	165.0	167.5	2.5	NIL	
		2341S	167.5	170.0	2.5	NIL	
253.5	Highly altered argillite	2342S	170.0	175.0	5.0	NIL	
255.0	Quartz-carbonate. Some pyrite & red oxide.	2343S	175.0	177.5	2.5	NIL	
257.5	Brecciated argillite & quartzite (red) blocky and muddy.	2344S	177.5	180.0	2.5	TR	
258.5	Quartz-carbonate-altered and brecciated with a little pyrite and hematization.	2345S	180.0	185.0	5.0	TR	
		2346S	185.0	190.0	5.0	NIL	
261.0	LOST CORE FROM 258.5 to 261 feet	2347S	190.0	195.0	5.0	TR	
275.0	Red quartzite	2348S	195.0	200.0	5.0	TR	
	END OF HOLE.	2349S	250.0	255.0	5.0	TR	
		2350S	255.0	260.0	5.0	NIL	

DIAMOND DRILL RECORD

JO-AMI GOLD MINES LIMITED, MONGOWIN TOWNSHIP

PROPERTY SUDBURY MINING DIVISION, Whitefish Falls, Ontario. HOLE No 59-3

SHEET NUMBER 1 Of 2 SECTION FROM 0 TO 125-feet STARTED December 6th, 1959

Location: - Approx. 115 feet N. 20 deg. 40 min. W. Moyle Lake COMPLETED December 14th, 1959

~~XXXXXX~~ of Hole No. 59-1 DATUM Just north of S. Boundary of Claim No. 5, 107632 BEARING S, 20 deg. 40 min. E. ULTIMATE DEPTH 275 feet

ELEVATION Approx. 43.5 feet above Hole 59-1 (48.5 feet above Moyle Lake) DIP -45 degrees PROPOSED DEPTH _____

DEPTH FEET	FORMATION	SAMPLE NO.	FROM	TO	Core Length (feet)	ASSAY VALUES			
						Au (oz. per ton)		SLUDGE	
						From	To		AU
9	Recent and Pleistocene-Clay & Gravel-Casing								
75	Fine grained massive basic rock-diabase- ch toritic and sericitic alteration-finely disseminated sulphides throughout.	2311 S XXXX	70	72.5	2.5	nil	NOTE: No sludge samples taken as water did not return after depth of 75 feet before reaching gold-quartz vein.		
77.5	Diabase more altered, Quartz-carb stringer at 76-76.3								
XX 80	Massive hematized, vuggy diabase	2312 S	77.5	81.5	4	Trace			
81.5	Altered, fractured diabase some pyritic mineral- -alization. LOST CORE (3 in.) @ 81.5 ft.	2313 S	81.5	82.5	1	nil			
82.5	Quartz-carb.-mineralized. Blocky-ONLY 50% CORE RECOVERED								
85.5	Diabase altered and hematized	2314 S	82.5	85.5	3	Trace			
87	Quartz-Carbonate, mineralized red oxide & pyritic in fractures	2315 S	85.5	87	1.5	0.05			
90	Quartz-carbonate. A little disseminated pyritic mineralization	2316 S	87	90	3	Trace			
102.5	Quartz-carb. a little red-oxide hematization	2317 S	90	95	5	Tr.			
105	Quartz-carb. well fractured with good pyritic and hematitic mineralization.	2318 S 2319 S	95 100	100 102.5	5 2.5	nil Tr.			
125	Ditto per above. Not quite as much mineraliz- ation. Core ground at 109 feet. XXXX Diabase or small bits of greenstone ??? inclusion at 122.5 to 123.5	2320 S 2321 S 2322 S 2323 S	102.5 105 107.5 110	105 107.5 110 112.5	2.5 2.5 2.5 2.5	0.09 0.03 Trace Tr.			

NORTHERN MINER FORM 503 REV. 54

DRILLED BY CAMERON DRILLING COMPANY LIMITED SIGNED A. S. Bayne, P. Eng.

P. O. Box 400, MALARTIC, P. Que.

DIAMOND DRILL RECORD

JO-AMI GOLD MINES LIMITED, MONGOWIN TWP.

PROPERTY SUDBURY MINING DIVISION, Whitefish Falls, Ont. HOLE No. 59-3

SHEET NUMBER 2 of 2 SECTION FROM 125 TO 275 -feet STARTED Dec. 6, 1959

Location--SEE SHEET NO. 1
 BEARING S. 20 deg. 40 min. E. COMPLETED Dec. 14, 1959

DEPARTURE -45 degrees ULTIMATE DEPTH 275 feet

ELEVATION -45 degrees PROPOSED DEPTH

DEPTH FEET	FORMATION	SAMPLE NO.	FROM	TO	Core Diameter (inches)	ASSAY VALUES		
						Am	Ag	Cu
148	Quartz-carbonate vein, not much mineralization LOST CORE from 129-150 ft.	2324 C	112.5	117.5				
		2325 S	117.5	122.5	5	Trace		
150	Quartz mixed with argillite. A little disseminated pyritic mineralization	2326 S	122.5	125.5	2.5	Tr.		
		2327 S	125.5	130	4.5	Tr.		
175	Mixed argillite & quartz-carbonate with some pyrite & hematitic mineralization	2328 S	130	135	5	nil		
		2329 S	135	140	5	nil		
177	Quartz-carbonate. Not much mineralization	2330 S	140	145	5	Trace	(2330 S)	
		2332 S	145	147.5	2.5	nil		
200	Massive argillite with occasional 1/8 inch quartz-carbonate stringers.	2333 S	147.5	150	2.5	0.02	-0.13	
		2334 S	150	152.5	2.5	nil		
250	Massive banded argillite (altered) banding about 30 deg. to long axis of core.	2335 S	152.5	155	2.5	nil		
		2336 S	155	157.5	2.5	nil		
253.5	Highly altered argillite	2337 S	157.5	160	2.5	nil		
		2338 S	160	162.5	2.5	nil		
255	Quartz-carbonate. Some pyrite & red oxide	2339 S	162.5	165	2.5	nil		
		2340 S	165	167.5	2.5	nil		
257.5	Brecciated argillite & quartzite (red), blocky and studdy.	2341 S	167.5	170	2.5	nil		
		2342 S	170	175	5	nil		
258.5	Quartz-carbonate altered and brecciated, with a little pyrite & hematization.	2343 S	175	177.5	2.5	nil		
		2344 S	177.5	180	2.5	Trace		
261	LOST CORE from 258.5 to 261 feet.	2345 S	180	185	5	Tr.		
		2346 S	185	190	5	nil		
275	Red quartzite	2347 S	190	195	5	Trace		
		2348 S	195	200	5	Trace		
		2349 S	250	255	5	Trace		
	END OF HOLE	2350 S	255	260	5	nil		

NORTHERN MINER FORM 505 REV/54

DRILLED BY CAMERON DRILLING COMPANY LIMITED

P.O. Box 400, MALARTIC, P.Q.

SIGNED _____

[Signature]
 A. S. [Name]

DIAMOND DRILL RECORD

PROPERTY: *APPROX 50 W 1/4 TOWN 4 N 1/4 R 10 E* HOLE No. *60-9*
 SHEET NUMBER: *1* SECTION FROM: *0'* TO: *275'* STARTED: *JAN 17, 1960*
 LATITUDE: *164' N. 20° 40' W* DATUM: *Moyle (Huso) Lake* COMPLETED: *JAN 21, 1960*
 DEPARTURE: *of Hole 60-7* BEARING: *S. 20° 40' E* ULTIMATE DEPTH: *275'*
 ELEVATION: *of Hole 59-3* DIP: *-45-0* PROPOSED DEPTH: _____
Approx 47'
above lake level

DEPTH FEET	FORMATION	SAMPLE NO.	FROM	TO	Core WIDTH Length feet	GOLD ASSAY VALUES g/t	
						CORE ASSAY	g/t
0							
7	Casing						
70	Buff coloured quartzite						
226	Dark fine grained massive diabasic rock. Mineralized with quartz, chlorite & pyrite at 172'-173'	2572	172.	173.	1.0	0.01	
226	Buff coloured quartzite						
249	Pink & brown quartzite	2576	249.	250.	1.0	2.62	
255	Mixed quartz & gneiss with quartzite. Scattered pyrite mineralization (Some spots free gold possibly?)	2577	250.	252.5	2.5	1.24	
		2578	252.5	255.	2.5	3.00	
		AVERAGE OF SECTION					
			249.	255.	6.0	2.20	
275	END OF HOLE						

K

DIAMOND DRILL RECORD

PROPERTY JO-AMI GOLD MINES LTD. MONGOWIN TWP. ONTARIO

HOLE No. 60-10

SHEET NUMBER 1 SECTION FROM TO

STARTED Jan. 20, 1968

LATITUDE Same set-up as Hole DATUM Moyle (House) Lake
60-9

COMPLETED Jan. 31, 1968

DEPARTURE Approx. 47' above BEARING S 20° 40'E
Lake level

ULTIMATE DEPTH 348'

ELEVATION DIP -60°

PROPOSED DEPTH

DEPTH FEET	FORMATION	SAMPLE NO	FROM	TO	WIDTH	ASSAY VALUES		
						AU OZ/TON		
6.0	Casing							
75.0	.Buff coloured quartzite							
77.5	Diabasic fine grained dark rock with disseminated pyrite & chalcopyrite. 4" quartz stringer at each end of length.	2573	75	77.5	2.5	TR		
		2574	77.5	80.0	2.5	TR		
80.0	Quartz vein with same hematization -some pyrite.	2575	80.0	83.0	3.0	0.20		
83.0	Same as 2573, with no pyrite.							
249.0	Diabasic, dark, fine-grained rock							
348.0	Pink quartzite with occasional quartz stringers.							

END OF HOLE.

**DUPLICATE COPY
POOR QUALITY ORIGINAL
TO FOLLOW**

DIAMOND DRILL RECORD

PROPERTY JO-AMI GOLD MINES LTD. MONGOWIN TWP. ONTARIO

HOLE No. 60-11

SHEET NUMBER 1

SECTION FROM TO

STARTED Feb. 1, 1960

LATITUDE Same set-up as HOLE # 60-10
 DATUM Moyle (House) Lake

COMPLETED Feb. 3, 1960

DEPARTURE BEARING S 78°E

ULTIMATE DEPTH 204'

ELEVATION Approx. 47' above Lake level
 DIP -45°

PROPOSED DEPTH

DEPTH FEET	FORMATION	SAMPLE NO.	FROM	TO	WIDTH	ASSAY VALUES	
						AU OZ	TON
10.0	Casing						
75.0	Mixed quartzite & greywacke						
100.0	-ditto- with some brecciation & pyrite mineralization	1809	125	130.0	5.0	TR	
125.0	Altered greywacke	1811	130	134.0	4.0	TR	
130.0	Altered greywacke with some dissemination pyrite	1813	134	138.0	4.0	TR	
134.0	-ditto- with some iron oxide	1814	150	152.5	2.5	0.01	
138.0	Quartz with 1" band of greywacke Pyrite & iron oxide.	1815	152.5	155.0	2.5	TR	
150.0	Altered greywacke	1816	155.0	157.5	2.5	NIL	
152.5	Greywacke with 1/2" quartz stringers - some pyrite	1817	157.5	160.0	2.5	NIL	
155.0	Quartz with 1" pyritic greenstone	1818	160.0	162.5	2.5	TR	
157.5	Quartz with some scattered pyrite 1" band greenstone.	1819	162.5	165.0	2.5	TR	
160.0	Quartz. No mineralization	1820	165.0	167.5	2.5	TR	
162.5	Quartz with 1" band greywacke with pyrite mineralization.	1821	190.0	192.5	2.5	0.02	
165.0	Greywacke on greenstone mineralized with pyrite crystals in fractures.						
167.5	Banded, silicified, dark rock with scattered pyrite.						
190.0	Greywacke						
192.5	Altered greywacke & quartz well mineralized with pyrite						
204.0	Greywacke END OF HOLE.						

DIAMOND DRILL RECORD

PROPERTY *...* HOLE No. **60-11**
 SHEET NUMBER *...* SECTION FROM *...* TO *...* STARTED *...*
 LATITUDE *Same set-up* DATUM *Moyle (House) 2000* COMPLETED *...*
 DEPARTURE *ds Hole 60-10* BEARING *S. 78° E* ULTIMATE DEPTH *204'*
 ELEVATION *Approx. 47' above lake level* DIP *- 45°* PROPOSED DEPTH *...*

DEPTH FEET	FORMATION	SAMPLE NO	FROM	TO	Core MARK	ASSAY VALUES (oz/ton)
0					Core GOLD COAST LONG ASIAN (Foot)	
10	Casing					
75	Mixed quartzite & greywacke					
100	- ditto - with some brecciation & pyritic mineralization					
125	Altered greywacke					
130	Altered greywacke with some disseminated pyrite	1809	125	130	5	Trace
134	- ditto - with some iron oxide	1811	130	134	4	"
138	Quartz with 1" band of greywacke. Pyrite & iron oxide	1812	134	138	4	"
150	Altered greywacke					
152.5	Greywacke with 1/2" quartz stringer some pyrite	1814	150	152.5	2.5	0.51
155	Ditto with pyritic greywacke	1815	152.5	155

HL

DIAMOND DRILL RECORD

PROPERTY *...* HOLE No. *10-11*
 SHEET NUMBER *2* SECTION FROM *...* TO *...* STARTED *...*
 LATITUDE *Same set-up as Hole 60-10* DATUM *May 10 (170010) 440* COMPLETED *Feb 2, 1960*
 DEPARTURE *...* BEARING *S. 78° E* ULTIMATE DEPTH *214*
 ELEVATION *Approx 47' above 10th level* DIP *- 45°* PROPOSED DEPTH *...*

DEPTH FEET	FORMATION	SAMPLE NO.	FROM	TO	Core METH Length (feet)	GOLD ASSAY VALUES g/t		
						CORE ASSAY		
13-3								
157.5	Quartz with some scattered pyrite. 1" band greenstone	1816	155	157.5	2.5	nil		
160	Quartz. No mineralization	1818	160	162.5	2.5	Trace		
162.5	Quartz with 1" band greywacke with pyrite mineralization							
165	Greywacke or greenstone mineralized with pyritic crystals in fractures	1819	162.5	165	2.5	"		
167.5	Banded, silicified, dark rock with scattered pyrite	1820	165	167.5	2.5	"		
190	Greywacke	1821	190	192.5	2.5	0.02		
192.5	Altered greywacke & quartz well mineralized with pyrite							
204	Greywacke							

NORTHERN MINER FORM 534 REV 154

DRILLED BY *...*

[Signature]

DIAMOND DRILL RECORD

PROPERTY JO-AMI GOLD MINES LTD. MONGOWIN TWP. ONTARIO

HOLE No. 60-12

SHEET NUMBER 1

SECTION FROM TO

STARTED Feb. 4, 1960

52' N.78°W of Hole # 60-11

LATITUDE 34' N.12°E of Hole DATUM Moyle (House) Lake

COMPLETED Feb. 7, 1960

59-3

DEPARTURE BEARING S 78° E

ULTIMATE DEPTH 329'

ELEVATION Approx. 50' above lake level

DIP -45°

PROPOSED DEPTH

DEPTH FEET	FORMATION	SAMPLE NO.	FROM	TO	WIDTH	ASSAY VALUES			
						AU OZ/TON			
7.0	Casing								
150.0	Buff quartzite & greywacke								
155.0	Brecciated greywacke & quartz.	1822	150	155	5.0	0.02			
	Pyrite & chalcopyrite in fractures replacing breccia in massive blebs	1823	155	157.5	2.5	Tr.			
157.5	Greywacke & quartz breccia with sparse pyrite	1824	157.5	160.0	2.5	Tr.			
		1825	160.0	162.5	2.5	Tr			
160.0	Silicified greywacke with disseminated pyrite 1/4" blbes at 157.5-159.0'	1826	162.5	165.0	2.5	"			
		1827	165.0	167.5	2.5	"			
162.5	Silicified greywacke & quartzite with some disseminated pyrite Two 1/4" blebs pyrite at 161.5'	1828	226	230	4.0	"			
		1829	230	232	2.0	"			
165.0	Altered greywacke with quartz. Brecciated with massive blebs of pyrite and chalcopyrite.	1830	232	234	2.0	0.01			
167.5	Mixed greywacke & quartzite with occasional specks of pyrite.								
226.0	Massive greywacke quartzite								
230.0	Dark greywacke with quartz interbands, scattered pyrite.								
232.0	Black banded argillite with 1/8" stringers quartz. Sparse pyrite								
234.0	Altered black silicified banded rock with quartz stringers. Pyrite scattered in massive blebs.								
329.0	Buff & grey mixed greywacke & quartzite								
	END OF HOLE.								

**DUPLICATE COPY
POOR QUALITY ORIGINAL
TO FOLLOW**

DIAMOND DRILL RECORD

50 - FIMI GOLD MINES SERVICE

PROPERTY: MONKOWIN TWP. ONTARIO HOLE No. 60-12
 SHEET NUMBER: 2 SECTION: FROM 162.5' TO 232' STARTED: FEB. 4, 1960
 LATITUDE: 50° DATUM: Moyle (House) Lake COMPLETED: FEB. 7, 1960
 DEPARTURE: 54.00 BEARING: S. 78° E. ULTIMATE DEPTH: 329'
 ELEVATION: 1 DIP: -45° PROPOSED DEPTH: _____

DEPTH FEET	FORMATION	SAMPLE NO.	FROM	TO	CORE MARK LENGTH (feet)	GOLD CORE ASSAY	ASSAY VALUES OZ/TON			
162.5										
165	Altered greywacke with quartz. Brecciated with massive blocks of dyrite & chalcidynite.	1826	162.5	165	2.5	Trace				
167.5	Mixed greywacke & quartzite with occasional pieces of dyrite.	1827	165	167.5	2.5	"				
226	Massive greywacke & quartzite									
230	Dark greywacke with quartz interbedded. Scattered dyrite	1828	226	230	4.0	"				
232	Black banded argillite with 1/2" stringers quartz. Sparse pyrite	1829	230	232	2.0	"				

NORTHERN MINER FORM 100 REV 7/54

DRILLED BY:

Cameron Dillingham
 Malanda Co

B

DIAMOND DRILL RECORD

30-0111 GOLD MINES LTD

PROPERTY: MUNGOWIN TWP., ONTARIO HOLE No. 11-12
 SHEET NUMBER: 3 SECTION FROM 252' TO 329' STARTED Feb. 4, 1960
 LATITUDE: _____ DATUM: Meyle (Hovac) date _____ COMPLETED Feb. 7, 1960
 DEPARTURE: 500 shoot #1 BEARING: S. 78° E. ULTIMATE DEPTH: 329'
 ELEVATION: _____ DN: -450 PROPOSED DEPTH: _____

DEPTH FEET	FORMATION	SAMPLE NO.	FROM	TO	CORE LENGTH (feet)	GOLD ASSAY VALUES OZ/TON			
						CORE ASSAY			
232									
234	Altered black silicified banded rock with quartz stringers. Pyrite scattered in massive blocks	1850	232	234	2.0	0.91			
329	Buff & grey mixed granite & quartzite								
	- END OF HOLE -								

NORTHERN MINER FORM 809 REV. 54

DILLED BY: _____ SIGNED: _____

DIAMOND DRILL RECORD

PROPERTY JO-AMI GOLD MINES LTD. MONGOWIN TWP. ONTARIO HOLE No. 60-13
 SHEET NUMBER 1 SECTION FROM _____ TO _____ STARTED Feb. 9/60
 LATITUDE 100 ft. N. 12° E DATUM Moyle (House) Lake COMPLETED Feb. 15/60
 of Hole # 60-11
 DEPARTURE _____ BEARING S 78° E ULTIMATE DEPTH _____
 ELEVATION Approx. same as DIP -60° PROPOSED DEPTH _____
Hole # 60-11

DEPTH FEET	FORMATION	SAMPLE NO.	FROM	TO	WIDTH	ASSAY VALUES		
						AU OZ/TON		
5.0	Casing							
164.0	Mixed quartzite & greywacke	2579	164	165	1.0	0.03		
165.0	Altered, banded, argillaceous greywacke. Disseminated pyrite	2580	188.5	190	1.5	0.03		
188.8	Mixed greywacke & quartzite. No brecciation of pyrite observed							
190.0	Massive altered greywacke with much fine scattered pyrite.							
337.0	Mostly greywacke with occasional quartzite and quartz stringers.							
	END OF HOLE.							

DUPLICATE COPY
POOR QUALITY ORIGINAL
TO FOLLOW

DIAMOND DRILL RECORD

PROPERTY *Manganese*

HOLE No. **60-12**

SHEET NUMBER

SECTION FROM

TO

337'

STARTED

11-17-1960

LATITUDE

100 ft N. 12° E

DATUM

Moyl (Horse) Lake

COMPLETED

Feb. 15, 1960

DEPARTURE

of Hole 60-11

BEARING

S. 78° E.

ULTIMATE DEPTH

337

ELEVATION

1110 ± same as Hole 60-11

DP

-60°

PROPOSED DEPTH

DEPTH FEET	FORMATION	SAMPLE NO.	FROM	TO	CORE NUMBER	CORE		ASSAY VALUES g/t or %	
						LENGTH (feet)	ASSAY		
0									
4	<i>Casing</i>								
164	<i>Mixed quartzite & gneiss</i>	<i>2579</i>	<i>164</i>	<i>165</i>	<i>1.0</i>	<i>0.03</i>			
165	<i>Altered, banded argillaceous gneiss. Disseminated pyrite</i>								
188.5	<i>Mixed gneiss & quartzite. No brecciated pyrite observed</i>								
190	<i>Massive altered gneiss with much fine fractured pyrite</i>	<i>2580</i>	<i>188.5</i>	<i>190</i>	<i>1.5</i>	<i>0.03</i>			
337	<i>Mainly gneiss with occasional quartzite and quartzite stringers.</i>								
	<i>- END OF HOLE.</i>								

NORTHERN MINER FORM 509 REV 1/54

DRILLED BY

Charles E. ...

15

DIAMOND DRILL RECORD

PROPERTY JO-AMI GOLD MINES LTD. MONGOWIN TWP. ONTARIO HOLE No. 60-14
 SHEET NUMBER SECTION FROM TO STARTED Feb. 16/60
 LATITUDE 50'N. 12°E of Hole DATUM Moyle (House) Lake COMPLETED Feb. 20/60
 DEPARTURE BEARING S 78° E ULTIMATE DEPTH 207'
 ELEVATION Approx. same as 60-11 DIP -45° PROPOSED DEPTH

DEPTH FEET	FORMATION	SAMPLE NO.	FROM	TO	WIDTH	ASSAY VALUES			

11.0	Casing
207.0	<p>Mostly massive greywacke with small quartz stringers and some quartzite throughout core. No important mineralization noted.</p> <p>Some alteration observed, but no visible evidence of fault breccia as in Holes # 60-11, 60-12.</p> <p>No samples taken.</p> <p>END OF HOLE.</p>

DUPLICATE COPY
POOR QUALITY ORIGINAL
TO FOLLOW

DIAMOND DRILL RECORD

TO. DR. 5022 MINES LTD

PROPERTY

MUNGOHLY T.W.O.

HOLE No.

60-14

SHEET NUMBER

1

SECTION FROM

0' TO

STARTED

Feb 16 1955

LATITUDE

50 ft N. 12° E

DATUM

May 10 (House) Lette

COMPLETED

Feb 20 1955

DEPARTURE

of Hole 60-11

BEARING

S. 78° E

ULTIMATE DEPTH

207'

ELEVATION

Approx same as Hole 60-N

DIP

- 45°

PROPOSED DEPTH

DEPTH FEET	FORMATION	SAMPLE NO.	FROM	TO	Core Length (feet)	ASSAY VALUES	OTHER
0							
11	Casing						
207	Mostly massive greywacke with small quartz stringers & some quartzite. Throughout core. No important mineralization noted. Some alteration observed but no visible evidence of fault breccia as in Holes Nos. 60-11 & 60-12. No samples taken.						
	- END OF HOLE -						

[Signature]

DIAMOND DRILL RECORD

J. J. AMI GOLD MINES LTD

PROPERTY *MONGOWIN TWP, ONTARIO* HOLE No. *60-15*
 SHEET NUMBER *1* SECTION FROM *0' TO 164'* STARTED *Feb. 21, 1960*
 LATITUDE *100 ft. S. 78° E.* DATUM *Moyle (House) L.M.R.* COMPLETED *Feb. 23, 1960*
 DEPARTURE *from Hole 60-14* BEARING *N. 78° W.* ULTIMATE DEPTH *164'*
 APPROX. *same*
 ELEVATION *at hole 60-14* *500* PROPOSED DEPTH

DEPTH FEET	FORMATION	SAMPLE NO.	FROM	TO	Core Length (feet)	ASSAY VALUES 8/2/64	
						CORE	ASSAY
0							
8	Casing						
164	Mixed buff greywacke + quartzite with some narrow quartz stringers No important mineralization observed. Bedding and/or cleavage at small angle to core indicating drill following general dip too closely, so hole stopped. No samples taken						

NORTHON MINER FORM 101 REV. 54

DRILLED BY *[Signature]* SIGNED *[Signature]*

14

DIAMOND DRILL RECORD

PROPERTY..... JO-AMI GOLD MINES LTD. MONGOWIN TWP. ONTARIO HOLE No. 60-16
 SHEET NUMBER SECTION FROM TO STARTED Feb. 14/60
 LATITUDE Same set-up as Hole 60-12 DATUM Moyle (House) Lake COMPLETED Feb. 28, 1960
 DEPARTURE BEARING ULTIMATE DEPTH 211'
 ELEVATION Same as Hole 60-12 DIP PROPOSED DEPTH

DEPTH FEET	FORMATION	SAMPLE NO.	FROM	TO	WIDTH	ASSAY VALUES		
						AU	Gold	Assay
10.0	Casing	1831	161.0	162.5	1.5	0.01		
160.0	Dark, fine grained diabasic rock	1832	162.5	165.0	2.5	NIL		
162.5	Quartz with some argillites scattered disseminated pyrite mineralization. with varying degrees of red oxidization Hole possibly paralleling dip of gold- bearing zones intersected in holes 59-1, 59-2, 59-3	1833 1834	165.0	167.5	2.5	-		
195.0	- ditto -	1835	170.0	172.5	2.5	-		
197.5	Argillite & quartz with some pyrite and red oxide.	1836	172.5	175.0	2.5	-		
200.0	Argillite with some quartz	1837	175.0	177.5	2.5	-		
		1838	177.5	180.0	2.5	-		
	END OF HOLE.	1839	180.0	183.0	2.0	-		
		1840	183.0	185.0	2.0	-		
		1841	185.0	190.0	5.0	-		
		1842	190.0	193.5	3.5	TR		
		1843	193.5	195.0	1.5	0.03		
		1844	195.0	197.5	2.5	NIL		
		1845	197.5	200.0	2.5	-		
		1846	200.0	205.0	5.0	-		
		1847	205.0	211.0	6.0	-		

DUPLICATE COPY
POOR QUALITY ORIGINAL
TO FOLLOW

DIAMOND DRILL RECORD

PROPERTY *McKenna Mine District* HOLE No. *60-16*
 SHEET NUMBER *1* SECTION FROM *3* TO *195* STARTED *Feb 24, 1960*
 LATITUDE *Same set-up* DATUM *May 10 (House) datum* COMPLETED *Feb 28, 1960*
 DEPARTURE *as Hole 60-12* BEARING *S. 12° W* ULTIMATE DEPTH *211'*
 ELEVATION *Same as Hole 60-12* DIP *- 45°* PROPOSED DEPTH

DEPTH FEET	FORMATION	SAMPLE NO.	FROM	TO	Core Width Length (feet)	GOLD		ASSAY VALUES OZ/TON	
						CORE	ASSAY		
0									
10	Casing								
160	Dark fine grained diabase	1831	161	162.5	1.5	0.01			
	rock	1832	162.5	165	2.5	nil			
162.5	Quartz with some pyrite	1833	165	167.5	2.5	-			
	Scattered disseminated	1834	167.5	170.0	2.5	-			
	pyritic mineralization	1835	170	172.5	2.5	-			
	with varying degrees	1836	172.5	175	2.5	-			
	of red oxidation	1837	175	177.5	2.5	-			
	Hole possibly paralleling	1838	177.5	180	2.5	-			
	dip of gold-bearing zone	1839	180	183	2.0	-			
	interested in Holes	1840	183	185	2.0	-			
	59-1, 59-2 & 59-3	1841	185	190	5.0	-			
		1842	190	193.5	3.5	Trace			
195	ditto	1843	193.5	195	1.5	0.03			

15

DIAMOND DRILL RECORD

270 - 100 - 1000 - 1000 - 1000

PROPERTY *MONTGOMERY TWP, ONTARIO* HOLE No. *50 A*
 SHEET NUMBER *2* SECTION FROM *195' TO 211'* STARTED *Feb 24, 1960*
 LATITUDE *50° 54' 45"* DATUM *May 10 (H 100) L.H.C.* COMPLETED *Feb 28, 1960*
 DEPARTURE *2 1/2 Hk 60-12* BEARING *S. 120 W* ULTIMATE DEPTH *211'*
 ELEVATION *Sta. 45 Hk 60-12 O.P.* *- 450* PROPOSED DEPTH _____

DEPTH FEET	FORMATION	SAMPLE NO.	FROM	TO	Core Length (feet)	CORRECTION		ASSAY VALUES OR TESTS				
						+	-					
<i>195</i>												
<i>197.5</i>	<i>Argillite & quartz with some pyrite & red oxide.</i>	<i>1844</i>	<i>195</i>	<i>197.5</i>	<i>2.5</i>			<i>nil</i>				
		<i>1845</i>	<i>197.5</i>	<i>200</i>	<i>2.5</i>							
<i>200</i>	<i>Argillite with some quartz</i>	<i>1846</i>	<i>200</i>	<i>205</i>	<i>5.0</i>							
		<i>1847</i>	<i>205</i>	<i>211</i>	<i>6.0</i>							
	<i>End of Hole</i>											

NORTHERN MINER FORM 508 REV 1/60

DRILLED BY *CONWAY ILLINOIS* SIGNED *[Signature]*
16

MONGOWIN TWP.
(M. 871)

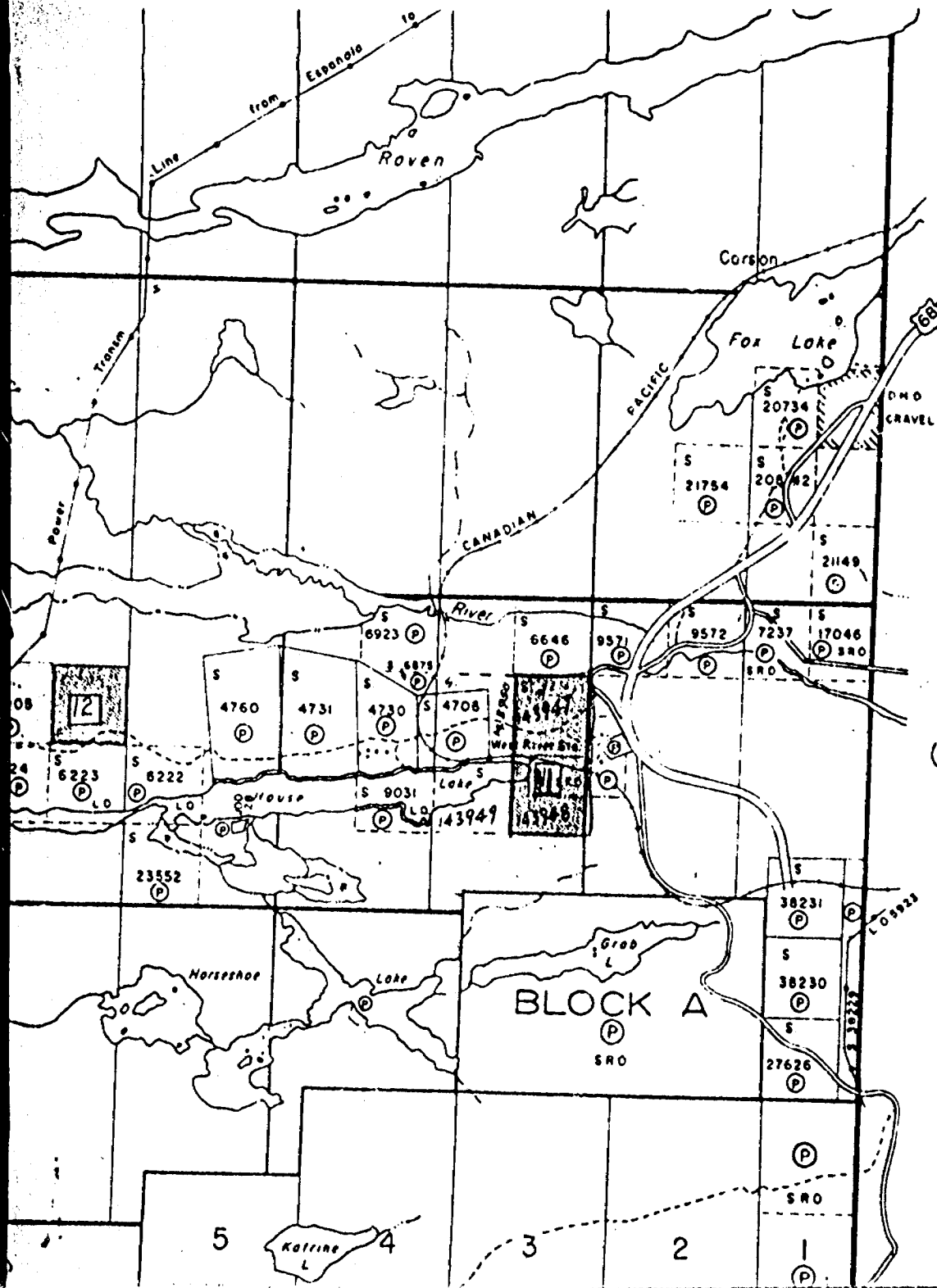

WHITEFISH RIVER
INDIAN RESERVE
(SURRENDERED PORTION)

FOR STATUS REFER TO
Curtin Twp. - M. 745

McKinnon Twp. - M.014

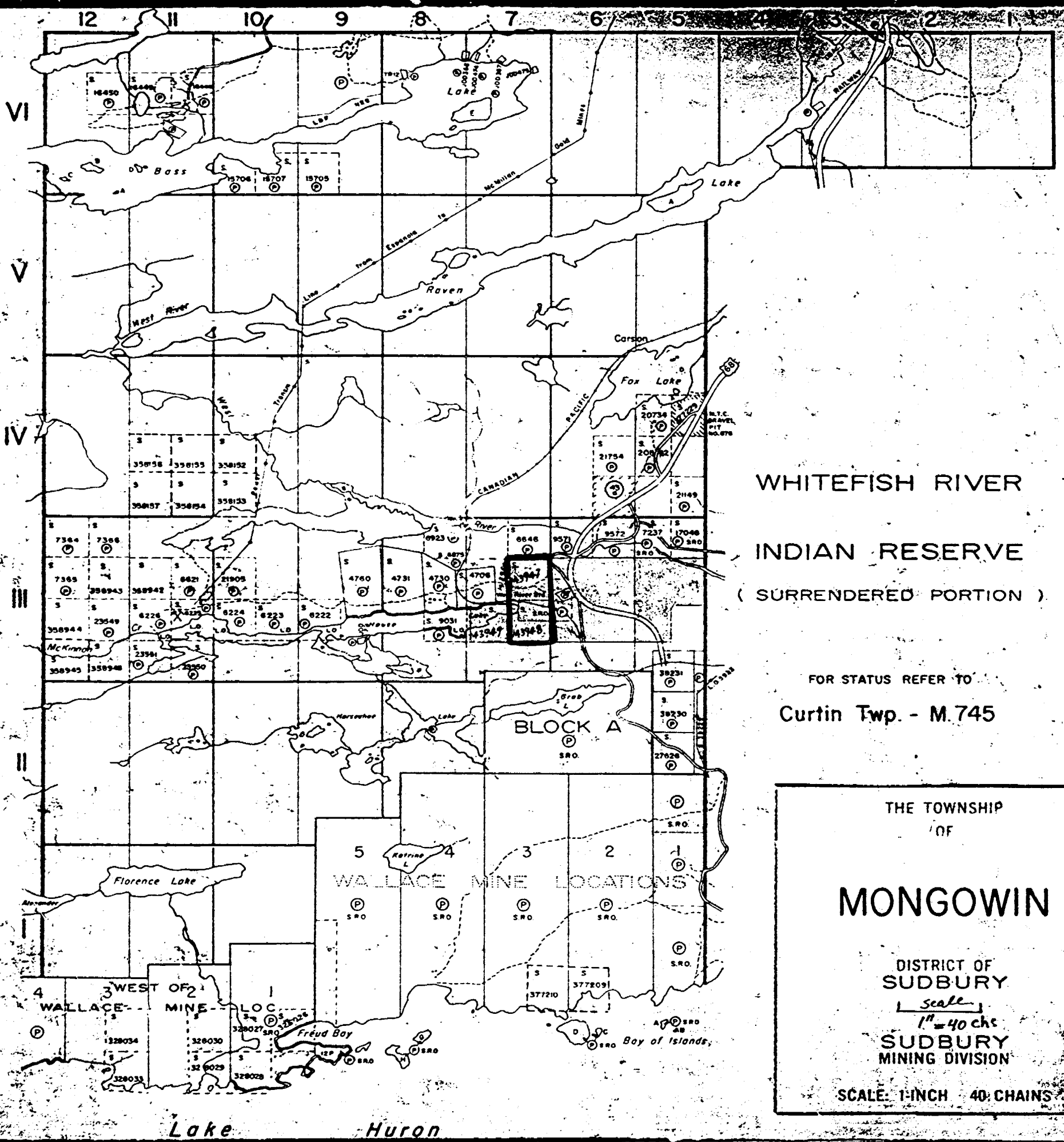

WHITEFISH RIVER
 INDIAN RESERVE
 (SURRENDERED PORTION)

FOR STATUS REFER TO
 Curtin Twp. - M.745

THE TOWNSHIP
 OF
MONGOWIN
 DISTRICT OF
 SUDBURY
 Scale
 1" = 40 chs
 SUDBURY
 MINING DIVISION
 SCALE: 1-INCH 40 CHAINS

Lake Huron

REVISIONS

DATE	LOCATION OF DIAMOND DRILL HOLES	DDH.N ^o	BEARING	DIP	LENGTH (feet)
Dec. 27/59		59-1	N 20°40' W	-45°	187'
Dec. 27/59		59-2	N 20°40' W	-60°	142'
Dec. 27/59		59-3	S 20°40' E	-45°	275'
Dec. 27/59		59-4	N 60°40' W	-45°	106'
Dec. 27/59		59-5	N 20°40' W	-45°	255'

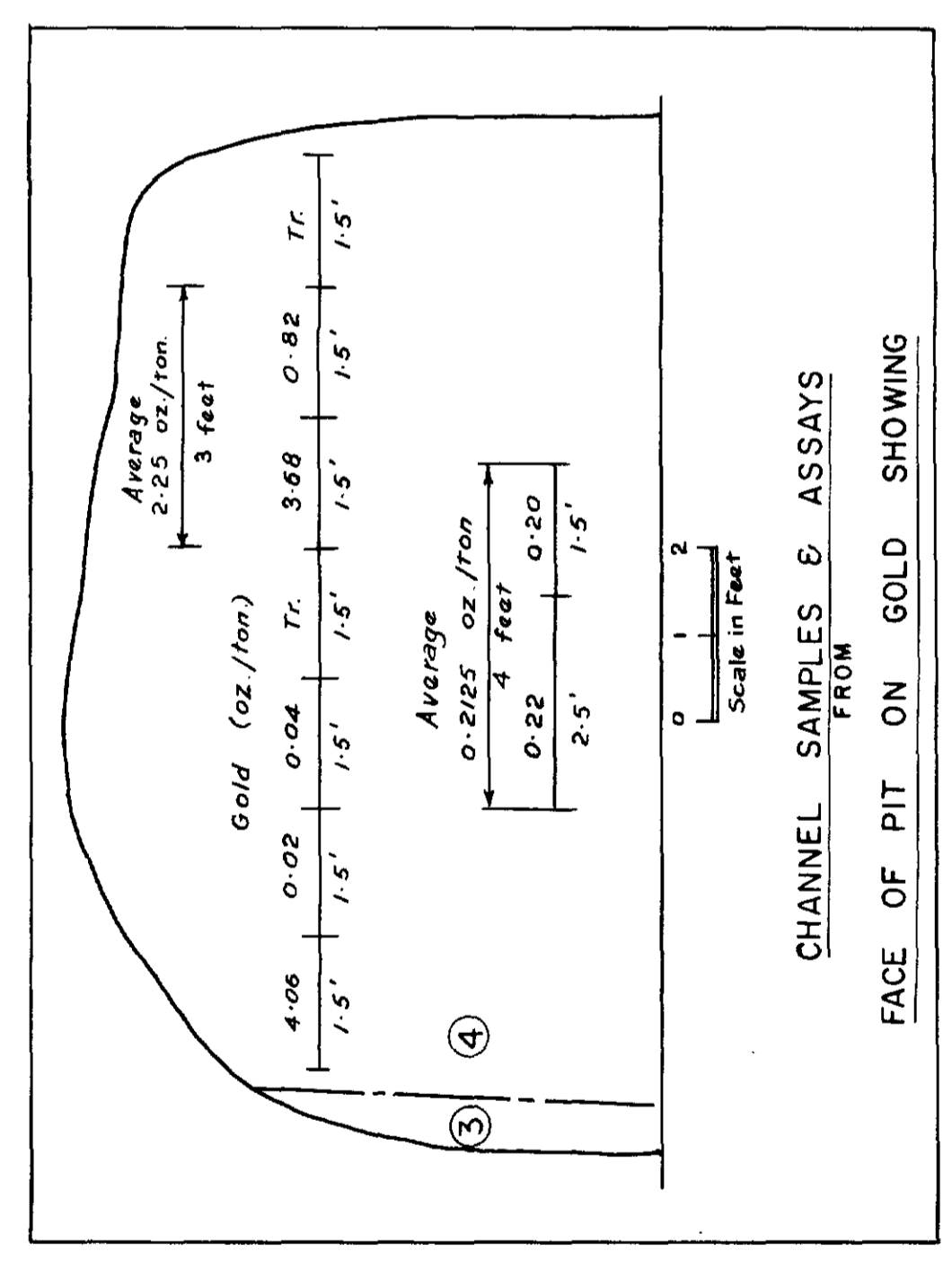
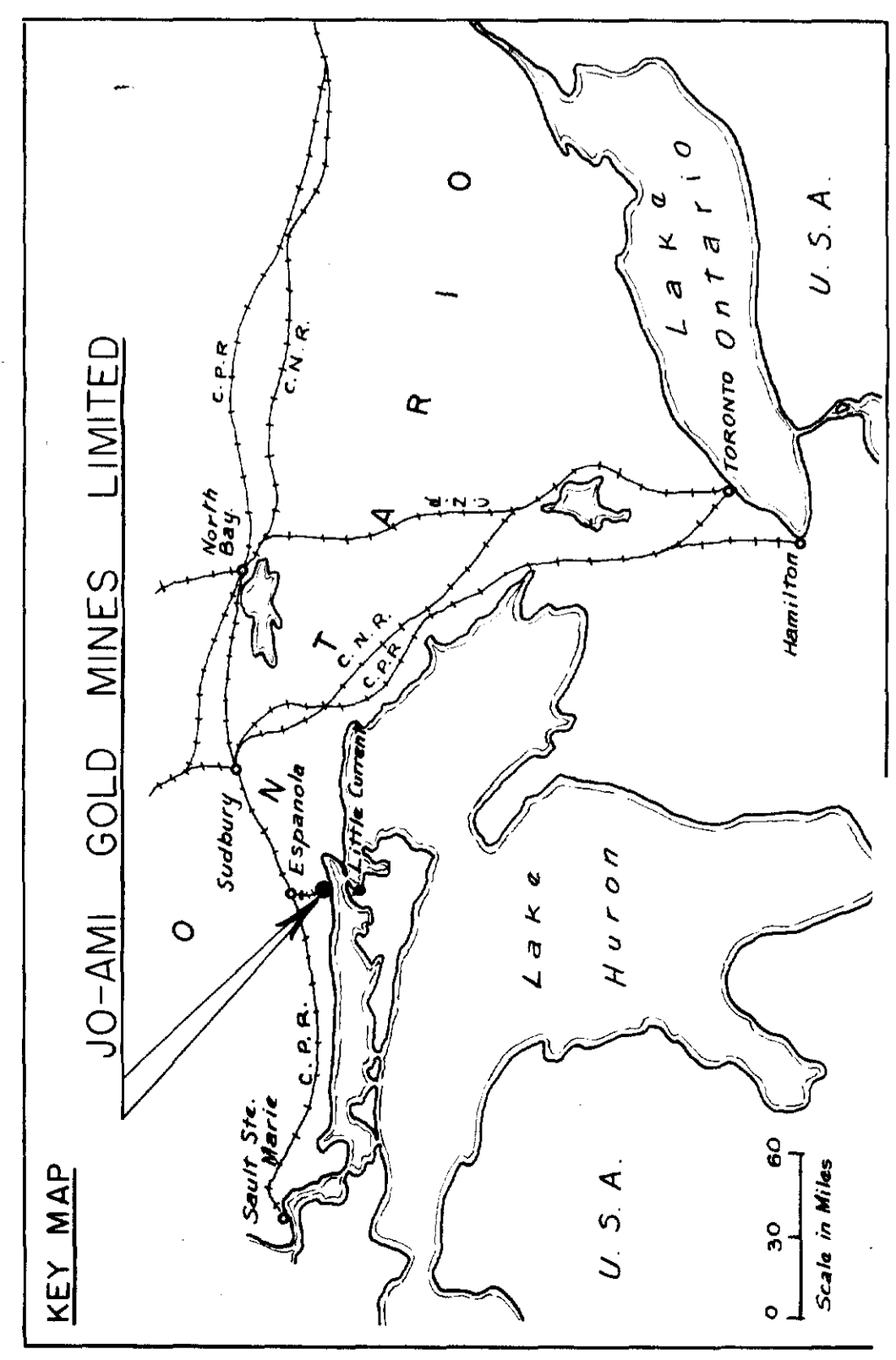
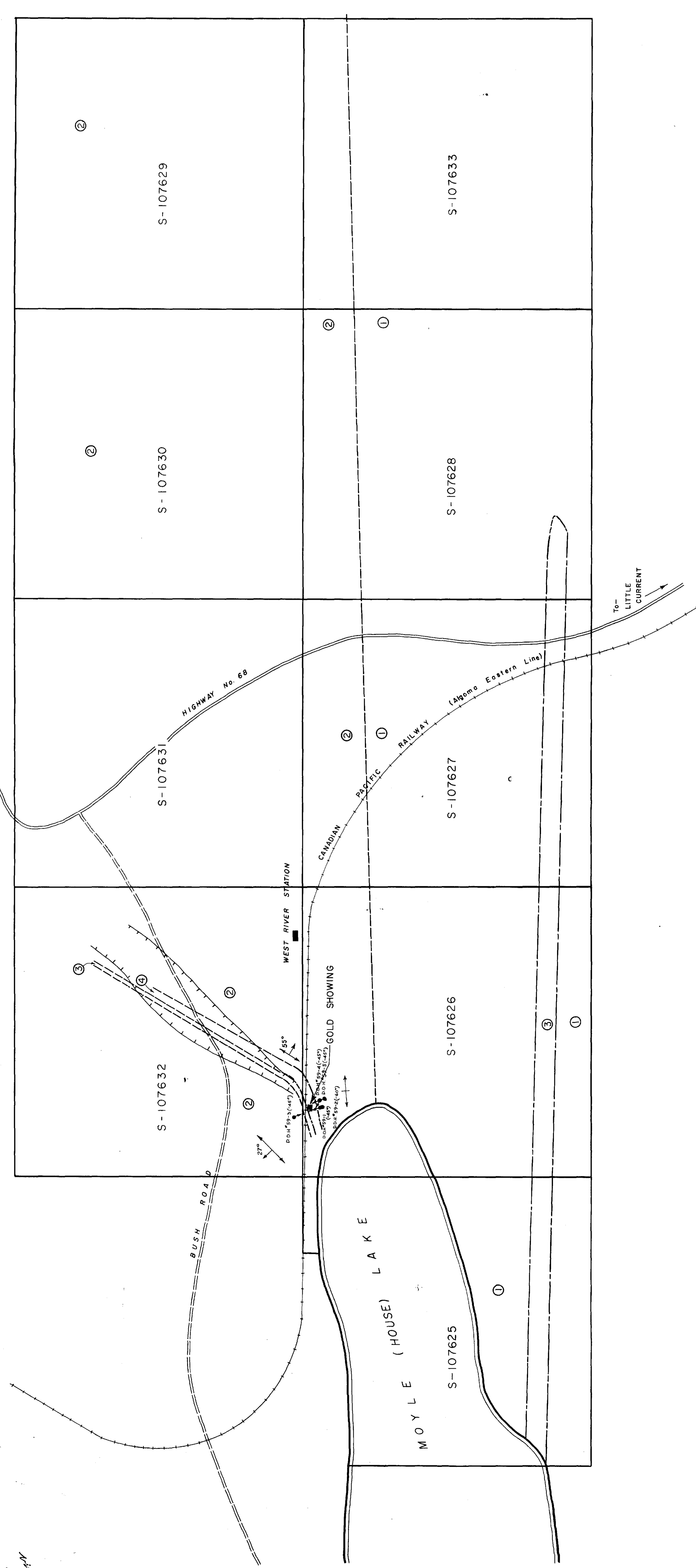

- LEGEND
- ④ Quartz Vein with graywacke and argillite.
 - ③ Diabase [Missing?]
 - ② Quartzite, argillite [Gonganda] and conglomerate [Formation]
 - ① Lorrain quartzite
 - Strike of vertical bedding or schistosity
 - Strike and dip of inclined bedding or schistosity
 - Geological contact assumed
 - Geological contact defined
 - Topographic depression.

PRELIMINARY SKETCH
 -SHOWING-
 LOCATION & GENERAL GEOLOGY
 -OF-
JO-AMI GOLD MINES LTD.
 MONGOWIN TOWNSHIP SUDBURY MINING DIVISION
 ONTARIO CANADA
 SCALE IN FEET
 0 220 660 1320

A.S. BAYNE & COMPANY
 CONSULTING ENGINEERS
 TORONTO, CANADA
 AUGUST 25, 1959
 DWN BY - A.S.B.
 TCD BY - C.A.H.
 CHECKED - A.S.B.
MONGOWIN-0014 #1

