



41105NE0019 0016 DRURY

010

# Diamond Drilling

Township of DRURY

Report No 30

Work performed by: Kerr Addison Mines Limited

Claim No	Hole No	Footage	Date	Note
S 358413 ε				
S 358415	KR-76-2	1168.0'	Oct/76	(1)
S 358413 ε				
S 358416	KR-76-1	1501.0'	Oct/76	(1)
S 291530	KR-76-3	1260.2'	Nov/76	(1)
S 324578	KR-76-4	154.0'	Dec/76	(1)
	KR-76-5	316.0'	Jan/77	(2)
	KR-76-6	1376.0'	Jan/77	(2)
S 324580	KR-76-7	366.0'	Jan/77	(2)
S 358475	KR-76-8	448.0'	Feb/77	(2)

TOTAL 8 DH 6589 FT

### Notes:

(1) #13-77

(2) #33-77

# DIAMOND DRILL RECORD

LOGGED BY Guy Hinse

Kerr Addison Mines Limited - Ryanor Newnorth Option - 0-10 - Drury Township, Ontario

D.D. No. 16-2 PAGE 1

BEARING OF HOLE N 20°E STARTED Oct. 26, 1976  
 DIP OF HOLE -75° COMPLETED Nov. 17, 1976  
 DIP TESTS See list DEPTH 1168.0'  
 Hosking Diamond Drilling - 25 Tardiff Street, Rouyn, Quebec - AQ Core

S 358413

CLAIM No. S-358413, 358415  
 DIRECTION AND DISTANCE FROM  
 NE. CLAIM POST

FOOTAGE		DESCRIPTION	SAMPLE	FOOTAGE		SAMPLE LENGTH	ASSAY		
FROM	TO			FROM	TO				
0.0	14.0	Casing					TROPARI TESTS		
14.0	30.8	Argillite, dark grey, very fine grained, altered, well bedded 200 to ca.					100'	-70°	21°
30.8	86.1	Arkose, low grey, medium grained, unaltered, massive.					200'	-66°	21°
		60.0 on, coarse, few narrow argillite beds toward's 86.1					300'	-58°	22°
		At 85.0, 1 1/2" argillite, weakly graphitic.					400'	-50°	21°
		At 36.0, bedded 15° to c.a.					600'	-40°	21°
		42.4-43.1 open seam					800'	-24°	21°
86.1	91.6	Siltstone, dark grey, very fine grained, altered, poorly bedded, coarser toward 91.6					1000'	-15°	24°
91.6	96.1	Arkose, coarse, dark grey, impure.					1150'	-10°	23°
96.1	99.5	Siltstone							
99.5	103.2	Micro-conglomerate, oligomictic, 2mm stretched quartz pebbles in a sericite-carbonate matrix, massive.							
103.2	112.5	Quartzite, medium to dark grey, impure, massive, unaltered.							
112.5	113.3	Conglomerate, oligomictic, 70% well stretched pebbles, 15mm in a sericite matrix, barren	1607		112.5	113.3	0.8	Nil	

**DUPLICATE COPY  
POOR QUALITY ORIGINAL  
TO FOLLOW**

# DRILL RECORD

LOGGED BY Guy Hirs

Ryanor Mines Limited - Ryanor Newnorth Option - "O-1G" - Drury Township - Ontario

CORRECTION AR 76-2 PAGE 1

LATITUDE \_\_\_\_\_ BEARING OF HOLE N 20° E STARTED Oct. 26, 1976  
 DEPARTURE \_\_\_\_\_ DIP OF HOLE -75° COMPLETED Nov. 17, 1976  
 ELEVATION \_\_\_\_\_ DIP TESTS See list DEPTH 1168.0'

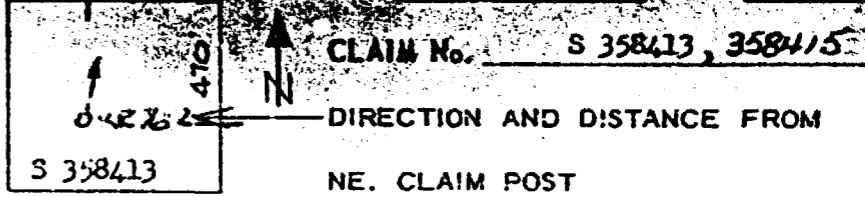

Hosking Diamond Drilling - 25 Tardif Street - Rouyn, Quebec - AQ Core

FOOTAGE		DESCRIPTION	SAMPLE No.	FOOTAGE		SAMPLE LENGTH	U <sub>3</sub> O <sub>8</sub> TV3B		ASSAY	
FROM	TO			FROM	TO		10. ton	T <sub>2</sub>	Trompeli Tests	
0.0	14.0	Casing								
14.0	30.8	Argillite, dark grey, very fine grained, altered, well bedded 200 to c.a.						100'	-70°	21°
30.8	86.1	Arkosa, low grey, medium grained, unaltered, massive.						200'	-66°	21°
		60.0 on, coarse, few narrow argillite beds towards 86.1.						300'	-55°	22°
		At 85.0, 1 1/2" argillite, weakly graphitic.						400'	-50°	21°
		At 36.0, bedded 15° to c.a.						600'	-40°	21°
		42.4-43.1 open seam.						800'	-25°	21°
86.1	91.6	Siltstone, dark grey, very fine grained, altered, poorly bedded, coarser towards 91.6						1000'	-15°	24°
91.6	96.1	Arkosa, coarse, dark grey, impure.						1150'	-10°	23°
96.1	99.5	Siltstone.								
99.5	103.2	Micro-Conglomerate, oligomictic, 2 mm stretched quartz pebbles in a sericite-carbonate matrix, massive.								
103.2	112.5	Quartzite, medium to dark grey, impure, massive, unaltered.								
112.5	113.3	Conglomerate, oligomictic, 70% well stretched pebbles, 15 mm in a sericite matrix, barren								
			1607	112.5	113.3	0.8	N:1			

# DRILL RECORD

LOGGED BY \_\_\_\_\_

LD:RNG. 76-2 PAGE 2

ATTITUDE \_\_\_\_\_ BEARING OF HOLE \_\_\_\_\_ STARTED \_\_\_\_\_  
 DEPARTURE \_\_\_\_\_ DIP OF HOLE \_\_\_\_\_ COMPLETED \_\_\_\_\_  
 ELEVATION \_\_\_\_\_ DIP TESTS \_\_\_\_\_ DEPTH \_\_\_\_\_

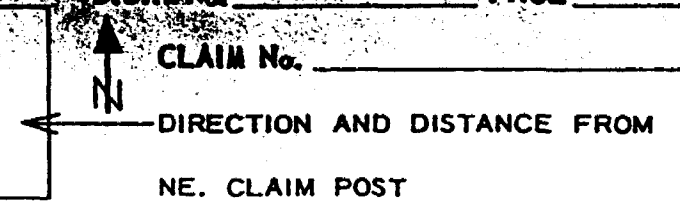
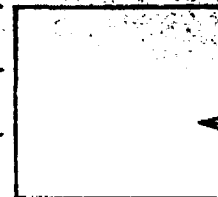

FOOTAGE		DESCRIPTION	SAMPLE No.	FOOTAGE		SAMPLE LENGTH	U <sub>3</sub> O <sub>8</sub> TV3B ASSAY		ThO <sub>2</sub>	
FROM	TO			FROM	TO		lb. ton	T <sub>2</sub>	lb. ton	
113.3	250.0	Arkose, low grey and white with shades of green and pink, very coarse, massive, unaltered. 3" low pink quartz at 114.4;								
		115.5-116.0 narrow white quartz and weak brecciation.								
		At 117.0, 20° to c.a., 197.0, 25°								
		150.0-150.9 few narrow, 4 mm wide, very coarse quartzite in arkose as above.	1608	150.0	150.9	0.9	Tr	460		
		163.7-164.7 irregular bedding, blotchy patches of pink arkose, crumpled bedding.								
		182.0-183.3 30% 4 mm partly well stretched pebbles.	1609	182.0	183.3	1.3	.30	500		
250.0	259.3	Micro-conglomerate, 30% 2 mm, arkosic, sericite matrix.								
		At 252.5 1" pure arkose, traces of pyrite	1610	252.3	252.8	0.8	Tr	440		
		257.3-257.9 15% well stretched, 5 mm, traces of pyrite	1611	252.8	257.3	4.5	Tr			
			1612	257.3	257.9	0.5	.20	700		
			1613	257.9	258.3	0.4	.20			
			1614	258.3	258.9	0.6	7.2	1900	4.7	} 3.20/1.0'
			1615	258.9	260.0	1.2	TR			
259.3	401.2	Arkose, low grey-green, coarse, massive, unaltered.								
		314.0-314.5 30% 4 mm well stretched pebbles	1616	314.0	314.5	0.5	.80	700	2.2	
		323.5-324.0 15% 3 mm pebbles	1617	321.5	322.1	0.6	.10	500		
			1618	323.5	324.1	0.6	.20	500		
		Quartz veins, 5" at 333.4'; 2" at 304.5'; 5" at 352.4; 5" at 353.1 with hematite and sericite; 2" at 366.1								
		400.7-401.2 40% 4mm well stretched	1619	400.7	401.2	0.5	.70	720	2.9	







# DIAMOND DRILL RECORD

LOGGED BY \_\_\_\_\_

D.I.H. No. IR 76-2 PAGE 6

PROPERTY \_\_\_\_\_  
 LATITUDE \_\_\_\_\_ BEARING OF HOLE \_\_\_\_\_ STARTED \_\_\_\_\_  
 DEPARTURE \_\_\_\_\_ DIP OF HOLE \_\_\_\_\_ COMPLETED \_\_\_\_\_  
 ELEVATION \_\_\_\_\_ DIP TESTS \_\_\_\_\_ DEPTH \_\_\_\_\_

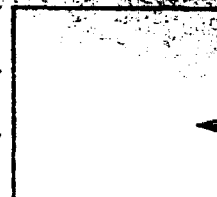

CLAIM No. \_\_\_\_\_  
 DIRECTION AND DISTANCE FROM  
 NE. CLAIM POST

FOOTAGE		DESCRIPTION	SAMPLE No.	FOOTAGE		SAMPLE LENGTH	U <sub>308</sub> TV <sub>35</sub>		ASSAY	
FROM	TO			FROM	TO		lb. ton	l <sub>2</sub>	lb. ton	
841.2	935.0	Gabbro, medium grey-green, very fine to pegmatitic, massive, relatively unaltered. Well bedded predominantly 65-80° to c.a., similar to a basic tuff. Some calcite in spots and veinlets, traces of pyrrhotite and pyrite. Few narrow interbeds of quartzite and argillite.								
935.0	945.7	Quartzite, white to medium grey, coarse, massive, unaltered. Some narrow argillite interbeds. 946.6-946.9 sericite-rich.	1623	946.6	946.9	0.3	1.2	520	.40	
945.7	1018.0	Arkose, grey-green, very coarse, massive, unaltered, few narrow pebbly sections increasing from 969.6 on. Well bedded 75° to c.a.	1636	948.3	949.7	1.4	.30	520		
		961.4 3" 30% 4 mm well stretched	1625	955.0	956.0	1.0	TR	400		
		965.2 2" 30% 10 mm well stretched	1626	956.0	956.3	0.3	.70	500	.70	
		969.6-975.0 25% 10 mm well stretched, traces of pyrite	1627	956.3	958.5	1.2	TR	500		
		971.5-972.3 40% " " " " " "	1628	958.5	961.4	2.9	TR	500		
		978.4-979.1 10% 5 mm well stretched	1629	961.4	961.8	0.4	TR	500		
		992.7-993.7 10% " " "	1630	961.8	965.0	3.2	TR	400		
		1000.6 2" 25% 10 mm well stretched, traces of pyrite	1631	965.0	969.6	4.6	TR	500		
		1001.5 4" 60% 10 mm " " " " "	1632	969.6	970.0	0.4	5.4	1400	3.3	
		1003.8 2-10 mm pebbles, weakly brecciated, traces of pyrite	1633	970.0	971.5	1.5	.20	500		



# DIAMOND DRILL RECORD

LOGGED BY \_\_\_\_\_

D.D.H. No. KR-76-2

PAGE 7

PROPERTY \_\_\_\_\_  
 ALTITUDE \_\_\_\_\_ BEARING OF HOLE \_\_\_\_\_ STARTED \_\_\_\_\_  
 DEPARTURE \_\_\_\_\_ DIP OF HOLE \_\_\_\_\_ COMPLETED \_\_\_\_\_  
 ELEVATION \_\_\_\_\_ DIP TESTS \_\_\_\_\_ DEPTH \_\_\_\_\_

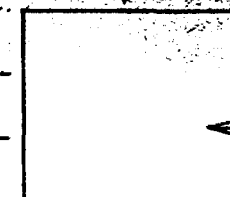

CLAIM No. \_\_\_\_\_  
 DIRECTION AND DISTANCE FROM  
 NE. CLAIM POST

FOOTAGE		DESCRIPTION	SAMPLE No.	FOOTAGE		SAMPLE LENGTH	Y.D.		ASSAY	
FROM	TO			FROM	TO		U <sub>3</sub> O <sub>8</sub> lb. ton	TV3B T <sub>2</sub>	lb. ton	
		1005.4-1005.7 40% 10 mm well stretched, traces of pyrite	1634	971.5	972.3	0.8	TR			
		1008.3-1010.0 80% grey quartz, traces of chalcopyrite	1625	972.3	975.0	2.7	.10			
		1011.0-1014.3 35% 20 mm, well stretched.	1637	1003.4	1004.2	0.8	.80	700	1.3	
1018.0	1039.0	Argillite, very fine grained, dark grey-black, altered, well bedded 75° to c.a. Traces of pyrite.								
1039.0	1042.9	arkose, low grey, coarse, massive, unaltered.								
1042.9	1055.8	Basic tuff, medium grey-green, very fine, well bedded at 75° to c.a. Contains several veinlets and elongated spots of calcite parallel to bedding. Gradual changes to argillite at 1050.0, to dirty quartzite at 1055.0								
1055.8	1056.6	Arkose, low grey-green, coarse								
1056.6	1062.0	40-50% quartz in argillite, traces of pyrite and chalcopyrite, lineated 65-70° to c.a. - 1057.8 80% quartz, weakly brecciated, 6% chalcopyrite and pyrrhotite as interstitial material.								
1062.0	1097.8	Arkose, low grey-green, coarse, unaltered, well bedded 75° to c.a. Few pebbles, very sharp contact with above. 4" quartz at 1080.2; 3" at 1080.7; 1" with traces of chalcopyrite and pyrite at 1086.7	1710 1064.2 1711		1066.6 1068.7	2.4 2.1	.30 .10	500 460		



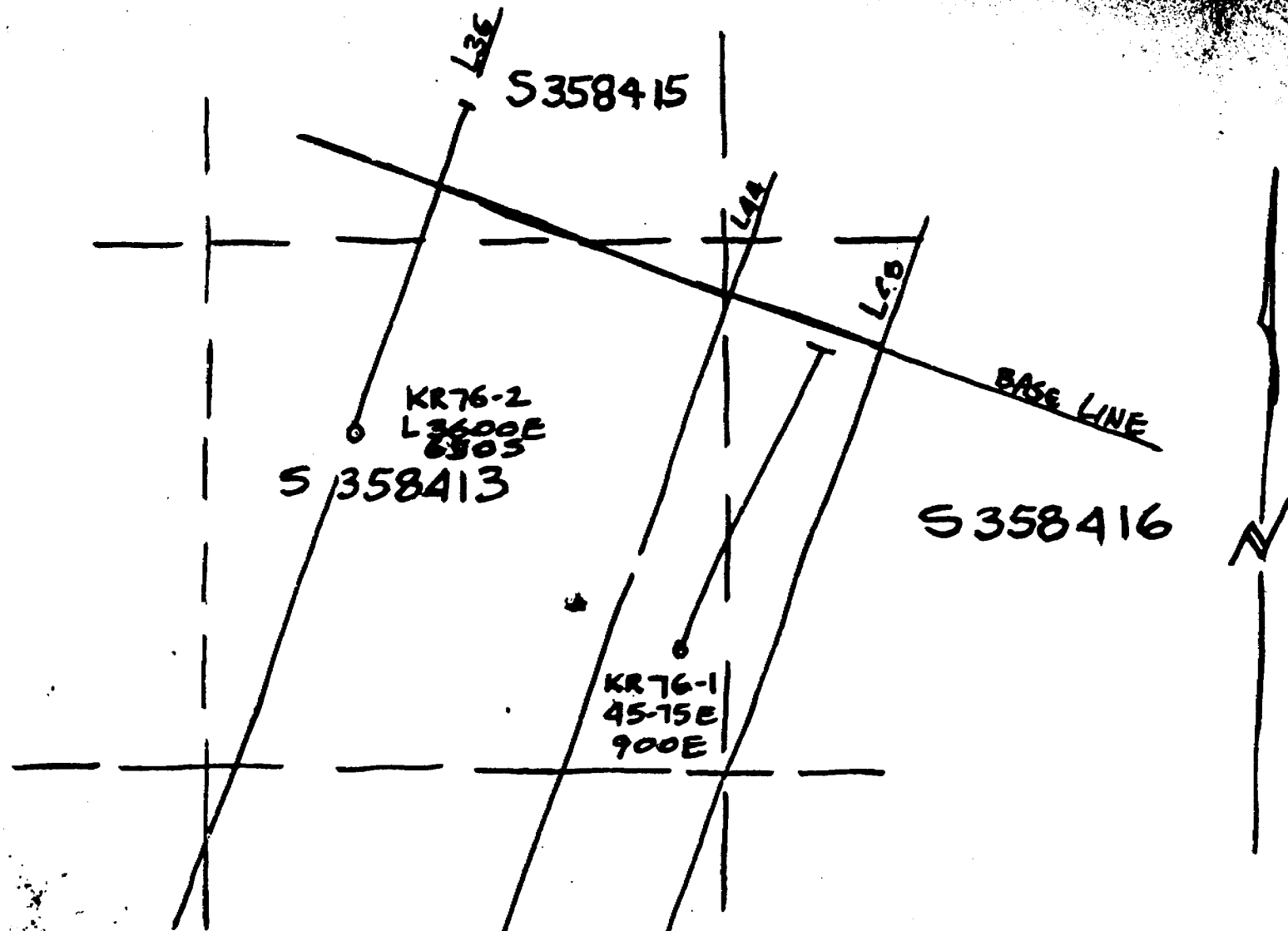

KERR ADDISON MINES LIMITED  
 RYANOR-NEWNORTH OPTION  
 Dury Twp. Ontario

LOCATION SKETCH -  
 HOLE KR76-1, KR76-2  
 Scale 1:400  
 G. Hines

# DIAMOND DRILL RECORD

LOGGED BY C. Hulse G. Hulse

PROPERTY Madison Mines Limited - Lynnor Hemworth Option - Drury Township, Ontario

D.D.I. No. KR-76-1 PAGE 1

LATITUDE 49° 00' S BEARING OF HOLE N 20° E STARTED October 5, 1976

CLAIM No. S 358413 S 358416

DEPARTURE 1575 E 4575 E DIP OF HOLE -80° -80° COMPLETED October 25, 1976

DIRECTION AND DISTANCE FROM

ELEVATION \_\_\_\_\_ DIP TESTS \_\_\_\_\_ DEPTH 1501.0'

NE. CLAIM POST

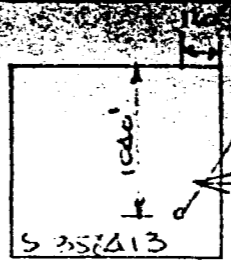

Hooking Diamond Drilling - Air Core

FOOTAGE Range, Core		DESCRIPTION	SAMPLE No.	FOOTAGE		SAMPLE LENGTH	USCF ASSAY		
FROM	TO			FROM	TO		15/ton		
0.0	20.0	Casing.							PAJARI TESTS
20.0	225.6	Argillite, very fine grained, dark grey, highly altered, locally micaceous, few spots of carbonate predominantly on slip faces. Locally some narrow veinlets of pyrite and chalcopyrite along bedding. Bedding parallel to 10° to C.A. Core broken up, several rusty fractures to 35.0'. At 28.7', 4" highly broken up, rusty, mud/ gouge? at 32.0', bedding at 35° to C.A.; at 50.0', 1°; at 90.0', 20°; 147.0', 20°; 197.0', 15°;							35° -78°
									100° -79°
									200° -71°
									300° -72°
									400° -70°
									600° -77°
		77.0 - 90.0 - core broken up, contorted and brecciated from 77.0 - 79.5', 2" mud/gouge at 79.5'.							800° -71°
									1100° -76°
		131.3 - 140.0 - core broken up, narrow mud slip at 131.5'.							1400° 27° 27°
		Lost core 180.9 - 183.7', 192.4 - 193.4'.						T2	
		210.5 - 211.3 - Core broken up, some narrow mud slips.							
225.6	227.5	70% Micro conglomerate, oligomictic bluish quartz grains, mm, subrounded, in a white carbonated matrix, few narrow sericitized veinlets parallel to bedding.	1681	225.6	227.5	1.9'	250	T2	
227.5	252.7	quartzite, dirty, low medium grey, fine, massive, <sup>not</sup> <del>well</del> altered, bedding 20° to C.A.							
252.7	253.8	quartzite, low medium grey, very fine, massive, unaltered, dirty.							

# DIAMOND DRILL RECORD

LOGGED BY \_\_\_\_\_

DIAMOND DRILL 76-1

PAGE 2

LATITUDE \_\_\_\_\_ BEARING OF HOLE \_\_\_\_\_ STARTED \_\_\_\_\_  
 DEPARTURE \_\_\_\_\_ DIP OF HOLE \_\_\_\_\_ COMPLETED \_\_\_\_\_  
 ELEVATION \_\_\_\_\_ DIP TESTS \_\_\_\_\_ DEPTH \_\_\_\_\_



CLAIM No. S 358413  
 DIRECTION AND DISTANCE FROM  
 NE. CLAIM POST

FOOTAGE		DESCRIPTION	SAMPLE No.	FOOTAGE		SAMPLE LENGTH	U3O8 ASSAY		
FROM	TO			FROM	TO		T2	lb/ton	
253.8	270.0	Gabbro, fine to medium grained, dark grey, chloritized, massive.							
270.0	284.1	Quartzite, dirty, dark grey, very fine grained, <sup>not</sup> slightly altered, massive, from 281.6 to 284.1', low medium grey, fine grained, dirty, massive, unaltered.							
284.1	323.6	Highly altered gabbro <sup>?</sup> dark brownish grey, coarse, 40% carbonated white spots in a micaceous matrix, 1 - 2% quartz eyes, 1% disseminated pyrite, gneissosity at 30° to C.A.  311.2', 2" white quartz, 317.1', 5" quartz, 322.0', 3" quartz.  317.1 - 323.5 - core broken up, some brecciation, few narrow mud slips. Fault at 323.6'.							
323.6	334.3	quartzite, white, very fine grained, well washed, bedded 20° to C.A.  323.6 - 325.0 - low grey green, altered.  323.6 - 326.5 - bleached, weakly brecciated, 332.7 - 333.8, brecciated with 4" highly altered sediments.							
334.3	345.0	Highly altered gabbro, chloritized and carbonated, contorted, broken up core, mud from 342.7 to 343.2'.							
345.0	425.0	Arkose, low white to smoky grey, fine to coarse grained, massive, unaltered, well washed, bedding at 30° to C.A. with shades of green and locally pink.	1682	423.0	425.0	2.0'	150	T2	









# DRILL RECORD

LOGGED BY \_\_\_\_\_

D.D. No. 1176-1 PAGE 6

LATITUDE \_\_\_\_\_ BEARING OF HOLE \_\_\_\_\_ STARTED \_\_\_\_\_  
 DEPARTURE \_\_\_\_\_ DIP OF HOLE \_\_\_\_\_ COMPLETED \_\_\_\_\_  
 ELEVATION \_\_\_\_\_ DIP TESTS \_\_\_\_\_ DEPTH \_\_\_\_\_

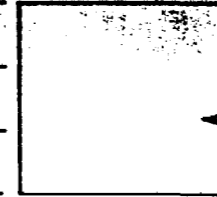

CLAIM No. S 358,13  
 DIRECTION AND DISTANCE FROM  
 NE. CLAIM POST

FOOTAGE		DESCRIPTION	SAMPLE No.	FOOTAGE		SAMPLE LENGTH	% CO <sub>2</sub>		ASSAY	
FROM	TO			FROM	TO		T2	(b/100)		
1065.0	1069.2	Gabbro, altered, fine to coarse grained, weakly brecciated and carbonated.								
1069.2	1218.5	Argillite, trace pyrite, chalcopyrite, bedding at 60° to C.A.; minor quartzite at 1117.1', 6"; 1118.2', 1"; 1120.1', 10", 1123.7', 1.6', weakly R.A. At 1135.0' bedding 50° to C.A.								
1218.5	1229.8	Greywacke as 840.7 - 849.1'.								
1229.8	1241.1	Highly altered gabbro? highly sheared at 55° to C.A., carbonated 3" white quartz at 1230.4'.								
1241.1	1246.7	Argillite.								
1246.7	1273.5	Arkose, grey-green, very coarse, 60 to C.A., contains well stretched pebbles, 30% - 4 mm - 3" at 1250.9'; 40% - 4 mm - 2" at 1260.4'; 20% - 5 mm - 4" at 1261.4'; 20% - 35 mm - 7" at 1263.2'; 40% - 10 mm. - 3" at 1266.6; 20% - 10 mm - 9" at 1267.3'.	1692	1246.7	1247.7	1.0'	500	0.4		
			1693	1247.7	1250.9	3.2'		TE		
			1694	1250.9	1252.0	1.1'	500	0.2		
			1695	1252.0	1255.0	3.0'		TE		
			1696	1255.0	1258.0	3.0'		TE		
			1697	1258.0	1260.4	2.4'		TE		
			1698	1260.4	1261.8	1.4'	900/2"	0.9		
			1699	1261.8	1263.2	1.4'		0.1		
			1700	1263.2	1263.8	0.6'	400	0.1		

# DRILL RECORD

LOGGED BY \_\_\_\_\_

PROPERTY \_\_\_\_\_

D.D.H. No. 11-76-1 PAGE 7

LATITUDE \_\_\_\_\_ BEARING OF HOLE \_\_\_\_\_ STARTED \_\_\_\_\_  
 DEPARTURE \_\_\_\_\_ DIP OF HOLE \_\_\_\_\_ COMPLETED \_\_\_\_\_  
 ELEVATION \_\_\_\_\_ DIP TESTS \_\_\_\_\_ DEPTH \_\_\_\_\_



CLAIM No. S 358413  
 DIRECTION AND DISTANCE FROM  
 NE. CLAIM POST

FOOTAGE		DESCRIPTION	SAMPLE No.	FOOTAGE		SAMPLE LENGTH	U <sub>3</sub> O <sub>2</sub>		ASSAY
FROM	TO			FROM	TO		T2	lb/ton	
			1701	1263.8	1266.0	2.8'		0.1	} 32 -7.6
			1702	1266.6	1268.0	1.4'	860/2'	0.5	
			1703	1268.0	1270.5	2.5'		0.1	
			1704	1270.5	1270.9	0.4'	500	0.3	
			1705	1270.9	1272.0	1.1'		TR	
			1706	1272.0	1273.5	1.5'		0.1	
1273.5	1275.8	Argillite, upper contact sericitized, marker argillite at Agnew?							
1275.8	1291.5	arkose, grey-green, coarse, trace pyrite, 4" with few 4 mm stretched pebbles at 1280.6' in argillite matrix.	1707	1280.6	1281.4	0.8'	1400/4'	1.8	
1291.5	1297.5	argillaceous siltstone.							
1297.5	1301.5	Tuff, basic, dark grey-green with minor dirty quartzite.							
1301.5	1301.9	quartzite, dirty, with narrow 1/8" pyrite veins at 1301.5', weakly R.A.	1708	1301.5	1303.1	1.6'	500/1"	0.3	
1301.9	1303.1	conglomerate, 20% 10 mm quartz pebbles in dark argillite matrix, with local sericite. weakly R.A.							
1303.1	1310.0	Tuff, basic, grey-green, well bedded 60° to U.A. Last 1.0' interbedded with argillite.							
1310.0	1314.0	Argillite with some conglomerate.							



# DIAMOND DRILL RECORD

LOGGED BY \_\_\_\_\_

D.D.H. No. IR 76-1 PAGE 2

PROPERTY \_\_\_\_\_  
 LATITUDE \_\_\_\_\_ BEARING OF HOLE \_\_\_\_\_ STARTED \_\_\_\_\_  
 DEPARTURE \_\_\_\_\_ DIP OF HOLE \_\_\_\_\_ COMPLETED \_\_\_\_\_  
 ELEVATION \_\_\_\_\_ DIP TESTS \_\_\_\_\_ DEPTH \_\_\_\_\_

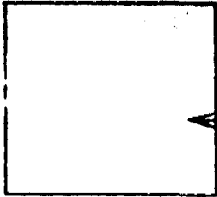

CLAIM No. S 358413  
 DIRECTION AND DISTANCE FROM  
 NE. CLAIM POST

FOOTAGE		DESCRIPTION	SAMPLE No.	FOOTAGE		SAMPLE LENGTH	ASSAY						
FROM	TO			FROM	TO								
1372.4	1374.5	argillite.											
1374.5	1375.3	Basic Tuff.											
1375.3	1375.7	quartzite, pure, white.											
1375.7	1390.0	Basic Tuff, locally highly altered, some disseminated pyrrhotite. 2" 30,											
		pyrrhotite at 1377.1'.											
1390.0	1391.4	quartzite, impure, brecciated and contorted 1390.0 - 1391.0', narrow tight fault											
		at 1390.6'.											
1391.4	1394.7	argillite.											
1394.7	1399.0	quartzite, low gray, impure.											
1399.0	1402.3	mafic gabbro, medium grained, medium dark grey-green, 55° to c.a. and fast,											
		fine grained, with 30% narrow argillite beds.											
1402.3	1413.4	Argillite, very fine grained, dark grey, 65° to c.a.											
1413.4	1414.5	Highly altered and sheared gabbro, med. grad, low-med. grey,											
		both contacts fine grained, chilled?											
1414.5	1501.0	Argillite as before, 2" highly alt'd gabbro at 1419.0											
		At 1416.0, bedding 70° to c.a.											
1501.0		End of hole.											

Core stored at Agnew Lake Mines  
 Casing left in hole.

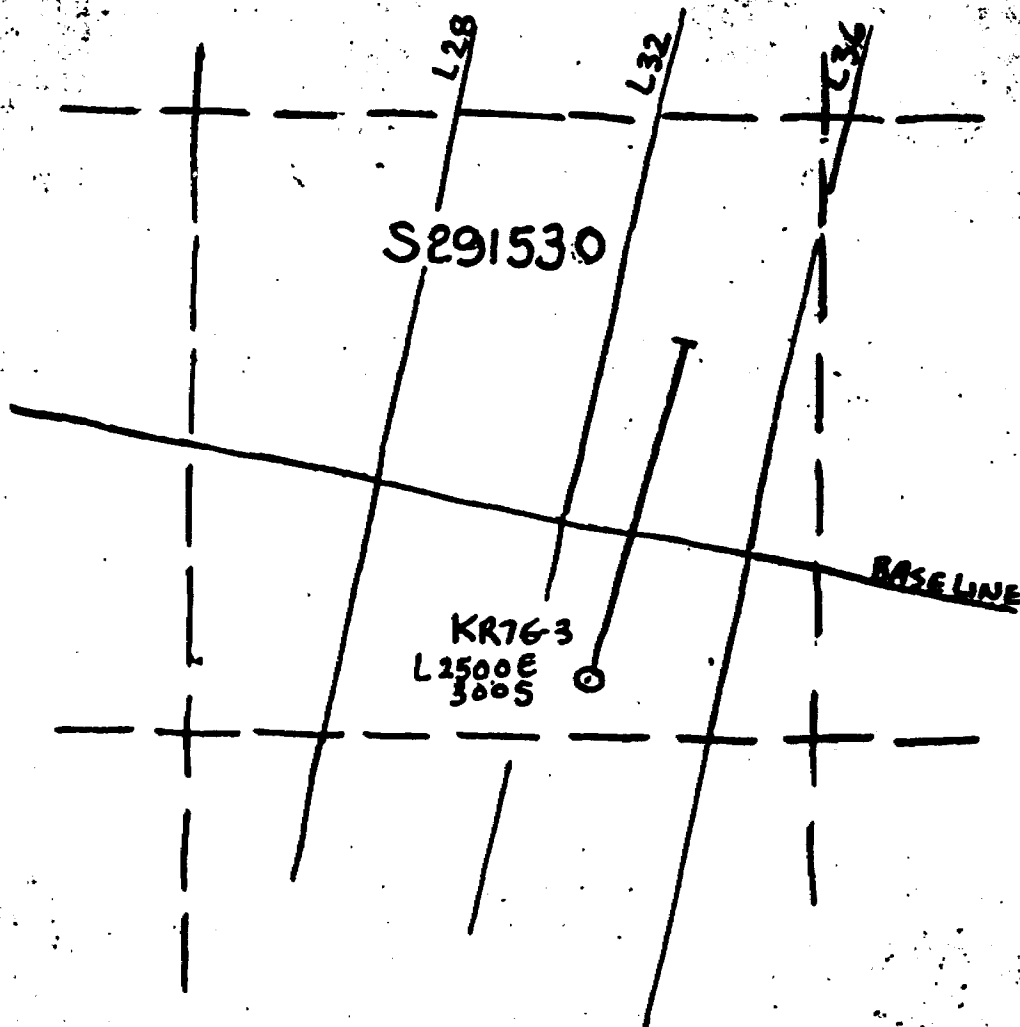

KERR ADDISON MINES LIMITED  
RYANOR NEWNORTH OPTION "0-10"  
DURY TWP. Ontario.  
LOCATION SKETCH  
HOLE KR76-3  
Scale 1" = 100'  
J.A. Foster  
Jan 77

# DIAMOND DRILL RECORD

LOGGED BY Guy Rinse

PROPERTY Addison Mines Limited - Ryanor Newnorth Option - "O-10" - Drury Township - Ontario

D.D.H. No. KR76-3 PAGE 1

LATITUDE 350 S BEARING OF HOLE 20° STARTED Nov. 16/76  
 DEPARTURE 2600E DIP OF HOLE -80° COMPLETED Dec. 8/76  
 ELEVATION \_\_\_\_\_ DIP TESTS \_\_\_\_\_ DEPTH 1260.2'

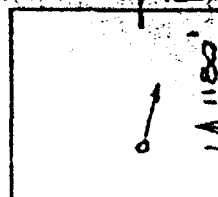

CLAIM No. S 291530  
 DIRECTION AND DISTANCE FROM  
 NE. CLAIM POST

Hosking Diamond Drilling - 24 Tardif - Rouyn - Quebec - AQ Core.

S 291530

FOOTAGE		DESCRIPTION	SAMPLE No.	FOOTAGE		SAMPLE LENGTH	ASSAY		
FROM	TO			FROM	TO			Dip	Str.
0.0	12.0	Casing					100'	-74°	14
12.0	88.7	Argillite, grey-black, very fine grained, macaceous, highly altered, bedding contorted predominantly 20-35° to c.a. - 2" quartz at 38.8'					200'	-72°	15
							400'	-63°	17
88.7	110.0	Gabbro, medium grey-green, coarse, weakly sheared 30° to c.a., well carbonated, sharp contact at 88.7 at 20° to c.a., not chilled. Contains few 2 mm quartz spots.					800'	-46°	20
							1000'	-28°	22
		94.5-96.2 70% quartz, 35-45° to c.a.							
		103.4-104.1 80% quartz, brecciated.							
110.0	160.0	Arkose, medium grey, coarse, massive, unaltered.							
160.0	190.0	Gabbro, medium grey-green, coarse, weakly sheared 30° to c.a., well carbonated.							
		176.0-176.5 white quartz							
		180.4-181.0 talcy, brecciated, some white quartz and calcite.							
190.0	414.0	Argillite, grey black, very fine grained, altered, bedded, contorted, pred. 35° to c.a.							
		213.0-221.0 lost core, gravel, pebbles, fault?							
		197.5-225.0 core broken up.							
		At 271.0, bedding 35°; at 347.0, 35° to c.a. (Box 375.0-400.0 spilled)							
414.0	468.4	Arkose, low grey-green, coarse, massive, unaltered. Well bedded 50° to c.a. Few pebbles locally.							

# DIAMOND DRILL RECORD

LOGGED BY \_\_\_\_\_

D. DIEN 1176-3 PAGE 2

PROPERTY \_\_\_\_\_ ATTITUDE \_\_\_\_\_ BEARING OF HOLE \_\_\_\_\_ STARTED \_\_\_\_\_  
 DEPARTURE \_\_\_\_\_ DIP OF HOLE \_\_\_\_\_ COMPLETED \_\_\_\_\_  
 ELEVATION \_\_\_\_\_ DIP TESTS \_\_\_\_\_ DEPTH \_\_\_\_\_

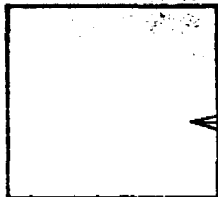

CLAIM No. \_\_\_\_\_  
 DIRECTION AND DISTANCE FROM  
 NE. CLAIM POST

FOOTAGE		DESCRIPTION	SAMPLE No.	FOOTAGE		SAMPLE LENGTH	ASSAY		T <sub>2</sub>
FROM	TO			FROM	TO		U <sub>3</sub> O <sub>8</sub> lb/ton	ThO <sub>2</sub> lb/ton	
		407.3-409.5 10% 5 mm well stretched, traces of pyrite	1712	407.3	409.5	2.2	.10		500
		418.0-418.8 10% " " " " "	1713	418.0	418.8	0.8	.10		380
		432.0-432.6 50% 20mm well stretched, sericite	1714	430.6	431.0	0.4	TR		400
		Argillite: 437.3-438.1; 447.2-447.9; 455.0-455.8 with 2- $\frac{1}{2}$ " pink foldspar vnlets	1715	431.0	432.0	1.0	TR		
		447.9 on, grey arkose, coarser towards 468.4, gradual change to micro-congl.	1716	432.0	432.6	0.6	.30		480
468.4	480.0	Quartzite, medium dark grey, very fine grained, massive, unaltered, bedded 50° to c.a.							
480.0	482.6	Argillite, dark grey-black, very fine grained, weakly altered, bedded 50° to c.a.							
		480.0-480.7 few small, 3 mm pebbles in argillite matrix							
482.6	506.7	Gabbro, medium grey-green, coarse, unaltered, massive							
506.7	510.4	Arkose, medium grey, coarse, unaltered, massive							
510.4	511.6	Gabbro							
511.6	513.7	Argillite							
513.7	518.3	Gabbro							
518.3	519.5	Arkose							
519.5	532.9	Argillite, medium grey, medium grained, weakly altered, bedded 40° to c.a.							
532.9	680.7	Gabbro, medium grey, coarse, massive, unaltered. Finer grained towards 680.7,							





# DIAMOND DRILL RECORD

LOGGED BY \_\_\_\_\_

D.D.H. No. IR76-3 PAGE 4

PROPERTY \_\_\_\_\_  
 LATITUDE \_\_\_\_\_ BEARING OF HOLE \_\_\_\_\_ STARTED \_\_\_\_\_  
 DEPARTURE \_\_\_\_\_ DIP OF HOLE \_\_\_\_\_ COMPLETED \_\_\_\_\_  
 ELEVATION \_\_\_\_\_ DIP TESTS \_\_\_\_\_ DEPTH \_\_\_\_\_

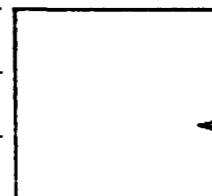

CLAIM No. \_\_\_\_\_  
 DIRECTION AND DISTANCE FROM  
 NE. CLAIM POST

FOOTAGE		DESCRIPTION	SAMPLE No.	FOOTAGE		SAMPLE LENGTH	ASSAY		
FROM	TO			FROM	TO		U <sub>3</sub> O <sub>8</sub> lb/ton	ThO <sub>2</sub> lb/ton	T <sub>2</sub>
		Pebbles: 60% 40 mm over 7" at 878.2	1729	875.8	878.2	2.4	.20		420
		30% 10 mm over 6" at 883.7	1730	878.2	878.8	0.6	1.4		700
		60% 30 mm over 5" at 893.9	1731	880.7	881.1	0.4	.20		420
		40% 10 mm over 2" at 895.2	1732	883.7	884.2	0.5	.10		
		At 900.0, changes to grey arkose, with at 913.3, narrow argillite interbeds	1733	886.2	887.4	1.2	TE		400
		at 55° to c.a.	1734	896.2	896.4	0.2	N.1		
		Argillite: 885.5-886.2; 887.9-889.0; 913.7-914.5; 918.3-919.5; 929.6-930.7	1735	916.4	917.1	0.7	TE		400
		At 922.5 changes to green arkose, coarse.	1736	925.0	926.3	1.3	TE		500
		Pebbles: 50% 10 mm over 2" at 929.1	1737	929.1	929.3	0.2	N.1		
		50% 7 mm over 2" at 934.8	1738	931.6	933.2	0.6	.30		400
			1739	934.6	935.4	0.8	.40		440
937.7	948.2	Basic tuff, medium grey green, well bedded at 60° to c.a. Contains narrow arkosic interbeds.							
948.2	953.7	Arkose, grey, coarse, locally with argillite matrix.							
953.7	974.2	Argillite, dark grey black, altered, bedded 60° to c.a. Contains narrow arkose interbeds.							
		971.8-972.3 white quartz;							





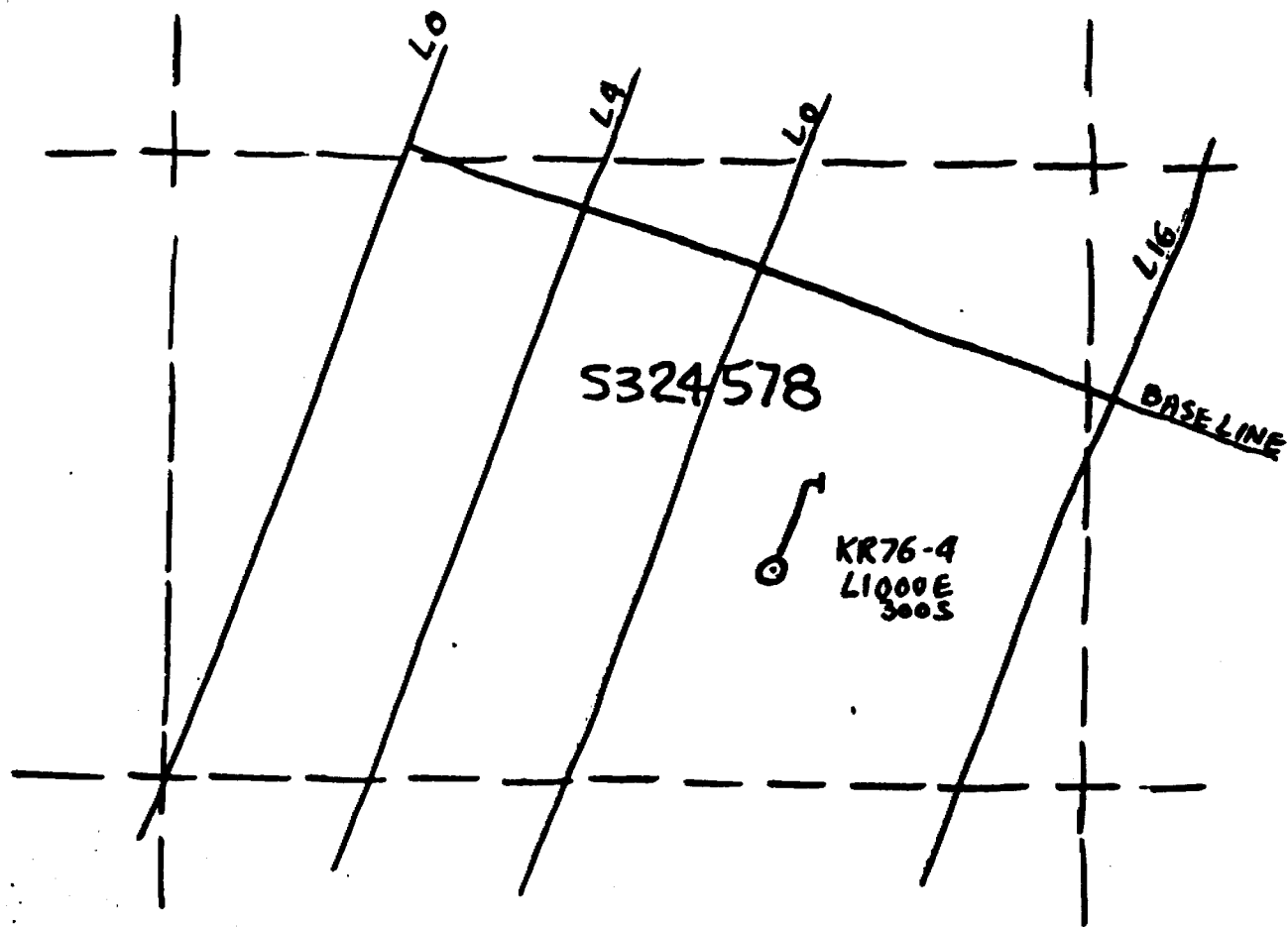

KERR ADDISON MINES LIMITED  
RYANOR-NEWNORTH OPTION "O-10"  
Drury Twp Ontario

LOCATION SKETCH  
HOLE KR76-4  
Scale: 1" = 100'  
J.R. Foster

Jan 77

KR76-4

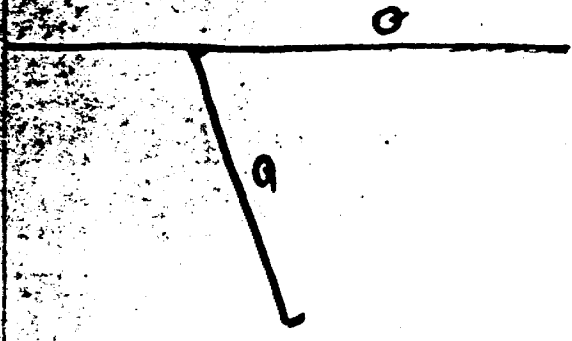

Collar	Strike	Dip
135'	20°	-80°
154'	90°	-88°
	108°	-87°

LEGEND

Q QUARTZITE

KERR ADDISON MINES LIMITED  
RYANOR-NEWNORTH OPTION '0-10"  
Drury Twp Ontario

VERTICAL SECTION LOOKING WEST

HOLE KR76-4

Scale 1 = 10d  
J.R. Foster

Jan 77



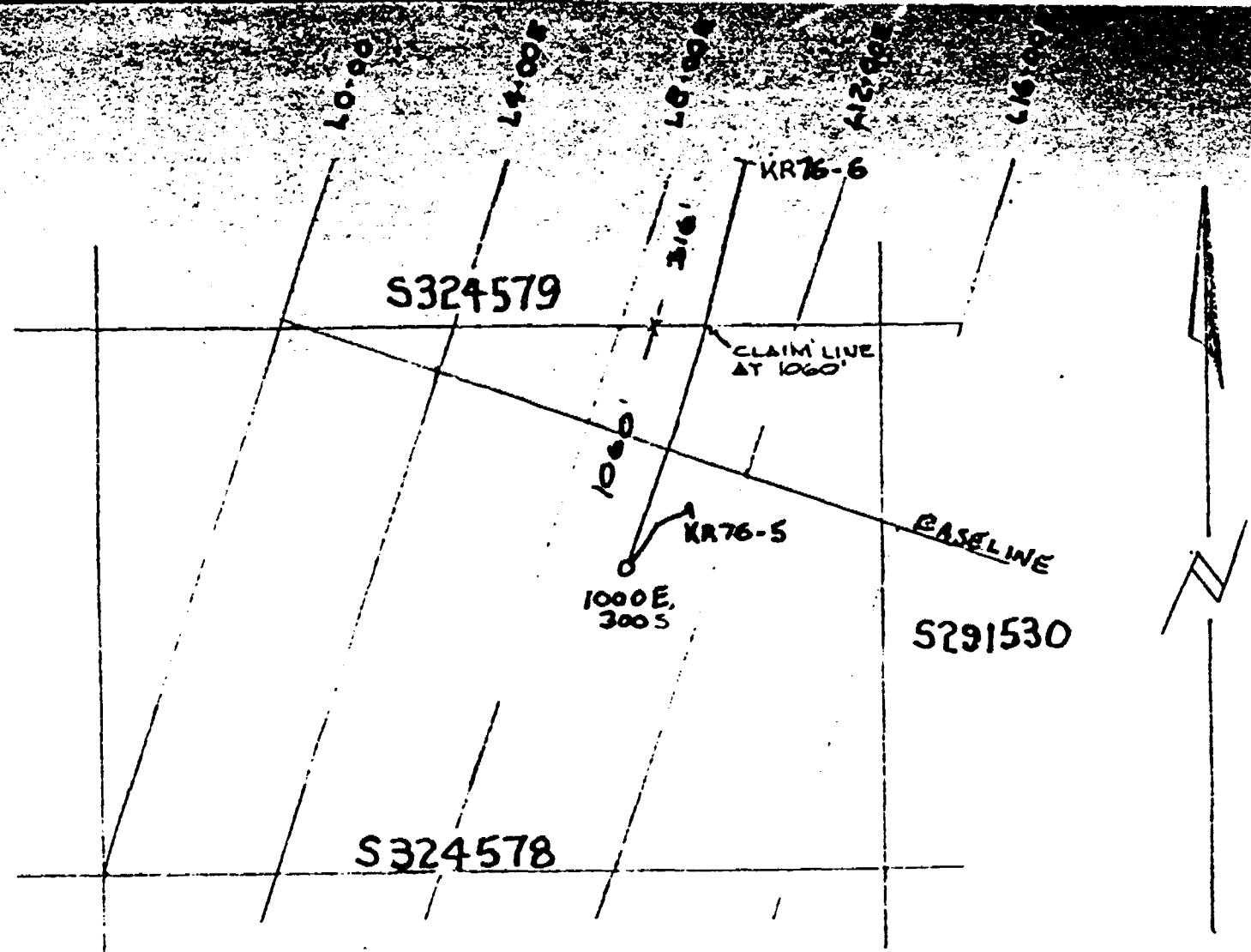

KERR ADDISON MINES LIMITED  
 RYANOR-NEWNORTH OPTION "O-10"  
 Drury Twp. Ontario

LOCATION SKETCH  
 D.D.H. KR76-5, KR76-6  
 Scale: 1" = 400'  
 J. R. Foster

Feb. 1977.

*G. Skup*

# DIAMOND DRILL RECORD

LOGGED BY G. Hinse

PROPERTY Kerr Addison Mines Limited - Ryonar Option - "0-10" - Drury Township, Ontario

D.D.H. No. KR-76-5

PAGE

LATITUDE 300S BEARING OF HOLE N20°E STARTED January 5, 1977

DEPARTURE L1100E DIP OF HOLE -75° COMPLETED January 9, 1977

ELEVATION \_\_\_\_\_ DIP TESTS \_\_\_\_\_ DEPTH 316.0

Hosking Diamond Drilling Limited - 24 Tardiff, Rouyn, Quebec, AQ Core.

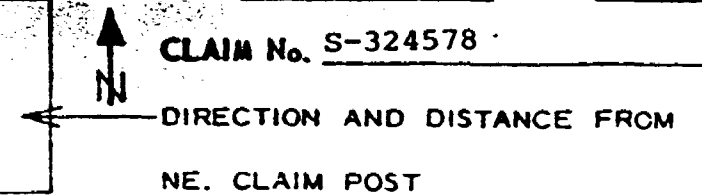

FOOTAGE		DESCRIPTION	SAMPLE No.	FOOTAGE		SAMPLE LENGTH	ASSAY	
FROM	TO			FROM	TO			
0.0	5.0	Casing					PAJARI TESTS	
5.0	214.7	Quartzite, low to medium grey, fine grained, unaltered, massive, Rusty slips to 22.0'. Poorly bedded at 15° to core axis. Weakly brecciated locally.					COLLAR -80° 20°	
		63.1-65.1. white quartz vein, with 20% spotty green chlorite, contacts 60° to core axis.					70' -81° 34°	
214.7	227.0	Argillite, dark grey, very fine grained, bedded 25° core axis.					120' -81° 31°	
227.0	303.2	Quartzite, as before					WEDGE 220' -83° 38°	
		263.6-276.6 30% argillite interbeds, 30° core axis.					316' -83° 71°	
303.2	316.0	Argillite, as before bedded 25° core axis.						
316.0		End of hole.						
		Wedge at 240.0'						
		Hole abandoned due to steepening and strike deviation. Core stored at Agnew Lake Mines, casing pulled out.						

**DUPLICATE COP.  
POOR QUALITY ORIGINAL  
TO FOLLOW**



# DIAMOND DRILL RECORD

LOGGED BY

G. Hance

G. Hance

PROPERTY Kerr Addison Mines Limited - Eynor Option - "O-10", Drury Township, Ontario

D.D.H. No. 1376-5

PAGE

ATTITUDE 300 S BEARING OF HOLE N20°E STARTED January 5, 1977

DEPARTURE L1000E DIP OF HOLE -75° COMPLETED January 9, 1977

ELEVATION \_\_\_\_\_ DIP TESTS \_\_\_\_\_ DEPTH 316.0



CLAIM No. 5324578

DIRECTION AND DISTANCE FROM

NE. CLAIM POST

Hosking Diamond Drilling Limited - 24 Tardif, Rouyn, Quebec - A4 core

FOOTAGE		DESCRIPTION	SAMPLE No.	FOOTAGE		SAMPLE LENGTH	ASSAY		
FROM	TO			FROM	TO				
0.0	5.0	Casing					collar	21°	31°
5.0	114.7	quartzite, low to medium grey, fine grained, unaltered, massive. Rusty chips to 22.0'. Poorly bedded at 15° to core axis. Heavily brecciated locally.					16'	-31°	31°
		63.1-65.1 white quartz vein, with 20% spotty green chlorite, contacts 60° to core axis					Wedge	225'	-33°
114.7	227.0	Argillite, dark grey, very fine grained, bedded 25° core axis					216'	-53°	31°
227.0	303.2	quartzite, as before							
		263.6-276.6 30% argillite interbeds, 30° core axis							
303.2	316.0	argillite, as before, bedded 25° core axis							
316.0		End of hole							
		Wedge at 240.0'							
		Hole abandoned due to steepening and strike deviation. Core stored at Agnew Lake Mines, casing pulled out.							

# DIAMOND DRILL RECORD

LOGGED BY G. J. Hinsa

PROPERTY Kerr Addison Mines Limited - Ryanor Option - "0-10" - Drury Township, Ontario

D.D.R. No. KR76-6 PAGE 1

LATITUDE 300S BEARING OF HOLE N 20°E STARTED January 9, 1977

DEPARTURE L1000E DIP OF HOLE -64° COMPLETED January 30, 1977

ELEVATION \_\_\_\_\_ DIP TESTS \_\_\_\_\_ DEPTH 1376.0

610'

CLAIM No. S-324578 + 79 ?  
 DIRECTION AND DISTANCE FROM  
 NE. CLAIM POST

Hosking Diamond Drilling Limited, 24 Tardiff, Rouyn, Quebec, AQ Core.

FOOTAGE		DESCRIPTION	SAMPLE No.	FOOTAGE		SAMPLE LENGTH	ASSAY		
FROM	TO			FROM	TO				
0.0	5.0	Casing							
5.0	245.0	Quartzite, low grey, fine grained, unaltered, massive. Weakly brecciated locally. At 75.0', bedded 35° core axis; at 81.0', 40° core axis; at 92.5', 35° core axis; at 105.0', 40° core axis; at 130.0', 35° core axis. At 95.5 and 96.5, 7" and 4" white quartz with 10% green spotty chlorite and amber mica. Adjacent quartzite has a brownish tinge.							
		200.0 on, medium grey, very fine grained with narrow argillite interbedded, 15° core axis.							
245.0	291.1	Argillite, dark grey-black, very fine grained, altered, bedded 15 to 30° core axis. Contains narrow quartzite interbeds.							
		268.9-272.0 white quartz vein, 15° to core axis.							
291.1	428.0	Quartzite, medium grey, fine grained, poorly bedded locally 15° core axis. 350.0 on, low grey, fine grained.							
		at 392.0, bedded 25° core axis.							
		at 395.2 and 397.8, 4" and 5" white quartz with 10% talcy green chlorite spots. Contacts irregular							
		Lost core 406.8-407.6, 415.0-416.6, 417.1-419.1, fractured almost parallel to core axis from 400.0 to 516.0, possible fault.							
428.0	447.7	Argillite, very fine grained, dark grey, bedded parallel to core axis. contains some narrow quartzite interbeds.							
447.7	451.2	Quartzite, low grey, medium grained.							
451.2	467.7	Argillite, bedding parallel to 15° core axis.							
467.7	499.2	Quartzite, low grey, fine-medium grained, massive unaltered. At 489.5 bedded at 15° core axis.							
		486.4-487.7 white quartz, parallel to core axis, 493.5-495.0, 496.4-499.0 60% white quartz, 15° core axis, traces of pyrrhotite at 493.7							
499.2	676.4	Argillite, medium dark grey, very fine grained, bedded 20° core axis. 509.0-512.0 and 513.5-516.0 20-25% narrow white quartz inlets, parallel to core axis, traces pyrrhotite and chalcopyrite. At 532.5 bedded 20° core axis.							

**DUPLICATE COPY  
 POOR QUALITY ORIGINAL  
 TO FOLLOW**

# DRILL RECORD

LOGGED BY \_\_\_\_\_

ALTITUDE \_\_\_\_\_ BEARING OF HOLE \_\_\_\_\_ STARTED \_\_\_\_\_  
 DEPARTURE \_\_\_\_\_ DIP OF HOLE \_\_\_\_\_ COMPLETED \_\_\_\_\_  
 ELEVATION \_\_\_\_\_ DIP TESTS \_\_\_\_\_ DEPTH \_\_\_\_\_

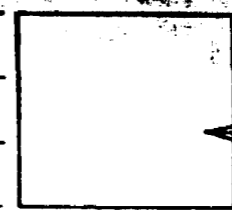

CLAIM No. \_\_\_\_\_  
 DIRECTION AND DISTANCE FROM  
 NE. CLAIM POST

FOOTAGE		DESCRIPTION	SAMPLE No.	FOOTAGE		SAMPLE LENGTH	ASSAY	
FROM	TO			FROM	TO			
		555.5-556.5, 40% white quartz with talcose green chlorite, parallel to core axis.						
		At 551.0, bedded 20° core axis.						
		Lost core 606.8-608.4, 621.2-622.3, 623.0-624.5, 620.0-623.0 graphitic, bedded 20° core axis.						
		625.8-628.1 white quartz, parallel to core axis.						
		At 641.0, bedding 20° core axis, at 652.0, 20° core axis; at 659.0, 30° core axis; at 670.0, 25° core axis.						
676.4	687.3	Quartzite, very fine grained, medium grey - Lost core 678.6-680.0						
687.3	730.0	Argillite, very fine grained, medium grey, bedded 20° to core axis.						
		700.0-722.5 core broken up, few narrow quartz inlets, lost core 701.2-702.3 703.6-704.1; 706.9-707.9; 708.7-709.6; 710.0-710.9						
730.0	916.8	Quartzite, very fine grained, medium grey, bedded 30° core axis.						
		At 755.0 low grey light brown shades, fine grained, massive, bedded 30° core axis.						
		At 786.2 changes abruptly to medium dark grey quartzite, very fine grained with 20-30% argillite interbeds.						
		Bedding changes from 30° at 732.0 to 45°-50° to core axis at 812.0						
		At 822.6, changes to low grey, fine grained, bedded 50° core axis.						
		At 865.3, changes to medium grey with argillite interbeds, bedded 60° to core axis.						
		907.3-916.8 very coarse, medium grey, 60° core axis.						
916.8	921.3	Argillite, very fine grained, dark grey, 45° core axis.						
921.3	939.0	Quartzite, medium grey, fine grained, contains narrow argillite interbeds 60° core axis. - at 937.5 coarse feldspathic.						
939.0	976.0	Argillite, dark grey, very fine grained, 60° to core axis.						
976.0	992.0	Quartzite, very fine grained, medium dark grey, with argillite interbeds, 60° to core axis.						
992.0	1009.5	Arkose, grey, very coarse, 65° core axis.						

**DUPLICATE COPY**  
**POOR QUALITY ORIGINAL**  
**TO FOLLOW**

# DIAMOND DRILL RECORD

LOGGED BY \_\_\_\_\_

D.D.R. No. \_\_\_\_\_ PAGE 3

PROPERTY \_\_\_\_\_  
 ALTITUDE \_\_\_\_\_ BEARING OF HOLE \_\_\_\_\_ STARTED \_\_\_\_\_  
 DEPARTURE \_\_\_\_\_ DIP OF HOLE \_\_\_\_\_ COMPLETED \_\_\_\_\_  
 ELEVATION \_\_\_\_\_ DIP TESTS \_\_\_\_\_ DEPTH \_\_\_\_\_

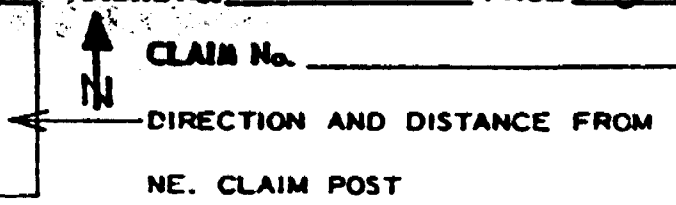
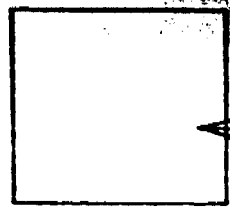

FOOTAGE		DESCRIPTION	SAMPLE No.	FOOTAGE		SAMPLE LENGTH	ASSAY	
FROM	TO			FROM	TO			
1009.5	1020.0	Argillite, dark grey black, very fine grained, 65° core axis.						
1020.0	1035.9	Basic tuff, low-medium grey-green, very fine grained, 10% erratic carbonate inlets and specks.						
1035.9	1122.2	Argillite, medium dark grey, very fine grained, bedded 65° core axis.						
1122.2	1144.1	Arkose, green, coarse grained, bedded 75° core axis. Few erratic quartz pebbles 1137.8 on grey, medium grained.						
1144.1	1148.1	Argillite, medium dark grey, very fine grained, bedded 75° core axis.						
1148.1	1166.5	Quartzite, dark grey, very fine grained 1156.7-1160.0 core broken up, few small quartz inlets.						
1166.5	1265.9	Gabbro, medium grey-green, fine to very coarse grained, tuffaceous at 1167.0 75° core axis, diabasic at 1174.0 Sharp intrusive ? contact at 1166.5 at 80° core axis. 1177.1-1178.5 brecciated quartz-carbonate veins with 15% pyrrhotite, pyrite, chalcopyrite Lost Core 1180-1185.0 At 1182.7 4" milky quartz vein, 65° to core axis.	1174	1177.1	1178.5	1.4	Nil	
1265.9	1271.4	Argillite, medium dark grey, very fine grained, bedded 60° core axis, sharp contacts with adjoining gabbro.						
1271.4	1274.0	Gabbro, as before.						
1274.0	1339.0	Argillite, dark grey-black, very fine grained, bedded 80° core axis First 10.0', several narrow gabbro dyklets, 60° core axis. - 1304.0 on medium grey.						
1339.8	1340.6	Quartz, smoky grey, traces pyrrhotite, chalcopyrite.						
1340.6	1366.6	Gabbro, as before.						
1366.6	1376.0	Grey arkose, low grey, very coarse grained, unaltered, well bedded 75°-80° core axis.						
1376.0		END OF HOLE Hole abandoned - too flat, unable to drill hard rock. Core stored at Agnew Lake Mines Limited.						

**DUPLICATE COPY  
 POOR QUALITY ORIGINAL  
 TO FOLLOW**

# DIAMOND DRILL RECORD

LOGGED BY

G. J. Hano *G. Hano*

Property Lorr Addison Mines Limited - Rynor Onton - "0-10" - Drury Township, Ontario

D.O.H. No. KR76-6

PAGE 1

LATITUDE 3003 BEARING OF HOLE N20°E STARTED January 9, 1977  
 DEPARTURE L1000E DIP OF HOLE -64° COMPLETED January 30, 1977  
 ELEVATION \_\_\_\_\_ DIP TESTS \_\_\_\_\_ DEPTH 1376.0

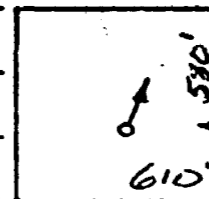

CLAIM No. S324578 + 19?  
 DIRECTION AND DISTANCE FROM  
 NE. CLAIM POST

Hosking Diamond Drilling Limited, 24 Tardif, Rynor, Quebec - AQ core

FOOTAGE		DESCRIPTION	SAMPLE No.	FOOTAGE		SAMPLE LENGTH	ASSAY		
FROM	TO			FROM	TO				
0.0	5.0	Casing					Collar	-64°	2
5.0	245.0	Quartzite, low grey, fine grained, unaltered, massive. Weakly brecciated locally. At 75.0', bedded 35° core axis; at 81.0', 40° core axis; at 92.5', 35° core axis; at 105.0', 40° core axis; at 130.0', 35° core axis. At 95.5 and 96.5, 7" and 4" white quartz with 10% green spotty chlorite and amber mica. Adjacent quartzite has a brownish tinge. 200.0 on, medium grey, very fine grained with narrow argillite interbeds, 15° core axis					80	-64	35
							120	-64	...
							220	-64	1
							370	-61	2
							600	-53	1
							880	-38	1
							1200	-11	1
245.0	291.1	Argillite, dark grey-black, very fine grained, altered, bedded 15 to 30° core axis. Contains narrow quartzite interbeds. 262.9-272.9 white quartz vein, 15° to core axis.							
291.1	428.0	Quartzite, medium grey, fine grained, poorly bedded locally 15° core axis. 350.0 on, low grey, fine grained At 392.0, bedded 25° core axis At 395.2 and 397.8, 4" and 5" white quartz with 10% talcy green chlorite spots. Contacts irregular. Lost core 406.8-407.6, 415.0-416.6, 417.1-419.1, fractured almost parallel to							











S324579

5424763

S359425

S324580

KR76-7  
2000E,  
1700N

L12-008

L16-005

L20-007

L24-009

KERR ADDISON MINES LIMITED  
RYANOR-NEWNORTH OPTION '0-10"  
Drury Twp. Ontario

LOCATION SKETCH  
D.D.H. KR76-7  
Scale: 1" = 100'  
J. R. Foster

Feb. 1977.

G. Keith

# DIAMOND DRILL RECORD

LOGGED BY G. J. Hinse

PROPERTY Ferr Addison Mines Limited, Ryanor Option "0-10" - Drury Township, Ontario

D.D. No. KR 76-7

PAGE 1

ATTITUDE 1700N BEARING OF HOLE N20°E STARTED January 31, 1977

DEPARTURE 2000E DIP OF HOLE -50° COMPLETED Feb. 6, 1977

ELEVATION \_\_\_\_\_ DIP TESTS 300' - 29° N14° DEPTH 366.0'

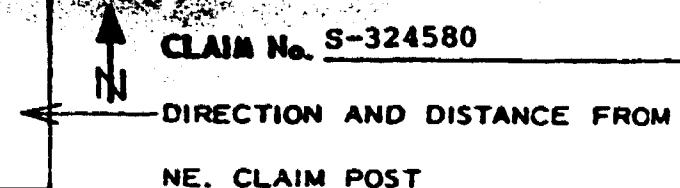
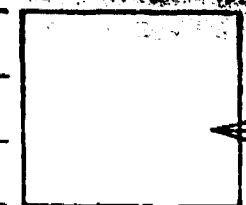

CLAIM No. S-324580

DIRECTION AND DISTANCE FROM

NE. CLAIM POST

U308 Tho2

Hosking Diamond Drilling Limited - 24 Tardiff, Rouyn, Quebec, AQ core

FOOTAGE		DESCRIPTION	SAMPLE No.	FOOTAGE		SAMPLE LENGTH	TV3B ASSAY	
FROM	TO			FROM	TO		T2	16/Ton
0.0	42.0	Casing						
42.0	81.2	Argillite, medium to dark grey, very fine grained, bedded 45-55° to core axis.						
81.2	106.6	Arkose, low grey-green, very coarse grained, unaltered, well bedded 40° to core axis - 93.9-94.9 10% pebbles, upto 10mm, well stretched At 103.1 1-5mm, well stretched pebble.	1745	93.1	93.9	.08	400	0.1
		98.1-98.7 argillite, medium grey, very fine grained, 45° core axis.	1746	93.9	94.5	0.6	400	TR
106.6	195.0	Quartzite, medium grey, fine grained, bedded 40° to core axis At 165.0 60° core axis. - 190.9-195.0 40% argillite interbeds.	1747	94.5	94.9	0.4		NIL
195.0	221.9	Arkose, low grey-green, pinkish locally, very coarse grained, few erratic quartz pebbles, one 10mm at 205.2; 1-5mm 215.3; 1-5mm at 220.9 Bedded 60° to core axis.						
221.9	303.7	Basic tuff, dark grey-green, fine grained, bedded 60° to core axis, 10% calcite in inlets and disseminated. 297.7-298.0; 298.7-299.3 granite Last 3', colour changes to black-green, well bedded 75° core axis.	1748	105.5	106.3	0.8	400	0.2
			1749	119.5	123.3	3.8	400	0.1
303.7	366.0	Granite, medium grey-pink, coarse grained, massive unaltered..	1750	132.6	132.6	0.6	500	0.1
366.0		END OF HOLE.						

**DUPLICATE COPY  
POOR QUALITY ORIGINAL  
TO FOLLOW**

# DIAMOND DRILL RECORD

LOGGED BY

G. J. Hense *G. Hense*

PROPERTY *Kerr Addison Mines Limited - Eganor Option - "O-10" - Drury Township - Ontario*

D.D.H. No. *RR76-7*

PAGE *1*

ATTITUDE *1700 N* BEARING OF HOLE *N20°E* STARTED *January 31, 1977*

DEPARTURE *2000 E* DIP OF HOLE *-50°* COMPLETED *February 6, 1977*

ELEVATION \_\_\_\_\_ DIP TESTS *300' -29° N14°E* DEPTH *366.0'*

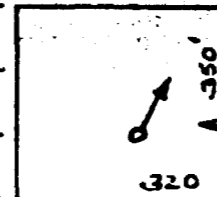

CLAIM No. *S321580*

DIRECTION AND DISTANCE FROM

NE. CLAIM POST

*Marking Diamond Drilling Limited - 24 Tardif, Rouyn, Quebec - AQ core*

*U<sub>3</sub>O<sub>8</sub> ThO<sub>2</sub>*

FOOTAGE		DESCRIPTION	SAMPLE No.	FOOTAGE		SAMPLE LENGTH	ASSAY		
FROM	TO			FROM	TO		TV-3	U <sub>3</sub> O <sub>8</sub>	ThO <sub>2</sub>
0.0	42.0	Casing							
42.0	81.2	Argillite, medium to dark grey, very fine grained, bedded 45-55° to core axis.							
81.2	106.6	Arkose, low grey-green, very coarse grained, unaltered, well bedded 40° to core axis	1745	93.1	93.9	0.8	400	0.1	
		93.9-94.9 10% pebbles, up to 10 mm, well stretched	1746	93.9	94.5	0.6	400	trace	
		At 103.1 1-5 mm, well stretched pebble	1747	94.5	94.9	0.4		all	
		98.1-98.7 argillite, medium grey, very fine grained, 45° core axis							
106.6	195.0	Quartzite, medium grey, fine grained, bedded 40° to core axis	1748	105.5	106.3	0.8	400	0.2	
		At 165.0 60° core axis	1749	119.5	123.3	3.8	400	0.1	
		190.9-195.0 40% argillite interbeds	1750	132.0	132.6	0.6	500	0.1	
195.0	221.9	Arkose, low grey-green, pinkish locally, very coarse grained, few erratic quartz pebbles, one 10 mm at 205.2; 1-5 mm 215.3; 1-5 mm at 220.9.							
		Bedded 60° to core axis							
221.9	303.7	Basic tuff, dark grey-green, fine grained, bedded 60° to core axis, 10% calcite in vugs and disseminated							
		297.7-298.0; 298.7-299.3 granite							
		Last 3', colour changes to black-green, well bedded 75° core axis							
303.7	366.0	Granite, medium grey-pink, coarse grained, massive unaltered							



#33-77

S358415

S359424

S358476

KR76-8  
4400E,  
550N

S358475

L40.000

L44.000

L48.000

L52.000



KERR ADDISON MINES LIMITED  
RYANOR-NEVINORTH OPTION "O-10"  
Drury Twp. Ontario

LOCATION SKETCH

D.D.H. KR76-8

Scale: 1"=100'

Feb. 1977.

J. R. Foster

G. New

# DRILL RECORD

LOGGED BY G. J. Hinse

Kerr Addison Mines Limited - Ryanor Option - "0-10" - Drury Township, Ontario

ALTITUDE 550 N BEARING OF HOLE N20°E STARTED Feb. 8/77  
 DEPARTURE 4400E DIP OF HOLE -50° COMPLETED Feb. 9/77  
 ELEVATION \_\_\_\_\_ DIP TESTS 274' N24°E 34° DEPTH 447.7

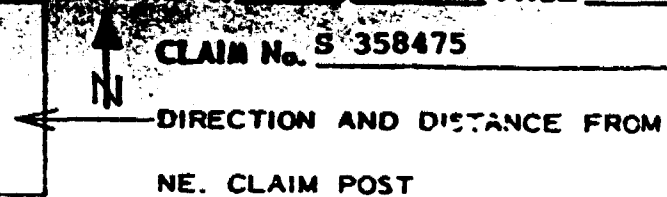
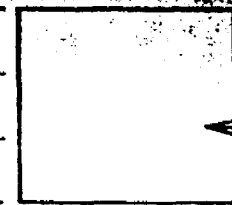

Hosking Diamond Drilling - 24 Tardiff, Rouyn, Quebec, - AQ Core.

FOOTAGE		DESCRIPTION	SAMPLE No.	FOOTAGE		SAMPLE LENGTH	ASSAY	
FROM	TO			FROM	TO			
0.0	54.0	Casing						
54.0	235.8	Quartzite, medium grey, very fine grained, well bedded at 45° to core axis Lost core 69.2-71.2, 72.2-73.2, 74.2-76.0, 78.3-79.3, 80.0-81.3, 86.2-87.1 88.4-89.2, 104.0-105.0, 106.5-107.5, 108.5-110.0, 201.3-202.2, 203.2-204.5 205.2-206.5, 207.9-209.2, 212.0-213.0						
		90.0 on, low grey to white, pure, fine grained, traces of pyrite 145.4-146.5, 148.5-149.1, 154.8-156.5, schistose gabbro, dark grey green, 60° core axis.						
235.0	258.0	Basic volcanic tuff, dark grey-green, very fine grained, well bedded, 70° core axis, traces of pyrite.						
258.0	267.2	Granite, low pink-grey, very coarse grained, weakly brecciated, contains 20-25% white milky quartz with biotite and green chlorite.						
267.2	274.0	Basic volcanic tuff as before						
274.0	321.0	Granite, as before, very coarse grained. Upper contact, few narrow quartz and tuff veinlets. 305.0-321.5 20% quartz veining, weakly brecciated.						
321.5	325.8	Basic tuff, 70° core axis.						
325.8	329.0	Granite, medium grey, 60° core axis.						
329.0	383.5	Basic tuff, 65° core axis. 355.0-367.0 gabbroic.						
383.5	388.3	30% coarse white pink arkose with sericite partings in dirty, dark grey, fine grained quartzite, well bedded 75° core axis.						
388.3	435.0	Quartzite, very fine grained, dark grey, well bedded 60° core axis contains some narrow tuff sections.						
435.0	441.9	Basic tuff, dark grey-green, very fine grained, bedded 75° core axis, with narrow argillite sections.						
441.9	447.7	Granite, low-medium pinkish grey, very coarse grained, slightly gneissic at 65° core axis.						
447.7		END OF HOLE						
		Core stored at Agnew Lake Mines Limited - casing pulled out.						

**DUPLICATE COF  
POOR QUALITY ORIGINAL  
TO FOLLOW**







RECEIVED

S. 291530

FEB 14 1977

A separate form is required for each type of work to be recorded.

U308



41105NE0019 0016 DRURY

900 REPORT OF WORK

To the Recorder of ..... Sudbury ..... Mining Division

I, ..... Kerr Addison Mines Limited ..... 1A35072  
name of Recorded Holder ..... Prospector's Licence

..... P.O. Box 91, Commerce Court West, Toronto, Ontario, M5L 1G7  
Post Office Address

do hereby report the performance of ..... 4083 ..... days of ..... diamond drilling .....  
type of work

not before reported to be applied on the following contiguous claims

Claim No.	Days	Claim No.	Days	Claim No.	Days
S291530 ✓	40 ✓	S358411	40 ✓	S358473	40 ✓
S324578 ✓	39 ✓	S358415 ✓	39 ✓	S358474	40 ✓
S324579	39 ✓	S358416 ✓	39 ✓	S358475	60 ✓
S324580	39 ✓	S358417	40 ✓	S358476	60 ✓
S324581	39 ✓	S358471	40 ✓	S358588	40 ✓
S358413 ✓	39 ✓	S358472	40 ✓	S358590	40 ✓

All the work was performed on Mining Claim (s) S291530, S324578, S358413, S358415, S358416.  
(In the case of geological and/or geophysical survey (s) where more than 18 claims are involved attach a schedule)

**READ CAREFULLY: THE FOLLOWING INFORMATION IS REQUIRED BY THE MINING RECORDER.**

For Manual Work, Stripping or Opening up of Mines, Sinking Shafts or Other Actual Mining Operations - Names and addresses of the men who performed the work and the dates and hours of their employment.

For Diamond and other Core Drilling - Footage, No. and angle of holes and diameter of core. Name and address of owner or operator of drill. Dates when drilling was done. Signed core log and sketch in duplicate.

For Compressed Air or Other Power Driven or Mechanical Equipment

Type of drill or equipment. Names and addresses of men engaged in operating equipment and the dates and hours of their employment.

For Power Stripping - Type of equipment. Name and address of owner or operator. Amount expended. Dates on which work was done. Proof of actual cost must be submitted within 30 days of recording.

With each of the above types of work sketches are required to show the location and extent of the work in relation to the nearest claim post. In the case of diamond or other core drilling the sketch must be submitted in duplicate.

For Geophysical, Geological, Geochemical Surveys and Expenditure Credits - the name of author of report. Covering dates of survey (linecutting & office). Type of instrument used. Total amount of expenditure. Technical reports, maps, expenditure breakdown, receipts must be filed in duplicate with the Minister within 60 days of recording.

For Land Survey - the name and address of Ontario Land surveyor.

The Required Information is as Follows: (Attach a list if this space is insufficient)

WORK ASSIGNMENT

S. 291530	-	1220	BALANCE	2780
S. 324578	-	115	BALANCE	3685
S. 358413	-	1541	BALANCE	2451
S. 358415	-	324	BALANCE	3671
S. 358416	-	682	BALANCE	3318

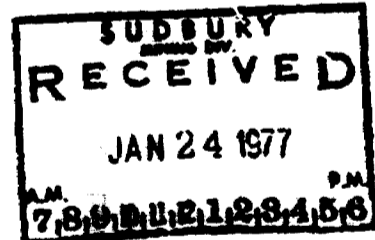

Date ..... January 21, 1977.

J. R. Foster  
Signature of Recorded Holder or Agent

The Mining Act  
Certificate Verifying Report of Work

I, ..... J. R. Foster .....  
P.O. Box 1780, Espanola, Ontario, P0P 1G0  
(Post Office Address)

Geological Branch ODM  
ASSESSMENT FILES  
RESEARCH OFFICE

hereby certify:

1. That I have a personal and intimate knowledge of the facts set forth in the report of work annexed here to, having performed the work or witnessed same during and/or after its completion.

2. That the annexed report is true.

Dated ..... January 21, 1977.

J. R. Foster  
Signature

J. R. Foster

THE PENALTY FOR MAKING A FALSE STATEMENT IN THIS REPORT AND/OR CERTIFICATE IS \$500. OR SIX MONTHS IMPRISONMENT OR BOTH

<u>Claim No.</u>	<u>Days</u>	<u>Claim No.</u>	<u>Days</u>
S358591 ✓	40'	S359425 ✓	59'
S358592 ✓	40'	S359427 ✓	119'
S359375 ✓	39'	S359428 ✓	119'
S359376 ✓	79'	S359429 ✓	119'
S359377 ✓	79'	S359430 ✓	119'
S359378 ✓	39'	S359431 ✓	119'
S359379 ✓	119'	S359432 ✓	119'
S359380 ✓	119'	S359433 ✓	119'
S359413 ✓	60'	S359434 ✓	119'
S359414 ✓	60'	S359435 ✓	119'
S359415 ✓	120'	Sl424767 ✓	40'
S359416 ✓	120'	Sl424768 ✓	40'
S359417 ✓	120'	Sl438576 ✓	39'
S359418 ✓	120'	Sl438577 ✓	39'
S359419 ✓	119'	Sl438578 ✓	39'
S359420 ✓	119'	Sl438579 ✓	59'
S359421 ✓	119'	Sl438580 ✓	59'
S359422 ✓	119'	Sl438581 ✓	39'
S359423 ✓	59'	Sl438582 ✓	39'
S359424 ✓	59'	Sl438583 ✓	59'



Ministry of,  
Natural  
Resources  
Ontario

DRURY TWP.

# 77-10

RECEIVED

FILE S.291530

FEB 14 1977

A separate form is required for each type of work to be recorded.

U-08

THE MINING ACT REPORT OF WORK

To the Recorder of Sudbury Mining Division

I, Kerr Addison Mines Limited 35072

name of Recorded Holder Prospector's Licence  
P.O. Box 91, Commerce Court West, Toronto, Ontario. M5L 1G7

do hereby report the performance of 152 days of core specimens type of work

not before reported to be applied on the following contiguous claims

Claim No.	Days	Claim No.	Days	Claim No.	Days
S291530	6	S358421	6	S358473	3
S324578	2	S358425	2	S358474	3
S324579	1	S358426	3	S358475	2
S324580	1	S358427	3	S358476	2
S324582	5	S358472	3	S358589	2
S358423	2	S358472	3	S358590	3

All the work was performed on Mining Claim (s) S291530, S324578, S358423, S358425, S358426, S358427, S358472, S358473, S358474, S358475, S358476, S358589, S358590  
(In the case of geological and/or geophysical survey (s) where more than 18 claims are involved attach a schedule)

READ CAREFULLY: THE FOLLOWING INFORMATION IS REQUIRED BY THE MINING RECORDER.

- For Manual Work, Stripping or Opening up of Mines, Sinking Shafts or Other Actual Mining Operations - Names and addresses of the men who performed the work and the dates and hours of their employment.
- For Diamond and other Core Drilling - Footage, No. and angle of holes and diameter of core. Name and address of owner or operator of drill. Dates when drilling was done. Signed core log and sketch in duplicate.
- For Compressed Air or Other Power Driven or Mechanical Equipment  
Type of drill or equipment. Names and addresses of men engaged in operating equipment and the dates and hours of their employment.
- For Power Stripping - Type of equipment. Name and address of owner or operator. Amount expended. Dates on which work was done. Proof of actual cost must be submitted within 30 days of recording.
- With each of the above types of work sketches are required to show the location and extent of the work in relation to the nearest claim post. In the case of diamond or other core drilling the sketch must be submitted in duplicate.
- For Geophysical, Geological, Geochemical Surveys and Expenditure Credits - the name of author of report. Covering dates of survey (linecutting & office). Type of instrument used. Total amount of expenditure. Technical reports, maps, expenditure breakdown, receipts must be filed in duplicate with the Minister within 60 days of recording.
- For Land Survey - the name and address of Ontario Land surveyor.

The Required Information is as Follows: (Attach a list if this space is insufficient)

Geological Branch ODM  
ASSESSMENT FILES  
RESEARCH OFFICE  
JAN 28 1977  
RECEIVED

SUDBURY  
RECEIVED  
JAN 24 1977  
P.M.  
7, 8, 9, 10, 11, 12, 1, 2, 3, 4, 5, 6

Date January 21, 1977

J. R. Foster  
Signature of Recorded Holder or Agent

The Mining Act  
Certificate Verifying Report of Work

I, J. R. Foster  
P.O. Box 1788, Espanola, Ontario, POP. 100  
(Post Office Address)

hereby certify:

- That I have a personal and intimate knowledge of the facts set forth in the report of work annexed hereto, having performed the work or witnessed same during and/or after its completion.
- That the annexed report is true.

Dated January 21, 1977

J. R. Foster  
Signature  
J. R. Foster

THE PENALTY FOR MAKING A FALSE STATEMENT IN THIS REPORT AND/OR CERTIFICATE IS \$500. OR SIX MONTHS IMPRISONMENT OR BOTH

<u>Claim No.</u>	<u>Days</u>	<u>Claim No.</u>	<u>Days</u>
S358591	3	S359425	2
S358592	3	S359427	6
S359375	3	S359428	6
S359376	3	S359429	6
S359377	3	S359430	5
S359378	3	S359431	5
S359379	2	S359432	5
S359330	2	S359433	2
S359413	2	S359434	2
S359414	2	S359435	2
S359415	2	SL21767	1
S359416	2	SL21768	1
S359417	2	SL38576	3
S359418	2	SL38577	3
S359419	2	SL38578	3
S359420	2	SL38579	2
S359421	2	SL38580	2
S359422	2	SL38581	3
S359423	2	SL38582	3
S359424	2	SL38583	2



Ministry of  
Natural  
Resources  
Ontario

# 77-34 117

5324579

A separate form is required for each type of work to be recorded.

THE MINING ACT REPORT OF WORK

To the Recorder of SUDBURY Mining Division

I, Kerr Addison Mines Limited 135072  
name of Recorded Holder Prospector's Licence

P. O. Box 91, Commerce Court West, Toronto, Ontario M5L 1C7  
Post Office Address

do hereby report the performance of 98 days of core specimens type of work

not before reported to be applied on the following contiguous claims

Claim No.	Days	Claim No.	Days	Claim No.	Days
S324579	2	S358416	2	S358475	2
S324580	2	S358417	2	S358476	2
S324581	2	S358471	2	S358588	2
S358413	2	S358472	2	S358590	2
S358414	2	S358473	2	S358591	2
S358415	2	S358474	2	S358592	2

All the work was performed on Mining Claim (s) S324578, S324579, S324580, S358475  
(In the case of geological and/or geophysical survey (s) where more than 18 claims are involved attach a schedule)

READ CAREFULLY: THE FOLLOWING INFORMATION IS REQUIRED BY THE MINING RECORDER.

For Manual Work, Stripping or Opening up of Mines, Sinking Shafts or Other Actual Mining Operations - Names and addresses of the men who performed the work and the dates and hours of their employment.

For Diamond and other Core Drilling - Footage, No. and angle of holes and diameter of core. Name and address of owner or operator of drill. Dates when driven or mechanical. Signed core log and sketch in duplicate.

For Compressed Air or Other Power Driven or Mechanical Equipment  
Type of drill or equipment. Names and addresses of men engaged in operating equipment and the dates and hours of their employment.

For Power Stripping - Type of equipment. Name and address of owner or operator. Amount expended. Dates on which work was done. Proof of actual cost must be submitted within 30 days of recording.

With each of the above types of work sketches are required to show the location and extent of the work in relation to the nearest claim post. In the case of diamond or other core drilling the sketch must be submitted in duplicate.

For Geophysical, Geological, Geochemical Surveys and Expenditure Credits - the name of author of report. Covering dates of survey (linecutting & office). Type of instrument used. Total amount of expenditure. Technical reports, maps, expenditure breakdown, receipts must be filed in duplicate with the Minister within 60 days of recording.

For Land Survey - the name and address of Ontario Land surveyor.

The Required Information is as Follows: (Attach a list if this space is insufficient)

- Hole KR 76-5 316.0 feet
- KR 76-6 1376.0 feet
- KR 76-7 366.0 feet
- KR 76-8 447.7 Feet

All drilled by Hosking Diamond Drilling Company

Geological Branch ODM  
ASSESSMENT FILES  
RECORDS OFFICE  
JUN 23 1977  
RECEIVED

Date May 24, 1977

G. J. Hinse  
Signature of Recorded Holder or Agent  
G. J. Hinse

The Mining Act  
Certificate Verifying Report of Work

I, G. J. Hinse  
P. O. Box 1788, Espanola, Ontario POP 1C0  
(Post Office Address)

herby certify:

- That I have a personal and intimate knowledge of the facts set forth in the report of work annexed hereto, having performed the work or witnessed same during and/or after its completion.
- That the annexed report is true.

Dated May 24, 1977

G. J. Hinse  
Signature  
G. J. Hinse

THE PENALTY FOR MAKING A FALSE STATEMENT IN THIS REPORT AND/OR CERTIFICATE IS \$500. OR SIX MONTHS IMPRISONMENT OR BOTH

<u>CLAIM NO.</u>	<u>DAYS</u>	<u>CLAIM NO.</u>	<u>DAYS</u>
S359375	36	S359427	53
S359378	36	S359428	53
S359379	57	S359429	53
S359380	57	S359430	54
S359413	56	S359431	54
S359414	86	S359432	54
S359415	56	S359433	57
S359416	56	S359434	57
S359417	56	S359435	57
S359419	41	S424767	127
S359420	57	S424768	127
S359421	57	S438576	26
S359422	57	S438579	37
S359423	87	S438580	37
S359424	57	S438582	27
S359425	57	S438583	38

50 claims



Ministry of  
Natural  
Resources

Ontario

# 77-23

S. 324579

A separate form is  
required for each  
type of work to be  
recorded.

THE MINING ACT REPORT OF WORK

To the Recorder of SUBURBY Mining Division

I, KERR ADDISON MINES LIMITED A 3507  
name of Recorded Holder Prospector's Licence

..P.O. Box 91, Commerce Court West, Toronto, Ontario M5L 1C7  
Post Office Address

do hereby report the performance of 2505 days of diamond drilling  
type of work

not before reported to be applied on the following contiguous claims

Claim No.	Days	Claim No.	Days	Claim No.	Days
S324579	38	S358476	36	S358475	56
S324580	38	S358477	35	S358476	56
S324581	34	S358471	35	S358588	36
S358413	37	S358472	35	S358590	35
S358414	37	S358473	35	S358591	35
S358415	37	S358474	35	S358592	35

All the work was performed on Mining Claim (s) S324578, S324579, S324580, S358475  
(In the case of geological and/or geophysical survey (s) where more than 18 claims are involved attach a schedule)

**READ CAREFULLY: THE FOLLOWING INFORMATION IS REQUIRED BY THE MINING RECORDER.**

For Manual Work, Stripping or Opening up of Mines, Sinking Shafts or Other Actual Mining Operations - Names and addresses of the men who performed the work and the dates and hours of their employment.

For Diamond and other Core Drilling - Footage, No. and angle of holes and diameter of core. Name and address of owner or operator of drill. Dates when drilling was done. Signed core log and sketch in duplicate.

For Compressed Air or Other Power Driven or Mechanical Equipment  
Type of drill or equipment. Names and addresses of men engaged in operating equipment and the dates and hours of their employment.

For Power Stripping - Type of equipment. Name and address of owner or operator. Amount expended. Dates on which work was done. Proof of actual cost must be submitted within 30 days of recording.

With each of the above types of work sketches are required to show the location and extent of the work in relation to the nearest claim post. In the case of diamond or other core drilling the sketch must be submitted in duplicate.

For Geophysical, Geological, Geochemical Surveys and Expenditure Credits - the name of author of report. Covering dates of survey (linecutting & office). Type of instrument used. Total amount of expenditure. Technical reports, maps, expenditure breakdown, receipts must be filed in duplicate with the Minister within 60 days of recording.

For Land Survey - the name and address of Ontario Land surveyor.

The Required Information is as Follows:

(Attach a list if this space is insufficient)

Hole KR 76-5 316.0 feet  
KR 76-6 1376.0 feet  
KR 76-7 366.0 feet  
KR 76-8 447.7 feet

Geological Branch ODM  
ASSESSMENT FILES  
RECORDS OFFICE

JUN 23 1977

RECEIVED

All drilled by Hosking Diamond Drilling Company Limited, Toronto

Date May 24, 1977

G. J. Hines  
Signature of Recorded Holder or Agent  
G. J. Hines

The Mining Act  
Certificate Verifying Report of Work

G. J. Hines

P. O. Box 1788, Espanola, Ontario P0P 1C0  
(Post Office Address)

hereby certify:

1. That I have a personal and intimate knowledge of the facts set forth in the report of work annexed hereto, having performed the work or witnessed same during and/or after its completion.
2. That the annexed report is true.

Dated May 24, 1977

G. J. Hines  
Signature  
G. J. Hines

*commodity bought*

THE PENALTY FOR MAKING A FALSE STATEMENT IN THIS REPORT AND/OR CERTIFICATE IS \$500. OR SIX MONTHS IMPRISONMENT OR BOTH



CORE SPECIMENS

<u>CLAIM NO.</u>	<u>DAYS</u>	<u>CLAIM NO.</u>	<u>DAYS</u>
S359375	2	S359427	2
S359378	2	S359428	2
S359379	2	S359429	2
S359380	2	S359430	2
S359413	2	S359431	2
S359414	2	S359432	2
S359415	2	S359433	2
S359416	2	S359434	2
S359417	2	S359435	2
S359419	2	S424767	2
S359420	2	S424768	2
S359421	2	S438576	2
S359422	2	S438579	2
S359423	2	S438580	2
S359424	2	S438582	1
S359425	2	S438583	1

50 claims



FOR ADDITIONAL

INFORMATION

SEE MAPS:

DRURY.0016 #1,2,3,4,  
5.

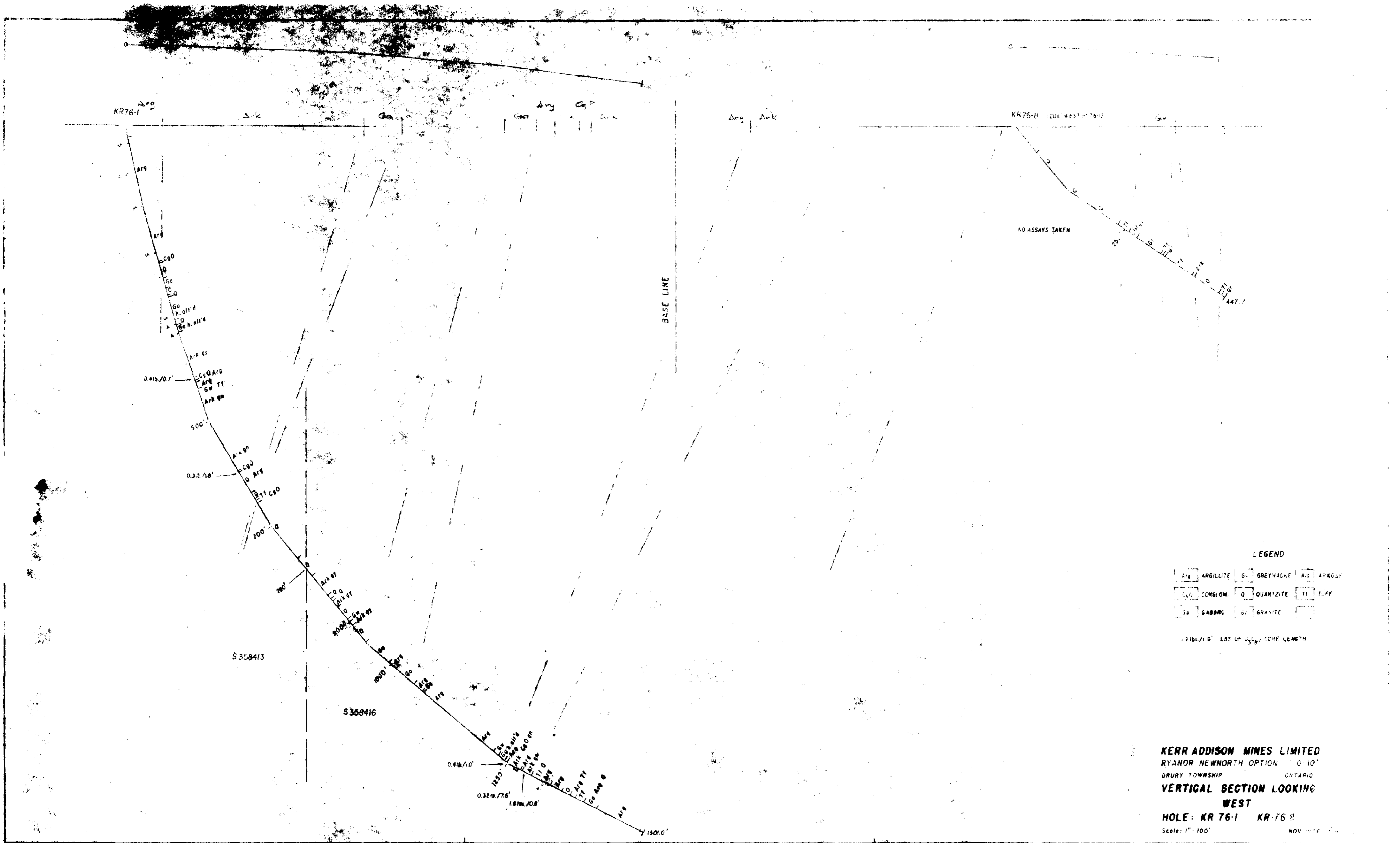

★ DRURY-0016-#1



100'	100'	100'
200'	200'	200'
300'	300'	300'
400'	400'	400'
500'	500'	500'
600'	600'	600'
700'	700'	700'
800'	800'	800'
900'	900'	900'
1000'	1000'	1000'

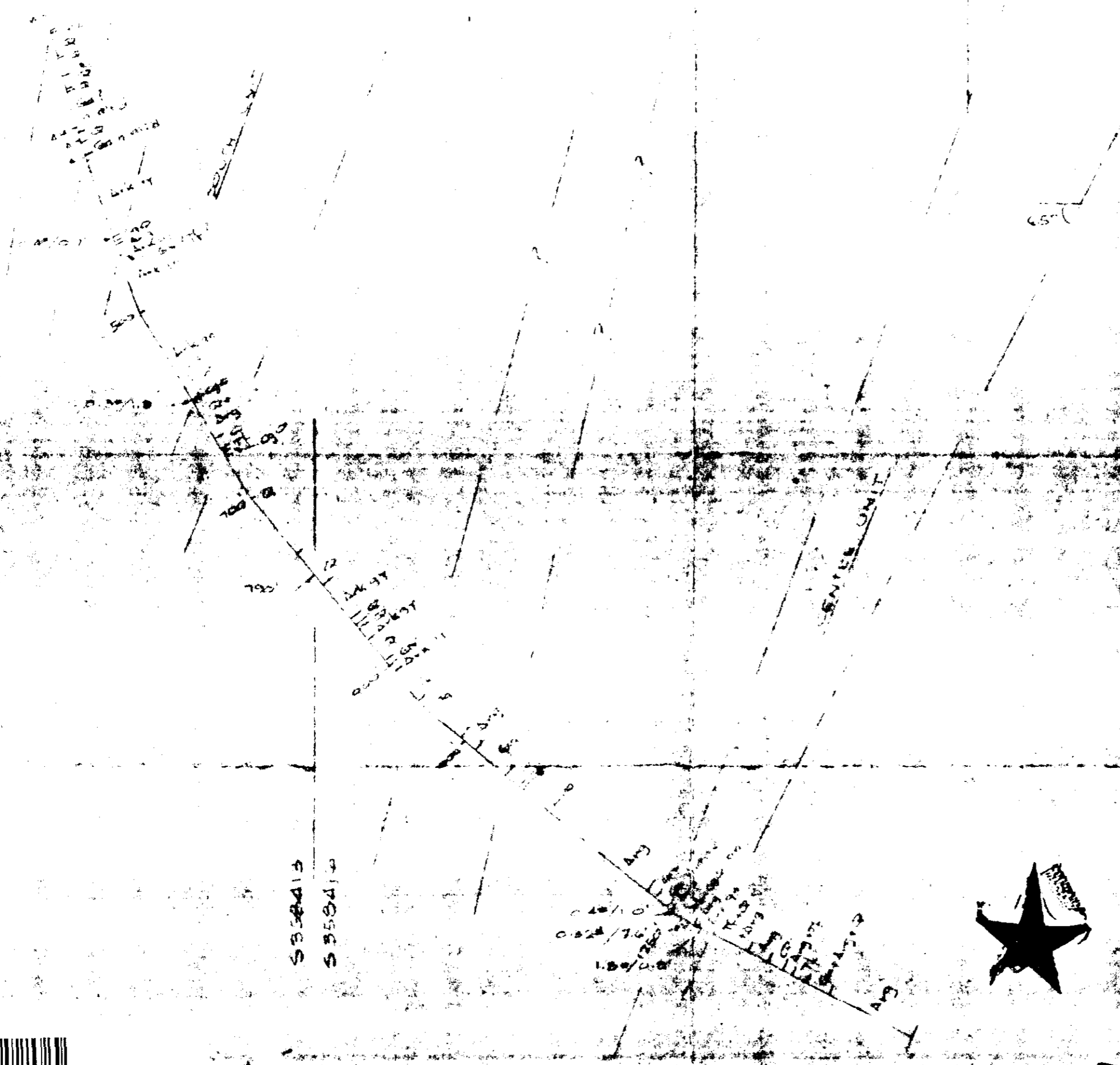

LEGEND

- G GABBRO
- Q QUARTZITE
- S SILTSTONE
- Cgp CONGLOMERATE, polymitic
- DL DOLOMITE
- Cq CONGLOMERATE, of quartzite
- T TUFF
- G GABBRO

100' of U<sub>2</sub>O<sub>5</sub> / Core Length

KEER ADDISON MINES LIMITED  
 PLANOZ-NEVNORTH OPTION - 10-10'  
 Duff Twp. Ontario  
 VERTICAL SECTION LOOKING WEST  
 HOLE KE 76-1  
 Scale: 1" = 100'  
 G. W. Jones Nov. 76

DRURY-0016-22



KL 76-2  
97.4  
97.4  
97.4

Collar	Strike	Dip
100'	20°	-75°
100'	21°	-70°
200'	21°	-66°
300'	22°	-58°
400'	21°	-50°
600'	21°	-40°
900'	21°	-24°
1000'	24°	-5°
1050'	23°	-10°

LEGEND

- A<sub>g</sub> ARGILLITE
- S<sub>o</sub> SILTSTONE
- Q QUARTZITE
- C<sub>g</sub>P CONGLOMERATE, polymictic
- A<sub>k</sub> ARLOSE
- C<sub>g</sub>O CONGLOMERATE, oligomictic
- T TUFF
- A SANDSTONE

1.5"/0.4" lbs of USGS/cora length

KEER ADDISON MINES LIMITED  
 BYDNOE-NEWMOUTH OPTION - 10-10"  
 Drury Twp. Ontario  
 VERTICAL SECTION LOOKING WEST  
 HOLE - KE 76-2  
 Scale: 1" = 100'  
 G. H. H. 11/26/76



DRURY-0016-#3





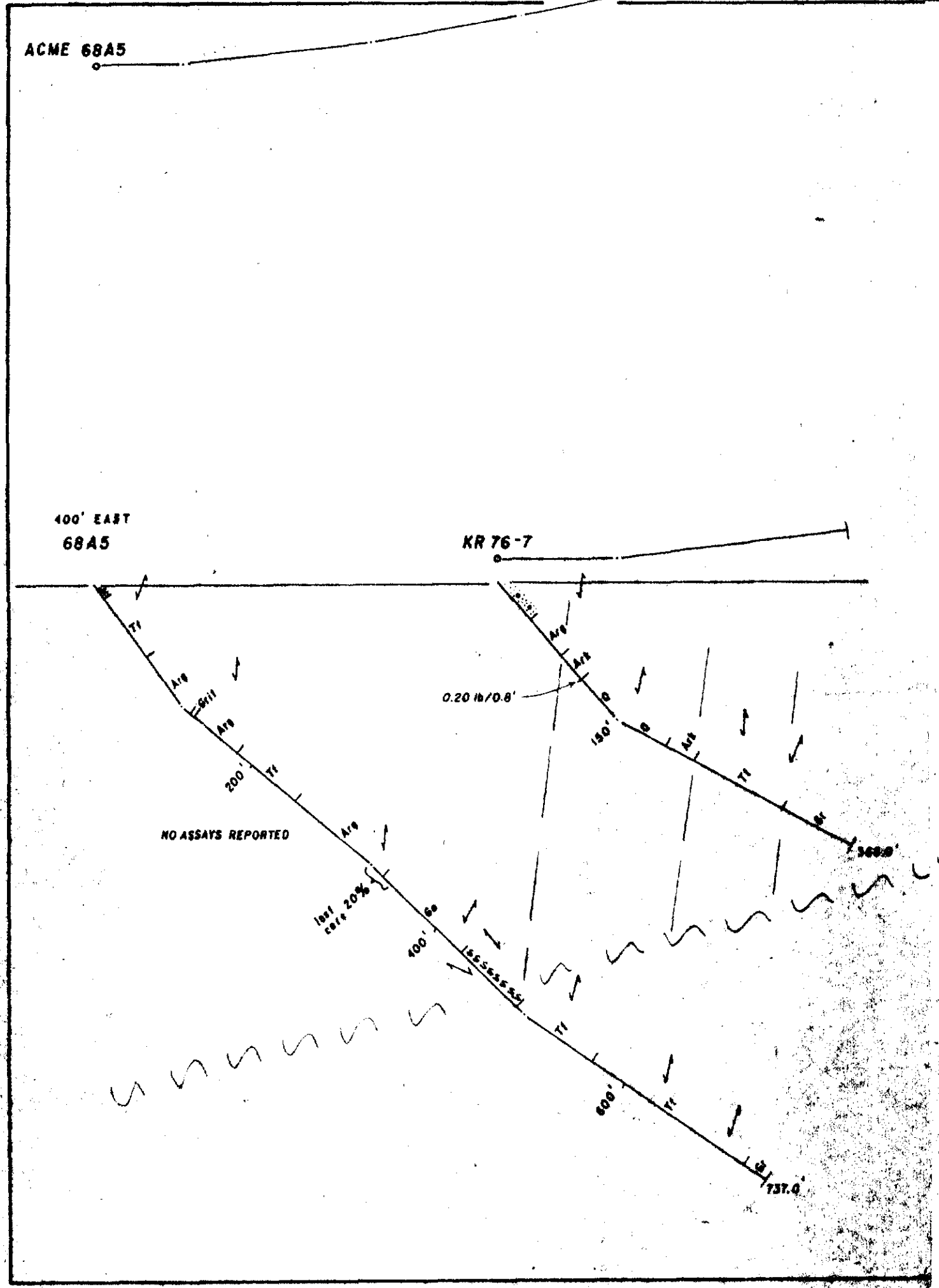

**LEGEND**

Arg	ARGILLITE	Ark	ARKOSE	Q	QUARTZITE
Gb	GABBRO	Gr	GRANITE	TI	TUFF

**KERR ADDISON MINES LIMITED**  
 RYANOR NEWNORTH OPTION "O-10"  
 DRURY TOWNSHIP ONTARIO  
**VERTICAL SECTION LOOKING WEST**  
 HOLE: ACME 68A5 , KR 76-7  
 SCALE: 1" = 100' FEB. 1977

*G. Hunt*

★ DRURY. 0016. #5  
 #5





KR 76 6  
KR 76 5  
KR 76 4

ACME 68-3

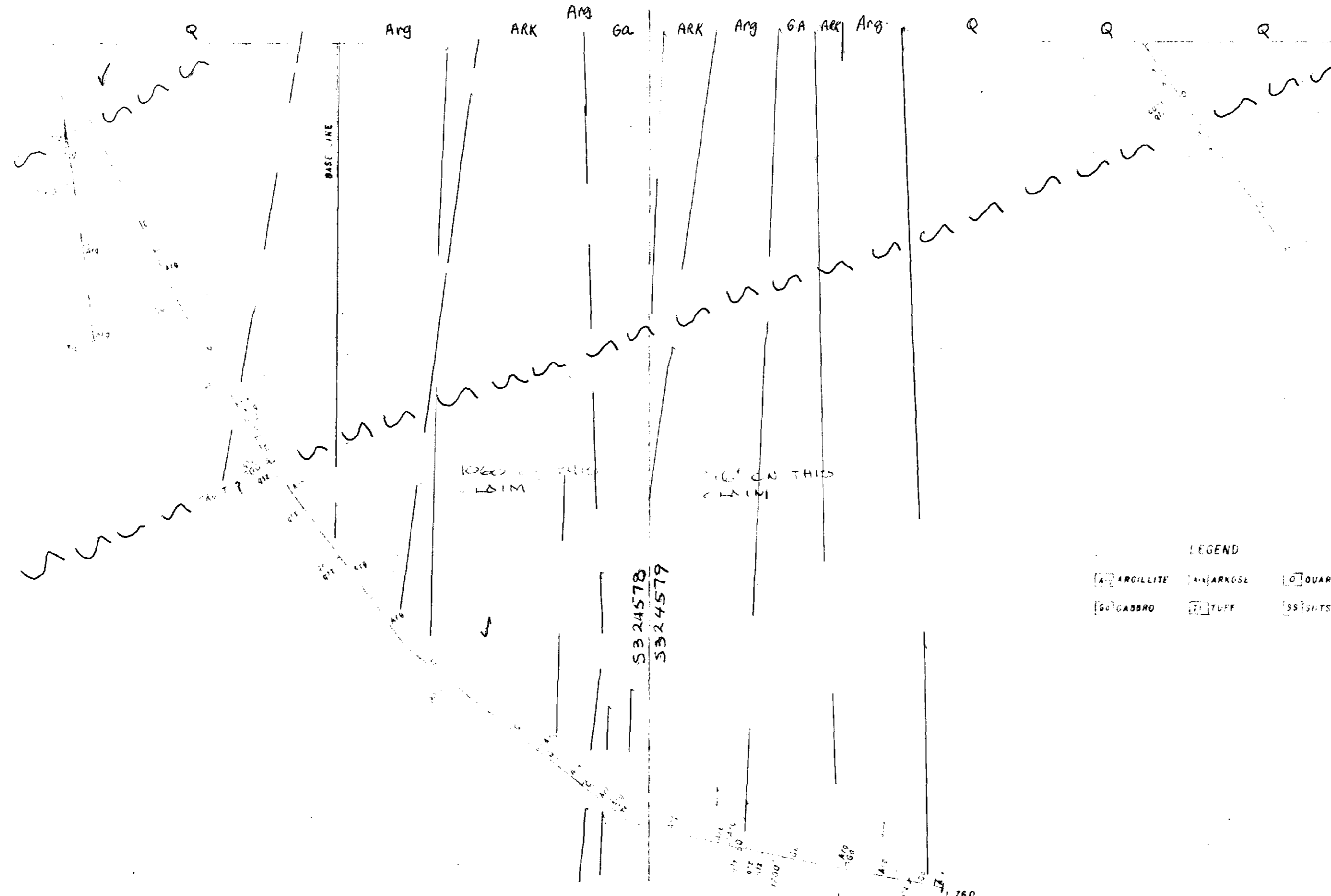

LEGEND

[A] ARGILLITE	[AR] ARKOSE	[Q] QUARTZITE
[G] GABBRO	[T] TUFF	[S] SLTSTONE

KERR ADDISON MINES LIMITED  
 RYANOR NEWNORTH OPTION "O-10"  
 DRURY TOWNSHIP ONTARIO  
 VERTICAL SECTION LOOKING WEST  
 HOLE: KR 76456 ACME 68-3  
 SCALE 1" = 100' JAN 1977

G. D. Hunt

DRURY-0016-#6

