



41105NE0031 0014B1 DRURY

010

Diamond Drilling

Township of Drury

Report NO: 23

Work performed by: Acme Gas & Oil Co. Ltd.

Claim NO	Hole NO	Footage	Date	Note
S 139126	68-A-6	538'	Oct/68	(1) (3) (4)
	69-A-6	<u>416'</u>	Apr/69	
		<u>954'</u>		
S 138818	68-A-7	710'	Oct/68	(3)
		<u>303'</u>	Apr/69	
		<u>1013'</u>		
S 139132	68-A-13	353'	Jan/69	(2)
	69-A-13	<u>1454'</u>	Mar/69	
		<u>1807</u>		

TOTAL 5 DH 3774

Notes:

- (1) 14/71
- (2) 15/71
- (3) 71/71
- (4) 125/71

CL: 13926 75' PROPERTY: ... 68-A-6
 LOCATION: ...
 STRIKE: N-19°E (AS ...)
 DIP: Collar 55°
 DATE DRILLED: 2 - 5 Oct/68
 CL: ...

PURPOSE: To test surface showings.

FOOTAGE	DESCRIPTION	SAMPLE NO.	WIDTH	ABS. VALUE
0- 30	CASING			
30- 49	SLATE - BLUE BLACK - soft-bedded 45°/core.			
49--54	SLATE - BROWN - THIN bedded - occ. 1/4" Quartzite.			
54- 58	Polymictic Grit (1/4") Quartz pebbles in slaty-greywacke MATRIX.			
58- 80	SLATE - grey to black - bedded 45°/core. Short sections of argillite and grit.			
80- 90	Polymictic GRIT - with interbedded greywacke with calcite veins.			
90- 93	SLATE - grey to black.			
93-103	Quartzite - white to grey - MASSIVE feldspathic R/A = 2 x P G.			
103-130	SLATE - Greywacke - grey to black grading into soft schistose rock at 130.			
130-160	SCHIST (soft shale?) - very soft - grey-green 45°/core.			
160-225	Meta sediment - SHALE & SLATE - green - black - often grey speckled - some beds have quartz eyes (1/2" dia.) bedding 45° - 60°/core - variable thin bedded to massive.			
225-305	Meta Volcanic - dark green - massive gradalimal change to grey rock showing bedding or schistosity - 50° - 60°/core.			
305-313	QUARTZITE - yellow - green - sharp contact grading downward to greywacke and thin silt.			
313-315	QUARTZITE - yellow - green greywacke to silt as above 6" quartzite - pyritized. R/A = 5 x B.G.			
315-318	SHALE - Black - soft schistose. Contacts sharp.			
318-323	Quartzite - white - grading into greywacke with silty bands.			
323-332	SHALE - Black - soft - scattered 4" sections of quartzite.			
332-373	Quartzite - yellow - green - in part gritty occasional small pebble (1/4" - 1/2") occ. spot of R/A 2-3 x B.G. at 345 grades into yellow-blue quartzite.			
373-385	Greywacke - gradalimal change from quartzite to greywacke to silty shale.			
385-393	Quartzite - occ. 1/2" pebble (Qtz.) grading into greywacke into shale.			
393-402	Quartzite - feldspathic.			
402-427	Sharp change to metasediment - grey-black - becoming soft at 425. Bedding 60°/core.			
427-517	GRIT - Granite derived - coarse - red - resembles granite.			
517-519	SHALE - Black soft - contains 1/2" pebble of Quartz.			
519-528	GRIT - AS ABOVE.			

FILLED BY: Bradley Bros. Limited

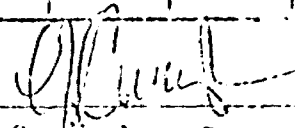
SIGNED: 
 L. J. Cunningham, B.Sc., P.Eng.

PROPERTY ACME GAS & OIL CO., LIMITED

HOLE NO. 68 A 6

LOCATION: _____

LATITUDE: _____

DEPARTURE: _____

ELEVATION: _____

STRIKE: N19°E

DIP: _____

DATE DRILLED: _____

PAGE NO. _____

CLAIM _____

PURPOSE: To test surface showings.

FOOTAGE	DESCRIPTION	SAMPLE NO.	WIDTH	ASSAY VALUE
528-538 538	Mixture slate - greywacke - quartzite - grit. END OF HOLE	Tests 250-40° 500-45°	(Astronomic) N16°E N12°E	
<i>This section previously reported Dec 25/69 see Rpt. of Work.</i>				

DRILLED BY Bradley Bros. Limited

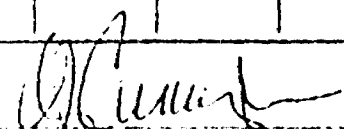
SIGNED 
L. J. Cunningham, B.Sc., P.Eng.

PROPERTY Acme Gas & Oil Company Limited

Claim 139826

HOLE NO. A-6

LOCATION:

LATITUDE:

DEPARTURE:

ELEVATION:

STRIKE:

DIP:

DATE DRILLED: April-May, 1969

PAGE NO. 3

PURPOSE: hole deepened

FOOTAGE	DESCRIPTION	SAMPLE NO.	WIDTH	ASSAY VALUE
538 - 554	GRIT (Granite derived) fragments of blue quartz & gray to brown feldspar in dark matrix shows banding or bedding - 60°/core			
554 - 562	METASEDIMENTS - grey to black - distinct bedding - 60°/core			
562 - 580	METASEDIMENT OR METAVOLCANIC? greenish grey massive no evidence of bedding			
580 - 582	30° - 40° vein quartz with some grey carbonate			
582 - 625	METAVOLCANIC? coarse grained crystalline light coloured 600-601 1 foot vein quartz			
625 - 662	METASEDIMENT fine grained grey green in part distinct bedding 60°/core - may continue interbedded tuff or metavolcanic			
662 - 954	METAVOLCANIC coarse grained, highly altered crystalline - grey, creamy coloured - massive may be regolithic material Occasional indistinct feature suggesting bedding Occasional large granitic patch suggesting partially digested fragment			
954	884 - possible fault 6" quartz & gouge - 60°/core			
	END OF HOLE			
	TEST 900' 38° - N 7° W			

DRILLED BY Bradley Bros Limited

SIGNED

L. J. Cunningham, B.Sc., P.Eng.

PROPERTY ACME GAS & OIL CO., LIMITED
 Claim 138818 300' South & 50' East of #4 Post
 LOCATION: L. 70E
 LATITUDE: 7N STRIKE: N 19°E
 DEPARTURE: _____ DIP: Collar -55°
 ELEVATION: _____ DATE DRILLED: _____ CLAIM _____

HOLE No. 68 A 7
 PAGE No. 1

PURPOSE: To test R/A near Basement Contact

FOOTAGE	DESCRIPTION	SAMPLE NO.	WIDTH	ASSAY VALUE
0- 28	CASING			
28- 44	Metasediment - dark grey black possibly tuff or metavolcanic sheared - 40°/core.			
41- 44	Fault zone @ 45°/core - soft sheared Qtz. introduced.			
44- 56	Quartzite - dark grey - bedded 45°/core - in part gritty. R/A = 2 x B.G. 52-3 - Grit approaching conglomerate - 1/4" Qtz. pebble.			
56-195	Meta Sediment - dark grey-black - well bedded - slate-like at 50°/core. Contains minor interbedded Quartzite occ. lighter coloured quartzitic bed - 2" - 6" wide. Occasional section 2" - 6" fine pyrite - chalcopryrite mineralization that is weakly radioactive - 2 x B.G. bedding varying to 45°/core.			
195-214	Quartzite - grey impure - poorly bedded 45°/core R/A = 2 x B.G.			
214-374	Metavolcanic - dark grey - no structure. 240-265 - Sections of introduced Quartz-calcite 1" - 6" wide - 45°/core.			
374-396	Metasediment - well bedded - mixture of beds 4" - 6" wide @ 60-80°/core of Quartzite, greywacke - slate R/A. R/A = 2-4 x B.G. T1 = 4,000. B.G. - 1,000			
396-	Quartzite - 396-401 - reddish - fine grained 401-414 - grey to green gritty 395-398 - R/A to T1 - 7,500 - 6 x B.G. 398 - 414 - R/A to T1 - 3,500 - 3 x B.G. 414-			

DRILLED BY Bradley Bros. Limited

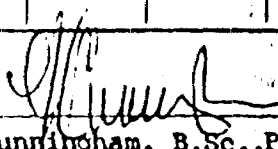
SIGNED 
 L. J. Cunningham, B.Sc., P. Eng.

PROPERTY Acme Gas & Oil Limited

HOLE No. 68A-7

LOCATION: L 70 E
 LATITUDE: 7 N
 DEPARTURE: _____
 ELEVATION: _____

STRIKE: N 19° E
 DIP: Collar - 55°
 DATE DRILLED: October, 1968

PAGE No. 1

PURPOSE: To test R/A near basement contact

FOOTAGE	DESCRIPTION	SAMPLE NO.	WIDTH	ASSAY VALUE
0 - 28	CASING			
28 - 44	METASEDIMENT - dark-grey black possibly buff or meta-volcanic sheared - 40°/core			
41-44	fault zone @ 45°/core soft-sheared-qtz introduced			
44 - 58	QUARTZITE - dark grey bedded 45°/core in part gritty	R/A	2 x B.G.	
52-3	approaching conglomerate 1/4" qtz. pebbles			
56 - 195	META SEDIMENT dark grey black - well bedded - slate-like at 35°/core - contains minor interbedded qtzite occ. lighter coloured quartzitic bed - 2"-6" wide occasional section 2"-6" fine pyrite-chalcopyrite mineralization that is weakly radioactive - 2 x B.G. bedding varying to 45°/core			
195 - 214	QUARTZITE grey-impure poorly bedded 45°/core	R/A	2 x B.G.	
214 - 374	METAVOLCANIC dark grey no structure			
240-265	sections of introduced qtz-calcite 1"-6" wide - 45°/core			
374 - 396	METASEDIMENT well bedded - mixture of beds 4"-6" wide @ 60-80°/core of quartzite greywacke-slate	R/A	2-4 x B.G.	Ti=4,000 R.G. 1000
396	QUARTZITE			
396-401	reddish fine grained			
401-414	grey to green gritty			
395-398	R/A to T1 7500 6 x B.G.			
398-414	R/A to T1 3500 3 x B.G.			
396 - 452				
414-424	Impure quartzite - thin bedded - 60°/core	R/A	2 x B.G.	
424-452	Quartzite - grey to flesh coloured gritty occasional pebble	R/A	3 x B.G.	
452 - 558	METAVOLCANIC dark massive Basic			
558 - 620	GRANITIC GRIT grey - mottley coloured with narrow 4" - 12" sections of intruded granite pink fresh appearance			
620 - 637	Around 620 grading in a few feet to fine grained black to grey metasediment soft slaty bedded - 60°/core contains scattered blue quartz eyes			
637 - 650	Grading into metavolcanic grey-green coarse crystalline rock			
650 - 682	METAVOLCANIC fine grained dark green massive no bedding			
682 - 710	METAVOLCANIC coarse recrystallized grey to green			
710	END OF HOLE			
		SAMPLES: 395-399	2767	4'
		399-404	2768	5'
		404-409	2889	5'
		409-414	2770	5'
	TESTS: Collar 55°			
	250 52° - N 12° E			
	500 44° N 9° E			
	710 41° N 7° E			

DRILLED BY Bradley Diamond Drilling

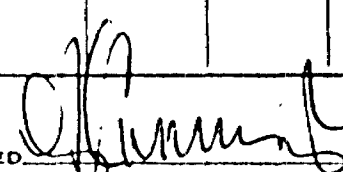
SIGNED 
 L. J. Cunningham, B.Sc., P.Eng.

PROPERTY Acme Gas & Oil Limited

Claim 138818

HOLE NO. A-7

LOCATION: _____

LATITUDE: _____

DEPARTURE: _____

ELEVATION: _____

STRIKE: _____

DIP: _____

DATE DRILLED: April, 1969

PAGE No. 2

PURPOSE: hole deepened

FOOTAGE	DESCRIPTION	SAMPLE NO.	WIDTH	ASSAY VALUE
710	deepened April			
710 - 752	METAVOLCANIC - coarse grained crystalline There exists a suggestion of bedding or shearing 45° - 60° /core - may be regolithic material - in places appears to contain partially xxxx destroyed fragments of a granitic rock			
752 - 758	METASEDIMENT? fine grained, grey-green, uniform rock may be tuff bed Contacts suggest sedimentary origin			
758 - 765	METAVOLCANIC as above			
765 - 780	shows distinct banding which appears to be bedding and altered granitic fragments in a highly altered agglomeration - regolithic material?			
780 - 905	METAVOLCANIC AS above except 803-804, - Pink granitic dike or large fragment and numerous 1"-6" patches thought to be fragments of granitic between 808-875. 891-893 & 903-905 - unmistakably sedimentary, thin bedded, dark, fine grained metasediment - 60° /core			
905 - 906	Granite fragment?			
906 - 931	METASEDIMENT in part distinct thin bedded, dark sediment - 60° /core and part massive grey-green			
931 - 946	GRANITIC ROCK may be intrusive but thought to be altered agglomerate			
946 - 962	METASEDIMENT? dark, grey-green, uniform, fine grained basic rock with a suggestion of bedding			
962 - 977	METASEDIMENT distinct sedimentary rock, dark, thin bedded - 60° - 70° /core possibly a greywacke - minor amount of fine crystalline pyrite			
977 - 981	GRANITIC ROCK could be intrusive or a granite derived agglomerate coarse grained pinkish			
981 - 997	METASEDIMENT as above			
997 - 1013	GRANITIC ROCK may be intrusive or a granite derived agglomerate coarse grained pink coloured			
1013	END OF HOLE			

TEST @ 1000' - 39° - N 9° E

DRILLED BY Bradley Bros. Limited

SIGNED

L. J. Cunningham
L. J. Cunningham, B.Sc., P.Eng.

PROPERTY: ACME GAS & OIL LIMITED

11 Con. IV, Drury Twp.

LOCATION: 350' South & 1075' east of #4 post - 139132

HOLE NO. 68-A-1

LATITUDE: 1. 11 + 00S

STRIKE: N 19°/E

PAGE NO. 1

DEPARTURE: 1. 55 + 00E

DIP: -45°

ELEVATION:

DATE DRILLED: 19-23 January, 1969

PURPOSE: To test below surface showing.

FOOTAGE	DESCRIPTION	SAMPLE NO.	WIDTH
0 - 8	CASING		
8 - 80	METAPELITE - grey to black, thin bedded - 40°/core crumpling of beds around 63 ft.		
80 - 114	GREYWACKE, grey, gradational change to more massive beds - bedding indistinct		
114 - 273	GRADING into QUARTZITE - white to grey colour includes occasional narrow 6" - 12" silty argillaceous section bedding 40° - 45°/core		
268 - 273	Greenish coloured - sericitic sheared - gritty weak radioactive - narrow sections give 2 x B.G.		
273 - 280	METAPELITE - soft black some crumpling thin seams of pyrite		
	268-270	150	2.0
	270-273	151	3.0
280 - 298	Mixture of Quartzite & metapelite		
284 - 285	Radioactive mineralized quartz-pebble conglomerate dark	152	1.0
285 - 287	Radioactive quartzite dark green	153	2.0
298 - 308	Metapelite - black, soft argillaceous		
308 - 310	QUARTZITE		
310 - 353	METAPELITE black to grey soft argillaceous		
353	END OF HOLE		

Sh. 1/4 N. 1/4 Lot 11
Con. IV Drury Twp.

PROPERTY Acme Gas & Oil Limited

LOCATION: 350' south & 1075' east of #4 Post - 139132

HOLE No. 69-A-13

LATITUDE: L 11 + 00 S

STRIKE: N 19° E

PAGE No. 1

DEPARTURE: L 55 + 00 E

DIP: - 45°

ELEVATION: _____

DATE DRILLED: 19 - 23 January, 1969

PURPOSE: To test below surface showing

FOOTAGE	DESCRIPTION	SAMPLE NO.	WIDTH	ASSAY VALUE
0 - 8	CASING			
8 - 80	METAPELITE - grey to black, thin bedded - 40°/core crumpling of beds around 63 ft.			
80 - 114	GREYWACKE, grey, gradational change to more massive beds - bedding indistinct			
114 - 273	GRADING into QUARTZITE - white to grey colour includes occasional narrow 6" - 12" silty argillaceous section bedding 40° - 45°/core			
268 - 273	Greenish coloured - sericitic sheared - gritty weak radioactive - narrow sections give 2 x B.G.			
273 - 280	METAPELITE - soft black some crumpling thin seams of pyrite			
	268-270	150	2.0	Tr
	270-273	151	3.0	Tr
280 - 298	Mixture of Quartzite & metapelite			
284 - 285	Radioactive mineralized quartz-pebble conglomerate dark	152	1.0	.06
285 - 287	Radioactive quartzite dark green	153	2.0	Tr
298 - 308	Metapelite - black, soft argillaceous			
308 - 310	QUARTZITE			
310 - 353	METAPELITE black to grey soft argillaceous			
353	END OF HOLE			

This section previously filed Feb. 25/69. - Rept. of Work.

DRILLED BY Bradley Bros.

SIGNED 

PROPERTY Acme Gas & Oil Limited

HOLE NO. 69-A-13

LOCATION: _____

LATITUDE: _____

DEPARTURE: _____

ELEVATION: _____

Tests

STRIKE: 800' Az 23 (Mag) - 33°

DIP: _____

DATE DRILLED: 1000 Az 24 (Mag) 23°
1500 24 30' 18'

PAGE NO. 2

12 March, 1969

PURPOSE: _____

FOOTAGE	DESCRIPTION	SAMPLE NO.	WIDTH	ASSAY VALUE
	Hole deepened 12 Mar/69			
353 - 355	Gritty QUARTZITE grey			
355 - 357	ARGILLITE			
357 - 389	QUARTZITE grey generally massive occasional bedding plane 60°/core			
389 - 413	ARGILLITE dark thin bedded 60° - 70°/core			
413 - 455	QUARTZITE gradational contact dark grey uniform massive			
455 - 510	Mixture - interbedded QUARTZITE & ARGILLITE Argillite thin bedded 50-60°/core Quartzite - more massive some Argillite beds are schisted			
510 - 515	METAVOLCANIC? fine grained - greenish-maybe dike or flow			
515-540	GREYWACKE banded light to grey bedding - 60°/core			
540 - 546	QUARTZITE grey in part greenish sericitic			
546 - 551	ARGILLITE sharp contact very soft grey-green grading into GREYWACKE at 549 to 551			
551 - 569	Repeated sequence of ARGILLITE grading into GREYWACKE very few feet - approx 12 in number veins of irregular calcite introduced along bedding - possible faulting?			
569 - 571	QUARTZITE grey gritty			
571 - 583	ARGILLITE for 2.3 feet grading into QUARTZITE grey and into impure quartzite			
583 - 586.10	QUARTZITE predominantly with minor amount of ARGILLITE			
	591 - 1 ft. vein quartz white			
610 - 615	ARGILLITE predominantly with some GREYWACKE & QUARTZITE occasional local spot of low radioactivity			
	614-615 Low radioactivity	100169	1.0	
	615.5 4" Qtz-pebble conglomerate greyish colour			
615.5-619.5	CONGLOMERATE Qtz. pebbles in argillaceous matrix and Qtz. fragments			
617.5-622	GREYWACKE grading into QUARTZITE			
622 - 635	QUARTZITE grey uniform weakly sericitic			
635 - 728	ARGILLITE soft-grey-green sharp contact thin bedded - 60°/core occasional bedded schisted occasional 1/2" bed of impure quartzite			
	709 1' quartzite			
	712-715 3' "			
	726-728 2' "			
728 - 761	QUARTZITE - grey - with minor ARGILLITE interbedded			
	733.5-737.5 quartzite with few pebbles and small amount ± 1% fine pyrite & chalcopryrite radioactive 2-3 x B.G.	100170	4.0	
	739-742 Quartzite occasional pebbles and ± 1% pyrite & chalcopryrite R/A 2 x B.G.	100171	3.0	
761 - 851	ARGILLITE black thin bedded 50-60°/core with repeated narrow interbeds of greywacke			
851 - 939	METAVOLCANIC grey green - highly altered uniform massive flow or tuff contains scattered vein quartz 1"-4" wide			
939 - 953	ARGILLITE black soft bedded 60°/core			

DRILLED BY Bradley Bros.

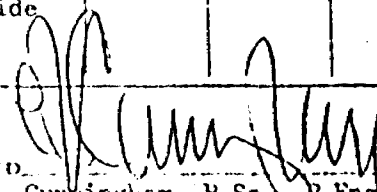
SIGNED 
L. J. Cunningham, B.Sc., P.Eng.
Mining Engineer

PROPERTY Acme Gas & Oil Limited

HOLE No. 69-A13

LOCATION: _____

LATITUDE: _____

DEPARTURE: _____

ELEVATION: _____

STRIKE: _____

DIP: _____

DATE DRILLED: _____

PAGE No. 3

PURPOSE: _____

FOOTAGE	DESCRIPTION	SAMPLE NO.	WIDTH	ASSAY VALUE
953-1008	QUARTZITE grey generally massive uniform with some Argillite 967-974 975-1005 Spotty low radioactivity 2-3 x B.G. no pebbles noted and only sparse pyrite 979-983 1004-1005	100172 100173	4.0 1.0	
1008-1053	Mixture of thin bedded argillite & greywacke with rare narrow interbed of quartzite - 60°/core 1051 6" grit pebble to 1/4"			
1053-1082	QUARTZITE gradational contact - dark grey			
1082-1103	Mixture thin bedded ARGILLITE greywacke & quartzite - 60°/core			
1103-1121	QUARTZITE grey 1112-1115 and 1112-1121 xxx sercitic loose small qtz. pebbles no sulphides no radioactivity spot of radioactivity at 1121			
1121-1155	ARGILLITE dark bedded 70°/core in sections sheared			
1155-1195	QUARTZITE sharp contact interbedded with ARGILLITE and GREYWACKE few pebbles to 2" dia. in argillite at 1167			
1195-1222	QUARTZITE greenish sercitic low spotty radioactivity 1210-1212	100174	2.0	
1222-1372	1349 ARGILLITE thin bedded 60°-90°/core some crumpling			
1372-1384	QUARTZITE gritty-greenish-sercitic bedded 70°-80°/core weakly			R?a 2 x B.G.
1384-1420	ARGILLITE thin bedded black - 70°-80°			
1420-1433	Gradational change to impure QUARTZITE weakly R/A 2 x B.G. gritty with occasional pea sized pebble			
1433-1465	ARGILLITE black-thin bedded 70°-80°/core			
1465-1523	Gradational change to impure quartzites (GREYWACKE) gritty with occ. small pebbles as above R/A 2 x B.G. 1523 last few feet grit is coarser and more plentiful pea size			
1523-1713	1515-1520 2 - 6" metavolcanic dike or flow? green crystalline ARGILLITE black thin bedded 70-80°/core interbedded with narrow beds of grey greywacke grading from thin bedded argillite to more massive greywacke to impure quartzite NOTE: Box 1563-1603 40' must be round core 1603-1632 29' " " 1632-1663 31' " 1663-1713 50' Around 1660 grading into quartzite fine grained dense black bedded 70-80°/core Tropari Test (A13) 1500 Dip 18° - 21°, 30' (Mag)			

DRILLED BY Bradley Bros.

SIGNED

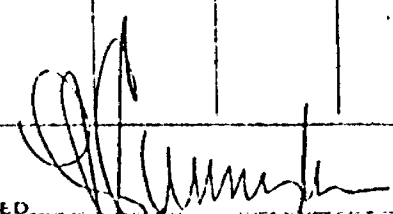
L. J. Cunningham, B.Sc., P. Eng.

PROPERTY Acme Gas & Oil Limited

HOLE No. 69 - A13

LOCATION: _____

LATITUDE: _____

DEPARTURE: _____

ELEVATION: _____

STRIKE: _____

DIP: _____

DATE DRILLED: _____

PAGE No. 4

PURPOSE: _____

FOOTAGE	DESCRIPTION	SAMPLE NO.	WIDTH	ASSAY VALUE
	Hole deepened in April, 1969			
1713 - 1807	QUARTZITE grey, uniform, poorly bedded 70° - 80°/core			
1807 *	END OF HOLE			

DRILLED BY: _____

SIGNED: *[Signature]*

Rec. in Sudbury
Res. Dept. Office
Apr. 19/71



A separate form is required for each type of work to be recorded.

THE MINING ACT REPORT OF WORK

To the Recorder of Sudbury Mining Division
I, Acme Gas & Oil Co., Limited name of Recorded Holder
Suite 401 - 80 Richmond St. West, Toronto, Ontario Post Office Address
do hereby report the performance of 66 436 days of Diamond Drilling type of work
not before reported to be applied on the following contiguous claims

Claim No.	Days	Claim No.	Days	Claim No.	Days
S-138814	21	139126	1		
S-138842	1				
S-139404	1				
S-139407	1				
S-140891	40				
S-140894	28				

All the work was performed on Mining Claim (s) S-139126 (i.e. S-139400) Diamond Drilling
(In the case of geological and/or geophysical survey (s) where more than 18 claims are involved attach a schedule)

READ CAREFULLY: THE FOLLOWING INFORMATION IS REQUIRED BY THE MINING RECORDER.

- For Annual Work, Stripping or Opening up of Mines, Sinking Shafts or Other Actual Mining Operations - Names and addresses of the men who performed the work and the dates and hours of their employment.
- For Diamond and other Core Drilling - Passage, No. and angle of holes and diameter of core. Name and address of owner or operator of drill. Dates when drilling was done. Signed core tag and sheets - duplicate.
- For Compressed Air or Other Power Driven or Mechanical Equipment - Type of drill or equipment. Names and addresses of men engaged in operating equipment and the dates and hours of their employment.
- For Power Stripping - Type of equipment. Name and address of owner or operator. Amount expended. Dates on which work was done. Proof of actual cost must be submitted within 30 days of recording.
- With each of the above types of work sketches are required to show the location and extent of the work in relation to the nearest claim post. In the case of diamond or other core drilling the sketch must be submitted in duplicate.
- For Geological and Geophysical Survey - The names and addresses of men employed as well as dates. Type of instrument used in the case of geophysical survey. Reports and maps in duplicate must be filed with the Minister within 60 days of recording.
- For Land Survey - the name and address of Ontario Land surveyor.

The Required Information is as Follows: (Attach a list if this space is insufficient)
Diamond Driller Owner: Bradley Bros. Ltd., P.O. Box 367, Noranda, Que.
Hole No. 69-A-6 (Extension of 68-A-6) Total footage 954 feet
Footage 6'-538' drilled Oct. 1-5/68 (Filed and distributed - Feb. 25/69)
Footage 538'-954' drilled April-May, 1966 = 416 feet.
Angle: 55°
Diameter of Core: AXT

NOTE: 350 days to be distributed at a later date.

Date March 5, 1971
E. A. Jagulski
Signature of Recorded Holder or Agent

The Mining Act
Certificate Verifying Report of Work

I, E. A. Jagulski
Suite 401 - 80 Richmond St. West, Toronto, Ontario
(Post Office Address)

hereby certify:
1. That I have a personal and intimate knowledge of the facts set forth in this report of work annexed hereto, having performed the work or witnessed same during and/or after its completion.
2. That the annexed report is true.

Dated March 5, 1971
E. A. Jagulski
Signature

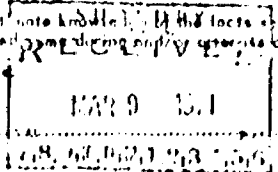

THE PENALTY FOR MAKING A FALSE STATEMENT IN THIS REPORT AND/OR CERTIFICATE IS \$500. OR SIX MONTHS IMPRISONMENT OR BOTH.



900

in his last office

Apr. 19/71

15



ONTARIO

THE MINING ACT REPORT OF WORK

A separate form is required for each type of work to be recorded.

To the Recorder of... Sudbury... Mining Division
I, Acme Gas & Oil Co., Limited... A-37770
Suite 401 - 80 Richmond St. West, Toronto, Ontario... Miner's Licence
do hereby report the performance of... 28 days of... Diamond Drilling... type of work

not before reported to be applied on the following contiguous claims

Table with 6 columns: Claim No., Days, Claim No., Days, Claim No., Days. Contains entries for claims S-138822, S-138823, S-139129, S-139130, S-139131, S-140378.

All the work was performed on Mining Claim (s) S-139132... (In the case of geological and/or geophysical survey (s) where more than 18 claims are involved attach a schedule)

READ CAREFULLY: THE FOLLOWING INFORMATION IS REQUIRED BY THE MINING RECORDER.

- For Manual Work, Stripping or Opening up of Mines, Sinking Shafts or Other Actual Mining Operations - Names and addresses of the men who performed the work and the dates and hours of their employment
For Diamond and other Core Drilling - Footage, No. and angle of holes and diameter of core, name and address of owner or operator of drill, Dates when drilling was done, Signed core log and sketch in duplicate
For Compressed Air or Other Power Driven or Mechanical Equipment
Type of drill or equipment, Names and addresses of men engaged in operating equipment and the dates and hours of their employment.
For Power Stripping - Type of equipment, Name and address of owner or operator, Amount expended, Dates on which work was done. Proof of actual cost must be submitted within 30 days of recording.
With each of the above types of work sketches are required to show the location and extent of the work in relation to the nearest claim post. In the case of diamond or other core the sketch must be submitted in duplicate.
For Geological and Geophysical Survey - The names and addresses of men employed as well as dates, Type of instrument used in the case of geophysical survey. Reports and maps in duplicate must be filed with the Minister within 60 days of recording.
For Land Survey - the name and address of Ontario Land surveyor.

The Required Information is as follows: (Attach a list if this space is insufficient)

Diamond Driller - Bradley Bros. Ltd., P.O. Box 367, Noranda, Quebec.
Hole No. 69-A-13 (Extension of 68-A-13) Total footage 1,807 feet
Footage 0'-353' drilled Jan.19-23, 1969 (Filed & distributed Feb.25/69)
353'-1,807' completed March 12, 1969 = 1,454 feet
Angle: 45°
Diameter of Core: AXT
NOTE: 1,174 days to be distributed at a later date.

Date March 5, 1971 Signature of Recorded Holder or Ag

The Mining Act Certificate Verifying Report of Work

I, E. A. Pigulski Suite 401 - 80 Richmond St. West, Toronto, Ontario (Post Office Address)

hereby certify:

- 1. That I have a personal and intimate knowledge of the facts set forth in the report of work and, having performed the work or witnessed its completion.
2. That the annexed report is true

Dated March 5, 1971 Signature

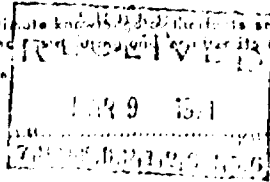

MAKING A FALSE STATEMENT IN THIS REPORT AND/OR CERTIFICATE IS \$500. OR SIX MONTHS IMPRISONMENT OR BOTH

REPLACEMENT COPY



ONTARIO

THE MINING ACT REPORT OF WORK

A separate form is required for each type of work to be recorded.

To the Recorder of Sudbury Mining Division
 I, Acma Gas & Oil Company Ltd. A-37770
 name of Recorded Holder Miner's Licence
Suite 401 - 80 Richmond Street West, Toronto, Ont
 Post Office Address
 do hereby report the performance of 1080 days of Diamond drilling
 type of work

not before reported to be applied on the following contiguous claims

Claim No.	Days	Claim No.	Days	Claim No.	Days
S-135353	60	S-137426	60	S-138836	60
S-136371	60	S-136377	60	S-138837	60
S-136372	60	S-136378	60	S-138838	60
S-137423	60	S-137622	60	S-138839	60
S-137424	60	S-137623	60	S-138840	60
S-137425	60	S-137685	60	S-138841	60

All the work was performed on Mining Claim (s) S-138818, 139176, 139440, 139407 Drury
 (In the case of geological and/or geophysical survey (s) where more than 18 claims are involved attach a schedule)

READ CAREFULLY: THE FOLLOWING INFORMATION IS REQUIRED BY THE MINING RECORDER.

- For Manual Work, Stripping or Opening up of Mines, Sinking Shafts or Other Actual Mining Operations - Names and addresses of the men who performed the work and the dates and hours of their employment.
- For Diamond and other Core Drilling - Footage, No. and angle of holes and diameter of core. Name and address of owner or operator of drill. Dates when drilling was done. Signed core log and sketch in duplicate.
- For Compressed Air or Other Power Driven or Mechanical Equipment - Type of drill or equipment. Names and addresses of men engaged in operating equipment and the dates and hours of their employment.
- For Power Stripping - Type of equipment. Name and address of owner or operator. Amount expended. Dates on which work was done. Proof of actual cost must be submitted within 30 days of recording.
- With each of the above types of work sketches are required to show the location and extent of the work in relation to the nearest claim post. In the case of diamond or other core drilling the sketch must be submitted in duplicate.
- For Geophysical, Geological, Geochemical Surveys and Expenditure Credits - the name of author of report. Covering dates of survey (linecutting & office). Type of instrument used. Total amount of expenditure. Technical reports, maps, expenditure breakdown, receipts must be filed in duplicate with the Minister within 60 days of recording.
- For Land Survey - the name and address of Ontario Land surveyor.

The Required Information is as Follows: (Attach a list if this space is insufficient)

Diamond driller - Bradley Bros. Ltd. P.O. Box 367, Noranda, Quebec
 Hole No. 69-A-6 (Extension) see reports of work dated Mar. 5/71
- 109 days to be distributed - 42 = 61

Hole No. 68-A-7 1013 ft.
 Date drilled Oct. 9/68 and Apr. 69

Note : there will still be 42 days left for distribution at a later date

Date July 27, 1971
 Signature of Recorded Holder or Agent

The Mining Act
 Certificate Verifying Report of Work

I, E. A. Pigulski
 Suite 401 - 80 Richmond St. West, Toronto, Ont
 (Post Office Address)

hereby certify:

- That I have a personal and intimate knowledge of the facts set forth in the report of work annexed here- to, having performed the work or witnessed same during and/or after its completion.
- That the annexed report is true.

Dated July 27, 1971
 Signature

THE PENALTY FOR MAKING A FALSE STATEMENT IN THIS REPORT AND/OR CERTIFICATE IS \$500. OR SIX MONTHS IMPRISONMENT OR BOTH

RECEIVED COPY



ONTARIO

THE MINING ACT REPORT OF WORK

A separate form is required for each type of work to be recorded.

To the Recorder of Sudbury Mining Division
Acme Gas & Oil Co. Ltd. A-37770
 I, Suite 1401-80 Richmond St. West, Toronto, ONT Miner's Licence
 name of Recorded Holder
Post Office Address
 do hereby report the performance of 240 days of Diamond drilling
 type of work
 not before reported to be applied on the following contiguous claims

Claim No.	Days	Claim No.	Days	Claim No.	Days
S-134888	60
S 134889	60
S 134890	60
S 134891	60
.....
.....

All the work was performed on Mining Claim (s) S-139126(nil) S-139440 (240 days)Drury
 (In the case of geological and/or geophysical survey (s) where more than 18 claims are involved attach a schedule)

READ CAREFULLY: THE FOLLOWING INFORMATION IS REQUIRED BY THE MINING RECORDER.

- For Manual Work, Stripping or Opening up of Mines, Sinking Shafts or Other Actual Mining Operations - Names and addresses of the men who performed the work and the dates and hours of their employment.
- For Diamond and other Core Drilling - Footage, No. and angle of holes and diameter of core. Name and address of owner or operator of drill. Dates when drilling was done. Signed core log and sketch in duplicate.
- For Compressed Air or Other Power Driven or Mechanical Equipment
 Type of drill or equipment. Names and addresses of men engaged in operating equipment and the dates and hours of their employment.
- For Power Stripping - Type of equipment. Name and address of owner or operator. Amount expended. Dates on which work was done. Proof of actual cost must be submitted within 30 days of recording.
- With each of the above types of work sketches are required to show the location and extent of the work in relation to the nearest claim post. In the case of diamond or other core drilling the sketch must be submitted in duplicate.
- For Geophysical, Geological, Geochemical Surveys and Expenditure Credits - the name of author of report. Covering dates of survey (linecutting & office). Type of instrument used. Total amount of expenditure. Technical reports, maps, expenditure breakdown, receipts must be filed in duplicate with the Minister within 60 days of recording
- For Land Survey - the name and address of Ontario Land surveyor.

The Required Information is as Follows: (Attach a list if this space is insufficient)

Diamond driller - Bradley Bros. Ltd. P.O.Box 367, Noranda, Quebec
 Hole NO.69-A-6 (Extension 68-A-6) Total footage 954 feet
 See report of work dated March 5, 1971 for 349 days to be distributed.
 Note : after the above work is recorded, there will be 109 days to be distributed at a later date.

Date June 5, 1971
 Signature of Recorded Holder or Agent

The Mining Act
 Certificate Verifying Report of Work

I, E. A. Pigluski
Suite 401 - 80 Richmond St. West, Toronto, ONY
 (Post Office Address)

hereby certify:

- That I have a personal and intimate knowledge of the facts set forth in the report of work annexed hereto, having performed the work or witnessed same during and/or after its completion.
- That the annexed report is true.

Dated Nov. 1st 19 71
 Signature

THE PENALTY FOR MAKING A FALSE STATEMENT IN THIS REPORT AND/OR CERTIFICATE IS \$500. OR SIX MONTHS IMPRISONMENT OR BOTH

THE PENALTY FOR MAKING A FALSE STATEMENT IN THIS REPORT AND/OR CERTIFICATE IS \$500. OR SIX MONTHS IMPRISONMENT OR BOTH

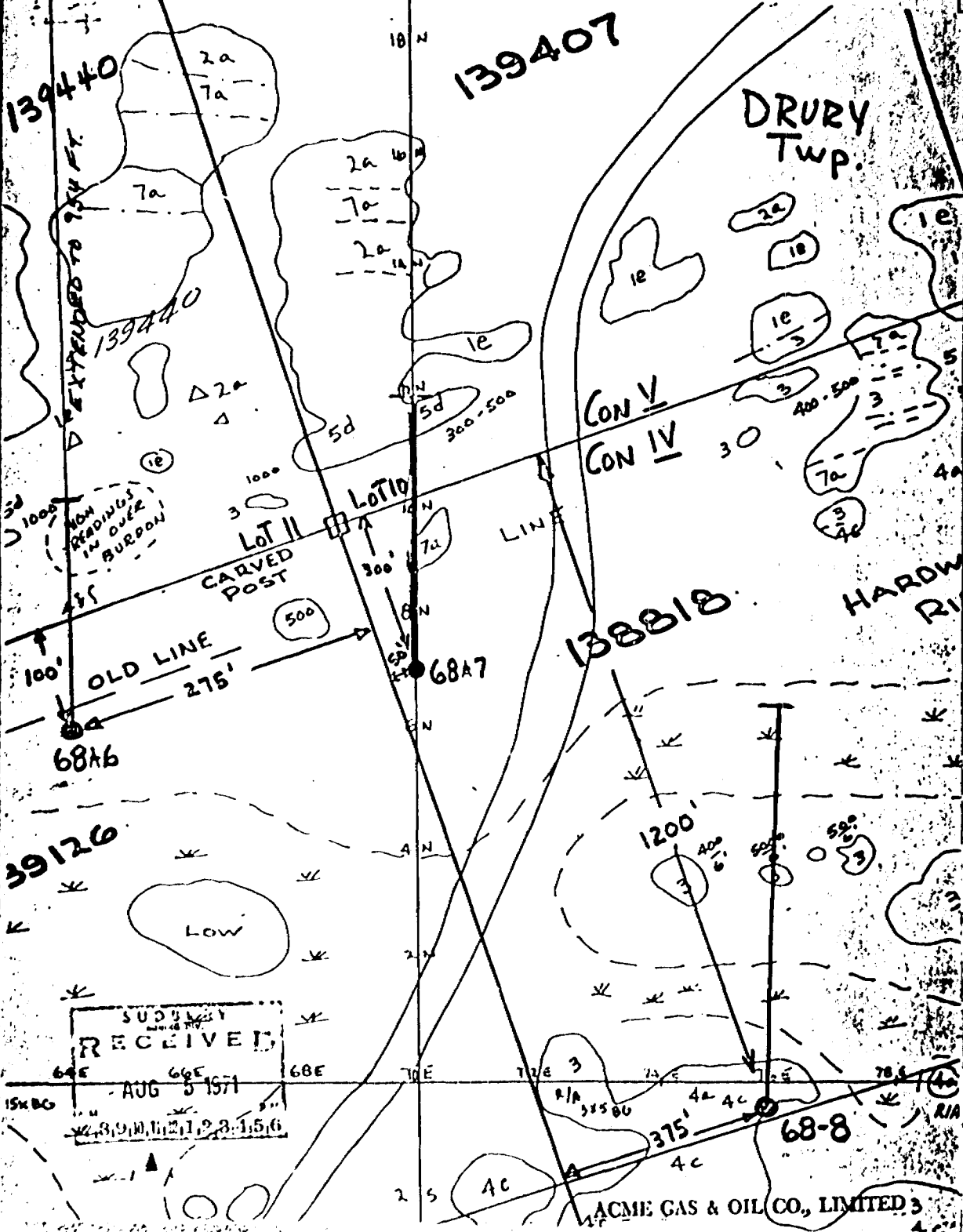

139440

139407

DRURY TWP.

CON V
CON IV

HARDW R

138818

39126

SURVEY RECEIVED
AUG 5 1971
15X80
3, 9, 10, 11, 21, 23, 15, 6

ACME GAS & OIL CO., LIMITED

68A6

68A7

68-8

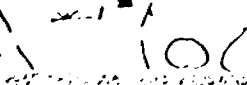
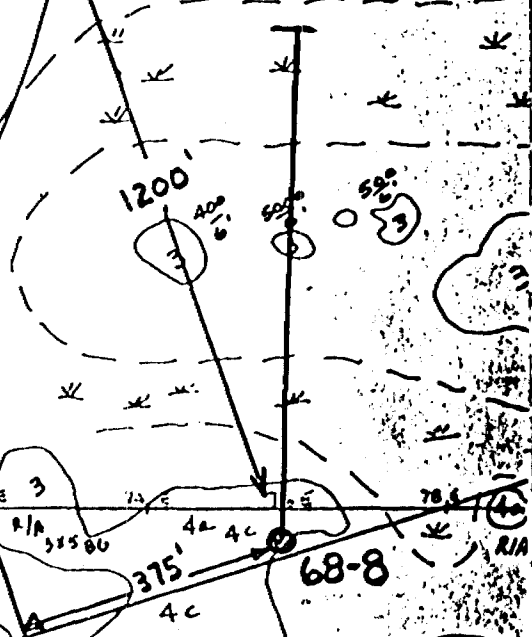
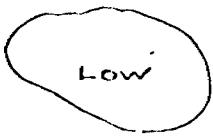
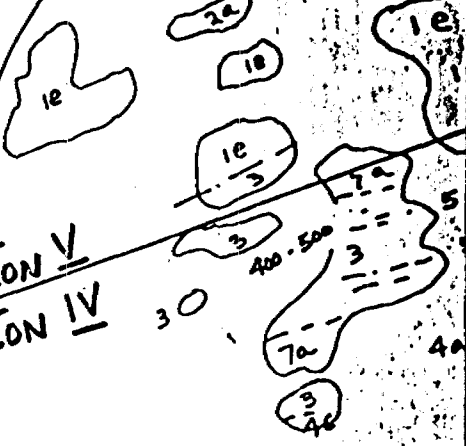
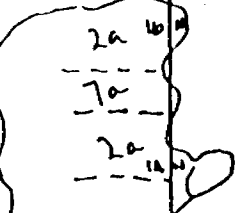
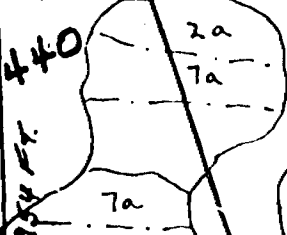

S. 139416

S. 139132

S. 139127

S. 139131

S. 139133

ACME GAS & OIL CO., LIMITED

DRURY TWP.

68-13

350'

1075'

EXTENDED EXTENSION TO 1,807 FT. 1937

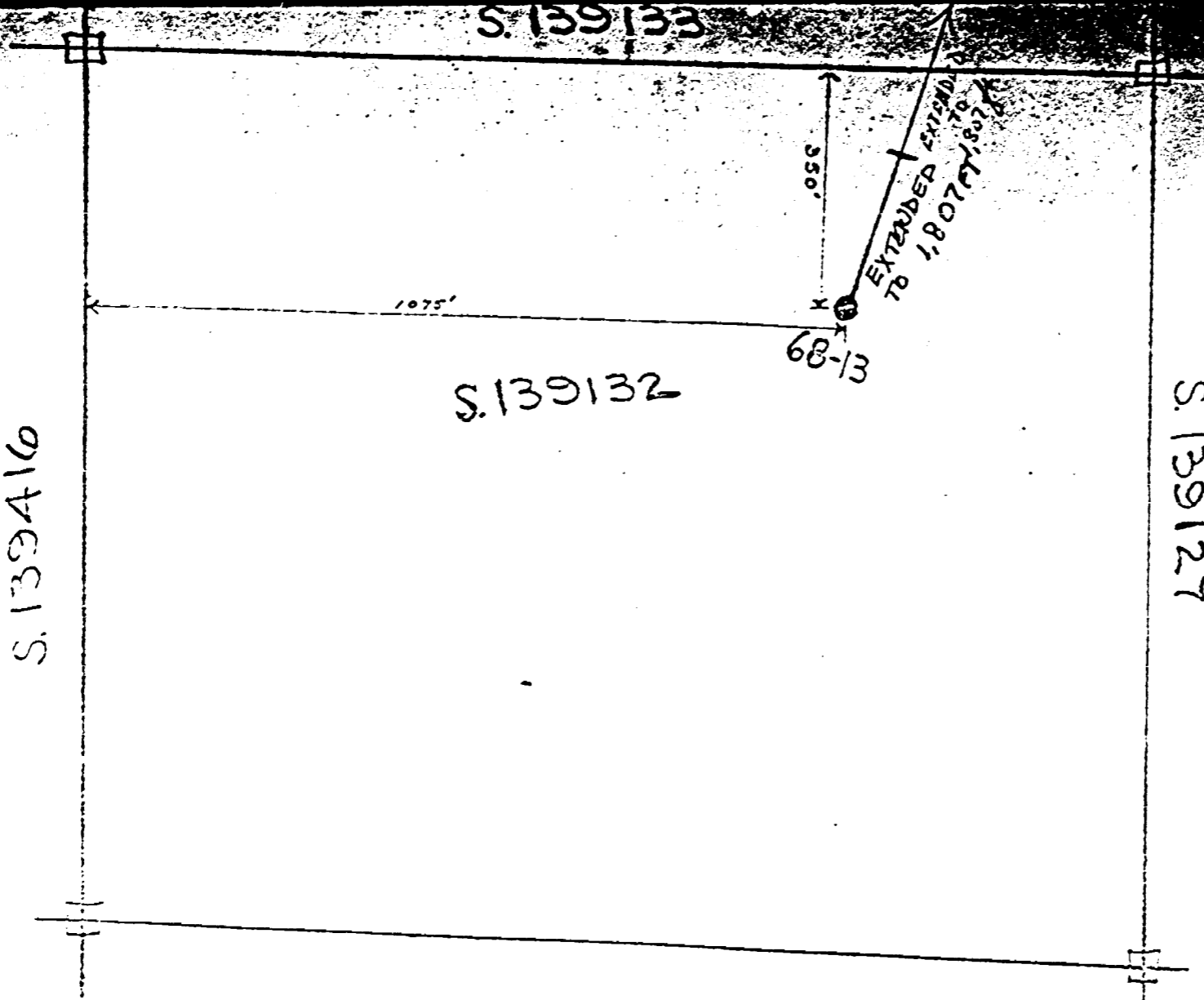

THE TOWNSHIP
OF
DRURY
DISTRICT OF SUDBURY
SUDBURY MINING
DIVISION

SCALE 1 INCH TO 40 CHAINS

HYMAN TWP. 945

