



41105NE0041 001581 DRURY

010

### Diamond Drilling

Township of Drury

Report No: 13

Work performed by: Wm. Alanen-Garrison Harbour Gold Mines

Claim No	Hole No	Footage	Date	Note
S 79107	1	56'	Aug/55	
S 79108	2	52'	Aug/55	
	3	58'	Aug/55	
	4	38'	Aug/55	
	5	58'	Aug/55	
S 79276	6	60'	Aug/55	
<u>Garrison Harbour Gold Mines Ltd.</u>				
S 79107	3	649'	Apr/56	

TOTAL

7 DH 971 FT

Notes:

# DIAMOND DRILL RECORD

Hole No. 1 Sheet No. 1

Property S 79107  
 Location SOUTH WEST 1/4 of the SOUTH 1/2  
of Lot 6, Concession V  
DRURY TWP  
 Latitude \_\_\_\_\_  
 Departure \_\_\_\_\_  
 Bearing S 70° E

Dip 45°  
 \_\_\_\_\_  
 \_\_\_\_\_  
 \_\_\_\_\_  
 Total Footage 56.0'

Elev. Collar \_\_\_\_\_  
 Datum \_\_\_\_\_  
 Date Started AUG. 8, 1955  
 Date Completed AUG. 10, 1955  
 Drilled by Wm. ALLARDEN  
 Logged by J. P. Mc GREGOR

Footage		Formation	Sample Number	Sample Footage	Sample Width	Gold Sample	Gold Sludge	Remarks
From	To							
0.0		<u>Collar</u>						
0.0	27.0	<u>Quartzite, blocky, locally numerous iron stained fractures, few small silic stringers at various angles, fine grained, very rare small speck sulfide pyrite &amp; pyrrhotite</u>						
27.0	33.0	<u>Quartzite, blocky, relatively coarse grained, sulfide very rare</u>						
33.0	56.0	<u>Quartzite, as entry to 27.0</u>						
56.0		<u>END OF HOLE</u>						

Date of Examination SEPT 12, 1955

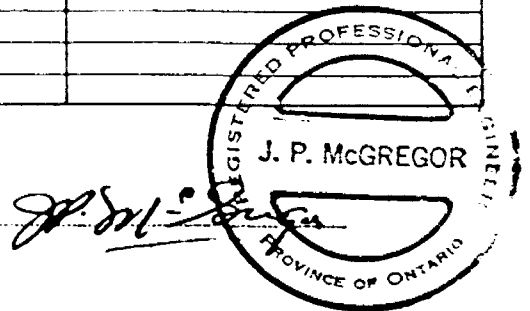

# DIAMOND DRILL RECORD

Hole No. 2 Sheet No. 1

Property 579108  
 Location NORTH West 1/4 of the North 1/2 of  
Lot 6, CONCESSION IV  
DRURY TWP  
 Latitude \_\_\_\_\_  
 Departure \_\_\_\_\_  
 Bearing S 25° W

Dip  
43°  
 \_\_\_\_\_  
 \_\_\_\_\_  
 \_\_\_\_\_  
 Total Footage 52.0'

Elev. Collar \_\_\_\_\_  
 Datum \_\_\_\_\_  
 Date Started AUG. 11, 1955  
 Date Completed AUG. 16, 1955  
 Drilled by Wm. ALLANEN  
 Logged by J. P. MCGREGOR

Footage		Formation	Sample Number	Sample Footage	Sample Width	Gold Sample	Gold Sludge	Remarks
From	To							
0.0		<u>Collar</u>						
0.0	11.0	<u>Quartzite, medium massive to blocky, quite coarse grained with prominent grey salic speckling, sulfide scarce to lacking</u>						
11.0	17.0	<u>Quartzite, as previous entry except shows common small spots pyrrhotite &amp; associated chalcopyrite</u>						
17.0	24.0	<u>Quartzite, much as entry to 11.0 except that becomes progressively finer grain &amp; the prominent salic speckling gradually fades &amp; disappears</u>						
24.0	52.0	<u>Granite, pink, mottled</u>						
52.0		<u>END OF HOLE</u>						

Date of Examination SEPT. 12, 1955

*J.P. McGregor*

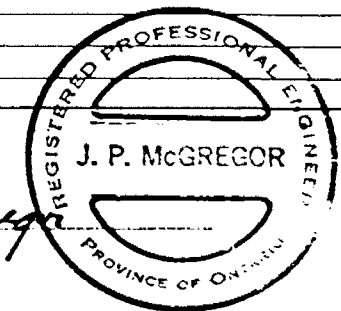

# DIAMOND DRILL RECORD

 Hole No. 2

 Sheet No. 1

 Property S 7910 8  
 Location North West 1/4 of the North 1/2 of  
Lot 6, CONCESSION 12  
DRURY TWP  
 Latitude \_\_\_\_\_  
 Departure \_\_\_\_\_  
 Bearing S 25° N

 Dip 37°  
 Total Footage 58.0'

 Elev. Collar \_\_\_\_\_  
 Datum \_\_\_\_\_  
 Date Started AUG. 18, 1955  
 Date Completed AUG. 19, 1955  
 Drilled by Wm. ALLAMEN  
 Logged by J. P. Mc GREGOR

Footage		Formation	Sample Number	Sample Footage	Sample Width	Gold Sample	Gold Sludge	Remarks
From	To							
0.0	0.0	0.0						
0.0	24.5	Quartzite, medium massive, quite coarse grained with prominent silic speckling, few to locally common small scattered spots & vague black stringers pyrrhotite & minor associated Chalcopyrite, towards end of entry becomes fine grained.						
24.5	58.0	Granite, pink, mottled						
58.0		END OF HOLE.						

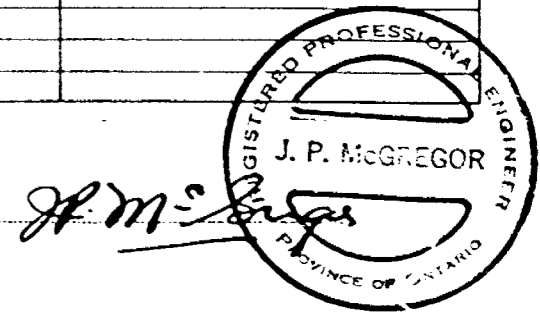
 Date of Examination SEPT. 12, 1955

# DIAMOND DRILL RECORD

 Hole No. 4

 Sheet No. 1

 Property S 79108  
 Location North West 1/4 of the North 1/2 of Lot 6, Concession IV, Drury Twp.

 Latitude \_\_\_\_\_  
 Departure \_\_\_\_\_  
 Bearing N 62° E

Dip
<div style="position: relative; height: 100px;"> <span style="position: absolute; top: 0; left: 50%; transform: translate(-50%, 0);">34°</span> </div>
Total Footage <u>38.0'</u>

 Elev. Collar \_\_\_\_\_  
 Datum \_\_\_\_\_  
 Date Started AUG. 20, 1955  
 Date Completed AUG. 22, 1955  
 Drilled by Wm. ALLARD  
 Logged by J.P. MCGREGOR

Footage		Formation	Sample Number	Sample Footage	Sample Width	Gold Sample	Gold Sludge	Remarks
From	To							
0.0		<u>Collar</u>						
0.0	14.0	<u>Quartzite, mass, coarse grained &amp; prominent silic speckling, vague banding, overall scattered small spots &amp; disseminated areas pyrrhotite &amp; minor associated chokopyrite</u>						
14.0	30.0	<u>Quartzite, as previous entry except sulphide scarce to lacking</u>						
30.0		<u>END OF HOLE</u>						

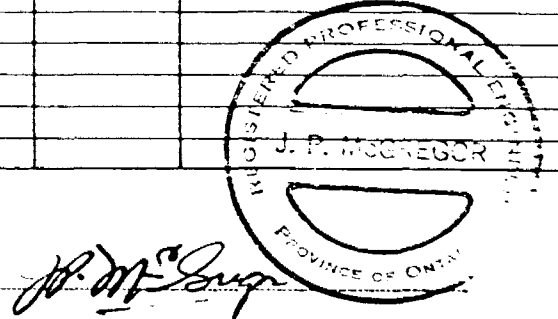
 Date of Examination SEPT. 12, 1955

# DIAMOND DRILL RECORD

Hole No. 5 Sheet No. 1

Property 579108  
 Location North west 1/4 of the North 1/2 of  
lot 6, Concession IV, BRURY TWP.  
 Latitude \_\_\_\_\_  
 Departure \_\_\_\_\_  
 Bearing S. 36° E

Dip  
10°  
 Total Footage 58.0'

Elev. Collar \_\_\_\_\_  
 Datum \_\_\_\_\_  
 Date Started AUG. 23, 1955.  
 Date Completed AUG. 25, 1955.  
 Drilled by Wm. ALLARD  
 Logged by J. P. M. GREGOR

Footage		Formation	Sample Number	Sample Footage	Sample Width	Gold Sample	Gold Sludge	Remarks
From	To							
0.0		Collar						
0.0	7.0	Quartzite, massive, medium grey, scattered small spots pyrrhotite & minor associated chalcopyrite, vague banding 60°						
7.0	17.5	Quartzite, massive, sulfide scarce to lacking, medium grey, vague banding 60°						
17.5	24.0	Quartzite, medium massive to blocky, became finer grain towards contact						
24.0	58.0	Granite, pink, mottled						
58.0		END OF HOLE.						

Date of Examination Sept. 17, 1955.

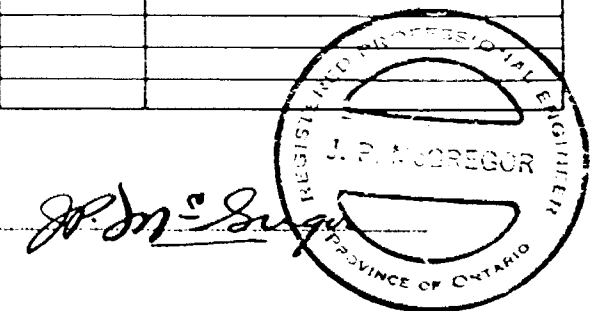

DIAMOND DRILL RECORD

Hole No. 6

Sheet No. 1

Property S 79276  
 Location North east 1/4 of the North 1/2 of  
Lot 7, Concession IV  
DRURY TWP.  
 Latitude \_\_\_\_\_  
 Departure \_\_\_\_\_  
 Bearing \_\_\_\_\_

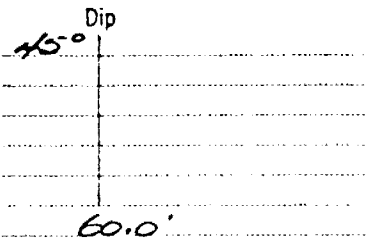

Total Footage 60.0'

Elev. Collar \_\_\_\_\_  
 Datum \_\_\_\_\_  
 Date Started AUG. 26, 1955.  
 Date Completed AUG. 28, 1955.  
 Drilled by Wm. ALANEN  
 Logged by J.P. MCGREGOR

Footage		Formation	Sample Number	Sample Footage	Sample Width	Gold Sample	Gold Sludge	Remarks
From	To							
0.0		<u>Collar</u>						
0.0	60.0	<u>Greenstone, massive, amphibolitic, coarse grained, banded at 45°, locally minor scattered specks pyrrhotite, pyrite, chalcopyrite</u>						
60.0		<u>END OF HOLE</u>						

Date of Examination SEPT 12, 1955.

*[Handwritten signature: J.P. McGregor]*



DIAMOND DRILL RECORD

Property - Garrison Harbour, Drury Township Option

Location: 200 ft. N. #1 Post-79276  
880 ft. E #1 Post -79276  
930

Dip: 45°  
Bearing: S 35°W.

D. D. H. No. 3  
Started: April 18, 1956  
Finished: May 1, 1956  
Depth: 649 ft.

Depth Feet	Remarks
0 - 21	Casing.
21 - 39	Granite gneiss, green, schistosity at 30° to core. Narrow inclusions of fine grained quartz diorite.
39 - 112	Quartz diorite. Fine grained sparsely mineralized with hornblende, pyrite, chalcopyrite and pyrrhotite.
112 - 137	Dark dense rock with almost felsitic texture. Could be altered diabase.
137 - 185	Quartz diorite fine grained as above.
185 - 225	Quartz diorite fine to medium grained. Scattered pink feldspar crystals up to 1/16 in. in diameter. More hornblende and slightly more pyrite, chalcopyrite and pyrrhotite.
225 - 391	Quartz diorite. Coarse grained. Heavily mineralized with hornblende with crystals up to 3/16 in. in diameter. Lightly mineralized with pyrite, pyrrhotite and chalcopyrite. Lost core 257 - 259, 265 - 268.
391 - 394	Diabase fine grained. Black. Contacts sharp but irregular.
394 - 436	Quartz diorite. Fine to medium grained. White feldspar crystals up to 1/8 in. Lightly mineralized with pyrite, chalcopyrite, pyrrhotite. Hornblende substantial but finer grained.
436 - 440	Diabase, as above.
440 - 584	Quartz diorite, fine grained. Mineralized as above. Some irregular fine quartz filled fractures.
584 - 619	Granite. Medium grained, pink.
619 - 626	Quartz diorite. Fine grained.
626 - 632	Granite, as above.
632 - 640	Quartz diorite fine grained.
640 - 649	Granite.

End of Hole.

Note: No core was sent for assay.

N. B. Original hole started on same line at bearing N. 35°E. This encountered 114 ft. of overburden and was discontinued. This hole was collared 500 ft. from D. D. H. No. 1 on above bearing.

*Core is on Lot 5  
Con. 5, Drury*

No core on the property of W. Alanen.

R. N. Sexsmith



6  
 S 79276  
 NE 1/4 N 1/2  
 LOT 7  
 CON 5  
 Hole 60ft X 400 FT FROM POST  
 S.W.  
 POST HOLE

NW 1/4 N 1/2  
 LOT 6 CON 4  
 DRURY TWP.  
 S 79108  
 CREEK 200 FT FROM  
 4 DIAMOND DRILL HOLES 206 FT.  
 (23, 4, 5)

S 79107  
 SW 1/4 S 1/2  
 LOT 6  
 CON 5  
 ①  
 CREEK 200 FT NORTH OF CREEK  
 HOLE 56 FT

Geol.  
 Core stored  
 at Wm. Alamen's  
 home at  
 Worthington, Ont.

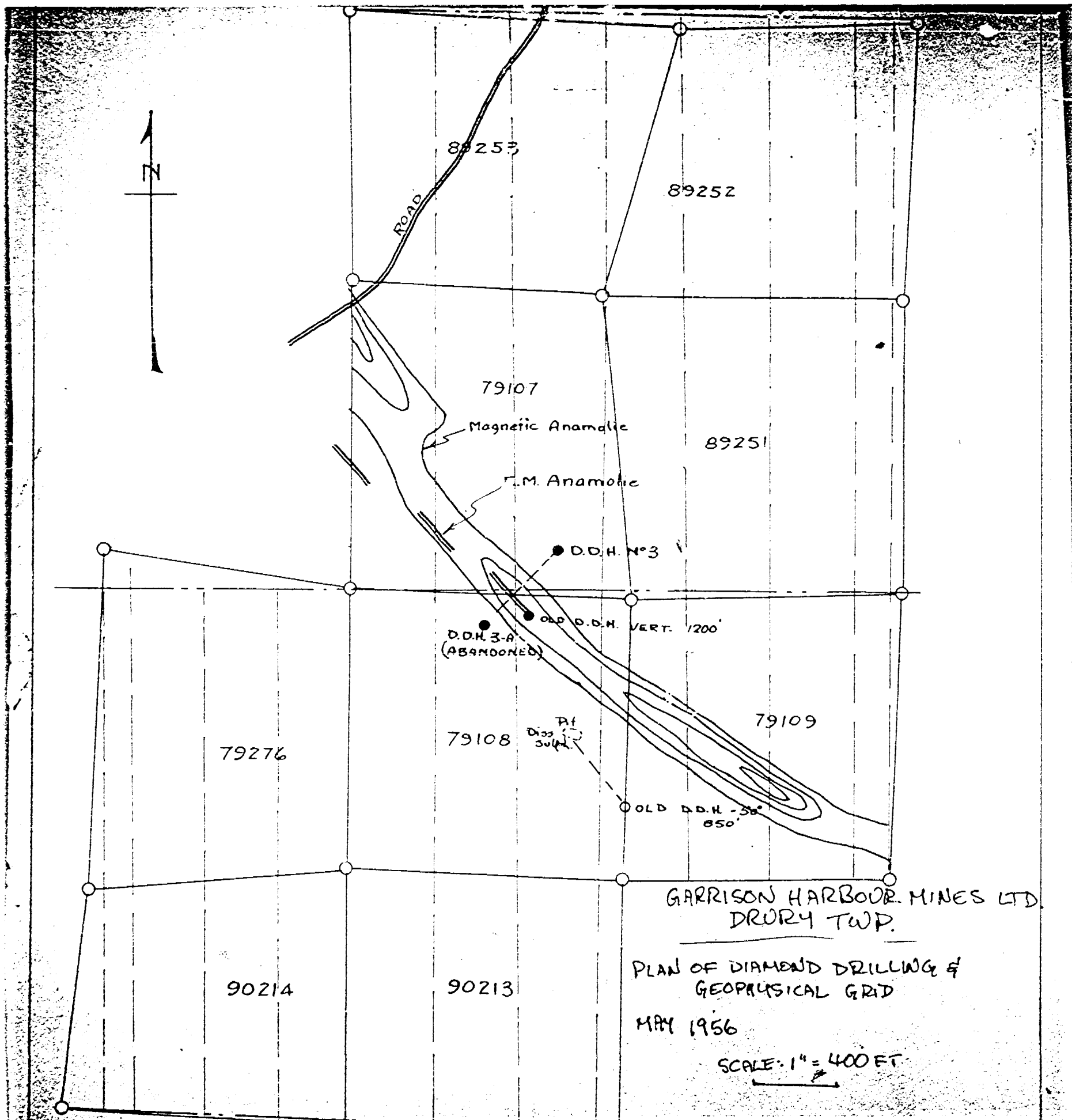

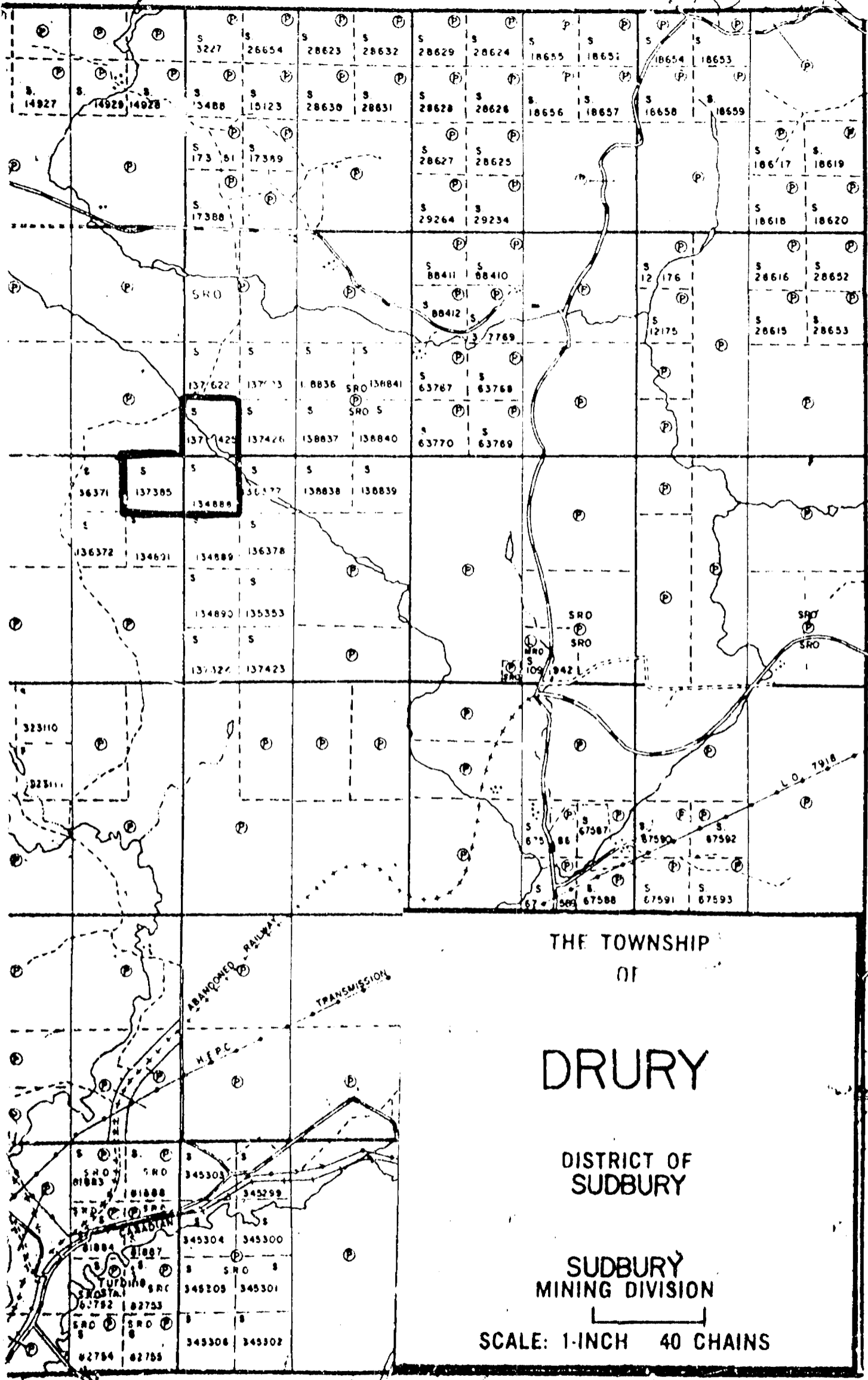

VI

V

IV

III

II

I

THE TOWNSHIP OF

DRURY

DISTRICT OF SUDBURY

SUDBURY MINING DIVISION

SCALE: 1-INCH 40 CHAINS

7 6 5 4 3 2 1