

Diamond Drilling



010

Township of PORTER

Report NO: 20

Work performed by: Springer Property

Claim NO	Hole NO	Footage	Date	Note
S 97182	M-1	158'	1957	
	M-2	205.8	1957	
	M-3	200.8'	1957	
	M-4	230.0'	1957	
	M-5	293.0'	1957	
	M-6	224.0'	1957	

---

TOTAL: 6 DH 1322 FT

Notes:

Hole M-1

<u>Footage</u>	<u>Bearing</u>	<u>Dip</u>	<u>Depth</u>	
0 - 45.0	casing	S60°W	-45°	158.0
45.0-93.0	Greywacke-argillite, greenish grey in colour, soft. Locally some bedding present at 20° to the core.			
47.0-54.8	dissem. pyrrhotite and chalcopyrite.			
75.0-93.0	Greywacke is well altered and sheared in this section with quartz stringers and patches. Minor chalcopyrite present in quartz.			
93.0-104.0	Quartz vein material, dark grey in colour with a few inclusions of greywacke. Mineralized throughout with fine chalcopyrite.			
	Sample #338 from 93.0-96.0		3cu. 3.0ft.	
	Sample #339 from 96.0-100.0		3cu. 4.0ft.	
	Sample #340 from 100.0-104.0		3cu. 4.0ft.	
104.0-140.0	Quartzite, impure, dark grey in colour, somewhat brecciated with quartz stringers common. Some chalcopyrite mineralization present.			
140.0-153.0	Quartzite as above, with only the odd narrow quartz stringer present. Minor dissem. sulphide in narrow patches.			
153.0	End of hole.			

*J. M. Lawrence*

Hole M-2

<u>Footage</u>	<u>Bearing</u>	<u>Dip</u>	<u>Depth</u>
	360°W	-45°	208.8
0 - 44.0	casing		
44.0-123.0	Greywacke-argillite, greenish grey in colour, soft. Locally mineralized sections with disseminated pyrrhotite and a little associated chalcopyrite.		
75.0-88.5	Altered greywacke, locally sheared and silicified, with a few narrow quartz stringers, and a little chalcopyrite mineralization.		
108.0-123.0	Altered and brecciated greywacke; contains frequent narrow quartz stringers.		
123.0-130.0	Quartz vein material. Upper contact sharp at 45° to the core. Minor pyrite mineralization.		
127.5-130.0	lost core.		
130.0-140.0	quartzite, light to dark grey in colour, impure.		
130.0-140.5	Well brecciated section with quartz stringers common. A few specks of pyrite.		
160.5-181.0	quartz vein- barren.		
181.0-208.8	Diorite, medium grained, dark green in colour, and fresh in appearance.		
208.8	End of hole.		

*J. H. S.*

Hole M-3

<u>Footage</u>	<u>Logging</u>	<u>Dip</u>	<u>Depth</u>
	2000'	-40°	200.3
0 - 32.0	casing		
32.0-83.5	Diorite, fine to medium grained, dark green in colour. Similar to the diorite in hole M-2.		
83.5-100.5	Greywacke-argillite. Locally well bedded with the bedding planes almost normal to the core.		
100.5-111.5	83.5-85.0 Brecciated section with coarse pyrrhotite in quartz stringers.		
111.5-114.5	Brecciated greywacke with some quartz patches.		
114.5-123.5	Brecciated greywacke with quartz stringers containing the odd speck of chalcopyrite. this section about 25% vein quartz.		
123.5-140.0	Shear zone; well sheared greywacke with nodules of quartz. Fine pyrrhotite and chalcopyrite mineralization throughout this section.		
140.0-160.0	Diorite dyke, similar to previous diorite section.		
160.0-200.0	Quartzite, impure dark grey in colour, mostly fine grained.		
200.0	200.0 Quartzite becoming darker grey and more impure.		
200.0	End of hole.		

*J. H. Green*

Wole M-4

<u>Footage</u>	<u>Logging</u>	<u>Dip</u>	<u>Depth</u>
	N60°E	-45°	200.1
0 - 12.0	casing		
12.0-131.0	quartzite, light to dark grey in colour, impure. Occasional narrow quartz stringers.		
25.0-76.5	quartz vein, barren.		
90.0-103.0	quartzite darker grey and more impure than previous. Some shearing in this section.		
104.0-131.0	Braced quartzite, contains about 10% vein quartz in stringers. A little chalcoprite mineralization in stringers.		
131.0-144.0	Gneiss, dark green in colour, contains some quartz stringers, but not as well braced as previous quartzite section.		
144.0-174.5	Well braced section, contains about 50% vein quartz and is mineralized throughout with fine chalcoprite.		
174.5-175.5	quartz vein material, includes some sections of wall rock in fragments. Locally a little chalcoprite, but mostly barren.		
175.5-176.5	Coarse pyrochite mineralization in vein.		
176.5-177.0	Gneiss-schist, well altered and altered.		
177.0-200.1	Highly altered and chloritized material, likely an altered schist.		
200.1	End of hole.		

*P. M. Lee*

Note M-5

<u>Footage</u>	<u>Bearing</u>	<u>Dip</u>	<u>Depth</u>
	500°W	-90°	293.0
0 - 46.0	Casing		
46.0-83.0	Graywacke-argillite, Locally bedding noted at 78° to the core.		
83.0-137.0	Dibase, similar to the dykes in the other holes, medium grained and fresh in appearance.		
137.0-149.2	Graywacke, greenish grey in colour with good bedding noted at 60° to the core.		
149.2-159.3	quartz vein, well developed and consisting of almost all vein quartz. A few specks of chalcopyrite and pyrrhotite scattered throughout.		
159.3-173.0	Altered sds. green, chloritic, with biotite well developed locally.		
173.0-220.0	quartzite, dark grey and impure. Locally narrow sections contain a little dissem. pyrrhotite and chalcopyrite.		
220.0-293.0	quartzite becoming more impure than the previous section. Approaching a siliceous graywacke in composition.		
293.0	End of hole.		

*J.C. McLean*

Hole N-6

<u>Footage</u>	<u>Bearing</u>	<u>Dip</u>	<u>Depth</u>
	S60°W	-30°	224.0
0 - 57.0	Casing		
57.0-90.0	Greywacke-argillite, dark greenish grey in colour. Locally bedding noted almost normal to the core. Some sheared sections.		
90.0-135.0	Siorite, medium grained, greenish in colour, altered and contains occasional narrow quartz stringers.		
135.0-224.0	Argillite, dark green in colour with the odd narrow quartz stringer.		
224.0	End of hole.		

*J. H. S.*

ASSUMED TRACE OF VEIL ON SURFACE

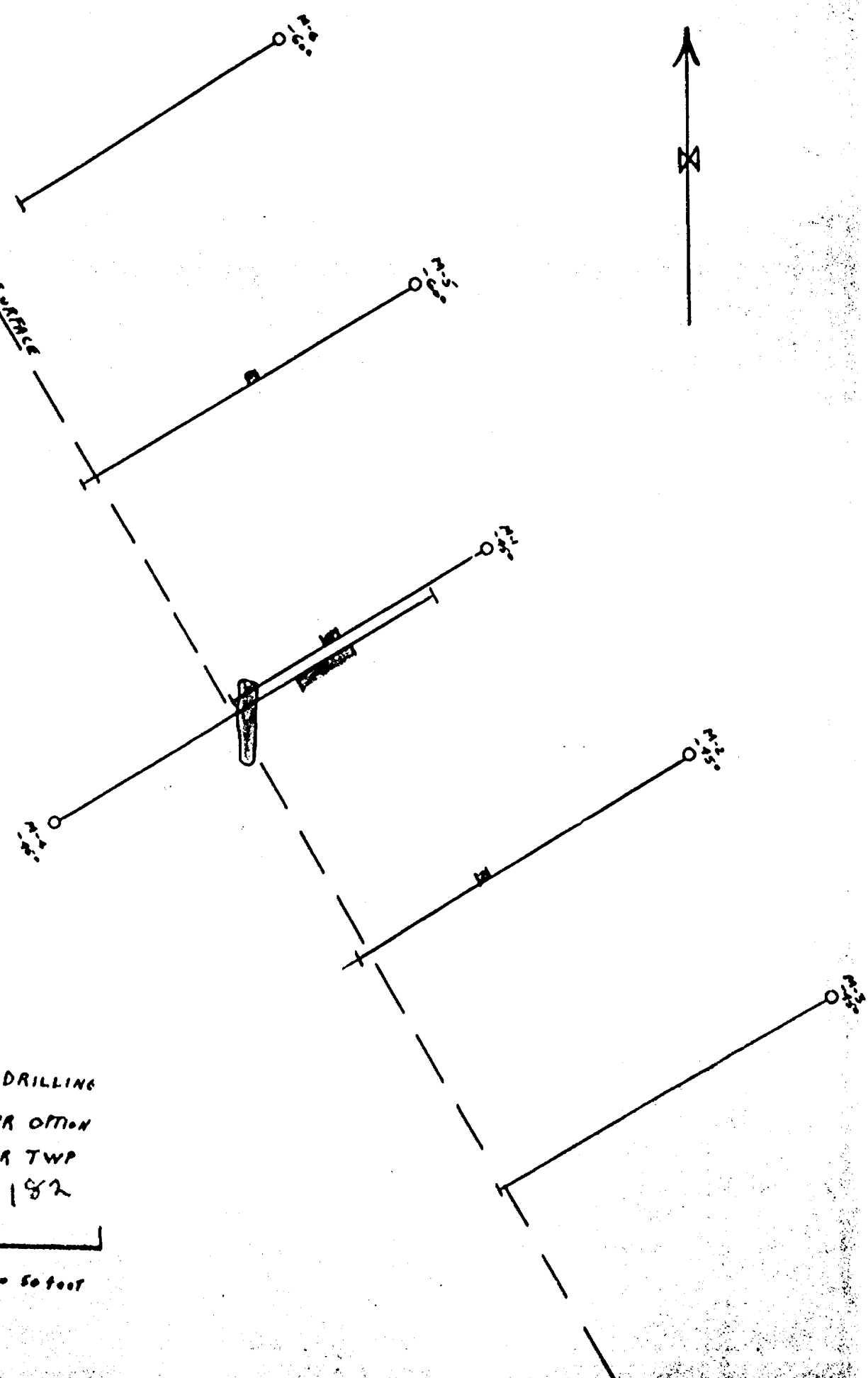

PLAN OF DRILLING  
SPRINGER OPTION  
PORTER TWP

Claim 5 97182

Scale:   
1 inch = 50 feet

H. M. S.  
2/2/17



41165M0021 0013E1 PORTER



900

DENLOP

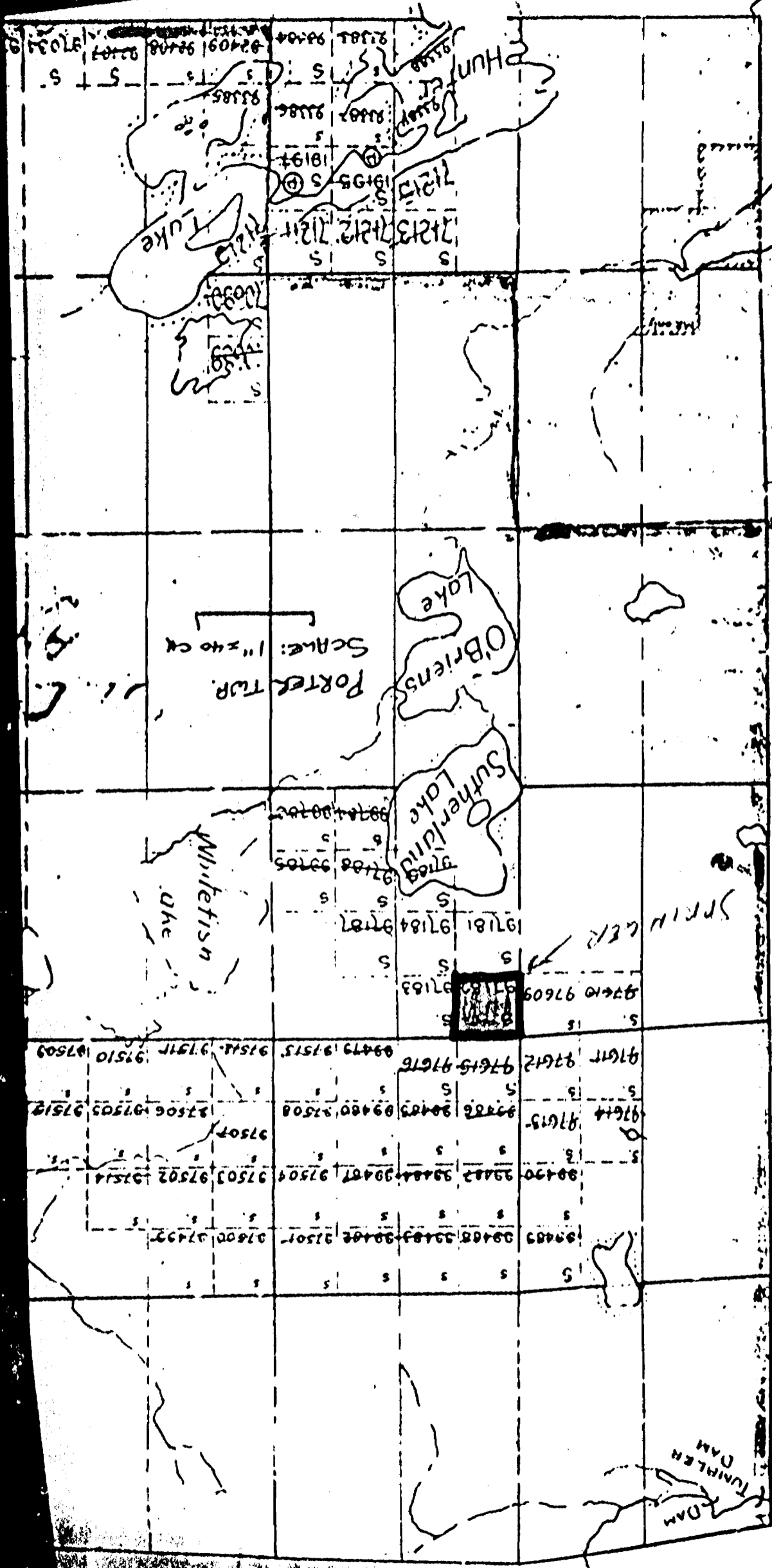

DENLOP

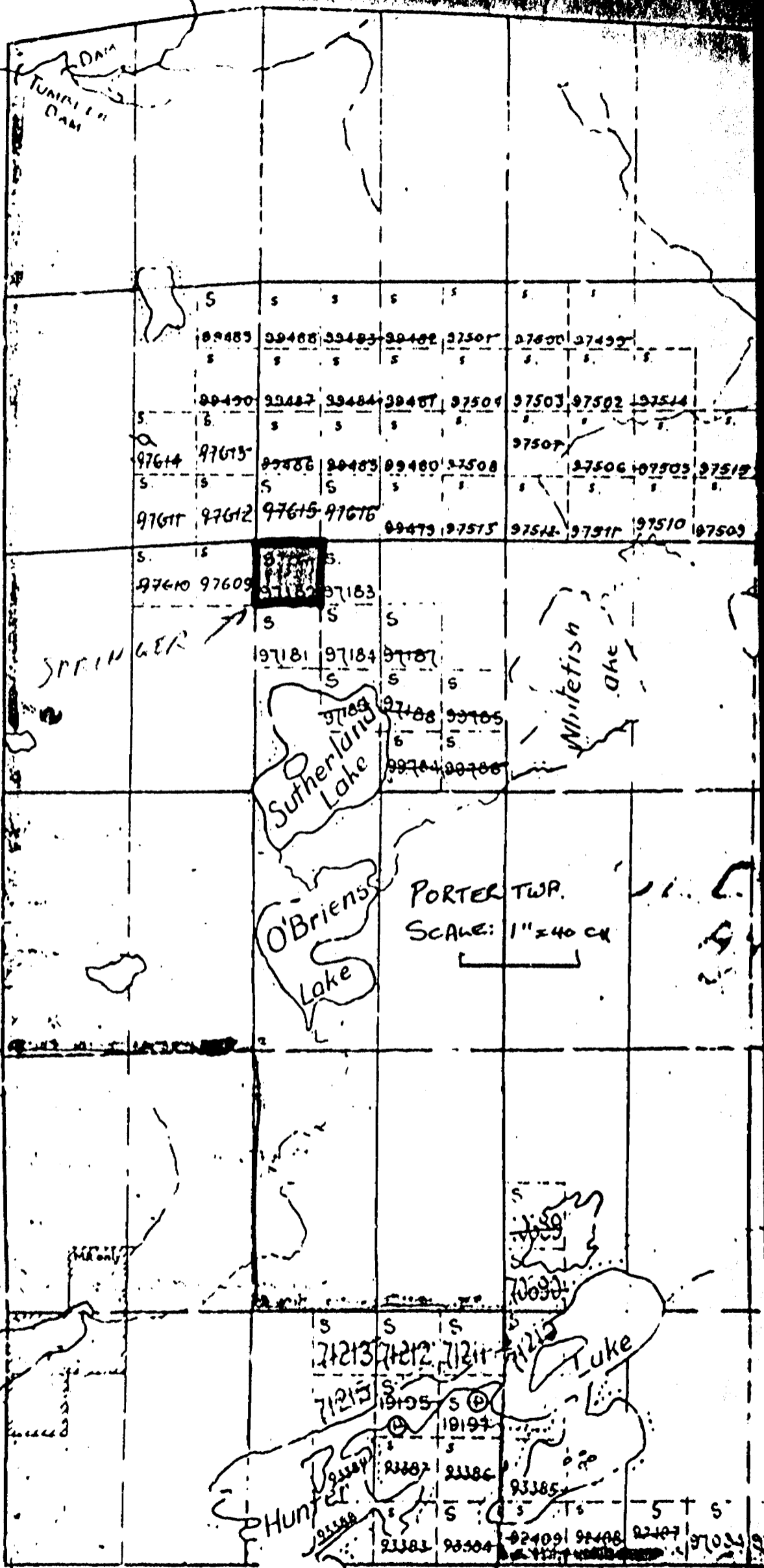

12 11 10 9 8 7