

PORTER TOWNSHIP REPORT #10

This file contains work performed by Mid-north Engineering Services Limited on claims.

S.71212	Holes #1;	1955
	#2;	1955
	#3;	1955
S.71215	Hole # 4;	1955

4 DH



41105NW0028 0010A1 PORTER

010

DIAMOND DRILL RECORD

Hole No. 1 Sheet No. 1

Property MACFEE EXPLORATIONS LTD
 Location CL 3 71214 NW 1/4, NT. LOT 9, CO. 1,
 PORTER TWP.

Latitude NADON 1300' 222W FROM NOL PT. T
 Departure (575' S OF BASELINE ON P.L. 42W)
 Bearing N 15° W.

COLLAR	Dip	
	13°	
200'	25°	
262'	23°	
Total Footage		262'

Elev. Collar _____
 Datum _____
 Date Started JAN 22ND 1955
 Date Completed JAN 24th
 Drilled by N. RICHIETTE D.D.CO.
 Logged by L. B. MERRELL

Footage		Formation	Sample Number	Sample Footage	Sample Width	Gold Sample	Gold Sludge	Remarks	
From	To								
0	13	Sand, gravel, ameboulders. 1/2 uncoated casings in rock.							
13	188.5	Conglomerate, graywacke matrix, used sh. at 25' to core axis. Silty to white, gray to tan, diss. throughout w. local concn. pebbles of various sizes but gen. under 1/2" sparsely diss. throughout. A few flint pebbles to 3" 3" aplite lenses at 27.5-29.5-8' & 29.5' pyrite, chalcite (?) margins. (Pebbles or dikes?) minor Fe. py. diss. in matrix with local py. streaking. Some pebbles halved w. py. shaly less evident from 100' - 100-150 - scattered flat bedded w. pebbles. From 150 all pebbles fewer - rare from 175.	NOL	TEST SAMPLE 25.0-26.0 SENT. 12 FEB 1955 TO PROV. ASSAYER FOR U.O.P.S. ANAL.					
188.5	197.0	Silt (argillite?) laminae to 1/8" L to core.							
197.0	209.2	Silt (argillite?) (impure quartzite?) sparse scatt. py. oolite, probably additional zone. Concretion.							
209.2	210.0	Local deformation, impure siltite, bedding at 1/8" to core.							
210.0	237.0	AS 177-207.0							
237.0	262.0	Quartzite, more typical, folts for rich bedding about 20% to core axis. Sparse scatt. py.							
END OF HOLE									
		LOST CORE: 232.0-232.7; 234.1-235.0							

Date of Examination _____

NOTE: DRILLING CORN. PL. IN U. EST. CORE REC. 96%

DIAMOND DRILL RECORD

Hole No. 2 Sheet No. 1

Property MACFIE EXPLORATIONS LTD.
 Location N.W. 1/4, N. 1/2, Lot 9, Con. 1
PORTER TWP.
CLAIM S. 71 R. 12
 UTM 1150' S 10° W CEN 1 POST
 Reference 610' S OF BASELINE ON PL. 39 W.
 Bearing N 15° W.

Dip 45°
COLLAR
 3 ATTEMPTS TO TAKE TEST AT 200'
 FAILED DUE TO FREEZING OF WATER
 PRE-PREPARED ACID MIXTURE RUDS
 DOWN HOLE SMOOTHLY SO FEEL SLIGHT
 IF ANY DEVIATION.
 Total Footage 224

Elev. Collar _____
 Datum _____
 Date Started JAN 25th
 Date Completed JAN 27th
 Drilled by N. MORRISSETTE D.D. LTD.
 Logged by L. B. MERRELL

Footage		Formation	Sample Number	Sample Footage	Sample Width	Gold Sample	Gold Sludge	Remarks
From	To							
0	8	4 SAND ETC. 4' UNCORED CASING IN ROCK.						
8	151.4	CONGLOMERATE TO 68.0. 12-15% QUARTZ GRANITIC, CHERT & BASIC PEBBLES (A FEW FLAT & BEACH WORN) FROM 3MM TO 6" - GRAN UNDER 3/4". PEBBLES SCARCE FROM 68.0. MATRIX COARSE SLIGHTLY SERGITIC GREYWACK. TO 10% BLUE & 12 GRAINS TO 3MM. INTERMIT SLIGHT SH. AT ABOUT 30° TO CORE. 1/10 - 1/4 OF 1% FE. PY. WELL DISSEM. A FEW S. FAKS & HALE 3 AROUND PEBBLES. LESS PY FROM 75.2. NO CORE 144.6 - 199.8	A 2	110.2 - 110.9	0.7	TR		SL SHR. COARSE GR. GREYWACK. V. SP. PY. A FEW TINY (2mm) SUB-ANGULAR PEBBLES. RA - 1/2 x BC
151.4	160.4	SILT, MORE COMPACT THAN IN HOLE NO 1.						
160.9	199.2	COARSE GRAN. GREYWACK OR IMPURE QUARTZITE. SPARSE PY. GRADATIONAL ZONE. CONFORMITY(?)						
199.2	224.0	QUARTZITE, FELD. RICH. IMPURE SECTIONS						

DIAMOND DRILL RECORD

Hole No. 3 Sheet No. 1

Property MACFIE EXPLORATIONS LTD.
 Location NW 1/4, N 1/2, LOT 9, CON 1
PORT ARTHUR
CL S. 71 R.
 Latitude 1850' S 15E OF No 4 POST.
 Longitude
 Bearing N 15 W

Dip 45°

COLLAR
 NOTES IN HOLE - NO ACID - HEAPER
 SENT FOR ACID DID NOT RETURN.
 BODS GO DOWN WELL - PROBABLY
 SLIGHT DEVIATION IF ANY.
 Total Footage 258'

Elev. Collar
 Datum
 Date Started JAN 28th 1955
 Date Completed JAN 30th
 Drilled by N. MCGRIFFIE D.D. LTD.
 Logged by L.E. MERRELL

Footage		Formation	Sample Number	Sample Footage	Sample Width	Gold Sample	Gold Sludge	Remarks
From	To							
0	7	CASING - 3' UNCORED IN ROCK.						
7	187.5	CONGLOMERATE - TO 75' 15% GRANITIC, QUARTZ AND A FEW BIG PEBBLES - TO 3" BUT MOST UNDER 3/4". ROUNDED TO SUB-ANGULAR. FEWER FROM 75'; SPARSE FROM 140'. MANY BLUSH ROUNDED QZ GRANULES TO 3MM THROUGHOUT. SPARSE FINE PYRITE THROUGHOUT. INTERMIT. SLIGHTLY SERICITIC SHEAR AT APPROX 30' TO CORE AXIS THROUGHOUT. LEAKED SEAM AT 18' 3/4" QZ STR. WITH 2 1/2" BUNCHES BRASSY PYRITE AT 116.8 - WATER LOST ABOUT 125' - L' CAVE IN 20' AT 140'.						VERY SLIGHT INTERMIT. RA TAKEN MONT BUT NO MORE THAN 1/4% BC SUSTAINED ANYWHERE, BETA COUNT VERY SLIGHTLY HIGHER.
187.5	203.5	SILT. MORE FINELY BEDDED AT TOP. SPARSE FINE PYRITE.						
203.5	249.8	COARSE GRAN. GREENALBE OR IMPURE QUARTZITE. V. SPARSE PYRITE, CONFORMITY?						LESS RH THAN CONGLOMERATE.
249.8	258.0	QUARTZITE, OCCASIONAL TRACE PYRITE.						
END OF HOLE								

DIAMOND DRILL RECORD

Hole No. 4 Sheet No. 1

Property MAGNIE-PORTER
 Location SE 1/4 N 1/2 Lot 10, Con 1,
PORTER TWP.
CL. S. 7115
 Lab/Ch 585' S 21 E OF NO 4 POST.
 Departure N 25 W
 Bearing

COLLAR Dip 45°
200 41°
350 35°
 Total Footage 360'

Elev. Collar _____
 Datum _____
 Date Started FEB 1ST 1955
 Date Completed FEB 5TH
 Drilled by N. MARKISSETTE D.D.LTD.
 Logged by L.B. MERRILL

Footage		Formation	Sample Number	Sample Footage	Sample Width	Gold Sample	Gold Sludge	Remarks
From	To							
0	7	CASING - 4' UNCORED IN ROCK.						
7	230.4	CONGLOMERATE. SIL. GWK. MATRIX. 15% QTZOSE GRANITIC AND A FEW BASIC PEBBLES TO 2" BUT GEN. UNDER 1/4" PEBB. PROGRESSIVELY FEWER & SMALLER FROM 138. VERY FEW FROM 175. MILD INTERMIT. SHEAR TO ABOUT 160.0. 1/8" QTZ STR. AT 75.4 & 123.0. SPARSE DISS PYRITE THROUGHOUT.						NO SUSTAINED RA HIGHER THAN 1/4" X BC.
230.4	231.0	DARK GRAY SILT.						
231.0	253.1	CONGLOMERATE. PEBBLES TO 1" IN UPPER TEN FEET DECREASING IN NUMBER - 10% & 2% - AND SIZE. SP. PY.						
253.1	296.0	IMPURE QUARTZITE. W A FEW INTERBEDDED SILTS TO 3" GRADUALLY PURER TO ABOUT 296. V. SP. PY.						
296.0	360.0	QUARTZITE.						
END OF HOLE.								

Date of Examination _____



900

THE MINING ACT



ONTARIO

REPORT OF WORK

To the Recorder of Sudbury Mining Division:

I, MID-NORTH ENGINEERING SERVICES LTD.

(Name of Applicant)

145 Yonge Street, Toronto, Ontario

(Post Office Address)

the recorded holder of mining claim No. S 71212 hereby report the performance of 107 1/2 days' work not before reported.

* This mining claim is one of a group of contiguous claims numbered S 70689; 70690;

71210; 71211; 71212; 71213; 71215

of which I am the recorded holder under Mining Licence No. A 22041, and the work

was performed on mining claim(s) 71212 and 71215 and is to be applied

in respect of mining claim(s) All equally

(*Complete above section only if applicable)

The work is as follows:

Stripping or opening up mines, sinking shafts or other actual mining operations

The names and addresses of the men who performed the work and the dates upon which each man worked in its performance are: (If more space is required, attach list).

Total No. of days

Diamond or other Core Drilling

Footage drilled 1104 No. of holes drilled 4 Angle 45°

Diameter of core AZT Names and address of owner and operator of

drill R. Horibetto Diamond Drilling Ltd., Halleybury, Ont.

Dates upon which drilling was done Jan. 10 to Feb. 6, 1965

(Core log accompanies this report).

Total No. of days 1104

Work by Compressed Air or other Power Driven Rock Drill

Type of drill

Names and addresses of men engaged in operating drill.

Dates upon which each man worked

Total No. of days

Geophysical Survey

Type of instrument used

Names and addresses of men employed and the dates on which each worked are:

Total No. of days

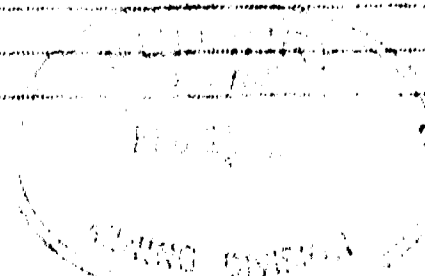

Geological Survey

Names and addresses of men employed and the dates on which each worked are:

Power Stripping

Total No. of days _____

Type of equipment used _____

Names and addresses of owner and operators _____

Amount expended \$ _____

Dates on which work was done _____

Total No. of days _____

The following diagram shows the approximate location of the work done and the nature and extent thereof:

IMPORTANT

Attach sketch showing location of work in relation to corner posts, and nature and extent thereof.

Date February 11, 1956

Mid-North Engineering Services Ltd.

G. L. Holbrooke
(Signature of Recorded Holder)

Form 11

Affidavit Verifying Report of Work

County (or District)
of York

To Wit:

I, G. L. Holbrooke
of the City of Toronto
in the Province of Ontario
make oath and say:

1. I am the Agent and as such I have a personal and intimate knowledge of the facts hereinafter deposed to, and the grounds of my knowledge are:
I had charge of this work.

2. That the annexed report is true.

Sworn before me at the City of Toronto
in the County of York this 11 day of February, 19 56

G. L. Holbrooke
(Signature)
145 Yonge Street, Toronto
(Post Office Address)

Albert
Mining Recorder or Commissioner, etc.

Porter
MID-NORTH ENGINEERING SERVICES LTD.

145 YONGE STREET
TORONTO 1. ONTARIO

February 28th, 1955

Dr. M. E. Hurst,
Provincial Geologist,
Ontario Department of Mines,
Parliament Buildings,
Toronto, Ontario.

Dear Sir:

Re: Assessment work - claims S 71210
to 15 inclusive; S 70889-90 - Porter
Township

Mr. J. R. McGinn has requested us that we advise you as to the disposition of the core from drilling that was done on these claims. The core is stored beside a small cabin on the north shore of Hunter Lake on claim 71212.

Yours very truly,

MID-NORTH ENGINEERING SERVICES LTD.

G. L. Holbrooke

G. L. Holbrooke
President

GLH:DF

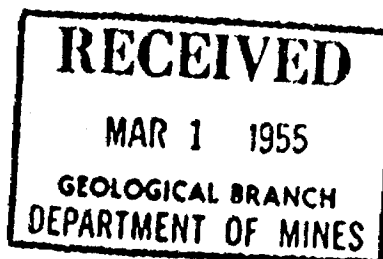

DUNLOP TR. M-771

PORTER TWP.

SCALE: 1" = 40 CH

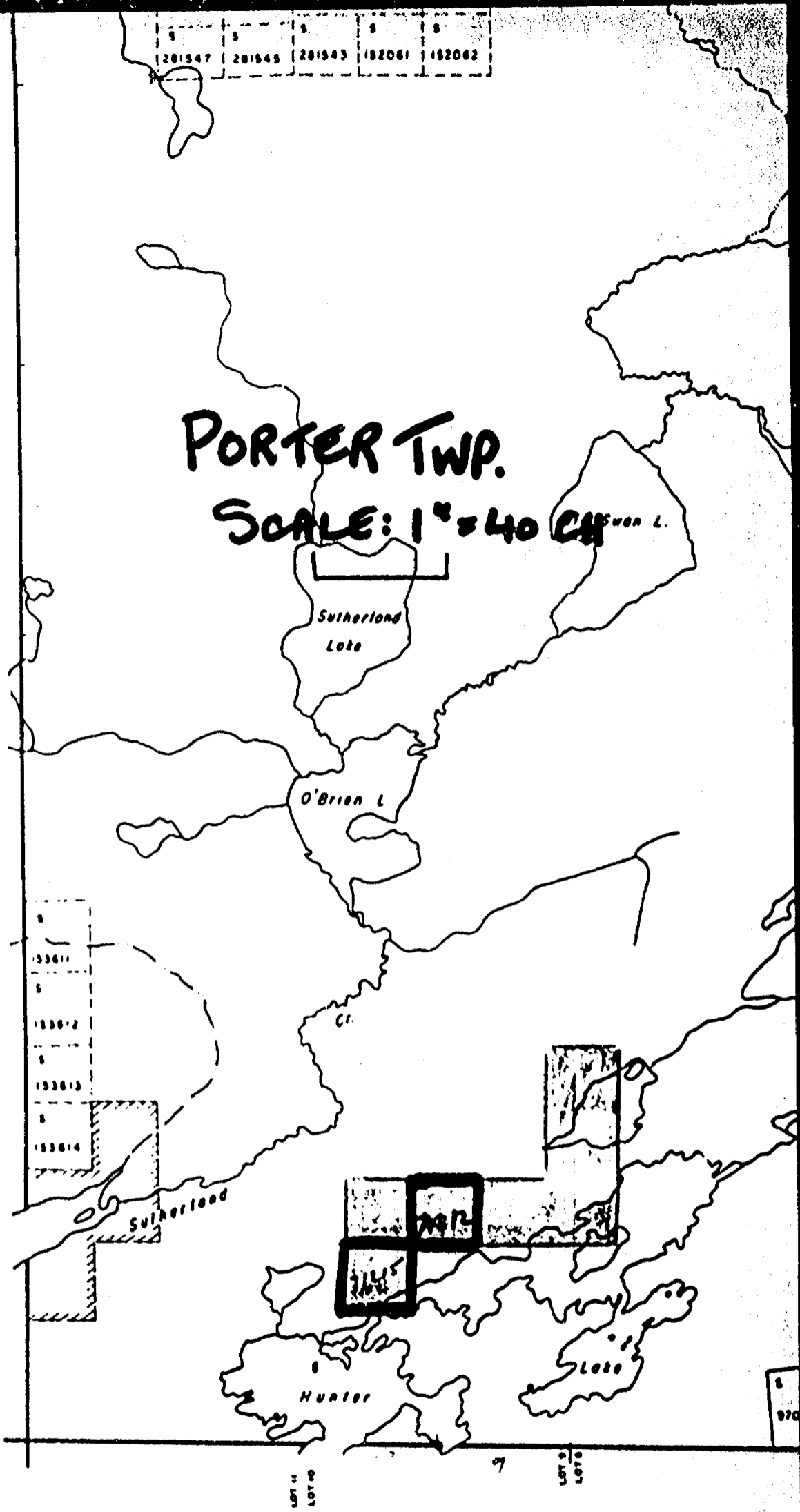

BALDWIN

SEE ACCOMPANYING
MAP(S) IDENTIFIED AS

PORTER-0010-A1.#1

LOCATED IN THE MAP
CHANNEL IN THE FOLLOWING
SEQUENCE (X)

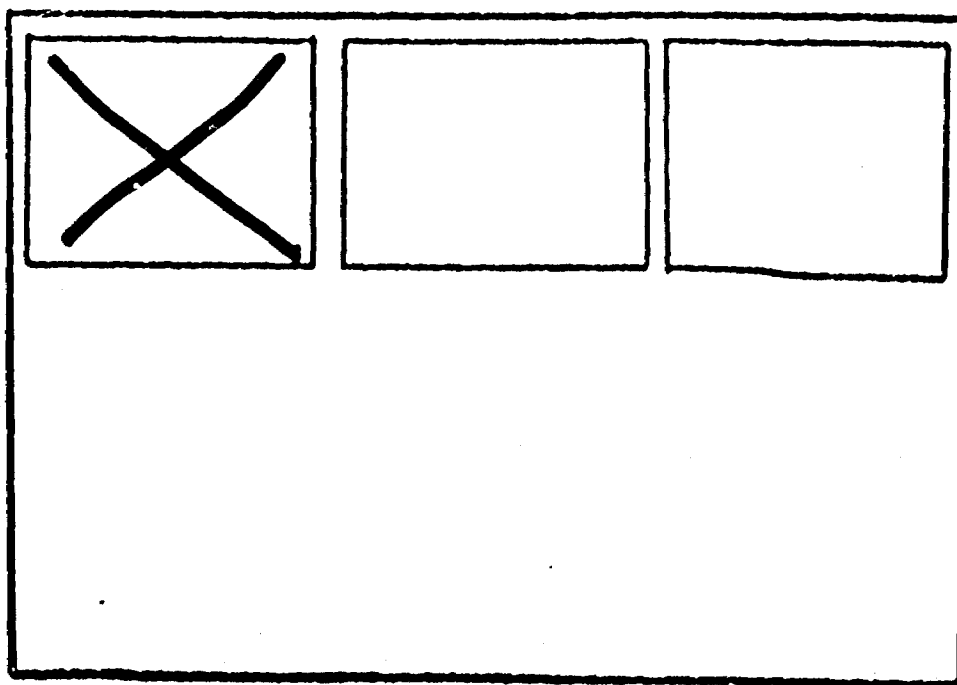

MIDNORTH ENGINEERING SERVICE LTD.

HUNTER LAKE GROUP

PORTER TWP.

1 IN. = 200 FT.

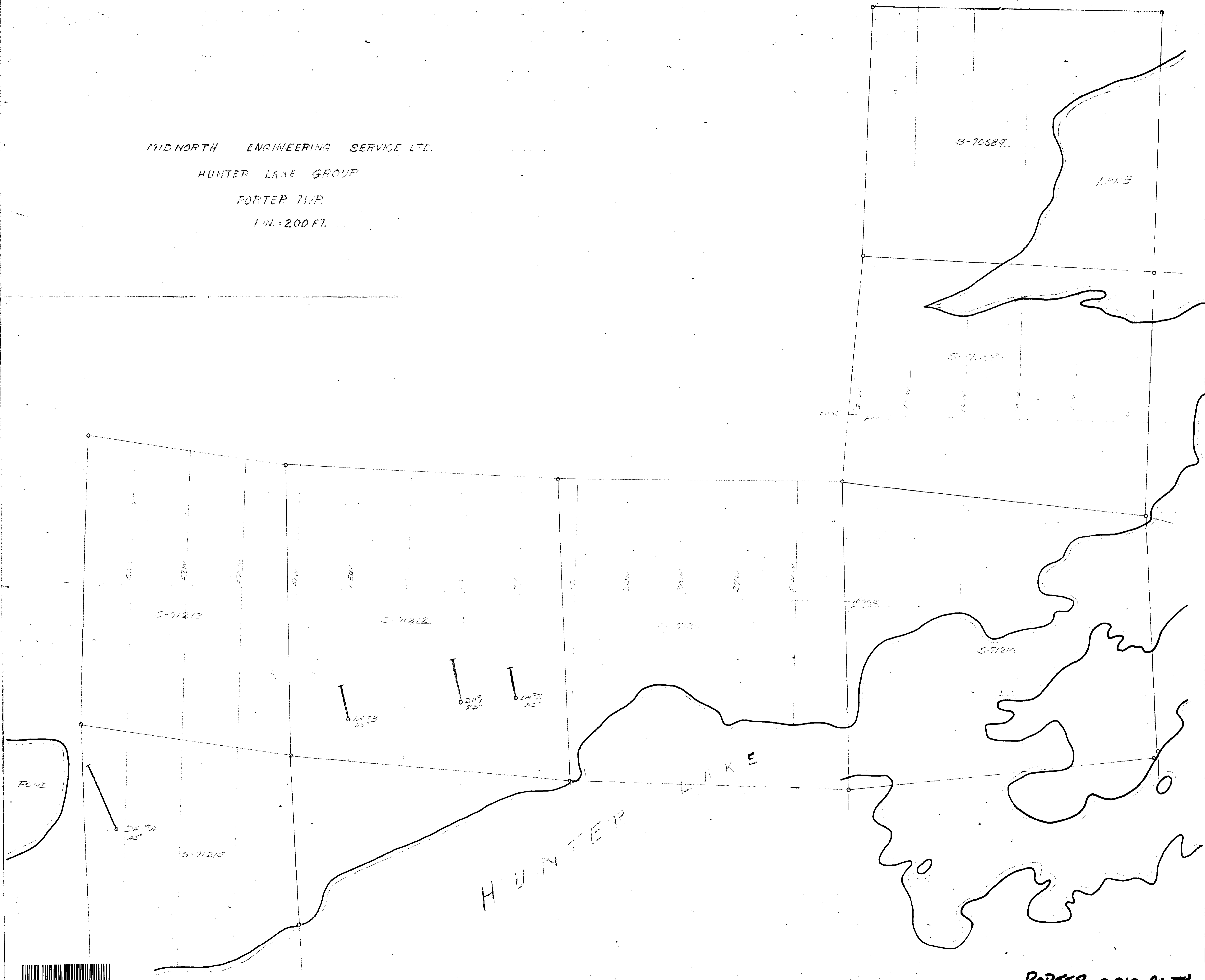

200

PORTER 0010-A1-11