



41105NW0225 001281 SHAKESPEARE

010

Diamond Drilling

Township OF SHAKESPEARE

Report NO: 16

Work performed by: BROULAN REEF JINES LIMITED

Claim NO	Hole NO	Footage	Date	Note
S 140916	<u>BSU-9-12</u>	<u>2070'</u>	Oct-Nov/69	

TOTAL: 1 DH 2070 FT

Notes:

BROULAN RIVER MINES LIMITED

DIP -90° BEARING                      LENGTH 2070'  
 LAT. 70° S & 12° E of  
 DEP. #4 Post, Cl. 140916  
 ELEV.                     

CLAIM NO. S-140916  
 STARTED October 16, 1969  
 COMPLETED November 12, 1969

HOLE NO. RSU-9-12  
 PROPERTY Aspen Lake

FOOTAGE		DESCRIPTION	CORE												
FROM	TO		SPL NO.	FROM	TO	WIDTH	GRADE								
0	107	Overburden													
107	447	<p>Quartzite: Dark grey in colour, numerous biotite flakes with minor blue quartz grains and white feldspars. in a fine-grained quartzite. Generally fine-grained with occasional short medium grained sections. Cross bedding and contorted bedding.</p> <p>107'-227' Hematite occurs in fractures and with quartz veins. C.A. 10°/130'; 10°/319'; 15°/433'.</p> <p>LOGGED BY D. ROSS</p> <p>Tro-Pari Tests</p> <table border="0"> <tr> <td>Footage</td> <td>Dip</td> <td>True Azimuth</td> </tr> <tr> <td>150</td> <td>-90°</td> <td>246°</td> </tr> <tr> <td>300</td> <td>-86°</td> <td>267°</td> </tr> </table>	Footage	Dip	True Azimuth	150	-90°	246°	300	-86°	267°				
Footage	Dip	True Azimuth													
150	-90°	246°													
300	-86°	267°													

BROULAN REEF MINES LIMITED

DIP -90° BEARING - LENGTH 2070'  
 LAT. 70° S & 12' E of  
 DEP. #4 Post, CL 140916  
 ELEV. \_\_\_\_\_

CLAIM NO. S-140916  
 STARTED October 16, 1969  
 COMPLETED November 12, 1969

HOLE NO. BSU-9-12  
 PROPERTY Agnew Lake

FOOTAGE		DESCRIPTION	CORE				
FROM	TO		SPL. NO.	FROM	TO	WIDTH	GRADE
447	500	Quartzite: Dark grey in colour, numerous biotite flakes with minor blue quartz grains and white feldspars. in a fine-grained quartzite. Generally fine-grained with occasional short medium grained sections. Cross bedding and contorted bedding. C.A. 10°/464'.					
500	615	Feldspathic Quartzite: Medium-grey in colour. Generally fine-grained with cross-bedding. C.A. 10°/515'. 500'-513' Pink feldspars.					
615	849	Quartzite: Medium to light grey in colour, fine-medium grained. Cross-bedding. 754'-768' Core is blocky, possible minor fault.					
849	851	Minor fault zone; bleaching & brecciation.					
851	1839.5	Feldspathic Quartzite; Light to medium grey in colour. Generally fine-grained. Cross-bedding. C.A. 20°/867'; 70°/1564'; 70°/1575; 75°/1711'. 1555' Graded bedding, tops up hole. 1739-1775' Scattered irregular quartz veining.					
1839.5	1875	Quartzite: Medium to dark grey in colour. Scattered blue quartz grains and micaceous minerals in a fine grained quartzite. Generally massive.					
1875	1933	Feldspathic Quartzite: Shades of light brown and grey, fine-coarse grained. Massive. 1903'-1931' Rock is fractured. 1931'-1932' Barren quartz vein. 1932'-1933' Weak fault breccia.					
1933	1977	Altered Diabase: Scattered quartzite inclusions. Massive with numerous fractures. Medium grey in colour. 1945'-1947' Barren quartz vein.					
1977	1998.5	Altered Diabase: Massive, medium grey in colour, medium grained.					
1998.5	2013	Diabase: Dark green in colour, medium to coarse grained. Massive.					

BROULAN REEF MINES LIMITED

DIP

BEARING

LENGTH

EAT.

STARTED \_\_\_\_\_  
COMPLETED \_\_\_\_\_

HOLE NO. BSU-9-12  
PROPERTY \_\_\_\_\_

DEP. \_\_\_\_\_

ELEV. \_\_\_\_\_

FOOTAGE		DESCRIPTION	CORE				
FROM	TO		SPL. NO.	FROM	TO	WIDTH	GRADE
2013	2019	Altered Diabase: Medium grey in colour.					
2019	2031	Diabase: Same as 1998.5-2013'.					
2031	2046	Altered Diabase: Massive, medium grey in colour. Coarse grained. 2039'-2046' Rock is very soft.					
2046	2070	Quartz Diabase (?): Massive, light grey in colour. Fine grained.					
	2070	END OF HOLE					
		LOGGED BY D. ROSS					
		Tro-Pari Tests					
		Footage	Dip	True Azimuth			
		500	-79°	259°			
		700	-71°	261°			
		800	-68°	263°			
		1200	-51°	277°			
		1400	-45°	283°			
		1550	-42°	282°			
		1800	-36°	286°			
		2000	-35°	287°			

*D. Ross*

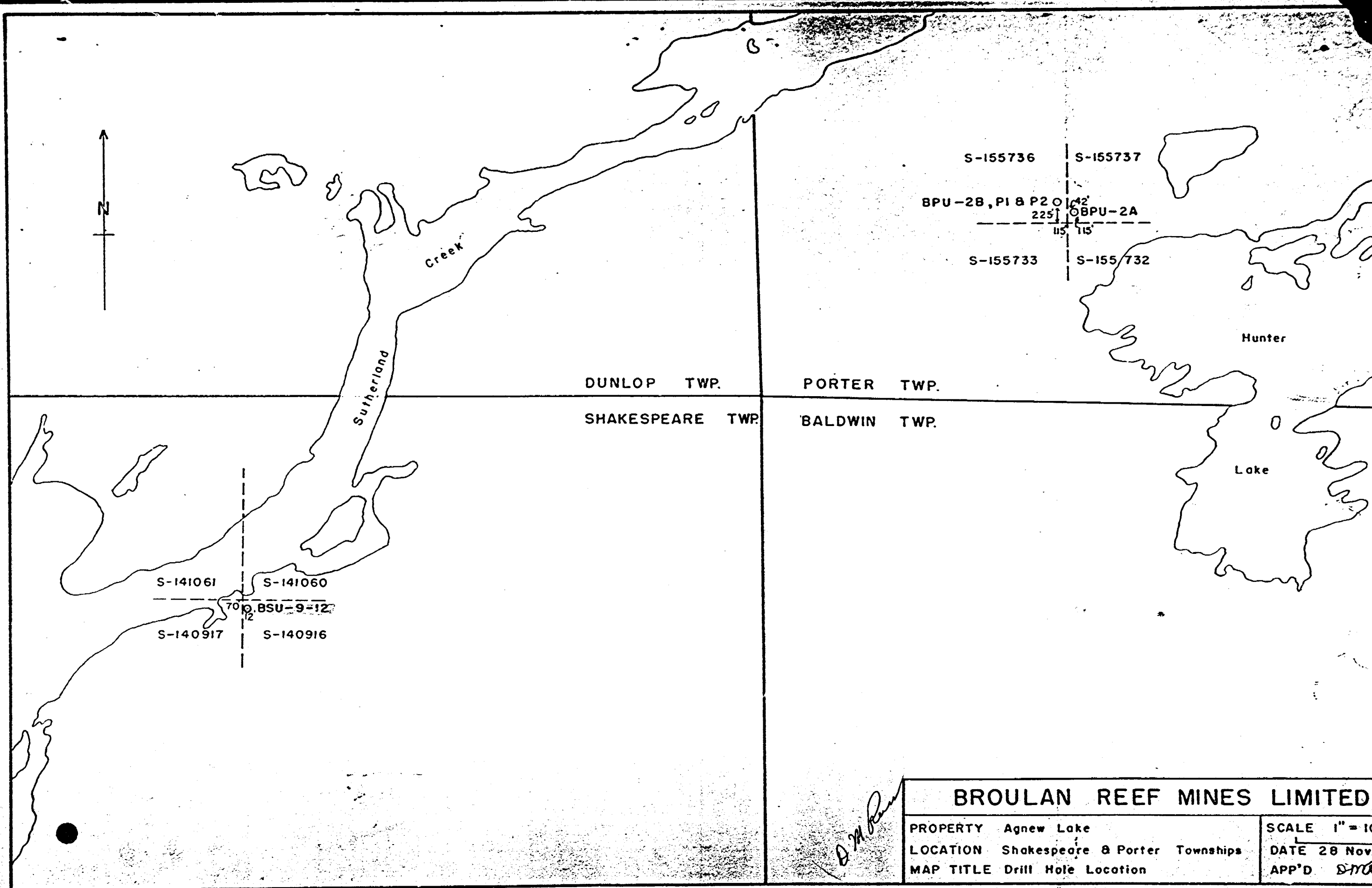

**BROULAN REEF MINES LIMITED**

PROPERTY Agnew Lake  
LOCATION Shakespeare & Porter Townships  
MAP TITLE Drill Hole Location

SCALE 1" = 1000'  
DATE 28 Nov. 1969  
APP'D *DMR*

Rec'd in Res. Dept. Office

July 10/70



ONTARIO

THE MINING ACT REPORT OF WORK

A separate form is required for each type of work to be recorded.

# 71

To the Recorder of.....Sudbury.....Mining Division

I, .....Broulan Reef Mines Limited.....A-31385  
name of Recorded Holder Miner's Licence

.....105 Adelaide St. West, Toronto, Ontario.....  
Post Office Address

do hereby report the performance of .....1,687..... days of diamond drilling and core specimens  
type of work

not before reported to be applied on the following contiguous claims

Claim No. Days Claim No. Days Claim No. Days

.....(per list attached).....



41105NW0225 001201 SHAKESPEARE

900

140917 141061.....

Baldwin

All the work was performed on Mining Claim (s) S. 140917, S. 141061, Shakespeare, Exp 1.....  
(In the case of geological and/or geophysical survey (s) where more than 18 claims are involved attach a schedule)

READ CAREFULLY: THE FOLLOWING INFORMATION IS REQUIRED BY THE MINING RECORDER.

- For Manual Work, Stripping or Opening up of Mines, Sinking Shafts or Other Actual Mining Operations - Names and addresses of the men who performed the work and the dates and hours of their employment.
- For Diamond and other Core Drilling - Footage, No. and angle of holes and diameter of core. Name and address of owner or operator of drill. Dates when drilling was done. Signed core log and sketch in duplicate.
- For Compressed Air or Other Power Driven Mechanical Equipment
- Type of drill or equipment. Names and address of men engaged in operating equipment and the dates and hours of their employment.
- For Power Stripping - Type of equipment. Name and address of owner or operator. Amount expended. Dates on which work was done. Proof of actual cost must be submitted within 30 days of recording.
- With each of the above types of work sketches are required to show the location and extent of the work in relation to the nearest claim post. In the case of diamond or other core drilling the sketch must be submitted in duplicate.
- For Geological and Geophysical Survey - The names and addresses of men employed as well as dates. Type of instrument used in the case of geophysical survey. Reports and maps in duplicate must be filed with the Minister within 60 days of recording.
- For Land Survey - the name and address of Ontario Land surveyor.

The Required Information is as Follows: (Attach a list if this space is insufficient)

Hole No.	Core Size	Claim No.	Footage	Credit for Core Specimens	Work Credit (days)
BSU-9-12	1 1/2"	S140917	1,179'		
		S141061	444'		
			1,623'	64 days	1,687 days

This hole was collared on claim S. 140916 at a dip of -90°. Total footage is 2070', of which the first 447' was recorded in December, 1969. Contractor: Continental Diamond Drilling Co. Ltd., Rouyn, Que.

BROULAN REEF MINES LIMITED

Date .....JUNE 16, 1970.....

Signature of Recorded Holder or Agent

The Mining Act Certificate Verifying Report of Work

I, .....David M. Ross.....  
.....c/o Broulan Reef Mines Limited, P.O. Box 1487, Espanola, Ontario.....  
(Post Office Address)

herby certify:

- That I have a personal and intimate knowledge of the facts set forth in the report of work annexed hereto, having performed the work or witnessed some during and/or after its completion.
- That the annexed report is true

Dated .....JUNE 17, 1970.....

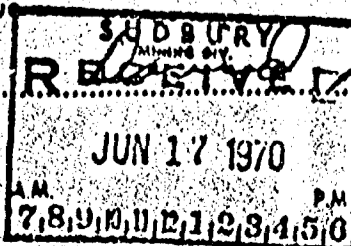

Signature

S. 140917

THE PENALTY FOR MAKING A FALSE STATEMENT IN THIS REPORT AND/OR CERTIFICATE IS \$500. OR SIX MONTHS IMPRISONMENT OR BOTH

BROULAN REEF MINES LIMITED

<u>CLAIM NO.</u>	<u>DAYS</u>
<u>SHAKESPEARE TWP.</u>	
S140917	1
S141061	1
S139709	1
S137896	1
S137895	1
S139310	1
S139309	1
S139308	1
S147595	1
S147596	1
S147597	10
S147598	60
S147599	60
S147608	60
S147609	60
S147614	60
S147615	60
S147616	60
S147617	60
S147618	60
S147619	59
S147620	60
S147621	60
S147622	60
S148248	60
S148249	60
S148250	60
S148251	60
S148252	60
S148253	27
S148254	60
S148255	60
S148256	60
<u>BALDWIN TWP.</u>	
S137495	21 * 17 <del>days</del>
S137496	60 *
S137497	60
S137499	60
S139286	60
S139287	60
S139288	60
	<hr/>
	<u>1,687</u>

\* Credit for core specimens applied as follows:

S137495	4 days
S137496	60 "
	<hr/>
	<u>64</u> days



ONTARIO  
DEPARTMENT OF MINES  
Mining Lands Branch

PARLIAMENT BUILDINGS  
TORONTO 2, ONTARIO  
Tel. 416 365-6139

April 10, 1969.

Resident Geologist,  
Ont. Dept. Mines,  
1349 LaSalle Blvd.  
SUDBURY, Ontario.

Dear Sir:

I am enclosing diamond drill core logs and maps submitted by the following to the Mining Recorder at Sudbury;

#73 - Broulan Reef Mines Ltd.  
Shakespeare Township.

#75 - Cominco Ltd.,  
Township 143.

Please add these to your files.

Yours very truly,

*G. F. Stevens*  
G. F. Stevens,  
Research Officer.

GTS/fv

*SHAKESPEARE  
TWP  
NP*

*This belongs to  
Sault Ste.  
Marie.*