



41105SE0019 2.16796 PORTER

010

**REPORT ON BULK SAMPLE PROJECT
(FORMER SPANISH RIVER MINE PROPERTY)
BALDWIN TOWNSHIP
SUDBURY MINING DIVISION**

2.16796

PREPARED BY: SOUTHBAY DESIGN & CONSTRUCTION LTD.
P.O. BOX 1094 STN B , SUDBURY ONTARIO P3E 4S6
FOR D. & H. CONSULTING SERVICES INC.
AUG. 16, 1996

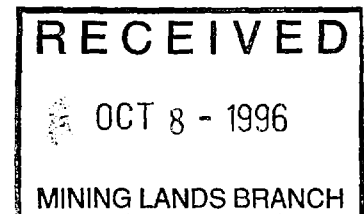



41105SE0019 2 16796 PORTER

010C

INDEX

PAGE # 3.....INTRODUCTION

PAGE # 4.....LOCATION & ACCESS, BULK SAMPLE PROJECT

PAGE # 5...MINERALIZATION OF BULK SAMPLE PROJECT AND SURVEYING

PAGE # 6-7-8.....EXPENSES

PAGE # 9...DELIVERY MAT'L. TO FALCONBRIDGE FOR CHEMICAL ANALYSIS

PAGE # 10.....ASSESSMENT WORK COST / CATEGORY

INTRODUCTION

D. & H. CONSULTING SERVICES INC.
1900 SOUTHBAY ROAD ,
SUDBURY ONTARIO P3E 6H7
THE REGISTERED OWNER OF S1197772, S1197773, S1197695, S1197774,
S1197397, LOCATED IN THE SUDBURY MINING DIVISION RECEIVED
PERMISSION FROM O.M.N.D.M. ON NOVEMBER 8, 95 FOR ENVIRONMENTAL
CLEAN UP AND THE REMOVAL OF A 14,500 M.T. OF MINERALIZED ROCK AS
A BULK SAMPLE .

PRIOR TO COMMENCEMENT OF WORK ON THE BULK SAMPLE PROJECT D. &
H. CONSULTING SERVICES INC. DESIGNATED CONTRACTOR SOUTHBAY
DESIGN & CONSTRUCTION LTD. TOGETHER WITH REPRESENTATIVES OF
O.M.N.D.M. VISITED THE PROJECT SITE TO DETERMINE THE LOCATIONS
FOR THE BULK SAMPLE AND TO COLLECT WATER SAMPLES FOR
ANALYSIS.

SUBSEQUENT TO THIS AND BEFORE WORK ON THE BULK SAMPLE
COMMENCED SOUTHBAY DESIGN ON BEHALF OF D. & H. CONSULTING
COLLECTED, PACKAGED AND DELIVERED TO FALCONBRIDGE FOR
CHEMICAL ANALYSIS ROCK FROM THE PROPERTY . (RESULTS ATTACHED)

SOUTHBAY 'S BULK SAMPLE WORK WAS CARRIED OUT BETWEEN MAY 31,
95 AND JULY 28, 95. DURING THIS PERIOD A TOTAL OF FIFTEEN DAYS
WERE SPENT ON ENVIRONMENTAL CLEANUP. THE FIFTEEN DAYS SPENT
ON ENVIRONMENTAL CLEANUP ARE NOT LISTED FOR ASSESSMENT WORK
CREDIT.

LOCATION & ACCESS (SEE ATTACHED MAP)

THE PROPERTY IS LOCATED ON THE NORTH SHORE OF AGNEW LAKE. IT IS REACHED BY TRAVELING WEST ON HWY. # 17 FROM SUDBURY TO THE VILLAGE OF MC KERROW, A DISTANCE OF 42 MILES , THENCE NORTH, NORTH EAST ON HARDWOOD ROAD FOR A DISTANCE OF SOME THREE MILES TO THE LAKE LANDING , THEN BY BOAT/BARGE FOR A DISTANCE OF APPROXIMATELY 700 FT..

BULK SAMPLE PROJECT / BACK GROUND

WORK WAS CARRIED OUT FOR A TOTAL OF FORTY ONE DAYS BETWEEN MAY 29, 95 AND JULY 27, 95 .

SOUTH BAY DESIGN & CONSTRUCTION LTD. WAS DESIGNATED BY D. & H. CONSULTING INC. TO CARRY OUT THE TOTAL PROGRAM.

FROM 1969 TO 1970 THE FORMER SPANISH RIVER MINES LTD. REMOVED 146,316 TONS OF ORE FROM ITS WORKINGS ON THE PROPERTY. THE AREA WAS LEFT WITH WASTE ROCK, ORE, STEEL, TIN, OLD VEHICLES, PIPES AND OTHER DEBRIS SCATTERED OVER THE ENTIRE WORK SITE. TO DATE SOME NINETY PERCENT OF THE DEBRIS IS CLEARED AND REMOVED FROM THE PROPERTY. STRIPPING BED ROCK TRENCHING WAS CARRIED OUT BY A CREW OF SIX WORKING WITH A 2.5 YD. AND A 8 YD. LOADERS, SLEDGES, ROCK HAMMERS AND WHEEL BARROWS, COBBED SELECT AND STOCKPILED MINERALIZED ROCKS FOR THE BULK SAMPLE. AS WALLS AROUND AN EXCAVATED AREA LEFT OPEN BY SPANISH RIVER MINES WERE STEEP AND DANGEROUS TO WORK AROUND A ROCK TRENCH 40 FT. X 60 FT. X 30 FT. DEEP WAS ESTABLISHED (LAYOUT, DRILLED, BLASTED AND MUCKED SKETCH # 4) FOR ACCESS TO MINERALIZED ROCKS IN AND AROUND THE OLD EXCAVATED AREA. ONCE BROKEN COBBED AND PILED, THE BULK SAMPLE PRODUCT WAS APPROVED AND LOADED FOR DELIVERY TO THE MAIN STOCK PILE AREA. FROM THIS AREA THE PRODUCT WAS LOADED ON TO 20 TON TRUCKS THAN ONTO A BARGE FOR DELIVERY TO THE MAIN LOADOUT STOCKPILE ESTABLISHED ON THE MAINLAND. THIS MAINLAND STOCKPILE AREA 75 FT. X 75 FT. WAS CLEARED AND COVERED WITH GEOTEXTILE FABRIC TO AVOID CONTAMINATION.

MINERALIZATION OF BULK SAMPLE PRODUCT

CHALCOPYRITE PYRITES AND PYRRHOTITE OCCURS AS MASSIVE BLEBS, STRINGERS AND DISSEMINATED IN SILICIFIED QUARTZ AND IN GREYWACKE AND CONGLOMERATE. TOTAL SULFIDES CONTENT RANGES FROM 60 - 20 PERCENT.

SURVEYING

A TRANSIT WAS USED TO LAYOUT THE BOUNDARY FOR THE TRENCH AREA; WHILE A DUMPY LEVEL AND STADIA ROD WERE USED TO ESTABLISH LEVELS AROUND THE OLD EXCAVATED AREA.

A TOTAL OF SOME 200 TONS OF BULK SAMPLE MATERIAL WAS DELIVERED TO MAIN LOADOUT STOCKPILE AREA WHILE SOME 5,000 TONNES COBBED AND UNCOBBED REMAIN AT THE PROJECT SITE. THE RATIO OF MINERALIZED ROCK SUITABLE AS BULK SAMPLE PRODUCT, TO WASTE ROCK WAS DETERMINED TO BE IN THE ORDER OF 1-20. WORK WAS SUSPENDED ON JULY 25, 95 TO BE CONTINUED AT A LATER DATE.

EXPENSES

EXPENSES RELATED TO BULK SAMPLE - FOR ASSESSMENT WORK

-BULK SAMPLE WORK PERIOD MAY 31,95 TO JULY 28,95(43 WORKING DAYS)

SOUTHBAY DESIGN & CONSTRUCTION LTD. OF P.O. BOX 1094 STN: B SUDBURY, ONTARIO P3E 4S6 AND 230 FIELDING ROAD LIVELY, ONTARIO WAS CONTRACTED BY D. & H. CONSULTING SERVICES INC. TO SUPPLY THE NECESSARY MANPOWER EQUIPMENT AND SUPPORT SUPPLIES NECESSARY TO COLLECT THE BULK SAMPLE.

SOUTHBAY WAS CONTRACTED AT A FLAT RATE OF \$960 PER WORKING DAY FOR MANPOWER THEIR SUPPLIES AND TRANSPORTATION TO AND FROM THE SITE AND AT A COST PLUS 15 % FOR MOBILIZATION, DEMOB, INSTRUMENTS, HEAVY EQUIPMENT , BOAT / MOTOR, FUEL, AND DRILLING & BLASTING SUB-CONTRACTED

MAY 31 95 DAY # 1- MARK UP ORE AREA, COBBED AND STOCKPILED ORE AROUND PIT AREA.

JUNE 1 95 DAY # 2--CONTINUE AS DAY # 1, DELIVERED LOADERS TO PROJECT SITE

JUNE 2 95 DAY # 3--CONTINUE COBBING AND STOCKPILING ; DELIVERED TRAILER AND FUEL CONTAINER (FOR EQUIP FUEL SUPPLY) TO SITE

JUNE 3 95 DAY # 4--MARK UP ORE AND WASTE AREA ON RAMP EAST SIDE OF OLD EXCAVATION , COBBED AND STOCKPILED ORE

JUNE 4 95 DAY # 5--AS DAY # 4

JUNE 5 95 DAY # 6--AS ABOVE

JUNE 6 95 DAY # 7--MORE MUCK FROM F/WALL AREA DELIVERED TO SORTING PAD NEAR ADIT AREA COBBED ORE. REMOVED WASTE FROM RAMP AREA AND DELIVERED TO WASTE STOCKPILE AREA . ESTABLISHED 15 DEGREE RAMP SLOPE.

JUNE 7 95 DAY # 8--CONTINUE MUCKING ON RAMP AND ORE COBBING.

JUNE 8 95 DAY # 9--AS ABOVE

JUNE 9 95 DAY # 10-COBBING ON EAST AND N.E. SIDES OF STOCKPILE ESTABLISHED NEAR ADIT.

JUNE 10 95 DAY #11-RAIN NO WORK

JUNE 11 95 DAY #12-NO WORK, ENVIRONMENTAL CLEAN UP

JUNE 12 95 DAY #13-REMOVE WASTE FROM RAMP AREA SORTING AND
COBBING PREPARE LOAD OUT ORE PAD (75 FT. X 75 FT)
ACROSS LAKE

JUNE 13 95 DAY #14-COMPLETE LAYOUT PAD - CONTINUED COBBING

JUNE 14 95 DAY #15-DELIVERED AIR TRACK DRILL TO SITE, LAYOUT ROCK
TRENCH AREA AND ESTABLISH LEVELS, COBBING
CONTINUED.

JUNE 15 95 DAY #16-PREPARE SURVEY SKETCH, COBBING AROUND OLD
EXCAVATION AREA

JUNE 16 95 DAY #17-LAYOUT DRILL HOLES FOR ROCK TRENCH, CONTINUED
COBBING ORE AROUND OLD EXCAVATION AREA

JUNE 17 95 DAY #18-NO WORK-ENVIRONMENTAL CLEANUP

JUNE 18 95 DAY #19-DITTO ABOVE

JUNE 19 95 DAY #20-TRANSPORT COB ORE TO OLD CONCRETE PAD ACROSS
FROM ADIT. DRILLING CONTINUING ON ROCK TRENCH
AREA, COBBED AROUND OLD EXCAVATION.

JUNE 20 95 DAY #21-ESTABLISH LEVELS, ROCK TRENCH DRILLING,
CONTINUE COBBING AT OLD EXCAVATION, & AT ADIT
STOCKPILE.

JUNE 21 95 DAY #22-NO WORK-ENVIRONMENTAL CLEAN UP.

JUNE 22 95 DAY #23-ROCK TRENCH DRILLING & COBBING AT OLD
EXCAVATION AREA

JUNE 23 95 DAY #24-AS ABOVE

JUNE 24 95 DAY #25-NO WORK-ENVIRONMENTAL CLEAN UP.

JUNE 25 95 DAY #26-NO WORK-ENVIRONMENTAL CLEAN UP.

JUNE 26 95 DAY #27-BARGED HOE & FUEL ACROSS LAKE, COBBING &
SORTING CONTINUES

JUNE 27 95 DAY #28-COBBING & SORTING.

JUNE 28 95 DAY #29-SAME AS ABOVE.

JUNE 29 95 DAY #30-COBBING & SORTING, ESTABLISHED MORE LEVELS
AROUND OLD EXCAVATED AREA FOR ROCK TRENCH
DRILLING.

JUNE 30 95 DAY #31-TRENCH DRILLING , COBBING & SORTING.

JULY 1 95 DAY # 32-NO WORK-ENVIRONMENTAL CLEANUP

JULY 2 95 DAY # 33-SAME AS ABOVE

JULY 3 95 DAY # 34-SAME AS ABOVE.

JULY 4 95 DAY # 35-SAME AS ABOVE

JULY 5 95 DAY # 36-DELIVERED COMPRESSOR & POWDER, COBBED &
SORTED AT ADIT AREA.

JULY 6 95 DAY # 37-NO WORK, ENVIRONMENTAL CLEAN UP.

JULY 7 95 DAY # 38-NO WORK, ENVIRONMENTAL CLEAN UP.
 JULY 8 95 DAY # 39-NO WORK, ENVIRONMENTAL CLEAN UP.
 JULY 9 95 DAY # 40-DELIVERED OIL, HOSES & FUEL, COBBING & SORTING.
 JULY 10 95 DAY #41-MORE FUEL DELIVERED, COBBING & SORTING, BLAST
 TRENCH.
 JULY 11 95 DAY #42-DIRECTED TRENCH MUCKING, COBBING & SORTING
 TRENCH MUCK-JOHN ROBINSON OF O.M.N.D.M. VISITED
 SITE FOR INSPECTION.
 JULY 12 95 DAY #43-DELIVERED FUEL TO SITE, COBBING & SORTING ON
 TRENCH STOCKPILE.
 JULY 13 95 DAY #44-AS ABOVE.
 JULY 14 95 DAY #45-AS ABOVE.
 JULY 15 95 DAY #46-AS ABOVE
 JULY 16 95 DAY #47-NO WORK DAY.
 JULY 17 95 DAY #48-AS DAY #46.
 JULY 18 95 DAY #49-TRENCH SORTED ORE TO CONCRETE PAD, CONTINUED
 COBBING & SORTING AT TRENCH AREA.
 JULY 19 95 DAY #50-AS DAY #49.
 JULY 20 95 DAY #51-REMOVE WASTE FROM TRENCH AREA, COBBED &
 SORTED.
 JULY 21 95 DAY #52-NO WORK DAY.
 JULY 22 95 DAY #53-NO WORK DAY.
 JULY 23 95 DAY #54-NO WORK DAY.
 JULY 24 95 DAY #55-AS DAY #51.
 JULY 25 95 DAY #56-SORTING & COBBING TRENCH AREA.
 JULY 26 95 DAY #57-AS ABOVE
 JULY 27 95 DAY #58-AS ABOVE

1. 41- 8 HOUR DAYS FOR SAMPLING@ \$960.00 / DAY =	\$39,360.00
2. SURVEY & LEVEL INSTRUMENTS =	575.00
3. DRILL/BLAST CONTRACTOR =	24,443.72
4. 2 1/2 & 8 YD. LOADER 6HRS/DAY WITH OPERATOR FOR 40 DAYS @ \$160/HR.=	38,400.00
5. MOBILIZATION & DEMOBILIZATION=	2,500.00
6. GEOTEXTILE PAD FLOOR,45 GAL. DRUMS=	800.00
7. WATER SAMPLE ANALYSIS, SAMPLE=	1,600.00
8. FALCONBRIDGE SAMPLE=	680.00
TOTAL	108,358.72

**DELIVERY OF MATERIAL TO FALCONBRIDGE
FOR CHEMICAL ANALYSIS**

AS CONTAINED IN THE BODY OF THE ASSESSMENT WORK REPORT, PRIOR TO COMMENCEMENT OF WORK ON THE REMOVAL OF THE BULK SAMPLE, 2-45 GAL. DRUMS WEIGHING APPROXIMATELY 800 LBS EACH WERE PRODUCED AND DELIVERED BY SOUTH BAY DESIGN ON BEHALF OF D & H CONSULTING TO FALCONBRIDGE FOR CHEMICAL ANALYSIS.

THE FOLLOWING DETAILS THE SAMPLE DELIVERY:

CONTRACTOR: SOUTH BAY DESIGN & CONSTRUCTION LTD.
P.O. BOX 1094, STN. B SUDBURY, ONT. P3E 4S6
230 FIELDING RD. LIVELY.

PERIOD SEPT. 22, & OCT 3, 94

DIRECT COST

STRAIGHT TIME	360.00
45 GAL. DRUMS	80.00
TRANSPORTATION	120.00
BOAT & MOTOR	120.00
TOTAL	680.00

COLLECTION OF WATER SAMPLE ANALYSIS

SAMPLES TO:

- 1) A.J. PERON (VIRGINIATOWN ONTARIO)
- 2) HAILEYBURY SCHOOL OF MINES (HAILEYBURY ONTARIO)
- 3) EGO/COBALTEC (COBALT ONTARIO)

ON OCT.6 & 7, 94; SOUTH BAY ON BEHALF OF D & H COLLECTED WATER SAMPLES WHICH WERE DELIVERED TO INCO FOR ANALYSIS AND THREE 50LB. SELECTED MUCK SAMPLES WHICH WERE DELIVERED TO HAILEYBURY SCHOOL OF MINES NEW LISKEARD, A.J. PERON & EGO/COBALTEC FOR ANALYSIS. D & H AWAITS RESULTS FROM 1 & 2, RESULTS FROM 3 ARE ATTACHED.

TOTAL COST----- \$ 1,600.00

ASSESSMENT WORK COST/CATEGORY

D & H CONSULTING SERVICES INC.
BALDWIN TOWNSHIP BULK SAMPLE PROJECT
CONTRACTOR: SOUTH BAY DESIGN & CONSTRUCTION LTD.
P.O. BOX 1094 STN. B SUDBURY, ONT. P3E 4S6
230 FIELDING RD. LIVELY

PROJECT PERIOD - MAY 31, 95 TO JULY 25, 95

ITEMS	COST
1) WATER SAMPLE ANALYSIS & COLLECTION & DELIVERY OF TEST SAMPLES TO HAILEYBURY SCHOOL OF MINES, A.J. PERON, EGO/COBALTEC	\$1,600.00 (other authorized work category)
2) BULK SAMPLE DIRECT COST	108,358.72 (Physical work category)
3) FALCONRIDGE SAMPLE	680.00 (Assay category)
TOTAL	110,638.72

INVOICE

Page: 1

SOUTHBAY DESIGN & CONSTRUCTION LTD.
 P.O. Box 1094, Station "B"
 SUDBURY, Ontario
 P3E 4S6

Phone (705)682-0687 Fax (705)682-0690

Sold to:
 D & H Consulting Services Inc.
 1900 Southbay Road
 SUDBURY, Ontario
 P3E 6H7

Ship to:

P.O.#:
 Packing Slip#:
 Invoice#: 960732
 Attention:

Shipped via:
 Terms:
 Date: Jul 31,96
 Job #:

Account	Description	Amount	GST	Total
402	RE BALDWIN TOWNSHIP PROJECT FIELD SUPERVISION, CONSULTING WITH REGARDS TO BULK SAMPLE WATER SAMPLES & COLLECTION & DELIVERY OF TEST SAMPLES SUPERVISION AT PROJECT, OFFICE EXPENSES, COMPRESSOR, HAMMERS, HANDLES, RAIN COATS, BOOTS, SAFETY LINES & BELTS, TRUCK RENTAL, TRANSPORTAION, SIGNS, OPERATOR CHARGES, OILS & FUELS	110,638.72	7,744.71	118,383.43
	GST #R104939095			
Totals		110,638.72	7,744.71	118,383.43

DELIVERY OF MATERIAL TO FALCONBRIDGE
FOR CHEMICAL ANALYSIS

AS OCNTAINED IN THE BODY OF THE ASSESSMENT WORK REPORT, PRIOR TO COMMENCEMENT OF WORK ON THE REMOVAL OF THE BULK SAMPLE, 2-45 GAL. DRUMS WEIGHING APPROXIMATELY 800 LBS EACH WERE PRODUCED AND DELIVERED BY SOUTH BAY DESIGN ON BEHALF OF D & H CONSULTING TO FALCONBRIDGE FOR CHEMICAL ANALYSIS.

THE FOLLOWING DETAILS THE SAMPLE DELIVERY:

CONTRACTOR: SOUTH BAY DESIGN & CONSTRUCTION LTD.
P.O. BOX 1094, STN. B SUDBURY, ONT. P3E 4S6
230 FIELDING RD. LIVELY.

PERIOD SEPT. 22, & OCT 3, 94

DIRECT COST

STRAIGHT TIME	360.00
45 GAL. DRUMS	80.00
TRANSPORTATION	120.00
BOAT & MOTOR	120.00
TOTAL	680.00

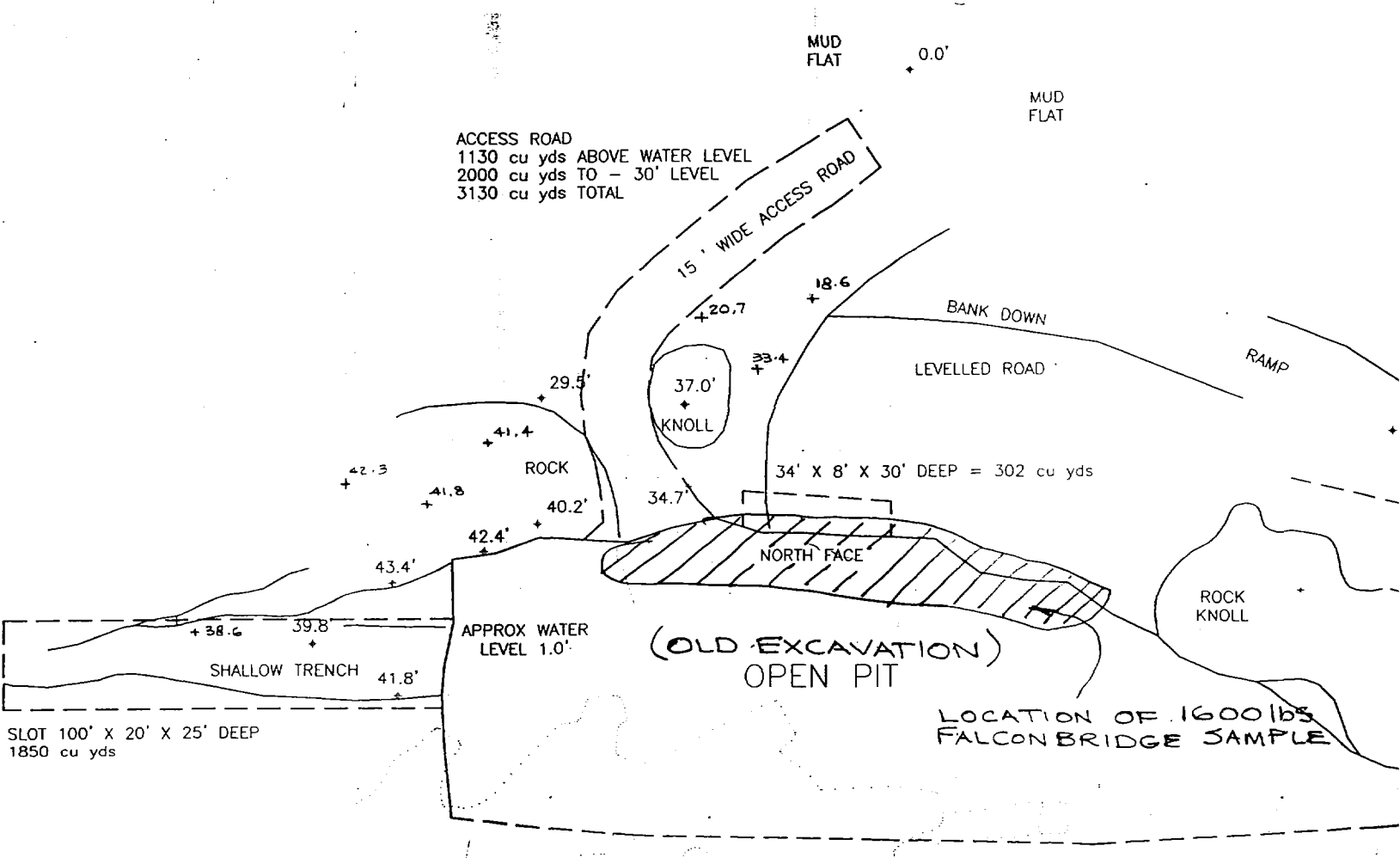

LOCATION OF 1600 lbs FALCON BRIDGE SAMPLE

D&H CONSULTING LOCATION 1600 lbs SAMPLE

RANDOM SAMPLE ^{Dang}

REPORT No. : AUG8094.C94 Reference : Spanish River Ore

As discussed - Give
a call if you have
questions

M. White

```

<sysdata> ~PC~E0180040.C~
<datetime> ~1994-09-09~15:25:00~
<sampdat> ~O~FALASSAY~OFF~OE018~9447033~
<cmsdoc> ~OE018~
<lab> ~LAKEFIELD~

```

```

<dv> ~Co~%~0.04~
<dv> ~Cu~%~2.73~
<dv> ~Ni~%~0.03~0.003<Ni<0.03~
<dv> ~Al~%~0.60~
<dv> ~As~%~0.10~
<dv> ~B ~%~0.0050~B<0.0050~
<dv> ~Bi~%~0.0003~Bi<0.0003~
<dv> ~Br~%~0.002~<0.002~
<dv> ~Ca~%~0.01~0.001<Ca<0.01~
<dv> ~Cd~%~0.0050~Cd<0.0050~
<dv> ~Cl~%~0.01~<0.01~
<dv> ~Cr~%~0.003~0.0003<Cr<0.003~
<dv> ~F~%~0.01~<0.01~
<dv> ~Fe~%~4.20~
<dv> ~Hg~%~0.001~<0.001~
<dv> ~Li~%~0.0050~Li<0.0050~
<dv> ~LOI~%~0.50~<0.50~
<dv> ~Mg~%~0.15~
<dv> ~Mn~%~0.01~0.001<Mn<0.01~
<dv> ~Mo~%~0.001~0.0001<Mo<0.001~
<dv> ~Na~%~0.03~0.003<Na<0.03~
<dv> ~P ~%~0.030~P<0.030~
<dv> ~Pb~%~0.0003~Pb<0.0003~
<dv> ~S~%~4.34~
<dv> ~Sb~%~0.0050~Sb<0.0050~
<dv> ~Se~%~0.023~
<dv> ~Si~%~40.0~
<dv> ~Sn~%~0.0025~Sn<0.0025~
<dv> ~Te~%~0.030~Te<0.030~
<dv> ~V ~%~0.0010~V<0.0010~
<dv> ~W ~%~0.020~W<0.020~
<dv> ~Zn~%~0.003~0.0003<Zn<0.003~
<dv> ~K~%~0.31~
<dv> ~Th~%~0.03~0.003<Th<0.03~
<dv> ~Ti~%~0.003~0.0003<Ti<0.003~
<dv> ~Ag~ppm~5.0~
<dv> ~C(I)~%~0.06~
<dv> ~CN~%~0.001~<0.001~
<dv> ~NO3~%~0.01~<0.01~
<dv> ~pH~(Ratio)~4.31~
<dv> ~Rd~N/A~N.D.~
<dv> ~SO4~%~0.50~

```

<end-of-file>

LAKEFIELD RESEARCH

A Division of Falconbridge Limited
P.O. Box 4300, 185 Concession St., Lakefield, Ontario, K0L 2H0
Phone : 705-652-2000 - FAX : 705-652-6365

AVERAGE

Falconbridge Limited, Smelter
Sudbury Operations
Falconbridge, Ontario, POM 1SO - Canada

Lakefield, October 14, 1994

Attn : Mr. Dan Freeman
Fax : 705-693-2215

Date Rec. : October 3, 1994
LR. Ref. : OCT8005.C94
Reference : Spanish River Ore SRCM #2
Project : 9447441-L-LOTSCAN

CERTIFICATE OF ANALYSIS

Element	OFF-02003
Ag [g/t]	3.0
Cu [%]	1.74
Al [%]	2.62
As [%]	0.035
Br [%]	< 0.002
C(t) [%]	0.05
Cl [%]	< 0.01
CN [%]	< 0.001
F [%]	< 0.001
Fe [%]	3.05
Hg [%]	< 0.001
K [%]	1.83
LOI [%]	< 0.50
Mg [%]	0.27
Moisture [%]	0.13
NO3 [%]	< 0.01
Pb [%]	0.013
pH	3.36
Radiact.	N.D.
S [%]	2.80
Se [%]	0.012
Si [%]	38.0
SO4 [%]	0.95

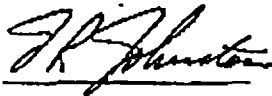

J. R. Johnston

A MEMBER OF IAETL CANADA

Accredited by CAEAL for specific tests registered with the Association

10/18/94 14:50 705 693 2153
10/17/94 MON 07:53 FAX 705 2 6441

PLANTS OFFICE
LEFLD RESEARCH

004/00
000

LAKEFIELD RESEARCH

A Division of Falconbridge Limited
P.O. Box 4300, 185 Concession St., Lakefield, Ontario, K0L 2H0
Phone : 705-652-2000 - FAX : 705-652-6366

HIGH GRADE

Falconbridge Limited, Smelter
Sudbury Operations
Falconbridge, Ontario, POM 150 - Canada

Lakefield, October 14, 1994

Attn : Mr. Dan Freeman
Fax : 705-693-2215

Date Rec. : October 5, 1994
LR. Ref. : OCT8006.C94
Reference : Spanish River Ore SRCM #3-1
Project : 9447442-L-LOTSCAN

CERTIFICATE OF ANALYSIS

Element	OFF-OZ004
Ag [g/t]	14.0
Cu [%]	8.77
Al [%]	0.25
As [%]	0.11
Br [%]	< 0.002
C(t) [%]	0.04
Cl [%]	< 0.01
CN [%]	< 0.001
F [%]	< 0.01
Fe [%]	10.7
Hg [%]	< 0.001
LOI [%]	< 0.50
Moisture [%]	0.11
NO ₃ [%]	< 0.01
Pb [%]	0.0034
pH	3.37
Radioact.	N.D.
S [%]	12.2
Se [%]	0.024
Si [%]	33.3
SO ₄ [%]	0.73



J. R. Johnston

A MEMBER OF IAETL CANADA

Accredited by CAEAL for specific tests registered with the Association



Ontario

Mining Act

Personal information collected on this form is obtained under the authority of the Mining Act. This information will be used for correspondence. Questions about this collection should be directed to the Provincial Manager, Mining Lands, Ministry of Northern Development and Mines, Fourth Floor, 159 Cedar Street, Sudbury, Ontario, P3E 6A5, telephone (705) 670-7264.

2.16796

- Instructions:
- Please type or print and submit in duplicate.
 - Refer to the Mining Act and Regulations for rec Recorder.
 - A separate copy of this form must be complete
 - Technical reports and maps must accompany tl
 - A sketch, showing the claims the work is assign



41105SE0019 2.16796 PORTER

900

Recorded Holder(s) D & H CONSULTING SERVICES INC.		Client No. 300592
Address 1900 SOUTHBAY RD. SUD. ONT. P3E 6H7		Telephone No. 705-682-0688
Mining Division SUDBURY	Township/Area BALDWIN & PORTER	Mining Plan No. 3003 & 2865
Dates Work Performed From: SEPT/22/94 to OCT/03/94		

Work Performed (Check One Work Group Only)

Work Group	Type
Geotechnical Survey	
Physical Work, Including Drilling	
Rehabilitation	
Other Authorized Work	
Assays	2-45 GALLON BARRELS (1600LBS) SAMPLES TO FALCONBRIDGE
Assignment from Reserve	

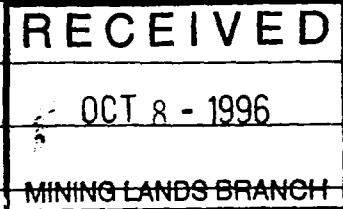

Total Assessment Work Claimed on the Attached Statement of Costs \$ **680.00**

Note: The Minister may reject for assessment work credit all or part of the assessment work submitted if the recorded holder cannot verify expenditures claimed in the statement of costs within 30 days of a request for verification.

Persons and Survey Company Who Performed the Work (Give Name and Address of Author of Report)

Name	Address
SOUTHBAY DESIGN & CONSTRUCTION	230 FIRMDING RD. LIVELY ONT.

(attach a schedule if necessary)

Certification of Beneficial Interest * See Note No. 1 on reverse side

I certify that at the time the work was performed, the claims covered in this work report were recorded in the current holder's name or held under a beneficial interest by the current recorded holder.	Date AUG/16/96	Recorded Holder or Agent (Signature) <i>[Signature]</i> AGENT.
--	--------------------------	---

Certification of Work Report

I certify that I have a personal knowledge of the facts set forth in this Work report, having performed the work or witnessed same during and/or after its completion and annexed report is true.		
Name and Address of Person Certifying DOUG EDMONDSON - 1900 SOUTHBAY RD. SUD. ONT. P3E 6H7		
Telephone No. 705-682-0688	Date AUG/16/96	Certified By (Signature) <i>[Signature]</i>

For Office Use Only

Total Value Cr. Recorded Received 8680.00	Date Recorded AUGUST 19/96	Mining Recorder <i>[Signature]</i>	Received Stamp SUDBURY MINING DIV. RECEIVED AUG 19 1996 A.M. P.M. 7 8 9 10 11 12 1 2 3 4 5 6
	Deemed Approval Date November 17/96	Date Approved <i>[Signature]</i>	
Date Notice for Amendments Sent			

Total Number of Claims	Total Report Number for Mining Claims	Claim Number (see item 2)	Number of Claim Bills
5	549287	919772	10
			2
			4
			2
			2

Total Value from Bills	Total Value from Other	Value of Assessment Work Done on the Claim	Value Applied to the Claim
680	0	\$680	—

RECEIVED
 OCT 8 - 1996
 MINING LANDS BRANCH

Total Applied from the Claim	Total Applied from Other	Amount Due to be Claimed at a Future Date
680	0	680

Credits you are claiming in this report may be cut back. In order to minimize the adverse effects of such deletions, please indicate from which claims you wish to prioritize the deletion of credits. Please mark (✓) one of the following:

- Credits are to be cut back starting with the claim listed last, working backwards.
- Credits are to be cut back equally over all claims contained in this report of work.
- Credits are to be cut back as prioritized on the attached appendix.

In the event that you have not specified your choice of priority, option one will be implemented.

Note 1: Examples of beneficial interest are unrecorded transfers, option agreements, memorandum of agreements, etc., with respect to the mining claims.

Note 2: If work has been performed on patented or leased land, please complete the following:

I certify that the recorded holder had a beneficial interest in the patented or leased land at the time the work was performed.	Signature	Date
---	-----------	------

2.16796

ASSESSMENT WORK COST/CATEGORY

D & H CONSULTING SERVICES INC.
BALDWIN TOWNSHIP BULK SAMPLE PROJECT
CONTRACTOR: SOUTH BAY DESIGN & CONSTRUCTION LTD.
P.O. BOX 1094 STN. B SUDBURY, ONT. P3E 4S6
230 FIELDING RD. LIVELY

PROJECT PERIOD - MAY 31, 95 TO JULY 25, 95

ITEMS	COST
1) WATER SAMPLE ANALYSIS & COLLECTION & DELIVERY OF TEST SAMPLES TO HAILEYBURY SCHOOL OF MINES, A.J. PERON, EGO/COBALTEC	\$1,600.00 (other authorized work category)
2) BULK SAMPLE DIRECT COST	108,358.72 (Physical work category)
3) FALCONRIDGE SAMPLE	680.00 (Assay category)
TOTAL	110,638.72

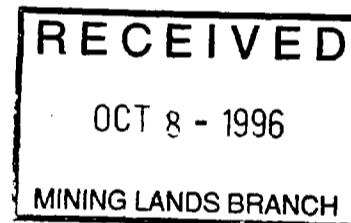

Ministry of
Northern Development
and Mines

Ministère du
Développement du Nord
et des Mines



November 13, 1996

Roy Denomme
Mining Recorder
933 Ramsey Lake Road, 3rd Floor
Sudbury, ON
P6E 6B5

Geoscience Assessment Office
933 Ramsey Lake Road
6th Floor
Sudbury, Ontario
P3E 6B5

Telephone: (705) 670-5853
Fax: (705) 670-5863

Dear Sir or Madam:

Submission Number: 2.16796

Subject: Transaction Number(s): W9670.00137

After reviewing the Work Report(s) we have prepared this letter and the attached summary, which lists the results of our review. Requirements of the Assessment Work Regulation may not have been fully met. Please examine the summary to determine the next course of action concerning the identified Work Report(s).

NOTE: The 90 day deemed approval provision, subsection 6(7) of the Assessment Work Regulation, is no longer in effect for this submission.

PLEASE NOTE ANY REQUESTED REVISIONS MUST BE SUBMITTED IN DUPLICATE.

If the anniversary dates for the mining claims affected by this correspondence have not passed, a number of options are available. Please contact the Mining Recorder to discuss these options.

If you have any questions regarding this correspondence, please contact Lucille Jerome at (705) 670-5858.

Yours sincerely,

A handwritten signature in black ink, appearing to read "Ron C. Gashinski".

ORIGINAL SIGNED BY
Ron C. Gashinski
Senior Manager, Mining Lands Section
Mines and Minerals Division

Work Report Assessment Results

Submission Number: 2.16796

Date Correspondence Sent: November 13, 1996

Assessor: Lucille Jerome

Transaction Number	First Claim Number	Township(s) / Area(s)	Status	Approval Date
W9670.00137	1197772	BALDWIN, PORTER	Approval	November 13, 1996

Section:

17 Assays ASSAY

Correspondence to:

Mining Recorder
Sudbury, ON

Resident Geologist
Sudbury, ON

Assessment Files Library
Sudbury, ON

Recorded Holder(s) and/or Agent(s):

Doug Edmondson
SUDBURY, ONTARIO, CANADA

D & H CONSULTING SERVICES INC.
SUDBURY, ONTARIO

MAP SYMBOLS

AREAS WITHDRAWN FROM DISPOSITION

M.R.O. - MINING RIGHTS ONLY				
S.R.O. - SURFACE RIGHTS ONLY				
M+S - MINING AND SURFACE RIGHTS				
Description	Order No.	Date	Disposition	File
	W 2/83	31/3/83	S.R.O.	77094

NOTES

Area shown thus CL1664 under Water Power Lease Agreement No. 110, File No. 3214 - Surface Rights Withdrawn.

Lots 2 to 6 inclusive and 8 to 12 inclusive Con. V and Lots 1 to 11 inclusive Con VI, subject to Section 109 of the Mining Act, (R.S.O. 1980)

E 1/2 of NE 1/4 of S 1/2 of LOT 1, CON. 6 Mining Rights Withdrawn by Order in Council, dated 9 January, 1945. File No. 9296

* Section 30(b) Application
March 20, 1992

† S.R.O. OPENED JUNE 1992

THE INFORMATION THAT APPEARS ON THIS MAP HAS BEEN COMPILED FROM VARIOUS SOURCES, AND ACCURACY IS NOT GUARANTEED. THOSE WISHING TO STAKE MINING CLAIMS SHOULD CONSULT WITH THE MINING RECORDER, MINISTRY OF NORTHERN DEVELOPMENT AND MINES, PORTLAND, ONTARIO. INFORMATION ON THE STATUS OF THE LANDS SHOWN HEREON.

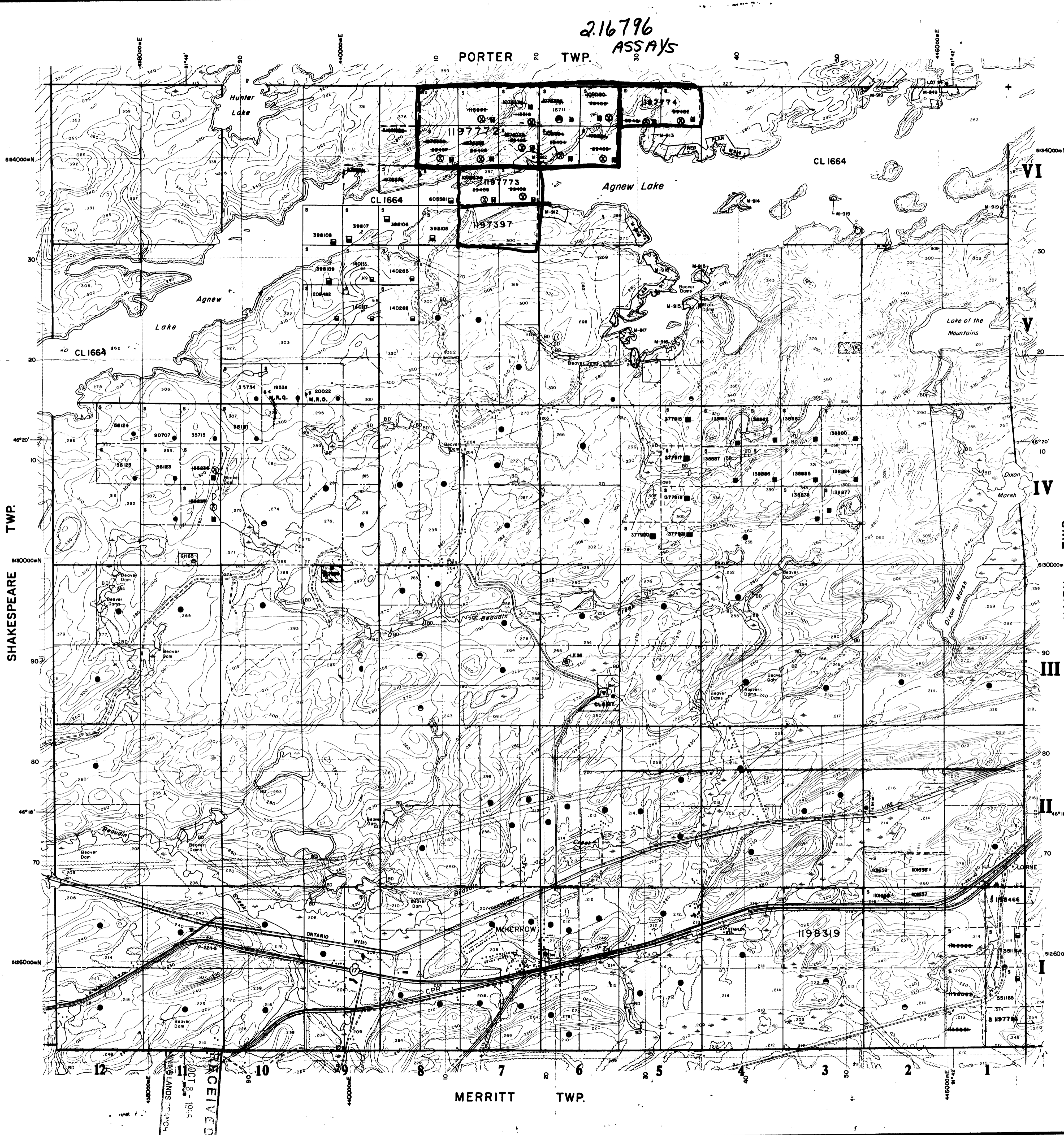

LEGEND

HIGHWAY AND ROUTE No.	
OTHER ROADS	
TRAILS	
SURVEYED LINES:	
TOWNSHIPS, BASE LINES, ETC.	
LOTS, MINING CLAIMS, PARCELS, ETC.	
UNSURVEYED LINES:	
LOT LINES	
PARCEL BOUNDARY	
MINING CLAIMS ETC.	
RAILWAY AND RIGHT OF WAY	
UTILITY LINES	
NON-PERENNIAL STREAM	
FLOODING OR FLOODING RIGHTS	
SUBDIVISION OR COMPOSITE PLAN	
RESERVATIONS	
ORIGINAL SHORELINE	
MARSH OR MUSKEG	
MINES	
TRAVERSE MONUMENT	

DISPOSITION OF CROWN LANDS

TYPE OF DOCUMENT	SYMBOL
PATENT, SURFACE & MINING RIGHTS	
" SURFACE RIGHTS ONLY	
" MINING RIGHTS ONLY	
LEASE, SURFACE & MINING RIGHTS	
" SURFACE RIGHTS ONLY	
" MINING RIGHTS ONLY	
LICENCE OF OCCUPATION	
ORDER-IN-COUNCIL	
RESERVATION	
CANCELLED	
SAND & GRAVEL	

NOTE: MINING RIGHTS IN PARCELS PATENTED PRIOR TO MAY 6, 1913, VESTED IN ORIGINAL PATENTEE BY THE PUBLIC LANDS ACT, R.S.O. 1970, CHAP. 200, SEC. 63, SUBSEC. 1.

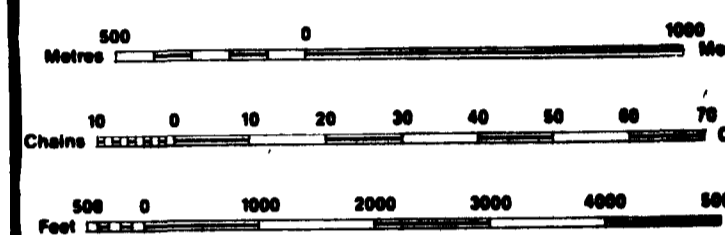

SCALE 1:20 000
GRID ZONE 17

JUNE 1ST. OPENINGS
ONTARIO GAZETTE VOL. 22-18
MAY 6TH 1988

NE PART OF N PART BROKEN LOT 5 CON. 4
NW PART OF N PART BROKEN LOT 5
SECONDLY CON. 6

NE PART OF N PART BROKEN LOT 6 CON. 6
NW PART N PART OF BROKEN LOT 6 CON. 6
SE PART N PART OF BROKEN LOT 6 CON. 6
SW PART N PART OF BROKEN LOT 6 CON. 6

NE PART N PART OF BROKEN LOT 7 CON. 6
NW PART N PART OF BROKEN LOT 7 CON. 6
SE PART N PART OF BROKEN LOT 7 CON. 6
SW PART N PART OF BROKEN LOT 7 CON. 6

NE PART S PART OF BROKEN LOT 7 CON. 6
NW PART S PART OF BROKEN LOT 7 CON. 6
SE PART N PART OF BROKEN LOT 8 CON. 6
NE 1/4 OF S 1/2 LOT 8 CON. 4

2.16796

TOWNSHIP
BALDWIN DATE OF ISSUE
M.N.R. ADMINISTRATIVE DISTRICT AUG 19 1996
ESPANOLA
MINING DIVISION
SUDBURY
LAND TITLES / REGISTRY DIVISION
SUDBURY

Ministry of Natural Resources
Ontario

Land Management Branch

Original Compilation: JULY, 1985
Revised: _____

Number
G-3003

RECEIVED
MAY 11 1996