

Rec. in Sudbury off.

Feb. 24/70



ONTARIO

THE MINING ACT REPORT OF WORK

A separate form is required for each type of work to be recorded

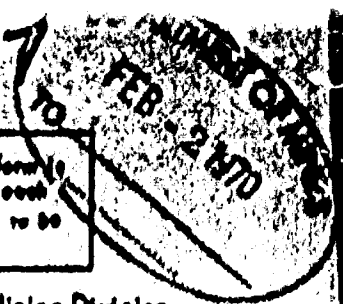

#17

To the Recorder of Sudbury Mining Division

1. STANLEY GRIMSELL C-289-13
Name of Recorded Holder Miner's Licence

R.R.#2 WORTHINGTON ONTARIO
Post Office Address

do hereby report the performance of 68 days of DRILLING, BLASTING & MUCKING
type of work

not before reported to be applied on the following contiguous claims

Claim No.	Days	Claim No.	Days	Claim No.	Days
<u>153484</u>	<u>34</u>
<u>153483</u>	<u>34</u>
.....
.....
.....



010

All the work was performed on Mining Claim (s) 153484 Nairn Township
(In the case of geological and/or geophysical survey (s) where more than 18 claims are involved attach a schedule)

READ CAREFULLY: THE FOLLOWING INFORMATION IS REQUIRED BY THE MINING RECORDER.

- For Manual Work, Stripping or Opening up of Mines, Sinking Shafts or Other Actual Mining Operations - Names and addresses of the men who performed the work and the dates and hours of their employment.
- For Diamond and other Core Drilling - Footage, No. and angle of holes and diameter of core. Name and address of owner or operator of drill. Dates when drilling was done. Signed core log and sketch in duplicate.
- For Compressed Air or Other Power Driven or Mechanical Equipment - Type of drill or equipment. Names and addresses of men engaged in operating equipment and the dates and hours of their employment.
- For Power Stripping - Type of equipment. Name and address of owner or operator. Amount expended. Dates on which work was done. Proof of actual cost must be submitted within 30 days of recording.
- With each of the above types of work sketches are required to show the location and extent of the work in relation to the nearest claim post. In the case of diamond or other core drilling the sketch must be submitted in duplicate.
- For Geological and Geophysical Survey - The names and addresses of men employed as well as dates. Type of instrument used in the case of geophysical survey. Reports and maps in duplicate must be filed with the Minister within 60 days of recording.
- For Land Survey - the name and address of Ontario Land surveyor.

The Required Information is as Follows: (Attach a list if this space is insufficient)

- STANLEY GRIMSELL - WORTHINGTON, ONT.
- TRD BRICK - NAIRN CENTER, ONT.
- LONEL CRICK - NAIRN CENTER, ONT.
- WILLIAM ALLEN - NAIRN CENTER, ONT.
- WIND JARVIS - WORTHINGTON, ONT.
- DON RASTALL - SUDBURY, ONT.

Date Jan 30 1970

Stanley Grimsell
Signature of Recorded Holder or Agent

The Mining Act Certificate Verifying Report of Work

Stanley Grimsell
R.R.#2 WORTHINGTON Ontario
(Post Office Address)

hereby certify:

- That I have a personal and intimate knowledge of the facts set forth in the report of work annexed hereto, having performed the work or witnessed same during and/or after its completion.
- That the annexed report is true.

Date Jan 30

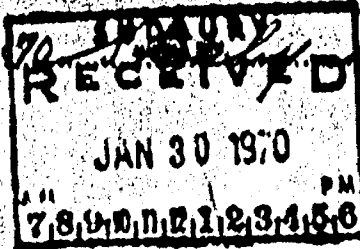

Stanley Grimsell
Signature

5.153483

THE PENALTY FOR MAKING A FALSE STATEMENT IN THIS REPORT AND/OR CERTIFICATE IS \$500. OR SIX MONTHS IMPRISONMENT OR BOTH

NAIRN TOWNSHIP.

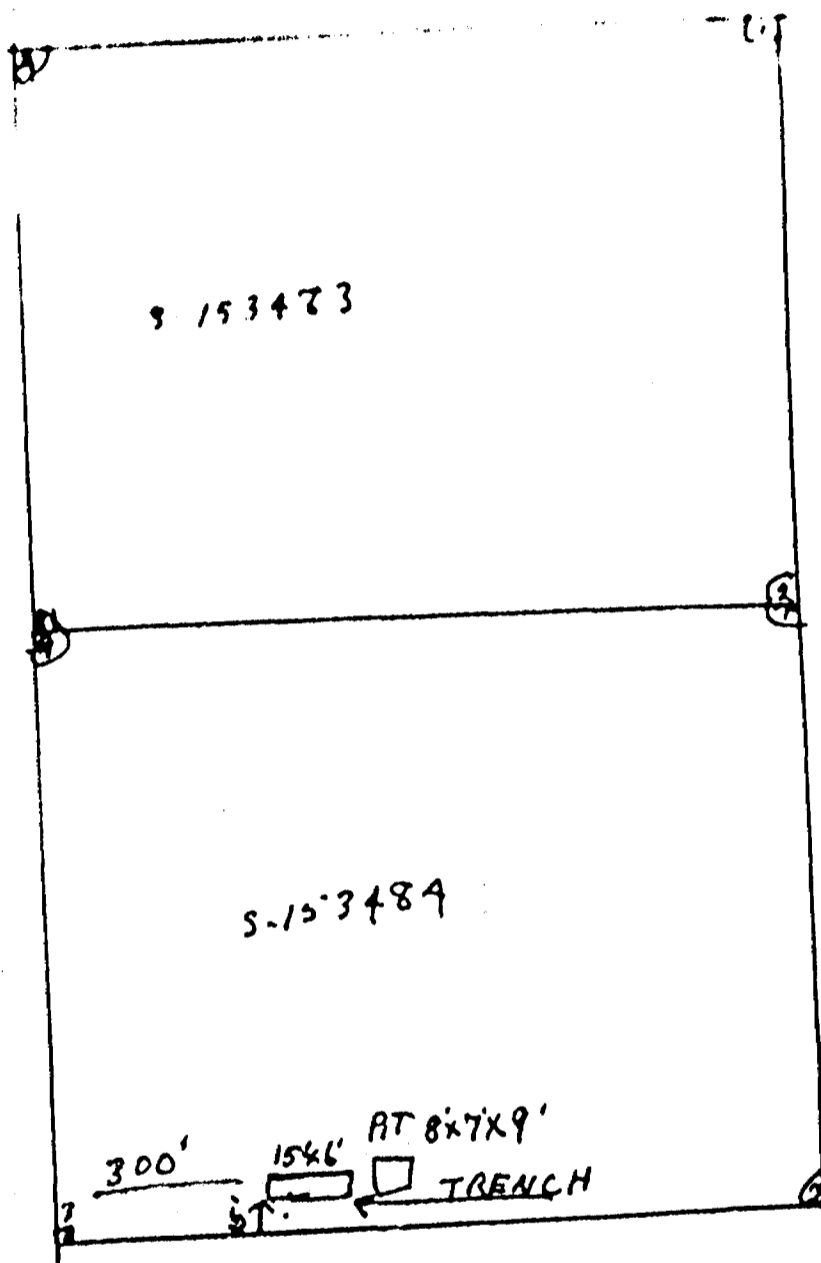

SUDBURY

SUDBURY
MINING DIVISION

SCALE: 1-INCH = 40 CH

NARN TWP.

SCALE: 1" = 40 CH

LEGEND

- UNDEVELOPED LAND
- CROWN LAND SALE
- LEASES
- UNDEVELOPED LAND
- LICENSE OF OCCUPATION
- MINING RIGHTS ONLY
- SURFACE RIGHTS ONLY
- ROADS
- IMPROVED ROADS
- KING'S HIGHWAYS
- RAILWAYS
- POWER LINES
- MARSH OR MUSKEG
- MINES
- CANCELLED

NOTES

400' Surface Rights Re
around all Lakes and F
Area Shown This
RIGHTS Only Withdrawn from
Sec 42 of the Mining Act
File: 77208

SURFACE RIGHTS Only Re
Dept of L. B. F. in South May
and all of Lot 9 Con 11 Sho
File: 77198

Handwritten signature

PLAN NO. M.883

ONTARIO
DEPARTMENT
AND NORTHERN

1575-100-111-645

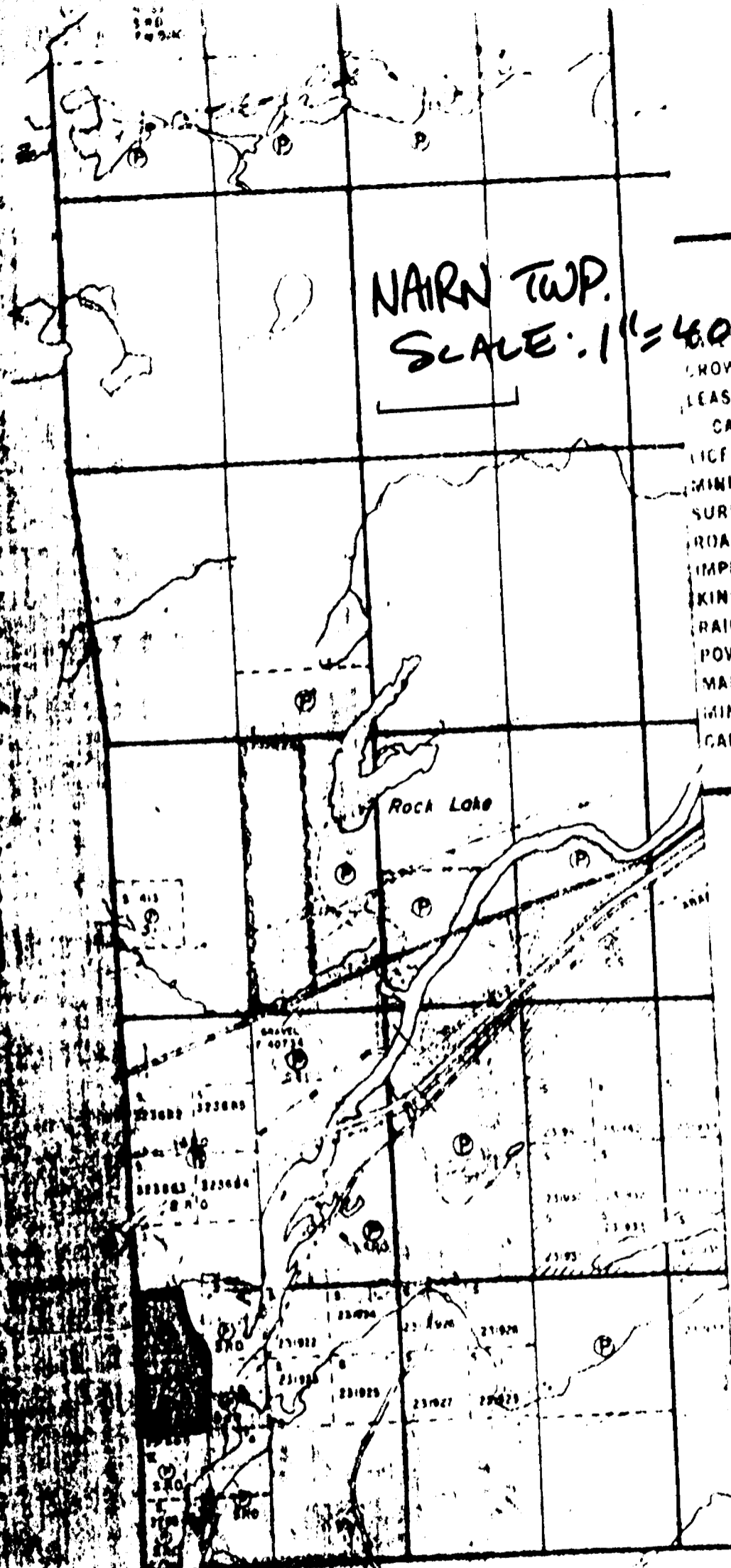

ONTARIO