



41I05SE2001 2.19502 NAIRN

010

REPORT ON ASSESSMENT WORK

For

JAMES PETER OWEN

Baldwin-Nairn Property

September 1, 1999

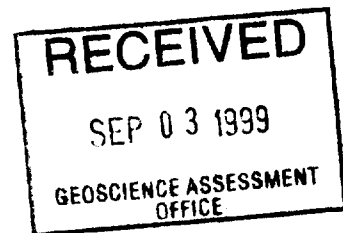

Mineral Project Management

W. G. Cooper

2.19502

TABLE OF CONTENTS

Item	Page
1) Purpose of the Report	2
2) Description of the Property	2
3) Access to the Property	3
4) Description of the Assessment Work	3
5) Market Investigation	5
6) Geology	7
Appendices	
Appendix 1	Qualifications Resume of W. G. Cooper, R. Adlington, Frank Racicot
Appendix 2	Certificate of Analysis - XRAL Laboratories
Appendix 3	Invoices for Work - OCL Trucking & Excavation Ltd.
Appendix 4	Letters of Interest
Appendix 5	Additional Reports - R. Adlington - Frank Racicot
Appendix 6	Map



41I05SE2001 2.19502 NAIRN

010C

CERTIFICATE

I, William Gerald Cooper do hereby certify that I am a graduate of the Provincial Institute Mining at Haileybury, Ontario. I have been continuously employed in the mining industry since my graduation in 1954; in technical, supervisory and executive positions, all as described in the attached résumé.

This report is based on:

- 1) Information, both written and verbal, supplied to me by Mr. James Owen.
- 2) Area geology and topography as shown on Ontario Ministry of Mines maps 1951-1, 2062, and topographical maps of the Ministry of Natural Resources, Land Management Branch Nos. G2976 and G3003.
- 3) My personal examination of the property and location of the surface pits.

Signed:

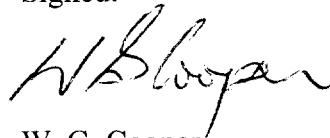

W. G. Cooper
September 1, 1999

REPORT ON ASSESSMENT WORK FOR JAMES PETER OWEN

PURPOSE OF THE REPORT:

This report has been prepared to meet the requirements of the GeoScience Assessment Office of the Ministry of Northern Development and Mines as per Submission Number 2.19502; Transaction Number W9970.00202 dated July 20, 1999.

The report has been prepared by William Gerald Cooper, principal of Mineral Resource Management of Orillia, Ontario. Cooper's qualifications are contained in his résumé which is listed as Appendix 1. The work was supervised by Mr. James P. Owen, of 55 Ipswich Crescent, Willowdale, ON. M2J 3N4 who has supplied most of the information herein.

DESCRIPTION OF THE PROPERTY:

The property consists of the following mining claim numbers:

551165:	Mining lease status, 16 ha in area
551164:	Mining lease status, 16 ha in area
1214624:	4 claim units in area
1214625:	1 claim unit, 16 ha in area
1214626:	1 claim unit, 16 ha in area

Claim nos. 551165, 551164, 1214625 and 1214626 are located in the south east corner of Baldwin Township, in Lot 1, Concession I. Claim no. 1214624 is located in the south west corner of Nairn Township, in Lot 12, Concession I. All are within the Sudbury Mining Division. These claims are registered in the name of James Peter Owen, client no. 178581, 55 Ipswich Crescent, Willowdale, Ontario. Mr. Owen is applying to register the assessment work described in this report and to apply the work assessment credit to the claim units not under mining lease.

ACCESS:

Access to the claims is via Highway 17, east from Sudbury to Nairn Centre; to the Jacklin Road. About 1.2 kilometers south of Highway 17 on the Jacklin Road, one turns left onto a short access road which is located on the property.

DESCRIPTION OF WORK:

James Owen has held these claims since 1980, originally as a prospect for nickel and gold. More recently he has been seeking to establish a commercial deposit of diabase rock for highway aggregate and for monumental stone. Sometime previous to this assessment period, samples had been taken by "Rock of Ages", a building stone manufacturing group in Quebec. The polished stone samples were very impressive. This encouraged Mr. Owen to continue his prospecting on the property. Some of the polished samples are on display in the Willett Green Centre, 933 Ramsay Lake Road in Sudbury, Ontario.

During the periods of July 2 to October 23, 1997, and May 1 to June 25, 1998, heavy equipment was mobilized to the property to clear and strip four areas; and to sink 2 test pits to determine the quality of the rock.

A sample of the rock from these pits was submitted in the aggregate to XRAL Laboratories for general mineral analysis in 1997. The analysis were performed in order to determine the presence of impurities which would make the stone unacceptable for road bed and building products. No problems were encountered. The Certificate of Analysis and the invoice for the lab work is attached as Appendix 2 to this report.

The clearing, stripping and trenching were carried out by OCL Trucking and Excavating Ltd. of Nairn Centre, Ontario, under the supervision of Mr. J. Odnokon, president of the company, and under the direction of James Owen. The work was carried out intermittently between July 2 and October 23, 1997 and between May 1 and June 25, 1998. The total number of hours of operation on the property, and the items of equipment employed were as follows:

Float to transport equipment from Nairn Centre to and from property	
16 hours @ \$65.00/hr.	\$1,040.00
1 ¾ yard Excavator (Backhoe)	
104 hours @ \$11.00/hr.	11,440.00

D6 Cat Bulldozer	
64 hours @ \$90.00/hr.	5,760.00
Air Compressor and Rock Drill	
88 hours @ \$75.00/hr.	6,600.00
(All equipment rates include an operator)	
SUBTOTAL	\$24,840.00
+ GST	<u>1,738.80</u>
TOTAL COST	\$26,578.80

The invoices are listed in Appendix 3 of this report.

The work carried out resulted in the clearing and stripping of a total of approximately 0.4 hectares in 5 separate locations. These are indicated on the map (Appendix 6).

In order to determine the suitability of the stone for monument purposes, the removal of 3 blocks of "Black Granite" was planned. Two blocks were removed from Pit "A". The dimensions of these blocks were approximately 4' x 4' x 8'. One of these broke up in handling and was returned to the property. The second, of approximately the same dimensions was removed and shipped to Sterling Cutting and Coring in Mississauga, Ontario for examination. This resulted in cutting and polishing tests and were positive.

The third block was removed from Pit "B". This block was approximately 2' x 4' x 4' and was shipped to Khouri Granite Limited of Sudbury, Ontario for evaluation. Their comments are attached in Appendix 4 of this report.

More recently, Mr. Owen engaged K. H. Harvey and Raymond Bowes to locate the mining claim boundaries and to mark up a 15 meter buffer zone inside the claims in Baldwin Township. The invoices for this work are attached in Appendix 3 of this report.

MARKETABILITY

Mr. Owen then began a prospecting "sales trips" to determine the marketability of the stone, both as a road aggregate material and as a source of building and monumental stone. As a result of his enquiries he has received a positive response from the following:

* Accurate Ceramics and Marble, Toronto, Ontario
(building stone)

* D. Crupi & Sons Limited, Agincourt, Ontario
(trap rock aggregates)

* Crystal Tile & Marble Ltd., North York, Ontario
(building products – decorative stone)

* Khouri Granite Limited, Sudbury, Ontario
(monumental stone)

* Lafarge Construction Materials/ North eastern Div., Gloucester, Ontario
(traprock aggregates)

Maple Terrazzo Marble & Tile Inc., Woodbridge, Ontario
(building products – decorative stone)

CR Marble and Craft Ltd., Toronto, Ontario
(building products – decorative stone)

* Moscone Tile Ltd., Weston, Ontario
(building products – decorative stone)

* North-Tech Stone & Ceramic Inc., Sudbury, Ontario
(architectural stone)

Park Lawn Cemeteries Co. Ltd., Toronto, Ontario
(monumental stone)

Pave-Al Limited, Mississauga, Ontario
(surface asphalt)

Porital Marble and Ceramic Ltd., Woodbridge, Ontario
(architectural and monumental stone)

* York Marble, Tile and Terrazzo Ltd., Toronto, Ontario
(architectural and decorative stone)

Those interested parties who have followed up their interest with a letter are marked *. Copies of these letters are included in Appendix 4.

GEOLOGY:

The topography of the claim group is that of a steep ridge running north-south, with the crest of the ridge located 100 - 125 meters east of the Township Line between Baldwin and Nairn Townships. This ridge is covered with light forest on the west side. Further west on the claim group, the ground is covered by a swampy forested overburden of undetermined depth. About 100 meters east of the Jacklin Road the ridge rises from the overburden. Although there are a considerable number of outcrops in this hill, it has been necessary to strip light to medium overburden to inspect and to sample the gabbro-diorite in order to evaluate its qualities as an industrial mineral. It is on the west side of the ridge that five such pits have been stripped and examined; there are four older pits where the structure has been examined for sulphides; and one which was sunk to examine traprock. On the east side of the ridge the topography is very steep. A cliff drops some 50 meters to the Spanish River, and about half of the east boundary of the property is in the River.

The geology of the ridge is essentially a basic intrusive rock and has been described by R. M. Ginn and Jas. E. Thomson as a gabbro diorite of Keweenaw or earlier age. It is this rock that is described as "black granite" in the monument trade and referred to by several interested stone manufacturers. (See letters.)

On the east side of the claim group, below the cliff, the older sedimentary rocks are present. These have been described as an argillaceous greyrock by R. M. Ginn in "Geological Report No. 35, Nairn and Lorne Townships".

Two geological reports have been submitted to Mr. James Owen: These are:

- 1) "Description of the Quarry Stone" submitted by R. Adlington - Geologist
- 2) "Fracture and Density Report" submitted by Frank Racicot - Geologist.

These reports address the suitability of the rock for building, road and monumental stone relative to colour, shine and fractures. The reports are attached as Appendix 5.

No extensive diamond drilling has been carried out to determine an actual reserve of the suitable stone for the various products. However, it can be seen that the hill or ridge above the elevation of the Jacklin Road contains in excess of 81,000,000 metric tonnes presuming all rock is suitable for the requirements. More detailed work will be required after quarrying begins in order to separate the various products.

APPENDIX 1

RESUME OF EXPERIENCE

WILLIAM GERALD COOPER

William Gerald Cooper is an experienced mining executive and operating manager. He is currently 66 years of age and is semi-retired, spending much of his time in mining consulting and evaluating possible acquisitions. He is a director of two junior mining companies and the president and principal shareholder of Mireman Inc., a private company with the objective of evaluating and pursuing entrepreneurial mining opportunities.

EMPLOYMENT HISTORY

- 1990 to 1992 **DEAK RESOURCES CORPORATION**
President, Chief Executive Officer, Director of this junior mining company (and of its subsidiary, GSR Mining Corporation) during which time the company grew from a small exploration group with some base metal properties to a producer operating a 1000-ton per day gold mine and a 2000-ton gold mill, utilizing its surplus capacity to custom mill for other gold mines in the northern Ontario/northwestern Quebec area. The Deak operations had achieved a modest operating profit during Mr. Cooper's last year of tenure as President.
- 1974 to 1990 **MINING CORPORATION OF CANADA LIMITED**
A mining project development group, subsidiary of Noranda Inc.
- 1974 to 1975 **Manager - Mining Development**
- 1975 to 1978 **Manager of Operations**
- 1978 to 1980 **General Manager**
- 1980 to 1990 **Vice President and General Manager**
Functioned as Chief Operating Officer of the company, building it to the profile of \$40,000,000 in mine development projects annually, expanding or down-sizing business as required by the mining climate. Responsible for the expansion from the northern Ontario area into all mining areas of Canada, the United States, South America and Africa (Ghana). Under the direction of Mr. Cooper, Mining Corporation carried out project engineering and mining contracts on an international basis including some World Bank projects.

- 1965 to 1974 RIO ALGOM MINES LTD., Mines de Poirier, Joutel, Quebec
Mr. Cooper joined Rio Algom Mines as Mine Captain at Mines de Poirier, a base-metal operation of Rio Algom Mines Ltd.
- 1966 **General Mine Foreman** with responsibility for all mine development and production.
Through subsequent promotions to **Underground Superintendent** and **Mine Superintendent**, he was ultimately promoted to **General Superintendent** with responsibility for all engineering and production for the mine. During Mr. Cooper's time at Mines de Poirier, he was responsible for the development of an 1800-ton base metal producer (copper and zinc), the ongoing production of the mine and its administration which included the winning of two major safety awards.
- 1964 to 1965 QUEMONT MINING CORPORATION LTD., Noranda, Quebec
Layout Engineer for all mining methods employed at Quemont, a major base and precious metal producer.
- 1957 to 1964 FARADAY URANIUM MINES LTD. Bancroft, Ontario
Shift Boss and Mine Captain, supervising mining operations at this medium-sized uranium mine.
- 1956 to 1957 LYNDHURST MINING COMPANY LTD., Duparquet, Quebec
Mine Engineer responsible for all engineering functions at this small base metal (copper) operation.
- 1955 to 1956 CANADIAN JOHNS-MANVILLE COMPANY LTD., Matheson, Ontario
Assistant Engineer, responsible for surveying and technical services for this major asbestos producer.
- 1954 to 1955 BEATTIE-DUQUESNE MINES LTD., Duparquet, Quebec
Surveyor and Engineer-Trainee at this major gold producer.

EDUCATION

- 1976 University of Western Ontario, London, Ontario
Management Training Course, attended and completed the course for general management
- 1954 The Provincial Institute of Mining, (Halleybury School of Mines), Halleybury, Ontario
Graduated In Mining Technology

CERTIFICATE

I, Richard Adlington, do hereby certify that:

1. I was graduated from the University of Manitoba in 1950 with a B. Sc. (Hons) degree.
2. I have practised my profession as a geologist since 1950.
3. I have no interest, direct, indirect, or expected, in the property of J. Owen.
4. This report is based on:
 - (a) My personal examination of a portion of the property in October, 1980.
 - (b) Areal geology as shown on Ontario Geological Survey Map 2361, Sudbury-Cobalt Geological Compilation Series.
 - (c) My knowledge of the geology of the Sudbury district acquired since 1950.

July 1, 1981

Signed: R. Adlington

787 Attlee Ave.
Sudbury, Ont., P3E 3H5

STATEMENT OF QUALIFICATIONS

This is to certify that I, Frank Racicot, have obtained a BSc in geology from Laurentian University in 1974 and have worked in the field in part or whole for ten field seasons.

signed

Frank Racicot

Aug 18/88

Frank Racicot

APPENDIX 2



XRAL Laboratories
A Division of SGS Canada Inc.

1885 Leslie Street
Don Mills, Ont.
Canada M3B 3J4
Telephone (416) 445-5755
Fax (416) 445-4152

CERTIFICATE OF ANALYSIS
REPORT 14342

TO: JIM OWEN
UNIT 22
72 DOUSAY PLACE
SCARBOROUGH

CUSTOMER No. 3278

DATE SUBMITTED
15-Jul-97

WORKORDER 16111-

TOTAL PAGES 1

2 ROCKS

	METHOD	DETECTION	METHOD		METHOD	DETECTION	METHOD
		LIMIT	CODE			LIMIT	CODE
AU-1AT PPB	FADCP	5.	FA-30	ZN PPM	ICP	.5	ICP-70
BE PPM	ICP	.5	ICP-70	AS PPM	ICP	3.	ICP-70
NA %	ICP	.01	ICP-70	SR PPM	ICP	.5	ICP-70
MG %	ICP	.01	ICP-70	Y PPM	ICP	.5	ICP-70
AL %	ICP	.01	ICP-70	ZR PPM	ICP	.5	ICP-70
P %	ICP	.01	ICP-70	MO PPM	ICP	1.	ICP-70
K %	ICP	.01	ICP-70	AG PPM	ICP	.2	ICP-70
CA %	ICP	.01	ICP-70	CD PPM	ICP	1.	ICP-70
SC PPM	ICP	.5	ICP-70	SN PPM	ICP	10.	ICP-70
TI %	ICP	.01	ICP-70	SB PPM	ICP	5.	ICP-70
V PPM	ICP	2.	ICP-70	BA PPM	ICP	1.	ICP-70
CR PPM	ICP	1.	ICP-70	LA PPM	ICP	.5	ICP-70
MN PPM	ICP	2.	ICP-70	W PPM	ICP	10.	ICP-70
FE %	ICP	.01	ICP-70	PB PPM	ICP	2.	ICP-70
CO PPM	ICP	1.	ICP-70	BI PPM	ICP	5.	ICP-70
NI PPM	ICP	1.	ICP-70	PT-1AT PPB	FADCP	10.	FA-30
CU PPM	ICP	.5	ICP-70	PD-1AT PPB	FADCP	1.	FA-30

*** UNLESS INSTRUCTED OTHERWISE WE WILL DISCARD PULPS IN 90 DAYS ***
AND REJECTS IN 30 DAYS FROM THE DATE OF THIS REPORT

DATE 24-JUL-97

CERTIFIED BY 
Dr. Hugh de Souza, General Manager

ELEMENT	METHOD	METHOD CODE	1-QB	2-B	1-QB-D
AU-1AT PPB	FADCP	FA-30	1	11	2
BE PPM	ICP	ICP-70	<.5	<.5	<.5
NA %	ICP	ICP-70	.07	.09	.07
MG %	ICP	ICP-70	<.01	1.57	<.01
AL %	ICP	ICP-70	.03	2.45	.03
P %	ICP	ICP-70	<.01	.02	<.01
K %	ICP	ICP-70	<.01	.14	<.01
CA %	ICP	ICP-70	.02	.02	.02
SC PPM	ICP	ICP-70	<.5	<.5	<.5
TI %	ICP	ICP-70	<.01	<.01	<.01
V PPM	ICP	ICP-70	10	46	10
CR PPM	ICP	ICP-70	231	95	238
MN PPM	ICP	ICP-70	30	361	31
FE %	ICP	ICP-70	.30	5.75	.31
CO PPM	ICP	ICP-70	<1	147	<1
NI PPM	ICP	ICP-70	9	247	9
CU PPM	ICP	ICP-70	4.2	6090	5.0
ZN PPM	ICP	ICP-70	<.5	310	<.5
AS PPM	ICP	ICP-70	<3	<3	<3
SR PPM	ICP	ICP-70	1.2	3.1	1.1
Y PPM	ICP	ICP-70	<.5	2.0	<.5
ZR PPM	ICP	ICP-70	1.0	<.5	1.0
MO PPM	ICP	ICP-70	2	6	2
AG PPM	ICP	ICP-70	<.2	2.0	<.2
CD PPM	ICP	ICP-70	<1	<1	<1
SN PPM	ICP	ICP-70	<10	<10	<10
SB PPM	ICP	ICP-70	<5	<5	<5
BA PPM	ICP	ICP-70	3	44	3
LA PPM	ICP	ICP-70	<.5	5.7	<.5
W PPM	ICP	ICP-70	<10	<10	<10
PB PPM	ICP	ICP-70	3	21	3
BI PPM	ICP	ICP-70	<5	INF	<5
PT-1AT PPB	FADCP	FA-30	<10	<10	<10
PD-1AT PPB	FADCP	FA-30	<1	15	<1

AU-1AT PPB - ASSAY PERFORMED ON 30 GRAM ALIQUOT

PT-1AT PPB - ASSAY PERFORMED ON 30 GRAM ALIQUOT

PD-1AT PPB - ASSAY PERFORMED ON 30 GRAM ALIQUOT

D - QUALITY CONTROL DUPLICATE

INF - COMPOSITION MAKES DETECTION IMPOSSIBLE BY THIS METHOD



XRAL Laboratories
A Division of SGS Canada Inc.

1885 Leslie Street
Don Mills, Ont.
Canada M3B 3J4
Telephone (416) 445-5755
Fax (416) 445-4152

UPPER CONCENTRATION LIMITS HAVE BEEN EXCEEDED

Some of the results in this report are outside the applicable analytical range. Please refer to the table below or the current Schedule of Fees and Services for our recommended upper concentration limits. Results greater than the upper concentration limit are reported for the convenience of our clients but are of poor precision and/or subject to interferences.

Please contact us for additional technical information or for an accurate determination by an appropriate technique.

Method Code	Instrument	Element	Upper Limit	Comments
ICP-70	ICP/AA	Ag	10ppm	See note below
ICP-70 ICP-80	ICP	32 elements	5,000 ppm	As, Sb, Bi, W, La may be affected for samples with >10% Cu, Zn or >25% Fe.
XRF-7	XRF	25 elements	4,000 ppm	Matrix dependent. Not suitable for concentrates or highly mineralized samples.
CHM-20	Cold Vapour	Hg	100 ppm	
AAH-3	AA-Hydride	Sb,As,Bi	200 ppm	
ES-4	DCP-Fusion	Be, B, Ge, V	2,000 ppm	
GFAA-10	GFAA	Cd,Se,Te	200 ppm	
CHM-13 CHM-10	Specific Ion	Cl F	5000ppm 1%	
ICPMS-10	ICPMS	In	4,000 ppm	

Note:

Method code ICP-70 utilizes a nitric aqua regia digestion. Silver may precipitate from solution as a chloride and may be underestimated. A fire assay determination for silver is recommended.

APPENDIX 3

James P. Owen
55 Ipswich Crescent,
Willowdale, ON. M2J 3N4

SUMMARY OF EXPENSES

RE: ASSESSMENT WORK

OCL Trenching and Excavating Ltd	
July 2 to Oct. 23, 1997.	16,092.80
May 1 to June 25, 1998	10,486.00
XRAL Laboratories	60.03
Ken H. Harvey	112.35
Raymond M. Bowes	75.00
Ken H. Harvey	157.29
W. G. Cooper	2,044.06
James Owen - Transportation and Lodging	<u>1,162.87</u>
TOTAL	\$30,190.40

OOL TRUCKING & EXCAVATING LTD.

P.O. Box 158 Naim Centre, Ont
 POM 2L0
 Tel: (705) 869-1022
 Fax: (705) 869-5303

N2 001995

TO: Jim Owen

INVOICE DATE
 November 3, 1997

BOUNTS BY
 J. Odnokon

CUSTOMER ORDER NO.	DATE SHIPPED	SHIPPED VIA	FOB POINT
QUANTITY	DESCRIPTION	UNIT PRICE	TOTAL
72 hrs	Rental of excavator from July 2 to Oct.23, 1997.	\$ 110.00	\$ 7,920.00
8 hrs	Floating equipment from July 2 to Oct. 23, 1997	\$ 65.00	\$ 520.00
40 hrs	Rental of Dozer for your pit in Baldwin/Naim Quarry from July 2 to Oct. 23, 1997.	\$ 90.00	\$ 3,600.00
40 hrs	Rental of Air Compressor and rock drill from July 2 to Oct. 23, 1997.	\$ 75.00	\$ 3,000.00
			\$ 15,040.00
TERMS:		G.S.T. #R133806067	G.S.T. 1,052.80
			SUBTOTAL \$ 16,092.80
			P.S.T.



XRAL Laboratories
A Division of SGS Canada Inc.

Mail:
P.O. Box 9581
Station 'A'
Toronto, Ont.
M6W 2K3

courier:
1885 Leslie St.
Don Mills, Ont.
M3B 3J4

Invoice To:
JIM OWEN
UNIT 22
72 DOUSAY PLACE
SCARBOROUGH

Invoice Date: 24-Jul-97
Work Order No.: 16111
Date Submitted: 15-Jul-97
Report No.: 14342
Customer No.: 3278-1/390686
Your P.O. No.:
Your Project No.:

Submitted To:
JIM OWEN
UNIT 22
72 DOUSAY PLACE
SCARBOROUGH

NO. OF PKGS	SHIPPED VIA	WAY BILL NO.	SHIPPED FROM		TYPE OF SAMPLES
			SELF	ROCK	
QUANTITY	DESCRIPTION METHOD		CODE NUMBER	UNIT COST	AMOUNT
1. 2	AU (FA-30/5)		10 0 0 0 0	10.00	20.00
2. 2	PD,PT (FA-30/5)		10 0 0 0 0	2.80	5.60
3. 2	ICP PKG. (ICP70)		4 9 0 0 0	8.15	16.30
4. 2	CRUSHING		1 0 0 0 0	2.90	5.80
5. 2	MILLING		1 0 0 0 0	2.65	5.30
6. 2	SILICA SAND CLEANER		1 0 0 0 0	1.55	3.10
GST REG NO. R105082572 APPLIED TO \$56.10					3.93
MISC. CHARGES	SHIPPING CHARGES	CUSTOM BROKERAGE	TELEX/FAX	MINIMUM CHARGES	
	OTHER	C.O.D.		SURCHARGE - RUSH SERVICE	

PAID
15 July 97

ORIGINAL INVOICE

TOTAL IN > CDN FUNDS \$ 60.03



Member of the SGS Group (Société Générale de Surveillance)



K.H. Harvey
Forestry

242 Algoma St.
Espanola, Ontario, P5E 1H7
(705) 869-4933

May 19, 1999

Tree Marking, Boundary Lines
& Forest Management

Attention: Mr. Jim Owens

Invoice Re: Locating mining claim boundaries and a 15 m buffer inside the boundary Lot 1 Conc. 1, Baldwin Twp.

Claim boundaries marked with red paint and the 15 m buffer zone marked with pink ribbon. Sketch attached.

5 hours @ \$15.00/hr	\$75.00	
6 rolls pink flagging ribbon @ \$2.00/roll	12.00	
4 cans red pain @ \$4.50/can	<u>18.00</u>	
Total		\$105.00
GST (Registration No. 87080 3046)		<u>7.35</u>
Total of this invoice		\$112.35

*Pd. by cheque
May 20/99*

K.H. Harvey

Ken. H. Harvey

**LEE VALLEY FORESTRY
CONSULTANT**

RAYMOND M. BOWES
602 LEE VALLEY ROAD
MASSEY, ON
POP 1 P0
(705) 865-2261

May 19, 1999

Attention: Mr. Jim Owens

Ray M. Bowes INVOICE _____

RE: Assisting with boundary marking Lot 1 Conc. 1, Baldwin Twp.

5 hours @ \$15.00/hour

\$75.00



K.H. Harvey
Forestry

242 Algoma St.
Espanola, Ontario, P5E 1H7
(705) 869-4933

Tree Marking, Boundary Lines
& Forest Management

May 27, 1999
Invoice No. 002

Attention: Mr. Jim Owens

Invoice Re: Boundary and road location, Baldwin Twp.

Monday, May 24		
4 hours @ \$15.00/hr	\$60.00	
2 rolls flagging tape @ \$2.00/roll	4.00	
Wednesday, May 26		
5 hours @ \$15.00/hr	75.00	
4 rolls flagging tape @ \$2.00/roll	<u>8.00</u>	
Total		\$147.00
GST (Registration No. 87080 3046)		<u>10.29</u>
Total of this invoice		\$157.29

*Paid by cheque.
May 27/99
K.H. Harvey*

K.H. Harvey
Ken. H. Harvey

MINERAL PROJECT MANAGEMENT

15 Hepinstall Pl.
Orillia, Ontario
L3V 6H2

Mr. James P. Owen
55 Ipswich Crescent,
Willowdale, ON.
M2J 3N4

September 1, 1999

Dear Mr. Owen;

I attach the report on assessment work for the Ministry of Northern Development and Mines as requested. My invoice for the preparation of this report and the map is:

5 days @ \$400.00 per day	\$2,000.00
Secretarial Services	<u>44.06</u>
TOTAL	

Hoping you find the above satisfactory,

I remain,

Yours very truly,



W. G. Cooper

APPENDIX 4

Accurate

Ceramics & Marble Corporation

182 TURBINE DRIVE
WESTON, ONT. M9L 2S2

Nov. 15, 1996

Jim Owen
72 Dusay Place, Unit 22
Scarborough, Ontario
M1W 2N2

Dear Mr. Jim Owen:

I am pleased to see that you are making progress with your future stone quarry operation. Your hard work and persistence will ensure your success. I look forward to the future supply of your two new stone varieties. I have seen the samples and feel that the market would readily accept them if a reliable supply could be established. Your estimated wholesale market price range of \$ 12.00-\$ 15.00/square foot for 2cm polished slabs is very competitive with similar stones quarried in Canada and imported by Canada. The possibility of an export market also exists and cannot be ignored.

We at Accurate would also be future clients if a reliable supply of good quality material could be established. We would definitely recommend and show your stone to our clients and to the designers and architects with which we work. I believe we will receive a favourable response. I have also taken the liberty to discuss your new stone with a large Canadian based stone tile fabricator. They have shown interest in your product and would like to see the samples.

As the use of stone in Canada increases so does the demand for new varieties. I believe your two new varieties will help fill some of this demand.

I wish you success with your future quarry and hope to see your products available in the not too distant future.

Sincerely

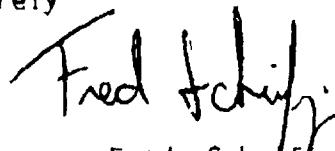

Fred Schelfinger
Operations Manager

D. CRUPI & SONS LIMITED

85 Possmore Avenue,
Mailing Address - P.O. Box 272, Agincourt, Ontario M1S 3B6
Tel. (416) 291-1986 Fax (416) 291-3252

November 24th, 1998

Owen Quarry
47 Lofthouse Ave
Scarborough, Ontario
M1W 2E1

Attention: Jamie Cameron / *Jim Owen*

Re: Trap Rock Supply

Dear Sir:

As per our discussion we would like to confirm that we are users of Trap Rock aggregates in our Metro contracts. We would be happy to discuss our requirements for the purchase of this product if the specifications are met and the prices are competitive.

I thank you for meeting with me and shall look forward to hearing from you.

Yours truly,

D. CRUPI & SONS LIMITED

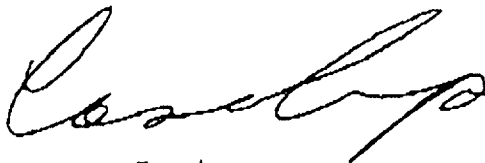

Cosimo Crupi
President

CC/fv



Crystal Tile &

Marble Ltd.

• Contracting • Manufacturing • Distribution

20 Apex Road, North York, Ontario M6A 2V2
Telephone: (416) 761-5871 Fax: (416) 761-1389

January 4, 1991

MR. JIM OWEN
J. Owen Development Ltd.
190 Mountain Street
Suite 305
Sudbury, Ontario
P3B 4G2

Dear Mr. Owen:

Recently you had provided us with a sample of granite from your quarry in the Espanola area. As we mentioned to you at this time we felt that you had a very competitive product. The black colour of the stone is of excellent quality as far as comparing it to the other black granites that are available.

Further to our conversation, please be advised that we would be interested in pursuing the possibility of becoming a distributor for this stone should it become available. We understand that your plan is to go into production within the foreseeable future.

We wish you luck with this venture and we look forward to hearing from you.

Sincerely,

David Woodwark

875 Lapointe Street,
Sudbury, Ontario,
Canada P3A 8N8

F.A.X.: (705) 580-846

KHOURI GRANITE LIMITED
Marble and Granite Manufacturers

SUDBURY MAY 17 1989

TO WHOM IT MAY CONCERN.

WE HAVE PREVIOUSLY CUT AND POLISHED SOME SAMPLES OF BLACK GRANITE FROM MR. JIM OWEN DEVELOPMENT COMPANY AND THEIR GRANITE DEPOSIT..

THE RESULTS WERE EXCELLENT.

WE BELIEVE MR. JIM OWEN HAS A GREAT POTENTIAL IN ESTABLISHING THIS QUARRY AND BE IN PRODUCTION IN THE NEAR FUTURE , WHERE WE COULD BUY GRANITE BLOCKS FROM HIM.

THE BLACK FINE GRAINE GRANITE HAS A GREAT DEMAND IN TODAY,S MARKET.

THEREFOR WE ARE READY TO SUPPORT SUCH OPERATION.

WITH BEST REGARDS.



ELIE MALAKIEH

VICE PRESIDENT



June 8, 1999

James Owen
45 Lofthouse Square
Scarborough, Ontario
MIW ZE1

Dear Sirs,

As per our discussion regarding the traprock site near Espanola, we would be interested in discussing our potential involvement in an extraction/purchasing agreement of quality aggregates from this site.

This expression of interest is contingent upon quality, pricing and market demand variables all being favourable.

We trust this meets with your approval.

LAFARGE CONSTRUCTION MATERIALS

A handwritten signature in black ink that reads 'Jeff Kerr'.

Jeff Kerr
Area Manager
Pipeline/Projects



Moscone Tile Ltd.

CERAMIC — MARBLE — RESILIENT

5161 STEELES AVE. W., WESTON, ONT., CANADA M9L 1R5 TEL. (416) 741-7385 FAX. (416) 741-8396

Since 1952

MR. JIM OWEN
J. Owen Development Ltd.
190 Mountain St.
Suite 305
Sudbury, Ontario
P3B 4G2

Dear Mr. Owen:

We are in possession of a sample of granite which you had given to us from your quarry located in the Espanola area. My opinion of the sample is that the black colour is of excellent quality. Due to this reason, I believe that there would be an excellent market for this stone.

I would also be interested in the possibility of adding this black granite to our present line of products should you eventually go into production as you informed us.

Sincerely,



Undersigned.

NORTH-TECH STONE & CERAMIC INC.
1260 Kelley Lake Rd.
Sudbury, Ont., Canada
P3E 5P4

Date: Oct.11/90

Attention: Whom It May Concern

Re: Granite Quarry

Dear Sir/Madame:

We are in the possession of a sample of granite supplied to us by Mr. J. Owen from his quarry located in the Espanola area. My impression of the sample is that the colour of the stone is of excellent quality. Should this product go into production it is my belief that the product will be well received by the architectural community.

When the quarry is in production we would be interested in the possibility of using this material to enhance our present stock of architectural stone.

Respectfully yours

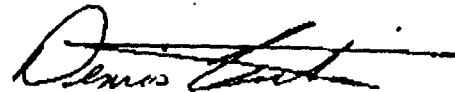

Dennis Centis, B.Sc.



PAVE-AL LIMITED

6205 airport road • mississauga, ontario L4V 1E3
tel: (905) 677-5480 fax: (905) 677-1298

November 27, 1998

Via Fax - 416 497-5506

HCH Lazerman
500 King Street West
Suite 408
Toronto, Ontario
M5V 1L9

Attention: Jaime B. Cameron

Dear Sir:

Further to discussions we have had regarding the Owen Quarry as a source of traprock for surface mix asphalts, we would be willing to enter into discussions for the purchase of material from this source if this material is approved by Ministry of Transport for use in surface asphalt; if it is economical to do so and if you can demonstrate that you are capable of supplying our requirements both quantity- and quality- wise.

Yours truly,

PAVE-AL LIMITED

A large, handwritten signature in black ink, appearing to read 'Olaf Kaminski', is written over the company name and extends across the page.

Olaf Kaminski, P. Eng.
Project Manager

OK:sw

PORITAL LTD.

DIRECT DIAL 850-4642

MR. JIM OWEN
J. Owen Development Ltd.
190 Mountain St.
Suite 305
Sudbury, Ontario
P3B 4G2

Dear Mr. Owen:

We are in possession of a sample of granite which you had given to us from your quarry located in the Espanola area. My opinion of the sample is that the black colour is of excellent quality. Due to this reason, I believe that there would be an excellent market for this stone.

I would also be interested in the possibility of adding this black granite to our present line of products should you eventually go into production as you informed us.

Sincerely,



Undersigned.

PORITAL MARBLE & CERAMIC LTD.
4000 STEELES AVE. W., UNIT 10
WOODBIDGE, ONT. L4L 4V9
TEL (416) 850-4642

**YORK MARBLE, TILE & TERRAZZO LTD.**

41 COLVILLE ROAD - TORONTO, ONTARIO - M6M 2Y2 FAX: 235-1247 TEL: 235-0161

January 4, 1991.

Mr. Jim Owen,
J. Owen Development Ltd.,
190 Mountain Street,
Suite 305,
Sudbury, Ontario.
P3B 4G2

Dear Mr. Owen:

Recently, you had provided us with a sample of granite from your quarry in the Espanola area. As we mentioned to you at this time we felt that you had a very competitive product. The black colour of the stone is of excellent quality as far as comparing it to the other black granites that are available.

Further to our conversation, please be advised that we would be interested in pursuing the possibility of becoming a distributor for this stone should it become available. We understand that your plan is to go into production within the foreseeable future.

We wish you luck with this venture and we look forward to hearing from you.

Sincerely,

York Marble, Tile & Terrazzo Ltd.,

Andrew Bortolotti

AB/cs



APPENDIX 5

J. OWEN DEVELOPMENT LTD.

BALDWIN & NAIRN TOWNSHIPS

SUDBURY MINING DIVISION

DISTRICT OF SUDBURY

FRACTURE DENSITY REPORT

Prepared for: Jim Owen

Author: Frank Racicot

Date: August 1988

LOCATION AND ACCESS

The property is located on the boundary between Baldwin and Nairn Townships approximately 65 km west of Sudbury, Ontario. The property can be reached by two methods. The first one is reached by driving west on Highway 17 to Highway 68 - the Manitoulin-Espanola turn off. Proceed south towards Espanola for approximately 1.2 km and turn left on the Old Nairn Road. One then drives for a distance of 5.8 km to reach the property.

The property can also be reached by driving one mile (1.6 km) west of the Spanish River to a red and white Hi-Way Market Building. Then turn south on a small dirt road that immediately crosses the tracks. Proceeding 1 km down this road will also bring you to the property.

PURPOSE OF SURVEY

The main purpose of this field project was to accurately locate the outcrops in the project area and report their fracture density. Other factors such as variability, obvious sulfides, veining, etc. were to be noted.

METHODOLOGY

A grid was established over the area to maintain control. An east-west base line was cut through the centre of the property; as well the centre line (line 0+00) was cut for most of its length. North south lines were then flagged with stations recorded every 25 m. Lines were 50 m apart. Portable hip chains were used to measure the distance between all stations.

Once outcrops were located a method had to be devised to report on the number of fractures. To keep things workable and simple only 4 categories were used. The following table illustrates the criteria used to determine which category the outcrop belonged to. The size factor criteria is the size of blocks that had to be available for at least 50% of the outcrop.

TABLE 1

<u>Fracture Key</u>	<u>Size Factor Criteria</u>		Size of blocks available for at least $\frac{1}{2}$ of outcrop
	Metric	Imperial	
H - High	<15 cm	<6 in.	
M - Medium	15-23 cm	6- 9 in.	"
L - Low	23-31 cm	9-12 in.	"
VL - Very Low	> 31 cm	>12 in.	"

In order to come up with a size factor rating of the outcrop, one had to be able to generalize the size of blocks that might be obtained. This size factor was in turn a reflection of the amount of joints.

Several factors had to be taken into account however. For instance:

- (a) the amount of joints, or
- (b) the intersecting angles of the joints.

In places there might not have been many joints, but the intersecting strike and dip of the joints or the randomness of joints made it difficult to get the proper size of blocks.

Another factor that determined the rating of the outcrop was whether or not it was large enough to have any vertical exposure. If it was relatively flat or "domed", then any shallow or flat lying joints could not be seen.

Also, one had to be able to generalize and assign a rating on outcrops of different sizes. For instance, a small outcrop might only have one size factor rating, i.e. M (medium). But a large outcrop might have two or three ratings - high, medium and low. But a single generalization usually had to be made on the whole outcrop. If there were two obvious sizes in one outcrop, it was at times given a dual rating, i.e. H-M (high-medium). The main designation was listed first. In the latter example, H-M, most of it was H (high) but there was enough M (medium) to warrant mention.

Large moss or overburden free outcrops were walked over quite thoroughly. Large moss covered outcrops usually had about 3 - 6 places scraped off for examination. A flagging tape with the assigned rating was usually left at the outcrop for easy verification by anyone examining them.

One factor not always taken into account was the fact that the blocks had to be cut vertically. It was assumed that the blocks might be initially cut along a main joint direction - even if it was slightly dipping; or that once taken out, the blocks might be somewhat rotated to align with one of the main fracture directions if they were not vertical.

This should not pose much of a problem as most of the joints are near vertical in the main area of interest. Also, depending on the client's excavation procedures, these dipping joints may be used to his advantage.

The author would like to acknowledge and thank Dan Brunne for his technical help and assistance in the field.

FIELD OBSERVATIONS

Rock Types

The predominant rock type is a fine to medium grained dark coloured diorite. As the main purpose of this study was to determine the density of the fractures, the outcrops were not examined in great detail to determine their colour variability, range of grain size, etc. (Note: the term joints and fractures is used somewhat interchangeably.) Although in general the colour and texture of the rocks as they appeared on surface was relatively consistent.

One sample taken from within the main area of interest (on line 1+00 E and 1+75 N) was a bit lighter in colour and dull looking. This may have been due to a slightly higher feldspar content or alteration of the rock itself.

Another sample which came from the cliff area, approximately 75 m to the northeast was finer grained, noticeably darker (almost gabbroic) and had a trace of sulfides.

On the west side of the property in and near the sulfide pits, the rock was quite variable. There were varying amounts of sulfides and pods of coarse grained diorite; in fact there may be a genetic relationship between the sulfides and coarse grained diorite.

The rocks on the southwest part of the property are noticeably different from elsewhere; specifically, on line

1+00 W from 1+00 S to 3+00 S. Here the rocks are mainly medium grained, denser and have a bit higher feldspar content. This gives the rocks a "salt and pepper" texture. Unfortunately most of the outcrops have a high fracture density.

Veinlets

There are many outcrops which contain what appear to be small diorite veinlets. The symbol (V) was usually used to represent them on the map, although some outcrops may have the veinlets but not actually have the symbol on the map.

These veinlets are a dark greenish colour and on fresh and weathered surfaces are usually darker than the surrounding country rock. They usually form small ridges 1 to 4 mm high. This indicates they are more resistive to weathering and are actually harder than the main diorite body. This is seen as a positive aspect in that any fractures or main joints that these veinlets intruded, may actually be "welded" together. The veinlets range in size from about 1 to 10 mm in width and in places may be wider where several of them have come together. They frequently criss cross in different directions and form a pattern that is very aesthetically pleasing to look at. One of the highest density of veinlets came from a small outcrop at 1+55 N and 0+10 E.

As a general rule of thumb, the more veinlets there are, the fewer fractures there are. The sequence of events appears to be that after the diorite was intruded it was later fractured; then at a later date a small pulse of the diorite magma came in and filled many of the fractures.

SUMMARY AND RECOMMENDATIONS

A grid was established over a ridge of diorite that covers parts of four claims in Baldwin and Nairn Townships. A fracture density map outlined an area of mainly moderate to low jointing. This would yield a block ranging in size from 15 - 31 cm (6 - 12 inches). The area of the lowest jointing centres around the top of a ridge where some previous stripping was done this spring. The rock type is a diorite but contains a high percentage of small diorite veinlets. The actual zone of the lowest jointing appears to be a northeast trending block from approximately line 0+25 E to about 1+75 E. That would be about 150 m (500 feet) long. This zone may be about 100 m (320 feet) wide.

These dimensions mark the general area which contains the least amount of jointing. There are some outcrops which actually contain a high to moderate amount of jointing within this defined area.

The following recommendations are purposed for the defined area of interest. It is up to the client's discretion, market, purpose, etc. as to which he does first.

1. Excavate some larger blocks--especially ones that contain typical diorite veinlets. These should be cut and polished to see if they are aesthetically pleasing--but more

importantly that they do not weaken the rock.

2. Strip off some overburden from different outcrops to determine the extent of the low to moderate jointing and the consistency of the veinlets.

3. Establish a means of determining the consistency and continuity of both the jointing and veinlets

**DESCRIPTION OF THE QUARRY STONE
(SUBMITTED BY R. ADLINGTON - GEOLOGIST)**

The Nipissing Diabase, also known as the Sudbury area Sudbury Gabbro, occurs as large and small sill-like igneous intrusions in the Precambrian lower Proterozoic Huronian sediments. Its age is about 2160 million years. It outcrops over a large area extending from Cobalt in the east to near Sault Ste. Marie in the west.

Much of the Nipissing Diabase is a gabbro consisting mainly of plagioclase feldspar and lesser amounts of pyroxene, both monoclinic and orthorhombic.

Within the gabbro are other facies, including a feldspathic pyroxenite. The rock on the Owen Property in Baldwin Township would fall into this category, pending a thin section examination which would be more definitive.

In an article by B.O. Burkhart (1) quoting from a paper by Card and Pattison (2), in the southern Sudbury area, orthopyroxene can constitute up to 43% of the rock, clinopyroxene up to 46% and quartz up to 10%. Accessory minerals are bitite, titanite, apatite and opaque minerals.

The pyroxenes are the minerals giving the rock its black colour. These may be more or less altered by metamorphism to black hornblende. This will not detract from the rock's use as a building stone and it takes an excellent polish.

This rock has medium grained igneous (interlocking minerals) texture. It will not be as prone to breakage due to parting along the cleavage planes of large feldspar crystals as in "black granite" (anorthosite).

The Nipissing Diabase intrusions, being sill-like, lie roughly parallel to the bedding of the sediments. In the Baldwin Township area the sediments are steeply dipping so the Nipissing Diabase would be expected to attain considerable depths. This does not mean the feldspathic pyroxenite facies would necessarily also attain great depths. Apart from the vertical extent shown as hills any downward extension would have to be determined by a few diamond drill holes, which need only go as deep as any possible quarry. Additional information provided by drilling would be the quality of the rock and number of fractures per unit of vertical depth.

This report is based on the references given and on my own knowledge of the Sudbury area. I have seen the feldspathic Pyroxenite on the Owen Property but not in this section.

REFERENCES

- (1) Burkhart, B.E.

1984: Chapter 4. General Geology of the Sudbury Area, p. 70 - 71, In the Geology and Ore Deposits of the Sudbury Structure, edited by E.G. Pye, A.J. Naldrett and P.E. Giblin, O.G.S. Special Volume 1.

(2) Card, K.D. and Pattison, E.G.

1973: Nipissing Diabase of the Southern Province, Ontario; p. 7 - 30 in Huronian Stratigraphy and Sedimentation, edited by G.M. Young. G.S.A. Special Paper No. 12.



41I05SE2001 2.19502 NAIRN

020

TECHNICAL REPORT

Quarry Project

Prepared by:
James Owen

Prepared for:
Roy Denomme
of
Ministry of Northern Development
and Mines
Sudbury Office

April, 1998

2.19502

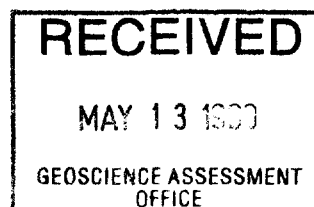

April 20, 1998

Roy Denomme
Mining Recorder
Sudbury Mining Division
Ministry of Northern Development
and Mines
Willet Green Miller Centre
933 Ramsey Lake Road (B3)
Sudbury ON P3E 6B5

Dear Mr. Denomme:

Re: Technical Report

This report is based on my investigation as to where to start a quarry operation on claims I hold in Baldwin and Nairn Townships.

In the past several years I prospected and conducted walk over studies with several professional business people. I had decided to proceed with a plan in July 1997. I found an outcrop, which had no fractures. This outcrop is situated on Claim number 551165 which I have leased in Baldwin Township. I have discussed my plan with the Ministry of Natural Resources' Pit and Quarry Inspector Tim Ruthenberg. I also have an agreement signed with the land owners E.B. Eddy. As well, I also contacted Mr. Ross Kelly and Mr. Dick Cowan and requested permission to extract a block for test purposes. Two blocks measuring 4'x4'x8' were extracted. One block was satisfactory.

I have also done a market study relating to the stone industry for the past two years. I believe there is potential business for both the dimensional stone and the aggregates.

I am optimistic on having a quarry operation by late summer 1998 or by early 1999. I am aware that more control has been distributed to the townships with respect to zoning bylaws. Recently I spoke to councilors from both townships regarding zoning my claims under pits and quarry. I have their permission to proceed with my project and they have indicated that they will provide me with a letter stating such.

I trust the information contained in this technical report meets your requirements.

Sincerely,



James Owen

Report on Bulk Sample Extraction

Prepared By:

James Owen

Prepared For:

**Roy Denomme
Of
Ministry of Northern Development
And Mines
Sudbury Office**

April 22, 1998

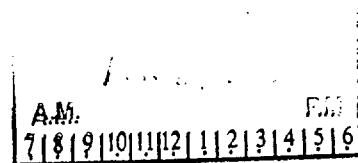
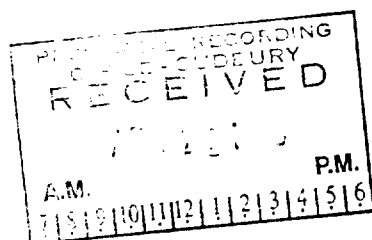

April 22, 1998

Roy Denomme
Mining Recorder
Sudbury Mining Division
Ministry of Northern Development
And Mines
Willet Green Miller Centre
933 Ramsey Lake Road (B3)
Sudbury, Ontario
P3E 6B5

Attention: Roy Denomme

Re: Bulk Sample
Request for Extension – July 31, 1997

Dear Mr. Denomme:

This report is based on extracting a 4'x4'x8' approximately 6 ton granite block from Claim Number S1197787 which has been restaked June 11, 1997 to New Claim Number S-1214624.

One block of granite was extracted August 1997. After closely examining the granite block I found several fractures. I then decided not to proceed with the tests that needed to be done. The granite block was not moved off site.

Enclosed is the location map and a cost to extract granite block.

I trust the information contained in this report meets your requirements.

Should you have any questions or concerns, please feel free to contact the undersigned below at (416) 497-5506.

Yours truly,

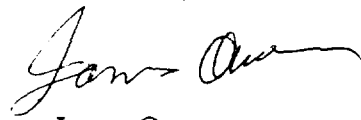

James Owen

Cost to Extract Granite Block

1 – Man – Compressor & Rock Drill – 4 hours x \$ 85.00 = \$ 340.00

1 – ¾ yard Excavator and Operator – 2 hours x \$ 125.00 = \$ 250.00

Hydraulic Splitters Rental per Day – 1 day x \$ 125.00 = \$ 125.00

Grand Total \$ 715.00



2.19502

THIS AGREEMENT made between:

DOMTAR INC.

Incorporated under the laws of Canada
(Hereinafter referred to as the "Company")

AND

**Mr. James Owen of the City of Toronto,
Ontario,**

(Hereinafter referred to as "Mr. Owen")

WHEREAS Mr. Owen wishes to conduct bedrock crushing operations on a portion of the Company's freehold land in Baldwin and Nairn Townships.

AND WHEREAS the Company recognizes the existence of mineral rights held by Mr. Owen on a portion of the Company's freehold land in Baldwin and Nairn Townships.

NOW THEREFORE THIS AGREEMENT WITNESSES that in consideration of the mutual provisions contained in this Agreement, hereinafter referred to as the "Agreement", the Company and Contractor agree with each other as follows:

1. TERM

This Agreement shall commence on the 1st day of May, 1999 and end on the 30th day of April, 2000, subject to the provisions for termination hereinafter contained.

Domtar Inc.
1 Station Road.
Espanola, Ontario P5E 1R6

Telephone: (705) 869-2020
Fax: (705) 869-4471

2. EXTENT

This Agreement shall apply to Mining Leases 551165 and 551164, Lot 1, Conc. 1, Parcel 11488, Baldwin Township, and Mining Claim 1214624, Parcel 17194, Nairn Township, Sudbury Mining and Land Registry Divisions.

3. NATURE OF ACTIVITIES

Mr. Owen shall conduct bedrock extraction work relative to commercial crushing operations for the production of ~~gravel~~. *Crushed stone.*

4. MR. OWEN'S COVENANTS

Mr. Owen covenants with the Company:

- a) to promptly comply with all requirements of the Ministry of Health, Ministry of Labour, Ministry of Natural Resources, Ministry of Northern Development and Mines, Ministry of Environment, local Board of Health, all other applicable Government Agencies, and all Municipal Zoning By-Laws;
- b) to perform operations in a manner that is satisfactory to the Company, particularly with regard to the minimization of damage to existing trees and soil and preservation of aesthetic values;
- c) to pre-fell, in advance of drilling or blasting, all trees required to be removed, and to delimb, top at a maximum diameter of 10.0 centimetres and skid to the side of Jacklin Road, all trees measuring in excess of 13.0 cm. outside diameter at breast height, for subsequent scaling and payment of applicable stumpage fees to the Company;
- d) to obtain a necessary Work Permit from OMNR prior to commencing operations and to ensure the required fire suppression equipment is maintained on-site; and

BOW
Jo-

- e) to compensate the Company for surface disturbance, i.e. soil removal, at a rate of \$500.00 per hectare, and for timber destroyed at the then-applicable stumpage rates for Crown timber.

5. INDEMNIFICATION OF THE COMPANY

Mr. Owen will indemnify and save harmless the Company from any and all liabilities, fines, suits, claims, demands, costs and actions of any kind or nature whatsoever to which the Company shall or may become liable for, or suffered by reason of any breach, violation, or non-performance by Mr. Owen of any covenant, term or provision hereof, or by reason of any injury, loss, damage or death, resulting from, occasioned to or suffered by any person or persons, or any property by reason of any act, neglect or default on the part of Mr. Owen, or any of his agents, customers, employees, servants, contractors, licencees or invitees, in or about the demised premises (which for the purpose of this clause shall include access to the demised premises provided over lands owned by the Company to Mr. Owen or any part thereof; such indemnification in respect of any such breach, violation, non-performance, damage to property, loss, injury or death during the term of this Agreement shall survive any termination of this Agreement, anything in this Agreement to the contrary notwithstanding and shall include solicitor and client costs.

6. TERMINATION

If, in the opinion of the Company, Mr. Owen substantially defaults on his obligations described herein, the Company may terminate this Agreement, provided that a minimum of ten (10) days notice in writing is given to the other party prior to the Termination Date.

7. RENEWAL

Subject to the satisfactory performance by Mr. Owen of his obligations outlined herein, the Company agrees to renew this Agreement effective May 1, 2000 for a further period of one (1) year. Future annual agreements will provide for similar renewal periods, with the intent of providing Mr. Owen with long-term security, subject to performance acceptable to the Company.

8. GOVERNING LAW

This Agreement shall be construed and governed by the laws of the Province of Ontario.

9. CODE OF FOREST PRACTICES

Mr. Owen agrees to adhere to the Code of Forest Practices developed by the Ontario Forest Industries Association and endorsed by Domtar Forest Resources.

IN WITNESS WHEREOF the Parties hereto have executed this Agreement.

WITNESS:

BY: Susan McCabe

DATE: April 29/99

DOMTAR INC.

BY: Bob Nickle

DATE: April 29/99

WITNESS:

BY: Susan McCabe

DATE: April 29/99

MR. JAMES OWEN

BY: J. Owen

DATE: April 29/99



XRAL Laboratories
A Division of SGS Canada Inc.

1885 Leslie Street
Don Mills, Ont.
Canada M3B 3J4
Telephone (416) 445-5755
Fax (416) 445-4152

CERTIFICATE OF ANALYSIS
REPORT 14342

TO: JIM OWEN
UNIT 22
72 DOUSAY PLACE
SCARBOROUGH

CUSTOMER No. 3278

DATE SUBMITTED
15-Jul-97

WORKORDER 16111-

TOTAL PAGES 1

2 ROCKS

	METHOD	DETECTION LIMIT	METHOD CODE
AU-1AT PPB	FADCP	5.	FA-30
BE PPM	ICP	.5	ICP-70
NA %	ICP	.01	ICP-70
MG %	ICP	.01	ICP-70
AL %	ICP	.01	ICP-70
P %	ICP	.01	ICP-70
K %	ICP	.01	ICP-70
CA %	ICP	.01	ICP-70
SC PPM	ICP	.5	ICP-70
TI %	ICP	.01	ICP-70
V PPM	ICP	2.	ICP-70
CR PPM	ICP	1.	ICP-70
MN PPM	ICP	2.	ICP-70
FE %	ICP	.01	ICP-70
CO PPM	ICP	1.	ICP-70
NI PPM	ICP	1.	ICP-70
CU PPM	ICP	.5	ICP-70

	METHOD	DETECTION LIMIT	METHOD CODE
ZN PPM	ICP	.5	ICP-70
AS PPM	ICP	3.	ICP-70
SR PPM	ICP	.5	ICP-70
Y PPM	ICP	.5	ICP-70
ZR PPM	ICP	.5	ICP-70
MO PPM	ICP	1.	ICP-70
AG PPM	ICP	.2	ICP-70
CD PPM	ICP	1.	ICP-70
SN PPM	ICP	10.	ICP-70
SB PPM	ICP	5.	ICP-70
BA PPM	ICP	1.	ICP-70
LA PPM	ICP	.5	ICP-70
W PPM	ICP	10.	ICP-70
PB PPM	ICP	2.	ICP-70
BI PPM	ICP	5.	ICP-70
PT-1AT PPB	FADCP	10.	FA-30
PD-1AT PPB	FADCP	1.	FA-30

*** UNLESS INSTRUCTED OTHERWISE WE WILL DISCARD PULPS IN 90 DAYS ***
AND REJECTS IN 30 DAYS FROM THE DATE OF THIS REPORT

DATE 24-JUL-97

CERTIFIED BY

[Signature]
Dr. Hugh de Souza, General Manager



Member of the SGS Group (Société Générale de Surveillance)

ELEMENT	METHOD	METHOD CODE	1-QB	2-B	1-QB-D
AU-1AT PPB	FADCP	FA-30	1	11	2
BE PPM	ICP	ICP-70	<.5	<.5	<.5
NA %	ICP	ICP-70	.07	.09	.07
MG %	ICP	ICP-70	<.01	1.57	<.01
AL %	ICP	ICP-70	.03	2.45	.03
P %	ICP	ICP-70	<.01	.02	<.01
K %	ICP	ICP-70	<.01	.14	<.01
CA %	ICP	ICP-70	.02	.02	.02
SC PPM	ICP	ICP-70	<.5	<.5	<.5
TI %	ICP	ICP-70	<.01	<.01	<.01
V PPM	ICP	ICP-70	10	46	10
CR PPM	ICP	ICP-70	231	95	238
MN PPM	ICP	ICP-70	30	361	31
FE %	ICP	ICP-70	.30	5.75	.31
CO PPM	ICP	ICP-70	<1	147	<1
NI PPM	ICP	ICP-70	9	247	9
CU PPM	ICP	ICP-70	4.2	6090	5.0
ZN PPM	ICP	ICP-70	<.5	310	<.5
AS PPM	ICP	ICP-70	<3	<3	<3
SR PPM	ICP	ICP-70	1.2	3.1	1.1
Y PPM	ICP	ICP-70	<.5	2.0	<.5
ZR PPM	ICP	ICP-70	1.0	<.5	1.0
MO PPM	ICP	ICP-70	2	6	2
AG PPM	ICP	ICP-70	<.2	2.0	<.2
CD PPM	ICP	ICP-70	<1	<1	<1
SN PPM	ICP	ICP-70	<10	<10	<10
SB PPM	ICP	ICP-70	<5	<5	<5
BA PPM	ICP	ICP-70	3	44	3
LA PPM	ICP	ICP-70	<.5	5.7	<.5
W PPM	ICP	ICP-70	<10	<10	<10
PB PPM	ICP	ICP-70	3	21	3
BI PPM	ICP	ICP-70	<5	INF	<5
PT-1AT PPB	FADCP	FA-30	<10	<10	<10
PD-1AT PPB	FADCP	FA-30	<1	15	<1

AU-1AT PPB - ASSAY PERFORMED ON 30 GRAM ALIQUOT

PT-1AT PPB - ASSAY PERFORMED ON 30 GRAM ALIQUOT

PD-1AT PPB - ASSAY PERFORMED ON 30 GRAM ALIQUOT

D - QUALITY CONTROL DUPLICATE

INF - COMPOSITION MAKES DETECTION IMPOSSIBLE BY THIS METHOD



XRAL Laboratories
A Division of SGS Canada Inc.

1885 Leslie Street
Don Mills, Ont.
Canada M3B 3J4
Telephone (416) 445-5755
Fax (416) 445-4152

UPPER CONCENTRATION LIMITS HAVE BEEN EXCEEDED

Some of the results in this report are outside the applicable analytical range. Please refer to the table below or the current Schedule of Fees and Services for our recommended upper concentration limits. Results greater than the upper concentration limit are reported for the convenience of our clients but are of poor precision and/or subject to interferences.

Please contact us for additional technical information or for an accurate determination by an appropriate technique.

Method Code	Instrument	Element	Upper Limit	Comments
ICP-70	ICP/AA	Ag	10ppm	See note below
ICP-70 ICP-80	ICP	32 elements	5,000 ppm	As, Sb, Bi, W, La may be affected for samples with >10% Cu, Zn or >25% Fe.
XRF-7	XRF	25 elements	4,000 ppm	Matrix dependent. Not suitable for concentrates or highly mineralized samples.
CHM-20	Cold Vapour	Hg	100 ppm	
AAH-3	AA-Hydride	Sb,As,Bi	200 ppm	
ES-4	DGP-Fusion	Be, B, Ge, V	2,000 ppm	
GFAA-10	GFAA	Cd,Se,Te	200 ppm	
CHM-13 CHM-10	Specific Ion	Cl F	5000ppm 1%	
ICPMS-10	ICPMS	in	4,000 ppm	

Note:

Method code ICP-70 utilizes a nitric aqua regia digestion. Silver may precipitate from solution as a chloride and may be underestimated. A fire assay determination for silver is recommended.



41I05SE2001 2.19502 NAIRN

900

Sections 65(2) and 66(3) of the Mining Act. Under section 8 of the Mining Act, this work and correspond with the mining land holder. Questions about this collection contact the Ministry of Northern Development and Mines, 3rd Floor, 933 Ramsey Lake Road, Sudbury, Ontario, P3E 6B5.

- Instructions:
- For work performed on Crown Lands before recording a claim, use form 0240.
 - Please type or print in ink.

1. Recorded holder(s) (Attach a list if necessary)

Name <i>James P. Owen</i>	Client Number <i>178581</i>
Address <i>45 Lofthouse Sq.</i>	Telephone Number <i>416-497-5506</i>
<i>Scarborough, ON M1W 2E1</i>	Fax Number <i>416-497-5506</i>
Name	Client Number
Address	Telephone Number
	Fax Number

2. Type of work performed: Check (✓) and report on only ONE of the following groups for this declaration.

<input type="checkbox"/> Geotechnical: prospecting, surveys, assays and work under section 18 (regs)	<input checked="" type="checkbox"/> Physical: drilling stripping, trenching and associated assays	<input type="checkbox"/> Rehabilitation
Work Type <i>Clearing trees, power stripping, rock drilling to extract large blocks for building stone and construction material sampling.</i>		Office Use
		Commodity <i>1</i>
		Total \$ Value of Work Claimed <i>27,741</i>
Dates Work Performed From <i>02</i> <i>07</i> <i>1997</i> To <i>25</i> <i>06</i> <i>1998</i>		NTS Reference
Global Positioning System Data (if available)		Mining Division <i>Sudbury</i>
Township/Area <i>Baldwin & Nairn</i>		Resident Geologist District <i>Sudbury</i>
M or G-Plan Number <i>(G3003) (G2976)</i>		

- Please remember to:
- obtain a work permit from the Ministry of Natural Resources as required;
 - provide proper notice to surface rights holders before starting work;
 - complete and attach a Statement of Costs, form 0212;
 - provide a map showing contiguous mining lands that are linked for assigning work;
 - include two copies of your technical report.

3. Person or companies who prepared the technical report (Attach a list if necessary)

Name <i>James P. Owen</i>	Telephone Number <i>416-497-5506</i>
Address <i>45 Lofthouse Sq. Scarborough, ON M1W 2E1</i>	Fax Number <i>416-497-5506</i>
Name	Telephone Number
Address	Fax Number
Name	Telephone Number
Address	Fax Number

4. Certification by Recorded Holder or Agent

 I, *James P. Owen* (Print Name), do hereby certify that I have personal knowledge of the facts set forth in

this Declaration of Assessment Work having caused the work to be performed or witnessed the same during or after its completion and, to the best of my knowledge, the annexed report is true.

Signature of Recorded Holder or Agent <i>James Owen</i>	Date <i>May 12 / 99</i>
Agent's Address	Telephone Number <i>416-497-5506</i>
	Fax Number <i>416-497-5506</i>

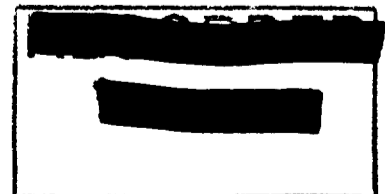
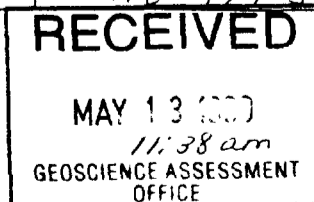

5. Work to be recorded and distributed. Work can only be assigned to claims that are contiguous (adjoining) to the mining land where work was performed, at the time work was performed. A map showing the contiguous link must accompany this form.

W9970.00202

Mining Claim Number. Or if work was done on other eligible mining land, show in this column the location number indicated on the claim map.	Number of Claim Units. For other mining land, list hectares.	Value of work performed on this claim or other mining land.	Value of work applied to this claim.	Value of work assigned to other mining claims.	Bank Value of work to be distributed at a future date
eg TB 7827	16 ha	\$26,825	N/A	\$24,000	\$2,825
eg 1234567	12	0	\$24,000	0	0
eg 1234568	2	\$ 8,892	\$ 4,000	0	\$4,892
1 551165	16 ha	\$13,870.83	0	\$5,153.00 \$13,870.83	\$8,719.00 0
2 551164	16 ha	\$ 4,623.61	0	\$ 3,281.95	\$4,623.00 \$1,341.66
3 1214624	4 units	\$ 9,247.22	\$17,600.00 \$4,000.00	0	0
4 1214625	16 ha	0	\$17,400.00 \$4,000.00	0	0
5 1214626	16 ha	0	\$17,400.00 \$4,400.00	0	0
6					
7					
8					
9					
10	changes made may 28/99 for.				
11					
12					
13				2.19502	
14					
15					
Column Totals		\$27,741.66	\$14,400.00 \$26,400.00	\$15,153.00 \$17,152.78	\$13,340.00 \$1,341.66

I, _____, do hereby certify that the above work credits are eligible under subsection 7 (1) of the Assessment Work Regulation 6/96 for assignment to contiguous claims or for application to the claim where the work was done.

Signature of Recorded Holder or Agent Authorized in Writing: *Josma Quez* Date: *May 12, 1999*

6. Instructions for cutting back credits that are not approved.

Some of the credits claimed in this declaration may be cut back. Please check (✓) in the boxes below to show how you wish to prioritize the deletion of credits:

- 1. Credits are to be cut back from the Bank first, followed by option 2 or 3 or 4 as indicated.
- 2. Credits are to be cut back starting with the claims listed last, working backwards; or
- 3. Credits are to be cut back equally over all claims listed in this declaration; or
- 4. Credits are to be cut back as prioritized on the attached appendix or as follows (describe):

Note: If you have not indicated how your credits are to be deleted, credits will be cut back from the Bank first, followed by option number 2 if necessary.

For Office Use Only

Received Stamp	Deemed Approved Date	Date Notification Sent
	Date Approved	Total Value of Credit Approved
	Approved for Recording by Mining Recorder (Signature)	

0241 (03/97)

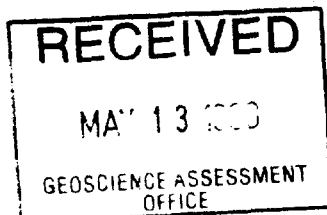



Statement of Costs for Assessment Credit

Transaction Number (office use) 49970 00202

Personal information collected on this form is obtained under the authority of subsection 6 (1) of the Assessment Work Regulation 6/96. Under section 8 of the Mining Act, this information is a public record. This information will be used to review the assessment work and correspond with the mining land holder. Questions about this collection should be directed to a Provincial Mining Recorder, Ministry of Northern Development and Mines, 3rd Floor, 933 Ramsey Lake Road, Sudbury, Ontario, P3E 6B5.

Table with 4 columns: Work Type, Units of work, Cost Per Unit of work, Total Cost. Includes entries for 3/4 Yard Excavator, D6 Cat Dozer, Air Compressor and Rock Drill, Floating Equipment, Transportation Costs, and Food and Lodging Costs. Total Value of Assessment Work: \$27,741.67

Calculations of Filing Discounts:

- 1. Work filed within two years of performance is claimed at 100% of the above Total Value of Assessment Work.
2. If work is filed after two years and up to five years after performance, it can only be claimed at 50% of the Total Value of Assessment Work.

TOTAL VALUE OF ASSESSMENT WORK x 0.50 = Total \$ value of worked claimed.

Note: - Work older than 5 years is not eligible for credit. - A recorded holder may be required to verify expenditures claimed in this statement of costs within 45 days of a request for verification and/or correction/clarification.

Certification verifying costs:

I, James P. Owen, do hereby certify, that the amounts shown are as accurate as may reasonably be determined and the costs were incurred while conducting assessment work on the lands indicated on the accompanying

Declaration of Work form as James P. Owen I am authorized to make this certification. (recorded holder, agent, or state company position: with signing authority)

Signature: James Owen Date: May 12/99

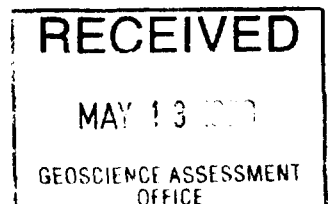

Geoscience Assessment Office
933 Ramsey Lake Road
6th Floor
Sudbury, Ontario
P3E 6B5

Telephone: (888) 415-9846
Fax: (877) 670-1555

September 10, 1999

JAMES PETER OWEN
45 Lofthouse Square
Scarborough, ONTARIO
M1W 2E1

Visit our website at:
www.gov.on.ca/MNDM/MINES/LANDS/mlsmnpge.htm

Dear Sir or Madam:

Submission Number: 2.19502

Status

Subject: Transaction Number(s): W9970.00202 Approval After Notice

We have reviewed your Assessment Work submission with the above noted Transaction Number(s). The attached summary page(s) indicate the results of the review. **WE RECOMMEND YOU READ THIS SUMMARY FOR THE DETAILS PERTAINING TO YOUR ASSESSMENT WORK.**

If the status for a transaction is a 45 Day Notice, the summary will outline the reasons for the notice, and any steps you can take to remedy deficiencies. The 90-day deemed approval provision, subsection 6(7) of the Assessment Work Regulation, will no longer be in effect for assessment work which has received a 45 Day Notice. Allowable changes to your credit distribution can be made by contacting the Geoscience Assessment Office within this 45 Day period, otherwise assessment credit will be cut back and distributed as outlined in Section #6 of the Declaration of Assessment work form.

Please note any revisions must be submitted in **DUPLICATE** to the Geoscience Assessment Office, by the response date on the summary.

If you have any questions regarding this correspondence, please contact Lucille Jerome by e-mail at lucille.jerome@ndm.gov.on.ca or by telephone at (705) 670-5858.

Yours sincerely,



ORIGINAL SIGNED BY
Blair Kite
Supervisor, Geoscience Assessment Office
Mining Lands Section

Work Report Assessment Results

Submission Number: 2.19502

Date Correspondence Sent: September 10, 1999

Assessor: Lucille Jerome

Transaction Number	First Claim Number	Township(s) / Area(s)	Status	Approval Date
W9970.00202	551165	BALDWIN, NAIRN	Approval After Notice	September 07, 1999

Section:
18 Other INDUS

Although this work was approved, in all future assessment work submissions of this nature, please provide the rock types encountered in the field on a proper map. Locations of any samples sent in for analysis must also be clearly represented on a map.

Correspondence to:

Resident Geologist
Sudbury, ON

Recorded Holder(s) and/or Agent(s):

JAMES PETER OWEN
Scarborough, ONTARIO

Assessment Files Library
Sudbury, ON

In Service June 30, 1992

INDEX TO LAND DISPOSITION

PLAN
G - 2976
 TOWNSHIP
NAIRN

M.N.R. ADMINISTRATIVE DISTRICT
FSPANOLA
 MINING DISTRICT
SUDBUKY
 LAND FILES/REGISTRATION
SUDBUKY

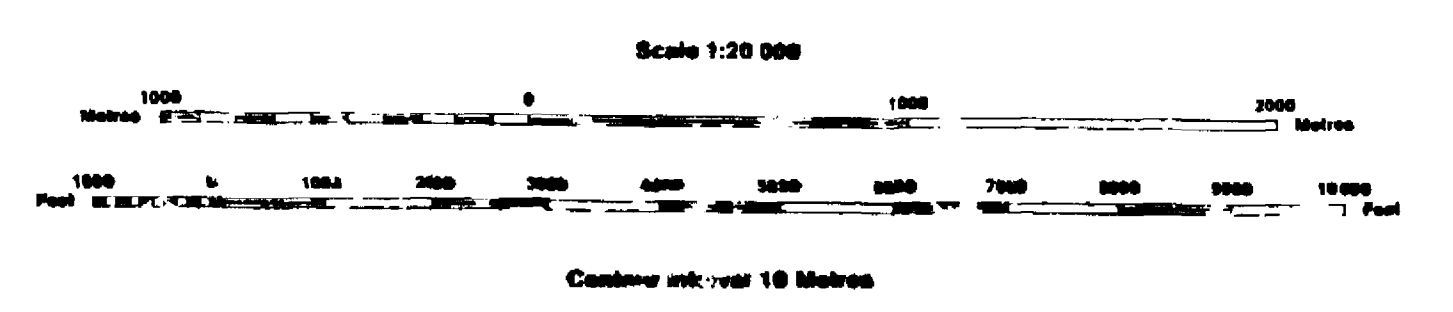

THE INFORMATION THAT APPEARS ON THIS MAP HAS BEEN COMPILED FROM VARIOUS SOURCES, AND ACCURACY IS NOT GUARANTEED.

OCT 06 1993

THOSE WISHING TO STAKE MINING CLAIMS SHOULD CONSULT WITH THE MINING RECORDER, MINISTRY OF NORTHERN DEVELOPMENT AND MINES, FOR ADDITIONAL INFORMATION ON THE STATUS OF THE LANDS SHOWN HEREON.

AREAS WITHDRAWN FROM DISPOSITION

M.R.O. - MINING RIGHTS ONLY
 S.R.O. - SURFACE RIGHTS ONLY
 M.+S. - MINING AND SURFACE RIGHTS

SYMBOLS

Description	Symbol
Boundary	—
Township, Meridian, Baseline	—
Road allowance; surveyed	—
shoreline	—
Lot/Concession; surveyed	—
unsurveyed	—
Parcel; surveyed	—
unsurveyed	—
Right-of-way; road	—
railway	—
utility	—
Reservation	—
Cliff, Pit, Pile	—
Contour	—
Interpolated	—
Approximate	—
Depression	—
Control point (horizontal)	—
Flooded land	—
Mine head frame	—
Pipeline (above ground)	—
Railway; single track	—
double track	—
abandoned	—
Road; highway, county, township	—
access	—
trail, bush	—
Shoreline (original)	—
Transmission line	—
Wooded area	—

Description	Order No.	Date	Disposition	File
(R1) SEC 16/90	W.1/90	10/2/90	S.R.O.	188550
(R2) SEC 36/90	W.26/90 M.R.	12/17/90	S.R.O.	

DISPOSITION OF CROWN LANDS

Patent	●
Surface & Mining Rights	●
Surface Rights Only	○
Mining Rights Only	○
Lease	■
Surface & Mining Rights	■
Surface Rights Only	■
Mining Rights Only	■
Licence of Occupation	▲
Order-in-Council	OC
Cancelled	⊗
Reservation	⊗
Sand & Gravel	⊗
LAND USE PERMIT	⊗

NOTES
 400 FOOT SURFACE RIGHTS RESERVATION AROUND ALL LAKES AND RIVERS.
 APPLICATION UNDER SEC.30(b) Dec.25/93 See Land Roll File

THE INFORMATION THAT APPEARS ON THIS MAP HAS BEEN COMPILED FROM VARIOUS SOURCES, AND ACCURACY IS NOT GUARANTEED. THOSE WISHING TO STAKE MINING CLAIMS SHOULD CONSULT WITH THE MINING RECORDER, MINISTRY OF NORTHERN DEVELOPMENT AND MINES, FOR ADDITIONAL INFORMATION ON THE STATUS OF THE LANDS SHOWN HEREON.

Map base and land disposition drafted by Survey and Mapping Branch, Ministry of Natural Resources. The disposition of land, location of lot boundaries and parcel boundaries on this index is compiled for administrative purposes only.

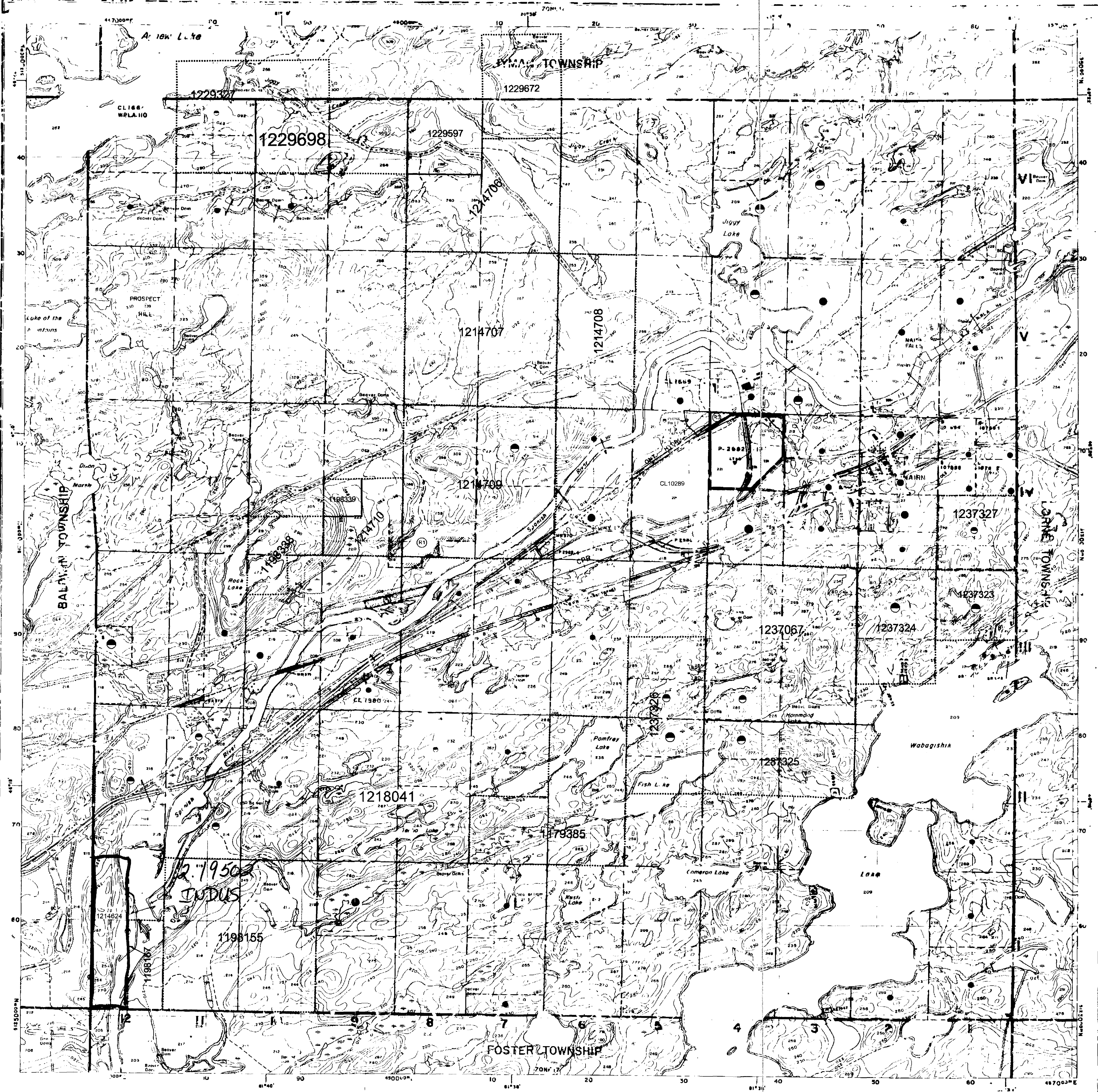

MAP SYMBOLOLOGY

Aerial Cableway	Pipeline (above ground)
Boundary	Railroad
Intermittent	Single Track
Perennial	Double Track
Abandoned	Turbine
Appurtenant	Road
Let, Concession	Highway, County
Appurtenant	Township
Per Boundary	Access (road of doubtful maintenance or unimproved driveway)
Bridge	Trail, Back Road (overgrown, etc.)
Beam, Railroad	Rapids
Building	Double line river with multiple rapids
Chimney	White line river with multiple rapids
Cliff, Pit, Pile	Reservoir
Contours	River, Stream, Canal
Intermittent	Approximate
Appurtenant	Direction of flow
Streamcourse	Peak
Control Points	Spot Elevation
Horizontal	Time elevations
Vertical	Direction of flow
Culvert	Fork
Falls	Pool
Double line river	Transmission Line
Fence, Hedge, Wall	Pole
Feature Outline (contour lines, etc.)	Post
Flooded Land	Tunnel
Lock	Utility Poles
Marsh or Swamp	Wharf, Dock, Pier
Moat	Wooded Area
Mine Head Frame	
Outcrop	

AREAS WITHDRAWN FROM DISPOSITION

M.R.O. - MINING RIGHTS ONLY				
S.R.O. - SURFACE RIGHTS ONLY				
M.+S. - MINING AND SURFACE RIGHTS				
Description	Order No.	Date	Disposition	File
SEC 36/80	W 2/83	31/8/83	S.R.O.	77094

NOTES

Area shown thus CL 1664 under Water Power Lease Agreement No. 10, File No. 9214 - Surface Rights Withdrawn.

Lots 2 to 6 inclusive and 8 to 12 inclusive Con. V and Lots 1 to 11 inclusive Con. VI, subject to Section 109 of the Mining Act (R.S.O. 1980)

E 1/2 of NE 1/4 of S 1/2 of LOT 1, CON. 6 Mining Rights Withdrawn by Order in Council dated 9 January, 1945 File No. 9296

* Section 30(b) Application March 20, 1982

* S.R.O. OPENED JUNE 1, 1982

THE INFORMATION THAT APPEARS ON THIS MAP HAS BEEN COMPILED FROM VARIOUS SOURCES, AND ACCURACY IS NOT GUARANTEED. THOSE WISHING TO STAKE MINING CLAIMS SHOULD CONSULT WITH THE MINING RECORDER, MINISTRY OF NORTHERN DEVELOPMENT AND MINES. FOR ADDITIONAL INFORMATION ON THE STATUS OF THE LANDS SHOWN HEREON.

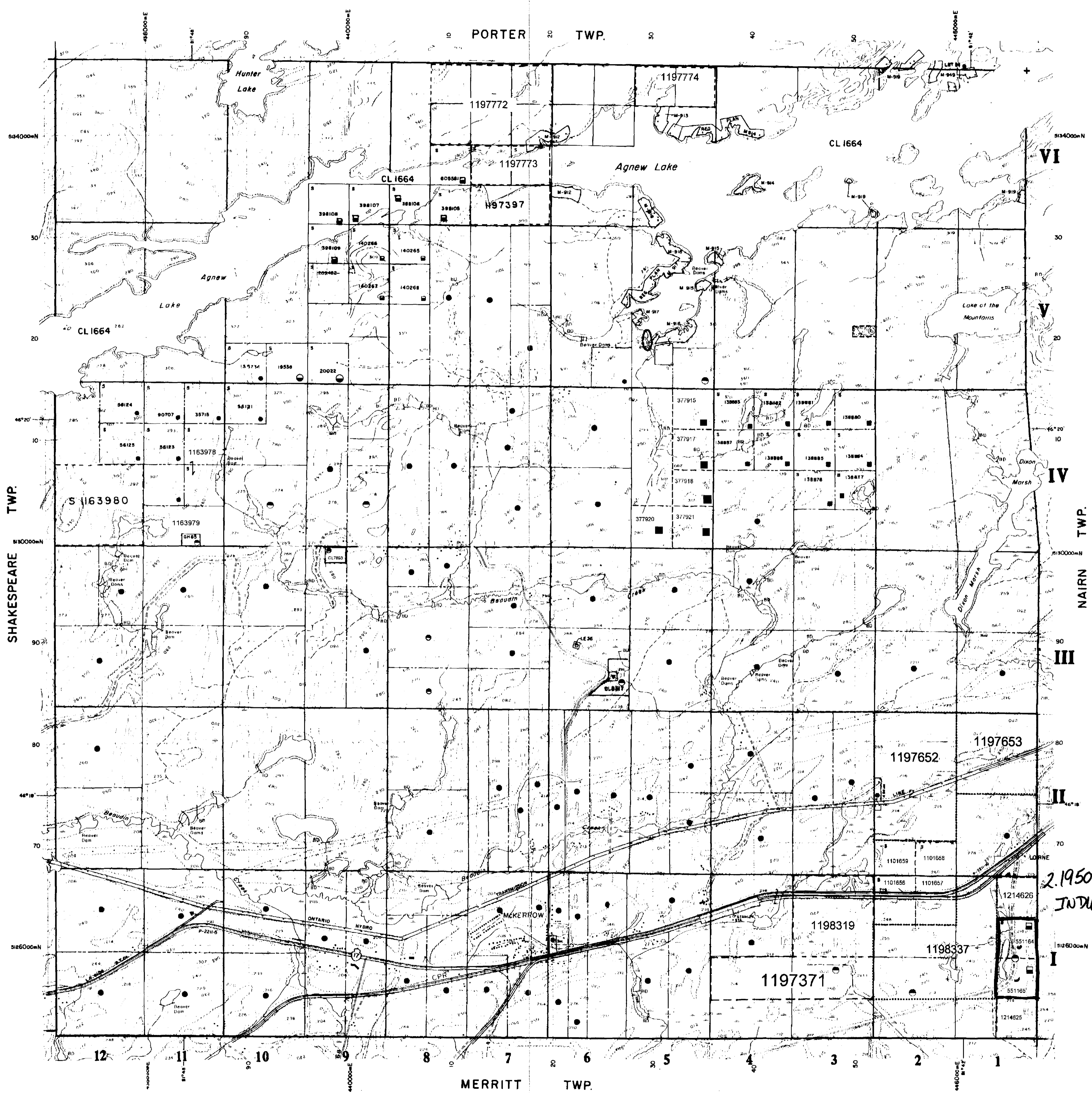

LEGEND

HIGHWAY AND ROUTE No.	
OTHER ROADS	
TRAILS	
SURVEYED LINES	
TOWNSHIPS, BASE LINES, ETC.	
LOTS, MINING CLAIMS, PARCELS, ETC.	
UNSURVEYED LINES	
LOT LINES	
PARCEL BOUNDARY	
MINING CLAIMS ETC.	
RAILWAY AND RIGHT OF WAY	
UTILITY LINES	
NON-PERENNIAL STREAM	
FLOODING OR FLOODING RIGHTS	
SUBDIVISION OR COMPOSITE PLAN	
RESERVATIONS	
ORIGINAL SHORELINE	
MARSH OR MUSKEG	
MINES	
TRAVERSE MONUMENT	

DISPOSITION OF CROWN LAND:

TYPE OF DOCUMENT	SYMBOL
PATENT SURFACE & MINING RIGHTS	●
" SURFACE RIGHTS ONLY	○
" MINING RIGHTS ONLY	◐
LEASE, SURFACE & MINING RIGHTS	◑
" SURFACE RIGHTS ONLY	◒
" MINING RIGHTS ONLY	◓
LICENCE OF OCCUPATION	OC
ORDER-IN-COUNCIL RESERVATION	⊙
CANCELLED	⊘
SAND & GRAVEL	⊙
LAND USE PERMITS FOR COMMERCIAL TOURISM, OUTPOST CAMPS	✓

NOTE: MINING RIGHTS IN PARCELS PATENTED PRIOR TO MAY 6, 1913, VESTED IN ORIGINAL PATENTEE BY THE PUBLIC LANDS ACT, R.S.O. 1976, CHAP. 390, SEC. 83, SUBSEC. 1.

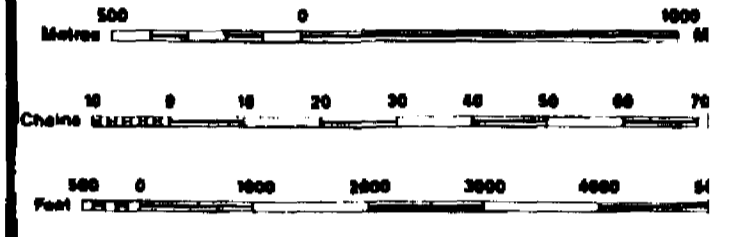

JUNE 1ST. OPENINGS
ONTARIO GAZETTE VOL. 123-18
MAY 6TH 1982

NE PART OF N PART BROKEN LOT 5 CONS.
NW PART OF N PART BROKEN LOT 5 SECONDLY CONS.

NE PART OF N PART BROKEN LOT 6 CONS.
NW PART N PART OF BROKEN LOT 6 CONS.
SE PART N PART OF BROKEN LOT 6 CONS.
SW PART N PART OF BROKEN LOT 6 CONS.

NE PART N PART OF BROKEN LOT 7 CONS.
NW PART N PART OF BROKEN LOT 7 CONS.
SE PART N PART OF BROKEN LOT 7 CONS.
SW PART N PART OF BROKEN LOT 7 CONS.

NE PART S PART OF BROKEN LOT 7 CONS.
NW PART S PART OF BROKEN LOT 7 CONS.
SE PART N PART OF BROKEN LOT 7 CONS.
SW PART N PART OF BROKEN LOT 7 CONS.

SE 1/4 OF N 1/2 LOT 1 CON. 4
NE 1/4 OF S 1/2 LOT 1 CON. 4

THE INFORMATION THAT APPEARS ON THIS MAP HAS BEEN COMPILED FROM VARIOUS SOURCES, AND ACCURACY IS NOT GUARANTEED.

OCT 06 1999

TOWNSHIP
BALDWIN
M.N.R. ADMINISTRATIVE DISTRICT
ESPANOLA
MINING DIVISION
SUDBURY
LAND TITLES / REGISTRY DIVISION
SUDBURY

Ministry of Natural Resources
Land Management Branch
Ontario

Original Compilation: JULY, 1985
Revised: _____

Number: **G-3003**

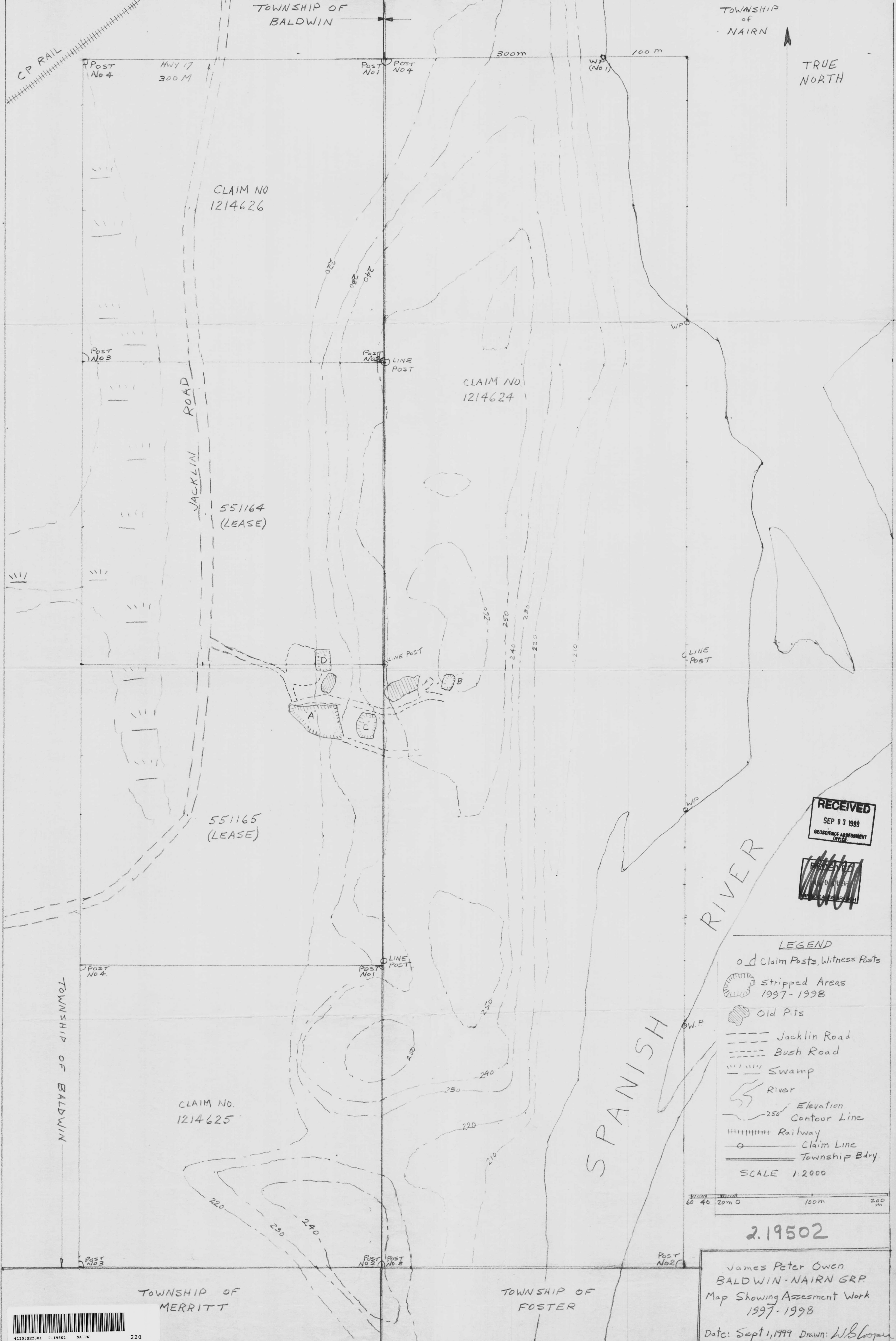

TOWNSHIP OF BALDWIN

TOWNSHIP of NAIRN

TRUE NORTH

CP RAIL

Post No 4

Hwy 17
300 M

Post No 1

Post No 4

300m

100 m

WP (No 1)

CLAIM NO
1214626

CLAIM NO
1214624

551164
(LEASE)

551165
(LEASE)

CLAIM NO.
1214625

TOWNSHIP OF BALDWIN

TOWNSHIP OF MERRITT

TOWNSHIP OF FOSTER

LINE POST

WP

WP

Post No 2

RECEIVED
SEP 03 1999
GEODENSURE ASSESSMENT
OFFICE

~~RECEIVED~~
SEP 03 1999
GEODENSURE ASSESSMENT
OFFICE

LEGEND

- o Claim Posts, Witness Posts
- Stripped Areas 1997-1998
- Old Pits
- Jacklin Road
- Bush Road
- Swamp
- River
- 250' Elevation Contour Line
- Railway
- Claim Line
- Township Bdry.

SCALE 1:2000

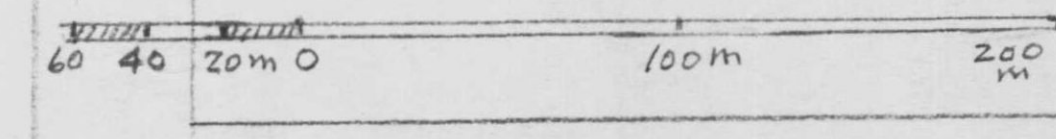

2.19502

James Peter Owen
BALDWIN-NAIRN GRP
Map Showing Assessment Work
1997-1998

Date: Sept 1, 1999 Drawn: W. B. Logan

