

**TOTAL FIELD MAGNETOMETER REPORT**

**ON THE**

**HYMAN TOWNSHIP PROPERTY**

**DISTRICT OF SUDBURY**

**FOR**

**MUSTANG MINERALS CORP.**

**BY**

**Dan Patrie**

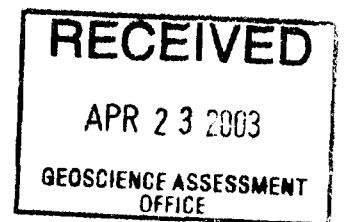

Dan Patrie  
April 10, 2003



## TABLE OF CONTENTS

	PAGE
INTRODUCTION	1
SUMMARY AND RECOMMENDATIONS	1
CLAIM DESCRIPTION	1
LOCATION AND ACCESS	2
GEOLOGY	2
EXPLORATION HISTORY	2
EXPLORATION POTENTIAL	3
RECOMMENDED EXPLORATION PROGRAM	4
INSTRUMENTATION AND WORK DONE	5
MAGNETOMETER SURVEY	5
INTERPRETATION	5
CONCLUSIONS	6
REFERENCES	
PERSONNEL	
CERTIFICATE OF QUALIFICATION	
LETTER OF CONSENT	
MAGNETIC MAP	
BASE MAP	

## **INTRODUCTION**

Mustang Minerals Corp. acquired a group of 6 unpatented mining claims 40 units in Hyman and Nairn Townships in the District of Sudbury, Ontario in the Sudbury, Ontario Mining Division.

Mustang Minerals Corp., requested Dan Patrie Exploration Ltd., to do a program consisting of a total field magnetometer survey and line cutting on part of their claims. The survey which began February 2<sup>nd</sup>, 2003 to February 20<sup>th</sup>, 2003 with very good results.

## **SUMMARY AND RECOMMENDATION**

The Hyman boundary property has potential for a major deposit of base metals and PGE minerals and further exploration is warranted.

A program totaling 13 kilometres of a total field magnetometer survey was done on the property to the east which is an extension of a magnetometer survey done in the past by Dan Patrie Exploration Ltd. The survey proved successful in finding the extension of the magnetic high from the past magnetometer survey.

Due to the lack of geological information an ongoing program of exploration over all of the existing claims should be performed.

## **CLAIM DESCRIPTION**

Hyman Property consists of 7 unpatented mining claim, 48 units located in Hyman and Nairn Townships, Sudbury Mining Division, claim number 3002789, 3002749, 3010331, 1229597, 1218042 and 1229698.

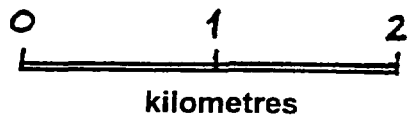
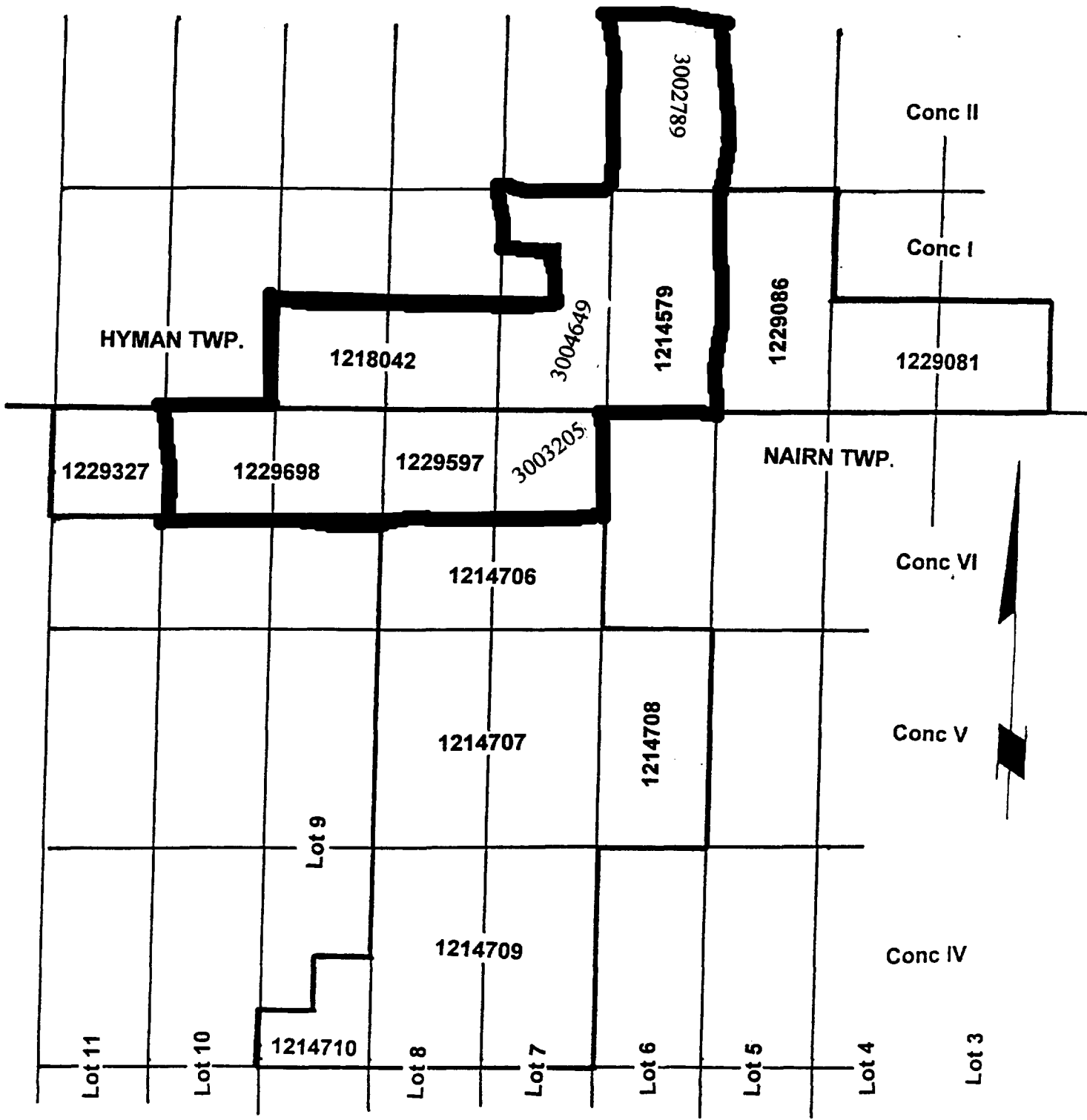

After claim maps G-2966, Hyman Twp.  
 and G-2976, Nairn Twp.,  
 Ministry of Natural Resources, Ontario

CLAIM MAP

## **LOCATION AND ACCESS**

Access to The Hyman and Nairn property is by driving highway 17 west past the town of Nairn Center, Ontario and another 5 miles west, and just past the Spanish river bridge turn north on the Sand Bay Road for approximately 6 kilometres to which the road runs through the property grid.

## **GEOLOGY**

The rock groups consist of an older metavolcanic group, which was intruded by granitic rocks of the Birch Lake batholith some 2,000 million years ago. These groups are overlain unconformably by, or are in fault contact with metamorphosed quartzitic conglomeritic and pelitic rocks of probable Huronian age. These rock groups are intruded successively by gabbroic rocks, by rocks of the Nickel Irruptive and late olivine diabase dikes.

The gabbroic and older rocks were folded and metamorphosed during an orogeny that occurred some 1,600 million years ago. The structure consists of east-trending folds of various magnitudes. Faults are very abundant and apparently steep reverse faults. Copper commonly accompanied by nickel occurs as disseminations and pods in metamorphosed Nipissing Diabase Intrusions. Minerals sought are copper, nickel and PGE deposits.

## **EXPLORATION HISTORY**

The showings numbered 3 and 4 on the maps included. Kordol Exploration Limited held and explored the area south of Lake Agnew in 1959. Exploration work consisted of geological mapping, a ground magnetometer survey, surface trenching and sampling and diamond drilling. The main showings lie in alteration zones in a large metagabbro body and consists of pockets of disseminated or massive pyrrhotite, pyrite and chalcopyrite. A chip sample taken by Kordol over a width of 17 feet, gave the following assay: copper 1.03%, nickel 0.45%, cobalt 0.12% palladium, platinum and gold running from 50 ppb to 340 ppb.

Dan Patrie Exploration did a total field magnetometer survey and induced polarization survey on part of the property covering part of the Keba Cu and Nickel showings along the Hyman-Nairn township line with very good results.

The Keba Cu and Ni showings along the Nairn-Hyman township line also was explored by Falconbridge Nickel Mines in 1957, which they did a very small grid over the showings doing a mag and vertical loop survey with poor results because of mostly being disseminated sulphide where the only method best for the survey would have been an induced polarization survey.

### **EXPLORATION POTENTIAL**

Sulphide minerals mainly pyrrhotite, pentlandite, pyrite chalcopyrite are closely associated with gabbroic rocks in the area. The potential for finding Cu-Ni-PGE deposits in these showings are very encouraging and a more detailed exploration program should be conducted.

Also, with the new discoveries of PGE'S by Mustang Gold, and New Millenium Metals Corporation, located west of Sudbury and Pacific North West Capital, located east of Sudbury in the same type of rock setting shows the potential for more Cu, Ni, and PGE discoveries being made in sulphide pods in the Nipissing Gabbro Anorthosite rocks which is part of the Huronian-Nipissing magmatic belt, a 200 kilometre long arcuate zone of coeval early Proterozoic-aged dyke swarms, mafic intrusions and related volcanics extending from Elliot Lake to Sudbury.

In summary, it is considered that the potential of the property is association with potential for PGE and base metal deposits in the gabbroic rocks of Hyman and Nairn townships. With the previous work of trenching and sampling with traces of platinum palladium group elements in the 1950's and the recent exploration program with very good results the property merits more exploration work.

To evaluate the potential of the property it is recommended that a program of line cutting, mapping, sampling and geophysics be completed over all of the property not already covered.

**RECOMMENDED EXPLORATION PROGRAM**

The surveys should include as follows:

1. Completion of grid lines over entire property.
2. Total field magnetometer survey.
3. Induced polarization survey.
4. HLEM survey.
5. Diamond drilling anomalies found to establish sulphide content and geology.

Following completion of this work and contingent upon the results then additional work should be considered to further evaluate the economic potential for a PGE, Cu and Ni discovery.

This report summarizes the results obtained from the work carried out during the current program and the interpretation is speculative.

Respectfully submitted,

Daniel F. Patrie

Geology and Geophysics Technologist

April 10, 2003



## **INSTRUMENTATION AND WORK DONE**

### **MAGNETOMETER SURVEY**

The magnetometer survey was carried out using a Scintrex Envi-I unit with the total field being measured and a station magnetometer for correcting magnetic drift. These are total field magnetometers which measure the magnetic field through the use of proton precessional effects caused by the interaction of a magnetic field with a spin aligned, proton rich fluid. An instrument accuracy precision and resolution of 0.1 nt may be obtained with these instruments under ideal conditions. Microprocessors contained in these instruments allow for the collection of the readings along with the time and its position in digital form suitable for downloading to a computer for data processing.

A total of 13 kilometers of magnetic readings were taken and readings were taken along the lines at 25 meter station intervals. The field measurements were corrected for diurnal variations of the earth's magnetic field by direct subtraction of the base station readings from the reading taken at the same moment in the field units. The corrected data was then downloaded to a computer and plotted on the total field magnetic map.

### **INTERPRETATION**

The total field magnetic survey produced a strong anomaly running north south centered on line 9+50 east from 3+00 south to 3+00 north with an offset running north east and north west from there. Also, from 3+00 south there are 2 magnetic anomalies running off the main anomaly at 3+00 south running in a northeast and south east direction with these anomalies being open in both directions.

The induced polarization survey proved successful in finding areas of disseminated sulphide which merit more exploration such as drilling these anomalies.

The total field values for these anomalies are well above background from 100 to 400 nT which could correspond to a magnetic mineralized target.

. Also, for a better observation of data interpretation see map in back of report.



**CONCLUSIONS**

With the presence of a favorable geological environment and the recent discovery of PGM and Base Metals by New Millennium Metals Corporation, Mustang Minerals Corp., Tearlach Exploration Ltd., Ursa Major Corp. and Pacific North West Capitol and the past prospecting survey over the grid with anomalous values in the same rock type lends credence to the potential of the property hosting either a PGM or copper/nickel deposit.

Also, assays to date by John Finley of New Millennium Minerals were up to 4% copper, 0.8% nickel, 900 ppm of cobalt and 0.5 grams of platinum palladium combined.

This considered, shows the Hyman/Nairn property to be very favorable geological environment for the localization of economic importance. To further evaluate the property's potential, with the encouraging results of the geophysics survey the writer recommends on going work consisting of line cutting and geophysical surveys over the balance of the property not covered and test drilling the anomalies found.

Dan Patrie

Geology and Geophysics Technologist

April 10, 2003



**PERSONNEL**

Dan Patrie  
Massey, Ontario

Bryan Patrie  
Spanish, Ontario

Brent Patrie  
Elliot Lake, Ontario

Bronson Ede  
Spanish, Ontario

## **REFERENCES**

1. R. M Ginn, 1965, Ontario Department of Mines, Geological Report No. 35, Nairn and Lorne Townships.
2. K. D. Card, 1965, Ontario Department of Mines, Geological Report No. 34, Hyman and Drury Townships.
3. K. D. Card, 1978, Ontario Geological Survey, Report 166, Geology of the Sudbury-Manitoulin Area, Districts of Sudbury and Manitoulin.

## CERTIFICATE OF QUALIFICATION

I, Daniel Patrie do hereby certify:

1. That I am a Geology and Geophysics Technologist and I reside at Hwy. 17 West, P.O. Box 45, Massey, Ont., Canada, P0P 1P0,
2. I graduated from Cambrian College Of Applied Arts and Technology, Sudbury, Ontario, in 1987 with a diploma in Geological Technology with a one year certificate in Geophysics,
3. And I have practiced my profession continuously since graduation, as well as being an active prospector since 1972.
4. That my report on the Hyman Nairn Township Property, Sudbury Mining Division, Ontario, is based on my personal knowledge of the geology of the area, and on a review of published and unpublished information on the property and surrounding area.
5. That I supervised the entire exploration program.

Daniel F. Patrie

Geology and Geophysics Technologist (Dipl. T)

April 10, 2003

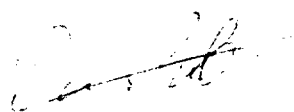

**LETTER OF CONSENT**

I, Daniel F. Patrie, of the Town of Massey, Ontario, do hereby consent to Mustang Minerals Corp., using in whole or in part my Geophysics report on the Hyman Boundary Property situated in the District of Sudbury Ontario, Sudbury Mining Division in a prospectus of statement of material facts or for filing with government regulatory bodies as deemed necessary.

Dated at Massey, Ontario this 10<sup>th</sup> day of April, 2003, in the District of Sudbury, Ontario.

Daniel F. Patrie

Geology and Geophysics Technologist.

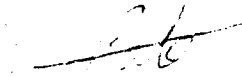



Date: 2003-MAY-05

GEOSCIENCE ASSESSMENT OFFICE  
933 RAMSEY LAKE ROAD, 6th FLOOR  
SUDBURY, ONTARIO  
P3E 6B5

MUSTANG MINERALS CORP.  
1351 E. KELLY LAKE RD. UNIT 8  
SUDBURY, ONTARIO  
P3E 5P5 CANADA

Tel: (888) 415-9845  
Fax: (877) 670-1555

**Submission Number:** 2.25466  
**Transaction Number(s):** W0370.00679

Dear Sir or Madam

**Subject: Approval of Assessment Work**

We have approved your Assessment Work Submission with the above noted Transaction Number(s). The attached Work Report Summary indicates the results of the approval.

At the discretion of the Ministry, the assessment work performed on the mining lands noted in this work report may be subject to inspection and/or investigation at any time.

If you have any question regarding this correspondence, please contact STEVEN BENETEAU by email at [steve.beneteau@ndm.gov.on.ca](mailto:steve.beneteau@ndm.gov.on.ca) or by phone at (705) 670-5855.

Yours Sincerely,



Ron Gashinski  
Senior Manager, Mining Lands Section

Cc: Resident Geologist

Ken J. Lapierre  
(Agent)

Assessment File Library

Mustang Minerals Corp.  
(Claim Holder)

Mustang Minerals Corp.  
(Assessment Office)



41I05SE2014 2.25466 HYMAN

200

ONTARIO CANADA

MINISTRY OF NORTHERN DEVELOPMENT AND MINES  
PROVINCIAL MINING RECORDER'S OFFICE

Mining Land Tenure Map

Date / Time of Issue: Fri May 02 15:54:42 EDT 2003

TOWNSHIP / AREA  
HYMAN

PLAN  
G-2966

ADMINISTRATIVE DISTRICTS / DIVISIONS

Mining Division  
Land Titles/Registry Division  
Ministry of Natural Resources District

Sudbury  
SUDBURY  
SUDBURY

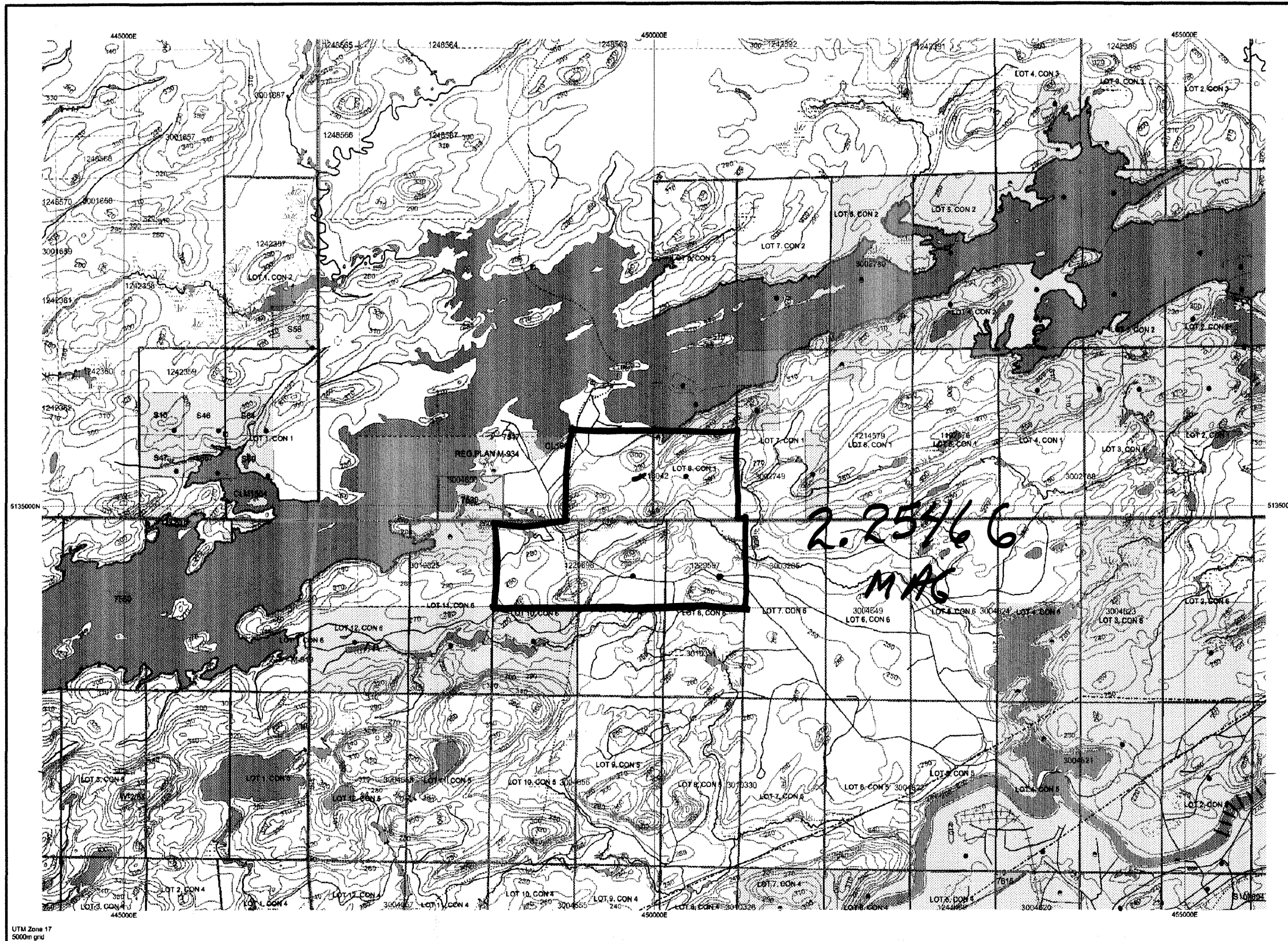

UTM Zone 17  
5000m grid

TOPOGRAPHIC

- Administrative Boundaries
- Township
- Concession Lot
- Provincial Park
- Indian Reserve
- Cliff, Pit & Pile
- Contour
- Mine Shaft
- Mine Headframe
- Railway
- Road
- Trail
- Natural Gas Pipeline
- Utilities
- Tower

Land Tenure

- Freehold Patent**
  - Surface And Mining Rights
  - Surface Rights Only
  - Mining Rights Only
- Leasehold Patent**
  - Surface And Mining Rights
  - Surface Rights Only
  - Mining Rights Only
- Licence of Occupation**
  - Uses Not Specified
  - Surface And Mining Rights
  - Surface Rights Only
  - Mining Rights Only
  - Land Use Permit
  - Order in Council (Not open for staking)
  - Water Power Lease Agreement
  - Mining Claim
  - Filled Only Mining Claims
- LAND TENURE WITHDRAWALS**
  - Areas Withdrawn from Disposition
  - Mining Acts Withdrawal Types**
    - Surface And Mining Rights Withdrawn
    - Surface Rights Only Withdrawn
    - Mining Rights Only Withdrawn
  - Order in Council Withdrawal Types**
    - Surface And Mining Rights Withdrawn
    - Surface Rights Only Withdrawn
    - Mining Rights Only Withdrawn
- IMPORTANT NOTICES**

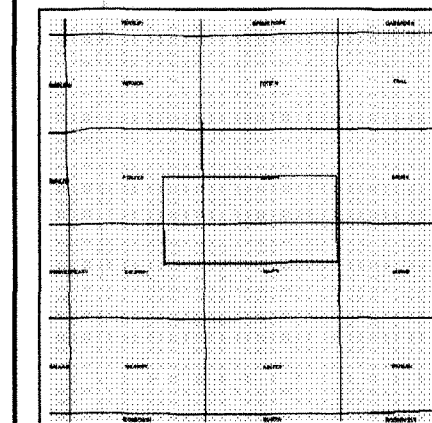

LAND TENURE WITHDRAWAL DESCRIPTIONS

Identifier	Type	Date	Description
7517	Wsm	Jan 1, 2001	PENDING S.R.O. APPLICATION UNDER PUBLIC LANDS ACT.
7530	Wm	Jan 1, 2001	O.C. 9/145 M.R.O. 9290
7559	Wsm	Jan 1, 2001	W.P.L.A. NO 110, FILE 8214 SURFACE RIGHTS WITHDRAWN
7515	Wsm	Jan 1, 2001	APPLICATION UNDER SEC.30(B) DEC.23/03 SEE LAND ROLL FILE
PDS	Wsm	Jan 4, 2002	Proposed Dump Site
W-2/83	Ws	Mar 31, 1983	SEC.36/80 W-2/83 313/83 S.R.O. 77094
W-1/84	Ws	May 10, 1984	SEC.36/80 W-1/84 10/5/84 S.R.O. 188539
W-26/85	Ws	Dec 12, 1985	SEC.36/80 W-26/85 NER 12/12/85 S.R.O.
ProvPark	Wsm	Oct 20, 2001	Spanish River Provincial Park
W-LL-P192/01	Wsm	Jul 20, 2001	SEC 35 W-LL-P192/01 ONT JULY 20/01 M+S
W-LL-P192/99	Wsm	May 17, 1999	SEC 35 W-LL-P192/99 ONT MAY 17/99 M+S (200 m FROM WATERS EDGE)
W-4/82	Ws	Jul 14, 1982	SEC.36/80 W-4/82 14/07/82 S.R.O. 137635

Those wishing to stake mining claims should consult with the Provincial Mining Recorders' Office of the Ministry of Northern Development and Mines for additional information on the status of the lands shown hereon. This map is not intended for navigational, survey, or land title determination purposes as the information shown on this map is compiled from various sources. Completeness and accuracy are not guaranteed. Additional information may also be obtained through the local Land Titles or Registry Office, or the Ministry of Natural Resources.

The information shown is derived from digital data available in the Provincial Mining Recorders' Office at the time of downloading from the Ministry of Northern Development and Mines web site.

General Information and Limitations

Contact Information:  
Provincial Mining Recorders' Office  
Wilket Green Miller Centre 933 Ramsey Lake Road  
Sudbury ON P3E 6B5  
Home Page: [www.mndm.gov.on.ca/MNDM/MINES/LANDS/mimsmppge.htm](http://www.mndm.gov.on.ca/MNDM/MINES/LANDS/mimsmppge.htm)

Toll Free  
Tel: 1 (888) 415-8845 ext 5788  
Fax: 1 (877) 670-1444

Map Datum: NAD 83  
Projection: UTM (8 degree)  
Topographic Data Source: Land Information Ontario  
Mining Land Tenure Source: Provincial Mining Recorders' Office

This map may not show unregistered land tenure and interests in land including certain patents, leases, easements, right of ways, flooding rights, licences, or other forms of disposition of rights and interest from the Crown. Also certain land tenure and land uses that restrict or prohibit free entry to stake mining claims may not be illustrated.



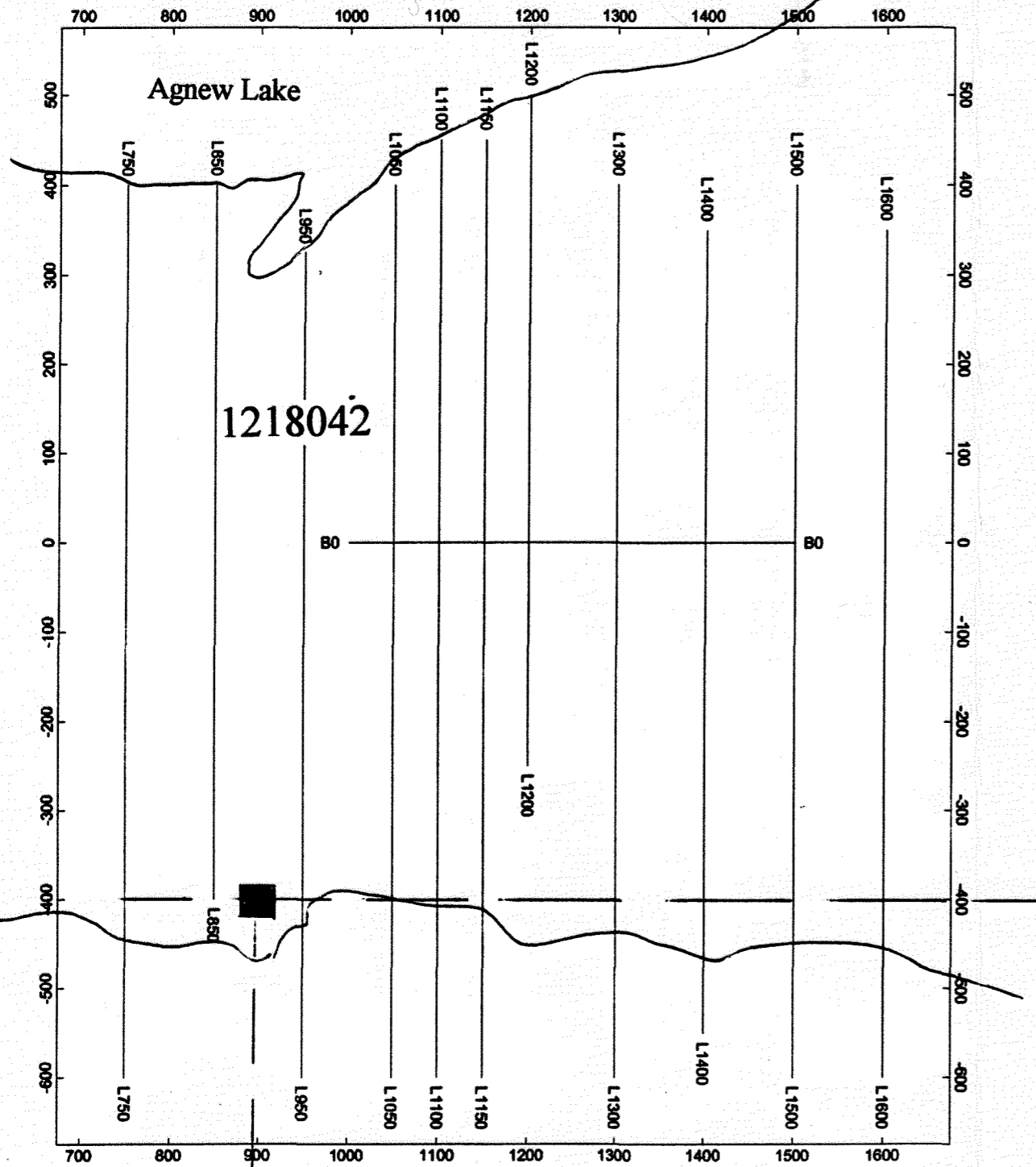

1218042

1229698

1229697

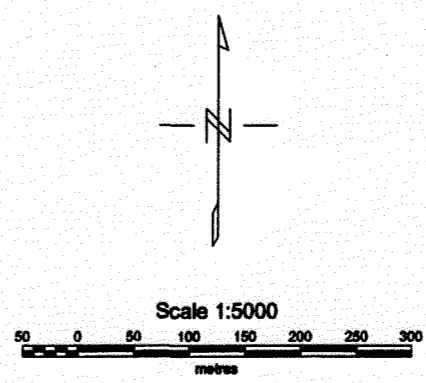

MUSTANG MINERALS CORP.
BASE MAP NAIRN PROPERTY HYMAN TOWNSHIPS
CLAIM LINE ——— CLAIM POST ■
DRAWN BY; DAN PATRIE EXPLORATION LTD.

2.25466



