



41105SE9404 BALDWIN 25C1 BALDWIN

010

LOG : HOLE 1
HANS WIEMER, SUDBURY
LIC. #C 25.169
CLAIM 82.681
BALWIN TWP.

Log
of Hole # 1
Hans Wiener jr., Sudbury
Lic. # C ~~25.267~~ 25.169
Claim ~~83.476~~ ~~82.481~~ 82.681
Baldwin Twp.

HOLE #1 Record holder of claim: Hans Wiemer, Sudbury Lic. #C25267
 drilled on claim: 82.681 in Baldwin Twp.

Angle of drill hole: 70°
 direction of hole: to south west

Date	Footage	Workmen	Rock types encountered	Sample #	on feet	Assay	Remarks
April 17/55	6'	Hans Wiemer, Jr.	Nipissing quartz diabase				
April 18/55	1' 7'	Rynart Weimer	" " "				
April 19/55	17' 24'	Allan Dixon	" " "				
April 20/55	15' 39'	" "	Quartz diabase, 30'-33' quartz	#1	30'	Gold trace, silver none	Five assay
		" "	Quartz mixed with diabase, calcite	#2	36'	Chrom. T, cobalt, copper T-L Lead T, Mang. T, nickel T, silver T, titanium L, Vanad. -T, Zircon T.	Spectrograph Analysis
April 21/55	16' 55'	" "	Calcide vein with black & some red cristal				
April 22/55	16'	" "	" " " " " "				
Total	71'	" "					
April 23/55	5' 76'	Rynart Wiemer Wilfrid Wiemer	" " " " " "	#3	80'	Boron T, Chrom. T, Cobalt T, Copper T, Mang. T-L, Nickel T Titanium M, Van. T, Zinc T Zircon T.	Spectrograph Anal.
April 24/55	12'	Allan Dixon	" " " " " "				
Total	88'			#4	88'	Chrom. T, Cobalt T, Copper T, Mang. T-L, Nickel T, Silver T, Titanium M, Vanad. T, Zircon T	Spectrograph Anal.
May 8/55	22' 110'	Hans F. Wiemer Kurt Fuerins	" " " " " "	#5	86'	Zinc none, Iron 18.17%	Chemical Analy.
May 9/55	18' 128'	Fred Zippel	" " " " " "	#6	87-88'	Silver trace, copper-trace	" "
May 11/55	12'	Hans F. Wiemer	" " " " " "	#7	110'	Boron T, Chrom. T, Cobalt T, Copper T, Mang. L, Nickel T, Titanium L, Vanad. T. Zircon T.	Legend of Spectrograph Analysis
Total	140'	Fred Zippel					
May 12/55	10'	" "	Calcide quartz, reddish pebbles				
Total	150'		last 7' not recovered, still in hole.			Drill hole is 200' south of No. 4 Post of 82681	H= 10 to 100% MH= 5 to 15% M= 1 to 10% L-M= 0.5 to 5% L= 0.1 to 1% T-L= 0.05 - - 0.50% T= less than 0.10%

**DUPLICATE COPY
 POOR QUALITY ORIGINAL
 TO FOLLOW**

Hole # 1 Record holder of claim: Hans Wreiner, Sundry Lic. # 25 267
 drilled on claim: ~~82681~~ in Baldwin Trwp.
 82681

Angle of drill hole: 70°
 direction of hole: to south west

date	footage	workmen	rock types encountered	sample #	Feet	Assay	Remarks
April 17/55	6'	Hans Wreiner &	Hips issuing quartz diabase
April 18/55	1'	Rupert Wreiner	"
April 19/55	17'	Allan Brian	"
	24'	"	"
April 20/55	15'	"	quartz diabase, 30'-33' quartz'	# 1	30'	gold trace, silver none	Fire assay
	39'	"	quartz mixed with labau, calcite	# 2	36'	Iron T, cobalt T, copper T-L, Gold T, Manganese T, nickel T, silver T, Titanium L, Vanad T, Zircon T.	Spectrograph. Analysis
April 24/55	16'	"	calcide vein with black, some red oxidite				
April 24/55	16'	"	"				
	total						
April 27/55	5'	Rupert Wreiner	"	# 3	80'	Iron T, Cobalt T, Copper T, Manganese T-L, Nickel T, Titanium L, Vanad T, Zircon T.	Spectrograph. Analysis
April 27/55	76'	Wilfrid Wreiner	"				
April 27/55	12'	Allan Brian	"				
	total						
May 8/55	22'	Hans F. Wreiner	"	# 4	88'	Iron T, Cobalt T, Copper T, Manganese T-L, Nickel T, Silver T, Titanium L, Vanad T, Zircon T.	Spectrograph. Analysis
May 8/55	110'	Kurt Frennis	"	# 5	86'	Zinc none, Iron 18, 17%	Chemical Analysis
May 9/55	18'	Fred Zippel	"	# 6	87.5'	Silver: trace, Copper: trace	"
	total						
May 14/55	12'	Hans F. Wreiner	"	# 7	100'	Iron T, Cobalt T, Copper T, Manganese T, Nickel T, Titanium L, Vanad T, Zircon T.	Legend of symbols.
	total	Fred Zippel					
May 12/55	10'	"	calcide quartz, reddish pebbles				
	total		last 7' not recovered, still in hole				

DRILL HOLE IS
 200' SOUTH OF No 4
 POST OF 82681

Legend of symbols:
 H = 10 to 100%
 MH = 5 to 15%
 M = 1 to 10%
 L-M = 0.5 to 5%
 L = 0.1 to 1%
 T-L = 0.05 - 0.50%
 T = less than 0.10%

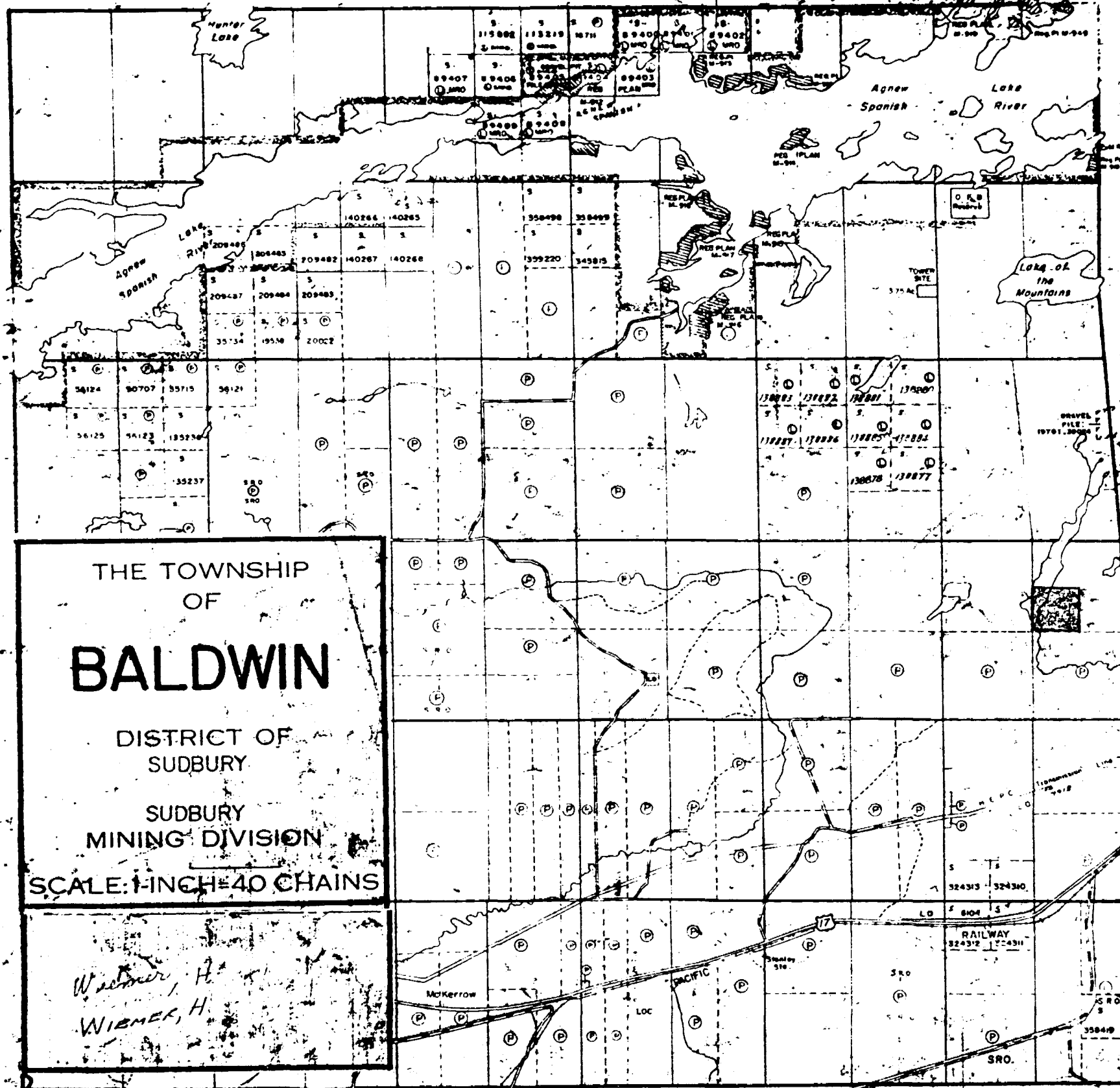

THE TOWNSHIP OF BALDWIN DISTRICT OF SUDBURY SUDBURY MINING DIVISION SCALE: 1 INCH = 40 CHAINS

Wiemer, H. WIEMER, H.

12 11 10 9 8 7 6 5 4 3 2 1

VI

V

IV

III

II

I

Nairn Twp. (M-883)