



41105SW0021 0032A1 BALDWIN

010

GEOLOGY AND SCINTILLOMETER SURVEY

FOR

BIRCH POINT MINES LTD.

GREAT YUKON MINES LTD.

SEELEY MINING CORP. LTD.

BALDWIN AND SHAKESPEARE TOWNSHIPS

ONTARIO

*P. HOLLER - Hunt*

NOVEMBER 1967.

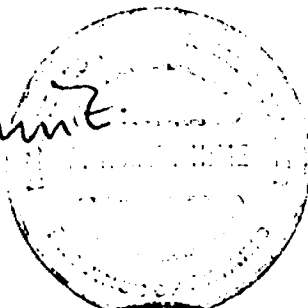

*R. H. Sutherland*



SUMMARY

The purpose of the survey was to locate uranium. Lines were cut north and south on 400 centres over the entire property. Scintillometer counting was carried out over outcrops encountered on the lines and, where deemed advisable on either side of the lines, geological mapping followed the same procedure. Mississagi formations were found in the northern and southwestern parts of the property. They returned universally low scintillometer counts with the exception of a pit near line 56, 6/008. Snow cover prevented a detailed examination, though a grab assay ran .015%  $U_3O_8$ . It is felt that a small belt of basal Mississagi rocks may strike east-west in Concession II, Lots 11 and 12, in the vicinity of the pit and this should definitely be examined in detail in the spring. Some of the southwestern claims should be allowed to lapse.

SCINTILLATION COUNTING

Counts were taken over rock outcrops encountered on the lines. Background in the area was found to be 25 counts per minute. This figure in general applied over basic rocks, volcanics and metasedimentary or schist facies. It was also found to apply over the Mississagi formation though counts were generally fractionally higher at say 30 cpm. This is not considered significant. Counts are plotted on the attached map.

One count of 180 cpm was obtained near a small pit in Mississagi quartzites on L 56, 6/00 south. By the time this pit was found, snow had fallen and detailing of the area was impossible.

The unit used was a McPhar TV3 scintillometer.

## GEOLOGY

For the purposes of this survey which was directed primarily at the Mississagi formation, only three fundamental rock units were distinguished. They are:-

- (a) Post-sedimentary diabase and gabbro, and pre-sedimentary volcanics.
- (b) Quartzites of the Mississagi formation.
- (c) Sedimentary rocks and schists.

The age-relationships of (b) and (c) are not considered important for the purposes of this report.

Outcrops were mapped as encountered on the lines. These are shown on the attached map.

A small belt of Mississagi rocks crosses the property with an east-west strike in the southwest corner on claims S 139512, S 139511. This is quite a narrow belt, appears to be partly secondarily silicified quartzite and has very low scintillometer counts. It does not warrant further investigation for uranium or thorium.

A second belt of Mississagi rocks crosses the northern part of the property with an east-west strike on claims S 139265, 139264, 139267, 139270, 139273, 139276.

Here in general the dips of the Mississagi quartzite are vertical or to the south at a steep angle. A section drawn from north to south might indicate the following:-

- (a) "basement" of volcanic rocks;
- (b) Mississagi rocks, possibly with conglomerate;
- (c) Basic intrusives apparently lying above, but probably intruded into the Mississagi quartzite.

No conglomerate was found during this examination of the ground, primarily because first snows had fallen by the time the northern part of the property was surveyed. However, one small pit had been blasted out as previously mentioned; such rocks as were visible were heavily gossaned and on the fresh surface indicated a pyrite content of up to 5% with minor pyrrhotite. Leaching was also noted and a grab sample from debris scattered around the pit assayed 0.015%  $U_3O_8$  chemical. This higher radioactivity is coincident with proximity northward to basement - in this case composed of volcanic rocks.

On this basis it is felt that this northern belt of Mississagi rocks should be very closely examined in the spring.

#### RECOMMENDATIONS

1. Detailed geological mapping of the east-west belt of Mississagi rocks running through the middle of Concession II, Lots 11 and 12.
2. Detailed scintillometer counting over the same area.
3. If significant pyrite concentration and continuity can be established consideration should be given to a Ronka EM 16 - type survey over the areas on strike from the surface sulfide concentrations.
4. Survey details be applied as assessment work to maintain the property in good standing - at least in the area suggested, for work in the spring of 1968; the remainder of the ground in Concession I Baldwin & Shakespeare Townships be allowed to lapse.

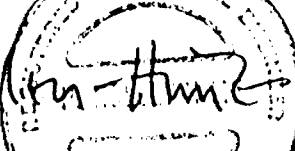
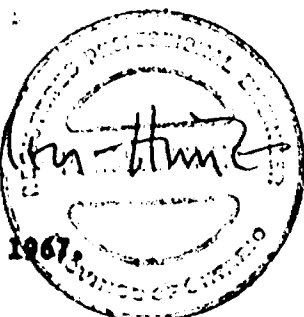
P. H. H.   
November 1967 

Respectfully submitted,

  
Earth Sciences International, 



T WORK BREAKDOWN

900

- 1. Type of Survey Geological
- 2. Township or Area Baldwin and Shakespeare, Sault Ste Marie District.
- 3. Numbers of Mining Claims Traversed by Survey 139501, 139502, 139503, 139504, 139505.  
139506, 139507, 139508, 139509, 139510, 139511, 139512, 139513, 139514, 139261.  
139262, 139263, 139264, 139265, 139266, 139267, 139268, 139269, 139270, 139271,  
139272, 139273, 139274, 139275, 139276, 139277, 139278.

4. Number of Miles of Line Cut 30.9 Flown nil

\*5. Number of Stations Established -----

\*6. Make and type of Instrument Used -----

\*7. Scale Constant or Sensitivity -----

\*8. Frequency Used and Power Output -----

9. Summary of Assessment Credits (details on reverse side)

Total 2 hour Technical Days (Include Consultants, Draughting etc.) ~~XXX~~ 184

Total 8 hour Line-Cutting Days see other survey

Calculation

$$\frac{184}{\text{Technical}} \times 7 = \frac{1288}{\text{Line-cutting}} + \frac{\text{nil}}{\text{Line-cutting}} = \frac{1288}{\text{Line-cutting}} \div \frac{32}{\text{Number of claims}} = \frac{42}{\text{Assessment credits per claim}}$$

The dates listed on this form represent working time spent entirely within the limits of the above listed claims  Check  
If otherwise, please explain -----

Dated: Dec 19, 1967

Signed:

- Note:
- (A) \* Complete only if applicable.
  - (B) Complete list of names, addresses and dates on reverse side.
  - (C) Submit separate breakdown for each type of survey.
  - (D) Submit in duplicate.

ASSESSMENT WORK BREAKDOWN

1. FIELD WORK

<u>Type of Work</u>	<u>Name &amp; Address</u>	<u>Dates Worked</u>	<u>Number of 8 hour days</u>
Geol. Mapping	P. Holley Hime - Toronto	Oct 24 - Nov 20, 67 (30)	45
" "	M. W. Channing "	Oct 24 - Nov 20, 67 (28)	42
" "	F. Sparrow "	Oct 25 - Nov 19, 67 (26)	39
" "	H. Sutherland "	Oct 25 - Nov 19, 67 (26)	39

2. CONSULTANTS

<u>Name &amp; Address</u>	<u>Dates Worked (specify in field or office)</u>	<u>Number of 8 hour days</u>
H. Sutherland	Office Nov 25, 27	3
P. Holley Hime	Office Nov 21 to 29	8

3. DRAUGHTSMAN, TYPING, OTHERS (specify)

<u>Name &amp; Address</u>	<u>Type of Work</u>	<u>Dates Worked</u>	<u>Number of 8 hour days</u>
M. W. Channing	drafting	Nov 25 to 30	6
T. Pilo	Typing	Nov 29, 30	2

TOTAL 8 HOUR TECHNICAL DAYS 184

4. LINE-CUTTING

<u>Name</u>	<u>Address</u>	<u>Dates Worked</u>	<u>Number of 8 hour days</u>

TOTAL 8 HOUR LINE-CUTTING DAYS \_\_\_\_\_

ASSESSMENT WORK BREAKDOWN

1. FIELD WORK

<u>Type of Work</u>	<u>Name &amp; Address</u>	<u>Dates Worked</u>	<u>Number of 8 hour days</u>
Geol. Mapping	P. Holley Hime - Toronto	Oct 24 - Nov 20, 67 (30)	45
" "	M. W. Channing "	Oct 24 - Nov 20, 67 (28)	42
" "	F. Sparrow "	Oct 25 - Nov 19, 67 (26)	39
" "	H. Sutherland "	Oct 25 - Nov 19, 67 (26)	39

2. CONSULTANTS

<u>Name &amp; Address</u>	<u>Dates Worked (specify in field or office)</u>	<u>Number of 8 hour days</u>
H. Sutherland	Office Nov 25, 27	3
P. Holley Hime	Office Nov 21 to 29	8

3. DRAUGHTSMAN, TYPING, OTHERS (specify)

<u>Name &amp; Address</u>	<u>Type of Work</u>	<u>Dates Worked</u>	<u>Number of 8 hour days</u>
M. W. Channing	drafting	Nov 25 to 30	6
T. Pilo	Typing	Nov 29, 30	2

TOTAL 8 HOUR TECHNICAL DAYS 184

4. LINE-CUTTING

<u>Name</u>	<u>Address</u>	<u>Dates Worked</u>	<u>Number of 8 hour days</u>

TOTAL 8 HOUR LINE-CUTTING DAYS \_\_\_\_\_

ASSESSMENT WORK BREAKDOWN

1. Type of Survey Radometric
2. Township or Area Baldwin and Shakespeare
3. Numbers of Mining Claims Traversed by Survey 32  
S 139261 to 139278 Incl 139501 to 139514 (139501 → 139514)
4. Number of Miles of Line Cut 30.9 Flown nil
- \*5. Number of Stations Established 1601
- \*6. Make and type of Instrument Used McPhar T.V.3 Scintillometer
- \*7. Scale Constant or Sensitivity Counts per minute radioactive emission
- \*8. Frequency Used and Power Output Position 2 uranium threshold only

9. Summary of Assessment Credits (details on reverse side)

Total 8 hour Technical Days (Include Consultants, Draughting etc.) 64

Total 8 hour Line-Cutting Days 180

Calculation

$$\frac{64}{\text{Technical}} \times 7 = \frac{448}{\text{Line-cutting}} + \frac{180}{\text{Line-cutting}} = \frac{608}{\text{Line-cutting}} \div \frac{32}{\text{Number of claims}} = \frac{19}{\text{Assessment credits per claim}}$$

The dates listed on this form represent working time spent entirely within the limits of the above listed claims  Check  
 If otherwise, please explain \_\_\_\_\_

Dated: Dec 20 1967

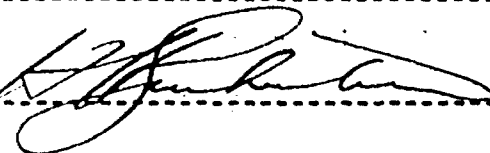
Signed: 

- Note: (A) \* Complete only if applicable.  
 (B) Complete list of names, addresses and dates on reverse side.  
 (C) Submit separate breakdown for each type of survey.  
 (D) Submit in duplicate.



ASSESSMENT WORK BREAKDOWN

1. FIELD WORK

<u>Type of Work</u>	<u>Name &amp; Address</u>	<u>Dates Worked</u>	<u>Number of 8 hour days</u>
Radiometric	B.T.HOwes	Oct nov 1967	
"	R. Parke	Oct, Nov, 1967	

2. CONSULTANTS

<u>Name &amp; Address</u>	<u>Dates Worked (specify in field or office)</u>	<u>Number of 8 hour days</u>
H Sutherland	Office	
M.W.Channing	Office	

3. DRAUGHTSMAN, TYPING, OTHERS (specify)

<u>Name &amp; Address</u>	<u>Type of Work</u>	<u>Dates Worked</u>	<u>Number of 8 hour days</u>
B.T.HOwes			

TOTAL 8 HOUR TECHNICAL DAYS 62

4. LINE-CUTTING

<u>Name</u>	<u>Address</u>	<u>Dates Worked</u>	<u>Number of 8 hour days</u>
Maurice Hibbard	contractors	5 men names not supplied.	
		Sept October 1967	120 days of 12 hrs each

TOTAL 8 HOUR LINE-CUTTING DAYS 180

ASSESSMENT WORK BREAKDOWN

1. FIELD WORK

<u>Type of Work</u>	<u>Name &amp; Address</u>	<u>Dates Worked</u>	<u>Number of 8 hour days</u>
Radiometric	B.T.HOwes	Oct nov 1967	
"	R. Parke	Oct, Nov, 1967	

2. CONSULTANTS

<u>Name &amp; Address</u>	<u>Dates Worked (specify in field or office)</u>	<u>Number of 8 hour days</u>
H Sutherland	Office	
M.W.Channing	Office	

3. DRAUGHTSMAN, TYPING, OTHERS (specify)

<u>Name &amp; Address</u>	<u>Type of Work</u>	<u>Dates Worked</u>	<u>Number of 8 hour days</u>
B.T.HOwes			

TOTAL 8 HOUR TECHNICAL DAYS 62

4. LINE-CUTTING

<u>Name</u>	<u>Address</u>	<u>Dates Worked</u>	<u>Number of 8 hour days</u>
Maurice Hibbard contractors	5 men names not supplied.		
Sept October 1967	120 days of 12 hrs each		

TOTAL 8 HOUR LINE-CUTTING DAYS 180

File: 63.2246 (63.2246)

THE MINING ACT

Assessment Work Credits

Name: Harry Schlesinger (HARRY SCHLESINGER)

Township or Area: Shakespeare and Baldwin Townships (SHAKESPEARE & BALDWIN TOWNSHIPS)

Number of Assessment work days per claim:

Geophysical -

Geological - 40

Geochemical -

Mining Claims:

Radiometric - 7

8 139501 to 139514 inclusive

(S 139501-139514 INCLUSIVE)

139261 to 139276 inclusive

(139261 TO 139276 INCLUSIVE)

139278 (139278)

EASTERN ONTARIO  
MINING DIVISION



83.2246  
PARLIAMENT BUILDINGS  
TORONTO 2, ONTARIO  
TEL. 365-1322

DEPARTMENT OF MINES

OFFICE OF MINING RECORDER

August 12, 1968.

*File under Shakespeare  
Twp.*

Mr. K.M. Hallock,  
5, Young St. N.,  
Sudbury, Ontario.

Mining claims S 139501 et al  
Shakespeare and Baldwin Townships

Dear Sir:

The geological and radiometric assessment work credits as shown on the attached list have been approved as of the above date. Please inform the recorded holder and so indicate on your records.

Yours truly,

A handwritten signature in cursive script, appearing to read "Fred W. Matthews".

Fred W. Matthews,  
Mining Recorder.

/AR  
Encl:

- cc: Mr. H. Shlesinger,  
Assistant to the Secretary,  
Birch Point Mines Limited,  
Suite 403-62 Richmond St. W.,  
Toronto 1, Ontario.
- cc: Mr. J.F. Donovan, ✓  
Resident Geologist,  
1349 La Salle Blvd.,  
Sudbury, Ontario.

Porter Twp. (M-1061)

Shakespeare Twp. (M-1104)

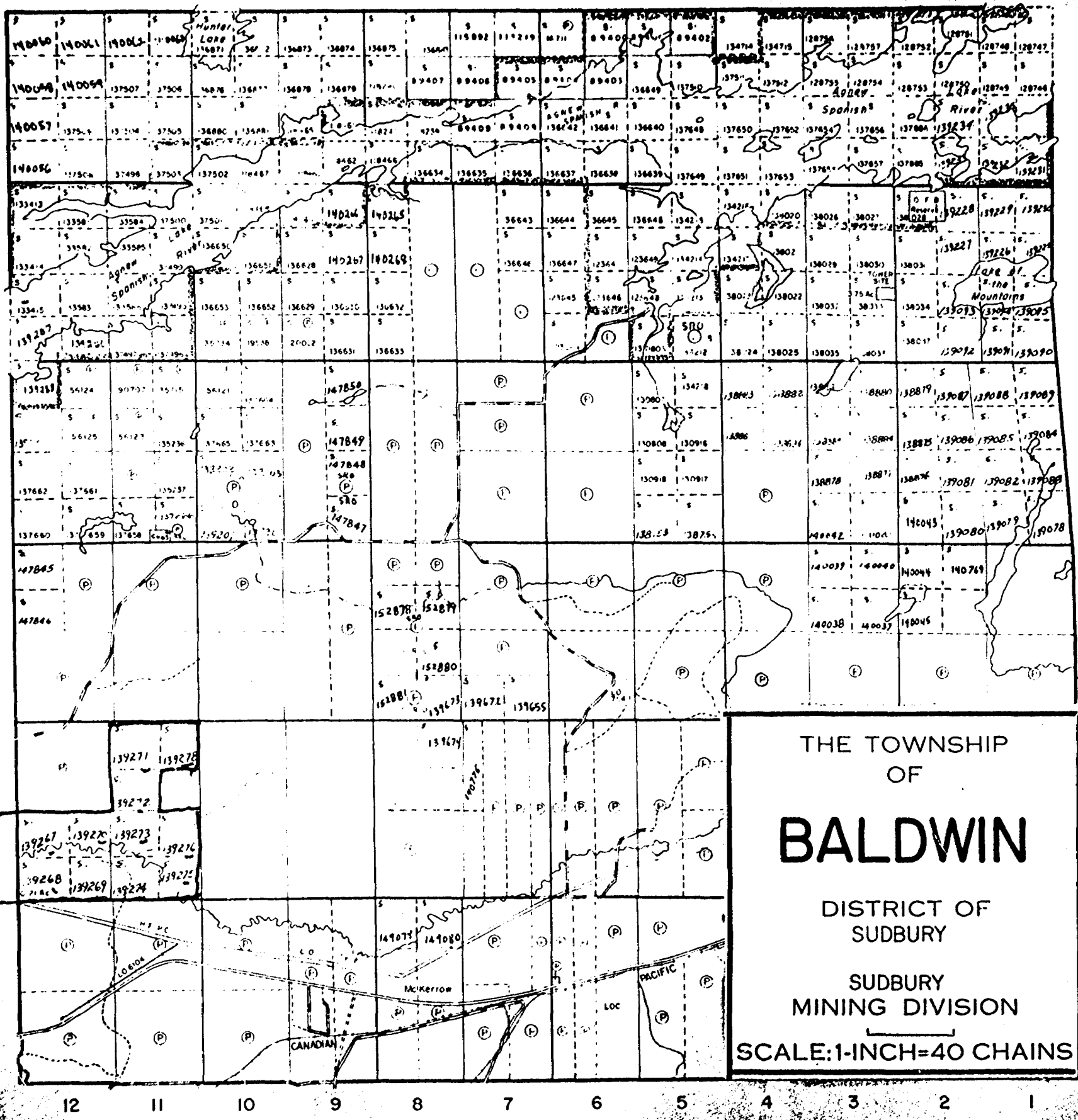

VI

V

IV

III

II

I

Nairn Twp. (M-883)

Merritt Twp. (M-863)

THE TOWNSHIP  
OF  
**BALDWIN**  
DISTRICT OF  
SUDBURY  
SUDBURY  
MINING DIVISION  
SCALE: 1-INCH=40 CHAINS

Dunlop Twp. (M.771)

Gough Twp. (M.890)

Baldwin Twp. (M.645)

THE TOWNSHIP  
OF  
**SHAKESPEARE**  
DISTRICT OF  
SUDBURY  
*SCHLESINGER, HARRY*  
SUDBURY  
MINING DIVISION  
SCALE: 1-INCH 40 CHAINS

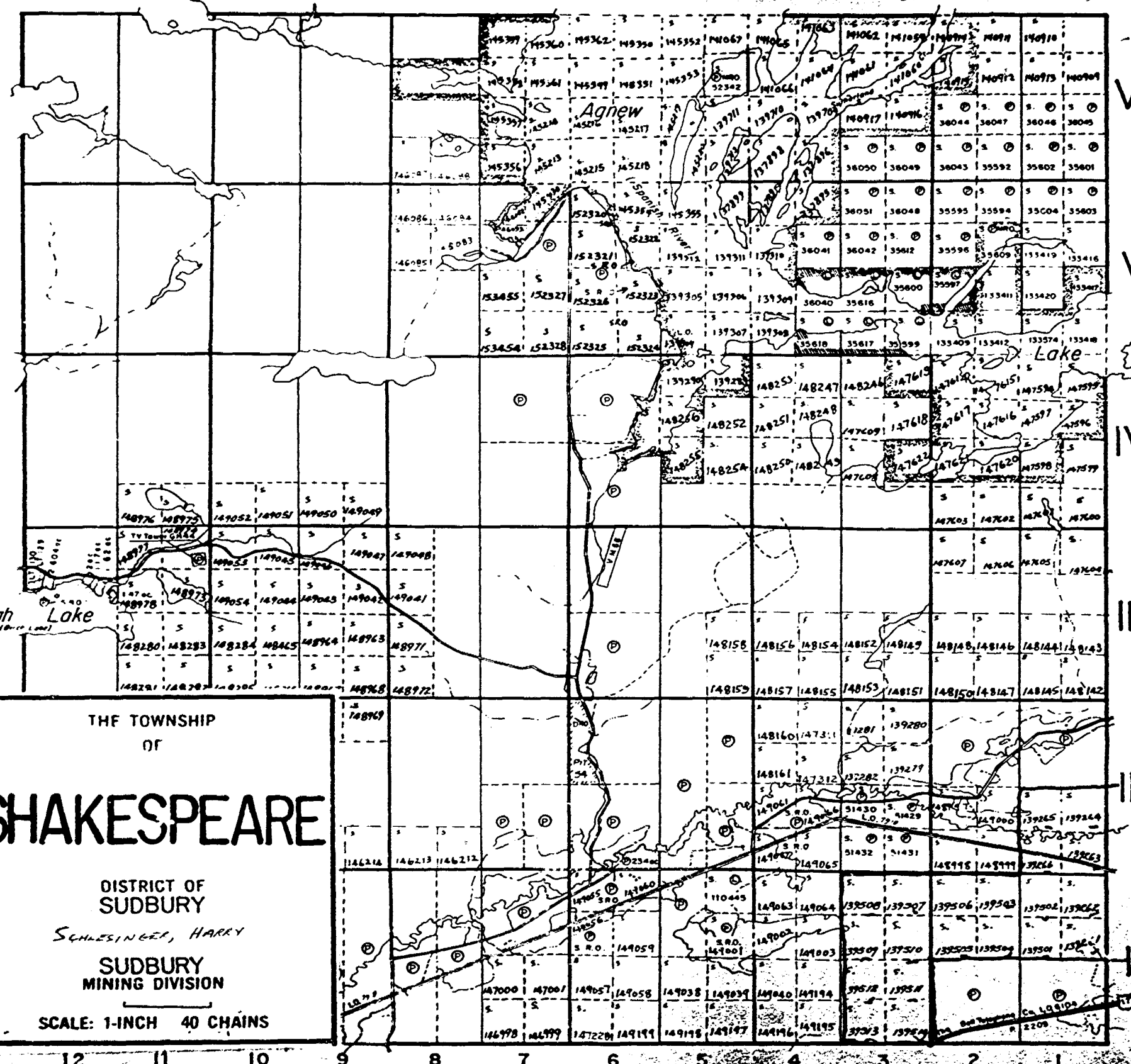

Hallam Twp. (M.909)

SEE ACCOMPANYING  
MAP(S) IDENTIFIED AS

BALDWIN-0032-A1, #1, #2

---

---

LOCATED IN THE MAP  
CHANNEL IN THE FOLLOWING  
SEQUENCE (X)

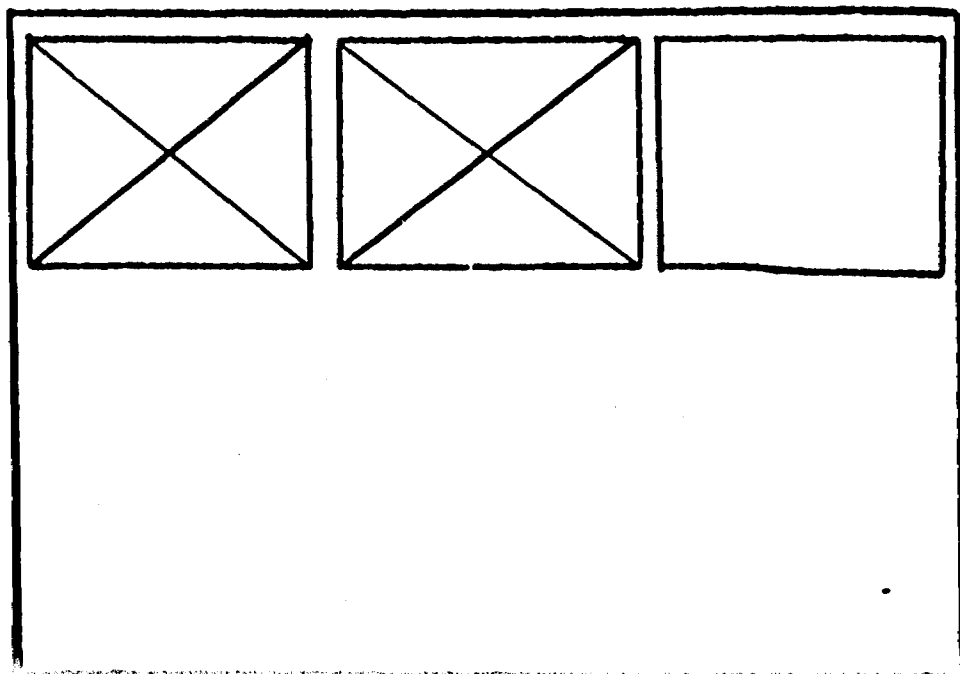

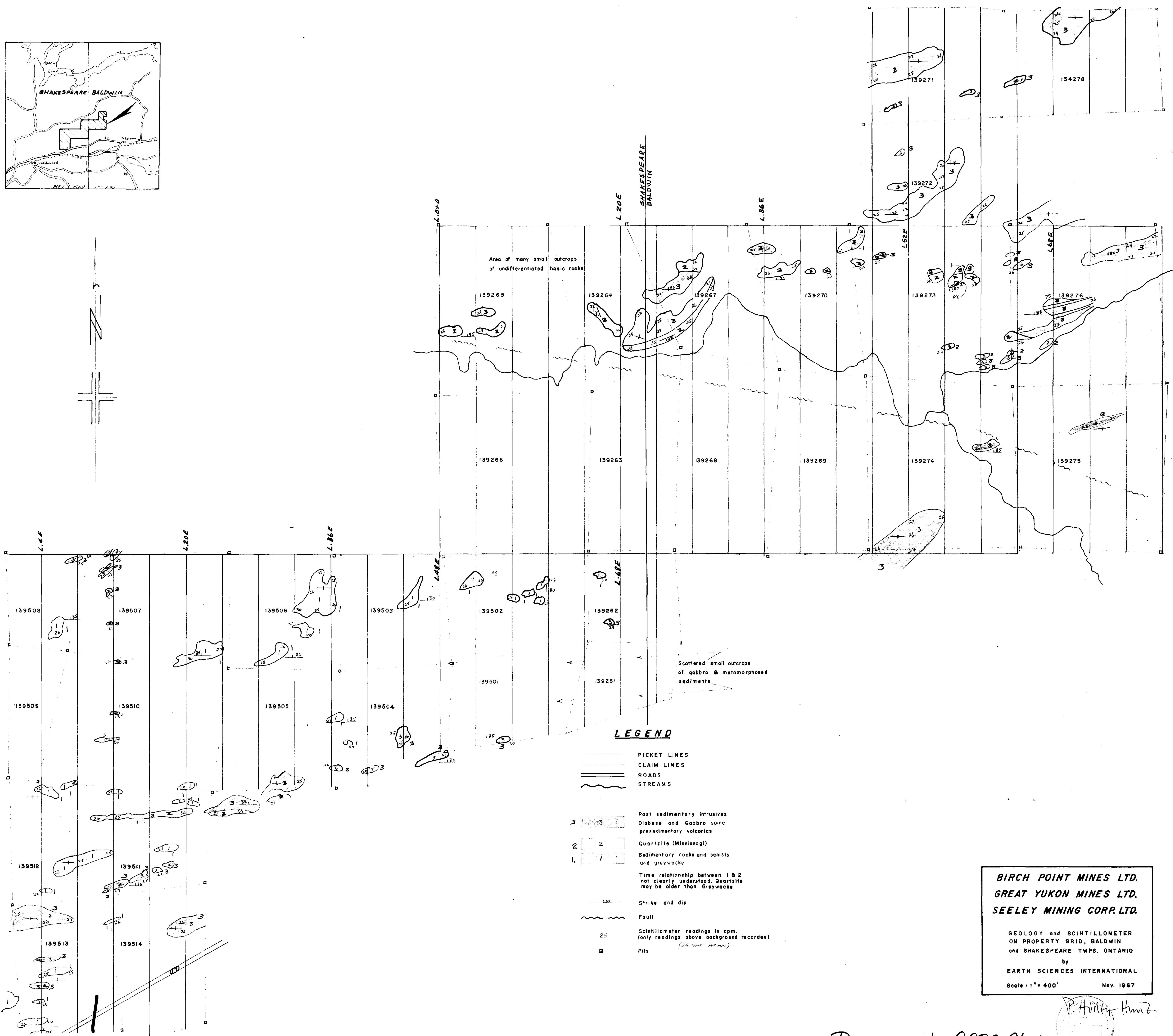
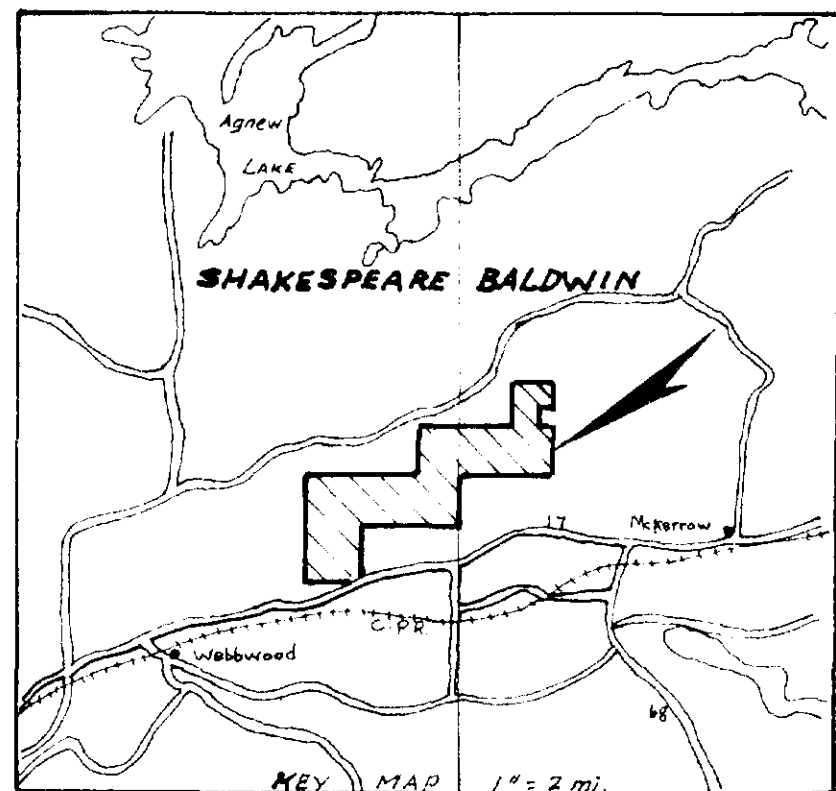

**BIRCH POINT MINES LTD.**  
**GREAT YUKON MINES LTD.**  
**SEELEY MINING CORP. LTD.**

GEOLOGY and SCINTILLOMETER  
 ON PROPERTY GRID, BALDWIN  
 and SHAKESPEARE TWPS. ONTARIO

by  
**EARTH SCIENCES INTERNATIONAL**

Scale 1" = 400' Nov. 1967

P. Holden Hunt

BALDWIN-0032-A1, #1





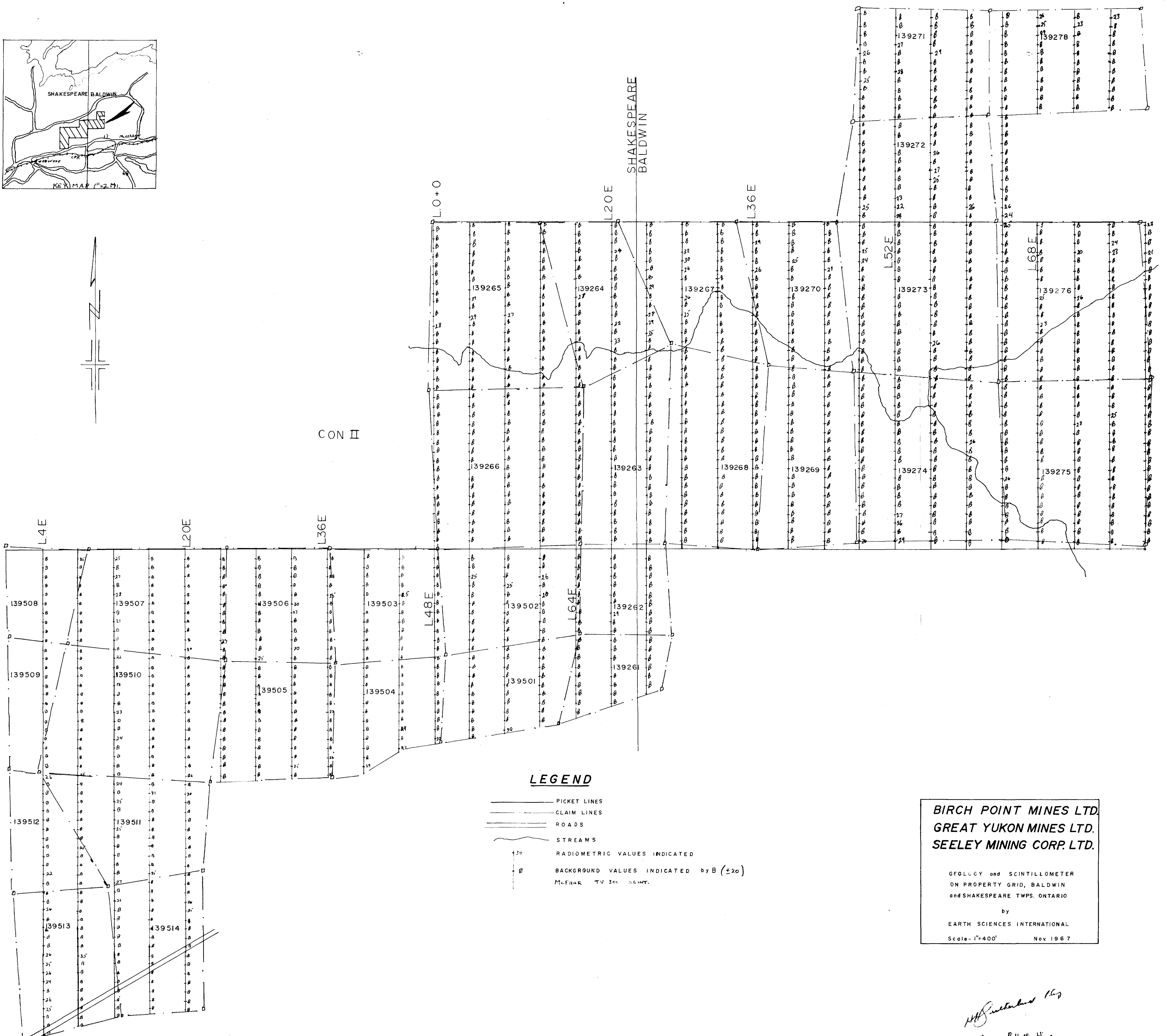
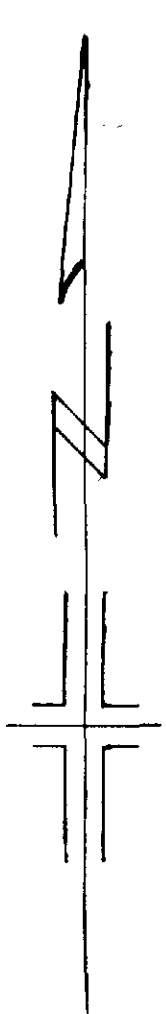
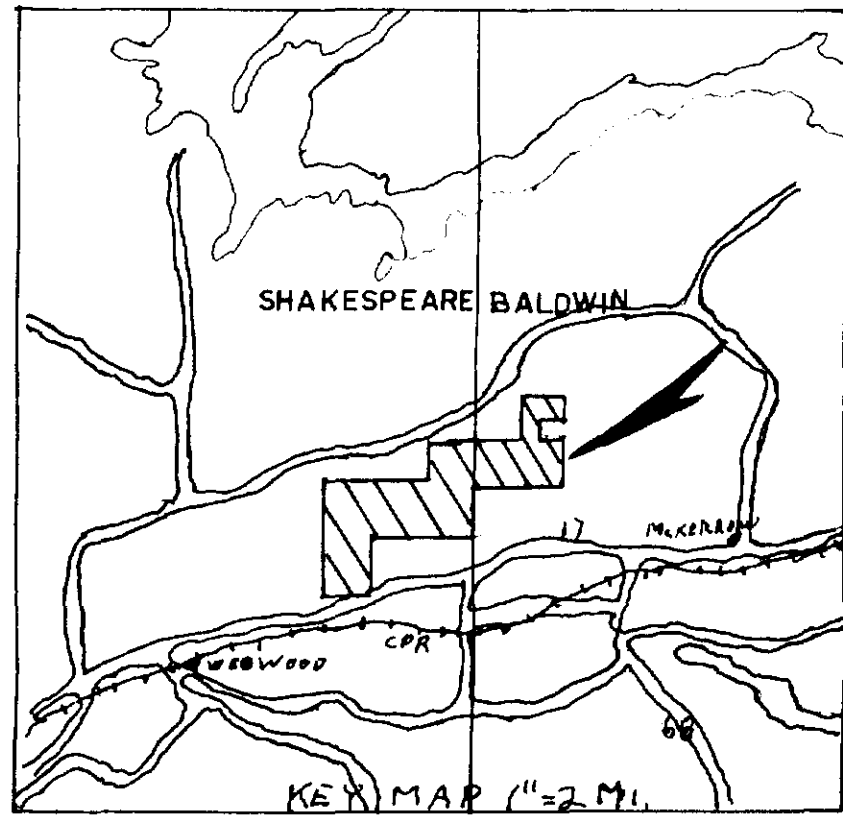

**LEGEND**

- PICKET LINES
- CLAIM LINES
- ROADS
- STREAMS
- 20 RADIOMETRIC VALUES INDICATED
- B BACKGROUND VALUES INDICATED by B (±20)
- McFAR TV 300 SCINT.

**BIRCH POINT MINES LTD.**  
**GREAT YUKON MINES LTD.**  
**SEELEY MINING CORP. LTD.**

GEOLOGY and SCINTILLOMETER  
 ON PROPERTY GRID, BALDWIN  
 and SHAKESPEARE TWP. ONTARIO

by  
 EARTH SCIENCES INTERNATIONAL

Scale: 1"=400' Nov 1967

*M. J. [Signature]*  
 from P. H. [Signature]

**BALDWIN-0032-A1, #2**