



Ministry of
Natural
Resources

Ontario
Geological
Survey

77 Grenville St.
11th Floor
Toronto, Ontario
Tel: 965-1337

Report Number
B 12843

Geoservices Laboratory Report

Date May 12, 1980

Used To: P.R. Blue, 207 Sweeney Drive, Don Mills, Ontario M4A 1V8

Sample Number	Gold Oz. Per Ton	Gold Value Per Ton	Silver Oz. Per Ton	
#1	Trace			 <p>411055W0059 0025A1 SHAKESPEARE</p> <p>900</p>

Fees Received

Paid \$6.75
Rec. No. B194397

Chris Riddle, Chief Analyst
Manager

Except by special permission, reproduction of these results must include any qualifying remarks made by this ministry with reference to any sample.

X-RAY ASSAY LABORATORIES
LIMITED

1885 LESLIE STREET, DON MILLS, ONTARIO M3B 3J4

CERTIFICATE OF ANALYSIS

REPORT 7200 REF. FILE 3385-F6

TO: P. G. BLUE,
207 SWEENEY DR.,
DON MILLS, ONTARIO.
M4A 1V5

3 ROCKS SUBMITTED ON 9-MAY-80

WERE ANALYSED AS FOLLOWS:

	UNITS	METHOD	DETECTION LIMIT
AU	OZ/TON	FA	0.010

DATE 14-MAY-80

X-RAY ASSAY LABORATORIES LIMITED

CERTIFIED BY

L. H. Operebeck
L. H. OPEREBECK

X-RAY ASSAY LABORATORIES 09-80 INVOICE 7200 REF. FILE 3385-F6 PAGE

SAMPLE	AU OZ/TON
2	NIL
3	NIL
4	NIL



Ontario

Ministry of
Natural
Resources

Ontario
Geological
Survey

77 Grenville St.
11th Floor
Toronto, Ontario

Tel: 965-1337

Report Number
B 13055

Geoservices Laboratory Report

Date Sept. 12,

Issued To: P.G. Blue, 207 Sweeney Drive, Toronto, Ontario M4A 1V5

Sample Number	Gold Oz. Per Ton	Gold Value Per Ton	Silver Oz. Per Ton					
1	Trace <.01			<table border="1"> <thead> <tr> <th>Sample No.</th> <th>Total Radioact (Uranium Oxide (Equivalent %)</th> </tr> </thead> <tbody> <tr> <td>#2</td> <td>0.0028</td> </tr> </tbody> </table>	Sample No.	Total Radioact (Uranium Oxide (Equivalent %)	#2	0.0028
Sample No.	Total Radioact (Uranium Oxide (Equivalent %)							
#2	0.0028							
2	Trace <.01							

Fees Received

3 Coups. Card #3100

Chris Riddie
 Chris Riddie, Chief Analyst
 Manager

Except by special permission, reproduction of these results must include any
qualifying remarks made by this ministry with reference to any sample.

Geoservices Laboratory Report

Date October 15, 1980

Address To: P.G. Blue, 207 Sweeney Drive, Toronto, Ontario M4A 1V5

Sample Number	Gold Oz. Per Ton	Gold Value Per Ton	Silver Oz. Per Ton	
#1	Trace <.01			
#2	Trace <.01			

Fees Received

Paid \$17.00 Rec. No. C153328

Chris Riddle
Chris Riddle, Chief Analyst
Manager

Except by special permission, reproduction of these results must include any
qualifying remarks made by this ministry with reference to any sample.



Ministry of
Natural
Resources

Ontario
Geological
Survey

77 Grenville Street
11th Floor
Toronto, Ontario
M7A 1W3
Telephone 965-1337

Geoservices
Laboratory
Report

Report No.
C 20869

Date
Nov. 03, 1980

Issued to:

P. G. Blue 207 Sweeney Drive Toronto, Ontario M4A 1V5

SAMPLE NO.

2

URANIUM OXIDE (U₃O₈)

4 ppm . 0004 %

34.3 ppm
one count per liter

350 ppm by / l of xli
stair.

Fees Received

Paid \$6.00 Receipt #C153328

Director

Chris Riddle Chief Analyst

Except by special permission reproduction of these results must include any qualifying remarks made by this ministry with reference to any sample.



2.3615

Recorded Holder **Peter G. Blue**

Township or Area **Township of Shakespeare**

Type of survey and number of Assessment days credit per claim	Mining Claims Assessed
Geophysical Electromagnetic _____ days Magnetometer _____ days Radiometric _____ days Induced polarization _____ days Section 86 (18) <u>See across</u> _____ days Geological _____ days Geochemical _____ days Man days <input type="checkbox"/> Airborne <input type="checkbox"/> Special provision <input type="checkbox"/> Ground <input checked="" type="checkbox"/> <input type="checkbox"/> Credits have been reduced because of partial coverage of claims. <input type="checkbox"/> Credits have been reduced because of corrections to work dates and figures of applicant.	 \$72.75 spent on assaying samples taken from claim S.543810 4.87 days' credit allowed

Special credits under section 86 (15a) for the following mining claims

No credits have been allowed for the following mining claims.

not sufficiently covered by the survey insufficient technical data filed

The Mining Recorder may reduce the above credits if necessary in order that the total number of approved assessment days recorded on each claim does not exceed the maximum allowed as follows: Geophysical — 80; Geological — 40; Geochemical — 40; Section 86(18)-80:

APRIL 1980 PETER G BUCKE CLAIMS 543810 AND 460724
Claims 543810 + 460724

SEPT-OCT 1980

ASSESSMENT WORK REPORTED ON 1979 ASSESSMENT REPORT

ASSAYS - SAMPLING

TAKEN HERE APRIL-SEP-OCT 1980

ASSAYS-SAMPLING TAKEN HERE APR-SEP-OCT 1980

CLAIM 543810 LOT 4 CONC II SHAKESPEARE TWP.

SHRUBLY POST FOR BOUNDARY BETWEEN LOT 415 CONC I & II

APRIL 1980 PITS ENLARGED - DRILLING AND BLASTING-MANUAL.

NW CORNER OF CLAIM 460724 AND SW CORNER OF CLAIM 543810

PIT FROM PREVIOUS WORK - SEE ASSESSMENT WORK REPORTED FOR 1979, 1978.

EDGE OF SMALL CLIFF

SHAKESPEARE MINE ABOUT 400'

ROUGH TRAIL FROM ROAD

ROCKY HILL

ROCKY HILL

NARROW VALLEY

TO TOWNSHIP ROAD

TO YOUNG'S LAKE

BUSH ROAD

CLAIM 460724 NW 1/4 OF N 12 W 10 S SHAKESPEARE TWP.

PITS REPORTED ON 1979 ASSESSMENT WORK REPORT.



411055W0059 0025A1 SHAKESPEARE

010

NW CLAIM POST
543810

TOWNSHIP ROAD

CLAIM 543810 SHAKESPEARE
TWP.

APPROX 50'

CUTCROP SEE DETAIL PAGE (A)

TURN AROUND

PLUGGER HOLES

HYDRO POLES AND WIRES

ROAD TO YOUNG'S LAKE
AND SHAKESPEARE
GOLD MINE

FAULT LINE

SEE DETAILS PAGE (B)

ROCKY HALL-CUTCROP.

DD HOLES

DD HOLE

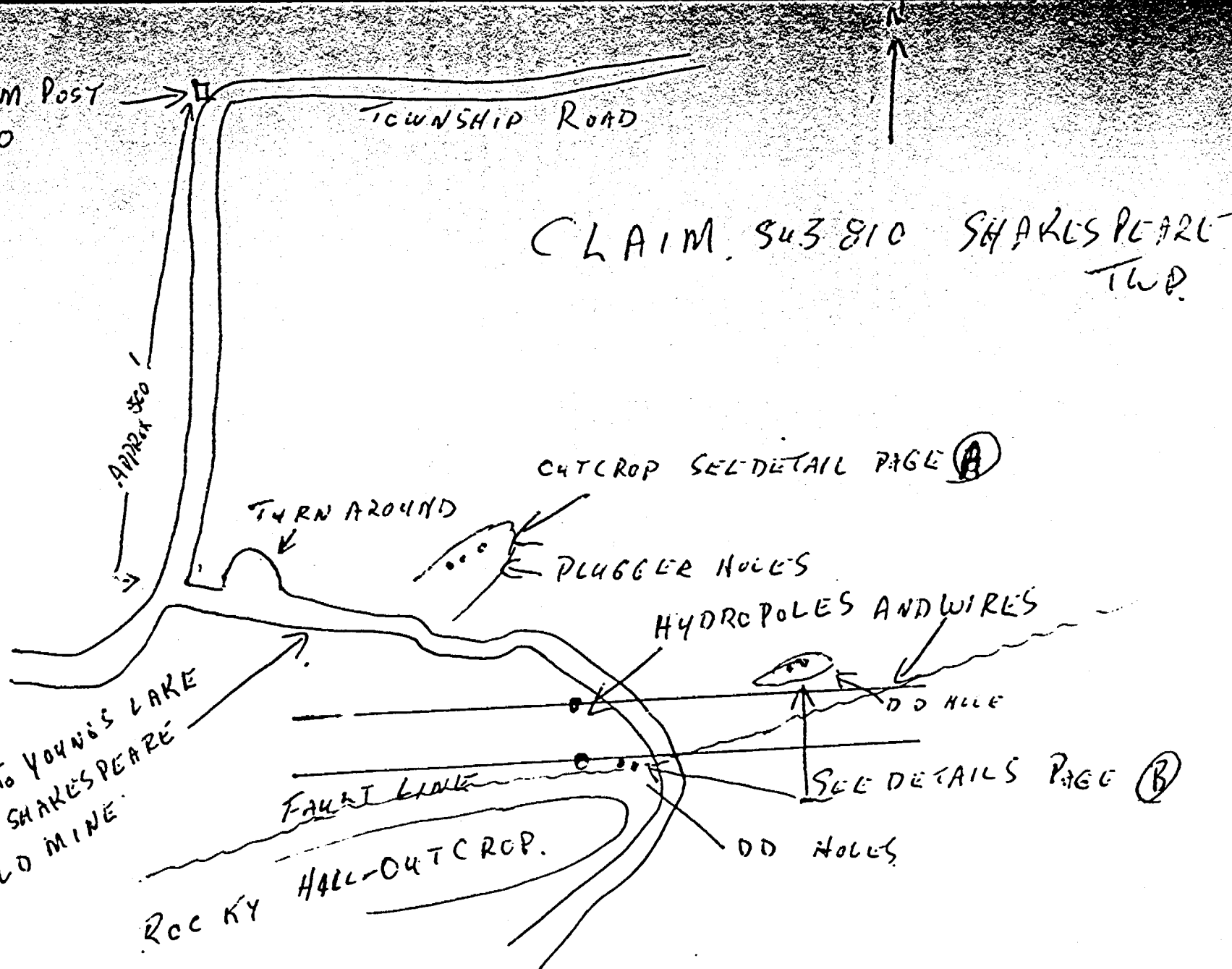



PAGE (A)

CLAIM 543810
SHAKESPEARE TWP.

PLUGGER HOLES

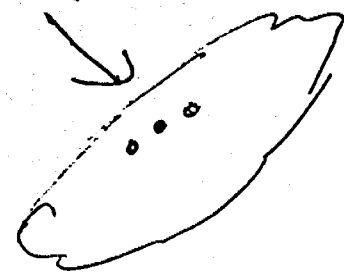

TOWNSHIP
ROAD

ROAD TO YOUNGS LAKE AND SHAKESPEARE MINE

↑
SMALL
HILL

↑
SMALL
HILL

← SMALL
WATERCOURSE

SWAMP
←

PAGE (B)

CHAIN SUBSIC SHAKESPEARE TWP.

